

Save This Manual
For Future Reference

SEARS

**owner's
manual**

MODEL NO.
113.299720

Serial
Number _____
Model and serial
numbers may be found
on the face beside the
switch. You should
record both model and
serial numbers in a safe
place for future use.

**FOR YOUR
SAFETY**

**READ ALL
INSTRUCTIONS
CAREFULLY**

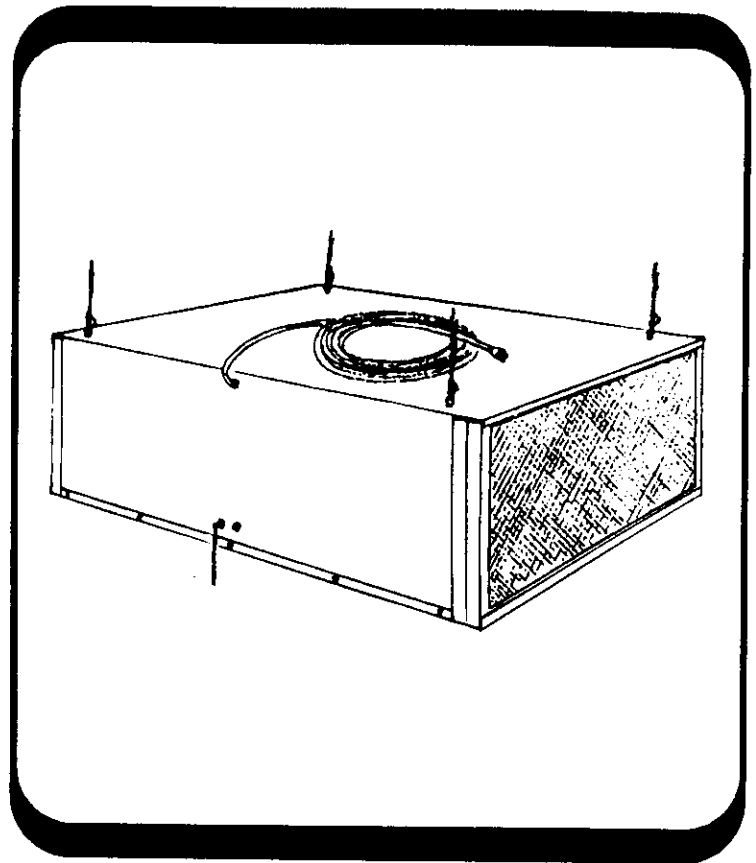

CRAFTSMAN®

**AIRBORNE
FILTRATION SYSTEM**

- **assembly**
- **operating**
- **repair parts**

Sears, Roebuck and Co., Hoffman Estates, IL 60179 U.S.A.

Part No. SP6131

Printed in U.S.A.

FULL ONE YEAR WARRANTY ON CRAFTSMAN Airborne Filtration System

If within one year from the date of purchase, this Craftsman Airborne Filtration System fails due to a defect in material or workmanship, Sears will repair it, free of charge.

If this Craftsman Airborne Filtration System is used for commercial or rental purposes, this warranty coverage applies for only 90 days from date of purchase.

WARRANTY SERVICE IS AVAILABLE BY SIMPLY CONTACTING THE NEAREST SEARS SERVICE CENTER/DEPARTMENT THROUGHOUT THE UNITED STATES.

This warranty applies only while this product is used in the United States.

This warranty gives you specific legal rights, and you may also have other rights which vary from state to state.

Sears, Roebuck and Co., D817 WA, Hoffman Estates, IL. 60179

IMPORTANT SAFETY INSTRUCTIONS

Safety is a combination of common sense, staying alert and knowing how your Airborne Filtration System works. Read this manual to understand the Airborne Filtration System.

Safety Signal Words

DANGER: means if the safety information is not followed someone **will** be seriously injured or killed.

WARNING: means if the safety information is not followed someone **could** be seriously injured or killed.

CAUTION: means if the safety information is not followed someone **might** be injured.

When using your Airborne Filtration System, follow basic safety precautions including the following.

WARNING - To reduce the risk of fire, electric shock, or injury:

Read and understand this owner's manual and all labels on the Airborne Filtration System before operating. Use only as described in this manual. To avoid personal injury or damage to Airborne Filtration System, use only Sears Craftsman recommended accessories.

Sparks inside the motor can ignite flammable vapors or dust. To avoid fire or explosion:

- Do not use this Airborne Filtration System near flammable or combustible liquids, gases, or explosive dusts, such as gasoline or other fuels, lighter fluid, cleaners, oil-based paints, natural gas, hydrogen, coal dust, magnesium dust, grain dust, or gun powder.

To avoid health hazards from vapors or dusts, do not operate near toxic materials. Do not use or store near hazardous materials. To avoid electric shock, do not expose to rain. Store indoors.

Do not allow Airborne Filtration System to be used as a toy. Close attention is necessary when used by or near children.

Do not use this Airborne Filtration System with a torn filter or without the filters installed.

Do not use this Airborne Filtration System without fine filter screw installed.

Unplug from outlet before servicing. Turn off Airborne Filtration System before unplugging.

To avoid injury from accidental starting, unplug power cord before changing or cleaning filters.

Do not unplug by pulling on cord. To unplug, grasp the plug, not the cord. Do not use with damaged cord, plug or other parts. If your Airborne Filtration System is not working as it should, has missing parts, has been dropped, damaged, left outdoors, or dropped into water, return it to a Sears Service Center.

Keep cord away from heated surfaces, such as light bulbs or heaters.

Do not handle plug or the Airborne Filtration System with wet hands.

Do not put any object into ventilation openings.

Keep hair, loose clothing, fingers and all parts of body away from openings and moving parts.

This product should not be used in a spray paint booth or in a kitchen type environment.

Do not use the top of this unit for storage.

WARNING: To reduce the risk of electric shock - do not expose to rain - store indoors.

WARNING: For your own safety, read and understand owner's manual. Do not use the Airborne Filtration System to filter hot ashes, coals, toxic, flammable or other hazardous materials. Do not use around explosive liquids or vapors.

SAVE THESE INSTRUCTIONS

The operation of any power tool can result in foreign objects being blown into the eyes, which can result in severe eye damage. Always wear safety goggles complying with CSA Z94-3-M88 (shown on package) before commencing operation. Safety Goggles are available at Sears retail or hardware stores.



To avoid hearing damage, wear ear protectors when using any power tool for extended hours, or when working in a noisy area. For dust operations, wear dust mask.

Use only extension cords that are rated for outdoor use. Extension cords in poor condition or that are too small in wire size can pose fire and shock hazards. When using an extension cord, be sure it is in good condition. Using any extension cord will cause some loss of power. To keep the loss to a minimum, use the following table to choose the minimum wire size extension cord.

Extension Cord Length	Gauge (A.W.G.)
0-50 Ft.	14
50-100 Ft.	12

Contents

Item	Page	Item	Page
Warranty Information	2	Electrical Requirements	7
Safety Instructions	2	Operation.....	8
Contents	4	Maintenance	8
Unpacking and Checking		Wiring Diagram.....	9
Carton Contents	4	Repair Parts	10
Installation Procedure.....	5		

Unpacking and Checking Carton Contents —

Remove entire contents of carton. Check each item against the Carton Contents List. Notify your Sears Store immediately if any parts are damaged or missing.

Carton Contents List

Key	Description	Qty.
A	Airborne Filtration System	1
B	Owners Manual.....	1
C	Bag of Loose Parts Containing the following:	
D	"S" Hook.....	4
E	Screw Hook.....	4
F	3/16-24 Eye Bolt	4
G	Extension Spring.....	4
H	Double Loop Chain	4
J	3/16" Lockwasher.....	8
K	3/16-24 Hex Nut.....	8

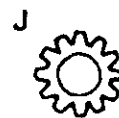
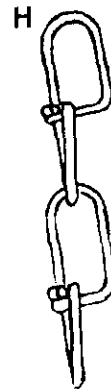
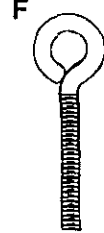
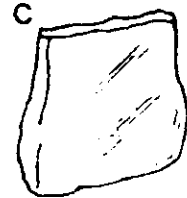
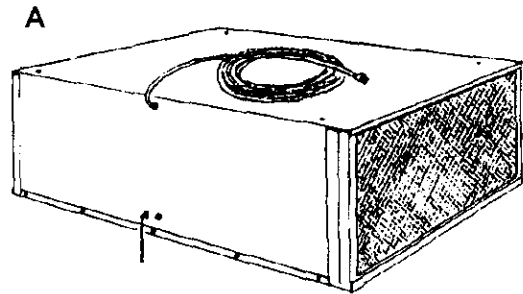

Installation Procedure

WARNING: For your own safety, never connect plug to power source outlet until all assembly steps are complete and you have read and understood the safety and operation instructions. Do not operate filter system with any parts damaged or missing.

1. Select location for Airborne Filtration System. Unit should be installed with the side opposite the switch and light a minimum distance of six inches to the nearest wall. Ends should be at least two feet clear of wall surface to allow for proper air circulation as shown below.

It is important that you select the location carefully so that it is not in a high traffic area, or consider installing it above a bench to reduce the hazard of bumping your head on the unit. The minimum height required for the unit and suspension will be 17-3/8", so keep this in mind when selecting a location.

2. Joists are normally sixteen inches apart. Spacing of holes on width of unit is 18-7/8", and on length of unit is 28" on center as shown. Chain allows for suspension from joist in either direction.
3. Unit weighs 40 pounds so suspension should be from center of ceiling joists only.

WARNING: To reduce the risk of injury from a falling unit, install in structure that will support 160 pound load.

4. When you have selected the location for your unit, use a pencil to mark the four suspension points in the joists (again, make sure that these points are at the center of the joists). Drill 1/8" diameter pilot holes 1-1/4" deep into each of the four suspension points.
5. Install the four screw hooks in the pilot holes up to the start of the curve as shown on page 6.

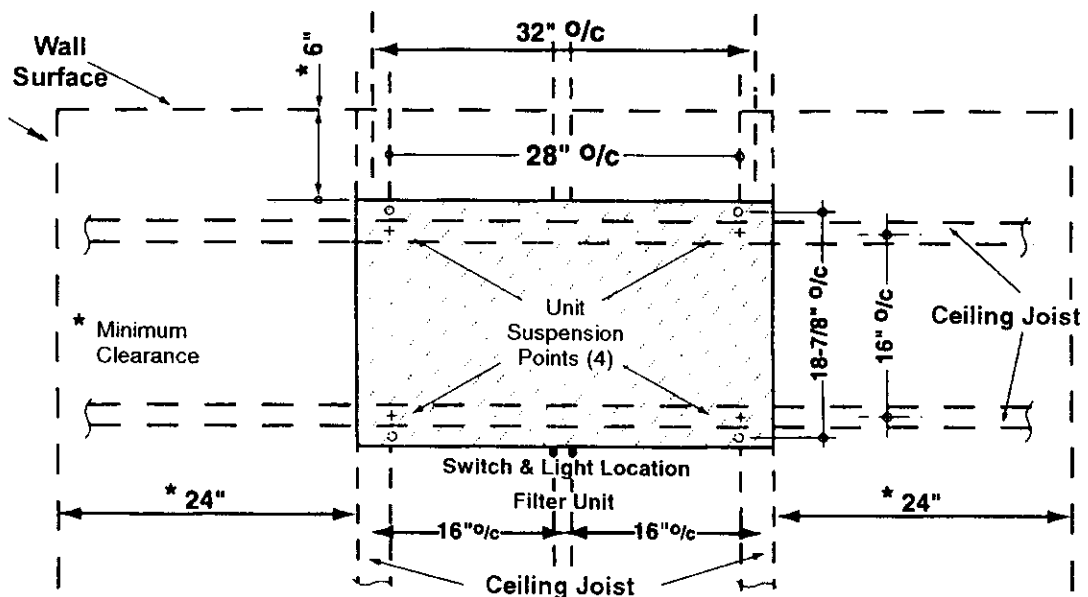

* 24" minimum clearance from wall to unit openings, 6" minimum from wall to side.

Installation Procedure (continued)

6. The next step is to install the eye bolts in the top of the unit. To do this, you must remove the three filters first. Refer to drawing under "Maintenance" section for location of three types of filters.
7. The Pre Filter (intake) slides out of the channel in the cabinet.
8. The Fine Filter (mid bag type) has a screw at the center of the bottom of the cabinet. To remove the Fine Filter, remove screw and slide filter out about 2" to the right. Push left end of filter into cabinet about 4". Slide filter further into cabinet at an angle. Tilt in at top and pull filter towards you.
9. The diffuser (exhaust) slides out of the channel in the cabinet.
10. Install a hex nut on an eye bolt until 1/4" of thread is showing below the eye. Slip on a lockwasher and put eye bolt in hole in top of cabinet. Repeat for other three eye bolts.
11. Slip lockwasher and hex nut on eye bolt as shown on Figure "B". Repeat for other three eye bolts and then tighten nuts with two wrenches until all nuts are snug.
12. Filters can be reinstalled at this point.
 - Diffuser (exhaust) - slide into channel.
 - Fine Filter (mid bag type) - reverse motions for removing the fine filter, shown in step 8. Reinstall bottom screw.
 - Pre Filter (intake) - slide into channel.

WARNING: Although compact in size, the Air Filtration Unit weighs 40 lbs. To avoid back injury obtain help to lift the unit into place.

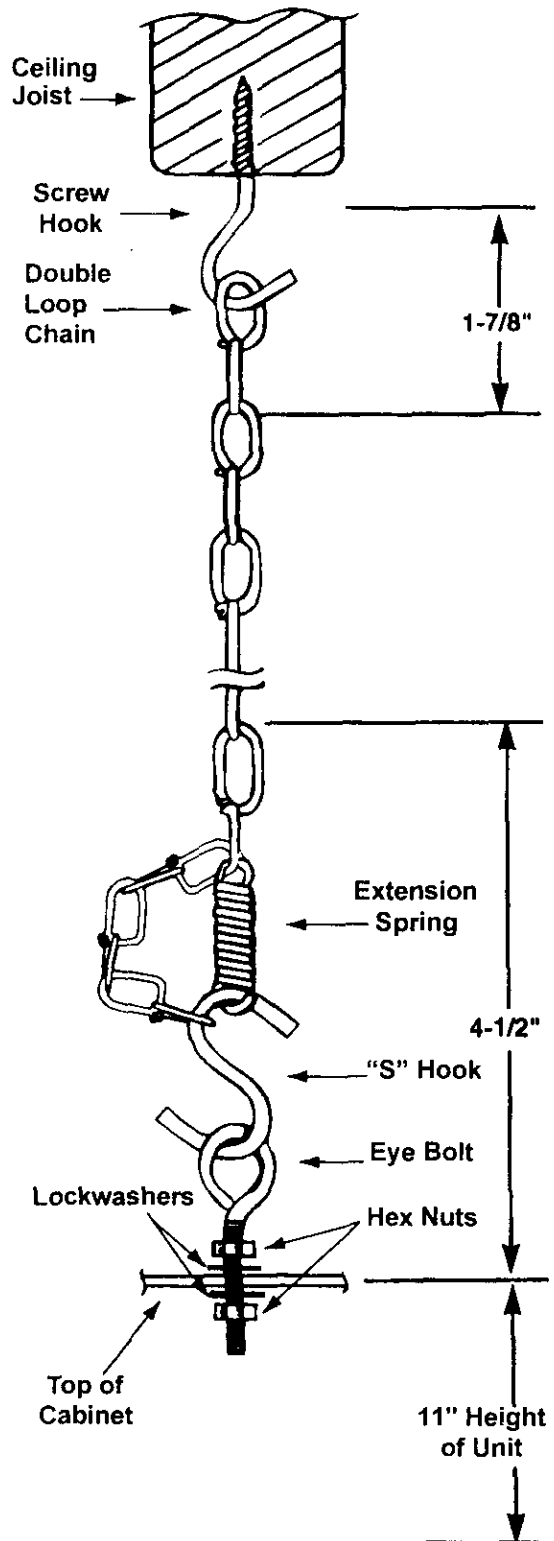

13. To suspend your unit at the minimum height, five double loop sections of chain are required (4-13/16"). Slip this length of chain over the screw eye in the joist, letting the excess chain hang down in case adjustment of length is required later.
14. Place "S" hook in bottom link of chain at four suspension points.
15. Lift cabinet up, with help and connect "S" hooks to eye bolts at four points in cabinet.
16. Connect extension springs to "S" hooks. Push unit up and connect upper loop of extension spring to bottom loop of fourth double loop of

chain. Repeat for other three springs. Refer to figure shown on previous page.

17. Unit is now hung from the ceiling as high as possible. If you prefer the unit to hang lower, unhooking each of the four chains from its screw hook (one at a time), and rehooking each chain to its screw hook on a different link can do this. When the hanging height is satisfactory, squeeze all four "S" hook loops closed at the eye bolts and chains. (Optional: For a cleaner appearance, snip off extra length of chain links.)

Electrical Requirements

Your filter system is wired for 120 volts A.C. and is equipped with a 3 conductor cord and grounding type plug approved by Underwriters Laboratories and Canadian Standards Association.

Connect unit to the nearest 120 volt AC outlet and route cord so that it will not be easily snagged and pulled accidentally.

This plug requires a mating 3 conductor grounded type outlet, properly grounded. If the outlet you are planning to use for this filter unit is of the two prong type **DO NOT REMOVE OR ALTER THE GROUNDING PRONG IN ANY MANNER.** Have a qualified electrician replace the 2-prong outlet with a grounded 15 amp 3-prong outlet.

WARNING: Damaged power cords can cause shocks or fires. If the power cord is worn, cut or damaged in any way, have it replaced immediately.

WARNING: To assure product SAFETY and RELIABILITY, repairs and adjustment should be performed by Sears Service Centers, always using Sears replacement parts.

WARNING: Electric shock can kill. Not all outlets are properly grounded. If you are not sure that your outlet is properly grounded, have it checked by a qualified electrician.

WARNING: Electric shock can kill. To avoid shock, never connect plug to power source outlet until all assembly steps are completed. Unplug filter unit before servicing or changing any filters.

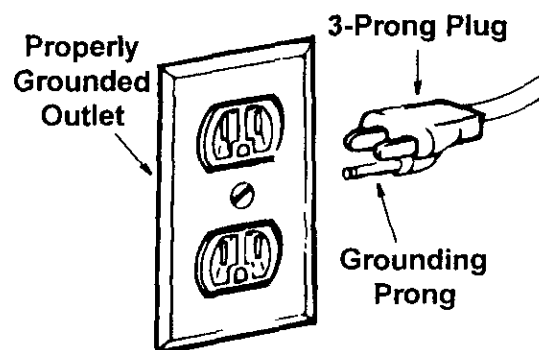

Operation

WARNING: To avoid fire or explosion, do not operate this filter unit in areas with flammable gases or flammable vapors such as lighter fluid, cleaners, oil-base paints, gasoline, alcohol or explosive dust such as coal, magnesium, grain or gun powder in the air. To avoid health hazards from vapors or dusts, do not use this system to filter toxic materials. The Craftsman Airborne Filtration System is intended for indoor use only. Unplug power cord before changing or cleaning filters.

CAUTION: The operation of any power tool can result in foreign objects being thrown into the eyes, which can result in severe eye damage. Always wear safety goggles complying with CSA Z94-3-M88 (shown on Package) before commencing operation. Safety Goggles are available at Sears hardware stores.

Your Craftsman Airborne Filtration System is equipped with an Pull On/Pull Off switch, a light to show power is ON, and a power cord to plug into your electrical outlet.

When installation is complete, plug power cord into wall receptacle. To activate Airborne Filtration System, pull on switch cord. Light will come on and filter unit is in operation. To stop operation, pull on switch cord and the light will turn off.

Remove power cord from wall receptacle before changing or cleaning filters.

WARNING: To reduce the risk of fire or electrical shock, do not use this Airborne Filtration System with any solid-state speed control device.

Maintenance

IMPORTANT: To assure product safety and reliability, repairs and adjustments should only be performed by Sears Service Centers, always using Sears replacement parts.

Filter Maintenance

WARNING: To avoid injury from accidentally starting, unplug power cord before cleaning or changing filters.

Cleaning

Your Airborne Filtration System consists of three types of filters as shown under "Removal".

- #1 - Pre Filter (intake)
Polyurethane foam
- #2 - Fine Filter (mid-bag type)
Non-woven polyester

#3 - Diffuser (exhaust)

Expanded aluminum

The #1 Pre Filter and #3 Diffuser can be washed in warm water with a mild detergent, dried and then reinstalled. Check the filters for tears or small holes. Do not use a filter with holes or tears in it.

Replace it immediately. To maintain peak performance clean your filters often. Handle the filters carefully, when removing to clean or when installing.

The #2 Fine Filter should be replaced when it becomes clogged with fine dust. A visual inspection can be done by sliding the #1 Pre Filter out and checking the Fine Filter for contents and tears or holes. If tears or holes appear, replace your filter immediately.

Removal

To remove the filters for cleaning or replacement review the section in your manual under "Installation Procedure" following steps, 7, 8 and 9.

WARNING: For your own safety, use only Sears replacement filters.

WARNING: To avoid electrical shock, be sure to replace screw that secures Fine Filter.

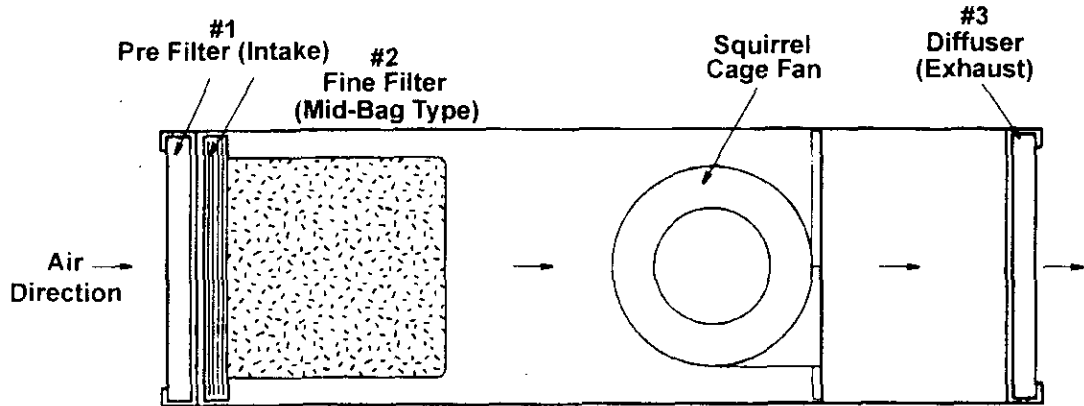

CAUTION: For proper operation, make sure "Air Flow" arrows on the filters are facing the proper direction.

Wiring Diagram

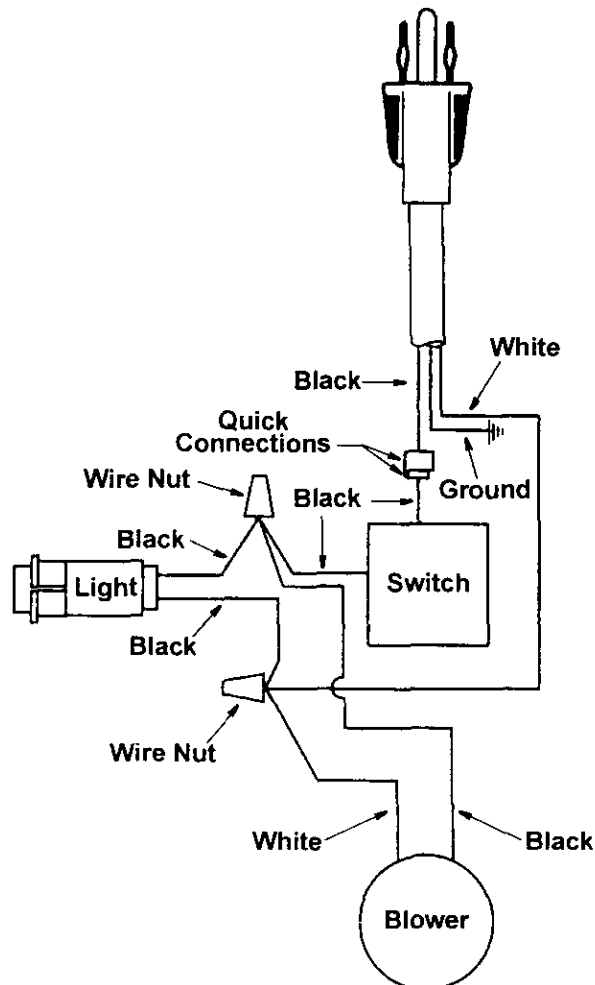

Repair Parts

Airborne Filtration System Model Number 113.299720

Always order by Part Number - Not by Key Number

Key No.	Part No.	Description
1	825702	Cabinet Assembly
2	824294	Bottom Panel
3	9-17931	† Pre Filter - Intake
4	9-17933	† Fine Filter - Mid Bag Type
5	824295	Diffuser - Exhaust
6	824311	Blower Assembly
7	824289	Cord Assembly
8	169123-9	Strain Relief
9	824288	Light
10	824292	Switch Assembly
11	STD375006	* Wire Connector
12	824290	Clip Wire
13	60306	* Screw, Pan Hd. Cross Recess 8-32 x 3/8" Lg.
14	STD551225	* Lockwasher, 1/4" External Type
15	STD541025	* Hex Nut 1/4-20
16	**	Gasket 1/8" Max. Th. x 1/4" x 9"
17	824301	* "S" Hook 1-1/2"
18	824299	* Screw Hook 1-9/16"
19	824302	* Eye Bolt 3/16-24 x 2"
20	STD541010	* Hex Nut 3/16-24
21	STD551210	* Lockwasher 3/16" External Type
22	824298	* Chain, Double Loop
23	824300	Spring, Extension 1-1/4"
24	824291	Clip Wire
25	STD551208	* Lockwasher - External Type #8
26	809372-3	* Screw, Pan Hd. Cross Recess 10-32 x 1/2"
27	STD541110	* Hex Nut 10-32 ZN
28	821330	* Screw K-Lath #8 x 9/16"
29	824597-1	Screen, Blower
—	SP6131	Owners Manual (Not Illustrated)

* Standard Hardware Item - May Be Purchased Locally.

** Standard weather stripping (purchase locally)

† Stock Item - May be purchased through the hardware department of most Sears retail stores.

Repair Parts

Airborne Filtration System Model Number 113.299720

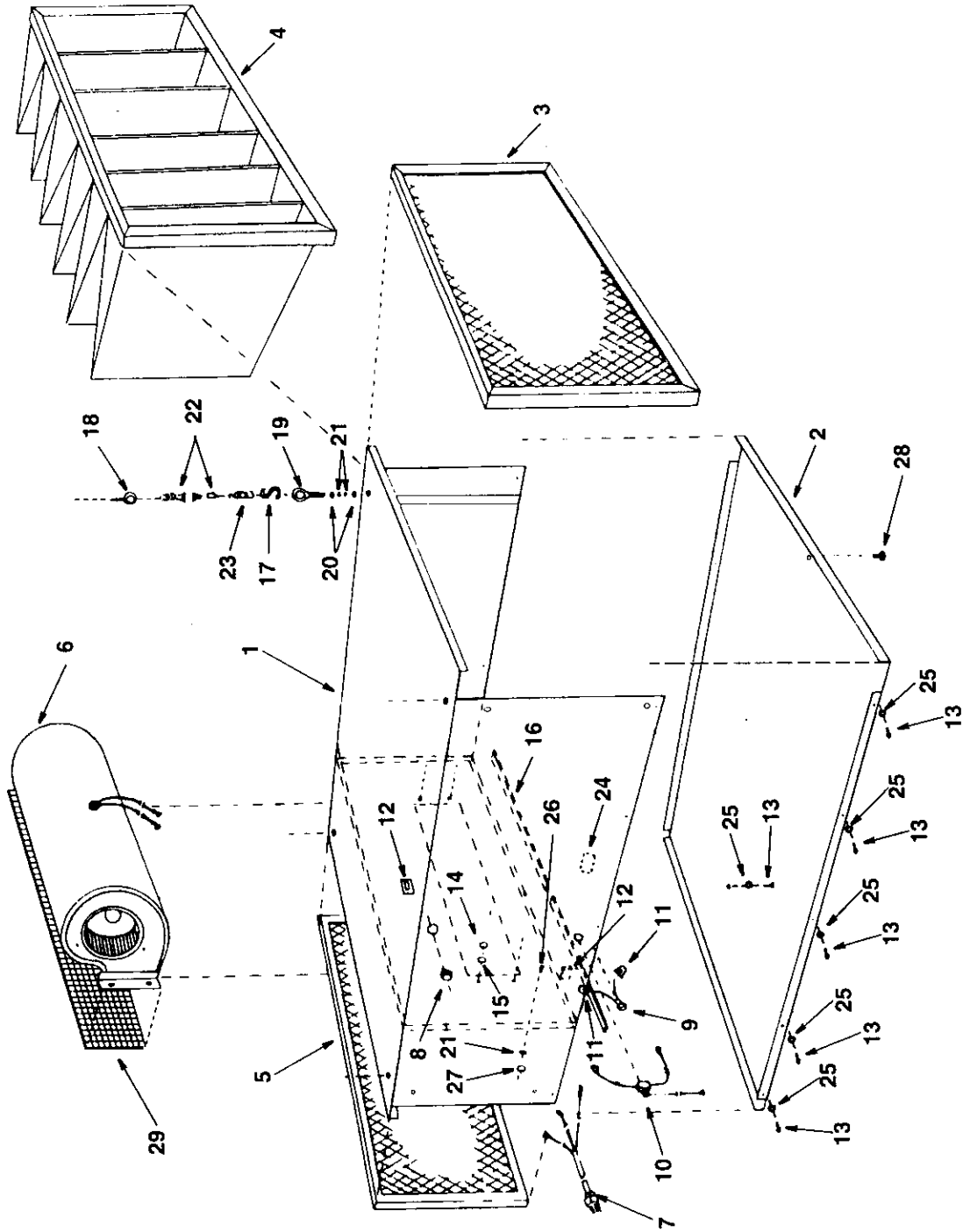

For the repair or replacement parts you need

Call 7 am - 7 pm, 7 days a week

1-800-366-PART

(1-800-366-7278)

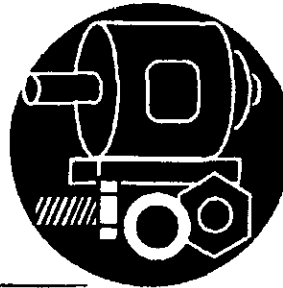

For in-home major brand repair service

Call 24 hours a day, 7 days a week

1-800-4-REPAIR

(1-800-473-7247)



**For the location of a
Sears Repair Service Center in your area**

Call 24 hours a day, 7 days a week

1-800-488-1222



**For information on purchasing a Sears
Maintenance Agreement or to inquire
about an existing Agreement**

Call 9 am - 5 pm, Monday-Saturday

1-800-827-6655



SEARS
REPAIR SERVICES

America's Repair Specialists

The model and serial numbers will be found on the handle.
When requesting service or ordering parts, always provide the following information:

- Product Type
- Part Number
- Part Number
- Part Description

Sears, Roebuck and Co., Chicago, IL. 60179 U.S.A.