



OPERATOR'S MANUAL

**Models
587 and 588**



IMPORTANT: READ SAFETY RULES AND INSTRUCTIONS CAREFULLY

Warning: This unit is equipped with an internal combustion engine and should not be used on or near any unimproved forest-covered, brush-covered or grass-covered land unless the engine's exhaust system is equipped with a spark arrester meeting applicable local or state laws (if any). If a spark arrester is used, it should be maintained in effective working order by the operator. In the State of California the above is required by law (Section 4442 of the California Public Resources Code). Other states may have similar laws. Federal laws apply on federal lands. A spark arrester for the muffler is available through your nearest engine authorized service dealer or contact the service department, P.O. Box 368022 Cleveland, Ohio 44136-9722.

MTD PRODUCTS INC. P.O. BOX 368022 CLEVELAND, OHIO 44136-9722

SECTION 1: FINDING YOUR MODEL NUMBER

This Operator's Manual is an important part of your new edger. It will help you assemble, prepare and maintain your edger. Please read and understand what it says.

Before you start to prepare your edger for its first use, please locate the model plate and copy the information from it in this Operators Manual. The information on the model plate is very important if you need help from your dealer or the MTD customer support department.

- Every edger has a model plate. You can locate it by standing in the operating position behind the unit and looking down at the rear of the frame. An example of the model plate is shown below.

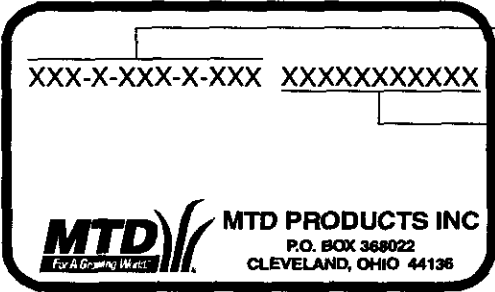
	_____ This is where your model number will be.
	_____ This is where your serial number will be.
	Copy the model number here: _____
	Copy the serial number here: _____

SECTION 2: CALLING CUSTOMER SUPPORT

- **LOCATE YOUR MODEL NUMBER AND SERIAL NUMBER** — Record this information in the space provided. To find your unit's specific model number and serial number, see SECTION 1: FINDING YOUR MODEL NUMBER.
- If you are having difficulty assembling this product or if you have any questions regarding the controls, operation or maintenance of this unit, please call the Customer Support Department.
- Customer Support can be reached by dialing: **1- (330) 220-4MTD (4683)**
or
1- (800)-800-7310
- Please have your model number and serial number ready when you call.
- Although both numbers are important, you will be asked to enter only your *serial* number before your call can be processed.

SECTION 3: IMPORTANT SAFE OPERATION PRACTICES



WARNING: THIS SYMBOL POINTS OUT IMPORTANT SAFETY INSTRUCTIONS WHICH, IF NOT FOLLOWED, COULD ENDANGER THE PERSONAL SAFETY AND/OR PROPERTY OF YOURSELF AND OTHERS. READ AND FOLLOW ALL INSTRUCTIONS IN THIS MANUAL BEFORE ATTEMPTING TO OPERATE YOUR EDGER. **FAILURE TO COMPLY WITH THESE INSTRUCTIONS MAY RESULT IN PERSONAL INJURY. WHEN YOU SEE THIS SYMBOL HEED ITS WARNING.**



WARNING: The Engine Exhaust from this product contains chemicals known to the State of California to cause cancer, birth defects or other reproductive harm.



DANGER: Your edger was built to be operated according to the rules for safe operation in this manual. As with any type of power equipment, carelessness or error on the part of the operator can result in serious injury. If you violate any of these rules, you may cause serious injury to yourself or others.

1. TRAINING AND PREPARATION

- Read the operator's manual carefully. Be thoroughly familiar with the controls and proper use of the equipment. Know how to disengage the blade control and stop the unit quickly.
- Never allow children to operate equipment. Never allow adults to operate equipment without proper instruction.
- Keep the area of operation clear (at least 50 feet) of all persons, especially small children and pets.
- Use the edger only as manufacture intended and as described in the operator's manual.
- Do not operate edger after it has been dropped or damaged.
- Return product to nearest authorized service facility for examination and repair. Do not operate product with damaged or excessively worn cutting blade.
- Dress properly-always wear safety glasses or goggles. Always wear safety footwear, and pants or slacks that cover your legs to reduce the risk of injury that may be caused by flying debris. Do not wear loose clothing or jewelry that can be caught in moving parts. Use of gloves and substantial footwear is recommended when working outdoors. Do not operate edger when barefoot or wearing sandals or open-toed shoes. Wear boots, preferably with steel-toe caps.
- Objects struck by the blade can cause severe injuries to persons. The work area should always be carefully examined and cleared of all stones, sticks, wires, bones and other foreign objects, prior to edging.
- Never attempt to make any adjustments, other than depth of cut, while engine is running.
- The use of accessory attachments not recommended by the manufacturer may cause hazard and will void warranty.
- Never operate the edger without proper guards, plates or other safety protective devices in place.
- Turn engine off and disconnect spark plug wire:
 - When not in use.
 - Before servicing, cleaning and the like.
 - Before changing accessories.
- Handle fuel with care; it is highly flammable
- Extinguish all smoking materials and other possible sources of ignition.
- Use a fuel container acceptable for the purpose.
- Never add fuel to a running or hot engine.
- Fill fuel tank outdoors with extreme care. Never fill fuel tank indoors.
- Replace gasoline cap securely.
- If fuel is spilled, move product and fuel container from area and do not create a source of ignition. Wipe up spilled fuel.

2. OPERATION

- Make sure all nuts, bolts, and screws are kept tightly in place, especially the blade and all guards.
- Start the engine carefully. Make certain the blade is disengaged before attempting to start. Keep hands, feet, clothing, and the like well away from cutting blade and moving parts.

DANGER: ROTATING CUTTING BLADE

- Keep both hands on handles when blade is rotating.
- Keep feet away from cutting area.
- Make sure engine is off and spark plug wire is disconnected when clearing jammed material from blade.

- Make sure engine is off and spark plug wire is disconnected when clearing jammed material from blade.
- Do not attempt to remove cut material nor hold material to be cut when engine is running or when cutting blade is moving.

CAUTION: CUTTING BLADE COASTS AFTER ENGINE IS TURNED OFF.

- Stay alert. Watch what you are doing. Use common sense.
- Do not operate edger when fatigued or under the influence of alcohol, drugs or heavy medication.
- Never operate the product without good visibility or light.
- Keep good footing and balance at all times. Do not overreach or stand on unstable support.
- Do not force or abuse product. It will do the job better and safer at the rate for which it was designed.
- Do not operate engine above speed necessary to do the job.
- Do not run the engine indoors; exhaust fumes are dangerous.
- Never direct discharge of material towards bystanders nor allow anyone near the area of operation. Use care in directing discharge to avoid glass enclosures, automobiles, and the like.
- Stay alert for uneven sidewalks, holes in terrain or other similar conditions when using product. Always push slowly over rough ground. Do not use the product on graveled surfaces.
- Do not operate edger in rain or wet locations.
- Always operate edger from behind the upper handle and position yourself where line of sight to cutting blade is blocked by guards.
- Always disconnect spark plug wire to prevent accidental starting.
- Always stop engine when edging or trimming is delayed or when walking from one location to another.

- After striking a foreign object, shut off the engine, make absolutely sure the blade and all moving parts have completely stopped, disconnect the spark plug wire to prevent accidental starting, then thoroughly inspect the unit for any damage. Such damage must be repaired before restarting and operating the edger. Remember, heavy vibration is generally a sign of trouble.
- Stop the engine, wait for blade and all moving parts to stop before cleaning, adjusting, repairing or inspecting the product.
- Muffler and engine become hot during operation and can cause a burn. Allow to cool down before touching.
- Take all possible precautions when leaving the product unattended. Disengage the blade, stop the engine and disconnect spark plug wire.

3. MAINTENANCE AND STORAGE

STORE PRODUCT INDOORS

- When not in use, store product indoors in a dry place, locked or otherwise inaccessible to children.
- Maintain product with care.
- Follow maintenance instructions given in this manual for your product.
- To reduce the risk of injury and engine failure, do not allow excessive grass, leaves or other debris to accumulate on or in the edger. Wipe engine housing clean after each use.
- Keep air filter clean.
- Follow instructions for changing accessories.
- Replace any missing or damaged labels immediately.
- Do not operate unit if blade is excessively worn or damaged.
- Replace with blade which meets original equipment specifications.
- Do not attempt to repair edger. Have mechanical repairs made by qualified dealer or repairman. See that only identical replacement parts are used.



WARNING - YOUR RESPONSIBILITY: Restrict the use of this power machine to persons who read, understand and follow the warnings and instructions in this manual and on the machine.



Safety Labels found on your edger

SECTION 4: SET-UP INSTRUCTIONS

IMPORTANT: This unit is shipped WITHOUT GASOLINE or OIL. After setting up the unit, service engine with gasoline and oil as instructed in the separate engine manual packed with your unit.

NOTE: Reference to right or left hand side of the edger is observed from the operating position.

TO REMOVE UNIT FROM CARTON

1. Remove staples, break glue on top flaps, or cut tape at carton end and peel along top flap to open carton.
2. Remove all loose parts from carton.
3. Cut along dotted lines and lay carton down flat.
4. Remove any loose cardboard and other packing material from carton and roll unit out.

CONTENTS OF CARTON

- Edger with upper handle folded downward
- Edger Operator's Manual and registration card; engine Owner's Manual
- Clutch Rod
- Hardware pack containing: two flat washers
two hairpin clips
one ferrule

EDGER SET-UP

1. Unfold the edger upper handle and tighten the two hand knobs. See Figure 1.
2. Thread the ferrule onto the threaded end of clutch rod then insert the ferrule into the hole on the blade clutch/depth control lever. Affix with flat washer and hairpin clip provided in hardware pack. See Figure 1, Inset A.

3. Insert opposite end of clutch rod into the hole in the pivot arm extension. Affix with flat washer and hairpin clip provided. See Figure 1, Inset B.

IMPORTANT: Perform clutch rod adjustment before operating the edger.

CLUTCH ROD ADJUSTMENT

Before operating the edger, check the adjustment of the clutch rod as follows.

1. **Disconnect the spark plug wire and move it away from the spark plug.**
2. With the blade clutch/depth control lever in the disengaged position (the top notch in the depth adjustment bracket), carefully pull the recoil starter rope. The blade on the edger should not turn. If the blade turns, remove the ferrule from the blade clutch/depth control lever by first removing the hairpin clip and flat washer.
3. Rotate the ferrule clockwise one or two turns on the clutch rod, then re-insert the ferrule into the lever and recheck the adjustment.
4. After adjusting, check to be certain the blade clutch/depth control lever can be moved to the furthest notch forward without bowing the clutch rod. If it can't, recheck the adjustment.

IMPORTANT: Be certain that the clutch rod is secured at both ends with a flat washer and hairpin clip before operating the edger.



WARNING: When operating the edger, stop engine immediately and readjust the clutch rod if blade turns with blade clutch/depth control lever in the disengaged position.

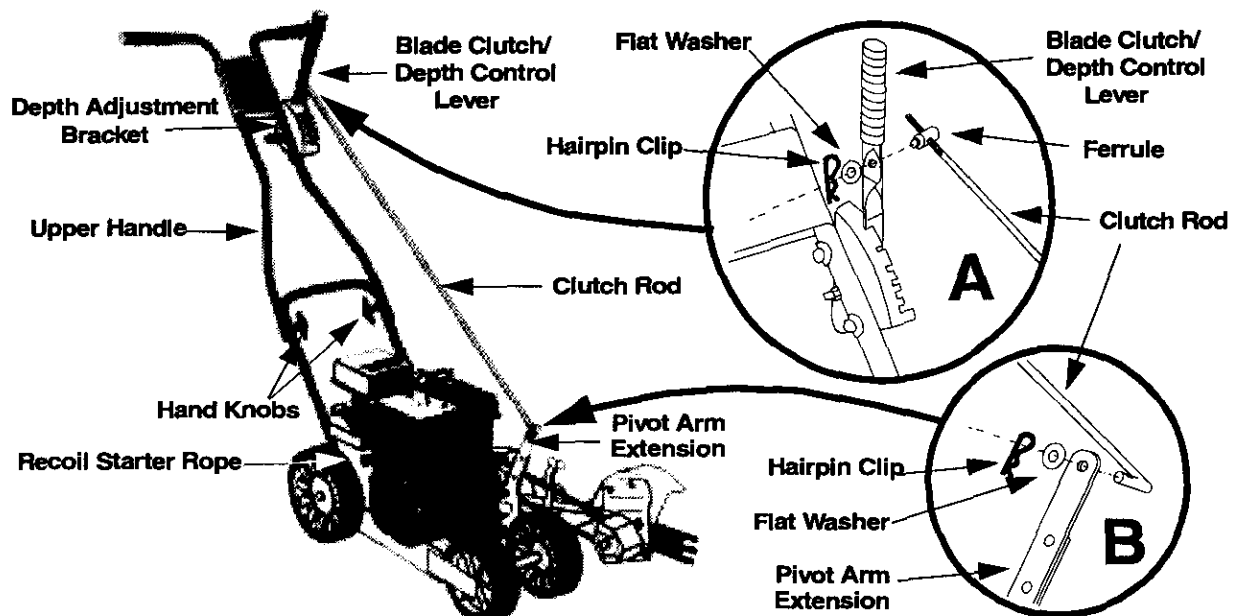

Figure 1

SECTION 5: CONTROLS

THROTTLE CONTROL

The throttle control lever is located on the engine. It allows the engine to run and also stops the engine. Refer to Figure 5.

BLADE CLUTCH/DEPTH CONTROL



WARNING: The blade clutch/depth control is designed to minimize the risk of blade contact injury. Do not under any circumstances attempt to defeat the function of the blade clutch/depth control, or use the edger if the control is not adjusted properly.

Keep hands and feet away from edger blade whenever the engine is running, whether blade is engaged or disengaged.

The blade clutch/depth control has two main functions:

1. To engage and disengage the blade.
2. To control the depth of cut.

To disengage the blade, move the control lever to the left and pull it back to the top notch in the depth adjustment bracket. See Figure 2. This position takes tension off the drive belt and disallows the blade from turning. To engage the blade, move the control lever forward into any of the other notches to engage the drive belt and start the blade turning. The further forward the control lever is moved, the deeper or lower the blade will cut into the ground.

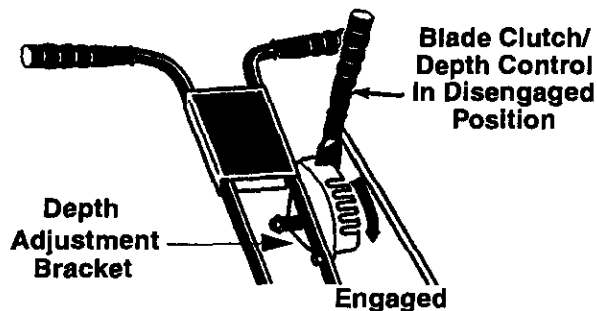

Figure 2

BLADE PLANE ADJUSTMENT

The cutting blade can be adjusted to eight positions from vertical to horizontal. To adjust, make certain the blade is disengaged, release the adjustment lever on the pivot bracket and rotate the spindle housing. Place adjustment lever in notch desired. See Figure 3.

When the blade is adjusted toward the horizontal position, the front wheels must also be adjusted. Remove the hairpin clip on the left side and slide the wheel to the right as shown in Figure 4. Reinsert the hairpin clip.

IMPORTANT: If the wheels are not adjusted, the blade will hit the left front wheel, causing the belt to slip and possibly damaging the wheel.

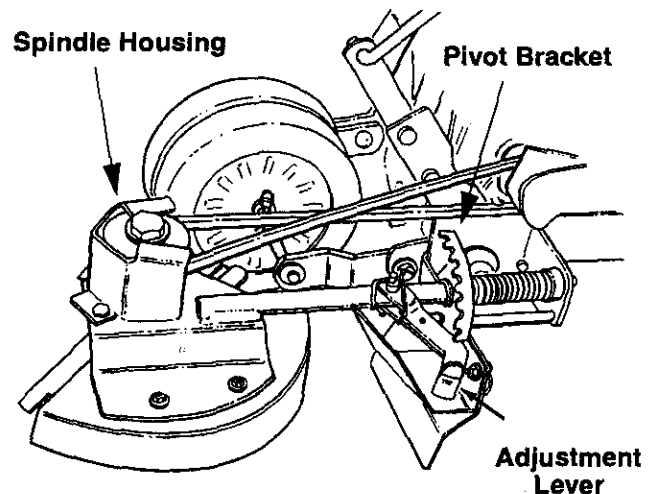

Figure 3

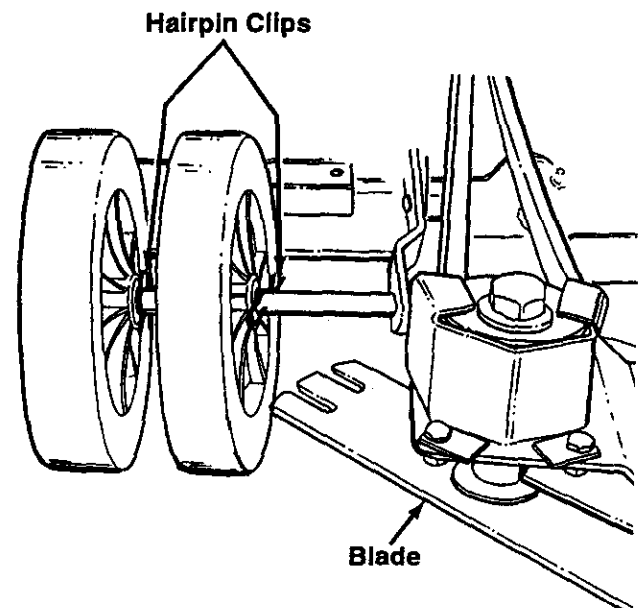

Figure 4

Become familiar with all the controls and adjustments before operating the edger so you can adjust it easily to a variety of cutting and trimming conditions. **DO NOT ATTEMPT TO MAKE ANY ADJUSTMENTS** while the engine is running.

SECTION 6: OPERATION



The operation of any edger can result in foreign objects being thrown into the eyes, which can result in severe eye damage. Always wear safety glasses or eye shields. We recommend wide

vision safety mask for over spectacles or standard safety glasses.



WARNING: Do not engage and lower blade if blade is over concrete, asphalt, rocks, etc. The blade can strike the supporting surface, which could result in personal injury or property damage.

STARTING THE ENGINE

1. Service the engine with gasoline and oil as instructed in the separate engine manual packed with your edger. Read instructions carefully.



WARNING: Never fill fuel tank indoors, with engine running or until the engine has been allowed to cool for at least two minutes after running.

NOTE: The engine may have a short wire dangling near the front of the unit. It is a kill wire and is NOT used in application with your edger. Disregard it.

2. Move the blade clutch/depth control handle back as far as it will go, and place it in the last notch. See Figure 2.
3. Set the throttle in the ON position.
4. Move choke control into the CHOKE position. Refer to Figure 5.

NOTE: A warm engine may not require choking.

5. Grasp starter handle and pull rope out slowly until engine reaches start of compression cycle (rope will pull slightly harder at this point). Let the rope rewind slowly.
6. Pull rope with a rapid, continuous, full arm stroke. Keep a firm grip on starter handle. Return it slowly to the rope guide.
7. After the engine starts, move the choke lever gradually to the RUN position.

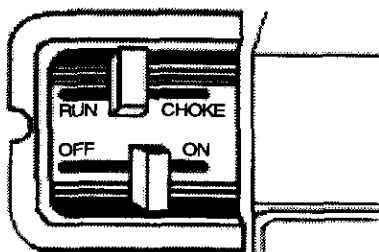

Figure 5

STOPPING THE ENGINE

To stop the engine, move throttle control to the OFF position. Disconnect and ground the spark plug wire to prevent accidental starting while equipment is unattended.

OPERATING THE EDGER



WARNING: Rotating cutting blade may throw objects causing personal injury. Keep area clear of bystanders and do not operate without guards in place.

1. To edge along driveway or sidewalk (vertically), set the adjustment lever (refer to Figure 3) in the second notch. See Figure 6.

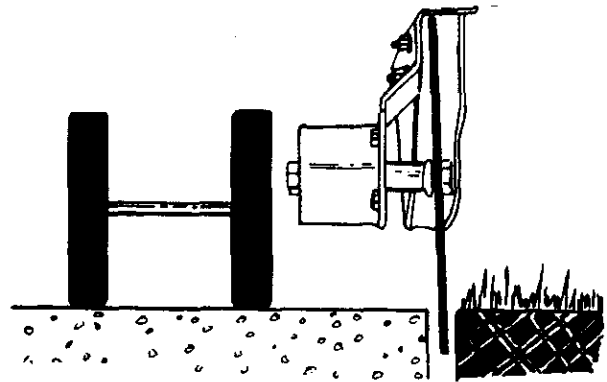

Figure 6

2. To use your edger for trenching, set the adjustment lever (refer to Figure 3) in the first notch at the top. See Figure 7.

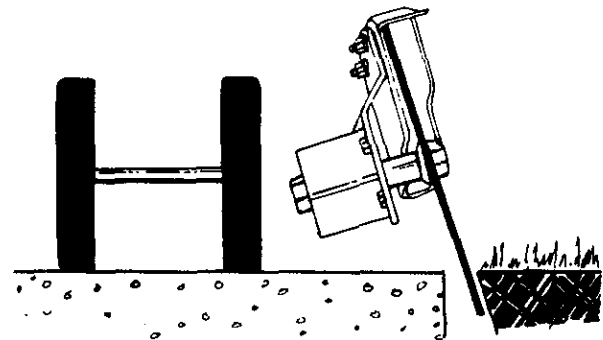

Figure 7

3. To operate the unit as a trimmer, move the adjustment lever and rotate the cutting blade 90 degrees. See Figure 8. Move the front wheels all the way to the right, as described in the SECTION 5: CONTROLS on page 6.



WARNING: Do not adjust the blade guard with the engine running.

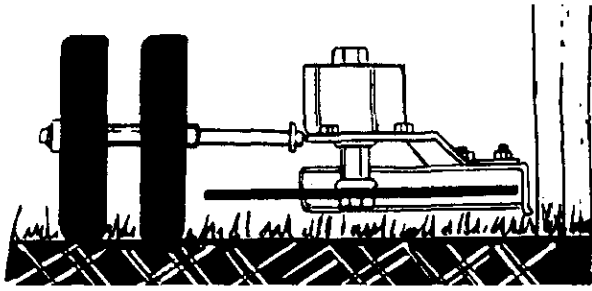

Figure 8

- To edge along a curb, remove the hairpin clip from the right side of the front axle, slide the right wheel toward the left side of the unit and replace the hairpin clip. See Figure 9. Lower the right rear wheel (on units equipped with adjustable curb wheel) by moving the height adjustment lever toward the engine, pivoting the wheel to the desired depth and releasing the lever. See Figure 10.

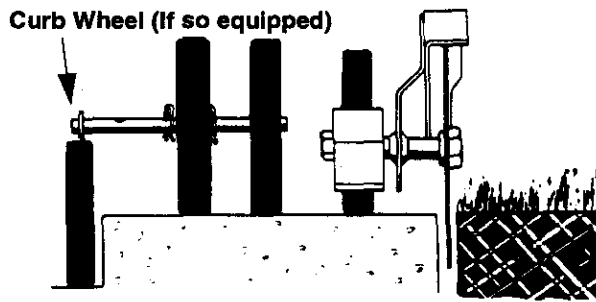

Figure 9

NOTE: Adjustable curb wheel is NOT standard on all units.

Height Adjustment Lever (If so equipped)

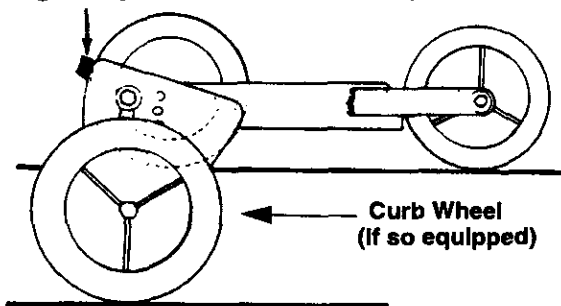

Figure 10

SECTION 7: LUBRICATION

Wheels—The wheels are plastic and require no lubrication.

Cutting Head Bearings—The two ball bearings in the cutting head are lubricated and sealed at the factory and require no lubrication. Lubricate all other moving parts with engine oil.

Shaft—It is important to lubricate the two bearings and the area under the compression spring on the shaft with light oil frequently during the season. Do NOT allow rust to form in this area. See Figure 11.

Engine—Refer to engine manual for lubrication instructions.

SECTION 8: MAINTENANCE



WARNING: Disconnect the spark plug wire and ground against the engine before performing any adjustment, repairs or maintenance.

ENGINE

Refer to engine manual for complete instructions for care and maintenance of engine.

BLADE REMOVAL

Use a wrench on both sides of the blade to remove it for replacement.

BELT REMOVAL

- To remove the V-belt, remove the belt guard assembly at the engine pulley. Remove the hex nuts and lock washers. See Figure 11.

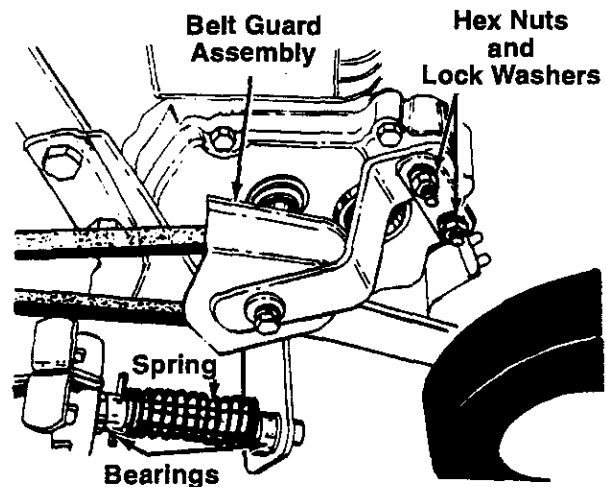

Figure 11

- Remove the belt guard at the spindle assembly by removing two hex bolts, lock washers and hex nuts. See Figure 12.
- Remove the old belt, and reassemble with a new belt, part number 754-0142.

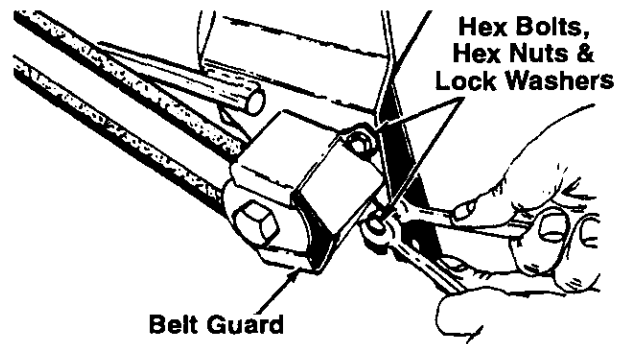

Figure 12

SECTION 9: OFF-SEASON STORAGE

The following steps should be taken to prepare unit for storage.

1. Clean and lubricate unit thoroughly.
2. Refer to engine manual for correct engine storage instructions.
3. Coat cutting blade with chassis grease to prevent rusting.

4. Store unit in a dry, clean area. Do not store next to corrosive materials, such as fertilizer.

NOTE: When storing any type of power equipment in a poorly ventilated or metal storage shed, care should be taken to rustproof the equipment. Using a light oil or silicone, coat the equipment, especially springs and bearings.

SECTION 10: TROUBLE SHOOTING GUIDE

Trouble	Possible Cause(s)	Corrective Action
Engine fails to start	Dirty air cleaner. Choke not in CHOKE position. Fuel tank empty, or stale fuel. Throttle control lever not in ON position. Spark plug wire disconnected. Faulty spark plug. Engine flooded.	Refer to the engine manual packed with your unit. Move switch to CHOKE position. Fill tank with clean, fresh gasoline. Fuel will not last over thirty days unless a fuel stabilizer is used. Move throttle lever to ON position. Connect wire to spark plug. Clean, adjust gap or replace. Refer to the engine manual packed with your unit.
Engine runs erratic	Unit running on CHOKE. Spark plug wire loose. Stale fuel. Vent in gas cap plugged. Water or dirt in fuel system. Dirty air cleaner. Carburetor out of adjustment.	Move choke to OFF position. Connect and tighten spark plug wire. Fill tank with clean, fresh gasoline. Fuel will not last over thirty days unless a fuel stabilizer is used. Clear vent. Drain fuel tank. Refill with fresh fuel. Refer to the engine manual packed with your unit. Refer to the engine manual packed with your unit.
Engine overheats	Engine oil level low. Air flow restricted. Dirty air cleaner. Carburetor not adjusted properly.	Fill crankcase with proper oil. Stop engine and disconnect spark plug wire. Refer to the engine manual packed with your unit. Refer to the engine manual packed with your unit. Refer to the engine manual packed with your unit.
Excessive vibration at blade	Spindle bent. Ball bearings worn out.	Replace spindle. Replace ball bearings.
Belt slips	Belt worn or stretched. Blade clutch control will not remain in adjustment bracket.	Adjust clutch rod or replace belt. Readjust spring tension at blade-clutch control.
The edger head will not go down to the last position	Lack of lubrication. Rod not adjusted properly. Pivot bolt not properly tightened.	Lubricate compression spring on spindle plate assembly with oil. Disconnect rod from bracket, push head all the way down until stop bracket is against frame (handle should be in lowest position) and adjust rod accordingly. Check pivot bolt for tightness.
Blade guard pivots forward, throwing dirt on operator	Cam lever and carriage bolt on guard are loose.	Readjust guard, tighten cam lever and carriage bolt.

Note: For repairs beyond the minor adjustments above, contact your local authorized service dealer.

Models 587 & 588

NOTE: Adjustable curb wheel is NOT standard on all units.

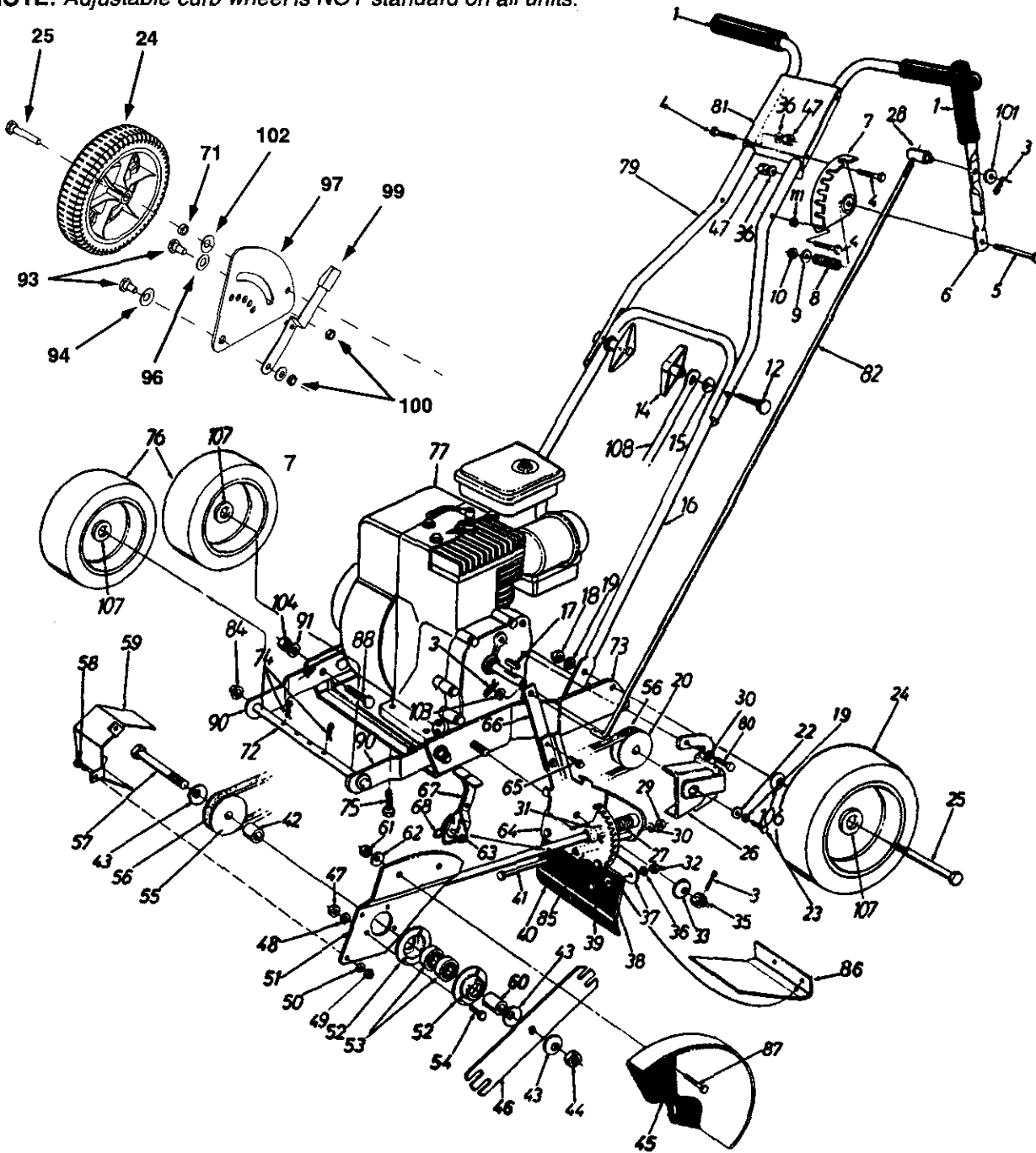

IMPORTANT: For a proper working machine, use Factory Approved Parts.

V-BELTS are specially designed to engage and disengage safely. A substitute (non-OEM) V-Belt can be dangerous by not disengaging completely.

Models 587 & 588

Ref. No.	PART NO	DESCRIPTION	Ref. No.	PART NO	DESCRIPTION
1	720-0283	Grip	55	756-0449	3/8" "V"-Pulley
2	712-0107	Hex L-Nut 1/4-20 Thd.	56	754-0142	"V"-Belt
3	714-0104	Cotter Pin 5/16" Dia.	57	710-0929	Hex Bolt 5/8-18 x 4.5" Lg.
4	710-0106	Hex Bolt 1/4-20 x 1.25" Lg.	58	710-0258	Hex Bolt 1/4-20 x .625" Lg.
5	710-0116	Hex Bolt 5/16-18 x 2" Lg.	59	781-0086	Belt Guard
6	749-0666	Engagement Handle	60	750-0118	Sleeve .90" Lg.
7	781-0081	Adjustment Bracket	61	712-0267	Hex Nut 5/16-18 Thd.
8	732-0369	Compression Spring 1.38" Lg.	62	736-0242	Bell Wash. .345" I.D.
9	736-0264	Flat Wash. .344" I.D.	63	715-0121	Spring Pin Spir. 1/4" Dia.
10	712-0158	Hex L-Nut 5/16-18 Thd.	64	781-0090	Pivot Bracket Ass'y.
12	710-1174	Curv. Hd. Bolt 5/16-18 x 2" Lg.	65	710-0600	Hex Self-Tap Scr. 5/16-24 x .5"
14	720-0241	Wing Nut Ass'y.	66	781-0075	Arm Extension
15	736-0451	Saddle Wash. .32" I.D. x .937"	67	781-0093	Adjustment Lever Ass'y.
16	749-0937	Lower Handle	68	732-0188A	Torsion Spring
17	714-0122	Sq. Key 3/16" x .75" Lg.	69	712-0267	Hex Nut 5/16-18 Thd.
18	712-0798	Hex Nut 3/8-16 Thd.	70	736-0119	L-Wash. 5/16" I.D.
19	736-0169	L-Wash. 3/8" I.D.	71	750-0535	Spacer
20	756-0327B	Engine Pulley	72	738-0898	Axle 8.20" Lg.(Front)
22	736-0258	Flat Wash. .385" I.D.	73	681-0044	Base Ass'y
23	710-0152	Hex Bolt 3/8-24 x 1" Lg.	74	714-0101	Hairpin Cotter 1/2" Dia.
24	734-1781	Wheel, Slot Bar Gray	75	710-0654A	Hex TT-Tap Scr. 3/8-16 x 1" Lg.
25	738-0108	Shoulder Bolt .498" Dia.	76	734-1797	Wheel, Slot Bar Gray
26	687-0100	Belt Guard Ass'y.	77	—	Engine
27	732-0187	Compression Spring	79	749-0938	Upper Handle
28	711-0392	Ferrule	80	710-0237	Hex Bolt 5/16-24 x .62" Lg.
29	712-0267	Hex Nut 5/16-18 Thd.	81	781-0091A	Handle Support Plate
30	736-0119	L-Wash. 5/16" I.D.	82	747-1164	Clutch Rod
31	715-0143	Spring Pin Spir. 1/4" Dia.	84	726-0221	Push Cap 1/2" Dia.
32	712-0287	Hex Nut 1/4-20 Thd.	85	711-0386	Spacer 3.765" Lg.
33	736-0112	Bell Wash. .535" I.D.	86	781-0095	Debris Deflector
35	712-0114	Hex Slotted Nut 1/2-20 Thd.	87	710-0118	Hex Bolt 5/16-18 x .75" Lg.
36	736-0329	L-Wash. 1/4" I.D.	88	710-0793	Ribbed Neck Bolt 3/8-24 x .8" Lg.
37	781-0087	Flap Bracket	90	781-0580	Axle Arm
38	736-0342	Flat Wash. .25" I.D.	91	736-0105	Bell Washer .40" I.D.
39	710-0258	Hex Bolt 1/4-20 x .62" Lg.	92	736-0280	Flat Wash. .39" I.D.
40	731-0725	Flap	93	738-0258	Shid. Bolt .5" Dia.
41	710-0402	Hex Bolt 5/16-18 x 4.5" Lg.	94	736-0255	Bell Wash .515" I.D.
42	750-0229	Spacer 1.030" Lg.	96	736-0272	Flat Wash .51" I.D. x 1.0" O.D.
43	736-0317	Bell Washer .63" I.D.	97	781-0100	Curb Height Adjuster
44	712-0413	Hex Jam L-Nut 5/8-18 Thd.	99	732-0552	Spring Adj. Lever
45	781-0076	Guard Ass'y.	100	712-0266	Hex Jam Nut 3/8-16 Thd.
46	781-0080	Edger Blade	101	736-0264	Flat Wash .344" I.D. x .62" O.D.
47	712-0287	Hex Nut 1/4-20 Thd.	102	736-0504	Wave Wash. .51" I.D.
48	736-0329	L-Wash. 1/4" I.D.	103	736-3050	Flat Washer .406" I.D. x .81" O.D.
49	712-0287	Hex Nut 1/4-20 Thd.	104	712-0241	Hex Nut 3/8-24 Thd.
50	736-0329	L-Wash. 1/4" I.D.	105	736-0452	Bell Washer .396" I.D. x 1.14" O.D.
51	781-0078	Spindle Plate Ass'y.	106	736-0105	Bell Washer .38" I.D. x .88" O.D.
52	05034A	Bearing Housing	108	749-0941	Strut 15.91"
53	741-0155	Ball Bearing .62" I.D.	111	736-0463	Flat Washer .25" I.D. x .62" O.D.
54	710-0258	Hex Bolt 1/4-20 x .62" Lg.			

NOTE: Adjustable Curb wheel is NOT standard on all units.

MANUFACTURER'S LIMITED WARRANTY FOR:



For TWO YEARS from the date of retail purchase within the United States of America, its possessions and territories, MTD PRODUCTS INC will, at its option, repair or replace, for the original purchaser, free of charge, any part or parts found to be defective in material or workmanship. This warranty covers units which have been operated and maintained in accordance with the operating instructions furnished with the unit, and which have not been subject to misuse, abuse, commercial use, neglect, accident, improper maintenance or alteration.

Normal wear parts or components thereof are subject to separate terms as noted below in the "No Fault Ninety Day Consumer Warranty" clause.

All normal wear part failures will be covered on this product for a period of 90 days regardless of cause. After 90 days, but within the two year period, normal wear parts failures will be covered ONLY IF caused by defects in material or workmanship of OTHER component parts. Normal wear parts are defined as batteries*, belts, blades, blade adapters, grass bags, rider deck wheels, seats, snow thrower skid shoes, shave plates and tires.

How to obtain service: Warranty service is available, with proof of purchase, through your local authorized service dealer. To locate the dealer in your area, please check the yellow pages or contact the Customer Service Department of MTD PRODUCTS INC, P. O. Box 368022, Cleveland, Ohio 44136-9722. Phone 1 (800) 800-7310. The return of a complete unit will not be accepted by the factory unless prior written permission has been extended by the Customer Service Department of MTD PRODUCTS INC.

Transportation charges: Transportation charges for the movement of any power equipment unit or attachment are the responsibility of the purchaser.

Units exported out of the United States: MTD PRODUCTS INC does not extend any warranty for

products sold or exported outside of the United States of America, its possessions and territories, except those sold through MTD PRODUCTS INC's authorized channels of export distribution.

Other Warranties:

1. The engine or component parts thereof carry separate warranties from their manufacturers. Please refer to the applicable manufacturer's warranty on these items.
2. *Batteries are covered by a 90-day replacement warranty.
3. Log splitter pumps, valves and cylinders or component parts thereof are covered by a one year warranty.
4. All other warranties, express or implied, including any implied warranty of merchantability or fitness for a particular purpose, are hereby expressly disclaimed in their entirety.
5. The provisions as set forth in this warranty provide the sole and exclusive remedy of MTD PRODUCTS INC's obligations arising from the sales of its products. MTD PRODUCTS INC will not be liable for incidental or consequential loss or damage.

How state law relates to this warranty: This limited warranty gives you specific legal rights, and you may also have other rights which vary from state to state. Certain disclaimers are not allowed in some states and therefore they may not apply to you under all circumstances.

NOTE: This warranty does not cover routine maintenance items such as lubricants, filters, blade sharpening and tune-ups, or adjustments such as brake adjustments, clutch adjustments or deck adjustments. Nor does this warranty cover normal deterioration of the exterior finish due to use or exposure.