

Operator's Manual

**CRAFTSMAN**®

32cc/1.9 cu. in. 2-Cycle

17" Cutting Path

**GASOLINE WEEDWACKER**

Model No.

**358.796090**

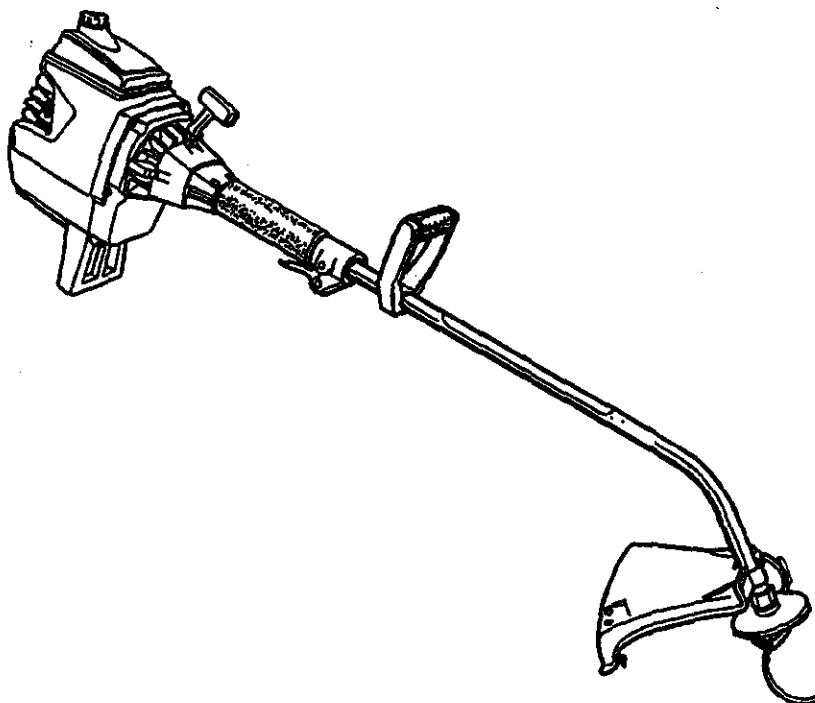

**WARNING:**

Read and follow all Safety Rules and Operating Instructions before first use of this product.



For answers to your questions about this product, call 7am-7pm, Mon.-Sat., or 10am-7pm, Sun.

**1-800-235-5878** (Hours listed are Central Time)

Sears, Roebuck and Co., Hoffman Estates, IL 60179 USA

# TABLE OF CONTENTS

Warranty Statement	2	Storage	10
Safety Rules	2	Troubleshooting Chart	11
Assembly	4	Repair Parts List	12
Operation	5	Spanish	15
Maintenance	8	Parts Ordering	Back Cover
Service & Adjustments	9		

## WARRANTY STATEMENT

**FULL ONE YEAR WARRANTY ON CRAFTSMAN WEEDWACKER® GAS POWERED LINE TRIMMER.**

For one year from the date of purchase, when this Craftsman Gas Powered Weedwacker® Line Trimmer is maintained, lubricated, and tuned up according to the operating and maintenance instructions in the Operator's Manual, Sears will repair, free of charge, any defect in materials or workmanship.

This warranty excludes nylon line, spark plug, and air filter, which are expendable parts and become worn during normal use.

If this Weedwacker® Line Trimmer is used for commercial purposes, this warranty applies for only 90 days from the date of purchase. If this Weedwacker® Line Trimmer is used for rental purposes, this warranty applies for only 30 days from the date of purchase. This warranty applies only while this product is in use in the United States.

WARRANTY SERVICE IS AVAILABLE BY RETURNING THE WEEDWACKER® LINE TRIMMER TO THE NEAREST SEARS SERVICE CENTER IN THE UNITED STATES. This warranty gives you specific legal rights, and you may also have other rights which vary from state to state.

**Sears, Roebuck and Co., D/817 WA Hoffman Estates, IL 60179**

## SAFETY RULES

**WARNING:** When using gardening appliances, basic safety precautions must always be followed to reduce the risk of fire and serious injury. Read and follow all instructions.

*This power unit can be dangerous! Operator is responsible for following instructions and warnings on unit and in manual. Read entire Operator's Manual before using unit! Be thoroughly familiar with the controls and the proper use of the unit. Restrict the use of this unit to persons who have read, understand, and will follow the instructions and warnings on the unit and in the manual. Never allow children to operate this unit.*

Safety information on the unit



**DANGER:** Never use blades or flailing devices. This unit is designed for

line trimmer use only. Use of any other accessories or attachments will increase the risk of injury.



**WARNING:** Trimmer line throws objects violently. You and others can be blinded/injured. Wear eye and leg protection. Keep body parts clear of rotating line. Keep children, bystanders, and animals 50 feet (15 m) away. If approached, stop unit immediately.

Eye Protection



Boots

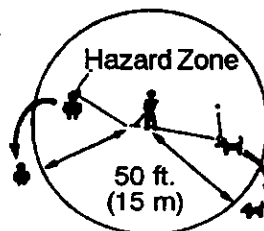

- If situations occur which are not covered in this manual, use care and good judgement. If you need assistance, contact Sears Service or call the 1-800 number listed on the front of this manual.

### **OPERATOR SAFETY**

- Always wear safety eye protection.
- Always wear long pants, long sleeves, boots, and gloves. Wearing safety leg guards is recommended. Do not go barefoot or wear sandals. Stay clear of spinning line.
- Secure hair above shoulder length. Secure or remove loose clothing or clothing with loosely hanging ties, straps, tassels, etc. They can be caught in moving parts.
- Do not operate when you are tired, ill, or under the influence of alcohol, drugs, or medication.
- Wear hearing protection if you use unit for more than 1-1/2 hours per day.
- Never start or run inside a closed room or building. Breathing exhaust fumes can kill.
- Keep handles free of oil and fuel.

### **UNIT / MAINTENANCE SAFETY**

- Disconnect the spark plug before performing maintenance except carburetor adjustments.
- Look for and replace damaged or loose parts before each use. Look for and repair fuel leaks before use. Keep in good working condition.
- Replace trimmer head parts that are chipped, cracked, broken, or damaged in any other way before using the unit.
- Make sure unit is assembled correctly as shown in this manual.
- Make carburetor adjustments with lower end supported to prevent line from contacting any object.
- Keep others away when making carburetor adjustments.
- Use only recommended Craftsman accessories and replacement parts.

### **FUEL SAFETY**

- Mix and pour fuel outdoors.
- Keep away from sparks or flames.
- Use a container approved for fuel.
- Do not smoke or allow smoking near fuel or the unit.
- Wipe up all fuel spills.
- Move at least 10 feet (3 meters) away from fueling site before starting engine.

- Stop engine and allow to cool before removing fuel cap.

### **CUTTING SAFETY**

- Use only for trimming, mowing, and sweeping. Do not use for pruning or hedge trimming.
- Inspect the area before each use. Remove objects (rocks, broken glass, nails, wire, etc.) which can be thrown by or become entangled in line. Hard objects can damage the trimmer head and be thrown causing serious injury.
- Keep firm footing and balance. Do not overreach.
- Keep all parts of your body away from muffler and spinning line. Keep engine below waist level. A hot muffler can cause serious burns.
- Cutting on left side of the shield will throw debris away from the operator.

### **TRANSPORTING AND STORAGE**

- Allow engine to cool; secure unit before storing or transporting in vehicle.
- Empty the fuel tank before storing or transporting the unit. Use up fuel left in the carburetor by starting the engine and letting it run until it stops.
- Store unit and fuel in area where fuel vapors cannot reach sparks or open flames from water heaters, electric motors or switches, furnaces, etc.
- Store unit so line limiter cannot accidentally cause injury. The unit can be hung by the tube.
- Store unit out of reach of children.
- If situations occur which are not covered in this manual, use care and good judgment. If you need assistance, call 1-800-235-5878.

**SPECIAL NOTICE:** This unit is not equipped with a temperature limiting muffler and spark arresting screen which meets the requirements of California Codes 4442 and 4443. All U.S. forest land and the states of California, Idaho, Maine, Minnesota, New Jersey, Oregon, and Washington require by law that many internal combustion engines be equipped with a spark arrester screen. If you operate in a locale where such regulations exist, you are legally responsible for installing and maintaining the operating condition of these parts. Failure to do so is a violation of the law. Refer to the MAINTENANCE section in this manual.

# ASSEMBLY

## CARTON CONTENTS

Check carton contents against the following list.

### Model 358.796090

- Trimmer
- Shield
- Container of Oil

Examine parts for damage. Do not use damaged parts.

**NOTE:** If you need assistance or find parts missing or damaged, call 1-800-235-5878.

**Note:** It is normal for the fuel filter to rattle in the empty fuel tank.

Finding fuel or oil residue on muffler is normal due to carburetor adjustments and testing done by the manufacturer.

## ASSEMBLY

**WARNING:** If received assembled, repeat all steps to ensure your unit is properly assembled and all fasteners are secure.

## ADJUSTING THE HANDLE

**WARNING:** Make sure unit is properly assembled and all fasteners are secure.

- Loosen the wing nut on the handle.
- Rotate handle to the upright position.

- Tighten wing nut securely.

## ATTACHING SHIELD

**WARNING:** The shield must be properly installed. The shield provides partial protection from the risk of thrown objects to the operator and others and is equipped with a line limiter which cuts excess line to the proper length.

**WARNING:** The line limiter (on underside of shield) is sharp and can cut you.

### WARNING:

- Remove wing nut from shield.
- Insert bracket into slot as shown.
- Pivot shield until bolt passes through hole in bracket.
- Securely tighten wing nut onto bolt.

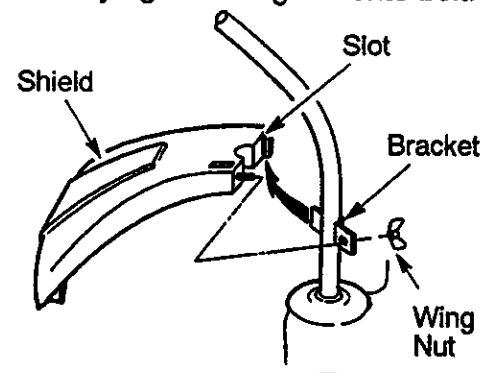

# OPERATION

## KNOW YOUR TRIMMER

READ THIS OPERATOR'S MANUAL AND SAFETY RULES BEFORE OPERATING YOUR UNIT. Compare the illustrations with your unit to familiarize yourself with the location of the various controls and adjustments. Save this manual for future reference.

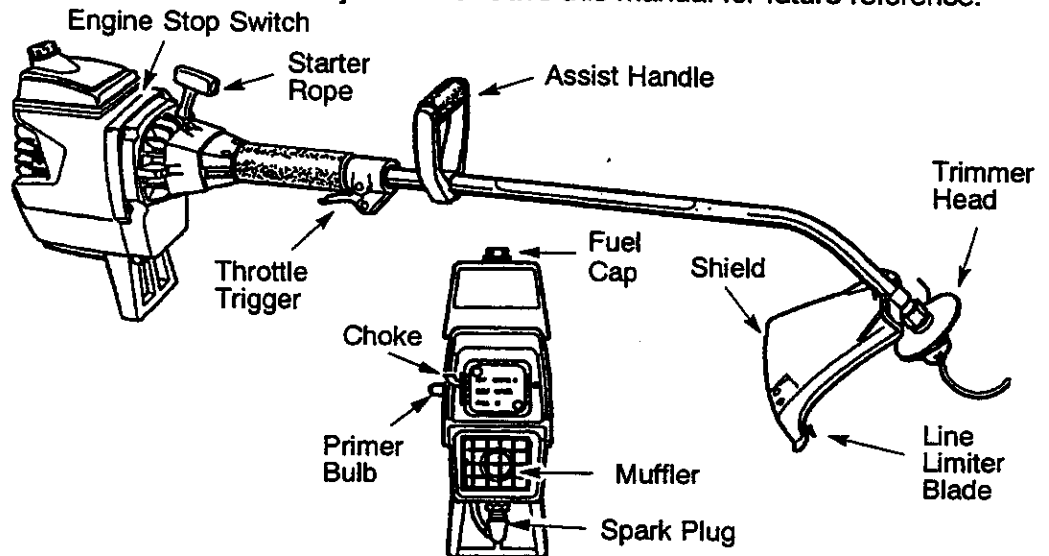

### ENGINE STOP SWITCH

The engine stop switch is used to stop engine. Push and hold the engine stop switch in the STOP or OFF position until the engine has fully stopped.

### PRIMER BULB

The primer bulb removes air from the fuel lines and fills them with fuel. This allows you to start the engine with fewer pulls on the starter rope. Activate

the primer bulb by pressing it and allowing it to return to its original form.

### CHOKE

The choke helps to supply fuel to the carburetor during starting. This allows you to start a cold engine. Activate the choke by moving the choke lever to the Full Choke position. After the engine has started, move knob to the Off Choke position.

## BEFORE STARTING ENGINE

**WARNING:** Be sure to read the fuel information in the safety rules before you begin. If you do not understand the safety rules, do not attempt to fuel your unit. Call the 1-800 number listed on the front of this manual.

## FUELING ENGINE

This engine is certified to operate on unleaded gasoline. Before operation, gasoline must be mixed with a good quality 2-cycle air-cooled engine oil. We recommend Craftsman brand oil. Mix gasoline and oil at a ratio of 40:1 (A 40:1 ratio is obtained by mixing 3.2 ounces of oil with 1 gallon of unleaded gasoline). DO NOT USE automotive oil or boat oil. These oils will cause engine damage. When mixing fuel, follow instructions printed on container. Once oil is added to gasoline, shake

container momentarily to assure that the fuel is thoroughly mixed. Always read and follow the safety rules relating to fuel before fueling your unit.

### IMPORTANT

Experience indicates that alcohol blended fuels (called gasohol or using ethanol or methanol) can attract moisture which leads to separation and formation of acids during storage. Acidic gas can damage the fuel system of an engine while in storage. To avoid engine problems, empty fuel system before storage for 30 days or longer. Drain gas tank, start engine and let it run until fuel lines and carburetor are empty. Use fresh fuel next season. Never use engine or carburetor cleaner products in the fuel tank or permanent damage may occur. See the STORAGE section for additional information.

## STARTING YOUR ENGINE

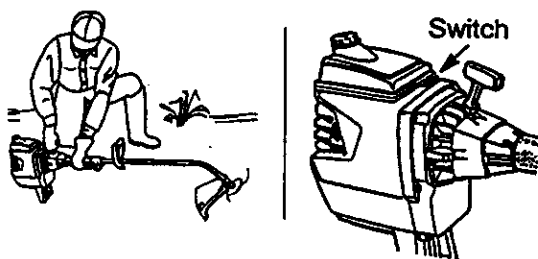

## HOW TO STOP YOUR UNIT

Push and hold the engine stop switch in the STOP or OFF position until the unit has fully stopped.

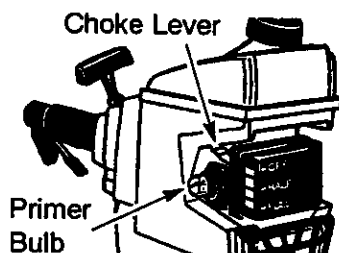

## HOW TO START YOUR UNIT

**WARNING:** The trimmer head will turn while starting the engine. A hot muffler can cause serious burns.

## COLD ENGINE STARTING OR STARTING AFTER REFUELLING

- Set unit on flat surface.
- Move engine stop switch to On.
- Slowly press the primer bulb 6 times.
- Move choke lever to Full Choke.
- Squeeze and hold the throttle trigger. *Keep throttle trigger fully squeezed until the engine runs smoothly.*
- Sharply pull starter rope until engine attempts to run or 5 times.
- Move choke lever to Half Choke.
- Sharply pull starter rope until the engine runs, but no more than 6 pulls.
- Continue to squeeze trigger and allow engine to run for 5 to 10 seconds.
- Move choke lever to the Off Choke position while continuing to squeeze trigger for 30 second warm up.

**NOTE:** If the engine fails to start after 6 pulls (at Half Choke), check to make sure the choke lever is in the proper position. Then, repeat the above steps. If the engine still does not start, it is probably flooded. Proceed to Starting a Flooded Engine.

## RESTARTING A WARM ENGINE

- Move engine stop switch to On.
- Move the choke lever to Half Choke.

- Squeeze and hold the throttle trigger. *Keep throttle trigger fully squeezed until the engine runs smoothly.*
- Sharply pull starter rope until engine runs, but no more than 5 pulls.
- Allow engine to run 15 seconds, then move choke lever to Off Choke.
- If engine fails to start in 5 pulls, pull starter rope 5 more pulls. If engine still does not run, it is probably flooded. Proceed to Starting a Flooded Engine.

## STARTING A FLOODED ENGINE

Flooded engines can be started by moving choke lever to Off Choke; then, pull rope to clear engine of excess fuel. This could require pulling starter rope *many times* depending on how badly unit is flooded. If unit still doesn't start, refer to TROUBLESHOOTING CHART or call the 1-800 number found on the front of this manual.

## OPERATING INSTRUCTIONS

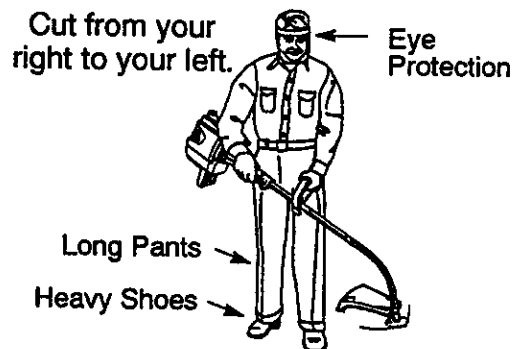

Do not run engine at a higher speed than necessary. The cutting line will cut efficiently when engine is run at less than full throttle. At lower speeds there is less engine noise and vibration. The cutting line will last longer and will be less likely to "weld" onto the spool. Always release throttle trigger and allow engine to return to idle speed when not cutting.

To stop engine:

- Release the throttle trigger.
- Push and hold the engine stop switch in the STOP or OFF position until the engine has fully stopped.

## CUTTING METHODS

**WARNING:** Use minimum speed and do not crowd line when cutting around hard objects (rock, gravel, fence posts, etc.), which can damage the trimmer head, become entangled in the line, or be thrown causing a serious hazard.

- The tip of the line does the cutting. You will achieve the best perform-

ance and minimum line wear by not crowding the line into the cutting area. The right and wrong ways are shown below.

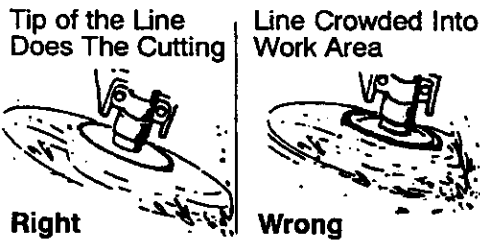

- The line will easily remove grass and weeds from around walls, fences, trees and flower beds, but it also can cut the tender bark of trees or shrubs and scar fences. To help avoid damage especially to delicate vegetation or trees with tender bark, shorten line to 4-5 in. (10-13 cm) and use at less than full throttle.
- For trimming or scalping, use less than full throttle to increase line life and decrease head wear, especially:
  - During light duty cutting.
  - Near objects around which the line can wrap such as small posts, trees or fence wire.
- For mowing or sweeping, use full throttle for a good clean job.

**WARNING:** Always wear eye protection. Never lean over the trimmer head. Rocks or debris can ricochet or be thrown into eyes and face and cause blindness or other serious injury.

**TRIMMING** – Hold the bottom of the trimmer head about 3 in. (8 cm) above the ground and at an angle. Allow only the tip of the line to make contact. Do not force trimmer line into work area.

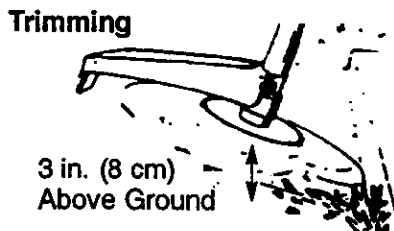

**SCALPING** – The scalping technique removes unwanted vegetation. Hold the bottom of the trimmer head about 3 in. (8 cm) above the ground and at an angle. Allow the tip of the line to strike the ground around trees, posts, monuments, etc. This technique increases line wear.

Scalping

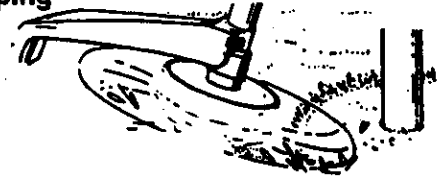

**MOWING** – Your trimmer is ideal for mowing in places conventional lawn mowers cannot reach. In the mowing position, keep the line parallel to the ground. Avoid pressing the head into the ground as this can scalp the ground and damage the tool.

Mowing

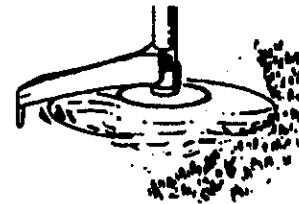

**SWEEPING** – The fanning action of rotating line can be used for a quick and easy clean up. Keep line parallel to and above the surfaces being swept and move the tool from side to side.

Sweeping



# MAINTENANCE

## MAINTENANCE SCHEDULE

CARE & MAINTENANCE TASK	WHEN TO PERFORM
Check for Loose fasteners and parts	Before each use
Check for damaged or worn parts	Before each use
Clean unit and labels	After each use
Clean air filter	Every 5 hours of operation
Replace spark plug	Yearly

### GENERAL RECOMMENDATIONS

The warranty on this unit does not cover items that have been subjected to operator abuse or negligence. To receive full value from the warranty, the operator must maintain unit as instructed in this manual. Various adjustments will need to be made periodically to properly maintain your unit.

### CHECK FOR LOOSE FASTENERS AND PARTS

- Spark Plug Boot
- Air Filter
- Housing Screws
- Assist Handle Screws
- Shield

### CHECK FOR DAMAGED OR WORN PARTS

Refer replacement of damaged/worn parts to your Sears Service Center.

- Engine Stop Switch – Ensure switch functions properly by holding the switch in the “Stop” position. Make sure engine stops; then turn switch on, restart engine, and continue.
- Fuel Tank – Do not use unit if fuel tank shows signs of damage or leaks.
- Shield – Discontinue use of unit if debris shield is damaged.

### CLEAN UNIT & LABELS

- Clean the unit using a damp cloth with a mild detergent.
- Wipe off unit with a clean dry cloth.

### CLEAN AIR FILTER

Do not clean filter in gasoline or other flammable solvent to avoid creating a fire hazard or producing harmful evaporative emissions.

#### Cleaning the air filter:

A dirty air filter decreases engine performance and increases fuel consumption and harmful emissions. Always clean after every 5 hours of operation.

- Clean the cover and the area around it to keep dirt and debris from falling into the carburetor chamber when the cover is removed.
- Remove parts as illustrated.
- Wash the filter in soap and water.
- Allow filter to dry.
- Replace parts.

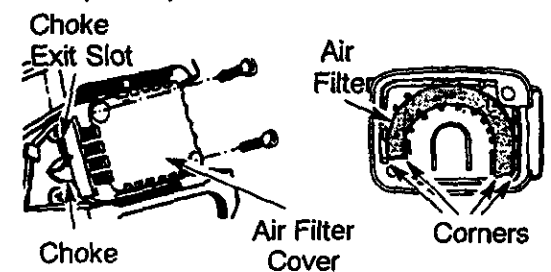



## REPLACE SPARK PLUG

Replace the spark plug each year to ensure the engine starts easier and runs better. Set spark plug gap at .025 in. Ignition timing is fixed and nonadjustable.

- Twist, then pull off spark plug boot.

- Remove spark plug from cylinder and discard.
- Replace with Champion CJ-8Y spark plug and tighten with a 3/4 in. socket wrench (10-12 ft.-lbs).
- Reinstall the spark plug boot.

## SERVICE AND ADJUSTMENTS

### REPLACING THE LINE

- Always use Craftsman replacement line.

**Note:** Choose the line size best suited for the job at hand. Green colored line is designed for cutting grass, red line for grass and small weeds. The black colored line is designed for cutting larger weeds and light brush.

- Before inserting the line into the holes in the cutting head, identify the proper holes. When using Green, or Red, line insert into the holes marked small on the cutting head. Black line should be inserted in the holes marked large.
- Insert both ends of your line through the proper holes in the side of the cutting head.

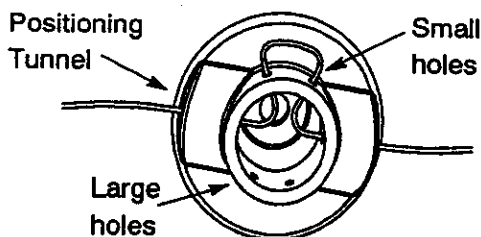

- Insert ends of the line one at a time thru the positioning tunnels.

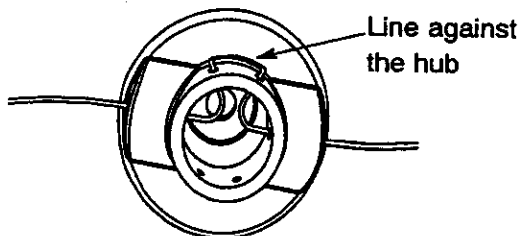

- Pull the line and make sure the line is against the hub and extended fully thru the positioning tunnels.
- Correctly installed line will be the same length on both ends.

### CARBURETOR ADJUSTMENT

**WARNING:** The trimmer head will be spinning during most of this procedure. Wear your protective equipment and observe all safety pre-

cautions. After making mixture adjustments, recheck idle speed.

Carburetor adjustment is critical and if done improperly can permanently damage the engine as well as the carburetor. If you require further assistance or are unsure about performing this procedure, call our customer assistance help line found on the front of this manual.

Old fuel, a dirty air filter, a dirty fuel filter, or flooding may give the impression of an improperly adjusted carburetor. Check these conditions before adjusting the carburetor.

The carburetor has been carefully set at the factory. Adjustments may be necessary if you notice any of the following conditions:

- Engine will not idle. See "Idle Speed" under adjusting procedure.
- Engine dies or hesitates instead of accelerating. See "Acceleration Check" under adjusting procedure.
- Loss of cutting power. See "Mixture Adjustment" under adjusting procedure.

There are two adjustment screws on the carburetor as shown.

Mixture Screw with Limiter Cap

Idle Speed Adjustment Screw

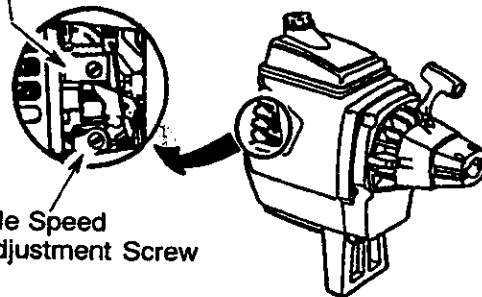

### CARBURETOR PRESETS

When making carburetor preset adjustments, do not force plastic limiter caps beyond stops or damage may occur.

If carburetor presets are not needed, proceed to "Adjusting Procedure, Idle Speed."

To adjust presets:

- Turn mixture screw counterclockwise until it stops.
- Turn the idle speed screw clockwise until it stops. Now turn counterclockwise 4-1/2 turns.
- Start motor, cut grass for 3 minutes, and proceed to the adjustment section. If engine does not start, refer to troubleshooting chart or call the 1-800 number found on the front of this manual.
- If engine performance is acceptable at the preset positions, no further adjustment is necessary.

## ADJUSTING PROCEDURE

### Idle Speed

Allow engine to idle. Adjust speed until engine runs without stalling.

- Turn clockwise to increase engine speed if engine stalls or dies.
- Turn counterclockwise to decrease speed.

No further adjustments are necessary if performance is satisfactory.

### Mixture Adjustment

DO NOT operate engine at full throttle for prolonged periods while making adjustments. Damage to the engine can occur. Replace cutting line with a new piece of line, and cut some grass.

Based on performance while cutting, turn the mixture adjustment in 1/16-turn increments as follows:

- Clockwise until the engine has good power while cutting with no hesitation. Do not adjust by sound or speed, but judge by how well the engine performs while cutting.
  - Counterclockwise if engine has speed but dies or lacks power while cutting.
- After completing adjustments, check for acceleration. Reset if necessary.

### Acceleration Check

If engine dies or hesitates instead of accelerating, turn mixture adjustment counterclockwise until you have smooth acceleration. Recheck and adjust as necessary for acceptable performance.

## STORAGE

Prepare unit for storage at end of season or if it will not be used for 30 days or more.

### WARNING:

- Allow engine to cool, and secure the unit before storing or transporting.
- Store unit and fuel in a well ventilated area where fuel vapors cannot reach sparks or open flames from water heaters, electric motors or switches, furnaces, etc.
- Store unit with all guards in place. Position unit so that any sharp object cannot accidentally cause injury.
- Store unit and fuel well out of the reach of children.

### EXTERNAL SURFACES

If your unit is to be stored for a period of time, clean it thoroughly before storage.

- Store in a clean dry area.
- Lightly oil external metal surfaces.

### FUEL SYSTEM

Under Fueling Engine in the Operating Section of this manual, see message

labeled **IMPORTANT** regarding the use of gasohol in your engine.

Fuel stabilizer is an acceptable alternative in minimizing the formation of fuel gum deposits during storage. Add stabilizer to the gasoline in the fuel tank or fuel storage container. Follow the mix instructions found on stabilizer container. Run engine at least 5 minutes after adding stabilizer.

CRAFTSMAN 40:1, 2-cycle engine oil (air cooled) is already blended with fuel stabilizer. If you do not use this Sears oil, you can add a fuel stabilizer to your fuel tank.

### INTERNAL ENGINE

- Remove spark plug and pour 1 teaspoon of 40:1, 2-cycle engine oil (air cooled) through the spark plug opening. Slowly pull the starter rope 8 to 10 times to distribute oil.
- Replace spark plug with new one of recommended type and heat range.
- Clean air filter.

- Check entire unit for loose screws, nuts, and bolts. Replace any damaged, broken, or worn parts.
- At the beginning of the next season, use only fresh fuel having the proper gasoline to oil ratio.

## OTHER

- Do not store gasoline from one season to another.
- Replace gasoline can if it starts to rust.

## TROUBLESHOOTING CHART

TROUBLE	CAUSE	REMEDY
Engine will not start.	<ul style="list-style-type: none"> <li>• Engine flooded.</li> <li>• Fuel tank empty.</li> <li>• Spark plug not firing.</li> <li>• Fuel not reaching carburetor.</li> <li>• Compression low.</li> </ul>	<ul style="list-style-type: none"> <li>• See "Starting Instructions."</li> <li>• Fill tank with correct fuel mixture.</li> <li>• Install new spark plug.</li> <li>• Check for dirty fuel filter; replace. Check for kinked or split fuel line; repair or replace.</li> <li>• Contact Sears Service.</li> </ul>
Engine will not idle properly.	<ul style="list-style-type: none"> <li>• Idle speed set too low.</li> <li>• Idle speed set too high.</li> <li>• Carburetor requires adjustment.</li> <li>• Crankshaft seals worn.</li> <li>• Compression low.</li> </ul>	<ul style="list-style-type: none"> <li>• Adjust idle speed screw clockwise to increase speed.</li> <li>• Adjust idle speed screw counter-clockwise to reduce speed.</li> <li>• See "Carburetor Adjustments."</li> <li>• Contact Sears Service.</li> <li>• Contact Sears Service.</li> </ul>
Engine will not accelerate, lacks power, or dies under a load.	<ul style="list-style-type: none"> <li>• Air filter dirty.</li> <li>• Spark plug fouled.</li> <li>• Carburetor requires adjustment.</li> <li>• Carbon build up.</li> <li>• Compression low.</li> </ul>	<ul style="list-style-type: none"> <li>• Clean or replace air filter.</li> <li>• Clean or replace spark plug and re-gap.</li> <li>• See "Carburetor Adjustments."</li> <li>• Contact Sears Service.</li> <li>• Contact Sears Service.</li> </ul>
Engine smokes excessively.	<ul style="list-style-type: none"> <li>• Choke partially on.</li> <li>• Fuel mixture incorrect.</li> <li>• Air filter dirty.</li> <li>• Carburetor requires adjustment.</li> </ul>	<ul style="list-style-type: none"> <li>• Adjust choke.</li> <li>• Empty fuel tank and refill with correct fuel mixture.</li> <li>• Clean or replace air filter.</li> <li>• See "Carburetor Adjustments."</li> </ul>
Engine runs hot.	<ul style="list-style-type: none"> <li>• Fuel mixture incorrect.</li> <li>• Spark plug incorrect.</li> <li>• Carburetor requires adjustment</li> <li>• Carbon build up.</li> </ul>	<ul style="list-style-type: none"> <li>• See "Fueling Your Unit."</li> <li>• Replace with correct spark plug.</li> <li>• See "Carburetor Adjustments."</li> <li>• Contact Sears Service.</li> </ul>

# REPAIR PARTS



## WARNING

All repairs, adjustments and maintenance not described in the Operator's Manual must be performed by qualified service personnel.

SEARS MODEL 358.796090

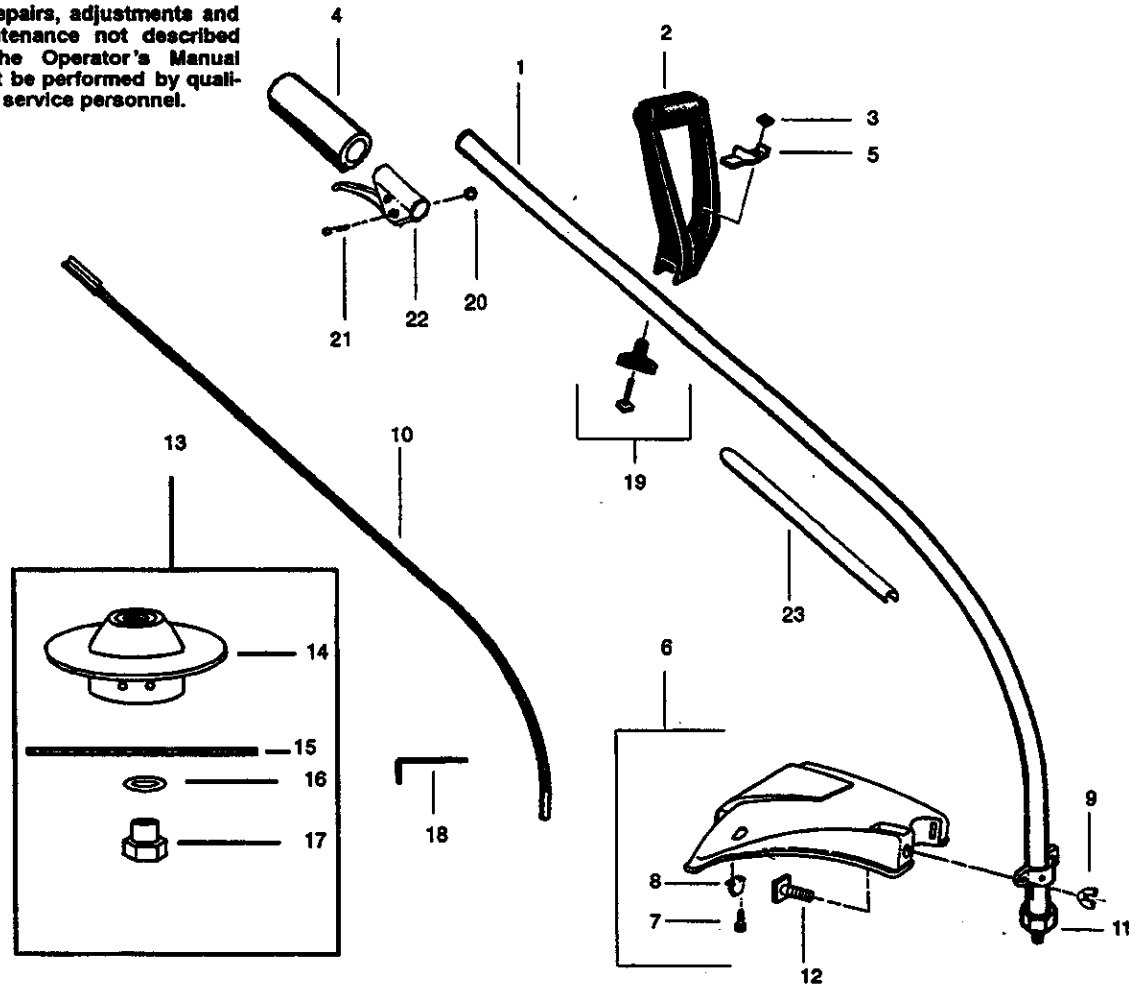

Ref.	Part No.	Description	Ref.	Part No.	Description
1	530095321	Drive Shaft Housing	14	530095653	Hub Ass'y.
2	530069496	Assist Handle Kit (Incl. 3, 5, 21)	15	71-85641	Line - Green (Grass)
3	530015610	Nut		71-85628	Line - Red (Grass& Weeds)
4	530029445	Drive Shaft Grip		71-85629	Line - Black (Weeds& Lt. Brush)
5	530094847	Clamp-Assist	16	530016296	Washer
6	530069666	Shield Kit Ass'y. (Incl. #7 & 8)	17	530016297	Nut-Shoulder
7	530015814	Screw	18	530031159	Hex Wrench (5/32)
8	530052286	Line Limiter	19	530069252	Kit-T-Handle
9	530401992	Wingnut	20	530015768	Locknut
10	530095176	Flex Shaft	21	530015774	Screw
11	530094543	Dust Cup	22	530047329	Throttle Hsg. Ass'y.
12	530015820	Bolt	23	530047467	Shaft Warning Decal
13	71-85640	Cutting Head Ass'y.	Not Shown		
				530087756	Operator Manual
				952701570	Shaft Lubrication
				530054049	Shield Decal

# REPAIR PARTS

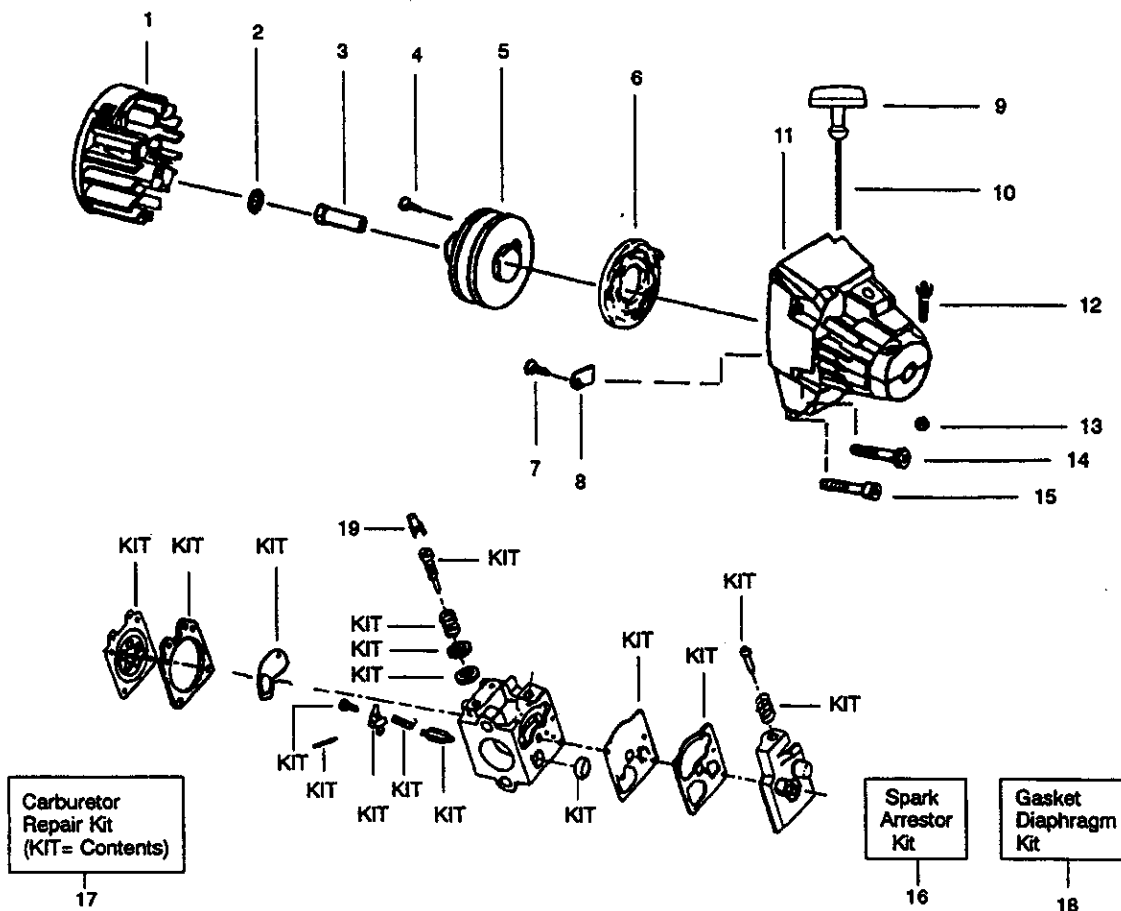

Ref.	Part No.	Description	Ref.	Part No.	Description
1.	530047198	Flywheel Ass'y.	16.	952701612	Spark Arrestor Kit
2.	530015828	Washer-Flat	17.	530069837	Carburetor Repair Kit (KIT=Contents)
3.	530027953	Drive Coupling	18.	530069844	Gasket/Diaphragm Kit
4.	530016080	Screw-Starter Pulley	19.	530038403	Limiter Cap
5.	530069486	Starter Pulley Kit (Incl. 4)			
6.	530042085	Starter Spring			
7.	530015496	Screw-Retaining			
8.	530027523	Pulley Retainer			
9.	530049488	Starter Handle			
10.	530069907	Rope Kit			
11.	530069810	Fan Housing Kit			
12.	530015767	Screw-Pinch Clamp			
13.	530015768	Locknut-Pinch Clamp			
14.	530015769	Screw-Fan Housing			
15.	530015770	Screw-Fan Housing			

# REPAIR PARTS

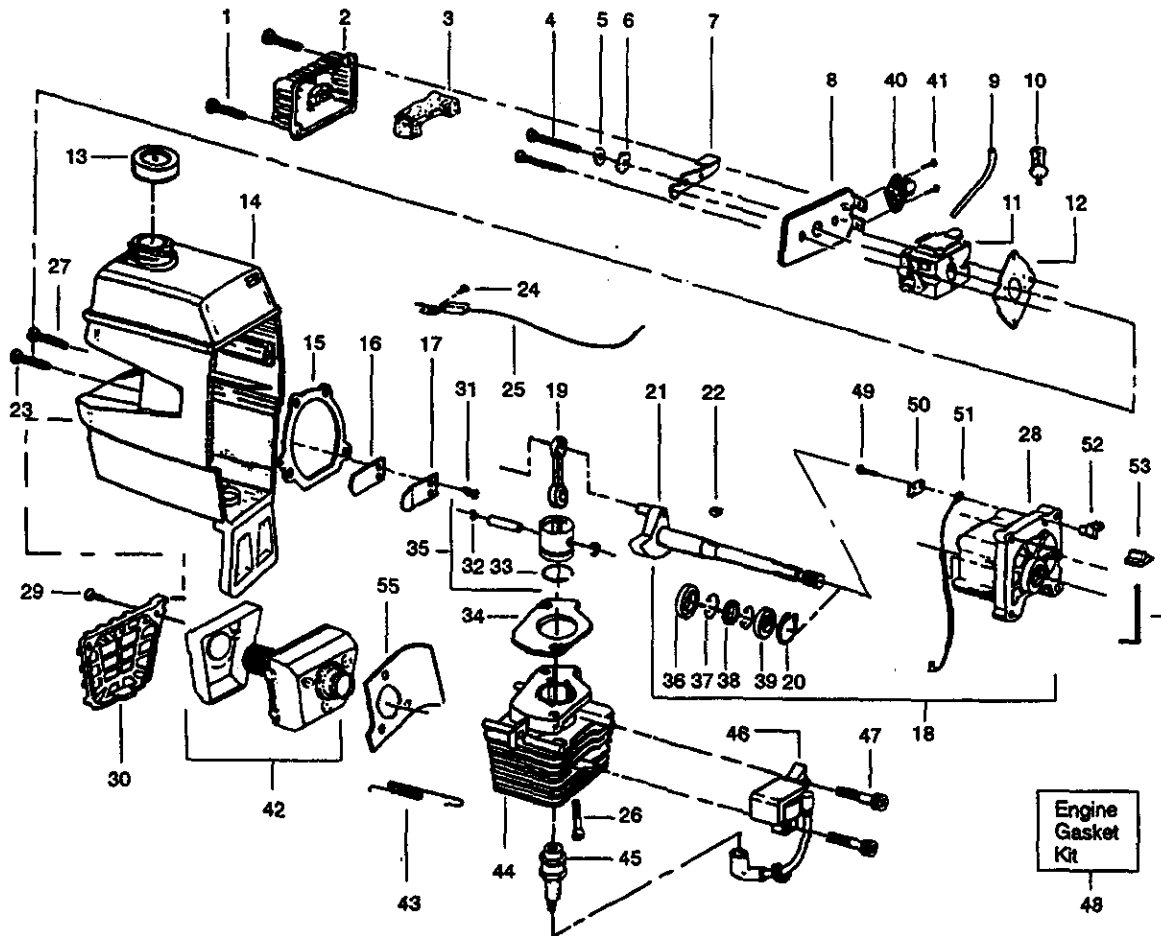

Ref.	Part No.	Description	Ref.	Part No.	Description	Ref.	Part No.	Description
1.	530015773	Screw-Air Filter Cover	20.	530015789	Retaining Ring-Crankshaft	40.	530038874	Bulb Ass'y.
2.	530027529	Filter Cover	21.	530010945	Crankshaft Ass'y. (Incl. 36)	41.	530016091	Screw-Primer Bu
3.	530027530	Air Filter	22.	530015126	Flywheel Key	42.	530069310	Muffler Kit
4.	530015849	Screw	23.	530015771	Screw	43.	530036409	Muffler Spring
5.	530015852	Spacer-Choke	24.	530015775	Screw-Throttle Cable	44.	530069905	Cylinder Kit
6.	530015254	Washer	25.	530037498	Throttle Cable Ass'y.	45.	Champion	Spark Plug (CJ-8Y)
7.	530038915	Choke Shutter	26.	530001624	Screw-Cylinder	46.	530039134	Ignition Module
8.	530037930	Air Filter Plate	27.	530015772	Screw	47.	530015816	Screw-Ignition Module
9.	-	Fuel Line Kit	28.	530014016	Crankcase Ass'y. (Incl. 36-39)	48.	530069276	Engine Gasket K (Incl. 12, 15 & 3)
	530069571	Primer/Tank	29.	530015717	Screw-Muffler Guard	49.	530015780	Screw
	530069216	Tank/Purge	30.	530047541	Muffler Guard	50.	530027546	Switch Insulator
	530069247	Carb/Purge	31.	530016064	Screw	51.	530027547	Lead Wire
10.	530014362	Fuel Pick-up Ass'y.	32.	530015162	Piston Pin Ret.	52.	530027545	Switch Ramp
11.	530069730	Carburetor Kit (WA2198) (Incl. Limiter Caps)	33.	530025875	Piston Ring	53.	530038309	Switch Button
12.	530019156	Carburetor Gasket	34.	530019178	Cylinder Gasket	54.	530027959	Switch Spring
13.	530014347	Fuel Cap Ass'y.	35.	530069899	Piston Kit (Incl. 32, 33 & Pin)	55.	530053346	Heat Shield/Air C
14.	530047577	Shroud & Tank Ass'y.	36.	530032103	Inner Bearing	Not Shown		
15.	530019154	Crankcase/Shroud Gasket	37.	530015787	Retaining Ring	530049927		Instruction Deca
16.	530027593	Reed Valve	38.	530019158	Crankshaft Seal	530054047		Shroud Decal
17.	530027594	Reed Stop	39.	530032102	Outer Bearing			
18.	530014004	C'case/Crankshaft Ass'y. (Incl. 20, 21 & 28)						
19.	530010960	Connecting Rod Ass'y.						

**For in-home major brand repair service:**

Call 24 hours a day, 7 days a week

**1-800-4-MY-Home<sup>SM</sup>** (1-800-469-4663)

**Para pedir servicio de reparación a domicilio – 1-800-676-5811**

In Canada for all your service and parts needs call  
Au Canada pour tout le service ou les pièces – **1-800-665-4455**

**For the repair or replacement parts you need:**

Call 7 am – 7 pm, 7 days a week

**1-800-366-PART** (1-800-366-7278)

**Para ordenar piezas con entrega a domicilio – 1-800-659-7084**

**For the location of a Sears Parts and Repair Center in your area:**

Call 24 hours a day, 7 days a week

**1-800-488-1222**

**For information on purchasing a Sears Maintenance Agreement  
or to inquire about an existing Agreement:**

Call 9 am – 5 pm, Monday – Saturday

**1-800-827-6655**



The Service Side of Sears<sup>SM</sup>