

**SEARS
OWNER'S
MANUAL**

**MODEL NO.
917.380221**

**Caution:
Read and Follow
all Safety Rules
and Instructions
Before Operating
This Equipment**

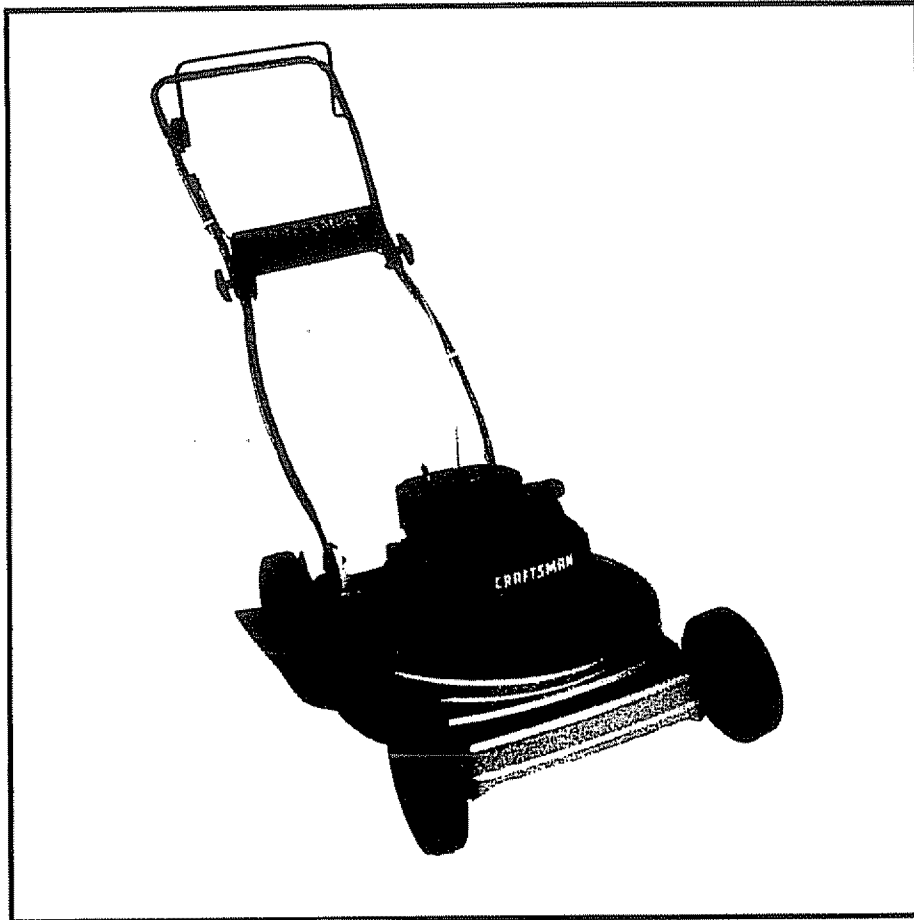

CRAFTSMAN®

**3.5 RESERVE POWER
20'' SIDE DISCHARGE
ROTARY LAWN MOWER**

**Assembly
Operation
Maintenance
Service and Adjustment
Repair Parts**

SEARS, ROEBUCK AND Co., Chicago, IL. 60684 U.S.A.

SAFETY RULES



CAUTION: ALWAYS DISCONNECT SPARK PLUG WIRE AND PLACE WIRE WHERE IT CANNOT CONTACT SPARK PLUG TO PREVENT ACCIDENTAL STARTING WHEN SETTING-UP, TRANSPORTING, ADJUSTING OR MAKING REPAIRS TO YOUR MOWER.



IMPORTANT

FEDERAL REGULATIONS REQUIRE OPERATOR PRESENCE BLADE STOP CONTROLS TO MINIMIZE THE RISK OF BLADE CONTACT INJURY. YOUR MOWER IS EQUIPPED WITH SUCH CONTROLS. DO NOT ATTEMPT TO DEFEAT THE FUNCTION OF THE OPERATOR PRESENCE CONTROL UNDER ANY CIRCUMSTANCES.

- BE CAREFUL-WHEN THE ENGINE IS RUNNING, THE BLADE IS TURNING.
- Please read your owner's manual. Only allow persons who know the safety rules to use your mower.
- DO NOT tie the operator presence control bar to the handle. Control must be free to permit brake engagement when handles and control are released.
- DO NOT allow children to use your mower.
- Check your mower over before each use. Tighten any loose bolts, nuts, etc.
- Remove all sticks, stones, wires, cans, boards, etc. from area to be mowed. These objects can be thrown by the blade.
- DO NOT allow children, bystanders or pets in the area while mowing.
- Always wear shoes when mowing. DO NOT operate mower when barefoot or wearing open sandals.
- Always wear safety glasses or eye shields before starting your lawn mower and while mowing.
- Always shut off engine before trying to adjust wheel heights.
- When engine is running, DO NOT put hands or feet under mower or in the discharge chute, nor make any adjustments.
- Stay clear of discharge opening at all times.
- Do not fill gas tank when engine is running, when indoors or when engine is hot. Allow engine to cool for several minutes before filling gas tank. Clean off any spilled gasoline before starting engine.
- Mow only in good light.
- Always stop blade when not cutting grass or when crossing gravel drive, sidewalk, or roadway.
- DO NOT continue to run your mower if you hit a foreign object. Stop the engine, disconnect the spark plug wire from the spark plug, inspect the mower for damage and make repairs as required.
- DO NOT use a damaged mower. Always have damage repaired before mowing.
- DO NOT run your mower if it vibrates too much. Stop engine and make repairs. Vibration is an indication of damage.
- Never use your mower without proper guards or deflectors in place.
- Always mow across a slope or inclined area. DO NOT mow up or down a slope or inclined area.
- DO NOT mow in wet grass. Be careful of footing when mowing in wet grass, use shoes with good traction.
- DO NOT run with the mower.
- DO NOT run your mower indoors. Exhaust gases are deadly poison.
- Always disconnect the spark plug wire from the spark plug to prevent accidental starting when transporting or storing your mower after the mowing season.
- DO NOT attempt to raise engine speed above factory settings. Engine damage or personal injury may result.
- If a grass catcher is used on your mower, check the catcher often for damage or deterioration. It will wear through normal use. Use only a recommended replacement catcher.
- Always stop blade to remove or install catcher.
- DO NOT store your mower or gasoline where fumes may reach an open flame and cause a fire.
- DRAIN THE GASOLINE from your mower before transporting your mower inside your car or other vehicle.



LOOK FOR THIS SYMBOL TO POINT OUT IMPORTANT SAFETY PRECAUTIONS. IT MEANS-- ATTENTION!!! BECOME ALERT!!! YOUR SAFETY IS INVOLVED.

CONGRATULATIONS on your purchase of a Sears Craftsman Lawn Mower. It has been designed, engineered and manufactured to give you the best possible dependability and performance.

Should you experience any problem you cannot easily remedy, please contact your nearest Sears Service Center/Department. We have competent, well-trained technicians and the proper tools to service or repair this unit.

Please read and retain this manual. The instructions will enable you to assemble and maintain your mower properly. Always observe the "SAFETY RULES".

<p>MODEL NUMBER 917.380221</p> <p>SERIAL NUMBER _____</p> <p>DATE OF PURCHASE _____</p> <p>THE MODEL AND SERIAL NUMBERS WILL BE FOUND ON A DECAL ATTACHED TO THE REAR OF THE MOWER HOUSING.</p> <p>YOU SHOULD RECORD BOTH SERIAL NUMBER AND DATE OF PURCHASE AND KEEP IN A SAFE PLACE FOR FUTURE REFERENCE.</p>

PRODUCT SPECIFICATIONS

RESERVE POWER:	3.5
DISPLACEMENT:	9.06 cu. in.
GASOLINE CAPACITY:	1.0 quart. (unleaded)
OIL (21 oz. capacity):	SAE 30W (SAE 10W 30)
SPARK PLUG (GAP .030 in.)	Champion RJ19-LL or (Sears 7133312 or STD 361458)
VALVE CLEARANCE:	Intake: .008 in. Exhaust: .008 in.
SOLID STATE IGNITION AIR GAP:	.0125 in.
BLADE NUT TORQUE:	70-75 ft.-lbs.

MAINTENANCE AGREEMENT

A Sears Maintenance Agreement is available on this product. Contact your nearest Sears store for details.

CUSTOMER RESPONSIBILITIES

- Read and observe the safety rules.
- Follow a regular schedule in maintaining, caring for and using your mower.
- Follow the instructions under "Maintenance" and "Storage" sections of this Owner's Manual.

ONE YEAR LIMITED WARRANTY ON CRAFTSMAN POWER MOWER

For one year from the date of purchase, when this Craftsman Lawn Mower is maintained, lubricated and tuned-up according to the instructions in the owner's manual, Sears will repair, free of charge, any defect in material and workmanship.

If this Craftsman Lawn Mower is used for commercial or rental purposes, this warranty applies for only 90 days from the date of purchase.

This warranty does not cover:

- Expendable items which become worn during normal use, such as rotary mower blades, blade adapters, belts, air cleaners and spark plug.
- Repairs necessary because of operator abuse or negligence, including bent crankshafts and the failure to maintain the equipment according to the instructions contained in the owner's manual.

WARRANTY SERVICE IS AVAILABLE BY RETURNING THE CRAFTSMAN POWER MOWER TO THE NEAREST SEARS SERVICE CENTER/DEPARTMENT IN THE UNITED STATES. THIS WARRANTY APPLIES ONLY WHILE THIS PRODUCT IS IN USE IN THE UNITED STATES.







This warranty gives you specific legal rights, and you may also have other rights which may vary from state to state.

SEARS, ROEBUCK AND CO. Department 698/731A Sears Tower, Chicago, Ill. 60684





MOWER ACCESSORIES

These accessories were available when the mower was purchased. They are also available at most Sears retail outlets, catalog and service centers. Most Sears stores can order repair parts for you, when you provide the model number of your mower.

ENGINE

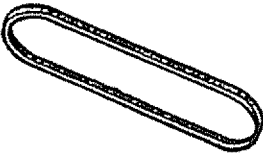
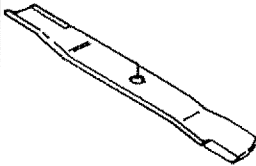
SPARK PLUG 	MUFFLER 	AIR FILTER 	GAS CAN 	ENGINE OIL 	STABILIZER 
--------------------------------------------------------------------------------------------------------	-----------------------------------------------------------------------------------------------------	--------------------------------------------------------------------------------------------------------	------------------------------------------------------------------------------------------------------	----------------------------------------------------------------------------------------------------------	----------------------------------------------------------------------------------------------------------

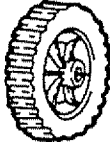
MOWER MAINTENANCE

BELT 	BLADE 	BLADE ADAPTER 	WHEELS 	MOWER COVER 
---------------------------------------------------------------------------------------------------	----------------------------------------------------------------------------------------------------	-----------------------------------------------------------------------------------------------------------	-------------------------------------------------------------------------------------------------------	------------------------------------------------------------------------------------------------------------

ASSEMBLY

Your lawn mower has been completely assembled at the factory.

TO REMOVE MOWER FROM CARTON

- Remove loose parts if included with mower, (i.e. grass catcher, catcher frame, hardware pack, etc.).
- Cut down corners on one end of carton and lay end down flat.
- Remove packing material.
- Roll mower out of carton and check carton thoroughly for loose parts.

HOW TO SET-UP YOUR LAWN MOWER

TO UNFOLD HANDLE

Remove tape and paper holding operator presence control bar to upper handle.

- Hold down operator presence control bar to upper handle to allow handle to move to mowing position.
- Raise handles until lower handle section locks into place in the mowing position (See Fig. 1).

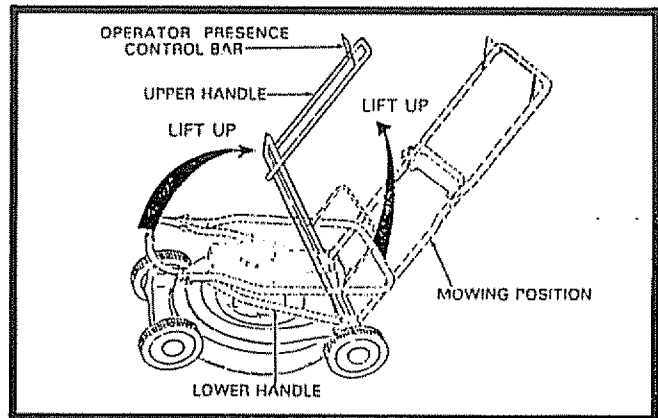

FIG. 1

- Raise upper handle section into place on lower handle and tighten one (1) handle knob.
- Release operator presence control bar and tighten remaining handle knob.
- Your mower handle can be adjusted for your mowing comfort. Refer to "ADJUST HANDLE" in the Service and Adjustment section of this manual.

OPERATION

KNOW YOUR MOWER

READ THIS OWNER'S MANUAL AND SAFETY RULES BEFORE OPERATING YOUR ROTARY MOWER. Compare the illustrations with your Rotary Mower to familiarize yourself with the location of various controls and adjustments. Save this manual for future reference.

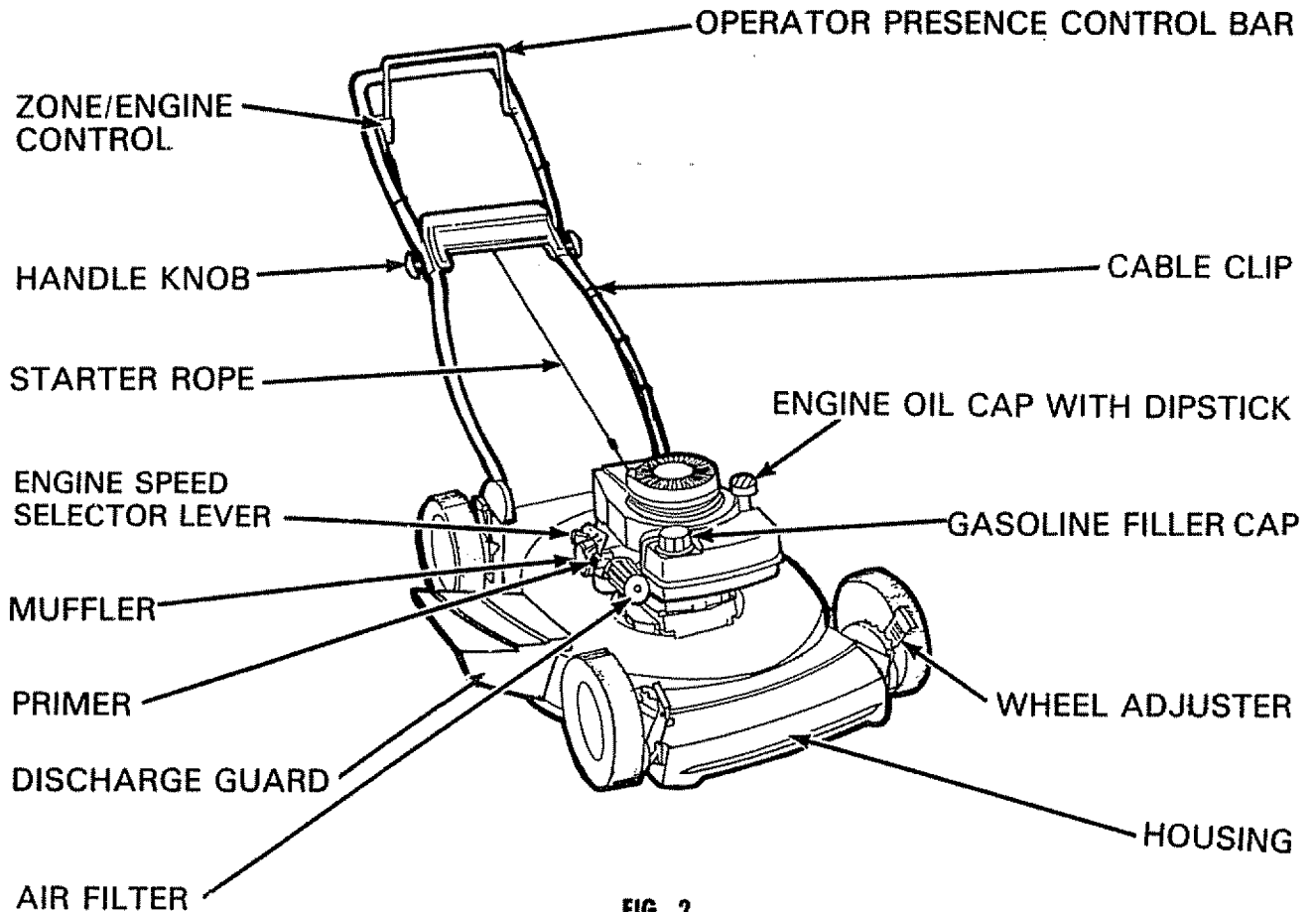

FIG. 2

MEETS CPSC SAFETY REQUIREMENTS

Sears Rotary Walk-Behind Power Mowers conform to the safety standards of the American National Standards Institute and The U.S. Consumer Product Safety Commission. The blade turns when the engine is running.

OPERATOR PRESENCE CONTROL BAR - must be held down to the handle to start the engine. Release to stop the engine.

ENGINE SPEED CONTROL LEVER - located on the right side of the engine which allows you to select either "HIGH" or "LOW" engine speed.

PRIMER - pumps additional fuel from the carburetor to the cylinder for use when starting a cold engine.

STARTER ROPE - used for starting the engine.

OPERATION

HOW TO USE YOUR MOWER

ENGINE SPEED SELECTOR

The engine speed is controlled by a lever (red knob) located on the right side of the engine. "HIGH" position is for starting engine, normal cutting and better grass bagging. "LOW" position is for light cutting, trimming, and fuel economy (See Fig. 3).

TO ADJUST CUTTING HEIGHT

- Raise wheels for low cut and lower wheels for high cut.
- Wheels are set in low cut for shipping. Adjust cutting height to suit your requirements. Medium position is best for most lawns.
- To change cutting height, squeeze adjuster lever toward wheel. Move wheel up or down to suit your requirements. Be sure all wheels are in the same setting (See Fig. 4).

BEFORE STARTING ENGINE

OIL:

- Remove engine oil cap with dipstick or oil fill plug. Fill to "FULL" line on dipstick or to top of slot down in filler hole. Use about 1 pint or 1/2 liter of Sears 30W oil or equivalent. SAE 10W 30 oil can also be used. DO NOT use SAE 10W 40 oil. The total oil capacity of your engine is 21 oz. or 0.62 liters. Fill only to "FULL" line on dipstick or to top of slot down in oil filler hole. DO NOT over fill. The first fill on a new engine uses about 1 pint. Check oil level and add oil as needed to bring to proper level.
- Pour oil slowly, DO NOT over fill.

GAS:

- Fill gasoline tank with fresh, clean unleaded gasoline. DO NOT USE PREMIUM GASOLINE. BE CAREFUL NOT TO OVER FILL TANK (SEE FIG. 2).

WARNING: Experience indicates that alcohol blended fuels (called gasohol or using ethanol or methanol) can attract moisture which leads to separation and formation of acids during storage. Acidic gas can damage the fuel system of an engine while in storage. To avoid engine problems, the fuel system should be emptied before storage for 30 days or longer. Drain the gas tank, start the engine and let it run until the fuel lines and carburetor are empty. Use fresh fuel

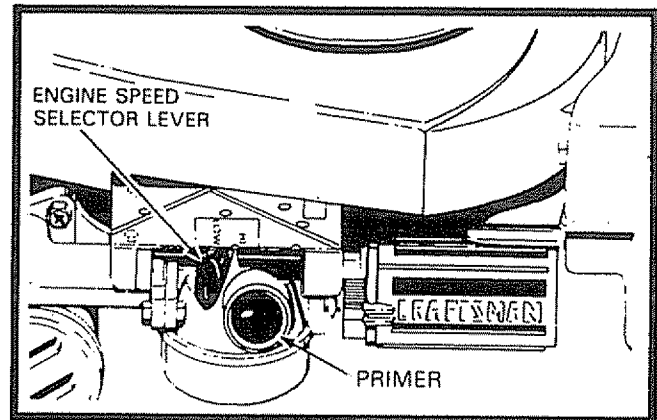

FIG. 3

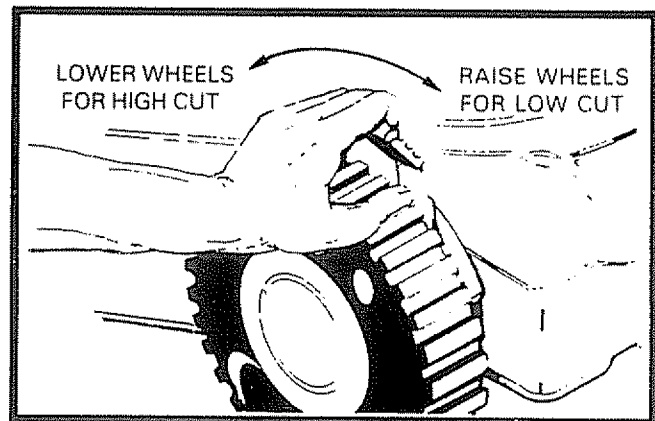

FIG. 4

next season. See Storage Instructions for additional information.

Never use engine or carburetor cleaner products in the fuel tank or permanent damage may occur.

TO START ENGINE

- To start a cold engine, push primer five (5) times before trying to start. Use a firm push. This step is not usually necessary when starting an engine which has already run for a few minutes.
- Push engine speed selector lever forward to "HIGH" position.
- Hold operator presence control bar down to the handle and pull starter handle quickly. Do not allow starter rope to snap back.
- To "STOP" engine, release operator presence control bar.

NOTE: In cooler weather it may be necessary to repeat priming steps. In warmer weather over priming may cause flooding and engine will not start. If you do flood engine wait a few minutes before attempting to start and DO NOT repeat priming steps.

OPERATION

MOWING TIPS

- Under certain conditions, such as very tall grass, it may be necessary to raise the height of cut to reduce pushing effort and to keep from overloading the engine and leaving clumps of grass clippings.
- For extremely heavy cutting, reduce the width of cut and raise the rear of the mower housing one (1) wheel adjuster setting higher than the front for better discharge of grass.
- When using a rear bagging mower in moist, heavy grass, clumps of cut grass may not enter the grass catcher. Reduce ground speed (pushing speed) and/or run the mower over the area a second time.
- For better grass bagging and most cutting conditions, the engine speed should be set in the "HIGH" (fast) position.
- If a trail of grass clippings is left on the right side of a rear bagging mower, mow in a clockwise direction with a small overlap to collect the clippings on the next pass.
- For side discharge mowers, cutting in a counter-clockwise direction, starting at the outside of the area to be cut, spreads grass clippings more evenly and puts less load on the engine. To keep clippings off of walkways, flower beds, etc., make the first cuts in a clockwise direction.
- Pores in cloth grass catchers can become filled with dirt and dust with use and catchers will collect less grass. To prevent this, regularly hose catcher off with water and let dry before using.

MAINTENANCE

MOWER

GENERAL RECOMMENDATIONS

- Once a year you should replace the spark plug, air filter, and check blade for wear. A new spark plug and air filter assures proper air-fuel mixture and helps your engine run better and last longer.
- You should check all fasteners and be sure they are tight.
- Follow the Service Recommendation Schedule on page 13.

BLADE/BLADE FLANGE CARE

Your mower will work better with a sharp blade.



CAUTION: DISCONNECT SPARK PLUG WIRE FROM SPARK PLUG AND PLACE WIRE WHERE IT CANNOT COME IN CONTACT WITH THE SPARK PLUG.

TO REMOVE BLADE:

- Turn mower on its side. Make sure air filter and carburetor are up.
- Use block of wood between blade and mower housing to prevent blade from turning when nut is removed. Protect your hands with gloves and/or wrap blade with heavy cloth.
- Remove nut by turning counter-clockwise. Use a 15/16" box or open-end wrench.

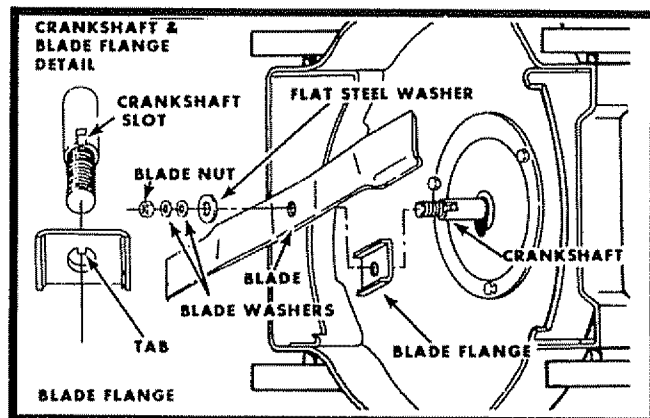

FIG. 5

NOTE: Check tab in blade flange after removing. If tab is damaged, replace it. It must be in good condition for the blade to work properly. We recommend that a new blade nut be used each time blade is removed.

TO REPLACE BLADE:

- Put blade flange on engine crankshaft with tab in slot (See Fig. 5).
- Fit blade on crankshaft in the blade flange. Be sure the word "TOP" (stamped on blade) is toward engine.
- Place flat washer, two (2) formed washers and nut on crankshaft (See Fig. 5).
- Use block of wood to hold blade and tighten nut clockwise. The recommended torque is 70-75 ft.-lbs. Torque wrenches are available at most Sears stores and through the catalog.

MAINTENANCE

MOWER

BLADE/BLADE FLANGE CARE (CONT'D)



CAUTION: A LOOSE BLADE CAN BE DANGEROUS AND MAY MAKE THE ENGINE HARD TO START.

Use only a Sears authorized replacement blade to get the best cutting results.

NOTE: We do not recommend sharpening blade - but if you do, be sure the blade is balanced.

TO SHARPEN BLADE:

- The blade can be sharpened with a file or on a grinding wheel. Do not attempt to sharpen while on the mower.
- Care should be taken to keep the blade balanced. An unbalanced blade will cause excessive vibration when running and eventual damage to mower or engine.
- To check blade balance, drive a nail into a beam or wall. Leave about one inch of the straight nail exposed. Place center hole of blade over the head of the nail. If blade is balanced, it should remain in a horizontal position. If either end of the blade moves downward, blade is not balanced. Sharpen the heavy end until the blade is balanced.

GRASS CATCHER

(If Purchased As An Accessory)

Check your grass catcher often for damage or deterioration. Through normal use it will wear. If catcher needs replacing, replace only with a manufacturer approved replacement catcher from Sears. Give the mower model number when ordering.

NOTE: The catcher may be hosed with water, but must be dry when used.

ENGINE

TO CHANGE OIL



CAUTION: DISCONNECT SPARK PLUG WIRE FROM SPARK PLUG AND PLACE WIRE WHERE IT CANNOT COME IN CONTACT WITH SPARK PLUG.

- Remove engine oil cap with dipstick; lay aside on a clean surface. Warm oil drains better.

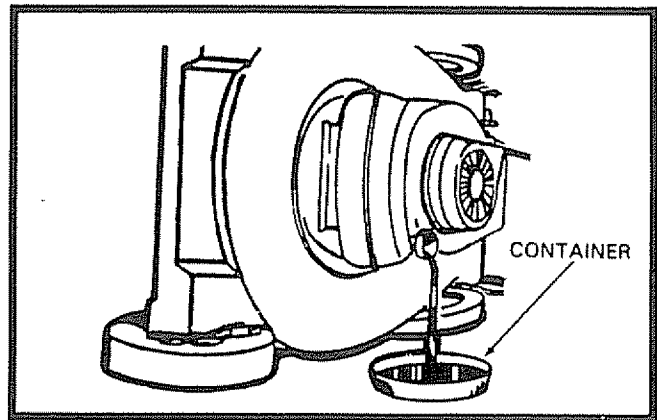

FIG. 6

- Tip mower on its side as shown in Fig. 6 and drain oil into suitable container. Rock mower back and forth to remove any oil trapped inside of engine.
- Wipe off any spilled oil on mower and on side of engine.
- Fill engine with oil. Fill only to the "FULL" line on the dipstick. DO NOT over fill.
- Replace engine oil cap.
- Reconnect spark plug wire to spark plug.

AIR FILTER

Your engine will not run properly and may be damaged by using a dirty air filter.

Replace the air filter every year, more often if you mow in very dusty, dirty conditions. Do not wash air filter.

TO CHANGE AIR FILTER:

- Remove the air filter cover by turning counterclockwise to the stop and pull away from collar (See Fig. 7).
- Remove filter from inside of cover (See Fig. 7).
- Clean the inside of the cover and the collar to remove any dirt accumulation.
- Insert new filter into cover.

MAINTENANCE

AIR FILTER (CONT'D)

- Put air filter cover and filter into collar aligning the tab with the slot.
- Push in on cover and turn clockwise to tighten (See Fig. 7).

SPARK PLUG

Change your spark plug each year to make your engine start easier and run better. Set spark plug gap at .030 inch.

CLEANING



- Turn mower on its side with carburetor up.
- Clean the underside of your mower by scraping to remove build-up of grass and trash.

NOTE: We recommend that you clean the underside of your mower after each use.

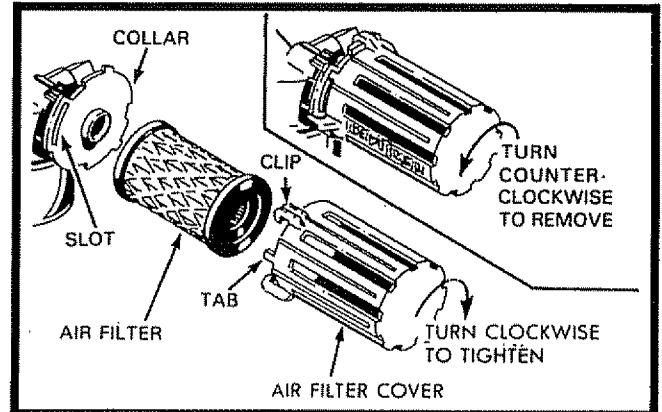

FIG. 7

- Clean your mower and engine often to keep build-up of trash from accumulating around engine. A clogged engine runs hotter and shortens engine life.

NOTE: We DO NOT recommend using a garden hose to clean mower unless the electrical system, muffler, air filter, and carburetor are covered to keep water out. Water in engine can result in shortening engine life.

SERVICE AND ADJUSTMENTS

CARBURETOR

Your carburetor has a non-adjustable fixed main jet for mixture control. If your engine does not operate properly due to suspected carburetor problems, take your mower to an authorized Sears Service Center for repair and adjustment.

ENGINE SPEED

Your engine speed has been factory set. Do not attempt to increase engine speed or it may result in personal injury. If you believe that the engine is running too fast or too slow, take your mower to an authorized Sears Service Center for repair and adjustment.

DISCHARGE GUARD

The discharge guard, attached to the discharge opening of your mower, is provided to prevent the

possibility of injury resulting from objects being thrown out of the discharge opening into the operator mowing position.

If the discharge guard becomes damaged, it should be replaced.



REAR DEFLECTOR

The rear deflector, attached between the rear wheels of your mower, is provided to minimize the possibility that objects will be thrown out the rear of the mower into the operator mowing position.

If the rear deflector becomes damaged, it should be replaced.

SERVICE AND ADJUSTMENTS

TO ADJUST HANDLE

Your lawn mower handle can be mounted in a high or low position for your mowing comfort. Handles are shipped mounted in the high position.

- To change from high to low position, only the lower handle section will have to be turned over (See Fig. 8).
- Remove the upper handle section and all of the parts that are attached to the lower handle section. Remove all of the parts that hold the lower handle to the handle brackets (See Fig. 9).
- Turn the lower handle over and re-assemble all of the parts that were taken off. Re-assemble the upper handle section to the lower handle (See Fig. 9).

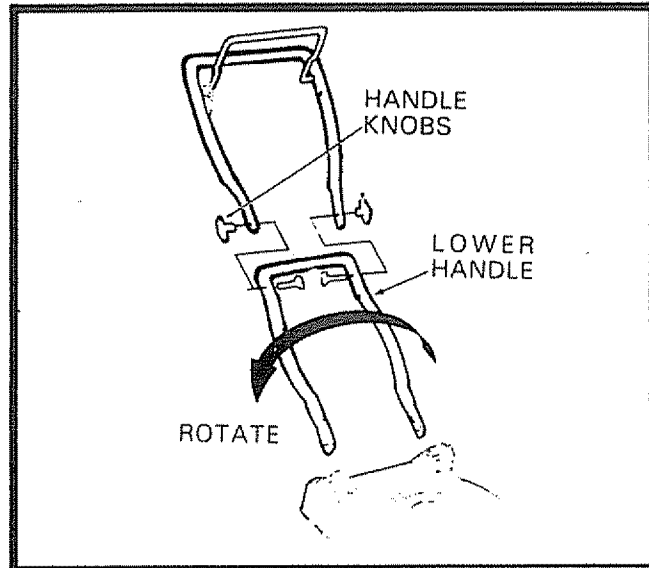

FIG. 8

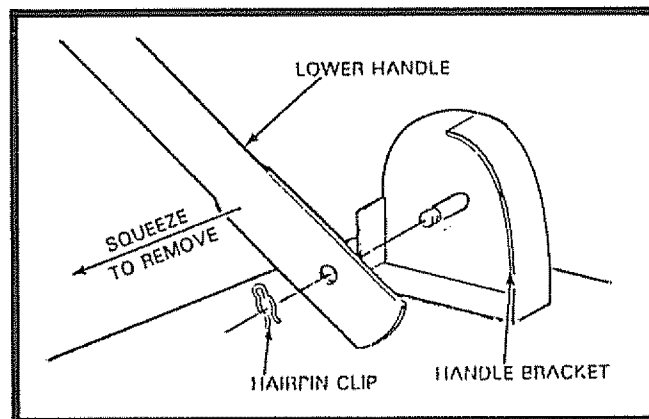

FIG. 9

STORAGE

Your mower and engine should be prepared for off-season storage as follows:

MOWER

- Clean underside of mower housing. (See "Cleaning" in Maintenance section of manual).
- Inspect and replace/sharpen blade, if required (see "Blade/Blade Flange Care" in Maintenance section of manual).
- Hose grass catcher off with water and let dry before storing.
- Lubricate as shown in Service Recommendation Chart on page 13 of manual.

HANDLE

- You can fold your mower handle for storage as shown in Fig. 10.
- To fold, squeeze the bottom ends of the lower handle toward each other until the lower handle clears the handle bracket, then move handle forward (See Fig. 11).

IMPORTANT: WHEN FOLDING THE HANDLE FOR STORAGE OR TRANSPORTATION, BE SURE TO FOLD THE HANDLE AS SHOWN IN FIG. 10. IF YOU FOLD THE UPPER HANDLE SECTION THE WRONG WAY, YOU MAY DAMAGE THE CONTROL CABLES.

ENGINE

- Change oil (see "TO CHANGE OIL" in maintenance section of manual).
- Drain fuel and run engine until fuel system is empty.

IMPORTANT: IT IS IMPORTANT TO PREVENT GUM DEPOSITS FROM FORMING IN ESSENTIAL FUEL SYSTEM PARTS SUCH AS THE CARBURETOR, FUEL FILTER, FUEL HOSE, OR TANK DURING STORAGE. ALSO, EXPERIENCE INDICATES THAT ALCOHOL BLENDED FUELS (CALLED GASOHOL OR USING ETHANOL OR METHANOL) CAN ATTRACT MOISTURE WHICH LEADS TO SEPARATION AND FORMATION OF ACIDS DURING STORAGE. ACIDIC GAS CAN DAMAGE THE FUEL SYSTEM OF AN ENGINE WHILE IN STORAGE.

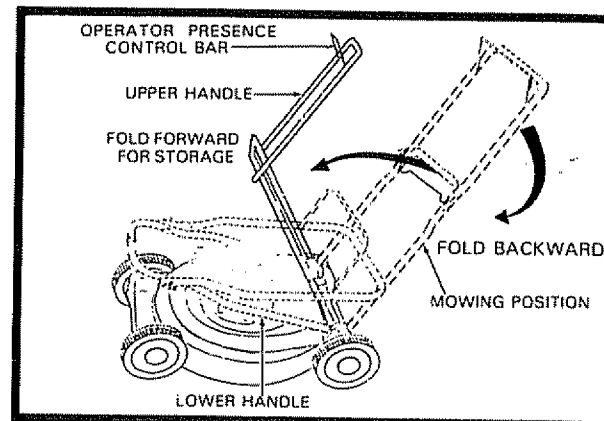

FIG. 10

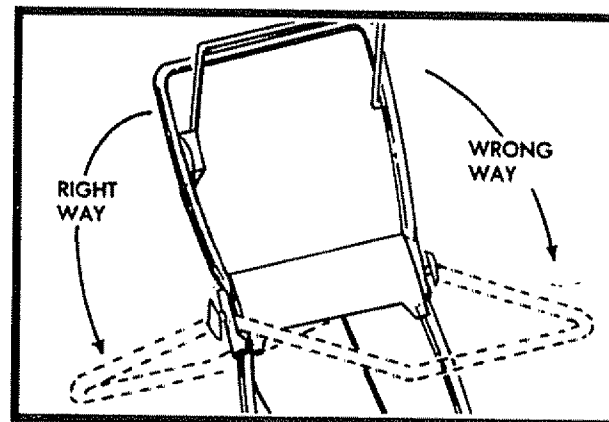

FIG. 11

OTHER

- Do not store gasoline from one season to another.
- Replace your gasoline can if your can starts rust. Rust and/or dirt in your gasoline can cause problems.
- Do not store your mower under any plastic cover. Plastic cannot breathe which allows condensate to form and can cause your mower to rust.
- When setting up your handle from the storage position, the lower handle will automatically lock into the mowing position.

SERVICE RECOMMENDATIONS

SERVICE RECORD Fill in dates as you complete regular service	SCHEDULE					SERVICE DATES		
	First 2 Hours	Every 10 Hours	Every 25 Hours	Every 50 Hours	Every Use			
Blades Sharpened		✓						
Blades Replaced			✓					
Engine Oil Change	✓		✓					
Engine Oil Check					✓			
Air Cleaner Replaced			✓					
Spark Plug Replaced			✓					
Lubricate Mower			✓					
Cleaning					✓			
Grass Catcher (if applicable)			✓					
Muffler			✓					

✓ - CHECK

LUBRICATION CHART

① SAE 30W MOTOR OIL (10W 30)

② SPRAY LUBRICANT

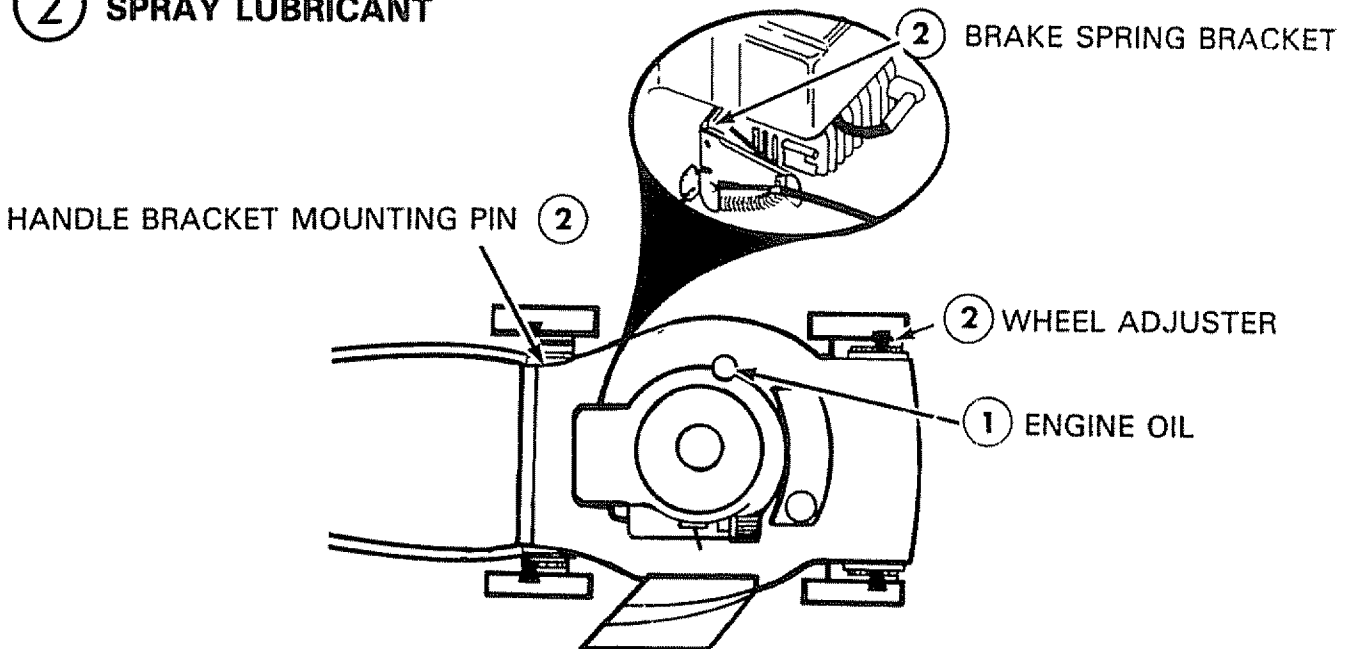

CRAFTSMAN 20" SIDE DISCHARGE ROTARY LAWN MOWER 917.380221

REPAIR PARTS

14

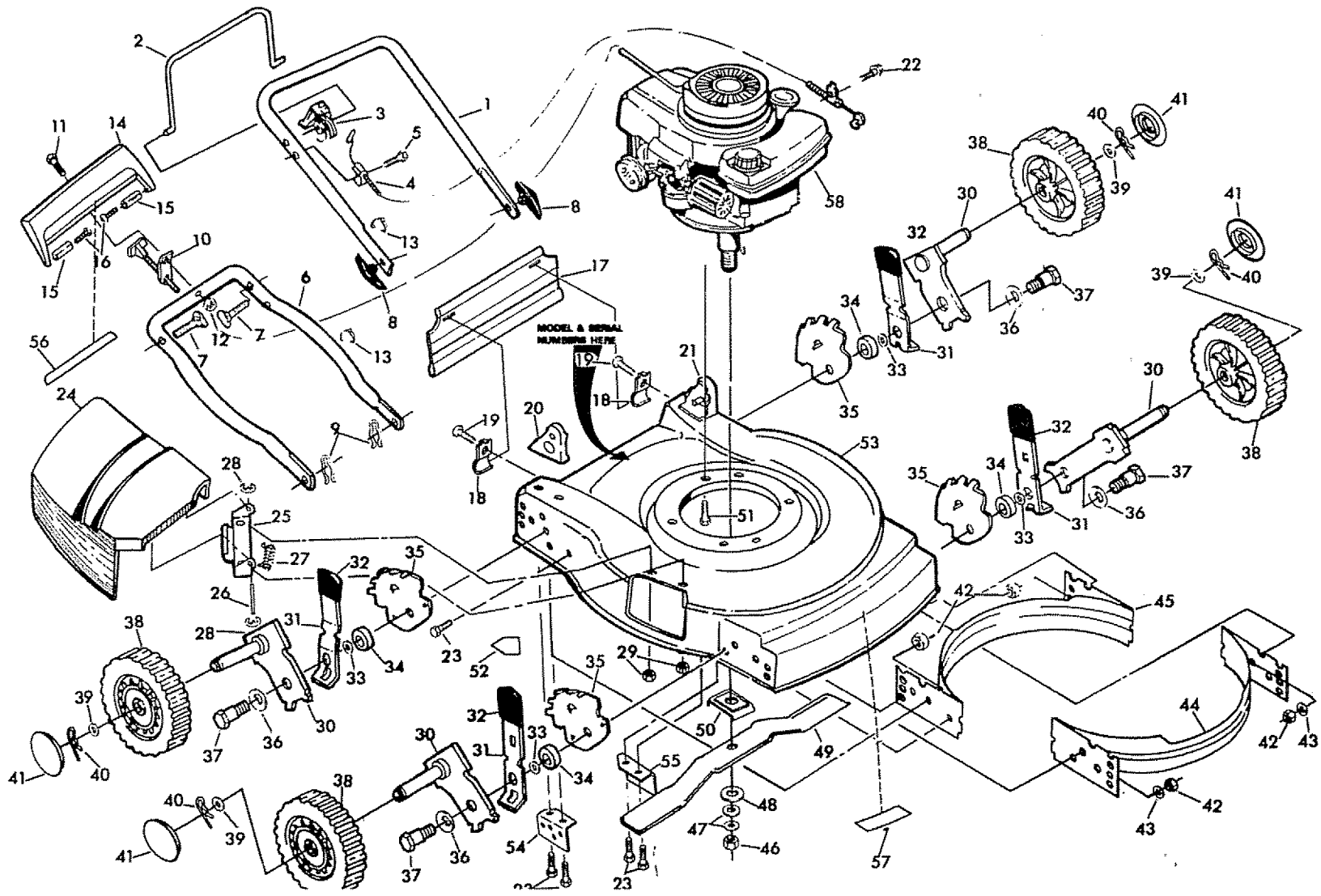

REPAIR PARTS

CRAFTSMAN 20" SIDE DISCHARGE ROTARY LAWN MOWER 917.380221

Ref. No.	PART No.	Part Name	Ref. No.	PART No.	Part Name
1	84046	Upper Handle	30	85022	Axle Arm Assembly
2	84049	Control Bar	31	84888	Selector Spring
3	86874	Zone Control Actuator	32	87877	Selector Knob
4	85483	Cable Assembly	33	88348	Washer
5	85768	Hex Thread Rolling Screw 10-24 x 3/4	34	84920	Spacer
6	84683	Lower Handle	35	69478	Wheel Adjusting Bracket
7	58714	Handle Bolt	36	62335	Spring Washer
8	63688	Handle Knob	37	84921	Shoulder Bolt
9	51793	Hairpin Cotter	38	87695	Wheel & Tire Assembly 7 1/2"
10	34372A	Rope Guide (See Engine Parts List) (Source 143)	39	51260	Washer
11	85436	Hex Washer Head Machine Screw 1/4-20 x 1 1/2	40	85179	Retainer Clip
12	63601	Locknut 1/4-20	41	77400	Hubcap
13	85827	Cable Clip	42	74400	Locknut 3/8-16
14	85424	Trim Plate	43	62333	Washer
15	85529	Nylon Bushing	44	88374	Baffle-Front
16	85825	Self Tapping Screw 10-24 x 1	45	88375	Baffle-Rear
17	87586	Rear Skirt	46	51433	Locknut 5/8-18
18	87585	Rear Skirt Bracket	47	54867	Spring Washer
19	81276	Self Tapping Screw 10-24 x 1/2	48	69385	Washer
20	85663	Handle Bracket Assembly (Right)	49	69229	Blade
21	85664	Handle Bracket Assembly (Left)	50	87712	Blade Flange
22	83813	Hex Head Screw 10-32 x 5/16	51	68205	Hex Head Screw 5/16-18 x 7/8
23	55187	Thread Cutting Screw 5/16 - 18 x 3/4	52	85463	Danger Decal
24	87605	Discharge Guard	53	48109	Mower Housing Assembly (Incl. Ref #44 & 45)
25	87593	Housing Bracket	54	88394	Support Bracket (Right)
26	87590	Hinge Rod	55	88393	Support Bracket (Left)
27	87589	Torsion Spring	56	85425	Trim Plate Decal
28	STD581025	E-Ring	57	86875	Housing Decal
29	53490	Locknut 1/4-20	58	700040	Engine Assembly 143.394032 (See pages 16 thru 18)
				700042	Owners Manual
					Grass Catcher Complete (Not In- cluded with Mower) <u>71</u> 33072

CRAFTSMAN 4-CYCLE ENGINE

MODEL NUMBER: 143.394032

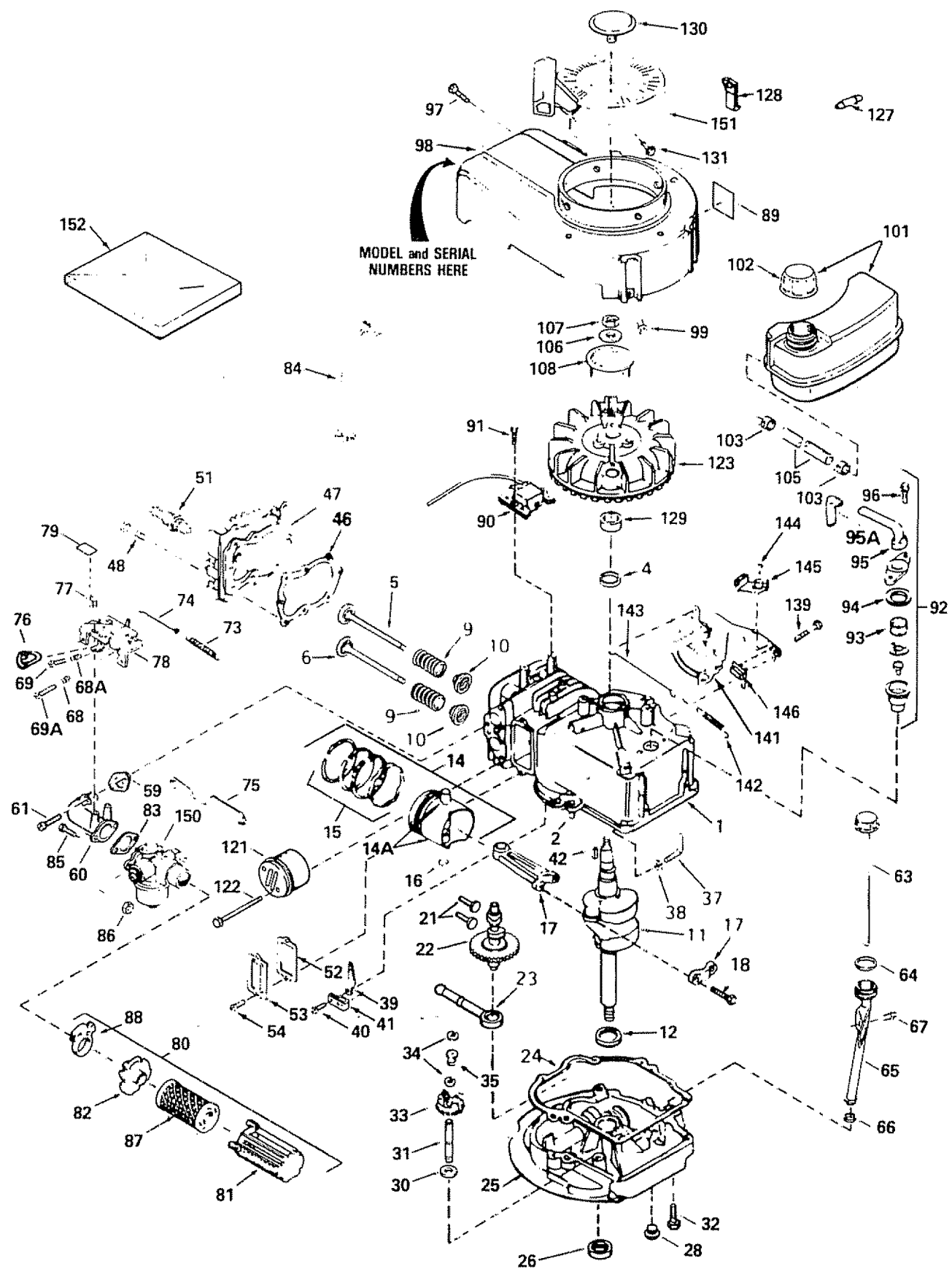

CRAFTSMAN 4-CYCLE ENGINE

MODEL NUMBER: 143.394032

Ref. No.	Part No.	Part Name	Ref. No.	Part No.	Part Name
1	34975	Cylinder Assy. (Incl Nos 2, 4, 94 & 96)	69A	650777	Screw, Fil. hd., 6-32 x 21/32
2	26727	Pin, Dowel	73	31361	Spring, Governor
4	32600	Seal, Oil	74	34337	Link, Governor spring
5	29314B	Valve, Intake (Std.) (Incl. No. 10)	75	34336	Link, Governor-to-throttle
5	29315C	Valve, Intake (1/32" oversize) (Incl. No. 10)	76	32410	Knob, Speed control
6	29313C	Valve, Exhaust (Std.) (Incl. No. 10)	77	30200	Screw, Hex washer hd. self-tap. Sems. 10-24 x 9/16
6	29315C	Valve, Exhaust (1/32" oversize) (Incl. No. 10)	78	33205A	Control Assy., Speed (Incl. Nos 68, 68A, 69, 69A)
9	31672	Spring, Valve	79	35167	Decal, Instruction
10	31673	Cap, Lower valve spring	80	3331	Air Cleaner Kit (Incl. Nos 81, 82, 87 & 88)
11	35588	Crankshaft	81	35065	Cover, Air cleaner
12	32323	Washer, Thrust	82	35067	Collar, Air cleaner
14	34514	Piston, Pin & Ring Assy. (Incl. Nos. 14A, 15 & 16) (Std.)	83	*26756	Gasket, Carburetor
14	34515	Piston, Pin & Ring Assy. (Incl. Nos. 14A, 15 & 16) (.010 oversize)	84	34961	Wire, Ground
14	34516	Piston, Pin & Ring Assy. (Incl. Nos. 14A, 15 & 16) (.020 oversize)	85	6201	Screw, Hex hd., 1/4-28 x 7/8
14A	32538B	Piston & Pin Assy. (Std.) (Incl. No. 16)	86	29752	Nut & Lockwasher, 1/4-28
14A	32548B	Piston & Pin Assy. (.010 oversize) (Incl. No. 16)	87	35066	Filter, Air cleaner
14A	32549B	Piston & Pin Assy. (.020 oversize) (Incl. No. 16)	88	35068	Clamp, Air cleaner
15	28986	Ring Set, Piston (Std.)	89	35391	Decal, Instruction
15	28987	Ring Set, Piston (.010 oversize)	90	34443A	Solid State Assy
15	28988	Ring Set, Piston (.020 oversize)	91	650814	Screw, Torx hex washer hd Sems. 10-24 x 1
16	20381	Ring, Piston pin retaining	92	34214A	Breather Assy (Incl. Nos 93 thru 96)
17	30963B	Rod Assy., Connecting (Incl. No. 18)	93	33734	Element, Breather
18	32610A	Bolt, Connecting rod	94	*33735	Gasket, Breather
21	27241	Lifter, Valve	95	33886	Tube, Breather
22	33148A	Camshaft (Compression Release)	95A	34695	Elbow, Breather tube
23	29914	Pump Assy., Oil	96	30200	Screw, Hex washer hd self-tap Sems. 10-24 x 9/16
24	*35261	Gasket, Mounting flange	97	30200	Screw, Hex washer hd self-tap Sems. 10-24 x 9/16
25	34311B	Flange Assy., Mounting (Incl. Nos. 26, 28 & 31)	98	35478	Housing, Blower
26	27897	Seal, Oil	99	650831	Screw, Hex washer hd., Powerlok thread, 1/4-20 x 15/32
28	27244	Plug, Oil drain	101	35586	Tank Assy., Fuel (Incl. Nos 102 & 103)
30	35479	Washer, Flat	102	35355	Cap, Fuel tank
31	30574	Shaft, Mechanical governor	103	26460	Clamp, Fuel line
32	650488	Screw, Hex hd. Sems, 1/4-20 x 1-1/4	105	34357	Line, Fuel
33	30591	Gear Assy., Governor (Incl. No. 30)	106	650815	Washer, Belleville
34	29193	Ring, Retaining	107	650816	Nut, Flywheel
35	30588A	Spool, Governor	108	35000	Hub, Starter
37	30589	Rod, Governor (Incl. No. 38)	121	27181B	Muffler (Incl. No. 122)
38	28277	Washer, Flat	122	650795	Screw, Hex hd., 1/4-20 x 2-1/4
39	31383A	Lever, Governor	123	611112	Flywheel
40	650548	Screw, Hex washer hd., 8-32 x 5/16	127	34985	Rope Stop & Staple Assy.
41	31335	Clamp, Governor lever	128	35168	Bracket Assy., Rope guide
42	611004	Key, Flywheel (Solid State)	129	34080	Spacer, Flywheel key
46	*29953C	Gasket, Cylinder head	130	35392	Plug, Starter
47	34335	Head, Cylinder	131	650884	Screw, Hex washer hd., 8-32 x 1/2
48	6021A	Screw, Hex flange hd., 5/16-18 x 1-1/2	139	650839	Screw, Hex washer hd Powerlok. 1/4-20 x 3/8
51	35395	Resistor Spark Plug (Champion R-J-19LM or equivalent)	141	35015A	Bracket Assy., Brake
52	*27234A	Gasket, Breather	142	34965	Spring, Extension
53	32755	Cover, Valve spring	143	34966	Link, Control
54	650128	Screw, Hex hd. Sems. 10-24 x 1/2	144	32309	Ring, Retaining
59	*34690A	Gasket, Intake	145	34968	Lever, Brake
60	31384A	Pipe, Intake (Incl. No. 59)	146	610973	Terminal Assy
61	650451	Screw, Hex hd. Sems, 1/4-20 x 1	150	632387	Carburetor (Incl. No. 83)
63	35578	Dipstick, Oil	151	590621	Starter, Rewind
64	35499	"O" Ring	152	33238D	Gasket Set (Incl. items marked*)
65	35577	Tube, Oil fill			RPM Speed Settings: Low, 2050; High, 3000
66	34265	Gasket, Oil fill tube			*Indicates Parts Included in Gasket Set, Ref. No. 152.
67	650562	Screw, Hex washer hd. shakeproof, 10-32 x 1/2			
68	33802	Spring, Compression			
68A	31342	Spring, Compression			
69	650549	Screw, Fil. hd., 5-40 x 7/16			

CARBURETOR NO. 632387

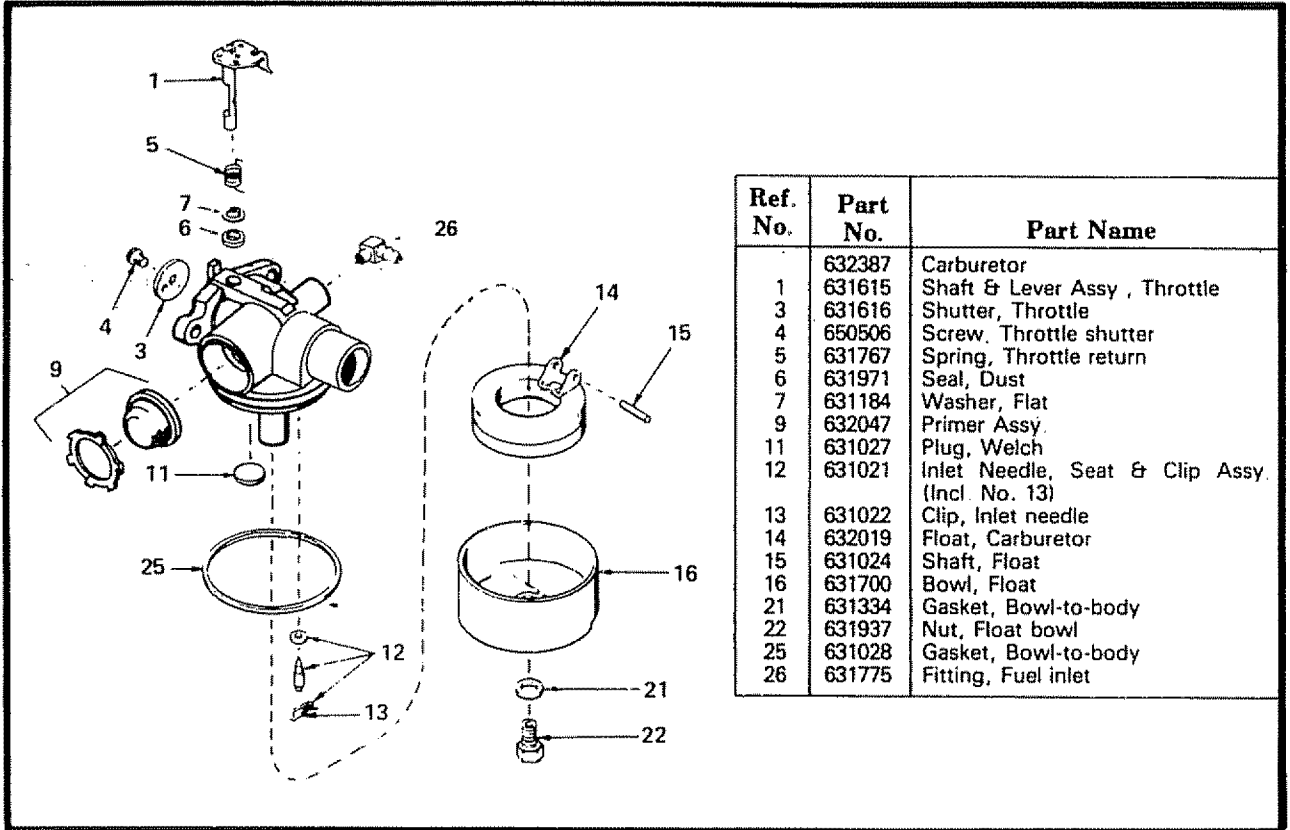

Ref. No.	Part No.	Part Name
	632387	Carburetor
1	631615	Shaft & Lever Assy , Throttle
3	631616	Shutter, Throttle
4	650506	Screw, Throttle shutter
5	631767	Spring, Throttle return
6	631971	Seal, Dust
7	631184	Washer, Flat
9	632047	Primer Assy.
11	631027	Plug, Welch
12	631021	Inlet Needle, Seat & Clip Assy. (Incl. No. 13)
13	631022	Clip, Inlet needle
14	632019	Float, Carburetor
15	631024	Shaft, Float
16	631700	Bowl, Float
21	631334	Gasket, Bowl-to-body
22	631937	Nut, Float bowl
25	631028	Gasket, Bowl-to-body
26	631775	Fitting, Fuel inlet

REWIND STARTER NO. 590621

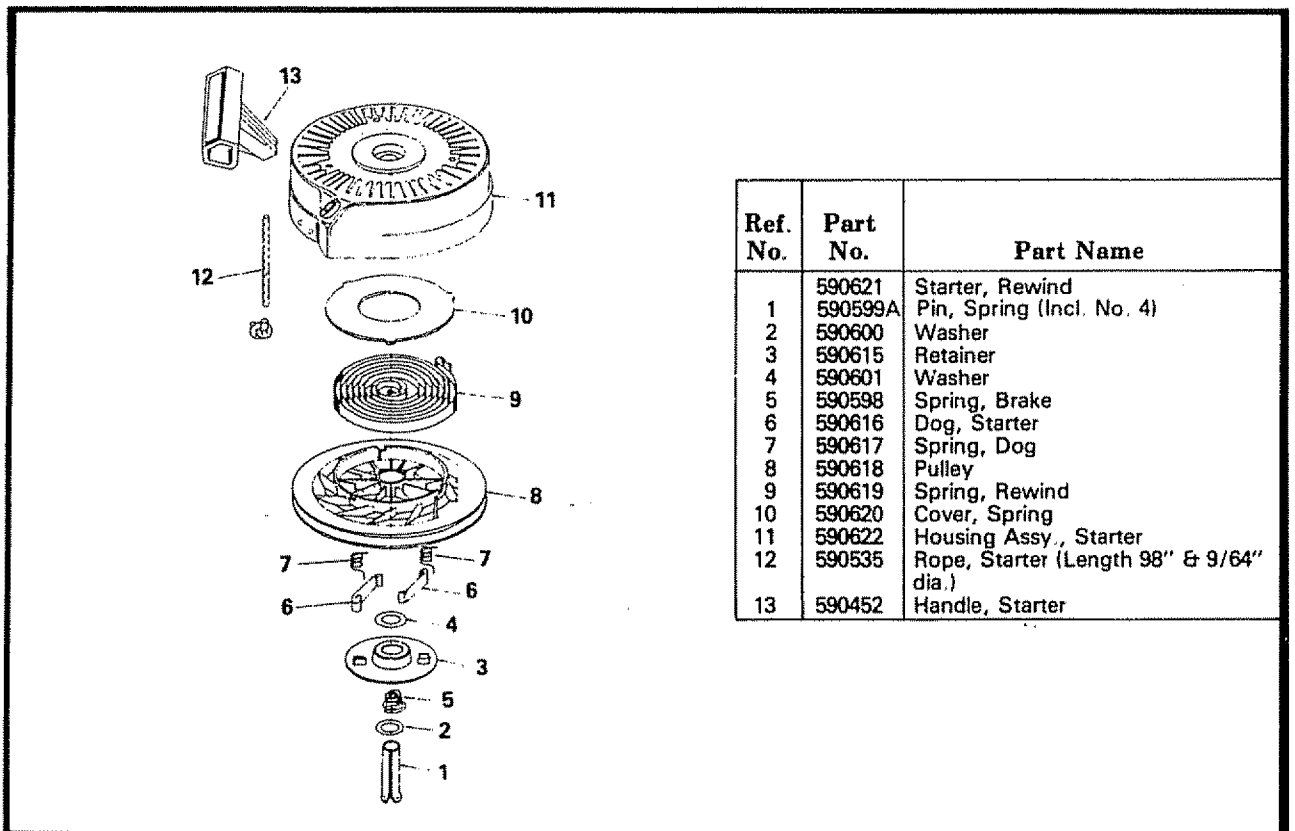

Ref. No.	Part No.	Part Name
	590621	Starter, Rewind
1	590599A	Pin, Spring (Incl. No. 4)
2	590600	Washer
3	590615	Retainer
4	590601	Washer
5	590598	Spring, Brake
6	590616	Dog, Starter
7	590617	Spring, Dog
8	590618	Pulley
9	590619	Spring, Rewind
10	590620	Cover, Spring
11	590622	Housing Assy., Starter
12	590535	Rope, Starter (Length 98" & 9/64" dia.)
13	590452	Handle, Starter

TROUBLE SHOOTING POINTS

PROBLEM	CAUSE	CORRECTION
Does not Start	<ol style="list-style-type: none"> 1. Dirty Air Filter. 2. Out of gasoline. 3. Stale Gasoline. 4. Spark plug wire is disconnected from the spark plug. 5. Bad spark plug. 6. Water in gasoline. 7. Loose blade or broken blade flange. 8. Operator Presence Control Bar in released position. 9. Operator Presence Control Bar defective. 	<ol style="list-style-type: none"> 1. Replace Air Filter 2. Fill gasoline tank. 3. Drain gas tank and refill with fresh gasoline. 4. Connect wire to spark plug 5. Replace spark plug 6. Drain tank and refill with fresh, clean gasoline 7. Tighten blade nut and/or replace blade flange 8. Depress Operator Presence Control 9. Replace Operator Presence Control Bar.
Loss of Power	<ol style="list-style-type: none"> 1. Rear of mower housing/blade Dragging in heavy grass. 2. Cutting too much grass. 3. Dirty air filter 4. Build-up of grass, leaves, and trash under mower housing. 5. Walking speed too fast. 6. Too much oil in engine. 	<ol style="list-style-type: none"> 1. Raise rear of mower housing one (1) setting higher than front. 2. Set in "Higher Cut" position. 3. Clean or replace air filter 4. Disconnect spark plug wire and clean underside of mower housing 5. Cut at slower walking speed 6. Check engine oil level.
Poor cut-Uneven	<ol style="list-style-type: none"> 1. Worn, bent or loose blade. 2. Wheel heights uneven. 3. Low engine speed. 4. Build-up of grass, leaves and trash under mower housing 	<ol style="list-style-type: none"> 1. Replace blade Tighten blade nut. 2. Set all wheels at same height. 3. Set engine speed selector on "HIGH" or "FAST" 4. Disconnect spark plug wire & clean underside of mower housing
Too much Vibration	<ol style="list-style-type: none"> 1. Worn or bent blade. 2. Loose blade. 3. Bent engine crankshaft. 	<ol style="list-style-type: none"> 1. Replace blade 2. Tighten blade nut 3. Contact Sears Service Department
Starter Rope Hard to Pull	<ol style="list-style-type: none"> 1. Flywheel brake is on when Operator Presence Control Bar is released. 2. Bent engine crankshaft. 3. Blade flange sheared 4. Blade dragging in grass. 	<ol style="list-style-type: none"> 1. Depress Operator Presence Control Bar to upper handle before pulling on starter rope. 2. Contact Sears Service Department 3. Replace blade flange. 4. Get over low grass and/or hard surface to start engine.
Catcher Not Filling Completely	<ol style="list-style-type: none"> 1. Cutting height too low. 2. Lift on blade worn off 3. Catcher bag dirty, poor air venting 4. Low engine speed. 	<ol style="list-style-type: none"> 1. Raise cutting height. 2. Replace blade 3. Clean/replace catcher bag (If optional grass catcher is being used) 4. Set engine speed selector on "HIGH" or "FAST"
HARD TO PUSH	<ol style="list-style-type: none"> 1. High Grass or cutting height too low 2. Rear of mower housing/blade dragging in heavy grass 3. Grass catcher too full. 4. Handle height position not right for you. 	<ol style="list-style-type: none"> 1. Raise cutting height. 2. Raise rear of mower housing one (1) setting higher than front. 3. Empty grass catcher. 4. Adjust handle height to suit.

SEARS **OWNER'S** **MANUAL**

MODEL NO.
917.380221

HOW TO ORDER **REPAIR PARTS**

CRAFTSMAN[®]

3.5 RESERVE POWER **20'' SIDE DISCHARGE** **ROTARY LAWN MOWER**

Each Lawn Mower has its own model number. Each engine has its own model number.

The model number for your lawn mower will be found on a decal attached to the rear of the mower housing.

The model number for the engine will be found on the Blower Housing of the engine adjacent to the spark plug.

All parts listed herein may be ordered through Sears, Roebuck and Co. Service Centers and most Retail Stores.

WHEN ORDERING REPAIR PARTS, ALWAYS GIVE THE FOLLOWING INFORMATION:

- * **PRODUCT - "ROTARY LAWN MOWER"**
- * **MODEL NUMBER - 917.380221**
- * **ENGINE MODEL NO. - 143.394032**
- * **PART NUMBER**
- * **PART DESCRIPTION**

Your Sears merchandise has added value when you consider that Sears has service units nationwide staffed with Sears trained technicians...professional technicians specifically trained on Sears products, having the parts, tools and the equipment to insure that we meet our pledge to you, we service what we sell.

SEARS, ROEBUCK AND CO., Chicago, IL. 60684 U.S.A.