

IMPORTANT MANUAL

Do Not Throw Away

SEARS

operator's
manual

MODEL NO.

358.797930-22.2cc

358.797970-22.2cc

358.796921-28.0cc

358.796982-28.0cc

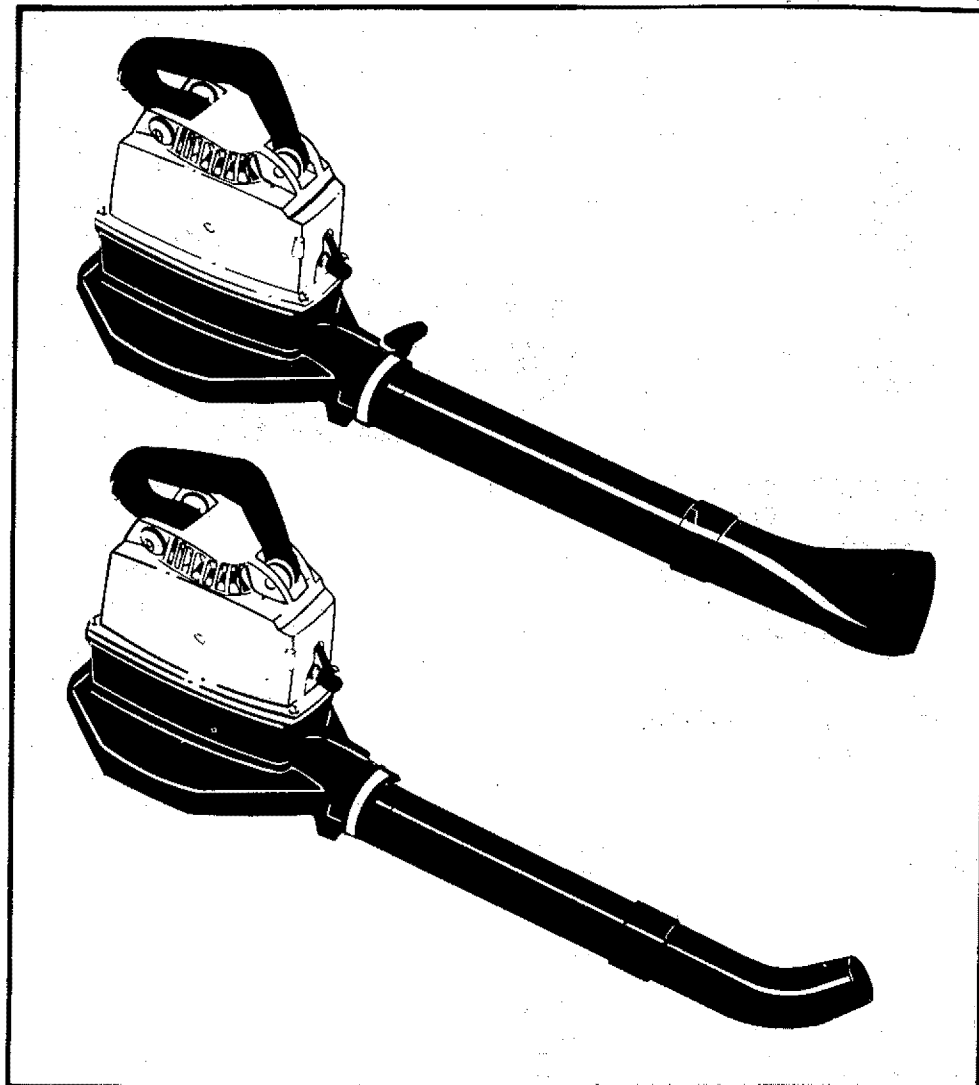

Always Wear Eye Protection During Operation

SEARS / CRAFTSMAN®

GAS POWER BLOWER

2 Cycle Engine

Fuel Mix 16:1

- Assembly
- Maintenance
- Operation
- Repair Parts

⚠ WARNING:

Read the Operator's Manual and follow all Warnings and Safety Instructions. Failure to do so can result in serious injury.

Sold by Sears, Roebuck and Co., Chicago, Ill. 60684 U.S.A.

ONE YEAR LIMITED WARRANTY ON CRAFTSMAN POWER BLOWER

For One Year from date of purchase, when this Power Blower is maintained, lubricated, and tuned up according to the operating and maintenance instructions in the operator's manual, Sears will repair free of charge any defect in material or workmanship.

This warranty excludes blower pipes, spark plug, and air cleaner; which are expendable parts and become worn during normal use.

If this Power Blower is used for commercial or rental purposes, this warranty applies for only 90 days from the date of purchase.

WARRANTY SERVICE IS AVAILABLE BY CONTACTING THE NEAREST SEARS SERVICE CENTER/DEPARTMENT IN THE UNITED STATES. This warranty applies only while this product is in use in the United States.

This warranty gives you specific legal rights, and you may also have other rights which vary from state to state.

SEARS, ROEBUCK AND CO./DEPT. 698/731A/SEARS TOWER CHICAGO, IL 60684

TABLE OF CONTENTS

<p>WARNINGS AND SAFETY INSTRUCTIONS 3</p> <p>KNOW YOUR BLOWER 4</p> <p>ASSEMBLY 4</p> <p>ENGINE INFORMATION 5</p> <p style="padding-left: 20px;">A. Fueling Your Engine 5</p> <p style="padding-left: 20px;">B. Pre-Operation Checks 6</p> <p style="padding-left: 20px;">C. Starting Instructions 6</p> <p style="padding-left: 20px;">D. Carburetor Adjustments 7</p> <p>USING YOUR TOOL AS A BLOWER 9</p> <p style="padding-left: 20px;">A. Operating Instructions 9</p>	<p style="padding-left: 20px;">B. Operating Tips 9</p> <p>GENERAL MAINTENANCE 10</p> <p style="padding-left: 20px;">A. Air Filter 10</p> <p style="padding-left: 20px;">B. Fuel Tank 10</p> <p style="padding-left: 20px;">C. Starter Rope 10</p> <p style="padding-left: 20px;">D. Storage 11</p> <p style="padding-left: 20px;">E. Trouble Shooting Chart 12</p> <p>ACCESSORIES 12</p> <p>REPAIR PARTS LIST 13-17</p> <p>QUICK REFERENCE PAGE 19</p>
--	--

SPECIFICATIONS

ENGINE TYPE:	2 Cycle Air Cooled	MUFFLER:	Lo Tone
DISPLACEMENT:	22.2cc- Model 358.797930 Model 358.797970 28.0cc- Model 358.796982 Model 358.796921	VELOCITY:	135 mph- Model 358.797930 Model 358.797970 150 mph- Model 358.796982 Model 358.796921
ENGINE RPM:	Operating — 7500-8200- Model 358.797930 Model 358.797970 Operating — 7300-7900 Model 358.796982 Model 358.796921 Idle—3800-4600-All Models	AIR VOLUME:	320cu.ft./min.- Model 358.797930 Model 358.797970 340 cu.ft./min.- Model 358.796982 Model 358.796921
IGNITION:	Solid State	SPARK PLUG:	CJ-8 (Cat. No. 71-36403)
CARBURETOR:	All Position-Diaphragm	SPARK PLUG GAP:	.025"
ON/OFF SWITCH:	Positive Toggle Switch	MODULE AIR GAP:	.010"-.014"
STARTER:	Auto Rewind	LUBRICATION	Gasoline/Oil Mixture- See "Fueling Your Engine"
FUEL TANK:	13.5 fl. oz.		

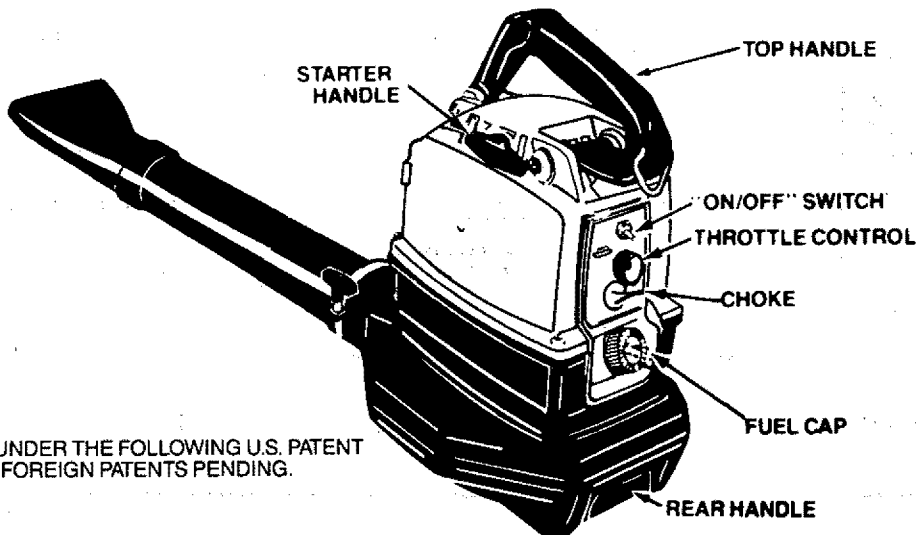

MANUFACTURED UNDER THE FOLLOWING U.S. PATENT 4,674,146; U.S. AND FOREIGN PATENTS PENDING.

WARNINGS AND SAFETY INSTRUCTIONS

Failure to follow all Safety Rules and Precautions can result in serious injury.

A. KNOW YOUR UNIT

1. Read your Operator's Manual carefully until you completely understand and can follow all warnings and safety instructions before operating the tool.
2. Restrict your tool to users who understand and follow all warnings and safety instructions in this manual.

B. PLAN AHEAD

1.  Always wear eye protection to prevent rocks or debris from being blown or ricocheting into eyes and face which can result in blindness and/or other serious injury.
2. Always wear a respirator or facemask when working with the blower in dusty environments.
3. Dress safely in long pants. Do not wear loose clothing, jewelry, short pants or sandals; or go barefoot.
4. Do not operate the tool when you are tired, ill, or upset; or if you are under the influence of alcohol, drugs, or medication.
5. Keep children, bystanders and animals away from the work area, a minimum of 30 feet when starting or operating the engine.
6. Inspect the area before starting the tool. Remove all debris and hard or sharp objects such as rocks, glass, wire, etc. that can ricochet, be thrown or otherwise cause injury or damage during operation.

C. HANDLE FUEL WITH CAUTION

1. Eliminate all sources of sparks or flame (including smoking, open flames, or work that can cause sparks) in the areas where fuel is mixed, poured, or stored.
2. Mix and pour fuel in an outdoor area; store fuel in a cool, dry, well-ventilated place; and use an approved, marked container for all fuel purposes.
3. Do not smoke while handling fuel or while operating the unit.
4. Do not fill the fuel tank while the engine is running.
5. Wipe up all spills before starting the engine.
6. Move at least 10 feet away from fuel and fueling site before starting the engine.

D. OPERATE YOUR UNIT SAFELY

1. Stop the engine before opening the vacuum inlet door. The engine must be stopped and the impeller blades no longer turning to avoid serious injury from the rotating blades.
2. Inspect the entire tool before each use for worn, loose, missing or damaged parts. Do not use until the tool is in proper working order.
3. Keep the outside surfaces free of oil and fuel.
4. Never start or run the engine inside a closed room or building. Breathing exhaust fumes can kill.

5. Do not set the tool on any surface except a clean, hard area to start the engine or while the engine is running. Debris such as gravel, sand, dust, grass, etc. could be picked up by the air intake and thrown out through the discharge opening, damaging the tool, property or causing serious injury to bystanders or the operator.
6. Avoid dangerous environments. Do not use in unventilated areas or where explosive vapors or carbon monoxide build up could be present.
7. Do not overreach or use from unstable surfaces such as ladders, trees, steep slopes, rooftops, etc. Keep firm footing and balance at all times.
8. Never place objects inside the blower tubes; always direct the blowing debris away from people, animals, glass, and solid objects such as trees, automobiles, walls, etc. The force of air can cause rocks, dirt, or sticks to be thrown or to ricochet which can hurt people or animals, break glass or cause other damage.
9. Never place any object in the air intake opening as this could restrict proper air flow and cause damage to the tool.
10. Never run the engine without the proper equipment attached. When used as a blower, always install a blower tube.
11. Never use for spreading or misting chemicals, fertilizers or any other substances which may contain toxic material.
12. Use only for jobs explained in this manual.

E. MAINTAIN YOUR UNIT PROPERLY

1. Have all maintenance other than the recommended procedures described in the Operator's Manual performed by your Sears Service Center.
2. Disconnect spark plug before performing maintenance except for carburetor adjustment.
3. Use only genuine replacement parts as recommended by Sears to avoid creating a hazard and/or voiding your warranty.
4. Check air intake openings and blower tubes frequently, always with the engine stopped and spark plug disconnected. Keep vents and tubes free of debris which can accumulate and restrict proper air flow.
5. Empty the fuel tank before storing the tool. Use up fuel left in the carburetor by starting the engine and letting the engine run until it stops.
6. Do not use any accessory or attachment other than those recommended by Sears for use with your tool.
7. Do not store the tool or fuel in a closed area where fuel vapors can reach sparks or an open flame from hot water heaters, electric motors or switches, furnaces, etc.
8. Store in a dry area out of the reach of children.

SPECIAL NOTICE

For users on U.S. Forest Land and in the states of California, Maine, Oregon and Washington. All U.S. Forest Land and the states of California (Public Resources Codes 4442 and 4443), Oregon and Washington require, by law, that certain internal combustion engines operated on forest, brush and/or grass-covered areas be equipped with a spark arrestor, maintained in effective working order, or the engine be constructed, equipped and maintained for the prevention of fire. Check with your state or local authorities for regulations pertaining to these requirements. Failure to follow these requirements are a violation of the law. This unit is not factory-equipped with a spark arrestor. If these items are required in your area, ask your dealer to install Part #530-069207.

KNOW YOUR BLOWER

A. INTRODUCTION

Your blower is a high performance product designed for tough jobs.

Special Features Include:

- Top handle for one-handed operation
- Direct Drive
- Vibration-Dampened Handle
- Weight - 11.5 lbs.
- Convenient Upright Storage
- Rear Assist Handle for versatile operation
- Available Gutter Attachment Kit #71-79992 (optional accessory)
- For Model 358.796982 and 358.796921, Vacuum capability is included (See accompanying manual).

B. UNPACKING INSTRUCTIONS

1. Remove contents from the carton if you have not done so.
2. Check parts against the Carton Contents List.
3. Examine parts for damage. Do not use damaged parts.
4. Notify your Sears Store immediately if a part is missing or damaged.

NOTE: It is normal to hear the fuel filter rattle in an empty fuel tank.

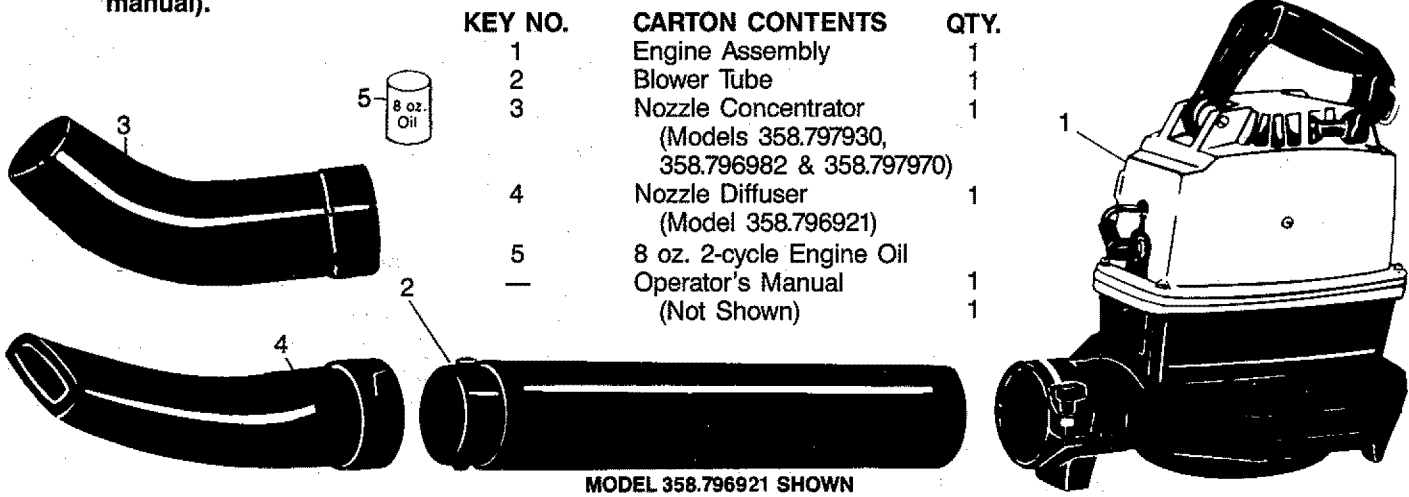

ASSEMBLY

A. PREPARATION

Your Operator's Manual has been developed to help you assemble the unit and to understand its safe operation. It is important that you read your manual completely to become familiar with the tool *before* you begin assembly.

1. READ YOUR OPERATOR'S MANUAL(S).
2. No tools are required to assemble Model No. 358.796921. A flathead screwdriver is required for Model No. 358.797930, 358.797970, and 358.796982.

B. BLOWER ASSEMBLY

1. Locate the two projections on the side of the Blower Tube. Figure 1.
2. Align the grooves on the Nozzle with the projections and push the Nozzle onto the Blower Tube.
3. Turn the Nozzle clockwise until the parts snap in place and are firmly tightened.
4. Slide the blower tube and nozzle assembly into the engine housing until it bottoms out (approximately 2-1/2"). Figure 1.

5. Align the blower tube assembly so the nozzle is pointing as shown in Figure 1.
6. Secure the blower tube assembly by tightening the T-handle or screw until hand-tight. Figure 1.

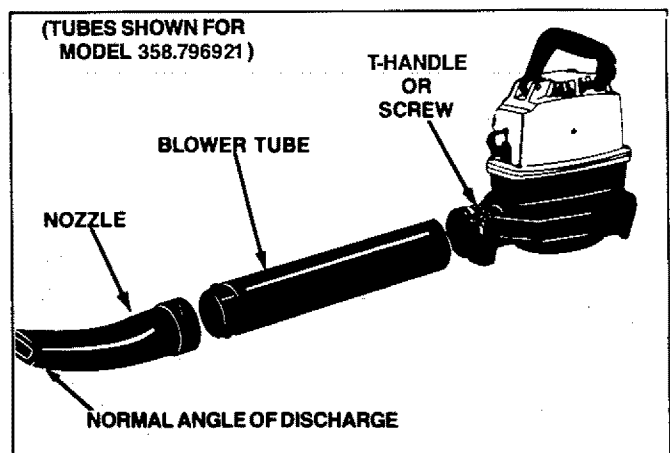

Figure 1

ENGINE INFORMATION

A. FUELING YOUR ENGINE

1. FUEL SAFETY

- a. Use only recommended fuel mixtures.
- b. Mix and pour fuel outdoors and where there are no sparks or flames.
- c. Use a container approved for fuel.
- d. Do not smoke or allow smoking near fuel or the tool or while using the tool.
- e. Wipe up all fuel spills before starting engine.
- f. Move at least 10 feet away from fueling site before starting engine.
- g. Stop engine before removing fuel cap.
- h. Empty the fuel tank before storing the tool. Use up fuel left in the carburetor by starting the engine and letting the engine run until it stops.
- i. Store tool and fuel in an area where fuel vapors cannot reach sparks or open flames from water heaters, electric motors or switches, furnaces, etc.

2. FUEL MIXTURE

- Your tool is powered by a two-cycle engine which requires a fuel mixture of regular unleaded gasoline and a high quality engine oil specially made for 2-cycle, air cooled engines. The internal design of the 2-cycle engine requires lubrication of moving parts. Lubrication is provided when the recommended mixture of gasoline and oil is used.
- Gasoline must be clean and fresh. After a short period of time, gasoline will chemically break down and form compounds that cause hard starting and damage in 2-cycle engines.
- The correct measure of gasoline to oil is very important. Too much oil in the mixture will foul the spark plug.

CAUTION: Too little oil will cause the engine to overheat and seize.

- Always mix the fuel thoroughly in a container since gasoline and oil do not readily combine. *Do not mix gasoline and oil directly in the fuel tank.*

3. USE THE FOLLOWING ONLY:

(16 parts gasoline to 1 part oil)

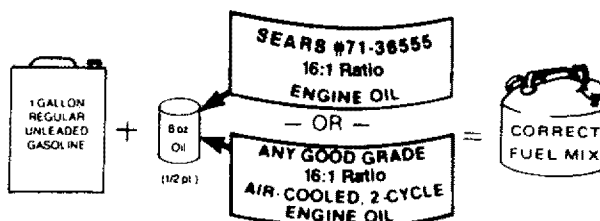

4. DO NOT USE:

- BIA OIL (Boating Institute of America) —
— Does not have proper additives for air-cooled, 2-cycle engines and can cause engine damage.
- AUTOMOTIVE OIL —
— Does not have proper additives for 2-cycle engines and can cause damage.

5. HOW TO MIX FUEL AND FILL TANK

- a. Pour 1/2 of the regular unleaded gasoline to be used into an approved, marked container. *Do not mix gasoline and oil directly in the fuel tank.*
- b. Add entire measure of engine oil.
- c. Cover container tightly and shake for one minute.
- d. Slowly remove fuel container cover.
- e. Add remainder of gasoline.
- f. Cover container tightly and shake again.
- g. Slowly remove fuel container cover.
- h. Slowly remove the fuel cap. Refer to "Specifications" for fuel cap location.
- i. Fill the tank using a spout or funnel.
- j. Reinstall the fuel cap securely.

B. PRE-OPERATION CHECKS

Before operating your unit, always:

1. ✓ **CHECK OVER WARNINGS AND SAFETY INSTRUCTIONS** in this Operator's Manual. Make certain you completely understand and follow each one.
2. ✓ **CHECK THE AIR FILTER.**
Clean the filter if dirty *before* operating the tool. For location, see the "Air Filter" section.

3. CHECK THE UNIT FOR LOOSE BOLTS, NUTS, OR FITTINGS.

Tighten, repair or replace parts as necessary. You will need a Phillips screwdriver and a slotted screwdriver. Use only genuine replacement parts as recommended by Sears.

4. CHECK THE FUEL TANK.

Fill with a clean, fresh fuel mixture according to instructions in fuel mixture section, this page.

C. STARTING INSTRUCTIONS (For location of controls, refer to "Specifications.")

1. Before Starting the Engine:

- a. Fuel the engine. Move at least 10 feet away from the fueling site.
- b. Hold the tool in the starting position as shown in Figure 2. Make sure the blower end is directed away from people, animals, glass and solid objects.

2. For a Cold Engine:

- a. Move Ignition Switch to the "On" position. Figure 3.
- b. Move Throttle Control clockwise  to the "Fast" position. Figure 4.
- c. Move Choke to "ON" position. Figure 5.
- d. Pull Starter Rope sharply until engine attempts to run, but no more than 8 pulls on full choke. **The engine "attempts to run" may be hard to hear. The operator must listen carefully.** After 8 pulls, proceed to step "e" even if the engine has not attempted to run.
- e. Move Choke to "half" position. Figure 5.
- f. Pull Starter Rope sharply until engine runs, but no more than 5 pulls.

NOTE: If engine has not started after 5 pulls, repeat steps "a" through "f."

- g. Allow engine to run for 5 seconds, then move Choke to "Off" position. Figure 5.

NOTE: If engine dies with Choke at "Off" position, repeat steps "e" through "g." If engine does not operate properly, refer to "Carburetor Adjustments."

- h. To stop engine, move Ignition Switch to "Off" position. Figure 3.

▲ WARNING
Hold the tool for starting as shown in Figure 2. Do not set the tool on any surface except a clean, hard area to start the engine or while the engine is running. Debris such as gravel, sand, dust, grass, etc. could be picked up by the air intake and thrown out through the discharge opening, damaging the tool or property or causing serious injury to bystanders or the operator.

3. For a Warm Engine:

- a. Move Ignition Switch to the "On" position. Figure 3.
- b. Move Throttle Control clockwise  to the "Fast" position. Figure 4.
- c. Move Choke to "Half" position. Figure 5.
- d. Pull Starter Rope sharply until engine runs, but no more than 5 pulls.
- e. Move Choke to "Off" position. Figure 5.

NOTE: If engine does not run after 5 pulls, it is probably flooded. Wait a few minutes and repeat procedure with Choke at "Off" position.

- f. To stop engine, move Ignition Switch to "Off" position. Figure 3.

4. For A Warm Engine (After Running Out of Fuel;)

- a. Refuel engine. Move at least 10 feet away from the fueling site.
- b. Move Ignition Switch to the "On" position. Figure 3.
- c. Move Throttle Control clockwise  to the "Fast" position. Figure 4.
- d. Move Choke to "On" position. Figure 5.
- e. Pull Starter Rope sharply until engine attempts to run, but no more than 5 pulls.
- f. Move Choke to "Off" position. Figure 5.
- g. Pull Starter Rope until engine runs, but no more than 5 pulls.

NOTE: If engine has not started, pull Starter Rope 5 more pulls. If engine still does not run, it is probably flooded. Wait a few minutes and repeat procedure with Choke at "Off" position.

- h. To stop engine, move Ignition Switch to "Off" position. Figure 3.

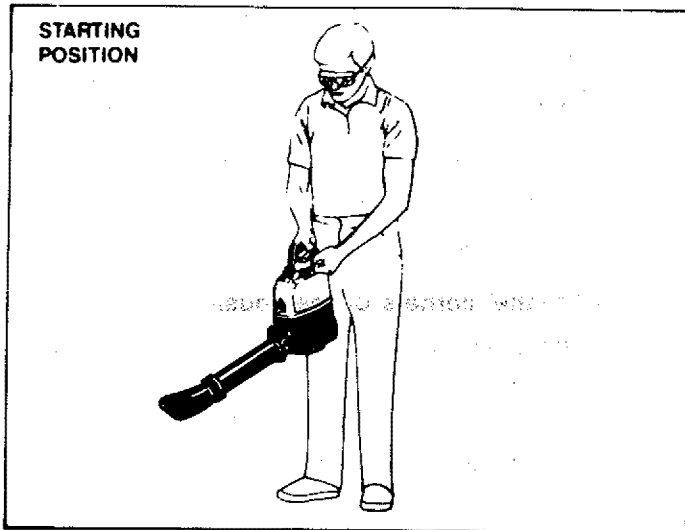

Figure 2

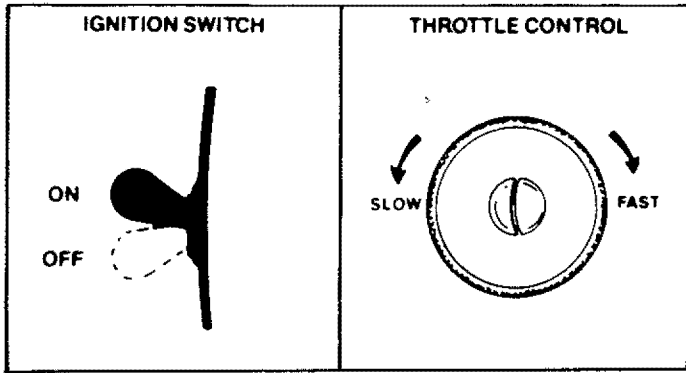

Figure 3

Figure 4

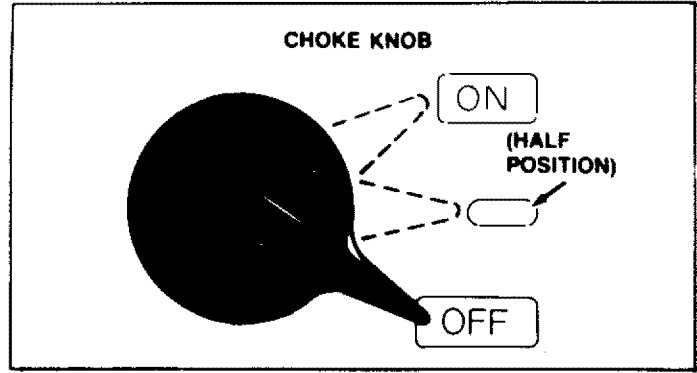

Figure 5

D. CARBURETOR ADJUSTMENTS

- Poor engine performance can be a result of other causes such as dirty air filter, carbon build-up on muffler outlets, etc. See "Trouble Shooting Chart" before proceeding with carburetor adjustments.
- The carburetor has been carefully adjusted at the factory. Due to changes in altitude and operating conditions, your carburetor may require adjusting. To make the adjustment follow the procedure below very carefully.

1. PREPARATION

- Use fresh fuel mix. See "Fueling Your Engine."
- Remove air filter. See Figure 8.
- Turn **Mixture Screw** (Figure 6) clockwise → until fully closed, but **do not overtighten**. Figure 6. Unscrew mixture screw one full turn counterclockwise ←.
- Turn **Idle Speed Screw** (Figure 6) clockwise → until it stops. **do not overtighten**. Open screw three full turns counterclockwise ←.

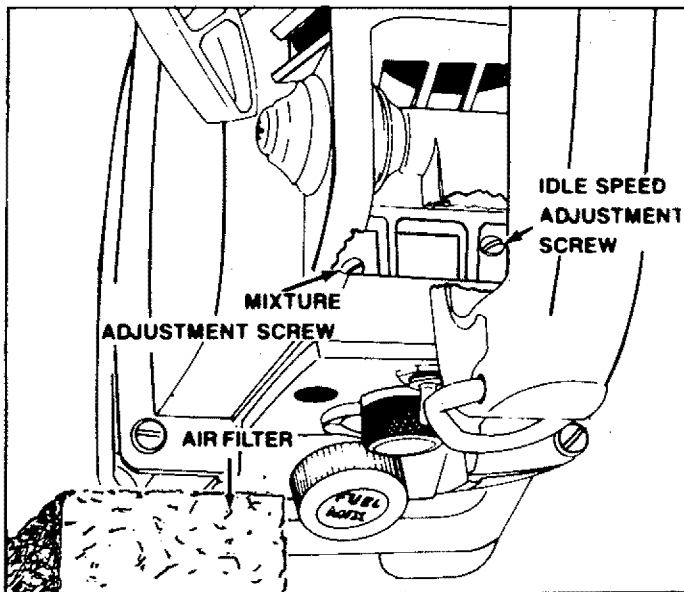

Figure 6

2. IDLE SPEED ADJUSTMENT

- Start the engine and turn throttle control to halfway between "Fast" and "Slow".
- Operate the unit for 3 minutes to warm up engine.
- Turn throttle control counterclockwise ← to slow setting.
- Adjust the **Idle Speed Screw** until the engine idles as slow as possible without the engine stalling.
 - Turn screw clockwise → if the engine stalls.
 - Turn screw counterclockwise ← to slow engine down.

CAUTION: The mixture setting is a highly critical adjustment. If set incorrectly, permanent damage will occur to the engine. Do not operate engine at fast throttle for prolonged periods while making the mixture adjustment. The mixture screw should be in the range of 3/4 to 1-1/4 turns open.

3. MIXTURE ADJUSTMENT:

- Adjust throttle knob to "Fast" position.
- Turn the **Mixture Screw** slowly clockwise → until the engine speed is reduced. Note position.
- Turn the screw slowly counterclockwise ←. Stop when the engine just begins to run roughly.
- Turn the screw slowly the minimum amount clockwise → until the engine runs smoothly.
- Reinstall Air Filter.

CAUTION: The air filter must be fitted into the corners of the housing and under the center tab to avoid engine damage.

NOTES

USING YOUR TOOL AS A BLOWER

A. OPERATING INSTRUCTIONS

1. **Read your Operator's Manual.** Make certain you completely understand and can follow all warnings and safety instructions, before operating the tool.
2. **Always wear eye protection to prevent rocks or debris from being blown or ricocheting into eyes and face which can result in blindness and/or other serious injury.**
3. **Always wear a respirator or facemask when working in dusty environments.**
4. **Dress safely in long pants.** Do not wear loose clothing, jewelry, short pants or sandals; or go barefoot.
5. **Check the tool before operation.** Look for worn, loose, missing or damaged parts. Do not use until the tool is in proper working order.
6. **Inspect the area before starting tool.** Remove all debris and hard objects such as rocks, glass, wire, etc. that can ricochet, be blown or otherwise cause damage during operation.

⚠ WARNING

Hold the tool for starting as shown in Figure 2. Do not set the tool on any surface except a clean, hard area to start the engine or while the engine is running. Debris such as gravel, sand, dust, grass, etc. could be picked up by the air intake and thrown out through the discharge opening, damaging the tool or property or causing serious injury to bystanders or the operator.

7. **Keep children, bystanders, and animals safely away.** Before starting the engine and during operation, make certain people and animals are away from the work area - a minimum of 30 feet.
8. **Check air intake opening and blower tubes frequently, always with the engine stopped and spark plug disconnected.** Keep vents and discharge tubes free of debris which can accumulate and restrict proper air flow.

9. **Use the correct operating position (Figure 7).** Do not overreach or use from unstable surfaces such as ladders, trees, steep slopes, roof tops, etc. Keep firm footing and balance at all times.
10. **Never place objects inside the blower tubes; always direct the blowing debris away from people, animals, glass, and solid objects such as trees, automobiles, walls, etc.** The force of air can cause rocks, dirt, or sticks to be thrown or to ricochet which may hurt people or animals, break glass, or cause other damage.



Figure 7

B. OPERATING TIPS

1. **Always work going away from solid objects such as walls, large stones, automobiles and fences.**
2. **Clean spaces with corners by starting in corners and moving outward to straight areas** to prevent an accumulation of debris which could fly into face.
3. **Be careful when working near plants.** The force of the air could damage tender plants.
4. **Direct air flow by adjusting the nozzle position down or to the side.**
5. **Vary or reduce the air flow by setting the throttle knob at any position from "Fast" to "Slow."**
6. **Use the assist handle located on the bottom of the unit below the control panel when working above the waist or when a two-handed grip is desired.** Refer to "Specifications" drawing, and Figure 7.

⚠ WARNING

Always wear eye protection to prevent rocks or debris from being blown or ricocheting into the eyes and face which can result in blindness or serious injury.

7. Uses For Your Blower:

- a. Sweeping debris or grass clippings from driveways, sidewalks, patios, park, parking lots, barns, stadiums, etc.
- b. Gathering grass clippings, straw or leaves into piles.
- c. Fast drying wet, outdoor areas such as a patio.
- d. Removing debris from corners, around joints and between bricks.
- e. Blowing light snow from driveways, sidewalks or patios.

GENERAL MAINTENANCE

A. AIR FILTER

A dirty air filter decreases engine performance and increases fuel consumption.

Clean the Air Filter:

- Frequently,
- Always clean after 5 tanks of fuel or 5 hours of operation, whichever is less.

Follow these steps:

1. Remove the air filter (located above the control panel; see Figure 8).
2. Wash in soap and water.

CAUTION: Do not clean filter in gasoline or other flammable solvent to avoid creating a fire hazard.

3. Squeeze filter dry.
4. Add a small amount of oil to coat the filter.

NOTE: Avoid soaking the filter with oil.

5. Squeeze out excess oil.
6. Replace the air filter.

CAUTION: The air filter must be fitted into the corners of the housing and under the center tab to avoid engine damage.

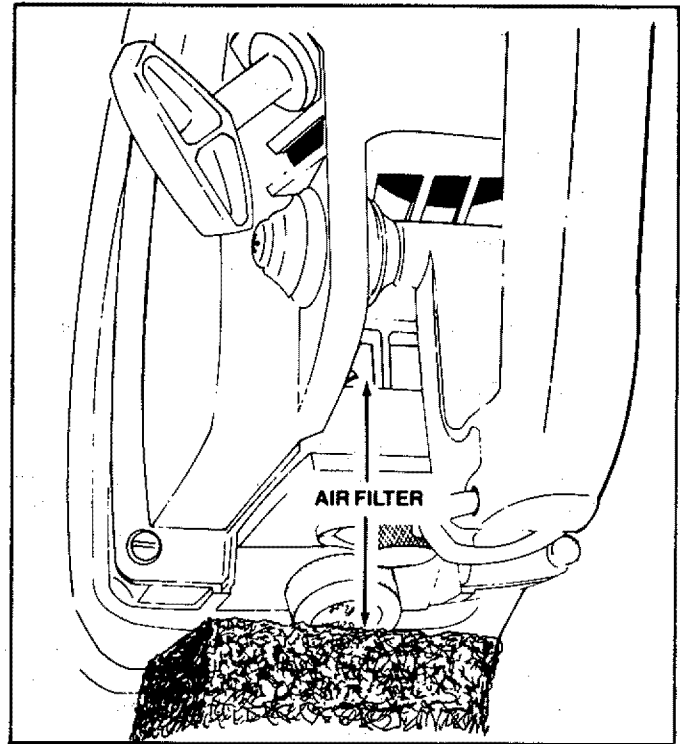

Figure 8

B. FUEL TANK

Never use gasoline that is more than 2 months old in a fuel mixture. Gasoline begins to break down after a short period of time and will form compounds that cause hard starting and damage in 2-cycle engines.

1. Inspect the unit for fuel leaks each time it is used. Repair or replace parts as necessary.
2. Using a fuel mix or gasoline over 2 months old will cause the engine to be difficult or impossible to start.
3. Drain all fuel from the unit or allow unit to run out of fuel before storing.

C. STARTER ROPE

- Repair the starter rope if the rope breaks.

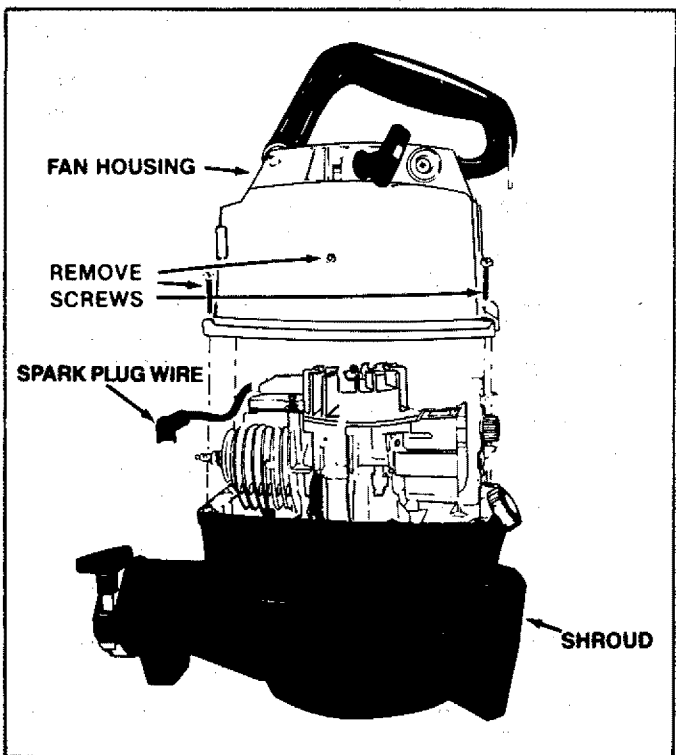

Figure 9

WARNING



Always wear eye protection when servicing the starter rope. The recoil spring, located beneath the pulley, is under tension. If the spring pops out, serious injury can result.

● **To repair or replace:**

1. Disconnect the spark plug wire and remove the 6 screws from the fan housing. Figure 9.
2. Separate the fan housing completely from the shroud.

⚠ WARNING

Avoid contact with the grounding tab wire in the fan housing (Figure 10) when removing or reinstalling the starter rope pulley. Contact with the grounding tab wire can result in serious injury.

3. If the starter rope is not broken, release the spring tension by pulling about 10 inches of rope from the pulley and catching the rope in the notch as shown. Figure 10. With the rope in the notch, let the pulley unwind slowly until it stops turning. If the rope is broken, remove the broken piece.

NOTE: The tension on the starter spring will be released if the rope is broken.

4. Remove screw and pulley very carefully. Figure 10: **The recoil spring which lies beneath the pulley must stay in the housing, flat against the bottom. If the spring is disturbed, it will require considerable time and effort to reinstall. Twist the pulley gently counter clockwise ← as you pull up to release the spring.**
5. Move away from the fuel tank and melt the end of the rope to go into the pulley.
6. Allow the melted end to drip once; then while the rope is still hot, pull the melted end through a clean rag to obtain a smooth, pointed end.
7. Insert one end of the rope through the handle and secure with a knot. Leave 3/16" pigtail behind knot. Figure 12 (inset).
8. Insert rope through the rope exit hole into the inside of the fan housing.
9. Guide rope inside the pulley, then through topside pulley hole by pushing the rope from the underside hole with a small round object such as a Phillips screwdriver. See Inset, Figure 11.
10. Wrap rope counterclockwise ← around pulley ratchet and tuck loose end back under rope leaving a 1/4 to 3/8 inch tail next to the ridge. Figure 11. Pull tightly.
11. Wind all but about 12 inches of the rope clockwise → around the pulley.
12. Replace pulley in the housing. Be sure the pulley is all the way down and the spring is secured.
13. Replace and tighten pulley screw. Figure 10.
14. Hold the 12 inch slack in the rope and catch rope in pulley notch. Figure 12.

15. Hold the rope taut and make 3 complete turns of the pulley clockwise → to place tension on the pulley. Hold the pulley to retain tension.
16. Align pulley notch with rope exit hole, pull starter handle to the full extent of the rope and allow the rope to slowly wind around the pulley.
17. Reinstall the fan housing.

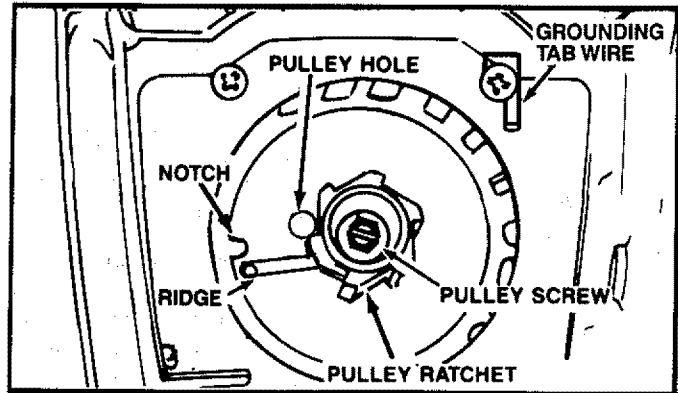

Figure 10

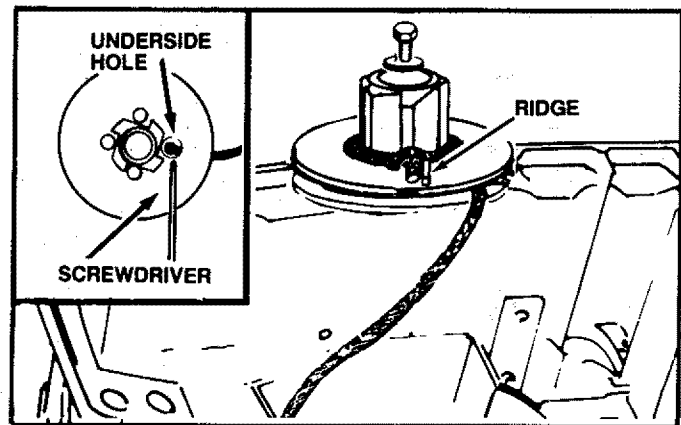

Figure 11

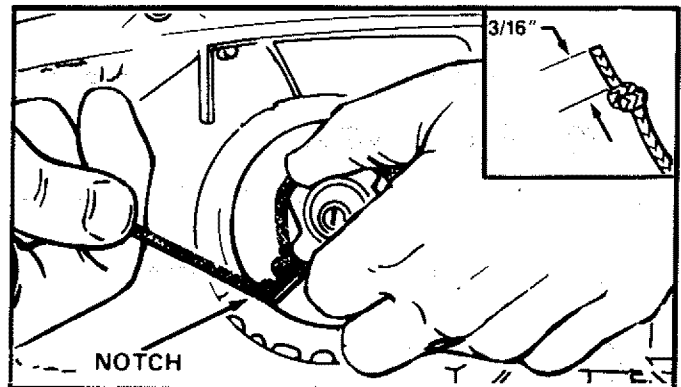

Figure 12

D. STORAGE

1. **Clean the tool before storing.** Pay particular attention to the air intake area, keeping it free of debris. Use a mild detergent and sponge to clean the plastic surfaces.
2. **Empty the fuel tank before storing the tool. Use up fuel left in the carburetor by starting the engine and letting the engine run until it stops.**
3. **Do not store the tool or fuel in a closed area where fuel vapors can reach sparks or an open flame from hot water heaters, electric motors or switches, furnaces, etc.**
4. **Store in a dry area out of reach of children.**

E. TROUBLE SHOOTING CHART

TROUBLE	CAUSE	REMEDY
Engine will not start	<ol style="list-style-type: none"> 1. Ignition switch off. 2. Fuel tank empty. 3. Spark plug not firing. 4. Fuel not reaching carburetor. 5. Engine flooded. 6. Compression low. 	<ol style="list-style-type: none"> 1. Move switch to "Start". 2. Fill tank with correct fuel mixture. 3. Install new plug. 4. Check for dirty fuel filter; clean. Check for kinked or split fuel line; repair or replace. 5. See Starting Instructions. 6. Contact your Sears Service Center.
Engine will not idle properly	<ol style="list-style-type: none"> 1. Idling speed set too low. 2. Idle speed set too high. 3. Mixture screw requires adjustment. 4. Crankshaft seals worn. 5. Compression low. 	<ol style="list-style-type: none"> 1. Adjust idle speed screw clockwise to increase speed. 2. Adjust idle speed screw counter-clockwise to reduce speed. 3. See Carburetor Adjustments. 4. Contact your Sears Service Center. 5. Contact your Sears Service Center.
Engine will not accelerate, lacks power or dies under a load	<ol style="list-style-type: none"> 1. Carburetor requires adjustment. 2. Air filter dirty. 3. Spark plug fouled. 4. Carbon build-up. 5. Low compression. 	<ol style="list-style-type: none"> 1. See Carburetor Adjustments. 2. Clean or replace air filter. 3. Clean or replace spark plug and regap. 4. Contact your Sears Service Center. 5. Contact your Sears Service Center.
Engine smokes excessively	<ol style="list-style-type: none"> 1. Choke partially on. 2. Mixture screw requires adjustment. 3. Air filter dirty. 4. Fuel mixture incorrect. 	<ol style="list-style-type: none"> 1. Adjust choke. 2. See Carburetor Adjustments. 3. Clean or replace air filter. 4. Empty fuel tank and refill with correct fuel mixture.
Engine runs hot	<ol style="list-style-type: none"> 1. Fuel mixture incorrect. 2. Spark plug incorrect. 3. Carbon build-up. 4. Mixture screw set too low. 	<ol style="list-style-type: none"> 1. See Fueling Your Unit. 2. Replace with correct plug. 3. Contact you Sears Service Center. 4. See Carburetor Adjustments.

ACCESSORIES

The following accessories are available through Sears Retail Stores, Catalog Outlets or Service Centers.

<u>ITEM</u>	<u>STOCK NO.</u>
SAFETY FACE SHIELD	9-18613
SAFETY GOGGLES	9-1859
GUTTER ATTACHMENT KIT	71-79992
2-CYCLE ENGINE OIL	71-36555
SPARK PLUG	71-36403
ENGINE SHOULDER STRAP KIT	71-85783

SEARS GAS BLOWER REPAIR PARTS LIST – MODEL 358.797930, 358.797970,
358.796921 & 358.796982

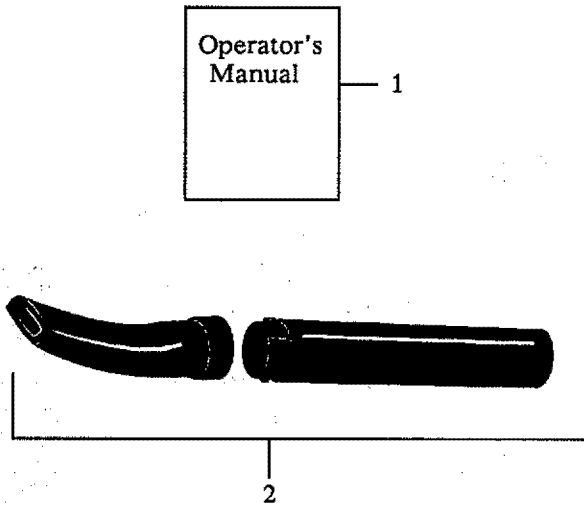

KEY NO.	PART NO.	DESCRIPTION
1	530-067355	Operator's Manual
2	530-069271	Blower Tube Kit

Carburetor Assembly - #530-035196

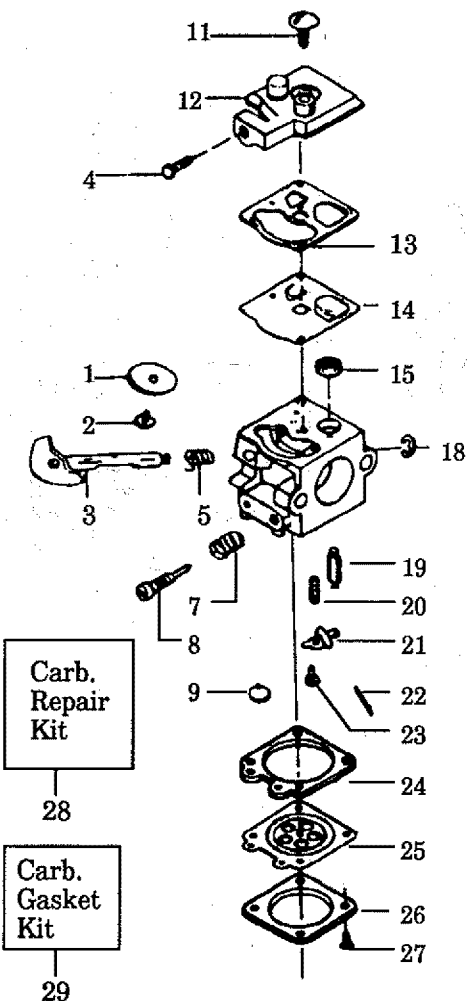

KEY NO.	PART NO.	DESCRIPTION
1	530-035197	Valve Throttle
2	530-035015	Screw
3	530-035132	Throttle Shaft Ass'y.
4	530-035156	Idle Speed Screw
5	530-035138	Throttle Return Spring
7	530-032000	High Speed Mixture Needle Spring
8	530-035198	High Speed Mixture Needle
9	530-035162	* Plug-5/16 Dia. Welch
11	530-035017	Pump Cover Screw
12	530-035191	Fuel Pump Cover
13	530-035164	+ *Fuel Pump Gasket
14	530-035166	+ *Fuel Pump Diaphragm
15	530-035178	Fuel Inlet Screen
18	530-035007	Throttle Retainer Ring
19	530-035106	* Inlet Needle Valve
20	530-035139	* Metering Lever Spring
21	530-035031	* Metering Lever
22	530-035028	* Metering Lever Pin
23	530-035016	* Screw
24	530-035151	+ *Metering Diaphragm Gasket
25	530-035014	+ *Metering Diaphragm
26	530-035003	Metering Diaphragm Cover
27	530-035021	Metering Cover Screw Ass'y.
28	530-035199	Carb. Kwik Repair Kit (+ Indicates Contents)
29	530-035186	Carb. Gasket/Diaphragm Kit (*Indicates Contents)

*Indicates Contents of Carb. Gasket/Diaphragm Kit
+ Indicates Contents of Carb. Repair Kit

SEARS GAS BLOWER REPAIR PARTS LIST - MODEL 358.797930, 358.797970,
358.796921 & 358.796982

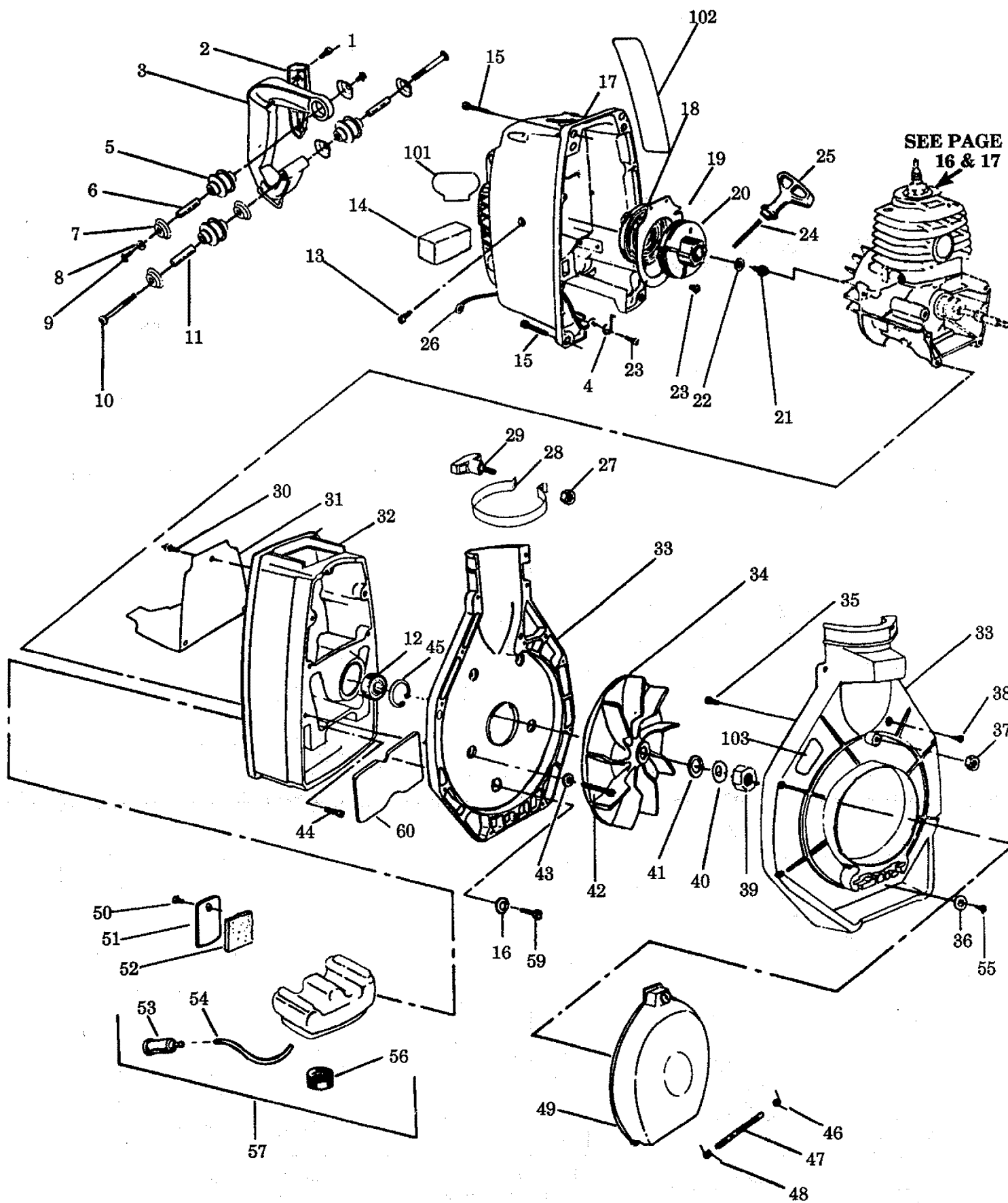

SEARS GAS BLOWER REPAIR PARTS LIST - MODEL 358.797930, 358.797970,
358.796921 & 358.796982

KEY NO.	PART NO.	DESCRIPTION	KEY NO.	PART NO.	DESCRIPTION
1	530-015635	Screw #10-14x11/16	34	530-094215	Impeller
2	530-094212	Handle Cover	35	530-015661	Screw #10-14x3/4
3	530-010827	Handle Ass'y.	36	530-015382	Washer
4	530-027157	Static Ground Wire	37	530-001543	Nut
5	530-026994	Handle Isolator	38	530-015367	Screw
6	530-015343	Isolator Spacer (Front)	39	530-015644	Nut
7	530-026163	Isolator Cup	40	530-015441	Washer
8	530-015629	Washer #8	41	530-015626	Washer
9	530-015628	Screw #8-32x7/16	42	530-015632	Screw #1/4-20x7/8
10	530-015561	Screw #12-11x2	43	530-015682	Washer
11	530-015342	Isolator Spacer (Rear)	44	530-015168	Screw #10-24x5/8
12	530-032091*	Ball Bearing (Shroud)	45	530-001516	Shroud Bearing Retainer
13	530-015700	Screw #10-24x5/8	46	530-015667	Spring-Tension (Right)
14	530-024371	Air Filter	47	530-015647	Pivot Pin
15	530-015687	Screw #10-24x1	48	530-015672	Spring-Tension (Left)
16	530-015685	Washer	49	530-094241	Inlet Door Ass'y.
17	530-069224	Fan Housing (Incl. #16,23 & 26)	50	530-015638	Screw
18	530-042023	Starter Pulley Spring	51	530-015637	Fuel Tank Retainer
19	530-026780	Air Baffle	52	530-026781	Fuel Tank Cushion
20	530-069200	Pulley Replacement Kit	53	530-010897	Fuel Pick-Up Ass'y
21	530-015479	Screw #10-3/4	54	530-069247	Line Kit
22	530-015123	Washer	55	530-015495	Screw
23	530-015544	Screw	56	530-010729	Fuel Cap Ass'y. (Incl. O-Ring)
24	530-069232	Rope Kit	57	530-010815	Fuel Tank Ass'y. (Incl. #53, 54 & 56)
25	530-026735	Starter Rope Handle	59	530-015683	Screw
26	530-027175	Ground Wire	60	530-027350	Fuel Tank Shield
27	530-015197	Nut			
28	530-094222	Blower Tube Clamp			
29	530-069252	"T" Handle Kit			
30	530-015636	Screw #10			
31	530-026776	Heat Deflector			
32	530-010824*	Shroud (Incl. #12 & 45)			
33	530-069269	Blower Hsg. Kit (Incl. #36,46-49,55 & Vac. Tubes)	101	-	Instruction Decal
				530-027902	Model 358.796982
				530-027896	Model 358.796921
				530-027897	Model 358.797930
				530-029005	Model 358.797970
			102	-	Fan Housing Decal (Left)
				530-026762	Model 358.796982
				530-027448	Model 358.796921
				530-027288	Model 358.797930 & 358.797970
			103	530-026925	Warning Decal

*When removing or installing the bearing (#530-032091), the area of the shroud (#530-010824) receiving the bearing must be heated to approximately 300° F. to avoid damaging the shroud.

SEARS GAS BLOWER REPAIR PARTS LIST - MODEL 358.797930, 358.797970,
358.796921 & 358.796982

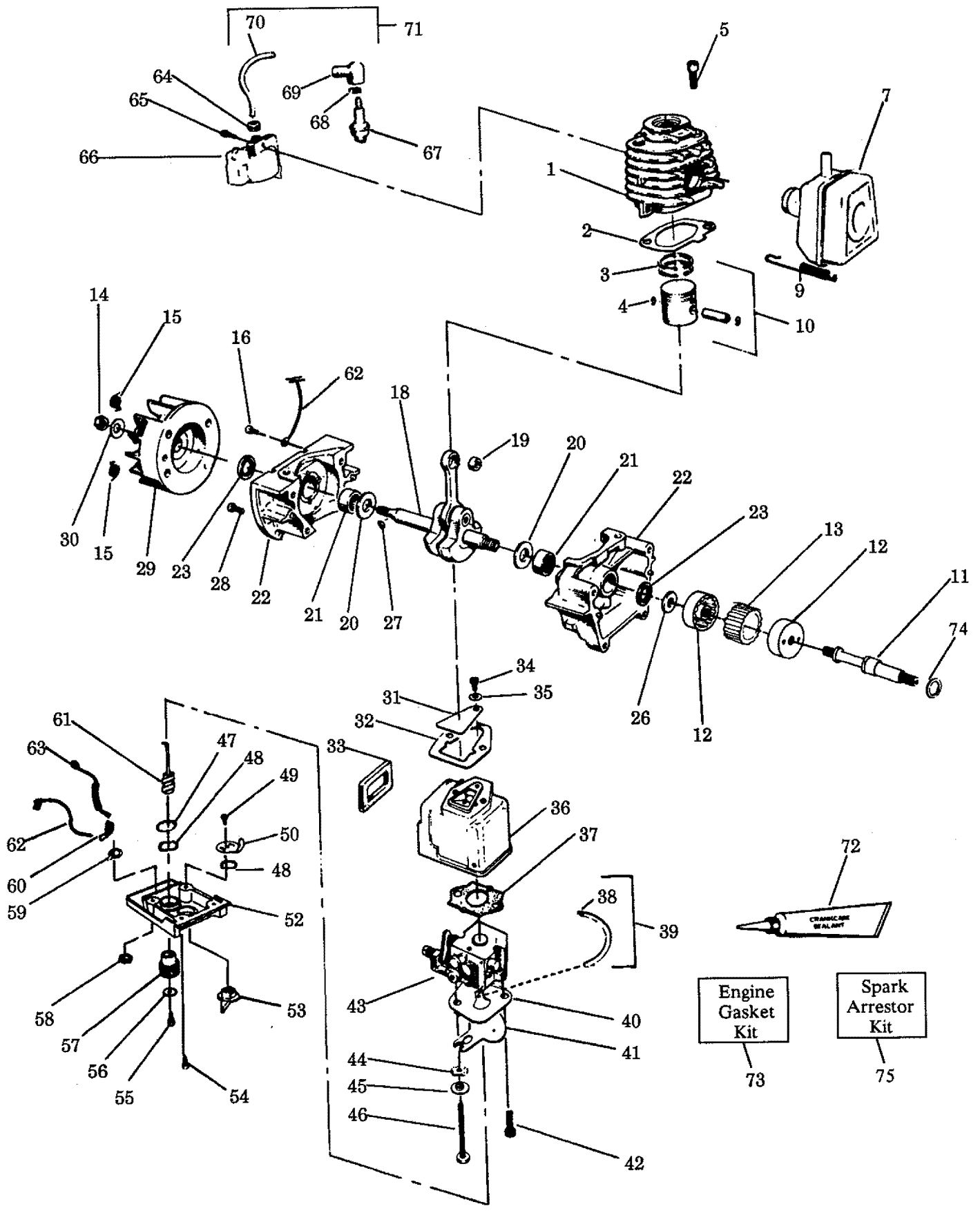

SEARS GAS BLOWER REPAIR PARTS LIST - MODEL 358.797930, 358.797970,
358.796921 & 358.796982

KEY NO.	PART NO.	DESCRIPTION	KEY NO.	PART NO.	DESCRIPTION
1	-	Cylinder	36	530-026818	Carburetor Case
	530-012192	Model 358.796982 & 358.796921	37	530-019157	* Carburetor Gasket
	530-012168	Model 358.797930 & 358.797970	38	530-026981	Fuel Line Fitting
2	530-019111	* Cylinder Gasket	39	530-010875	Fuel Line & Fitting Ass'y.
3	-	Piston Ring	40	530-026797	Choke Guide Plate
	530-026681	Model 358.796982 & 358.796921	41	530-026772	Choke Shutter
	530-026413	Model 358.797930 & 358.797970	42	530-015674	Screw #10-24x7/8
4	530-015162	Wrist Pin Retainer	43	530-035196	Carburetor
5	530-015239	Screw #1/4-20x3/4	44	530-015254	Wave Washer
7	530-069245	Muffler Ass'y.	45	530-015673	Spacer
9	530-024903	Muffler Attachment Spring	46	530-015630	Screw
10	-	Piston Kit (Incl. #3,4 & Pin)	47	530-015654	Retaining Ring
	530-069203	Model 358.796982 & 358.796921	48	530-015147	Wave Washer
	530-010753	Model 358.797930 & 358.797970	49	530-015407	Screw #8-32x5/16
11	530-069242	Shaft Kit	50	530-026773	Choke Actuator
12	530-012145	Shaft Coupling	52	530-026764	Carb. Case Cover
13	530-094243	Plastic Coupling	53	530-023807	Choke Knob
14	530-626605	Flywheel Nut	54	530-015675	Screw #8-18x5/8
15	530-023817	Starter Dog Spring	55	530-015660	Screw #10-14x3/8
16	530-015004	Screw #8-32x5/16	56	530-015658	Washer
18	-	Crankshaft & Rod Ass'y.	57	530-015614	Throttle Knob
	530-010853	Model 358.796982 & 358.796921	58	530-023575	Grounding Switch Nut
	530-027273	Model 358.797930 & 358.797970	59	530-024569	Washer
19	530-032092	Wrist Pin Bearing	60	530-069204	Toggle Switch Kit (Incl. #58 & 59)
		Model 358.796982 & 358.796921	61	530-026771	Throttle Wire Ass'y.
20	530-015351	Washer	62	530-026951	Ignition Wire
21	530-032029	Crankshaft Bearing	63	530-026829	Ground Wire
22	530-010757	Crankcase Ass'y. (Incl. #21,23 & Qty. 4 of 28)	64	530-024435	Plug Wire Grommet
23	530-019059	* Crankcase Seal	65	530-015128	Screw #8-32x3/4
26	530-001717	Coupling Washer	66	530-039124	Ignition Module
27	530-015126	Flywheel Key	67	STD360946	Spark Plug (CJ-8) - (Cat. No. (71-36403)
28	530-015369	Screw #10-24x5/8	68	530-003933	Spark Plug Lead Connector
29	530-039111	Flywheel Ass'y.	69	530-003934	Spark Plug Boot
30	530-015127	Flywheel Washer	70	530-039082	High Tension Lead Wire
31	530-024438	Reed Valve	71	530-039103	High Tension Lead Ass'y. (Incl. #68,69 & 70)
32	530-019108	* Carburetor Case to Crankcase Gasket	72	530-030054	Crankcase Sealant (Not Supplied With Unit)
33	530-019105	* Carburetor Case Seal	73	530-069219	Engine Gasket Kit (*Indicates Contents)
34	530-015241	Screw #6-19x5/16	74	530-015763	Washer
35	530-023367	Washer	75	530-069207	Spark Arrestor Kit (Not Supplied with Unit)

*Indicates Engine Gasket Kit Contents

NOTES

QUICK REFERENCE PAGE

***Read and follow all Warnings and Safety Instructions.
Failure to do so can result in serious injury.***

PREPARATION page 3

1. Wear eye protection.
2. Dress safely — boots or safety shoes, long pants.
3. Check for worn, loose, missing, or damaged parts and repair.
4. Inspect and make safe the area to be cut.
5. Keep children, bystanders, and animals a minimum of 30 feet away.

FUELING 5

1. Eliminate all sources of sparks or flame where fuel is mixed, poured or stored.
2. Use clean and fresh gasoline.
3. Use 16 parts regular unleaded gasoline to 1 part air-cooled, 2-cycle engine oil.
4. Mix and pour fuel in an approved, marked container in an outdoor area.
5. Move a minimum of 10 feet away from fuel and fueling site before starting engine.

STARTING THE ENGINE 6

1. Move the ignition switch to the "ON" position.
2. Move throttle control to the "FAST" position.
3. Adjust choke appropriately.
4. Make sure the nozzle is directed away from people, animals, glass and solid objects.
5. Pull the starter rope no more than 10 times to avoid flooding the engine.
6. Stop the engine by moving the ignition to the "OFF" position.

MAINTENANCE 10

1. Have all maintenance other than the recommended procedures described in the Operator's Manual performed by your Sears Service Center.
2. Disconnect spark plug before performing maintenance except for carburetor adjustment.
3. Drain fuel from the unit before storing for 30 days or more.
4. Clean air filter frequently but always after 5 hours of operation or 5 tanks of fuel, whichever is less.
5. Store in a dry place out of the reach of children.

SEARS operator's manual

MODEL NO.
358.797930-22.2cc
358.797970-22.2cc
358.796921-28.0cc
358.796982-28.0cc

How to Order Repair Parts

**SEARS SERVICE
IS AT YOUR SERVICE**

The Model Number will be found below the top handle with the Serial Number. Always mention the Model Number when requesting service or repair parts for your unit.

All parts listed herein may be ordered from any Sears Service Center and most Sears Stores.

WHEN ORDERING REPAIR PARTS ALWAYS GIVE THE FOLLOWING INFORMATION AS SHOWN IN THIS LIST.

1. The PART NUMBER
2. The MODEL NUMBER
358.797930-22.2cc
358.797970-22.2cc
358.796921-28.0cc
358.796982-28.0cc
3. The PART DESCRIPTION
4. The NAME OF ITEM —
GAS POWER BLOWER

If the parts you need are not stocked locally, your order will be electronically transmitted to a Sears Repair Parts Distribution Center for handling.

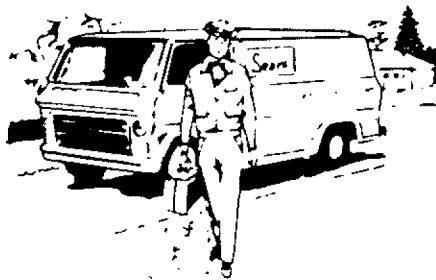

When you buy merchandise from Sears you get an extra something that nobody else can offer: Sears Service.

Across town or across the country, Sears Service follows you, providing trustworthy, competent service technicians using only Sears specified factory parts.

Your Sears Merchandise takes on added value when you discover that Sears has Service Units throughout the country. Each is staffed by Sears Trained, professional technicians using Sears approved methods.

Sold by Sears, Roebuck and Co., Chicago, Ill. 60684 U.S.A.