

# Panasonic®

## Operating Instructions DVD Home Theater Sound System

Model No. **SC-PT670**

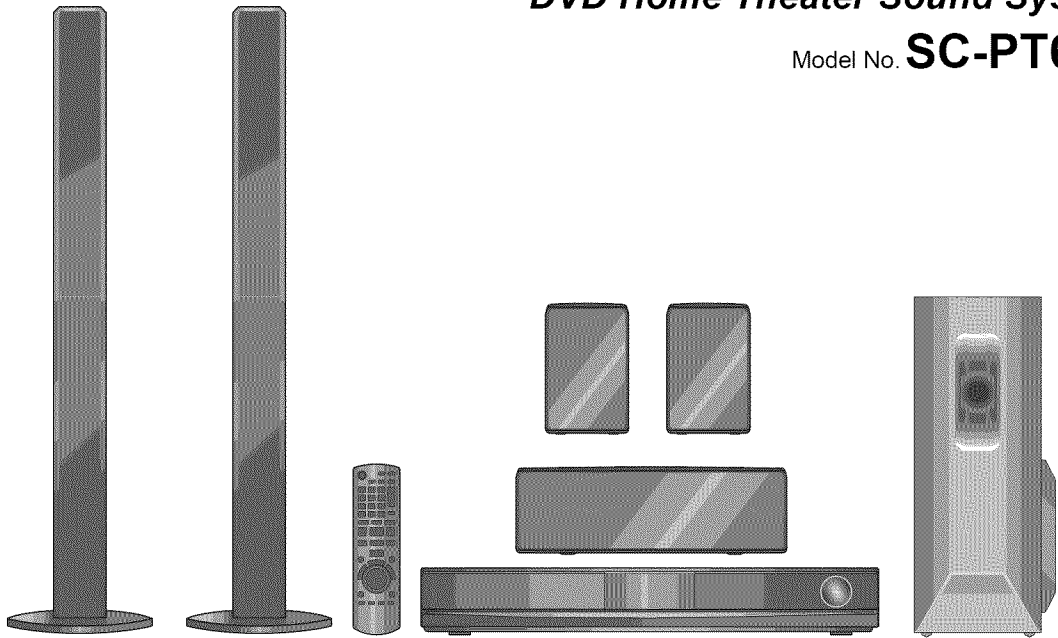

The illustrations shown may differ from your unit.

### Region number

The player plays DVD-Video marked with labels containing the region number "1" or "ALL".

Example:



### U.S.A. and Canada



As an ENERGY STAR® Partner,\*  
Panasonic has determined that  
this product meets the ENERGY STAR®  
guidelines for energy efficiency.

\* For Canada only: The word "Participant" is used in place of the word "Partner".

Before connecting, operating or adjusting this product, please  
read the instructions completely.  
Please keep this manual for future reference.

If you have any questions contact  
**In the U.S.A. and Puerto Rico:**  
**1-800-211-PANA (7262)**  
**In Canada: 1-800-561-5505**



# Dear customer

Thank you for purchasing this product. For optimum performance and safety, please read these instructions carefully.

Operations in these instructions are described mainly with the remote control, but you can perform the operations on the main unit if the controls are the same.

<b>System</b>	SC-PT670
<b>Main unit</b>	SA-PT670
<b>Front speakers</b>	SB-HF770
<b>Center speaker</b>	SB-HC470
<b>Surround speakers</b>	SB-HS470
<b>Subwoofer</b>	SB-HW460

**CAUTION!**  
 THIS PRODUCT UTILIZES A LASER.  
 USE OF CONTROLS OR ADJUSTMENTS OR PERFORMANCE OF PROCEDURES OTHER THAN THOSE SPECIFIED HEREIN MAY RESULT IN HAZARDOUS RADIATION EXPOSURE.  
 DO NOT OPEN COVERS AND DO NOT REPAIR YOURSELF.  
 REFER SERVICING TO QUALIFIED PERSONNEL.

**WARNING:**  
 TO REDUCE THE RISK OF FIRE, ELECTRIC SHOCK OR PRODUCT DAMAGE,  
 ●DO NOT EXPOSE THIS APPARATUS TO RAIN, MOISTURE, DRIPPING OR SPLASHING AND THAT NO OBJECTS FILLED WITH LIQUIDS, SUCH AS VASES, SHALL BE PLACED ON THE APPARATUS.  
 ●USE ONLY THE RECOMMENDED ACCESSORIES.  
 ●DO NOT REMOVE THE COVER (OR BACK); THERE ARE NO USER SERVICEABLE PARTS INSIDE. REFER SERVICING TO QUALIFIED SERVICE PERSONNEL.

**CAUTION!**  
 ● DO NOT INSTALL OR PLACE THIS UNIT IN A BOOKCASE, BUILT-IN CABINET OR IN ANOTHER CONFINED SPACE. ENSURE THE UNIT IS WELL VENTILATED. TO PREVENT RISK OF ELECTRIC SHOCK OR FIRE HAZARD DUE TO OVERHEATING, ENSURE THAT CURTAINS AND ANY OTHER MATERIALS DO NOT OBSTRUCT THE VENTILATION VENTS.  
 ● DO NOT OBSTRUCT THE UNIT'S VENTILATION OPENINGS WITH NEWSPAPERS, TABLECLOTHS, CURTAINS, AND SIMILAR ITEMS.  
 ● DO NOT PLACE SOURCES OF NAKED FLAMES, SUCH AS LIGHTED CANDLES, ON THE UNIT.  
 ● DISPOSE OF BATTERIES IN AN ENVIRONMENTALLY FRIENDLY MANNER.

THE FOLLOWING APPLIES ONLY IN THE U.S.A. AND CANADA.



**CAUTION**

**RISK OF ELECTRIC SHOCK**

**DO NOT OPEN**



CAUTION: TO REDUCE THE RISK OF ELECTRIC SHOCK, DO NOT REMOVE SCREWS. NO USER-SERVICEABLE PARTS INSIDE. REFER SERVICING TO QUALIFIED SERVICE PERSONNEL.

 The lightning flash with arrowhead symbol, within an equilateral triangle, is intended to alert the user to the presence of uninsulated "dangerous voltage" within the product's enclosure that may be of sufficient magnitude to constitute a risk of electric shock to persons.

 The exclamation point within an equilateral triangle is intended to alert the user to the presence of important operating and maintenance (servicing) instructions in the literature accompanying the appliance.

This product may receive radio interference caused by mobile telephones during use. If such interference is apparent, please increase separation between the product and the mobile telephone.

The socket outlet shall be installed near the equipment and easily accessible.  
 The mains plug of the power supply cord shall remain readily operable. To completely disconnect this apparatus from the AC Mains, disconnect the power supply cord plug from AC receptacle.

**For units with PX printed on the outer packaging**  
 THIS UNIT IS INTENDED FOR USE IN MODERATE CLIMATES.

-If you see this symbol-

**Information on Disposal in other Countries outside the European Union**



This symbol is only valid in the European Union. If you wish to discard this product, please contact your local authorities or dealer and ask for the correct method of disposal.

<b>CAUTION</b>	- LASER RADIATION WHEN OPEN. DO NOT STARE INTO BEAM.	FDA 21 CFR / Class
<b>CAUTION</b>	- CLASS 1M VISIBLE AND INVISIBLE LASER RADIATION WHEN OPEN. DO NOT VIEW DIRECTLY WITH OPTICAL INSTRUMENTS. (EYE PROTECT +42) Class 1M	
<b>VARNING</b>	- KLASS 1M SYNLIG OCH OSYNLIG LASERSTRÅLNING NÄR DESSA DELAR ÖPPNAS. BETRÄKTA EJ STRÅLEN DIREKT GENOM OPTISKA INSTRUMENT.	
<b>FORSIGTIG</b>	- SYNLIG OG USYNLIG LASERSTRÅLING KLASSE 1M. NÅR LÅGET ER ÅBENT, UNDGÅ AT SE LIGE PÅ MED OPTISKE INSTRUMENTER.	
<b>VARO!</b>	- AVATTRESSA OLET ALTIINA LUCKAN 1M NÄRKYÄÄ JA NÄKYMÄTÖNÄ, LASERSÄTELYÄ. ÄLÄ KATSO OPTISELLÄ LAITTEELLA SUORAAN SÄTEESEEN.	
<b>VORSICHT</b>	- SICHTBARE UND UNSICHTBARE LASERSTRÄHLUNG KLASSE 1M. WENN ABDECKUNG GEÖFFNET, NICHT DIREKT MIT OPTISCHEN INSTRUMENTEN BETRACHTEN.	
<b>ATTENTION</b>	- RAYONNEMENT LASER VISIBLE ET INVISIBLE. CLASSE 1M EN CAS D'OUVERTURE. NE PAS REGARDER DIRECTEMENT À L'USAGE D'INSTRUMENTS OPTIQUES.	
<b>注意</b>	- ここを開くと可視及び不可視レーザー光が出ます。 ビームを視たり、鏡れたりしないでください。	
<b>注意</b>	- 打穿料や可視及不可視レーザー照射。 警告光線照射。	GB2741, 4-2001GB 英 RGLXS0076

(Inside of product)



The laser product label has not been attached to products for the U.S.A. and Canada.



(Side of product)

# IMPORTANT SAFETY INSTRUCTIONS

Getting Started

**FCC Note:**

This equipment has been tested and found to comply with the limits for a Class B digital device, pursuant to Part 15 of the FCC Rules. These limits are designed to provide reasonable protection against harmful interference in a residential installation. This equipment generates, uses and can radiate radio frequency energy and, if not installed and used in accordance with the instructions, may cause harmful interference to radio communications. However, there is no guarantee that interference will not occur in a particular installation. If this equipment does cause harmful interference to radio or television reception, which can be determined by turning the equipment off and on, the user is encouraged to try to correct the interference by one or more of the following measures:

- Reorient or relocate the receiving antenna.
- Increase the separation between the equipment and receiver.
- Connect the equipment into an outlet on a circuit different from that to which the receiver is connected.
- Consult the dealer or an experienced radio/TV technician for help.

Any unauthorized changes or modifications to this equipment would void the user's authority to operate this device.

This device complies with Part 15 of the FCC Rules. Operation is subject to the following two conditions: (1) This device may not cause harmful interference, and (2) this device must accept any interference received, including interference that may cause undesired operation.

**Responsible Party:**

Panasonic Corporation of North America  
One Panasonic Way  
Secaucus, NJ 07094

**Support Contact:**

Panasonic Consumer Electronics Company  
Telephone No.: 1-800-211-PANA (7262)

Read these operating instructions carefully before using the unit. Follow the safety instructions on the unit and the applicable safety instructions listed below. Keep these operating instructions handy for future reference.

- 1) Read these instructions.
- 2) Keep these instructions.
- 3) Heed all warnings.
- 4) Follow all instructions.
- 5) Do not use this apparatus near water.
- 6) Clean only with dry cloth.
- 7) Do not block any ventilation openings. Install in accordance with the manufacturer's instructions.
- 8) Do not install near any heat sources such as radiators, heat registers, stoves, or other apparatus (including amplifiers) that produce heat.
- 9) **U.S.A. and Canada**  
Do not defeat the safety purpose of the polarized or grounding-type plug. A polarized plug has two blades with one wider than the other. A grounding-type plug has two blades and a third grounding prong. The wide blade or the third prong are provided for your safety. If the provided plug does not fit into your outlet, consult an electrician for replacement of the obsolete outlet.
- 10) Protect the power cord from being walked on or pinched particularly at plugs, convenience receptacles, and the point where they exit from the apparatus.
- 11) Only use attachments/accessories specified by the manufacturer.
- 12) Use only with the cart, stand, tripod, bracket, or table specified by the manufacturer, or sold with the apparatus. When a cart is used, use caution when moving the cart/apparatus combination to avoid injury from tip-over.
- 13) Unplug this apparatus during lightning storms or when unused for long periods of time.
- 14) Refer all servicing to qualified service personnel. Servicing is required when the apparatus has been damaged in any way, such as power-supply cord or plug is damaged, liquid has been spilled or objects have fallen into the apparatus, the apparatus has been exposed to rain or moisture, does not operate normally, or has been dropped.



## Accessories



Please check and identify the supplied accessories. Use numbers indicated in parentheses when asking for replacement parts. (Product numbers correct as of December 2008. These may be subject to change.)

**Only for U.S.A. and Puerto Rico:**

To order accessories, refer to "Accessory Purchases (United States and Puerto Rico)" on page 36.

For other areas: To order accessories, call the dealer from whom you made your purchase.

- 1 Remote control (N2QAYB000359)



- 1 FM indoor antenna (RSA0007-M)



- 1 AC power supply cord **U.S.A. and Canada** (K2CB2CB00021)



- Others** (K2CQ2CA00007)



- 2 Speaker stands (with cable) [RYPX0386-KLJ (white)] [RYPX0386-KRJ (red)]



- 8 Screws (XTN5+10FFJK)



- 2 Remote control batteries



- 3 Speaker cables [REEX0860E-Q (blue)] [REEX0868E-Q (gray)] [REEX0858-Q (green)]



- 1 Video cable (K2KA2BA00001)



- 1 Sheet of speaker cable stickers



- 1 AC plug adaptor **For areas except U.S.A. and Canada** (K2DA42E00001)



- 1 Auto speaker setup microphone (LOCBAB000125)



- 1 AM loop antenna (N1DAAAA00002)



- 2 Bases (RYPX0389-KJ)



# Glossary

## Decoder

A decoder restores the coded audio signals on DVDs to normal. This is called decoding.

## Dolby Digital

This is a method of coding digital signals developed by Dolby Laboratories. Apart from stereo (2-channel) audio, these signals can also be 5.1-channel sound.

## DTS (Digital Theater Systems)

This surround system is used in many movie theaters around the world. There is good separation between the channels, so realistic sound effects are possible.

## Dynamic range

Dynamic range is the difference between the lowest level of sound that can be heard above the noise of the equipment and the highest level of sound before distortion occurs.

## Frame still and field still

Frames are the still pictures that go together to make a moving picture. There are about 30 frames shown each second.

One frame is made up of two fields. A regular TV shows these fields one after the other to create frames.

A still is shown when you pause a moving picture. A frame still is made up of two alternating fields, so the picture may appear blurred, but overall quality is high.

A field still is not blurred, but it has only half the information of a frame still so picture quality is lower.

## HDMI (High-Definition Multimedia Interface)

HDMI is a next-generation digital interface for consumer electronic products. Unlike conventional connections, it transmits uncompressed digital video and audio signals on a single cable. This unit supports high-definition video output (720p, 1080i, 1080p) from the HDMI AV OUT terminal. To enjoy high-definition video, a high-definition compatible TV is required.

## I/P/B

MPEG 2, the video compression standard adopted for use with DVD-Video, codes frames using these 3 picture types.

**I:** Intra coded picture

This picture has the best quality and is the best to use when adjusting the picture.

**P:** Predictive coded picture

This picture is calculated based on past I- or P-pictures.

**B:** Bidirectionally-predictive coded picture

This picture is calculated by comparing past and future I- and P-pictures so it has the lowest volume of information.

## JPEG (Joint Photographic Experts Group)

This is a system used for compressing/decoding color still pictures. The benefit of JPEG is less deterioration in picture quality considering the degree of compression.

## Linear PCM (pulse code modulation)

These are uncompressed digital signals, similar to those found on CDs.

## MP3 (MPEG Audio Layer 3)

An audio compression method that compresses audio to approximately one tenth of its size without any considerable loss of audio quality.

## Playback control (PBC)

If a Video CD has playback control, you can select scenes and information with menus.

## Progressive/Interlaced

NTSC, the video signal standard, has 480 interlaced (i) scan lines, whereas progressive scanning uses twice the number of scan lines. This is called 480p.

Using progressive output, you can enjoy the high-resolution video recorded on media such as DVD-Video.

Your TV must be compatible to enjoy progressive video.

## Sampling frequency

Sampling is the process of converting the heights of sound wave (analog signal) samples taken at set periods into digits (digital encoding).

Sampling frequency is the number of samples taken per second, so larger numbers mean more faithful reproduction of the original sound.

## WMA

WMA is a compression format developed by Microsoft Corporation. It achieves the same sound quality as MP3 with a file size that is smaller than that of MP3.

## Listening caution



Selecting fine audio equipment such as the unit you've just purchased is only the start of your musical enjoyment. Now it's time to consider how you can maximize the fun and excitement your equipment offers. This manufacturer and the Electronic Industries Association's Consumer Electronics Group want you to get the most out of your equipment by playing it at a safe level. One that lets the sound come through loud and clear without annoying blaring or distortion—and, most importantly, without affecting your sensitive hearing.

We recommend that you avoid prolonged exposure to excessive noise.

Sound can be deceiving. Over time your hearing "comfort level" adapts to higher volumes of sound. So what sounds "normal" can actually be loud and harmful to your hearing.

Guard against this by setting your equipment at a safe level BEFORE your hearing adapts.



To establish a safe level:

- Start your volume control at a low setting.
- Slowly increase the sound until you can hear it comfortably and clearly, and without distortion.

Once you have established a comfortable sound level:

- Set the dial and leave it there.

Taking a minute to do this now will help to prevent hearing damage or loss in the future. After all, we want you listening for a lifetime.

# TABLE OF CONTENTS

## Getting Started

IMPORTANT SAFETY INSTRUCTIONS	3
Accessories	3
Glossary	4

### Quick Start Guide

step 1 Assembling the front speakers	6
step 2 Positioning	7
step 3 Connections	8
Speaker connections	8
Audio and video connections	9
Radio antenna connections	10
step 4 AC power supply cord connections	11
step 5 Preparing the remote control	11
step 6 SMART SETUP	12

Setting up the radio	13
Presetting stations automatically	13
Confirming the preset channels	13
Manual tuning	13
Selecting the playback source	15
Selecting the source from the START menu	15
Selecting the source by the remote control	15

### Enjoying sound from all speakers and various sound effects

Enjoying surround sound effects	16
Selecting sound mode	16
Whisper-mode Surround	16
Adjusting the speaker output level manually	17

## Playing Discs

Basic play	18
Using the main unit	18
Using the remote control	19
Other modes of play	20
Playing CDs sequentially (CD Mode)	20
Repeat play	20
Program and Random play	20

Using navigation menus	21
Playing data discs	21
Playing RAM and DVD-R/-RW (DVD-VR) discs	21
Using on-screen menus	22

## Other Operations

Using the VIERA Link™ "HDAVI Control™"	24
One touch play	24
Auto input switching	24
Power off link	24
Speaker control	25
VIERA Link Control only with TV's remote control (for "HDAVI Control 2 or later")	25

Using the iPod	26
----------------	----

## Reference

Speaker installation options	27
Changing the player settings	28
Discs that can be played	30
Maintenance	31
Product Service	31
Troubleshooting guide	32

Specifications	34
Limited Warranty (ONLY FOR U.S.A. AND PUERTO RICO)	36
Limited Warranty (ONLY FOR CANADA)	37
Control reference guide	38

## step 1 | Assembling the front speakers

### Preparation

- To prevent damage or scratches, lay down a soft cloth and perform assembly on it.
- For assembly, use a Phillips-head screwdriver (not included).

Make sure you have all the indicated components before starting assembly, setup, and connection.

- Keep the screws out of reach of children to prevent swallowing.
- For optional wall mount, refer to page 27.

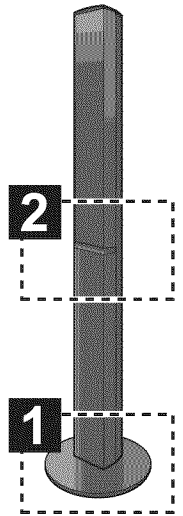
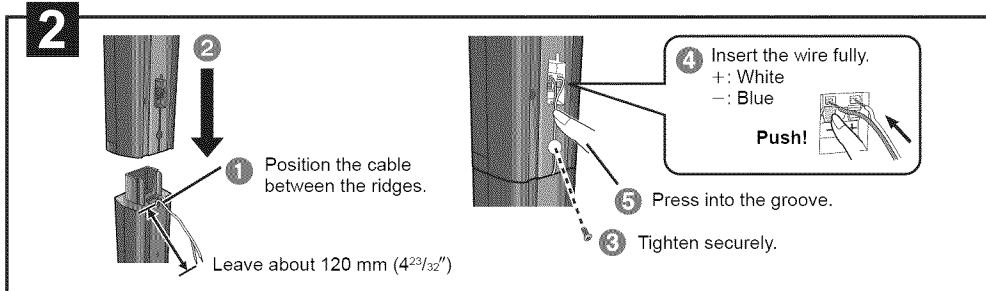
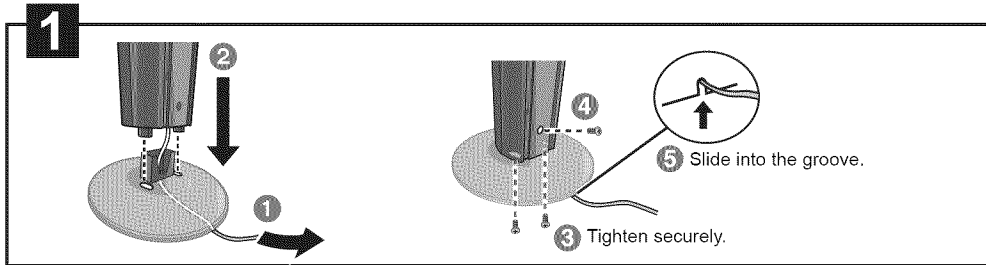
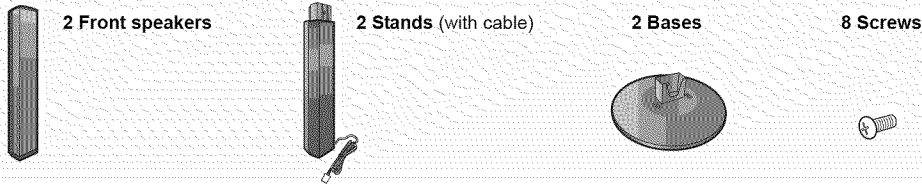

### Speaker assembly option

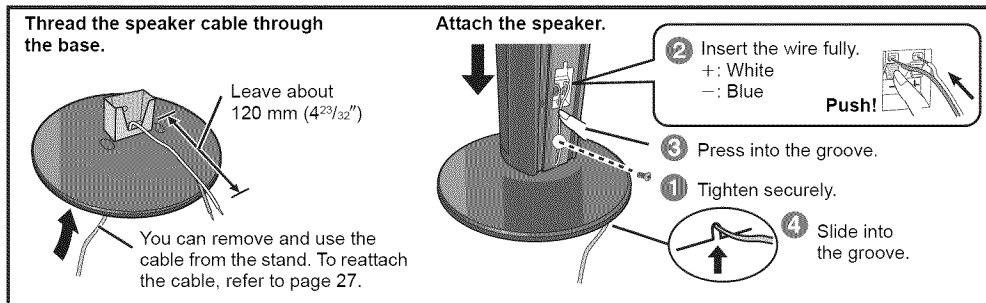

### Preventing the speakers from falling

- You will need to obtain the appropriate screw eyes to match the walls or pillars to which they are going to be fastened.
- Consult a qualified housing contractor concerning the appropriate procedure when attaching to a concrete wall or a surface that may not have strong enough support. Improper attachment may result in damage to the wall or speakers.

e.g. Front speaker

**String** (not included)  
Thread from the wall to the speaker and tie tightly.

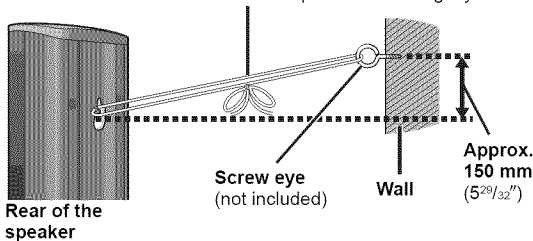

### Caution

Do not stand on the base. Be cautious when children are near.

e.g. Front speaker



## step 2 | Positioning

How you set up your speakers can affect the bass and the sound field.

Note the following points:

- Place speakers on flat secure bases.
- Placing speakers too close to floors, walls, and corners can result in excessive bass. Cover walls and windows with thick curtains.

### Note

Keep your speakers at least 10 mm ( $13/32$ " ) away from the system for proper ventilation.

### Setup example

Place the front, center, and surround speakers at approximately the same distance from the seating position. Using "Auto speaker setup" (⇒ 12) is a convenient way to get the ideal surround sound from your speakers when you are unable to place them. The angles in the diagram are approximate.

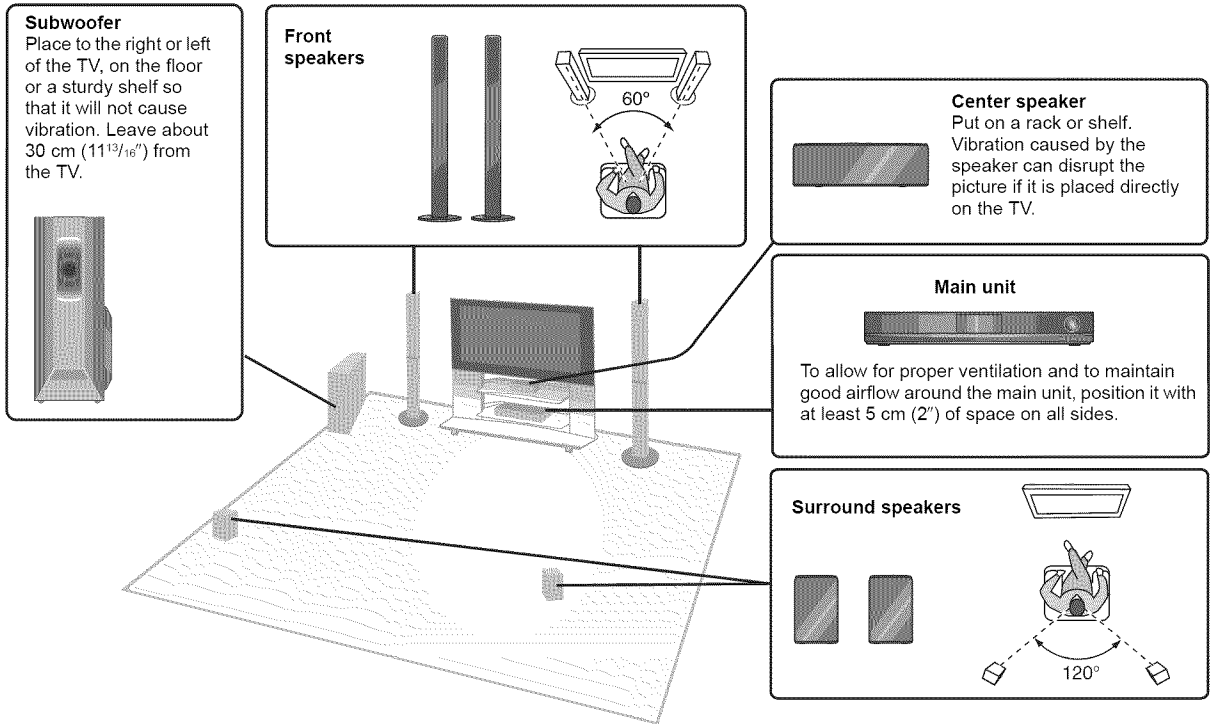

## Set your surround sound free!

### Optional Panasonic wireless accessory (example: SH-FX70)

You can enjoy surround speaker sound wirelessly when you use the optional Panasonic wireless accessory (example: SH-FX70). For details, please refer to the operating instructions for the optional Panasonic wireless accessory.

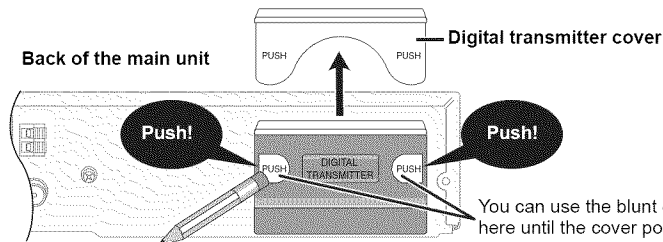

- Remove the digital transmitter cover before installing any optional Panasonic wireless accessory.
- Replace the cover when the digital transmitter is not in use.

You can use the blunt end of a writing instrument to push here until the cover pops out.

### If irregular coloring occurs on your TV

The center speaker is designed to be used close to a TV, but the picture may be affected with some TVs and setup combinations.

**If this occurs, turn the TV off for about 30 minutes.**

The demagnetizing function of the TV should correct the problem. If it persists, move the speakers further away from the TV.

### Caution

- The main unit and supplied speakers are to be used only as indicated in this setup. Failure to do so may lead to damage to the amplifier and/or the speakers, and may result in the risk of fire. Consult a qualified service person if damage has occurred or if you experience a sudden change in performance.
- Do not attempt to attach these speakers to walls using methods other than those described in this manual.

### Notes on speaker use

#### ● Use only supplied speakers

Using other speakers can damage the unit, and sound quality will be negatively affected.

- You can damage your speakers and shorten their useful life if you play sound at high levels over extended periods.
- Reduce the volume in the following cases to avoid damage:
  - When playing distorted sound.
  - When the speakers are reverberating due to a record player, noise from FM broadcasts, or continuous signals from an oscillator, test disc, or electronic instrument.
  - When adjusting the sound quality.
  - When tuning the unit on or off.

### Caution

Do not touch the front netted area of the speakers. Hold by the sides. e.g. Center speaker

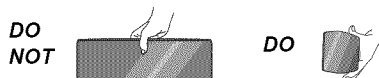

## step 3 | Connections

Turn off all equipment before connection and read the appropriate operating instructions.  
Do not connect the AC power supply cord until all other connections are complete.

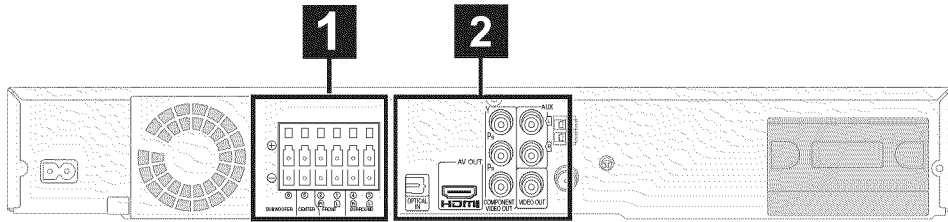

Main unit

## 1 Speaker connections

### Setup example

Pay attention to the type of speaker and the connector color when you place the speakers.

**Connect to the terminals of the same color.**

Use of the speaker cable stickers is convenient when making cable connections.

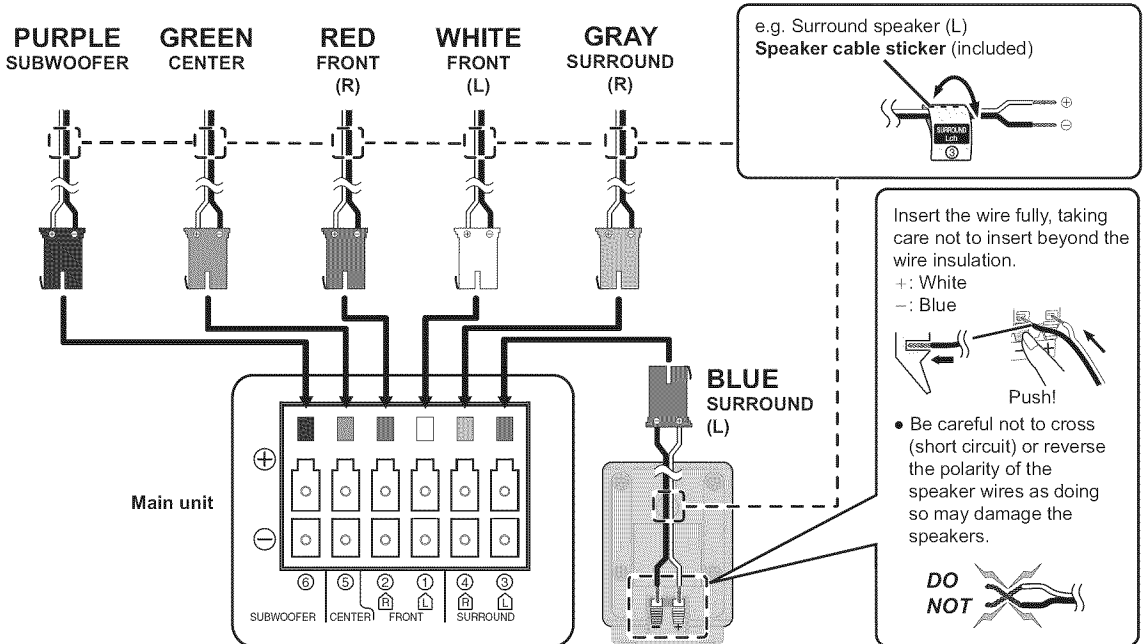



# 2 Audio and video connections

## Basic setup example

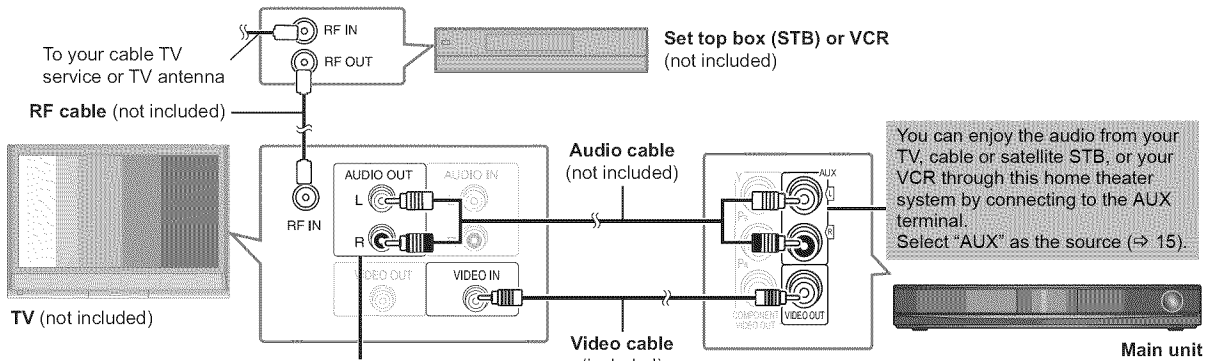

Refer to the operating instructions for the TV, cable or satellite STB, or VCR for the settings necessary to output its audio from the AUDIO OUT terminal to your home theater system.

Other video connections			
TV terminal	Cable required (not included)	Main unit terminal	Features
	<p><b>HDMI cable</b></p> <p><b>Note</b></p> <ul style="list-style-type: none"> <li>Non-HDMI-compliant cables cannot be utilized.</li> <li>It is recommended that you use Panasonic's HDMI cable. Recommended part number: RP-CDHG15 (1.5 m/4.9 ft), RP-CDHG30 (3.0 m/9.8 ft), RP-CDHG50 (5.0 m/16.4 ft), etc.</li> </ul>	<p><b>HDMI</b></p> <p><b>AV OUT</b></p>	<p>This connection provides the best picture quality.</p> <ul style="list-style-type: none"> <li>Set "VIDEO PRIORITY" to "ON" (=&gt; 29, HDMI menu).</li> <li>Set "VIDEO FORMAT" in Menu 4 (HDMI) (=&gt; 23).</li> </ul> <p><b>VIERA Link "HDAVI Control"</b></p> <p>If your Panasonic TV is VIERA Link compatible, you can operate your TV synchronizing with home theater operations or vice versa (=&gt; 24, Using the VIERA Link™ "HDAVI Control"™).</p> <ul style="list-style-type: none"> <li>Make the audio connection (=&gt; above) when you use VIERA Link "HDAVI Control" function.</li> </ul>
<p>All Panasonic TVs that have 480p input connectors are compatible. Consult the manufacturer if you have another brand of TV.</p>	<p><b>Video cables</b></p>	<p><b>COMPONENT VIDEO</b></p> <ul style="list-style-type: none"> <li>Connect to terminals of the same color.</li> </ul>	<p>This connection provides a much purer picture than the VIDEO OUT terminal.</p> <ul style="list-style-type: none"> <li>After making this connection, select "DARKER" from the "BLACK LEVEL" in the VIDEO menu (=&gt; 28).</li> </ul> <p><b>To enjoy progressive video</b></p> <ul style="list-style-type: none"> <li>Connect to a progressive output compatible TV.                     <ul style="list-style-type: none"> <li>Set "VIDEO OUT (I/P)" in VIDEO menu to "PROGRESSIVE" and then follow the instructions on the menu screen (=&gt; 28).</li> </ul> </li> </ul>
Other audio connection			
TV or external equipment terminal	Cable required (not included)	Main unit terminal	Features
	<ul style="list-style-type: none"> <li>Do not bend sharply when connecting.</li> </ul> <p><b>Optical digital audio cable</b></p>	<p><b>OPTICAL IN</b></p>	<p>This is the preferred connection for best sound and true surround sound.</p> <p>This unit can decode the surround signals received from your TV, cable or satellite STB. Refer to the operating instructions for the TV, cable or satellite STB for the settings necessary to output its audio from the digital audio output to your home theater system. Only Dolby Digital and PCM can be played with this connection.</p> <ul style="list-style-type: none"> <li>After making this connection, make settings to suit the type of audio from your digital equipment (=&gt; 15).</li> </ul>

**Note**

- Do not make the video connections through the VCR.** Due to copy guard protection, the picture may not be displayed properly.
- Only one video connection is required. Choose one of the video connections above depending on your TV.
- If you have various sound sources (such as Blu-ray player, DVD recorder, VCR, etc.), connect them to the available inputs on the TV and the TV output should then be connected to the AUX or OPTICAL IN terminal of the main unit.

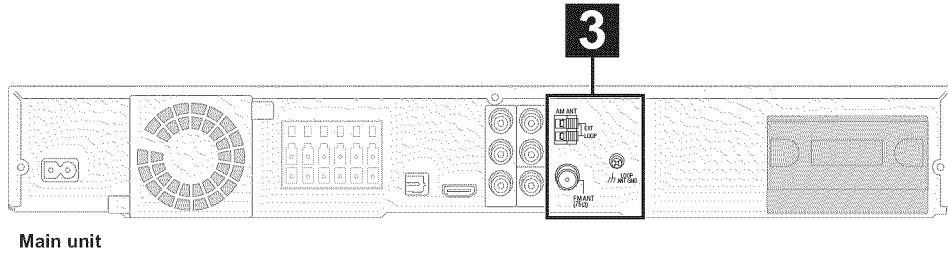

Main unit

### 3 Radio antenna connections

- Keep loose antenna cables away from other wires and cables.

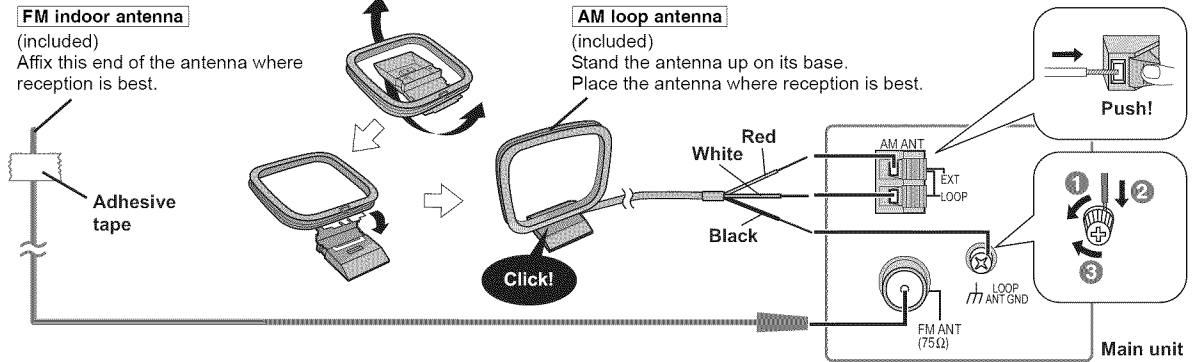

Main unit

#### Using an FM/AM outdoor antenna (optional)

Use outdoor antenna if FM/AM radio reception is poor.

- Disconnect the antenna when the unit is not in use.
- Do not use the outdoor antenna during an electrical storm.

**FM outdoor antenna**  
[Using a TV antenna (not included)]  
The antenna should be installed by a competent technician.

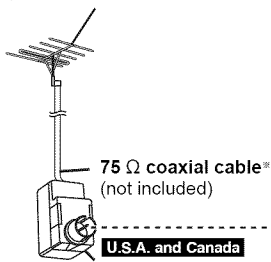

Antenna plug (not included)

**AM outdoor antenna**  
[Using a vinyl wire (not included)]  
Run a piece of vinyl wire horizontally across a window or other convenient location.

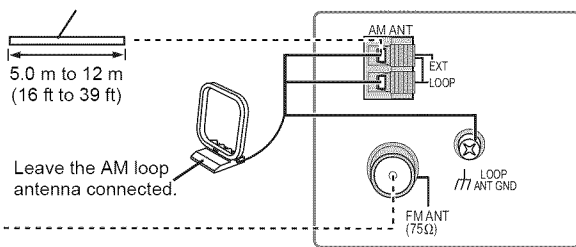

Main unit

\*Rework your outdoor antenna's 75 Ω coaxial cable as follows.

<p>① Remove a piece of the outer vinyl insulator.</p>	<p>② Carefully pull the tabs apart to remove the cover.</p>	<p>③ Install the coaxial cable. Clamp the cable conductor, and wind it on so that it does not contact anything else.</p>	<p>④ Attach the cover.</p>
---	---	--	----------------------------

## step 4 | AC power supply cord connections

For areas except U.S.A. and Canada

### Before connecting the AC power supply cord

#### Set the voltage.

Use a flat-head screwdriver to move the voltage selector to the appropriate position for the area in which this system is used.

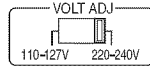

- If the AC plug does not fit your household AC outlet  
Use the AC plug adaptor (included).

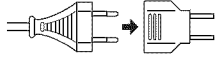

If it still does not fit, contact an electrical parts distributor for assistance.

Main unit

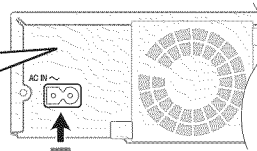

AC power supply cord (included)

To household AC outlet

### Conserving power

The main unit consumes a small amount of power when it is turned off (**U.S.A. and Canada** approx. 0.1 W, **Others** approx. 0.2 W). To save power when it is not to be used for a long time, unplug it from the household AC outlet.

You will need to reset some memory items after plugging in the main unit.

### Note

The included AC power supply cord is for use with the main unit only. Do not use it with other equipment. Also, do not use cords for other equipment with the main unit.

## step 5 | Preparing the remote control

### Batteries

- 2 Insert so the poles (+ and -) match those in the remote control.

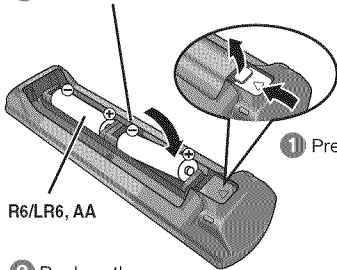

- 3 Replace the cover.

### CAUTION

Danger of explosion if battery is incorrectly replaced. Replace only with the same or equivalent type recommended by the manufacturer. Dispose of used batteries according to the manufacturer's instructions.

- Use alkaline or manganese batteries.
- Do not heat or expose to flame.
- Do not leave the battery(ies) in an automobile exposed to direct sunlight for a long period of time with doors and windows closed.

### Do not:

- mix old and new batteries.
  - use different types at the same time.
  - take apart or short circuit.
  - attempt to recharge alkaline or manganese batteries.
  - use batteries if the covering has been peeled off.
- Mishandling of batteries can cause electrolyte leakage which can severely damage the remote control.

Remove the batteries if the remote control is not going to be used for a long period of time. Store in a cool, dark place.

### Use

Aim at the remote control signal sensor (⇒ 39), avoiding obstacles, at a maximum range of 7 m (23 ft) directly in front of the unit.

The Smart setup screen assists you to make necessary settings.

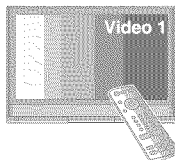

**Preparation**

- Turn on your TV and select the appropriate video input mode (e.g. VIDEO 1, AV 1, HDMI, etc.) to suit the connections to this unit.
- To change your TV's video input mode, refer to its operating instructions.
  - This remote control can perform some basic TV operations (⇒ 38).

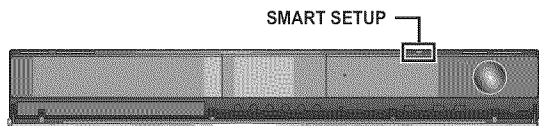
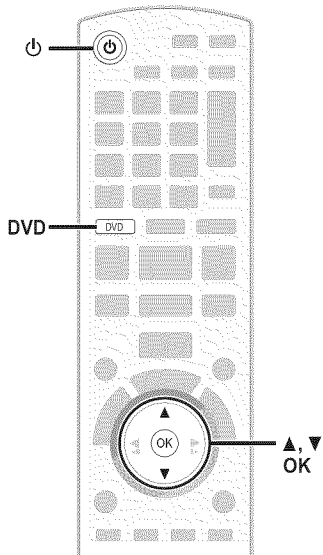

- |          |                      |   |
|----------|----------------------|---|
| <b>1</b> |                      | <b>Turn on the unit.</b>  |
|          |                      | <ul style="list-style-type: none"> <li>• When the Smart setup screen appears automatically, skip step 2 and 3.</li> </ul> |
| <b>2</b> |                      | <b>Select "DVD/CD".</b>   |
| <b>3</b> | <br>(Main unit only) | <b>Show the Smart setup.</b>  |
|          |                      | e.g.<br>  |
| <b>4</b> |                      | <b>Select "Yes".</b>  |
| <b>5</b> |                      | <b>Follow the messages and make the settings.</b>   |
|          |                      | (⇒ right, Smart setup settings)   |
| <b>6</b> |                      | <b>Finish Smart setup.</b>  |

**Smart setup settings**

- **Language**  
Select the language used on menu screen.
- **TV aspect**  
Select the aspect to suit your TV.
- **Speaker check**  
Listen to speaker output to confirm speaker connections.
- **Auto speaker setup**  
Adjust the speaker output level automatically. (⇒ below)
- **Speaker output**  
Make surround sound setting for speaker output.
- **TV audio**  
Select the audio input connection from your TV.  
For AUX connection (⇒ 9): Select "AUX".  
For OPTICAL IN connection (⇒ 9): Select "DIGITAL IN".  
This will be the TV audio setting for VIERA Link "HDAVI Control". (⇒ 24)

**Note**

- If this unit is connected to a "HDAVI Control 3 or later" compatible TV via HDMI cable, the menu language and TV aspect information will be retrieved via VIERA Link.
- If this unit is connected to a "HDAVI Control 2" compatible TV via HDMI cable, the menu language information will be retrieved via VIERA Link.
- Settings in the Smart setup can also be changed in the player settings [e.g. language, TV aspect, speaker level and TV audio (⇒ 28)].

**■ Adjusting the speaker output level automatically: Auto speaker setup**

The speaker level settings can be optimized to accommodate your room's listening conditions so that you can enjoy the ideal surround sound experience.

Keep as quiet as possible during the Auto speaker setup. Loud voices, air-conditioning noise, or excessive wind may lead to incorrect settings. The speakers output loud test signals during setup.

- Place the Auto speaker setup microphone at actual seating position. (At ear level when seated.)
- The test signal is output from each speaker.

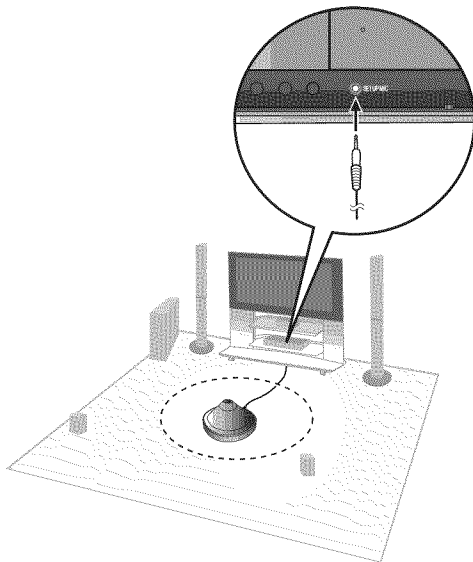

**Note**

Auto speaker setup can be activated through Smart setup only.

# Setting up the radio

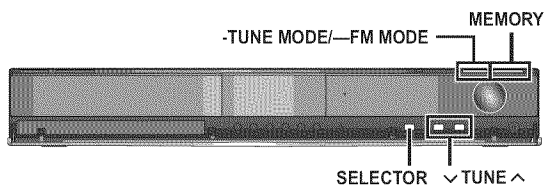
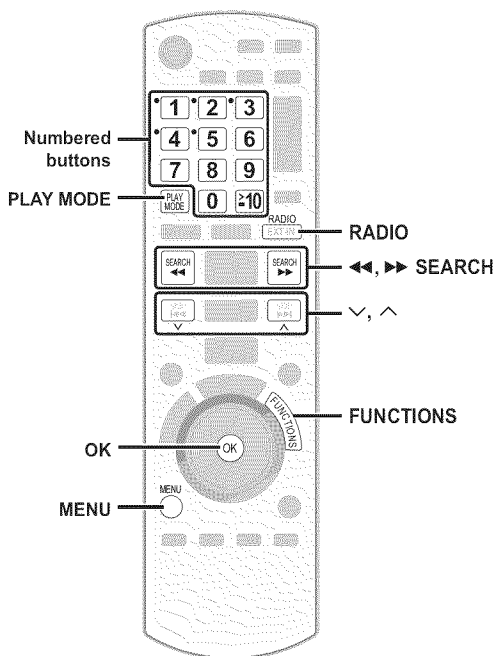

## Confirming the preset channels

<p><b>1</b></p>	<p><b>Select "FM" or "AM".</b></p> <ul style="list-style-type: none"> <li>• Main unit: Press [SELECTOR].</li> </ul>
<p><b>2</b></p>	<p><b>Select the channel.</b></p> <ul style="list-style-type: none"> <li>• To select a 2-digit number e.g. 12: [≥10] ⇒ [1] ⇒ [2]</li> </ul> <p>Alternatively, press [v, ^].</p> <ul style="list-style-type: none"> <li>• Main unit: Press [-TUNE MODE] to select "PRESET" on the display, and then press [v TUNE ^] to select the channel.</li> </ul> <p>When a stereo FM broadcast is being received, "ST" lights in the display.</p>

• The FM/AM setting is also shown on the TV display.

## If noise is excessive

When "FM" is selected

Press and hold [PLAY MODE] (main unit: [-FM MODE]) to display "MONO".

Press and hold the button again to cancel the mode.

• The mode is also canceled when you change the frequency.

When "AM" is selected

Press [FUNCTIONS] on the remote control.

Each time you press the button: BP 2 ↔ BP 1

## Presetting stations automatically

Up to 30 stations can be set in each band, FM and AM.

<p><b>1</b></p>	<p><b>Select "FM" or "AM".</b></p> <ul style="list-style-type: none"> <li>• Main unit: Press [SELECTOR].</li> </ul>
<p><b>2</b></p>	<p>Each time you press the button:</p> <p><b>LOWEST</b> (factory preset): To begin auto preset with the lowest frequency.</p> <p><b>CURRENT:</b> To begin auto preset with the current frequency.*</p> <p>* To change the frequency, refer "Manual tuning" (⇒ right).</p>
<p><b>3</b></p> <p>(press and hold)</p>	<p>Release the button when "FM AUTO" or "AM AUTO" is displayed.</p> <ul style="list-style-type: none"> <li>• Main unit: Press and hold [MEMORY].</li> </ul> <p>The tuner starts to preset all the stations it can receive into the channels in ascending order.</p>

• "SET OK" is displayed when the stations are set, and the radio tunes to the last preset station.

• "ERROR" is displayed when automatic presetting is unsuccessful. Preset the channels manually (⇒ 14).

## Manual tuning

<p><b>1</b></p>	<p><b>Select "FM" or "AM".</b></p> <ul style="list-style-type: none"> <li>• Main unit: Press [SELECTOR].</li> </ul>
<p><b>2</b></p>	<p><b>Select the frequency.</b></p> <ul style="list-style-type: none"> <li>• Main unit: Press [-TUNE MODE] to select "MANUAL" on the display, and then press [v TUNE ^] to select the frequency.</li> <li>• To start automatic tuning, press and hold [◀▶] (main unit: [v TUNE ^]) until the frequency starts scrolling. Tuning stops when a station is found.</li> </ul>

(Continued on next page)

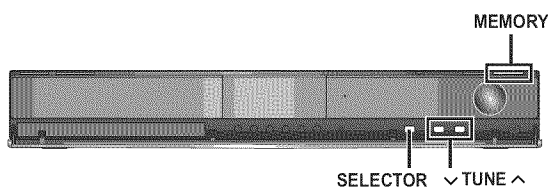
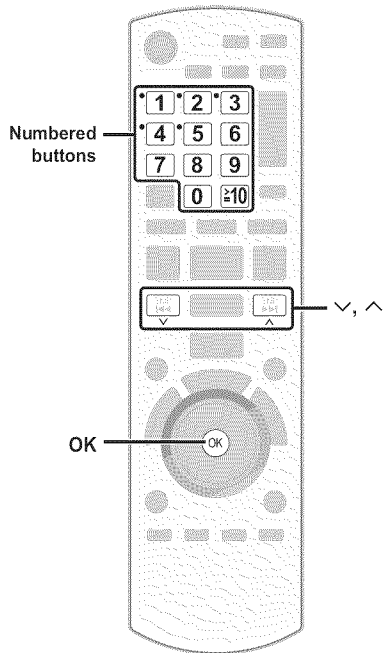

### Presetting stations manually

Up to 30 stations can be set in each band, FM and AM.

- ① While listening to the radio broadcast  
**Press [OK].**
- ② While the frequency is flashing on the display  
**Press the numbered buttons to select a channel.**
  - To select a 2-digit number  
e.g. 12: [≥10] → [1] → [2]

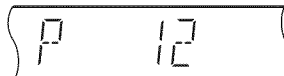

Alternatively, press [v, ^], and then press [OK].

Main unit:

- ① While listening to the radio broadcast  
**Press [MEMORY] twice.**
- ② While a channel number is flashing on the display  
**Press [v TUNE ^], and then press [MEMORY].**

A station previously stored is overwritten when another station is stored in the same channel preset.

### FM frequency step

Main unit only

The step is factory-set to 0.2-MHz, but you can change it to receive broadcasts allocated in 0.1-MHz steps. You may need to change this setting if the tuner seems to skip over the correct frequency for stations in your area.

- ① Press [SELECTOR] to select "FM".
- ② Press and hold [SELECTOR].

After a few seconds the display changes to show the current minimum frequency. Continue to hold the button down. The minimum frequency changes and the step is changed.  
e.g. 87.9 (Factory preset) ↔ 87.5

To return to the original step, repeat steps ① and ②.

#### Note

After changing the setting, previously preset frequencies will be cleared. Preset them again.

# Selecting the playback source

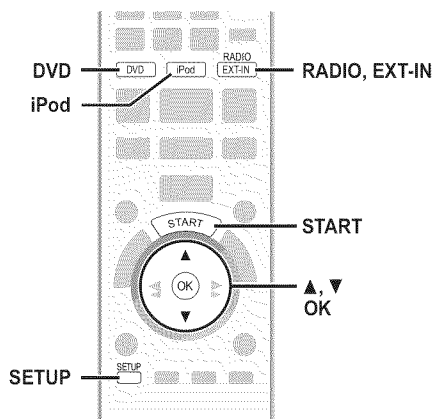

## Selecting the source by the remote control

	DVD/CD (⇒ 12)
	Each time you press the button: <b>FM</b> (⇒ 13) <b>AM</b> (⇒ 13) <b>AUX*</b> : For audio input through the AUX terminal. <b>D-IN*</b> : For audio input through the OPTICAL IN terminal. (⇒ below) <small>* "(TV)" will appear beside "AUX" or "D-IN", indicating the TV audio setting for VIERA Link "HDAVI Control" (⇒ 24).</small>
	iPod (⇒ 26)

## Selecting the source from the START menu

You can select desired source or access playback/menus by using the START menu.

- Show the START menu.**  
 This unit automatically turns on. (The TV also turns on when using VIERA Link "HDAVI Control". This works only when in "DVD/CD" or "IPOD" mode without any disc/device being loaded/connected.) e.g.
 

DVD/CD Home theater  
 Input select  
 OK RETURN
- Select an item.**  
 • To exit, press [START].
- Make the setting.**

### When "Input select" is selected

You can select a desired source from the menu.

- DVD/CD (⇒ 12), FM (⇒ 13), AM (⇒ 13), AUX\* (⇒ right), DIGITAL IN\* (⇒ right), iPod (⇒ 26)
- \*“(TV)” will appear beside “AUX” or “DIGITAL IN”, indicating the TV audio setting for VIERA Link “HDAVI Control” (⇒ 24).

When a disc is loaded, you can also access playback or menus from the START menu.

e.g. DVD-V

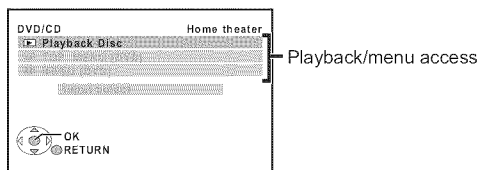

When the on-screen control panel appears

e.g. DVD-V (when "Playback Disc" is selected from the START menu)

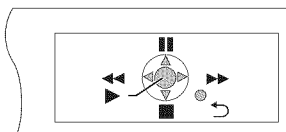

You can operate the playback with the indicated controls.

Press [SELECTOR] on the main unit to select source from the main unit. (⇒ 39)

### Note

Confirm the audio connection to the AUX or OPTICAL IN terminal on the main unit when you select the corresponding sources (⇒ 9). Reduce the volume on the TV to its minimum and then balance the TV volume with the volume setting on the main unit. Refer also to the operating instructions of your TV to balance the sound.

### Making settings for digital audio input

Select to suit the type of audio from the OPTICAL IN terminal on the main unit.

- While in "D-IN" mode  
 Press [SETUP] to select "MAIN/SAP", "DRC" or "PCM FIX".
- While the selected mode is displayed  
 Press [▲, ▼] to make the setting.

**MAIN/SAP mode** (Only works with Dolby Dual Mono):

- MAIN, SAP\***, MAIN+SAP\* (stereo audio)
- \* "SAP" = Secondary Audio Program

**Dynamic Range Compression**

- DRC ON:** Adjust for clarity even when the volume is low by compressing the range of the lowest sound level and the highest sound level. Convenient for late night viewing. (Only works with Dolby Digital)

**DRC OFF:** The full dynamic range of the signal is reproduced.

**PCM FIX mode**

- PCM ON:** Select when receiving only PCM signals.
- PCM OFF:** Select when receiving Dolby Digital and PCM signals.

(When receiving true 5.1-channel surround sound, select "PCM OFF".)

### Note

- Audio that is input through the OPTICAL IN terminal is not output from the HDMI terminal.
- Underlined items in the above are factory settings.

# Enjoying sound from all speakers and various sound effects

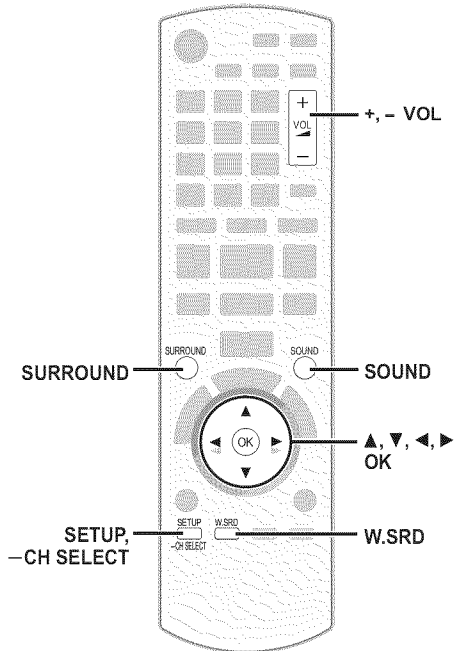

- The following sound effects may not be available or have no effect with some sources, or when headphones are used (⇒ 39).
- You may experience a reduction in sound quality when these sound effects are used with some sources. If this occurs, turn the sound effects off.

**Recommended modes to enjoy TV audio or stereo sources from all speakers:**

- PLII MOVIE
- PLII MUSIC
- S.SRND

## Selecting sound mode

- 1** **SOUND**

Select a sound mode.  
Each time you press the button:  
**EQ:** Equalizer  
**SUBW LVL:** Subwoofer Level  
**C.FOCUS:** Center Focus
- 2** **While the selected mode is displayed**

**Make settings.**  
Refer to the followings for setting details of each sound effect.

**Equalizer**  
You can select sound quality settings.  
Each time you press [◀, ▶]:  
**HEAVY:** Adds punch to rock.  
**CLEAR:** Clarifies higher sounds.  
**SOFT:** For background music.  
**FLAT:** Cancel (no effect is added).

**Subwoofer level**  
You can adjust the amount of bass. The unit automatically selects the most suitable setting according to the type of playback source.  
SUB W 1 ↔ SUB W 2 ↔ SUB W 3 ↔ SUB W 4  
↑

- The setting you make is retained, and recalled every time you play the same type of source.

**Center Focus**  
(Effective when playing audio containing center channel sound or when "□□PLII" lights in the main unit display.)  
You can make the sound of the center speaker seem like it is coming from within the TV.  
C.FOCUS ON ↔ C.FOCUS OFF

## Enjoying surround sound effects

**SURROUND**

SURROUND OUTPUT indicator on the main unit will light up when there is surround sound effect.

Each time you press the button:  
**STANDARD:**  
Sound is output as it was recorded/encoded. Speaker output varies depending on the source.  
**MULTI-CH:**  
You can enjoy sound from the front speakers, as well as the surround speakers even when playing a 2-channel sound or non-surround sound.  
**MANUAL:** (⇒ below)

**While "MANUAL" is displayed**

**Select other surround modes.**

Each time you press [◀, ▶]:  
**PLII MOVIE**™  
Suitable for movie software, or the one recorded in Dolby Surround.  
**PLII MUSIC**™  
Adds 5.1-channel effects to stereo sources.  
**S.SRND**  
You can enjoy sound from all speakers with stereo sources. (Surround output will be in mono.)  
**STEREO**  
Sound will be output to the front speakers and the subwoofer only for any source.

## Whisper-mode Surround

You can enhance the surround effect for low volume 5.1-channel sound. (Convenient for late night viewing.)

**W.SRD**

- "(( ))" lights when there is effect.

**WHISPER-MODE SRD ON**  
↓  
**WHISPER-MODE SRD OFF**

**WHISPER-MODE SRD OFF**

\* "□□PLII" lights in the main unit's display when there is effect.



## Adjusting the speaker output level manually

### Preparation

- To display the picture, turn on the TV and select the appropriate video input mode.
- Press [+ , - VOL] to adjust the volume to normal listening level.
- Select "TEST TONE" from "SPEAKER SETTINGS" in AUDIO menu (⇒ 29).

**1** Enter test tone mode.

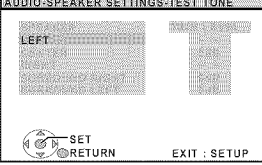

e.g. 

Test tone will be output to each channel in the following order:  
LEFT, CENTER, RIGHT,  
SURROUND RIGHT, SURROUND LEFT

**2** Adjust the speaker level for each speaker. (CENTER, SURROUND RIGHT, SURROUND LEFT)



-6 dB to +6 dB (Factory preset: 0 dB)

- To exit the screen, press [SETUP].

### To adjust speaker level during play

(Effective when playing 5.1-channel sound or when "DOLBY" lights.)

- 1 **Press and hold [—CH SELECT] to select the speaker.**  
While the speaker channel is displayed, press [—CH SELECT].  
L → C → R → RS → LS → SW

  - You can adjust SW (Subwoofer) only if the disc includes a subwoofer channel and "DOLBY" is not lit.
  - "S" appears on the main unit's display when you have selected "S.SRND" (⇒ 16, Enjoying surround sound effects). In this case, you can adjust both surround speaker levels at the same time using [▲, ▼].  
S: -6 dB to +6 dB

- 2 **Press [▲] (increase) or [▼] (decrease) to adjust the speaker level for each speaker.**  
C, RS, LS, SW: -6 dB to +6 dB  
(L, R: Only the balance is adjustable.)

To adjust the balance of the front speakers, while "L" or "R" is selected, press [◀, ▶].

# Basic play

If you are experiencing problems, refer to troubleshooting (⇒ 32 to 33)

## Preparation

To display the picture, turn on your TV and change its video input mode (e.g. VIDEO 1, AV 1, HDMI, etc.) to suit the connections to this unit.

## Using the main unit



**1 Turn on the unit.**



**2 Select "DVD/CD".**



**3 Open all the disc trays.**

- To select a desired tray (⇒ below, Selecting the desired tray).
- Press [▲OPEN/CLOSE] again to close all the disc trays.

**4 Load the disc.**

- Load double-sided discs so the label for the side you want to play is facing up.
- Press [EXCHANGE] to load discs one by one.
- For DVD-RAM, remove the disc from its cartridge before use.
- Do not:
  - Load more than one disc per tray.
  - Push or pull out the tray by hand.

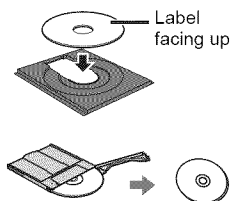

**5 Start play.**

- Turn [–, + VOLUME] to adjust the volume.

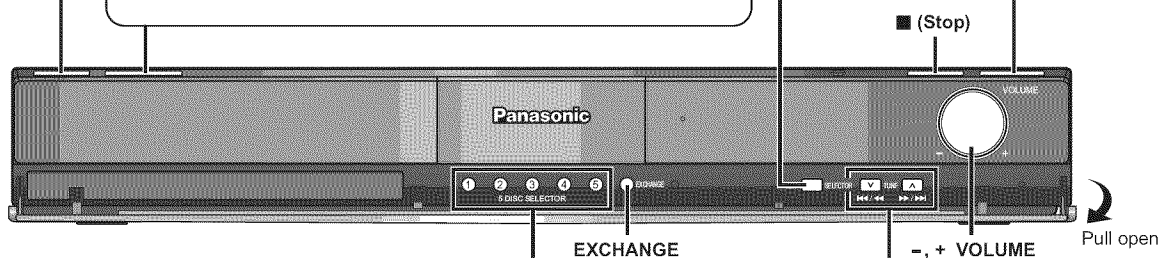

**Press to select a disc directly.**

- You can also select the disc using the remote control (⇒ 19, Selecting a disc).



**Press to skip. Press and hold to**

- search during play
- start slow-motion play during pause
- Press [▶] (Play) to start normal play.

### Selecting the desired tray

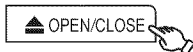

Press [▲OPEN/CLOSE] again to close the tray.

### Change discs without interrupting playback



During play,

- All trays are opened (except the tray that the disc is playing).
- Press [EXCHANGE] to close the top tray. Press again until all the trays are closed.
- Press [▲OPEN/CLOSE] to close all the open trays.

#### Note

#### DISC CONTINUES TO ROTATE WHILE MENUS ARE DISPLAYED.

To preserve the unit's motor and your TV screen, press [■] (Stop) when you are finished with the menus.

- Total title number may not be displayed properly on +R/+RW.

# Using the remote control

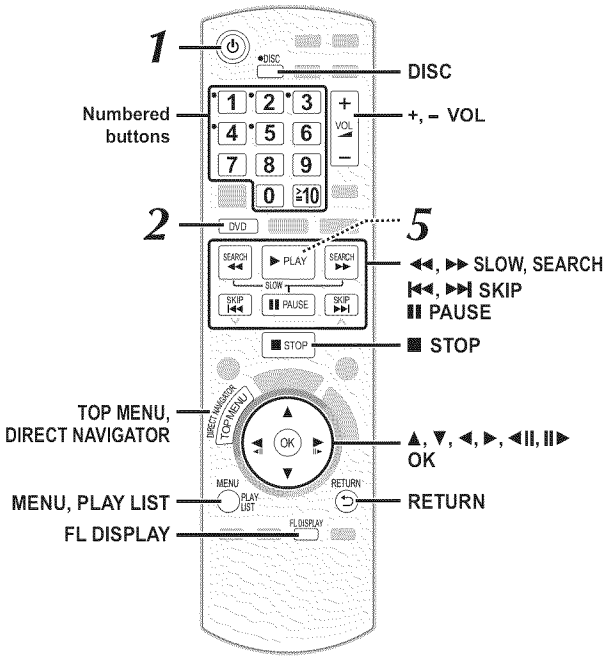

## Selecting a disc

Disc information screen is displayed.

- To exit the screen, press [DISC].
- e.g. **DVD-V**

or

**1 2 3**  
**4 5**

## Enter number

**DVD-VR** **DVD-V** **VCD** **CD**  
e.g. To select 12:  
[≥10] ⇒ [1] ⇒ [2]

**VCD** with playback control  
Press [■ STOP] to cancel the PBC function, and then press the numbered buttons.

**1 2 3**  
**4 5 6**  
**7 8 9**  
**0 ±10**

## One touch play (during standby mode)

**▶ PLAY**

(Remote control only)  
The main unit automatically turns on and starts playing the disc in the tray.

## Stop

**■ STOP**

The position is memorized while "RESUME STOP" is on the screen.

- Press [▶ PLAY] to resume.
- Press [■ STOP] again to clear the position.

## Pause

**|| PAUSE**

- Press [▶ PLAY] to restart play.

## Skip

**◀ SKIP** **▶ SKIP**

—

## Search (during play)

**◀ SEARCH** **▶ SEARCH**

- Up to 5 steps.
- Press [▶ PLAY] to start normal play.

## Slow-motion (during pause)

**SLOW**

- VCD** Slow-motion: Forward direction only.

## Frame-by-frame (during pause)

**DVD-VR** **DVD-V** **VCD**

- DVD-VR** **VCD** Forward direction only.

## On-screen item select

Select

Confirm

—

## Disc menu

**DIRECT NAVIGATOR** **TOP MENU**

**DVD-V**  
Shows a disc top menu.

**DVD-VR**  
Press the button to show the programs (⇒ 21).

**MENU** **PLAY LIST**

**DVD-V**  
Shows a disc menu.

**DVD-VR**  
Press the button to show a play list (⇒ 21).

**RETURN**

**VCD** with playback control  
Shows a disc menu.

## Return to previous screen

**RETURN**

—

## Main unit display

**DVD-VR** **DVD-V** **WMA** **MP3**  
Time display

**FL DISPLAY**  
Information display (e.g. **DVD-VR** Program number)

**SLEEP**

**JPEG**  
SLIDE ↔ Contents number

Playing Discs

# Other modes of play

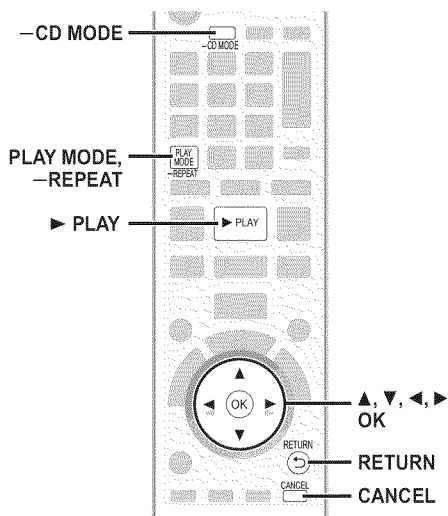

## Playing CDs sequentially (CD Mode)

VCD CD WMA MP3

This feature allows you to play all loaded CDs sequentially. Select an applicable disc before playing (⇒ 19, Selecting a disc).

### While stopped

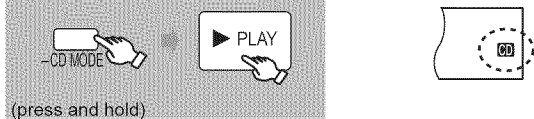

- If all loaded discs are DVDs, CD Mode does not work.
- Video CD playback control are disabled.
- You cannot turn CD Mode on or off during program or random mode.
- If you want to play a DVD, press and hold [—CD MODE] again while stopped to cancel CD Mode. (CD Mode is also canceled when you switch the unit to standby, select another source, or when the disc tray is opened.)

## Repeat play

This works only when the elapsed play time can be displayed. It also works with all JPEG content.

### 1 During play Show the repeat mode.



### 2 While the repeat mode is displayed Select an item to be repeated.

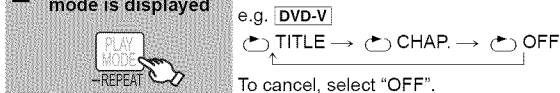

Items shown differ depending on the type of disc and playback mode.

## Program and Random play

DVD-V VCD CD WMA MP3 JPEG

To enjoy program or random play with:  
 - 1 disc : ensure CD Mode (⇒ above) is off  
 - all discs : ensure CD Mode is on

### Preparation

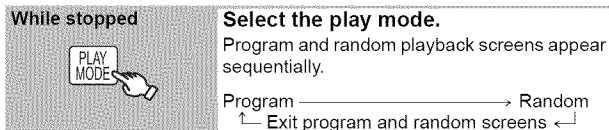

- [DVD-VR] Select "DATA" in "DVD-VR/DATA" (⇒ 29, OTHERS menu) to play WMA, MP3, JPEG contents.
- [DVD-V] Some items cannot be played even if you have programmed them.

## Program play (up to 30 items)

### ■ 1-Disc program

DVD-V VCD CD WMA MP3 JPEG You can program all the items on a disc in the selected tray.

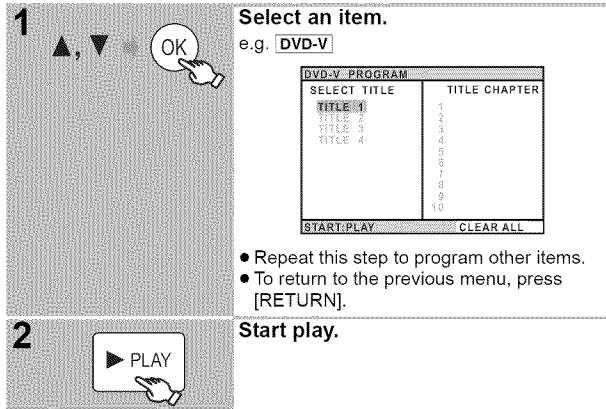

### ■ All-Disc program (when CD Mode is on)

VCD CD You can program all the items on all the discs.

- 1 Press [▲, ▼], and then press [OK] to select the disc.
- 2 Press [▲, ▼], and then press [OK] to select the track.
- 3 Repeat step 1 and 2 to program other items.
  - To return to the previous menu, press [RETURN].
- 4 Press [▶ PLAY].

### To select all the items

Press [▲, ▼] to select "ALL" and press [OK].

### To clear the selected program

- 1 Press [▶] and then press [▲, ▼] to select the program.
- 2 Press [CANCEL].

### To clear the whole program

Press [▶] several times to select "CLEAR ALL", and then press [OK]. The whole program is also cleared when the disc tray is opened, the unit is turned off or another source is selected.

## Random play

### ■ 1-Disc random

VCD CD You can playback all the items on a disc in the selected tray in random order.

DVD-V WMA MP3 JPEG You can playback selected item(s) on a disc in the selected tray in random order.

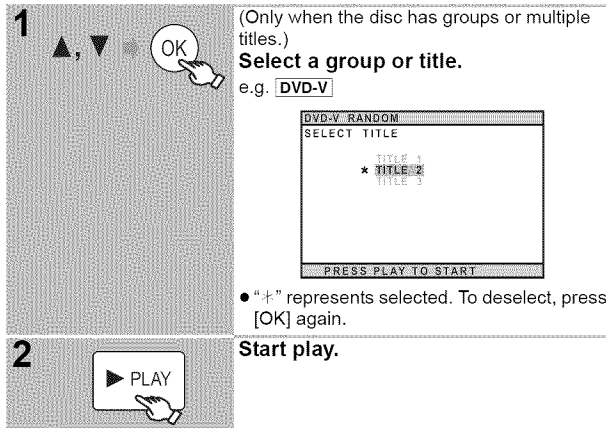

### ■ All-Disc random (when CD Mode is on)

VCD CD You can playback all the items on all the discs in random order.

Press [▶ PLAY]. e.g. CD



# Using navigation menus

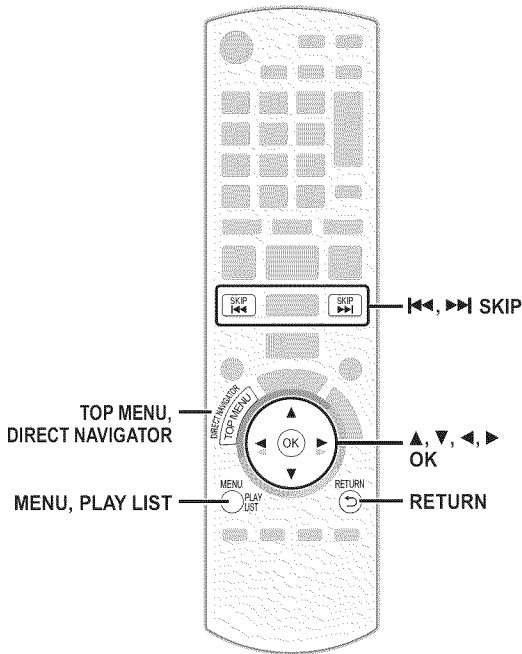

## ■ Selecting the picture in Thumbnail menu

JPEG

**1** While picture is displayed

e.g.

Group name: JPEG Images    Group and content number: G 17    1-C 3/ 9

**2** Select a picture.

- Press [SKIP] to skip page by page.

### To go to other group

- 1 Press [▲] to select the group name.
- 2 Press [◀ ▶] to select the group and press [OK].

## Playing RAM and DVD-R/-RW (DVD-VR) discs

DVD-VR

- Titles appear only if the titles are recorded on the disc.
- You cannot edit programs, play lists and disc titles.

### Playing the programs

**1** While stopped

e.g.

PG	DATE	LENGTH	TITLE
1	10/11 02:15	0:16:02	LIVE CONCERT
2	12/05 01:30	0:38:25	AUTO ACTION
3	04/03 02:10	1:16:05	CINEMA

• To exit the screen, press [DIRECT NAVIGATOR].

**2** Select the program.

- Press [◀ ▶] to skip page by page.

## Playing data discs

WMA MP3 JPEG

[DVD-VR] Select "DATA" in "DVD-VR/DATA" (⇒ 29, OTHERS menu) to play WMA, MP3, JPEG contents.

### Playing from the selected item

You can select to play from your desired item while the "DATA-DISC" screen is displayed.

e.g.

**Group (Folder):**

**Content (File):**

WMA/MP3

JPEG

- To display/exit the screen, press [MENU].

**Select an item.**

- Press [◀ ▶] to skip page by page.
- To return to 1 level up from the current folder, press [RETURN].
- Maximum: 28 characters for file/folder name.

Play starts from the selected content.

### Playing a play list

This works only when the disc contains a play list.

**1** While stopped

e.g.

PL	DATE	LENGTH	TITLE
1	11/11 00:01	0:00:10	CITY PENGUIN
2	12/01 01:20	0:01:20	FOOTBALL
3	01/02 01:10	1:10:04	SPECIAL

• To exit the screen, press [PLAY LIST].

**2** Select the play list.

- Press [◀ ▶] to skip page by page.

# Using on-screen menus

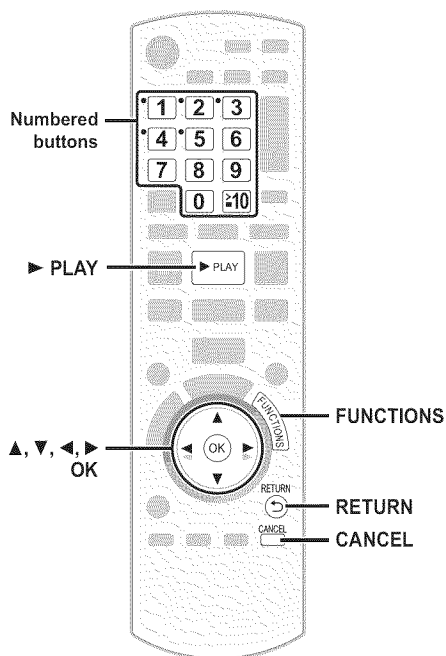

Items shown differ depending on the type of disc.

## Menu 1 (Disc/Play)

- TRACK SEARCH** To start from a specific item
- TITLE SEARCH**
  - **VCD** This does not work when using playback control.
- CONTENT SEARCH** e.g. **DVD-V**: T2 C5
- CHAPTER SEARCH**
- PG SEARCH** To select numbers for data disc
- (Program Search)** e.g. 123: [≥10] → [1] → [2] → [3] → [OK]
- PL SEARCH** (Playlist Search)

## AUDIO

- DVD-V** (with multiple soundtracks)
- To select audio soundtrack
- DVD-VR** **VCD**
- To select "L", "R", "L+R" or "L R"
- DVD-V** (Karaoke disc)
- To select "ON" or "OFF" for vocals
- To select "OFF", "V1", "V2" or "V1+V2" for vocal selections
- Actual operations depend on the disc. Read the disc's instructions for details.

**Signal type/data**  
LPCM/PPCM/DSD/DTS/MP3/MPEG: Signal type  
kHz (Sampling frequency)/bit/ch (Number of channels)

- e.g. 3/2, 1ch
- .1: Low frequency effect  
(not displayed if there is no signal)
  - 0: No surround
  - 1: Mono surround
  - 2: Stereo surround (left/right)
  - 1: Center
  - 2: Front left+ Front right
  - 3: Front left+ Front right+ Center

### 1 Show the on-screen menu.

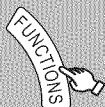

Each time you press the button:  
Menu 1 (Disc/Play)  
Menu 2 (Video)  
Menu 3 (Audio)  
Menu 4 (HDMI)  
Exit

e.g. Menu 1 (Disc/Play) **DVD-V**

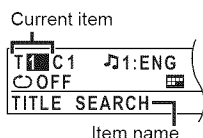

### 2 Select the item.



e.g. Menu 1 (Disc/Play) **DVD-V**

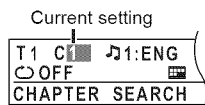

### 3 Make the settings.



### 4 Exit.



## PLAY SPEED

- DVD-VR** **DVD-V**
- To change play speed
- from "×0.6" to "×1.4" (in 0.1-unit steps)
- Press **▶** [PLAY] to return to normal play.
- After you change the speed
  - Dolby Pro Logic II has no effect.
  - Audio output switches to 2-channel stereo.
  - Sampling frequency of 96 kHz is converted to 48 kHz.
- This function may not work depending on the disc's recording.

## REPEAT MODE

- (⇒ 20, Repeat play)
- A-B Repeat** (To repeat a specified section)
- Except **JPEG** **DVD-VR** (Still picture part)
- VCD** (SVCD)
- Press [OK] at the starting and ending points.
- Select "OFF" to cancel.

## SUBTITLE

- DVD-V** (with multiple subtitles)
- VCD** (SVCD only)
- To select subtitle language
- On +R/+RW, a subtitle number may be shown for subtitles that are not displayed.
- DVD-VR** (with subtitle on/off information)
- To select "ON" or "OFF"
- This may not work depending on the disc.

## ANGLE

- DVD-V** (with multiple angles)
- To select a video angle

## DATE DISPLAY

- JPEG** To select "ON" or "OFF" for picture's date display

## ROTATION

To rotate a picture (during pause)

JPEG:  
0 ← 90 ← 180 ← 270  
↑

## Menu 2 (Video)

### PICTURE MODE

- NORMAL**
- CINEMA1:** Mellows images and enhances detail in dark scenes.
- CINEMA2:** Sharpens images and enhances detail in dark scenes.
- DYNAMIC:** Enhances the contrast for powerful images.
- ANIMATION:** Suitable for animation.

### ZOOM

To select zoom sizes  
NORMAL, AUTO (DVD-VR DVD-V VCD), ×2, ×4  
• JPEG: during pause

### TRANSFER MODE

If you have chosen "480p"/"720p"/"1080p" (progressive), "1080i" (interlaced) ["VIDEO FORMAT" in Menu 4 (HDMI)] or "PROGRESSIVE" under "VIDEO OUT (I/P)" (⇒ 28, VIDEO menu), select the method of conversion for progressive output to suit the type of material.

- The setting will return to "AUTO1" when the disc tray is opened, the unit is turned off or another source is selected.

- AUTO1:** Automatically detects the film and video content, and appropriately converts it.
- AUTO2:** In addition to "AUTO1", automatically detects film contents with different frame rates and appropriately converts it.
- VIDEO:** Select if the video content is distorted when using "AUTO1" or "AUTO2".

## Menu 3 (Audio)

### DIALOGUE ENHANCER

To make the dialogue in movies easier to hear  
DVD-V (Dolby Digital, DTS, 3-channel or higher, with the dialogue recorded in the center channel)  
OFF, ON

## Menu 4 (HDMI)

### HDMI

To show HDMI information.  
(⇒ below, Confirming HDMI information)

### HDMI STATUS



### HD ENHANCER

This works when the HDMI connection is being used with "VIDEO PRIORITY" (⇒ 29, HDMI menu) set to "ON".

To sharpen the "720p", "1080i" and "1080p" picture quality  
OFF, 1 (weakest) to 3 (strongest)



### VIDEO FORMAT

This works when the HDMI connection is being used with "VIDEO PRIORITY" (⇒ 29, HDMI menu) set to "ON".

To select suitable picture quality with your TV (Video recordings will be converted to, and output as, high-definition video.)

- \* 480p/720p/1080p (progressive)
- \* 480i/1080i (interlaced)

- If the picture is distorted, press and hold [CANCEL] until the picture is displayed correctly. (The output will return to "480p".)

- \* The numbers displayed depend on the disc being played. One of the above numbers is displayed.



### COLOR SPACE

This works when the HDMI connection is being used with "VIDEO PRIORITY" (⇒ 29, HDMI menu) set to "ON".

To select suitable picture color with your TV  
YCbCr 4:2:2\*

– Luminance and color details are sent separately. Most of the picture details are in luminance. The color rate is much higher than composite video. Compatible for all TV models.

YCbCr 4:4:4\*

– All color details are sent. Luminance and color details are in same signal.

### RGB

– Component video type of signal.

- If the setting above is not compatible with your TV, it will not be displayed.

- \* Terms are descriptions of the sample formats used in digital video. YCbCr is a video signal for luminance (Y), blue (Cb) and red (Cr) details.

## Confirming HDMI information

e.g.

HDMI – INFORMATION	
①	CONNECTED STATE    CONNECTED
②	AUDIO STREAM        PCM
③	MAX CHANNEL        2ch
④	VIDEO FORMAT        720p
⑤	COLOR SPACE         YCbCr 4:4:4

- ① Connection status
- ② Shows the output signal type.
- ③ Shows the number of audio channels.
- ④ (⇒ above, VIDEO FORMAT)
- ⑤ (⇒ above, COLOR SPACE)

### Note

When "OFF" is selected in "AUDIO OUT" (⇒ 29, HDMI menu), "– – –" will be displayed in "AUDIO STREAM".

# Using the VIERA Link™ “HDAVI Control™”

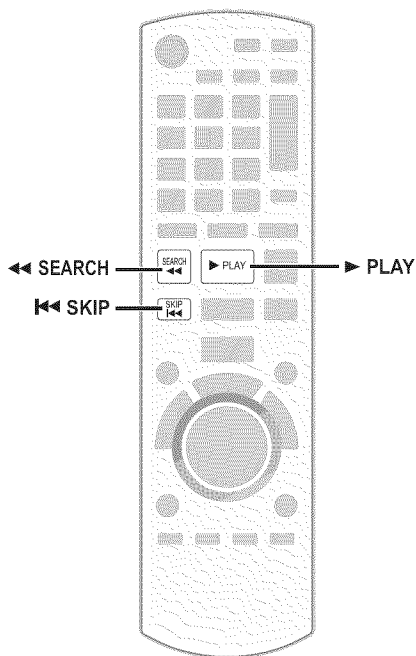

## VIERA Link “HDAVI Control”

VIERA Link™ is a new name for EZ Sync™.

VIERA Link “HDAVI Control” is a convenient function that offers linked operations of this unit, and a Panasonic TV (VIERA) under “HDAVI Control”. You can use this function by connecting the equipment with the HDMI cable. See the operating instructions for connected equipment for operational details.

- VIERA Link “HDAVI Control”, based on the control functions provided by HDMI which is an industry standard known as HDMI CEC (Consumer Electronics Control), is a unique function that we have developed and added. As such, its operation with other manufacturers’ equipment that supports HDMI CEC cannot be guaranteed.
- This unit supports “HDAVI Control 4” function. “HDAVI Control 4” is the newest standard (current as of December, 2008) for Panasonic’s HDAVI Control compatible equipment. This standard is compatible with Panasonic’s conventional HDAVI equipment.
- Please refer to individual manuals for other manufacturers’ equipment supporting VIERA Link function.

The TV with “HDAVI Control 2 or later” function enables the following operation: VIERA Link Control only with TV’s remote control (for “HDAVI Control 2 or later”) (⇒ 25)

## Preparation

- Confirm that the HDMI connection has been made (⇒ 9).
- Set “VIERA Link” to “ON” (⇒ 29, HDMI menu).
- To complete and activate the connection correctly, turn on all VIERA Link “HDAVI Control” compatible equipment and set the TV to the corresponding HDMI input mode for this unit.

## Setting the TV audio for VIERA Link “HDAVI Control”

Select between “AUX” and “DIGITAL IN” to work with the linked operations. Refer to TV audio setting in Smart setup (⇒ 12) or “TV AUDIO” in HDMI menu (⇒ 29).

Confirm the audio connection to the AUX terminal (for “AUX”) or OPTICAL IN terminal (for “DIGITAL IN”) (⇒ 9).

Whenever the connection or settings are changed, reconfirm the points above.

\* “AUX” or “D-IN” (“DIGITAL IN”) works depending on the TV audio setting (⇒ above, Setting the TV audio for VIERA Link “HDAVI Control”).

## Auto lip sync

(Available when using VIERA Link “HDAVI Control” with “HDAVI Control 3 or later” compatible TV)

This function automatically provides synchronized audio and video output. (This works only when the source is “DVD/CD”, “AUX” or “D-IN”.)

- When using “DVD/CD” as the source, set “TIME DELAY” in VIDEO menu to “0 ms/AUTO” (⇒ 28).

## One touch play

You can turn on this unit and the TV, and start playing the disc with a single press of a button.

During standby mode



(Remote control only)

### Start disc playback.

This unit’s speakers will be automatically activated (⇒ 25).

## Note

Playback may not be immediately displayed on the TV. If you miss the beginning portion of playback, press [◀◀] or [◀◀] to go back to where playback started.

## Auto input switching

- When you switch the TV input to TV tuner mode, this unit will automatically switch to “AUX”\* or “D-IN”\*. (For “IPOD” mode, this works only in iPod music mode, or when iPod is not connected.)
- When you start disc play, the TV will automatically switch its input mode for this unit.

## Power off link

When the TV is turned off, this unit goes into standby mode automatically. To continue audio playback even when the TV is turned off, select “VIDEO” (⇒ 29, “POWER OFF LINK” in HDMI menu).

## Note

- When you press [⏻], only this unit turns off. Other connected equipment compatible with VIERA Link “HDAVI Control” stays on.
- If this unit is connected to a “HDAVI Control 4” compatible TV with the “Auto power standby” setting activated on the TV, the main unit will be automatically turned to standby under the following conditions:  
e.g.,
  - when changing the TV input from the one the main unit is connected
  - when changing the speaker use from this unit’s speaker to the TV speakers

For details, refer also to the operating instructions of your TV.



## Speaker control

You can select whether audio is output from this unit's speakers or the TV speakers by using the TV menu settings. For details, refer to the operating instructions of your TV.

### Home theater

This unit's speakers are active.

- When you turn on this unit, this unit's speakers will be automatically activated.
- When this unit is in standby mode, changing the TV speakers to this unit's speakers in the TV menu will automatically turn this unit on and select "AUX"\* or "D-IN"\* as the source.
- The TV speakers are automatically muted.
- You can control the volume setting using the volume or mute button on the TV's remote control. (The volume level is displayed on the main unit's display.)
- To cancel muting, you can also use this unit's remote control (⇒ 38).
- If you turn off this unit, TV speakers will be automatically activated.

### TV

TV speakers are active.

- The volume of this unit is set to "0".
  - This function works only when "DVD/CD", "AUX"\* or "D-IN"\* is selected as the source on this unit.
- Audio output is 2-channel audio.

When switching between this unit's speakers and TV speakers, the TV screen may be blank for several seconds.

## VIERA Link Control only with TV's remote control (for "HDAVI Control 2 or later")

You can control the playback menus of this unit with the TV's remote control. When operating the TV's remote control, refer to the below illustration for operation buttons.

- 1 Select this unit's operation menu by using the TV menu settings. (For details, refer to the operating instructions of your TV.)

The START menu will be shown.

e.g. **DVD-V**

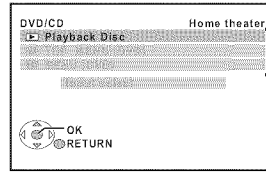

- The START menu can also be shown by using a button on the TV's remote control (e.g. [SUB MENU]).
  - When "DVD/CD" is selected as the source, this works only during stop mode.
  - This does not work while iPod music playback screen is displayed on the TV.

- 2 Select the desired item on the START menu (⇒ 15).

When the on-screen control panel appears

e.g. **DVD-V** (when "Playback Disc" is selected from the START menu.)

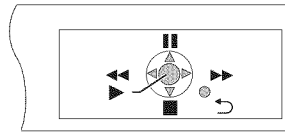

You can operate the playback with the indicated controls.

- The on-screen control panel can also be shown by using a button on the TV's remote control (e.g. [SUB MENU]).
  - This works only during "DVD/CD" playback and resume modes or, while iPod music playback screen is displayed on the TV.

### Note

- Depending on the menu, some button operations cannot be performed from the TV's remote control.
- You cannot input numbers with the numbered buttons on the TV's remote control ([0] to [9]). Use this unit's remote control to select the play list etc.

# Using the iPod

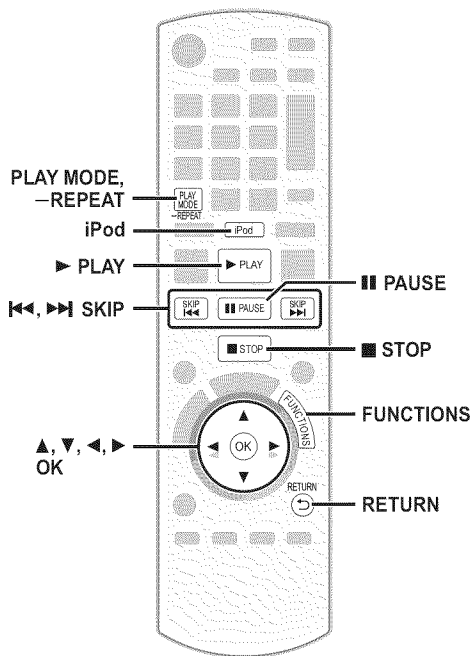

You can enjoy iPod music through this unit's speakers or view iPod videos/photos on the TV.

## Preparation

- To view photos/videos from the iPod
  - Ensure the video connection to the VIDEO OUT terminal on this unit (⇒ 9).
  - Operate the iPod menu to make the appropriate photo/video output settings for your TV. (Refer to operating instructions of your iPod.)
- To display the picture, turn on the TV and select the appropriate video input mode.
- Before connecting/disconnecting the iPod, turn the main unit off or reduce the volume of the main unit to its minimum.

## Connect the iPod (not included) firmly.

Recharging starts when the iPod is inserted.

e.g.

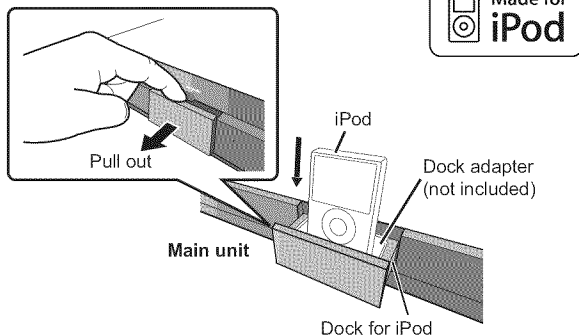

- Attach the dock adapter which should be supplied with your iPod to the dock for the stable use of the iPod. If you need an adapter, consult your iPod dealer.

**Select "IPOD".**

The iPod automatically switches to this unit's display mode. Music menu appears on the TV.

e.g.

---

**Select the menu.**

Each time you press the button:

Music menu → Video menu  
 iPod menu (iPod LCD) ←

## When using the START menu in "IPOD" mode

e.g.

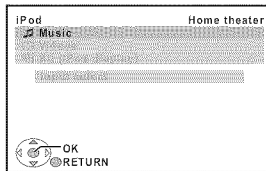

- Music:** Shows the music menu.
- Videos:** Shows the video menu.
- All (iPod display):** Switches to iPod menu.

## Enjoying music/videos

1

**Select music or video menu on the TV.**

---

2

**Select an item.**

- Press [◀, ▶] to skip page by page.
- To return to the previous screen, press [RETURN].

Play starts from the selected song or video.

e.g. music playback screen

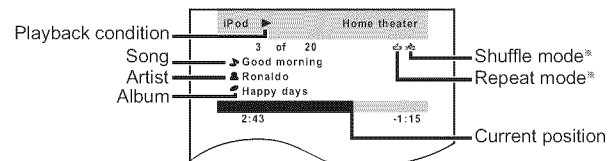

\* These icons will only appear for music mode.

- : Song shuffle
- : Repeat 1 song
- : Album shuffle
- : Repeat all

## Basic controls (For music and videos only)

Button	Function
[▶ PLAY]	Play
[■ STOP], [   PAUSE]	Pause
[◀◀, ▶▶ SKIP]	Skip
(press and hold) [◀◀, ▶▶ SKIP]	Search

## Other methods of playback

### Shuffle mode (For music playback only)

Press [PLAY MODE] several times. SONGS, ALBUMS, OFF

### Repeat mode

Press and hold [—REPEAT] and then press the button several times within a few seconds.

During the music/video playback: ONE, ALL, OFF

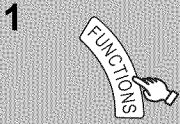

**1** Select the iPod menu.

**2** Play a slideshow on your iPod.

- You can use the remote control to operate the iPod menu.
- [▲ ▼]: To navigate menu items.
  - [OK]: To go to the next menu.
  - [RETURN]: To return to the previous menu.

**While an iPod is connected**

- Do not push the Dock for iPod.

**DO NOT**

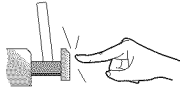

- Do not push or pull your iPod back and forth with great force.

**DO NOT**

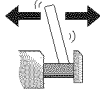

**About recharging the battery**

- iPod will start recharging regardless of whether this unit is on or off.
- "iPOD ⚡" will be shown on the main unit's display during iPod charging in main unit standby mode.
- Check iPod to see if the battery is fully recharged.
- If you are not using iPod for an extended period of time after recharging has completed, disconnect it from main unit, as the battery will be depleted naturally. (Once fully recharged, additional recharging will not occur.)

**Compatible iPod**

- iPod touch 2nd generation (8GB, 16GB, 32GB)
- iPod nano 4th generation (video) (8GB, 16GB)
- iPod classic (120GB)
- iPod touch 1st generation (8GB, 16GB, 32GB)
- iPod nano 3rd generation (video) (4GB, 8GB)
- iPod classic (80GB, 160GB)
- iPod nano 2nd generation (aluminum) (2GB, 4GB, 8GB)
- iPod 5th generation (video) (60GB, 80GB)
- iPod 5th generation (video) (30GB)
- iPod nano 1st generation (1GB, 2GB, 4GB)
- iPod 4th generation (color display) (40GB, 60GB)
- iPod 4th generation (color display) (20GB, 30GB)
- iPod 4th generation (40GB)
- iPod 4th generation (20GB)
- iPod mini (4GB, 6GB)

Compatibility depends on the software version of your iPod.

# Speaker installation options

**Attaching to a wall**

You can attach all of the speakers (except subwoofer) to a wall.

- The wall or pillar on which the speakers are to be attached should be capable of supporting 10 kg (22 lbs) per screw. Consult a qualified building contractor when attaching the speakers to a wall. Improper attachment may result in damage to the wall and speakers.

① Drive a screw (not included) into the wall.

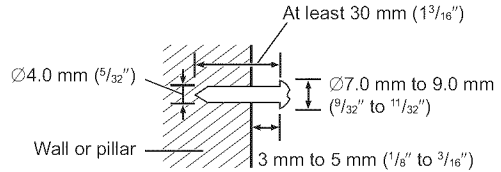

② Fit the speaker securely onto the screw(s) with the hole(s).

**Front speaker**

Attach to a wall without the base and the stand

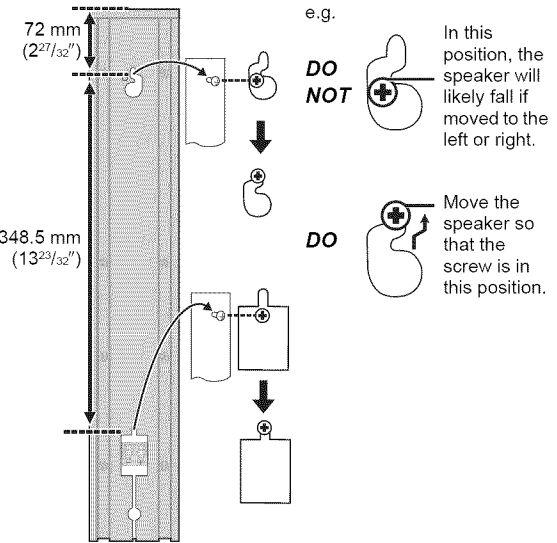

**Surround speaker**

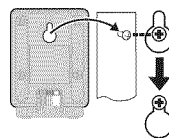

**Center speaker**

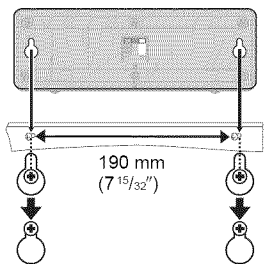

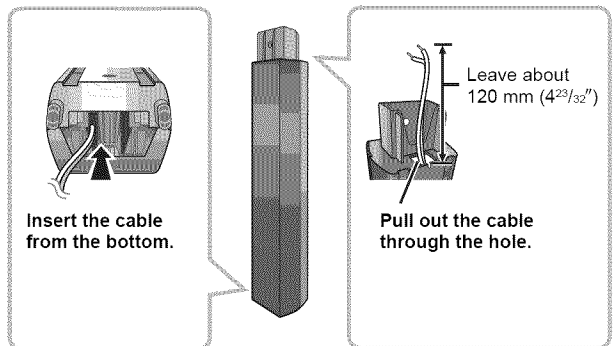

**Reattaching the speaker cable**



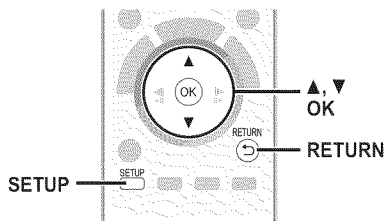

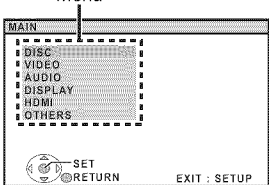

# Changing the player settings

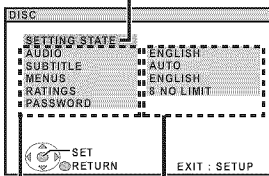

- 1 Show the setup menu.**  

- 2 Select the menu.**  

Display the current setting of the items below



Item                      Setting
- 3 Select the item.**  

- 4 Make the settings.**  

- 5 Exit.**  

- The settings remain intact even if you switch the unit to standby.
- Underlined items are the factory settings in the following menus.

## DISC menu

### AUDIO

Choose the audio language.

- ENGLISH      • FRENCH      • SPANISH
- ORIGINAL\*1    • OTHER ---\*2

### SUBTITLE

Choose the subtitle language.

- AUTO\*3      • ENGLISH      • FRENCH      • SPANISH
- OTHER ---\*2

### MENUS

Choose the language for disc menus.

- ENGLISH      • FRENCH      • SPANISH
- OTHER ---\*2

\*1 The original language designated on the disc is selected.

\*2 Input the appropriate code from the language code list (→ 39).

\*3 If the language selected for "AUDIO" is not available, subtitles appear in that language (if available on the disc).

## RATINGS

Set a rating level to limit DVD-Video play.

Setting ratings (When level 8 is selected)

- 0 LOCK ALL: To prevent play of discs without rating levels.
- 1 to 7
- 8 NO LIMIT

When you select your ratings level, a password screen is shown.

Follow the on-screen instructions.

**Do not forget your password.**

A message screen will be shown if a DVD-Video disc exceeding the rating level is inserted in the unit.

Follow the on-screen instructions.

## PASSWORD

Change the password for "RATINGS".

- SETTING

To change ratings (When level 0 to 7 is selected)

- CHANGE: Follow the on-screen instructions.

## VIDEO menu

### TV ASPECT

Choose the setting to suit your TV.

- 16:9: Widescreen TV (16:9)

- 4:3PAN&SCAN: Regular aspect TV (4:3)

The sides of the widescreen picture are cut off so it fills the screen (unless prohibited by the disc).



- 4:3LETTERBOX: Regular aspect TV (4:3)

Widescreen picture is shown in the letterbox style.



### TIME DELAY

When connected with a Plasma display, adjust if you notice the audio is out of sync with the video.

- 0 ms/AUTO      • 20 ms      • 40 ms      • 60 ms
- 80 ms              • 100 ms

When using VIERA Link "HDAVI Control" with "HDAVI Control 3 or later" compatible TV, select "0 ms/AUTO".

Audio and video will automatically be set in sync.

### STILL MODE

Specify the type of picture shown when paused.

- AUTO
- FIELD\*: The picture is not blurred, but picture quality is lower.
- FRAME\*: Overall quality is high, but the picture may appear blurred.

\* Refer to "Frame still and field still" (→ 4, Glossary).

### BLACK LEVEL

Change the black level of the picture.

- LIGHTER
- DARKER

### VIDEO OUT (I/P)

Select "PROGRESSIVE" only if connecting to a progressive output compatible TV.

- INTERLACE
- PROGRESSIVE: A message screen will appear. Follow the on-screen instructions.

## AUDIO menu

Select to suit the type of equipment you connected to the HDMI AV OUT terminal.

Select "BITSTREAM" when the equipment can decode the bitstream (digital form of 5.1-channel data). Otherwise, select "PCM". (If the bitstream is output to the equipment without a decoder, high levels of noise can be output and may damage your speakers and hearing.)

### DOLBY DIGITAL\*

- **BITSTREAM**
- **PCM**

### DTS\*

- **BITSTREAM**
- **PCM**

\* When audio is output from HDMI AV OUT terminal, and the connected equipment does not support the item selected, the actual output will depend on the performance of this connected equipment.

### DYNAMIC RANGE

- **ON**: Adjusts for clarity even when the volume is low. Convenient for late night viewing. (Only works with Dolby Digital)
- **OFF**

### SPEAKER SETTINGS

Select the delay time of the speakers.

(Effective when playing 5.1-channel sound)

(Center and surround speakers only)

For optimum listening with 5.1-channel sound, all the speakers, except for the subwoofer, should be the same distance from the seating position. If you have to place the center or surround speakers closer to the seating position, adjust the delay time to make up for the difference.

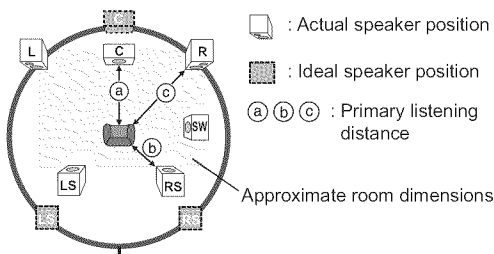

Circle of constant primary listening distance

If either distance (a) or (b) is less than (c), find the difference in the table and change to the recommended setting.

Ⓐ Center speaker		Ⓑ Surround speaker	
Difference (Approx.)	Setting	Difference (Approx.)	Setting
30 cm (1 foot)	1ms	150 cm (5 feet)	5ms
60 cm (2 feet)	2ms	300 cm (10 feet)	10ms
90 cm (3 feet)	3ms	450 cm (15 feet)	15ms
120 cm (4 feet)	4ms		
150 cm (5 feet)	5ms		

### ● SETTINGS:

- **C DELAY** (Center Delay): 0ms, 1ms, 2ms, 3ms, 4ms, 5ms  
Select the delay time for your center speaker.
- **LS/RS DELAY** (Left Surround/Right Surround Delay): 0ms, 5ms, 10ms, 15ms  
Select the delay time for your surround speakers.
- **TEST TONE: SETTING**  
Use the test tone for speaker level adjustments (⇒ 17, Adjusting the speaker output level manually).

## DISPLAY menu

### LANGUAGE

Choose the language for the on-screen messages.

- **ENGLISH**
- **FRANÇAIS**
- **ESPAÑOL**

## HDMI menu

### VIDEO PRIORITY

- **ON**: When using the HDMI AV OUT terminal for video output. The resolution of the video output from the HDMI AV OUT terminal is optimized according to the capability of the connected equipment (e.g. TV).

- **OFF**: When not using the HDMI AV OUT terminal for video output. Video output will not depend on the connected equipment, but on this unit.

### AUDIO OUT

- **ON**: When audio output is from the HDMI AV OUT terminal. (Depending on the capabilities of the connected equipment, audio output may differ from the audio settings of the main unit.)
- **OFF**: When audio output is not from the HDMI AV OUT terminal. (The audio is output using the settings of the main unit.)

### RGB RANGE

This works only when "COLOR SPACE" in Menu 4 (HDMI) is set to RGB (⇒ 23).

- **STANDARD**
- **ENHANCED**: When the black and white images are not distinct.

### VIERA Link

- **ON**: The VIERA Link "HDAVI Control" function is available (⇒ 24).
- **OFF**

### POWER OFF LINK

Select the desired power off link setting of this unit for VIERA Link operation (⇒ 24). (This works depending on the settings of the connected VIERA Link "HDAVI Control" compatible equipment.)

- **VIDEO/AUDIO**: When the TV is turned off, this unit will turn off automatically.
- **VIDEO**: When the TV is turned off, this unit will turn off except during the following conditions:
  - audio playback (CD MP3 WMA)
  - iPod mode
  - radio mode
  - "AUX" or "D-IN" mode (non-selected TV audio setting for VIERA Link)

### TV AUDIO

Select the TV audio input to work with the VIERA Link operations (⇒ 24).

- **AUX**
- **DIGITAL IN**

## OTHERS menu

### JPEG TIME

Set the speed of the slideshow.

Factory preset: 3 SEC

- 1 SEC to 15 SEC (in 1-unit steps)
- 15 SEC to 60 SEC (in 5-unit steps)
- 60 SEC to 180 SEC (in 30-unit steps)

### FL DIMMER

Change the brightness of the unit's display and indicator.

- **BRIGHT**
- **DIM**: The display is dimmed. (SURROUND OUTPUT indicator will turn off even if it is activated.)
- **AUTO**: The display is dimmed, but brightens when you perform some operations. (The SURROUND OUTPUT indicator will turn on if it is activated, when you perform some operations.)

### DVD-VR/DATA

Select to play only DVD-VR or DATA format.

- **DVD-VR**: To play the video programs on DVD-RAM or DVD-R/RW.
- **DATA**: To play the data files on DVD-RAM or DVD-R/RW.

### SCREEN DIMMER

This is to prevent burn mark on the TV screen.

- **OFF**
- **WAIT 5 MIN**: If there is no operation for 5 minutes, the picture turns gray. The TV screen would resume when you perform some operations. (This does not work during video playback.)



### DEFAULTS

This returns all values in the MAIN menu to the default settings.



- **RESET**  
The password screen is shown if "RATINGS" (⇒ 28) is set. Please enter the same password, then turn the unit off and on again.

# Discs that can be played

## Commercial discs

Disc	Logo	Indicated in these instructions by	Remarks
DVD-Video		DVD-V	High quality movie and music discs
Video CD		VCD	Music discs with video Including SVCD (Conforming to IEC62107)
CD		CD	Music discs

## Recorded discs (○: Playable, —: Not playable)

Disc	Logo	Recorded on a DVD video recorder, etc.		Recorded on a personal computer, etc.			Finalizing <sup>*6</sup>
		DVD-VR <sup>*2</sup>	DVD-V <sup>*4</sup>	WMA	MP3	JPEG	
DVD-RAM		○	—	—	○	○	Not necessary
DVD-R/RW		○	○	—	○	○	Necessary
DVD-R DL		○ <sup>*3</sup>	○	—	—	—	Necessary
+R/+RW	—	—	(○) <sup>*5</sup>	—	—	—	Necessary
+R DL	—	—	(○) <sup>*5</sup>	—	—	—	Necessary
CD-R/RW <sup>*1</sup>	—	—	—	○	○	○	Necessary <sup>*7</sup>

● It may not be possible to play all the above-mentioned discs in some cases due to the type of disc, the condition of the recording, the recording method, or how the files were created (⇒ 31, Tips for making data discs).

\*1 This unit can play CD-R/RW recorded with CD-DA or Video CD format.

\*2 Discs recorded on DVD recorders or DVD video cameras, etc. using Version 1.1 of the Video Recording Format (a unified video recording standard).

\*3 Discs recorded on DVD recorders or DVD video cameras using Version 1.2 of the Video Recording Format (a unified video recording standard).

\*4 Discs recorded on DVD recorders or DVD video cameras using DVD-Video Format.

\*5 Recorded using a format different from DVD-Video Format, therefore some functions cannot be used.

\*6 A process that allows play on compatible equipment. To play a disc that is indicated as "Necessary", the disc must first be finalized on the device it was recorded on.

\*7 Closing the session will also work.

### Note about using a DualDisc

The digital audio content side of a DualDisc does not meet the technical specifications of the Compact Disc Digital Audio (CD-DA) format so playback may not be possible.

### Discs that cannot be played

Blu-ray, HD DVD, AVCHD discs, DVD-RW version 1.0, DVD-Audio, DVD-ROM, CD-ROM, CDV, CD-G, SACD, DivX Video Discs and Photo CD, DVD-RAM that cannot be removed from their cartridge, 2.6 GB and 5.2 GB DVD-RAM, and "Chaaji VCD" available on the market including VCD, DVCD and SVCD that do not conform to IEC62107.

### Disc handling precautions

- Do not attach labels or stickers to discs. This may cause disc warping, rendering it unusable.
- Do not write on the label side with a ball-point pen or other writing instrument.
- Do not use record cleaning sprays, benzine, thinner, liquids which prevent static electricity, or any other solvent.
- Do not use scratch-proof protectors or covers.
- Do not use the following discs:
  - Discs with exposed adhesive from removed stickers or labels (rented discs, etc.).
  - Discs that are badly warped or cracked.
  - Irregularly shaped discs, such as heart shapes.

## Tips for making data discs

Format	Disc	Extension	Reference
WMA	CD-R/RW	“.WMA” “.wma”	<ul style="list-style-type: none"> <li>Compatible compression rate: between 48 kbps and 320 kbps</li> <li>You cannot play WMA files that are copy-protected.</li> <li>This unit does not support Multiple Bit Rate (MBR: an encoding process for audio content that produces an audio file encoded at several different bit rates).</li> </ul>
MP3	DVD-RAM DVD-R/RW CD-R/RW	“.MP3” “.mp3”	<ul style="list-style-type: none"> <li>This unit does not support ID3 tags.</li> <li>Sampling frequency and compression rate:                             <ul style="list-style-type: none"> <li>DVD-RAM, DVD-R/RW: 11.02, 12, 22.05, 24 kHz (8 to 160 kbps), 44.1 and 48 kHz (32 to 320 kbps)</li> <li>CD-R/RW: 8, 11.02, 12, 16, 22.05, 24 kHz (8 to 160 kbps), 32, 44.1 and 48 kHz (32 to 320 kbps)</li> </ul> </li> </ul>
JPEG	DVD-RAM DVD-R/RW CD-R/RW	“.JPG” “.jpg” “.JPEG” “.jpeg”	<ul style="list-style-type: none"> <li>JPEG files taken on a digital camera that conform to DCF Standard (Design rule for Camera File system) Version 1.0 are displayed.</li> <li>Files that have been altered, edited or saved with computer picture editing software may not be displayed.</li> <li>This unit cannot display moving pictures, MOTION JPEG and other such formats, still pictures other than JPEG (e.g. TIFF), or play pictures with attached audio.</li> </ul>

- There may be differences in the display order on the menu screen and computer screen.
- This unit cannot play files recorded using packet write.

### DVD-RAM

- Discs must conform to UDF 2.0.

### DVD-R/RW

- Discs must conform to UDF bridge (UDF 1.02/ISO9660).
- This unit does not support multi-session. Only the default session is played.

### CD-R/RW

- Discs must conform to ISO9660 level 1 or 2 (except for extended formats).
- This unit supports multi-session but if there are many sessions it takes more time for play to start. Keep the number of sessions to a minimum to avoid this.

## Maintenance

### To clean discs

Wipe with a damp cloth and then wipe dry.

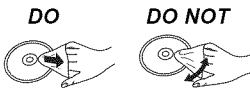

### Clean this unit with a soft, dry cloth

- Never use alcohol, paint thinner or benzene to clean this unit.
- Before using chemically treated cloth, carefully read the instructions that came with the cloth.

**Do not use commercially available lens cleaners as they may cause malfunction.** Cleaning of the lens is generally not necessary although this depends on the operating environment.

**Before moving the unit, ensure the disc trays are empty.** Failure to do so will risk severely damaging the discs and the unit.

## Product Service

- Damage requiring service**—The unit should be serviced by qualified service personnel if:
  - The AC power supply cord or AC adaptor has been damaged; or
  - Objects or liquids have gotten into the unit; or
  - The unit has been exposed to rain; or
  - The unit does not operate normally or exhibits a marked change in performance; or
  - The unit has been dropped or the cabinet damaged.
- Servicing**—Do not attempt to service the unit beyond that described in these operating instructions. Refer all other servicing to authorized servicing personnel.
- Replacement parts**—When parts need replacing ensure the servicer uses parts specified by the manufacturer or parts that have the same characteristics as the original parts. Unauthorized substitutes may result in fire, electric shock, or other hazards.
- Safety check**—After repairs or service, ask the servicer to perform safety checks to confirm that the unit is in proper working condition.

The servicer will require all components to service your system. Therefore, should service ever be necessary, be sure to bring the entire system.

### Product information

For product information or assistance with product operation:

In the U.S.A. and Puerto Rico, refer to “Customer Services Directory (United States and Puerto Rico)” on page 36.

In Canada, contact the Panasonic Canada Inc. Customer Care Centre at 1-800-561-5505, or visit the website ([www.panasonic.ca](http://www.panasonic.ca)), or an authorized Servicentre closest to you.

# Troubleshooting guide

Before requesting service, make the following checks. If you are in doubt about some of the check points, or if the solutions indicated in the following guide do not solve the problem, refer to "Customer Services Directory (United States and Puerto Rico)" on page 36 if you reside in the U.S.A. or Puerto Rico, or refer to "Product information" on page 31 if you reside in Canada. In other areas, consult your dealer.

## Power

### No power.

Insert the AC power supply cord securely. (⇒ 11)

### The unit is automatically switched to standby mode.

The Sleep timer was working and had reached the set time limit. (⇒ 38)

## Unit displays

### The display is dark.

Select "BRIGHT" in "FL DIMMER" in the OTHERS menu. (⇒ 29)

### "NOPLAY"

- You inserted a disc the unit cannot play; insert one it can. (⇒ 30)
- You inserted a blank disc.
- You inserted a disc that has not been finalized.

### "NODISC"

- You have not inserted a disc; insert one.
- You have not inserted the disc correctly; insert it correctly. (⇒ 18)

### "IPOD OVER CURRENT ERROR"

The iPod is drawing too much power. Remove the iPod, and turn the unit off and on again.

### "F61"

Check and correct the speaker cable connections. If this does not fix the problem, consult the dealer. (⇒ 6, 8)

### "F76"

There is a power supply problem. Consult the dealer.

### "DVD U11"

Disc may be dirty. Wipe it clean. (⇒ 31)

### "ERROR"

Incorrect operation performed. Read the instructions and try again.

### "DVD H□□"

### "DVD F□□□"

□ stands for a number.

- Trouble may have occurred. The numbers following "H" and "F" depend on the status of the unit. Turn the unit off and then back on. Alternatively, turn the unit off, disconnect the AC power supply cord, and then reconnect it.
- If the service numbers fail to clear, note the service number and contact a qualified service person.

### "U70□"

□ stands for a number. (The actual number following "U70" will depend on the state of the main unit.)

- The HDMI connection acts unusually.
  - The connected equipment is not HDMI-compatible.
  - Please use HDMI cables that have the HDMI logo (as shown on the cover).
  - The HDMI cable is too long.
  - The HDMI cable is damaged.

### "REMOTE 1" or "REMOTE 2"

Match the modes on the main unit and remote control. Depending on the number being displayed ("1" or "2"), press and hold [OK] and the corresponding numbered button ([1] or [2]) for at least 2 seconds. (⇒ 38)

### "LOADING"

- The iPod is not ready. Wait for this display to disappear.
- Disconnect the iPod, and then reconnect it firmly. (⇒ 26)

### "NO MIC"

The Auto speaker setup microphone is not inserted. Check whether the Auto speaker setup microphone is plugged in properly into the SETUP MIC jack.

### "NOISY"

Excessive ambient noise in the room. Perform the setup again and keep quiet during the Auto speaker setup.

## General operation

### No response when any buttons are pressed.

- This unit cannot play discs other than the ones listed in these operating instructions. (⇒ 30)
- The unit may not be operating properly due to lightning, static electricity or some other external factor. Turn the unit off and then back on. Alternatively, turn the unit off, disconnect the AC power supply cord, and then reconnect it.
- Condensation has formed. Wait 1 to 2 hours for it to evaporate.

### No response when remote control buttons are pressed.

- Check that the batteries are installed correctly. (⇒ 11)
- The batteries are depleted. Replace them with new ones. (⇒ 11)
- Aim the remote control at the remote control signal sensor and operate. (⇒ 39)

### Other products respond to the remote control.

Change the remote control operating mode. (⇒ 38)

### Cannot play DVDs.

CD Mode is on. Press and hold [—CD MODE] to turn CD Mode off. (⇒ 20)

### No picture or sound.

- Check the video or speaker connection. (⇒ 6, 8, 9)
- Check the power or input setting of the connected equipment and the main unit.
- Check that the disc has something recorded on it.

### You have forgotten your ratings password.

Reset all the settings to Factory Preset.

While stopped and "DVD/CD" is the source, press and hold [■] (Stop) on the main unit and [≥10] on the remote control until "INITIALIZED" disappears from the TV. Turn the unit off and on again. All settings will return to the default values.

(This does not work during program and random modes, or when setup menu or START menu is displayed.)

### Some characters are not displayed correctly.

Characters other than English alphabet and Arabic numerals may not be displayed correctly.

### The VIERA Link "HDAVI Control" function does not respond.

Depending on the condition of this unit or the connected equipment, it may be necessary to repeat the same operation so that the function can work correctly. (⇒ 24)

### The setting you made in "TV ASPECT" (⇒ 28, VIDEO menu) or "LANGUAGE" (⇒ 29, DISPLAY menu) does not work.

The settings for "TV ASPECT"<sup>\*1</sup> and "LANGUAGE"<sup>\*2</sup> will automatically follow to the information from the TV. (⇒ 12, Smart setup settings)

<sup>\*1</sup> When using VIERA Link "HDAVI Control" with "HDAVI Control 3 or later" compatible TV

<sup>\*2</sup> When using VIERA Link "HDAVI Control" with "HDAVI Control 2 or later" compatible TV

## Disc trays

### Disc tray(s) cannot open.

#### "CHGR ERR" is displayed.

Press [⏻] to release the jammed tray(s) as the unit will switch off. Disconnect the AC power supply cord, and then reconnect it. Turn the unit on again and the tray will initialize to the previous tray condition. If this still does not fix the problem, please consult the dealer.



## Disc operation

### It takes time before play starts. [MP3]

Play may take time to begin when an MP3 track has still picture data. Even after the track starts, the correct play time will not be displayed. This is normal.

### A menu screen appears during skip or search. [VCD]

This is normal for Video CDs.

### Playback control menu does not appear.

[VCD] with playback control

Press [■ STOP] twice and then press [▶ PLAY].

### Program and Random play do not work. [DVD-V]

These functions do not work with some DVD-Videos.

### Play does not start.

- This unit may not play WMA that contains still picture data.
- If a disc contains CD-DA and other formats, proper playback may not be possible.

### No subtitles.

Display the subtitles. ("SUBTITLE" in Menu 1) (⇒ 22)

### Point B is automatically set.

The end of an item becomes point B when it is reached.

### The Setup menu cannot be accessed.

- Select "DVD/CD" as the source.
- Cancel Program and Random play. (⇒ 20)

## Sound

### Sound is distorted.

- Noise may occur when playing WMA.
- When using the HDMI output, audio may not be output from other terminals.

### Effects do not work.

Some audio effects do not work or have less effect with some discs.

### Humming is heard during play.

An AC power supply cord or fluorescent light is near the main unit. Keep other appliances and cables away from the main unit.

### No sound.

- There may be a slight pause in sound when you change the play speed.
- Audio may not be heard when more than 4 devices are connected with HDMI cables. Reduce the number of connected devices.
- When using the HDMI connection, ensure that "AUDIO OUT" in the HDMI menu is set to "ON". (⇒ 29)

### No sound from the TV.

Confirm the audio connection. Press [EXT-IN] to select the corresponding source. (⇒ 9, 15)

### No surround sound.

Press [SURROUND] to select MULTI-CH. (⇒ 16)

## Picture

### The picture on the TV is not displayed correctly or disappears.

- Ensure that the unit is connected directly to the TV, and is not connected through a VCR. (⇒ 9)
- Mobile telephone chargers can cause some disturbance.
- If you are using an indoor TV antenna, change to an outdoor antenna.
- The TV antenna wire is too close to the unit. Move it away from the unit.
- Picture may not be seen when more than 4 devices are connected with HDMI cables. Reduce the number of connected devices.
- When using the COMPONENT VIDEO OUT terminal, ensure that progressive output is not selected when the connected TV is not progressive compatible. Press and hold [CANCEL] until "PRG" disappears from the main unit display and the picture is displayed correctly.
- When using the HDMI AV OUT terminal, ensure that video output unacceptable with the connected TV is not selected. Press and hold [CANCEL] until the picture is displayed correctly. (The output will return to "480p".) (⇒ 23)
- Video images converted to 1920×1080 resolution may look different from the true native 1080p full-HD sources. This is not malfunction of the main unit.

### Picture size does not fit the screen.

- Change "TV ASPECT" in the VIDEO menu. (⇒ 28)
- Use the TV to change the aspect.
- Change the zoom setting. ("ZOOM" in Menu 2) (⇒ 23)

### Menu is not displayed correctly.

Restore the zoom ratio to "NORMAL". ("ZOOM" in Menu 2) (⇒ 23)

### Auto zoom function does not work well.

- Turn off TV's zoom function.
- Zoom function may not work well, especially in dark scenes and may not work depending on the type of disc.

## iPod operation

### Cannot charge or operate.

- Check that the iPod is connected firmly. (⇒ 26)
- The battery of the iPod is depleted. Charge the iPod, and then operate again.

### Cannot display iPod photos/videos on the TV.

- Ensure the video connection to the VIDEO OUT terminal on this unit. (⇒ 9)
- Operate the iPod menu to make the appropriate photo/video output settings for your TV. (Refer to operating instructions for your iPod.)

## HDMI or progressive video

### There is ghosting when HDMI or progressive output is on.

- This problem is caused by the editing method or material used on DVD-Video, but should be corrected if you use interlaced output. When using the HDMI AV OUT terminal, set "VIDEO FORMAT" in Menu 4 to "480i". Or, disable the HDMI AV OUT connection and use other video connections. (⇒ 9, 23)
- When using the COMPONENT VIDEO OUT terminal, set "VIDEO OUT (I/P)" in VIDEO menu to "INTERLACE". (Alternatively, press and hold [CANCEL] until "PRG" disappears from the main unit display.) (⇒ 28)

### Pictures not in progressive output.

- Select "PROGRESSIVE" in "VIDEO OUT (I/P)" in VIDEO menu. (⇒ 28)
- The unit's VIDEO OUT terminal outputs the interlaced signal even if "PRG" is displayed.

### Closed captions not displayed.

When HDMI or progressive output is on, closed captions will not be displayed.

## Radio

### Distorted sound or noise is heard.

#### "ST" flickers or does not light.

- Adjust the position of the FM or AM antenna.
- Use an outdoor antenna. (⇒ 10)

### A beat sound is heard.

Turn the TV off or move it away from the unit.

### A low hum is heard during AM broadcasts.

Separate the antenna from other cables.

## TV displays

"⊘"

The operation is prohibited by the unit or disc.

### "THIS DISC CANNOT BE PLAYED IN YOUR REGION."

Only DVD-Video discs that include or have the same region number as the one on the rear panel of this unit can be played. (⇒ Cover page)

### "No Video"

Depending on the connected iPod, video menu may not be available on the TV. Select iPod menu (iPod LCD) mode (⇒ 26) and operate video playback from your iPod menu.

# Specifications

## AMPLIFIER SECTION

### RMS Output Power: Dolby Digital Mode

Front Ch	125 W per channel (3 Ω), 1 kHz, 10 % THD
Surround Ch	125 W per channel (3 Ω), 1 kHz, 10 % THD
Center Ch	250 W per channel (6 Ω), 1 kHz, 10 % THD
Subwoofer Ch	250 W per channel (6 Ω), 100 Hz, 10 % THD
Total RMS Dolby Digital mode power	1000 W

### FTC Output Power: Dolby Digital Mode

Front Ch	63 W per channel (3 Ω), 120 Hz to 20 kHz, 1 % THD
Surround Ch	48 W per channel (3 Ω), 120 Hz to 20 kHz, 1 % THD
Center Ch	106 W per channel (6 Ω), 120 Hz to 20 kHz, 1 % THD
Subwoofer Ch	100 W per channel (6 Ω), 45 Hz to 120 Hz, 1 % THD
Total FTC Dolby Digital mode power	428 W

## FM/AM TUNER, TERMINALS SECTION

Preset Memory	FM 30 stations AM 30 stations
---------------	----------------------------------

### Frequency Modulation (FM)

Frequency range	87.9 MHz to 107.9 MHz (200-kHz step) 87.5 MHz to 108.0 MHz (100-kHz step)
Antenna terminals	75 Ω (unbalanced)

### Amplitude Modulation (AM)

Frequency range	520 kHz to 1710 kHz (10-kHz step)
-----------------	-----------------------------------

### Digital audio input

Optical digital input	Optical terminal
Sampling frequency	32 kHz, 44.1 kHz, 48 kHz

### Phone jack

Terminal	Stereo, 3.5 mm (1/8") jack
----------	----------------------------

### Calibration Mic

Sensitivity	100 mV, 1.4 kΩ
Terminal	Mono, 3.5 mm (1/8") jack

## DISC SECTION

### Discs played [8 cm (3") or 12 cm (5")]

- DVD (DVD-Video)
- DVD-RAM (DVD-VR, MP3<sup>\*2,5</sup>, JPEG<sup>\*4,5</sup>)
- DVD-R (DVD-Video, DVD-VR, MP3<sup>\*2,5</sup>, JPEG<sup>\*4,5</sup>)
- DVD-R DL (DVD-Video, DVD-VR)
- DVD-RW (DVD-Video, DVD-VR, MP3<sup>\*2,5</sup>, JPEG<sup>\*4,5</sup>)
- +R/+RW (Video)
- +R DL (Video)
- CD, CD-R/RW (CD-DA, Video CD, SVCD<sup>\*1</sup>, MP3<sup>\*2,5</sup>, WMA<sup>\*3,5</sup>, JPEG<sup>\*4,5</sup>)

\*1 Conforming to IEC62107

\*2 MPEG-1 Layer 3, MPEG-2 Layer 3

\*3 Windows Media Audio Ver.9.0 L3

Not compatible with Multiple Bit Rate (MBR)

\*4 Exif Ver 2.1 JPEG Baseline files

Picture resolution: between 160×120 and 6144×4096 pixels (Sub sampling is 4:0:0, 4:2:0, 4:2:2 or 4:4:4). Extremely long and narrow pictures may not be displayed.

\*5 The total combined maximum number of recognizable audio and picture contents and groups: 4000 audio and picture contents and 255 groups. (Excluding Root folder)

### Pick up

Wavelength (DVD/CD)	655/785 nm
Laser power (DVD/CD)	<b>U.S.A.</b> CLASS II/CLASS I <b>Others</b> CLASS 1/CLASS 1M

### Audio output (Disc)

Number of channels	5.1 ch (FL, FR, C, SL, SR, SW)
--------------------	--------------------------------

## VIDEO SECTION

### Video system

NTSC

### Composite video output

Output level	1 Vp-p (75 Ω)
Terminal	Pin jack (1 system)

### Component video output

Y output level	1 Vp-p (75 Ω)
P <sub>B</sub> output level	0.7 Vp-p (75 Ω)
P <sub>R</sub> output level	0.7 Vp-p (75 Ω)
Terminal	Pin jack (Y: green, P <sub>B</sub> : blue, P <sub>R</sub> : red) (1 system)

### HDMI AV output

Terminal	19-pin type A connector
----------	-------------------------

### HDAVI Control

This unit supports "HDAVI Control 4" function.

## SPEAKER SECTION

### Front speakers SB-HF770

Type	1 way, 1 speaker system (Bass reflex)
Speaker unit(s)	Impedance 3 Ω
Full range	6.5 cm (2 1/2") Cone type
Input power (IEC)	125 W <sup>*6</sup> (Max)
Output sound pressure	79 dB/W (1.0 m)
Frequency range	80 Hz to 25 kHz (-16 dB) 90 Hz to 22 kHz (-10 dB)
Dimensions (W×H×D)	100 mm×530 mm×78 mm (3 1/16"×20 7/16"×3 1/16")
Mass [Weight]	0.92 kg (2.2 lbs)

### Full assembly with stand base

Dimensions (W×H×D) max	255 mm×1020 mm×255 mm (10 1/16"×40 3/16"×10 1/16")
------------------------	---

### Dimensions (W×H×D) min

Dimensions (W×H×D) min	255 mm×550 mm×255 mm (10 1/16"×21 1/32"×10 1/16")
------------------------	--

### Mass [Weight]

Mass [Weight]	2.3 kg (5.1 lbs)
---------------	------------------

### Surround speakers SB-HS470

Type	1 way, 1 speaker system (Bass reflex)
Speaker unit(s)	Impedance 3 Ω
Full range	6.5 cm (2 1/2") Cone type
Input power (IEC)	125 W <sup>*6</sup> (Max)
Output sound pressure	79 dB/W (1.0 m)
Frequency range	100 Hz to 25 kHz (-16 dB) 120 Hz to 22 kHz (-10 dB)
Dimensions (W×H×D)	92 mm×128 mm×81 mm (3 5/8"×5 1/32"×3 1/16")
Mass [Weight]	0.47 kg (1.1 lbs)

### Center speaker SB-HC470

Type	2 way, 2 speaker system (Bass reflex)
Speaker unit(s)	Impedance 6 Ω
1. Woofer	6.5 cm (2 1/2") Cone type
2. Full range	6.5 cm (2 1/2") Cone type
Input power (IEC)	250 W <sup>*6</sup> (Max)
Output sound pressure	81 dB/W (1.0 m)
Frequency range	82 Hz to 25 kHz (-16 dB) 99 Hz to 22 kHz (-10 dB)
Dimensions (W×H×D)	250 mm×94.5 mm×81 mm (9 7/32"×3 3/4"×3 1/16")
Mass [Weight]	1.15 kg (2.6 lbs)

### Subwoofer SB-HW460

Type	1 way, 1 speaker system (Bass reflex)
Speaker unit(s)	Impedance 6 Ω
Woofer	16 cm (6 1/2") Cone type
Input power (IEC)	250 W (Max)
Output sound pressure	81 dB/W (1.0 m)
Frequency range	31 Hz to 220 Hz (-16 dB) 37 Hz to 180 Hz (-10 dB)
Dimensions (W×H×D)	153 mm×415 mm×257 mm (6 1/32"×16 11/32"×10 1/8")
Mass [Weight]	3.6 kg (7.9 lbs)

**GENERAL****Power supply****U.S.A. and Canada**

AC 120 V, 60 Hz

**Others**

AC 110 V to 127 V/220 V to 240 V, 50/60 Hz

**Power consumption**

Main unit 125 W

**Dimensions (W×H×D)**430 mm×63 mm×327 mm  
(16<sup>15/16</sup>"×2<sup>15/32</sup>"×12<sup>7/8</sup>" )**Mass [Weight]**

Main unit 3.6 kg (7.9 lbs)

**Operating temperature range**

0 °C to +40 °C (+32 °F to +104 °F)

**Operating humidity range**

35 % to 80 % RH (no condensation)

**Power consumption in standby mode****U.S.A. and Canada**

approx. 0.1 W

**Others**

approx. 0.2 W

\*6 Rating with Low-cut filter equipped Amplifier

**Note**

- 1 Specifications are subject to change without notice. Mass and dimensions are approximate.
- 2 Total harmonic distortion is measured by a digital spectrum analyzer.

Manufactured under license from Dolby Laboratories. Dolby, Pro Logic, and the double-D symbol are trademarks of Dolby Laboratories.

Manufactured under license under U.S. Patent #'s: 5,451,942; 5,956,674; 5,974,380; 5,978,762; 6,487,535 & other U.S. and worldwide patents issued & pending. DTS and DTS Digital Surround are registered trademarks and the DTS logos and Symbol are trademarks of DTS, Inc. © 1996-2008 DTS, Inc. All Rights Reserved.

U.S. Patent Nos. 6,836,549; 6,381,747; 7,050,698; 6,516,132; and 5,583,936.

This product incorporates copyright protection technology that is protected by U.S. patents and other intellectual property rights. Use of this copyright protection technology must be authorized by Macrovision, and is intended for home and other limited viewing uses only unless otherwise authorized by Macrovision. Reverse engineering or disassembly is prohibited.

Windows Media and the Windows logo are trademarks or registered trademarks of Microsoft Corporation in the United States and/or other countries.

This product is protected by certain intellectual property rights of Microsoft Corporation and third parties. Use or distribution of such technology outside of this product is prohibited without a license from Microsoft or an authorized Microsoft subsidiary and third parties.

HDMI, the HDMI logo and High-Definition Multimedia Interface are trademarks or registered trademarks of HDMI Licensing LLC.

HDAVI Control™ is a trademark of Panasonic Corporation.

VIERA Link™ is a trademark of Panasonic Corporation.

EZ Sync™ is a trademark of Panasonic Corporation.

iPod is a trademark of Apple Inc., registered in the U.S. and other countries.

# Limited Warranty (ONLY FOR U.S.A. AND PUERTO RICO)

Panasonic Consumer Electronics Company,  
Division of Panasonic Corporation of North America  
One Panasonic Way, Secaucus, New Jersey 07094

## Panasonic Audio Products Limited Warranty

### Limited Warranty Coverage (For USA and Puerto Rico Only)

If your product does not work properly because of a defect in materials or workmanship, Panasonic Consumer Electronics Company (referred to as "the warrantor") will, for the length of the period indicated on the chart below, which starts with the date of original purchase ("warranty period"), at its option either (a) repair your product with new or refurbished parts, or (b) replace it with a new or a refurbished product. The decision to repair or replace will be made by the warrantor.

Product or Part Name	Parts	Labor
Audio Products (except items listed below)	One (1) year	One (1) year
USB Reader-Writer, Personal Computer Card Adapters (in exchange for defective item)	One (1) year	Not Applicable
Accessories: Headphones, Cartridges, Microphones, Adapters	Ninety (90) days	Ninety (90) days
Rechargeable Batteries, DVD-R/-RAM Discs (in exchange for defective item)	Ten (10) days	Not Applicable
SD Memory Cards, Rechargeable Battery Packs (in exchange for defective item)	Ninety (90) days	Not Applicable

During the "Labor" warranty period there will be no charge for labor. During the "Parts" warranty period, there will be no charge for parts. You must carry-in or mail-in your product during the warranty period. If non-rechargeable batteries are included, they are not warranted. This warranty only applies to products purchased and serviced in the United States or Puerto Rico. This warranty is extended only to the original purchaser of a new product which was not sold "as is". A purchase receipt or other proof of the original purchase date is required for warranty service.

### Carry-In or Mail-In Service

For Carry-In or Mail-In Service in the United States and Puerto Rico call 1-800-211-PANA (7262) or visit Panasonic Web Site: <http://www.panasonic.com>

### Limited Warranty Limits And Exclusions

This warranty ONLY COVERS failures due to defects in materials or workmanship, and DOES NOT COVER normal wear and tear or cosmetic damage. The warranty ALSO DOES NOT COVER damages which occurred in shipment, or failures which are caused by products not supplied by the warrantor, or failures which result from accidents, misuse, abuse, neglect, mishandling, misapplication, alteration, faulty installation, set-up adjustments, misadjustment of consumer controls, improper maintenance, power line surge, lightning damage, modification, or commercial use (such as in a hotel, office, restaurant, or other business), rental use of the product, service by anyone other than a Factory Service Center or other Authorized Servicer, or damage that is attributable to acts of God.

**THERE ARE NO EXPRESS WARRANTIES EXCEPT AS LISTED UNDER "LIMITED WARRANTY COVERAGE". THE WARRANTOR IS NOT LIABLE FOR INCIDENTAL OR CONSEQUENTIAL DAMAGES RESULTING FROM THE USE OF THIS PRODUCT, OR ARISING OUT OF ANY BREACH OF THIS WARRANTY.** (As examples, this excludes damages for lost time, travel to and from the servicer, loss of media or images, data or other memory content. The items listed are not exclusive, but are for illustration only.)

**ALL EXPRESS AND IMPLIED WARRANTIES, INCLUDING THE WARRANTY OF MERCHANTABILITY, ARE LIMITED TO THE PERIOD OF THE LIMITED WARRANTY.**

Some states do not allow the exclusion or limitation of incidental or consequential damages, or limitations on how long an implied warranty lasts, so the exclusions may not apply to you.

This warranty gives you specific legal rights and you may also have other rights which vary from state to state. If a problem with this product develops during or after the warranty period, you may contact your dealer or Service Center. If the problem is not handled to your satisfaction, then write to the warrantor's Consumer Affairs Department at the addresses listed for the warrantor.

**PARTS AND SERVICE WHICH ARE NOT COVERED BY THIS LIMITED WARRANTY ARE YOUR RESPONSIBILITY.**

## Customer Services Directory (United States and Puerto Rico)

Obtain Product Information and Operating Assistance; locate your nearest Dealer or Service Center; purchase Parts and Accessories; or make Customer Service and Literature requests by visiting our Web Site at:

<http://www.panasonic.com/help>

or, contact us via the web at:

<http://www.panasonic.com/contactinfo>

You may also contact us directly at:

1-800-211-PANA (7262),

Monday-Friday 9 am-9 pm; Saturday-Sunday 10 am-7 pm, EST.

For hearing or speech impaired TTY users, TTY: 1-877-833-8855

## Accessory Purchases (United States and Puerto Rico)

Purchase Parts, Accessories and Instruction Books online for all Panasonic Products by visiting our Web Site at:

<http://www.pstc.panasonic.com>

or, send your request by E-mail to:

[npcparts@us.panasonic.com](mailto:npcparts@us.panasonic.com)

You may also contact us directly at:

1-800-332-5368 (Phone) 1-800-237-9080 (Fax Only) (Monday – Friday 9 am to 9 pm, EST.)

Panasonic Service and Technology Company

20421 84th Avenue South, Kent, WA 98032

(We Accept Visa, MasterCard, Discover Card, American Express, and Personal Checks)

For hearing or speech impaired TTY users, TTY: 1-866-605-1277

# Limited Warranty (ONLY FOR CANADA)

Panasonic Canada Inc.

## PANASONIC PRODUCT – LIMITED WARRANTY

Panasonic Canada Inc. warrants this product to be free from defects in material and workmanship and agrees to remedy any such defect for a period as stated below from the date of original purchase.

Technics Audio Product	One (1) year, parts and labour
Panasonic Portable / Clock Radio (without Tape, CD, MD)	One (1) year, parts and labour
Panasonic Audio / SD Audio Product	One (1) year, parts and labour
Panasonic DVD Product	One (1) year, parts and labour
Panasonic Combination DVD Player / VCR	One (1) year, parts and labour
Panasonic Combination DVD Recorder / VCR	One (1) year, parts and labour
Accessories including rechargeable batteries	Ninety (90) days

### LIMITATIONS AND EXCLUSIONS

This warranty does not apply to products purchased outside Canada or to any product which has been improperly installed, subjected to usage for which the product was not designed, misused or abused, damaged during shipping, or which has been altered or repaired in any way that affects the reliability or detracts from the performance, nor does it cover any product which is used commercially. Dry cell batteries are also excluded from coverage under this warranty.

This warranty is extended to the original end user purchaser only. A purchase receipt or other proof of date of original purchase is required before warranty service is performed.

**THIS EXPRESS, LIMITED WARRANTY IS IN LIEU OF ALL OTHER WARRANTIES, EXPRESS OR IMPLIED, INCLUDING ANY IMPLIED WARRANTIES OF MERCHANTABILITY AND FITNESS FOR A PARTICULAR PURPOSE. IN NO EVENT WILL PANASONIC CANADA INC. BE LIABLE FOR ANY SPECIAL, INDIRECT OR CONSEQUENTIAL DAMAGES.**

In certain instances, some jurisdictions do not allow the exclusion or limitation of incidental or consequential damages, or the exclusion of implied warranties, so the above limitations and exclusions may not be applicable.

### WARRANTY SERVICE

**FOR PRODUCT OPERATION ASSISTANCE**, please contact:

Our Customer Care Centre:	Telephone #:	(905) 624-5505
	1-800 #:	1-800-561-5505
	Fax #:	(905) 238-2360
	Email link:	"Customer support" on <a href="http://www.panasonic.ca">www.panasonic.ca</a>

**FOR PRODUCT REPAIRS**, please locate your nearest Authorized Servicentre at [www.panasonic.ca](http://www.panasonic.ca) :

Link : "Servicentres™ locator" under "Customer support"

### **IF YOU SHIP THE PRODUCT TO A SERVICENTRE**

Carefully pack and send prepaid, adequately insured and preferably in the original carton.  
Include details of the defect claimed, and proof of date of original purchase.

# Control reference guide

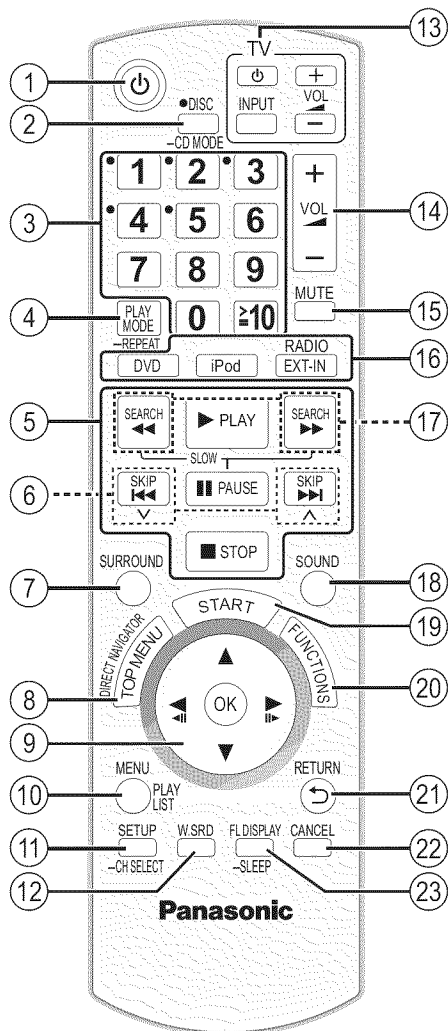

- ① Turn the main unit on/off (⇒ 12)
- ② Select a disc / Play all loaded CDs sequentially (⇒ 19, 20)
- ③ Select channels and title numbers etc. / Enter numbers (⇒ 13, 19)
- ④ Select the play mode / Set the repeat mode (⇒ 20)
- ⑤ Basic operations for play (⇒ 18, 19)
- ⑥ Select preset radio stations (⇒ 13)
- ⑦ Select surround sound effects (⇒ 16)
- ⑧ Show a disc top menu or program list (⇒ 19, 21)
- ⑨ Select or confirm menu items / Frame-by-frame (⇒ 19)
- ⑩ Show a disc menu or play list (⇒ 19, 21)
- ⑪ Show setup menu or select speaker channel (⇒ 17, 28)
- ⑫ Turn Whisper-mode Surround on/off (⇒ 16)

## ⑬ TV operations

Aim the remote control at the Panasonic TV and press the button.

[TV]: Turn the TV on/off

[INPUT]: Change the TV's video input mode

[+, -]: Adjust the TV volume

This may not work properly with some models.

- ⑭ Adjust the volume of the main unit

## ⑮ Mute the sound

- "MUTE" flashes on the main unit's display while the function is on.
- To cancel, press the button again or adjust the volume.
- Muting is canceled when you switch the unit to standby.

## ⑯ Source select

[DVD]: Select disc as the source (⇒ 12)

[iPod]: Select iPod as the source (⇒ 26)

[RADIO], [EXT-IN]: Select FM/AM tuner or external audio as the source (⇒ 13, 15)

FM→AM→AUX\*→D-IN\*

\* "(TV)" will appear beside "AUX" or "D-IN", indicating the TV audio setting for VIERA Link "HDAVI Control" (⇒ 24).

- ⑰ Select radio stations manually (⇒ 13)
- ⑱ Select sound mode (⇒ 16)
- ⑲ Show START menu (⇒ 15)
- ⑳ Show on-screen menu (⇒ 22)
- ㉑ Return to previous screen (⇒ 19)
- ㉒ Cancel (⇒ 20)
- ㉓ Switch information on the main unit's display (⇒ 19)

## Set the Sleep timer

Press and hold [—SLEEP].

While the time is shown on the main unit's display, press [—SLEEP] repeatedly.

SLEEP 30→SLEEP 60→SLEEP 90→SLEEP 120  
 ↑ OFF (Cancel) ↓

- To confirm the remaining time, press and hold the button again.

## Avoiding interference with other Panasonic equipment

Other Panasonic audio/video equipment may start functioning when you operate the unit using the supplied remote control. You can operate this unit in another mode by setting the remote control operating mode to "REMOTE 2".

### The main unit and remote control must be set to the same mode.

- 1 Press and hold [▶▶/▶▶] on the main unit and [2] on the remote control until the main unit's display shows "REMOTE 2".
- 2 Press and hold [OK] and [2] on the remote control for at least 2 seconds.

To change the mode back to "REMOTE 1", repeat both steps above by replacing [2] with [1].

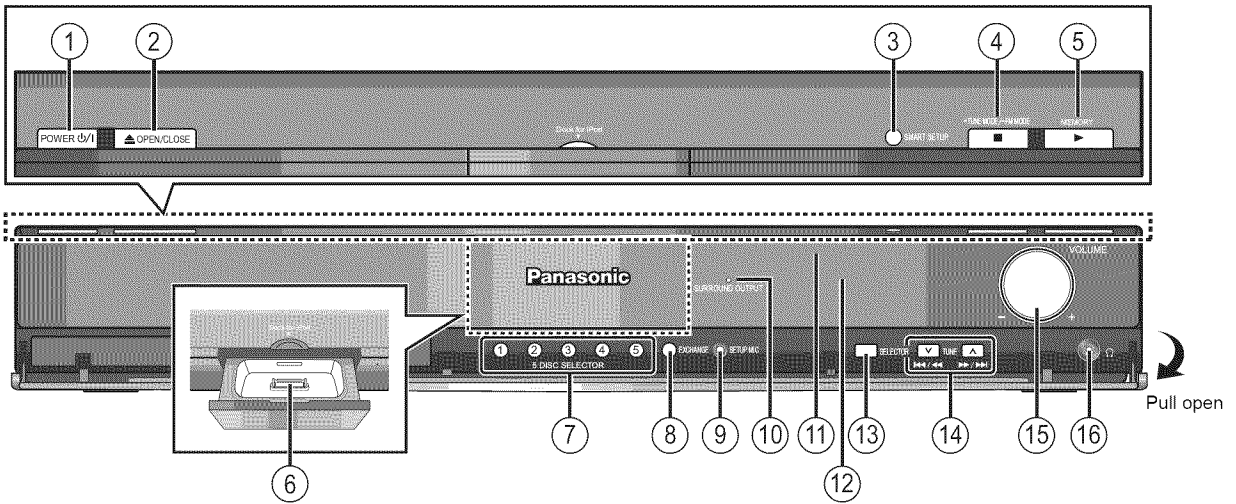

**① Standby/on switch (POWER ⏻/⏻)**

Press to switch the unit from on to standby mode or vice versa. In standby mode, the unit is still consuming a small amount of power. (⇒ 18)

**② Open/Close the disc tray (⇒ 18)**

**③ Show the Smart setup (⇒ 12)**

**④ Stop playing / Select the tuning mode / Adjust the FM reception condition (⇒ 13, 18)**

**⑤ Play discs / Memorize the receiving radio stations (⇒ 13, 18)**

**⑥ Connect iPod (⇒ 26)**

**⑦ Select a disc directly (⇒ 18)**

**⑧ Open the disc tray to exchange the disc. (⇒ 18)**

**⑨ Connect Auto speaker setup microphone (⇒ 12)**

**⑩ The indicator lights when there is surround sound effect. (⇒ 16)**

**⑪ Remote control signal sensor**

**⑫ Display**

**⑬ Select the source**

DVD/CD→FM→AM→AUX\*→D-IN\*→IPOD

\* ("TV") will appear beside "AUX" or "D-IN", indicating the TV audio setting for VIERA Link "HDAVI Control" (⇒ 24).

**⑭ Skip or slow-search play / Select the radio stations (⇒ 13, 18)**

**⑮ Adjust the volume of the main unit**

**⑯ Connect headphones (not included)**

Headphone plug type: Ø3.5 mm (1/8") stereo mini plug

- Reduce the volume before connecting.
  - Audio is automatically switched to 2-channel stereo.
  - To prevent hearing damage, avoid listening for prolonged periods of time.
- Excessive sound pressure from earphones and headphones can cause hearing loss.

**Language code list**

Abkhazian: 6566	Danish: 6865	Italian: 7384	Norwegian: 7879	Swedish: 8386
Afar: 6565	Dutch: 7876	Japanese: 7465	Oriya: 7982	Tagalog: 8476
Afrikaans: 6570	English: 6978	Javanese: 7487	Pashto, Pushto: 8083	Tajik: 8471
Albanian: 8381	Esperanto: 6979	Kannada: 7578	Persian: 7065	Tamil: 8465
Ameharic: 6577	Estonian: 6984	Kashmiri: 7583	Polish: 8076	Tatar: 8484
Arabic: 6582	Faroese: 7079	Kazakh: 7575	Portuguese: 8084	Telugu: 8469
Armenian: 7289	Fiji: 7074	Kirghiz: 7589	Punjabi: 8065	Thai: 8472
Assamese: 6583	Finnish: 7073	Korean: 7579	Quechua: 8185	Tibetan: 6679
Aymara: 6589	French: 7082	Kurdish: 7585	Rhaeto-Romance: 8277	Tigrinya: 8473
Azerbaijani: 6590	Frisian: 7089	Laotian: 7679	Romanian: 8279	Tonga: 8479
Bashkir: 6665	Galician: 7176	Latin: 7665	Russian: 8285	Turkish: 8482
Basque: 6985	Georgian: 7565	Latvian, Lettish: 7686	Samoan: 8377	Turkmen: 8475
Bengali, Bangla: 6678	German: 6869	Lingala: 7678	Sanskrit: 8365	Twi: 8487
Bhutani: 6890	Greek: 6976	Lithuanian: 7684	Scots Gaelic: 7168	Ukrainian: 8575
Bihari: 6672	Greenlandic: 7576	Macedonian: 7775	Serbian: 8382	Urdu: 8582
Breton: 6682	Guarani: 7178	Malagasy: 7771	Serbo-Croatian: 8372	Uzbek: 8590
Bulgarian: 6671	Gujarati: 7185	Malay: 7783	Shona: 8378	Vietnamese: 8673
Burmese: 7789	Hausa: 7265	Malayalam: 7776	Sindhi: 8368	Volapük: 8679
Byelorussian: 6669	Hebrew: 7387	Maltese: 7784	Singhalese: 8373	Welsh: 6789
Cambodian: 7577	Hindi: 7273	Maori: 7773	Slovak: 8375	Wolof: 8779
Catalan: 6765	Hungarian: 7285	Marathi: 7782	Slovenian: 8376	Xhosa: 8872
Chinese: 9072	Icelandic: 7383	Moldavian: 7779	Somali: 8379	Yiddish: 7473
Corsican: 6779	Indonesian: 7378	Mongolian: 7778	Spanish: 6983	Yoruba: 8979
Croatian: 7282	Interlingua: 7365	Nauru: 7865	Sundanese: 8385	Zulu: 9085
Czech: 6783	Irish: 7165	Nepali: 7869	Swahili: 8387	

**User memo:**

DATE OF PURCHASE _____
DEALER NAME _____
DEALER ADDRESS _____
_____
TELEPHONE NUMBER _____

The model number and serial number of this product can be found on either the back or the bottom of the unit. Please note them in the space provided below and keep for future reference.	
MODEL NUMBER _____	SC-PT670 _____
SERIAL NUMBER _____	_____

**For U.S.A. and Puerto Rico**

Panasonic Consumer Electronics Company, Division of Panasonic Corporation of North America  
One Panasonic Way, Secaucus, New Jersey 07094  
<http://www.panasonic.com>

**For Canada**

Panasonic Canada Inc.  
5770 Ambler Drive  
Mississauga, Ontario  
L4W 2T3  
[www.panasonic.ca](http://www.panasonic.ca)

**For others**

Panasonic Corporation  
Corporate Management Division for the Americas  
Sales Office for North America  
**Tokyo Panasonic Sales Section**  
32nd Floor, World Trade Center 4-1,  
Hamamatsu-cho, 2-Chome, Minato-Ku,  
Tokyo 105-6132, Japan

Panasonic Marketing Europe G.M.B.H.  
Wiesbaden N. (a Division of Panasonic Marketing G.M.B.H.)  
Military Sales Department  
6200 Wiesbaden-Biebrich, Hagenauerstr. 43  
Germany

En