

PowerSteamer® PowerLifter®

USER'S GUIDE

1694 SERIES
8806 SERIES



- 3 Safety Instructions
- 4 Product View
- 5 Assembly/Special Features
- 6-8 Operation
- 9 Maintenance and Care
- 9-10 Troubleshooting
- 11 Consumer Services
- 11 Replacement Parts
- 12 Warranty





Thank you for buying a BISSELL deep cleaner

We're glad you purchased a BISSELL deep cleaner. Everything we know about floor care went into the design and construction of this complete, high-tech home cleaning system.

Your BISSELL deep cleaner is well made, and we back it with a limited one year warranty. We also stand behind it with a knowledgeable, dedicated Consumer Services department, so, should you ever have a problem, you'll receive fast, considerate assistance.

My great-grandfather invented the floor sweeper in 1876. Today, BISSELL is a global leader in the design, manufacture, and service of high quality homecare products like your BISSELL deep cleaner.

Thanks again, from all of us at BISSELL.

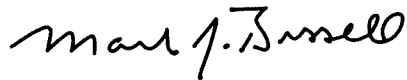

Mark J. Bissell
President and Chief Executive Officer

IMPORTANT SAFETY INSTRUCTIONS

When using an electrical appliance, basic precautions should be observed, including the following:

Read all instructions before using your PowerSteamer®/PowerLifter®

⚠ WARNING: To reduce the risk of fire, electric shock, or injury:

- Do not immerse.
- Use only on surfaces moistened by cleaning process.
- Always connect to a properly grounded outlet.
- See Grounding Instructions.
- Unplug from outlet when not in use and before conducting maintenance or troubleshooting.
- Do not leave machine when it is plugged in.
- Do not service machine when it is plugged in.
- Do not use with damaged cord or plug.
- If appliance is not working as it should, has been dropped, damaged, left outdoors, or dropped into water, have it repaired at an authorized Service Center.
- Use indoors only.
- Do not pull or carry by cord, use cord as a handle, close door on cord, pull cord around sharp corners or edges, run appliance over cord, or expose cord to heated surfaces.
- Unplug by grasping the plug, not the cord.
- Do not handle plug or appliance with wet hands.
- Do not put any object into appliance openings, use with blocked opening, or restrict air flow.
- Do not expose hair, loose clothing, fingers or body parts to openings or moving parts.
- Do not pick up hot or burning objects.
- Do not pick up flammable or combustible materials (lighter fluid, gasoline, kerosene, etc.) or use in the presence of explosive liquids or vapor.
- Do not use appliance in an enclosed space filled with vapors given off by oil base paint, paint thinner, some moth proofing substances, flammable dust, or other explosive or toxic vapors.
- Do not pick up toxic material (chlorine bleach, ammonia, drain cleaner, gasoline, etc.).
- Do not modify the 3-prong grounded plug.
- Do not allow to be used as a toy.
- Do not use for any purpose other than described in this User's Guide.
- Do not operate the appliance unless the belt door is securely assembled in the location provided.
- Do not unplug by pulling on the cord.
- Use only manufacturer's recommended attachments.
- Use only cleaning products formulated by BISSELL for use in this appliance to prevent internal component damage. See the cleaning fluid section of this guide.
- Keep openings free of dust, lint, hair, etc.
- Do not point attachment nozzle at people or animals
- Keep appliance on a level surface.

- Turn off all controls before unplugging.
- Be extra careful when cleaning stairs.
- Close attention is necessary when used by or near children.
- **WARNING:** The power cord on this product contains lead, a chemical known to the State of California to cause birth defects or other reproductive harm.
WASH HANDS AFTER HANDLING.

SAVE THESE INSTRUCTIONS.

THIS MODEL IS FOR HOUSEHOLD USE ONLY.
Commercial use of this unit voids the manufacturer's warranty.

GROUNDING INSTRUCTIONS

This appliance must be connected to a grounded wiring system. If it should malfunction or break down, grounding provides a safe path of least resistance for electrical current, reducing the risk of electrical shock. The cord for this appliance has an equipment-grounding conductor and a grounding plug. It must only be plugged into an outlet that is properly installed and grounded in accordance with all local codes and ordinances.

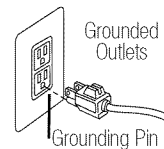

⚠ WARNING: Improper connection of the equipment-grounding conductor can result in a risk of electrical shock. Check with a qualified electrician or service person if you aren't sure if the outlet is properly grounded. **DO NOT MODIFY THE PLUG.** If it will not fit the outlet, have a proper outlet installed by a qualified electrician. This appliance is designed for use on a nominal 120-volt circuit, and has a grounding attachment plug that looks like the plug in the drawing above. Make certain that the appliance is connected to an outlet having the same configuration as the plug. No plug adapter should be used with this appliance.

Product view

Keep plenty of genuine BISSELL advanced cleaning formulas on hand so you can clean whenever it fits your schedule. Always use genuine BISSELL deep cleaning formulas. Non-BISSELL cleaning solutions may harm the machine and will void the warranty.

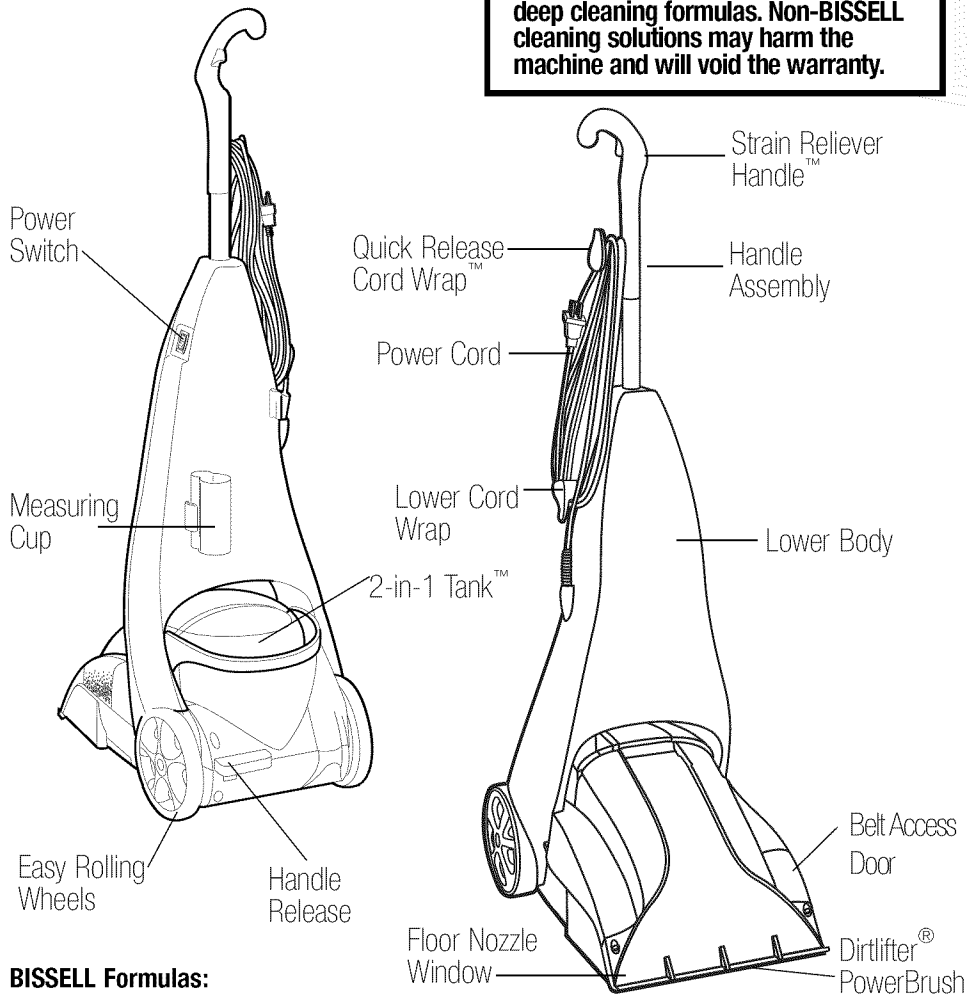

BISSELL Formulas:

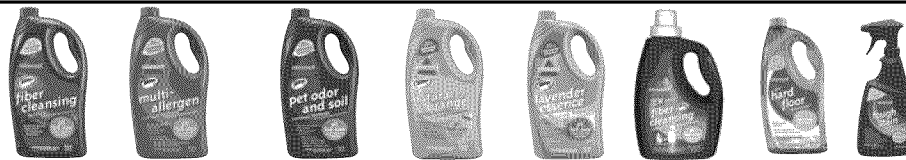

- 48 oz. BISSELL Fiber Cleansing Formula™ with Scotchgard™ Protector
- 48 oz. BISSELL Multi- Allergen Removal™ Formula™ with Scotchgard™ Protector
- 48 oz. BISSELL Pet Odor and Soil Removal™ Formula with Scotchgard™ Protector
- 48 oz. BISSELL Natural Orange Extract Formula with Scotchgard™ Protector
- 48 oz. BISSELL Lavender Essence Formula with Scotchgard™ Protector
- 43 oz. BISSELL 3X Concentrated Fiber Cleansing Formula with Scotchgard™ Protector
- 32 oz. BISSELL Hard Floor Solutions™ Formula
- 22 oz. BISSELL Tough Stain PreCleaner™



How to use this guide

This user's guide has been designed to help you get the maximum satisfaction from your BISSELL deep cleaner. You'll find assembly and operating instructions, safety precautions, as well as maintenance and troubleshooting instructions. Please read this user's guide thoroughly before assembling your deep cleaner.

Pay particular attention to the product diagram, assembly instructions, and part names. Locate and organize all parts before assembly. Familiarize yourself with the parts and where they go. Following this user's guide will greatly enhance your ability to get the most performance from your deep cleaner for many years.

Your deep cleaner comes in two easy to assemble components.

Handle Assembly Lower Body

The only tool you will need to assemble your cleaner is a Phillips head  screwdriver.

Assembly

1. Slide the handle assembly (with attached Quick Release Cord Wrap™) down into the lower body until it will go no further.
2. Secure the handle by placing one (1) Phillips head  screw (supplied) through the screw opening in the lower body and into the rear of the handle assembly. Tighten with screwdriver until secure.

Assembly is now complete.

Special features of your BISSELL deep cleaner

Your BISSELL deep cleaner is a home cleaning system that uses a combination of hot tap water, BISSELL advanced cleaning formula, brush agitation and suction to safely clean carpets.

DirtLifter® PowerBrush

The DirtLifter PowerBrush is designed to enhance cleaning performance. The bristle pattern safely lifts out the deep down dirt while gently grooming carpet fibers. The floating suspension self-adjusts to all carpet heights. When the power is ON (I) and the machine is in the upright position, your carpet is protected because the brushes are lifted up off the carpet.



WARNING:

Do not plug in your cleaner until you have completely assembled it per the following instructions and are familiar with all instructions and operating procedures.

Tip:

Deep cleaning carpeting and upholstery regularly can reduce dust and allergens in your home.

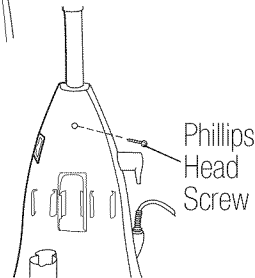
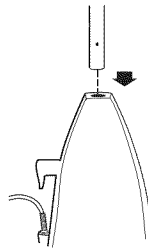

WARNING:

To reduce the risk of fire, use only BISSELL advanced deep cleaning formula for full size machines in your deep cleaner. Use of cleaning formulas that contain lemon or pine oil may damage this appliance and void the warranty. Chemical spot cleaners or solvent-based soil removers should not be used. These products may react with the plastic materials used in your deep cleaner causing cracking or pitting.

Special features of your BISSELL deep cleaner

Measuring cup

Your deep cleaner is equipped with a measuring cup for adding the proper amount of cleaning formula to the 2-in-1 tank. For convenience, the measuring cup stores on the back of the unit.

2-in-1 water tank

Our 2-in-1 water tank system is designed with a heavy duty bladder inside for clean water. As you clean, the clean water in the bladder will empty and mix with the cleaning formula. Dirty water pulled out of your carpets will collect around the outside of the bladder so that clean and dirty water are always kept separate. This allows the user to maximize tank space, yet only carry one tank to and from the sink for emptying and filling.

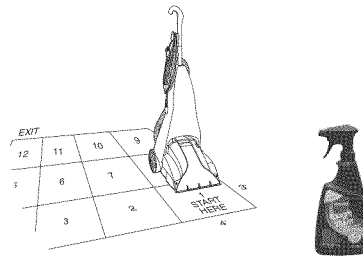
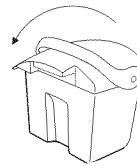
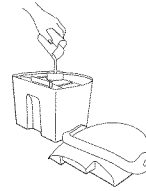

Operation

1. Plan activities to give your carpet time to dry.
2. Move furniture to another area if cleaning an entire room (optional).
3. Thoroughly vacuum area with a dry vacuum cleaner before deep cleaning.
4. Plan your cleaning route to leave an exit path. It is best to begin cleaning in the corner farthest from your exit.
5. Pretreating (optional)

Note: Pretreating is recommended to improve cleaning effectiveness for heavily soiled carpet in high traffic areas such as entryways and hallways.

- A. Spray the BISSELL Tough Stain Pre-treat formula onto heavy traffic areas, soiled areas, or stains.
- B. Allow to penetrate for at least 3 minutes.
- C. Following the instructions below, clean as normal, using the machine on the high traffic setting.

ATTENTION:

Some Berber carpets have a tendency to fuzz with wear. Repeated strokes in the same area with an ordinary vacuum or deep cleaner may aggravate this condition.

Tip:

Deep cleaning carpeting and upholstery regularly can reduce dust and allergens in your home.

Fill the 2-in-1 water tank

1. Release the handle and lay the machine handle back to access the tank.
2. Remove the tank from the base of the machine by lifting the tank carry handle.

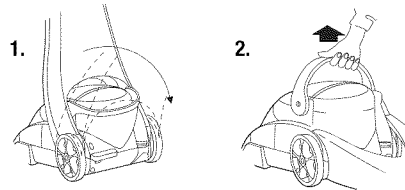

Operation

Fill the 2-in-1 water tank (continued)

3. Carry like a bucket to the sink. Rotate the handle forward to unlatch the lid. Lift off and set the lid aside.
4. Using the measuring cup, pour BISSELL deep cleaning formula into the mouth of the bladder.
- 4a. If using the BISSELL 3x Concentrated Fiber Cleansing Formula: add 3 capfuls of 3x Concentrated Fiber Cleansing Formula into the mouth of the bladder.
5. Fill up the bladder with clean hot tap water. ***Do not boil or microwave water as it can destroy the bladder.**
6. Replace the top of the tank by matching the lid and tank edges. Handle must be in the forward position in order to replace lid. Rotate the handle to the carrying position to latch the lid.
Note: Remember to secure the lid and test to make sure it is secure before picking up the tank.
7. Place tank into machine base, seating firmly in place. Rotate tank handle back into latched position. Bring machine handle back into upright position.

Power switch

Plug the deep cleaner into a proper outlet and turn the power switch ON. The switch is found on the side of the unit.

Cleaning strokes

1. While pressing the spray release trigger, make one slow forward and backward wet pass. Let the BISSELL advanced deep cleaning formula and DirtLifter Power Brush do the work for you.
Caution: Do not overwet.
2. Release the trigger and make one slow forward and back pass over the same area to remove any residual dirty water.
3. Repeat cleaning passes without pressing the trigger until you can't see any more water being suctioned up.
4. When cleaning job is complete, refer to the Maintenance care section on page 9 for machine cleanup and storage instructions.

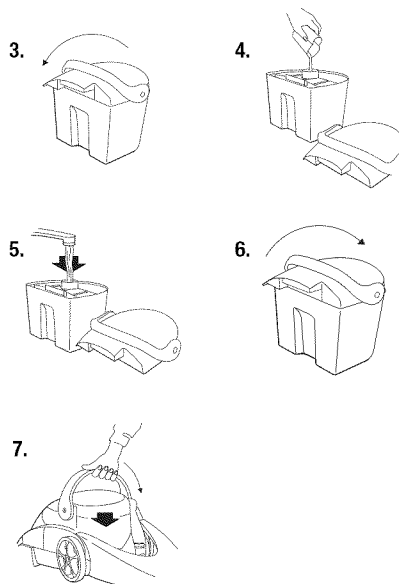

Tip:

Thorough vacuuming before deep cleaning will prevent early clogging of the lint trap.

WARNING:

To reduce the risk of fire and electric Shock due to internal component damage, use only BISSELL cleaning fluids intended for use with the deep cleaner. Non-BISSELL cleaning solutions may harm the machine and void the warranty.

Operation

Empty the 2-in-1 water tank

1. Remove the 2-in-1 water tank from the base using the tank carry handle. Carry the tank like a bucket to a utility sink or outside where you will dispose of the collection water. Remove the top of the tank by rotating the handle forward to unlatch lid and lifting lid off tank.

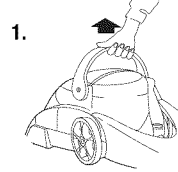

2. Empty collection water from bottom of tank.

NOTE: You may notice hair & debris deposits on the carpet or in the tank that were loosened by the cleaning action (especially with newer carpets that have never been deep cleaned before). This debris should be picked up and thrown away.

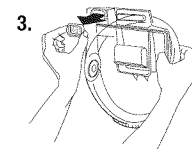
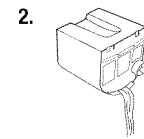

3. After each use, remove and rinse the lint screen located on the tank lid.

4. Refill the tank in tank by referencing "Fill the 2-in-1 water tank" on page 7. Remember to secure the top of the tank by rotating the handle and test to make sure it is secure before picking up.

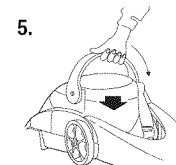
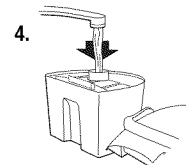

5. Return 2-in-1 water tank to the machine.

Cleaning fluid

Keep plenty of genuine BISSELL Fiber Cleansing Formula™ and Scotchgard™ protector cartridges on hand so you can clean and protect whenever it fits your schedule. Always use genuine BISSELL deep cleaning formulas.

! WARNING:
To reduce the risk of fire and electric shock due to internal component damage, use only BISSELL cleaning fluids intended for use with the deep cleaner. Non-BISSELL cleaning solutions may harm the machine and void the warranty.



48 oz. BISSELL
Fiber Cleansing Formula™
with Scotchgard™
Protector
item # 0710



48 oz. BISSELL
Multi-Allergen Removal™
Formula with Scotchgard™
Protector
item # 0720



48 oz. BISSELL
Pet Odor and Soil Removal™
Formula with Scotchgard™
Protector
item # 0730



48 oz. BISSELL
Natural Orange
Extract Formula with
Scotchgard™ Protector
item # 0740



43 oz. BISSELL 3X
Concentrated Fiber
Cleansing Formula with
Scotchgard™ Protector
item # 0716



8 www.bissell.com



800.237.7691



Maintenance and care

Machine care

For best results, a few simple steps can assure your machine is well maintained after your cleaning is complete.

1. Turn power switch OFF (0). Unplug the machine and wrap the power cord.
2. After emptying the 2-in-1 water tank, rinse it out at a faucet with running hot tap water, taking care to clean underneath the heavy duty bladder, and all around it. Clean out lint trap.
3. Replace the 2-in-1 water tank on the machine.
4. Any loose hair or debris can be pulled from the brush roll if desired and thrown away.
5. Wipe the machine's exterior with a soft cloth.
6. After carpet is dry, vacuum again to remove hair and fuzz.

Machine storage

Once your cleaning is complete, make sure the 2-in-1 water tank is emptied and rinsed out. Put the unit away in a closet or basement for the next use.

Note: Store cleaner in a protected, dry area. Since this product uses water, it must not be stored where there is a danger of freezing. Freezing will damage internal components and void the warranty.

WARNING:

To reduce the risk of fire, electric shock or injury, unplug from the outlet before servicing.

Troubleshooting

Reduced Spray OR No Spray.

Possible cause

1. Bladder may be empty
2. The lint screen may be clogged
3. 2-in-1 tank may not be seated properly.
4. Pump may have lost prime.

Remedies

1. Turn power off; Refill bladder with clean hot tap water.
2. Clean out lint screen.
3. Turn power switch OFF; remove tank and reseal tanks.
4. Turn power switch OFF; after 1 minute turn ON and depress spray release trigger.

Troubleshooting

Reduced Spray OR No Spray.

Possible cause

5. The pump belt may be broken.

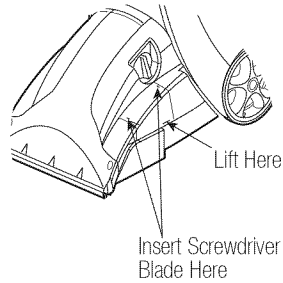

Remedies

5. Turn power Switch OFF (O) and unplug from the outlet. To check if a pump belt has broken, you will need a flat head screwdriver. Insert the blade end into the lower slot of the belt access door to release the lower snap. If necessary, insert the blade end into the upper slot to release the upper snap. Examine the belt for breakage. You should be able to see the pump belt looped around the motor shaft. If it is broken or missing, please refer to Replacement Parts on page 11 before calling BISSELL Consumer Services. Complete installation instructions will accompany the replacement belt.

DirtLifter PowerBrush Does Not Turn.

Possible cause

1. The brush belt or pump belt is off or broken.

Remedies

1. Turn the machine OFF (O) and unplug from the outlet. To check if the brush belt or pump belt has broken, you will need a flat head screwdriver. Insert the blade end into the lower slot of the belt access door to release the lower snap. If necessary, insert the blade end into the upper slot to release the upper snap. Examine the belt for breakage. If broken, please refer to Replacement Parts on page 11 before calling Consumer Services. Complete installation instructions will accompany the replacement belt.

Cleaner Not Picking Up Solution

Possible cause

1. Nozzle window may not be properly attached.
2. 2-in-1 tank lid is not installed.
3. 2-in-1 tank is not properly seated.
4. 2-in-1 tank has picked up maximum dirty water.

Remedies

1. Make sure the tabs on the floor nozzle window are inserted through the mating slot in the main housing. Re-install if necessary.
2. Re-install lid; refer to the Operation section.
3. 2-in-1 tank must be firmly seated to function; remove and reseal 2-in-1 tank.
4. Empty 2-in-1 tank and refill, refer to the Operation section.

Other maintenance or service not included in the manual should be performed by an authorized service representative.

Thank you for selecting a BISSELL product.

Please do not return this product to the store

For any questions or concerns, BISSELL is happy to be of service.
Contact us directly at 1-800-237-7691.



BISSELL Consumer Services

For information about repairs or replacement parts, or questions about your warranty, call:

BISSELL Consumer Services
1-800-237-7691

Monday - Friday 8 a.m. — 10 p.m. EST

Saturday 9 a.m. — 8 p.m. EST

Or write:

BISSELL HOMECARE, INC

PO Box 3606

Grand Rapids MI 49501

ATTN: Consumer Services

Or visit the BISSELL website - www.bissell.com

When contacting BISSELL, have model number of unit available.

Please record your Model Number: _____

Please record your Purchase Date: _____

NOTE: Please keep your original sales receipt. It provides proof of date of purchase in the event of a warranty claim. See Warranty on page 12 for details.

Replacement parts

Item	Part No.	Part Name
1	015-9043	Tank Assembly Complete
2	015-4439	Tank Lid Assembly
3	015-9041	Tank Bottom
4	213-0213	Baffle with Red Float
5	210-4052	Window Gasket
6	215-0628	Replacement Pump Belt (with instructions)
7	015-0621	Replacement Brush Belt (with instructions)
8	213-3501	Lint Screen
9	213-3010	Measuring Cup
10	0710	48 oz. BISSELL Fiber Cleansing Formula with Scotchgard™ Protector
11	0400	22 oz. BISSELL Tough Stain PreCleaner
12	0716	3x Concentrated Fiber Cleansing Formula with Scotchgard™ Protector 43 oz.

***Not all parts are included with every model.**

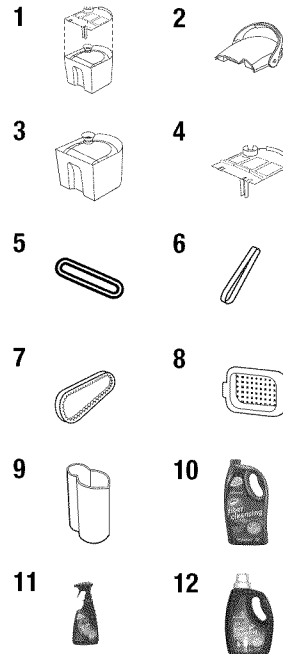

Warranty - BISSELL PowerSteamer/PowerLifter

This warranty gives you specific legal rights, and you may also have other rights which may vary from state to state. If you need additional instruction regarding this warranty or have questions regarding what it may cover, please contact BISSELL Consumer Services by E-mail, telephone, or regular mail as described below.

Limited One Year Warranty

Subject to the ***EXCEPTIONS AND EXCLUSIONS** identified below, upon receipt of the product BISSELL Homecare, Inc. will repair or replace (with new or remanufactured components or products), at BISSELL's option, free of charge from the date of purchase by the original purchaser, for one year any defective or malfunctioning part.

See information below on "If your BISSELL product should require service".

This warranty applies to product used for personal, and not commercial or rental service. This warranty does not apply to fans or routine maintenance components such as filters, belts, or brushes. Damage or malfunction caused by negligence, abuse, neglect, unauthorized repair, or any other use not in accordance with the User's Guide is not covered.

If your BISSELL product should require service:

Contact BISSELL Consumer Services to locate a BISSELL Authorized Service Center in your area.

If you need information about repairs or replacement parts, or if you have questions about your warranty, contact BISSELL Consumer Services.

Website or E-mail:

www.bissell.com

Use the "Customer Services" tab.

Or Call:

BISSELL Consumer Services

1-800-237-7691

Monday - Friday 8 a.m. - 10 p.m. ET

Saturday 9 a.m. - 8 p.m. ET

Or write:

BISSELL Homecare Inc.

PO Box 3606

Grand Rapids MI 49501

ATTN: Consumer Services

BISSELL HOME CARE, INC. IS NOT LIABLE FOR INCIDENTAL OR CONSEQUENTIAL DAMAGES OF ANY NATURE ASSOCIATED WITH THE USE OF THIS PRODUCT. BISSELL'S LIABILITY WILL NOT EXCEED THE PURCHASE PRICE OF THE PRODUCT.

Some states do not allow the exclusion or limitation of incidental or consequential damages, so the above limitation or exclusion may not apply to you.

*EXCEPTIONS AND EXCLUSIONS FROM THE TERMS OF THE LIMITED WARRANTY

THIS WARRANTY IS EXCLUSIVE AND IN LIEU OF ANY OTHER WARRANTIES EITHER ORAL OR WRITTEN. ANY IMPLIED WARRANTIES WHICH MAY ARISE BY OPERATION OF LAW, INCLUDING THE IMPLIED WARRANTIES OF MERCHANTABILITY AND FITNESS FOR A PARTICULAR PURPOSE, ARE LIMITED TO THE ONE YEAR DURATION FROM THE DATE OF PURCHASE AS DESCRIBED ABOVE.

Some states do not allow limitations on how long an implied warranty lasts, so the above limitation may not apply to you.



©2007 BISSELL Homecare, Inc.
Grand Rapids, Michigan
All rights reserved. Printed in China
Part Number 120-4007
Rev 5/07
Visit our website at:
www.bissell.com



12 www.bissell.com



800.237.7691