



## Compact Refrigerator

Model 60912

9.5 cu. ft. Capacity

### Read This Manual!

It will tell you how to operate and care for your refrigerator. It also offers tips on how to get the best and lowest cost performance.

If you prefer installing your own parts, use the parts list to find the part number. Do not use the illustration number.

In the space below record the model and serial number of your refrigerator. Each is printed on the model number plate located in the upper corner of the refrigerator back. Use these numbers when calling for service.

Model No. \_\_\_\_\_ Serial No. \_\_\_\_\_

### Full One Year Warranty on Refrigerator

For one year from the date of purchase, when this refrigerator is operated and maintained in accordance with the owner's instructions that come with it, Sears will repair it, free of charge, if defective in material or workmanship.

### Full Five Year Warranty on Sealed Refrigeration System

For five years from the date of purchase, when this refrigerator is operated and maintained in accordance with the owner's instructions that come with it, Sears will repair the sealed system (consisting of refrigerant, connecting tubing and compressor motor), free of charge, if defective in material or workmanship.

The above warranty coverage applies only to refrigerators which are used for the storage of food for private household purposes.

Warranty service is available by contacting the nearest Sears Service Center in the United States.

This warranty applies only while this product is in use in the United States. This warranty gives you specific rights and you may also have other rights which vary from state to state.

Sears, Roebuck and Co., Dept. 817WA,  
Hoffman Estates, IL 60179

### Installation

Remove all packing material and tape from unit. Inspect unit thoroughly. Notify Sears immediately if unit has any damaged or missing parts.

Install unit on a strong level floor or counter. Avoid any direct sunlight, heat source or moisture.

Let air circulate freely around the refrigerator. Keep the back of the unit at least 4 inches away from the wall. Provide at least 1 inch of space between the top of the unit and any surface above it.



**CAUTION:** If you turn off the cold control, allow at least three minutes before restarting to avoid blowing fuses or tripping your circuit breaker.

### Electrical Requirements

120 Volts, 60 Hz (60 cycles AC), 15 amps

### Electrical Grounding

Your refrigerator comes with a three-prong plug and must be inserted into a three-prong, grounded wall outlet. Do not use an extension cord.



**WARNING:** Unless the above grounding method is followed, you are not protected against severe or lethal shock in the event of a short circuit in refrigerator wiring or electrical components.

### Things to Remember

1. When resetting your refrigerator to a new temperature, allow 24 hours for it to reach the new setting.
2. The motor will start and stop often. It must do so in order to maintain the temperature you select.
3. Keep your refrigerator level.
4. Unplug the refrigerator before doing anything with the electrical system.

---

Sears, Roebuck and Co., Hoffman Estates, IL 60179

---

## Use and Care Information

### Tips on Everyday Care and Use

- To control the temperature:**  
First, set the Cold Control on "3." Wait 24 hours for the entire cabinet to cool. Then adjust the control if necessary. Setting the Cold Control to MIN is the warmest setting; MAX is the coldest. The MAX setting may reduce the temperature to below freezing, but it will not cool the refrigerator faster.  
The fresh food section should be as cold as possible without freezing vegetables or milk. Adjust as necessary.
- Defrost:**  
Defrost when 1/4 inch of frost forms. Set the temperature control dial to OFF for defrosting. Remove food. Do not touch the freezing plate with your bare hands. Do not use electric defrost devices or hair dryers to melt the frost. They may damage the plastic parts.  
When defrosting is completed, wipe the freezing plate dry and reset the control dial. Return food to refrigerator.
- For all cleaning:**  
Mix 2 tablespoons baking soda with 1 quart warm water or use a mild soap. Do not use strong cleaners, scouring powder or pads. For persistent odors, contact Sears Service Center for odor removal products. Do not put the drip tray in the dishwasher. Vacuum the condenser tubing on the back of the refrigerator when dusty.

### Energy Saving Tips

- Close the door as soon as you can** after opening it to remove food. Make sure the door is fully shut after each use so that cold air doesn't escape from the refrigerator cavity.
- Keep the condenser coils clean.** The motor must work harder when the coils are dusty. Clean the coils at least once every 3 months. They are located on the back of the unit.
- Adjust the Cold Control.** Try a warmer setting. Your refrigerator may be colder than necessary. Use the condition of milk to check refrigerator temperature. As long as milk keeps without spoiling your refrigerator is cold enough.
- Do Not place hot foods** in the refrigerator.
- Do Not allow more than 1/4 inch of frost** to build up in the freezer compartment.

- Reduce the number and length of the times you open the door.** Your cooling system won't have to run as often.
- Keep your refrigerator level,** so that the door seals tightly. When the door is closed, the door gaskets should touch the refrigerator all the way around. If not, make your refrigerator level by use of the adjustable leg located under the unit.
- Keep your refrigerator away from stoves or other heat sources.** A cool and dry place allows your refrigerator to operate more efficiently.

### Before Calling for Service

- Check the plug and fuse.
- Test the outlet with a lamp.
- Be sure the control is not set to OFF.
- Read this manual, especially the items under Use and Care Information. You may find the answer to your questions.
- If you do not find the answer to your questions in this manual, find the unit model number (on upper back of refrigerator) and contact your nearest Sears Service Center.

When requesting service or ordering parts, always provide the following information:

- Product Name           • Part Name
- Model Number           • Part Number



**DANGER: ELECTRICAL SHOCK HAZARD**

**Disconnect power before servicing.**

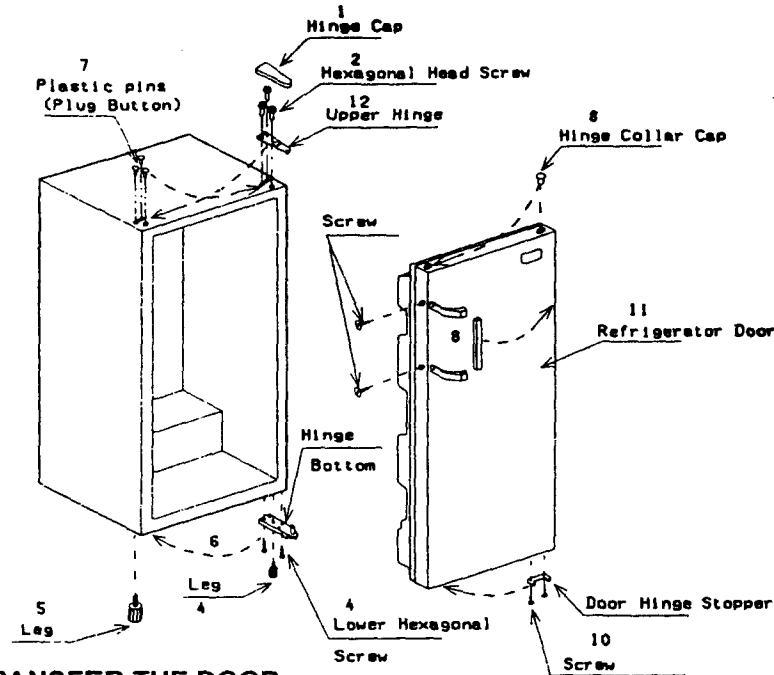

## HOW TO TRANSFER THE DOOR HINGE LOCATION OF A REVERSIBLE DOOR.

Refer to the disassembly diagram and change the door hinges in the following procedure. The numbers in the diagram indicate the procedure order in the instructions.

1. Remove the hinge cap by twisting it off.
2. Remove the upper hexagonal head screws. The refrigerator door can now be removed.
3. Tilt the refrigerator back or lay it on its back for steps 4, 5, and 6. Use a pad or blanket to protect the floor and to avoid scratching the painted finish.
4. Remove the leveling legs by turning them counterclockwise. Remove the lower hexagonal head screws, two on the hinge side and one near the front corner of the other side.
5. Attach the left side leg and leg spacer to the other side hole which was positioned symmetrically.
6. Attach the bottom hinge symmetrically to the other side of the cabinet.
7. Remove the upper hinge plastic pins and insert them in the holes from which the screws were removed in Procedure 2.
8. Take off the hinge collar cap using a screwdriver and insert them in the hinge collar on the opposite side.
9. Remove both screws holding the door handle on to the door. Remove the plastics pins on the other side of the door and insert them in the holes made by removing the handle.
10. Remove the refrigerator door hinge stopper and the hinge stopper screws and install them in the other side of the door.
11. Attach the refrigerator door to the bottom hinge.
12. Attach the upper hinge to the refrigerator door. Do not tighten the screws completely.
13. The direction in which the door opens has now been changed; however, the following points should be checked:
  - a. Make sure the door is on straight.
  - b. Make sure that there is no space between the door gasket and the refrigerator unit itself when the door is closed.
  - c. Make sure that the gasket on the hinge side is not caught between the door and the unit when the door is opened or closed. (If the door is forced closed when the gasket is caught, the gasket may be damaged.)

When checking the above points , if it is discovered that the door is not installed properly (this is apt to happen at the first try), loosen the screws holding the upper hinge, straighten the door and tighten the screws slowly with the socket wrench. After making sure that the door is installed correctly, tighten all the screws holding the hinge.

If they are not tightened, the door may slip out of position or there may be an opening between the door and the unit.

14. Stand the unit back in the upright position.

# Parts List

Model: 564.60912100

CAUTION: Use Kenmore parts number on all orders, not the illustration number.

Illus. No.	Part No.	Description	Illus. No.	Part No.	Description
1	301811	Door Liner	29	302009	Screws
2	302653	Gasket Assembly	30	301718	Hinge Top
3	302388	Grommet Cap	31	302372	Plug Buttons
4	302340	Mascot	32	301730	Case Wire Splicer
5	302338	Handle	33	300308	Screw
6	300063	Cap Handle A	34	301991	Screw, #026 Machine Screw
7	300064	Cap Handle B	35	300308	Screw
8	302647	Screw for Handle	36	301817	Clamp
9	302307	Door trim Shelf	37	301744	Power Cord
10	300308	Screw	38	300885	Legs
11	301847	Door Shelf Bushing Right	39	302426	Bottom Hinge
12	301846	Door Shelf Bushing Left	40	300456	Screw
13	302486	Ice Cube Tray	41	302317	Screw
14	302644	Shelf	42	300502	Condenser Bracket
15	302657	Drip Tray	43	302646	Condenser
17	302643	Glass Shelf	44	302659	Evaporator
18	302671	Trim for glass shelf	45	300255	Thermo Bulb Clamp
19	301795	Crisper	46	302304	Drier
20	302309	Evaporator Door Grommet	47	302648	Compressor
21	302645	Evaporator Door	48	302202	Clip Relay Cover
22	302199	Socket for lamp	49	302201	Relay Cover
23	301021	Lamp	50	302650	PTC Thermistor
24	302191	Panel Thermo	51	302649	Running Capacitor
25	301581	Thermostat	52	300413	Compressor Mounting Bolts
26	302192	Switch	53	302427	Compressor Mounting Grommets
27	302175	Thermo Knob	54	302651	Compressor Base Plate
28	300033	Hinge Cover	55	301868	Screw
			56	301809	Foam Door

Part No.	Description
302654	Owner's Manual/Parts list/ Auxiliary Manual
302655	Technical sheet

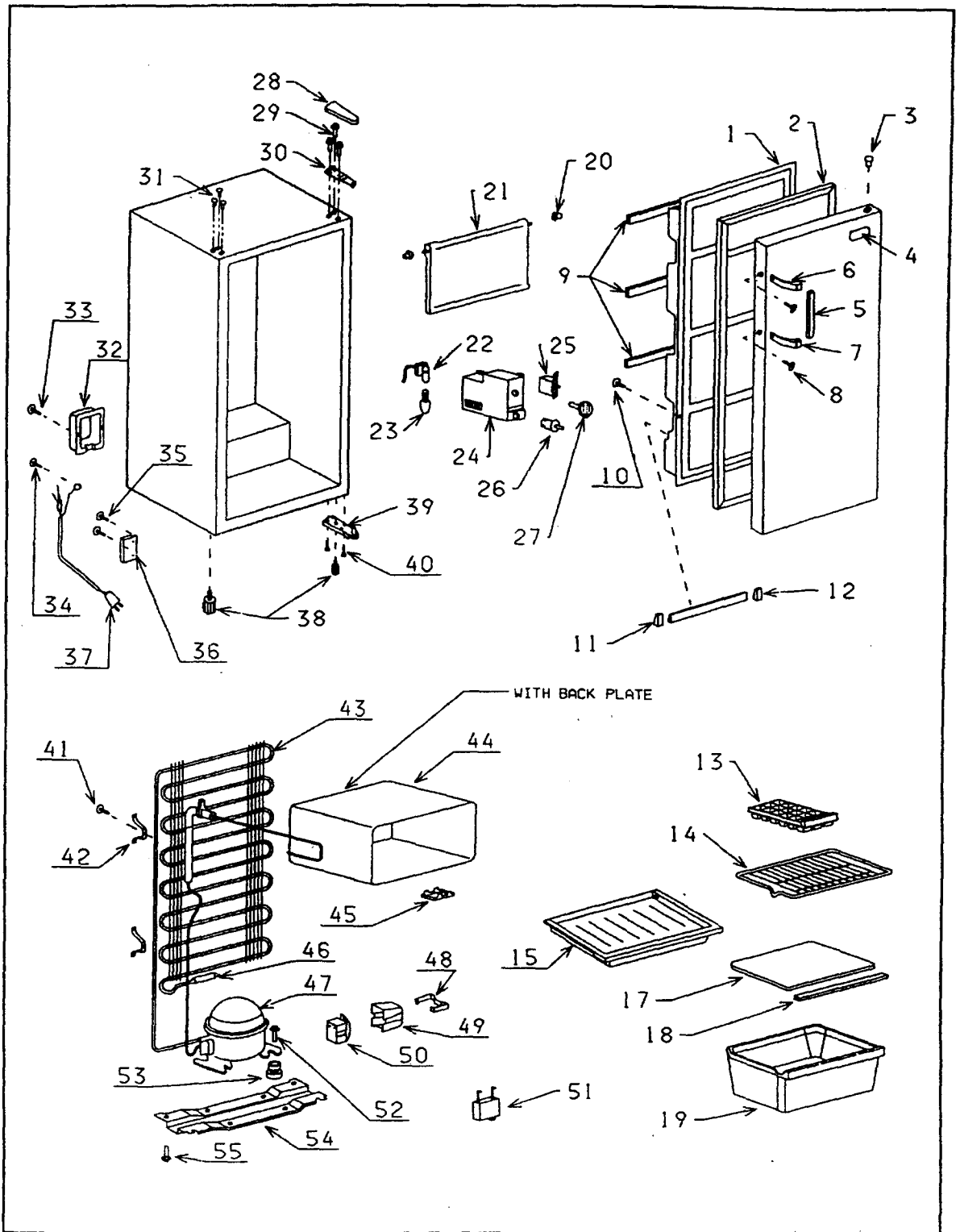

**For in-home major brand repair service:**

Call 24 hours a day, 7 days a week

**1-800-4-MY-HOME™** (1-800-469-4663)

**Para pedir servicio de reparación a domicilio – 1-800-676-5811**

In Canada for all your service and parts needs call **– 1-800-665-4455**  
Au Canada pour tout le service ou les pièces

**For the repair or replacement parts you need:**

Call 6 am – 11 pm CST, 7 days a week

**PartsDirect™**

**1-800-366-PART** (1-800-366-7278)

**Para ordenar piezas con entrega a domicilio – 1-800-659-7084**

**For the location of a Sears Parts and Repair Center in your area:**

Call 24 hours a day, 7 days a week

**1-800-488-1222**

**For information on purchasing a Sears Maintenance Agreement  
or to inquire about an existing Agreement:**

Call 9 am – 5 pm, Monday – Saturday

**1-800-827-6655**

