

Owner's Manual

CRAFTSMAN[®]

**42" HEAVY DUTY
LAWNSWEEPER**

Model No. 486.24237

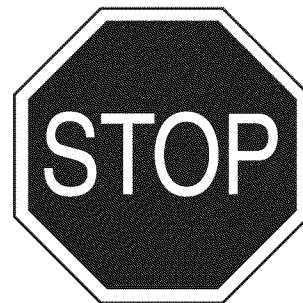

DO NOT RETURN TO STORE
For Missing Parts or Assembly
Questions Call 1-866-576-8388

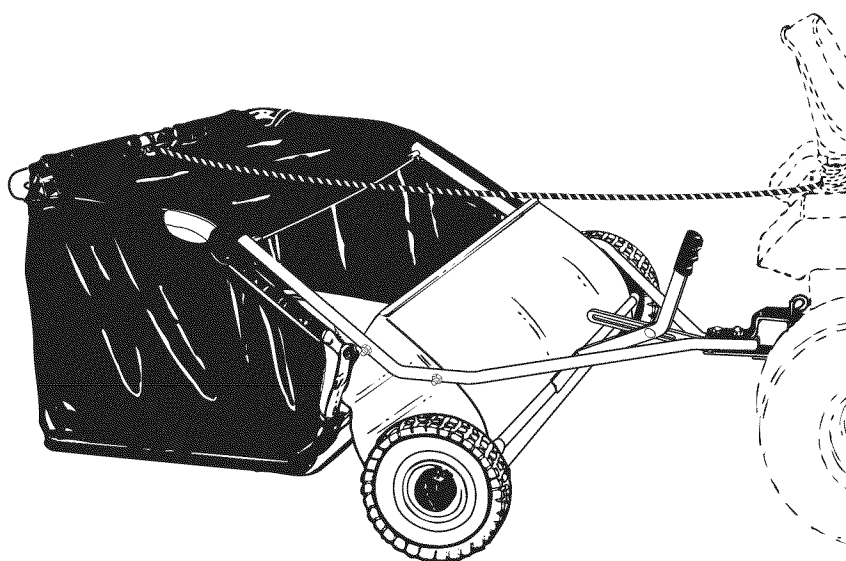

CAUTION:

Before using this product, read this manual and follow all Safety Rules and Operating Instructions.

- Safety
- Assembly
- Operation
- Maintenance
- Parts

Sears, Roebuck and Co., Hoffman Estates, IL 60179 U.S.A.
www.sears.com/craftsman

TABLE OF CONTENTS

Safety Rules	1	Maintenance Schedule	13
Warranty	2	Storage	13
Accessories and Attachments	3	Service and Adjustments	14
Carton Contents	3	Troubleshooting	14
Full Size Hardware Chart	4	Repair Parts Illustration	15
Sweeper Assembly Instructions	5	Repair Parts List	16
Hopper Assembly Instructions	7	Parts Ordering/Service	Back Cover
Operation	12		

WARRANTY

ONE YEAR FULL WARRANTY

When operated and maintained according to all supplied instructions, if this Craftsman product fails due to a defect in material or workmanship within one year from the date of purchase, return it to any Sears store or other Craftsman outlet in the United States for free replacement.

This warranty applies for only 90 days if this product is ever used for commercial or rental purposes.

This warranty gives you specific legal rights, and you may also have other rights which vary from state to state.

Sears, Roebuck and Co., D817WA, Hoffman Estates, IL 60179



SAFETY



Any power equipment can cause injury if operated improperly or if the user does not understand how to operate the equipment. Exercise caution at all times, when using power equipment.

1. Read the vehicle and sweeper owners manuals and know how to operate your vehicle and sweeper before using this sweeper attachment. Always instruct other users before they operate the sweeper.
2. Do not permit children to operate sweeper.
3. Do not permit anyone to ride on sweeper.
4. Never attach the hopper rope to any part of your body or clothing! Never hold onto the rope while towing the sweeper! Attach the rope to the towing vehicle to keep it away from wheels and rotating parts.
5. Operate the sweeper at reduced speed on rough terrain, near ditches and on hillsides to prevent loss of control.
6. Vehicle braking and stability may be affected with the attachment of this sweeper. Do not fill sweeper to maximum capacity without checking the capability of the towing vehicle to safely pull and stop with the sweeper attached. **Stay off of steep slopes.**
7. Stop and inspect vehicle and sweeper for damage after striking an object. Repair any damage before continuing operation.
8. Keep sweeper away from fire. Excessive heat can damage the brushes and hopper bag and could cause the bag and its contents to burn.
9. Before storing the sweeper, always empty the hopper bag to avoid spontaneous combustion.
10. Follow maintenance and lubrication instructions as outlined in the maintenance section of this manual.



Look for this symbol to point out important safety precautions. It means — **Attention!!**
Become alert!! Your safety is involved.

The model and serial numbers will be found on a decal attached to the lawnsweeper.

You should record both the serial number and the date of purchase and keep in a safe place for future reference.

MODEL NUMBER: 486.24237

SERIAL NUMBER: _____

DATE OF PURCHASE: _____

ACCESSORIES AND ATTACHMENTS

These accessories were available when the unit was purchased. They are also available at most Sears retail outlets and service centers. Most Sears stores can order repair parts for you when you provide the model numbers of your tractor and sweeper

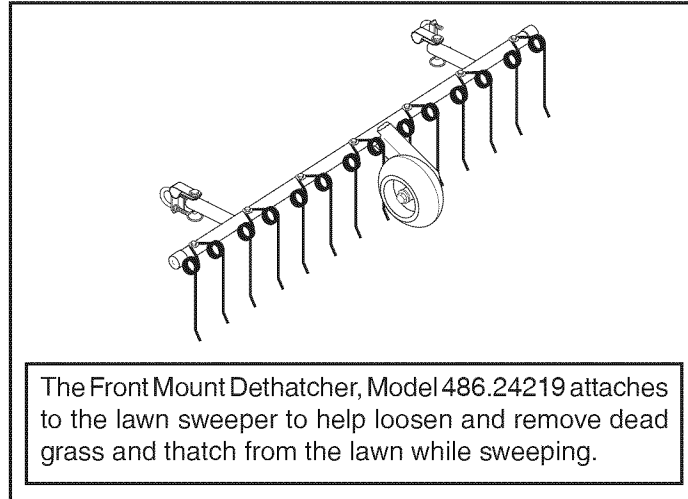

CARTON CONTENTS (Loose Parts in Carton)

- | | | |
|-----------------------------|-----------------------------|------------------------------------|
| 1. Sweeper Housing Assembly | 6. Height Adjustment Strap | 11. Upper Hopper Tube, (Front) (2) |
| 2. Bag Arm Tube (2) | 7. Height Adjustment Handle | 12. Hopper Middle Tube (Rear) (2) |
| 3. Hitch Tube, L.H. | 8. Hitch Tube, R.H. | 13. Lower Hopper Tube, (Front) (2) |
| 4. Hitch Bracket | 9. Rope | 14. Bag Support Strap (2) |
| 5. Hitch Bracket (Straight) | 10. Hopper Bag | 15. Hopper Bag Pivot Rod |
| | | 16. Bag Frame Strap |

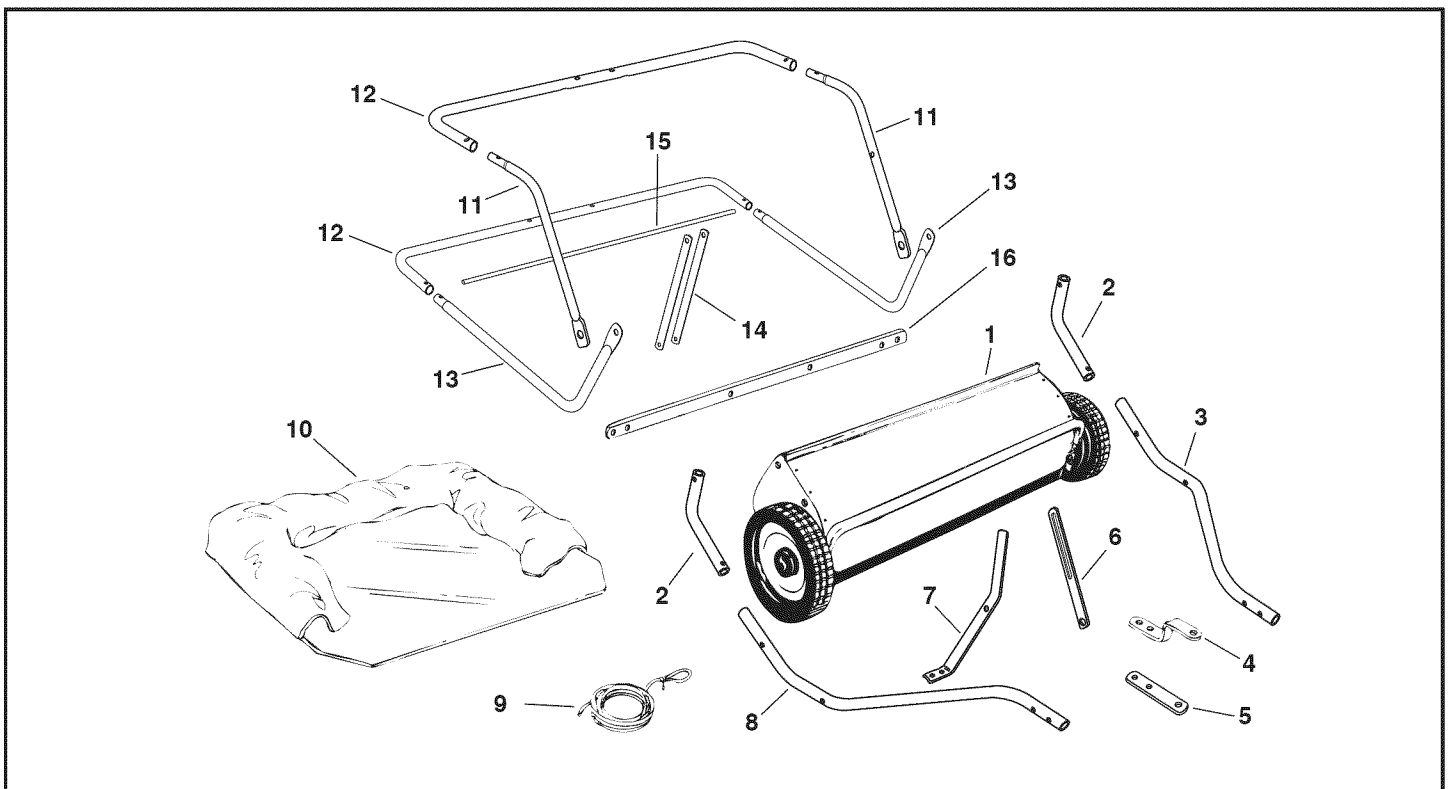

HARDWARE PACKAGE CONTENTS

SHOWN FULL SIZE

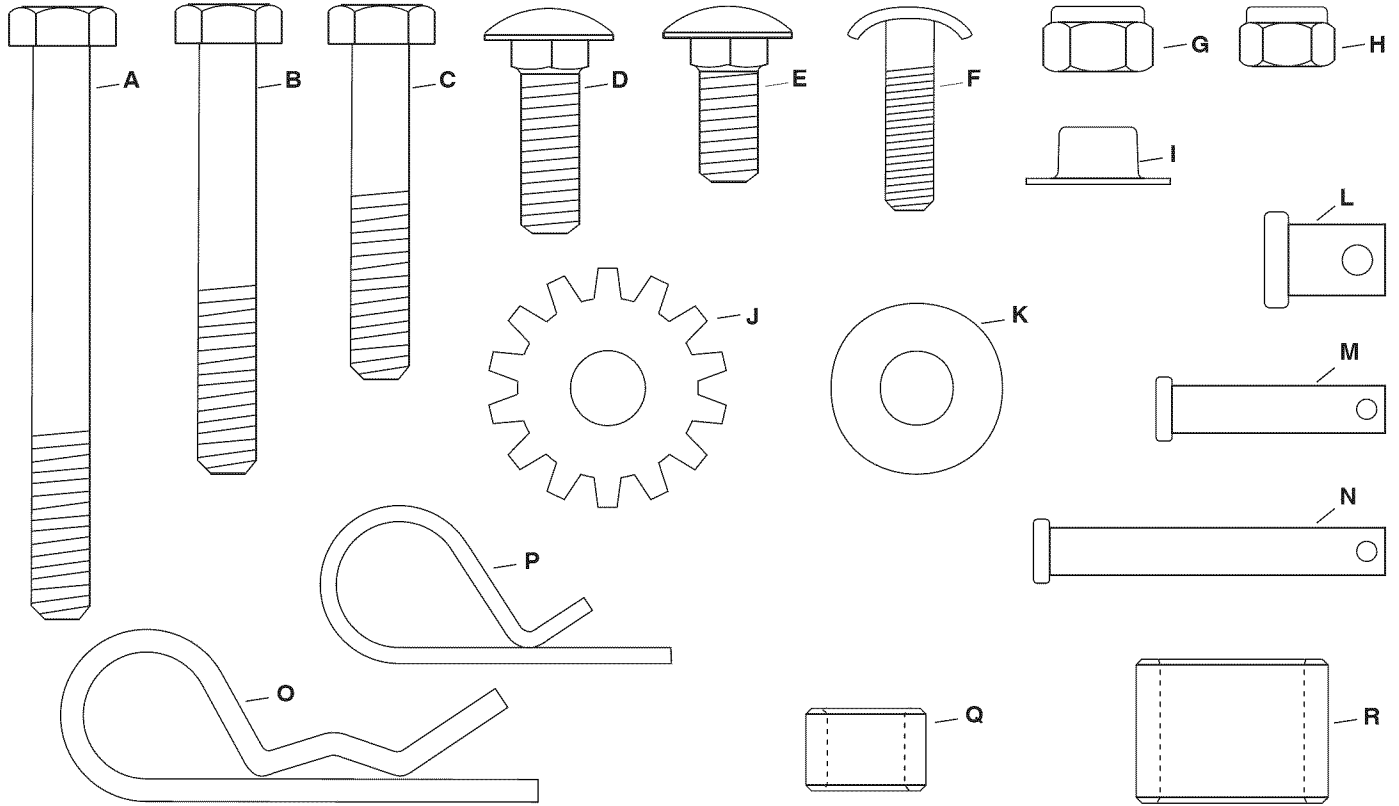

NOT SHOWN FULL SIZE

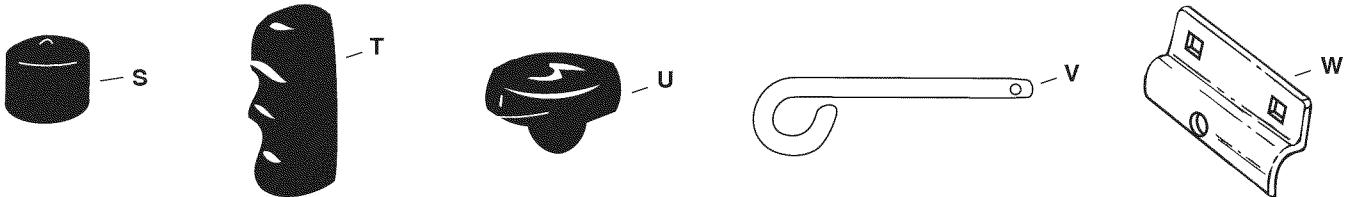

REF.	QTY.	DESCRIPTION	REF.	QTY.	DESCRIPTION
A	2	Hex Bolt, 5/16-18 x 3" Lg.	M	4	Clevis Pin, 1/4" x 1-1/8"
B	2	Hex Bolt, 5/16-18 x 2-1/4" Lg.	N	2	Clevis Pin, 1/4" x 1-3/4"
C	4	Hex Bolt, 5/16-18 x 1-3/4" Lg.	O	1	Hairpin Cotter, 1/8"
D	1	Carriage Bolt, 5/16-18 x 1" Lg.	P	8	Hairpin Cotter, 3/32"
E	4	Carriage Bolt, 5/16-18 x 3/4" Lg.	Q	1	Spacer Bushing
F	4	Curved Head Bolt, 1/4-20 x 1"	R	2	Hitch Spacer, 3/4"
G	12	Nylock Nut, 5/16"	S	2	Vinyl Cap
H	4	Nylock Nut, 1/4"	T	1	Grip
I	2	Palnut, 3/8"	U	1	Knob, Plastic
J	1	Star Washer	V	1	Hitch Pin
K	1	Flat Washer, 5/16" Std. Wrt.	W	4	Hopper Mount Clamp
L	2	Clevis Pin, 3/8" x 1/2"			

TOOLS REQUIRED FOR ASSEMBLY

- (1) Hammer
- (1) 7/16" Wrench
- (2) 1/2" Wrenches

STEP 1 - REMOVE PARTS FROM CARTON

- To protect painted parts, lay them on cardboard or a mat.
- Remove the sweeper housing, the loose parts and the hardware package from the carton. Lay out the parts and hardware as shown on pages 3 and 4.
- Place the sheet of cardboard from inside the carton onto your work surface to prevent scratching the sweeper.

STEP 2 - ASSEMBLE HITCH TUBES

- The hitch tubes are stamped with a "77L" for the left tube and a "76R" for the right tube. The sweeper housing is marked with an "L" on the left with side and an "R" on the right side. See figure 1.
- Hold the left hitch tube against the left side of the sweeper so that the "77L" on the tube faces **away** from the sweeper. Attach the hitch tube using two hex bolts (C) and nylock nuts (G). Repeat for the right hitch tube, but with the "76R" facing in toward the right side of the sweeper. **Do not tighten yet.** See figure 1.

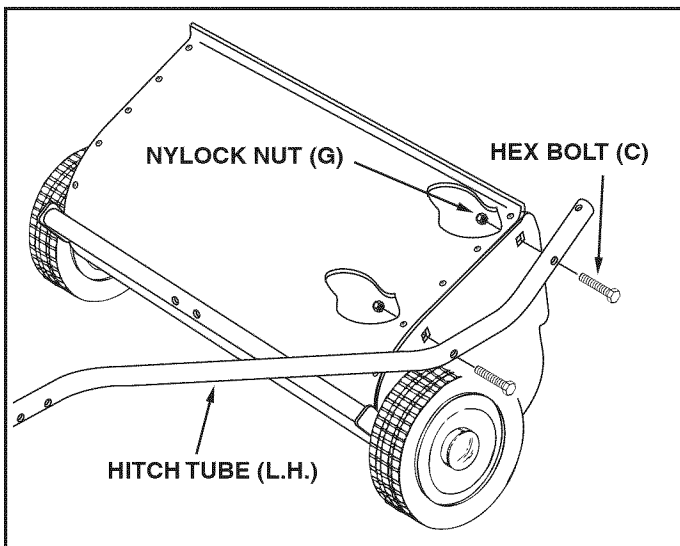

FIGURE 1

STEP 3 - ASSEMBLE HEIGHT ADJ. STRAP

- Place the spacer bushing (K) into the hole in the height adjustment strap. Place the strap and bushing between the hitch tubes, aligning them with the rear hole. Fasten the hitch tubes together, with the strap and bushing between them, using two hex bolts (A) and nylock nuts (G). **Do not tighten yet.** See figure 2.

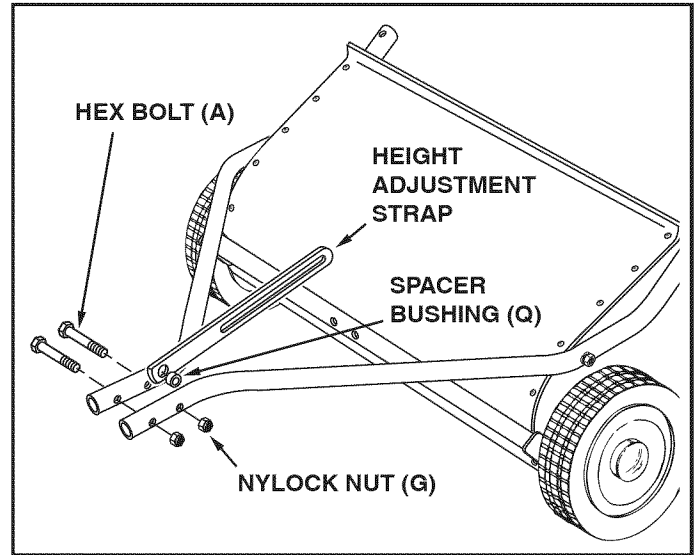

FIGURE 2

STEP 4 - MEASURE TRACTOR HITCH HEIGHT

- Use the mark along the side of this page to measure the height of the tractor hitch. The mark is 10" from the bottom of the page. If the tractor hitch is less than 10" above the ground, go to **STEP 5a**. If the tractor hitch is 10" or more above the ground, go to **STEP 5b**.

STEP 5a - ASSEMBLE HITCH BRACKETS

This step is for tractor hitches with less than 10" ground clearance. If your tractor hitch has more than 10" ground clearance, go to step 5b.

- Assemble the bent hitch bracket to the bottom and the straight hitch bracket on top of the hitch tubes. Fasten with two hex bolts (B) and two nylock nuts (G) as shown in figure 3. The bolts should straddle the front hitch tube bolt. **Do not tighten yet.**
- Assemble the hitch pin (V), two spacers (R) and the hairpin cotter (O) to the hitch brackets. See figure 3.

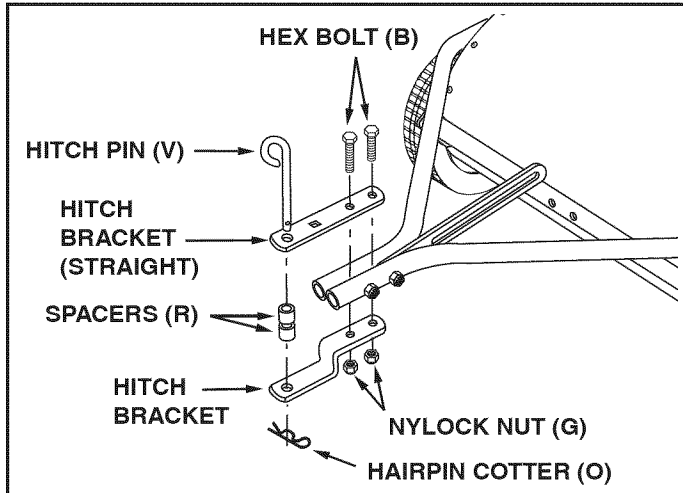

FIGURE 3

STEP 5b - ASSEMBLE HITCH BRACKETS

This step is for tractor hitches with more than 10" ground clearance. If your tractor hitch has less than 10" ground clearance, go back to step 5a.

- Assemble the bent hitch bracket on top and the straight hitch bracket to the bottom of the hitch tubes. Fasten with two hex bolts (B) and nylock nuts (G) as shown in figure 4. The bolts should straddle the front hitch tube bolt. **Do not tighten yet.**
- Assemble the hitch pin (V), two spacers (R) and the hairpin cotter (O) to the hitch brackets. See figure 4.

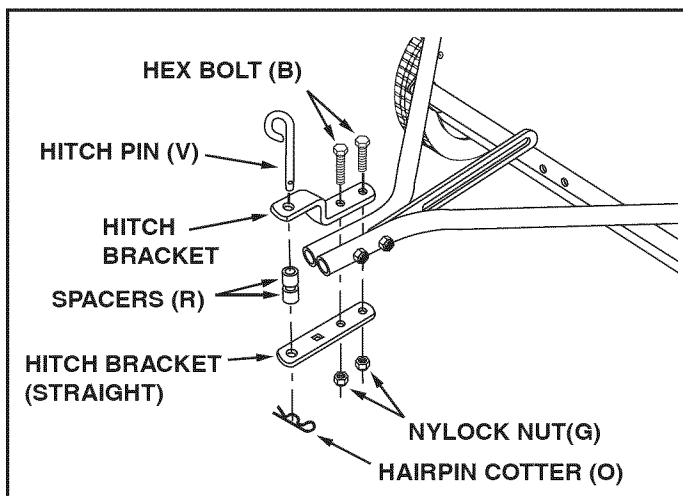

FIGURE 4

STEP 6 - TIGHTEN BOLTS

- **Tighten** the four bolts assembled in step 2.
- **Tighten** the two bolts assembled in step 3.
- **Tighten** the two bolts assembled in step 5a or 5b.

STEP 7 - ATTACH HANDLE

- Assemble the height adjustment handle to the height adjustment tube using the curved bolts, washers and nuts which come pre-assembled to the tube. Tighten the height adjustment handle so that the height adjustment strap is aligned with the outside of the handle. See figure 5.
- Assemble the grip (T) onto the end of the height adjustment handle as shown in figure 5.

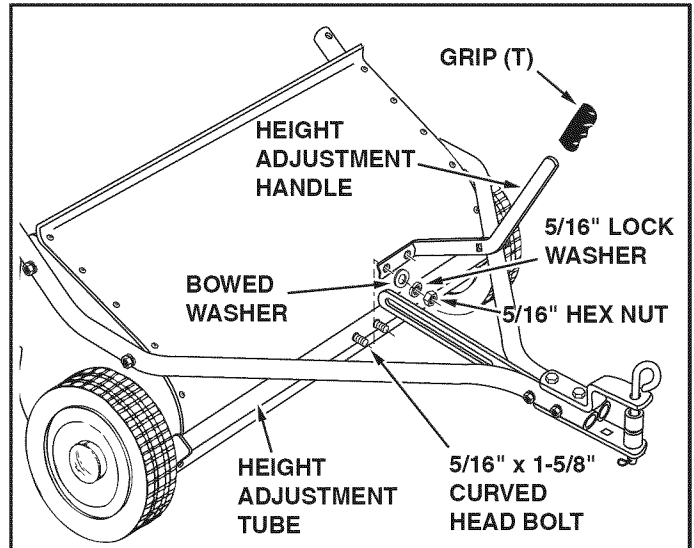

FIGURE 5

STEP 8 - ATTACH KNOB

- Place the star washer (J) between the height adjustment handle and the height adjustment strap. Insert the carriage bolt (D) through the handle, the star washer and the strap. Assemble the flat washer (K) and the plastic knob (U) onto the end of the carriage bolt and tighten. See figure 6.

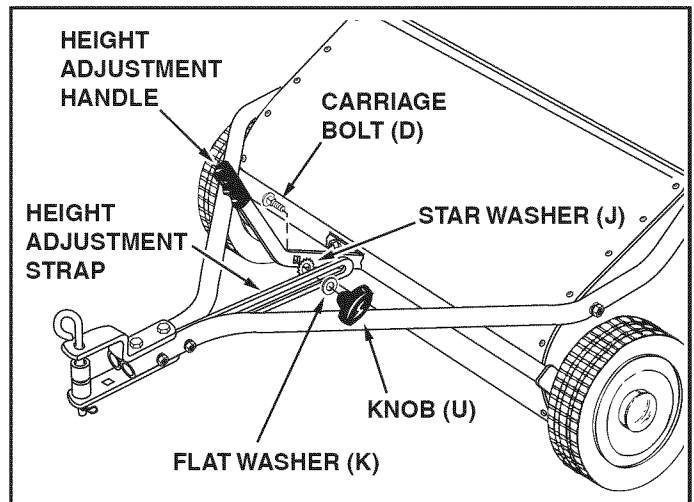

FIGURE 6

ASSEMBLY OF HOPPER BAG

STEP 9 - ASSEMBLE TUBES

- Fit the ends of the two upper hopper tubes into the ends of a rear hopper tube. Align the holes in the ends of the tubes and secure them in place using two curved head bolts (F) and nylock nuts (H). See figure 7.
- Fit the ends of the two lower hopper tubes into the ends of a rear hopper tube. Align the holes in the ends of the tubes and secure them in place using two curved head bolts (F) and nylock nuts (H). See figure 7.
- Insert a clevis pin (M) from the outside into each lower hopper tube and secure it with a hair cotter pin (P). See figure 7.

NOTE: Either side of the rear hopper tube can face up.

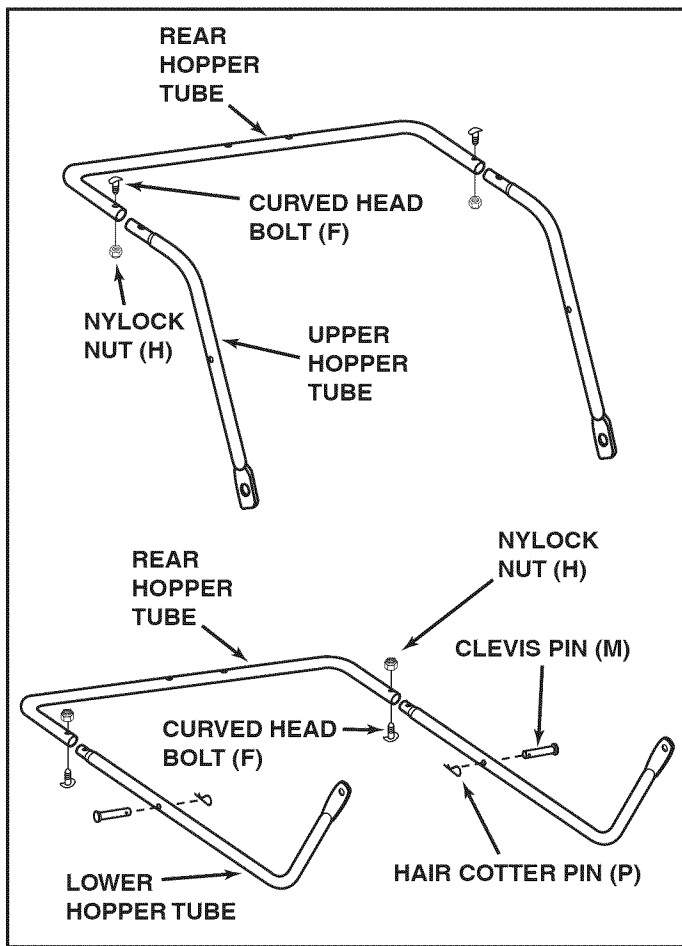

FIGURE 7

STEP 10 - ASSEMBLE TUBES TO BAG

- Unfold the hopper bag, reverse the fold of the mesh wind screen and then lay the bag out flat with the wind screen on top.
- Insert the ends of the assembled upper hopper tubes down through the stitched sleeves in the sides of the hopper bag and then slide the tubes back underneath the wind screen. See figure 8.

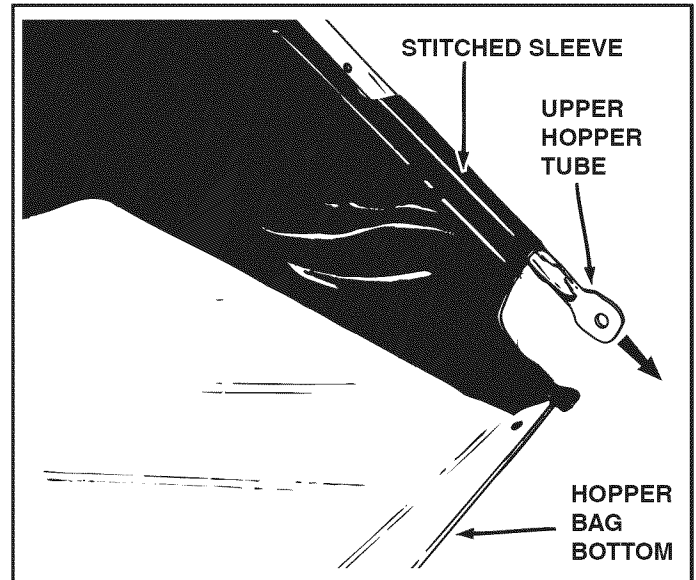

FIGURE 8

- Place the assembled lower hopper tubes into the bottom of the hopper bag and then slide the tubes to the back of the bag. See figure 9.
- Attach the ends of the lower hopper tubes to the **inside** of the upper hopper tubes using two clevis pins (L) inserted from the inside, and two hair cotter pins (P). See figure 9.

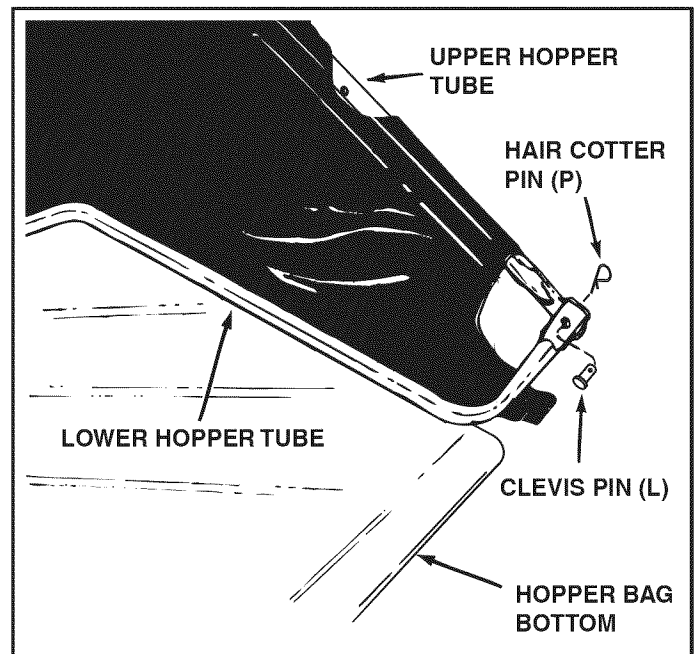

FIGURE 9

STEP 11 - ATTACH BAG BOTTOM

- Insert the bag frame strap into the stitched sleeve at the front edge of the bag bottom. See figure 10.

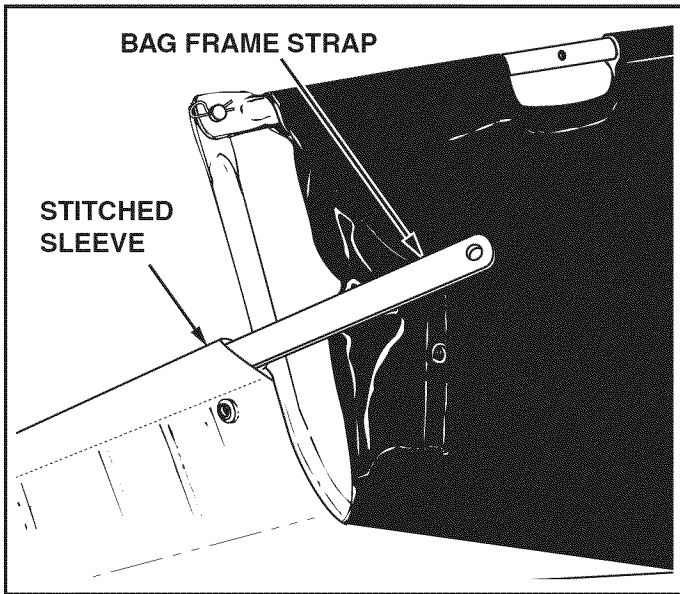

FIGURE 10

- Assemble the bag frame strap to the holes in the lower hopper tubes using two clevis pins (M) and hair cotter pins (P). See figure 11.

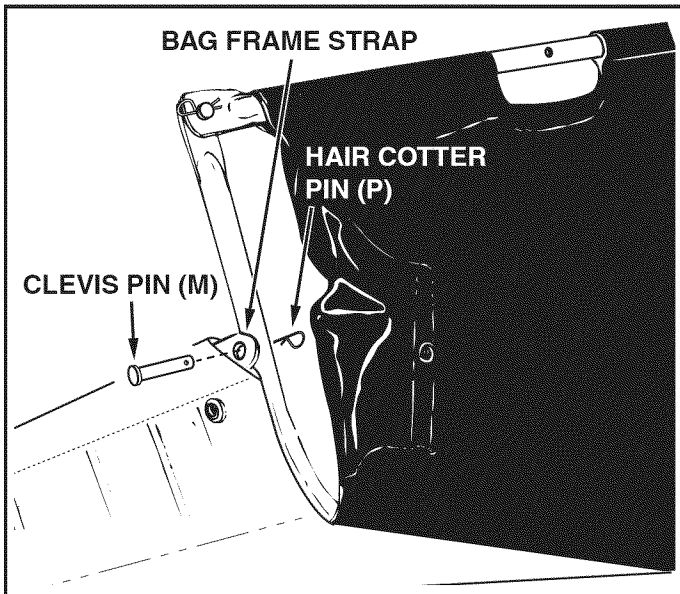

FIGURE 11

- Fold the bag flaps around the lower hopper tubes and attach to the bag bottom using the snaps. See figure 12.

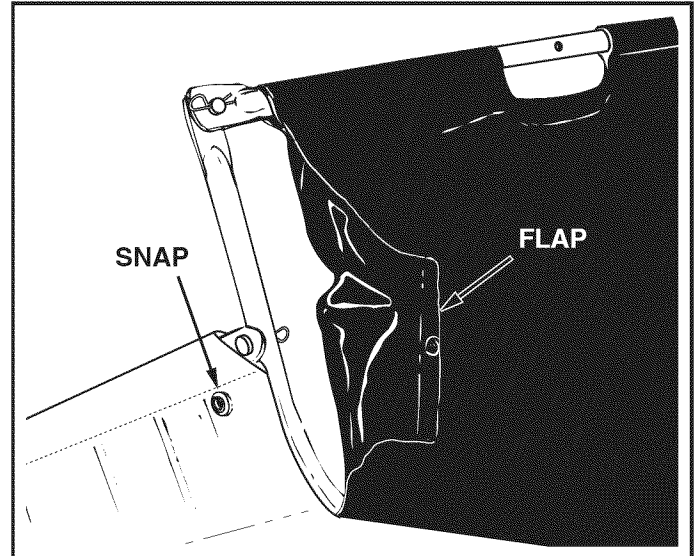

FIGURE 12

STEP 12 - ASSEMBLE HOPPER CLAMPS

- Assemble two hopper mount clamps (W) over the hole in the middle of each upper hopper tube using two carriage bolts (E) and two nylock nuts (G). Tighten only finger tight. See figure 13.

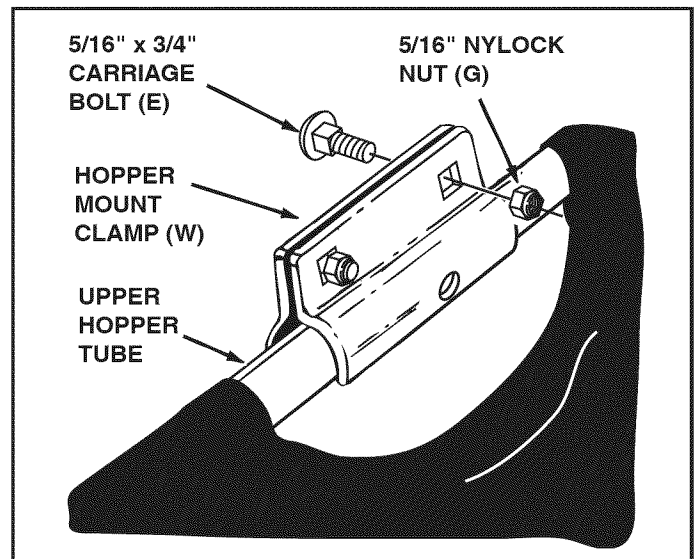

FIGURE 13

STEP 13 - ASSEMBLE PIVOT ROD

- Slide the end of the pivot rod through the upper hopper tube and the hopper mount clamps on one side of the hopper. Place a hopper support strap and then a bag arm tube onto the rod. Slide the rod through the stitched sleeve at the front edge of the wind screen, and then place another bag arm tube and a hopper support strap onto the rod. Slide the rod through the other upper hopper tube and hopper mount clamps. See figure 14.

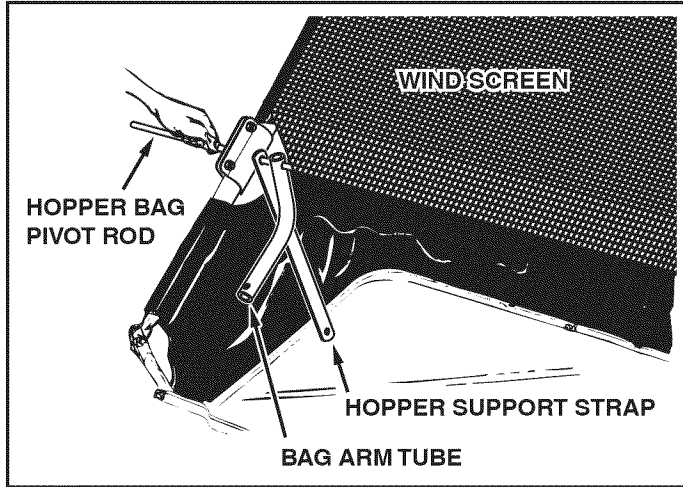

FIGURE 14

- Attach the bottoms of the hopper support straps to the clevis pins (M) in the lower hopper tubes, securing the straps with the previously assembled hair cotter pins (P). See figure 15.
- Tighten the nuts on the hopper mount clamps. See figure 15.

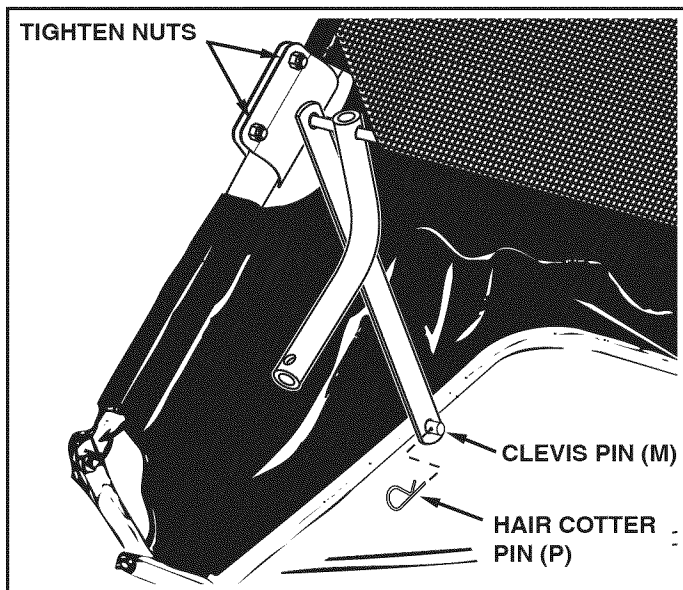

FIGURE 15

- Assemble a vinyl cap (S) onto each bag arm tube as shown in figure 16.
- Assemble two palnuts (I) onto the ends of the pivot rod using a hammer. See figure 16.

HINT: To ease assembly of the palnuts, place the bag on its side on a solid surface. With the bottom end of the pivot rod against the surface, tap a palnut onto the top end of the rod. Repeat for other end of rod.

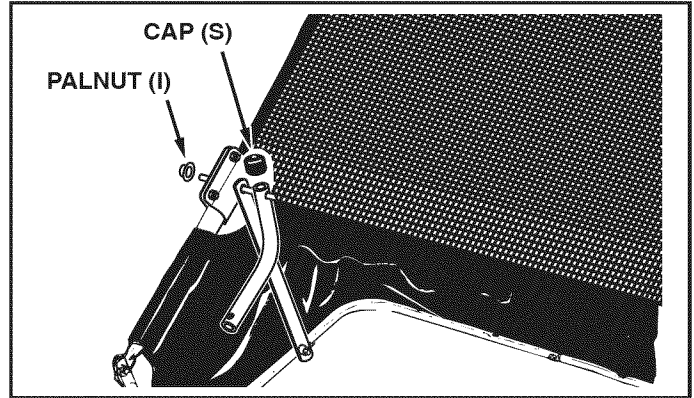

FIGURE 16

STEP 14 - ATTACH ROPE

- Secure the rope to the center of the upper rear hopper tube as shown in figure 17.



FIGURE 17

STEP 15 - ATTACH HOPPER BAG

- To attach the hopper bag to the sweeper, slide the ends of the bag arm tubes into the ends of the hitch tubes and secure with two clevis pins (N) and hairpin cotters (P). See figure 18.

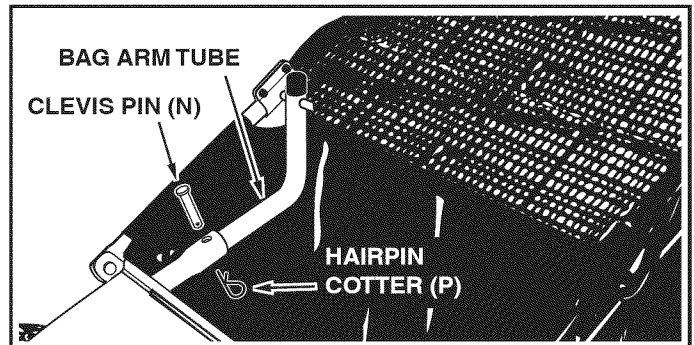

FIGURE 18

ATTACHING SWEEPER HITCH TO TRACTOR

- Place the tractor and sweeper on a flat level surface.
- Set the sweeper height adjustment handle to about the middle of its adjustment range.
- Attach the sweeper hitch to the tractor hitch, arranging the 3/4" spacers in one of six possible combinations as shown in GROUP A and GROUP B diagrams below.

IMPORTANT: To obtain the best performance from your sweeper, arrange the spacers so that the sweeper bag is approximately level with the ground and approximately 5" to 7" off the ground as shown in figure 19.

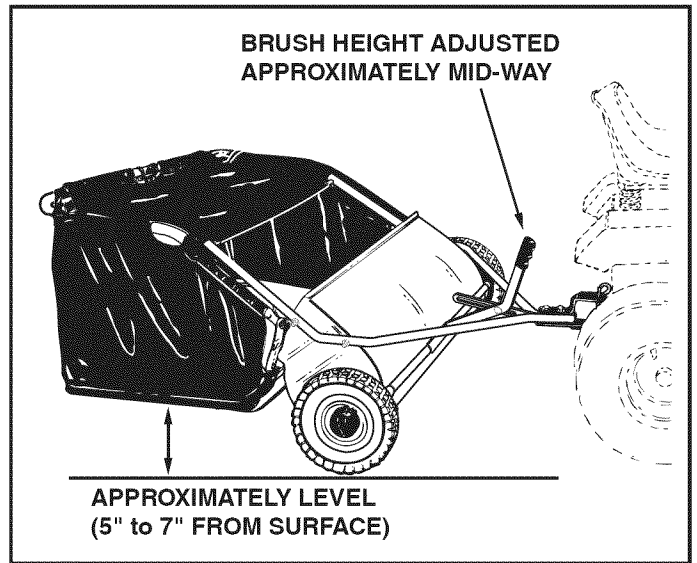
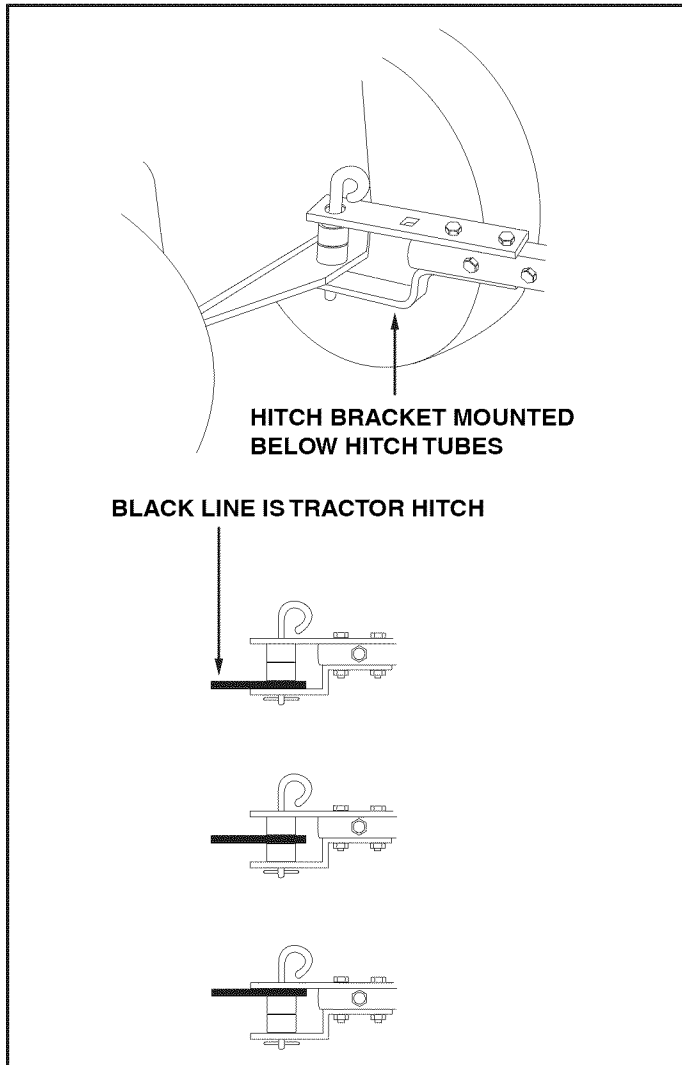
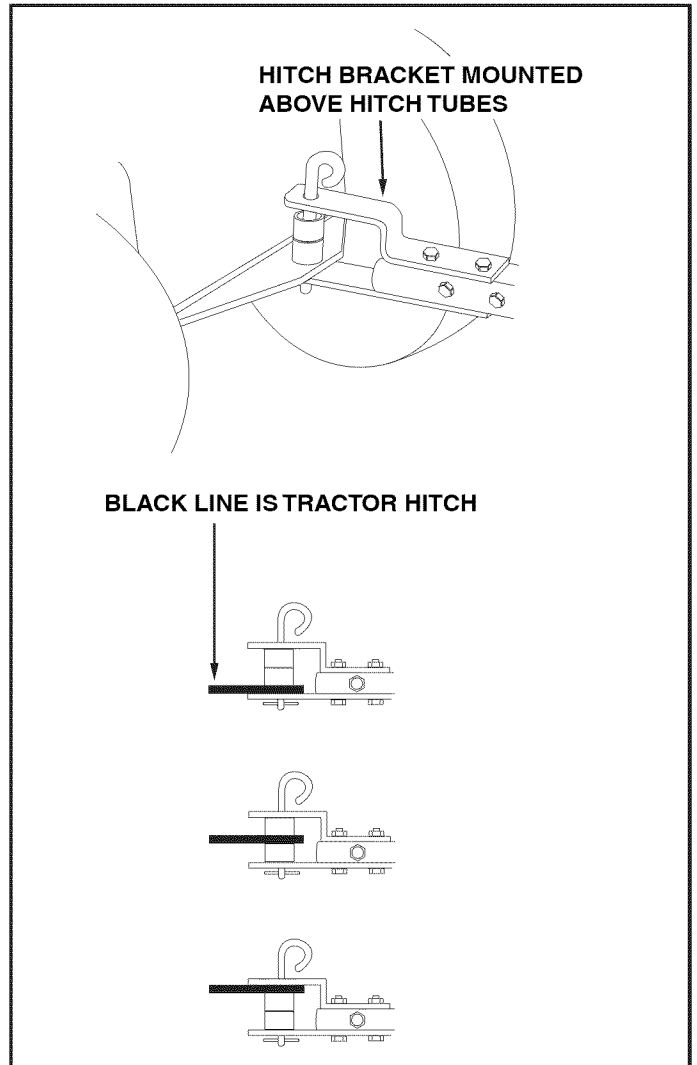

FIGURE 19

GROUP "A" - For vehicles with hitches having 8" to 10" ground clearance.



GROUP "B" - For vehicles with hitches having 10" to 13" ground clearance.



OPERATION

KNOW YOUR SWEEPER

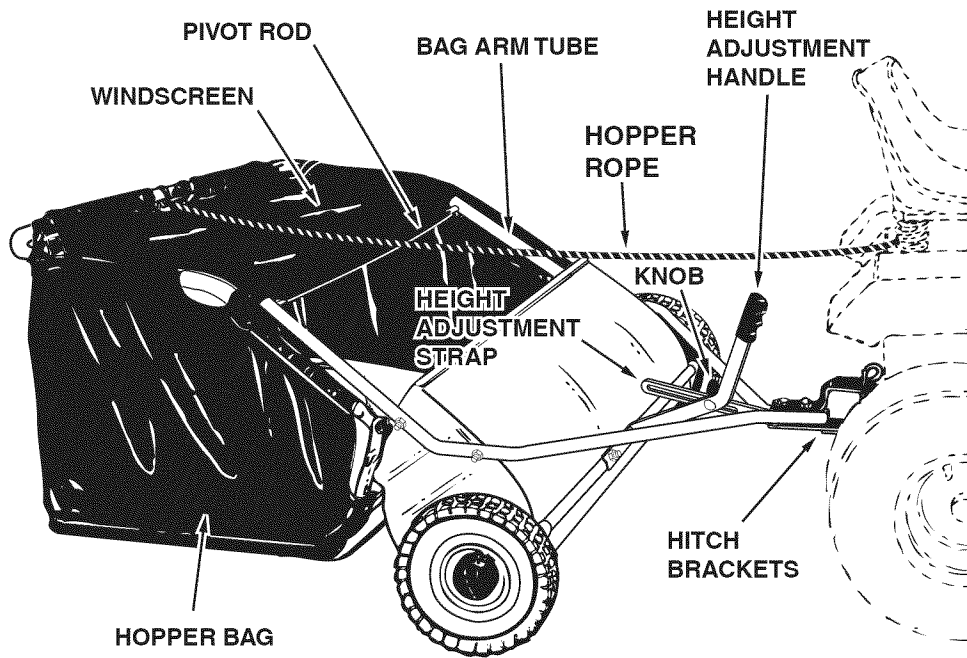

Hopper Bag	Collects grass clippings, leaves and debris.
Hopper Rope	Permits dumping of hopper bag from driver's seat.
Windscreen	Helps prevent collected material from being blown out of hopper bag.
Bag Arm Tubes	Connects the hopper bag to the sweeper housing.
Pivot Rod	Allows hopper bag to tilt forward to dump material.
Height Adjustment Handle	Adjusts the operating height of the sweeper.
Height Adjustment Strap	Holds the height adjustment handle in position when locked.
Hitch Bracket	Connects the sweeper to the towing vehicle. Adjusts for various height tractor hitches.

HOW TO USE YOUR SWEEPER

BRUSH HEIGHT ADJUSTMENT

- To adjust your sweeper brushes to the best operating height, loosen the adjustment knob and push down on the height adjustment handle to raise the brush, or push up on the handle to lower the brush. See figure 19. Best adjustment is when the brush setting is 1/2" down into the grass. Always mow the grass to an even height before sweeping.

SWEEPING SPEED

- Try a starting speed of approximately 3 m.p.h. (third gear on most tractors). Depending on the conditions, it may be necessary to adjust the sweeping speed in order to achieve best results.

DUMPING OF SWEEPER

- Your sweeper can be dumped easily without getting off of the rider or tractor. Simply pull the rope forward to dump the hopper. Always empty hopper after each use.



CAUTION: Never attach the hopper rope to any part of your body or clothing! Never hold onto the rope while towing the sweeper! Attach the rope to the towing vehicle to keep it away from wheels and rotating parts.



CAUTION: Keep sweeper away from fire. Excessive heat can damage the brushes and hopper bag and could cause the bag and its contents to burn.

MAINTENANCE

CUSTOMER RESPONSIBILITIES

- Read and follow the maintenance schedule and the procedures listed in the maintenance section.

MAINTENANCE SCHEDULE Fill in dates as you complete regular service.	Service Dates					
	Before each use	After each use	Twice a year	Every season	Before storage	Every two years
Check for loose fasteners	X					
Check for worn or damaged parts	X		X			
Lubricate brush shaft bearings		X				
Lubricate wheel bearings			X			
Clean Sweeper		X		X		
Clean/Lubricate chain and sprockets					X	

SCHEDULED MAINTENANCE

- Clean the sweeper after each use.
- Inspect for worn or damaged parts, such as brushes and wheels.
- Lubricate the brush shaft bearing twice a year with a few drops of light weight oil. See figure 20.

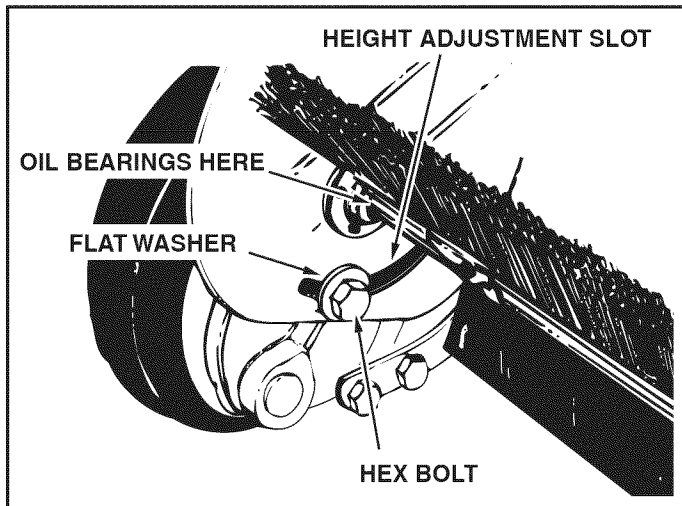

FIGURE 20

- Every two years, remove the wheels and clean the gears found inside the wheel housing. After cleaning, lubricate with an even coat of light grease. To remove the wheel, pop off the hub cap using a screwdriver and remove the lock nut and flat washer. See figure 21.

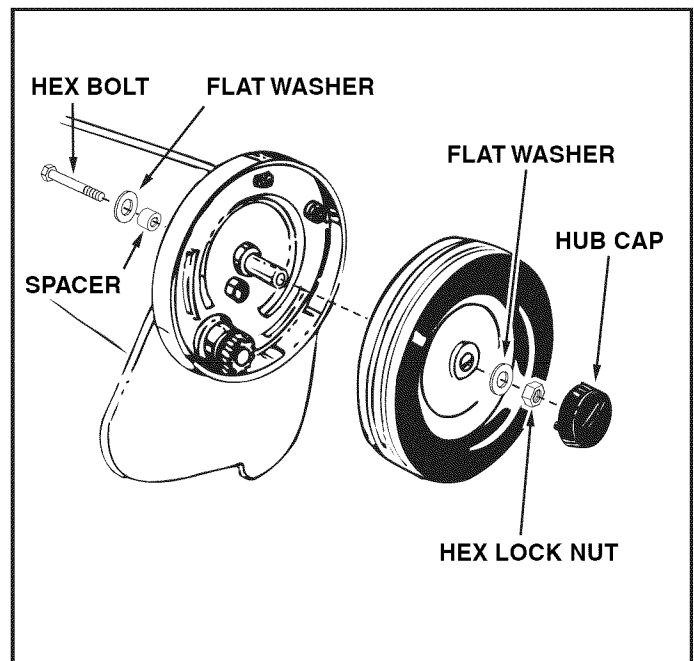

FIGURE 21

CLEANING

- Clean sweeper housing with a soft brush or cloth.
- Clean debris from hopper bag with a brush or broom.
- Remove any material which has wrapped around brushes or ends of brush shaft.

STORAGE



CAUTION: Before storing the sweeper, always empty the hopper bag to avoid spontaneous combustion.

- Clean the sweeper and hopper bag thoroughly to help prevent rust and mildew.
- To collapse the hopper bag for storage, remove the two hopper support rods from the rear of the hopper.
- Store in a dry area.

SERVICE AND ADJUSTMENTS

BRUSH REPLACEMENT

NOTE: Brush replacement should be done one brush at a time.

- Remove the hopper bag from the sweeper.
- Loosen the hex bolts and lock nuts on two single brush retainers which clamp one brush to the double brush retainers. **Do Not loosen** or remove the bolts which fasten the double brush retainers to the brush shaft. See figure 22.
- Slide the brush out of the retainers, noting on which side of the brush the bristles overlap. See figure 22.
- Install new brush, making sure the bristles overlap on the same side of the brush as before. See figure 22.

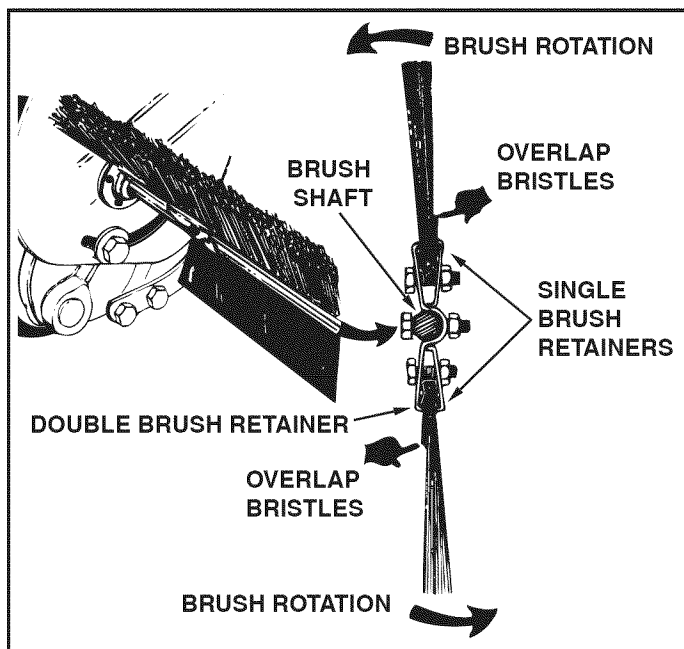

FIGURE 22

WHEEL GEAR AND PAWL SERVICE

IMPORTANT: Do not remove both wheels at the same time to avoid mixing of parts. (The R.H. and L.H. ratchet sprockets are not interchangeable.) **Make notes** on the position of washers and snap rings during disassembly.

- Remove one wheel from the sweeper.
- Remove the retaining rings and washers which hold the ratchet gear onto the brush shaft.
- Remove the gear by sliding it off the brush shaft. (Look for the drive pin, which may fall out of the brush shaft when the ratchet gear is removed.) See figure 23.
- To reassemble, insert the drive pin through the hole near the end of the brush shaft. Make sure the pin slides back and forth easily in the shaft.
- Lightly grease the shaft and fill the ratchet gear with grease. Assemble the ratchet gear back onto the shaft.
- Lightly grease the axle and the wheel's gear teeth and then reassemble the wheel. The brushes should rotate **only** during forward rotation of the wheel. If the brushes are driven (rotated) by both forward and reverse rotation of the wheel, the drive pin is jamming in the ratchet gear. Disassemble to clean and lubricate the drive pin and the ratchet gear.

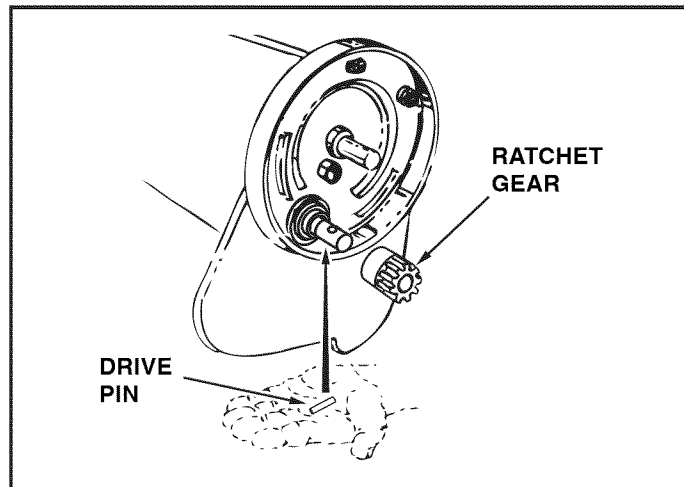

FIGURE 23

TROUBLESHOOTING

<p>Wheels skid when sweeping.</p>	<ul style="list-style-type: none"> • Brushes set too low. • Brushes are jammed • Wheels are jammed. 	<ul style="list-style-type: none"> • Adjust height till brushes are 1/2" down into grass. • Stop sweeper. Remove obstruction. • Remove one wheel at a time to check for obstruction or damage. Refer to Service and Adjustments section.
-----------------------------------	--	---

PARTS

REPAIR PARTS LIST FOR MODELS 486.24237 42" HEAVY DUTY LAWSWEEPER

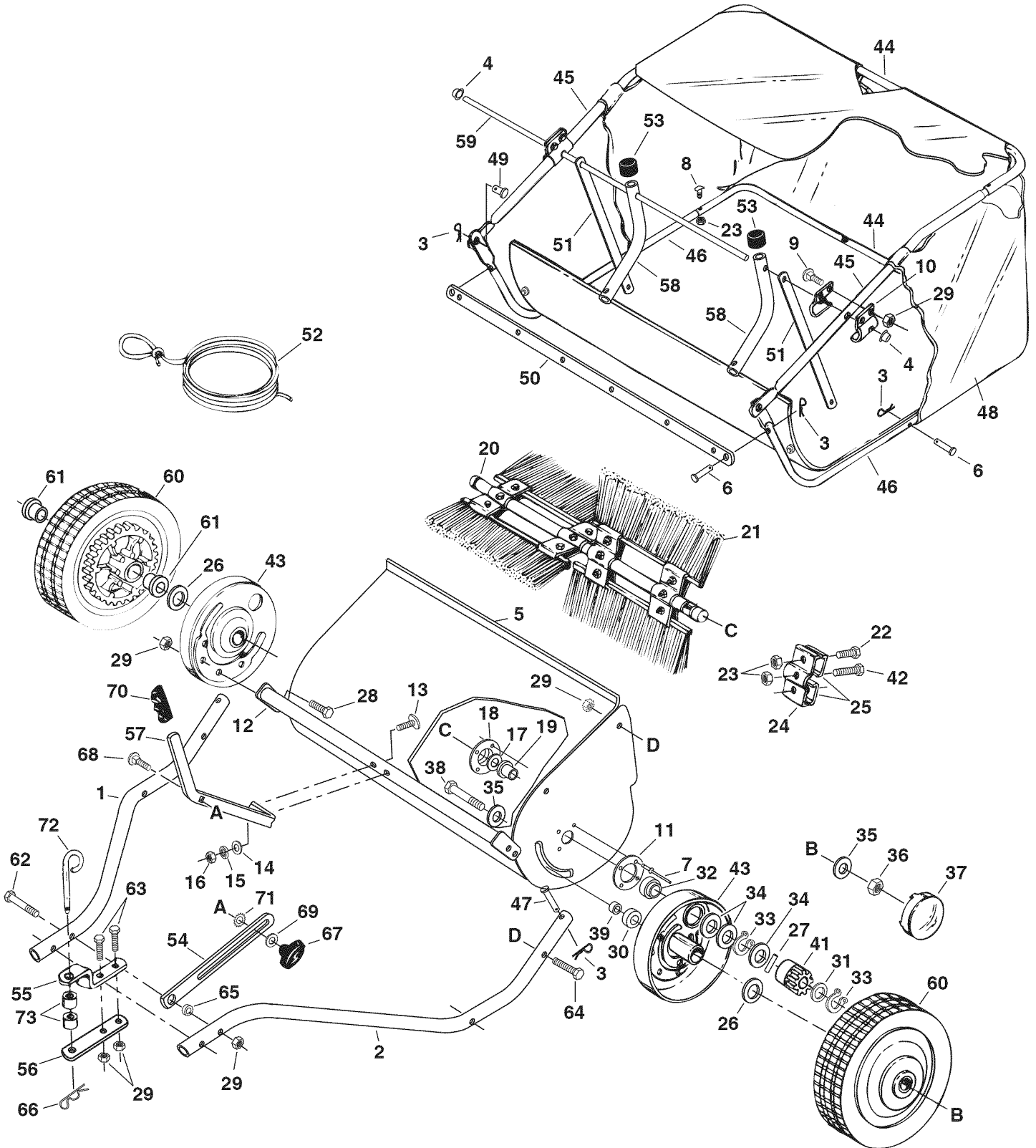

**REPAIR PARTS LIST FOR MODELS 486.24237
42" HEAVY DUTY LAWSWEEPER**

REF	PART NO.	QTY	DESCRIPTION	REF	PART NO.	QTY	DESCRIPTION
1	46776	1	Hitch Tube, R.H.	38	44961	2	Bolt, Hex 3/8-24 x 3-1/4" Lg.
2	46777	1	Hitch Tube, L.H.	39	23400	2	Bushing, Spacer
3	43055	8	Hairpin Cotter, 3/32" #3	40	2692-6	1	Gear, Pinion R.H. (not shown)
4	44917	2	Palnut, 3/8"	41	2692-7	1	Gear, Pinion L.H.
5	66221	1	Housing Assembly	42	43661	4	Bolt, Hex 1/4-20 x 1" Lg.
6	48365	4	Clevis Pin, 1/4" x 1-1/8"	43	63027	2	Ass'y, Dust Cover
7	C-9M5732	8	Rivet, Pop	44	47477	2	Hopper Frame (Middle)
8	43978	4	Bolt, Cvd. Hd. 1/4-20 x 1"	45	49765	2	Upper Hopper Frame (Front)
9	43080	4	Bolt, Carriage 5/16-18 x 3/4"	46	48726	2	Lower Hopper Frame (Front)
10	23331	4	Hopper Mount Clamp	47	46867	2	Pin, Clevis 1/4" x 1-3/4" Lg.
11	23336	2	Washer, Special	48	49768	1	Hopper Bag
12	63463	1	Height Adjustment Tube Ass'y.	49	48366	2	Clevis Pin, 3/8" x 1/2"
13	44947	2	Bolt, Cvd. Hd. 5/16-18 x 1-5/8" Lg.	50	24189	1	Strap, Bag Frame
14	44695	2	Washer, Bowed 1" x .32" x .06"	51	25813	2	Bag Support Strap
15	43086	2	Lock Washer, 5/16"	52	43737	1	Hopper Rope
16	43083	2	Nut, Hex 5/16-18 Thread	53	44481	2	Cap, Vinyl
17	R19212113	2	Washer, 5/8" SAE	54	24191	1	Strap, Height Adjustment
18	1629-56	2	Retainer, Dust Cover	55	23687	1	Bracket, Hitch
19	44910	2	Bushing, Brush Shaft	56	24192	1	Bracket, Hitch (Straight)
20	24188	1	Brush Shaft	57	24193	1	Handle, Height Adjustment
21	46780	4	Brush, 42"	58	49766	2	Tube, Bag Arm
22	43012	8	Bolt, Hex 1/4-20 x 3/4" Lg.	59	46823	1	Rod, Hopper Bag Pivot
23	47189	16	Nut, Nylock 1/4-20 Thread	60	44985	2	Wheel & Tire Ass'y. (with bearings)
24	23580	4	Retainer, Brush (Double)	61	45088	4	Wheel Bearing
25	23581	8	Retainer, Brush (Single)	62	46782	2	Bolt, Hex 5/16-18 x 3" Lg.
26	44008	2	Washer, Flat 1-1/8" x .78" x .025"	63	43224	2	Bolt, Hex 5/16-18 x 2-1/4" Lg.
27	47046	2	Dowel Pin (Drive)	64	43084	4	Bolt, Hex 5/16-18 x 1-3/4" Lg.
28	43182	4	Bolt, Hex 5/16-18 x 3/4" Lg.	65	46847	1	Bushing, Spacer
29	47810	16	Nut, Nylock 5/16-18 Thread	66	43343	1	Hairpin Cotter, 1/8" #4
30	44911	2	Spacer, .39 I.D. x 1-1/4" O.D. x .5"	67	43720	1	Knob, Wing 5/16-18 Thread
31	44006	2	Washer, Flat .849" x .598" x .025"	68	44326	1	Bolt, Carriage 5/16-18 x 1" Lg.
32	46219	2	Spacer, .78 I.D. x 1-1/4" O.D. x .5"	69	43081	1	Washer, Flat 5/16" Std. Wrt.
33	1650-21	4	Ring, Retaining .594"	70	43943	1	Grip, Height Adjust
34	44007	8	Washer, Shim 1-1/8" x .594" x .025"	71	44732	1	Washer, Star
35	141	4	Washer, Flat 1-1/2" x .375" x .062"	72	23353	1	Pin, Hitch
36	1038	2	Nut, Hex Lock 3/8-24 Thread	73	23368	2	Tube, Hitch Spacer
37	2674-32	2	Hub Cap		42112	1	Owners Manual

Get it fixed, at your home or ours!

Your Home

For expert troubleshooting and home solutions advice:

manage  home

www.managemyhome.com

For repair – **in your home** – of **all** major brand appliances, lawn and garden equipment, or heating and cooling systems, **no matter who made it, no matter who sold it!**

For the replacement parts, accessories and owner's manuals that you need to do-it-yourself.

For Sears professional installation of home appliances and items like garage door openers and water heaters.

1-800-4-MY-HOME[®] (1-800-469-4663)

Call anytime, day or night (U.S.A. and Canada)

www.sears.com www.sears.ca

Our Home

For repair of carry-in items like vacuums, lawn equipment, and electronics, call anytime for the location of your nearest

Sears Parts & Repair Service Center

1-800-488-1222 (U.S.A.) **1-800-469-4663** (Canada)

www.sears.com

www.sears.ca

To purchase a protection agreement on a product serviced by Sears:

1-800-827-6655 (U.S.A.)

1-800-361-6665 (Canada)

Para pedir servicio de reparación a domicilio, y para ordenar piezas:

1-888-SU-HOGAR[®]

(1-888-784-6427)

Au Canada pour service en français:

1-800-LE-FOYER^{MC}

(1-800-533-6937)

www.sears.ca

Sears

® Registered Trademark / TM Trademark / SM Service Mark of Sears Brands, LLC

® Marca Registrada / TM Marca de Fábrica / SM Marca de Servicio de Sears Brands, LLC

^{MC} Marque de commerce / ^{MD} Marque déposée de Sears Brands, LLC

© Sears Brands, LLC