

Operator's Manual

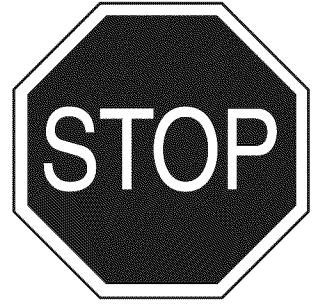

DISC CULTIVATOR

Model No. 486.24206

DO NOT RETURN TO STORE
For Missing Parts or Assembly
Questions Call 1-866-576-8388

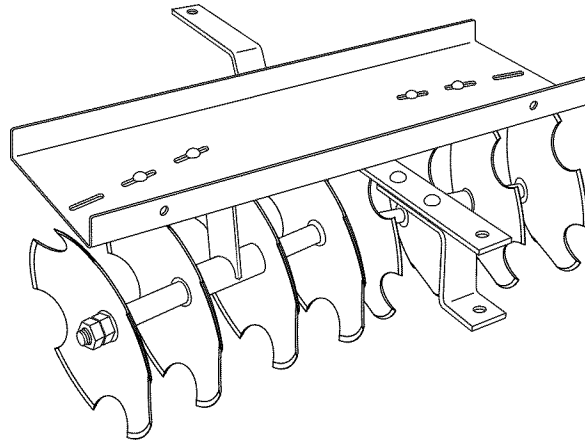

CAUTION:

Before using this product, read this manual and follow all Safety Rules and Operating Instructions.

- Safety
- Assembly
- Operation
- Maintenance
- Parts

Sears, Roebuck and Co., Hoffman Estates, IL 60179 U.S.A.
www.sears.com/craftsman

TABLE OF CONTENTS

SAFETY RULES..... 2	OPERATION..... 6
WARRANTY 2	MAINTENANCE 6
FULL SIZE HARDWARE CHART 3	REPAIR PARTS ILLUSTRATION..... 7
CARTON CONTENTS..... 3	PARTS ORDERING/SERVICE BACK PAGE
ASSEMBLY 4	

SAFETY RULES

Any power equipment can cause injury if operated improperly or if the user does not understand how to operate the equipment. Exercise caution at all times, when using power equipment.

- Read this owners manual and your vehicle and sleeve hitch owners manuals before using this equipment.
- Do not allow children to operate vehicle or disc cultivator.
- Do not allow adults to operate vehicle or disc cultivator without proper instructions.
- Do not allow anyone to ride on the disc cultivator.
- Before lowering and operating the disc cultivator, be sure no one is near the area of operation.
- Lower disc cultivator when leaving vehicle unattended.
- Wear substantial footwear when using disc cultivator. The disc edges are sharp!
- Vehicle braking and stability may be affected with the attachment of this equipment. Drive slowly when disc cultivator is in transport position. **Stay off of steep slopes.**
- Stop and inspect for damage after striking an object. Repair any damage before continuing operation.
- Keep all nuts and bolts tight and be sure that the equipment is in safe operating condition.
- Lock tractor lift handle in down position when attaching or removing disc cultivator from sleeve hitch.



Look for this symbol to point out important safety precautions. It means — **Attention!!**
Become alert!! Your safety is involved.

WARRANTY

CRAFTSMAN FULL WARRANTY

When operated and maintained according to all supplied instructions, if this Craftsman product fails due to a defect in material or workmanship within one year from the date of purchase, return it to any Sears store or other Craftsman outlet in the United States for free replacement.

This warranty applies for only 90 days from the date of purchase if this product is ever used for commercial or rental purposes.

This warranty does not include items considered to expendable parts that can wear out from normal use within the warranty period.

This warranty gives you specific legal rights, and you may also have other rights which vary from state to state.

Sears, Roebuck and Co., D817WA, Hoffman Estates, IL 60179

DO NOT RETURN TO STORE for Missing Parts or Assembly Questions
 Call 1-866-576-8388 Attachment Hotline

<p>The model number and serial numbers will be found on a decal attached to the Disc Cultivator.</p> <p>You should record both the serial number and the date of purchase and keep in a safe place for future reference.</p>	<table style="width: 100%; border-collapse: collapse;"> <tr> <td style="width: 60%;">MODEL NUMBER:</td> <td style="width: 40%;">486.24206</td> </tr> <tr> <td>SERIAL NUMBER:</td> <td>_____</td> </tr> <tr> <td>DATE OF PURCHASE:</td> <td>_____</td> </tr> </table>	MODEL NUMBER:	486.24206	SERIAL NUMBER:	_____	DATE OF PURCHASE:	_____
MODEL NUMBER:	486.24206						
SERIAL NUMBER:	_____						
DATE OF PURCHASE:	_____						

FULL SIZE HARDWARE CHART

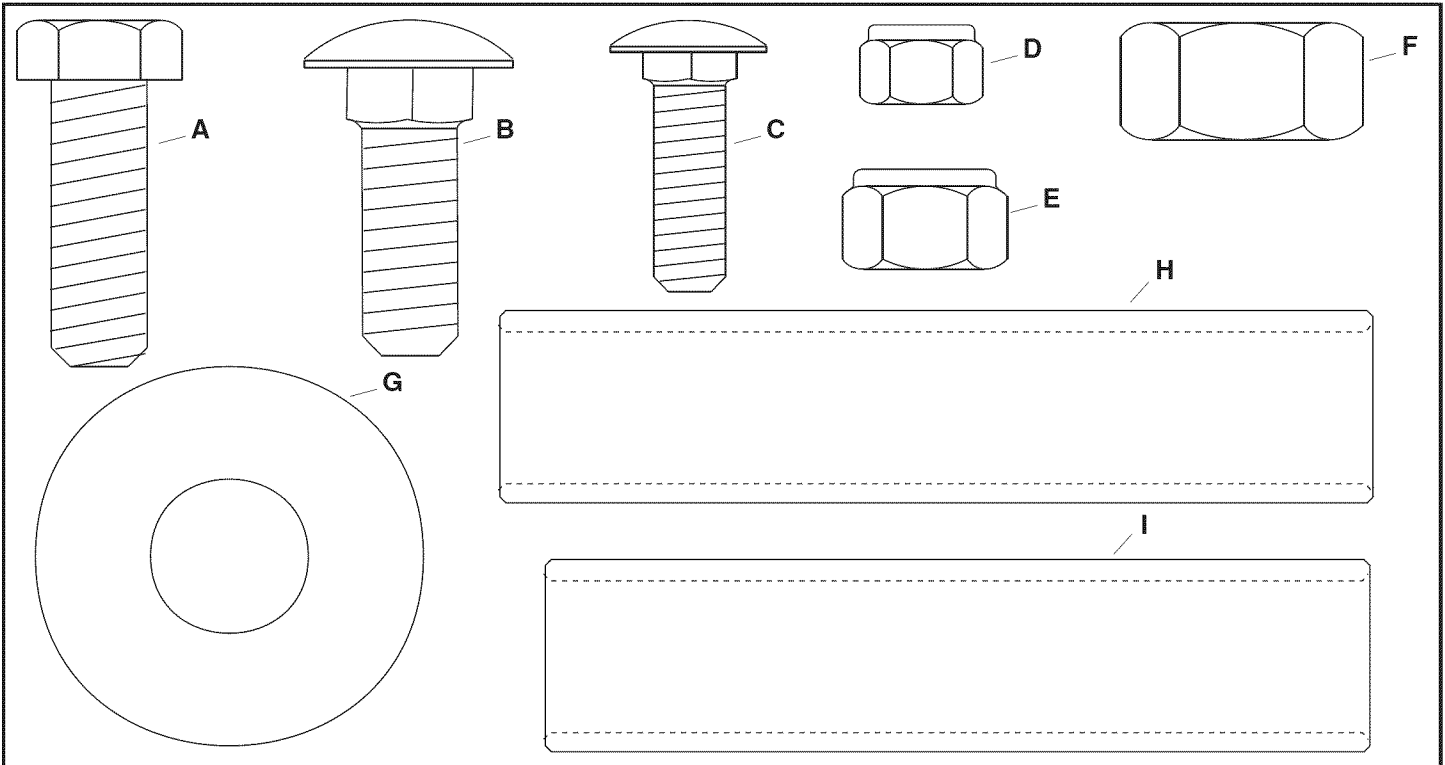

REF.	QTY.	DESCRIPTION	REF.	QTY.	DESCRIPTION
A	1	Hex Bolt, 1/2" x 1-1/2" Lg.	F	4	Hex Nut, 3/4"
B	4	Carriage Bolt, 1/2" x 1-1/2"	G	16	Flat Washer, 3/4"
C	4	Carriage Bolt, 3/8" x 1-1/4" Lg.	H	2	Bearing Sleeve
D	4	Nylock Nut, 3/8"	I	4	Spacer
E	5	Nylock Nut, 1/2"			

CARTON CONTENTS

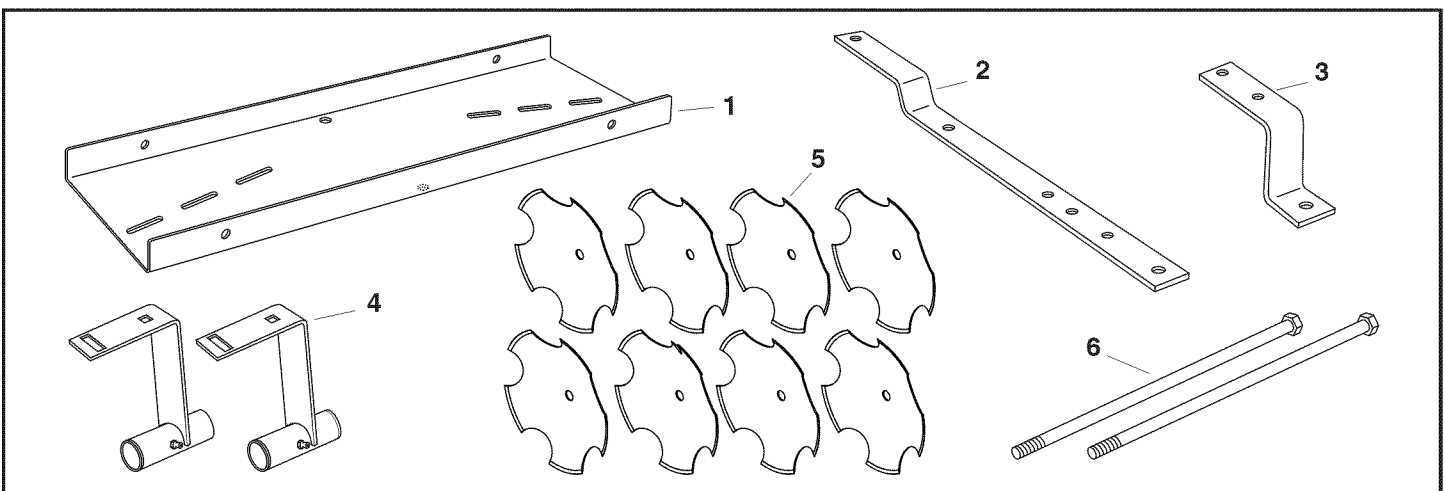

- | | |
|--|---|
| <ul style="list-style-type: none"> 1. Tray 2. Draw Bar 3. Hitch Bracket | <ul style="list-style-type: none"> 4. Bearing Hanger Bracket (2) 5. Disc Blade (8) 6. Hex Bolt, 3/4" x 16" (2) |
|--|---|

ASSEMBLY

TOOLS REQUIRED FOR ASSEMBLY

- (2) 9/16" Wrenches
- (2) 3/4" Wrenches
- (2) 1-1/8" Wrenches or 10" Adjustable Wrenches
- (1) Grease Gun



CAUTION: Disc blades have sharp edges. Use care in handling and assembly. Wear gloves for extra protection against cuts.

Remove loose parts and hardware package from the carton. Lay out and identify as shown on pages 2 and 3.

STEP 1: (SEE FIGURE 1)

- Assemble four discs to each bearing hanger bracket using a bearing sleeve (unplated), a 3/4" x 16" hex bolt, eight 3/4" flat washers, two spacers and two 3/4" hex nuts. Be sure the discs face the same direction relative to the hanger bracket as shown in the figure 1. **Tighten** the first hex nut and then **tighten** the second hex nut against the first.
- Lubricate the bearings through the grease fittings in the bearing hanger bracket assemblies until grease is forced out through the bearings.

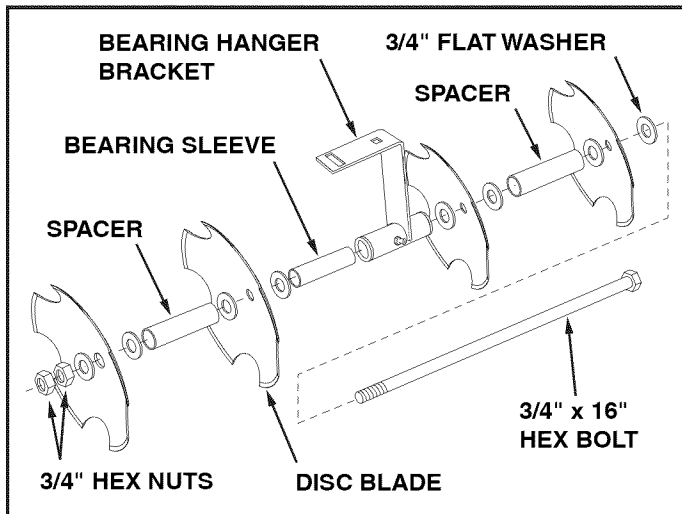

FIGURE 1

STEP 2: (SEE FIGURE 2)

- Assemble the hitch bracket to the draw bar using two 1/2" x 1-1/2" carriage bolts and 1/2" nylock nuts.

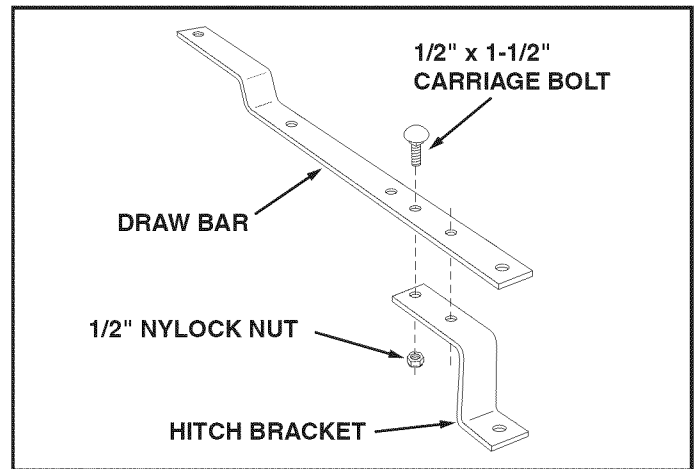

FIGURE 2

STEP 3: (SEE FIGURE 3)

- Position the tray with the slots angled either toward rear center or front center. (Refer to Operation section for more information.) Assemble the drawbar to the bottom of the tray using two 1/2" x 1-1/2" carriage bolts and 1/2" nylock nuts.

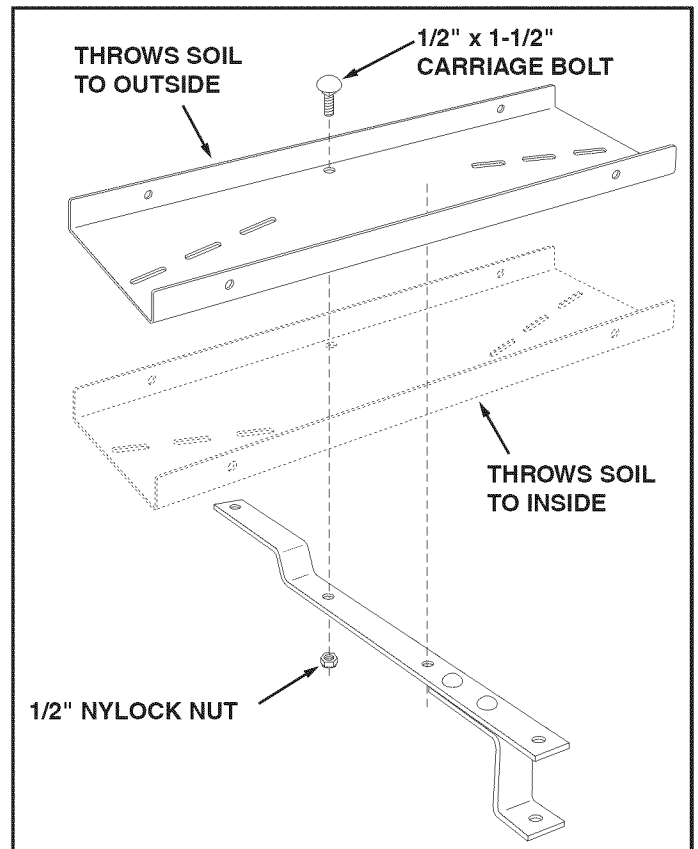

FIGURE 3

ASSEMBLY OF SINGLE CULTIVATOR

The following instructions describe the two types of disc arrangement. The discs can also be mounted farther apart by using the outer slots in the tray.

- Assemble the disc assemblies to the tray using four $3/8" \times 1-1/4"$ carriage bolts and $3/8"$ nylock nuts. Swivel the disc assemblies so that the carriage bolt is centered in the angle adjustment slot. **Tighten.** This places the discs at the standard 15 degree angle. See figures 4 and 5.

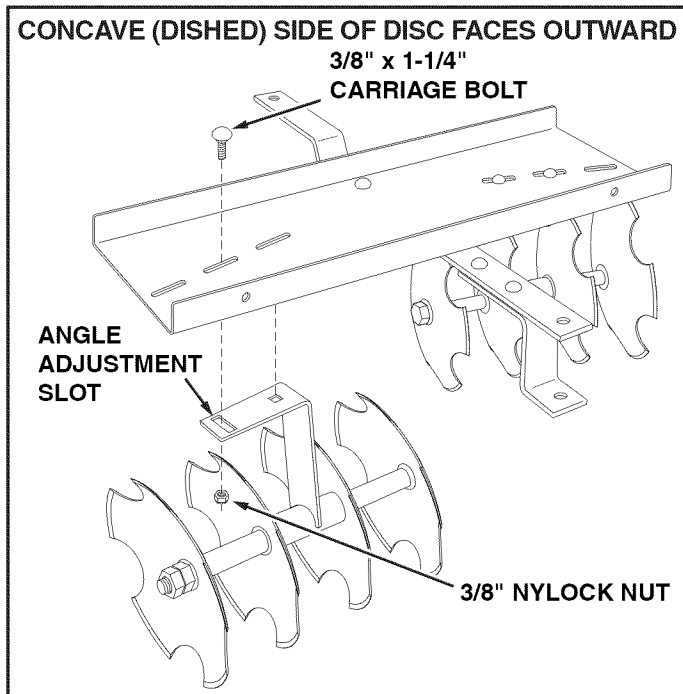

FIGURE 4

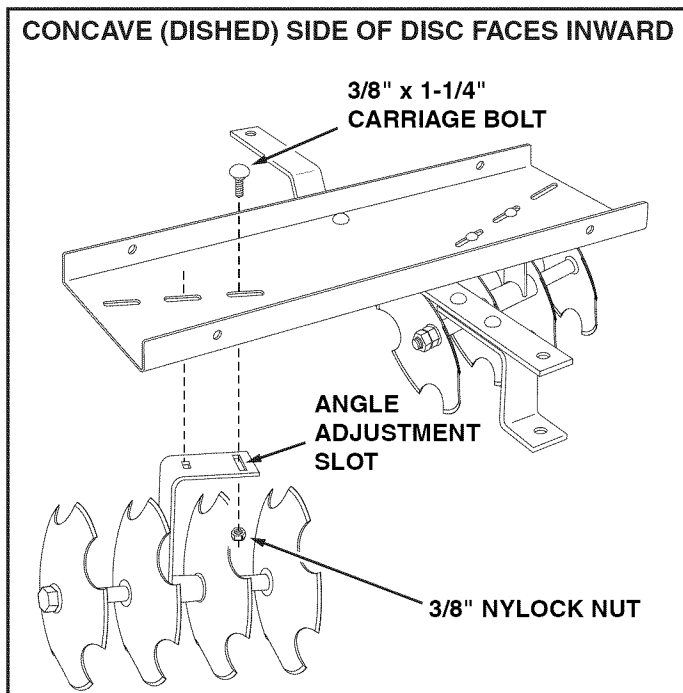

FIGURE 5

ASSEMBLY OF TANDEM CULTIVATORS

(Requires purchase of a second cultivator.)

The front cultivator should be assembled as shown in figure 4. The rear cultivator should be assembled using the following instructions. Note that the position of the tray and drawbar are the reverse of the front cultivator.

- Assemble the disc assemblies to the **outer** slots in the tray using four $3/8" \times 1-1/4"$ carriage bolts and $3/8"$ nylock nuts. Swivel the disc assemblies so that the carriage bolt is centered in the angle adjustment slot. This places the discs at the standard 15 degree angle. **Tighten.**

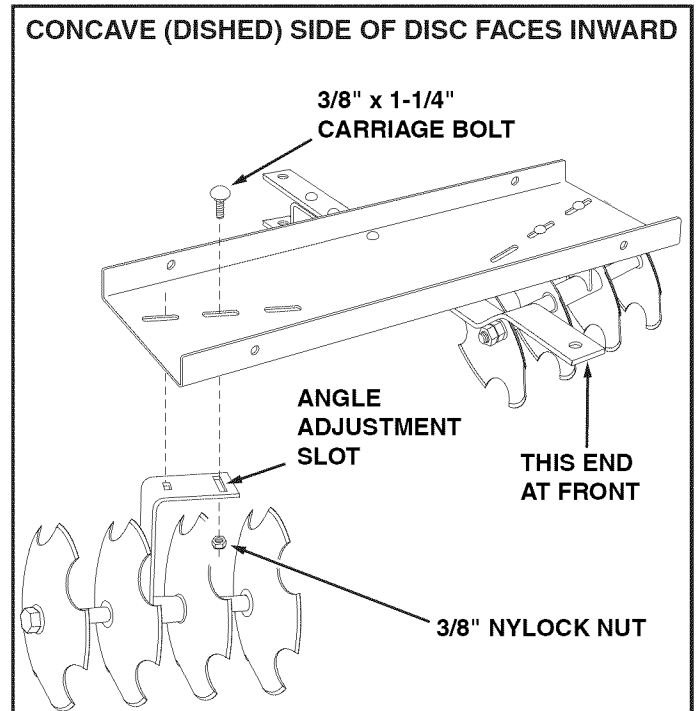

FIGURE 6

OPERATION

ATTACHING CULTIVATOR TO TRACTOR



CAUTION: Lock tractor lift handle in down position when attaching or removing the disc cultivator from sleeve hitch.

Refer to your sleeve hitch owners manual.

- Remove the stabilizer bolts from the tractor's sleeve hitch as shown in figure 7 to allow side to side motion of the disk cultivator.
- Attach the disc cultivator to the sleeve hitch on your tractor using the sleeve hitch pin.
- Adjust the sleeve hitch so that the disc cultivator is free to lower below ground level but can still be raised an adequate distance above ground for transport.

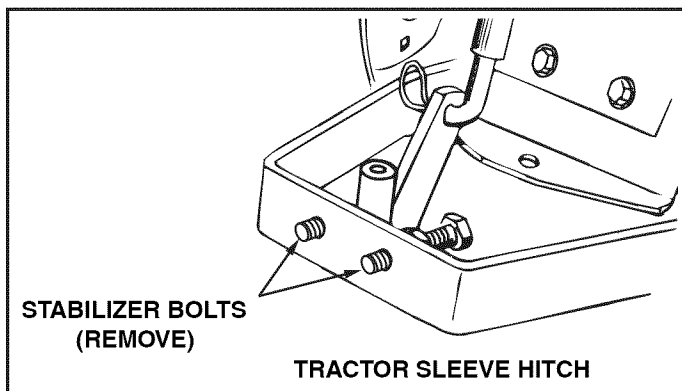

FIGURE 7

ATTACHING TANDEM CULTIVATORS

- Attach the front cultivator as instructed above.
- Attach the rear cultivator to the front cultivator by fastening the rear drawbars together using a 1/2" x 1-1/2" hex bolt and a 1/2" nylock nut. Do not completely tighten the nut, allowing a slight amount of play between the rear drawbars.



CAUTION: Do not attempt to raise the tractor sleeve hitch when connected to disc cultivators in tandem arrangement.

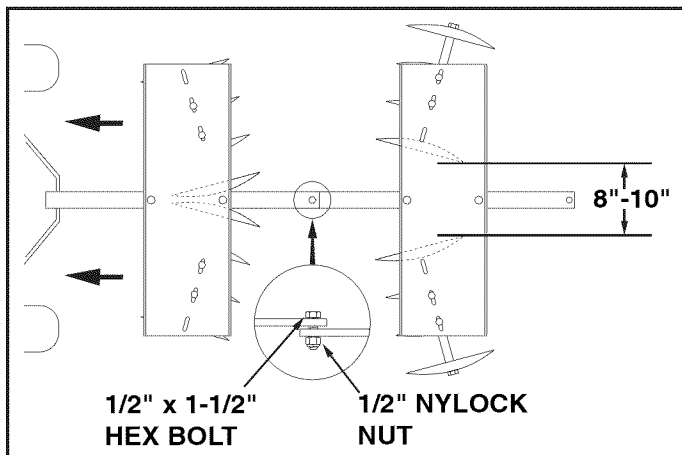

FIGURE 8

The disc cultivator is used to break up clods of dirt in plowed soil. It can also be used to cultivate between rows of young plants.

- Before starting make sure the soil is dry enough by squeezing some in your hand. If it forms a ball that doesn't crumble then the soil is too wet for cultivating. Wet soil will pack between the disc blades.
- Adjust the discs to the desired angle setting. The angle can be varied from 10 to 20 degrees. Start with a setting of 15 degrees (the carriage bolt centered in the angle adjustment slot in the bearing hanger bracket). The greater the angle, the greater the cultivating action.
- To break up dirt clods in plowed soil, start cultivating slowly at first. As the clods are broken up the speed may be gradually increased. Disc the soil using a crisscross pattern for best results.
- To cultivate young crops by straddling the rows, move the discs to the maximum width setting. To throw the dirt to the outside, the concave side of the discs should face outward with the disc assemblies angled toward the rear center. To throw dirt to the inside, to smother young weeds in the crop row, the concave side of the discs should face inward with the disc assemblies angled toward the front center.
- To use two cultivators in tandem, the disc assemblies should be positioned as shown in figure 8, with the inside discs almost touching on the front cultivator and 8" to 10" apart on the rear cultivator. With this arrangement the front cultivator will throw the dirt to the outside and the rear cultivator will throw the dirt back to the inside.
- Up to 100 lbs. of weight may be added to help increase penetration. Concrete blocks or other weight may be tied or strapped to the cultivator tray. Before adding weight, the cultivator should be attached to the tractor with the sleeve hitch in the down position.

MAINTENANCE

- Check for loose bolts after each use.
- Clean the disks and lightly oil any exposed metal after each use.
- Remove all dirt and rust and touch up with paint before storing.
- Store inside a dry area.

REPAIR PARTS ILLUSTRATION

MODEL #486.24206 DISC CULTIVATOR

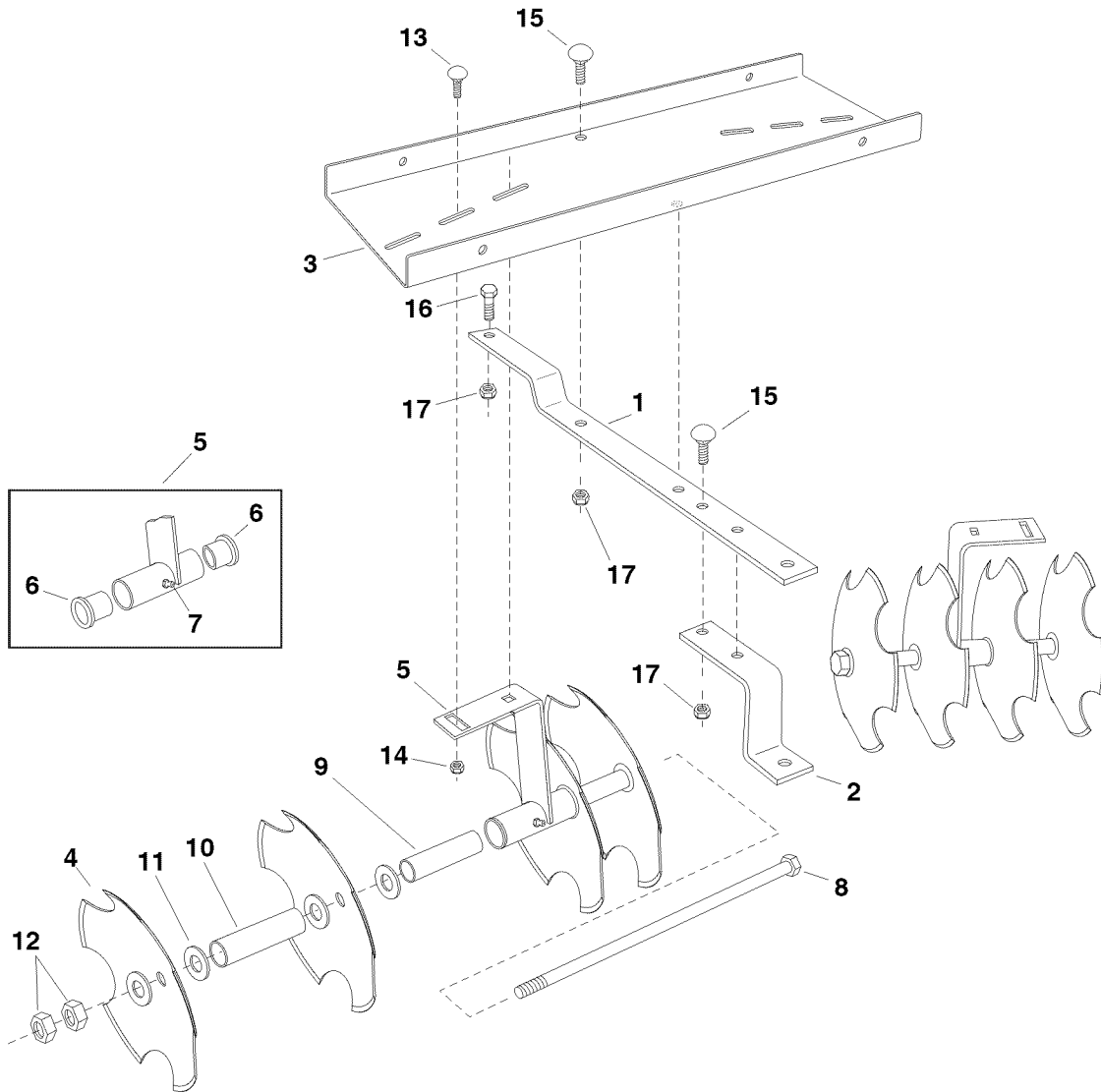

REF. NO.	PART NO.	QTY.	DESCRIPTION	REF. NO.	PART NO.	QTY.	DESCRIPTION
1	24850	1	Draw Bar	10	46859	4	Spacer, 3/4" I.D. x 4-1/4" Lg.
2	24851	1	Hitch Bracket	11	1540-162	16	Flat Washer, 3/4" Std. Wrt.
3	24852	1	Tray	12	46860	4	Hex Nut, 3/4-10 Thread
4	40106	8	Notched Blade Disc	13	710-0305	4	Carriage Bolt, 3/8-16 x 1-1/4" Lg.
5	63510	2	Bearing Hanger Brkt. Assembly	14	HA21362	4	Nylock Nut, 3/8-16 Thread
6	44488	4	Bearing (Included in #63510)	15	47660	4	Carriage Bolt, 1/2-13 x 1-1/2" Lg.
7	46858	2	Grease Fitting (Included in #63510)	16	43020	1	Hex Bolt, 1/2-13 x 1-1/2" Lg.
8	46857	2	Hex Bolt, 3/4-10 x 16" Lg.	17	712-3083	5	Nylock Nut, 1/2-13 Thread
9	24240	2	Bearing Sleeve		42128	1	Owners Manual

Get it fixed, at your home or ours!

Your Home

For expert troubleshooting and home solutions advice:

manage my home

www.managemyhome.com

For repair – **in your home** – of **all** major brand appliances, lawn and garden equipment, or heating and cooling systems, **no matter who made it, no matter who sold it!**

For the replacement parts, accessories and owner's manuals that you need to do-it-yourself.

For Sears professional installation of home appliances and items like garage door openers and water heaters.

1-800-4-MY-HOME[®] (1-800-469-4663)

Call anytime, day or night (U.S.A. and Canada)

www.sears.com www.sears.ca

Our Home

For repair of carry-in items like vacuums, lawn equipment, and electronics, call anytime for the location of your nearest

Sears Parts & Repair Service Center

1-800-488-1222 (U.S.A.)

www.sears.com

1-800-469-4663 (Canada)

www.sears.ca

To purchase a protection agreement on a product serviced by Sears:

1-800-827-6655 (U.S.A.)

1-800-361-6665 (Canada)

Para pedir servicio de reparación a domicilio, y para ordenar piezas:

1-888-SU-HOGAR[®]

(1-888-784-6427)

Au Canada pour service en français:

1-800-LE-FOYER^{MC}

(1-800-533-6937)

www.sears.ca

Sears

© Registered Trademark / TM Trademark / SM Service Mark of Sears Brands, LLC

© Marca Registrada / TM Marca de Fábrica / SM Marca de Servicio de Sears Brands, LLC

^{MC} Marque de commerce / ^{MD} Marque déposée de Sears Brands, LLC

© Sears Brands, LLC