

Owner's Manual
Manual del Usuario

CRAFTSMAN®

HEIGHT ADJUSTABLE CLAMPING TABLE BANCO DE TRABAJO DE FIJACIÓN RÁPIDA

Model No. 695.65796
Modelo N° 695.65796

CAUTION:

Before using this product, read this manual and follow all its Safety Rules and Operating Instructions.

PRECAUCIÓN:

Antes de usar este producto, lea este manual y siga todas las instrucciones de seguridad y de manejo.

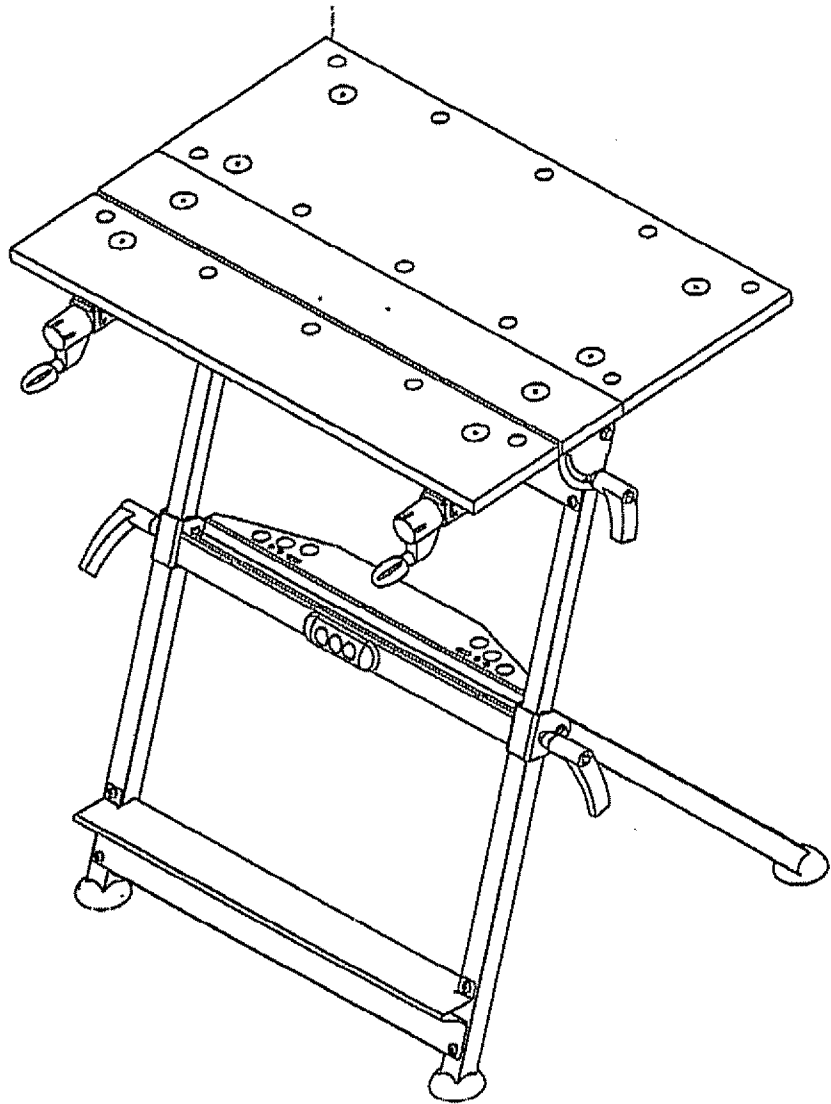

- Safety Instructions
- Assembly
- Operation
- Repair Parts

- Instrucciones de seguridad
- Montaje
- Manejo
- Lista de piezas

Sears, Roebuck and Co., Hoffman Estates, IL 60179 U.S.A.

TABLE OF CONTENTS

WARRANTY.....	2	OPERATION.....	5
SAFETY INSTRUCTIONS	3	SPECIFICATIONS	6
INTRODUCTION.....	4	UN-PACKING AND CHECKING	9
ASSEMBLY.....	4	ESPAÑOL	11

WARRANTY

Full One Year Warranty

If this CRAFTSMAN® Clamping Table fails to give complete satisfaction within one year from the date of purchase, return it to (or contact) the nearest Sears Service Center in the United States, and Sears will repair it, free of charge.

This warranty gives you specific legal rights and you may also have other rights which vary from state to state.

Sears, Roebuck and Co.,
D/817WA, Hoffman Estates, IL 60179

SAFETY INSTRUCTIONS

DO NOT attempt to assemble or operate your CRAFTSMAN® Height Adjustable Clamping Table until you have read the safety instructions in this section.

Safety items throughout this manual are labeled with **WARNING** or **CAUTION**.

WARNING Means that failure to follow this safety statement may result in extensive product damage, serious personal injury or death.

CAUTION Means that failure to follow this safety statement may result in minor or moderate personal injury, property or equipment damage.

WARNING **DO NOT** use this tool for scaffolding or as a ladder. Make sure to fully tighten handles when in use. Maximum capacity 330 lbs.

WARNING Read all instructions.

- **DO NOT** load clamping table with more than 330 lbs.
- **DO NOT** apply an unbalanced load which could result in the shop stand tipping over.

WARNING **DO NOT** attempt to use your portable workbench unless the jaw is securely locked in position.

WARNING When operating a stationary power tool such as a Mitre Saw, on your Clamping Table, be sure the tool is securely bolted to a separate piece of plywood and the plywood is securely clamped to the work table. **DO NOT** clamp or mount stationary power tool directly to table top. This could cause serious bodily damage.

WARNING When operating a portable power tool such as a drill, router, sander or planer: Always be sure that the workpiece is securely clamped to your Clamping Table. This will avoid kickback which could cause serious bodily injury.

WARNING To prevent personal injury while opening or closing your workbench, always avoid positioning hands or fingers where they could get pinched.

- **DO NOT** stand or climb on the shop stand. It could fall or tip over causing serious injury.
- Be sure the shop stand's leg set frame assembly is in the fully opened position before using.
- Dress for safety. **DO NOT** wear loose clothing, gloves, neckties or jewelry (rings, watches); they can get caught and draw you into moving parts. **ALWAYS** wear non-slip footwear; tie back hair.

CAUTION **DO NOT** store shop stand outdoors or in a damp location.

- **ALWAYS** keep your work area clean, uncluttered and well lit. **DO NOT** work on or place shop stand legs on floor surfaces that are slippery from sawdust, oil, water or wax.
- Keep visitors or children a safe distance away from the work area, especially when you're operating a power tool. Visitors should wear the same safety equipment as the operator.
- **SAVE THESE INSTRUCTIONS.**

PACKAGE CONTENTS

Your CRAFTSMAN® Clamping Table Is shipped complete in one carton.

Separate all parts from packaging materials and check each item with Figure 1 and "Table of Loose Parts." Make sure all items are accounted for before discarding any of the packing material.

Figure 1

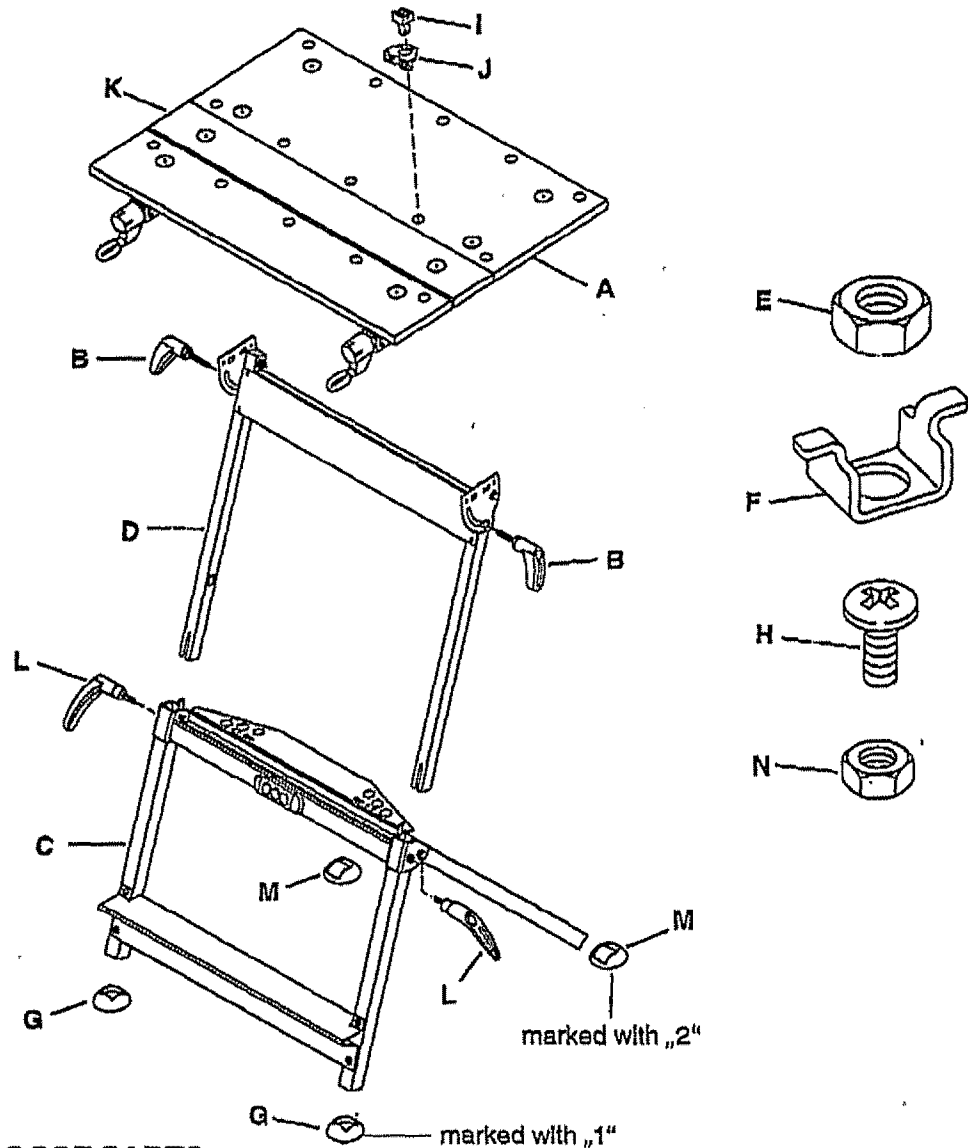

TABLE OF LOOSE PARTS

ITEM	DESCRIPTION	QTY.
A	Table Top Assembly.....	1
B	Locking Handle, Short.....	2
C	Legs.....	1
D	Support Posts Assembly.....	1
E	Nut, Short Locking Handle.....	2
F	Nut Holder.....	2
G	Foot, Front.....	2
H	Bolt, Support Posts To Top.....	4
I	Swivel Pegs.....	4
J	Peg Supports.....	2
K	Solid Surface Center Board.....	1
L	Locking Handle, Long.....	2
M	Foot, Back.....	2
N	Nuts, Support Posts To Top.....	4

TOOLS REQUIRED

#3 Phillips Screwdriver
Adjustable-Head Wrench

INTRODUCTION

The CRAFTSMAN® Clamping Table provides a work surface of up to 40-3/4". It features a large 30" x 20-1/2" tilting top made of durable 3/4-inch thick MDF (Medium Density Fiber). Its steel frame supports up to 330 lbs., and there is a convenient storage rack with slots for

table pegs, parts and for hand tools, such as screwdrivers and chisels. Jaw is adjustable up to 9 degrees for holding irregularly-shaped workpieces. A step bar provides additional support and stability.

ASSEMBLY

The major components of your CRAFTSMAN® Clamping Table have been assembled at the factory. This includes the table top, the support posts, and the legs. You need to complete the shop stand by assembling the following components to each other:

- table top to support posts
- short locking handles to support posts
- feet to legs
- long locking handles to legs
- table top/support posts to legs

For these procedures, you need a #3 Phillips screwdriver and an adjustable-head wrench.

Table Top to Support Posts

1. Place stand top (A) upside-down on a smooth surface. (See Figure 2.)

2. With triangular-shaped tilt brackets on inside of rail and pivoted toward rear of table, attach support posts assembly (D) with 4 bolts (H) and 4 nuts (N), 2 on each side.
3. Tighten with Phillips screwdriver and adjustable-head wrench.

Locking Handles to Support Posts

1. Move support posts assembly (D) to most advanced position (small tabs limit movement). (See Figure 2.)
2. Maintaining assembly in most advanced position with your shoulder, place tabs of nut holder (F) (over nut [E]) and into slots. While holding nut holder in slot with nut, use other hand to thread short locking handle (B) into nut.
3. Repeat for other side.

To tighten: Turn handles clockwise.

To loosen: Turn handles counterclockwise.

Figure 2

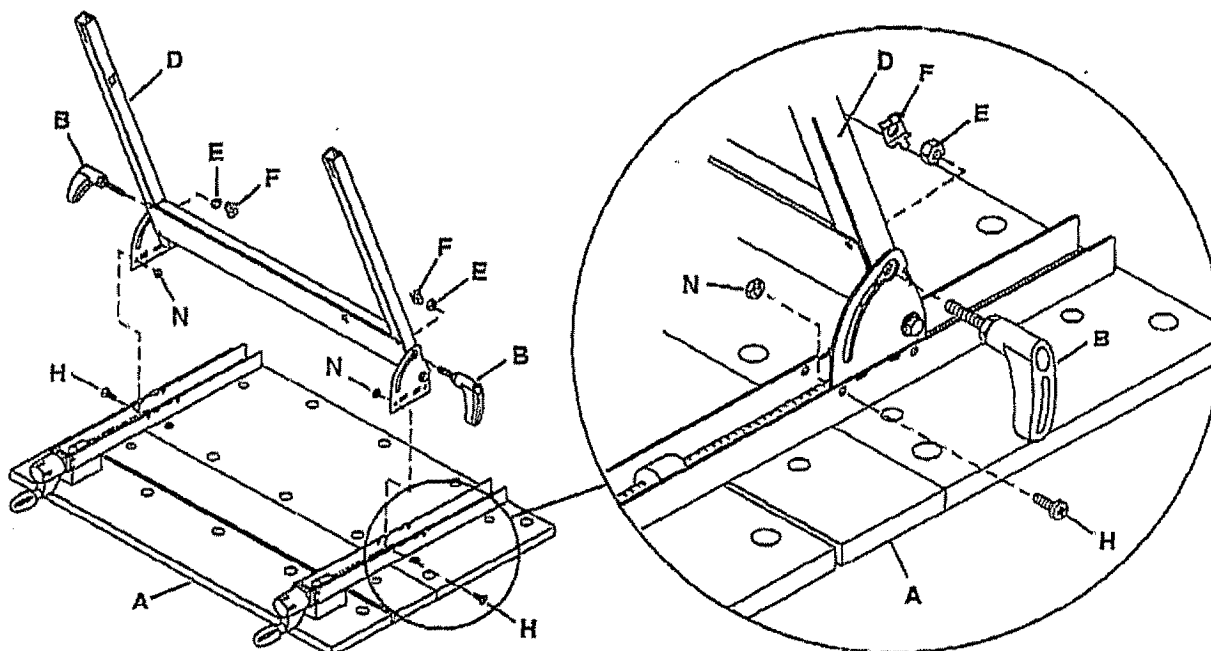
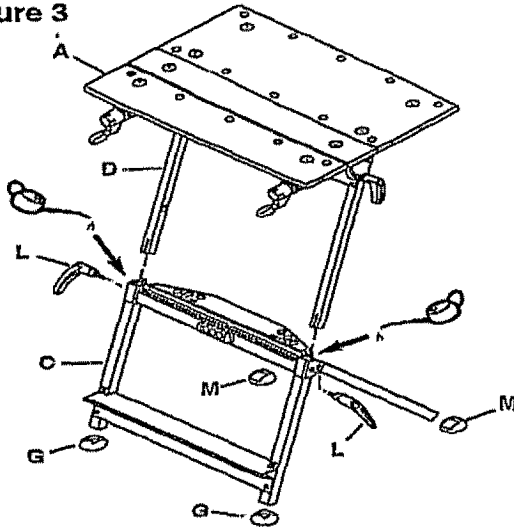

Figure 3



Feet to Legs

Attach 2 feet (G) to the front legs and 2 feet (M) to the back legs. (See Figure 3.)

Locking Handles to Legs – Figure 3

Two handles allow you to quickly and easily adjust the height of your stand.

1. Fully open legs and place on floor.
2. Thread long locking handle (L) into welded nut on each leg.

Table Top/Support Posts to Legs – Figure 3

1. Height adjust locking handles should be threaded only slightly at this time.
2. Lightly lubricate support posts (D) and carefully pick up table top (A) and posts. With foot on step bar for stability, securely insert posts into legs (C). If support posts (D) make a scratching noise then lightly lubricate.
3. Place table top at desired height and tighten height adjust locking handles. Turn handles clockwise to tighten; turn handles counterclockwise to loosen.

OPERATION

WARNING This Clamping Table **DOES NOT** provide adequate support for any table top tools that weigh in excess of 90 lbs. or that exceeds an overall combined height with table over 60 inches. Using any tools in excess of these weight and height measurements could result in serious injury.

WARNING When operating a stationary power tool such as a mitre saw, on your clamping table, be sure the tool is securely bolted to a separate piece of plywood and that the plywood is securely clamped to the Clamping Table. **DO NOT** clamp or mount stationary power tool directly to table top. This could cause serious bodily damage.

WARNING When operating a portable power tool such as a drill, router, sander or planer: Always be sure that the workpiece is securely clamped to your Clamping Table. This will avoid kickback which could cause serious bodily injury.

Adjusting Height

WARNING To avoid injury, remove tools and parts from top before adjusting Clamping Table height.

1. With one foot on step bar, slowly loosen one height adjustment locking handle. Then slowly loosen the other handle. (See Figure 4.)
2. With table top resting on thigh, carefully lower or heighten table top.

3. With table top still resting on thigh, reach down and secure one height adjustment locking handle. Then secure the other locking handle.

Figure 4

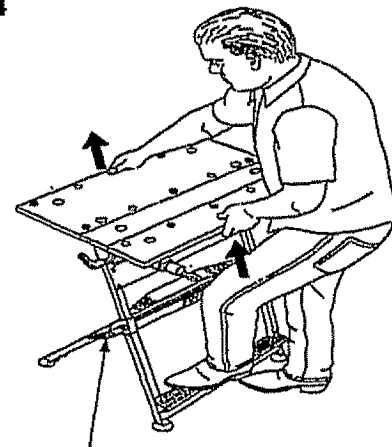

HEIGHT ADJUSTMENT
LOCKING HANDLE

Solid Surface Table

Your CRAFTSMAN® Clamping Table can be used as a Solid Surface Table (Figure 5) and as a Clamping Table. To convert from solid surface to clamping table simply remove the solid surface center board and adjust table top jaws for desired application. Refer to Figures 6, 7, 8, 9, 10 and 11.

Figure 5

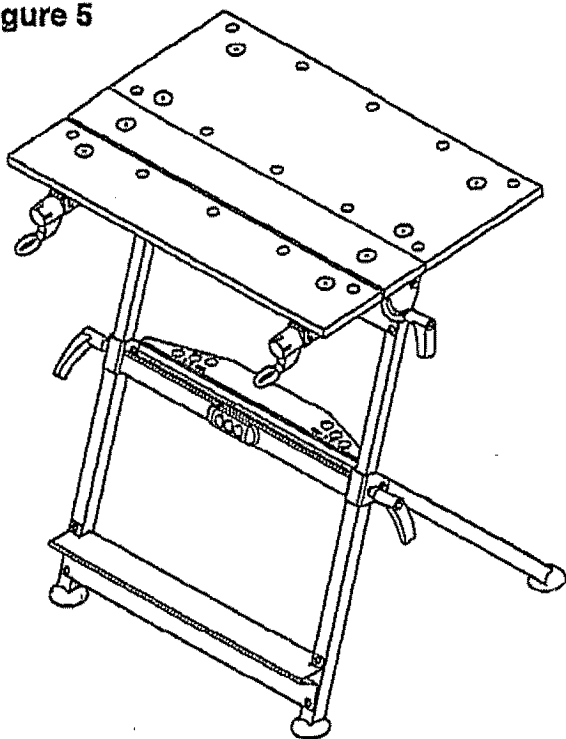

Jaw Use and Adjustment

Your CRAFTSMAN® Clamping Table is designed for maximum versatility. The Table top jaws adjust to clamp many workpiece sizes or shapes to simplify sawing, planing, sanding, drilling, routing, gluing and painting jobs.

Figure 6

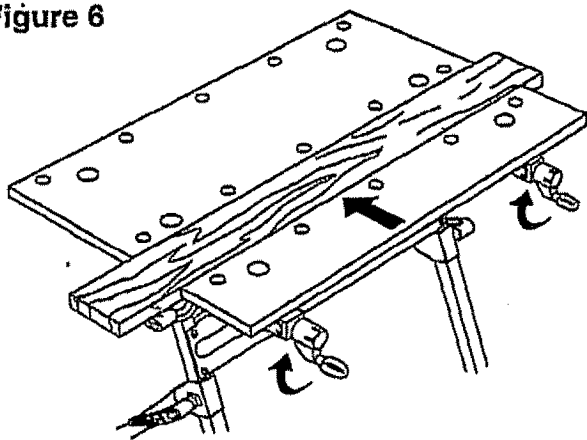

DO NOT attempt to use your Clamping Table unless the jaws are securely locked in position.

To Adjust Table Top Jaw

Turn the 2 front table top jaw adjustment handles counterclockwise to move front jaw out; turn adjustment handles clockwise to move front jaw in. (See Figure 6.) The table top jaw opens to clamp a maximum 4-inch wide workpiece.

Adjusting Jaw to Angle

Front jaw adjusts to a maximum angle of 9 degrees for clamping irregular shaped workpieces. To adjust jaw to angle, turn either the right or left adjustment handle until desired angle is reached. (See Figure 7.)

Figure 7

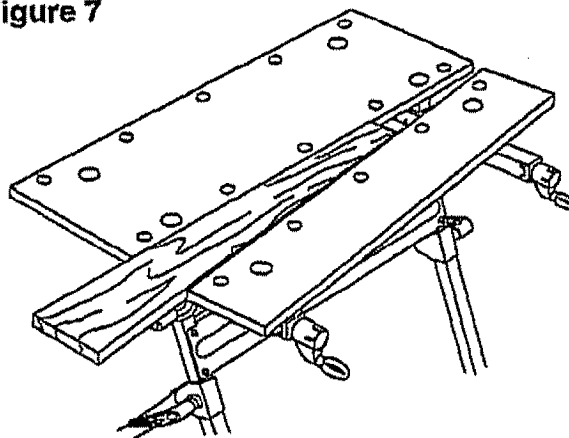

Using Adjustable Swivel Pegs to Hold Irregular Shaped Workpieces

Your Clamping Table is equipped with 4 swivel pegs. The swivel pegs can be positioned into any of the holes in the jaws and rear of top for gripping irregular shaped workpieces, or to extend gripping and clamping when your workpiece exceeds the jaw capacity. (See Figure 8.)

1. Fully extend front jaw.
2. Place workpiece on stand top.
3. Push swivel pegs into appropriate holes in table top and tighten jaw to securely grip workpiece. (See Figure 8.)

Figure 8

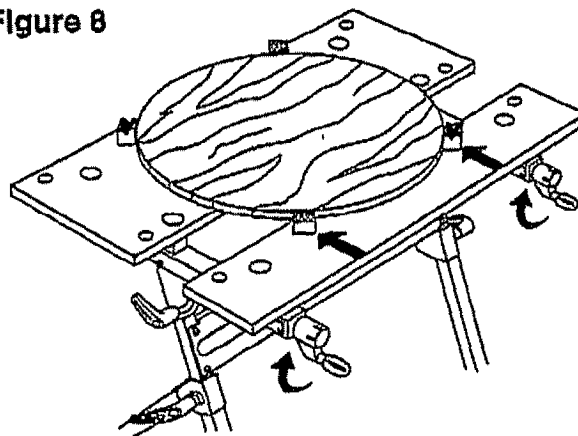

Increasing Gripping and Clamping Capacity

If workpiece exceeds jaw capacity, reposition swivel pegs into hole in the back row of holes in table top. (See Figure 9.)

CAUTION Swivel pegs are to be used to grip workpiece only in cases where the workpiece **DOES NOT** extend beyond the surface of the jaws.

Figure 9

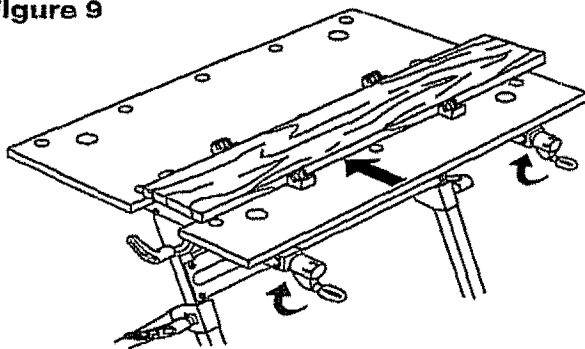

Using Adjustable Peg Supports

Your Clamping Table is equipped with 2 peg supports with horizontal and vertical V-grooves to grip pipes and other round shaped workpieces on the edge of table top jaw.

To Hold Round Workpieces Horizontally

1. Push swivel pegs and peg supports into holes on the edge of rear jaw. (See Figure 10.)
2. Close table top jaws until narrow enough for workpiece. Place workpiece in horizontal grooves in peg supports and tighten table top jaws until workpiece is secure.

Figure 10

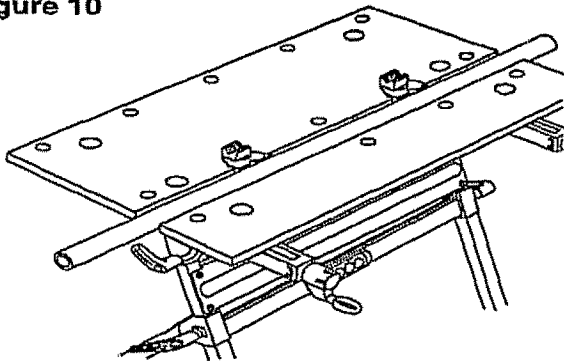

To Hold Round Workpieces Vertically

1. Push swivel peg and peg support into hole on the edge of front jaw.
2. Push swivel peg and peg support into hole in the same position on edge of rear jaw.

3. Close table top jaws until narrow enough for workpiece. Place workpiece in vertical groove in peg support and tighten table top jaws until workpiece is secure. (See Figure 11.)

Figure 11

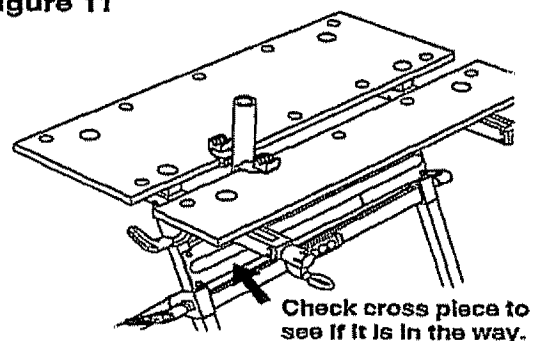

Folding Clamping Table for Storage and Carrying

1. Remove any hand tools or parts from stand top and storage rack. Close the table jaws together.
2. Turn handles counterclockwise to loosen top. Pivot the top to the folded position. (See Figure 12.)
3. Tilt stand back slightly onto rear legs. (See Figure 12.)
4. Reach down and push front legs backward.
5. Tighten handles by turning clockwise.

Figure 12

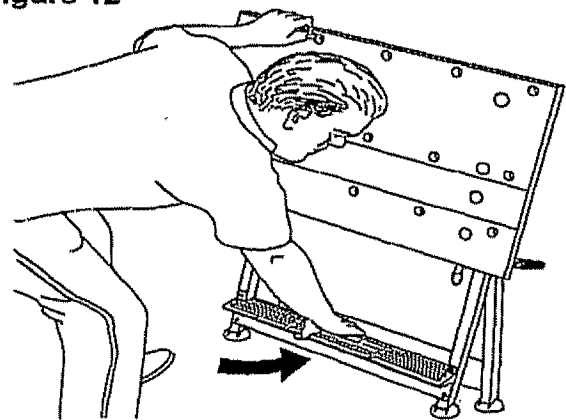

CAUTION To prevent personal injury while opening or closing your Clamping Table, always avoid positioning hands or fingers where they could get pinched.

Carrying the Clamping Table

With the Clamping Table folded and clamping table closed, carefully lift the Clamping Table by the yellow support grip mounted to the tool storage rack. (See Figure 13.)

WARNING To avoid having the shop stand open while moving, make sure handles are tightened securely.

Figure 13

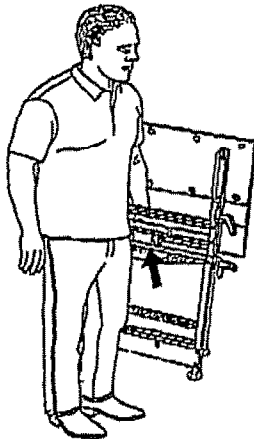
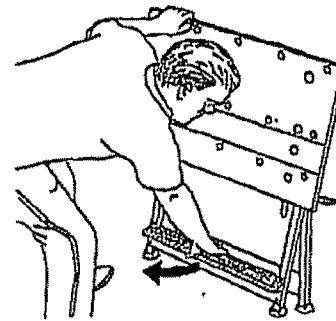

Figure 14



Tilting Table Top

1. Standing in front of the Clamping Table, loosen one top locking lever then the other.
2. Pull the table top up to the desired angle. (See Figure 15.)
3. Secure handles.

Figure 15

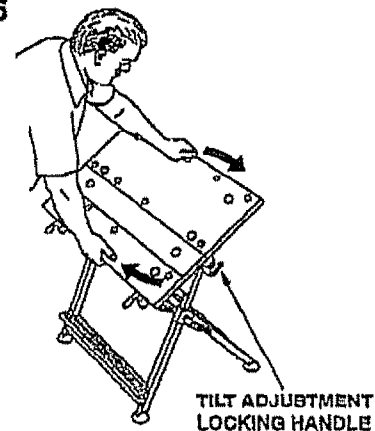

Opening the Clamping Table

1. Carefully move the folded Clamping Table to the desired location.
2. Face the front of the Clamping Table and hold the edge of the table top. Carefully reach down and pull the front legs of the table toward you. (See Figure 14.)
3. When the legs are in the fully-opened position, place them securely on the floor.

SPECIFICATIONS

Clamping Table	
Working Area.....	30" x 20-1/2"
Clamping Table Weight	42 lbs.
Maximum Weight Support.....	330 lbs.
Working Height.....	30" to 40-3/4"

Unpacking and Checking Model No. 695.65796

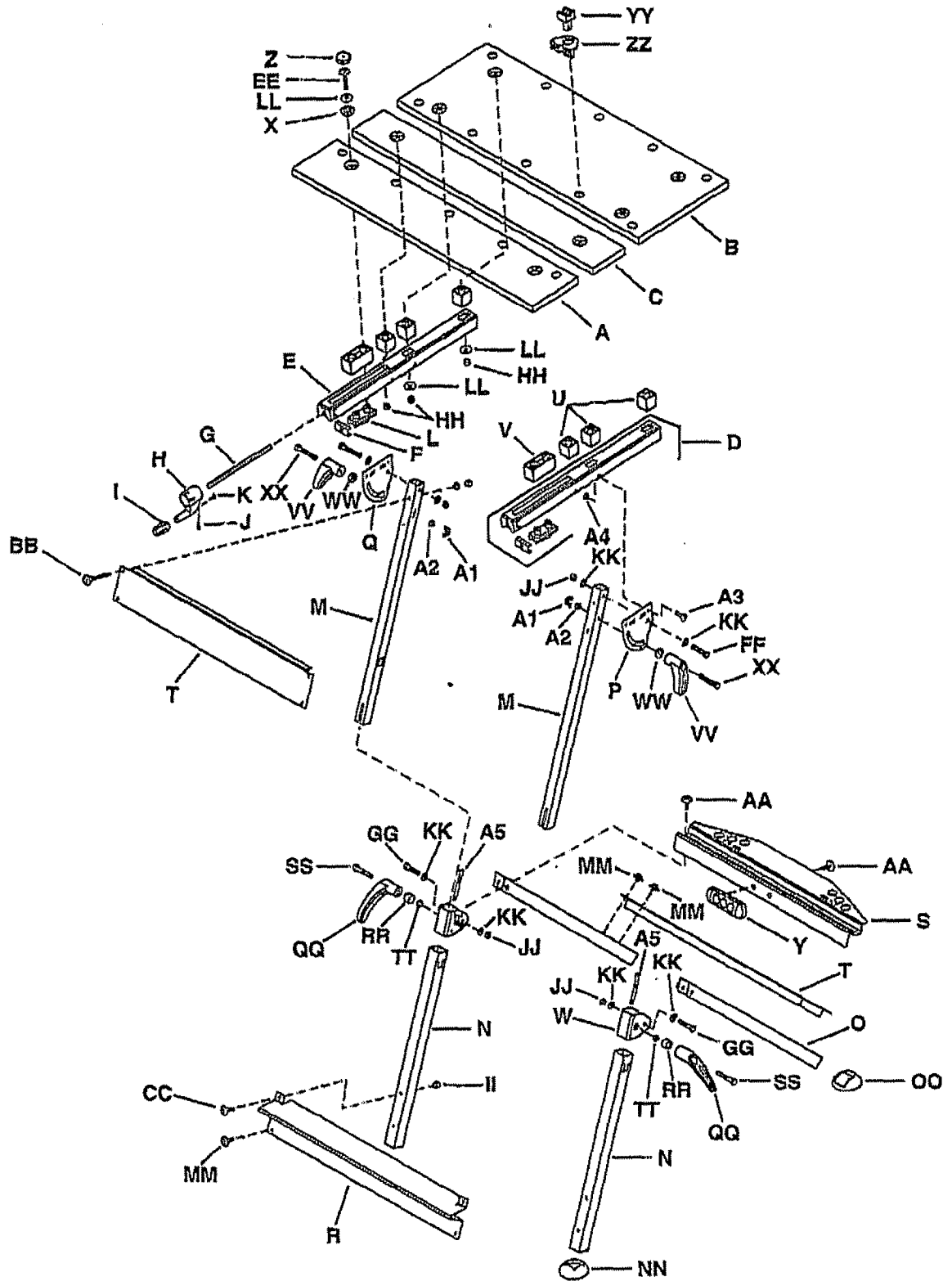

Contents

KEY NO.	PART NO.	DESCRIPTION	QTY	Part Set
A	119 800 364	Board - Front, Drilled and Printed	1	119 800 367
A	117 900 042	Board - Front, Raw Material	1	
B	119 800 365	Board - Rear, Drilled and Printed	1	
B	117 900 043	Board - Rear, Raw Material	1	
C	119 800 366	Board - Middle, Drilled and Printed	1	
C	117 900 044	Board - Middle, Raw Material	1	
D	119 800 367	Traverse Rail (Complete)	2	
E	117 010 219	Traverse Rail	1	
F	117 020 138	LL-Bracket	1	
G	117 210 091	Splindle	1	
H	116 600 057	Handle	1	
I	116 600 058	Grp for Handle <i>116 600 196</i>	1	
J	116 710 040	Lens Screw	1	
K	116 710 118	Lens Screw	1	
L	116 620 285	Thread Piece	1	
M	117 010 221	Telescopic Tube	2	
N	117 010 222	Leg, Front	2	
O	117 010 224	Leg, Rear	2	
P	117 010 231	Tilt Bracket, Right	1	
Q	117 010 227	Tilt Bracket, Left	1	
R	117 020 172	Footstep	1	
S	117 010 235	Tool Rack	1	
T	117 020 176	Crossbar	2	
U	116 610 160	Connector Part	6	
V	116 610 118	Connector Part - 2	2	
W	117 010 226	Connecting Part	2	
X	116 610 140	Slotted Bush	2	
Y	116 600 196	Hand Grp	1	
Z	116 610 141	Cover	8	
AA	116 710 015	Screw (M 6 X 12 DIN 7985)	4	
BB	116 710 136	Screw (M 6 X 35 DIN 7985)	4	
CC	116 700 082	Screw (M 6 X 40 DIN 7985)	2	
DD	116 710 140	Screw (M 8 X 45 DIN 7985)	2	
EE	116 710 091	Screw (M 8 X 55 DIN 7985)	6	
FF	116 710 139	Hex Head Screw (M 8 X 40 DIN 931)	2	
GG	116 720 136	Hex Head Screw (M 8 X 50 DIN 931)	2	
HH	116 700 021	Nut (M8 DIN 934)	6	
II	116 700 023	Nut (M 6 DIN 934)	6	
JJ	116 710 019	Nut (M 8 DIN 985)	4	
KK	116 700 027	Washer (B8 DIN 125)	8	
LL	116 720 112	Washer (8 DIN 9021)	12	
MM	117 710 141	Screw (M8 X 12 DIN 7500)	6	
NN	116 630 208	Foot Pad - Front	2	119 400 869
OO	116 630 202	Foot Pad - Rear	2	
PP	119 800 368	Handle (Complete)	2	119 800 368
QQ	116 610 171	Handle	1	
RR	116 600 043	Handle Cover	1	
SS	116 730 118	Hex Head Screw (M8 X 25 DIN 933)	1	119 800 369
TT	116 700 021	Nut (M8 DIN 934)	1	
JU	119 800 369	Handle (Complete)	2	119 800 369
VV	116 610 170	Handle	2	
WW	116 800 017	Clamping Nut	2	119 800 369
XX	116 720 002	Hex Head Screw (M8 X 50 DIN 933)	2	
YY	116 610 168	Swivel Peg	4	119 800 369
ZZ	116 610 169	Peg Support	2	
A1	117 010 230	Nut - Guide	2	119 800 369
A2	116 700 024 SQ	Nut (M8 DIN 934 557) <i>116 720 103</i>	2	
A3	116 710 117	Screw (M 6 X 10 DIN 7985)	4	119 800 369
A4	116 700 023	Nut (M6 DIN 934)	4	
A5	117 620 057	Flatspring	2	