

Operator's Manual

CRAFTSMAN[®]

CORDLESS DRILL-DRIVER

3/8 in. – 15.6 Volt – Variable Speed – Reversible

Model No.
973.114250

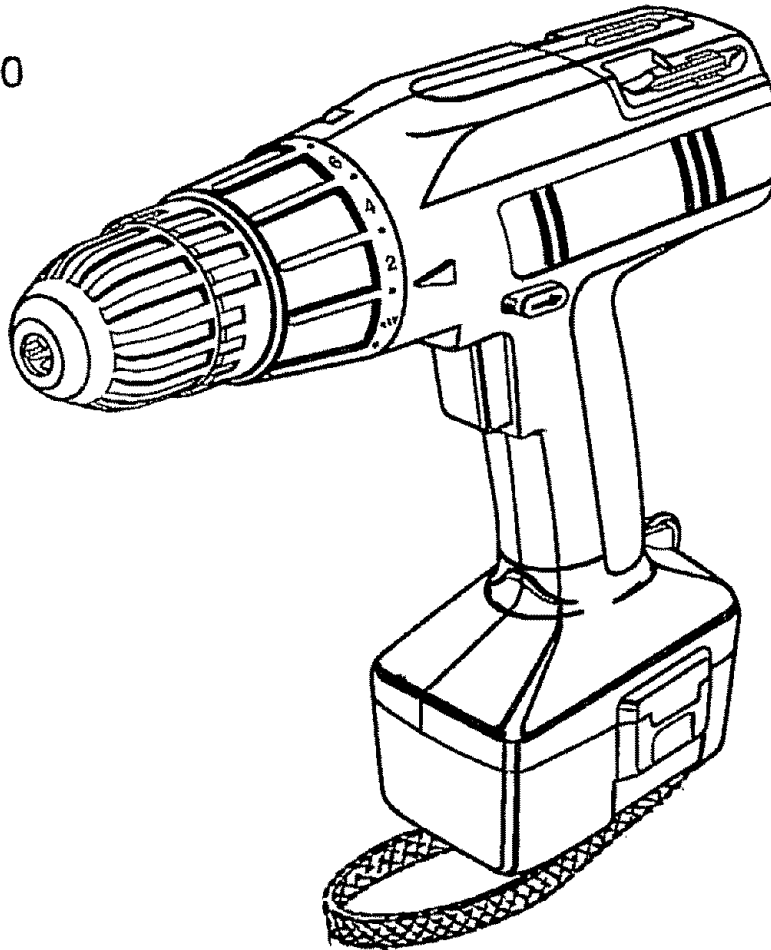

Save this manual for future reference.

⚠ CAUTION: Read and follow all safety rules and operating instructions before first use of this product.

Customer Help Line: 1-800-932-3188

Sears, Roebuck and Co., 3333 Beverly Rd., Hoffman Estates, IL 60179 USA

Visit the Craftsman Web page: www.sears.com/craftsman

983000-092
12-02



TABLE OF CONTENTS

■ Warranty	2
■ Introduction	2
■ General Safety Rules	3-4
■ Specific Safety Rules	4-5
■ Symbols	6
■ Specifications	7
■ Unpacking	7
■ Features	8
■ Adjustments	9-10
■ Operation	11-13
■ Maintenance	14
■ Accessories	15
■ Exploded View and Repair Parts List	17
■ Parts, Ordering, and Service	18

WARRANTY

FULL ONE YEAR WARRANTY ON CRAFTSMAN DRILL-DRIVER

If this **CRAFTSMAN** tool fails to give complete satisfaction within one year from the date of purchase, **RETURN IT TO THE NEAREST SEARS STORE IN THE UNITED STATES**, and Sears will repair it, free of charge.

If this **CRAFTSMAN** tool is used for commercial or rental purposes, this warranty applies for only 90 days from the date of purchase.

This warranty gives you specific legal rights, and you may also have other rights which vary from state to state.

Sears, Roebuck and Co., Dept. 817 WA, Hoffman Estates, IL 60179

INTRODUCTION

Your drill-driver has many features for making the use of this tool more pleasant and enjoyable. Safety, performance, and dependability have been given top priority in the design of this tool making it easy to maintain and operate.

⚠ WARNING: Do not attempt to use this tool until you thoroughly read and completely understand the operator's manual. Pay close attention to the safety rules, including Dangers, Warnings, and Cautions. If you use your tool properly and only for what it is intended, you will enjoy years of safe, reliable service.

⚠ Look for this symbol to point out important safety precautions. It means attention!!! Your safety is involved.



⚠ WARNING: The operation of any router can result in foreign objects being thrown into your eyes, which can result in severe eye damage. Before beginning operation, always wear safety goggles or safety glasses with side shields and a full face shield when needed. We recommend Wide Vision Safety Mask for use over eyeglasses or standard safety glasses with side shields. Always wear eye protection which is marked to comply with ANSI Z87.1.

GENERAL SAFETY RULES

⚠ WARNING: Read and understand all instructions. Failure to follow all instructions listed below, may result in electric shock, fire and/or serious personal injury.

SAVE THESE INSTRUCTIONS

WORK AREA

- **Keep your work area clean and well lit.** Cluttered benches and dark areas invite accidents.
- **Do not operate power tools in explosive atmospheres, such as in the presence of flammable liquids, gases, or dust.** Power tools may create sparks which may ignite the dust or fumes.
- **Keep bystanders, children, and visitors away while operating a power tool.** Distractions can cause you to lose control.

ELECTRICAL SAFETY

- **Do not abuse the cord.** Never use the cord to carry the charger. Keep cord away from heat, oil, sharp edges, or moving parts. Replace damaged cords immediately. Damaged cords may create a fire.
- **A battery operated tool with integral batteries or a separate battery pack must be recharged only with the specified charger for the battery.** A charger that may be suitable for one type of battery may create a risk of fire when used with another battery. Use battery only with charger listed.

BATTERY PACK

1311444 (Item No. 9-11004)

CHARGER

982031-001 (Item No. 9-11005)

- **Use battery operated tool only with specifically designated battery pack.** Use of any other batteries may create a risk of fire. Use only with battery pack listed.

PERSONAL SAFETY

- **Stay alert, watch what you are doing and use common sense when operating a power tool.** Do not use tool while tired or under the influence of drugs, alcohol, or medication. A moment of inattention while operating power tools may result in serious personal injury.
- **Dress properly. Do not wear loose clothing or jewelry. Contain long hair. Keep your hair, clothing, and gloves away from moving parts.** Loose clothes, jewelry, or long hair can be caught in moving parts.
- **Avoid accidental starting. Be sure switch is off before plugging in.** Carrying tools with your finger

on the switch or plugging in tools that have the switch on, invites accidents.

- **Remove adjusting keys or wrenches before turning the tool on.** A wrench or a key that is left attached to a rotating part of the tool may result in personal injury.
- **Do not overreach. Keep proper footing and balance at all times.** Proper footing and balance enables better control of the tool in unexpected situations. Do not use on a ladder or unstable support.
- **Use safety equipment. Always wear eye protection.** Dust mask, non-skid safety shoes, hard hat, or hearing protection must be used for appropriate conditions.

TOOL USE AND CARE

- **Use clamps or other practical way to secure and support the workpiece to a stable platform.** Holding the work by hand or against your body is unstable and may lead to loss of control.
- **Do not force tool. Use the correct tool for your application.** The correct tool will do the job better and safer at the rate for which it is designed.
- **Do not use tool if switch does not turn it on or off.** A tool that cannot be controlled with the switch is dangerous and must be repaired.
- **Disconnect battery pack from tool or place the switch in the locked or off position before making any adjustments, changing accessories, or storing the tool.** Such preventive safety measures reduce risk of starting the tool accidentally.
- **Store idle tools out of reach of children and other untrained persons.** Tools are dangerous in the hands of untrained users.
- **When battery pack is not in use, keep it away from other metal objects like: paper clips, coins, keys, nails, screws, or other small metal objects that can make a connection from one terminal to another.** Shorting the battery terminals together may cause sparks, burns, or a fire.
- **Maintain tools with care. Keep cutting tools sharp and clean.** Properly maintained tools with sharp cutting edges are less likely to bind and are easier to control.
- **Check for misalignment or binding of moving parts, breakage of parts, and any other condition that may affect the tool's operation. If damaged, have the tool serviced before using.** Many accidents are caused by poorly maintained tools.
- **Use only accessories that are recommended by the manufacturer for your model.** Accessories that may be suitable for one tool, may create a risk of injury when used on another tool.

GENERAL SAFETY RULES

SERVICE

- Tool service must be performed only by qualified repair personnel. Service or maintenance performed by unqualified personnel could result in a risk of injury.
- When servicing a tool, use only identical replacement parts. Follow instructions in the Maintenance section of this manual. Use of unauthorized parts or failure to follow Maintenance Instructions may create a risk of electric shock or injury.

SPECIFIC SAFETY RULES

Hold tool by insulated gripping surfaces when performing an operation where the tool may contact hidden wiring or its cord. Contact with a "live" wire will make exposed metal parts of the tool "live" and shock the operator.

CORDLESS TOOL RULES

- Know your power tool. Read operator's manual carefully. Learn its applications and limitations, as well as the specific potential hazards related to this tool. Following this rule will reduce the risk of electric shock, fire, or serious injury.
- Cordless tools do not have to be plugged into an electrical outlet; therefore, they are always in operating condition. Be aware of possible hazards when not using your cordless tool or when changing accessories. Following this rule will reduce the risk of electric shock, fire, or serious personal injury.
- Do not place cordless tools or their batteries near fire or heat. This will reduce the risk of explosion and possibly injury.

⚠ WARNING: Batteries vent hydrogen gas and can explode in the presence of a source of ignition, such as a pilot light. To reduce the risk of serious personal injury, never use any cordless product in the presence of open flame. An exploded battery can propel debris and chemical. If exposed, flush with water immediately.

- Do not charge cordless tool in a damp or wet location. Following this rule will reduce the risk of electric shock.
- For best results, your cordless tool should be charged in a location where the temperature is more than 50°F but less than 100°F. Do not store outside or in vehicles.
- Under extreme usage or temperature conditions, battery leakage may occur. If liquid comes in contact with your skin, wash immediately with soap and water, then neutralize with lemon juice or vinegar. If liquid gets into your eyes, flush them with clean water for at least 10 minutes, then seek immediate medical attention. Following this rule will reduce the risk of serious personal injury.

⚠ WARNING: A damaged battery is subject to explosion. To avoid serious personal injury, properly dispose of a damaged battery.

CHARGER RULES

- Save these instructions. This manual contains important safety and operating instructions for charger. Following this rule will reduce the risk of electric shock, fire, or serious personal injury.
- Before using battery charger, read all instructions and cautionary markings in this manual, on battery charger, and product using battery charger. Following this rule will reduce the risk of electric shock, fire, or serious personal injury.
- To reduce risk of injury, charge only nickel-cadmium type rechargeable batteries. Other types of batteries may burst causing personal injury and damage. Following this rule will reduce the risk of electric shock, fire, or serious personal injury.
- Do not expose charger to wet or damp conditions. Following this rule will reduce the risk of electric shock, fire, or serious personal injury.
- Use of an attachment not recommended or sold by the battery charger manufacturer may result in a risk of fire, electric shock, or injury to persons. Following this rule will reduce the risk of electric shock, fire, or serious personal injury.
- To reduce risk of damage to charger body and cord, pull by charger plug rather than cord when disconnecting charger. Following this rule will reduce the risk of electric shock, fire, or serious personal injury.
- Make sure cord is located so that it will not be stepped on, tripped over, or otherwise subjected to damage or stress. Following this rule will reduce the risk of serious personal injury.

SAVE THESE INSTRUCTIONS

SPECIFIC SAFETY RULES

- An extension cord should not be used unless absolutely necessary. Use of improper extension cord could result in a risk of fire and electric shock. If extension cord must be used, make sure:

- a. That pins on plug of extension cord are the same number, size and shape as those of plug on charger.
- b. That extension cord is properly wired and in good electrical condition; and
- c. That wire size is large enough for AC ampere rating of charger as specified below:

Cord Length (Feet) 25' 50' 100'

Cord Size (AWG) 16 16 16

Note: AWG = American Wire Gage

- Do not operate charger with a damaged cord or plug. If damaged, have replaced immediately by a qualified serviceman. Following this rule will reduce the risk of electric shock, fire, or serious personal injury.
- Do not operate charger if it has received a sharp blow, been dropped, or otherwise damaged in any way; take it to a qualified serviceman. Following this rule will reduce the risk of electric shock, fire, or serious personal injury.
- Do not disassemble charger; take it to a qualified serviceman when service or repair is required. Incorrect reassembly may result in a risk of electric shock or fire. Following this rule will reduce the risk of electric shock, fire, or serious personal injury.
- To reduce the risk of electric shock, unplug charger from outlet before attempting any maintenance or cleaning. Turning off controls will not reduce this risk. Following this rule will reduce the risk of electric shock, fire, or serious personal injury.
- Do not use charger outdoors. Following this rule will reduce the risk of electric shock, fire, or serious personal injury.
- Disconnect charger from power supply when not in use. Following this rule will reduce the risk of electric shock, fire, or serious personal injury.

- ⚠ **DANGER:** Risk of electric shock. Do not touch uninsulated portion of output connect or uninsulated battery terminal.

- Save these instructions. Refer to them frequently and use them to instruct others who may use this tool. If you loan someone this tool, loan them these instructions also. Following this rule will reduce the risk of electric shock, fire, or serious personal injury.



- ⚠ **WARNING:** Some dust created by power sanding, sawing, grinding, drilling, and other construction activities contains chemicals known to cause cancer, birth defects or other reproductive harm. Some examples of these chemicals are:

- lead from lead-based paints,
- crystalline silica from bricks and cement and other masonry products, and
- arsenic and chromium from chemically-treated lumber.

Your risk from these exposures varies, depending on how often you do this type of work. To reduce your exposure to these chemicals: work in a well ventilated area, and work with approved safety equipment, such as those dust masks that are specially designed to filter out microscopic particles.

SYMBOLS

Important: Some of the following symbols may be used on your tool. Please study them and learn their meaning. Proper interpretation of these symbols will allow you to operate the tool better and safer.

SYMBOL	NAME	DESIGNATION/EXPLANATION
V	Volts	Voltage
A	Amperes	Current
Hz	Hertz	Frequency (cycles per second)
W	Watt	Power
min	Minutes	Time
~	Alternating Current	Type or a characteristic of current
—	Direct Current	Type or a characteristic of current
n_0	No Load Speed	Rotational speed, at no load
	Class II Construction	Double-insulated construction
.../min	Per Minute	Revolutions, strokes, surface speed, orbits etc. per minute
	Safety Alert	Precautions that involve your safety
	Wet Conditions Alert	Do not expose to rain or use in damp locations

The purpose of safety symbols is to attract your attention to possible dangers. The safety symbols, and the explanations with them, deserve your careful attention and understanding. The safety warnings do not by themselves eliminate any danger. The instructions or warnings they give are not substitutes for proper accident prevention measures.

SYMBOL MEANING



DANGER: Indicates an imminently hazardous situation, which, if not avoided, will result in death or serious injury.



WARNING: Indicates a potentially hazardous situation, which, if not avoided, could result in serious injury.



CAUTION: Indicates a potentially hazardous situation, which, if not avoided, may result in minor or moderate injury.

Important: Advises you of important information or instructions vital to the operation or maintenance of the equipment.

Note: Advises you of additional information concerning the operation or maintenance of the equipment.

FEATURES

Before using the drill-driver, familiarize yourself with all operating features and safety requirements. However, do not let familiarity with the tool make you careless.

⚠ WARNING: Exercise caution when using the drill-driver. Careless actions, for even a fraction of a second, can result in serious personal injury.

SWITCH

The drill-driver has a conveniently located trigger switch.

VARIABLE SPEED

The variable speed feature allows you to operate the drill-driver at a higher speed and torque when necessary.

KEYLESS CHUCK

Your new drill-driver has a keyless chuck. As the name implies, you can hand tighten or release drill bits in the chuck jaws. Grasp and hold the collar of the chuck with one hand. Rotate the chuck body with your other hand. The arrows on the chuck indicate which direction to rotate the chuck body in order to **LOCK** (tighten) or **UNLOCK** (release) the drill bit.

TORQUE ADJUSTMENT

You can easily adjust the torque of the drill-driver. The maximum torque is 100 in.lb.

BI-DIRECTIONAL ROTATION

The drill-driver has a conveniently located switch that allows you to easily change the direction of the bit rotation.

LEVEL DRILLING

A level is recessed in the motor housing on top of the drill-driver, which allows you to keep drill bits level during drilling operations.

BIT STORAGE

When you are not using the drill-driver, you can store the bits in the storage area located on the top of the drill.

WRIST STRAP

A wrist strap is provided to reduce the chances of dropping the drill-driver. Place one hand through the wrist strap when carrying the tool.

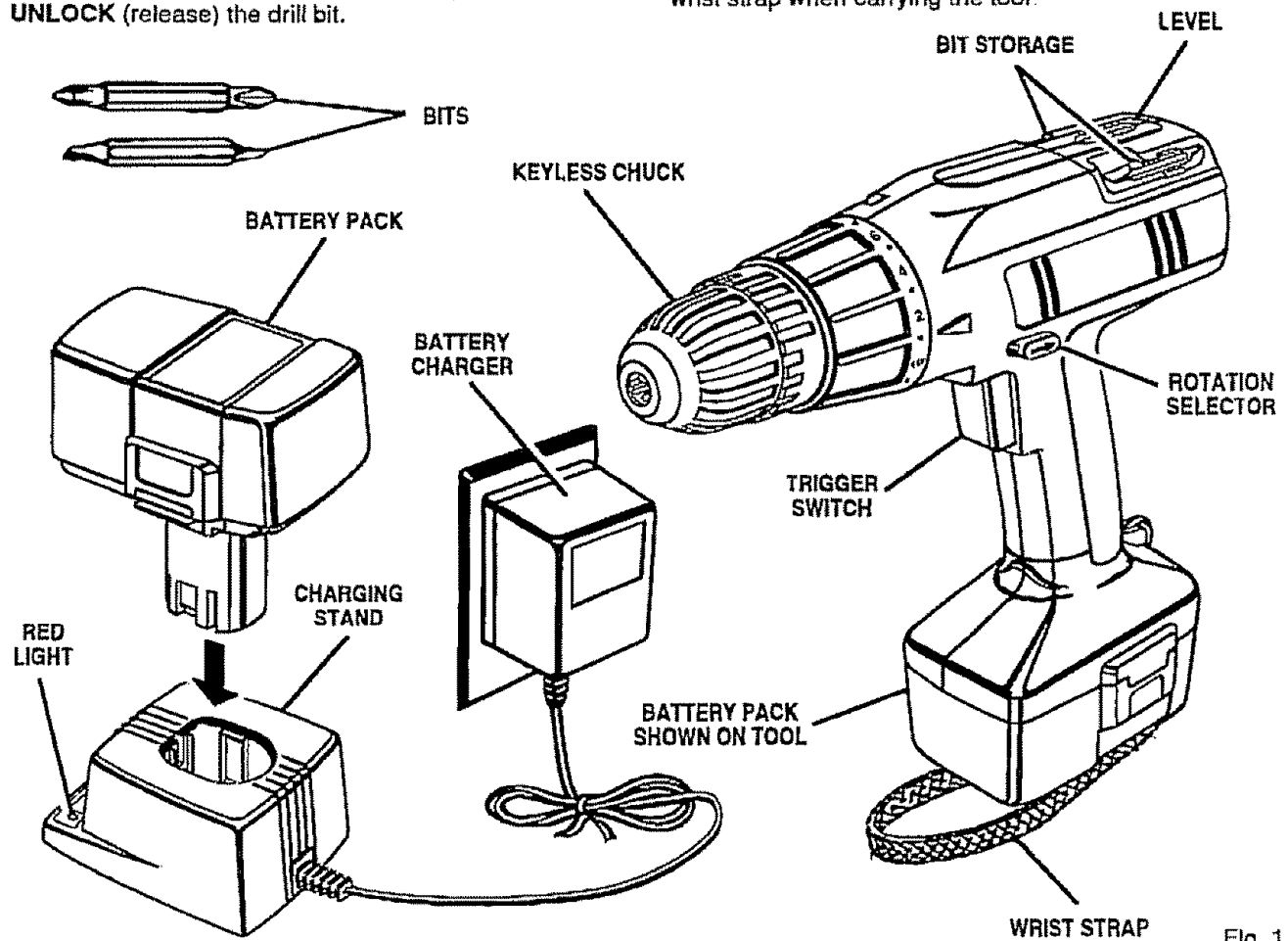

Fig. 1

SPECIFICATIONS

DRILL-DRIVER

Chuck	3/8 in. Keyless
Maximum Torque	100 in.lbs
Switch	Variable Speed
Clutch	24 positions
Motor	DC, 15.6 Volt
No Load Speed	0 - 600/min

CHARGER ASSEMBLY

Charger Input	120 Volts, 60 Hz, AC only
Charger Voltage	15.6 Volt
Charge Rate	3 - 6 Hours

UNPACKING

INSTRUCTIONS

We have shipped the drill-driver completely assembled.

- Carefully remove the tool and the accessories from the box. Make sure that all items listed in the packing list are included.
- Inspect the tool carefully to be sure no breakage or damage occurred during shipping.
- Do not discard the packing material until you have carefully inspected and satisfactorily operated the tool.
- If any parts are damaged or missing, please call 1-800-932-3188 for assistance.

PACKING LIST

Drill-driver
Battery (2)
Charger
Carrying Case
Operator's Manual

-  **WARNING:** If any parts are missing, do not operate your tool until the missing parts are replaced. Failure to do so could result in serious personal injury.

ADJUSTMENTS

⚠ WARNING: The drill-driver should never be connected to a power supply when you are assembling parts, making adjustments, cleaning, performing maintenance, or when the tool is not in use. Disconnecting the tool prevents accidental starting that could cause serious injury.

INSTALLING BITS

See Figure 2.

Follow these steps to install bits.

1. Lock the trigger switch by placing the rotation selector in the center position.
2. Open or close chuck jaws to a point where the opening is slightly larger than the bit size you intend to use.
3. Raise the front of the drill-driver slightly to keep the bit from falling out of the chuck jaws.

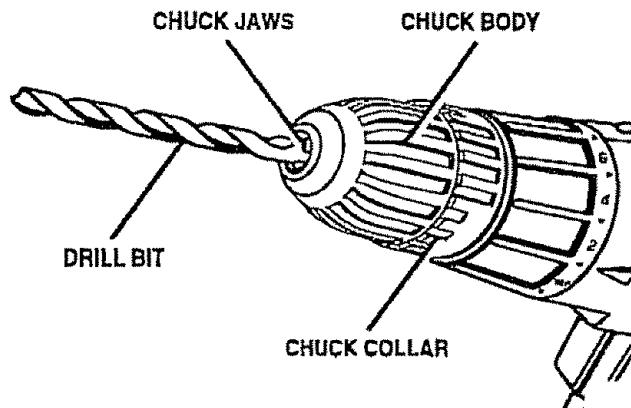

Fig. 2

4. Insert the drill bit into the chuck the full length of the jaws.
5. Tighten the chuck jaws onto the drill bit.

Note: To tighten the chuck jaws, grasp and hold the collar of the chuck with one hand, while rotating the chuck body with the other hand. Rotate the chuck body in the direction of the arrow marked **LOCK**. Do not use a wrench to tighten or loosen the chuck jaws.

⚠ WARNING: Make sure to insert the drill bit straight into the chuck jaws. Do not insert the drill bit into the chuck jaws at an angle (as shown in figure 3) and then tighten. This could cause the drill bit to be thrown from drill-driver, resulting in serious personal injury or damage to the chuck.

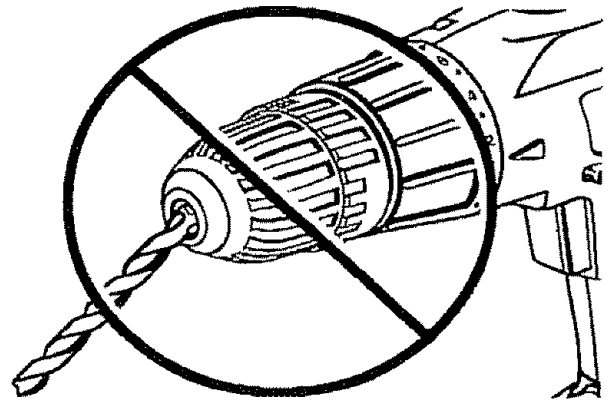

Fig. 3

⚠ WARNING: Do not hold the chuck body with one hand and use the power of the drill-driver to tighten the chuck jaws onto the drill bit. The chuck body could slip in your hand or your hand could slip and come in contact with the rotating drill bit. This could cause an accident resulting in serious personal injury.

REMOVING BITS

See Figure 2.

Follow these steps to remove bits.

1. Lock the trigger switch by placing the rotation selector in the center position.
2. Loosen the chuck jaws.

Note: To loosen the chuck jaws, grasp and hold the collar of the chuck with one hand, while rotating the chuck body with the other hand. Rotate the chuck body in the direction of the arrow marked **UNLOCK**. Do not use a wrench to tighten or loosen the chuck jaws.

3. Remove the drill bit from the chuck jaws.

ADJUSTMENTS

REMOVING THE CHUCK

You must remove the chuck in order to use some accessories.

See Figures 4, 5, and 6.

Follow these steps to remove the chuck.

1. Lock the trigger switch by placing the rotation selector in the center position.
2. Open the chuck jaws by turning the chuck collar counterclockwise.
3. Insert a 5/16 in. or larger hex key into the chuck.
4. Tighten the chuck jaws using the chuck key provided.

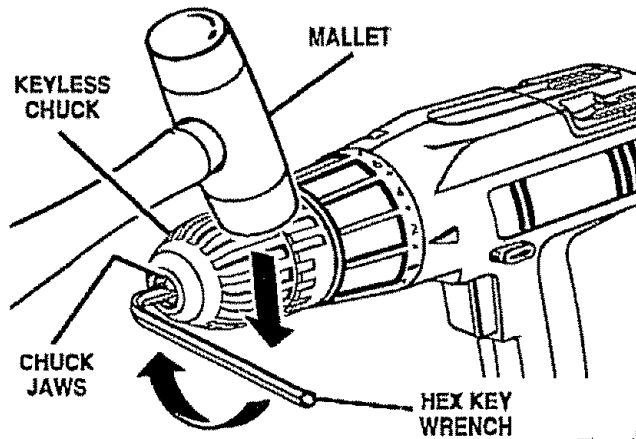

5. Loosen the chuck screw by tapping the hex key sharply with a mallet in a clockwise direction.
6. Open the chuck jaws and remove the hex key.
7. Remove the chuck screw by turning it in a clockwise direction with a screwdriver.

Note: The screw has left hand threads.

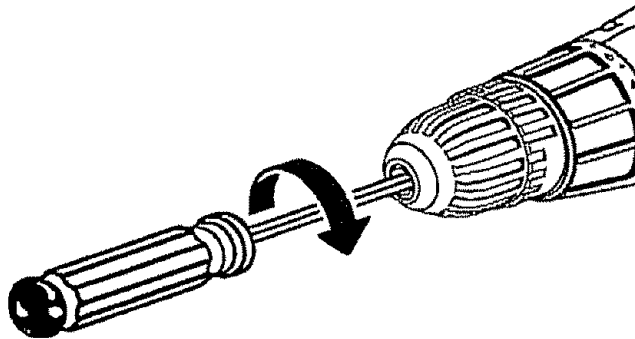
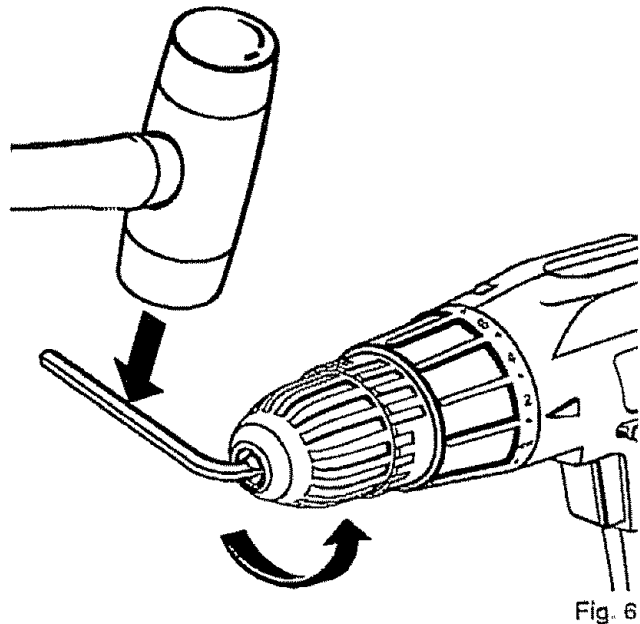

Fig. 5

8. Reinsert the hex key into the chuck.
9. Tighten the chuck jaws securely using the chuck key provided.
10. Loosen the chuck by tapping the hex key sharply with a mallet in a counterclockwise direction.
11. Unscrew the chuck by hand.



TIGHTENING A LOOSE CHUCK

The chuck may become loose on the spindle and develop a wobble. Periodically, check the chuck screw for tightness. A loose screw may cause the chuck jaws to bind and prevent them from closing.

Follow these steps to tighten a loose chuck.

1. Lock the trigger switch by placing the rotation selector in the center position.
2. Open the chuck jaws by turning the chuck collar counterclockwise.
3. Insert a 5/16 in. or larger hex key into the chuck.
4. Tighten the chuck jaws using the chuck key provided.
5. Tap the hex key sharply with a mallet in a clockwise direction to tighten the chuck on the spindle.
6. Open the chuck jaws and remove the hex key.
7. Tighten the chuck screw by turning it in a counterclockwise direction with a screwdriver.

Note: The screw has left hand threads.

OPERATION

⚠ WARNING: Always wear safety goggles or safety glasses with side shields when operating this tool. Failure to do so could result in dust, shavings, chips, or loose particles being thrown in your eyes resulting in possible serious injury. If the operation is dusty, also wear a face or dust mask.

CHARGING THE BATTERY PACK

The battery pack for this tool has been shipped in a low charge condition to prevent possible problems. Therefore, you should charge it at least 3 to 5 hours prior to use.

Note: The batteries will not reach full charge the first time they are charged. Allow several cycles (drilling followed by recharging) for them to become fully charged.

Follow these steps to charge the battery pack.

1. Connect the battery charger to a power supply.

Note: Make sure the power supply is normal house voltage, 120 volts, 60 Hz, AC only.

2. Place the battery pack in the charging stand.
3. Press down on the battery pack to ensure that the contacts on the battery pack engage properly with the contacts in the charging stand.

The red light on the base of the charging stand comes on when you have properly installed the battery pack.

Note: If the charger does not charge the battery pack, return the charger, battery pack, and charging stand to the nearest Sears repair center for an electrical check.

- After normal usage, 3 hours of charging time is required to be fully charged. A minimum charge time of 3 to 5 hours is required to recharge a completely discharged tool.
- Unplug the charger from the power supply when the battery becomes fully charged.
- Charge the battery pack only with the charger and charging stand provided.
- The battery pack will become slightly warm to the touch while charging. This is normal and does not indicate a problem.
- **Do not** place the charger in an area of extreme heat or cold. It works best at normal room temperature.

INSTALLING THE BATTERY PACK

See Figure 7.

Follow these steps to install the battery pack.

1. Lock the trigger switch by placing the rotation selector in the center position.
2. Place the battery pack on the drill-driver.
3. Make sure the latches on each side of the battery pack snap into place and the battery pack is secured on the tool before beginning operation.

⚠ CAUTION: When placing the battery pack on the drill-driver, make sure that the raised rib inside the drill-driver aligns with the groove on the battery pack and that the latches snap into place properly. Improper assembly of the battery pack can cause damage to internal components.

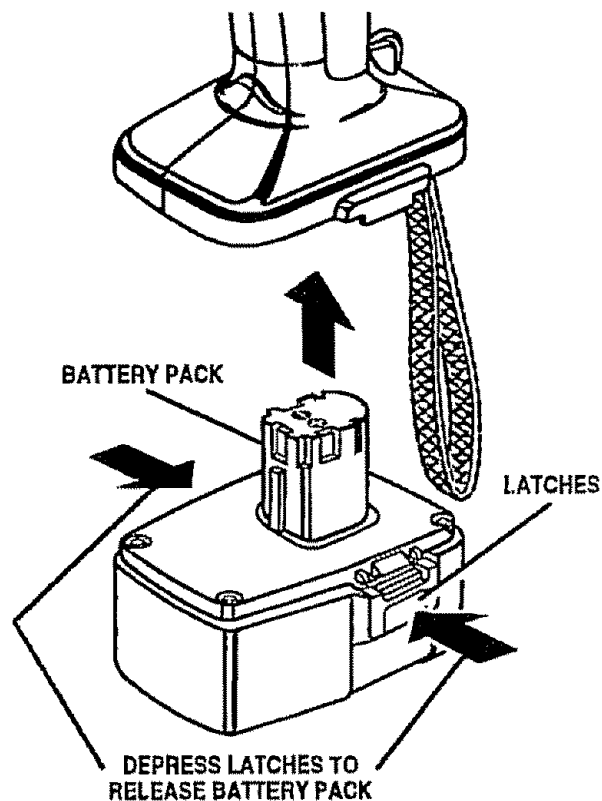

Fig. 7

REMOVING THE BATTERY PACK

Follow these steps to remove the battery pack.

1. Lock the trigger switch by placing the rotation selector in the center position.
2. Depress the latches on the side of battery pack.
3. Remove the battery pack from the drill-driver.

OPERATION

TURNING ON/OFF THE DRILL-DRIVER

See Figure 8.

Follow these steps to turn on/off the drill-driver.

- *Turn on the drill-driver*—Depress the trigger switch.
- *Turn off the drill-driver*—Release the trigger switch.

LOCKING THE SWITCH

See Figure 8.

You can lock the trigger switch in the **OFF** position to prevent accidental starting when the tool is not in use. To lock the switch, place the rotation selector in the center position.

⚠ WARNING: Battery tools are always in operating condition. Therefore, always lock the switch when you are not using the tool or when you are carrying the tool.

ADJUSTING THE SPEED

Adjust the speed with the trigger switch. The harder you press the trigger, the faster the bit turns.

Note: You might hear a whistling or ringing noise from the switch during use. Do not be concerned, this is a normal part of the switch function.

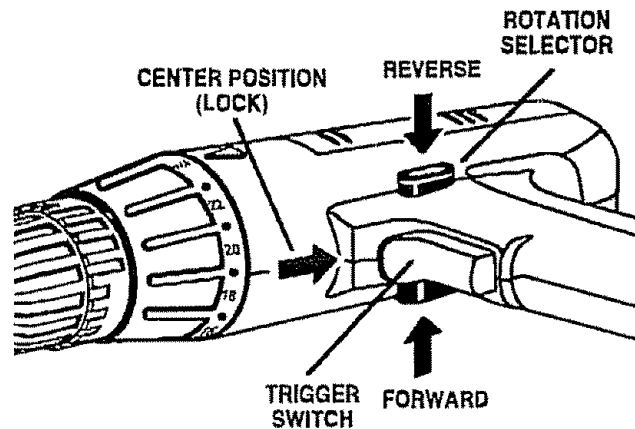



Fig. 8

ADJUSTING THE TORQUE

See Figure 9.

The drill-driver is equipped with an adjustable torque clutch for driving different types of screws into different materials. The proper setting depends on the type of material and the size of screw you are using.

Follow these steps to adjust the torque.

1. Identify the twenty four torque indicator settings located on the front of the drill-driver.
2. Rotate adjusting ring to the desired setting.
 - 1 - 4 For driving small screws.
 - 5 - 8 For driving screws into soft material.
 - 9 - 12 For driving screws into soft and hard materials.
 - 13 - 16 For driving screws in hard wood.
 - 17 - 20 For driving large screws.
 - 21 -  For heavy drilling.

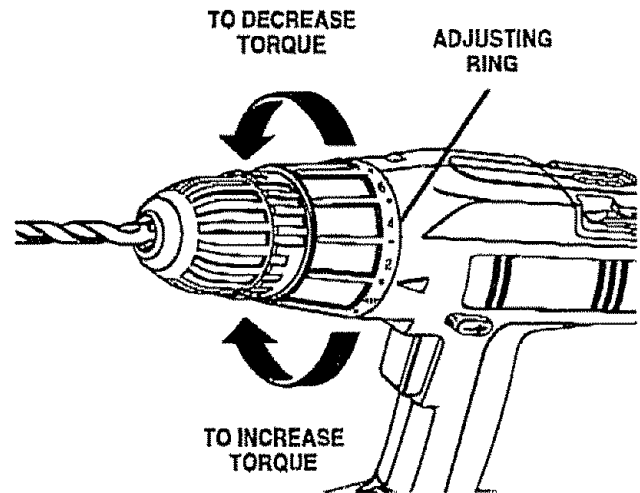

Fig. 9

CHANGING THE BIT ROTATION

See Figure 8.

Follow these steps to change the bit rotation.

1. Position the drill-driver in a normal operating position.
2. Choose one of these options:
 - *For forward rotation*—Move the rotation selector to the left.
 - *For backward rotation*—Move the rotation selector to the right.

Note: When the rotation selector is in center position, the trigger switch is locked.

⚠ CAUTION: To prevent gear damage, always allow the chuck to come to a complete stop before changing the bit rotation.

OPERATION

OPERATING THE DRILL-DRIVER

See Figure 10.

Follow these steps to operate the drill-driver.

1. Check the rotation selector for the correct setting. Refer to "CHANGING THE BIT ROTATION" earlier in this manual.
2. Secure the workpiece in a vise or with clamps to keep it from turning as the drill bit rotates.
3. Hold the drill-driver firmly and place the bit at the point to be drilled.
4. Depress the trigger switch to start the drill-driver.
5. Move the drill bit into the workpiece applying only enough pressure to keep the bit cutting.

Note: Do not force the drill-driver or apply side pressure to elongate a hole. Let the drill-driver and bit do the work.

⚠ WARNING: Be prepared for binding or bit breakthrough. When these situations occur, the drill-driver has a tendency to grab and kick in the opposite direction of the rotation and could cause loss of control when breaking through material. If you are not prepared, this loss of control can result in serious injury.

Observe these practices when drilling:

- When drilling hard, smooth surfaces, use a center punch to mark the desired hole location. This action prevents the bit from slipping off center as you start the hole. Operate the drill-driver at a low speed until the hole is started.
- When drilling metals, use a light oil on the bit to keep it from overheating. The oil will prolong the life of the bit and increase the drilling action.
- If the bit jams in the workpiece or if the drill-driver stalls, release the trigger switch immediately. Remove the bit from the workpiece and determine the reason for jamming.

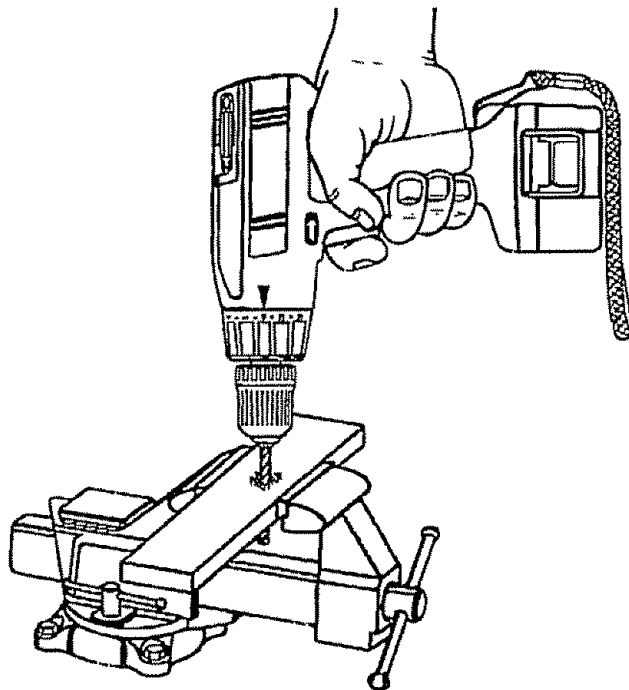

Fig. 10

MAINTENANCE

⚠ WARNING: When servicing, use only identical Craftsman replacement parts. Use of any other part may create a hazard or cause product damage.

GENERAL

Only the parts shown on the parts list are intended to be repaired or replaced by the customer. All other parts are an important part of the double insulation system and should be serviced only by a qualified Sears service technician.

Avoid using solvents when cleaning plastic parts. Most plastics are susceptible to damage from various types of commercial solvents and may be damaged by their use. Use clean cloths to remove dirt, carbon dust, etc.

⚠ WARNING: Do not at any time let brake fluids, gasoline, petroleum-based products, penetrating oils, etc. come in contact with plastic parts. They contain chemicals that can damage, weaken, or destroy plastic.

BATTERIES

Your tool is equipped with Nickel-Cadmium rechargeable batteries. Length of service from each charging will depend on the type of work you are doing.

The batteries in this tool have been designed to provide maximum trouble-free life. However, like all batteries, they will eventually wear out. **DO NOT** disassemble battery pack and attempt to replace the batteries. Handling of these batteries, especially when wearing rings and jewelry, could result in serious burn.

To obtain the longest possible battery life, we suggest the following:

- Store and charge the batteries in a cool area. Temperatures above or below normal room temperature will shorten battery life.
- Never store batteries in a discharged condition. Wait for battery to cool and charge immediately.
- All batteries gradually lose their charge. The higher the temperature, the quicker they lose their charge. If you store your tool for long periods of time without using it, recharge the batteries every month or two. This practice will prolong battery life.

BATTERY DISPOSAL

To preserve natural resources, please recycle or dispose of the battery properly. Local, state, or federal laws may prohibit disposal of Nickel-Cadmium batteries in ordinary trash.

Consult your local waste authority for information regarding available recycling and/or disposal options. For more information on battery recycling call 1-800-8BATTERY.



⚠ WARNING: Do not attempt to disassemble the battery pack. Fire or injury can result.

⚠ WARNING: Upon removal, cover the battery pack's terminals with heavy duty adhesive tape. Do not attempt to destroy or disassemble battery pack or remove any of its components. Also, never touch both terminals with metal objects and/or body parts, as short circuit can result. Keep away from children. Failure to comply with these warnings could result in fire and/or serious injury.

ACCESSORIES

The following recommended accessories are currently available at Sears retail stores.

- 6-Pc. Extra Length Magnite Power Bit Set
- 30-Pc. Power Screwdriver/Nutdriver Set and Case
- 17-Pc. Power Screwdriver/Nutdriver Set and Case
- High Speed Bits (For Wood or Metal), 3/4 in. Max.
- Keyless Chuck

 **WARNING:** The use of attachments or accessories not listed might be hazardous.

CRAFTSMAN DRILL-DRIVER – MODEL NUMBER 973.114250

The model number is on a plate attached to the motor housing. Always mention the model number in all correspondence regarding your **DRILL-DRIVER** or when ordering repair parts.

SEE BACK PAGE FOR PARTS ORDERING INSTRUCTIONS

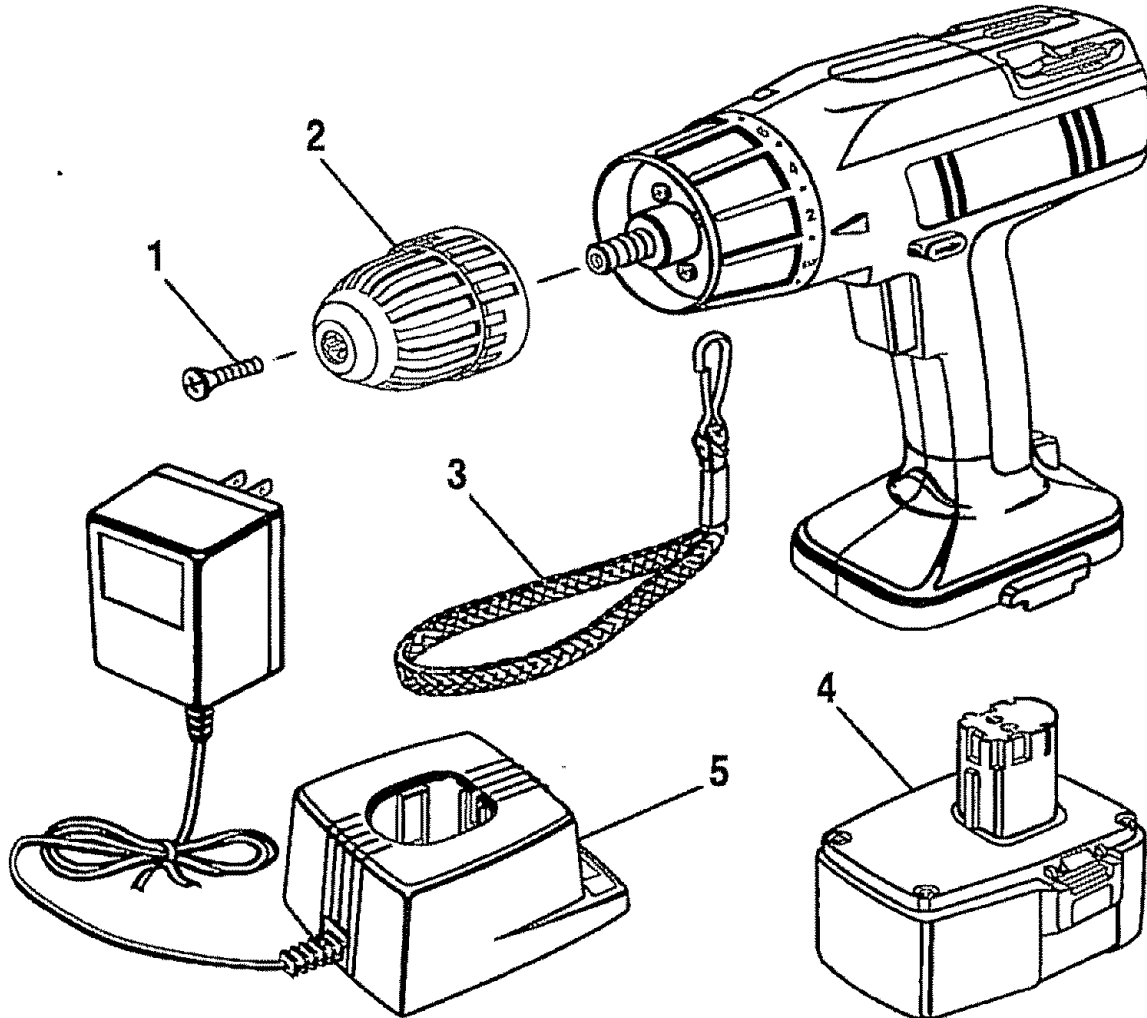

PARTS LIST

Key No.	Part No.	Description	Qty.
1	616478-003	Chuck Screw	1
2	6903302	Chuck	1
3	967216-007	Wrist Strap	1
4	1311444	Battery Pack (*Item No. 9-11004)	1
5	982031-001	Charger with Charging Stand (*Item No. 9-11005)	1
6	982149-001	Carrying Case (Not shown)	1
	983000-092	Operator's Manual	

* Can be purchased through RSOS (Retail Special Order System)

Get it fixed, at your home or ours!

Your Home

For repair—in **your home**—of all major brand appliances, lawn and garden equipment, or heating and cooling systems, **no matter who made it, no matter who sold it!**

For the replacement parts, accessories and owner's manuals that you need to do-it-yourself.

For Sears professional installation of home appliances and items like garage door openers and water heaters.

1-800-4-MY-HOME® (1-800-469-4663)

Call anytime, day or night (U.S.A. and Canada)

www.sears.com www.sears.ca

Our Home

For repair of carry-in items like vacuums, lawn equipment, and electronics, call or go on-line for the location of your nearest **Sears Parts & Repair Center.**

1-800-488-1222

Call anytime, day or night (U.S.A. only)

www.sears.com

To purchase a protection agreement (U.S.A.) or maintenance agreement (Canada) on a product serviced by Sears:

1-800-827-6655 (U.S.A.)

1-800-361-6665 (Canada)

Para pedir servicio de reparación a domicilio, y para ordenar piezas:

1-888-SU-HOGARSM

(1-888-784-6427)

Au Canada pour service en français:

1-800-LE-FOYER^{MC}

(1-800-533-6937)

www.sears.ca

SEARS