

SEARS

CRAFTSMAN®

MODEL NUMBER 917.380330

OWNER'S MANUAL

- Assembly
- Operation
- Maintenance
- Service
- Adjustments
- Repair Parts

Caution:
Read and Follow
all Safety Rules
and Instructions
Before Operating
This Equipment



SEARS, ROEBUCK AND Co., Chicago, IL. 60684 U.S.A.

SAFETY RULES



CAUTION: ALWAYS DISCONNECT SPARK PLUG WIRE AND PLACE WIRE WHERE IT CANNOT CONTACT SPARK PLUG TO PREVENT ACCIDENTAL STARTING WHEN SETTING-UP, TRANSPORTING, ADJUSTING OR MAKING REPAIRS TO YOUR LAWN MOWER.



IMPORTANT

FEDERAL REGULATIONS REQUIRE OPERATOR PRESENCE BLADE STOP CONTROLS TO MINIMIZE THE RISK OF BLADE CONTACT INJURY. YOUR LAWN MOWER IS EQUIPPED WITH SUCH CONTROLS. DO NOT ATTEMPT TO DEFEAT THE FUNCTION OF THE OPERATOR PRESENCE CONTROL UNDER ANY CIRCUMSTANCES.

- BE CAREFUL-WHEN THE ENGINE IS RUNNING THE BLADE IS TURNING.
- Please read your owner's manual. Only allow persons who know the safety rules to use your lawn mower.
- DO NOT tie the operator presence control bar to the handle. Control must be free to permit brake engagement when handles and control are released.
- DO NOT allow children to use your lawn mower.
- Check your lawn mower over before each use. Tighten any loose bolts, nuts, etc.
- Remove all sticks, stones, wires, cans, boards, etc. from area to be mowed. These objects can be thrown by the blade.
- DO NOT allow children, bystanders or pets in the area while mowing.
- Always wear shoes when mowing. DO NOT operate lawn mower when barefoot or wearing open sandals.
- Always wear safety glasses or eye shields before starting your lawn mower and while mowing.
- Always shut off engine before trying to adjust wheel heights.
- When engine is running, DO NOT put hands or feet under lawn mower or in the discharge chute, nor make any adjustments.
- Stay clear of discharge opening at all times.
- Do not fill gas tank when engine is running, when indoors or when engine is hot. Allow engine to cool for several minutes before filling gas tank. Clean off any spilled gasoline before starting engine.
- Mow only in good light.
- Always stop blade when not cutting grass or when crossing gravel drive, sidewalk, or roadway.
- DO NOT continue to run your lawn mower if you hit a foreign object. Stop the engine, disconnect the spark plug wire from the spark plug, inspect the lawn mower for damage and make repairs as required.
- DO NOT use a damaged lawn mower. Always have damage repaired before mowing.
- DO NOT run your lawn mower if it vibrates too much. Stop engine and make repairs. Vibration is an indication of damage.
- Never use your lawn mower without proper guards or deflectors in place.
- Always mow across a slope or inclined area. DO NOT mow up or down a slope or inclined area.
- DO NOT mow in wet grass. Be careful of footing when mowing in wet grass, use shoes with good traction.
- DO NOT run with the lawn mower.
- DO NOT run your lawn mower indoors. Exhaust gases are deadly poison.
- Always disconnect the spark plug wire from spark plug to prevent accidental starting when transporting or storing your lawn mower after the mowing season.
- DO NOT attempt to raise engine speed above factory settings. Engine damage or personal injury may result.
- If a grass catcher is used on your lawn mower, check the catcher often for damage or deterioration. It will wear through normal use. Use only a recommended replacement catcher.
- Always stop blade to remove or install catcher.
- DO NOT store your lawn mower or gasoline where fumes may reach an open flame and cause a fire.
- DRAIN THE GASOLINE from your lawn mower before transporting your lawn mower inside your car or other vehicle.



LOOK FOR THIS SYMBOL TO POINT OUT IMPORTANT SAFETY PRECAUTIONS. IT MEANS-- ATTENTION!!! BECOME ALERT!!! YOUR SAFETY IS INVOLVED.

CONGRATULATIONS on your purchase of a Sears Craftsman Lawn Mower. It has been designed, engineered and manufactured to give you the best possible dependability and performance.

Should you experience any problem you cannot easily remedy, please contact your nearest Sears Service Center/Department. We have competent, well-trained technicians and the proper tools to service or repair this unit.

Please read and retain this manual. The instructions will enable you to assemble and maintain your lawn mower properly. Always observe the "SAFETY RULES".

<p>MODEL NUMBER 917.380330</p> <p>SERIAL NUMBER _____</p> <p>DATE OF PURCHASE _____</p> <p>THE MODEL AND SERIAL NUMBERS WILL BE FOUND ON A DECAL ATTACHED TO THE REAR OF THE LAWN MOWER HOUSING</p> <p>YOU SHOULD RECORD BOTH SERIAL NUMBER AND DATE OF PURCHASE AND KEEP IN A SAFE PLACE FOR FUTURE REFERENCE.</p>

PRODUCT SPECIFICATIONS

HORSE POWER:	4.0
DISPLACEMENT:	10.49 cu. in.
GASOLINE CAPACITY:	1.0 quart (Unleaded)
OIL (21 oz. Capacity): A.P.I. Classification SG/SF/SE	SAE 30 (SAE 10W30)
SPARK PLUG (GAP .030 in.):	Champion RJ19-LM or Sears ⁷¹ 33312 or STD 361458
VALVE CLEARANCE:	Intake: .008 in. Exhaust: .008 in.
SOLID STATE IGNITION AIR GAP:	.0125 in.
BLADE BOLT TORQUE:	35-40 ft.-lbs.

MAINTENANCE AGREEMENT

A Sears Maintenance Agreement is available on this product. Contact your nearest Sears store for details.

CUSTOMER RESPONSIBILITIES

- Read and observe the safety rules.
- Follow a regular schedule in maintaining, caring for and using your lawn mower.
- Follow the instructions under "Maintenance" and "Storage" sections of this Owner's Manual.

TWO YEARS LIMITED WARRANTY ON CRAFTSMAN POWER MOWER

For two years from the date of purchase, when this Craftsman Lawn Mower is maintained, lubricated and tuned-up according to the instructions in the owner's manual, Sears will repair, free of charge, any defect in material and workmanship.

If this Craftsman Lawn Mower is used for commercial or rental purposes, this warranty applies for only 90 days from the date of purchase.

This warranty does not cover:

- Expendable items which become worn during normal use, such as rotary mower blades, blade adapters, belts, air cleaners and spark plug.
- Repairs necessary because of operator abuse or negligence, including bent crankshafts and the failure to maintain the equipment according to the instructions contained in the owner's manual.

WARRANTY SERVICE IS AVAILABLE BY RETURNING THE CRAFTSMAN POWER MOWER TO THE NEAREST SEARS SERVICE CENTER/DEPARTMENT IN THE UNITED STATES. THIS WARRANTY APPLIES ONLY WHILE THIS PRODUCT IS IN USE IN THE UNITED STATES.

This warranty gives you specific legal rights, and you may also have other rights which may vary from state to state.

Sears, Roebuck and Company, D/731CR-W, Sears Tower, Chicago, IL 60684

TABLE OF CONTENTS

SAFETY RULES	2	SERVICE AND ADJUSTMENT	12,13
PRODUCT SPECIFICATIONS	3	STORAGE	14
CUSTOMER RESPONSIBILITIES	3	SERVICE RECOMMENDATIONS	15
WARRANTY	3	REPAIR PARTS-LAWN MOWER	16-17
LAWN MOWER ACCESSORIES	5	REPAIR PARTS-ENGINE	18-21
ASSEMBLY	5	TROUBLE SHOOTING	23
OPERATION	6,7,8,9	PARTS ORDERING/SERVICE	24
MAINTENANCE	10,11		







INDEX

A	H	R	
Adjustments:	Handle:	Repair/Replacement Parts	18-21
Carburetor	Adjustment	Responsibilities, Customer	3
Handle Height	Assembly		
Height of Cut	Knob		
Air Filter:		S	
Replacement		Safety Rules	2
Assembly:	L	Service and Adjustments:	
Handle	Lubrication:	Carburetor	12
Accessories	Discharge Guard Hinge Pin	Handle	13
	Engine	Service Recommendation	15
B	Front Wheel Adjuster	Spark Plug	11
Blade:	Handle Bracket Mounting Pin	Specifications	3
Replacement		Speed Control:	
Sharpening		Engine	7
	M	Starting the Engine	8
C	Maintenance:	Starter Handle	6
Controls:	Agreement	Stopping Your Lawn Mower	8
Engine Zone Control Cable	Air Filter	Storage	14
Operator Presence Control Bar	Blade Care/Replacement		
Engine Speed Control	Engine	T	
Customer Responsibilities	Grass Catcher	Trouble Shooting Chart	23
Cutting Levels	Lubrication		
	Spark Plug		
	Mowing Tips		
E	O	W	
Engine:	Oil:	Warranty	3
Oil Cap	Engine	Wheels:	
Oil Change	Storage	Wheel Adjusters	6,7
Oil Level	Operation:		
Oil Type	Operating Lawn Mower		
Starting	Operator Presence Control Bar		
Storage	Options:		
	Attachments		
F	P		
Fuel:	Parts		18-21
Type			
Storage			

LAWN MOWER ACCESSORIES

These accessories were available when this lawn mower was produced. They are available at most Sears retail outlets, catalog and service centers. Most Sears stores can order repair parts for you, when you provide the model number of your lawn mower.

ENGINE

SPARK PLUG	MUFFLER	AIR FILTER	GAS CAN	ENGINE OIL	STABILIZER
					

LAWN MOWER MAINTENANCE

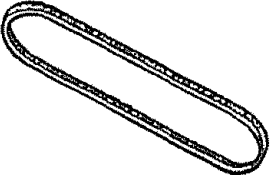
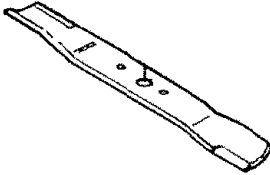
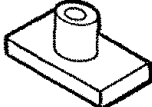
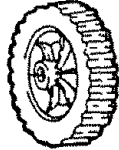
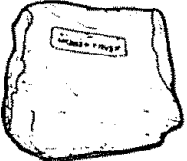
BELT	BLADE	BLADE ADAPTER	WHEELS	LAWN MOWER COVER
				

ASSEMBLY

Your lawn mower has been completely assembled at the factory.

HOW TO SET-UP YOUR LAWN MOWER

TO UNFOLD HANDLE

Remove handle padding holding operator presence control bar to upper handle.

- Hold down operator presence control bar to upper handle to allow handle to move to mowing position.
- Raise handles until lower handle section locks into place in the mowing position (See Fig. 1).
- Raise upper handle section into place on lower handle and tighten one (1) handle knob.
- Release operator presence control bar and tighten remaining handle knob.
- Your lawn mower handle can be adjusted for your mowing comfort. Refer to "ADJUST HANDLE" in the Service and Adjustment section of this manual.

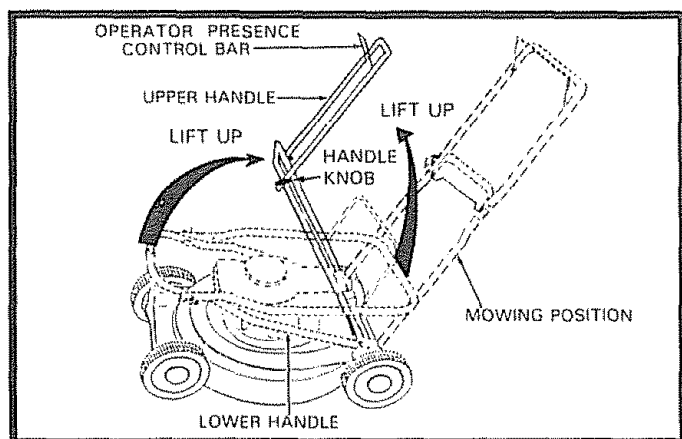

FIG. 1

OPERATION

KNOW YOUR LAWN MOWER

READ THIS OWNER'S MANUAL AND SAFETY RULES BEFORE OPERATING YOUR LAWN MOWER. Compare the illustrations with your Lawn Mower to familiarize yourself with the location of various controls and adjustments. Save this manual for future reference.

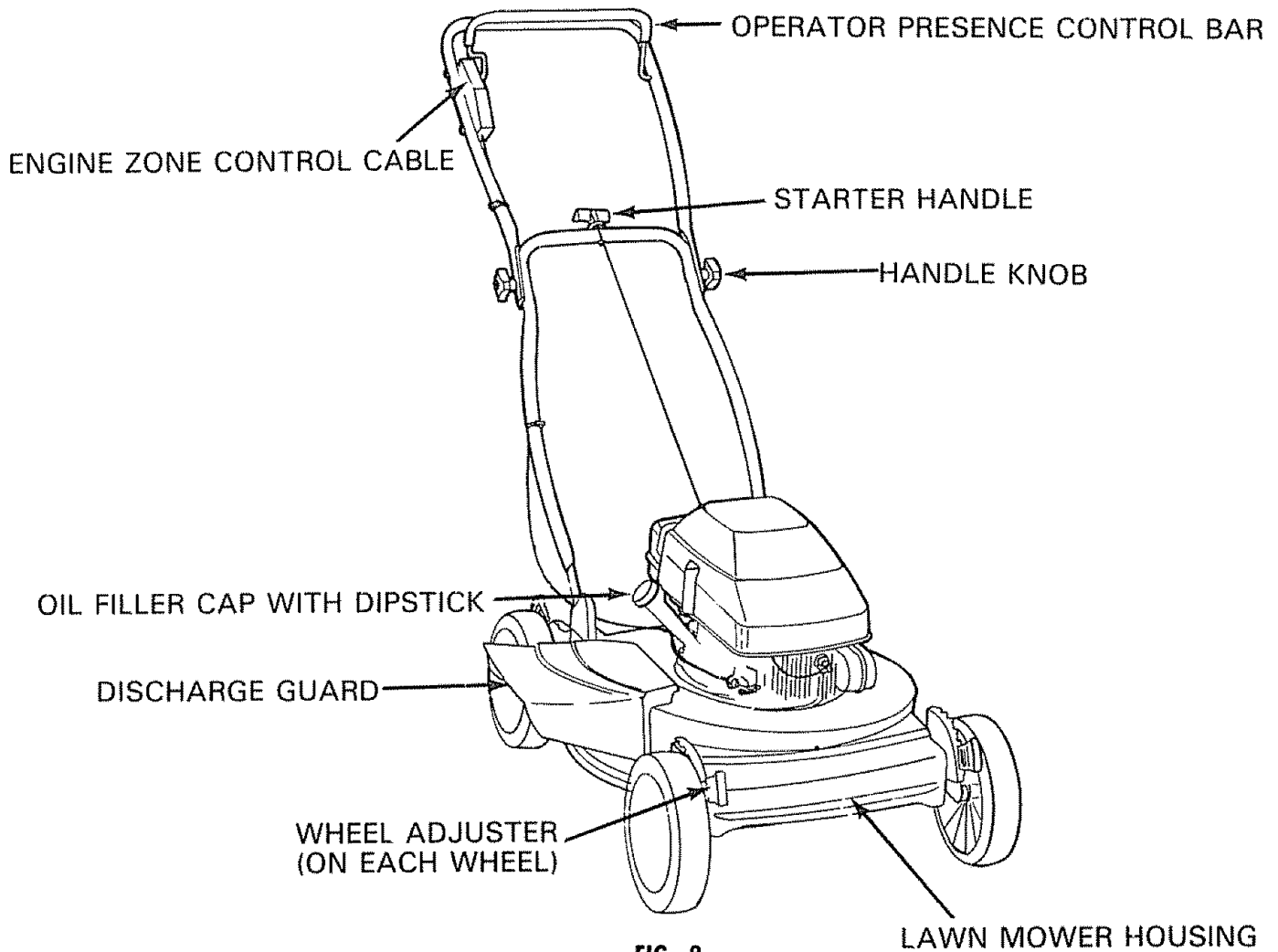

FIG. 2

MEETS CPSC SAFETY REQUIREMENTS

Sears Rotary Walk-Behind Power Lawn Mowers conform to the safety standards of the American National Standards Institute and the U.S. Consumer Product Safety Commission. The blade turns when the engine is running.

OPERATOR PRESENCE CONTROL BAR - must be held down to the handle to start the engine. Release to stop the engine.

ENGINE SPEED CONTROL - located on the left side of the engine which allows you to select either "HIGH" or "LOW" engine speed.

PRIMER - pumps additional fuel from the carburetor to the cylinder for use when starting a cold engine.

STARTER HANDLE - used for starting the engine.

OPERATION

HOW TO USE YOUR LAWN MOWER

ENGINE SPEED CONTROL

The engine speed is controlled by a lever (red knob) located on the left side of the engine. "HIGH" position is for starting engine, normal cutting and better grass bagging. "LOW" position is for light cutting, trimming and fuel economy (See Fig. 3).

IMPORTANT

ENGINE ZONE CONTROL



CAUTION: THE BLADE TURNS WHEN THE ENGINE IS RUNNING.

- Your lawn mower is equipped with an operator zone engine control which requires the operator to be positioned behind the lawn mower handle to start and operate the lawn mower.



CAUTION: FEDERAL REGULATIONS REQUIRE THE ENGINE CONTROL INSTALLED ON THIS LAWN MOWER IN ORDER TO MINIMIZE THE RISK OF BLADE CONTACT INJURY. DO NOT UNDER ANY CIRCUMSTANCES ATTEMPT TO DEFEAT THE FUNCTION OF THE OPERATOR CONTROL.

TO ADJUST CUTTING HEIGHT



CAUTION: DISCONNECT SPARK PLUG WIRE FROM SPARK PLUG AND PLACE WIRE WHERE IT CANNOT COME IN CONTACT WITH THE SPARK PLUG.

- Raise wheels for low cut and lower wheels for high cut.
- Wheels are set in a low cut for shipping. Adjust cutting height to suit your requirements. Medium position is best for most lawns.
- To change cutting height, squeeze adjuster lever toward wheel. Move wheel up or down to suit your requirements. Be sure all wheels are in the same setting (See Fig. 4).

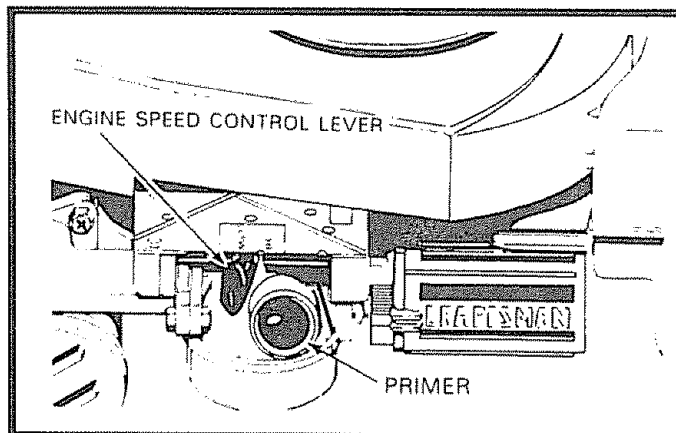

FIG. 3

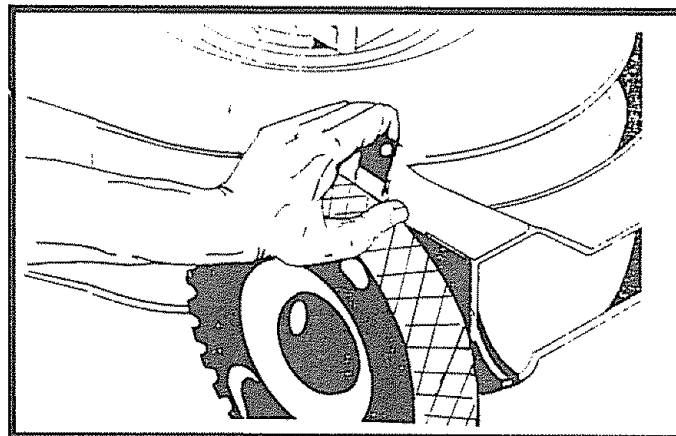

FIG. 4

OPERATION

BEFORE STARTING ENGINE

OIL:

- Remove engine oil cap with dipstick (See Fig. 5) and fill to the FULL line on the dipstick.
- Use one (1) pint or 0.5 liters of SAE 30 oil or equivalent. SAE 10W 30 oil can also be used. DO NOT use SAE 10W 40 oil.

NOTE: A 20 oz. bottle of Pennzoil SAE 30 Oil is included with your new lawn mower.

- POUR OIL SLOWLY. DO NOT OVERFILL.
- The total oil capacity of your engine is 21 oz. or 0.62 liters.
- To read proper level, tighten engine oil cap each time.
- Replace engine oil cap with dipstick and tighten.
- Check oil level before each use. Add oil if needed. Fill to FULL line on dipstick.
- The oil you use should meet A.P.I. Classification SG/SF/SE.

NOTE: After the first two (2) hours of mowing, change the oil, and every 25 hours thereafter. You may need to change the oil more often under dusty, dirty conditions.

GAS:

- Fill gasoline tank with fresh, clean unleaded gasoline. DO NOT USE PREMIUM GASOLINE. BE CAREFUL NOT TO OVERFILL TANK (SEE FIG. 5).

WARNING: Experience indicates that alcohol blended fuels (called gasohol or using ethanol or methanol) can attract moisture which leads to separation and formation of acids during storage. Acidic gas can damage the fuel system of an engine while in storage. To avoid engine problems, the fuel system should be emptied before storage for 30 days or longer. Drain the gas tank, start the engine and let it run until the fuel lines and carburetor are empty. Use fresh fuel next season. See Storage Instructions for additional information.

Never use engine or carburetor cleaner products in the fuel tank or permanent damage may occur.

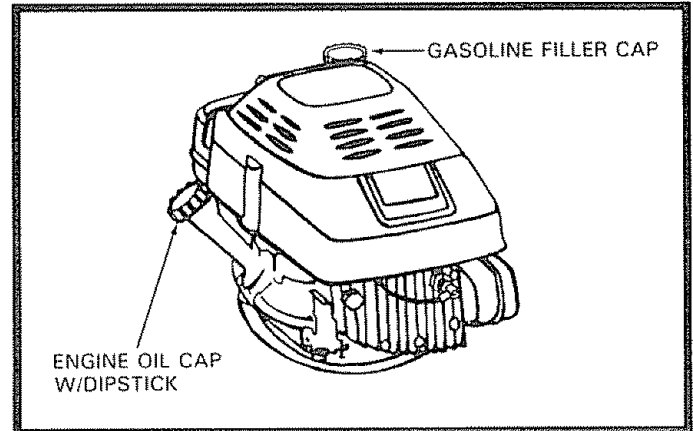

FIG. 5

TO START ENGINE

- To start a cold engine, push primer five (5) times before trying to start. Use a firm push. This step is not usually necessary when starting an engine which has already run for a few minutes.
- Push engine speed control lever forward to HIGH position.
- Hold operator presence control bar down to the handle and pull starter handle quickly. Do not allow starter rope to snap back.
- To STOP engine, release operator presence control bar.

NOTE: In cooler weather it may be necessary to repeat priming steps. In warmer weather over priming may cause flooding and engine will not start. If you do flood engine wait a few minutes before attempting to start and DO NOT repeat priming steps.

OPERATION

MOWING TIPS

- Under certain conditions, such as very tall grass, it may be necessary to raise the height of cut to reduce pushing effort and to keep from overloading the engine and leaving clumps of grass clippings.
- For extremely heavy cutting, reduce the width of cut and raise the rear of the lawn mower housing one (1) wheel adjuster setting higher than the front for better discharge of grass.
- For better grass bagging and most cutting conditions, the engine speed should be set in the "HIGH" (FAST) position.
- When using a rear discharge lawn mower in moist, heavy grass, clumps of cut grass may not enter the grass catcher. Reduce ground speed (pushing speed) and/or run the lawn mower over the area a second time.
- If a trail of grass clippings is left on the right side of a rear discharge lawn mower, mow in a clockwise direction with a small overlap to collect the clippings on the next pass.
- For side discharge lawn mowers, cutting in a counter-clockwise direction, starting at the outside of the area to be cut, spreads grass clippings more evenly and puts less load on the engine. To keep clippings off of walkways, flower beds, etc., make the first cuts in a clockwise direction.
- Pores in cloth grass catchers can become filled with dirt and dust with use and catchers will collect less grass. To prevent this, regularly hose catcher off with water and let dry before using.
- The vent holes in the baffle in back of a permanex catcher can become filled with dirt and dust with use and the catcher will collect less grass. To prevent this, regularly hose the catcher baffle with water and let dry before using.
- Keep top of engine around starter clear and clean of grass clippings and chaff. This will help engine air flow and extend engine life.

MAINTENANCE

GENERAL RECOMMENDATION

- Once a year you should replace the spark plug, air filter and check blade for wear. A new spark plug and air filter assures proper air-fuel mixture and helps your engine run better and last longer.
- You should check all fasteners and be sure they are tight.
- Follow the Service Recommendation Schedule on page 15.

LAWN MOWER

BLADE/BLADE ADAPTER CARE

Your lawn mower will work better with a sharp blade.



CAUTION: DISCONNECT SPARK PLUG WIRE FROM SPARK PLUG AND PLACE WIRE WHERE IT CANNOT COME IN CONTACT WITH THE SPARK PLUG.

TO REMOVE BLADE:

- Turn lawn mower on its side. Make sure air filter and carburetor are up.
- Use block of wood between blade and lawn mower housing to prevent blade from turning when removing the blade bolt.
- Protect your hands with gloves and/or wrap blade with heavy cloth.
- Remove blade bolt by turning counter-clockwise. Use a 9/16" box or open-end wrench.
- Remove blade and attaching hardware (bolt, lockwasher and hardened washer) (See Fig. 6).

NOTE: Remove the blade adapter and check the key inside hub of blade adapter. The key must be in good condition to work properly. Replace adapter if damaged.

TO REPLACE BLADE:

- Position the blade adapter on the engine crankshaft. Be sure key in adapter and key way in crankshaft are aligned.
- Position blade on to the blade adapter aligning the two (2) holes in the blade with the raised lugs on the adapter.

NOTE: Be sure the word TOP (stamped on the blade) is toward the engine (See Fig. 6).

- Install the blade bolt with the lockwasher and hardened washer into blade adapter and crankshaft (See Fig. 6).

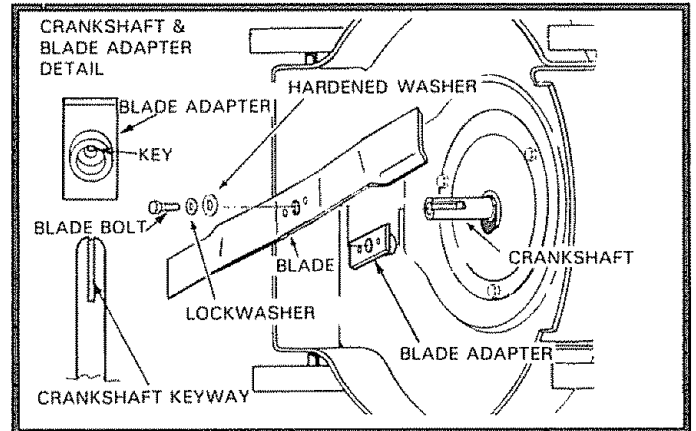

FIG. 6

- Use block of wood between blade and lawn mower housing and tighten the blade bolt, turning clockwise.
- The recommended tightening torque is 35-40 ft. lbs.
- Torque wrenches are available at most Sears stores and through the catalog.



CAUTION: A LOOSE BLADE CAN BE DANGEROUS AND MAY MAKE THE ENGINE HARD TO START.

Use only a Sears authorized replacement blade to get the best cutting results.

NOTE: We do not recommend sharpening blade - but if you do, be sure the blade is balanced.

TO SHARPEN BLADE:

- The blade can be sharpened with a file or on a grinding wheel. Do not attempt to sharpen while on the lawn mower.
- Care should be taken to keep the blade balanced. An unbalanced blade will cause excessive vibration when running and eventual damage to lawn mower or engine.
- To check blade balance, drive a nail into a beam or wall. Leave about one inch of the straight nail exposed. Place center hole of blade over the head of the nail. If blade is balanced, it should remain in a horizontal position. If either end of the blade moves downward, blade is not balanced. Sharpen the heavy end until the blade is balanced.

MAINTENANCE

GRASS CATCHER

(If Purchased As An Accessory)

Check your grass catcher often for damage or deterioration. Through normal use it will wear. If catcher needs replacing, replace only with a manufacturer approved replacement catcher from Sears. Give the lawn mower model number when ordering.

NOTE: The catcher may be hosed with water, but must be dry when used.

ENGINE

TO CHANGE OIL



CAUTION: DISCONNECT SPARK PLUG WIRE FROM SPARK PLUG AND PLACE WIRE WHERE IT CANNOT COME IN CONTACT WITH SPARK PLUG.

- Remove the drain plug from bottom of engine, (See Fig. 7). Warm oil drains better.
- Drain oil.
- Put oil drain plug back and tighten.
- Remove engine oil cap with dipstick and fill engine with oil. Fill only to the "FULL" line on the dipstick. DO NOT overfill.

NOTE: Use SAE30 or 10W30 oil which meets A.P.I. Classification SG/SF/SE.

- Replace engine oil cap with dipstick.
- Reconnect spark plug wire to spark plug.

AIR FILTER

Your engine will not run properly and may be damaged by using a dirty air filter.

Replace the air filter every year, more often if you mow in very dusty, dirty conditions. Do not wash air filter.

TO CHANGE AIR FILTER

- Remove the air filter cover by turning counter-clockwise to the stop and pull away from collar (See Fig. 8).
- Remove filter from inside of cover (See Fig. 8).
- Clean the inside of the cover and the collar to remove any dirt accumulation.
- Insert new filter into cover.
- Put air filter cover and filter into collar aligning the tab with the slot.
- Push in on cover and turn clockwise to tighten (See Fig. 8).

SPARK PLUG

Change your spark plug each year to make your engine start easier and run better. Set spark plug gap at .030 inch.

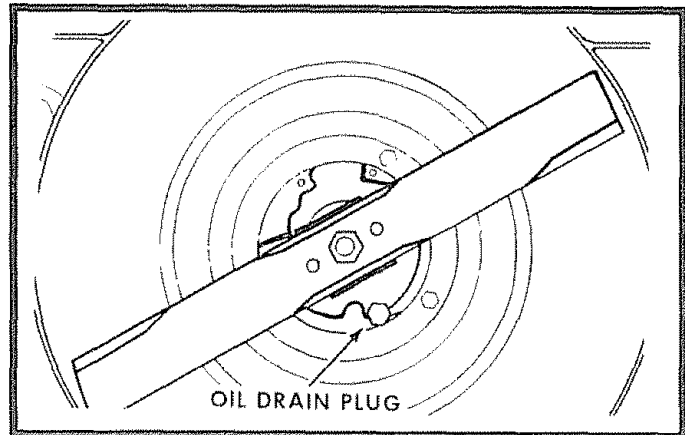

FIG. 7

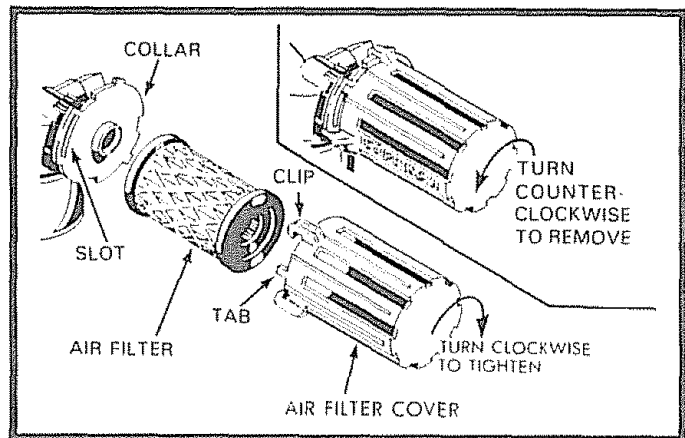

FIG. 8

CLEANING



CAUTION: DISCONNECT SPARK PLUG WIRE FROM SPARK PLUG AND PLACE WIRE WHERE IT CANNOT COME IN CONTACT WITH SPARK PLUG.

- Turn lawn mower on its side with carburetor up.
- Clean the underside of your lawn mower by scraping to remove build-up of grass and trash.

NOTE: We recommend that you clean the underside of your lawn mower after each use.

- Clean your lawn mower and engine often to keep trash from accumulating around engine. A clogged engine runs hotter and shortens engine life.

NOTE: We DO NOT recommend using a garden hose to clean lawn mower unless the electrical system, muffler, air filter, and carburetor are covered to keep water out. Water in engine can result in shortening engine life.

SERVICE AND ADJUSTMENT

CARBURETOR

Your carburetor has a non-adjustable fixed main jet for mixture control. If your engine does not operate properly due to suspected carburetor problems, take your lawn mower to an authorized Sears Service Center for repair and adjustment.

ENGINE SPEED

Your engine speed has been factory set. Do not attempt to increase engine speed or it may result in personal injury. If you believe that engine is running too fast or too slow, take your lawn mower to an authorized Sears Service Center for repair and adjustment.

DISCHARGE GUARD

The discharge guard, attached to the discharge opening of your lawn mower, is provided to prevent the possibility of injury resulting from objects being thrown out of the discharge opening into the operator mowing position.

If the discharge guard becomes damaged, it should be replaced.



CAUTION: DO NOT RUN YOUR LAWN MOWER WITHOUT DISCHARGE GUARD OR APPROVED GRASS CATCHER IN PLACE.

REAR DEFLECTOR

The rear deflector, attached between the rear wheels of your lawn mower, is provided to minimize the possibility that objects will be thrown out the rear of the lawn mower into the operator's mowing position.

If the rear deflector becomes damaged, it should be replaced.

SERVICE AND ADJUSTMENT

TO ADJUST HANDLE

Your lawn mower handle can be raised or lowered for your mowing comfort. Figs. 9A, 9B, 10A and 10B show the four (4) positions that are available: High, medium high, medium low and low. Handles are shipped mounted in the medium low position (See Fig. 9A)

- To change from medium low to medium high position, the upper and lower handle sections will have to be turned over (See Fig. 9B).
- Remove the cable clips.
- Remove the controls and operator presence control bar from the upper handle.
- Remove the starter rope guide from the lower handle.
- Remove hairpin cotters.
- Disconnect the lower handle from the handle brackets (See Fig. 11).
- Turn the handle over and reassemble the hairpin cotters that have been removed (See Fig. 11).
- Reassemble the starter rope guide.
- Reassemble the controls and the operator presence control bar to the upper handle.
- Replace the cable clips previously removed (See Fig. 2, Page 6).

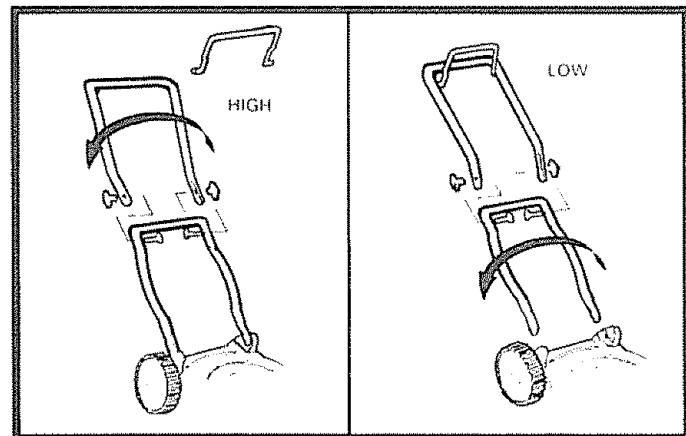
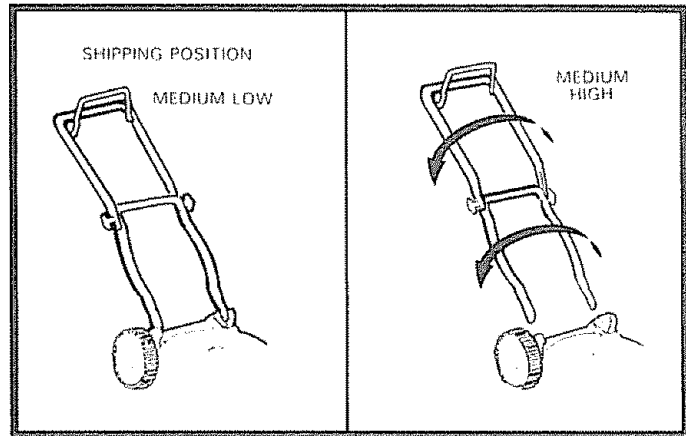

CAUTION: THE OPERATOR PRESENCE CONTROL BAR MUST PIVOT FREELY TO PERMIT BLADE BRAKE ENGAGEMENT WHEN CONTROL BAR IS RELEASED. DO NOT OVERTIGHTEN THE FASTENERS HOLDING THE CONTROLS TO THE UPPER HANDLE.

- To change from medium low to high position only the upper handle section will have to be turned over (See Fig. 10A).
- To change from medium low to low position, only the lower handle section will have to be turned over (See Fig. 10B).

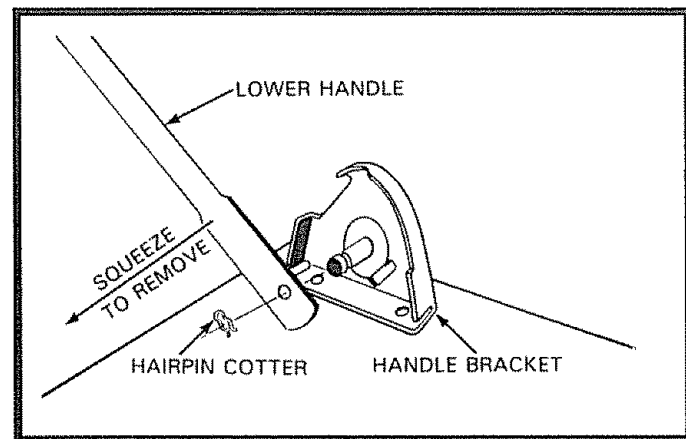

STORAGE

Your lawn mower and engine should be prepared for off-season storage as follows:

LAWN MOWER

- Clean underside of lawn mower housing. (See "Cleaning" in maintenance section of manual.)
- Inspect and replace/sharpen blade, if required (See "Blade/Blade Adapter Care" in maintenance section of manual).
- Lubricate as shown in Service Recommendation chart on page 15 of manual.
- Hose grass catcher off with water and let dry before storing. (If purchased as an accessory).

HANDLE

- You can fold your lawn mower handle for storage as shown in Fig. 12.
- To fold, squeeze the bottom ends of the lower handle toward each other until the lower handle clears the handle bracket, then move handle forward (See Fig. 13).

IMPORTANT: WHEN FOLDING THE HANDLE FOR STORAGE OR TRANSPORTATION, BE SURE TO FOLD THE HANDLE AS SHOWN IN FIG. 12. IF YOU FOLD THE UPPER HANDLE SECTION THE WRONG WAY, YOU MAY DAMAGE THE CONTROL CABLES.

ENGINE

- Change oil (See "To Change Oil" in maintenance section of manual).
- Drain Fuel and Run Engine until fuel system is empty.

IMPORTANT: IT IS IMPORTANT TO PREVENT GUM DEPOSITS FROM FORMING IN ESSENTIAL FUEL SYSTEM PARTS SUCH AS THE CARBURETOR, FUEL FILTER, FUEL HOSE, OR TANK DURING STORAGE. ALSO, EXPERIENCE INDICATES THAT ALCOHOL BLENDED FUELS (CALLED GASOLINOL OR USING ETHANOL OR METHANOL) CAN ATTRACT MOISTURE WHICH LEADS TO SEPARATION AND FORMATION OF ACIDS DURING STORAGE. ACIDIC GAS CAN DAMAGE THE FUEL SYSTEM OF AN ENGINE WHILE IN STORAGE.

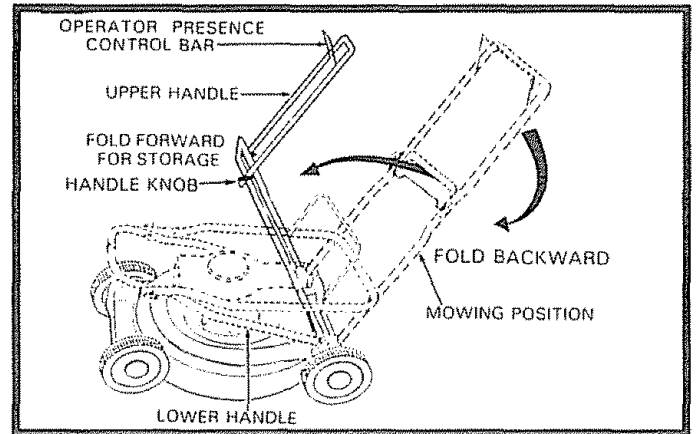

FIG. 12

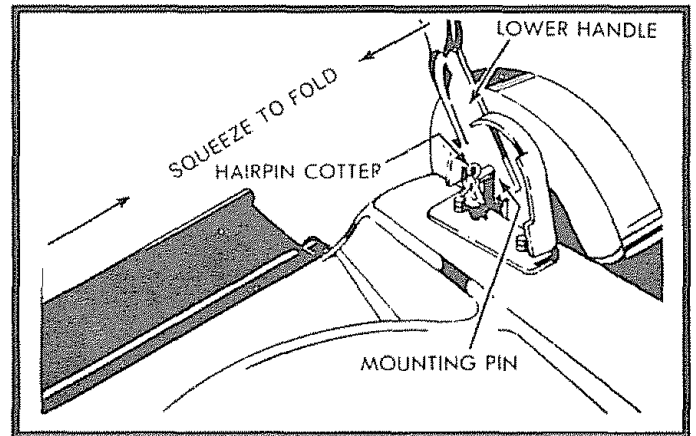

FIG. 13

OTHER

- Do not store gasoline from one season to another.
- Replace your gasoline can if your can starts to rust. Rust and/or dirt in your gasoline can cause problems.
- Do not store your lawn mower under any plastic cover. Plastic cannot breathe which allows condensation to form and can cause your lawn mower to rust.
- When setting up your handle from the storage position, the lower handle will automatically lock into the mowing position.

SERVICE RECOMMENDATIONS

SERVICE RECORD Fill in dates as you complete regular service	SCHEDULE					SERVICE DATES		
	First 2 Hours	Every 10 Hours	Every 25 Hours	Every 50 Hours	Every Use			
Blades Sharpened		✓						
Blades Replaced			✓					
Engine Oil Change	✓		✓					
Engine Oil Check					✓			
Air Cleaner			✓					
Spark Plug Replaced			✓					
Lubricate Lawn Mower			✓					
Cleaning					✓			
Grass Catcher (if applicable)			✓					
Muffler			✓					

✓ - CHECK

LUBRICATION CHART

① SAE 30 MOTOR OIL (10W 30)

② SPRAY LUBRICANT

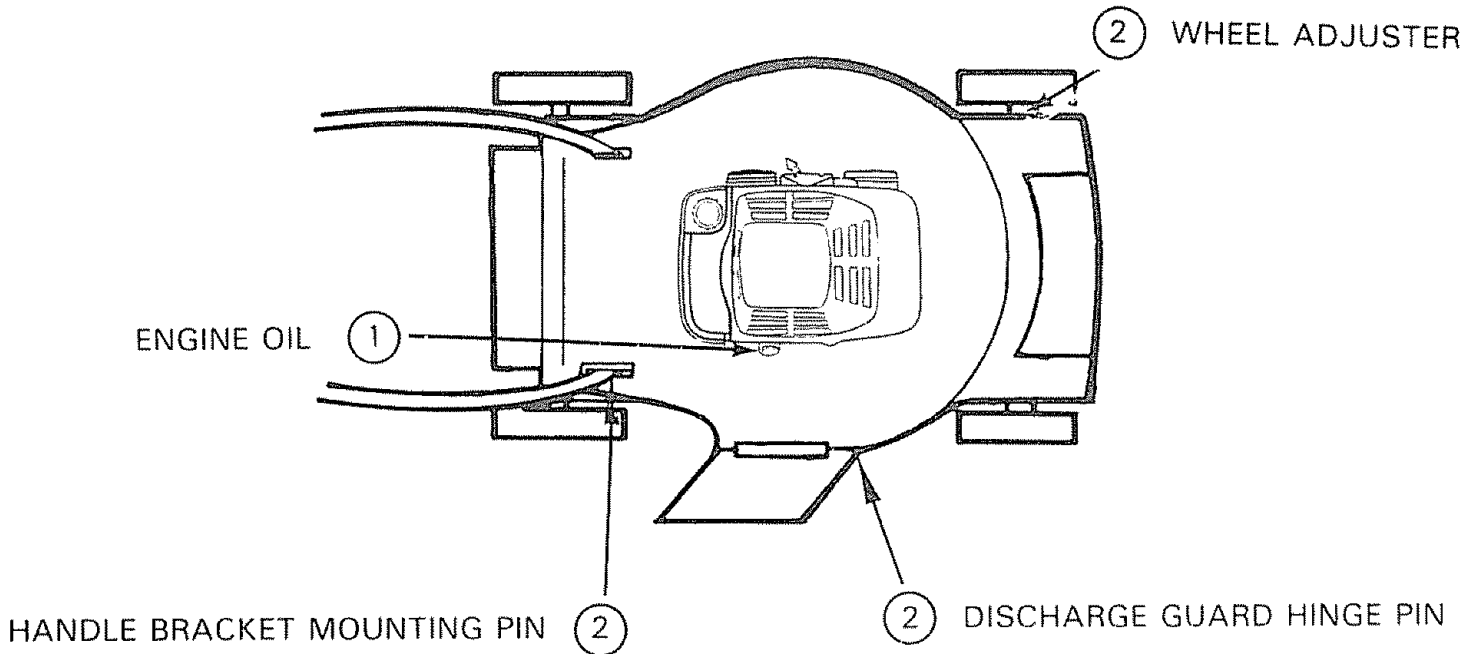

CRAFTSMAN 20" ROTARY LAWN MOWER MODEL NO. 917.380330

REPAIR PARTS
Rev. 0

16

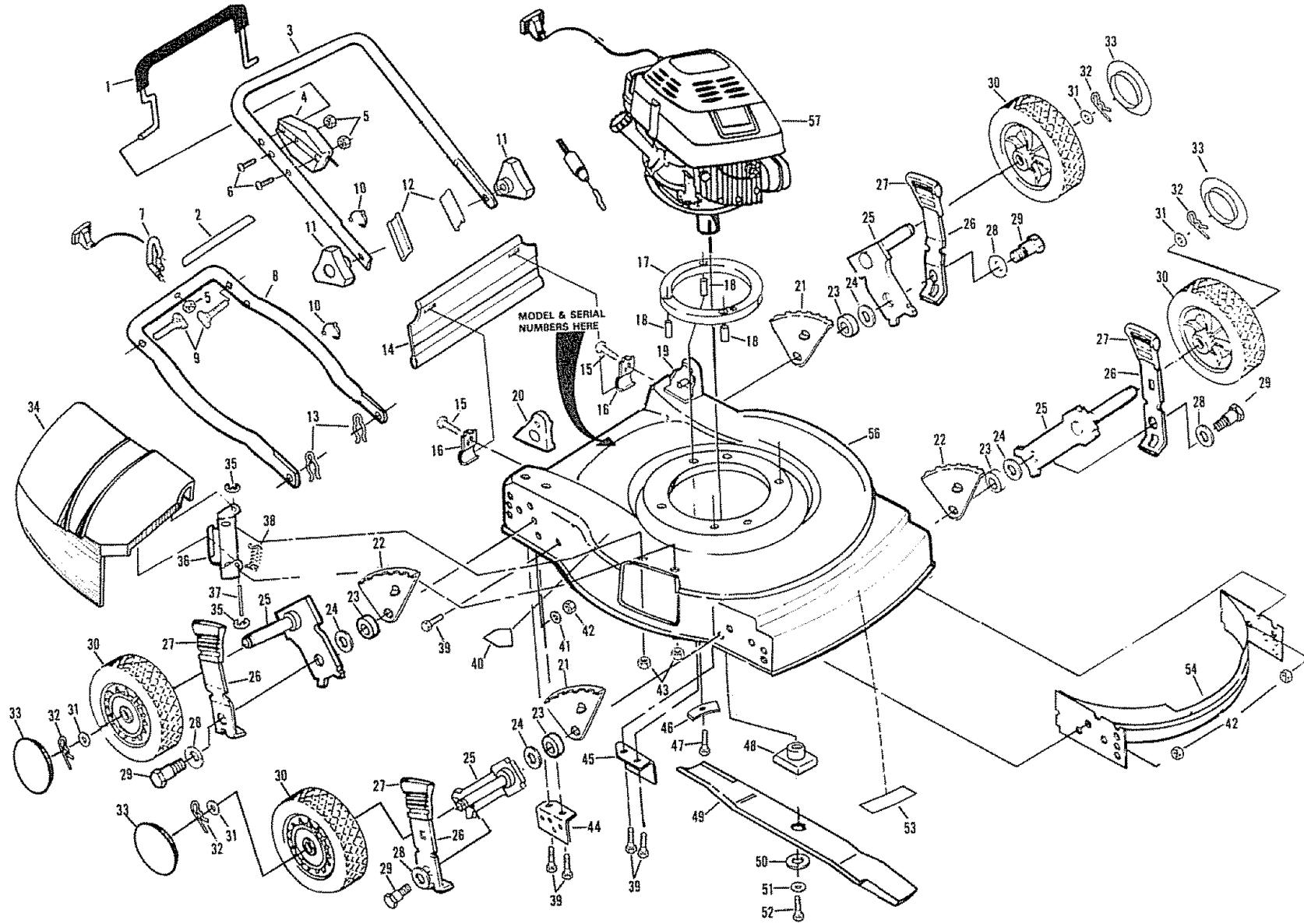

CRAFTSMAN 20" ROTARY LAWN MOWER MODEL NO. 917.380330

REPAIR PARTS

Rev. 0

Ref. No.	Part No.	Part Name	Ref. No.	Part No.	Part Name
1	86817	Control Bar	30	750507	Wheel & Tire Assembly 8.0 x 1 3/4
2	750627	Instruction Decal (Engine)	31	52160	Washer
3	850990	Upper Handle	32	85179	Retainer Clip
4	750508	Engine Zone Control Cable	33	800545	Hubcap
5	STD541425	Locknut 1/4-20	34	750149	Discharge Guard
6	85692	Pan Head Machine Screw 1/4-20 x 2 3/16	35	STD581025	E-Ring
7	103672X	Rope Guide	36	87592	Housing Bracket
8	800481	Lower Handle	37	87590	Hinge Rod
9	58714	Handle Bolt 5/16-18 x 1 3/4	38	87589	Torsion Spring
10	85827	Cable Clip	39	55187	Thread Cutting Screw 5/16-18 x 3/4
11	87692	Handle Knob	40	85463	Danger Decal
12	700148	Handle Pad	41	61537	Washer
13	51793	Hairpin Cotter	42	STD541437	Locknut 3/8-16
14	751228	Rear Skirt	43	STD541425	Locknut 1/4-20
15	81276	Hex Washer Head Tapping Screw 10-24 x 1/2	44	88394	Handle Bracket Support (Right)
16	87585	Skirt Bracket	45	88393	Handle Bracket Support (Left)
17	850988	Engine Spacer	46	STD551037	Washer
18	850987	Engine Bushing	47	850999	Hex Head Screw 3/8-16 x 2
19	85664	Handle Bracket Assembly (Left)	48	851514	Blade Adapter
20	85663	Handle Bracket Assembly (Right)	49	850972	20" Blade
21	86931	Wheel Adjusting Bracket (R.F.,L.R.)	50	851074	Hardened Washer
22	86933	Wheel Adjusting Bracket (L.F.,R.R.)	51	850263	Helical Lockwasher 3/8
23	84920	Spacer	52	851084	Hex Head Screw 3/8-24 x 1 3/8 Grd. 8
24	88348	Washer	53	750509	Housing Spec Decal
25	87887	Axle Arm Assembly	54	88374	Front Baffle
26	850863	Selector Spring	55	88375	Rear Baffle (Not Shown)
27	77865	Selector Knob	56	48216	Lawn Mower Housing (Incl. Ref. #40,54 & 55)
28	62335	Belleville Washer	57	750505	Engine - Craftsman (Source 143) Model No. 143.404082 (See Pages 18-21)
29	84921	Shoulder Bolt 3/8-16		750510	Owner's Manual

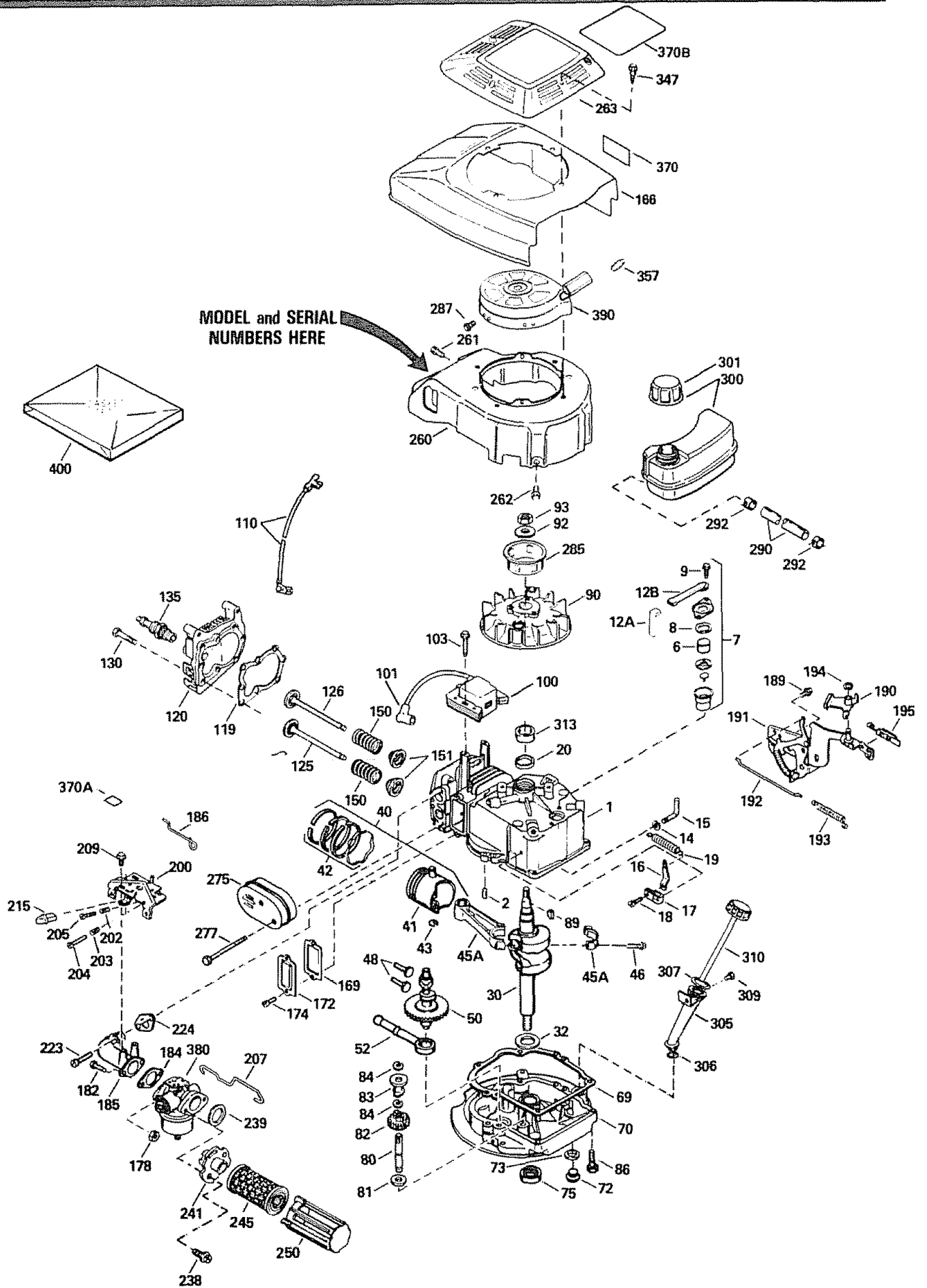

CRAFTSMAN 4-CYCLE ENGINE

MODEL: 143.404082

Ref. No.	Part No.	Part Name	Ref. No.	Part No.	Part Name
1	35010	Cylinder Assy (Incl. Nos. 2 & 20)	135	35395	Spark Plug, Resistor (Champion RJ-19LM or equivalent)
2	26727	Pin, Dowel	150	31672	Spring, Valve
6	33734	Element, Breather	151	31673	Cap, Lower valve spring
7	34214A	Breather Assy. (Incl. Nos. 6, 8, 9, 12A & 12B)	166	35827	Shroud
8	*33735	Gasket, Breather	169	*27234A	Gasket, Valve spring box
9	30200	Screw, Hex washer hd. self-tap Sems, 10-24 x 9/16	172	32755	Cover, Valve spring box
12A	34695	Elbow, Breather tube	174	650128	Screw, Hex hd Sems, 10-24 x 1/2
12B	33886	Tube, Breather	178	29752	Nut & Lockwasher, 1/4-28
14	28277	Washer, Flat	182	6201	Screw, Hex hd , 1/4-28 x 7/8
15	30589	Rod, Governor (Incl. No. 14)	184	*26756	Gasket, Carburetor
16	31383A	Lever, Governor	185	31384A	Pipe, Intake (incl. No 224)
17	31335	Clamp, Governor lever	186	34337	Link, Governor spring
18	650548	Screw, Hex washer hd. , 8-32 x 5/16	189	650839	Screw, Hex washer hd. Powerlok. 1/4-20 x 3/8
19	31361	Spring, Extension	190	34968	Lever, Brake
20	32600	Seal, Oil	191	35039	Bracket, S.E Brake
30	35839	Crankshaft Assy.	192	34966	Link, Control
32	32323	Washer, Thrust	193	34965	Spring, Extension
40	35544	Piston, Pin & Ring Assy. (Std.) (Incl. Nos. 41, 42 & 43)	194	32309	Ring, Retaining
40	35545	Piston, Pin & Ring Assy. (.010 oversize) (Incl. Nos. 41, 42 & 43)	195	610973	Terminal Assy
40	35546	Piston, Pin & Ring Assy (.020 oversize) (Incl. Nos. 41, 42 & 43)	200	35727	Bracket Assy , Control (Incl. Nos 202 thru 205)
41	35541	Piston & Pin Assy. (Std.) (Incl. No. 43)	202	33802	Spring, Compression
41	35542	Piston & Pin Assy. (.010 oversize) (Incl. No. 43)	203	31342	Spring, Compression
41	35543	Piston & Pin Assy. (.020 oversize) (Incl. No. 43)	204	650549	Screw, Fil hd , 5-40 x 7/16
42	35547	Ring Set, Piston (Std.)	205	650777	Screw, Fil hd , 6-32 x 21/32
42	35548	Ring Set, Piston (.010 oversize)	207	34336	Link, Throttle
42	35549	Ring Set, Piston (.020 oversize)	209	30200	Screw, Hex washer hd self-tap Sems, 10-24 x 9/16
43	20381	Ring, Piston pin retaining	215	35511	Knob, Control
45A	32875	Rod Assy., Connecting (Incl. No 46)	223	650451	Screw, Hex hd Sems, 1/4-20 x 1
46	32610A	Bolt, Connecting rod	224	*34690A	Gasket, Intake pipe
48	27241	Valve, Lifter	238	*34338	Gasket, Air cleaner
50	33148A	Camshaft (Compression Release)	239	650932	Screw, Hex washer hd. shoulder. 10-32 x 49/64
52	29914	Pump Assy., Oil	241	35797	Collar, Air cleaner
69	*35261	Gasket, Mounting flange	245	35066	Filter, Air cleaner (Paper)
70	35810	Flange, Mounting (Incl. Nos. 72, 73, 75 & 80)	250	35065	Cover, Air cleaner
72	30572	Plug, Oil drain (Incl. No. 73)	260	35826	Housing, Blower
73	*28833	Gasket, Oil plug (Not required with plastic oil plug)	261	30200	Screw, Hex washer hd. self-tap Sems. 10-24 x 9/16
75	27897	Seal, Oil	262	650831	Screw, Hex washer hd Powerlok thread, 1/4-20 x 15/32
80	30574	Shaft, Governor	263	35821	Grill, Shroud
81	35479	Washer, Flat	275	34613	Muffler Assy
82	30591	Gear Assy., Governor (Incl. No. 81)	277	650795	Screw, Hex hd . 1/4-20 x 2-1-4
83	30588A	Spool, Governor	285	35000	Hub, Starter
84	29193	Ring, Retaining	287	650884	Screw, Hex washer hd , 8-32 x 1 2
86	650488	Screw, Hex hd. Sems, 1/4-20 x 1-1/4	290	34357	Line, Fuel
89	611004	Key, Flywheel	292	26460	Clamp, Fuel line
90	611112	Flywheel	300	35586	Tank Assy (Incl. Nos. 292 & 301)
92	650815	Washer, Belleville	301	35355	Cap, Fuel
93	650816	Nut, Flywheel	305	35819	Tube, Oil fill
100	34443A	Solid State Assy.	306	34265	Gasket, Fill tube
101	610118	Cover, Spark plug	307	35499	"O" Ring
103	650814	Screw, Torx hex washer hd. Sems, 10-24 x 1	309	650562	Screw, Hex washer hd shakeproof, 10-32 x 1/2
110	34961	Wire, Ground			
119	*33015A	Gasket, Cylinder head			
120	34342	Head, Cylinder			
125	29313C	Valve, Exhaust (Std.) (Incl. No. 151)			
125	29315C	Valve, Exhaust (1/32" oversize) (Incl. No. 151)			
126	29314B	Valve, Intake (Std.) (Incl. No. 151)			
126	29315C	Valve, Intake (1/32" oversize) (Incl. No. 151)			
130	6021A	Screw, Hex flange hd , 5/16-18 x 1-1/2			

*Indicates Parts Included in Gasket Set, Ref. No 400

CRAFTSMAN 4-CYCLE ENGINE

MODEL: 143.404082

Ref. No.	Part No.	Part Name	Ref. No.	Part No.	Part Name
310	35822	Dipstick, Oil fill	400	33238D	Gasket Set (Incl. items marked *) RPM Setting: Low Speed: 2050 High Speed: 3000 *Indicates Parts Included in Gasket Set, Ref No 400
313	34080	Spacer, Flywheel key			
347	650898	Screw, Hex washer hd. shoulder, 10-32 x 27/32			
357	34985	Retainer, Starter rope			
370	35847	Decal, Instruction			
370A	35167	Decal, Throttle			
370B	35841	Decal, Name			
380	632569	Carburetor (Incl. No 184)			
390	590637	Starter, Rewind			

CARBURETOR NO. 632569

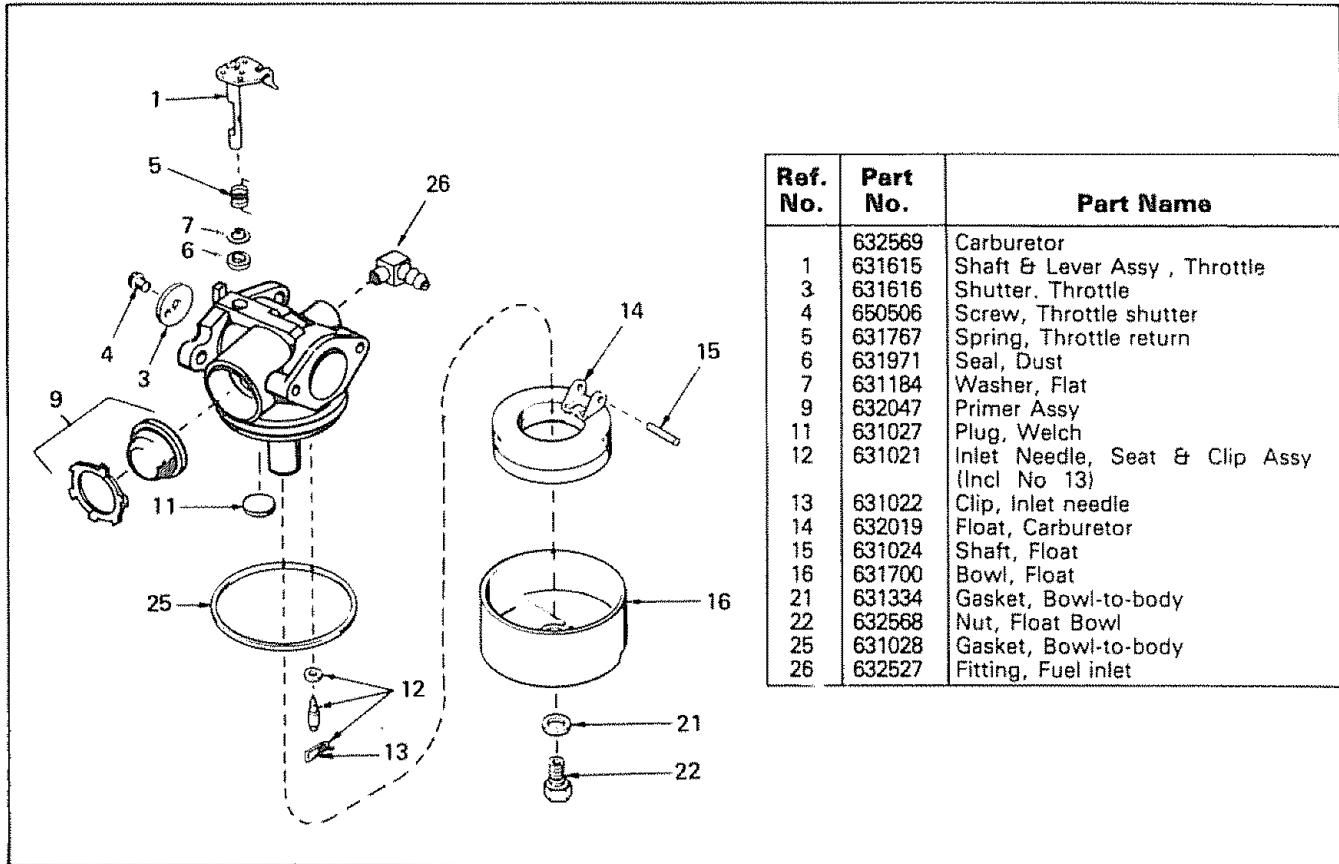

Ref. No.	Part No.	Part Name
	632569	Carburetor
1	631615	Shaft & Lever Assy , Throttle
3	631616	Shutter, Throttle
4	650506	Screw, Throttle shutter
5	631767	Spring, Throttle return
6	631971	Seal, Dust
7	631184	Washer, Flat
9	632047	Primer Assy
11	631027	Plug, Welch
12	631021	Inlet Needle, Seat & Clip Assy (Incl No 13)
13	631022	Clip, Inlet needle
14	632019	Float, Carburetor
15	631024	Shaft, Float
16	631700	Bowl, Float
21	631334	Gasket, Bowl-to-body
22	632568	Nut, Float Bowl
25	631028	Gasket, Bowl-to-body
26	632527	Fitting, Fuel inlet

REWIND STARTER NO. 590637

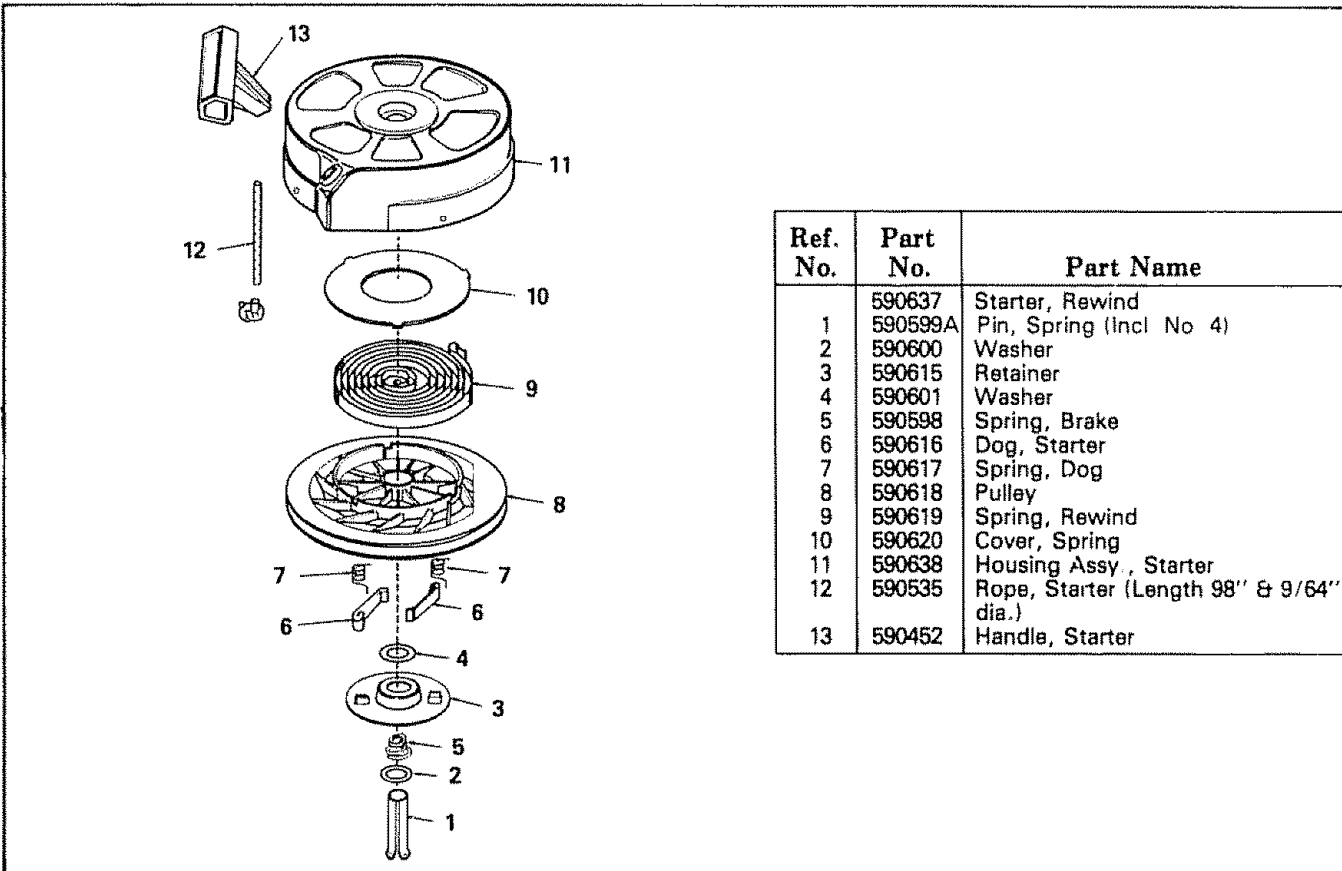

Ref. No.	Part No.	Part Name
	590637	Starter, Rewind
1	590599A	Pin, Spring (Incl No 4)
2	590600	Washer
3	590615	Retainer
4	590601	Washer
5	590598	Spring, Brake
6	590616	Dog, Starter
7	590617	Spring, Dog
8	590618	Pulley
9	590619	Spring, Rewind
10	590620	Cover, Spring
11	590638	Housing Assy , Starter
12	590535	Rope, Starter (Length 98" & 9/64" dia.)
13	590452	Handle, Starter

NOTES

TROUBLE SHOOTING POINTS

PROBLEM	CAUSE	CORRECTION
DOES NOT START	<ol style="list-style-type: none"> 1. Dirty air filter. 2. Out of gasoline. 3. Stale gasoline 4. Spark plug wire is disconnected from the spark plug. 5. Bad spark plug. 6. Water in gasoline. 7. Loose blade or broken blade adapter 8. Operator presence control bar in released position 9. Operator presence control bar defective. 	<ol style="list-style-type: none"> 1. Replace air filter 2. Fill gasoline tank. 3. Drain gas tank and refill with fresh gasoline 4. Connect wire to spark plug 5. Replace spark plug. 6. Drain tank and refill with fresh, clean gasoline 7. Tighten blade bolt and/or replace blade adapter 8. Depress operator presence control bar 9. Replace operator presence control bar
LOSS OF POWER	<ol style="list-style-type: none"> 1. Rear of lawn mower housing/blade dragging in heavy grass 2. Cutting too much grass. 3. Dirty air filter. 4. Build-up of grass, leaves, and trash under lawn mower housing 5. Walking speed too fast 6. Too much oil in engine. 	<ol style="list-style-type: none"> 1. Raise rear of lawn mower housing one (1) setting higher than front 2. Set in HIGHER CUT position 3. Clean or replace air filter 4. Disconnect spark plug wire and clean underside of lawn mower housing 5. Cut at slower walking speed 6. Check engine oil level
POOR CUT-UNEVEN	<ol style="list-style-type: none"> 1. Worn, bent or loose blade 2. Wheel heights uneven. 3. Low engine speed 4. Build-up of grass, leaves and trash under lawn mower housing. 	<ol style="list-style-type: none"> 1. Replace blade. Tighten blade bolt 2. Set all wheels at same height. 3. Set engine speed control in FAST or HIGH position. 4. Disconnect spark plug wire & clean underside of lawn mower housing
TOO MUCH VIBRATION	<ol style="list-style-type: none"> 1. Worn or bent blade 2. Loose blade 3. Bent engine crankshaft 	<ol style="list-style-type: none"> 1. Replace blade. 2. Tighten blade bolt 3. Contact Sears Service Department
STARTER ROPE HARD TO PULL	<ol style="list-style-type: none"> 1. Flywheel brake is on when operator presence control bar is released 2. Bent engine crankshaft. 3. Blade adapter sheared. 4. Blade dragging in grass 	<ol style="list-style-type: none"> 1. Depress operator presence control bar to upper handle before pulling on starter rope. 2. Contact Sears Service Department 3. Replace blade adapter. 4. Get over low grass and/or hard surface to start engine
CATCHER NOT FILLING COMPLETELY (IF APPLICABLE)	<ol style="list-style-type: none"> 1. Cutting height too low. 2. Lift on blade worn off. 3. Catcher bag dirty, poor air venting. 4. Low engine speed. 	<ol style="list-style-type: none"> 1. Raise cutting height 2. Replace blade. 3. Clean/replace catcher bag (If optional grass catcher is being used). 4. Set engine speed control in FAST or HIGH position.
HARD TO PUSH	<ol style="list-style-type: none"> 1. High grass or cutting height too low 2. Rear of lawn mower housing/blade dragging in heavy grass. 3. Grass catcher too full. 4. Handle height position not right for you. 	<ol style="list-style-type: none"> 1. Raise cutting height. 2. Raise rear of lawn mower housing one (1) setting higher than front. 3. Empty grass catcher. 4. Adjust handle height to suit.

SEARS

**OWNER'S
MANUAL**

**MODEL NO.
917.380330**

**HOW TO ORDER
REPAIR PARTS**

CRAFTSMAN®

**4.0 HORSE POWER
20'' SIDE DISCHARGE
ROTARY LAWN MOWER**

Each Lawn Mower has its own model number. Each engine has its own model number.

The model number for your lawn mower will be found on a decal attached to the rear of the lawn mower housing.

The model number for the engine will be found on the Blower Housing of the engine adjacent to the spark plug.

All parts listed herein may be ordered through Sears, Roebuck and Co. Service Centers and most Retail Stores.

WHEN ORDERING REPAIR PARTS, ALWAYS GIVE THE FOLLOWING INFORMATION:

- * PRODUCT - "ROTARY LAWN MOWER"
- * MODEL NUMBER - 917.380330
- * ENGINE - CRAFTSMAN
MODEL NO. 143.404082
- * PART NUMBER
- * PART DESCRIPTION

Your Sears merchandise has added value when you consider that Sears has service units nationwide staffed with Sears trained technicians...professional technicians specifically trained on Sears products, having the parts, tools and the equipment to insure that we meet our pledge to you, we service what we sell.