

## **Installation instructions**

DD605 and DS605 models

**DishDrawer**

**NZ AU GB IE**

# Safety and warnings

## WARNING!

### Electrical hazard

Before installing the DishDrawer®, remove the house fuse or open the circuit breaker.

If permanently connecting the DishDrawer®, be sure the power is isolated and the DishDrawer® unplugged.

This appliance must be grounded. In the event of a malfunction or breakdown, grounding will reduce the risk of electric shock by providing a path of least resistance for electric current. This appliance is equipped with a cord having an equipment-grounding conductor and a grounding plug. The plug must be plugged into an appropriate outlet that is installed and grounded in accordance with all local codes and ordinances. Improper connection of the equipment-grounding conductor can result in a risk of electric shock. Check with a qualified electrician or service representative if you are in doubt as to whether the appliance is properly grounded.

Do not modify the power supply plug provided with the appliance - if it will not fit the outlet, have a proper outlet installed by a qualified electrician. Do not use an extension cord, adapter plug or multiple outlet box.

Failure to do so may result in electrical shock or death



## WARNING!

### Cut Hazard

Take care - panel edges are sharp.

Failure to use caution could result in injury or cuts.



## ***Important safety precautions!***

- *Installation of this DishDrawer® requires basic mechanical and electrical skills.*
- *Be sure to leave these Instructions with the Customer.*
- *Installation must comply with your local building and electricity regulations.*
- *At the completion of the DishDrawer® installation, the Installer must perform Final Check List.*
- *Remove all packaging materials supplied with the DishDrawer®.*
- *This dishwasher is manufactured for indoor use only.*
- *Ensure all water connections are turned OFF. It is the responsibility of the plumber and electrician to ensure that each installation complies with all Codes and Regulations.*
- *The DishDrawer® MUST be installed to allow for future removal from the enclosure if service is required.*
- *The switched power outlet must be outside the DishDrawer® cavity so that it is accessible after installation.*
- *Care should be taken when the appliance is installed or removed to reduce the likelihood of damage to the power supply cord.*
- *If the DishDrawer® is to be relocated from one installation to another it must be kept upright to avoid damage from water spillage.*
- *Make sure only new hoses are used for connection (supplied with DishDrawer®). Old hoses should not be reused.*
- *Failure to install the DishDrawer correctly could invalidate any warranty or liability claims.*

# Contents

## DOUBLE MODELS

Product and cabinetry dimensions	2
Installation	
Cavity preparation	4
Route the hoses and move into the cavity	5
Removing the tub and levelling the product	6
Securing the product and refitting the tub	7
Plumbing and drainage - OPTION 1	8
Plumbing and drainage - OPTION 1 (connection)	9
Plumbing and drainage - OPTION 2	10
Plumbing and drainage - OPTION 2 (connection)	11
Fitting the toekick	12

## SINGLE MODELS

Product and cabinetry dimensions	14
Installation	
Cavity preparation	16
Route the hoses and move into the cavity	17
Removing the tub and securing the product	18
Refitting the tub	19
Plumbing and drainage - OPTION 1	20
Plumbing and drainage - OPTION 1 (connection)	21
Plumbing and drainage - OPTION 2	22
Plumbing and drainage - OPTION 2 (connection)	23
Final checklist	24

### ***Important!***

#### **SAVE THESE INSTRUCTIONS**

*The models shown in this User Guide may not be available in all markets and are subject to change at any time. For current details about model and specification availability in your country, please go to our website [www.fisherpaykel.com](http://www.fisherpaykel.com) or contact your local Fisher & Paykel dealer.*

Installation diagrams for illustration purposes only

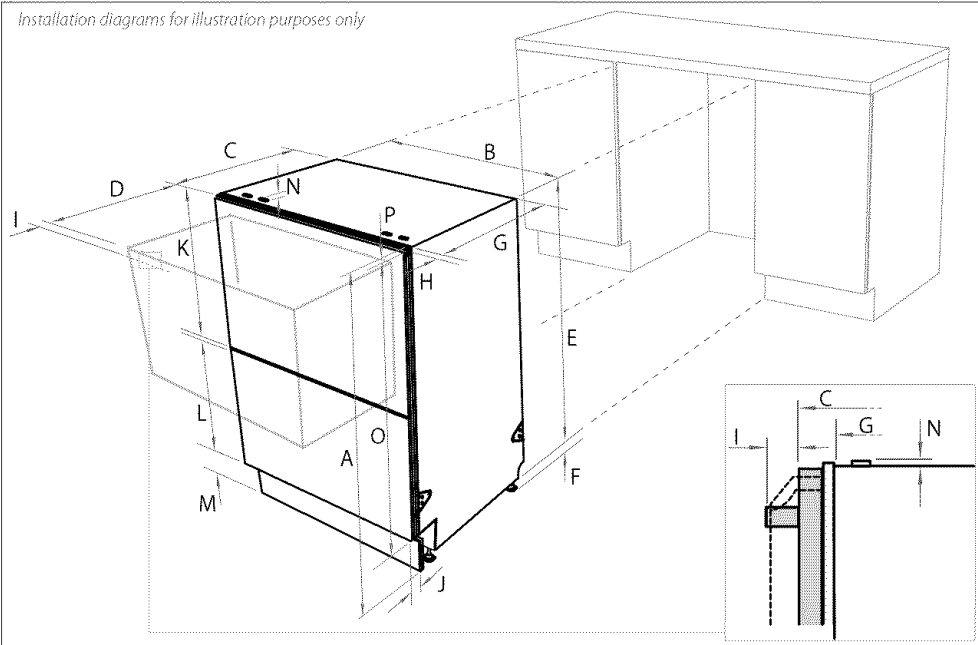

Product dimensions (mm)

	Prefinished LCD DD605	Prefinished Flat door DD605	Integrated DD605
A overall height* of product	819.5 - 879.5	819.5 - 879.5	819.5 - 879.5
B overall width of product	595	595	595
C overall depth of product (excl. curvature/handle)	570	570	570
D depth of drawer (open) (excl. curvature/handle)	520	520	520
E height* of chassis	809	809	809
F height range of levelling feet	60	60	60
G depth of chassis	552	552	552
H depth of drawer front panel (excl. curvature/handle)	18	18	18
I depth of curvature or handle	30	**	n/a
J depth of kickstrip	50 - 65	50 - 65	67 - 127***
K height of upper drawer front	394	398	398 min
L height of lower drawer front	312.5	311.5	311.5 min
M height of kickstrip (adjustable)	70 - 120	70 - 120	70 - 120
N height of installation tab slots (on top of chassis)	2	2	2
O height of drawer fronts	719.5	717.5	717.5 min
P height* of top of upper drawer to top of chassis	7	2	n/a

\* Chassis heights include tab slots

\*\* Designer handle - 41 mm, Curved handle - 36 mm

\*\*\* Prefinished 50-65 mm; Integrated 67 mm less the Kickstrip Panel thickness (Minimum Panel thickness using the supplied screws is 9 mm).

Installation diagrams for illustration purposes only

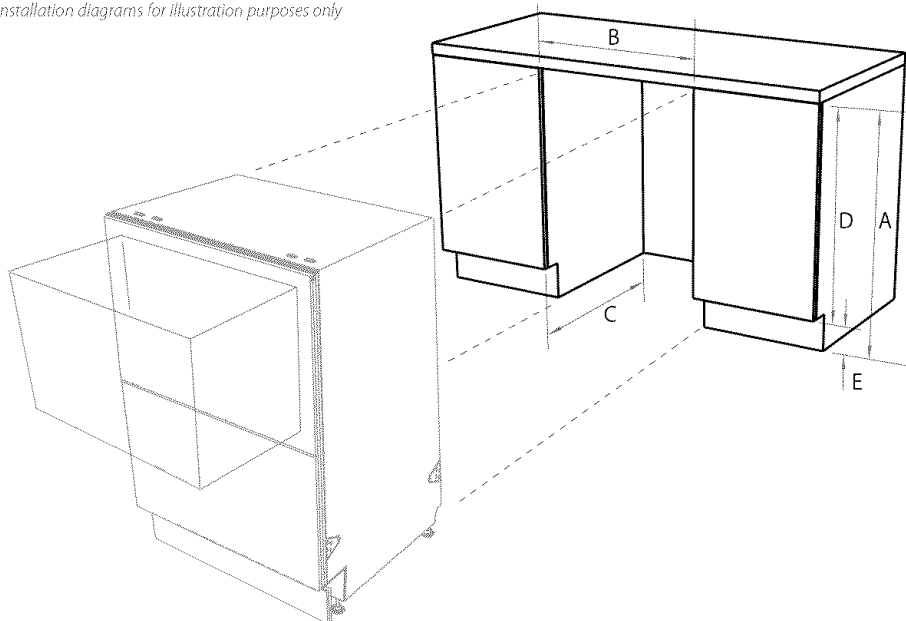

## Cabinetry dimensions (mm)

	Prefinished LCD DD605	Prefinished Flat door DD605	Integrated DD605	
A	inside height of cavity	820 - 882.5	820 - 882.5	820 - 882.5
B	inside width of cavity	600	600	600
C	inside depth of cavity (inside)	580	580	580
D	height of adjacent cabinetry	720	720	720
E	height of kickstrip	70 - 120	70 - 120	70 - 120

## Minimum clearances (mm)

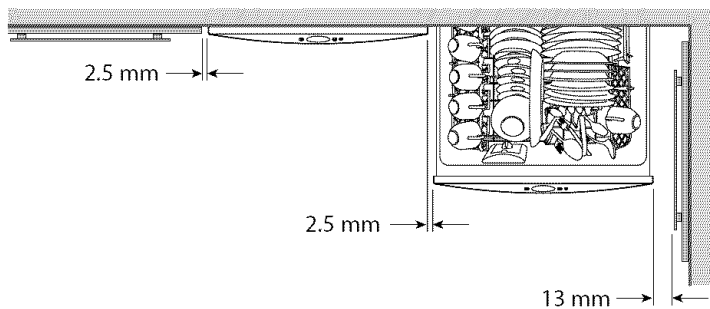

# Cavity preparation

## Parts supplied

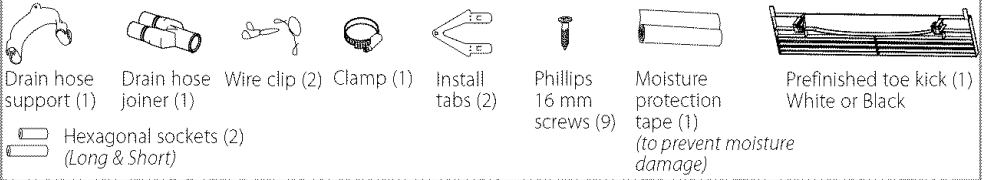

If the Drain hose(s) supplied are not long enough to reach your services, you **must** use a Drain Hose Extension Kit P/N 525798 which will extend the drain hose(s) by 3.6m. The kit is available from the nearest Fisher & Paykel Authorized Service Agent or [www.fisherpaykel.com](http://www.fisherpaykel.com). DO NOT extend beyond this limit.

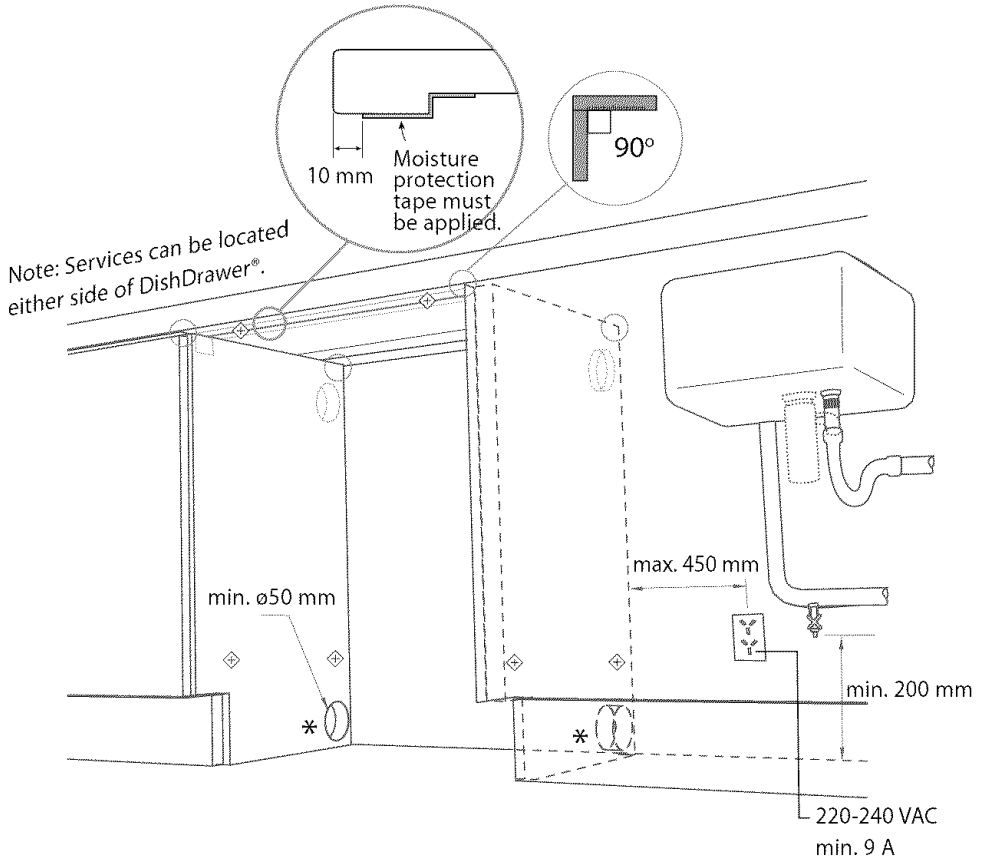

⊕ These marks indicate mounting tab screw locations

\* Preferred position. If adequate clearance, services hole can be higher to clear toe kick space. If hole is higher, ensure drain hose(s) are routed straight into the waste connection.

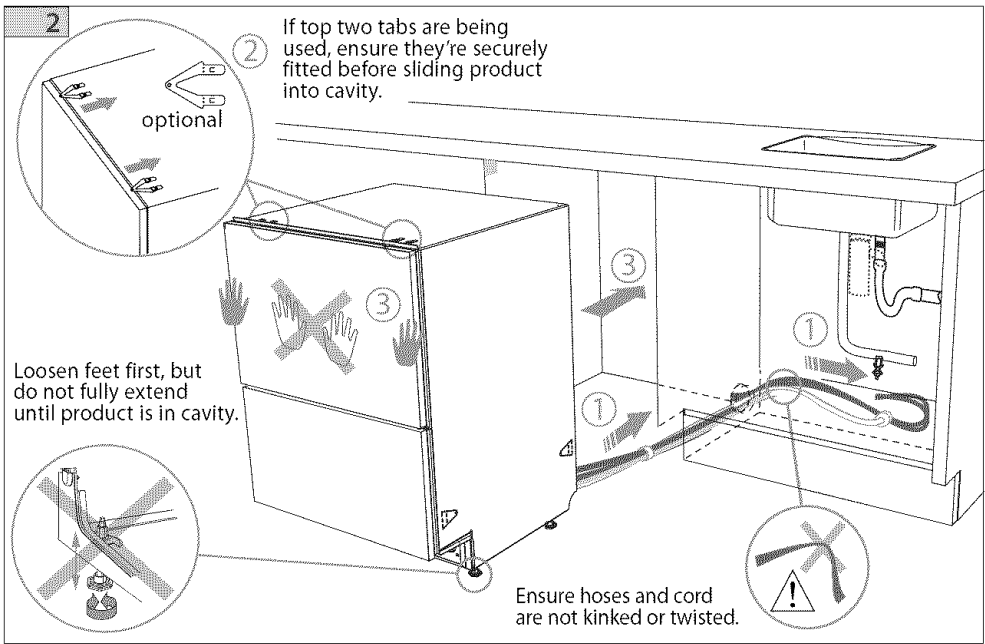
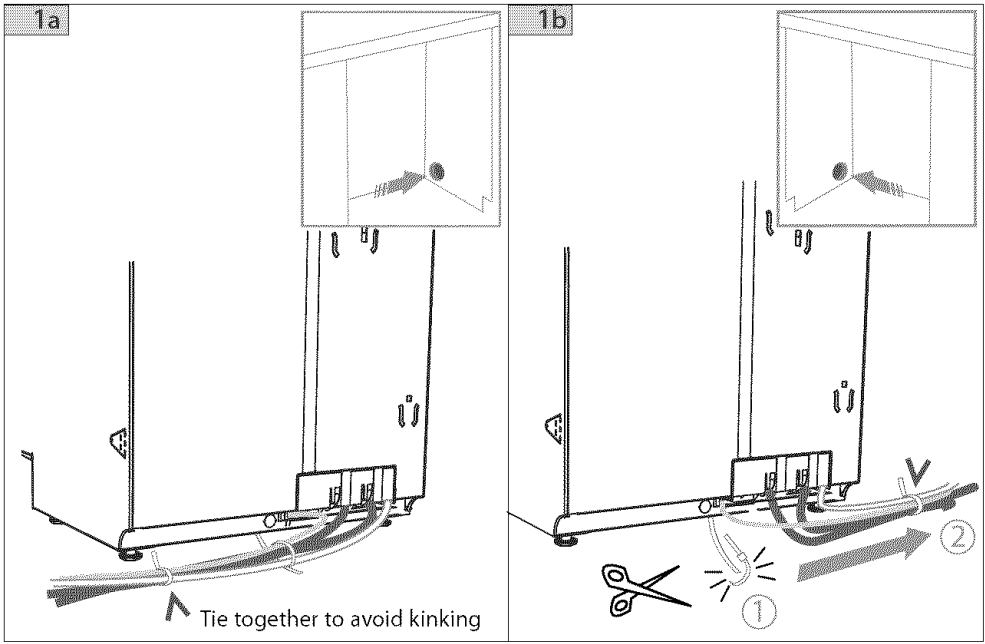

# Removing the tub and levelling the product

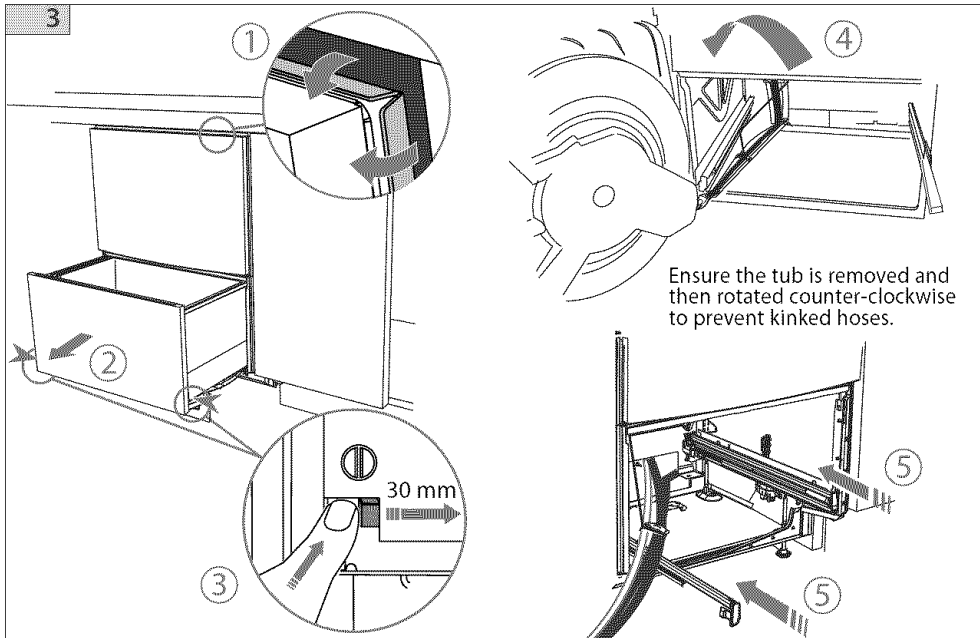

Ensure product is level. Using the most appropriate length Hexagonal socket supplied, and a screwdriver, fully extend levelling feet up to required distance.

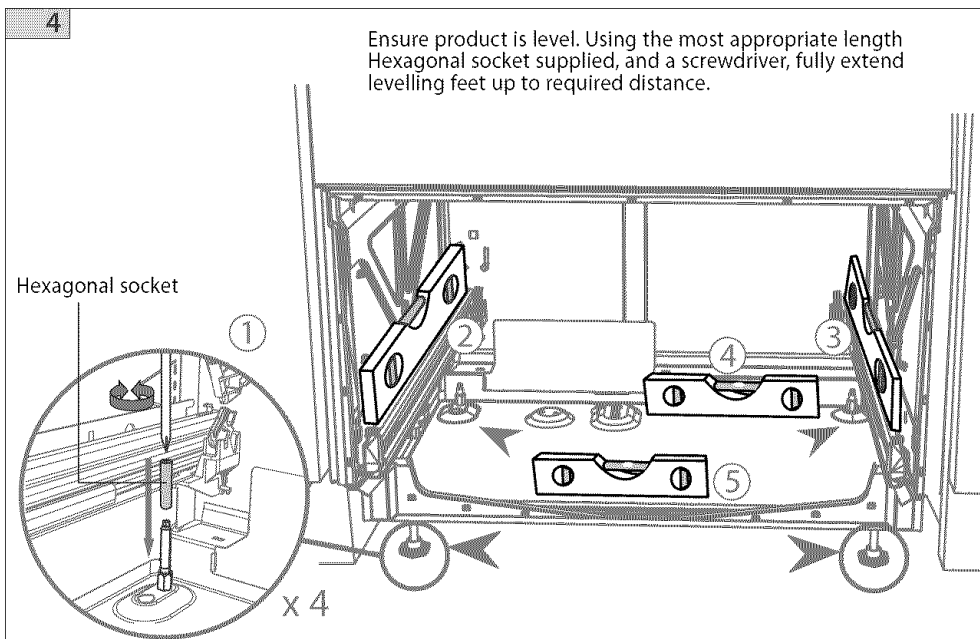



5

The mounting tabs are in pairs, one on each side of the product. At least two sets of tab pairs must be used.  
**A and B** tab pairs  
 OR **B and C** tab pairs  
 or all three pairs.

Ensure the sound insulation is repositioned correctly.

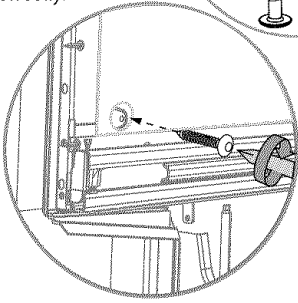
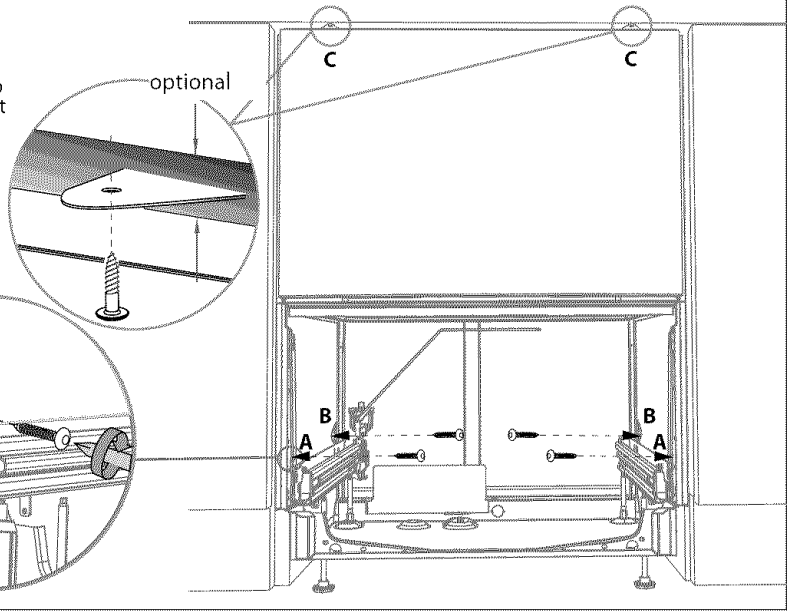

6

Ensure the tub clips on both sides are reset.

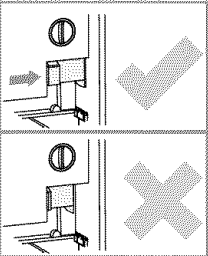

5

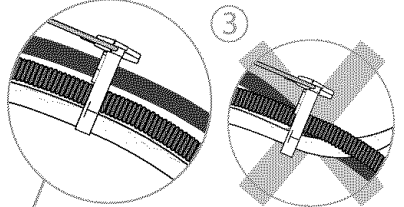

Before refitting the tub, ensure the hoses are not twisted and the latches at the rear of each drawer runner are facing forward.

Ensure the tub is now rotated clockwise back.

4

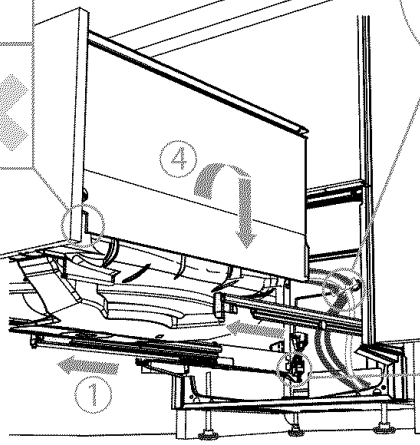

1

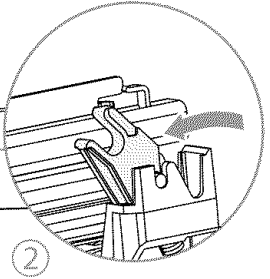

2

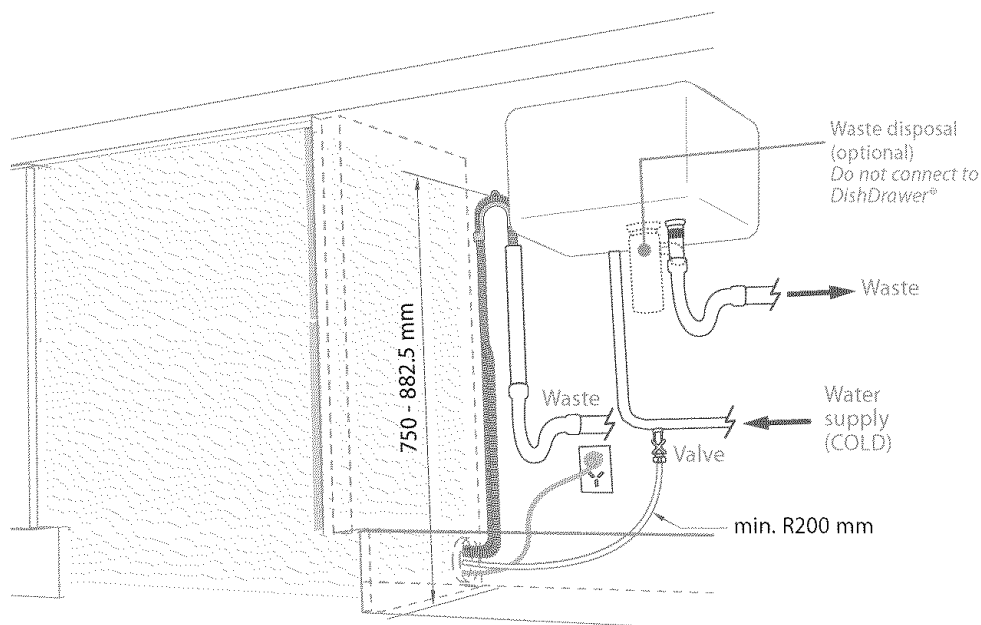
DishDrawer® and Standpipe  $\varnothing 38$  mm

Max. distance of hoses and cord from chassis edge	Left hand side	Right hand side
Drain hose	2011 mm	1794 mm
Inlet hose	1561 mm	1344 mm
Power cord	1776 mm	1559 mm

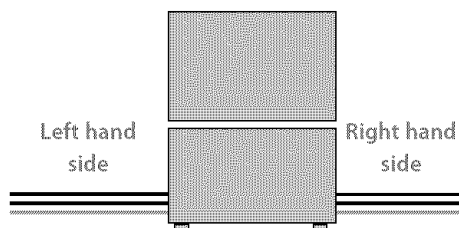

- Water Pressure**

	Max	Min
Water softener models	1 MPa (145 psi)	0.1 MPa (14.5 psi)
Other models	1 MPa (145 psi)	0.03 MPa (4.3 psi)
- Drains will need to be separated to satisfy Kosher requirements. We suggest you confirm acceptability with your local Rabbi in respect to Kosher installations.

## DishDrawer® and Standpipe $\varnothing 38$ mm

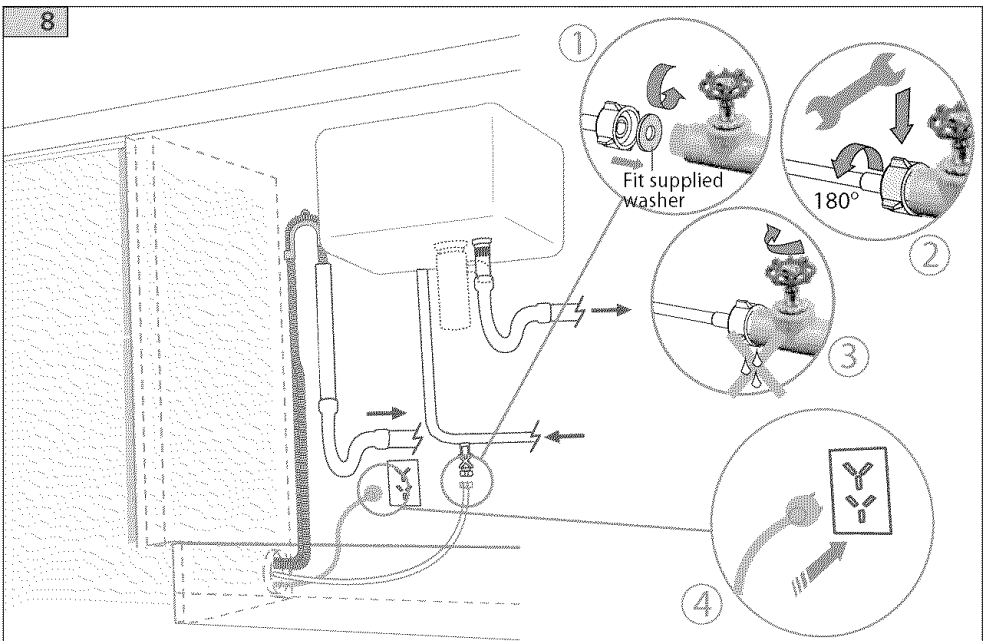
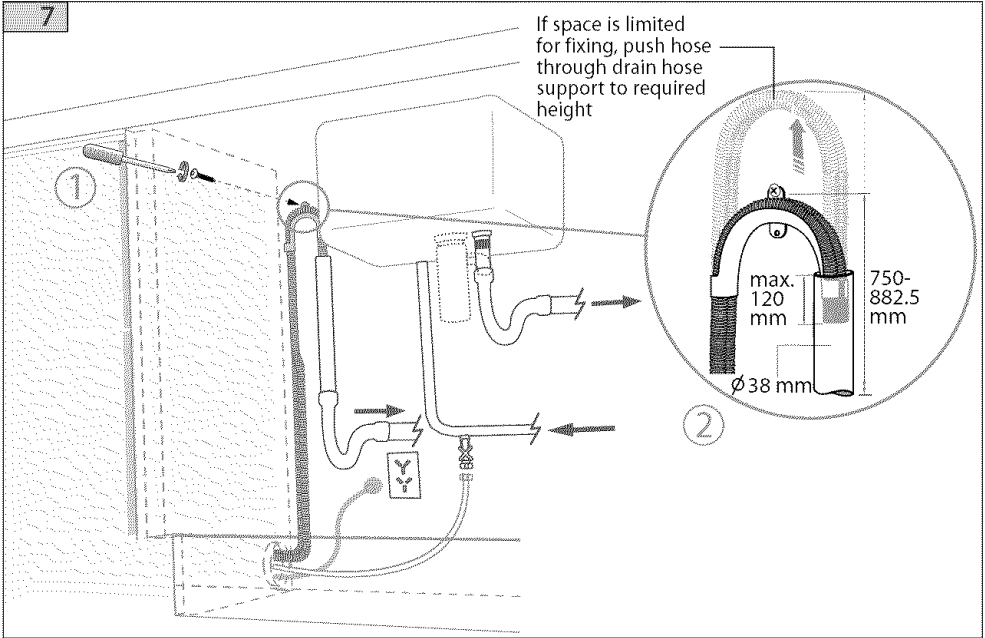

## DishDrawer® using sink trap with drain hose joiner

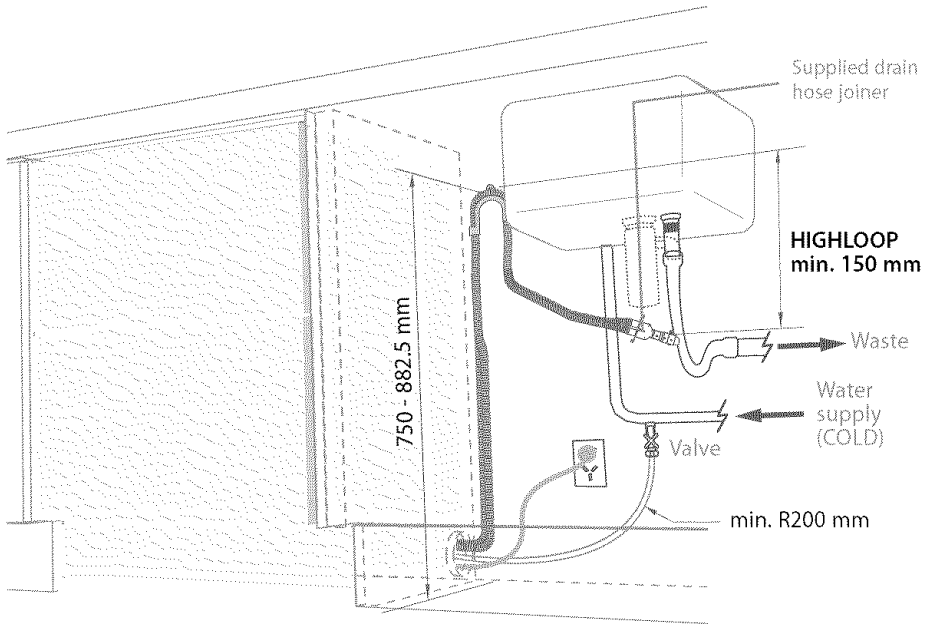

## DishDrawer® using sink trap with drain hose joiner

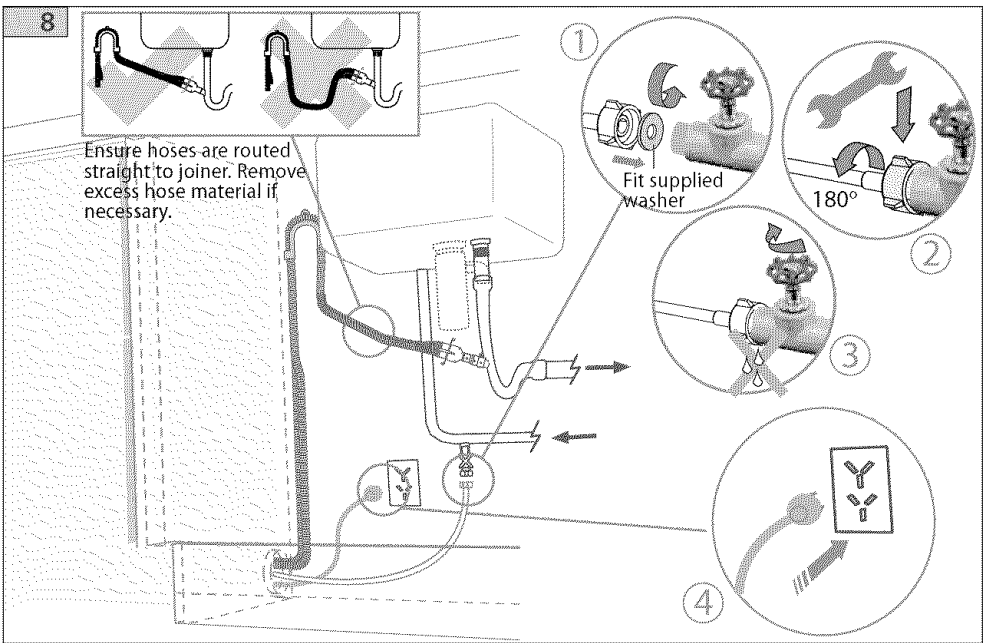
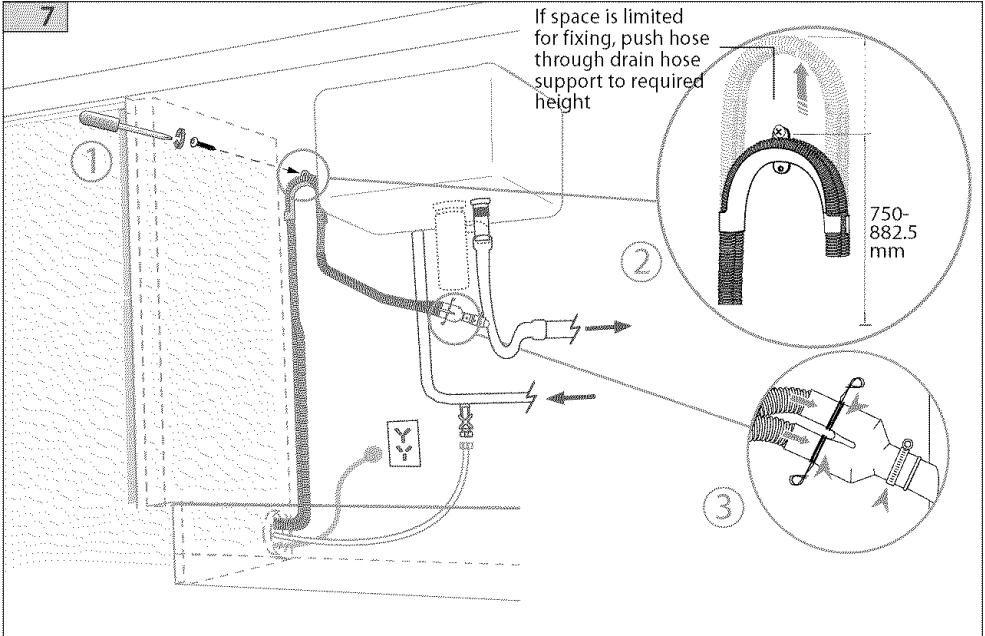

9

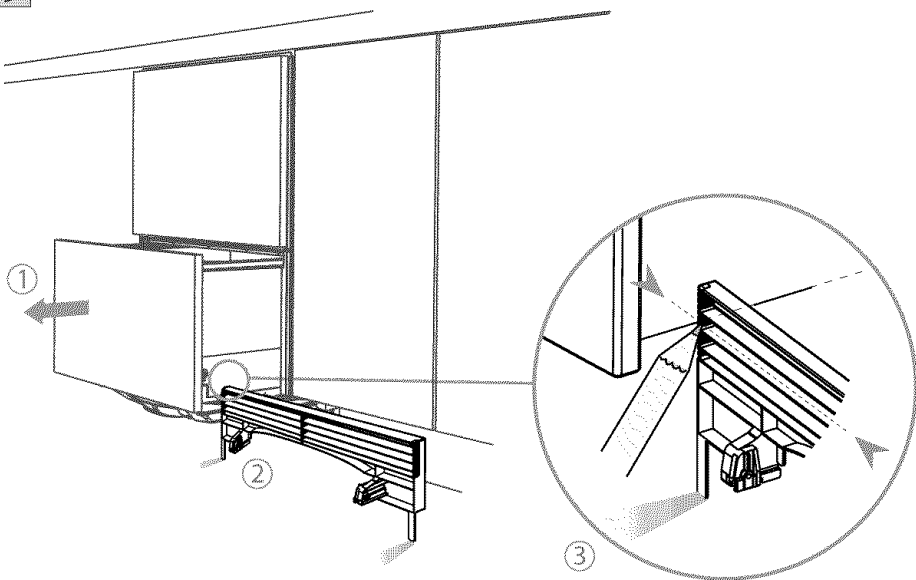

10

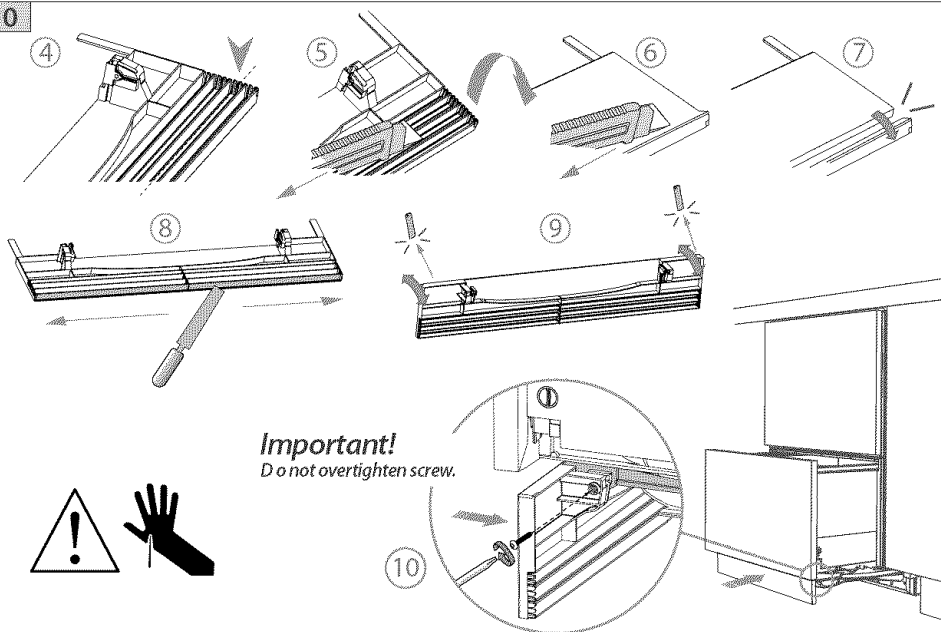

**Important!**  
Do not overtighten screw.





Installation diagrams for illustration purposes only

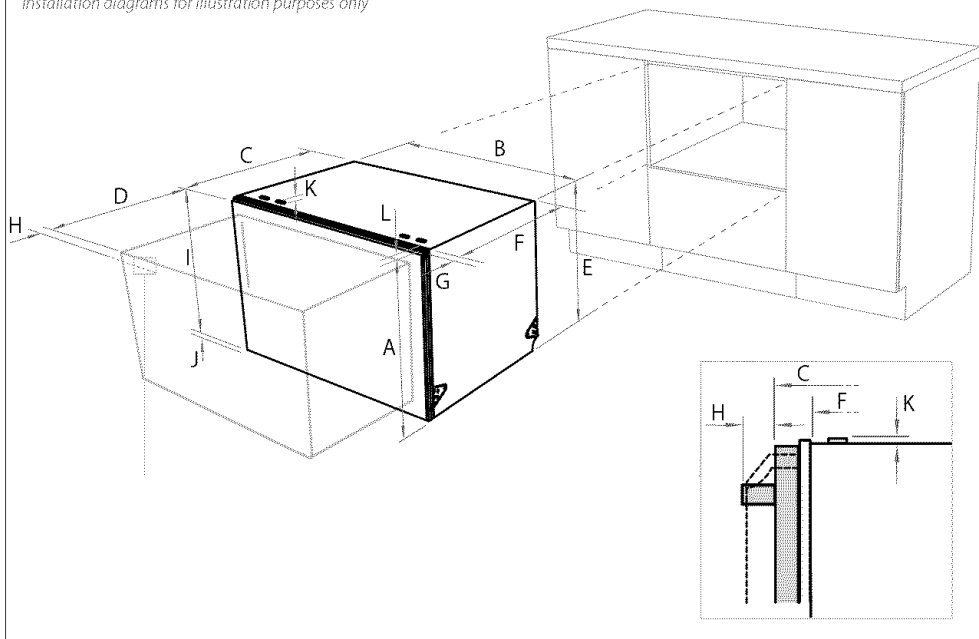

Product dimensions (mm)

	Prefinished LCD DS605	Prefinished Flat door DS605	Integrated DS605	
A	overall height* of product	409	409	
B	overall width of product	595	595	
C	overall depth of product (excl. curvature/handle)	570	570	570**
D	depth of drawer (open) (excl. curvature/handle)	520	520	520
E	height* of chassis	409	409	409
F	depth of chassis	552	552	552
G	depth of drawer front panel (excl. curvature/handle)	18	18	18
H	depth of curvature or handle	30	***	n/a
I	height of drawer front	394	398	398 min
J	height of venting area at base of product	7	9	9
K	height of installation tab slots (on top of chassis)	2	2	2
L	height* of top of drawer to top of chassis	7	2	n/a

\*Chassis heights include tab slots \*\* Panel thickness - 18 mm \*\*\* Designer handle - 41 mm, Curved handle - 36 mm

Note: for Prefinished Flat door models, the height from the top of handle to the top of door - 59.5 mm



Installation diagrams for illustration purposes only

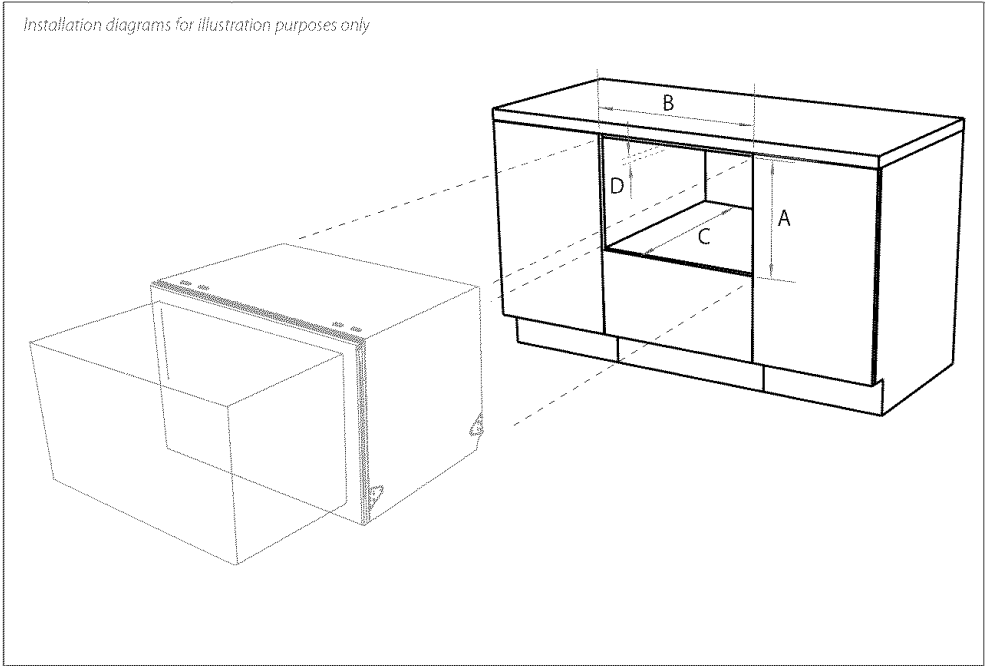

## Cabinetry dimensions (mm)

	Prefinished LCD DS605	Prefinished Flat door DS605	Integrated DS605	
A	inside height of cavity	412	412	412
B	inside width of cavity	600	600	600
C	inside depth of cavity (inside)	580	580	580
D	clearance below benchtop	Minimum 3*	Minimum 3*	Minimum 3*

\* Clearance is measured from the underside of benchtop to the chassis

## Minimum clearances (mm)

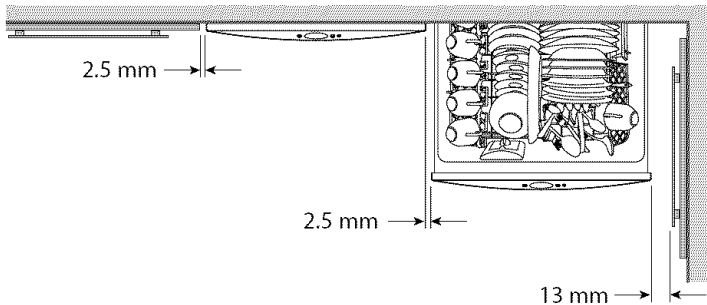

# Cavity preparation

## Cavity



If the Drain hose(s) supplied are not long enough to reach your services, you **must** use a Drain Hose Extension Kit P/N 525798 which will extend the drain hose(s) by 3.6m. The kit is available from the nearest Fisher & Paykel Authorized Service Agent or [www.fisherpaykel.com](http://www.fisherpaykel.com). DO NOT extend beyond this limit.

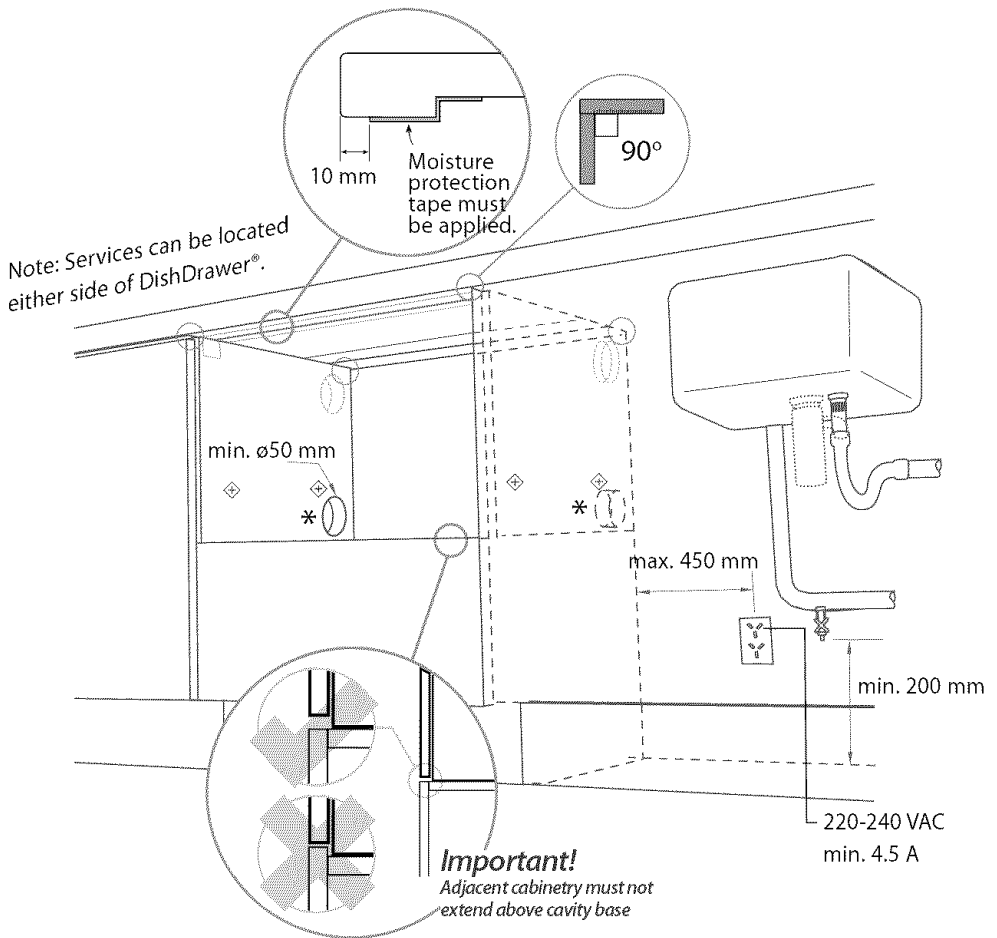

- ⊕ These marks indicate mounting tab screw locations
  - Note: To align drawer front to adjacent cabinetry, the product to counter top clearance can be increased to 3 mm.
  - \* Preferred position. If adequate clearance, services hole can be higher. If hole is higher, ensure drain hose(s) are routed straight into the waste connection.

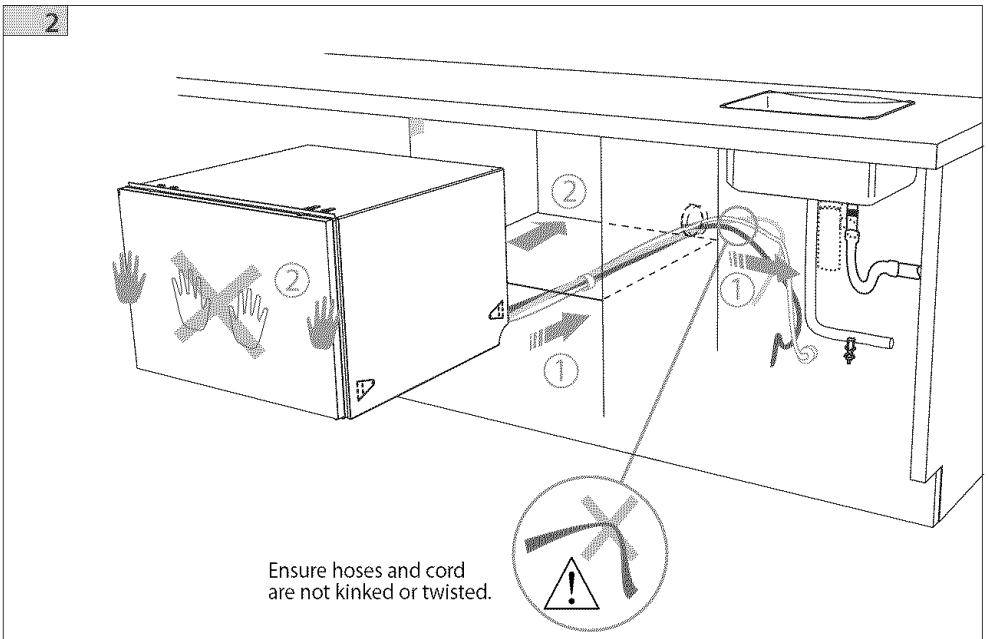
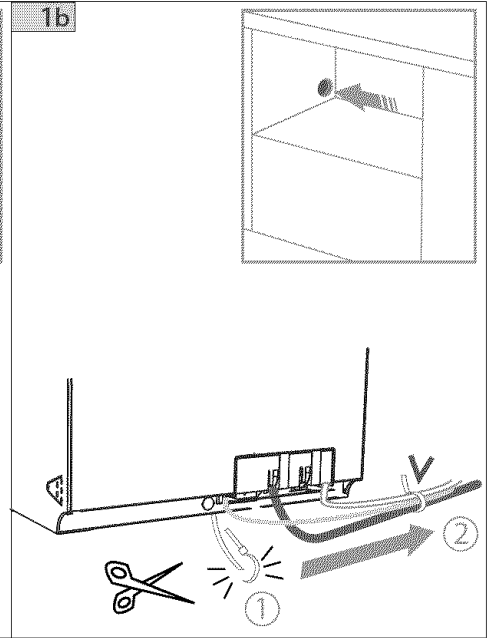
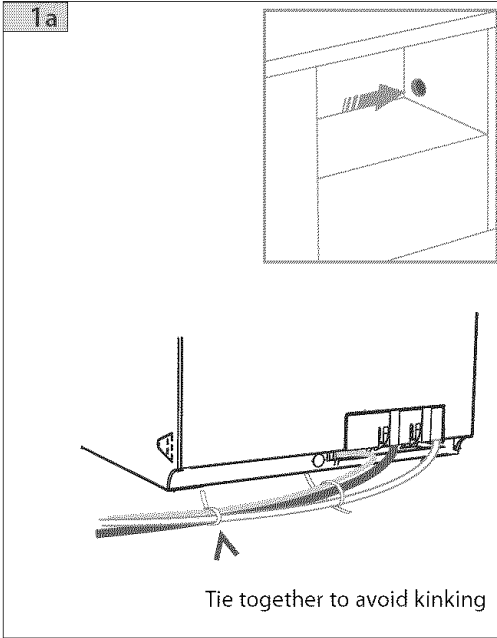

# Removing the tub and securing the product

3

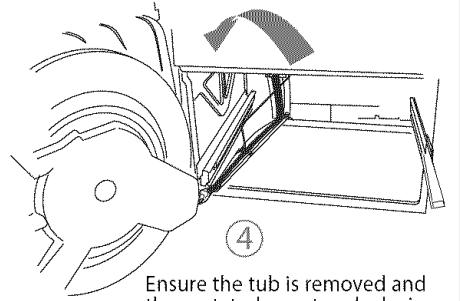
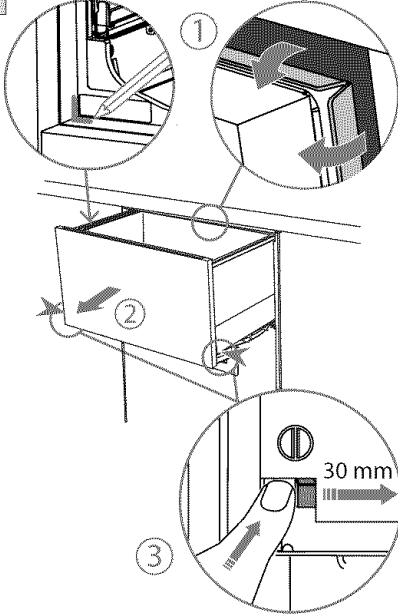

Ensure the tub is removed and then rotated counter-clockwise to prevent kinked hoses.

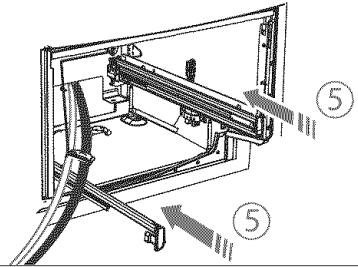

4

The mounting tabs are in pairs, one on each side of the product.

Ensure the sound insulation is repositioned correctly.

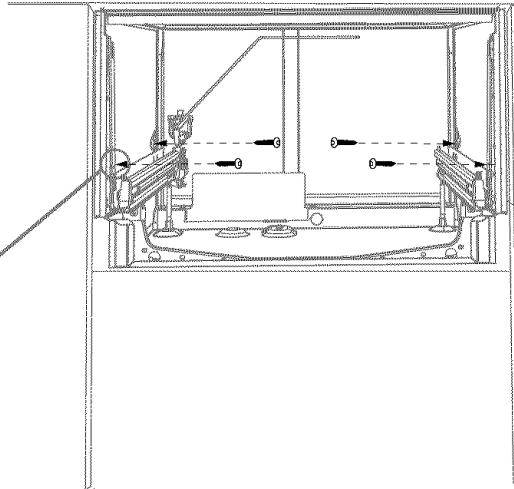
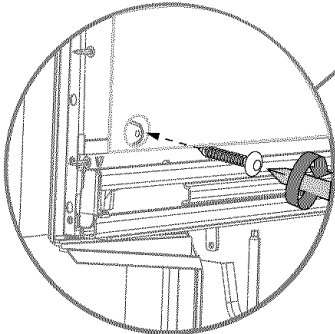

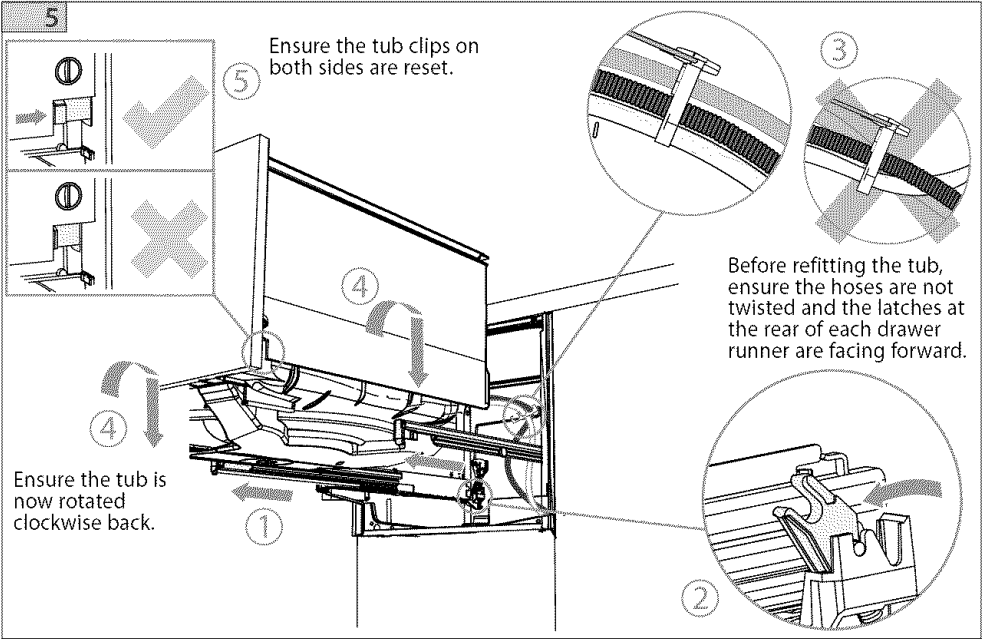

# Plumbing and drainage - OPTION 1

## DishDrawer® and Standpipe ø38 mm

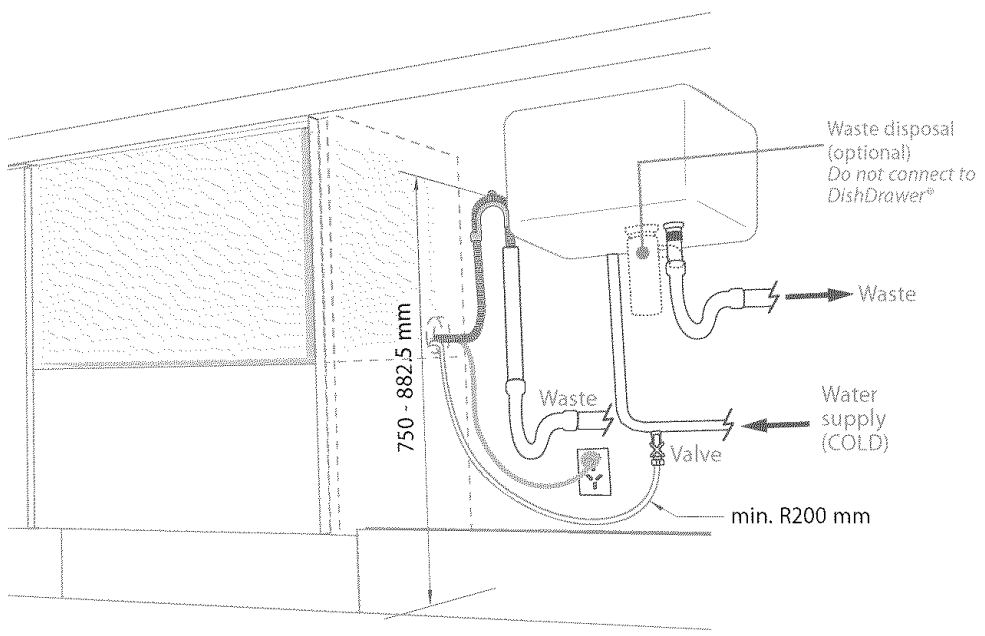

Max. distance of hoses and cord from chassis edge	Left hand side	Right hand side
Drain hose	2011 mm	1794 mm
Inlet hose	1561 mm	1344 mm
Power cord	1776 mm	1559 mm



- Water Pressure**

Water softener models	<b>Max</b> 1 MPa (145 psi)	<b>Min</b> 0.1 MPa (14.5 psi)
Other models	1 MPa (145 psi)	0.03 MPa (4.3 psi)

## DishDrawer® and Standpipe Ø38 mm

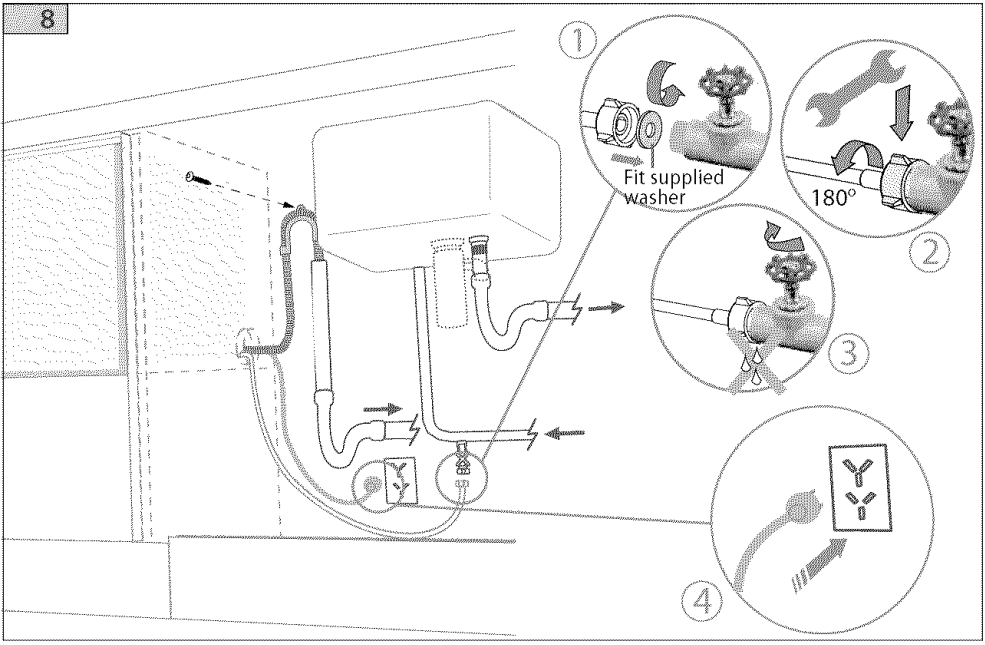
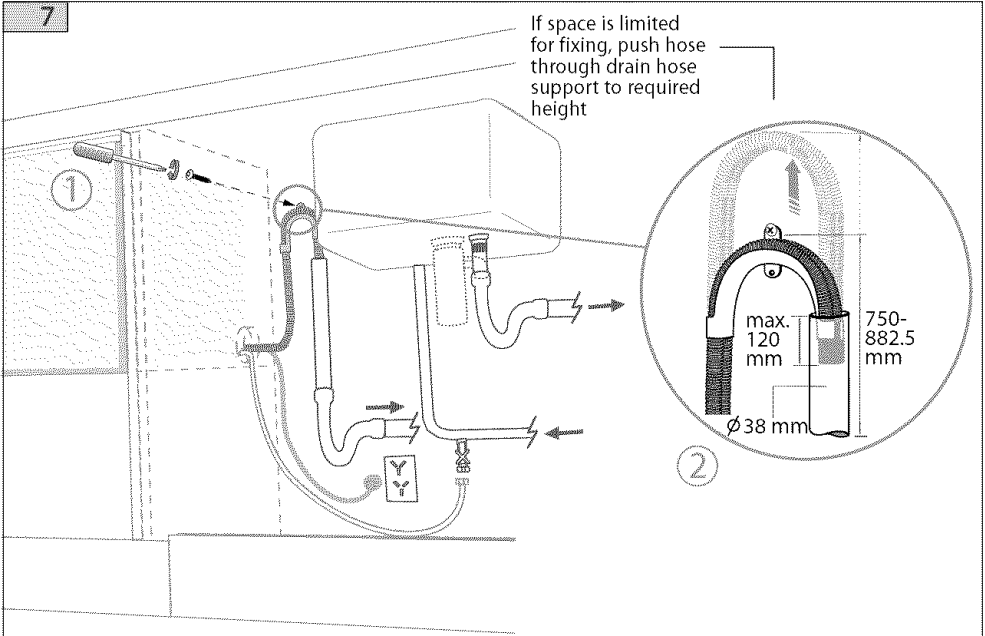

# Plumbing and drainage - OPTION 2

## DishDrawer® using sink trap with drain hose joiner

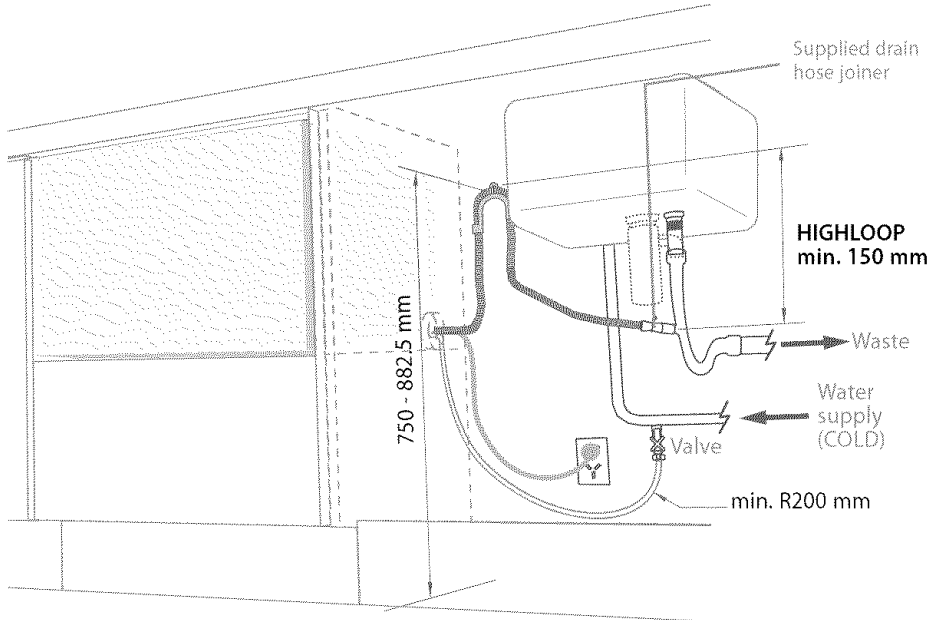



## DishDrawer® using sink trap with drain hose joiner

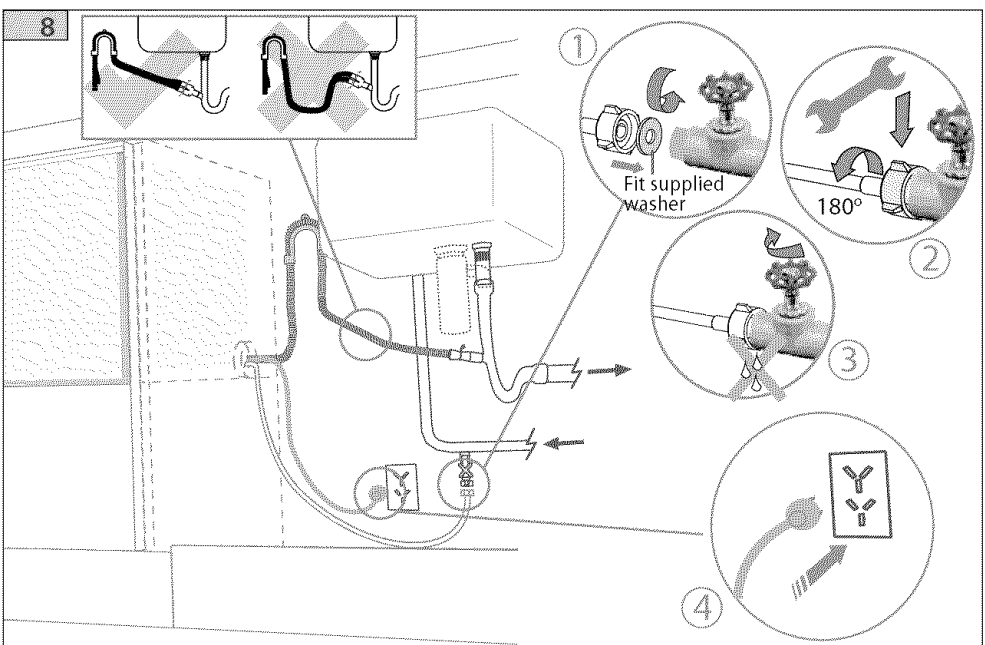
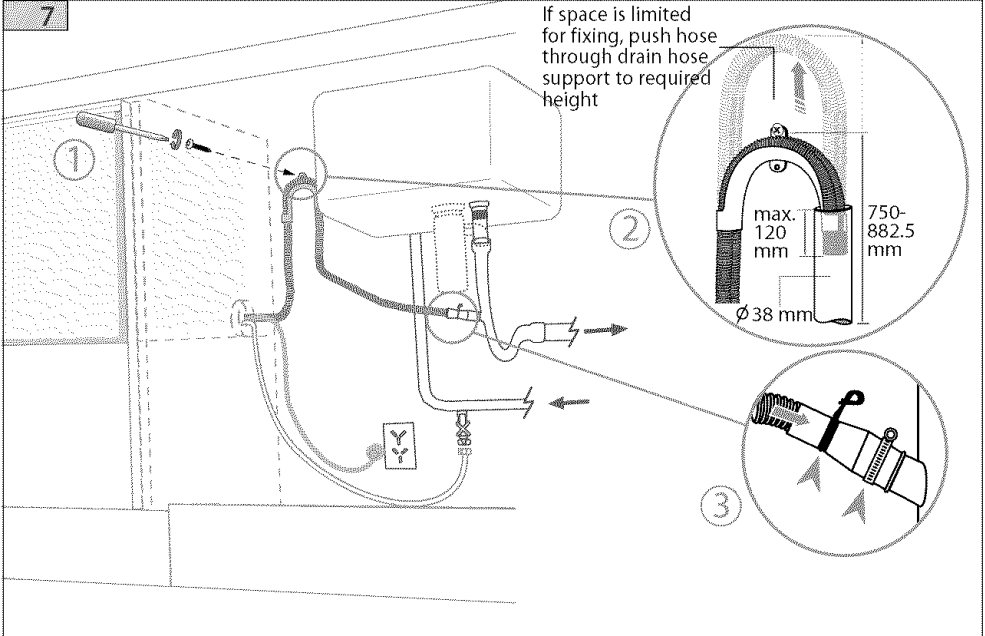

## Final checklist

- Check all parts are installed.
- Ensure product is level, securely fastened to the cabinetry and opens and closes freely. The DishDrawer® must be free to fully close with no resistance from the cabinetry.
- Ensure inlet hose to water supply has rubber washer fitted and is tightened a further half turn after seal contact.
- Ensure any knockouts or plugs in drain connection have been drilled out and drain connection has been made.
- The drain hose connector must not support the weight of excess hoses. Keep hoses as fully extended as possible to prevent sagging. Any excess length of hose should be kept on the dishwasher side of the high loop.
- If using Plumbing and Drainage OPTION 2, ensure the Highloop is a minimum 150 mm higher than the drain hose connector.
- Turn on the power and water supply. Then press the power button to turn the DishDrawer® on. The DishDrawer® should beep and cycle select lights light up.
- Check the sprayarm(s) are in place and free to rotate.
- Add three cups of water into the DishDrawer®.
- On the Wash Programme Selector Panel press Rinse and close the drawer(s). Start the programme by pressing the Start/Pause button.
- After the Rinse programme has finished, ensure machine has run and drained correctly.
- Check water supply and drainage connection for leakage.

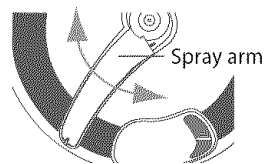

**Repeat for each Drawer.**

### Troubleshooting

- **Excessive water remaining above the filter plate, after the rinse cycle**  
Check for kinked drain hoses or blocked waste connection, high loop not properly installed or drain hoses not routed correctly.
- **No water supply (⊗ shows on display)**  
Check water is connected, turned on and the spray arm(s) is correctly fitted and free to rotate.
- **DishDrawer® does not light up when the tub is opened**  
Ensure power is connected and is switched on. Check if Auto Power option is on.
- **Water around water supply and drainage connections**  
Check connections, existing plumbing and hoses for leaks. Check washer and hose clamps are correctly fitted.
- **If product is tipping**  
Ensure the product is secured to the cabinetry. Refer to page 7 or 18.
- **If front panels are misaligned**  
Check and relevel product. Check the cabinetry is square.
- **Drawer(s) don't close properly**  
Ensure nothing is obstructing the drawer(s) from closing properly ie sound insulation, hoses or tub latches.
- If a problem occurs, consult the Troubleshooting section of the User Guide.
- If after checking these points you still need assistance, please refer to the Service & Warranty book for warranty details and your nearest Authorized Service Centre, or contact us through our website, [www.fisherpaykel.com](http://www.fisherpaykel.com).

Copyright © Fisher & Paykel 2007. All rights reserved.  
The product specifications in this booklet apply to the specific products and models described at the date of issue. Under our policy of continuous product improvement, these specifications may change at any time. You should therefore check with your Dealer to ensure this booklet correctly describes the product currently available.

**[www.fisherpaykel.com](http://www.fisherpaykel.com)**

NZ AU GB IE  
DishDrawer installation instructions  
Published: 06/2007  
**Part No. 529322 A**