

Sears

OWNER'S MANUAL

MODEL NO.
257.857240

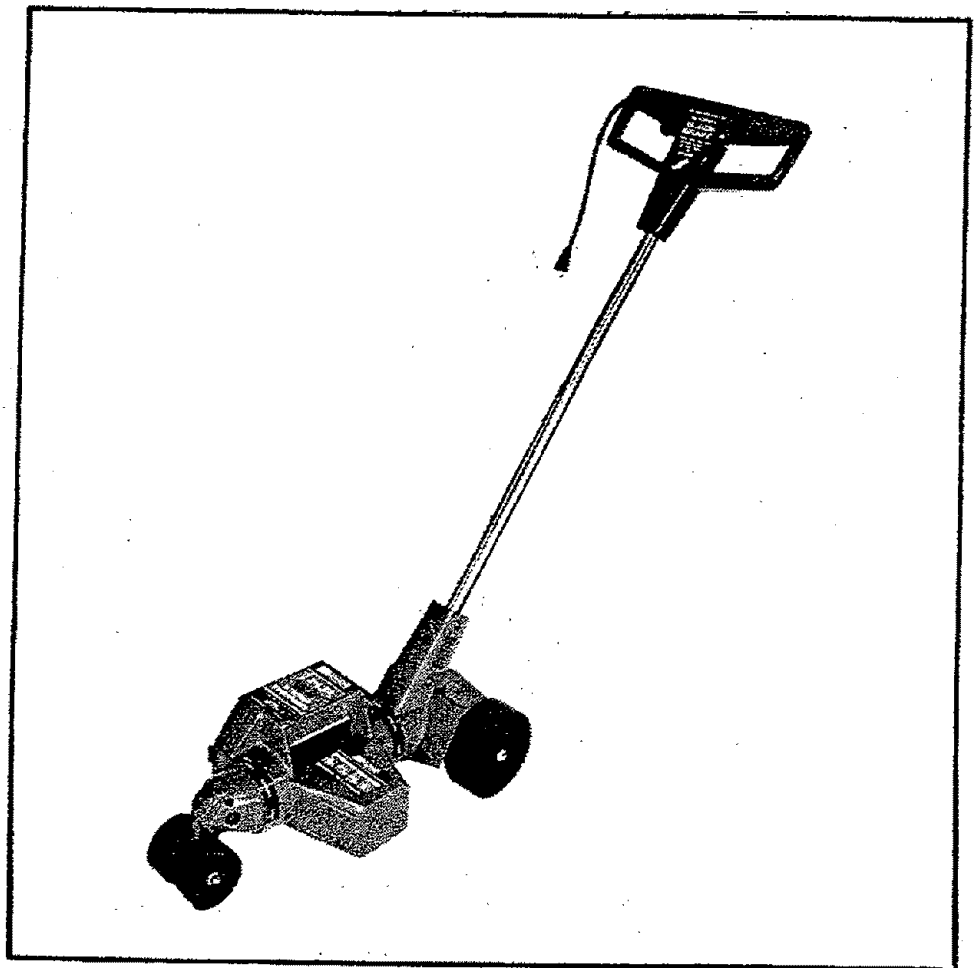

Sears

CRAFTSMAN

CAUTION:
Read **RULES** for
Safe **OPERATION**
and **INSTRUCTIONS**
Carefully

**ELECTRIC
EDGER**
DOUBLE INSULATED

- Assembly
- Operating
- Repair Parts

Sold by SEARS, ROEBUCK AND CO., Chicago, IL 60684 U.S.A.

FULL ONE-YEAR WARRANTY ON CRAFTSMAN ELECTRIC EDGER

If this Craftsman Electric Edger fails to perform properly due to a defect in material or workmanship within one year from the date of purchase, Sears will repair it free of charge.

If this Craftsman Electric Edger is used for commercial and rental purposes, this warranty coverage applies for only 90 days from the date of purchase. This warranty applies only while this product is in use in the United States.

WARRANTY SERVICE IS AVAILABLE BY CONTACTING THE NEAREST SEARS STORE OR SERVICE CENTER THROUGHOUT THE UNITED STATES.

This warranty gives you specific legal rights and you may also have other rights which vary from state to state.

SEARS, ROEBUCK AND CO., DEPT. 698/731A, Sears Tower, Chicago, IL 60684

IMPORTANT: rules for safe operation

DOUBLE INSULATION

Double Insulation is a concept in safety, replacing the standard grounded supply system in electric power tools. The construction of a double insulated tool affords comparable protection to a properly grounded tool without the necessity for using a grounded conductor. The double insulation system eliminates the need for the usual three-wire grounded power cord and ground supply system. Wherever there is electric current in the tool there are two complete sets of insulation to protect the user. All exposed metal parts are isolated from the internal metal motor components with protecting insulation. The lead wires, switch, etc. with their functional insulation have the added protection of non-conductive sleeving or housing to complete the double insulation system.

SERVICING OF A TOOL WITH DOUBLE INSULATION REQUIRES EXTREME CARE AND KNOWLEDGE OF THE SYSTEM AND SHOULD BE PERFORMED ONLY BY A QUALIFIED SERVICE TECHNICIAN. FOR SERVICE WE SUGGEST YOU RETURN THE TOOL TO YOUR NEAREST SEARS STORE FOR REPAIR WHICH WILL BE DONE WITH ORIGINAL FACTORY REPLACEMENT PARTS.

SAFETY RULES FOR POWER TOOLS

CAUTION

1. Keep hands, feet, and face clear of rotating blade.
2. Use Safety Goggles. Wear at all times when using tool.
3. Dress properly. Always wear shoes. Do not operate tool while barefoot or when wearing sandals, canvas or open-toed shoes. Use of rubber gloves and safety footwear is recommended when working outdoors. Wear long pants to protect your legs.
4. Keep children away. Keep spectators at a safe distance.
5. **WARNING:** To prevent electric shock hazard use only with an extension cord suitable for outdoor use. A two-wire cord without a ground connection may be used since the tool is double insulated. Cord should be 18 gauge or heavier to prevent overheating and loss of power. U.L. listed extension cords are available at your nearest Sears store.
6. To prevent disconnection of power supply cord from the extension cord during operation see instructions with Fig. 4.
7. Avoid Dangerous Environment -- Do not use unit in damp or wet areas.
8. Don't force this tool. It will work better and safer at the rate it was designed. If motor slows down too much, pull away and allow unit to obtain full speed.
9. Do not use tool for any job except that for which it is intended.
10. Do not immerse tool in water or operate in rain.
11. Don't overreach -- Keep proper footing and balance at all times.
12. Don't abuse cord -- Never carry tool by cord or yank cord from receptacle. Keep cord away from heat, oil and sharp edges. Replace damaged cord immediately.
13. Never carry plugged in tool with finger on switch.
14. Disconnect tool from the power supply when not in use and when making any repairs or inspections.
15. Maintain tool with care. Keep air vents clear of debris. Keep guards in place and in working order and follow instructions for replacing blade.
16. Store indoors in a high, dry, lock-up place out of reach of children.

BOX CONTENTS

This box should contain:

- 1 257.857240 Electric Edger
- 1 Loose Parts Kit containing:
 - 2 Ea. 3933-1 Screw
 - 2 Ea. 3935 Locknut
 - 1 Ea. 88-405-00 Owner's Manual

TOOLS NEEDED FOR ASSEMBLY

- 1 Phillips Screwdriver
- 1 11/32 Box or Crescent Wrench

Remove Edger from carton and examine it thoroughly to make sure it is not damaged.

NOTE: Your Edger comes packaged with protective clips inserted in the handle tubes. These plastic clips must be discarded before assembly of the unit.

ASSEMBLY INSTRUCTIONS

ATTACHING THE TUBES

1. Slide outer tube sleeve down upper tube and over lower tube until the assembly holes are aligned. Be careful not to pinch or cut harness wire.

NOTE: Should the outer tube be difficult to slide, grasp outer tube sleeve firmly and twist slowly back and forth while pushing downward.

2. Insert the screws and attach the locknuts supplied. Tighten. (Fig. 1)

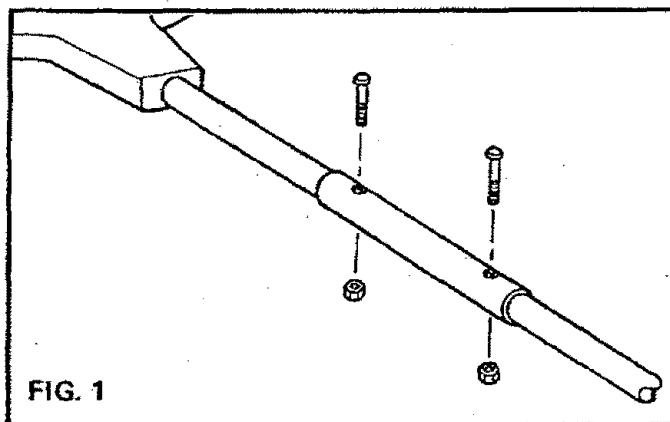

ADJUSTMENT

There are four different positions in which you can adjust your Edger.

TO ADJUST POSITION OF EDGER:

Grasp the front wheel assembly and lift front of Edger about three inches off the ground. Holding front wheels stationary, squeeze locking bar and rotate the Edger housing into the desired operating position. Release locking bar when identical position marks on Edger housing align with arrows on front and rear wheel assemblies. (See Fig. 2)

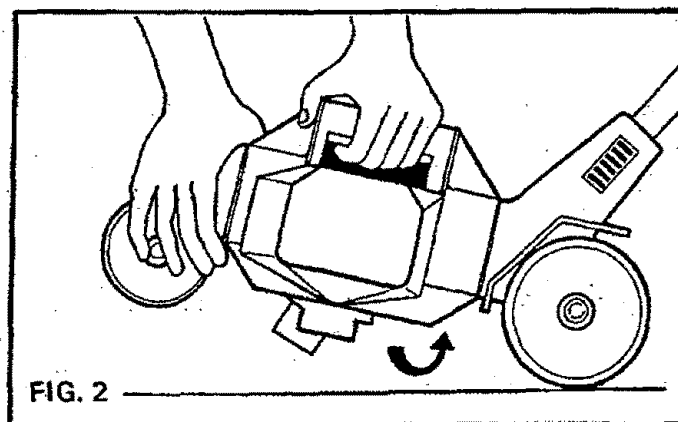

TO ADJUST CUTTING DEPTH OF EDGER:

Depress lock button and pull wheels forward to desired position.

Select wheel height to obtain a cutting depth of approximately 1-1/4 inches.

Change wheel adjustment, as necessary, to compensate for blade wear. (Fig. 3)

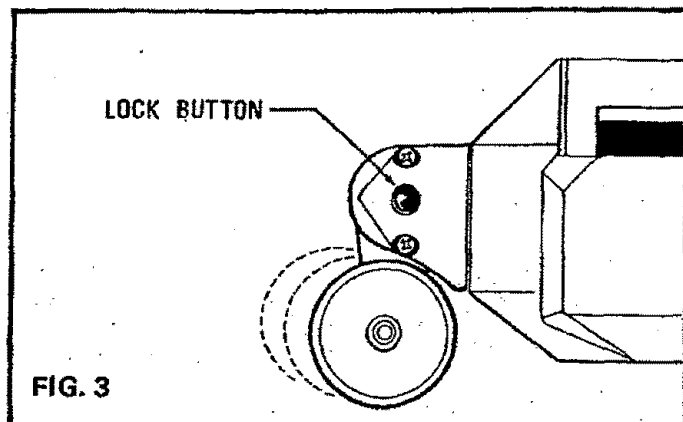

OPERATING INSTRUCTIONS

BEFORE OPERATING:

Read and understand the safety rules for power tools.

Always wear safety goggles.

Keep people at a safe distance.

Inspect area for wires, glass, and other foreign objects.

Tie extension cord as shown in Figure 4. Devices for retaining extension cords are also available at your nearest Sears store.

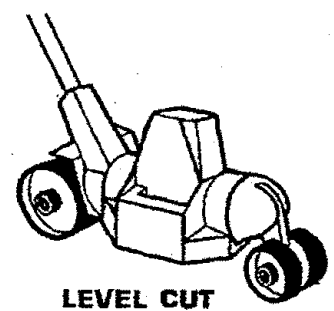
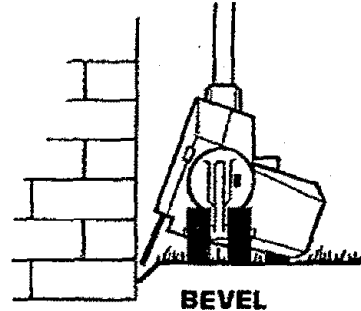
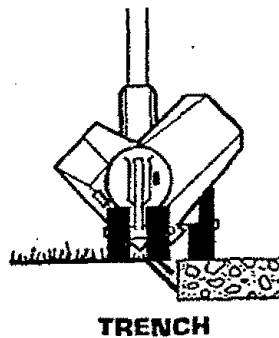
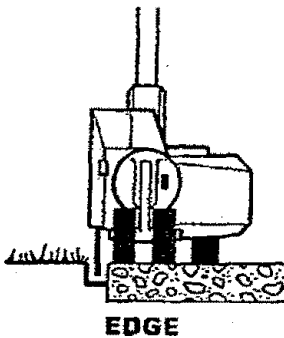
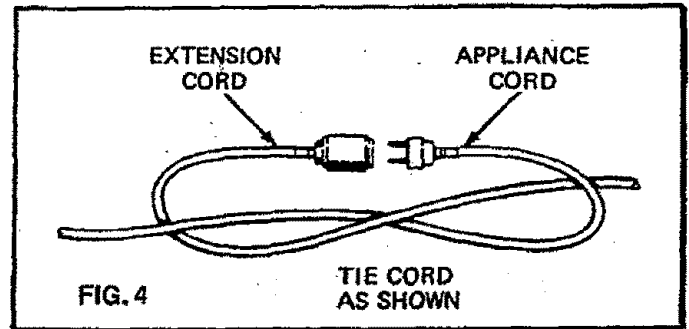

To EDGE:

The wheels should be run on the walk with the guide against the edge of the walk. Best results are obtained when you allow the tool to run at close to full speed. Do not push tool too fast so that motor stalls. Back up quickly if stalling occurs and allow tool to run at full speed.

To TRENCH:

Place Edger in position shown above. Trenching provides a wider margin between the lawn and the walk. Trenching removes more material and therefore increases the motor load. Be careful to move slowly to avoid motor stalling or overload.

DYNAMIC BRAKE:

Your edger is equipped with a dynamic brake. This feature uses the energy of the motor to stop the spinning blade when the switch is released.

To BEVEL:

Place Edger in position shown above. Beveling allows you to edge closer to walks or planters. The edge guide does not function in this position and care should be taken to avoid allowing blade to strike the wall or submerged footings.

To LEVEL CUT:

Place Edger in position shown above. Level cutting allows you to cut grasses similar to a lawn mower. Level cutting is practical for only small areas and is not intended as a lawn mower substitute.



THE OPERATION OF ANY EDGER CAN RESULT IN FOREIGN OBJECTS BEING THROWN INTO THE EYES, WHICH CAN RESULT IN SEVERE EYE DAMAGE. ALWAYS WEAR SAFETY GLASSES OR EYE SHIELDS BEFORE COMMENCING POWER TOOL OPERATION. WE RECOMMEND A WIDE VISION SAFETY MASK FOR OVER SPECTACLES OR STANDARD SAFETY GLASSES AVAILABLE AT SEARS RETAIL OR CATALOG STORES.

FORESIGHT IS BETTER THAN NO SIGHT.

KEEP BLADE AREA CLEAN

Mud and grass around blade area must be cleaned away regularly.

Make sure Edger is unplugged. Depress latch on side guard to open. Clean out accumulated debris.

CAUTION: Do not operate tool with side guard detached or open.

RECOMMENDED BLADE REPLACEMENT.

To maintain operating efficiency replace blade before wear decreases length to six inches.

The blade supplied is specifically designed for this Edger. Use of improper blades may be hazardous.

A replacement blade (Stock No. 85767) or a package of three (Stock No. 85762) may be purchased from your nearest Sears store or catalog outlet.

TO REPLACE BLADE

1. Make certain power cord is unplugged.
2. Depress spring latch located at front of side guard, shielding the blade, and open.
3. On each end of the lockwasher strap, bend back the tabs that prevent the hex nuts from working loose.
4. With a suitable wrench, turn both hex nuts counterclockwise and remove them.
5. Remove washers, lockwasher strap, and blade.
6. Place new blade in position over both bolts. (Either side of blade can face outwards.)
7. Replace lockwasher strap and washers — be sure tabs are flat.
8. Replace both hex nuts and tighten securely.
9. At each end of the lockwasher strap, bend one of the tabs upward. (See Fig. 6)
10. Close side guard.

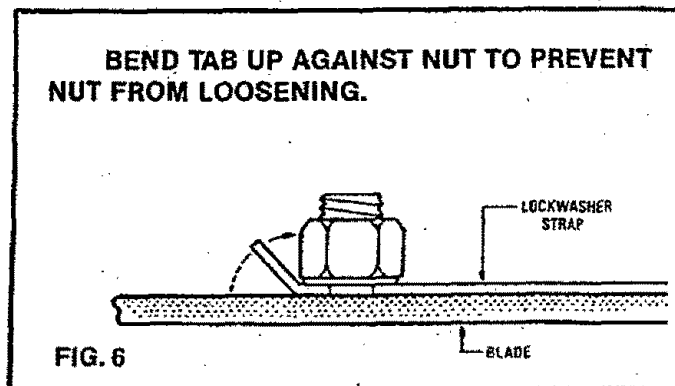
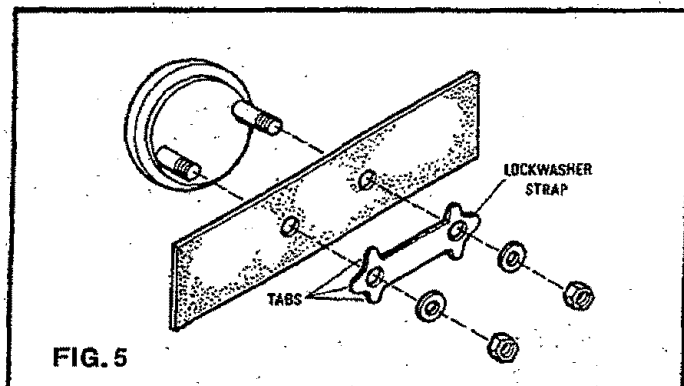

MODEL 257.857240 EXPLODED VIEW

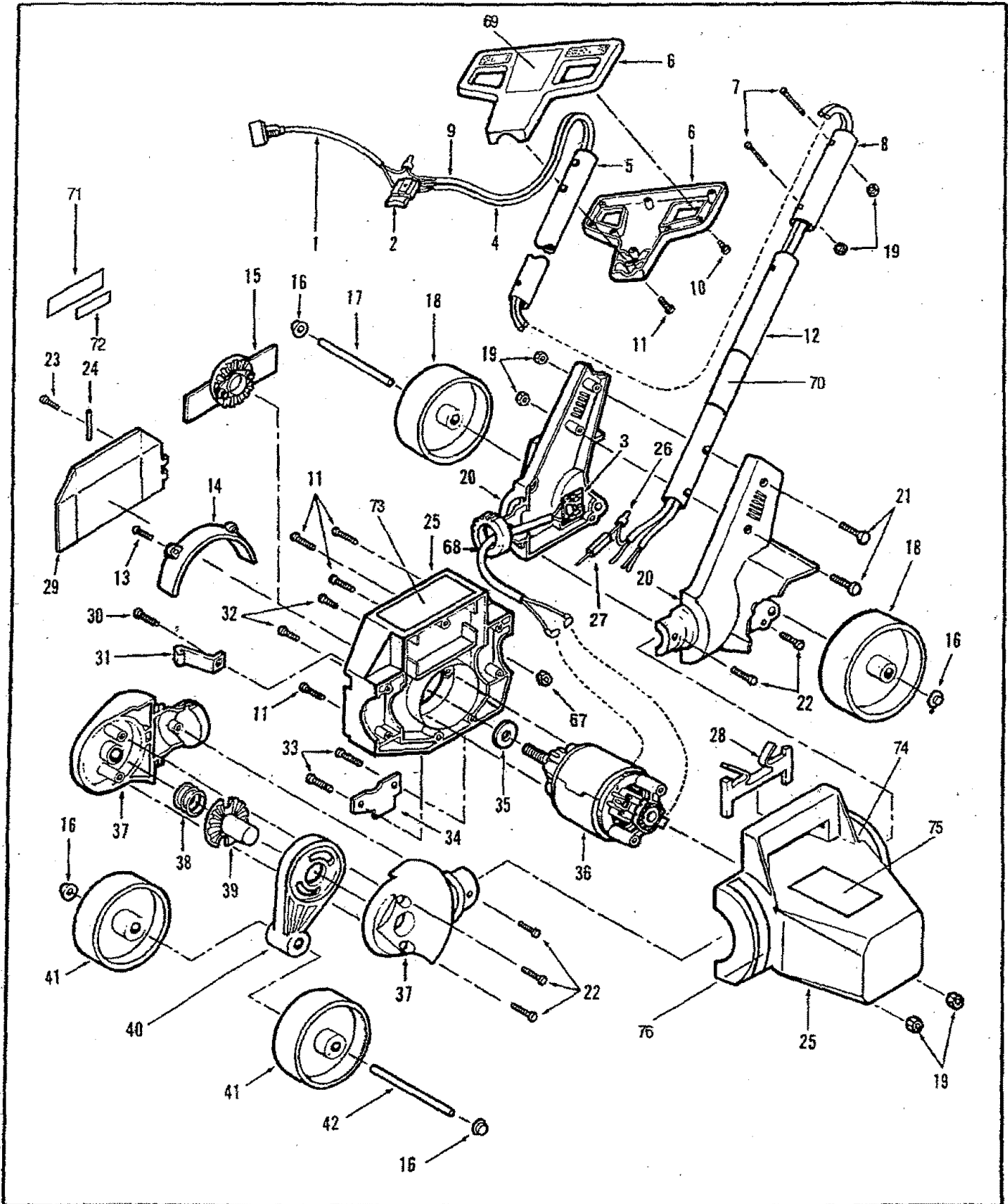

MODEL 257.857240 PARTS LIST

REF. NO.	PART NO.	DESCRIPTION	QTY.	REF. NO.	PART NO.	DESCRIPTION	QTY.
1	2345	Power Cord	1	65	1366	Lock Washer	2
2	1930-4	Switch, Trigger	1	66	1362	Nut 1/4-20 Hex	1
3	3365-1	P. C. Bridge-Kit	1	67	2615	Nut, 6-32 Hex	1
4	1623-20	Harness, (Red & White)	1	68	4883	Harness, Assy., Motor	1
5	4344-2	Tube, Upper	1	69.	5469	Label, Handle	1
6	2342-25	Handle—Top & Bottom	1(set)	70.	4346	Label, Warning	1
7	1745-2	Screw, 10-24x1-1/4	2	71.	4347	Label, Dynamic Brake	1
8	4343-1	Tube, Outer	1	72.	5468	Label, Clean Out	1
9	4863	Harness (Black & Yellow)	1	73.	4349	Label, Name Plate	1
10	1847	Screw, 10-16 x 5/8	5	74.	4345-1	Label, Rear Position	1
11	2224	Screw, 10-16 x 1	9	75.	4574	Label, Housing Position	1
12	4344-3	Tube, Lower	1	76.	4345	Label, Front Position	1
13	2242-2	Screw	2	77.	88-405-00	Owners Manual	1
14	5510-05	Liner	1				
15	1352-05	Blade Assy.	1				
16	1210	Push Nut	4				
17	781-1	Axle, Rear	1				
18	2368	Wheel, Rear	2				
19	2359-1	Nut 10-24 Hex	6				
20	3962-04	Rear Swivel R/L.H.	1 (set)				
21	1745-1	Screw 10-24x1-3/4	2				
22	2224-2	Screw 10-16x3/4	5				
23	4888	Screw, 6-32x1/2	1				
24	3272	Hinge Pin	1				
25	Q4472-04	Housing-Set	1				
26	561	Terminal Cap	2				
27	1345	Resistor (Dynamic Brake)	1				
28	3964-05	Latch, Release	1				
29	3968-08	Blade Cover	1				
30	2224-4	Screw, 10-16x1-1/2	1				
31	3963-05	Latch, Side Plate	1				
32	1364-1	Screw, 10-32 x 5/8	2				
33	4245	Screw, 10-24 x 2.38	2				
34	3969	Edge Guide	1				
35	1361	Washer, Thrust	1				
36	2250-15	Motor Assy	1				
37	3960-04	Front Swivel R/L.H	1(set)				
38	4247	Spring, Compression	1				
39	3967-05	Latch, Wheel Pivot	1				
40	3961-04	Arm, Wheel Pivot	1				
41	P-24-3	Wheel, Front	2				
42	781-12	Axle, Front	1				
43	2287-4	Screw, 10-32	2				
44.	2071-1	Endbell Assy.-Drive	1				
45	2288	Washer-Thrust	2				
46	2270-5	Field Assy.	1				
47	747-2	Retaining Ring	1				
48	2251-22	Armature Assy.	1				
49	2467	Retaining Ring	1				
50	2389-3	Washer, Bellville	1				
51	2275-1 -	Endbell Assy.-Brush	1				
52	2260	Insulator	1				
53	2278	Brush, Carbon	2				
54	2280	Spring, Brush	2				
55	2277	Holder, Brush	2				
56	1359	Bolt 1/4-20x1	2				
57	1356-05	Sleeve, Insulating	2				
58	1354	Plate, Clutch	1				
59	1363	Washer, Thrust	1				
60	2389	Washer, Load Spring	1				
61	1355	Sleeve, Clutch	1				
62	1353-05	Fan	1				
63	2053	Blade (85767)	1				
64	1357	Lock Strap	1				

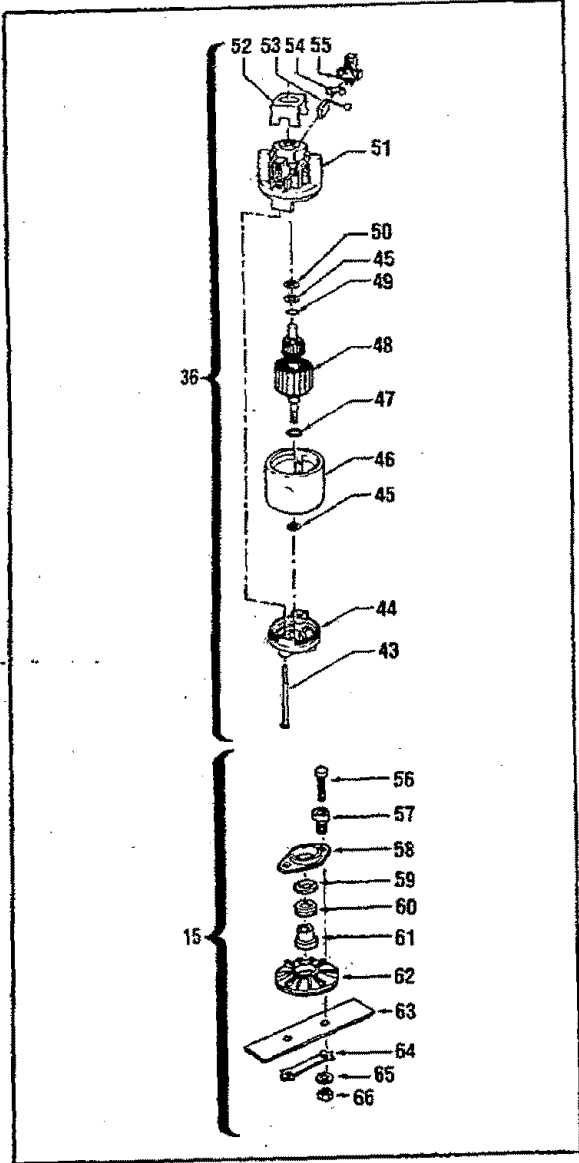

Sears

OWNER'S MANUAL

MODEL NO.
257.857240

Sears
SERVICE
is at
YOUR
SERVICE.

HOW TO ORDER REPAIR PARTS

The Model Number will be found on a plate attached to your handle tube. Always mention the Model Number when requesting service or repair parts for your Sears Edger.

All parts listed herein may be ordered from any SEARS, ROEBUCK AND CO. retail or catalog store.

WHEN ORDERING REPAIR PARTS, ALWAYS GIVE THE FOLLOWING INFORMATION:

1. PART NUMBER
2. PART DESCRIPTION
3. MODEL NUMBER — 257.857240
4. NAME OF ITEM — ELECTRIC EDGER
DOUBLE INSULATED

USE ONLY SEARS REPLACEMENT PARTS.

If the parts you need are not stocked locally, your order will be electronically transmitted to a Sears Repair Parts Distribution Center for expedited handling.

Your Sears merchandise has added value when you consider that Sears has service units staffed with Sears trained technicians...*professional technicians specifically trained on Sears products, having the parts, tools and equipment to insure that we meet our pledge to you...we service what we sell.*

Sold by SEARS, ROEBUCK AND CO., Chicago, IL 60684 U.S.A.