

Haier

Top Load
Clothes Washer

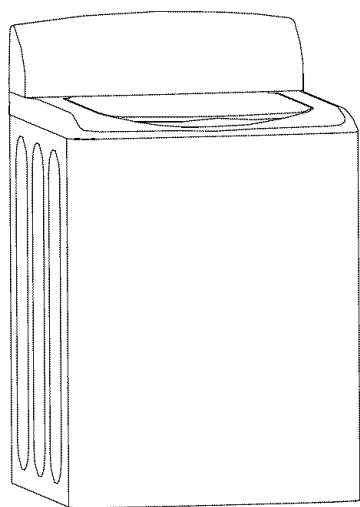

User Manual-

Model #

HLT364XXQ

IMPORTANT SAFETY INSTRUCTIONS

Warning - To reduce the risk of fire, electric shock, or injury to persons when using your appliance, follow basic precautions, including the following:

1. **Read all instructions before using the appliance.**
2. Use this appliance only for its intended purpose as described in this use and care guide.
3. Use only detergents or softeners recommended for use in a clothes washer and keep them out of the reach of children.
4. This washer must be properly installed in accordance with the installation instructions before it is used.
5. Never unplug your washer by pulling on the power cord. Always grasp the plug firmly and pull straight out from the outlet.
6. If the supply cord is damaged, it must be replaced by the manufacturer or an authorised service agent in order to avoid a hazard.
7. Unplug your washer before cleaning or before making any repairs.
8. If your old washer is not being used, we recommend that you remove the door. This will reduce the possibility of danger to children.
9. Do not operate your washer in the presence of explosive fumes.
10. Do not use the washer to wash clothes soaked, spotted or washed in gasoline, dry cleaning solvents or any other explosive or flammable substances that could ignite and explode.
11. Clothes or rags used to clean flammable or explosive materials should not be washed in the washer until all traces of this material have been removed, to avoid an accident.
12. Do not add or mix any flammable or explosive substances with the wash.
13. Do not try to remove clothes while the tub or the agitator is moving. Let it come to a complete stop first.
14. Washer loading door must be closed when agitator and tub is spinning
15. Do not operate your washer when parts are missing or parts are broken.
16. Do not use the washer for commercial clothes washing
17. Do not operate washer unless all enclosure panels are properly in place.
18. Do not tamper with controls.
19. To reduce risk of injury do not allow children to play in or on the washer
20. The washer must be connected to a proper electrical outlet with the correct electrical supply

21. Proper grounding must be ensured to reduce the risk of shock and fire. **DO NOT CUT OR REMOVE THE GROUNDING PLUG.** If you do not have a three-prong electric receptacle outlet in the wall, have a certified electrician install the proper receptacle. The wall receptacle **MUST** be properly grounded.
22. Hydrogen gas may be produced if the water heater has not been used in more than 2 weeks. This could be explosive and can explode under certain circumstances. If this is the case, before using the washer turn on all the hot faucets and let the hot water run for a few minutes. This will let the trapped hydrogen escape. During this process do not turn on an electric appliance, smoke, light a match/lighter or use a flame to avoid an accident, as hydrogen gas is flammable and can explode.

SAVE THESE INSTRUCTIONS
For Future Use

DANGER

Risk of child entrapment. Before you throw away your old washer, take off the door so that children may not easily get trapped inside.

Thank you for using our Haier product. This easy-to-use manual will guide you in getting the best use of your washer.

_____ **Model number**

_____ **Serial number**

Remember to record the model and serial number. They are on a label in back of the washer.

_____ **Date of purchase**

Staple your receipt to your manual. You will need it to obtain warranty service.

Table Of Contents

	PAGE
IMPORTANT SAFETY INSTRUCTIONS	1
OPERATING INSTRUCTIONS	4
Parts and Features.....	4
Operations	5
Normal Operating Sounds.....	8
Lint Filter	9
Care and Cleaning Guide	10
Cleaning and Maintenance.....	10
Moving and Vacationing.....	11
Storage of Your Washer.....	11
Troubleshooting	12
INSTALLATION INSTRUCTIONS	14
Tools and Materials Required.....	14
Unpacking Your Washer	15
Levelling Your Washer	15
Steps for Installation	16
Electrical Connections	18
Grounding Instructions.....	18
Power Interruptions.....	18

OPERATING INSTRUCTIONS

Parts and Features

Control Panel

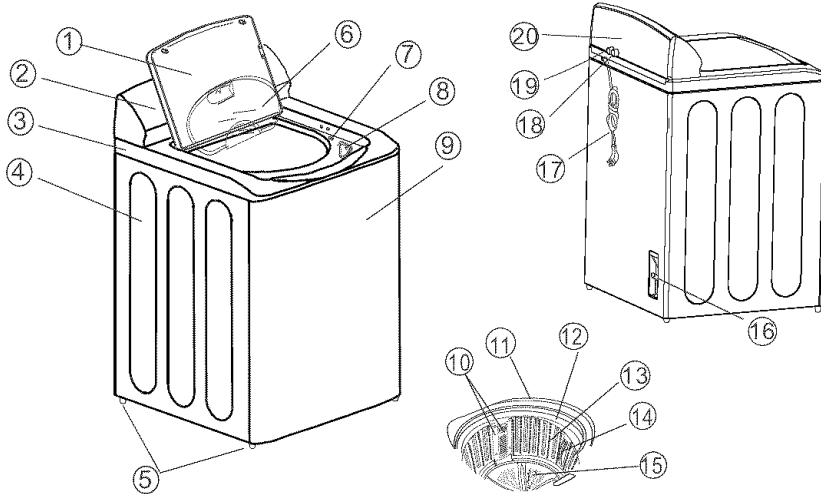
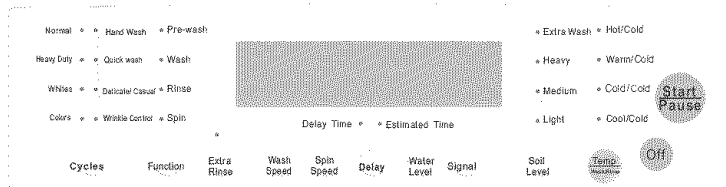

- | | | |
|-----------------------|---------------------------|----------------------------|
| 1. Top lid | 8. Bleach injection inlet | 15. Pulsator |
| 2. Control panel | 9. Front door | 16. Drain hose joint |
| 3. Control panel seat | 10. Filter, filter cover | 17. Power cord |
| 4. Cabinet | 11. Outer tub cover | 18. Cold water inlet valve |
| 5. Leveling legs | 12. Balance ring | 19. Hot water inlet valve |
| 6. Inner cover | 13. Inner tub | 20. Back cover |
| 7. Door switch | 14. Stick | |

Operations

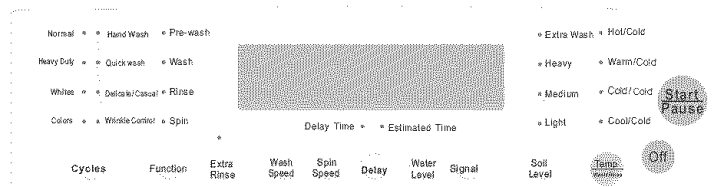

Delay Start

- When not activated the display shows cycle remaining time through the wash process.
- When Delay Start is selected the indicator light will display a minimum delay of 2 hours. Push button once for every additional 1 hour delay for up to 24 hours.

Cycles

- Normal-For regular washing . Such as cotton, flax.
- Heavy-For washing bigger, thicker and heavier dirty laundries.
- White-For washing cotton fabrics.
- Color-for washing color fabrics.
- Quick- For quick washing of light dirty laundries.
- Delicate- For washing of delicate fabrics.
- Hand wash-To have hand wash effect on clothes.
- Wrinkle Control-For washing wrinkle fabrics.

Process Select

This is to select washing process.

- Soak will not work in the cycles: Hand Wash, Quick Wash, Delicate Casual and Wrinkle Control.
- Water level indicator will shut off if only Spin is selected.

Extra Rinse

- Once a program is selected, press this button to have 2nd rinse. The washer will add a 2nd rinse.

Wash Speed/Spin Speed

- For selecting the speed of washing or spinning .

Water level

Water levels may be set at the beginning of the wash or at pause.

During Soak, Wash or Rinse press this button to manually replenish water. Release to stop. Function automatically is inactive when water reaches the overflow protection level.

Cycle Signal

Signal volume can be adjusted softer, louder or off.

Soil Level

Select clothes soil level.

Wash cycle increases 2 minutes for every soil level increased

Temperature Wash/Rinse

To select inlet water temperature for wash and rinse.

Power On/Off

Push the "Power On/Off" button to switch the machine on or off.

Start/Pause

Once washer is powered and selections are chosen, push this button once to start the wash.

While unit is working, push this button once to pause it.

If unit is in Pause mode, push this button once to resume operation.

Delay Start and Estimated Time Indicator

Indicates remaining minutes when cycle is in progress.

Indicates remaining hours during delay process.

Indicates fault codes or conditions that are not normal.

Loading the Washer:

- Load each item loosely.
- Separate the white and coloured clothes. Separate heavy clothes from light clothes.
- Carefully check all pockets and cuffs for small items. They can easily slide into the tub and may damage the tub.
- Pre-treat all stains and heavily soiled areas for best results.
- Do not overload your washer
- When loading wet items, keep water level high enough so items can float easily in the water.
- Close the door properly after loading the clothes. If you keep the lid up, the agitation will not start.

Proper Use of Detergent:

- It is good washing practice to add the detergent to the water before you add the clothes so that the detergent can work effectively on your clothes.

Note: You can use less or more detergent depending on the size of the load, water type in your living area, whether the water is soft or hard and whether the clothes are heavily soiled or lightly soiled.

Bleach Dispenser:

- The bleach dispenser is located on the front corner under the loading door
- Pour in the recommended amount of bleach into the dispenser during the first wash fill.

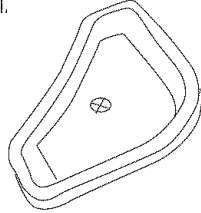

Note: Use only liquid bleach in dispenser.

- Warning:**
- Be careful not to spill undiluted bleach on the washer cabinet or on your clothes. As it is a strong chemical, it may damage some of your clothes or the finish of the washer if not properly diluted.
 - Use the manufacturer's chart, on the product container for the recommended use of liquid or powder bleach.

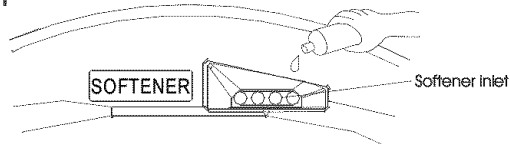
Softener inlet**Normal Operating Sounds**

- The following sounds are normally heard during the operation of the washer:
- Tumbling sounds: This is normal as the heavy wet clothes in the washer are continuously being tossed around.
- Air rushing noise: This happens when the washer tub spins at very high spinning speed.
- Wash and Rinse cycles going on and off will also make clicking sounds.

Lint Filter

The lint filter must be used during washing.
It must be cleaned after each wash.

1. Take off the lint filter.
2. Clean out the lint in the filter.
3. Install the lint filter.

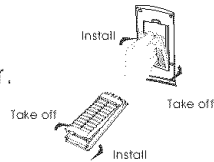

Install the inner cover

1. Open the top lid of the washing machine.
2. Put the inner cover component on the outer tub cover, lining up the inner cover shaft to the installation hole of the corresponding outer tub cover shaft groove.
3. Firstly insert the inner cover shaft of one side into the corresponding outer tub cover shaft groove, then push the other inner cover shaft into the corresponding outer tub cover shaft groove. Please install in the designated position to guarantee there is no abnormal sound in opening and closing of the inner cover, and the operation shall be smooth. Do not remove the inner cover component after washing.



CARE AND CLEANING GUIDE

Warning: Always unplug your washer to avoid electric shock before cleaning. Ignoring this warning may result in injury. Before using cleaning products, always read and follow manufacturer warnings to avoid personal injury or product damage.

Cleaning and Maintenance

Use only damp or sudsy cloth for cleaning control panel.

To avoid any kind of damage to cabinet finish, wipe washer cabinet as needed. If you spill liquid/powdered softener bleach or detergent on the cabinet, wipe cabinet immediately because it can damage the finish.

Do not use any abrasive, harsh chemicals, ammonia, chlorine bleach, concentrated detergent, solvents or metal scouring pads. Some of these chemicals may dissolve, damage or discolor your washer.

Remove pins or other sharp objects from clothes to prevent scratching of interior parts.

Leave lid open after you are done washing to allow inside of washer to dry and prevent bad odors.

Moving & Vacationing

- Turn off the water supply faucets and disconnect the hoses. Drain water from all of the hoses. This will prevent damage due to water leakage if the hoses accidentally get ruptured or they become loose.
- Disconnect the electrical plug
- Dry the inner wash tub. If you are moving the washer, disconnect the drain hose.
- Turn the levelling legs clockwise all the way in.
- Move and store your washer in an upright position only .
- To prevent mould or mildew, leave the lid open so moisture inside the machine can evaporate.

Storage of Your Washer

- The washer must be stored at room temperature.
- If you have received a washer when the outside temperature is below freezing do not operate until the washer has warmed to room temperature.
- Do not install or operate your washer where the room temperature is below freezing.

Troubleshooting

The washer does not operate:

- Check if the unit is plugged in. The plug may have come loose.
- Check if the electrical wall receptacle is of proper voltage.
- Check if the circuit breaker needs to be reset or if the fuse needs to be replaced.
- Check if the washer is overloaded: the load may need to be re-balanced and clothes may need to be redistributed.
- Check if the lid is open. You may have to close the lid properly.
- The washer pauses in some cycles. This is normal in some cycles, which has a short soak period. You will not hear the washer in operation for a short period of time. When the soak time is over, it will start automatically.

Problems with water:

- Not enough water coming out: Water faucet may need to be turned on fully. Water hoses may be tangled or wrinkled up. Straighten up the hoses. Check the water level selection, it may need to be readjusted.
- Water temperature is incorrect: Check your water heater temperature. Hot water needs to be at a temperature of at least 120 F -140 F (49 C-60 C). Check to make sure the inlet hoses are properly connected.(e.g.hot to hot & cold to cold)
- Water leaks: This is due to not properly installing the drain hose or the fill hoses. Your home drain may be clogged or may not have constant water pressure. You may need to tighten hoses, check the plumbing or call a plumber.
- The water will not drain: This is due to not installing your drain hose properly. You may need to connect the drain hose properly. Check the position of the drain hose. In order to drain the water properly, make sure that the top of the drain outlet is less than 4 ft.(1.2m) above the floor.

Washer is making noise:

Washer may need to be reinstalled. (Check washer installation section)

Washer load may need to be re-balanced, as the load may be uneven.

Coins, loose change, buttons or other heavy objects could make noise(read Operating Guide-Normal Operating Sounds).

Squealing sound: Due to overloaded wash tub.

Vibration Noise: Due to not leveling washer properly on the floor and uneven distribution of clothes in the tub.

Problems with clothes:

Clothes are too wrinkled: this is due to improper sorting, overloading and washing in too hot water repeatedly. Avoid overloading and resort your load. Do not mix heavy clothes such as work clothes with light clothes such as blouses, light shirts and delicate items. You may need to wash in warm or cold water.

Have soap residue: detergent may not be dissolving in water.

Check water temperature or you need to add detergent as wash tub is being filled with water.

Spots or stains on your clothes: this is due to incorrect use of fabric softener. You may need to read proper instructions on the container and follow proper directions when using the softener.

Clothes are grayed or yellowed: this is due to not pouring enough detergent for large loads. You may have to add more detergent to the load.

Clothes are ripped & have holes/excessive wear & tear: this is due to sharp objects such as pins and belt buckles left in pockets. You will need to remove small loose sharp objects. Fasten belts, zippers, metal snaps etc. Check if you are using undiluted bleach. Never add undiluted bleach to wash.

Note:

Trouble Codes	Reason
E0	Top lid not closed during delay start sequence
E1	Blockage of drain hose
E2	Top lid not closed during wash operation
E4	The water inlet time exceeds the preset time (30minutes)
E7	The communication is bad
F2	The protection of water overflow

INSTALLATION INSTRUCTIONS

Tools and Materials Required

You will need to have the following tools to help you in the installation of your washer:

- Pliers
- Wrench
- Tape Measure
- Gloves
- Level

Accessories Supplied	Quantity
1. Hot & Cold Inlet hoses	2
2. Drain Hose Hook	1
3. Pipe Hoop	1
4. Inner Tub Cover	1
5. Outer Drain Hose	1

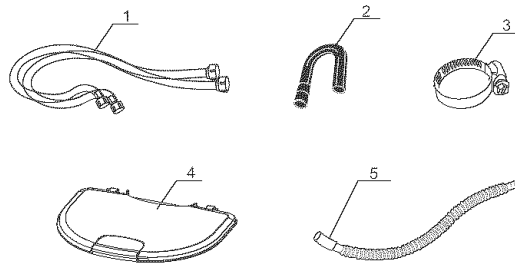

Unpacking Your Washer

- Remove all packing materials. This includes the foam base and all adhesive tape holding the washer accessories inside and outside
- Open the top lid to remove the styrofoam drum brace. Pull to remove.
- Before using this washing machine, please remove this shipping bar by pulling handle and dispose it properly, otherwise the washing machine will be damaged.

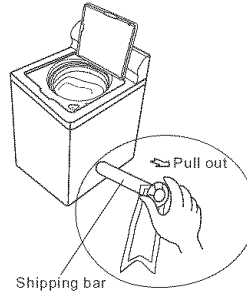

Leveling Your Washer

Your washer has 4 leveling legs; which are located on the bottom corners. After properly placing your washer in its final position, you can level your washer.

Leveling legs can be adjusted by turning them counter clockwise to raise your washer or turning them clockwise to lower your washer.

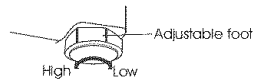

Warning: Leveling of washer is very important to prevent vibration during spin.

Steps for Installation

- Select a away suitable location for the washer on a hard even surface from direct sunlight or heat source e.g. radiators, base board heaters, cooking appliances etc. Any floor unevenness should be corrected with the leveling legs located on the bottom corners of the washer. The washer must be placed at room temperature. You must not place washer where the temperature is at below freezing.

Installing Your Washer:

Read through these instructions carefully before installation.

1. Connect the hot and cold water inlet hoses to the hot and cold water faucet.

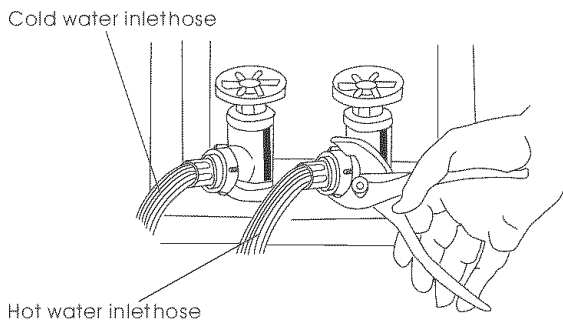

2. Connect the other end to the corresponding washer inlet located at the back of machine.

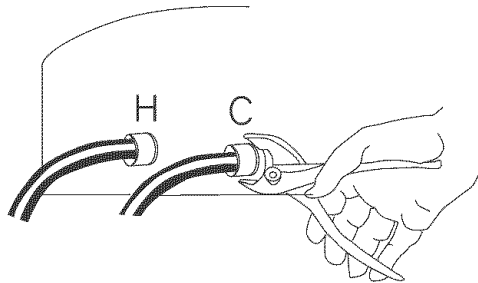

Note: You may have to use pliers to tighten the coupling. Do not over tighten because you may cause damage to the valve.

You should use the new hose-sets supplied with the washer. Old hose-sets should not be reused.

3. Install the drain hose hook to the outer drain hose tube. Using the drain hose clamp, attach the drain hose to the unit as shown below.

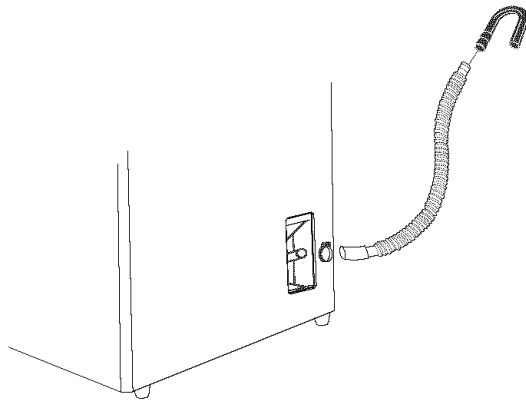

4. Plug the washer into a regular 120Volt/60Hz, 10Amps outlet.

Note : Carefully inspect all around the machine and at the back for any leaks, and tighten any loose connections.

Caution: If, after completing these steps, you are unsure that unit is properly installed, contact a qualified installer. To ensure that your washer is properly installed, it is recommended that it be installed by a certified installer.

Electrical Connections

Grounding Instructions

This appliance must be grounded. In the event of an electrical short circuit, grounding reduces the risk of electric shock by providing an escape wire for the electric current. This appliance is equipped with a cord having a grounding wire with a grounded plug. The plug must be inserted into an outlet that is properly installed and grounded.



Improper use of the plug can result in a risk of electric shock. Consult a qualified electrician or service person if the grounding instructions are not completely understood or if doubt exists as to whether the appliance is properly grounded.

Wiring Requirements:

The washer must be plugged into at least 10AMP 120VOLT 60 HZ GROUNDED OUTLET.

Note: Where a standard two-prong outlet is encountered, it is the personal responsibility and obligation of the consumer to have it replaced with a properly grounded three-prong outlet.

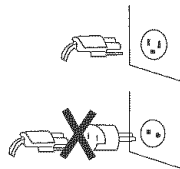

Extension Cords:

We do not recommend that you use an extension cord.

Power Interruptions

Occasionally there may be power interruptions due to thunderstorms or other causes. Remove the power cord from AC outlet when a power outage occurs. When power has been restored re-plug power cord to AC outlet. If outage is for a prolonged period, clean washer before using it again.