



OWNER'S MANUAL
Operating and Servicing Instructions

Find **GENUINE** Replacement Parts at
www.dirtdevil.com

This cleaner uses the following parts:

BELT STYLE	5
FILTER TYPE	F13

- Please read these instructions carefully before using your Upright.
- Let us help you put your vacuum together or answer any questions, call:

1-800-321-1134
(USA & Canada)
www.dirtdevil.com

⚠ WARNING:
Cleaner assembly may include small parts.
Small parts can present a choking hazard.

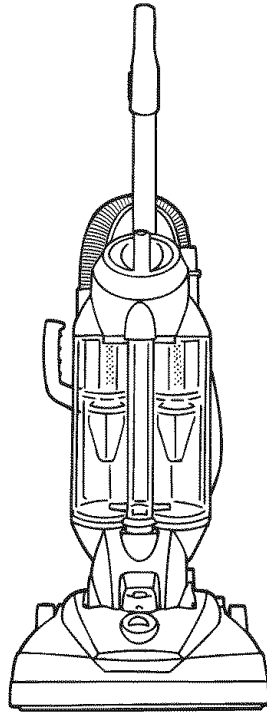

Warranty Registration

- Online at: www.dirtdevil.com
- Mail: Royal Appliance Mfg
7005 Cochran Rd.
Glenwillow, Ohio 44139

For quick reference, please record your vacuum information below.

Model #: _____
Mfg. Code: _____
(Mfg. code located on the lower backside of cleaner)

THIS VACUUM CLEANER IS INTENDED FOR HOUSEHOLD USE ONLY.
IMPORTANT SAFETY INSTRUCTIONS

When you use an appliance, basic precautions should always be followed, including the following:

- **READ ALL INSTRUCTIONS BEFORE USING THIS APPLIANCE.**
- **ALWAYS FOLLOW THESE SAFETY INSTRUCTIONS.**
- **BRING CLEANER TO UPRIGHT POSITION WHEN USING THE HOSE AND ATTACHMENTS.**
- **DO NOT LEAVE CLEANER UNATTENDED WHEN PLUGGED IN.**
- **REGULARLY CHECK THE FILTERS TO CLEAN OR REPLACE.**
- **WARNING: DO NOT USE SHARP OBJECTS TO CLEAN OUT THE HOSE SINCE THEY COULD CAUSE DAMAGE.**
- **OCCASIONALLY REMOVE BRUSH AND CLEAN DEBRIS FROM END CAPS TO KEEP BRUSH ROTATING SMOOTHLY.**
- **WARNING: THE CORDS, WIRES, AND/OR CABLES SUPPLIED WITH THIS PRODUCT CONTAINS CHEMICALS, INCLUDING LEAD OR LEAD COMPOUNDS, KNOWN TO THE STATE OF CALIFORNIA TO CAUSE CANCER AND BIRTH DEFECTS OR OTHER REPRODUCTIVE HARM. WASH HANDS AFTER USING.**

WARNING: TO REDUCE THE RISK OF FIRE, ELECTRIC SHOCK OR INJURY:

- Do not leave appliance when plugged in. Unplug from outlet when not in use and before servicing.
- Do not use outdoors or on wet surfaces. Electrical shock could occur.
- Do not allow to be used as a toy. Close attention is necessary when used by or near children.
- Use only as described in this manual. Use only manufacturer's recommended attachments.
- Do not use with damaged cord or plug. If appliance is not working as it should, has been dropped, damaged, left outdoors, or dropped into water, return it to a service center for inspection. Call 1-800-321-1134 for the nearest service center.
- Do not pull or carry by cord, use cord as handle, close a door on cord, or pull cord around sharp edges or corners. Do not run appliance over cord. Keep cord away from heated surfaces.
- Do not unplug by pulling on cord. To unplug, grasp the plug, not the cord.
- Do not handle plug or appliance with wet hands.
- Do not put any objects into openings. Do not use with any opening blocked; keep free of dust, lint, hair, and anything that may reduce air flow.
- Keep hair, loose clothing, fingers, and all parts of body away from openings and moving parts.
- Do not pick up anything that is burning or smoking, such as cigarettes, matches, or hot ashes.
- Do not use without dirt container and filters in place.

- Turn off all controls before unplugging.
- Use extra care when cleaning on stairs.
- Do not use to pick up flammable or combustible liquids, such as gasoline, or use in areas where they may be present.
- Keep the vacuum cleaner on the floor. Only the hand-held vacuum cleaners may be set on furniture.
- Cleaner must be in the upright position to lift the rotating brush off the carpet when doing above floor cleaning.
- Do not use an extension cord with this vacuum cleaner.
- Store the vacuum cleaner indoors. Put the vacuum cleaner away after use to prevent tripping accidents.
- Using improper voltage may result in damage to the motor and possible injury to the user. Proper voltage is listed on the cleaner plate.
- Unplug before connecting Power Brush Tool.

SAVE THESE INSTRUCTIONS

WARNING:

To reduce the risk of electric shock, this appliance has a polarized plug (one blade is wider than the other). This plug will fit in a polarized outlet only one way. If the plug does not fit fully in the outlet, reverse the plug. If it still does not fit, contact a qualified electrician to install the proper outlet. Do not change the plug in any way.

Your cleaner contains a thermal protective device to shut off the motor to avoid overheating. If this happens, turn switch off and unplug the cleaner. Inspect the exhaust, inlet, and filters for any blockage. Empty the dirt container and clean filters. After approximately 30 minutes the motor will have cooled and the vacuum will be ready to use. **Note:** *the cleaner must remain unplugged during the 30 minute cooling period.*

CONGRATULATIONS

You are now the proud owner of a Dirt Devil®. We trust your new purchase will bring you many years of satisfaction.

Our company designed and developed this product with you in mind.

We are very proud of our products and hope that you are equally satisfied with their quality and performance.

**Thank you for your support of Dirt Devil® products.
Visit our website at www.dirtdevil.com**

TABLE OF CONTENTS

Safety Instructions	Page 2, 3
Features	Page 5
How to Assemble	Page 6
How To Operate	Page 7, 8
Floor/Carpet Cleaning	Page 7
Above Floor Cleaning	Page 7, 8
Dirt Container & Filter: Removal & Replacement	Page 8, 9
Belt or Brush: Removal & Replacement	Page 10
Lightbulb: Removal & Replacement	Page 11
General Maintenance	Page 11
Troubleshooting Guide	Page 12

LIMITED WARRANTY

To the consumer, Royal Appliance Mfg. Co. warrants this vacuum cleaner to be free of defects in material or workmanship commencing upon the date of the original purchase. Refer to your vacuum cleaner carton for the length of warranty and save your original sales receipt to validate start of warranty period.

If the vacuum cleaner should become defective within the warranty period, we will repair or replace any defective parts free of charge. The complete machine must be delivered **prepaid** to any ROYAL® Authorized Sales & Warranty Service Station. Please include complete description of the problem, day of purchase, copy of original sales receipt and your name, address and telephone number. If you are not near a Warranty Station, call the factory for assistance at USA & Canada: 1-800-321-1134. Use only genuine Royal® replacement parts.

The warranty does not include unusual wear, damage resulting from accident or unreasonable use of the vacuum cleaner. This warranty does not cover brushes, bags, flat belts, filters and bulbs. This warranty does not cover unauthorized repairs. This warranty gives you specific legal rights and you may also have other rights (Other rights may vary from state to state in the USA).

**IMPORTANT: USE ONLY GENUINE ROYAL® REPLACEMENT PARTS.
NOTE: TO REGISTER YOUR PRODUCT, RETURN YOUR WARRANTY CARD OR REGISTER
ONLINE AT WWW.DIRTDEVIL.COM.**

FEATURES

FRONT

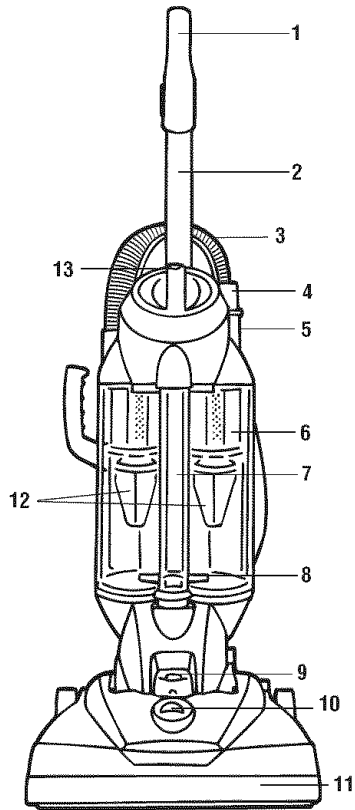

FRONT

1. Handle Grip
2. Handle
3. Hose
4. Crevice Tool (inside extension wand)
5. Extension Wand
6. Dirt Container
7. Center Dirt Path
8. Clean Release Empty Button
9. Headlight
10. Height Adjust Knob
11. Bumper
12. Air Directors
13. Dirt Container Release Button

BACK

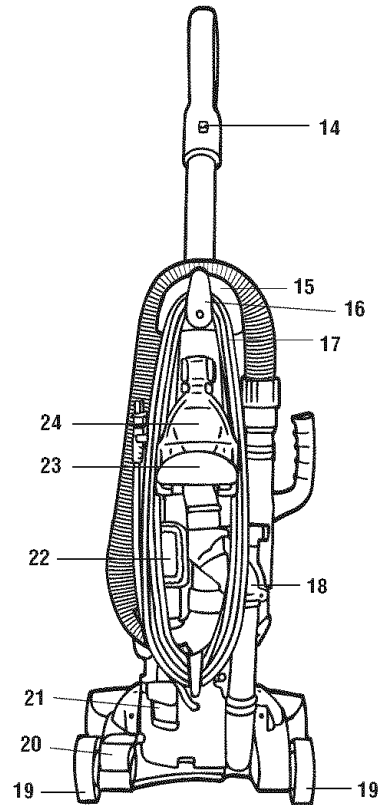

BACK

14. Cord Clip
15. Hose Guide
16. Cord Wrap With Quick Cord Release
17. Long Power Cord
18. Access Door
19. Wheels
20. Handle Release Pedal
21. On/Off Pedal
22. Dust Brush
23. Carry Handle/Power Brush Tool Caddy
24. Power Brush Tool

HOW TO ASSEMBLE

TOOL REQUIRED: PHILLIPS SCREWDRIVER

POWER BRUSH TOOL CADDY ASSEMBLY

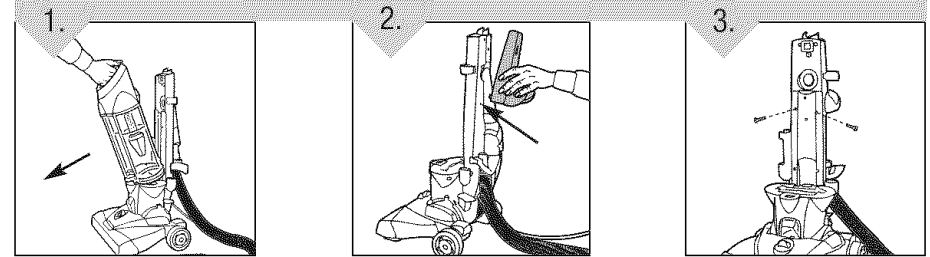

1. Detach dirt container from back panel of cleaner by pressing dirt container release button and tilting forward.

2. Insert Power Brush Tool caddy through holes in back panel.

3. Secure Power Brush Tool caddy with two (2) 1" screws through front of cleaner.

HANDLE ASSEMBLY

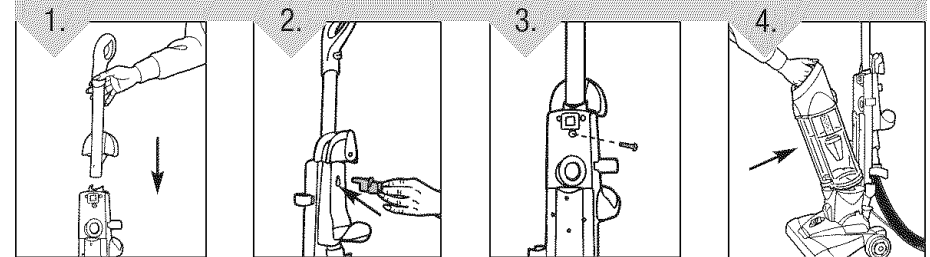

1. Slide handle through top of back panel.

2. Push handle plug through back of Power Brush Tool caddy.

3. Insert one (1) screw through front of cleaner to secure handle.

4. Reattach dirt container by aligning bottom of dirt container to bottom of cleaner and push forward to snap into place.

SECURE BACK HOSE

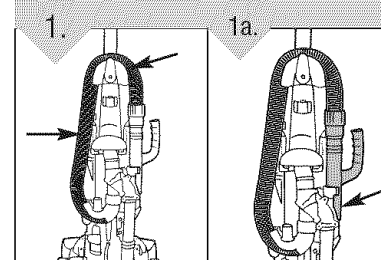

1. Wrap hose around back of hose caddy (Diagram 1). Push hose wand down into the right side of cleaner (Diagram 1a).

TOOL STORAGE

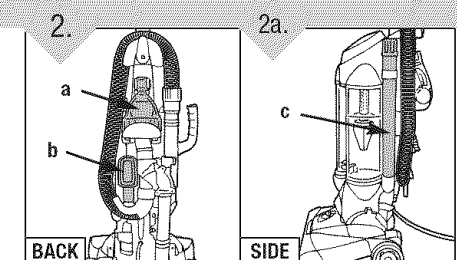

2. Attach tools: (a) Clip Power Brush Tool onto the top of the tool caddy. (b) Slide the dust brush onto post on the lower tool caddy with bristles facing out (Diagram 2). (c) Slide the extension wand/crevice tool into round slot on the left side of tool caddy (Diagram 2a).

HOW TO OPERATE

CORD RELEASE

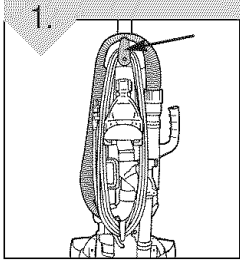

1. Turn Quick Cord Release for easy cord removal. Store cord in cord clip (see Features - pg. 5) to keep out of the way while vacuuming.

HEIGHT ADJUST LEVER

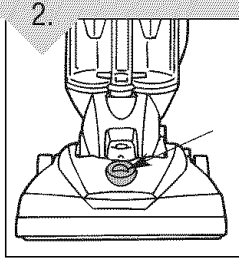

2. Turn the height adjustment knob to match the surface being cleaned. **IMPORTANT:** For easiest adjustment, place cleaner in full upright position.

CAUTION: Brush agitator continues to rotate while hose is removed or in use and at all times while cleaner is on. Keep hair, loose clothing, fingers, and all parts of body away from brush area while cleaner is on. Cleaner must be in the upright position to lift the rotation brush off the carpet when cleaning above the floor.

ON/OFF PEDAL

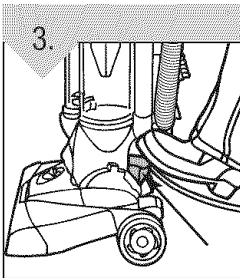

3. Plug cord into electrical outlet. Turn cleaner on by depressing foot pedal located on the back left side of the cleaner.

HANDLE RELEASE PEDAL

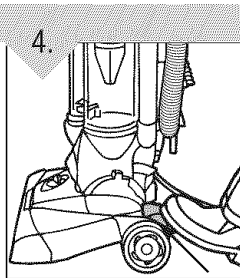

4. To release handle, push the handle release pedal located on the lower left side of the cleaner.

FLOOR/CARPET CLEANING

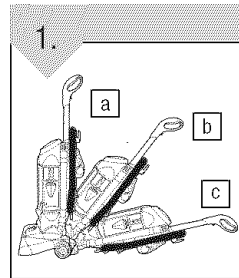

1. Move the handle and adjust it to the desired position for (a) storing the upright, (b) operating the cleaner, and (c) de-press the handle release pedal again to clean under furniture. **NOTE:** Rotating brush could cause area rug fringe to become tangled within cleaner. Use caution when vacuuming throw rugs with fringe.

ABOVE FLOOR CLEANING

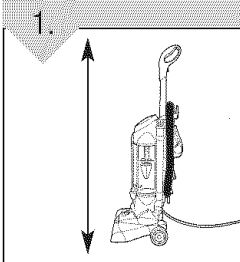

1. Cleaner must be in its upright position to raise brushroll.

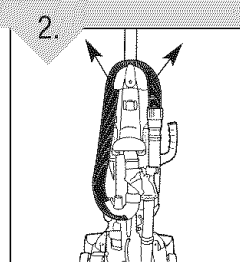

2. Remove the hose from the tool caddy.

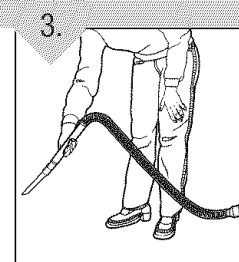

3. Choose any of the handy accessories or use the hose alone. Simply push the attachment firmly onto the end of the wand or hose handle. To remove tool, twist and pull apart gently.

HOW TO OPERATE: CONTINUED

EXTENSION WAND

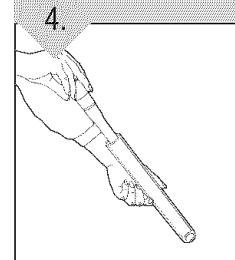

4. If additional length is needed, use the extension wand and crevice tool. Pull crevice tool out of extension wand. Use extension wand and crevice tool together or separately.

CARRY HANDLE

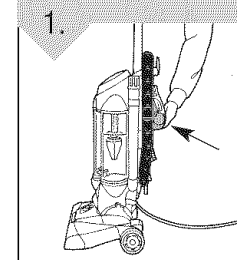

1. Use the carry handle on the Power Brush Tool caddy to move the cleaner from room to room.

DIRT CONTAINER & FILTER: REMOVAL & REPLACEMENT

WARNING: TO REDUCE THE RISK OF INJURY FROM MOVING PARTS - UNPLUG BEFORE SERVICING.

FILTER TYPE
F13

For F13 filter replacement, please visit our website at www.dirtdevil.com to buy online or call customer service at 1-800-321-1134.

EMPTY DIRT CONTAINER

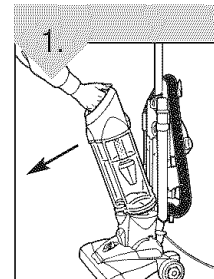

1. Press dirt container release button and remove dirt container from cleaner.

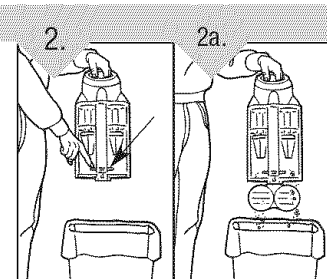

2. Hold dirt container over garbage can and press clean release dirt container button to empty. Snap dirt container bottom back into place after emptying.

REMOVE FILTER CARTRIDGE

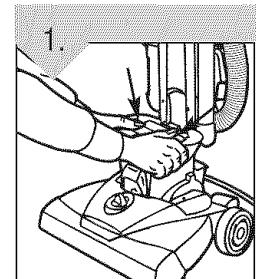

1. Click buttons on the base of the cleaner toward the outside edges to unlock filter cartridge.

REMOVE FOAM FILTER

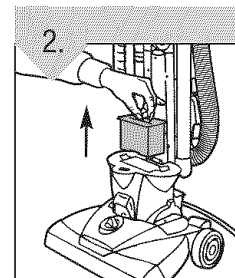

2. Lift filter cartridge out of base of cleaner.

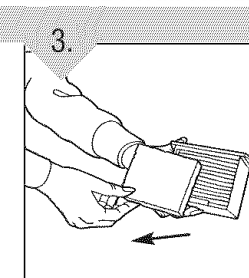

3. Remove foam filter from filter cartridge.

CLEAN PLEATED FILTER

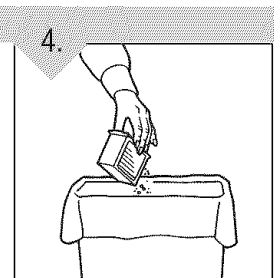

4. Tap the pleated filter on the inside of a garbage can to remove excess dust and dirt from filter. If filter is still clogged, rinse under running water and allow to dry for at least 24 hours before replacing in cleaner.

DIRT CONTAINER & FILTER REMOVAL & REPLACEMENT: CONTINUED

WASH FOAM FILTER

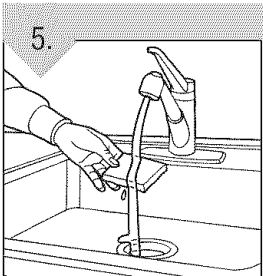

Hold foam filter under running water to wash. Ring excess water out of filter. Allow filter to dry for at least 24 hours before replacing in filter cartridge.

REPLACE FOAM FILTER

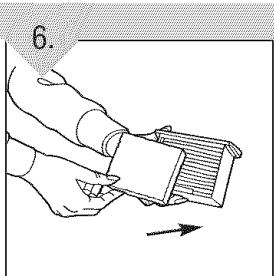

Return foam filter to filter cartridge.

REPLACE FILTER CARTRIDGE

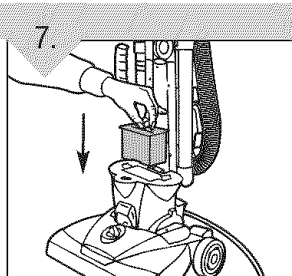

Return filter cartridge to base of cleaner.

TO CLEAN THE AIR DIRECTORS

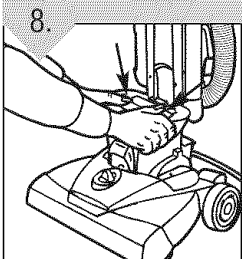

Click buttons back into place to lock filter cartridge in base of cleaner.

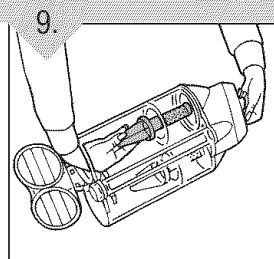

To remove Air Directors, rotate 1/4 turn counterclockwise.

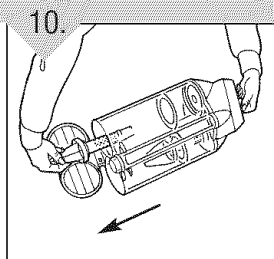

Pull out and wipe with a damp cloth to clean.

REPLACE DIRT CONTAINER

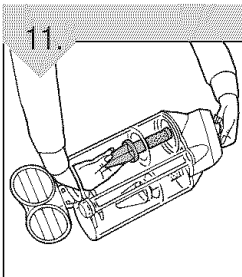

Dry and return the Air Directors to the dirt container. Rotate 1/4 turn clockwise to lock in place.

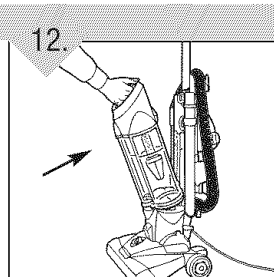

Return dirt container to cleaner. Align slot on bottom of dirt container with tab on cleaner. Push to snap into place.

***REGULAR MAINTENANCE:** Each time the dirt container is emptied, the filter should be cleaned. Tap the filter firmly against the inside of a trash can until the dirt stops falling from the filter. (Filter will be discolored after use, this will not affect the filter's performance.) Do not brush the filter. The cleaning instructions may vary depending on the dirt conditions. In some cases, more or less cleaning of the filter may be required.

BELT OR BRUSHROLL: REMOVAL & REPLACEMENT

TOOL REQUIRED: PHILLIPS OR FLATHEAD SCREWDRIVER

WARNING: TO REDUCE THE RISK OF INJURY FROM MOVING PARTS - UNPLUG CLEANER BEFORE CHANGING BELT OR BRUSHROLL.

BELT STYLE
5

For Belt Style 5 replacement, please visit our website at www.dirtdevil.com to buy online or call customer service at 1-800-321-1134.

TO REMOVE BELT

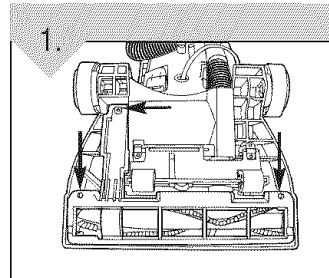

Lay cleaner flat and flip cleaner to expose nozzle base. Base should lay flat and face up. To remove nozzle guard, use Phillips screwdriver to remove the three (3) screws. Arrows show location of screws.

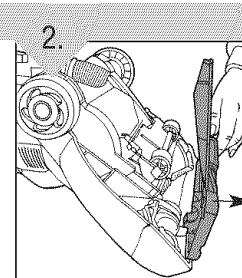

Pull and lift nozzle guard off.

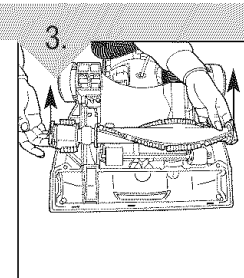

Lift and remove brushroll. Dispose of old belt.

TO REPLACE BELT OR BRUSHROLL

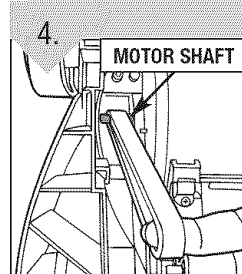

Slide belt onto motorshaft.

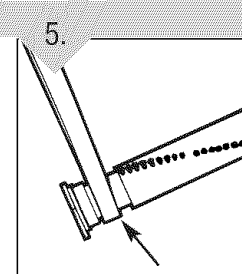

Place new belt in area of brushroll without bristles.

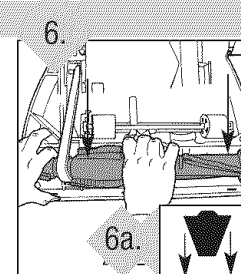

Rotate brushroll manually to make sure belt is properly aligned.

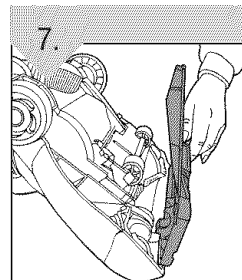

Reattach nozzle guard.

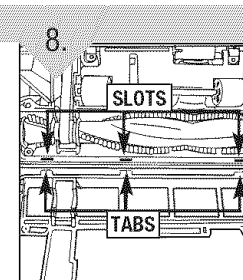

Secure by aligning the three (3) tabs in the base slots.

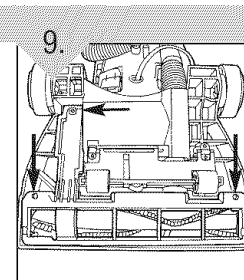

Replace all three (3) screws to secure nozzle guard.

LIGHTBULB: REMOVAL & REPLACEMENT

TOOL REQUIRED: FLATHEAD AND PHILLIPS SCREWDRIVER

WARNING: TO REDUCE THE RISK OF ELECTRIC SHOCK - UNPLUG CLEANER BEFORE REMOVING OR REPLACING LIGHTBULB.

This cleaner uses a common automotive lamp #906, 13.0 volts. For bulb replacement call 1-800-321-1134 or your local auto parts store.

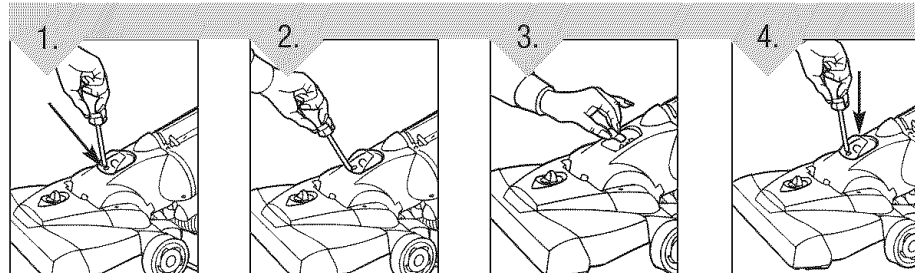

1. Lean cleaner handle back. Remove the one (1) screw.

2. Using the end of a Flathead screwdriver, gently pop open the lens. Remove lens.

3. Pull bulb out of socket. Do NOT twist. Gently push bulb into socket to replace.

4. Snap lens back into place. Secure the headlight lens by replacing the one screw.

GENERAL MAINTENANCE

WARNING: TO REDUCE THE RISK OF INJURY FROM MOVING PARTS - UNPLUG BEFORE SERVICING.

DEBRIS REMOVAL/HOSE

DEBRIS REMOVAL/NOZZLE GUARD

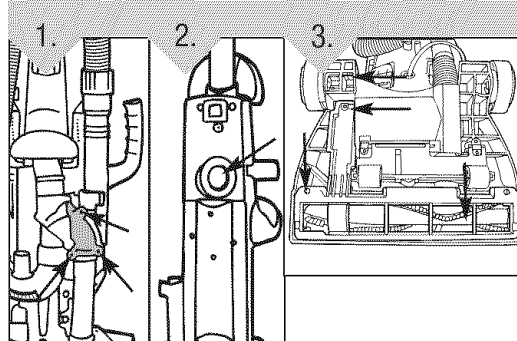

1. Check to see if dirt container is full; empty if needed.
2. Plug cleaner in and check to see if there is any suction at end of hose. If there is **suction** at end of hose, move on to Diagram 4. If there is **no suction** at the end of hose, follow these steps: 1. Unwrap hose from caddy. Remove obstruction. Check access door on back of cleaner (near hose wand). Remove three (3) screws and check for obstruction (Diagram 1).
2. Remove dirt container (Pg. 8) and check dirt container inlet located on cleaner (Diagram 2).
3. Remove nozzle guard (see Diagram 3) by removing the three (3) screws. Remove obstruction.

DEBRIS REMOVAL/POWER BRUSH TOOL

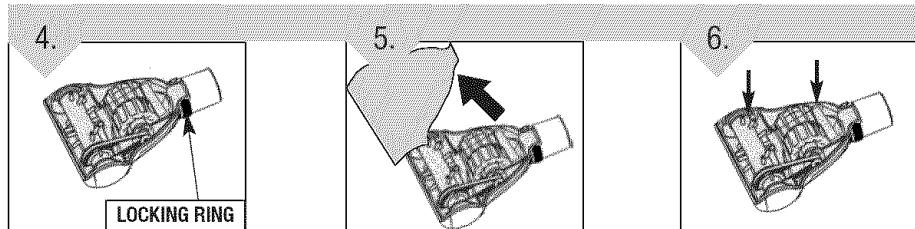

4. Rotate locking ring 180° and turn Power Brush Tool over.

5. Pivot lower housing and remove clog.

6. To reassemble, be sure tabs are engaged. Pivot the lower housing closed.

TROUBLESHOOTING GUIDE

WARNING: TO REDUCE RISK OF PERSONAL INJURY - UNPLUG CLEANER BEFORE SERVICING

PROBLEM	POSSIBLE REASON	POSSIBLE SOLUTION
Cleaner won't run	<ol style="list-style-type: none"> 1. Power cord not firmly plugged into outlet. 2. Blown fuse or tripped breaker. 3. Needs service. 4. Thermal Protector activated. 	<ol style="list-style-type: none"> 1. Plug unit in firmly. 2. Check fuse or breaker in home. Replace fuse/reset breaker. 3. Take to service center. To find nearest location, visit our website at www.dirtdevil.com or call 1-800-321-1134. 4. Allow cleaner to cool - Pg. 3.
Cleaner won't pick-up or low suction	<ol style="list-style-type: none"> 1. Dirt container not installed correctly. 2. Dirt container full. 3. Brushroll worn. 4. Broken or worn belt. 5. One or both filters are clogged. 6. Nozzle/dirt passage clogged. 7. Carpet height setting is incorrect. 	<ol style="list-style-type: none"> 1. Review dirt container removal and replacement - Pg. 8 & 9. 2. Empty dirt container - Pg. 8. 3. Replace brushroll - Pg. 10. 4. Replace belt - Pg. 10. 5. Remove both filters and clean - Pg. 8 & 9. 6. Open access door; remove obstruction - Pg. 11. 7. Set carpet height adjustment to appropriate setting for carpet being cleaned - Pg. 7.
Dust escaping from cleaner	<ol style="list-style-type: none"> 1. Dirt container full. 2. Dirt container not installed correctly. 3. Hose not installed correctly. 4. Filter not installed completely. 	<ol style="list-style-type: none"> 1. Empty dirt container - Pg. 8. 2. Review dirt container removal & replacement - Pg. 8 & 9. 3. Review hose installation - Pg. 6. 4. Review filter removal & replacement - Pg. 8 & 9.
Cleaner tools won't pick-up	<ol style="list-style-type: none"> 1. Hose clogged. 2. Dirt container full. 3. One or both filters are clogged. 	<ol style="list-style-type: none"> 1. Remove hose and tools; remove obstruction - Pg. 6 & 11. 2. Empty dirt container - Pg. 8. 3. Remove both filters and clean - Pg. 8 & 9.
Headlight not working	<ol style="list-style-type: none"> 1. Bulb burnt out. 2. Loose electrical wires. 	<ol style="list-style-type: none"> 1. Replace bulb - Pg. 11. 2. Take to service center. To find nearest location, visit our website at www.dirtdevil.com or call 1-800-321-1134.
Cleaner is difficult to push or won't move forward	<ol style="list-style-type: none"> 1. Carpet height setting is incorrect. 	<ol style="list-style-type: none"> 1. Set carpet height adjust lever to appropriate setting for carpet being cleaned - Pg. 7.

ANY OTHER SERVICING SHOULD BE DONE BY AN AUTHORIZED SERVICE REPRESENTATIVE CUSTOMER SERVICE (1-800-321-1134)

In the event that further assistance is required, see your Yellow Pages for an authorized Royal® Dealer or visit our website at www.dirtdevil.com. Costs of any transportation to and from any place of repair are to be paid by the owner. The service parts used in this unit are easily replaced and readily available from an authorized Royal® Dealer or retailer. Always identify your cleaner by the model number and manufacturing code when requesting information or ordering replacement parts. (The model number appears on the bottom of the cleaner.)