

LOCATION OF FEATURES / UBICACION DE LOS BOTONES / EMBLACEMENT DES BOUTONS

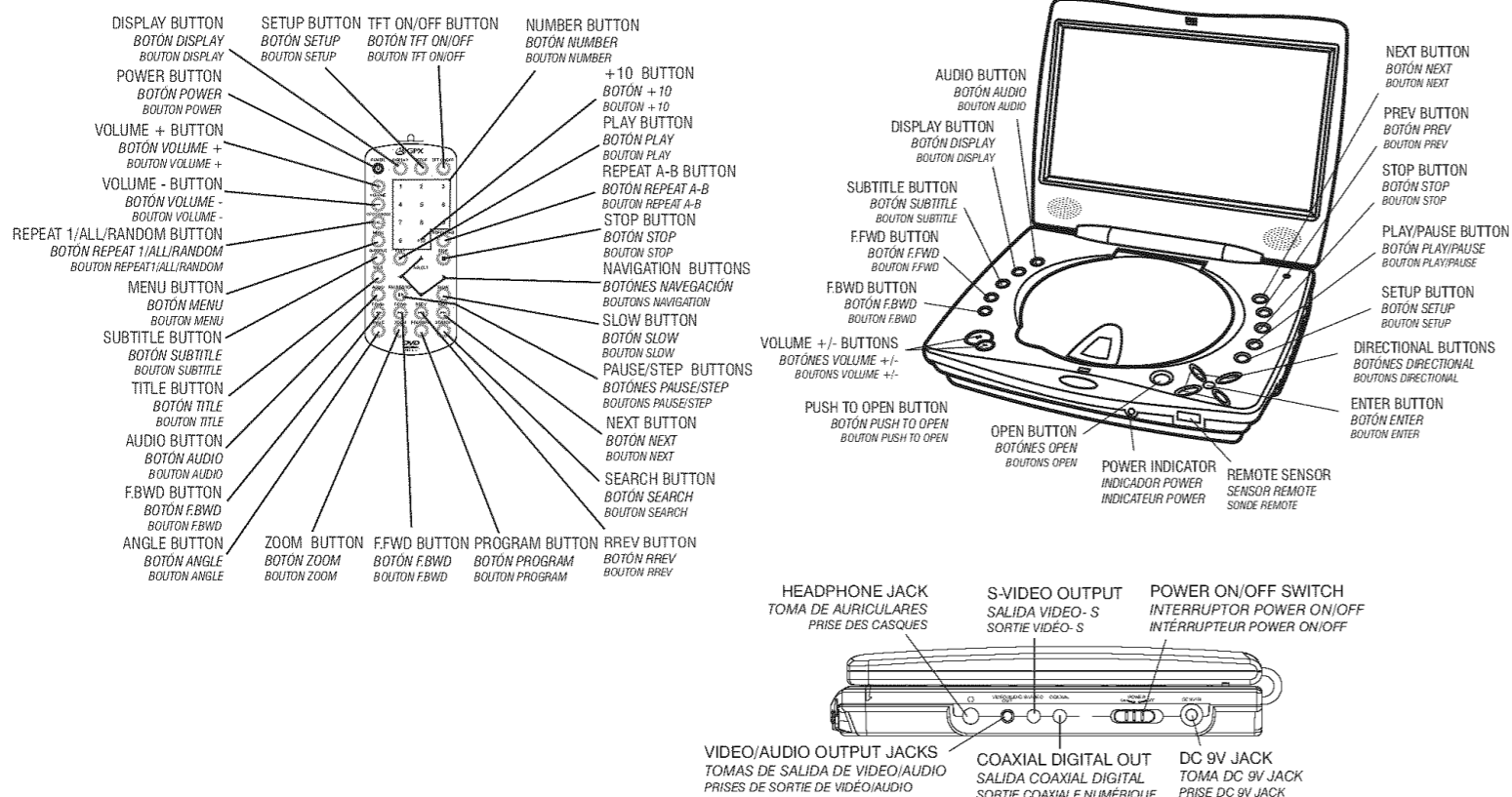

2 OPERATION / OPERACIÓN DEL DVD / OPÉRATION DU DVD

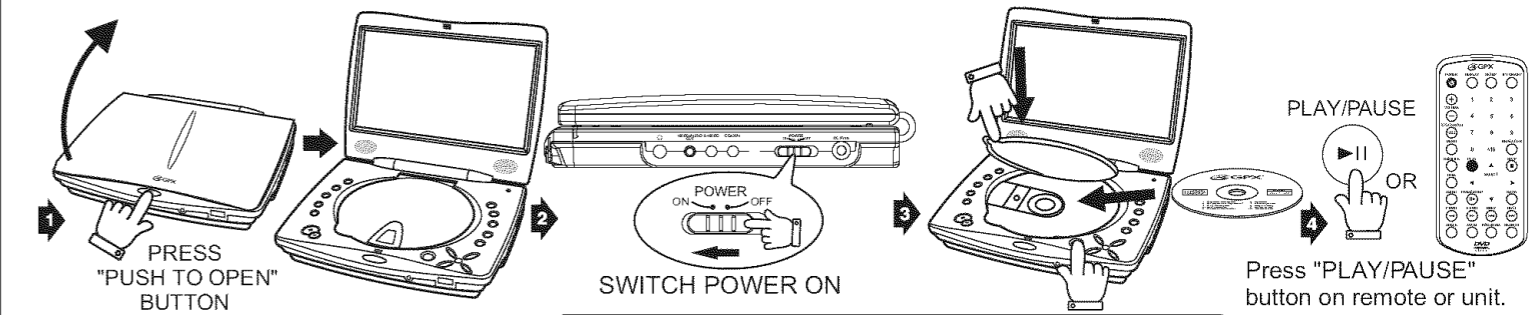

PAUSE / PAUSA / FAIRE UNE PAUSE

IN THE PLAY MODE / En modo reproducción: / Dans le mode lecture:

PLAY/PAUSE OR

TO CANCEL / CANCELAR / ANNULER

PLAY/PAUSE

PREV/NEXT / ANTERIOR/SIGUIENTE / PRÉCÉDENT/SUIVANT

IN THE PLAY MODE / En modo reproducción: / Dans le mode lecture:

PREV OR NEXT

Press "PREV" to go to previous chapter.
Press "NEXT" to advance to next chapter.

TFT ON/OFF / PARA APAGAR TFT / POUR ÉTEINDRE TFT

TFT ON/OFF

To turn off TFT.

NAVIGATE / NAVEGUE / DIRIGEZ

IN THE PLAY MODE / En modo reproducción: / Dans le mode lecture:

UP OR RIGHT OR DOWN OR LEFT

ON UNIT

FFWD/FBWD / ADELANTAR/ATRAZAR / AVANCER/ATRAZAR

IN THE PLAY MODE / En modo reproducción: / Dans le mode lecture:

OR

Each time the F.BWD or F.FWD button is pressed it increases the play speed by X2, X4, X8, X20.

VOLUME / VOLUMEN / VOLUME

VOLUME

SLOW / DESPACIO / LENTEMENT

IN THE PLAY MODE / En modo reproducción: / Dans le mode lecture:

DVD ONLY / DVD SOLAMENTE / DVD SEULEMENT

SF 1/2 SF 1/7

Press "SLOW" repeatedly, on remote, to slow motion picture from 1/2 to 1/7.

DISPLAY / EXPOSICIÓN / EXPOSITION

DISPLAY

Press to display elapsed time and remaining time.

STOP / PARAR / ARRÊTER

STOP

ZOOM / ENFOCAR / FOCALISER

IN THE PLAY MODE / En modo reproducción: / Dans le mode lecture:

Press "ZOOM" repeatedly until desire setting is chosen.

ZOOM X2 ZOOM X3 ZOOM X4 ZOOM 1/2 ZOOM 1/3 ZOOM 1/4 ZOOM OFF

PROGRAM / PROGRAMACIÓN / PROGRAMMATION

IN THE PLAY MODE / En modo reproducción: / Dans le mode lecture:

Press "PROGRAM" button.

Press "NUMBER" button to choose title and chapter.

Program up to 16 titles and chapter.

Press "PLAY/PAUSE" on unit to play program.

TO CANCEL / CANCELAR / ANNULER

PLAY/PAUSE

Press "PLAY" on remote to play program.

1 AC POWER / CABLE DE ALIMENTACIÓN / CÂBLE D'ALIMENTATION CA

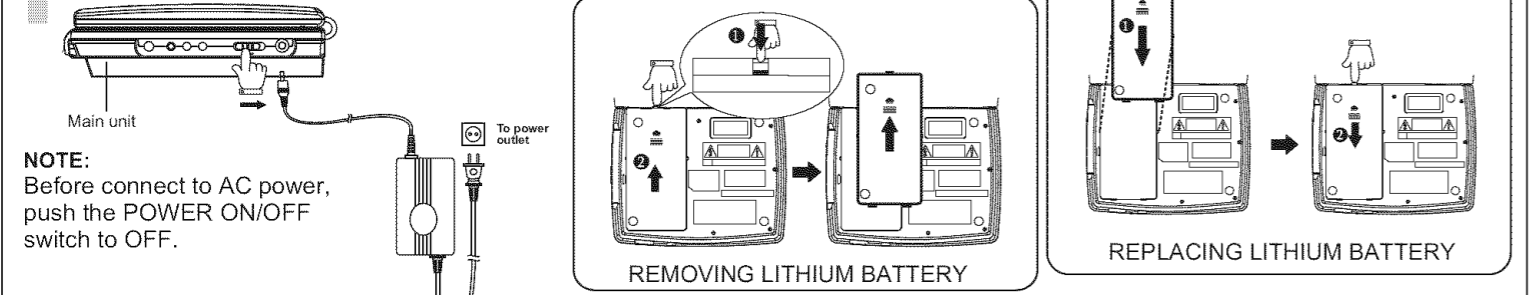

NOTE:
Before connect to AC power, push the POWER ON/OFF switch to OFF.

It takes approximately 5 hours to recharge a dead battery pack. If the battery becomes dead while operating, the battery pack needs to rest 10 to 20 minutes before recharging.

BATTERY INSTALLATION

REMOTE CONTROL / CONTROL REMOTO / CONTRÔLE ÉLOIGNÉ

USE ONE SIZE CR2025 LITHIUM BATTERY

- The button cell battery contains mercury, don't put in the trash. Recycle or dispose as hazardous waste.
- La pila célula tipo botón contiene mercurio, no la tire a la basura. Reciclaela ó deséchela como residuo peligroso.
- La pile cellule type bouton contient du mercure, ne la jetez pas à la poubelle. Veuillez la recyclé ou jeté comme déchet dangereux.

CONNECTING HEADPHONES / CONECTANDO LOS AURICOLARES / EN RELIANT L'ÉCOUTEUR

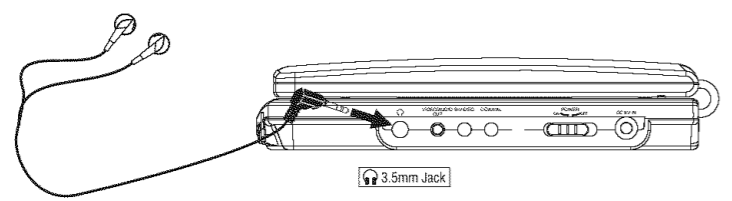

CAUTION / ADVERTENCIA / AVERTISSEMENT

Set the Volume to a low level before putting on the headphones. Gradually adjust the Volume to a comfortable listening level. Please do not play the volume too loudly for extended periods of time.

Baje el volumen antes de utilizar los auriculares. Gradualmente ajuste el volumen a un nivel de escucha confortable. Por favor no coloque el volumen muy alto durante largos periodos de tiempo.

Baissez le volume avant d'utiliser les casques. Réglez le volume graduellement jusqu'à atteindre le niveau d'écoute souhaité. S'il-vous-plait, ne mettez pas le volume trop fort pendant longtemps.

REPEAT 1/ALL / REPETICIÓN/1 TODO / RÉPÉTITION/1 TOUT
IN THE PLAY MODE / En modo reproducción: / Dans le mode lecture:

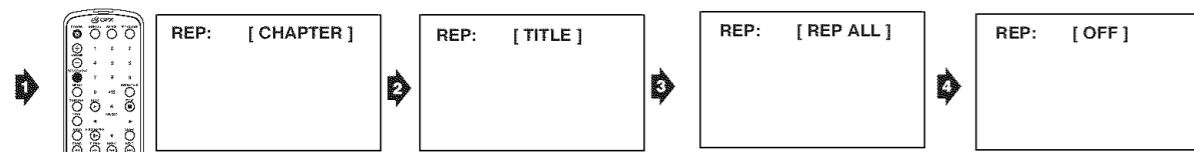

Press "REPEAT/RANDOM/1/ALL" button repeatedly until desired setting is chosen..

REPEAT A-B/ REPETICIÓN A-B / RÉPÉTITION A-B
IN THE PLAY MODE / En modo reproducción: / Dans le mode lecture:

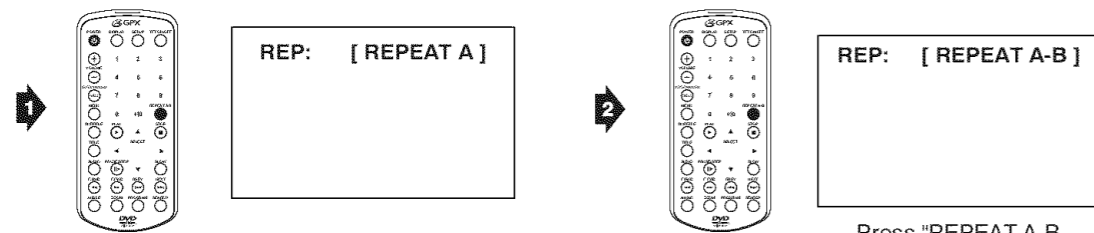

Press "REPEAT A-B" button to start repeat.

Press "REPEAT A-B" button again to end repeat. The movie will now be repeated between A start and B end.

ANGLE / Ángulo / Angle IN THE PLAY MODE / En modo reproducción: / Dans le mode lecture:

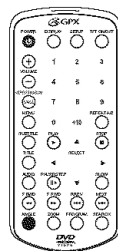

SomeDVDs may contain scenes which have been shot simultaneously from a number of different angles. For these discs, the same scene can be viewed from each of these different angles using the ANGLE button.

Press ANGLE during play, number of angle being playback will be displayed in the screen, and change to different angles.

- If there is no multi angle scenes recorded in the disc, pressing this button will not work.

Algunos DVDs puede que contengan escenas que se hallan tomado simultaneamente de diferentes ángulos. Para estos discos, la misma escena puede que se vea de cada uno de estos ángulos usando el botón ANGLE.

Presione ANGLE durante el tiempo de reproducción, en el monitor se mostrará el número de ángulo actual y cambia a los diferentes ángulos.

- Este botón no funcionará si el disco no tiene escenas con multi ángulos gravado.

Certains DVDs contiennent peut-être des scènes qui sont pris simultanément de différents angles. Pour ces disques, la même scène peut être vue de chacun de ces angles en utilisant le bouton ANGLE.

Pressez ANGLE pendant le temps de reproduction, dans le moniteur on montrera le numéro d'angle actuel et changez aux différents angles.

- Ce bouton ne fonctionnera pas si le disque n'a pas de scènes avec multi des angles gravé.

SEARCH / Búsqueda / Recherche IN THE PLAY MODE / En modo reproducción: / Dans le mode lecture:

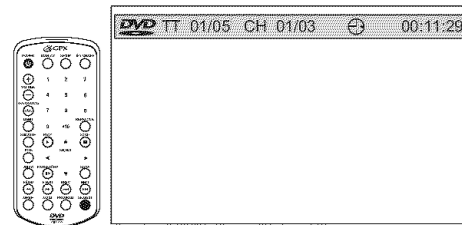

Note: TT Time = Title time
CH Time = Chapter time

1. Press SEARCH button during play, then press left or right Navigation button to select Title, Chapter, or Chapter time to play.
2. Enter the Title, Chapter, Title time or Chapter time to play by using the numeric buttons.
3. Press SELECT button to confirm selection.
4. To exit search menu, press SEARCH button directly.

1. Presione el botón SEARCH durante el tiempo de reproducción, luego presione el botón NAVIGATION de la izquierda o derecha para seleccionar si tocar el Tiempo, Capítulo o el tiempo de Capítulo.
2. Inserte el Título, Capítulo, Título de Tiempo o tiempo de Capítulo para tocar utilizando los botones numéricos.
3. Presione el botón SELECT para confirmar la selección.
4. Para salirse del menú de búsqueda, presione el botón SEARCH directamente.

1. Pressez le bouton SEARCH pendant le temps de reproduction, donc pressez le bouton NAVIGATION de gauche ou de droite pour choisir si toucher le Temps, le Chapitre ou le temps de Chapitre.
2. Insérez le Titre, le Chapitre, le Titre de Temps ou le temps de Chapitre pour toucher en utilisant les boutons numériques.
3. Pressez le il a lance SELECT pour confirmer la sélection.
4. Pour être sorti du menu de recherche, pressez le bouton SEARCH directement.

STEP / Paso / Pas

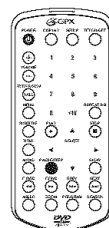

Press "PAUSE/STEP" repeatedly to advance movie frame by frame.

**TO CANCEL
CANCELAR
ANNULER**

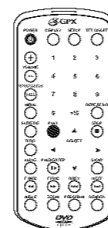

PLAY/PAUSE

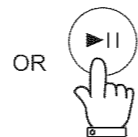

PICTURE CD/JPEG CD / CD DE FOTOS/CD JPEG / CD DE PHOTOS/CD DE JPEG

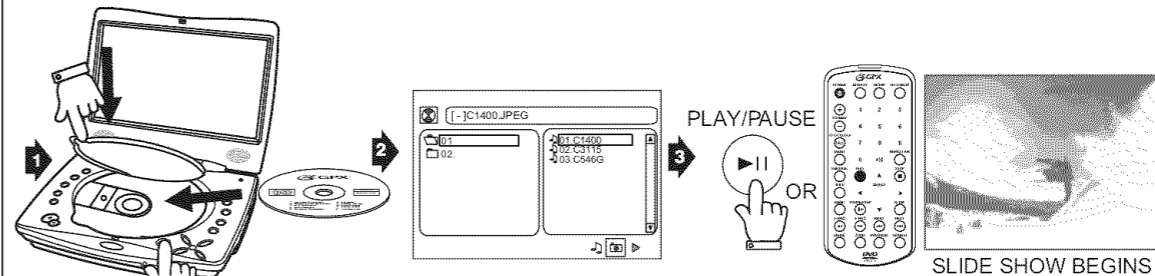

Press "OPEN" button. Insert VCD/CD and close.

NUMBER/ NÚMERO / NOMBRE

You can use the number button to select a certain picture.

Press 10+ button to access numbers over 10 and above.

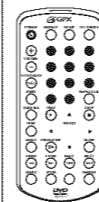

PREV/NEXT / ANTERIOR/SIGUIENTE / PRÉCÉDENT/SUIVANT

IN THE PLAY MODE / En modo reproducción: / Dans le mode lecture:

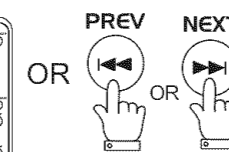
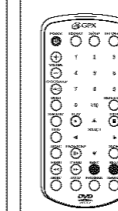

Press "PREV" to go to previous picture.
Press "NEXT" to advance to next picture.

STOP / PARAR / ARRÊTER

STOP

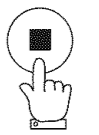

**PAUSE
PAUSA
FAIRE UNE PAUSE**

PLAY/PAUSE



**TO CANCEL
CANCELAR
ANNULER**

PLAY/PAUSE



ZOOM / Enfocar / Focalise

ZOOM

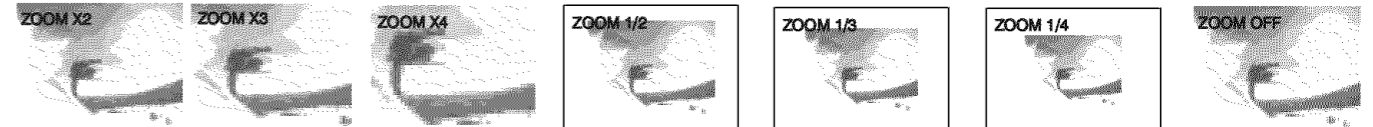
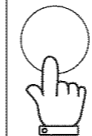

Press "ZOOM" repeatedly until desired setting.

ROTATING PICTURES/ FOTOS ROTANTES / PHOTOS TOURNANT

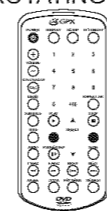

Press RIGHT navigation button to rotate the picture clockwise.
Press LEFT navigation button to rotate the picture counter-clockwise.

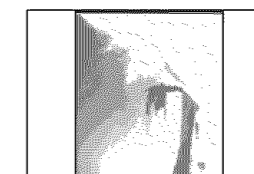

FLIPPING PICTURES/ VOLTEANDO FOTOS / ENVERS PHOTOS

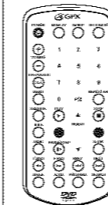

Press UP navigation button to flip the picture horizontally.

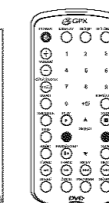
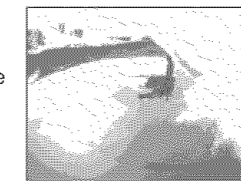

Press UP navigation button to flip the picture horizontally.

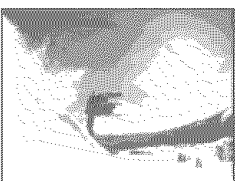

REPEAT 1/ALL / REPETICIÓN/1 TODO / RÉPÉTITION/1 TOUT
IN THE PLAY MODE / En modo reproducción: / Dans le mode lecture:

Press "REPEAT/1/ALL" repeatedly until desired setting is reached

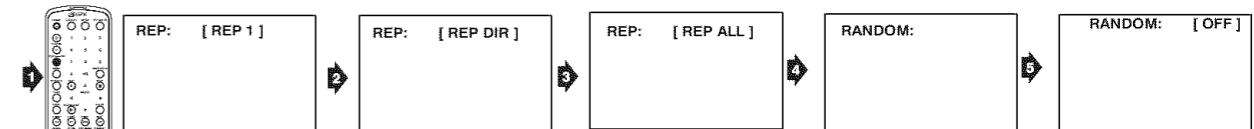

3 SYSTEM SETUP / DISPOSICIÓN DEL SISTEMA / DISPOSITION DU SYSTÈME

Press "PUSH TO OPEN" button to open.

Switch Power "ON"

Press "SETUP" button on remote or unit.

PLAY/PAUSE OR

SYSTEM SETUP

- LCD MODE
- SCREEN SAVER
- TY TYPE
- PASSWORD/CHANGE
- RATING
- DEFAULT
- EXIT SETUP

TV SYSTEM / SISTEMA DE TV / SYSTÈME DE TV

Press "DOWN" button on remote or unit.

ON UNIT OR

SYSTEM SETUP

- TV SYSTEM
- LCD MODE
- TY TYPE
- PASSWORD/CHANGE
- RATING
- DEFAULT
- EXIT SETUP

ON UNIT OR

SYSTEM SETUP

- TV SYSTEM
- LCD MODE
- TY TYPE
- PASSWORD/CHANGE
- RATING
- DEFAULT
- EXIT SETUP

LCD MODE / MODE LCD / MODE LCD

Press "DOWN" button until "LCD MODE" is highlighted

ON UNIT OR

SYSTEM SETUP

- TV SYSTEM
- LCD MODE
- TY TYPE
- PASSWORD/CHANGE
- RATING
- DEFAULT
- EXIT SETUP

ON UNIT OR

SYSTEM SETUP

- TV SYSTEM
- LCD MODE
- TY TYPE
- PASSWORD/CHANGE
- RATING
- DEFAULT
- EXIT SETUP

ON UNIT OR

SYSTEM SETUP

- TV SYSTEM
- LCD MODE
- TY TYPE
- PASSWORD/CHANGE
- RATING
- DEFAULT
- EXIT SETUP

Press "Navigation up/down" button to select 4:3 or 16:9.

Press "ENTER" button to confirm selection.

ON UNIT OR

SYSTEM SETUP

- TV SYSTEM
- LCD MODE
- TY TYPE
- PASSWORD/CHANGE
- RATING
- DEFAULT
- EXIT SETUP

ON UNIT OR

SYSTEM SETUP

- TV SYSTEM
- LCD MODE
- TY TYPE
- PASSWORD/CHANGE
- RATING
- DEFAULT
- EXIT SETUP

ON UNIT OR

SYSTEM SETUP

- TV SYSTEM
- LCD MODE
- TY TYPE
- PASSWORD/CHANGE
- RATING
- DEFAULT
- EXIT SETUP

Press navigation "DOWN" button until "EXIT SETUP" is highlighted then press "ENTER" to exit SYSTEM SETUP.

EXIT SETUP / INTERDIT DISPOSITION / ESCAPE DE DISPOSICIÓN

TV TYPE / TIPO DE TV / TYPE DE TV

Press "DOWN" button until "TV TYPE" is highlighted

ON UNIT OR

SYSTEM SETUP

- TV SYSTEM
- LCD MODE
- TY TYPE
- PASSWORD/CHANGE
- RATING
- DEFAULT
- EXIT SETUP

ON UNIT OR

SYSTEM SETUP

- TV SYSTEM
- LCD MODE
- TY TYPE
- PASSWORD/CHANGE
- RATING
- DEFAULT
- EXIT SETUP

ON UNIT OR

SYSTEM SETUP

- TV SYSTEM
- LCD MODE
- TY TYPE
- PASSWORD/CHANGE
- RATING
- DEFAULT
- EXIT SETUP

Press "Navigation Right" button until "LCD MODE" is highlighted

ON UNIT OR

SYSTEM SETUP

- TV SYSTEM
- LCD MODE
- TY TYPE
- PASSWORD/CHANGE
- RATING
- DEFAULT
- EXIT SETUP

ON UNIT OR

SYSTEM SETUP

- TV SYSTEM
- LCD MODE
- TY TYPE
- PASSWORD/CHANGE
- RATING
- DEFAULT
- EXIT SETUP

Press "Navigation up/down" button to select 4:3PS, 4:3LB or 16:9.

ON UNIT OR

SYSTEM SETUP

- TV SYSTEM
- LCD MODE
- TY TYPE
- PASSWORD/CHANGE
- RATING
- DEFAULT
- EXIT SETUP

Press "ENTER" to confirm selection

PASSWORD/CHANGE / CONTRASEÑA/CAMBIO / MOT DE PASSE / CHANGEMENT

Press "DOWN" button until "PASSWORD/CHANGE" is highlighted

ON UNIT OR

SYSTEM SETUP

- LCD MODE
- SCREEN SAVER
- TY TYPE
- PASSWORD/CHANGE
- RATING
- DEFAULT
- EXIT SETUP

ON UNIT OR

SYSTEM SETUP

- LCD MODE
- SCREEN SAVER
- TY TYPE
- PASSWORD/CHANGE
- RATING
- DEFAULT
- EXIT SETUP

ON UNIT OR

SYSTEM SETUP

- LCD MODE
- SCREEN SAVER
- TY TYPE
- PASSWORD/CHANGE
- RATING
- DEFAULT
- EXIT SETUP

Press "Navigation Right" button until "LCD MODE" is highlighted

ON UNIT OR

SYSTEM SETUP

- LCD MODE
- SCREEN SAVER
- TY TYPE
- PASSWORD/CHANGE
- RATING
- DEFAULT
- EXIT SETUP

ON UNIT OR

SYSTEM SETUP

- LCD MODE
- SCREEN SAVER
- TY TYPE
- PASSWORD/CHANGE
- RATING
- DEFAULT
- EXIT SETUP

Press "Number" buttons to enter numerical password.

ON UNIT OR

SYSTEM SETUP

- LCD MODE
- SCREEN SAVER
- TY TYPE
- PASSWORD/CHANGE
- RATING
- DEFAULT
- EXIT SETUP

Press "ENTER" to confirm password.

RATING / ÍNDICE DE AUDIENCIA / COTE

Press "DOWN" button until "RATING" is highlighted

ON UNIT OR

SYSTEM SETUP

- LCD MODE
- SCREEN SAVER
- TY TYPE
- PASSWORD/CHANGE
- RATING
- DEFAULT
- EXIT SETUP

ON UNIT OR

SYSTEM SETUP

- LCD MODE
- SCREEN SAVER
- TY TYPE
- PASSWORD/CHANGE
- RATING
- DEFAULT
- EXIT SETUP

ON UNIT OR

SYSTEM SETUP

- LCD MODE
- SCREEN SAVER
- TY TYPE
- PASSWORD/CHANGE
- RATING
- DEFAULT
- EXIT SETUP

ON UNIT OR

SYSTEM SETUP

- LCD MODE
- SCREEN SAVER
- TY TYPE
- PASSWORD/CHANGE
- RATING
- DEFAULT
- EXIT SETUP

Press "Navigation up/down" button to select from list.

ON UNIT OR

SYSTEM SETUP

- LCD MODE
- SCREEN SAVER
- TY TYPE
- PASSWORD/CHANGE
- RATING
- DEFAULT
- EXIT SETUP

Press "ENTER" to confirm selection.

DEFAULT / OPCIÓN POR DEFECTO / PAR DÉFAUT

Press "DOWN" button until "DEFAULT" is highlighted

ON UNIT OR

SYSTEM SETUP

- LCD MODE
- SCREEN SAVER
- TY TYPE
- PASSWORD/CHANGE
- RATING
- DEFAULT
- EXIT SETUP

ON UNIT OR

SYSTEM SETUP

- LCD MODE
- SCREEN SAVER
- TY TYPE
- PASSWORD/CHANGE
- RATING
- DEFAULT
- EXIT SETUP

ON UNIT OR

SYSTEM SETUP

- LCD MODE
- SCREEN SAVER
- TY TYPE
- PASSWORD/CHANGE
- RATING
- DEFAULT
- EXIT SETUP

ON UNIT OR

SYSTEM SETUP

- LCD MODE
- SCREEN SAVER
- TY TYPE
- PASSWORD/CHANGE
- RATING
- DEFAULT
- EXIT SETUP

Press "Navigation Right" button until "RESTORE" is highlighted

ON UNIT OR

SYSTEM SETUP

- LCD MODE
- SCREEN SAVER
- TY TYPE
- PASSWORD/CHANGE
- RATING
- DEFAULT
- EXIT SETUP

ON UNIT OR

SYSTEM SETUP

- LCD MODE
- SCREEN SAVER
- TY TYPE
- PASSWORD/CHANGE
- RATING
- DEFAULT
- EXIT SETUP

Press "ENTER" button to restore default.

4 LANGUAGE SETUP / DISPOSICIÓN DE LENGUAJE / DISPOSITION DE LANGAGE

OSD LANGUAGE / REPRODUCCIÓN DEL DVD / LECTURE DU DVD

Press navigation "DOWN" button until "LANGUAGE SETUP" is highlighted

ON UNIT OR

SYSTEM SETUP

- OSD LANGUAGE
- AUDIO LANG
- SUBTITLE LANG
- MENU LANG
- EXIT SETUP

ON UNIT OR

SYSTEM SETUP

- OSD LANGUAGE
- AUDIO LANG
- SUBTITLE LANG
- MENU LANG
- EXIT SETUP

ON UNIT OR

SYSTEM SETUP

- OSD LANGUAGE
- AUDIO LANG
- SUBTITLE LANG
- MENU LANG
- EXIT SETUP

ON UNIT OR

SYSTEM SETUP

- OSD LANGUAGE
- AUDIO LANG
- SUBTITLE LANG
- MENU LANG
- EXIT SETUP

Press navigation "DOWN" button until OSD LANGUAGE is highlighted.

ON UNIT OR

SYSTEM SETUP

- OSD LANGUAGE
- AUDIO LANG
- SUBTITLE LANG
- MENU LANG
- EXIT SETUP

ON UNIT OR

SYSTEM SETUP

- OSD LANGUAGE
- AUDIO LANG
- SUBTITLE LANG
- MENU LANG
- EXIT SETUP

ON UNIT OR

SYSTEM SETUP

- OSD LANGUAGE
- AUDIO LANG
- SUBTITLE LANG
- MENU LANG
- EXIT SETUP

Press "Navigation Right" button access list.

ON UNIT OR

SYSTEM SETUP

- OSD LANGUAGE
- AUDIO LANG
- SUBTITLE LANG
- MENU LANG
- EXIT SETUP

ON UNIT OR

SYSTEM SETUP

- OSD LANGUAGE
- AUDIO LANG
- SUBTITLE LANG
- MENU LANG
- EXIT SETUP

ON UNIT OR

SYSTEM SETUP

- OSD LANGUAGE
- AUDIO LANG
- SUBTITLE LANG
- MENU LANG
- EXIT SETUP

Press navigation "UP/DOWN" to select desired language.

ON UNIT OR

SYSTEM SETUP

- OSD LANGUAGE
- AUDIO LANG
- SUBTITLE LANG
- MENU LANG
- EXIT SETUP

ON UNIT OR

SYSTEM SETUP

- OSD LANGUAGE
- AUDIO LANG
- SUBTITLE LANG
- MENU LANG
- EXIT SETUP

ON UNIT OR

SYSTEM SETUP

- OSD LANGUAGE
- AUDIO LANG
- SUBTITLE LANG
- MENU LANG
- EXIT SETUP

Press "ENTER" to confirm selection.

ON UNIT OR

SYSTEM SETUP

- OSD LANGUAGE
- AUDIO LANG
- SUBTITLE LANG
- MENU LANG
- EXIT SETUP

ON UNIT OR

SYSTEM SETUP

- OSD LANGUAGE
- AUDIO LANG
- SUBTITLE LANG
- MENU LANG
- EXIT SETUP

ON UNIT OR

SYSTEM SETUP

- OSD LANGUAGE
- AUDIO LANG
- SUBTITLE LANG
- MENU LANG
- EXIT SETUP

Press navigation "DOWN" button until "EXIT SETUP" is highlighted then press "ENTER" to exit SYSTEM SETUP.

EXIT SETUP / INTERDIT DISPOSITION / ESCAPE DE DISPOSICIÓN

AUDIO LANGUAGE / AUDIO LENGÜAJE / AUDIO LANGUAGE

Press navigation "DOWN" button until "AUTO LANG" is highlighted

Press "Navigation Right" button to access list.

Press navigation "UP/DOWN" button to select desire language.

Press "ENTER" to confirm selection

SUBTITLE LANGUAGE / SUBTITLE LENGÜAJE / SUBTITLE LANGUAGE

Press navigation "DOWN" button until "SUBTITLE" is highlighted

Press navigation "RIGHT" button to access list.

Press navigation "UP/DOWN" button to select desire language.

Press "ENTER" to confirm selection

MENU LANGUAGE / MENU LENGÜAJE / MENU LANGUAGE

Press navigation "DOWN" button until "MENU LAND" is highlighted

Press navigation "RIGHT" button to access list.

Press navigation "UP/DOWN" button to select desire language.

Press "ENTER" to confirm selection

5 AUDIO SETUP / DISPOSICIÓN DE AUDIO / DISPOSITION DE AUDIO

AUDIO OUT / DE AUDIO / AUDIO DEHORS

Press "DOWN" button until "AUDIO SETUP" is highlighted

Press "Navigation Down" button to highlight Audio Out.

Press "Navigation Right" button to access list.

Press navigation "UP/DOWN" to highlight your selection .

Press "ENTER" to confirm selection.

EXIT SETUP / INTERDIT DISPOSITION / ESCAPE DE DISPOSICIÓN

Press navigation "DOWN" button until "EXIT SETUP" is highlighted then press "ENTER" to exit SYSTEM SETUP.

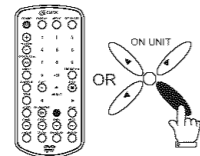

6 VIDEO SETUP / DISPOSICIÓN DE VIDEO / DISPOSITION DE VIDEO

Press "DOWN" button until "VIDEO SETUP" is highlighted

Press navigation "DOWN" button to highlight BRI.

Press navigation "RIGHT" button to access scale.

Press navigation "UP/DOWN" to highlight your selection .

Press "ENTER" to confirm selection.

EXIT SETUP / INTERDIT DISPOSITION / ESCAPE DE DISPOSICIÓN

Press navigation "DOWN" button until "EXIT SETUP" is highlighted then press "ENTER" to exit SYSTEM SETUP.

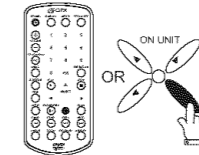

CON / CONTRASTE / CONTRASTE

Press navigation "DOWN" button until "CON" is highlighted

Press navigation "RIGHT" button to highlight scale.

Press navigation "UP/DOWN" button to selection.

Press "ENTER" button to confirm selection.

HUE / COLOR/EFFECTO / COULEUR/EFFET

Press "DOWN" button until "HUE" is highlighted

Press navigation "RIGHT" button to highlight scale.

Press navigation "UP/DOWN" button to selection.

Press "ENTER" button to confirm selection.

SATURATION / SATURACIÓN / SATURATION

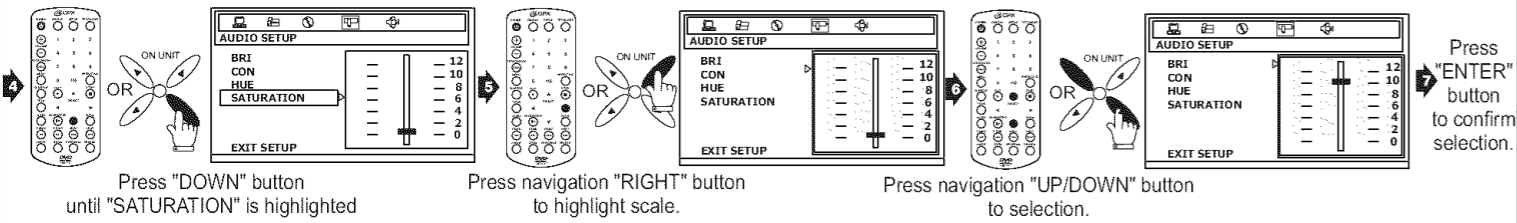

CONNECTING TO A STEREO TV SET

CONNECT THE S-VIDEO OUTPUT JACK ON YOUR DVD PLAYER TO THE S-VIDEO INPUT JACK ON YOUR TV USING AN OPTIONAL S-VIDEO CORD .

CONEXIÓN A UN TELEVISOR ESTÉREO

CONECTE LA TOMA DE SALIDA S-VIDEO DE SU APARATO DVD A LA TOMA DE ENTRADA S-VIDEO EN SU TELEVISIÓN UTILIZANDO UN CABLE OPCIONAL S-VIDEO

CONNEXION Á UN TÉLÉVISEUR STÉRÉO

BRANCHEZ LA PRISE DE SORTIE S-VIDEO DE VOTRE LECTEUR DVD Á LA PRISE D'ENTRÉE S-VIDÉO DE VOTRE TÉLÉVISION EN UTILISANT UN CÂBLE OPTIONEL S-VIDÉO

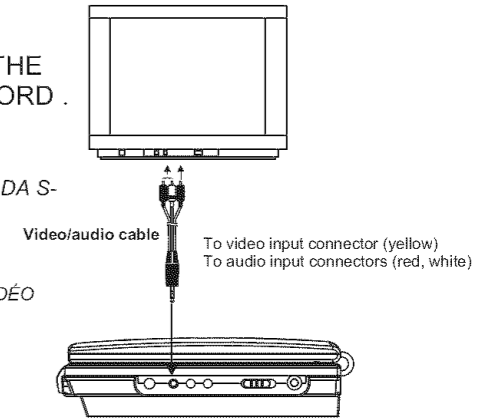

CONNECTING TO A TV SET OR MONITOR WITH S-VIDEO OUTPUT CONNECTORS

CONECTANDO A UN MONITORÓ TV CON LOS CONECTORES DE LA TOMADE SALIDA S-VIDEO

CONNEXION Á UN TÉLÉVISEUR STÉRÉO OU MONITEUR AUX-DE CONNEXION DE SORTIE S-VIDEO

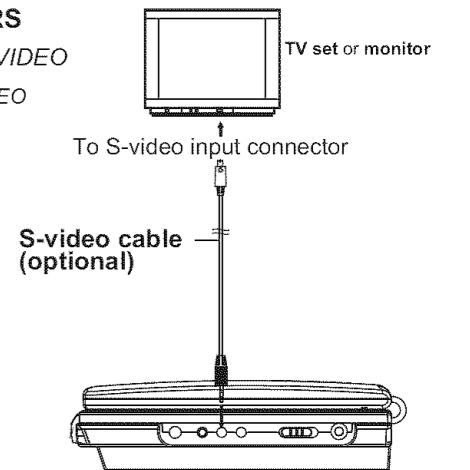

SIX SPEAKER SETUP / DESPOSICIÓN DE SEIS A HOPARLANTES / DESPOSITION DE SIX ORATEUR
DOWNMIX

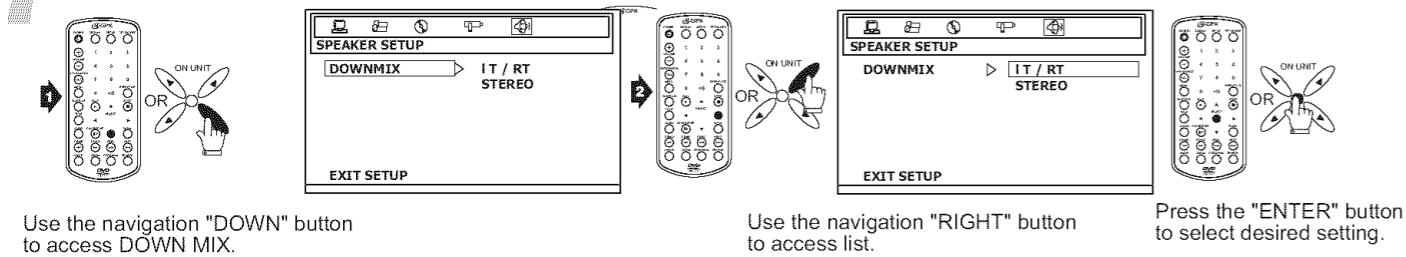

EXIT SETUP / INTERDIT DISPOSITION / ESCAPE DE DISPOSICIÓN

Press navigation "DOWN" button until "EXIT SETUP" is highlighted then press "ENTER" to exit SYSTEM SETUP.

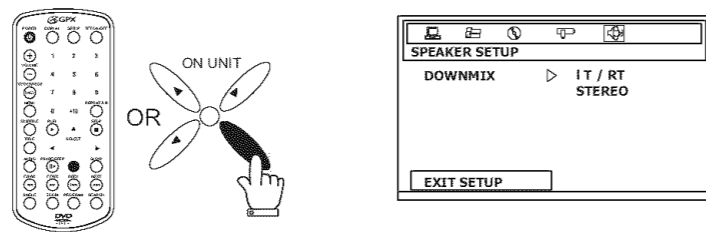

Optional audio connections

Coneciones de audio opcional

Connexion de audio optionel

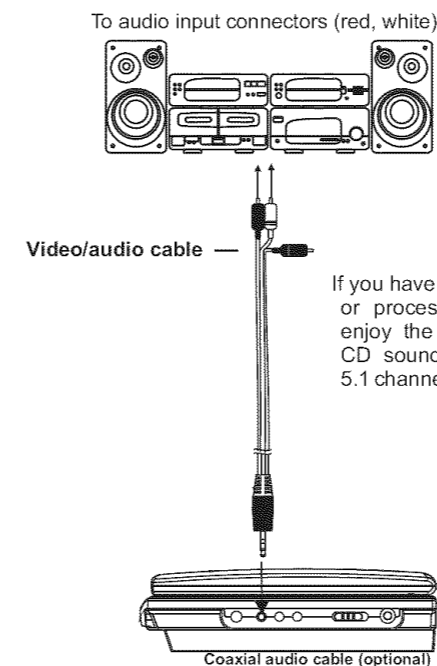

If you have DTS decoder or processor, you can enjoy the DVD disc or CD sound decoded by 5.1 channel DTS.

Connecting to a decoder with Dolby Digital (AC-3/DTS) processing

Conectando a un descondificador con un procesamiento digital de Dolby (AC-3/DTS).

Connexion á un décodeur avec traitement Dolby Digital(AC-3/DTS).

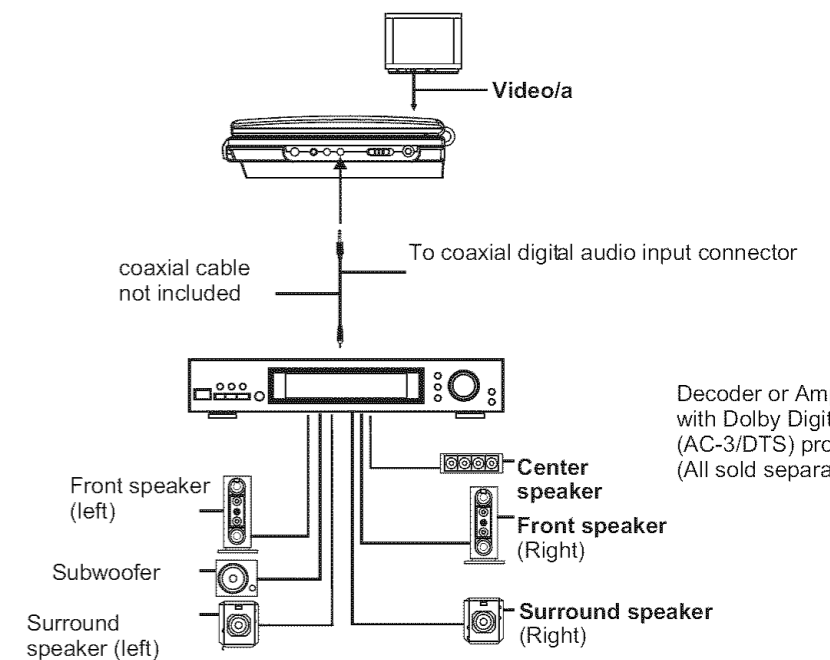

Decoder or Amplifier with Dolby Digital (AC-3/DTS) processing (All sold separately)

BRIGHTNESS Press "BRIGHTNESS +/-" to adjust brightness of picture.

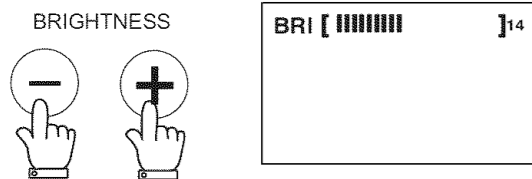

COLOR Press "COLOR +/-" to adjust color of picture.

