



# Compact Refrigerator

Model No. 98292

2.9 cu. ft. Capacity

## Read This Manual!

It will tell you how to operate and care for your refrigerator. It also offers tips on how to get the best and lowest cost performance.

If you prefer installing your own parts, use the parts list to find the part number. Do not use the illustration number.

In the space below record the model and serial number of your refrigerator. The model number and serial number are located in the upper corner of the refrigerator back. Use these number when calling for service.

Model No. \_\_\_\_\_ Serial No. \_\_\_\_\_

## Installation

Remove all packing material tape from the unit. Inspect the unit thoroughly, notify Sears immediately if the unit has any damaged or missing parts.

Install the unit on a strong level floor or counter. Avoid any direct sunlight, heat source or moisture.

Let air circulate freely around the refrigerator. Keep the back of the unit at least 4 inches away from the wall. Provide at least 1 inch of space between the top of the unit and any surface above it.



**CAUTION:** If you turn off the cold control, allow at least three minutes before restarting to avoid blowing fuses or tripping your circuit breaker.

## Electrical Requirements

120 Volts, 60 Hz (60 cycles AC), 15 amps.

## Manual Contents:

- Installation
- Operation
  - Temperature control
  - How To Remove Ice Cubes
  - How To Defrost
- Maintenance
  - Cleaning
- Food Storage Times and Energy Saving Tips
- Parts List
- Troubleshooting
- Warranty

## Electrical Grounding

Your refrigerator comes with a three-prong plug and must be inserted into a three-prong, grounded wall outlet. DO NOT use an extension cord.



**WARNING:** Unless the above grounding method is followed, you are not protected against severe or lethal shock in the event of a short circuit in refrigerator wiring or electrical components.

## Things to Remember

1. When resetting your refrigerator to a new temperature, allow 24 hours for it to reach the new setting.
2. The motor will start and stop often. It must do so in order to maintain the temperature you select.
3. Keep your refrigerator level, so that the door seals properly.
4. Unplug the refrigerator before doing anything with the electrical system.
5. The low temperature section is not intended for long-term storage of frozen food.

---

Sears, Roebuck and Co., Hoffman Estates, IL 60179

---

## Temperature control

Normally temp. Control knob should be set at "3" position. Refrigerator compartment temperature and freezer compartment temperature can be adjusted by turning Temp. Control knob. The closer to "MAX" position Temp. Control is set by turning the knob clockwise, the lower temperature of refrigerator compartment and freezer compartment becomes.

Set the knob at "MAX" position only when ice cubes are needed in a hurry. (Be sure to return Control setting to normal position when ice cubes have been made.)

When room temperature is high and Temp. Control knob is set at "5" or "MAX" position for a long time, it is possible that evaporator of refrigerator compartment will be frosted heavily which may cause insufficient cooling of refrigerator compartment. In this case, the Temp. Control knob should be set at "2" position or below. Then, set the knob at normal position.

Refrigerator compartment temperature and freezer compartment temperature will vary depending on the quantity of food stored and on the frequency with which doors are opened.

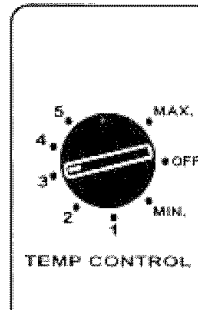

## How To Remote Ice Cubes

Ice cube tray is flexible, Twist tray to remove ice cubes.



Never use metal instrument such as a knife or screwdriver to remove ice cube tray, because this may damage evaporator.

## How To Defrost

This refrigerator has separate defrosting systems, one for each compartment.

### 1. Freezer Compartment.

When freezer compartment is frosted about 1/4 inch thick, defrosting is required. Frosting will interfere with proper freezing.

When frost is thin or soft, scrape off and remove frost on freezer compartment walls with scraper. This can be done without interrupting freezing operation.

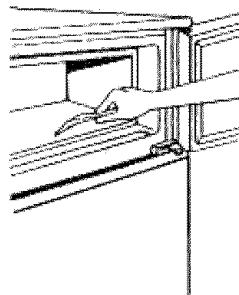

When frost is hard/icy or heavy, defrost freezer compartment as follows:

Remove foods from freezer compartment. Then, set Temp. Control knob at "OFF" position.

When ice/frost on side walls and ceiling of freezer compartment comes off, remove ice and melted water with scraper and cloth.

After defrosting, reset Temp. Control knob at normal position to start freezing.

### 2. Refrigerator Compartment.

As far as Temp. Control is set at ordinary position, evaporator of refrigerator compartment is automatically defrosted and no manual operation is needed to defrost. Defrosted water is drained out to evaporating tray on the back of refrigerator cabinet and is evaporated therein automatically.

Never use a knife or other metal instrument to remove frost and/or ice, because this may damage evaporator.

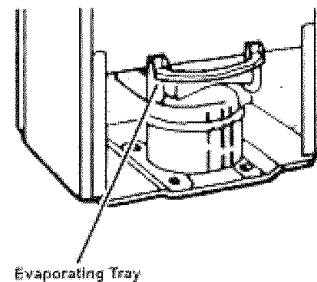

## Cleaning

Disconnect the plug from the electrical outlet. Remove food, shelves, trays, etc.

To clean interior liner, use a soft cloth with water or a solution of warm water mixed with two tablespoons baking soda per a quart. Do not use soaps, detergents, scouring powder, spray cleaners or the like, or it may cause odor in refrigerator.

Shelves and ice cube trays may be washed in water.

Wipe exterior surface with soft cloth dampened with mild soap water and then dry with soft cloth.

Use only mild soap water to clean door gaskets.

Never use boiling water, scouring powder, acids, chemical thinner, gasoline, benzine or the like for cleaning refrigerator, because these may deform or damage exterior surface, plastic and door gaskets.

Since dust accumulated on evaporating tray will decrease the evaporation efficiency, remove the tray and clean it. Evaporating tray is set on refrigerator back. To remove, pull it.

## Food Storage Times and Tips

Use these storage times as a guide. Actual storage times vary, since food quality always varies.

### For the Refrigerator Section

**Bread:** Refrigeration slows molding. But bread still gets stale with time, so use within 3 days.

**Dairy Products:** Keep cartons closed. Use milk, cream or cottage cheese within 5 days. Wrap cheese tightly with foil or plastic wrap. Hard cheese (cheddar, etc.) will keep as long as a month. Soft cheese will keep up to 2 weeks. - Wrapped butter keeps about 2 weeks.

**Eggs:** Store unwashed. Use within 2 weeks.

**Fish:** Clean. Wrap tightly. Freeze unless you use it the same day you buy it.

**Fruits:** Wash, dry and store in crisper. Store fruits with strong aromas (apples, melons) in plastic bags. Berries keep up to 3 days, if stored unwashed, in a shallow open bowl.

**Leftovers:** Let cool before storing. Wrap well. Use within 2 days (or freeze).

**Meat:** Wrap meats loosely (and seal). Wrap smoked meats tightly. Use foil or plastic wrap. Store in meat drawer or on lower shelf. For best results, use within recommended times.

### Refrigerator Storage Times

	No longer than
Bacon and other Smoked Meats	14 Days
Cold Cuts. . . (Date on Package)	or 3 Days
Ground Meat	1-2 Days
Liver and other Organ Meats	1-2 Days
Steaks and Roast (Fresh)	2-3 Days

**Poultry:** Rinse before storing. Wrap loosely in foil or plastic wrap and seal. (Wrap giblets separately.) Use within 2 days.

**Vegetables:** Wash, drain and store in crisper. Or store unwashed in plastic wrap.

### For the Freezer Section

Wrap carefully and seal. Contact with air shortens the life of food. So containers must be airtight. Fresh food that are already packaged, such as bread or poultry, should be rewrapped. Use heavy duty aluminum foil freezer paper and tape or special freezer containers.

Freeze food only when it is fresh and in top condition. Do not refreeze.

Label and date each package. Use food with the oldest date first.

When loading the freezer, allow enough space at the front to let the door close completely and seal.

## Freezer Storage Times

	No longer than
Bread	6 Months
Butter, Margarine	2-9 Months
Cooked Dishes	3 Months
Fish (package frozen)	3 Months
Fruits	12 Months
Ice Cream	1 Month
Juice Concentrate	6 Months
Meats-	
Bacon, other Smoked Meats	1 Month
Beef or Lamb	5-6 Months
Ground Meat	3-4 Months
Liver, other Variety Meats	3-4 Months
Pork or Veal	4 Months
Poultry	4-6 Months
Vegetables	8 Months

## Energy Saving Tips

Ways to Save Power, Save Money, and Still enjoy your Kenmore.

1. **Close the door as soon as you can.** Make sure the door is fully shut after each use, so cold air doesn't escape.
2. **Keep the condenser coils clean.** Your Kenmore's motor works harder when coils are dusty. Clean the coils at least once every 3 months. They are on the back of your refrigerator. Allow 1 inch of air space above your Kenmore so air circulates freely.
3. **Adjust the cold control.** Try a warmer setting. Your refrigerator may be colder than needed. Check the refrigerator temperature with milk. As long as it keeps well, your refrigerator is cold enough.
4. **Don't put hot food in the refrigerator.**
5. **Don't allow more than ¼" of frost to build up in the frozen food storage section.**
6. **Reduce door openings,** so your cooling system won't have to run as often.
7. **Keep your refrigerator reasonably level.** So the door seals tightly. When the door is closed, the door gaskets should touch the refrigerator all the way around. If not, make your refrigerator more level. Use the adjustment screw under the refrigerator.
8. **Keep the refrigerator away from the stove other heat sources.** A cool and dry place lets your refrigerator work best.

# Parts List

564.98292400

Model # SR2972SW

CAUTION: Use Sears parts number on all orders, not the illustration number.

Illus. No.	Part No.	Description	Illus. No.	Part No.	Description
1	302385	Foamed Door, F.	34	302317	Screw #159
2	302388	Cap Grommet White	35	302780	Plate Support Condenser
3	301269	Gasket, F.	36	302304	Single Drier
4	302387	Door Liner, F.	37	301982	Overload Relay
5	302390	Foamed Door, R.	38	302306	PTC Thermistor
6	301268	Gasket, R.	39	301742	Relay Cover
7	302406	Door Liner, R.	40	301957	Clip Relay Cover
8	300308	Screw #023	41	302427	Grommet Comp.Mtg.
9	301593	Door Trim R.	42	302814	Nylon Clamp.
10	300509	Shim,Hinge Middle	43	302365	Compressor Base Plate
11	300493	Screw #036	44	302289	Grommet Comp.Mtg.
12	302814	Clamp	45	300413	Bolt #10194
13	302198	Middle Shim	46	302397	Compressor CQN78L2A
14	302239	Screw Middle Hinge	47	301744	Power Cord, SPT-3
15	302392	Hinge Middle	48	301817	Cord Clamp
16	301084	Middle Hinge Cover	49	301991	Screw #026
18	302193	Plate Mullion	50	302150	Condenser
19	302394	Trim Shelf Door	51	302486	Ice Cube Tray
20	301868	Bolt #027	52	301769	Shelf
21	302175	Thermo Knob	53	300820	Crisper
22	302359	Plug Bottom	54	302172	Trim Shelf Crisper
23	300018	Thermostat	55	302364	Shelf Crisper, Clear Glass
24	302174	Scraper	56	302711	Shim Hinge Top
25	301021	Light Bulb	57	302378	Nylon Washer, Natural
26	302199	Lamp Socket	58	302361	Hinge Cover
27	302685	Panel Thermo	59	302342	Hinge Top
28	302009	Bolt #119			
29	301730	Case Wire Splicer			
30	302458	Drain Tray, Black			
31	302291	Leg			
32	302345	Bottom Hinge			
33	302345	Shaft, Hinge Bottom			

### Parts Not Illustrated

303023	Owner's Manual
302340	Mascot
302153	Technical Sheet

MODEL: 564-98292400

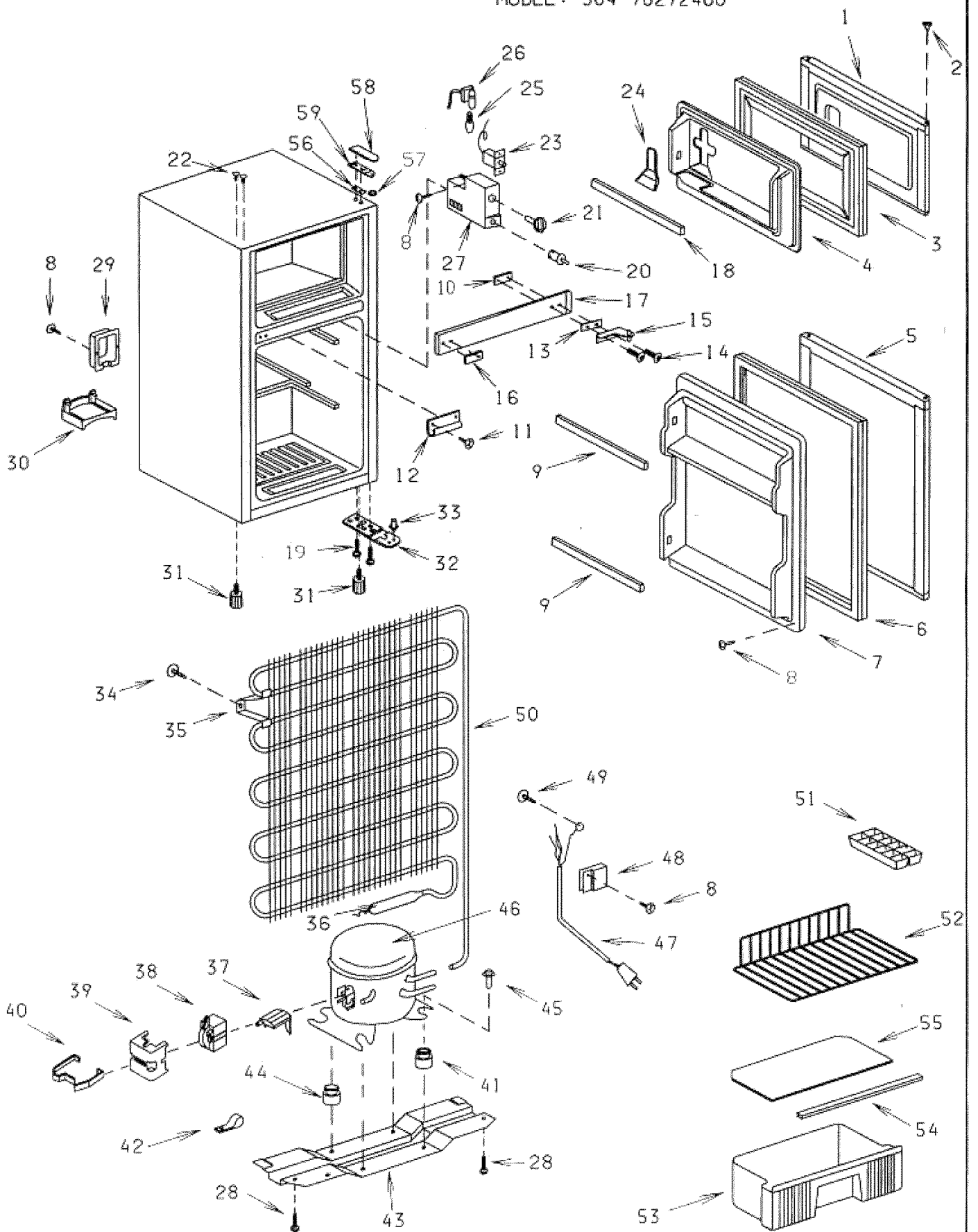

## REVERSING THE DOOR SWING

Refer to the disassembly diagram and change the door hinges in the following procedure. The numbers in the diagram ( see back page) indicate the procedure order in the instructions.

1. Remove the hinge cap by twisting it off.
2. Remove the upper hexagonal head screws. The freezer door can now be removed. *Use a pad or blanket to protect the floor and avoid scratching the painted finish.*
3. Remove the middle hexagonal head screws. The refrigerator door can now be removed.
4. Remove the lower hexagonal head screws and the leg.
5. Remove the left side leg, attach it to the other side hole that was positioned symmetrically.
6. Attach the bottom hinge symmetrically to the other side of cabinet.
7. Remove the upper hinge plastic pins and insert them in the holes from which the screws are removed in procedure 2.
8. Remove the middle hinge plastic pins and insert them in the holes from which the screws were removed in procedure 3.
9. Take off the hinge collar caps using a screwdriver and insert them in the hinge collars on the opposite side.
10. Attach the refrigerator door to the bottom hinge.
11. Rotate the middle hinge 180°. Attach it to the refrigerator door and secure it with a screw. (Do not tighten the screw completely.)
12. Attach the upper hinge to the freezer door. Attach the freezer to the middle hinge and use the screw to attach the upper hinge. (Do not tighten the screw completely.)
13. The direction in which the doors open has now been changed; however, the following points should be checked:
  - a) Make sure both doors are on straight
  - b) Make sure that there is no space between the door gaskets and the refrigerator unit itself when the doors are closed.
  - c) Make sure that the gasket on the hinged side is not caught between the door and the unit when the door is opened or closed. (If the door is forced closed when the gasket is caught, the gasket may be damaged.)
14. After making sure that the doors are installed correctly, tighten all the screws holding the hinges. If they are not tightened, the doors may slip out of position or there may be an opening between the doors and the unit.

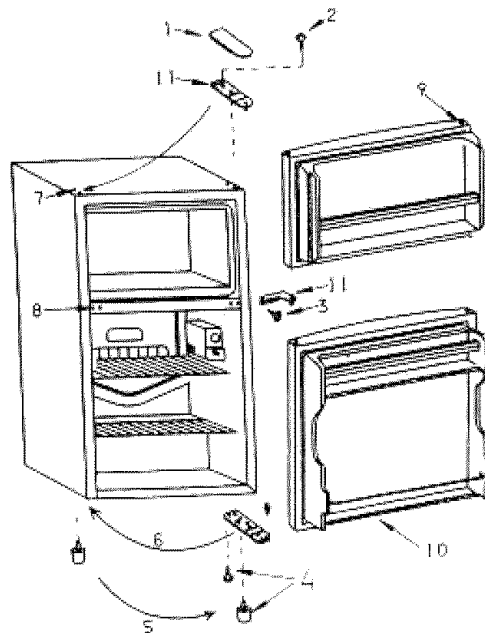

## Before Calling for Service

### Caution:

Your Kenmore refrigerator is an electrical appliance and should be unplugged before changing the light bulb or other servicing that involves the electrical system.

*See if your question can be answered on this page.*

## My Refrigerator is Too Warm

Review adjusting Temperature Control setting.

## My Refrigerator Has Stopped Running and The Light is Not On

1. Check the light bulb.
2. Make sure the power cord plug is making full contact in the wall outlet. Check the outlet with another appliance or lamp.
3. Check the fuse box for a blown fuse or tripped circuit breaker.

## When Power Fails

1. Keep the refrigerator door closed.
2. When the power is off for more than 5 hours, fill extra space in freezer with dry ice or transfer the food to the nearest food locker.

## Moisture Collects on the Outside of My Refrigerator

1. Periods of high humidity and temperature will cause this.
2. Make sure the doors seal tightly. If they do not, adjust the leveling feet.

## My Refrigerator Sounds Noisy

Make sure the cabinet is level from side to side and from front to back. Make sure the cabinet is not touching the wall and rests squarely on the floor at all four corners.

## There is an Odor in My Refrigerator

1. Check covers on food containers in both sections.
  - Check for spilled food.
2. Clean both sections.

## Ice Has an Odd Flavor

Ice, regardless of how it is made, will sometimes develop an off flavor or color if it kept too long. To avoid this empty ice cube trays and make a completely new supply about once a month.

## Model Number Location

If you ever need service, be sure to give the complete eleven digit model number. It's on a small label on the back of the refrigerator. For example if you have Kenmore 98291, your complete number may be 564.98291890

## To Order Repair Parts, See p. 4-5

## Full One Year Warranty on Refrigerator

For one year from the date of purchase, when this refrigerator is operated and maintained in accordance with the owner's manual that come with it, Sears will repair it, free of charge, if defective in material or workmanship.

## Full Five Year Warranty on Sealed Refrigeration System

For five years from the date of purchase, when this refrigerator is operated and maintained in accordance with the owner's manual that come with it, Sears will repair the sealed system (consisting of refrigerant, connecting tubing and compressor motor), free of charge, if defective in material or workmanship.

The above warranty coverage applies only to refrigerators which are used for the storage of food for private household purposes.

**Warranty service is available by contacting the nearest Sears Service Center throughout the United States.**

This warranty applies only while this product is in the United States. This warranty gives you specific rights and you may also have other rights which vary from state to state.

Sears, Roebuck and Co.  
Hoffman Estates, IL 60179

# Get fixed, at your home or ours!

## Your Home

For repair-in your home-of all major brand appliances,  
lawn and garden equipment, or heating and cooling system,  
**no matter who made it, no matter who sold it!**

For the replacement parts, accessories and  
owner's manuals that you need to do-it-yourself.

For Sears professional installation of home appliances  
and items like garage door openers and water heaters.

**1-800-4-MY-HOME®** (1-800-469-4663)

Call anytime, day or night (U.S.A. and Canada)

[www.sears.com](http://www.sears.com) [www.sears.ca](http://www.sears.ca)

---

## Our Home

For repair of carry-in items like vacuums, lawn equipment,  
and electronics, call or go on-line for the location of your nearest  
**Sears Parts & Repair Center.**

**1-800-488-1222**

Call anytime, day or night (U.S.A. only)

[www.sears.com](http://www.sears.com)

---

To purchase a protection agreement on a product serviced by Sears:

**1-800-827-6655** (U.S.A.)      **1-800-361-6665** (Canada)

---

Para pedir servicio de reparación  
a domicilio, y para ordenar piezas:

**1-888-SU-HOGAR<sup>SM</sup>**

(1-888-784-6427)

Au Canada pour service en français:

**1-888-LE-FOYER<sup>M C</sup>**

[www.sears.ca](http://www.sears.ca)

**SEARS**