

# Owner's Manual



for Carbide Tipped Blades or Dado Sets

## Zero Clearance Insert

Model No.  
152.298890

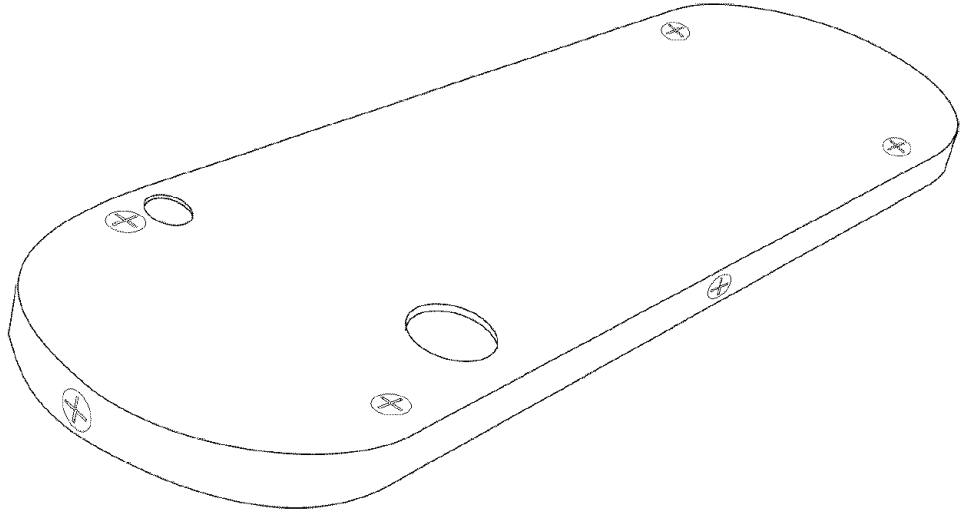

Fits: Craftsman Table Saw Models: 22104, 22114, 22124

### CAUTION:

FOR YOUR OWN SAFETY; Read and follow all of the Safety and Operating Instructions before using this product.

Customer Helpline  
**1-800-897-7709**  
Please have your Model No.  
available.

Sears, Roebuck and Co., Hoffman Estates, IL 60179 U.S.A.  
Manual Part No.: OR92850

# SAFETY INSTRUCTIONS

## **WARNING**

To avoid serious injury and damage to the tool, read and follow all of the Safety and Operating Instructions before installing or operating the table saw with this zero clearance insert.

1. **READ** the entire Instruction Manual. **LEARN** how to use the tool for its intended applications.
2. **ALWAYS UNPLUG THE TOOL FROM THE ELECTRICAL RECEPTACLE** when making adjustments, changing parts, fitting insert or performing any maintenance.
3. **ALWAYS WEAR EYE PROTECTION.** Any power tool can throw debris into the eyes during operations, which could cause severe and permanent eye damage. Everyday eyeglasses are **NOT** safety glasses. **ALWAYS** wear Safety Goggles (that comply with ANSI standard Z87.1) when operating power tools. Safety Goggles are available at Sears Retail Stores.
4. **ALWAYS WEAR HEARING PROTECTION.** Plain cotton is not an acceptable protective device. Hearing equipment should comply with ANSI S3.19 Standards.
5. **ALWAYS WEAR A DUST MASK TO PREVENT INHALING DANGEROUS DUST OR AIRBORNE PARTICLES**, including wood dust, crystalline silica dust and asbestos dust. Direct particles away from face and body. Always operate tool in well ventilated area and provide for proper dust removal. Use dust collection system wherever possible. Exposure to the dust may cause serious and permanent respiratory or other injury, including silicosis (a serious lung disease), cancer, and death. Avoid breathing the dust, and avoid prolonged contact with dust. Allowing dust to get into your mouth or eyes, or lay on your skin may promote absorption of harmful material. Always use properly fitting NIOSH/OSHA approved respiratory protection appropriate for the dust exposure, and wash exposed areas with soap and water.
6. **STAY ALERT**, watch what you are doing, and use common sense when operating a power tool. **DO NOT** use a tool while tired or under the influence of drugs, alcohol, or medication. A moment of inattention while operating power tools may result in serious personal injury.
7. **AVOID ACCIDENTAL STARTING.** Make sure that the power switch is in the "OFF" position before plugging in the power cord to the electrical receptacle.
8. **KEEP PROTECTIVE GUARDS IN PLACE** and in working order.
9. **REMOVE ALL MAINTENANCE TOOLS** from the immediate area prior to turning the tool "ON".
10. **WEAR PROPER CLOTHING. DO NOT** wear loose clothing, gloves, neckties, or jewelry. These items can get caught in the machine during operations and pull the operator into the moving parts. The user must wear a protective cover on their hair, if the hair is long, to prevent it from contacting any moving parts.
11. **USE ONLY RECOMMENDED ACCESSORIES.** Use of incorrect or improper accessories could cause serious injury to the operator and cause damage to the tool. If in doubt, check the instruction manual that comes with that particular accessory.
12. **DO NOT** attempt to bevel or tilt the saw blade while the blade is in the insert. The blade will bind, causing severe damage and possible injury. For bevel cuts make a separate insert for that specific purpose. The bevel angle must be pre-set before plunging through the insert.
13. The Insert must be securely clamped down with a board to the table surface, before plunging the blade through the insert.
14. The zero clearance insert is only recommended for use with carbide tipped blades and dado sets.
15. A separate zero clearance insert must be used for each individual blade, dado stack or angle set up. This will reduce the risk of injury and or damage to the machine.
16. **MAKE SURE** the saw blade is not in contact with the insert before starting the table saw.
17. If using blade stabilizers, **CHECK** clearances before attempting to plunge cut.
18. When using the zero clearance insert for thru-cut applications, you must cut out a rear slot in the insert to allow for the splitter/blade guard assembly to attach to the table saw. See section **OPENING FOR SPLITTER/BLADE GUARD ASSEMBLY**.
19. **EACH AND EVERY TIME, CHECK FOR DAMAGED** parts and **PROPER FIT** prior to using the zero clearance insert. Carefully check all guards to see that they operate properly, are not damaged, and perform their intended functions. Check for alignment, binding or breaking of all moving parts. A guard, insert or other part that is damaged should be immediately repaired or replaced.

# KNOW YOUR INSERT

- A Top surface of insert
- B Leveling screws
- C Width adjustment screw
- D Finger Hole
- E Length adjustment screw
- F Retaining bolt hole

- G Rear retaining pin
- H Splitter/Blade guard pocket
- I Blade pocket

Fig. 1-1

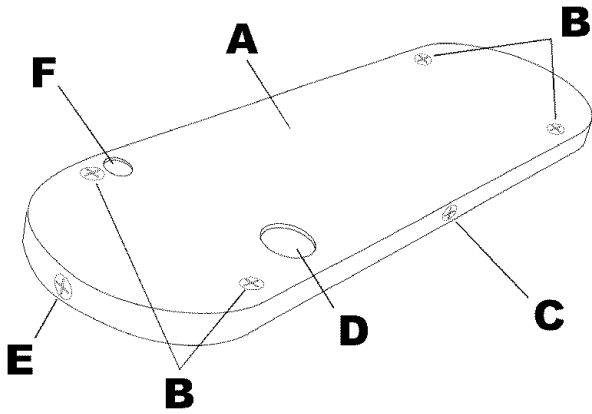
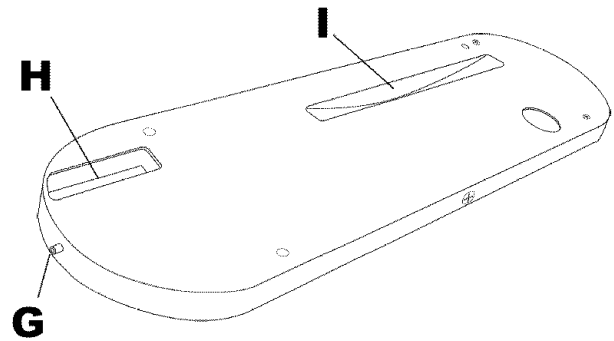

Fig. 1-2



# OPENING FOR SPLITTER/BLADE GUARD ASSEMBLY

When using the zero clearance insert for thru-cut applications, you must cut out the splitter/blade guard pocket to allow the assembly to attach to the table saw. If you are using the insert for non-thru cuts like dados you do not have to perform this operation.

1. Use a scroll saw, band saw or hack saw to cut-out the splitter/blade guard pocket (H). See Figure 1-2.
2. A file or sand paper can be used to clean up rough edges.
3. Figure 2-1 shows the splitter/blade guard pocket removed from the insert.

Fig. 2-1

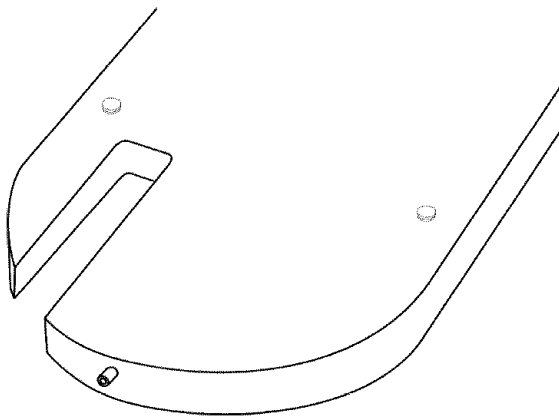

## INSTALLING AND FITTING

### **⚠ WARNING**

**MAKE CERTAIN** the table saw is disconnected from the power source when making adjustments.

Fig. 3-1

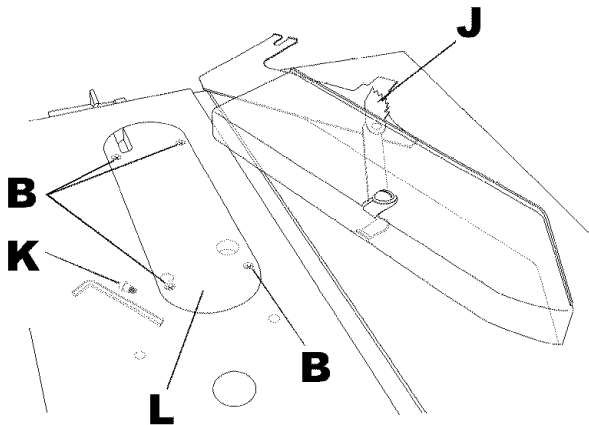

1. Lower the saw blade down completely.
2. Remove the splitter/blade guard assembly (J) from the table saw as shown in Figure 3-1. Refer to your table saw instruction manual for proper procedure.
3. Remove the standard insert from the table saw. Keep the retaining bolt (K), this will be used to secure the zero clearance insert. See Figure 3-1.
4. Place the zero clearance insert (L) into table opening. Tip the back of the insert down and place the rear retaining pin (G) under the table opening lip. **MAKE SURE** the insert is positioned with blade pocket (I) over the saw blade and the finger hole (D) to the right side. See Figure 1-1, 1-2 and 3-2.
5. Using the four leveling screws (B), level the insert with the saw table. Use a straight edge to make sure the insert is level. See Figure 3-1.
6. Adjust the length (E) and width (C) adjustment screws until you get a snug fit front to back and side to side, yet removable. See Figure 1-1.
7. Replace the retaining bolt (K) and secure the insert to the table. See Figure 3-1.
8. Open motor cover of the table saw and **CHECK** that the blade (M) spins free as shown in Figure 3-2. The blade should be inside of the blade pocket (I).

Fig. 3-2

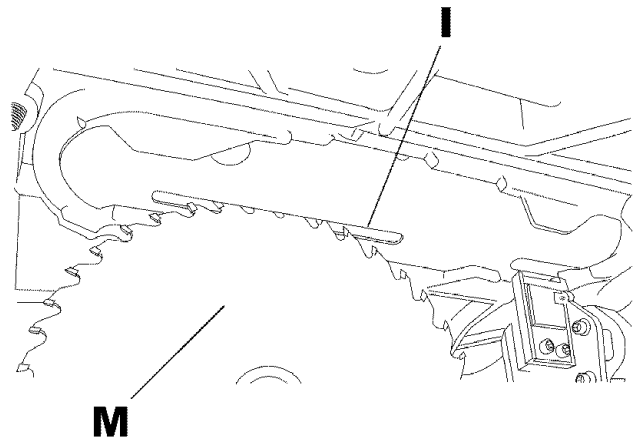

## CUTTING THE BLADE OPENING

### **WARNING**

**MAKE CERTAIN** the table saw is disconnected from the power source when making adjustments.

Fig. 4-1

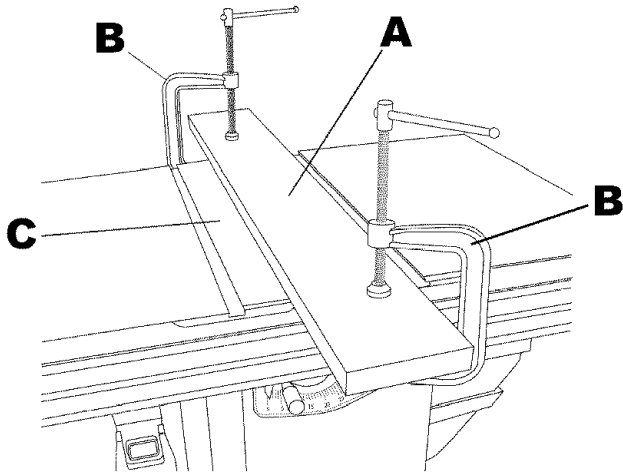

1. Double check that the insert has proper fit, retaining bolt is installed and the blade is clear and spins free.
2. Fully cover the insert with a board (A) and use two C-clamps (B) to securely fasten the board to the saw table (C). See Figure 4-1.
3. **MAKE SURE** the saw is OFF, plug the saw into the receptacle and turn the saw ON. **MAKE SURE** no one is standing in front of the board secured to the saw table.
4. Start slowly and cautiously to raise the saw blade to its maximum height. Keep hands off of the saw table and board.
5. Lower the blade and turn the saw OFF and unplug the saw from the receptacle.
6. Remove the C-clamps and board from the saw table.

Fig. 4-2

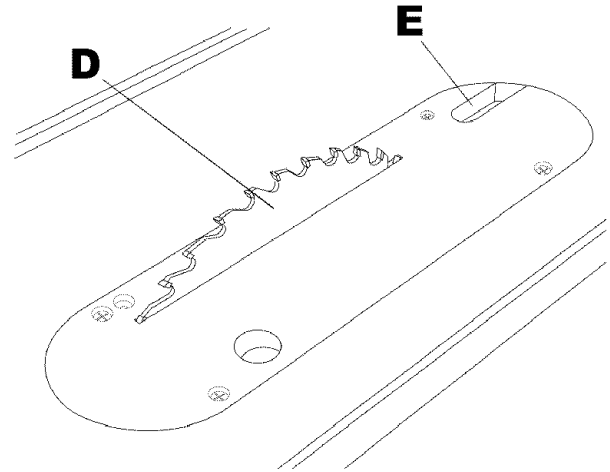

7. Figure 4-2 shows the saw blade (D) through the insert and the splitter/blade guard pocket cut-out (E).
8. For thru-cut operations, reinstall the splitter/blade guard assembly (F) as shown in Figure 4-3.

Fig. 4-3

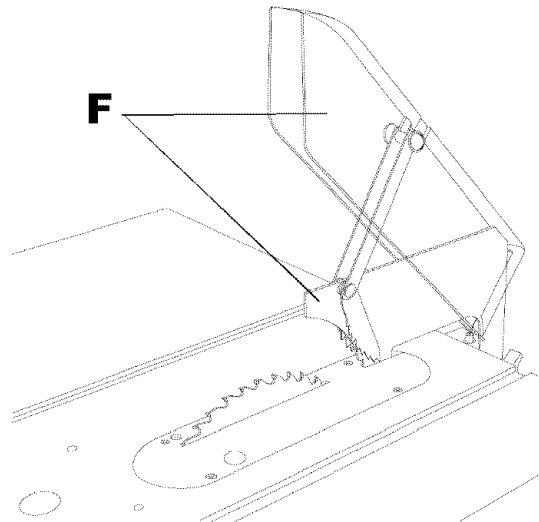

### **IMPORTANT TIPS**

- For Dado Blade - Use same procedures as outlined above, but use additional caution due to excessive material being machined from the insert during cutting operation.
- Under certain conditions, an underside scraping noise may be generated by the saw blade. Planer Type Blades and/or blade runout may be causing intermittent contact with the insert. To remedy this, remove the insert and slightly widen the slot using a file or sand paper.

# PARTS

Zero Clearance Insert

Model No. 152.298890

## **⚠ WARNING**

When servicing, use only CRAFTSMAN replacement parts. Use of any other parts may create a **HAZARD** or cause product damage.

Always order by PART NUMBER, not by key number.

	<b>PART No.</b>	<b>Description</b>	<b>Qty.</b>
1.	OR92852	Insert only	1
2.	OR92853	Leveling screws	4
3.	OR92853	Width adjustment screw	1
4.	OR92853	Length adjustment screw	1
5.	OR92854	Rear retaining pin (not shown)	1
6.	OR92855	Warning label (not shown)	1
7.	OR92850	Instruction Manual (not shown)	1
8.	OR92851	Carton (not shown)	1

