

Owner's Manual

CRAFTSMAN®

Model No. 486.24847

FRONT SCOOP TRACTOR ATTACHMENT

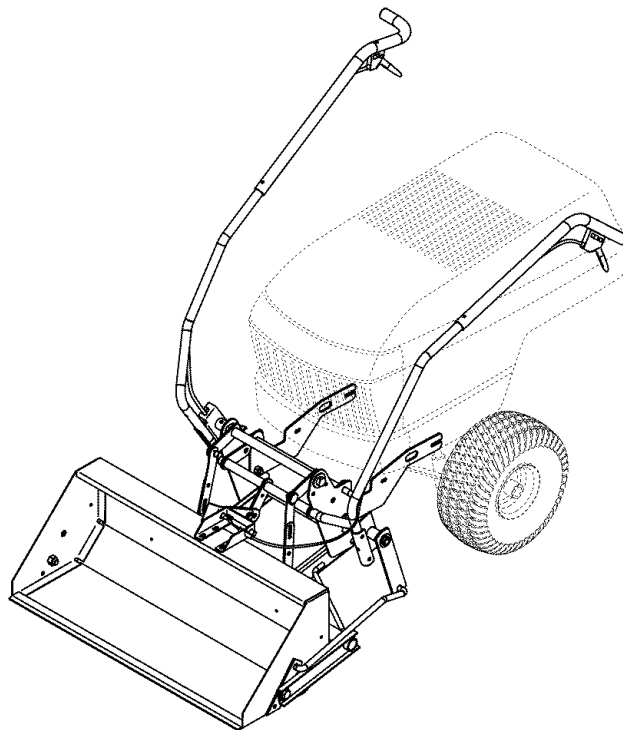

CAUTION:

Before using this product, read this manual and follow all Safety Rules and Operating Instructions.

IMPORTANT - READ THIS FIRST!!!

For Missing Parts or Assembly Questions

Please Call 866-576-8388

Mon.-Fri. 7 a.m.-5 p.m. CST.

FAX 217-728-2032 or e-mail info@agri-fab.com

Missing parts will be sent UPS in 24 hours directly to your home.

- Safety
- Assembly
- Operation
- Maintenance
- Parts

Sears, Roebuck and Co., Hoffman Estates, IL 60179 U.S.A.

www.sears.com/craftsman

TABLE OF CONTENTS

WARRANTY	2	MAINTENANCE	15
SAFETY RULES	3	TROUBLESHOOTING	15
FULL SIZE HARDWARE CHART	4	REPAIR PARTS ILLUSTRATION	16
CARTON CONTENTS	6	REPAIR PARTS LIST	17
ASSEMBLY	7	SLOPE GUIDE	19
OPERATION	14	PARTS ORDERING/SERVICE	Back Page

WARRANTY

LIMITED ONE YEAR WARRANTY ON CRAFTSMAN FRONT SCOOP TRACTOR ATTACHMENT

For one year from the date of purchase, when this scoop is maintained and lubricated according to the operating and maintenance instructions in this owner's manual, Sears will repair any defect in material or workmanship free of charge. If this scoop is used for commercial or rental purposes, this warranty applies for only 90 days from the date of purchase.

This warranty does not cover repairs necessary because of operator negligence or abuse, including the failure to maintain the equipment according to instructions contained in this owner's manual.

WARRANTY SERVICE IS AVAILABLE BY CONTACTING THE NEAREST SEARS SERVICE CENTER/ DEPARTMENT IN THE UNITED STATES.

This warranty applies only while this product is in the United States.

This warranty gives you specific legal rights, and you may also have other rights which vary from state to state.

Sears, Roebuck and Co., D/817 WA., Hoffman Estates, Chicago, IL 60179

The model number and serial number will be found on a decal attached to the bucket.

You should record both the serial number and the date of purchase and keep in a safe place for future reference.

MODEL NUMBER: 486.24847

SERIAL NUMBER: _____

DATE OF PURCHASE: _____



SAFETY RULES



Any power equipment can cause injury if operated improperly or if the user does not understand how to operate the equipment. Exercise caution at all times, when using power equipment.

- Read this owner's manual before attempting to assemble or operate the scoop attachment.
- Read the vehicle owner's manual and know how to operate your vehicle before using the scoop attachment.
- Never carry passengers in the scoop bucket. It has not been designed to carry passengers.
- Never allow children to operate the vehicle or the scoop attachment.
- Do not allow adults to operate the vehicle or scoop attachment without proper instructions.
- Always begin with the transmission in first (low) and gradually increase speed as conditions permit.
- Drive the tractor at reduced speed over rough terrain and hillsides or near creeks and ditches to prevent tipping over and loss of control. Do not drive too close to a creek or ditch.
- Never ram the scoop into material at high speed.
- Vehicle braking and stability may be affected with the attachment of this scoop. Do not fill the scoop to maximum weight capacity without checking the capability of the vehicle to safely drive and stop with the scoop attached.
- Before operating vehicle on any grade (hill) refer to the safety rules in the vehicle owner's manual concerning safe operation on slopes. Refer also to the slope guide on page 19 of this manual. **Stay off steep slopes!**
- Follow maintenance and lubrication instructions as outlined in this manual.



Look for this symbol to point out important safety precautions. It means—**Attention!! Become alert!! Your safety is involved.**

ACCESSORIES AND ATTACHMENTS

These accessories were available when the unit was purchased. They are also available at most Sears retail outlets and service centers. Most Sears stores can order repair parts for you when you provide the model numbers of your tractor and scoop.

WHEEL WEIGHT

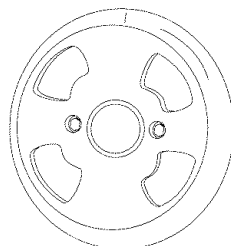

FULL SIZE HARDWARE CHART

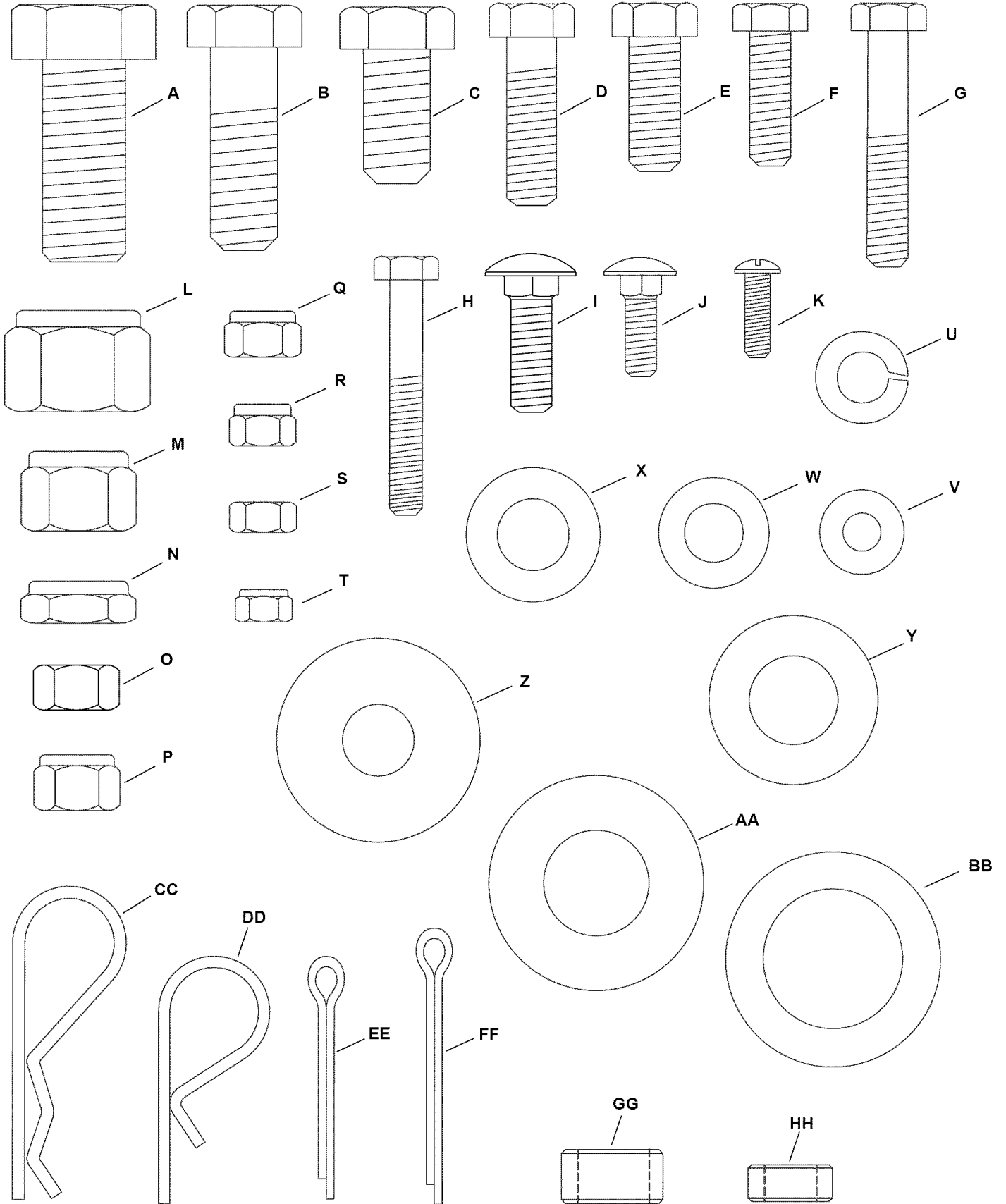

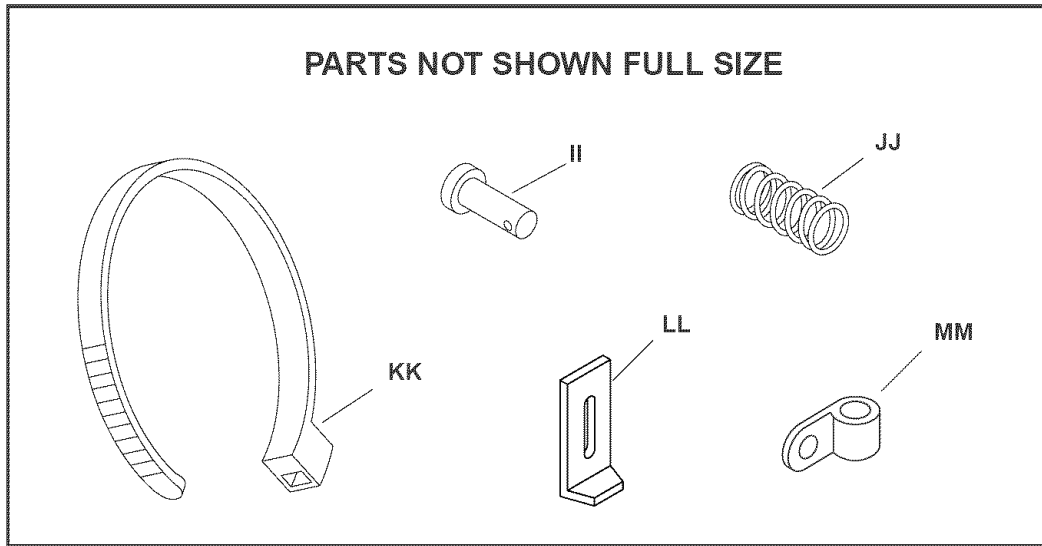

PARTS BAG CONTENTS

Not all parts will be needed for fit-up to any one tractor.
Discard unneeded parts after assembly is finished.

REF.	QTY.	DESCRIPTION	REF.	QTY.	DESCRIPTION
A	2	Hex Bolt, 5/8" x 1-1/2"	U	6	Lock Washer, 3/8"
B	2	Hex Bolt, 1/2" x 1-1/2"	V	3	Washer, 1/4"
C	3	Hex Bolt, 1/2" x 1"	W	8	Washer, 5/16"
D	2	Hex Bolt, 3/8" x 1-1/4"	X	3	Washer, 1/2" Small
E	4	Hex Bolt, 3/8" x 1"	Y	6	Washer, 5/8"
F	5	Hex Bolt, 5/16" x 1"	Z	2	Washer, 1/2" Large
G	5	Hex Bolt, 5/16" x 1-3/4"	AA	2	Washer, 3/4"
H	3	Hex Bolt, 1/4" x 1-3/4"	BB	2	Washer, 1"
I	2	Carriage Bolt, 5/16-18 x 1"	CC	3	Hairpin Cotter, Long
J	2	Carriage Bolt, 1/4-20 x 3/4"	DD	4	Hairpin Cotter, Short
K	1	Slotted Truss Head Bolt, 10-32 x 5/8"	EE	6	Cotter Pin, 1/8" x 1-1/4"
L	2	Nylock Nut, 5/8"	FFF	2	Cotter Pin, 1/8" x 1-1/2"
M	2	Nylock Nut, 1/2"	GG	4	Spacer, 1/2"
N	3	Nylock Jam Nut, 1/2"	HH	1	Spacer, 3/8" Small
O	2	Hex Nut, 3/8"	II	2	Clevis Pin
P	2	Nylock Nut, 3/8"	JJ	1	Compression Spring
Q	12	Nylock Nut, 5/16"	KK	6	Cable Tie
R	5	Nylock Nut, 1/4"	LL	2	Tilt Stop Bracket
S	1	Hex Nut, 1/4"	MM	1	Hose Clip
T	1	Nylock Nut, #10-32			

ASSEMBLY

CARTON CONTENTS

- | | | |
|--------------------------|-----------------------------|--------------------------------|
| 1. Bucket Assembly | 8. Right (GT) Side Plate | 15. Lift Handle Tube |
| 2. Pin Stop Bracket | 9. Left (GT) Side Plate | 16. Dump Handle Tube Extension |
| 3. Lift Frame Assembly | 10. Dump Control Rod | 17. Dump Pivot Bracket |
| 4. Lift Bracket Assembly | 11. Lift Strap Assembly (2) | 18. Lift Handle Tube Extension |
| 5. Tilt Anchor Assembly | 12. Tilt Bracket Assembly | 19. Dump Control Pin |
| 6. Right (LT) Side Plate | 13. Attachment Rod | 20. Lift Cable (Short) |
| 7. Left (LT) Side Plate | 14. Dump Handle Tube | 21. Lift Cable (Long) |

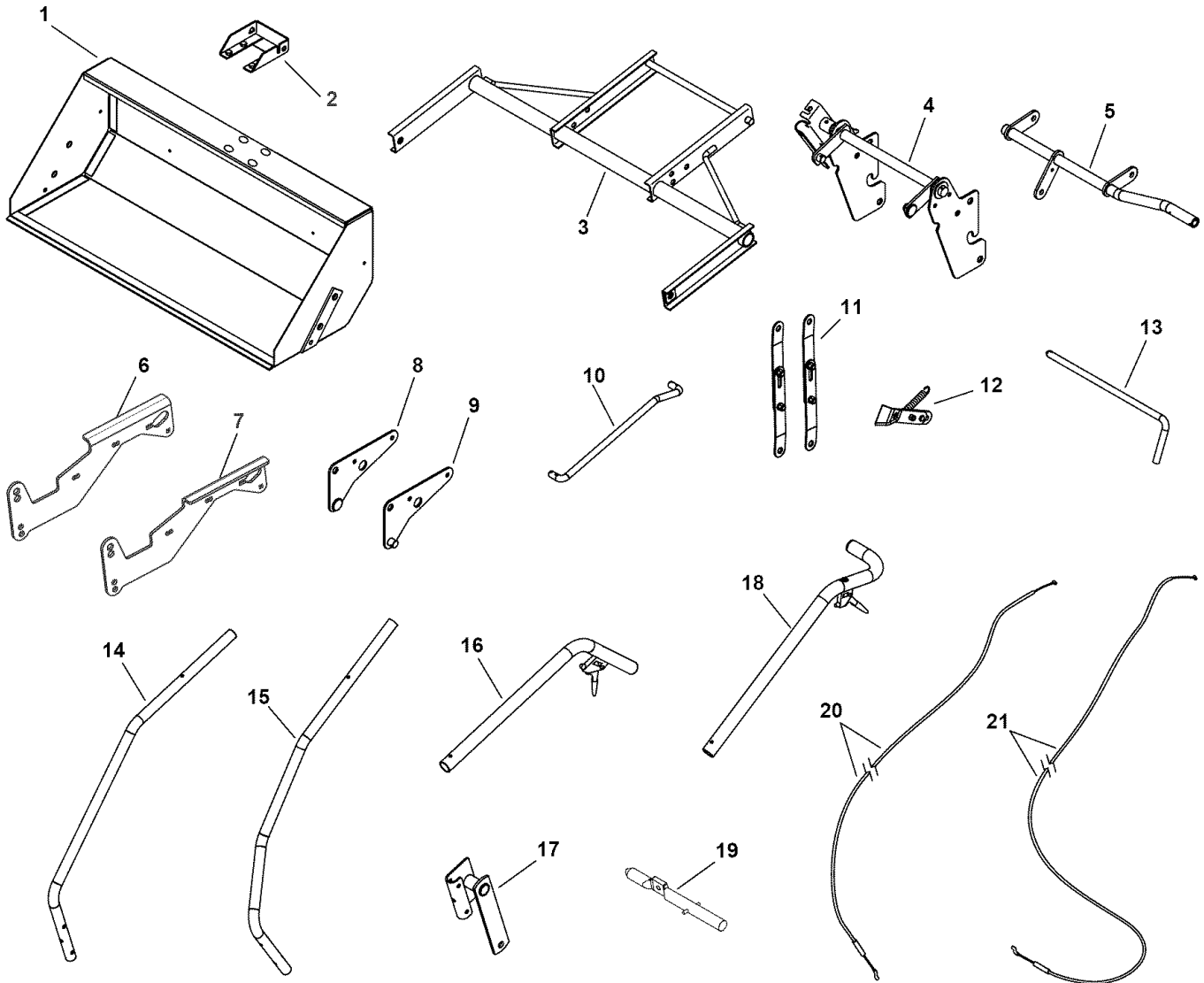

TOOLS REQUIRED FOR ASSEMBLY

- (1) #2 Phillips Screwdriver
- (1) Standard Screwdriver
- (2) 15/16" Wrenches (one should be box-end)
- (2) 3/4" Wrenches
- (2) 9/16" Wrenches
- (2) 7/16" Wrenches
- (2) 1/2" Wrenches
- (1) 3/8" Wrench

ADDITIONAL ITEMS NEEDED

- Ruler or Tape Measure
- Grease

STEP 1 - REMOVE PARTS FROM CARTON

- Remove the hardware pack and all loose parts from the carton.
- Lay cardboard on floor to help prevent scratching of painted parts.
- Lay out and identify all the parts and hardware as shown on pages 4 through 6.

STEP 2 - INSTALL TWO BOLTS

- Assemble two 3/8" x 1-1/4" hex bolts and 3/8" hex nuts, threading the nut all the way onto the bolt until it is tight against the head of the bolt. See figure 1.
- Install a nut/bolt assembly into the bucket assembly and fasten using a 3/8" nylock nut. **Tighten.** Repeat for the other side. See figure 1.

STEP 3 - INSTALL PIN STOP BRACKET

- Install the pin stop bracket to the top of the bucket assembly using four 5/16" x 1" hex bolts, eight 5/16" washers and four 5/16" nylock nuts. Center the bolts in the slots of the pin stop bracket and the slots of the bucket. Tighten the bracket so that it is square with the bucket. See figure 1.

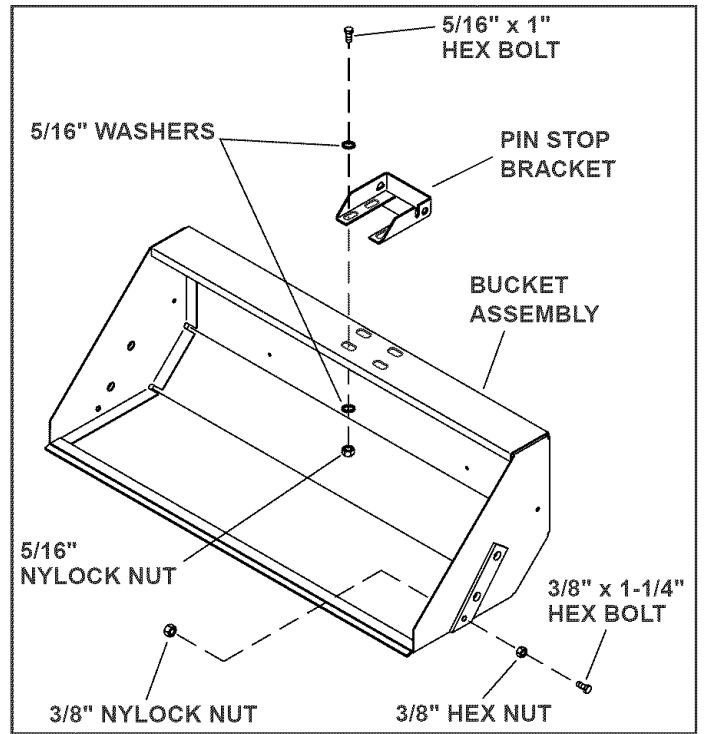

FIGURE 1

STEP 4 - INSTALL LIFT FRAME ASSEMBLY

- Apply grease to the mounting surface of the bucket assembly and the inside of the lift frame arms. See figure 2.
- Assemble the lift frame assembly to the bucket assembly using two 5/8" x 1-1/2" hex bolts and 5/8" nylock nuts. **Tighten, then loosen** the nuts 1/4 turn, or until the lift frame pivots freely. See figure 2.

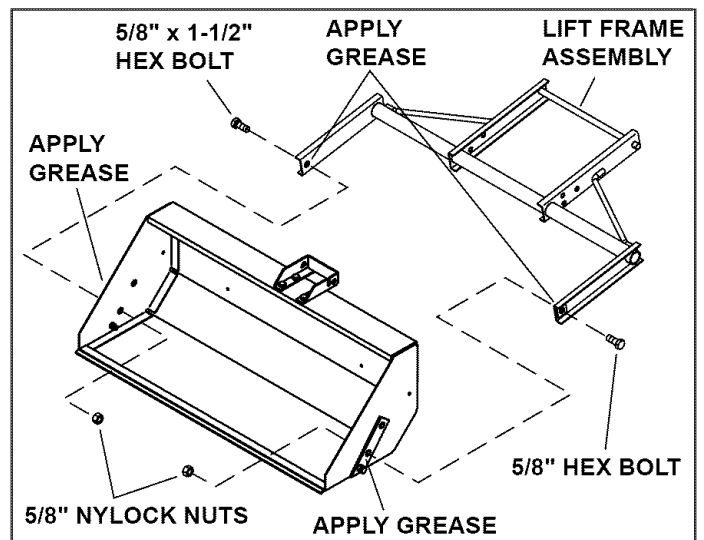

FIGURE 2

STEP 5 - INSTALL LIFT BRACKET ASSEMBLY

- Assemble the lift bracket assembly to the lift frame assembly using two 5/8" washers and 1/8" x 1-1/4" cotter pins. See figure 3.

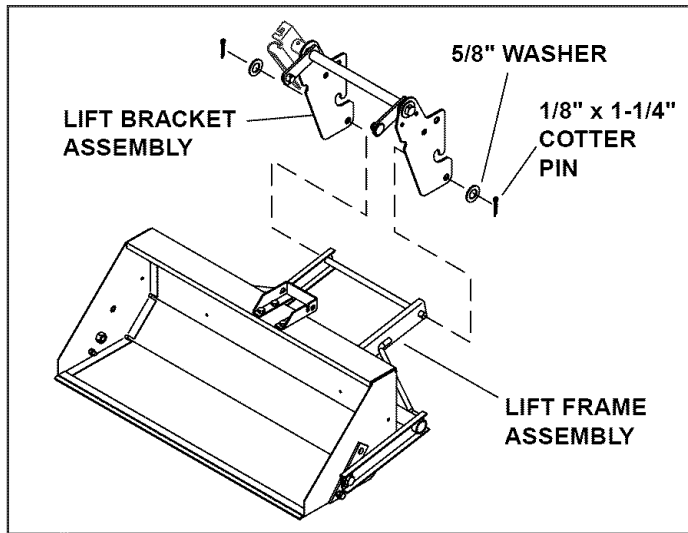

FIGURE 3

STEP 6 - INSTALL TILT ANCHOR ASSEMBLY

- Assemble the tilt anchor assembly to the lift bracket assembly using two 1/2" x 1" hex bolts and nylock jam nuts. **Tighten.** See figure 4.

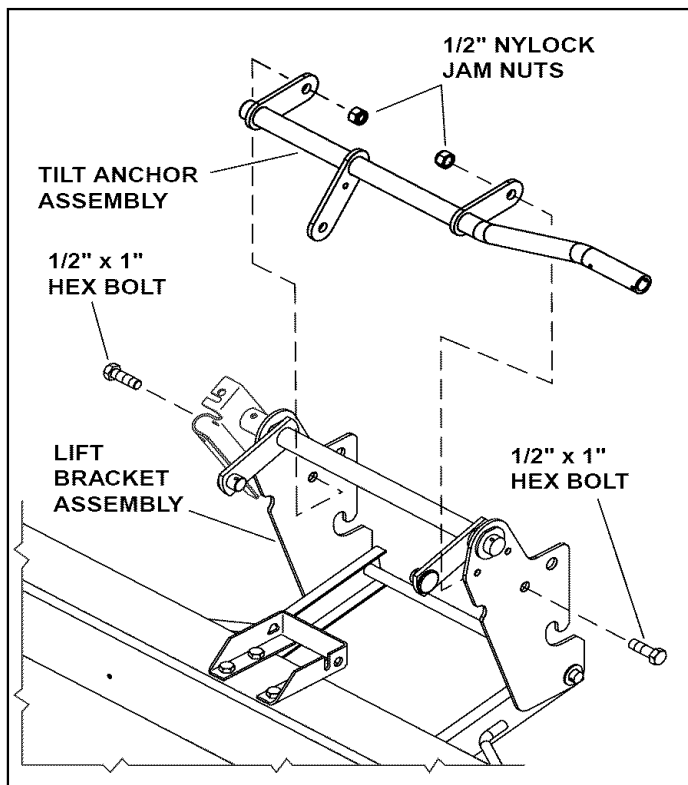

FIGURE 4

STEP 7 - INSTALL LIFT STRAP ASSEMBLIES

- Loosen the bolts and nuts** on the lift strap assemblies 1/4 turn or until the straps will slide back and forth. You will retighten them later in step 24.
- Turn the lift strap assemblies as shown. Install each lift strap assembly to an arm of the lift bracket assembly and then secure with a small 1/2" washer and a short hairpin cotter. See figure 5.
- Position the lower end of each lift strap assembly to the outside of the lift frame. Fasten to the upper front holes in the lift frame using a 1/2" x 1" clevis pin, 1/2" spacer and short hairpin cotter for each assembly. See figure 5.

NOTE: The lift strap assemblies may be installed in the rear mounting holes of the lift frame to increase the lift height, but this will also increase the lifting effort. The front holes give a lift height of about 6-1/2" and require 28 lbs. of force to lift a 150 lb load. The rear holes will give a lift height of about 8-1/2" and require 35 lbs. of force.

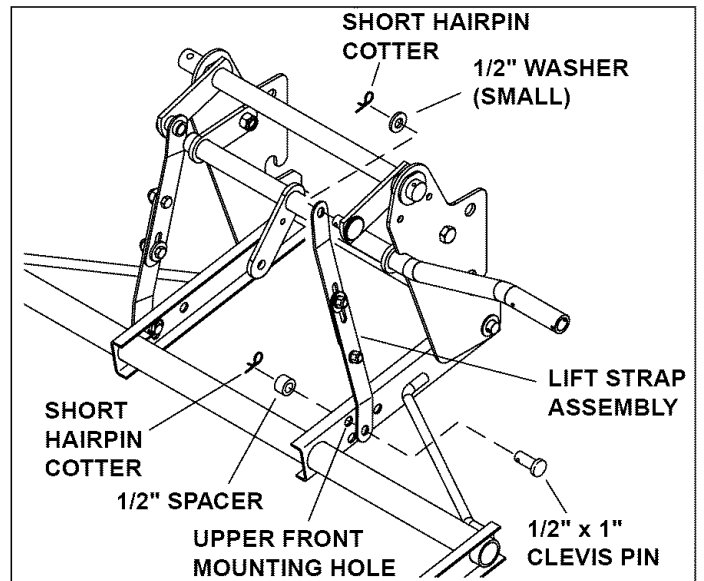

FIGURE 5 Bucket removed for clarity.

STEP 8 - INSTALL TILT BRACKET ASSEMBLY

NOTE: If you mounted the lift strap assemblies in Step 7 to the rear holes in the lift frame for increased lifting height, you need to replace the 3/8" spacer on the tilt bracket assembly with the smaller 3/8" spacer from the parts bag at this time.

- **Loosen the bolts and nuts** on the tilt bracket assembly 1/4 turn or until the two plates will slide back and forth. You will retighten them later in step 23. See figure 6.
- Lightly apply grease to the end of the arm on the tilt anchor assembly and install the tilt bracket assembly to the arm using a 1/2" x 1" hex bolt and 1/2" nylock jam nut. **Tighten.** Loosen the nut 1/4 turn, or until the tilt bracket assembly pivots freely. See figure 6.
- Install a 1/4" x 1-3/4" hex bolt through a 1/4" washer and then through the end of the extension spring on the tilt bracket assembly. Next, install a 1/4" hex nut all the way onto the threads of the bolt. Finally install the end of the bolt into the hole in the arm of the tilt anchor assembly and secure using a 1/4" nylock nut. **Tighten.** See figure 6.

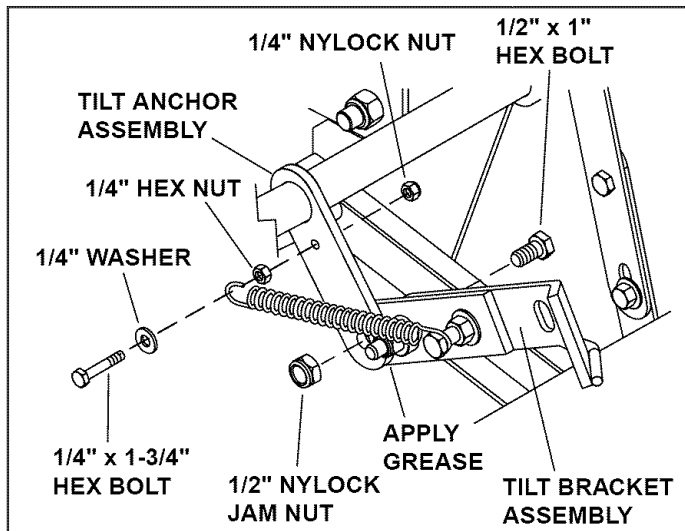

FIGURE 6

STEP 9 - INSTALL DUMP PIVOT BRACKET

- Install a 1/8" x 1-1/2" cotter pin to the inside hole in the shaft shown in figure 9, and then install a 1" washer onto the shaft. Apply grease to the end of the shaft and install the dump pivot bracket assembly onto the shaft. Install a 1" washer onto the shaft and secure it using a 1/8" x 1-1/2" cotter pin. See figure 7.

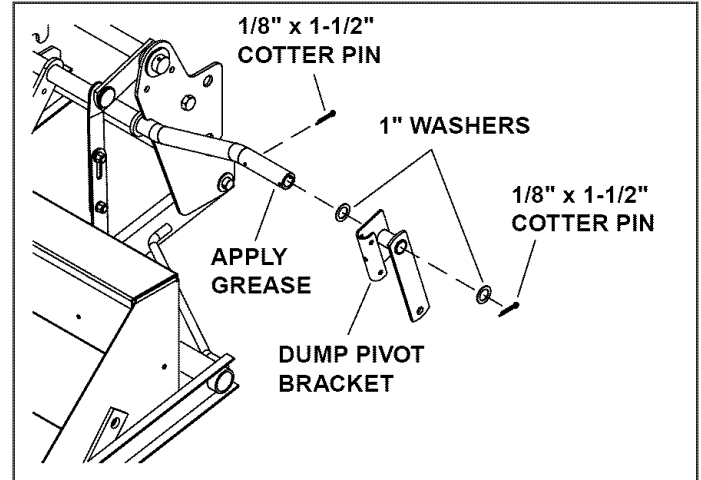

FIGURE 7

STEP 10 - INSTALL DUMP CONTROL ROD

- Install a 1/8" x 1-1/4" cotter pin into the inside hole in each end of the dump control rod. Spread the ends of the cotter pins and wrap around the rod. Install a 5/8" washer onto each end of the control rod. See figure 8.
- Install the dump control rod to the dump pivot bracket and bucket. Fasten using two 5/8" washers and 1/8" x 1-1/4" cotter pins. Spread the ends of the cotter pins and wrap around the rod. See figure 8.

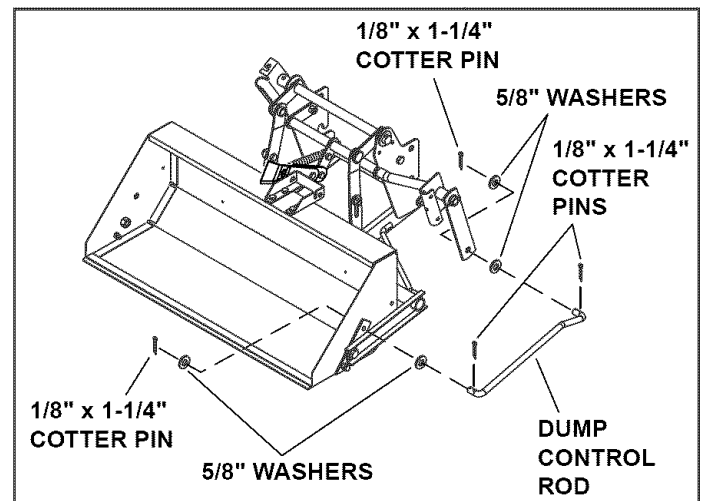

FIGURE 8

STEP 11 - INSTALL TILT STOP BRACKETS

- Install a tilt stop bracket to each side of the bucket using a 1/4" x 3/4" carriage bolt, 1/4" washer and 1/4" nylock nut. **Do not tighten** the nuts until step 25. See figure 9.

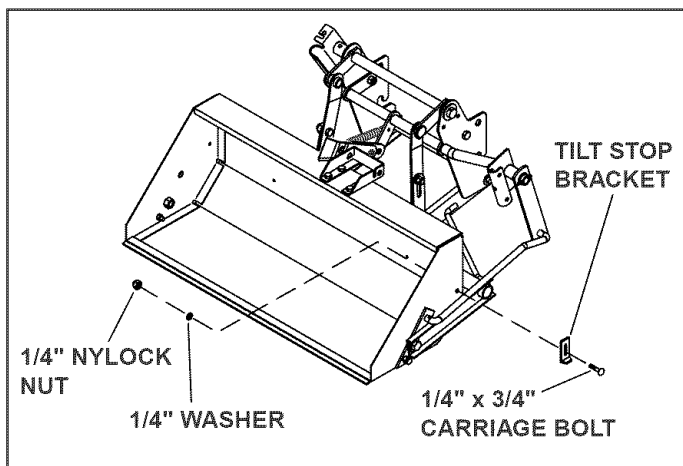

FIGURE 9

STEP 13 - INSTALL LIFT HANDLE TUBE EXTENSION

- Install the lift handle tube extension on the lift handle tube using a 1/4" x 1-3/4" hex bolt and 1/4" nylock nut. See figure 11.

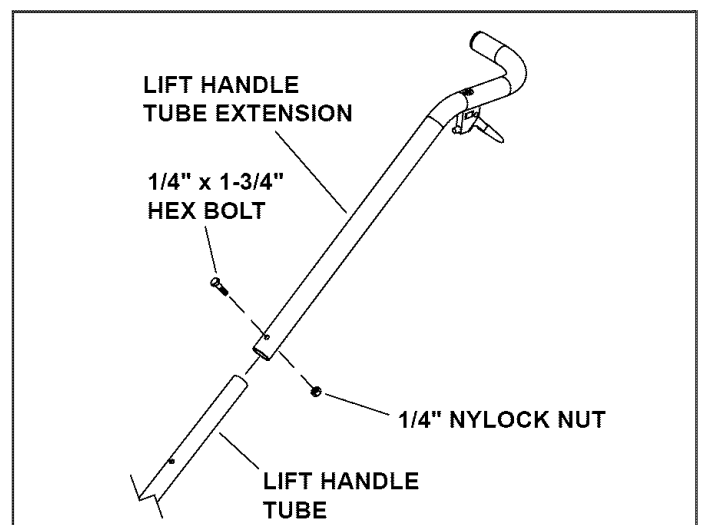

FIGURE 11

STEP 12 - INSTALL LIFT HANDLE TUBE

- Install the lift handle tube on the index bracket using two 5/16" x 1-3/4" hex bolts and 5/16" nylock nuts. See figure 10.

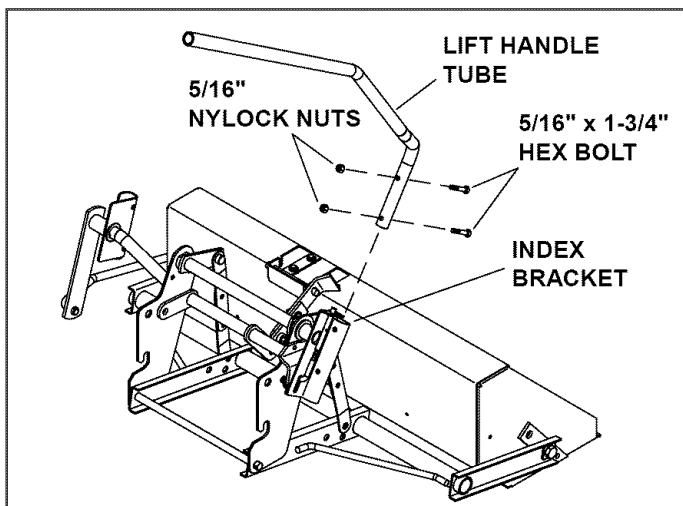

FIGURE 10

STEP 14 - INSTALL LIFT CABLE

- Squeeze the lift trigger and slide the anchor end of the lift (short) cable into the hole in the trigger. Release the trigger and guide the cable through the slot in the bottom of the trigger and trigger housing. Insert the end of the plastic cable covering into the trigger housing. See figure 12.
- Connect the hooked end of the lift cable into the index rod, and install the threaded cable adjuster into the notch in the top of the index bracket, placing a nut on each side of the notch. See figure 12.
- Adjust the cable adjuster nuts so that when the trigger is squeezed, the bottom of the index rod raises enough to release from the latched position. The index rod should also lower far enough to lock in the latched position when the trigger is released. See figure 12.
- Attach the lift cable to the lift handle using three cable ties.

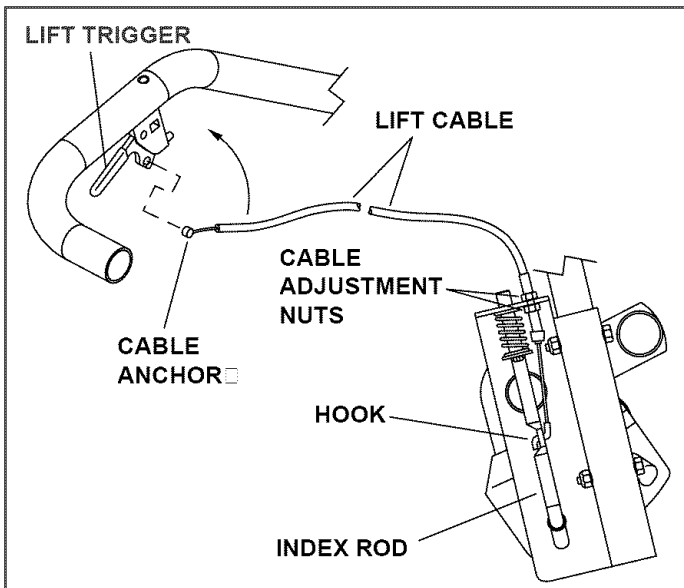

FIGURE 12

STEP 16 - INSTALL DUMP HANDLE TUBE EXTENSION

- Install the dump handle tube extension on the dump handle tube using a 1/4" x 1-3/4" hex bolt and 1/4" nylock nut. See figure 14.

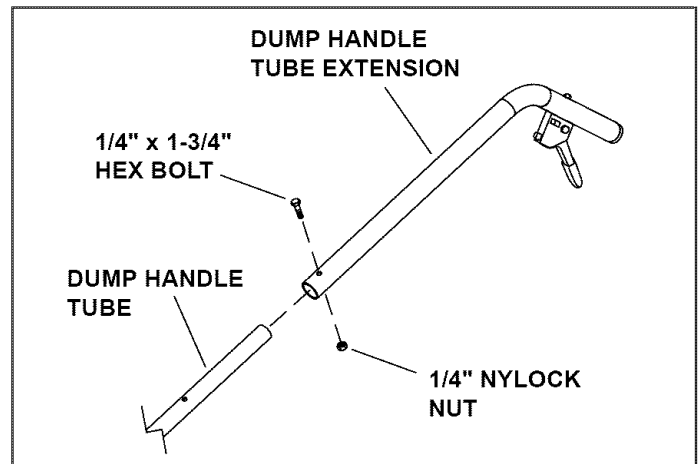

FIGURE 14

STEP 15 - INSTALL DUMP HANDLE TUBE

- Install the dump handle tube to the dump pivot bracket assembly using three 5/16" x 1-3/4" hex bolts and nylock nuts. See figure 13.

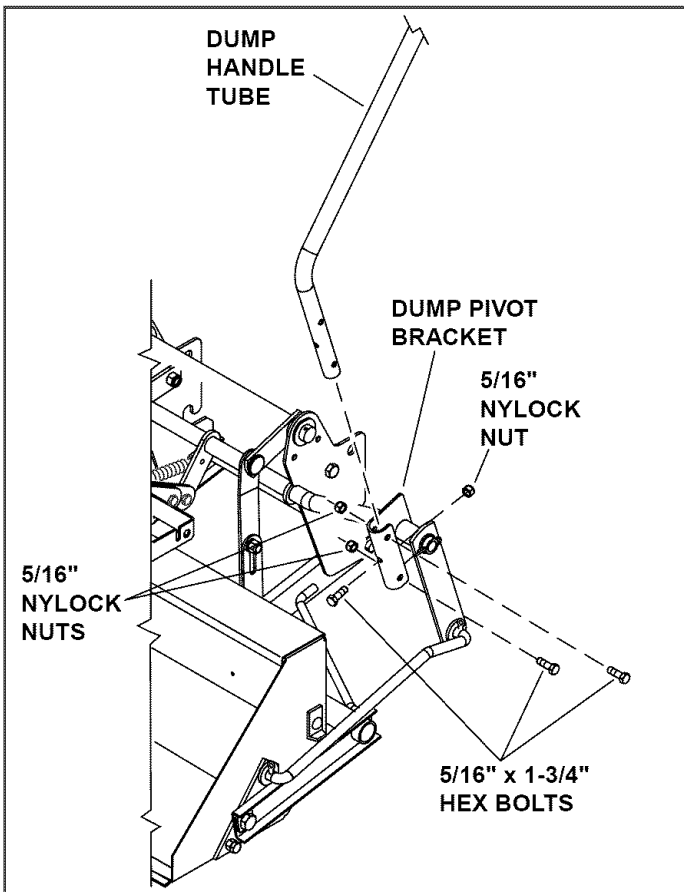

FIGURE 13

STEP 17 - INSTALL DUMP CABLE

- Squeeze the dump trigger and slide the anchor end of the dump (long) cable wire into the hole in the trigger. Release the trigger and guide the cable wire through the slot in the bottom of the trigger and trigger housing. Insert the end of the plastic cable covering into the trigger housing. See figure 15.
- Attach the dump cable to the dump handle tube using three cable ties.

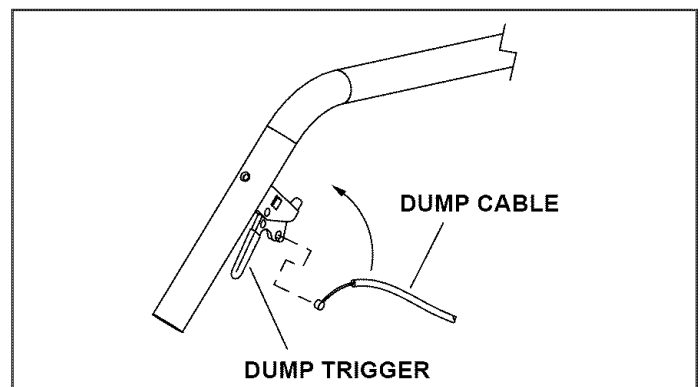

FIGURE 15

STEP 18 - INSTALL DUMP CONTROL PIN

- Install a small 1/2" washer and then the compression spring onto the dump control pin. Install the dump control pin into the pin stop bracket. Make sure the flat side of the pin faces to the front when finished. See figure 16.
- Connect the hooked end of the dump cable into the hole in the dump control pin. Install the threaded cable adjuster down into the notch in the pin stop bracket, placing a nut on each side of the notch. Adjust and tighten the adjuster nuts so that the tapered end of the dump control pin extends 3/4" through the side of the pin stop bracket. See figure 16.

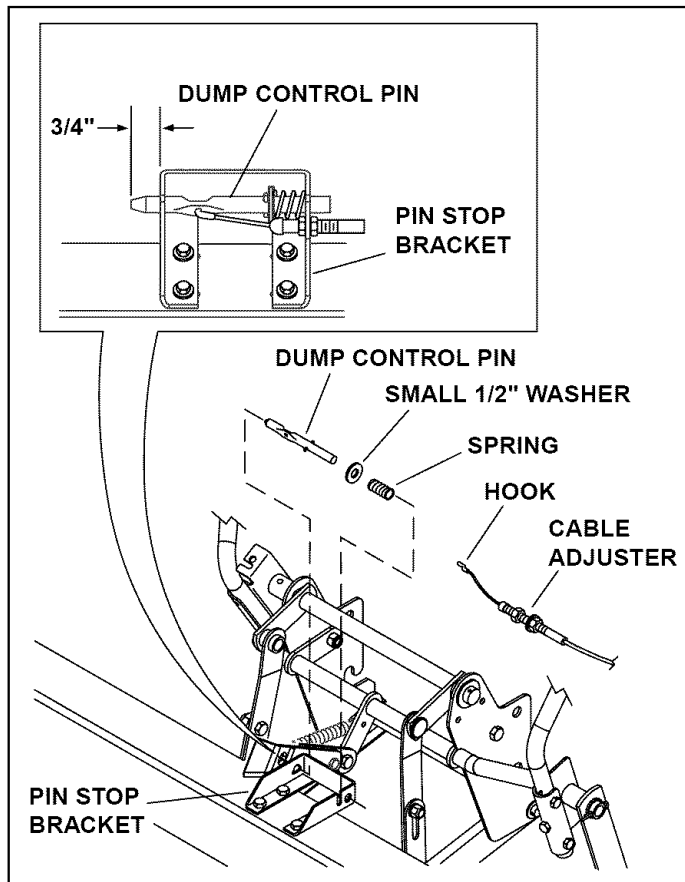

FIGURE 16

STEP 19 - INSTALL HOSE CLIP AND SPACER

- Secure the dump cable to the back of the bucket using a hose clip, #10 x 5/8" truss-head bolt and #10-32 nylock nut. See figure 17.
- Store the unused 3/8" spacer from step 7 on the lift frame using a 5/16" x 1" hex bolt and nylock nut. See figure 17.

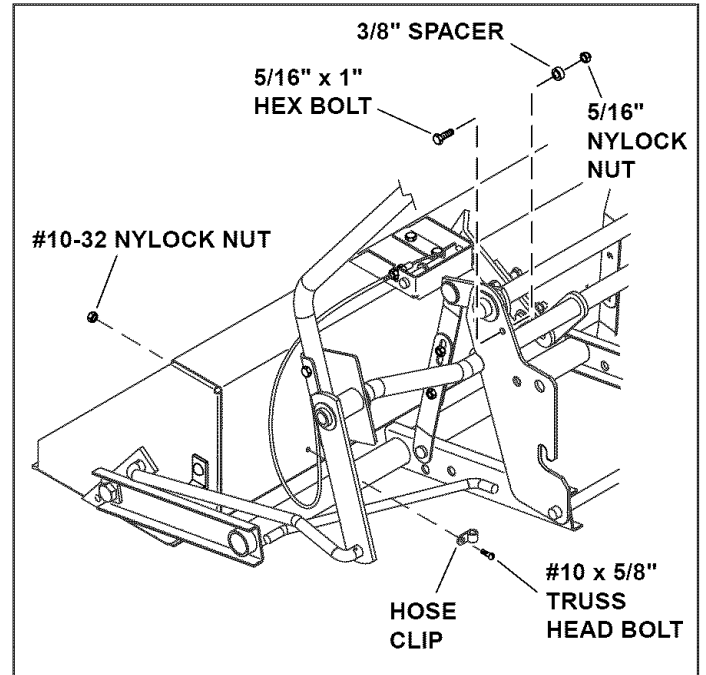

FIGURE 17

STEP 20 - INSTALL (LT) SIDE PLATES

- Install a large 1/2" washer and a 1/2" spacer onto a 1/2" x 1-1/2" hex bolt. Install the bolt into the hole shown in the left (LT) side plate, and fasten using a nylock nut. Repeat the step for the right side plate, but install the bolt, flat washer and spacer from the opposite direction. See figure 18.

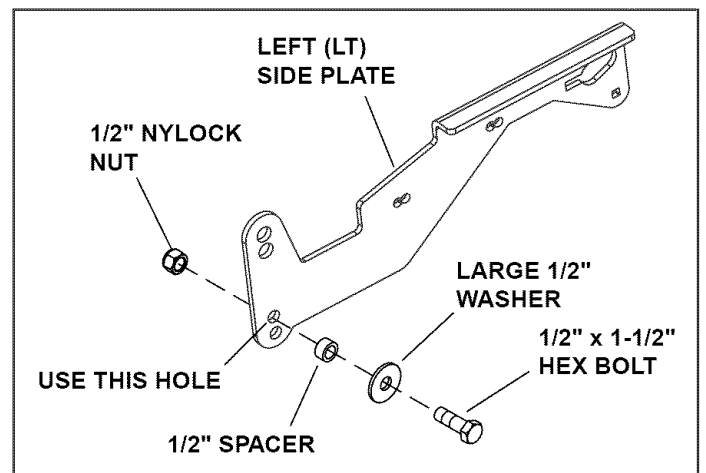

FIGURE 18

- Remove any bolts present in the mounting holes on the left side of the tractor frame. **Do not remove** bolts from right side of frame until left side plate has been installed. See figure 19.
- Install the left (LT) side plate on the tractor with the spacer to the outside. Fasten to the tractor frame using three 3/8" x 1" hex bolts and 3/8" lock washers and one 5/16" x 1" carriage bolt and 5/16" nylock nut. Tighten 3/8" bolts only until they are snug and lock washers are flattened. Repeat for the right side plate. See figure 19.

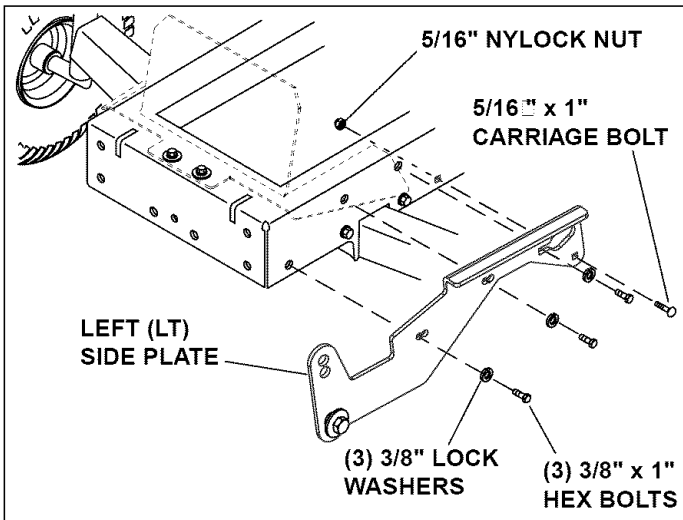

FIGURE 19

STEP 21 - INSTALL (GT) SIDE PLATES

- Remove any bolts present in the mounting holes on the left side of the tractor frame. **Do not remove** bolts from right side of frame until left side plate has been installed. See figure 20.
- Install the left (GT) side plate with the pin to the outside using two 3/8" x 1" hex bolts and lock washers. Tighten only until bolts are snug and lock washers are flattened. Repeat for the right side plate. See figure 20.
- Install a 3/4" washer and a long hairpin cotter to the pin in each side plate. Remove them while mounting the scoop. See figure 20.

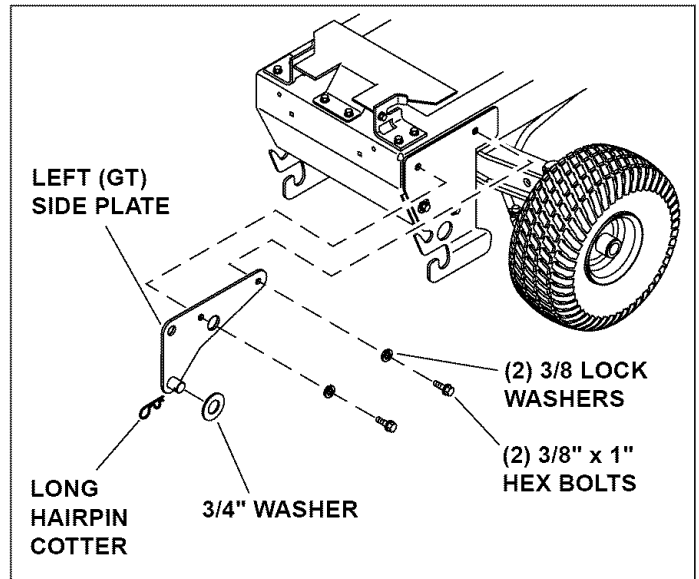

FIGURE 20

STEP 22 - MOUNT SCOOP TO TRACTOR

- Align the scoop with the side plates on the front of the tractor. Lift the rear of the scoop and slide the notches in the scoop frame onto the bolts or pins in the tractor side plates. Stand on the left side of the tractor and push down on the scoop dump handle until the holes in the scoop frame and the holes in the side plates are aligned. Install the attachment rod through the holes from the left side and secure it with a long hairpin cotter. See figure 21.

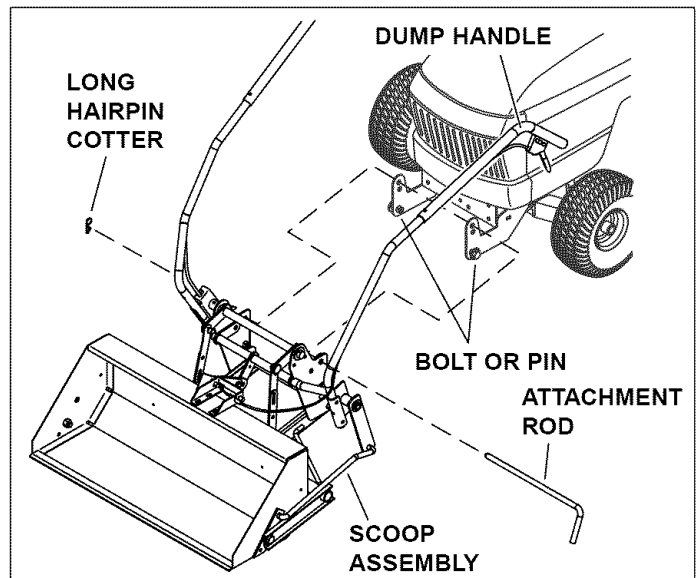

FIGURE 21

STEP 23 - ADJUST TILT BRACKET ASSEMBLY

- Lower the scoop assembly onto a smooth level surface. For normal use, let the bottom of the bucket rest flat on the ground. For more aggressive scraping action, place 1/4" shims under the rear of the bucket at each end.
- Swing the tilt bracket forward to check for clearance with the pin stop bracket. There should be a small gap between the tilt bracket and the side of the pin stop bracket. If not, adjust the position of the pin stop bracket side to side.
- Make sure the two bolts in the tilt bracket are loose enough to turn by hand. Align the tilt bracket so that the dump control pin snaps into the hole in the tilt bracket. The tapered end of the pin should extend clear through the tilt bracket. **Tighten the two bolts and nuts** in the tilt bracket. See figure 22.

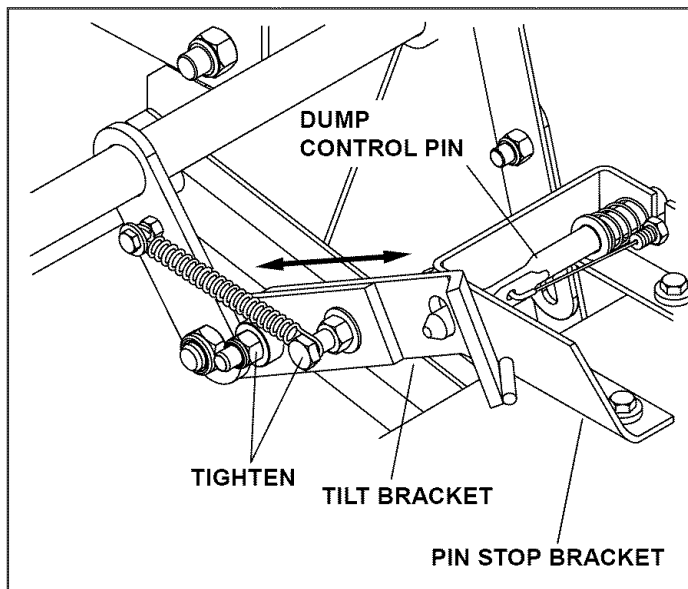

FIGURE 22

STEP 24 - ADJUST LIFT STRAPS

- Make sure the nuts and bolts in the lift straps are loose enough to turn by hand. Stand on the right side of the scoop and **hold the lift handle as far forward as it will go** while you tighten one of the nuts in the lift straps. You can let go of the lift handle to tighten the other three nuts in the lift straps. See figure 23.

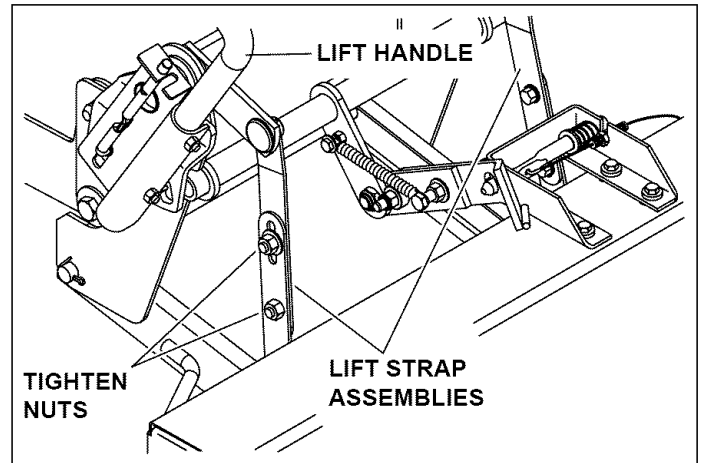

FIGURE 23

STEP 25 - ADJUST TILT STOP BRACKETS

- Raise the scoop until it locks in the TRANSPORT position. Push the tilt stop brackets on each side of the bucket down against the lift frame arms, and tighten the nuts. See figure 24.

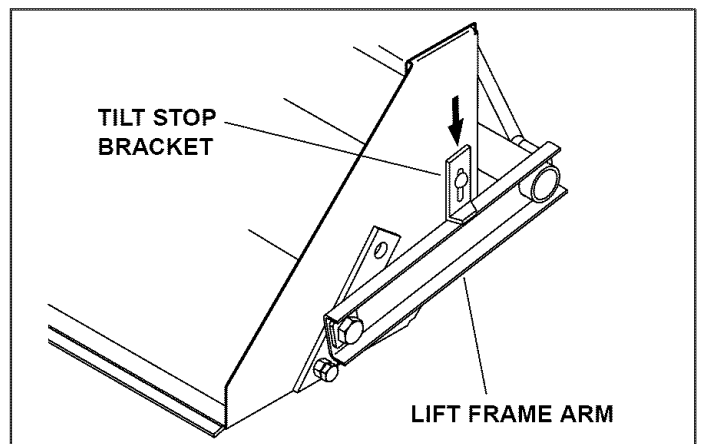

FIGURE 24

STEP 26 - CHECK DUMPING OPERATION

- With the scoop in the transport position, squeeze the dump trigger and push down on the dump handle to dump the bucket. Release the dump trigger and lift up on the handle to lock the bucket in the upright position. If the dump control pin passes underneath the tilt bracket instead of locking into it, move the pin stop bracket on top of the bucket farther towards the rear. If this does not work, repeat steps 23, 24 and 25.

OPERATION

KNOW YOUR FRONT END SCOOP

Read this owner's manual and safety rules before operating your front end scoop.

Compare the illustration below with your front end scoop to familiarize yourself with the various controls and their locations.

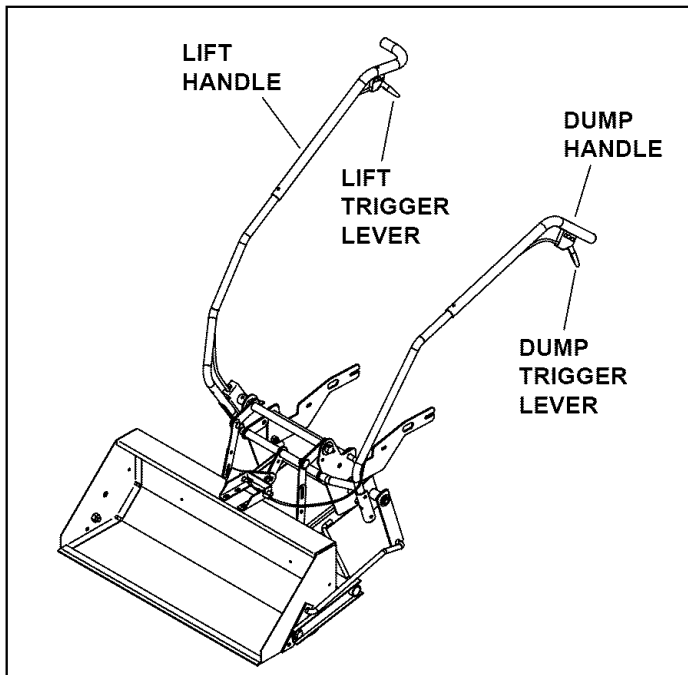

DUMP TRIGGER LEVER Press to release the dump pin.

DUMP HANDLE Press down to dump the bucket.

LIFT TRIGGER LEVER Press to release the index pin.

LIFT HANDLE Press down to lift the bucket assembly.

HOW TO USE YOUR SCOOP

DO NOT EXCEED 200 LB. CAPACITY OF BUCKET

One cubic foot of dirt weighs approximately 80 lbs.

One cubic foot of dry sand or gravel weighs approximately 100 lbs.



CAUTION: Vehicle braking and stability may be affected with the addition of an accessory or an attachment. Be aware of changing conditions on slopes.

- Refer to the vehicle owner's manual for instructions on safe operation on slopes.
- Use the slope guide provided on page 23 of this manual to determine whether slope angle is too steep for safe operation.

- Always test to make sure your vehicle has adequate power and braking capabilities whenever hauling a substantial amount of weight in your front end scoop. Use extra caution when operating on slopes.
- For best handling and traction, distribute the weight of the load evenly in the bucket.



CAUTION: Never ram the scoop into material at high speeds.

- Keep the lift handle locked in the raised position when tilting the scoop bucket forward to dump.
- The lift handle must be locked in the raised position to allow the dump handle to lock the scoop bucket back in the upright position after dumping.
- Do not scrape or push material with the scoop bucket while it is tilted forward.
- Add wheel weights for improved traction when using the scoop.
- To dump material from the bucket, squeeze the dump trigger and push the dump tube handle down. Release the trigger before returning the bucket to the upright position.
- To lower the bucket, squeeze the lift trigger and then lift up on the lift handle. If the trigger is hard to depress, you may need to push down on the lift handle while squeezing, and then lift up. Release the trigger before returning the bucket to the raised position.
- Do not exceed mowing speed (3 mph) when the front end scoop is attached to the tractor.



CAUTION: To avoid possible injury, before dumping the bucket, make sure that no one is near the bucket.



CAUTION: Always lower the scoop bucket to the ground before leaving the tractor.

MAINTENANCE

CUSTOMER RESPONSIBILITIES

- Read and follow the maintenance schedule and the maintenance procedures listed in this section.

MAINTENANCE SCHEDULE Fill in dates as you complete regular service.	Service Dates											
	Before each use	After each use	Every season	Before storage								
Check for loose fasteners	X											
Cleaning		X										
Lubricate			X									

CHECK FOR LOOSE FASTENERS

- Before each use make a thorough visual check of the front end scoop for any bolts and nuts which may have loosened. Retighten any loose bolts and nuts.

CLEANING

- After each use, clean off any dirt and debris from the scoop bucket lift frame.
- Before storing at the end of each season, rinse off the scoop bucket and scoop lift frame. Allow to dry thoroughly. Paint any exposed metal surfaces to protect from rust.
- Store in a clean, dry area.

LUBRICATION

- Lightly oil all pivot points on the scoop lift mechanism.
- Lightly oil the surface on the scoop bucket where the attachment lift frame pivots.
- Apply a good grade of spray lubricant to the trigger assemblies on the lift handle and dump handle.

TROUBLESHOOTING

PROBLEM	CAUSE	CORRECTION
Scoop won't lock into raised/transport position.	1. Index rod is jamming. 2. Frame is hitting the tilt stop brackets.	1. Apply grease to the bottom slot in the lift bracket, where the index rod slides. 2. Adjust the tilt stop brackets as instructed on page 14.
Scoop bucket won't lock into level position.	1. Dump control pin is not aligned with the tilt bracket.	1. Adjust tilt bracket and lift straps as instructed on page 14.
Lift handle trigger won't release scoop from the transport position.	1. Index rod is jamming. 2. Lift cable is not adjusted properly.	1. Apply grease to the bottom slot in the lift bracket, where the index rod slides. 2. Adjust cable nuts as instructed on page 11.
Dump handle trigger won't release bucket to dump.	1. Dump control cable is not adjusted properly. 2. Latch mechanism is not adjusted properly.	1. Adjust parts as instructed for figure 16 on page 11. 2. Adjust parts as instructed for figure 22 on page 14.
Bucket is becoming more difficult to tilt up or down.	1. Debris is lodged between bucket assembly and lift frame.	1. Remove all debris from between the bucket assembly and lift frame.

NOTES

PARTS

REPAIR PARTS FOR MODEL 486.24847

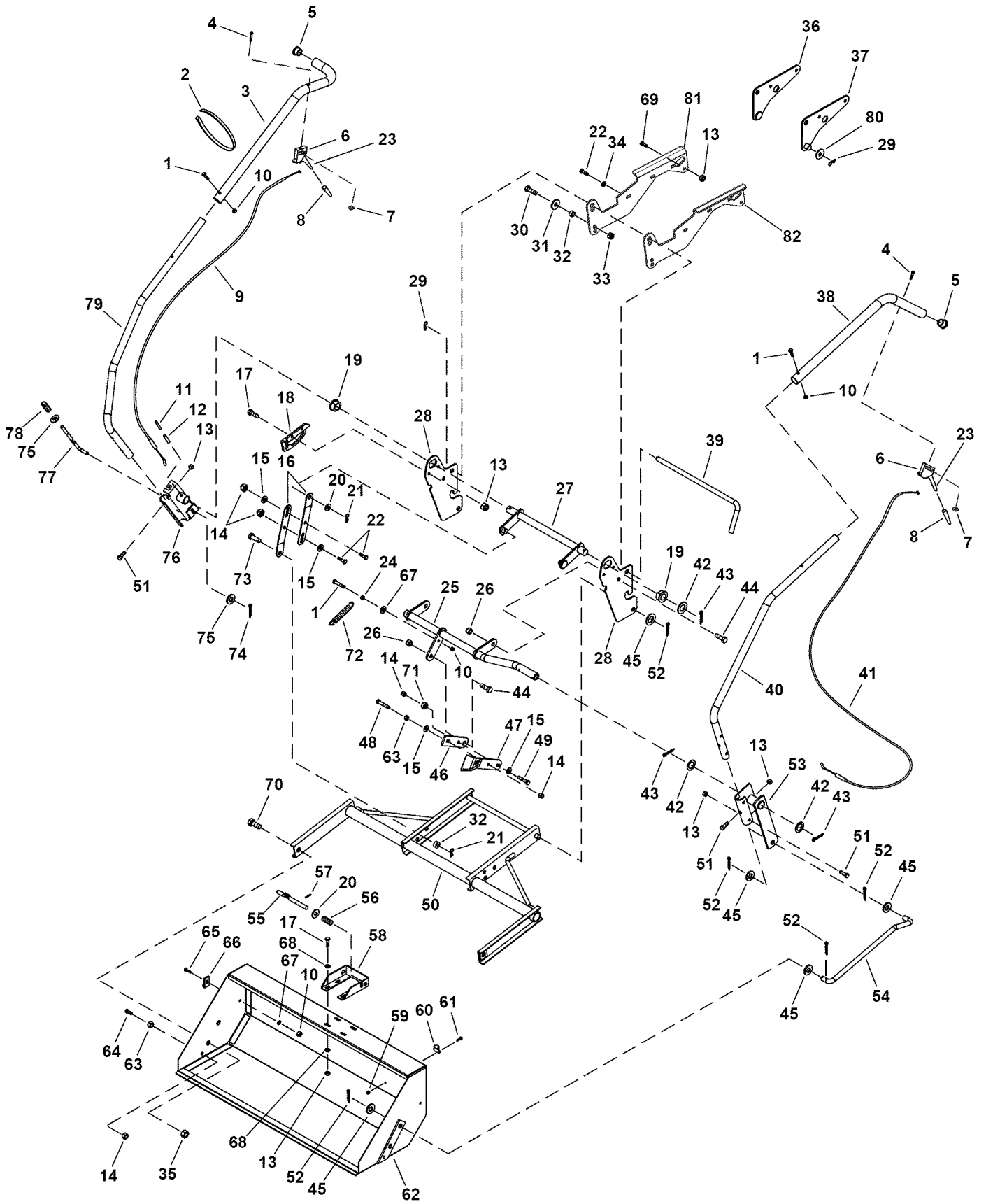

REPAIR PARTS FOR MODEL 486.24847

REF. NO.	PART NO.	QTY.	DESCRIPTION	REF. NO.	PART NO.	QTY.	DESCRIPTION
1	1509-69	3	Hex Bolt, 1/4-20 x 1-3/4" (Grade 5)	43	43093	3	Cotter Pin, 1/8" x 1-1/2"
2	726-0178	6	Cable Tie	44	710-0865	3	Hex Bolt, 1/2-13 x 1" (Grade 5)
3	49265	1	Lift Tube Handle Extension	45	R19212016	6	Flat Washer, 5/8" x 1-1/4" x 16 Ga.
4	49266	2	Oval Screw, 10-24 x 1-1/2"	46	25362	1	Tilt Bracket Extension Strap
5	47674	2	Plastic Plug, 1-1/4" O.D. Tube	47	64983	1	Tilt Bracket
6	47554	2	Trigger Housing Assembly	48	HA6441	1	Hex Bolt, 3/8-16 x 2" (Grade 5)
7	712-0127	2	Square Nut, #10-24	49	41576	1	Hex Bolt, 3/8-16 x 1-3/4" (Grade 5)
8	47317	2	Grip, Black	50	64963	1	Lift Frame Assembly
9	47555	1	Cable, Lift	51	43084	5	Hex Bolt, 5/16-18 x 1-3/4" (Grade 5)
10	47189	5	Nylock Nut, 1/4"	52	43010	6	Cotter Pin, 1/8" x 1-1/4"
11	47369	1	Roll Pin, 3/16" x 1-3/4"	53	64968	1	Dump Pivot Bracket
12	47368	1	Roll Pin, 5/16" x 1-3/4"	54	49273	1	Dump Control Rod
13	478 10	14	Nylock Nut, 5/16-18	55	49268	1	Dump Control Pin
14	HA21362	8	Nylock Nut, 3/8-16	56	48905	1	Compression Spring
15	43070	6	Flat Washer, 3/8"	57	46055	1	Spring Pin, 1/8" x 1"
16	25350	4	Lift Strap	58	25335	1	Pin Stop Bracket
17	43063	8	Hex Bolt, 5/16-18 x 1" (Grade 5)	59	47171	1	Nylock Nut, #10-32
18	25343	1	Lift Bracket	60	HA23761	1	Hose Clamp
19	741-0192	2	Flange Bearing with Flats	61	43346	1	Truss-Head Bolt, #10-32 x 5/8"
20	R1917616	3	Flat Washer, 1/2" x 1" (Small)	62	64962	1	Bucket Assembly
21	43055	4	Hairpin Cotter, 3/32" x 1.8"	63	43015	3	Hex Nut, 3/8-16
22	43001	10	Hex Bolt, 3/8-16 x 1" (Grade 5)	64	43087	2	Hex Bolt, 3/8-16 x 1-1/4" (Grade 5)
23	63755	2	Trigger Assembly	65	44950	2	Carriage Bolt, 1/4-20 x 3/4" (Grade 5)
24	43178	1	Hex Nut, 1/4-20	66	25331	2	Tilt Stop Bracket
25	64964	1	Tilt Anchor Assembly	67	736-0142	3	Flat Washer, 1/4"
26	48115	3	Nylock Jam Nut, 1/2-13	68	43081	8	Flat Washer, 5/16"
27	63675	1	Lift Arm Assembly	69	44326	2	Carriage Bolt, 5/16" x 1" (Grade 5)
28	25510	2	Mounting Bracket	70	710-0367	2	Hex Bolt, 5/8-11 x 1-1/2" (Grade 5)
29	43343	3	Hairpin Cotter, 3/32" x 2-5/16"	71	25408	1	Spacer, 3/8" I.D. x 7/8" O.D. x 3/8"
30	43020	2	Hex Bolt, 1/2-13 x 1-1/2" (Grade 5)		23625	1	Spacer, 3/8" I.D. x 5/8" O.D. x 1/4"
31	R19172410	2	Flat Washer, 1/2" x 1-1/2" (Large)	72	43000	1	Extension Spring
32	47364	4	Spacer, 0.52" x 0.75" x 0.4"	73	44062	2	Clevis Pin, 1/2" x 1"
33	712-3083	2	Nylock Nut, 1/2-13	74	142	1	Cotter Pin, 1/8" x 3/4"
34	43003	6	Lock Washer, 3/8"	75	R19131316	2	Flat Washer, 3/8" x 13/16" x 1/16"
35	712-0261	2	Nylock Nut, 5/8-11	76	63773	1	Index Bracket Assembly
36	63568	1	Right (GT) Side Plate	77	48049	1	Index Rod
37	63569	1	Left (GT) Side Plate	78	732-0306	1	Spring, Compression
38	49270	1	Dump Handle Tube Extension	79	49264	1	Lift Handle Tube
39	47066	1	Attachment Rod	80	43009	2	Flat Washer, 3/4"
40	49271	1	Dump Handle Tube	81	25562	1	Right (LT) Side Plate
41	49483	1	Dump Control Cable)	82	25563	1	Left (LT) Side Plate
42	43601	3	Washer, 1.59" x 1.032" x 0.60"		49326	1	Owner's Manual

* Purchase Common Hardware Locally

NOTES

NOTES

NOTES

SLOPE GUIDE

(Keep this sheet in a safe place for future reference.)
Use this guide to determine if a slope is safe for the operation of your tractor and scoop.
Refer also to the instructions in your vehicle owner's manual.

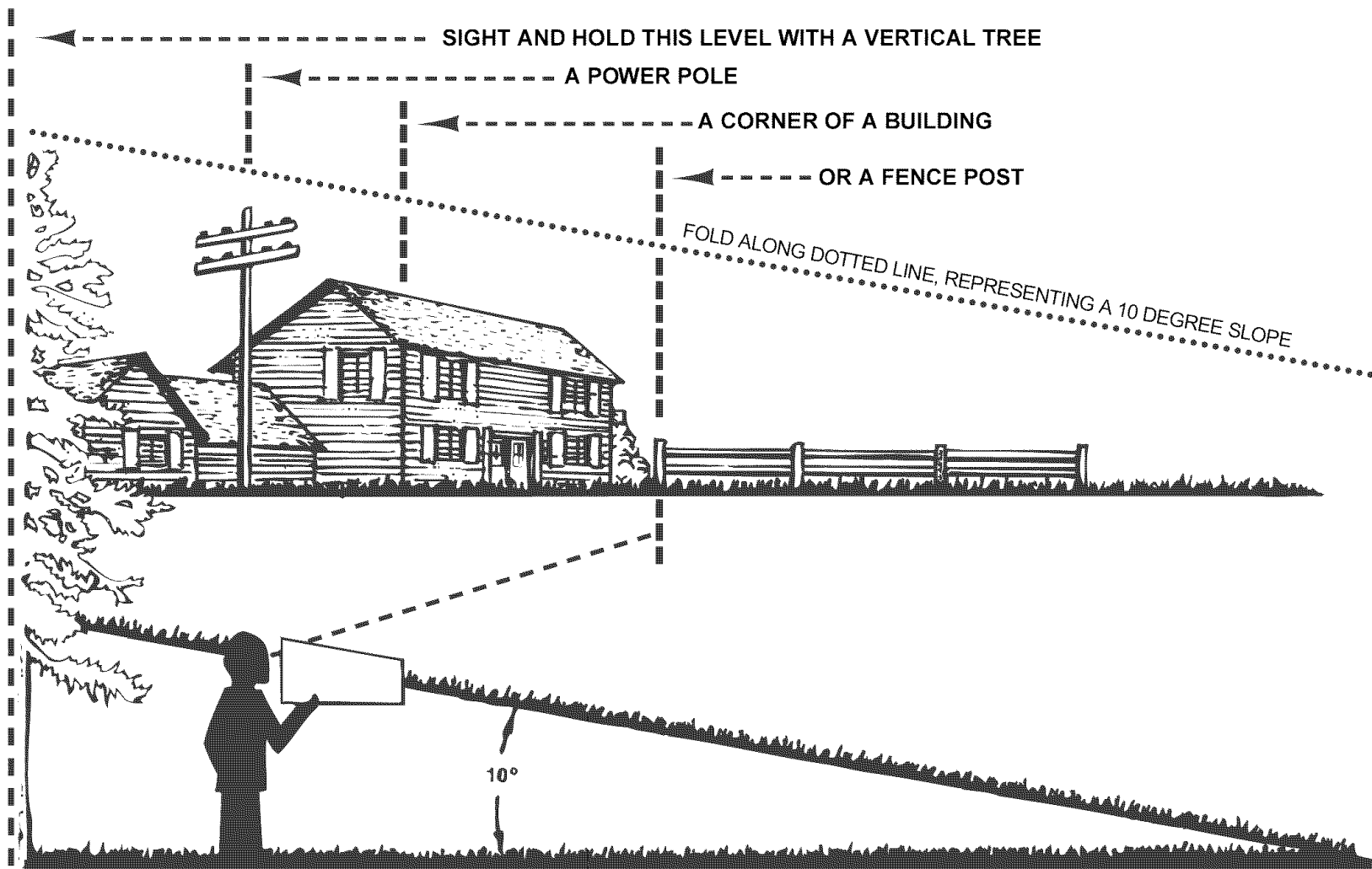

 CAUTION: DO NOT OPERATE YOUR TRACTOR AND SCOOP ON A SLOPE IN EXCESS OF 10 DEGREES. BE SURE OF YOUR TRACTOR'S TOWING AND BRAKING CAPABILITIES BEFORE OPERATING ON A SLOPE. AVOID ANY SUDDEN TURNS OR MANEUVERS WHILE ON A SLOPE.

Get it fixed, at your home or ours!

For repair of major brand appliances **in your own home...**
no matter who made it, no matter who sold it!

1-800-4-MY-HOMESM Anytime, day or night
(1-800-469-4663)

www.sears.com

To bring in products such as vacuums, lawn equipment and electronics
for repair, call for the location of your nearest **Sears Parts & Repair Center.**

1-800-488-1222 Anytime, day or night

www.sears.com

For the replacement parts, accessories and owner's manuals
that you need to do-it-yourself, call **Sears PartsDirectSM**!

1-800-366-PART 6 a.m. – 11 p.m. CST,
(1-800-366-7278) 7 days a week

www.sears.com/partsdirect

To purchase or inquire about a Sears Service Agreement:

1-800-827-6655

7 a.m. – 5 p.m. CST, Mon. – Sat.

Para pedir servicio de reparación a domicilio,
y para ordenar piezas con entrega a domicilio:

1-888-SU-HOGARSM
(1-888-784-6427)

Au Canada pour service en français:

1-877-LE-FOYERSM
(1-877-533-6937)

