

SEARS

Model No.
919.670070

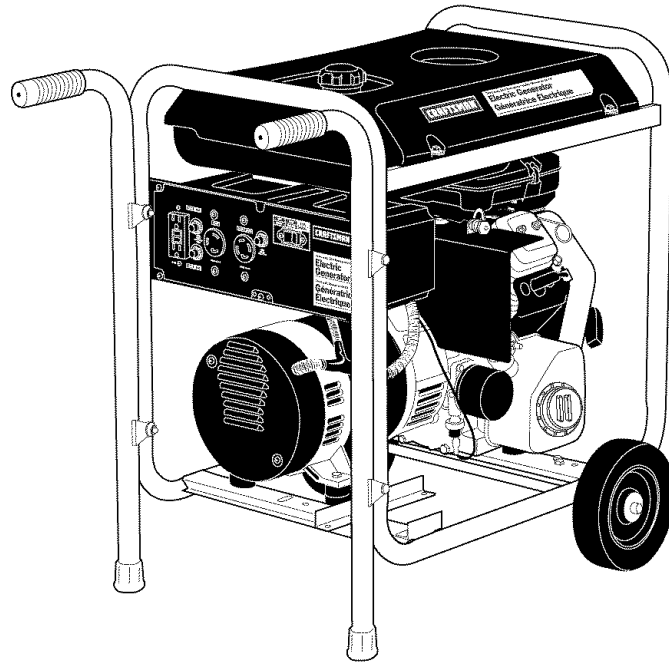

CRAFTSMAN

120/240 VOLT • 7000 WATT
GENERATOR

IMPORTANT:

Read the Safety Guidelines
and All Instructions Carefully
Before Operating

- SAFETY GUIDELINES
- ASSEMBLY
- OPERATION
- MAINTENANCE
- TROUBLESHOOTING
- REPAIR PARTS

Sold by Sears Canada, Inc., Toronto, Ont. M5B2B8

TABLE OF CONTENTS

Warranty	2	Storage	20
Safety Guidelines	3-8	Troubleshooting Guide	21
Assembly	9-12	Emissions Statement	22
Operation	13-17	Generator Parts	23-29
Maintenance	17-20	Engine Parts	30-36
Service Adjustments	20	How To Order Parts	Back Cover

DATE PURCHASED: _____

MODEL NO: _____

SERIAL NO: _____

STORE WHERE PURCHASED: _____

ADDRESS: _____

CITY: _____

TELEPHONE: _____

Record the above information about your unit so that you will be able to provide it in case of loss or theft.

HORSE POWER	14 HP
GASOLINE CAPACITY	7 GALLON/26.5 LITERS
OIL CAPACITY	48 OZ./1.4 LITERS

MAINTENANCE AGREEMENT

The Craftsman Warranty, plus a Maintenance Agreement, provide maximum value for your Sears products. Contact your nearest Sears store for details.

CUSTOMER RESPONSIBILITIES

Read and observe the safety rules.

Follow a regular schedule in maintaining, caring for and using your generator.

Follow the instructions under "Customer Responsibilities" and "Storage" sections of this owner's manual.

FULL ONE YEAR WARRANTY ON CRAFTSMAN GENERATORS

For one year from the date of purchase, when this Craftsman generator is maintained and operated according to the instructions in this owner's manual, Sears will repair, free of charge, any defect in material and workmanship.

If your Craftsman Generator is used for commercial or rental purposes, this warranty applies for only 90 days from the original date of purchase.

FULL ONE YEAR WARRANTY ON CRAFTSMAN ENGINE

For one year from the date of purchase, when this Craftsman engine is maintained and operated according to the instructions in this owner's manual, Sears will repair, free of charge, any defect in material and workmanship.

If your Craftsman engine is used for commercial or rental purposes, this warranty applies only for 90 days from the date of purchase. This warranty does not cover: Expendable items such as spark plugs and air filters, which become worn during normal use.

Repairs necessary because of operator abuse or negligence, including damage resulting from no oil being supplied to the engine or failure to maintain the equipment according to the instructions contained in this owner's manual, are not covered under warranty.

WARRANTY SERVICE IS AVAILABLE BY RETURNING THE GENERATOR TO THE NEAREST SEARS SERVICE CENTER. This warranty gives you specific legal rights and you may also have other rights, which vary from PROVINCE TO PROVINCE.

Sold by Sears Canada, Inc., Toronto, Ont.

SAFETY GUIDELINES - DEFINITIONS

This manual contains information that is important for you to know and understand. This information relates to protecting **YOUR SAFETY** and **PREVENTING EQUIPMENT PROBLEMS**. To help you recognize this information, we use the symbols to the right. Please read the manual and pay attention to these sections.

⚠ DANGER	⚠ CAUTION
DANGER indicates an imminently hazardous situation which, if not avoided, will result in <u>death or serious injury</u> .	CAUTION indicates a potentially hazardous situation which, if not avoided, <u>may</u> result in <u>minor or moderate injury</u> .
⚠ WARNING	CAUTION
WARNING indicates a potentially hazardous situation which, if not avoided, <u>could</u> result in <u>death or serious injury</u> .	CAUTION used without the safety alert symbol indicates a potentially hazardous situation which, if not avoided, <u>may</u> result in <u>property damage</u> .

This product is not equipped with a spark arresting muffler. If the product will be used around flammable materials, or on land covered with materials such as agricultural crops, forest, brush, grass, or other similar items, then an approved spark arrester must be installed and is legally required in the state of California. It is a violation of California statutes section 130050 and/or sections 4442 and 4443 of the California Public Resources Code, unless the engine is equipped with a spark arrester, as defined in section 4442, and maintained in effective working order. Spark arresters are also required on some U. S. Forest service land and may also be legally required under other statutes and ordinances.

⚠ WARNING This product may contain chemicals known to the state of California to cause cancer, birth defects, or other reproductive harm. This warning is given in compliance with California Proposition 65, as detectable amounts of chemicals subject to proposition 65 may be contained in this product.

IMPORTANT SAFETY INSTRUCTIONS

- **SAVE THESE INSTRUCTIONS** •

⚠ WARNING

When using this product basic precautions should always be followed including the following:

⚠ DANGER

RISK OF ELECTROCUTION AND FIRE

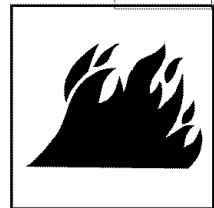
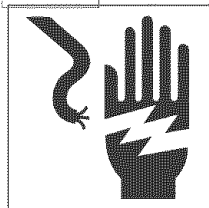

HAZARD	WHAT COULD HAPPEN	HOW TO PREVENT IT
Attempting to connect generator directly to the electrical system of any building structure.	<p>Back feeding electricity through a building's electrical system to the outside utility feed lines could endanger repair persons attempting to restore service.</p> <p>Attempting to connect to the incoming utility service could result in electrocution.</p> <p>Restoration of electrical service while the generator is connected to the incoming utility could result in a fire or serious damage if a isolator switch is not installed.</p> <p>Failure to use a double throw transfer switch when connecting to a structures electrical system can damage appliances and WILL VOID the manufacturers warranty.</p>	<p>Never backfeed electricity through a structure's electrical system.</p> <p>To connect to a structure's electrical system in a safe manner, always have a Double-Throw Transfer Switch installed by a qualified electrician and in compliance with local ordinances. (When installing a Double-Throw Transfer Switch, a minimum of 10 gauge wiring must be used.)</p>

**READ AND UNDERSTAND ALL WARNINGS BEFORE
ATTEMPTING TO OPERATE GENERATOR.**

⚠ DANGER

RISK OF ELECTROCUTION AND FIRE (cont'd)

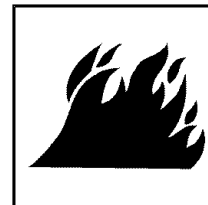
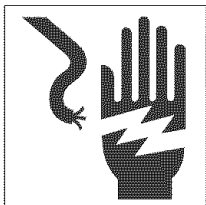

HAZARD	WHAT COULD HAPPEN	HOW TO PREVENT IT
<p>Operation of generator in rain, wet, icy, or flooded conditions.</p>	<p>Water is an excellent conductor of electricity! Water which comes in contact with electrically charged components can transmit electricity to the frame and other surfaces, resulting in electrical shock to anyone contacting them.</p>	<p>Operate generator in a clean, dry, well ventilated area. Make sure hands are dry before touching unit.</p>
<p>Use of worn damaged, undersized or ungrounded extension cords.</p>	<p>Contact with worn or damaged extension cords could result in electrocution.</p> <p>Use of undersize extension cords could result in overheating of the wires or attached items, resulting in fire.</p> <p>Use of ungrounded cordsets could prevent operation of circuit breakers and result in electrical shock.</p>	<p>Inspect extension cords before use and replace with new cord if required.</p> <p>Use proper size (wire gauge) cordset for application see chart in the Assembly section of this manual.</p> <p>Always use a cordset having a grounding wire with an appropriate grounding plug. DO NOT use an ungrounded plug.</p>
<p>Placing generator on or against highly conductive surface, such as a steel walkway or metal roof.</p>	<p>Accidental leakage of electrical current could charge conductive surfaces in contact with the generator.</p>	<p>Place generator on low conductivity surface such as a concrete slab.</p> <p>ALWAYS operate generator a minimum of six feet from any conductive surface.</p>
<p>Improper connection of items to generator.</p>	<p>Exceeding the load capacity of the generator by attaching too many items, or items with very high load ratings to it could result in overheating of some items or their attachment wiring resulting in fire or electrical shock.</p>	<p>Read the load rating chart and instructions in the Wattage Calculation section. Make sure that the summation of electrical loads for all attachments does not exceed the load rating of the generator.</p>
<p>Operation of unit when damaged, or with guards or panels removed.</p>	<p>Attempting to use the unit when it has been damaged, or when it is not functioning normally could result in fire or electrocution.</p> <p>Removal of guarding could expose electrically charged components and result in electrocution.</p>	<p>Do not operate generator with mechanical or electrical problem. Have unit repaired by an Authorized Service Center.</p> <p>Do not operate generator with protective guarding removed.</p>

**READ AND UNDERSTAND ALL WARNINGS BEFORE
ATTEMPTING TO OPERATE GENERATOR.**

**⚠ WARNING
RISK OF FIRE**

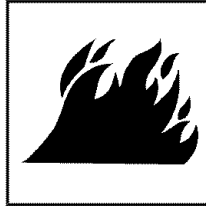

HAZARD	WHAT COULD HAPPEN	HOW TO PREVENT IT
<p>Attempting to fill the fuel tank while the engine is running.</p>	<p>Gasoline and gasoline vapors can become ignited by coming in contact with hot components such as the muffler, engine exhaust gases, or from an electrical spark.</p>	<p>Turn engine off and allow it to cool before adding fuel to the tank. Equip area of operation with a fire extinguisher certified to handle gasoline or fuel fires.</p>
<p>Sparks, fire, hot objects</p>	<p>Cigarettes, sparks, fires, or other hot objects can cause gasoline or gasoline vapors to ignite.</p>	<p>Add fuel to tank in well ventilated area. Make sure there are no sources of ignition near the generator.</p>
<p>Improper storage of fuel</p>	<p>Improperly stored fuel could lead to accidental ignition. Fuel improperly secured could get into the hands of children or other unqualified persons.</p>	<p>Store fuel in a OSHA approved container designed to hold gasoline. Store container in secure location to prevent use by others.</p>
<p>Inadequate ventilation for generator</p>	<p>Materials placed against or near the generator or operating the generator in areas where the temperature exceeds 104° F. ambient (such as storage rooms or garages) can interfere with its proper ventilation features causing overheating and possible ignition of the materials or buildings.</p>	<p>Operate generator in a clean, dry, well ventilated area a minimum of four feet from any building, object or wall. DO NOT OPERATE UNIT INDOORS OR IN ANY CONFINED AREA.</p>
<p>Tampering with factory set engine speed settings.</p>	<p>Engine speed has been factory set to provide safe operation. Tampering with the engine speed adjustment could result in overheating of attachments and could cause a fire.</p>	<p>Never attempt to “speed-up” the engine to obtain more performance. Both the output voltage and frequency will be thrown out of standard by this practice, endangering attachments and the user.</p>
<p>Overfilling the fuel tank – fuel spillage.</p>	<p>Spilled fuel and its vapors can become ignited from hot surfaces or sparks.</p>	<p>Use care in filling the tank to avoid spilling fuel. Make sure fuel cap is secured tightly and check engine for fuel leaks before starting engine. Move generator away from refueling area or any spillage before starting engine. Allow for fuel expansion. Keep maximum fuel level ¼ inch below the tip of the fuel tank. Never refuel with the engine running.</p>

READ AND UNDERSTAND ALL WARNINGS BEFORE

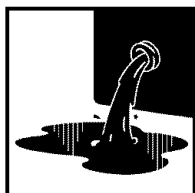

⚠ DANGER

Risk of Injury and Property Damage When Transporting Generator

HAZARD	WHAT COULD HAPPEN	HOW TO PREVENT IT
Fire, Inhalation, Damage to Vehicle Surfaces	Fuel or oil can leak or spill and could result in fire or breathing hazard, serious injury or death can result. Fuel or oil leaks will damage carpet, paint or other surfaces in vehicles or trailers.	If generator is equipped with a fuel shut-off valve, turn the valve to the off position before transporting to avoid fuel leaks. If generator is not equipped with a fuel shut-off valve, drain the fuel from tank before transporting. Transport fuel only in an OSHA approved container. Always place generator on a protective mat when transporting to protect against damage to vehicle from leaks. Remove generator from vehicle immediately upon arrival at your destination

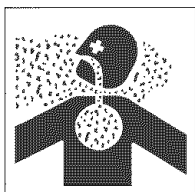

⚠ DANGER

RISK OF BREATHING - INHALATION HAZARD

HAZARD	WHAT COULD HAPPEN	HOW TO PREVENT IT
Gasoline engines produce toxic carbon monoxide exhaust fumes.	Breathing exhaust fumes will cause serious injury or death.	Operate generator in clean, dry, well ventilated area. Never operate unit in enclosed areas such as garages, basements, storage, sheds, or in any location occupied by humans or animals. Keep children, pets and others away from area of operating unit.

**READ AND UNDERSTAND ALL WARNINGS BEFORE
ATTEMPTING TO OPERATE GENERATOR.**



⚠ WARNING

RISK OF UNSAFE OPERATION

HAZARD	WHAT COULD HAPPEN	HOW TO PREVENT IT
<p>Operation of generator in careless manner.</p>	<p>All sources of energy include the potential for injury. Unsafe operation or maintenance of your generator could lead to serious injury or death to you or others.</p>	<ul style="list-style-type: none"> • Review and understand all of the operating instructions and warnings in this manual. • Become familiar with the operation and controls of the generator. Know how to shut it off quickly. • Equip area of operation with a fire extinguisher certified to handle gasoline or fuel fires. • Keep children or others away from the generator at all times.
<p>Operation of voltage sensitive appliances without a voltage surge protector.</p>	<p>Any gasoline operated household generator will incur voltage variations causing damage to voltage sensitive appliances or could result in fire.</p>	<p>Always use a U.L. listed voltage sensitive surge protector to connect voltage sensitive appliances such as TV, computer, or stereo equipment. Failure to use a U.L. listed voltage surge protector will void the warranty on your generator.</p> <p>Notice: A multiple outlet strip is not a surge protector make sure you use a U.L. listed voltage surge protector.</p>
<p>Raising or suspending generators equipped with lift rings improperly</p>	<p>Generator could fall causing serious injury or death to you or others.</p> <p>Improper raising or suspending can cause damage to the generator.</p>	<p>Always use proper connecting procedures as described in this manual when connecting cables, chains, or straps for raising or suspending generators equipped with lift rings.</p> <p>Always use cables, chains, or straps rated at 2000 lbs working load or more to raise or suspend generator.</p>
<p>Operating generator while suspended</p>	<p>Generator will not operate properly and will cause damage to the generator and could cause serious injury or death to you or others.</p>	<p>Never operate generator while suspended or in an unlevel position. Always operate generate on a flat, level surface.</p>

READ AND UNDERSTAND ALL WARNINGS BEFORE ATTEMPTING TO OPERATE GENERATOR.



⚠ WARNING
RISK OF HOT SURFACES

HAZARD	WHAT COULD HAPPEN	HOW TO PREVENT IT
Contact with hot engine and generator components.	Contact with hot surfaces, such as engines exhaust components, could result in serious burns.	During operation, touch only the control surfaces of the generator. Keep children away from the generator at all times. They may not be able to recognize the hazards of this product.

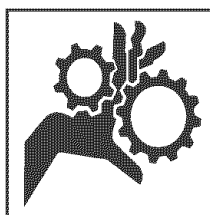

⚠ WARNING
RISK OF MOVING PARTS

HAZARD	WHAT COULD HAPPEN	HOW TO PREVENT IT
Contact with moving parts can result in serious injury.	The generator contains parts which rotate at high speed during operation. These parts are covered by guarding to prevent injury.	Never operate generator with guarding or cover plates removed. Avoid wearing loose fitting clothing or jewelry which could be caught by moving parts.



⚠ WARNING
RISK FROM LIFTING

HAZARD	WHAT COULD HAPPEN	HOW TO PREVENT IT
Lifting a very heavy object.	Serious injury can result from attempting to lift too heavy an object.	The generator is too heavy to be lifted by one person. Obtain assistance from others before you try to move it.

ASSEMBLY

CARTON CONTENTS

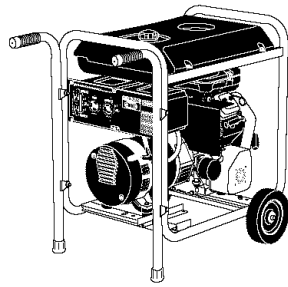

1 - Generator

1 - Parts Bag



1 - Owner's Manual



*1 - Twistlock Plug L5-30P

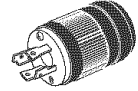

*1 - Twistlock Plug L14-30P

* **WARNING** To be installed and/or used in accordance with appropriate local electrical codes and regulations. Refer to enclosed instructions for proper installation.

Parts and Parts Box for Wheel Kit Assembly

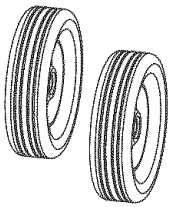

2 - Wheels



2 - Axle Spacers



1 - Cotter Pin



1 - Axle End Cap

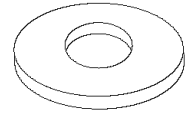

1 - Flat Washer
3/4 OD x 11/16 ID

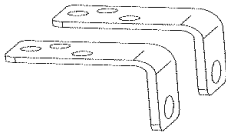

2 - Bracket

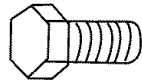

3 - 5/16-18 x 3/4 "
Cap Screws

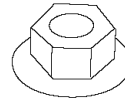

7 - 5/16-18
Lock Nuts

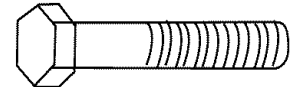

4 - 5/16-18 x 1 3/4 "
Cap Screws

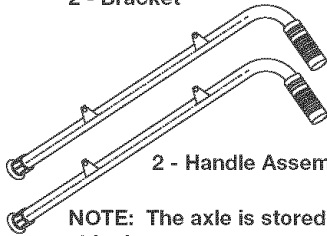

2 - Handle Assemblies

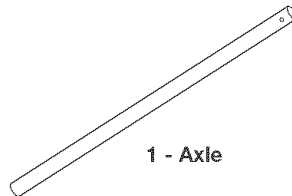

1 - Axle

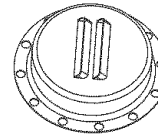

1 - Louvered Heat
Deflector

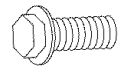

4- Screws, HH #8-32

NOTE: The axle is stored in one handle assembly for shipping purposes

Parts Bag for Battery Installation

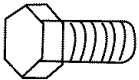

1 - 5/16-18 x 3.4 "
Cap Screws



1 - Star Washer

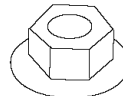

1 - 5/16-18
Lock Nuts



2 - Wing Nuts



1 - "L" Battery Bracket



2 - Battery Bolt Hold Down

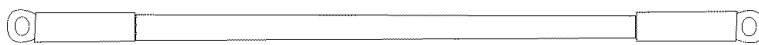

1 - Red Positive Battery Cable (red) with battery boots



1 - Black Negative Battery Cable (black)

CAUTION

Read owner's manual. Do not attempt to operate equipment until you have read Owner's Manual for Safety, Assembly, Operation, Maintenance, Storage Instructions.

TOOLS NEEDED FOR ASSEMBLY

- 1 - Box Cutter or Knife
- 2 - 1/2" Wrenches
- 1 - Pair Wire Pliers
- 1 - Hammer
- 1 - 1/2" Socket and Socket Wrench
- 1 - 1/4" Socket and Socket Wrench
- 1 - 1" thick x 1' square piece of wood

REMOVE GENERATOR FROM CARTON

- Open carton from top.
- Cut carton along dotted lines.
- Remove generator through opening in carton.
- Remove parts box containing wheel kit parts.
- Cut wire tie securing handle assembly to top frame.
- Cut wire ties securing handle assembly to side frame. This handle assembly stores the axle during shipping. Remove the base end cap and slide the axle from handle assembly. Replace base end cap with washer.
- Remove all packaging material from handle assemblies and oil filter on engine.
- Place handle assemblies aside to be used when assembling the wheel kit.
- Using a 1/2 inch socket remove shipping block from under the generator head. Unscrew the bolt and remove the wood block. **NOTE:** It is very important that this is removed before starting your generator.

IMPORTANT: Before any attempt to start your generator be sure to check engine oil (See Adding Engine Oil paragraph in the Operation section on page 15 of this manual.)

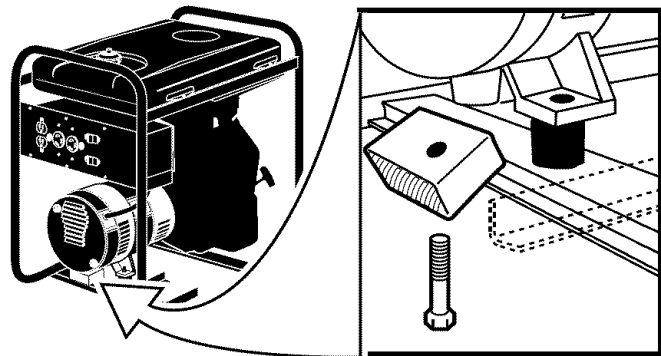
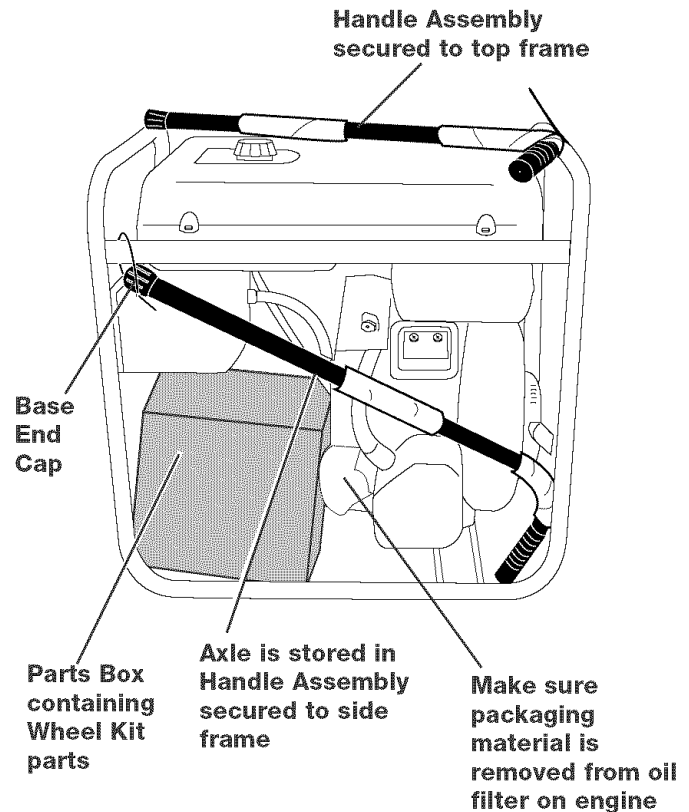

INSTALLATION OF BATTERY

Recommended Battery for Electric Start: 12V - 45 A H. or 210 CCA (Cold Cranking Amps)

Purchase battery and battery hardware separately, not included with unit.

- Place battery in rack with terminals facing towards generator head.
- Place battery bracket (A) over battery as shown (opposite battery terminals).

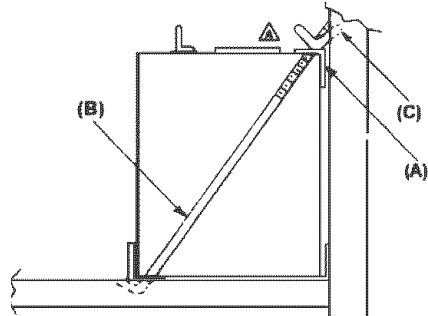

- Place "L" bolt (B) through top and bottom brackets and secure with wing nut (C).
- Locate the solenoid on the left side of the unit.

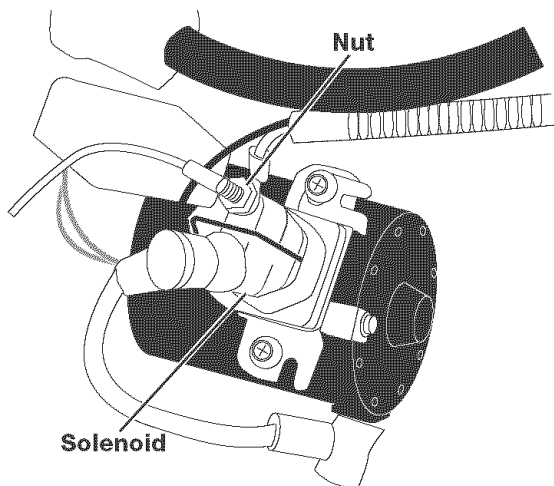

⚠ WARNING To Prevent sparks connect the red (positive) cable to the positive (+) terminal before connecting the black negative cable.

- Remove the nut from the solenoid post and place one end of the positive (red) battery cable onto the post. Reassemble nut and tighten securely.
- Attach the other end of the positive (red) battery cable to the positive (+) terminal on the battery.

NOTE: Make sure red battery boots cover positive battery cable terminals at battery and solenoid

- Attach one end of the negative (black) cable to the negative (-) terminal on the battery.
- Attach the other end of the negative (black) cable to the frame as shown. Install the star washer between the cable and the frame.

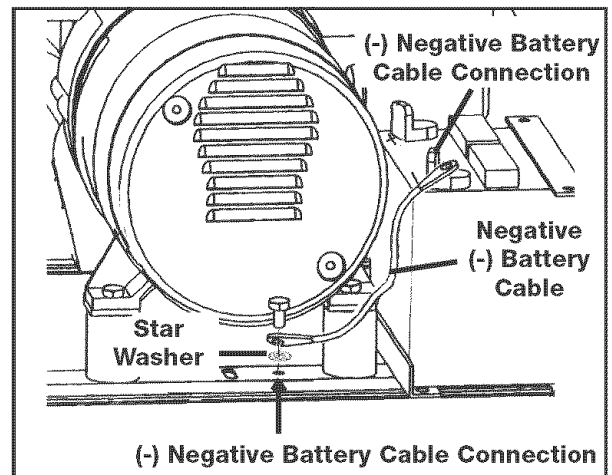

GROUNDING THE GENERATOR

A grounding lug is supplied with the generator for use when required by local electrical ordinances. Refer to article 250 of the National Electrical Code to clarify any needed grounding information. Your local electric company or a certified electrician should be able to help you with this information.

NOTE: Your engine is already grounded to the frame by a grounding strap.

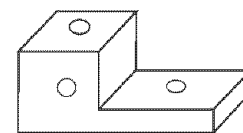

Grounding Lug

INSTALLING WHEEL KIT

The Craftsman Wheel Kit was designed to greatly improve the portability of your generator.

CAUTION Drain gas and oil before assembling the portability kit. Failure to do so will cause damage to the engine.

- Place generator on level ground; drain all gas and oil from the engine (see engine manual for correct procedure).
- Place a 1" thick x 1' square piece of wood on the ground in front of the engine. With the help of another person, tilt the generator and rest the recoil starter on the wood. **NOTE:** This will support the gasoline engine during assembly and make assembly easier.
- Using two screws (8) and two lock nuts (9) install the wheel bracket (5) on the bottom right side of the engine support.
 - a. Remove the locknut on the bottom of the isolator.
 - b. Position wheel bracket onto the existing screw, lining up holes in bracket with holes in frame. Secure with the removed locknut.
 - c. Place screw (8) into second hole and secure with locknut (9).
- Tap the axle cap (6) on the end of the axle (2), **without the hole**, using a hammer.
- Slide one wheel (1) onto the axle with the extended hub pointed away from axle cap.
- Slide one axle spacer (3) down against the wheel (1).
- Slide the axle (2) through the holes in the wheel brackets (5).
- Install the second axle spacer (3) then the second wheel (1) with the extended hub facing inward.

- Place the flat washer (7) against the wheel bushing and slide the cotter pin (4) through the drilled hole of the axle (2). Bend the cotter pin (4) to secure in place.
- Tighten lock nuts on wheel brackets.
- Line up the handle brackets with the holes in the frame near the receptacle end of the generator.
- Install hex screws (10) and lock nuts (9). Tighten with a 1/2" wrench.
- With another person helping, carefully tilt the generator to operating position.
- Install louvered heat deflector to the muffler using four #8-32 HH screws. Orient heat deflector so the vent openings are pointing toward the rear of the engine.

IMPORTANT: To prevent damage or possible hazards, do not orient deflector in any other position.

- The portability kit is now ready for use.

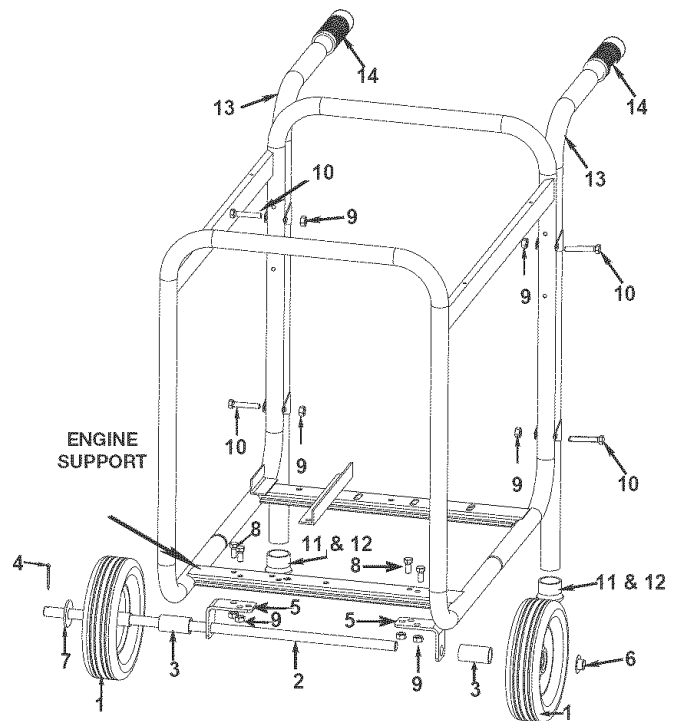

OPERATION

KNOW YOUR GENERATOR

Read this Owner's Manual and Safety Rules before operation of your Generator. Compare this illustration with your generator to familiarize yourself with the location of various controls and adjustments. Save the manual for future references.

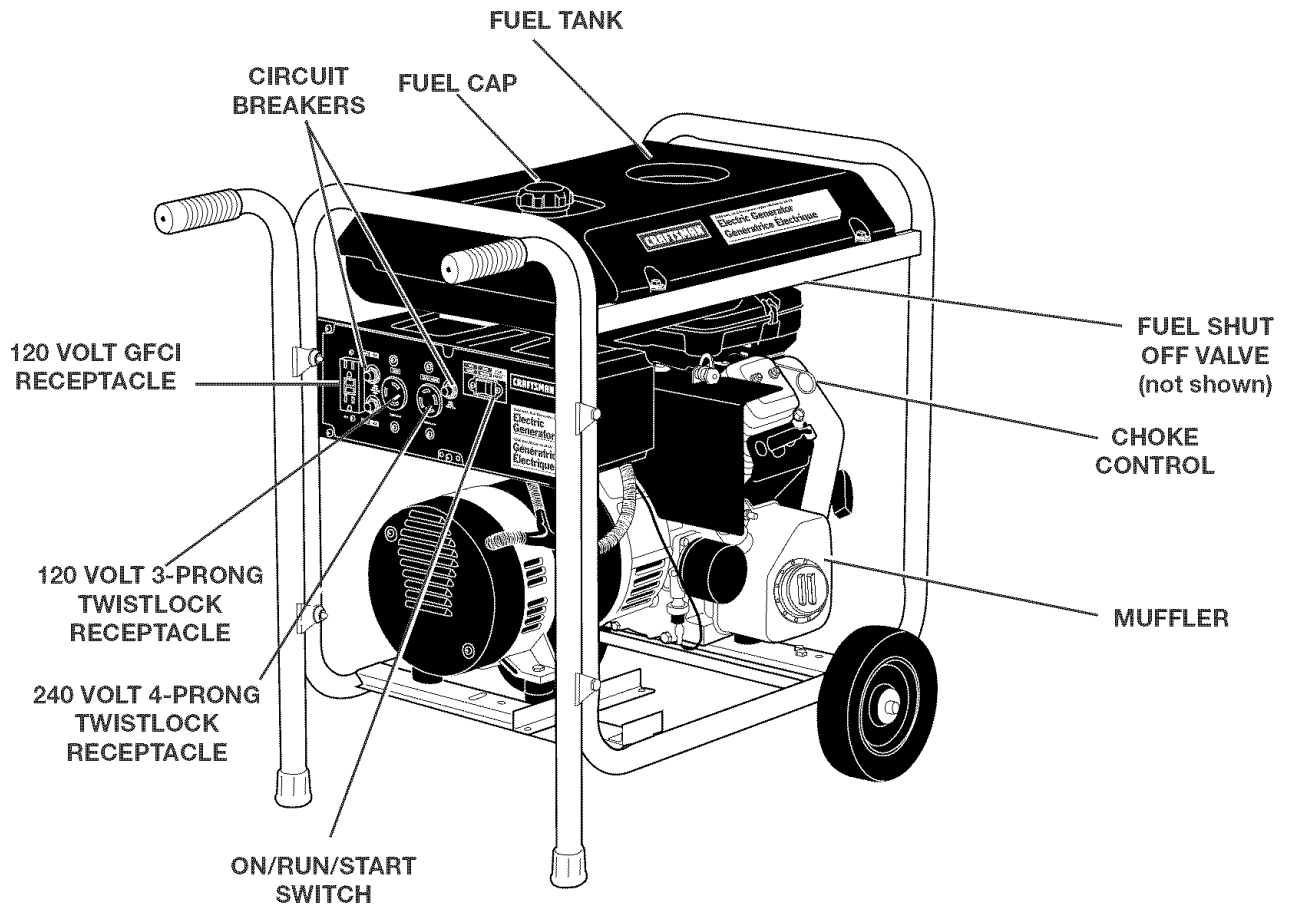

FUEL TANK- Capacity of 7 US gallons/26.5 Liters.

CHOKE CONTROL- Used to start cold engine.

ENGINE OFF/RUN/START SWITCH- Used to start and stop engine.

FUEL VALVE LEVER (located on engine) - Used to shut off the flow of fuel to the engine.

ENGINE OIL FILL- Check and fill engine with oil.

AIR CLEANER- Includes filter element cartridge and foam pre-cleaner that limits the amount of dirt that enters the engine.

CIRCUIT BREAKER- Each receptacle has a circuit breaker to protect the generator from overloading.

GFCI (Ground Fault Circuit Interrupter) 120 VOLT RECEPTACLE- GFCI receptacles reduce the chance of electrical shock by tripping it's built in circuit breaker when it senses an imbalance in current. This receptacle is protected by 30 amp circuit breaker.

3- PRONG 120 VOLT RECEPTACLE- Used to supply 3500 watts of electrical power and is protected by 30 amp circuit breaker.

4-PRONG 240 VOLT TWISTLOCK RECEPTACLE - Used to supply 7000 watts of electrical power and is protected by 30 amp circuit breaker.

RECEPTACLES

Your generator is equipped with:

- one 120 volt GFCI duplex receptacle protected by a 15 amp circuit breaker
- one 120 volt 3-prong twistlock receptacle protected by a 30 amp circuit breaker
- one 240 volt 4-prong twistlock receptacle protected by two 30 amp circuit breakers

The circuit breakers are provided to protect the generator against electrical overload. If the circuit breaker trips, unplug electrical load from receptacle. Let circuit breaker cool down and then push circuit breaker button to reset.

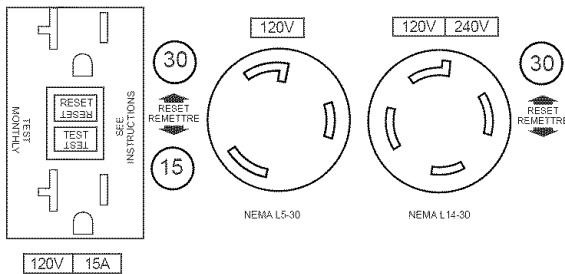

LOW OIL SHUTDOWN

Your Craftsman generator engine is equipped with Low Oil Shutdown. Low Oil Shutdown is a safety device designed to protect your engine from damage in the event the oil level in the crankcase is low.

If while the engine is running, the oil gets low, it will automatically shut itself down and will not restart until the oil is added. If the oil is low before start-up, the generator will not start until oil is added.

NOTE: The Low Oil Shutdown mechanism is very sensitive. You must fill the engine to the full mark on the dipstick to inactivate this safety device.

GENERATOR CAPACITY

Exceeding the rated capacity of your generator can result in serious damage to your generator and connected electrical devices. You should observe the following to prevent overloading the unit:

- Starting and running wattage requirements should always be calculated when matching a generator's wattage capacity to the appliance or tool.
- There are two types of electrical appliances that can be powered by your generator:
 - A. Items such as radios, light bulbs, television sets, and microwaves have a "resistive load". Starting wattage and running wattage are the same.
 - B. Items such as refrigerators, air compressors, washer, dryer, and hand tools that use an electrical motor have an "inductive load". Inductive load appliances and tools require approximately 2 to 4 times the listed wattage for **starting** the equipment. This initial load only lasts for a few seconds on start-up but is very important when figuring your total wattage to be used.

NOTE: Some inductive appliances and tools will list on the motor name plate, the starting and running voltage and amperage requirements. Use the following formula to convert voltage and amperage to wattage:

(Volts X Amp = Watts)

- Always start your largest electric motor first, and then plug in other items, one at a time.

NOTE: On 120-volt loads the maximum starting wattage should **NOT** exceed one half of the rated generator wattage. Example: a 7000 rated wattage generator = 3500 maximum starting wattage.

The guide is provided to assist you in determining the appliances and tools that can be ran with the wattage capacity of your generator.

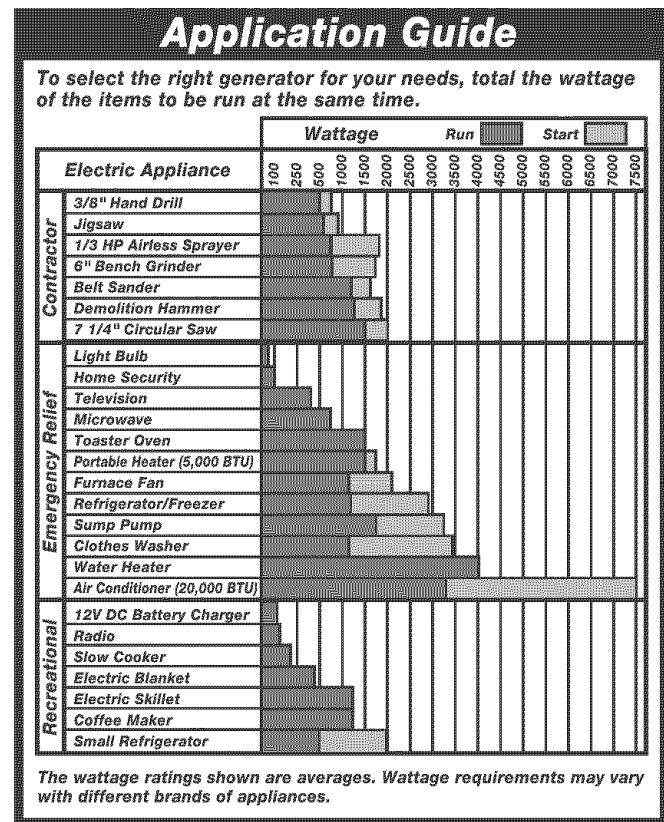

OBTAINING ELECTRICITY FROM GENERATOR

There are basically two ways to obtain electricity from a generator:

- Use of extension cords directly from the generator to the appliance, lights, tools, etc.
- Use of a double-throw transfer switch installed directly to the main electrical supply outside of the house.

Extension Cord

When using an appliance or tool at a considerable distance from the generator, a 3-wire extension cord that has a 3-blade grounding plug and a 3-slot receptacle that accepts the tool's plug **MUST** be used in order to reduce the risk of electrical shock. A cord of adequate size must be used. A minimum of 12 gauge wire size with at least a 20 amp draw can be used. When amperage exceeds 20 amps a 10 gauge wire size should be used.

⚠ WARNING An extension cord that is hot to the touch is overloaded. Repair or replace damaged extension cords immediately.

Connecting Generator To Main Electrical Supply

Potential hazards exist when a electrical generator is connected to the main electrical supply coming into the house. It is at that point that the generator could feed back into the utility company's system causing possible electrocution of workers who are repairing electrical lines. To avoid back feeding of electricity into utility systems, a **double-throw transfer switch** should be installed between the generator and utility power. This device should be installed by a licensed electrician and in compliance with all local electrical codes.

NOTE: When installing a Double-Throw Transfer Switch, a minimum of 10 gauge wiring must be used.

BEFORE STARTING ENGINE

⚠ CAUTION Always check engine oil level before every start. Running engine low of oil or out of oil could result in serious damage to the engine.

Adding Engine Oil

Your generator has been shipped **without** oil in the engine. Begin by removing the oil dipstick and plug. Start pouring the oil in slowly.

The engine will hold approximately 48 ounces/1.4 liters of oil.

To check oil:

- Place engine in a level position. Clean around oil fill and dipstick.
- Remove dipstick and wipe clean with cloth.
- Push dipstick back in and remove to check oil. Keep oil level at FULL line on dipstick.

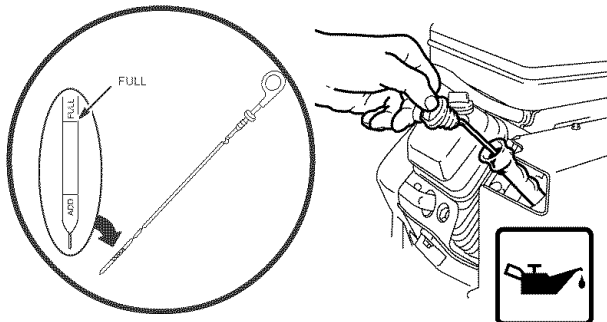

To add oil:

- Remove oil fill cap.
- Pour oil slowly and fill to FULL line on dipstick. Do not overfill.

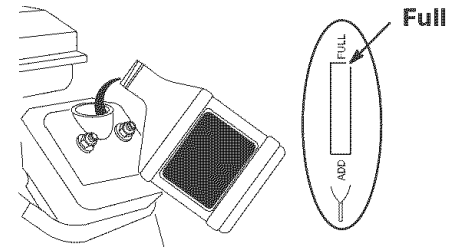

- Replace dipstick firmly.

NOTE: When adding oil to the engine crankcase, use a high quality detergent oil classified "For Service SF,SG,SH,SJ" rated SAE 30 weight. Use no special additives. Select the oil's viscosity grade according to your expected operating temperatures.

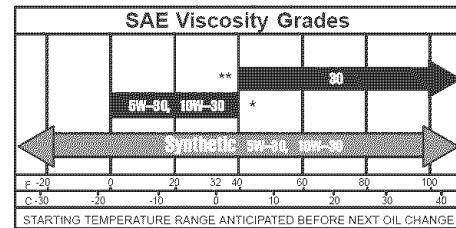

Gasoline

To add gasoline:

- Remove gas cap.

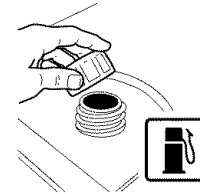

- Add unleaded gasoline, slowly, to fuel tank.

Use clean, fresh, regular unleaded gasoline with a minimum of 85 octane. Use unleaded fuel only. Do not use gasoline which contains Methanol. Never mix oil with gasoline.

⚠ CAUTION Never fill fuel tank completely. Fill tank to 1/2" below the bottom of the filler neck to provide space for fuel expansion. Wipe any fuel spillage from engine and equipment before starting engine.

- Do not overfill.
- Replace gas cap.

⚠ WARNING Never fill fuel tank indoors. Never fill fuel tank when engine is running or hot. Do not smoke when filling fuel tank.

⚠ WARNING Turn engine OFF and let engine cool at least 2 minutes before removing gas cap.

To Start Your Generator

CAUTION Never run engine indoors or in enclosed, poor ventilated areas. Engine exhaust contains carbon monoxide, an odorless and deadly gas.

IMPORTANT: Make sure the battery is properly serviced, fully charged, and assembled before starting.

- Open the fuel shut-off valve.

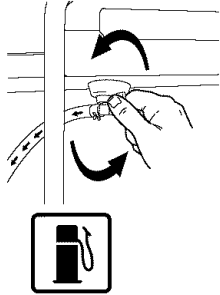

- Pull choke control out to CHOKE position.

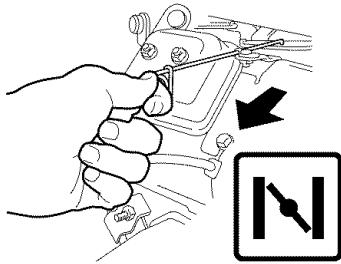

NOTE: No choke is required on warm engines. Push choke control in to start a warm engine.

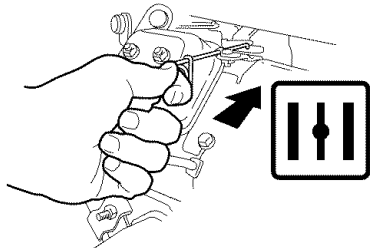

CAUTION You **MUST** unplug any load from the generator before starting to prevent permanent damage to any appliances.

For electric start:

- Place OFF/RUN/START switch in the START position.

NOTE: When the engine starts the switch will remain in the RUN position.

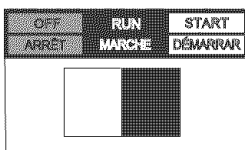

For recoil start:

- Place OFF/RUN/START switch in the RUN position.

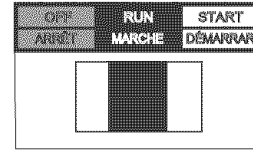

- Grasp handle on rope starter and pull slowly until resistance is felt. Let the rope rewind slowly. Pull rope with a rapid full arm stroke. Let rope rewind slowly. Repeat if necessary.

NOTE: IF ENGINE OIL LEVEL IS TOO LOW, ENGINE WILL NOT START. CHECK OIL LEVEL AND ADD IF NECESSARY.

- When engine warms up, gradually push choke control in to the NO CHOKE position.

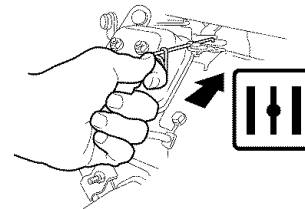

IMPORTANT: Allow generator to run at no load for 5 minutes upon each initial start-up to allow engine and generator to stabilize.

STOPPING ENGINE

- Disconnect all electrical loads.
- Turn OFF/RUN/START switch to "OFF" position.

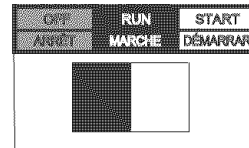

- Close fuel shut-off valve.

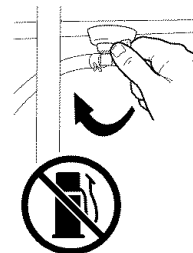

IMPORTANT: Never store engine with fuel in tank, indoors, or in enclosed, poorly ventilated areas or where fuel fumes may reach an open flame.

CONNECTING ELECTRICAL LOADS

- Let engine run and warm up for five minutes after starting with no electrical load.

Connect loads in the following manner to prevent damage to equipment:

- Connect inductive load equipment first, inductive loads consist of refrigerators, freezers, water pumps, air conditioners, or small hand tools. Connect the items that require the most wattage first.
- Connect the lights next.

- Voltage sensitive equipment should be the last equipment connected to the generator. Plug voltage sensitive appliances such as TV's, VCR's, microwaves, ovens, computers, and cordless telephones into a UL listed voltage surge protector, then connect the UL listed voltage surge protector to the generator.

IMPORTANT: You should always add up the rated watts of all lights, tools and appliances you are powering at one time. This total should not exceed the rated capacity of you generator or circuit breaker rating of the receptacle supplying power.

MAINTENANCE

CUSTOMER RESPONSIBILITIES TABLE

MAINTENANCE TASK	Every 8 Hours or Daily	Every 25 Hours of Every Season	Every 50 Hours of Every Season	Every 100 Hours of Every Season	Monthly
Check oil level	X				
Change oil			See Note 1		
Change oil filter				X	
Service air pre-cleaner		See Note 2			
Service air cleaner cartridge		See Note 2			
Spark arrester (if equipped)			X		
Clean cooling system				See Note 2	
Check spark plug				X	
Replace in-line fuel filter				X	
GFCI (ground fault circuit interrupter)					X
Prepare unit for storage	Prepare unit for storage if it is to remain idle for more than 30 days.				

Note 1: Change oil after first five (5) operating hours, every 25 hours if operating under heavy load or high ambient temperature, and every 50 operating hours thereafter.

Note 2: Clean more often under dusty conditions.

GENERAL RECOMMENDATIONS

The warranty of the generator does not cover items that have been subjected to operator abuse or negligence. To receive full value from the warranty, operator must maintain the generator as instructed in this manual.

Some adjustments will need to be made periodically to maintain your generator.

GENERATOR MAINTENANCE

Your generator should be kept clean and dry at all times. The generator should not be stored or operated in environments that include excessive moisture, dust or any corrosive vapors. If these substances are on the generator, clean with a cloth or soft bristle brush. Do not use a garden hose or anything with water pressure to clean the generator. Water may enter the cooling air slots and could possibly damage the rotor, stator and the internal windings of the generator head.

All adjustments in the Maintenance section of this manual should be made at least once each season.

ENGINE MAINTENANCE

NOTICE: Maintenance, replacement or repair of the emission control devices and systems may be performed by any nonroad engine repair establishment or individual. However, to obtain no charge repairs under the terms and provisions of the engine manufacturers warranty statement, any service or emission control part repair or replacement must be performed by a factory authorized dealer.

Oil

- Oil level should be checked prior to each use and at least every 8 hours of operation. To check oil see **Adding Engine Oil** paragraph in the **Operation** section of this manual.

Changing Engine Oil

For a new engine, change oil after the first **5 operating hours**. Thereafter, change oil after every **50 hours** of operation.

Change the oil while the engine is still warm. The oil will flow freely and carry away more impurities. Make sure the engine is level when filling, checking or changing oil.

Change the oil as follows:

- To keep dirt, grass clippings, etc. out of the engine, clean the area around the drain plug and dipstick before removing it.
- Disconnect spark plug wire and keep away from spark plug. Disconnect battery at negative terminal.
- With engine off but still warm, remove oil drain plug and drain oil into appropriate receptacle.

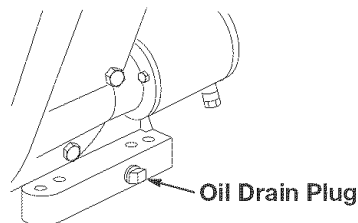

CAUTION Used oil is a hazardous waste product. Dispose of used oil properly. Do not discard with household waste. Check with your local authorities, service center, or dealer for safe disposal/recycling facilities.

- Reinstall drain plug. Remove oil fill cap.
- Fill the crankcase with new oil of the proper type (See **Adding Engine Oil** in the **Operation** section), to the FULL mark on the dipstick. Always check the level with the dipstick before adding more oil.

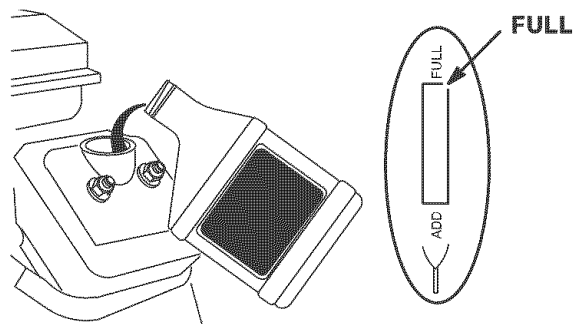

- Reinstall the oil fill cap or plug and tighten securely.

Change Oil Filter

Change oil filter after every 100 hours or every season.

- Drain engine oil and remove oil filter.

CAUTION Used oil is a hazardous waste product. Dispose of used oil properly. Do not discard with household waste. Check with your local authorities, service center, or dealer for safe disposal/recycling facilities.

- Before installing new filter, lightly oil filter gasket with fresh, clean oil.

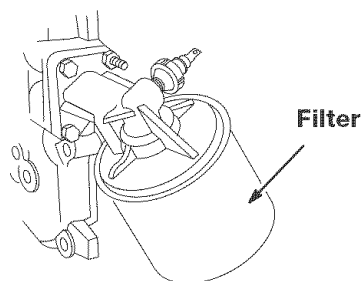

- Screw filter on by hand until gasket contacts oil filter adapter. Tighten 1/2 to 3/4 turn more.

- Add fresh oil. See **Add Engine Oil** in the **Operation** section of this manual.
- Start and run engine at idle to check for leaks.
- Stop engine. Re-check oil level, add oil if required.

Air Cleaner

CAUTION Do not use pressurized air or solvents to clean cartridge. Pressurized air can damage cartridge; solvents will dissolve cartridge.

To service air cleaner follow these steps:

- Unhook clips on both sides of cover and remove cover.

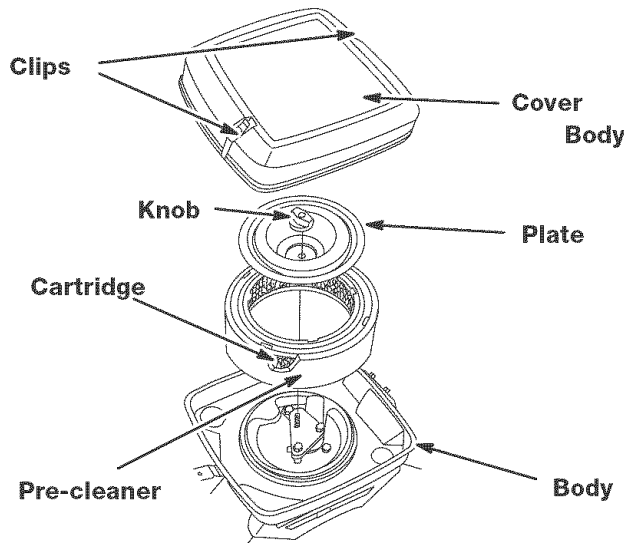

- Remove knob and plate. Carefully remove air cleaner assembly to prevent debris from entering carburetor.
- To clean pre-cleaner and cartridge:

Pre-cleaner

- Separate from cartridge and wash in liquid detergent and water.
- Squeeze dry in a clean cloth.
- Saturate in engine oil. Squeeze in clean, absorbent cloth to remove all EXCESS oil.

Cartridge

- Gently tap on a flat surface.
- Reassemble clean (or new) pre-cleaner on clean (or new) cartridge.
- Reinstall air cleaner assembly, plate and knob in body.
- Replace cover and reattach clips to body.

Clean Cooling System

Debris may clog the engine's air cooling system. Remove blower housing and clean area shown to prevent overheating and engine damage.

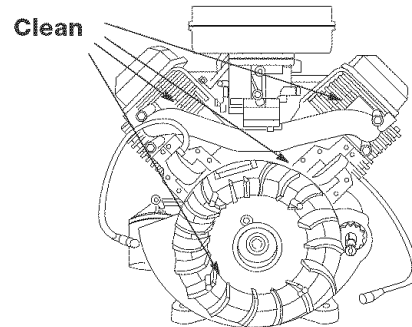

Clean and Replace Spark Plug

Check spark plug yearly or every 100 operating hours.

- Clean area around spark plug.
- Remove and inspect spark plug.
- Replace spark plug if electrodes are pitted, burned or porcelain is cracked.
- Check electrode gap with wire feeler gauge and set gap .030 if necessary.
- Install spark, tighten securely.

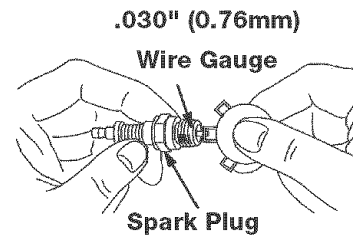

Replace Fuel In-Line Filter

- Disconnect spark plug wires and keep away from spark plugs.

WARNING Drain fuel tank or close fuel shut-off valve before replacing fuel filter.

- Replace in-line fuel filter.

In-line Fuel Filter

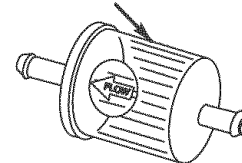

GFCI receptacle (Ground Fault Circuit Interrupter)

For maximum protection against electrical shock the GFCI should be tested monthly.

To test:

1. Depress the TEST button. The RESET button should extend. If the RESET button does not extend, notify a Authorized Service Center.
2. To restore power, depress the RESET button firmly into the GFCI unit until an audible click is heard. If reset properly, the RESET button is flush with the surface of the test button. When the button stays in, the power is ON.

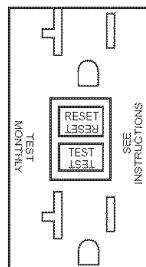

SERVICE ADJUSTMENTS

CARBURETOR

The carburetor of your generator is pre-set at the factory. The carburetor should not be tampered with. If your generator is used at an altitude in excess of 4000 feet performance may be affected. If so consult with your nearest Craftsman Service Center regarding high altitude set changes.

GOVERNOR

Your engine governor maintains the constant operating speed of your generator. **DO NOT** tamper with the engine governor which is factory set for proper engine speed.

Over-speeding your engine above factory high speed setting can be dangerous and could possibly cause personal injury or property damage. If you believe the engine is running too fast or slow, take your generator to a Authorized Craftsman Service Center for repair and adjustment.

CAUTION Low engine speeds impose a heavy load on the engine and when sufficient power is not available the engine life could be shortened.

STORAGE

If you are going to store your generator for more than 30 days, use the following information as a guide to prepare the generator for storage.

CAUTION Never store generator with fuel in the tank indoors or in enclosed, poorly ventilated areas, where fumes can reach an open flame, spark or pilot light as on a furnace, water heater, clothes dryer or other gas appliances.

Engine Preparation

- Add fuel stabilizer to fuel tank to minimize the formation of fuel gum deposits during storage.
- Run engine at least 10 minutes after adding stabilizer to allow it to enter the fuel system.
- Disconnect the spark plug wire and remove the spark plug.
- Add one teaspoon of oil through the spark plug hole.

- Place rag over spark plug hole and pull the recoil a few times to lubricate the combustion chamber.
Replace the spark plug, but do not connect the spark plug wire.

NOTE: If a fuel stabilizer is not used, all gasoline must be drained from the tank and carburetor to prevent gum deposits from forming on these parts and causing possible malfunction of the engine.

Generator

- Clean the generator as outlined in the Generator Maintenance paragraph on page 18.
- Check that cooling air slots and openings on generator are open and unobstructed.

Battery

- Store battery as described by the battery manufacturer.

NOTE: After storing battery for a long period of time it may lose its charge. If the battery loses its charge, manually start the engine with the battery connected. The engine will recharge the battery as it runs.

TROUBLESHOOTING GUIDE

<i>PROBLEM</i>	<i>CAUSE</i>	<i>CORRECTION</i>
<i>Engine will not start</i>	<ol style="list-style-type: none"> 1. Low on fuel or oil. 2. Ignition switch in "Off" position. 3. Faulty spark plug. 4. Choke in wrong position. 5. Fuel shut-off valve in closed position. 6. Unit loaded during start-up. 7. Spark plug wire loose. 	<ol style="list-style-type: none"> 1. Add fuel or oil. 2. Turn to "ON" position 3. Replace spark plug. 4. Adjust choke accordingly. 5. Open fuel shut-off valve. 6. Remove load from unit. 7. Attach wire to spark plug.
<i>No electrical output</i>	<ol style="list-style-type: none"> 1. Faulty receptacle. 2. Circuit breaker kicked out. 3. Defective capacitor. 4. Faulty power cord. 5. GFCI receptacle circuit breaker kicked out. 	<ol style="list-style-type: none"> 1. Have Authorized Sears Service Center replace. 2. Depress and reset. 3. Have Authorized Sears Service Center replace capacitor. 4. Repair or replace cord. 5. Depress and reset.
<i>Repeated circuit breaker tripping</i>	<ol style="list-style-type: none"> 1. Overload 2. Faulty cords or equipment. 	<ol style="list-style-type: none"> 1. Reduce load. 2. Check for damaged, bare, or frayed wires on equipment. Replace.
<i>Generator overheating the circuit breaker depressed</i>	<ol style="list-style-type: none"> 1. Generator overloaded. 2. Insufficient ventilation. 	<ol style="list-style-type: none"> 1. Reduce load. 2. Move to adequate supply of fresh air.

EMISSIONS CONTROL SYSTEMS STATEMENT

Briggs & Stratton Corporation (B&S), the California Air Resources Board (CARB)
and the United States Environmental Protection Agency (U.S. EPA)

Emission Control System Warranty Statement (Owner's Defect Warranty Rights and Obligations)

EMISSION CONTROL WARRANTY COVERAGE IS APPLICABLE TO CERTIFIED ENGINES PURCHASED IN CALIFORNIA IN 1995 AND THEREAFTER, WHICH ARE USED IN CALIFORNIA, AND

TO CERTIFIED MODEL YEAR 1997 AND LATER ENGINES WHICH ARE PURCHASED AND USED ELSEWHERE IN THE UNITED STATES.

California and United States Emission Control Defects Warranty Statement

The California Air Resources Board (CARB), U.S. EPA and B&S are pleased to explain the Emission Control System Warranty on your model year 2000 and later small off-road engine (SORE). In California, new small off-road engines must be designed, built and equipped to meet the State's stringent anti-smog standards. Elsewhere in the United States, new non-road, spark-ignition engines certified for model year 1997 and later, must meet similar standards set forth by the U.S. EPA. B&S must warrant the emission control system on your engine for

the periods of time listed below, provided there has been no abuse, neglect or improper maintenance of your small off-road engine.

Your emission control system includes parts such as the carburetor, air cleaner, ignition system, muffler and catalytic converter. Also included may be connectors and other emission related assemblies. Where a warrantable condition exists, B&S will repair your small off-road engine at no cost to you including diagnosis, parts and labor.

Briggs & Stratton Emission Control Defects Warranty Coverage

Small off-road engines are warranted relative to emission control parts defects for a period of two years, subject to provisions set forth

below. If any covered part on your engine is defective, the part will be repaired or replaced by B&S.

Owner's Warranty Responsibilities

As the small off-road engine owner, you are responsible for the performance of the required maintenance listed in your Operating and Maintenance Instructions. B&S recommends that you retain all your receipts covering maintenance on your small off-road engine, but B&S cannot deny warranty solely for the lack of receipts or for your failure to ensure the performance of all scheduled maintenance.

You are responsible for presenting your small off-road engine to an Authorized B&S Service Dealer as soon as a problem exists. The undisputed warranty repairs should be completed in a reasonable amount of time, not to exceed 30 days.

As the small off-road engine owner, you should however be aware that B&S may deny you warranty coverage if your small off-road engine or a part has failed due to abuse, neglect, improper maintenance or unapproved modifications.

If you have any questions regarding your warranty rights and responsibilities, you should contact a B&S Service Representative at 1-414-259-5262.

The emission warranty is a defects warranty. Defects are judged on normal engine performance. The warranty is not related to an in-use emission test.

Briggs & Stratton Emission Control Defects Warranty Provisions

The following are specific provisions relative to your Emission Control Defects Warranty Coverage. It is in addition to the B&S engine warranty for non-regulated engines found in the Operating and Maintenance Instructions.

1. Warranted Parts

Coverage under this warranty extends only to the parts listed below (the emission control systems parts) to the extent these parts were present on the engine purchased.

a. Fuel Metering System

Cold start enrichment system
Carburetor and internal parts
Fuel Pump

b. Air Induction System

Air cleaner
Intake manifold

c. Ignition System

Spark plug(s)
Magneto ignition system

d. Catalyst System

Catalytic converter
Exhaust manifold
Air injection system or pulse valve

e. Miscellaneous Items Used in Above Systems

Vacuum, temperature, position, time sensitive valves and switches
Connectors and assemblies

2. Length of Coverage

B&S warrants to the initial owner and each subsequent purchaser that the Warranted Parts shall be free from defects in materials and workmanship which caused the failure of the Warranted Parts for a period of two years from the date the engine is delivered to a retail purchaser.

3. No Charge

Repair or replacement of any Warranted Part will be performed at no charge to the owner, including diagnostic labor which leads to the determination that a Warranted Part is defective, if the diagnostic work is performed at an Authorized B&S Service Dealer. For emissions warranty service contact your nearest Authorized B&S Service Dealer as listed in the "Yellow Pages" under "Engines, Gasoline," "Gasoline Engines," "Lawn Mowers," or similar category.

4. Claims and Coverage Exclusions

Warranty claims shall be filed in accordance with the provisions of the B&S Engine Warranty Policy. Warranty coverage shall be excluded for failures of Warranted Parts which are not original B&S parts or because of abuse, neglect or improper maintenance as set forth in the B&S Engine Warranty Policy. B&S is not liable to cover failures of Warranted Parts caused by the use of add-on, non-original, or modified parts.

5. Maintenance

Any Warranted Part which is not scheduled for replacement as required maintenance or which is scheduled only for regular inspection to the effect of "repair or replace as necessary" shall be warranted as to defects for the warranty period. Any Warranted Part which is scheduled for replacement as required maintenance shall be warranted as to defects only for the period of time up to the first scheduled replacement for that part. Any replacement part that is equivalent in performance and durability may be used in the performance of any maintenance or repairs. The owner is responsible for the performance of all required maintenance, as defined in the B&S Operating and Maintenance Instructions.

6. Consequential Coverage

Coverage hereunder shall extend to the failure of any engine components caused by the failure of any Warranted Part still under warranty.

GENERATOR PARTS

CRAFTSMAN 7000 GENERATOR 919.670070

GENERATOR ASSEMBLY

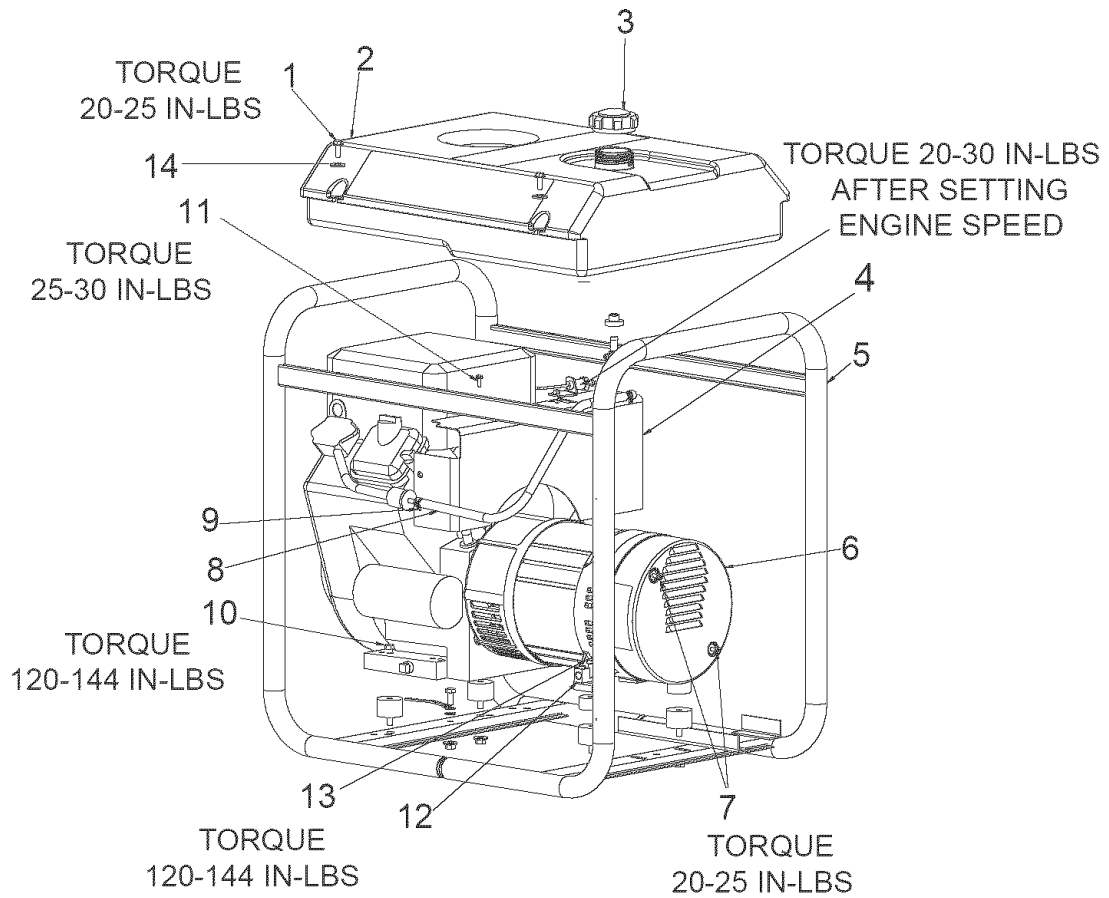

KEY

<u>NO.</u>	<u>DESCRIPTION</u>	<u>PART NUMBER</u>
1	FUEL TANK SCREWS	91895680
2	FUEL TANK	GS-0795
3	FUEL CAP	GS-0443
4	HEAT SHIELD	GS-0271
5	FRAME ASSEMBLY	GS-0913
6	END COVER	GS-0077
7	SCREW #10-24 x 9/16	SSF-553-1
8	FUEL HOSE	GS-0225
9	FUEL LINE CLAMP	GS-0227
10	SCREW, HEX CAP 5/16-18 x 1.25	SSF-605
11	SCREW #10-32 x 1/2	GS-0107
12	GROUND LUG	GS-0117
13	SCREW 5/16-18UNC 2A	95829230
14	WASHER .8750D .3751D .083THK	SSN-632

GENERATOR PARTS

CRAFTSMAN 7000 GENERATOR 919.670070

GENERATOR ASSEMBLY

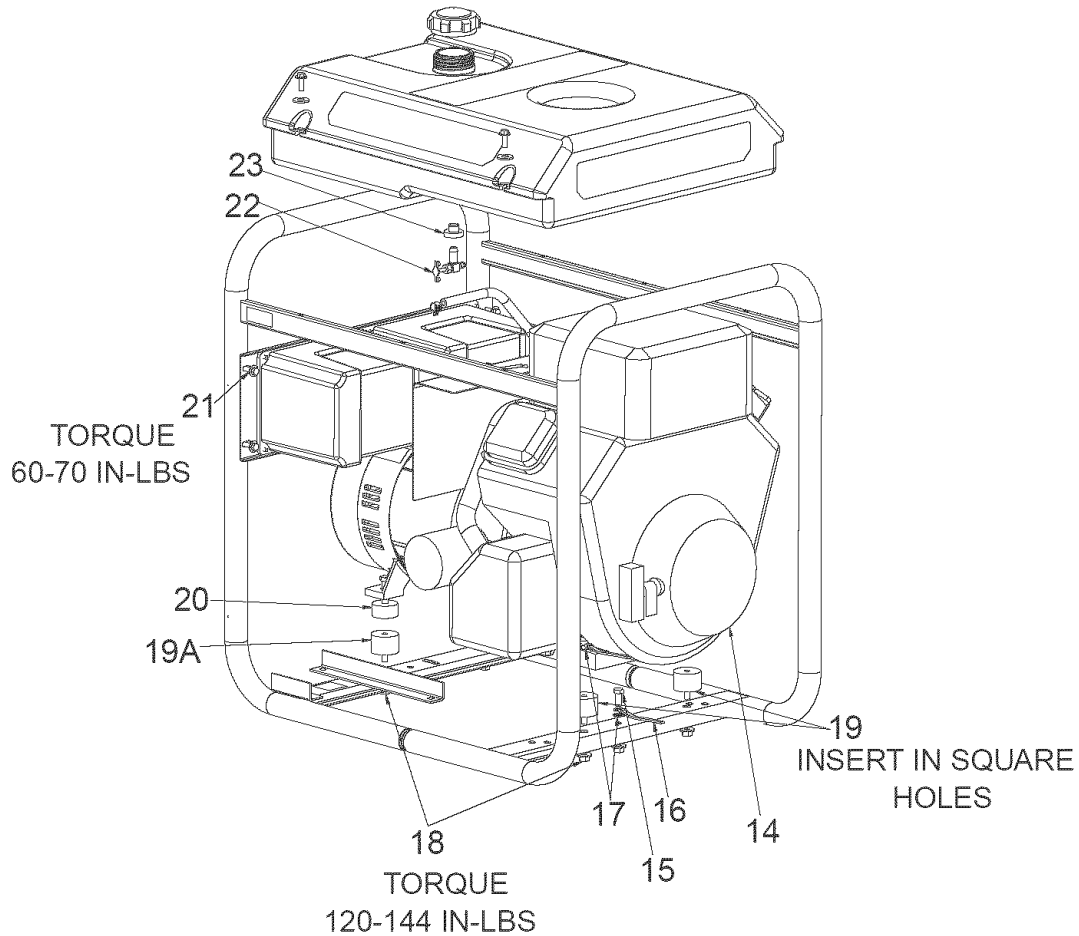

<u>KEY NO.</u>	<u>DESCRIPTION</u>	<u>PART NUMBER</u>
14	ENGINE (model # 294447-1042-E1)	*
15	SCREW 5/16-18 x 3/4	SS-12-CD
16	GROUND STRAP	GS-0118
17	LOCK WASHER	SSN-1619-ZN
18	LOCK NUT	SSF-8150
19	ISOLATOR	GS-0033
19A	ISOLATOR	GS-0033
20	REAR ISOLATOR SPACER	GS-0492
21	SCREW 1/4-20 x 3/4	91895680
22	FUEL SHUT-OFF VALVE	GS-0437
23	DRAINCOCK GROMMET	GS-0446

*SEE ENGINE PAGES 30-36

GENERATOR PARTS

CRAFTSMAN 7000 GENERATOR 919.670070

GENERATOR HEAD ASSEMBLY

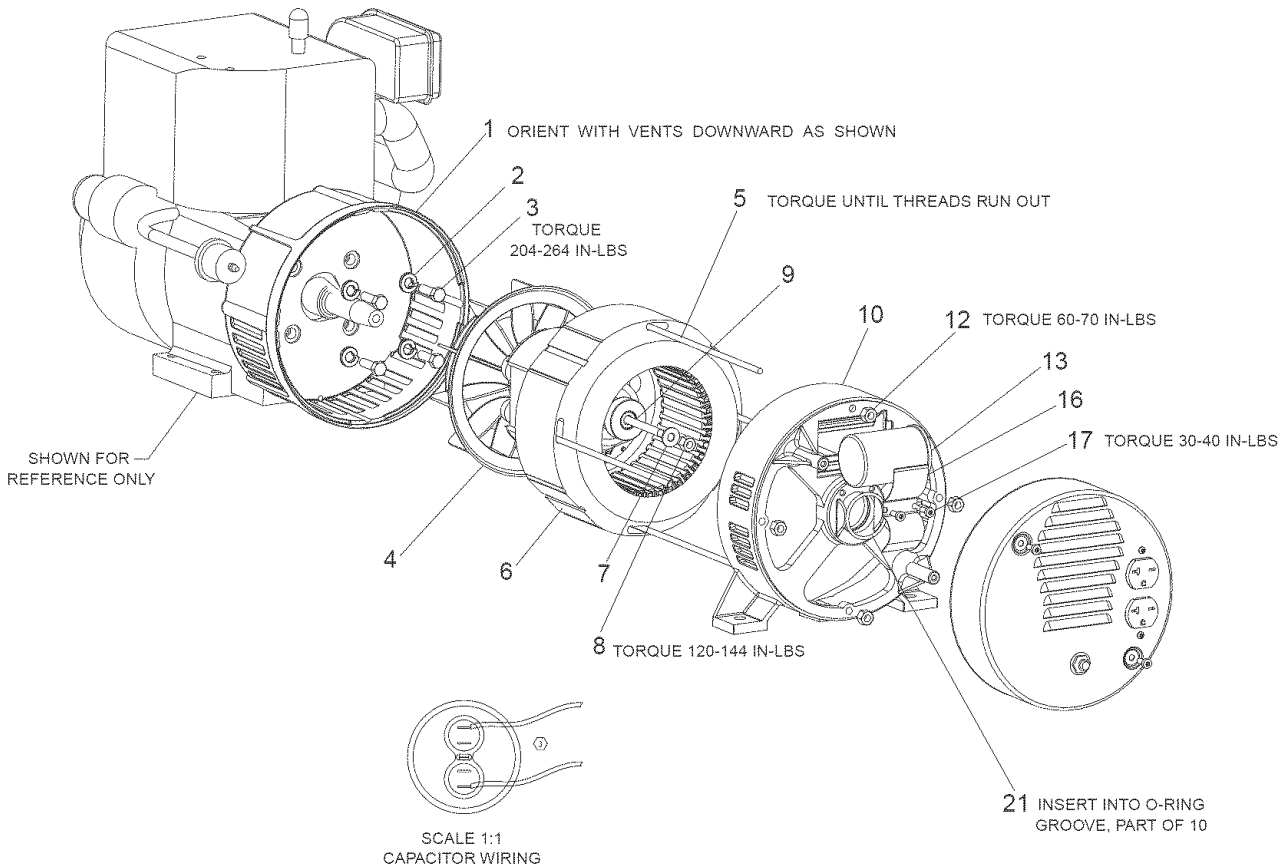

KEY NO.

KEY NO.	DESCRIPTION	PART NUMBER
1	DRIVE END ADAPTER	GS-0076
2	LOCK WASHER 3/8	SSN-619
3	CAP SCREW 3/8-16 x 1	SSF-577
4	ROTOR ASSEMBLY	GS-0571
5	STATOR THRU BOLT	GS-0273
6	STATOR ASSEMBLY	GS-0572
7	WASHER 11/16OD x 11/32	SS-6506-CD
8	NUT 5/16-24	SSF-576
9	ROTOR THRU BOLT	GS-0274
10	BEARING SUPPORT	GS-0861
11	HEX NUT 1/4-20	SSF-575
12	CAPACITOR	GS-0592
16	CAPACITOR BRACKET	GS-0595
17	SCREW 10-32	SSF-553-1
21	O-RING	GS-0862

ITEM NOT SHOWN

DIODES GS-0082

GENERATOR PARTS

CRAFTSMAN 7000 GENERATOR 919.670070

PANEL ASSEMBLY

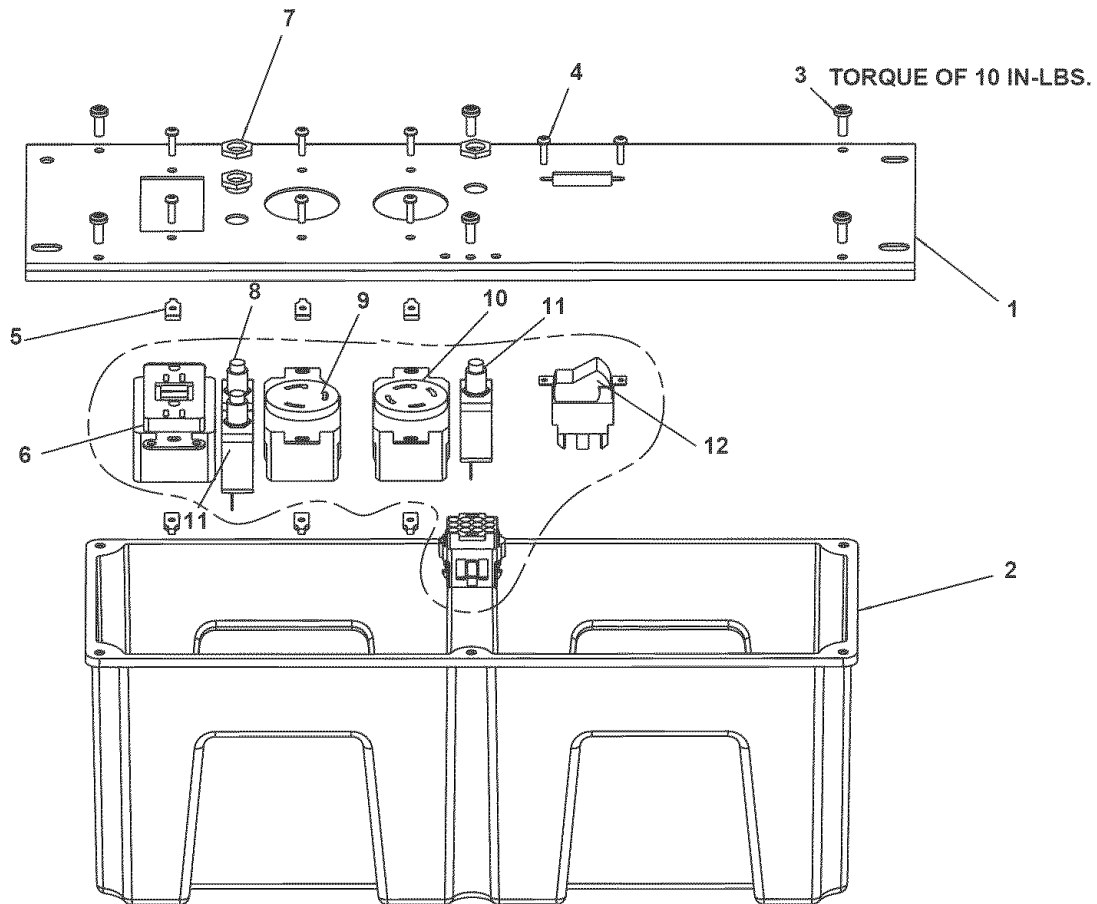

KEY

KEY NO.	DESCRIPTION	PART NUMBER
1	PANEL ASSEMBLY	GS-0928
2	PANEL COVER	GS-0017-1
3	SCREW 10 - 9 X .50	SSF-3156
4	SCREW #6-32 X .5 TORX	SSF-583
5	NUT, SPEED #6 - 32	SSF-584
6	120V DUPLEX GFCI RECEPTACLE	GS-0806
7	NUT, HEX JAM	SSF-595
8	CIRCUIT BREAKER 15 AMP	GS-0024
9	3 PRONG TWISTLOCK	GS-0021
10	4 PRONG TWISTLOCK	GS-0455
11	CIRCUIT BREAKER 30 AMP	GS-0026
12	ON/OFF(ON/OFF/START)	GS-0046

GENERATOR PARTS

CRAFTSMAN 7000 GENERATOR 919.670070

WHEEL KIT

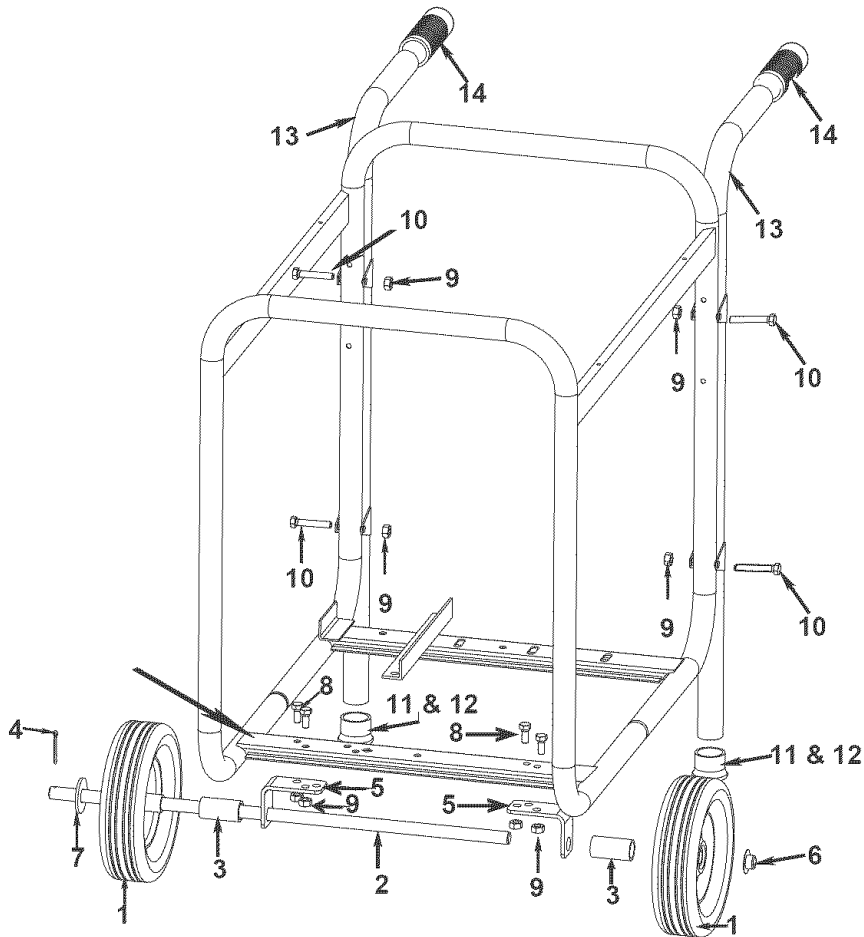

<u>KEY NO.</u>	<u>DESCRIPTION</u>	<u>PART NO.</u>
1	WHEEL (2 USED)	GS-0583
2	AXLE	GS-0586
3	AXLE SPACER (2 USED)	GS-0213
4	COTTER PIN	SSN-622
5	WHEEL BRACKET (2 USED)	GS-0217-1
6	AXLE END CAP	SSF-591
7	FLAT WASHER, 3/4 OD X 11/16 ID	SSN-623
8	SCREW, 5/16-18 X 1-3/4 (3 USED)	SS-12-CD
9	LOCK NUTS (7 USED)	SSF-8150
10	SCREW, 5/16-18 X 1-3/4 (4 USED)	SSF-999-1
11	BASE END CAPS (2 USED)	GS-0221
12	FLAT WASHER, 1-5/16 OD X 5/8 ID (2 USED)	91890228
13	HANDLE ASSEMBLY (2 USED)	GS-0584
14	HANDLE GRIP (2 USED)	GS-0220
15	LOUVERED HEAT DEFLECTOR (NOT SHOWN)	GS-0597
16	SCREW, HH #8-32 (4 USED) (NOT SHOWN)	SUDL-9-1

GENERATOR PARTS

CRAFTSMAN 7000 GENERATOR 919.670070

WIRING DIAGRAM

CONTROL PANEL REAR VIEW

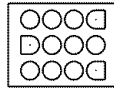

REAR VIEW
HOUSING (MALE)

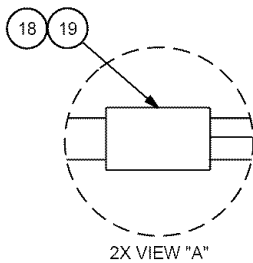
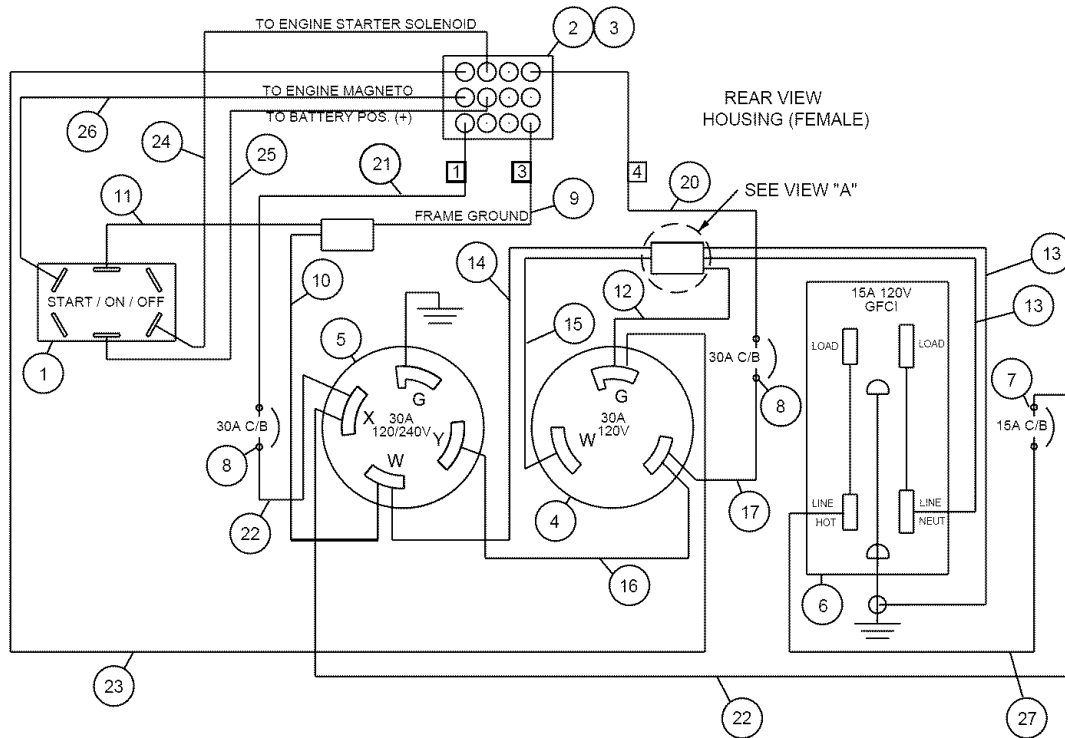

KEY NO.

KEY NO.	DESCRIPTION	COLOR	PART NUMBER
1	SWITCH OFF - ON / START	NA	GS-0046
2	CAP FRONT	NA	GS-0164
3	CAP REAR	NA	GS-0166
4	RECEPTACLE 125V 30A	NA	GS-0021
5	RECEPTACLE 4 PRONG 30A	NA	GS-0455
6	INTERRUPTER GR F CIRCUIT	NA	GS-0806
7	BREAKER CIRCUIT 125/250V	NA	GS-0024
8	CIRCUIT BREAKER 125/250V	NA	GS-0026
9	WIRE #12 AWG	GREEN	NA
10	WIRE #12 AWG	GREEN	NA
11	WIRE # 16AWG	GREEN	NA
12	WIRE #12 AWG	GREEN	NA
13	WIRE #12 AWG	GREEN	NA
14	WIRE #12 AWG	GREEN	NA
15	WIRE #12 AWG	GREEN	NA
16	WIRE #12 AWG	RED	NA
17	WIRE #12 AWG	RED	NA
18	TUBE HEAT SHRINK 1.5 IN	NA	NA
19	SPLICE TERMINAL	NA	NA
20	WIRE #12 AWG	RED	NA
21	WIRE #12 AWG	BLACK	NA
22	WIRE #12 AWG	BLACK	NA
23	WIRE #12 AWG	ORANGE	NA
24	WIRE # 16AWG	BLUE	NA
25	WIRE # 16AWG	PINK	NA
26	WIRE # 16AWG	YELLOW	NA
27	WIRE #12 AWG	BLACK	NA

GENERATOR PARTS

CRAFTSMAN 7000 GENERATOR 919.670070

WIRE ASSEMBLY

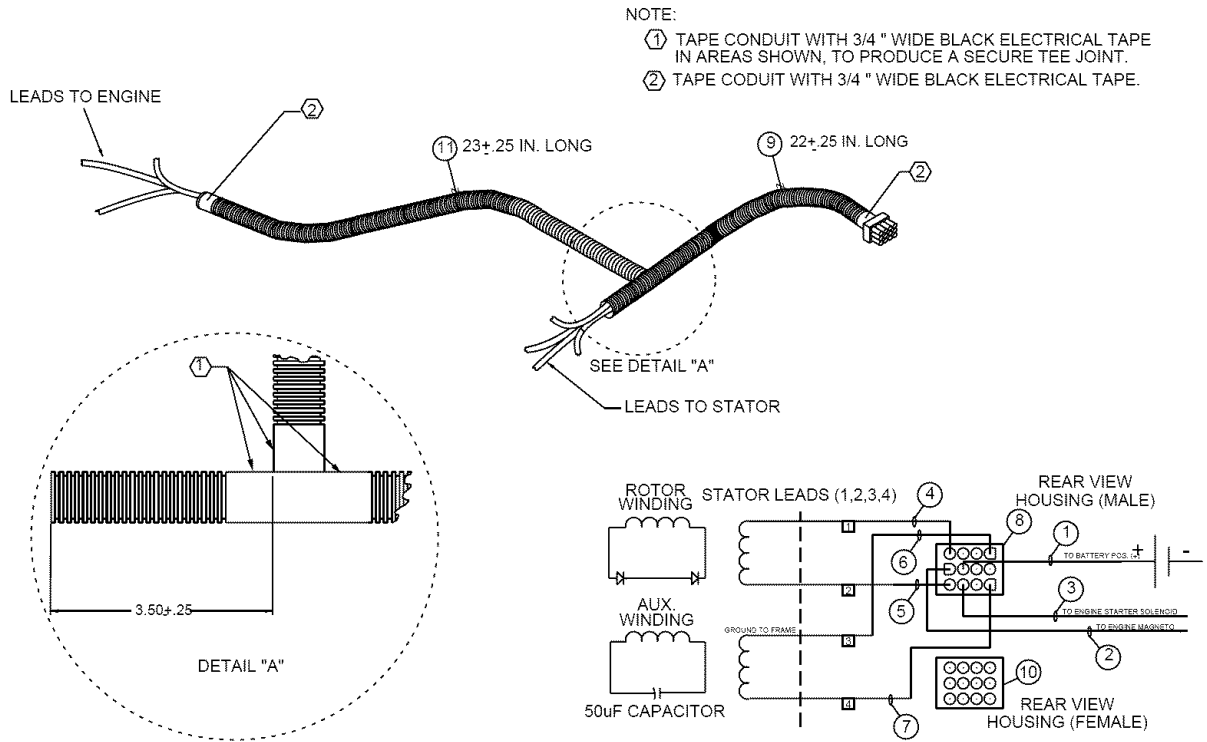

KEY

NO.	DESCRIPTION	COLOR
1	WIRE # 16AWG	PINK
2	WIRE # 16AWG	YELLOW
3	WIRE # 16AWG	BLUE
4	WIRE #12 AWG	BLACK
5	WIRE #12 AWG	ORANGE
6	WIRE #12 AWG	GREEN
8	PLUG FRONT	NA
9	CONDUIT FLEXIBLE	NA
10	PLUG REAR	NA
11	CONDUIT FLEXIBLE .42" ID	NA

ENGINE PARTS

CRAFTSMAN 7000 GENERATOR 919.670070

Briggs & Stratton Model No. 294447-1257-E1

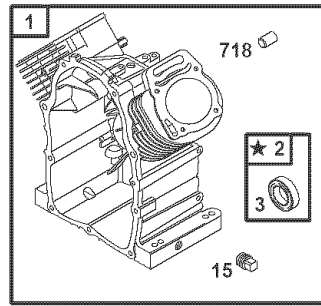
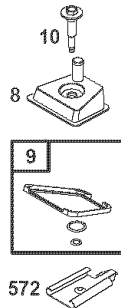
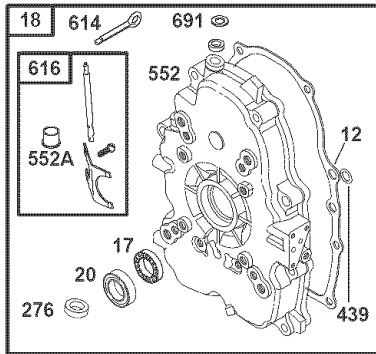

★ REQUIRES SPECIAL TOOL TO INSTALL. SEE REPAIR INSTRUCTION MANUAL.

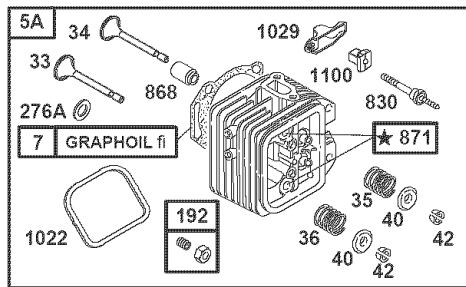
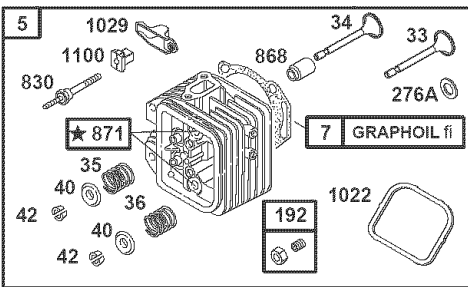
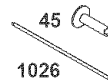
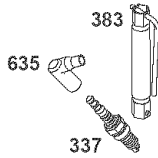

★ REQUIRES SPECIAL TOOLS TO INSTALL. SEE REPAIR INSTRUCTION MANUAL.

Key No.	Part No.	Description
1	692178	Cylinder Assembly
2	808534	Bushing/Seal Kit
3	805101	Oil Seal (Magneto Side)
5	808381	Cylinder Head (#1)
5A	808382	Cylinder Head (#2)
7	806085	Cylinder Head Gasket
8	807795	Breather Assembly
9	807688	Breather Gasket
10	690751	Screw (Breather Assembly)
11	806083	Breather Tube
12	806190	Crankcase Gasket
13	805097	Screw (Cylinder Head)
15	94239	Oil Drain Plug
17	690752	Ball Bearing
18	808847	Crankcase Cover
20	805049	Oil Seal (PTO Side)
22	692540	Screw (Crankcase Cover/Sump)
33	807681	Exhaust Valve
34	807680	Intake Valve
35	692084	Valve Spring (Intake)
36	682084	Valve Spring (Exhaust)
40	805092	Valve Retainer
42	807683	Valve Keeper
45	262679	Valve Tappet

Key No.	Part No.	Description
192	807623	Rocker Arm Adjuster
276	690704	Sealing Washer
276A	805420	Sealing Washer
337	491055	Spark Plug
383	19374	Spark Plug Wrench
439	692154	O-Ring Seal
		(Crankcase Cover/Sump)
552	690701	Governor Shaft Bushing
552A	806686	Governor Shaft Bushing
572	690686	Breather Baffle
616	806685	Governor Crank
635	805529	Spark Plug Boot
691	690680	Governor Shaft Seal
718	690684	Locating Pin
830	691544	Stud (Rocker Arm)
868	805094	Valve Seal
871	805084	Bushing Guide
1022	806039	Rocker Arm Gasket
1026	805352	Push Rod (Steel)
	805617	Push Rod (Aluminum)
		(Exhaust Side Only)
1029	691543	Rocker Arm
1100	690973	Rocker Arm Pivot

ENGINE PARTS

CRAFTSMAN 7000 GENERATOR 919.670070

Briggs & Stratton Model No. 294447-1257-E1

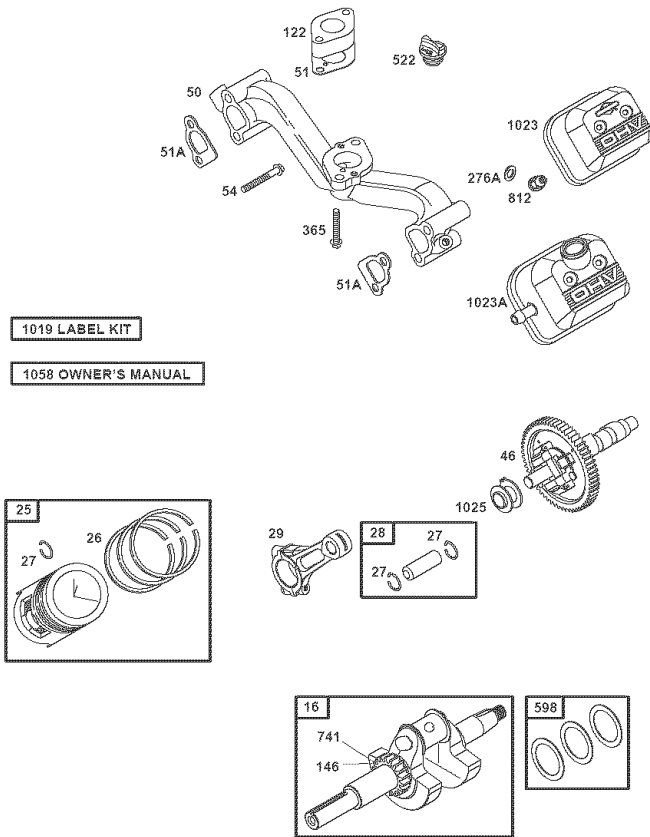

1019 LABEL KIT

1058 OWNER'S MANUAL

Key No.	Part No.	Description
16	692163	Crankshaft
25	807619	Piston Assembly (Standard)
		-----NOTE-----
	807807	Piston Assembly (.010 Oversize)
	807809	Piston Assembly (.020 Oversize)
	807811	Piston Assembly (.030 Oversize)
26	807620	Ring Set (Standard)
		-----NOTE-----
	807808	Ring Set (.010 Oversize)
	807810	Ring Set (.020 Oversize)
	807812	Ring Set (.030 Oversize)
27	690683	Piston Pin Lock
28	807621	Piston Pin
29	807900	Connecting Rod (Standard)
	807803	Connecting Rod (.020 Undersize)
46	691557	Camshaft
50	807802	Intake Manifold
51	805700	Intake Gasket
51A	805023	Intake Gasket
54	690676	Screw (Intake Gasket)
122	690691	Carburetor Spacer
146	94196	Timing Key
276A	805420	Sealing Washer
365	690711	Screw (Carburetor)
522	491832	Dipstick/Fill Plug
598	807625	End Play Shim (Crankshaft)
741	805675	Timing Gear
812	805019	Nut (Rocker Arm Cover)
1019	808035	Label Kit
1023	691494	Rocker Arm Cover
1023A	690910	Rocker Arm Cover (Cylinder #1 Fuel Pump Applications)
1025	690689	Governor Spool
1058	274272	Owner's Manual (Emission Engines)

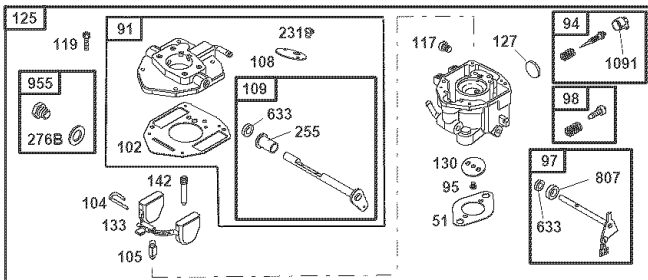

Key No.	Part No.	Description
51	805700	Intake Gasket
91	807919	Upper Carburetor Body Assembly
94	808257	Idle Mixture Kit
95	690718	Screw (Throttle Valve)
97	807720	Throttle Shaft
98	808177	Idle Speed Kit
102	805541	Carburetor Body Gasket
104	690723	Float Hinge Pin
105	805547	Float Needle Valve
108	690719	Choke Valve
109	807722	Choke Shaft
117	806652	Main Jet
119	690720	Screw (Upper to Lower Body)
125	808249	Carburetor
127	690727	Welch Plug
130	690726	Throttle Valve
133	691510	Carburetor Float
142	690725	Carburetor Nozzle
231	690718	Screw (Choke Valve)
255	690721	Choke Shaft Bushing
276B	690724	Sealing Washer
633	690722	Choke Shaft Seal
807	805557	Throttle Spacer
955	807723	Carburetor Plug
1091	691516	Limiter Cap

ENGINE PARTS

CRAFTSMAN 7000 GENERATOR 919.670070

Briggs & Stratton Model No. 294447-1257-E1

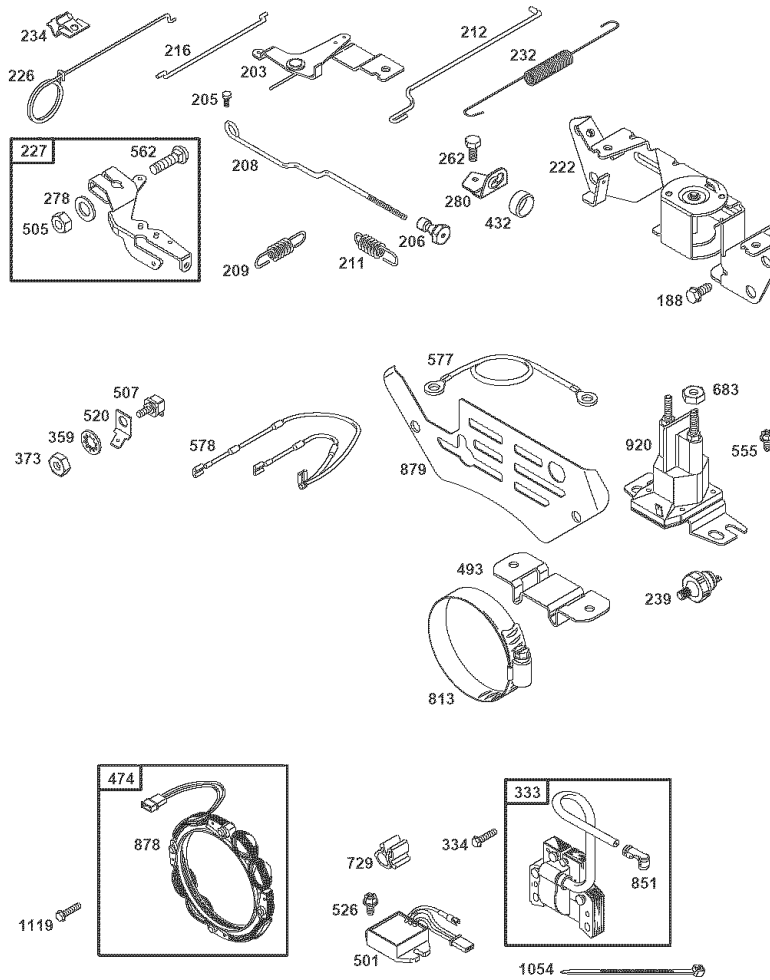

Key No.	Part No.	Description	Key No.	Part No.	Description
188	805025	Screw (Control Bracket)	432	691509	Spring Cap
203	690923	Bell Crank	474	393295	Alternator
205	805762	Screw (Bell Crank)	493	691177	Mounting Bracket
206	691244	Governor Adjusting Nut	501	394890	Regulator
208	691549	Governor Control Rod	505	690238	Nut (Governor Control Lever)
209	691506	Governor Spring	507	398525	Insulator
211	805450	Governor Idle Spring	520	691084	Ground Terminal
212	690712	Throttle Link	526	805448	Screw (Regulator)
216	690705	Choke Link	555	805448	Screw (Starter Solenoid)
222	808454	Control Bracket	562	690239	Bolt (Governor Control Lever)
226	690705	Hand Choke Rod	577	690795	Starter Cable
227	690236	Governor Control Lever	578	493792	Wire Assembly
232	805465	Governor Link Spring	683	92278	Nut (Starter Solenoid)
234	221372	Control Rod Clip	689	691272	Friction Spring
239	491657	Oil Pressure Switch	729	690586	Wire Clip
262	805762	Screw (Rod Bracket)	813	690635	Clamp
278	690237	Washer (Governor Control Lever)	851	493880	Spark Plug Terminal
280	691526	Rod Bracket	878	399916	Alternator Harness
333	492341	Magneto Armature	879	690757	Carburetor Cover
334	805407	Screw (Magneto Armature)	920	807829	Starter Solenoid
359	691077	Washer (Ground Terminal)	1054	280275	Cable Tie
373	90576	Nut (Ground Terminal)	1119	691552	Screw (Alternator)

ENGINE PARTS

CRAFTSMAN 7000 GENERATOR 919.670070

Briggs & Stratton Model No. 294447-1257-E1

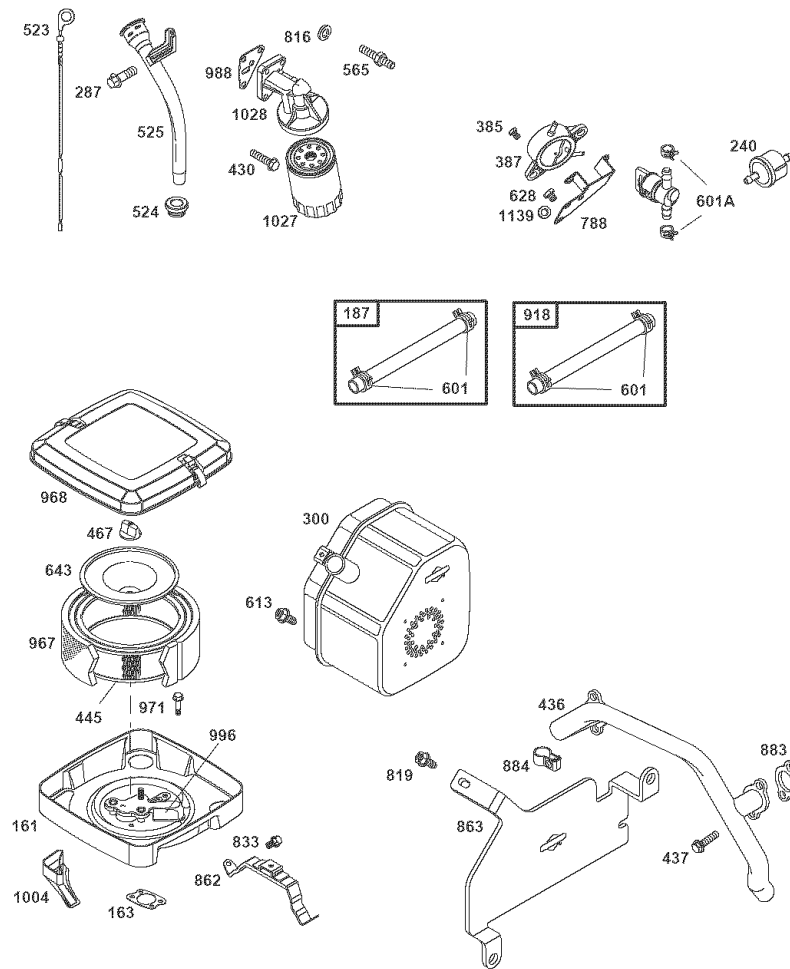

Key No.	Part No.	Description	Key No.	Part No.	Description
161	691561	Air Cleaner Base	643	805631	Air Filter Retainer
163	805655	Air Cleaner Gasket	788	691559	Fuel Pump Bracket
187	298049	Fuel Line	816	690706	Washer (Oil Filter Adapter)
240	493629	Fuel Filter	819	805025	Screw (Muffler Bracket)
287	805177	Screw (Dipstick Tube)	833	692539	Screw (Cleaner Mounting Strap)
300	807948	Exhaust Muffler	862	692153	Cleaner Mounting Strap
385	693169	Screw (Fuel Pump)	863	691513	Muffler Bracket
387	808656	Fuel Pump	883	805024	Exhaust Gasket
430	690679	Bolt (Oil Filter Adapter)	884	690898	Muffler Clamp
436	805142	Exhaust Manifold	918	393815	Vacuum Hose (Rocker Cover to Impulse Pump) (Cut to Length)
437	805158	Screw (Exhaust Manifold)	967	272490	Pre-Cleaner Filter
445	394018	Air Cleaner Cartridge Filter	968	807862	Air Cleaner Cover
467	491875	Air Cleaner Knob	971	692537	Screw (Air Cleaner Base)
523	693175	Dipstick	988	805250	Oil Adapter Gasket
524	693172	Dipstick Tube Seal	996	691577	Carburetor Shield
525	693174	Dipstick Tube	1004	690743	Air Duct
565	690682	Stud (Oil Filter Adapter)	1027	492932	Oil Filter
601	95162	Hose Clamp	1028	808033	Oil Filter Adapter
601A	93807	Hose Clamp	1139	806497	Washer (Fuel Pump Bracket)
613	805448	Screw (Exhaust Muffler)			
628	805247	Screw (Fuel Pump Bracket)			

ENGINE PARTS

CRAFTSMAN 7000 GENERATOR 919.670070

Briggs & Stratton Model No. 294447-1257-E1

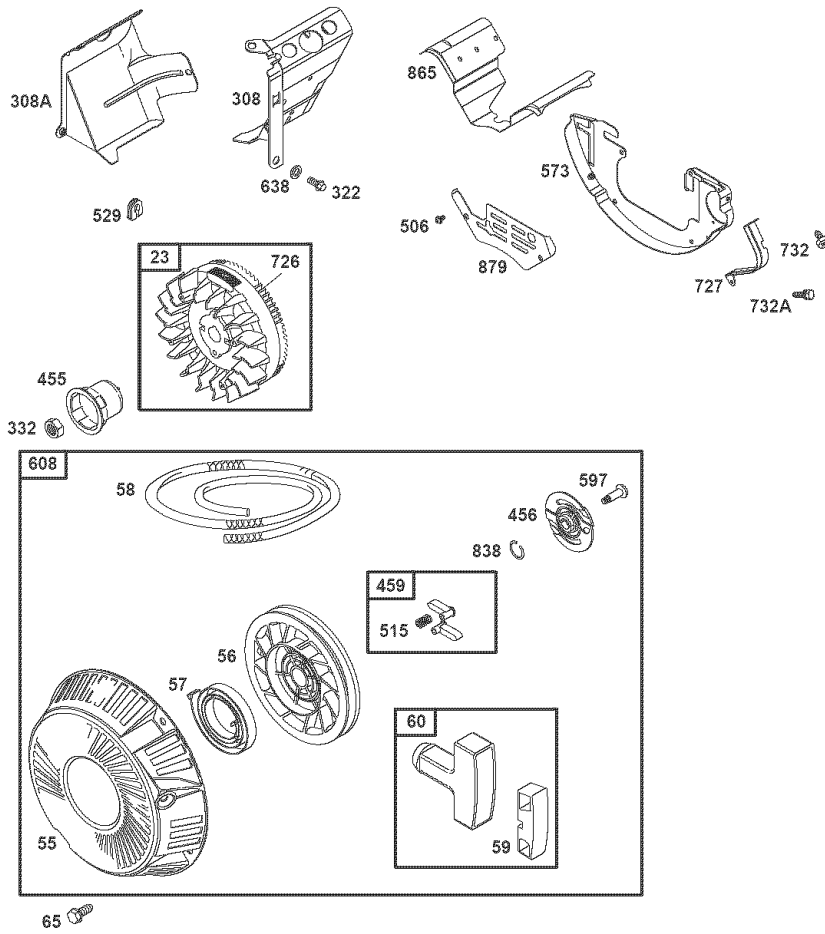

<u>Key No.</u>	<u>Part No.</u>	<u>Description</u>	<u>Key No.</u>	<u>Part No.</u>	<u>Description</u>
23	808766	Flywheel (Steel Ring Gear)	515	691528	Pawl Spring
55	691568	Rewind Starter Housing	529	690744	Grommet
56	805949	Starter Pulley	573	690902	Back Plate
57	805951	Rewind Starter Spring	597	690876	Screw (Pawl Friction Plate)
58	66574	Starter Rope (Cut to Length)	608	808087	Rewind Starter
59	805957	Grip Insert	638	691551	Washer (Cylinder Head Cover)
60	808167	Starter Rope Grip	726	—	Ring Gear (Steel) (Sold in Flywheel Kit Only; See Ref. 23.)
65	805026	Screw (Rewind Starter)	727	690714	Starter Drive Cover
308	806546	Cylinder Head Cover	732	690688	Screw (Starter Drive Cover)
308A	806547	Cylinder Head Cover	732A	692539	Screw (Starter Drive Cover)
322	692539	Screw (Cylinder Head Cover)	838	690875	Rewind Starter Ring
332	690887	Nut (Flywheel)	865	690750	Air Guide Cover
455	691517	Flywheel Cup	879	690757	Carburetor Cover
456	691529	Pawl Friction Plate			
459	808166	Ratchet Pawl			
506	690677	Screw (Carburetor Cover)			

ENGINE PARTS

CRAFTSMAN 7000 GENERATOR 919.670070

Briggs & Stratton Model No. 294447-1257-E1

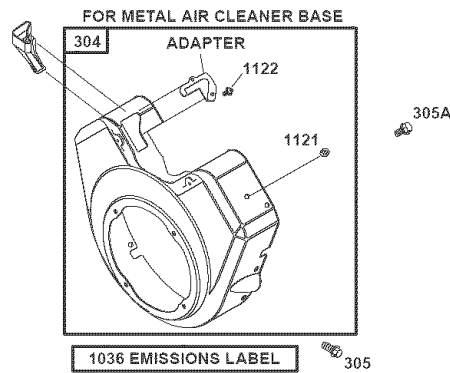
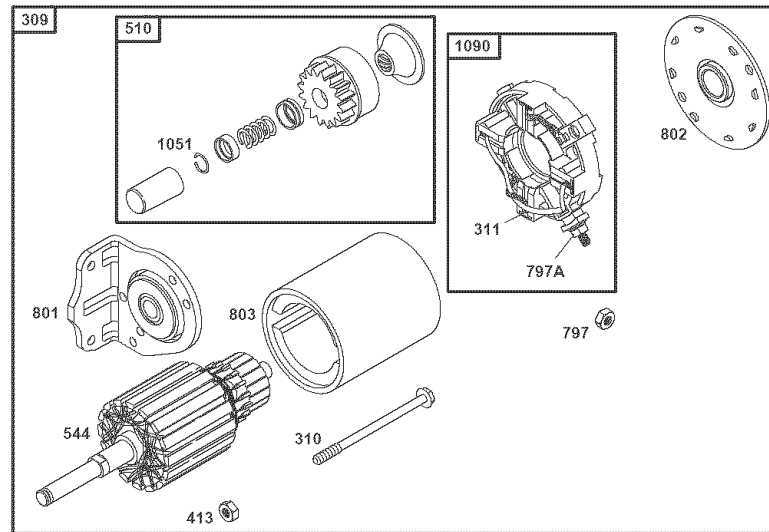

<u>Key No.</u>	<u>Part No.</u>	<u>Description</u>	<u>Key No.</u>	<u>Part No.</u>	<u>Description</u>
304	808055	Blower Housing	797A	693167	Nut (Brush Retainer)
305	692539	Screw (Blower Housing)	801	808777	Drive Cap
305A	805247	Screw (Blower Housing)	802	497607	End Cap
309	691564	Starter Motor	803	693547	Starter Housing
310	690323	Bolt (Starter Motor)	1036	806687	Emissions Label
311	497608	Brush Set	1051	691124	Retaining Ring
413	693587	Nut (Starter Motor)	1090	497605	Brush Retainer
510	496881	Starter Drive	1121	810056	Nut (Fuel Pump Bracket)
544	693548	Starter Armature	1122	93410	Screw
697	805247	Screw (Drive Cap)			(Blower Housing Adapter)
797	92278	Nut (Brush Retainer)			

ENGINE PARTS

CRAFTSMAN 7000 GENERATOR 919.670070

Briggs & Stratton Model No. 294447-1257-E1

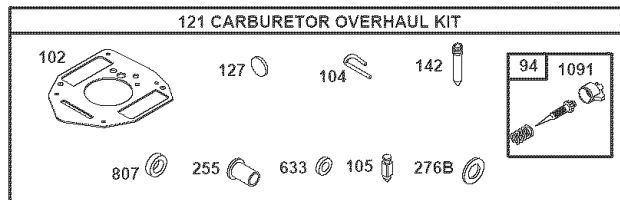
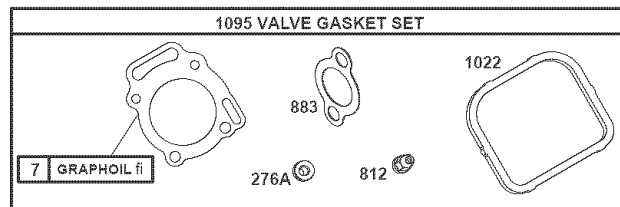
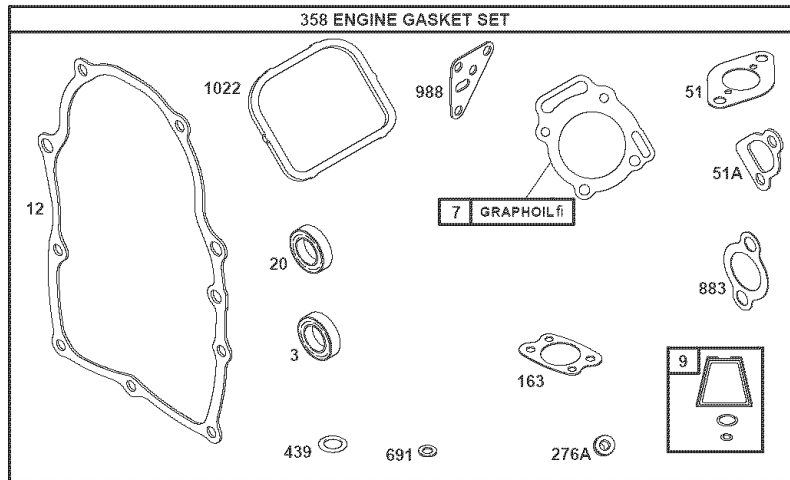

<u>Key No.</u>	<u>Part No.</u>	<u>Description</u>	<u>Key No.</u>	<u>Part No.</u>	<u>Description</u>
3	805101	Oil Seal (Magneto Side)	255	690721	Choke Shaft Bushing
7	806085	Cylinder Head Gasket	276A	805420	Sealing Washer
9	807688	Breather Gasket	276B	690724	Sealing Washer
12	806190	Crankcase Gasket	358	808390	Engine Gasket Set
20	805049	Oil Seal (PTO Side)	439	692154	O-Ring Seal (Crankcase Cover/ Sump)
51	805700	Intake Gasket	633	690722	Choke Shaft Seal
51A	805023	Intake Gasket	691	690680	Governor Shaft Seal
94	808257	Idle Mixture Kit	807	805557	Throttle Spacer
102	805541	Carburetor Body Gasket	812	805019	Nut (Rocker Arm Cover)
104	690723	Float Hinge Pin	883	805024	Exhaust Gasket
105	805547	Float Needle Valve	988	805250	Oil Adapter Gasket
121	807850	Carburetor Overhaul Kit	1022	806039	Rocker Arm Gasket
127	690727	Welch Plug	1091	691516	Limiter Cap
142	690725	Carburetor Nozzle	1095	808382	Valve Gasket Set
163	805655	Air Cleaner Gasket			

NOTES

NOTES

NOTES

Dear Customer,

In manufacturing this product, many steps have been taken to provide you with the highest quality. Unfortunately, errors or omissions occasionally occur. In the event that you find a missing or defective part, please contact your nearest Sears store.

SERVICE AND REPAIR PARTS
CALL 1-800-665-4455 *

Keep this number handy should you require a service call or need to order repair parts.

If ordering parts make sure you have the name, make and model no. of the merchandise and the name and number of the part you wish to order.

* If calling locally, please use one of the following numbers:

Regina - 566-5124	Montreal - 333-5740
Toronto - 744-4900	Halifax - 454-2444
Kitchener - 894-7590	Ottawa - 738-4440
Vancouver - 420-8211	

If you have any suggestions that would help us to improve our assembly/operation instructions, or this product, please write them down and mail it to:

Sears Canada Inc.
222 Jarvis Street
Toronto, Ontario
M5B 2B8

Attention: Buyer Dept: D671

Model No. _____

NAME _____

ADDRESS _____

POSTAL CODE _____ PHONE # _____

COMMENTS
