



## STAND ASSEMBLY INSTRUCTIONS FOR BAND SAW 21460 AND SCROLL SAW 22436

### UNPACKING

- Check for completeness. Locate all parts before attempting assembly (see Figure 1).

**NOTE:** Hardware to mount tools to stand is not included.

**CAUTION:** Do not attempt assembly if parts are missing. Follow assembly instructions. Use parts list to order replacement parts.

- A Long Upper Cross Brace (2 each)
- B Short Upper Cross Brace (2 each)
- C Long Lower Cross Brace (2 each)
- D Short Lower Cross Brace (2 each)
- E Leg (4 each)
- F Top (2 each)

Hardware Bag (not shown)

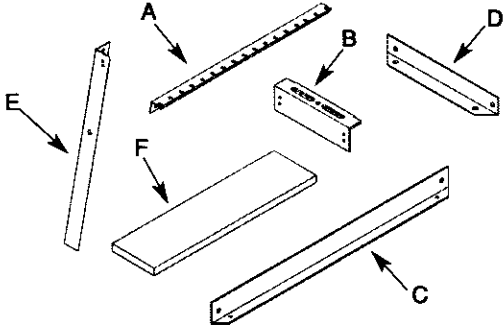

Figure 1 – Unpacking

### ASSEMBLY

Tools required: Phillips screwdriver, adjustable wrench and portable drill.

### ASSEMBLE FRAME

**NOTE:** Finger tighten fasteners until all metal components are assembled. Then tighten all fasteners securely.

**NOTE:** Use pan head screws and lock nuts. (Figure 7, Key Nos. 8 and 9) to assemble all components except the top and leveling pad.

- Assemble a long upper cross brace (A) and a long lower cross brace (C) to the two legs (E). The braces are assembled to the **INSIDE** of the legs (see Figure 2).
- Repeat for the other two legs and long cross braces.

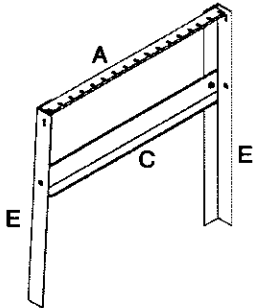

Figure 2 – Assemble Leg Set

- Connect each leg set by attaching the two short upper cross braces (B) and the two short lower cross braces (D) (see Figure 3).

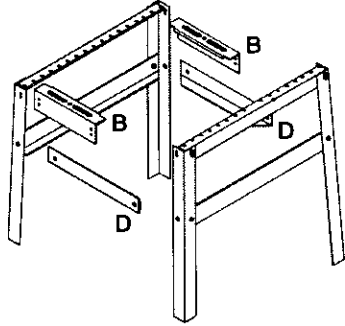

Figure 3 – Connect Leg Sets

- Tighten all fasteners completely.

### ASSEMBLE LEVELING FOOTPAD

- Insert pad onto countersink screw (see Figure 4).
- Thread nut onto screw. Insert screw into and through footpad.
- Place washer on screw. Thread second nut onto screw.

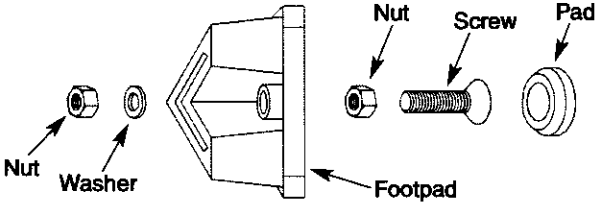

Figure 4 – Assemble Leveling Footpad

### ATTACH FOOTPADS

- Slide one footpad onto the bottom of each leg. (One footpad will include leveling device). Align corner of footpad to corner of leg and press footpad onto leg.

### ASSEMBLE TOP

- Location of pre-drilled holes used in attaching the top to the frame are indicated in Figure 5.

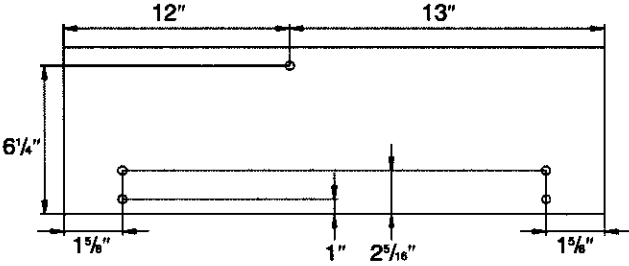

Figure 5 – Top Hole Pattern

- Place the boards together and then place the assembled frame on the boards. Attach frame to boards using wood screws and washers through the slots in the frame (see Figure 6).

**NOTE:** The center screw requires one washer under the screw head and one additional washer between the frame and board.

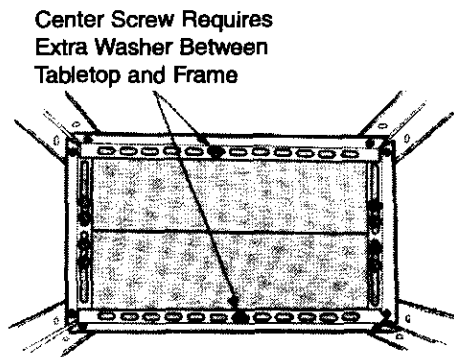

Figure 6 – Attaching the Top

**IMPORTANT:** For scroll saw 22436, the two rear and one of the front mounting bolts will need to be located through the slots in the frame. Carefully drill the two holes shown in Figure 7 and then place saw on stand, mark location of the other two holes, then drill holes.

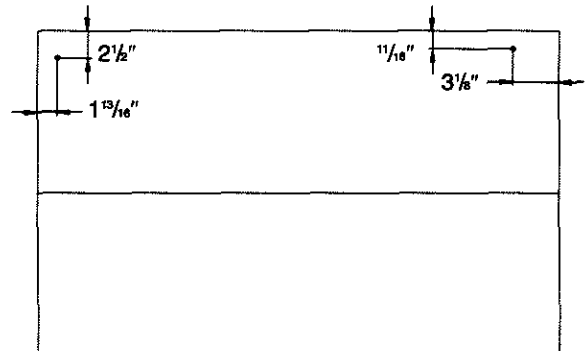

Figure 7 – Drill Mounting Holes for Scroll Saw

## REPLACEMENT PARTS LIST FOR STAND

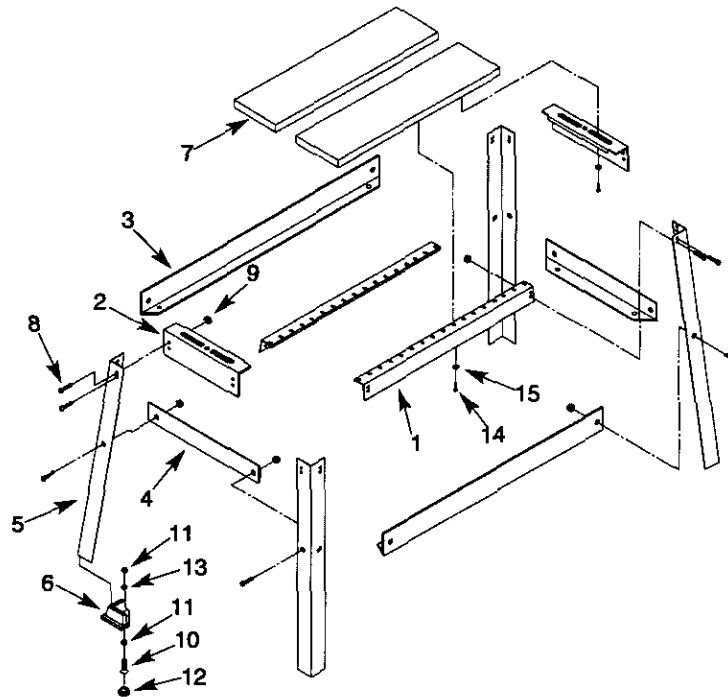

Figure 8 – Parts Illustration for Stand

KEY NO.	PART NO.	DESCRIPTION	QTY.
1	117 020 231	Long Upper Cross Brace	2
2	117 020 232	Short Upper Cross Brace	2
3	117 020 234	Long Lower Cross Brace	2
4	117 020 235	Short Lower Cross Brace	2
5	117 020 233	Leg	4
6	116 620 267	Footpad	4
7	117 900 073	Tabletop	2
8	116 710 117	Pan Head Screw (M6x10)	24

KEY NO.	PART NO.	DESCRIPTION	QTY.
9	116 710 020	Nut, Self-locking (M6)	24
10	116 710 003	Countersink Screw (M8x40)	1
11	116 700 021	Nut (M8)	2
12	116 620 268	Pad	1
13	116 700 027	Washer (8.4)	1
14	116 700 089	Pan Head Wood Screw (M6x16)	10
15	116 720 077	Washer (6.4)	12
Δ	119 900 873	Hardware Bag	1

Δ Not Shown