

ASSEMBLY GUIDE

RB1

Parts

- 1 Rear Foot Tube
- 2 Handlebar Set
- 1 Seat Post
- 1 Seat
- 1 Console Mast
- 1 Console Mast Boot
- 2 Mobile Wheels
- 1 Console
- 1 Power Supply
- 2 Pedals
- 2 Wheel Sleeves
- 2 Handlebar Links
- 1 Hardware Pack (contents listed below)

Tools (included)

- 5mm Allen Wrench/Phillips Screw Driver
- Flat Wrench

H A R D W A R E

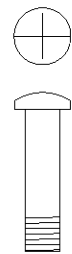

A) 20mm Bolt
Quantity: 2

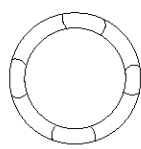

B) 21mm Wavy Washer
Quantity: 2

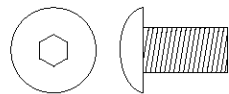

C) 15mm Bolt
Quantity: 4



E) 13mm Arc Washer (Pre-Attached)
Quantity: 2

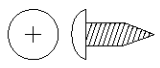

D) 12mm Screw
Quantity: 2

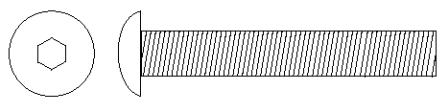

F) 90mm Bolt
Quantity: 2

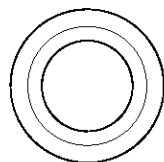

H) Pedal Spacer (Inner) (Pre-Attached)
Quantity: 2

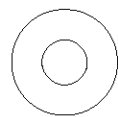

G) 14mm Washer
Quantity: 2

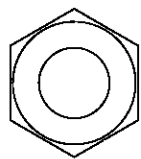

I) Acorn Nut
Quantity: 2

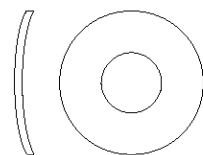

J) 20mm Arc Washer
Quantity: 4

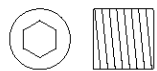

K) 8mm Screw
Quantity: 8

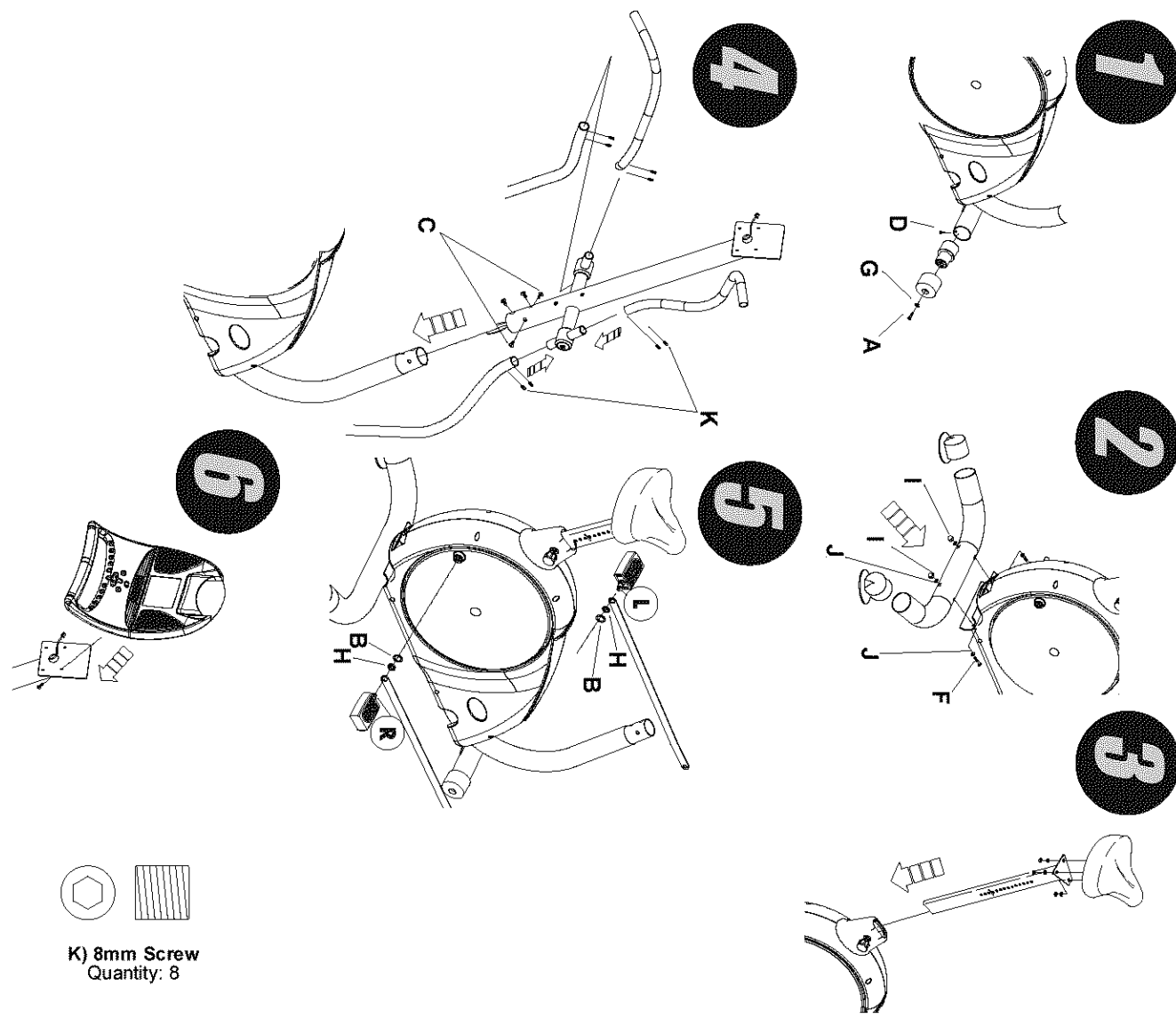

U N P A C K I N G
Unpack the product where you will be using it. Place the product on a level flat surface. It is recommended that you place a protective covering on your floor. **NOTE:** It is recommended that you apply grease to the threads of each bolt as you assemble the product, to prevent loosening and noise. Also, during each assembly step, ensure that ALL nuts and bolts are in place and partially threaded in before completely tightening any ONE bolt.

CORE FITNESS SYSTEM

