

Micro Hi-Fi System

MC-M570



Need help? Call us!

Philips representatives are ready to help you with any questions about your new product. We can guide you through Connections, First-time Setup, or any of the Features. We want you to start enjoying your new product right away!

**CALL US BEFORE YOU CONSIDER
RETURNING THE PRODUCT!**

1-800-531-0039

or

Visit us on the web at www.philips.com



visit our website

www.audio.philips.com

to download latest UPDATES of USB PC Link Driver
MusicMatch Jukebox softwares and FAQs.



PHILIPS

3139 115 22181

Canada

English:

This digital apparatus does not exceed the Class B limits for radio noise emissions from digital apparatus as set out in the Radio Interference Regulations of the Canadian Department of Communications.

Français:

Cet appareil numérique n'émet pas de bruits radioélectriques dépassant les limites applicables aux appareils numériques de Class B prescrites dans le Règlement sur le Brouillage Radioélectrique édicté par le Ministère des Communications du Canada.

This warning label is located on the rearside and inside this laser product.

CAUTION INVISIBLE LASER RADIATION WHEN OPEN. DO NOT STARE INTO BEAM.
DANGER INVISIBLE LASER RADIATION WHEN OPEN. AVOID DIRECT EXPOSURE TO BEAM.
VARO! AVATTAESSA JA SUOJALUKITUS OHITETTAESSA OLET ALTTIINÄÄNÄKYMÄTTÖMÄLLE LASERSÄTEILYLLE. ÄLÄ KATSO SATEESEEN.
VARNING! OSYNLIG LASERSTRÅLNING NÄR DENNA DEL ÄR ÖPPNAD. OCH STÄRNEN ÄR URSÄFFLAD. BETRÄKTA EJ STRÅLEN.

or

DANGER - Invisible laser radiation when open. AVOID DIRECT EXPOSURE TO BEAM.

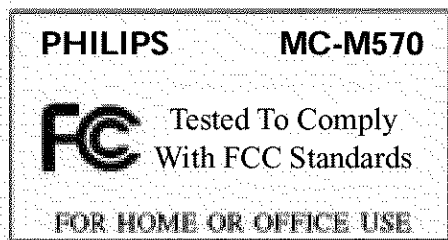

Philips Consumer Electronics North America
P.O.Box 14810 Knoxville, TN 37914-1810
Phone no.: 1-800-531-0039

CAUTION

Use of controls or adjustments or performance of procedures other than herein may result in hazardous radiation exposure or other unsafe operation.

ATTENTION

L'utilisation des commandes ou réglages ou le non-respect des procédures ci-incluses peuvent se traduire par une exposition dangereuse à l'irradiation.

ATENCIÓN

El uso de mando o ajustes o la ejecución de métodos que no sean los aquí descritos puede ocasionar peligro de exposición a radiación.

Energy Star

As an ENERGY STAR®

Partner, Philips has determined

that this product meets the

ENERGY STAR® guidelines for energy efficiency.



This system complies with the FCC rules, Part 15 and with 21 CFR 1040.10. Operation is subject to the following two conditions:

- This device may not cause harmful interference, and*
- This device must accept any interference received, including interference that may cause undesired operation.*

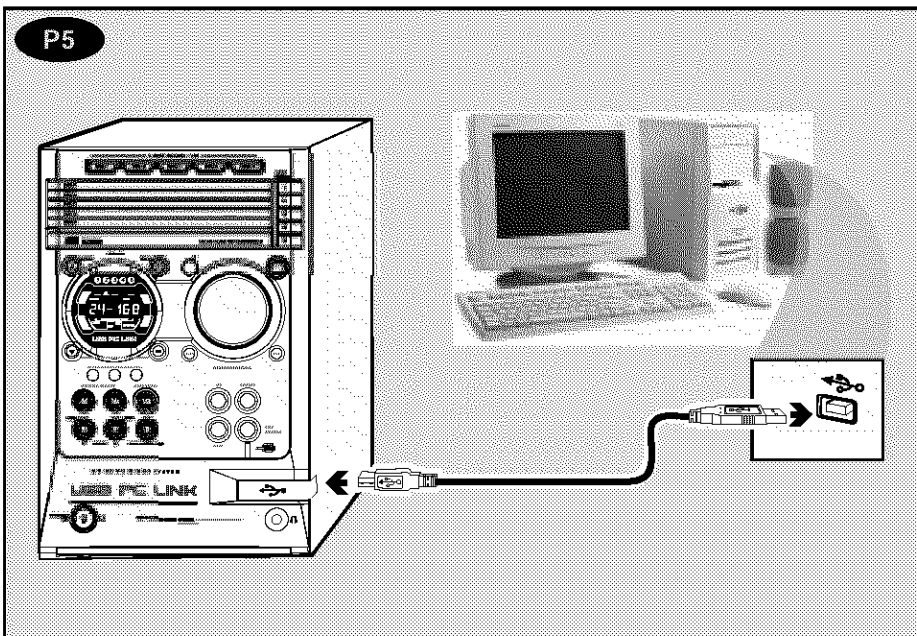
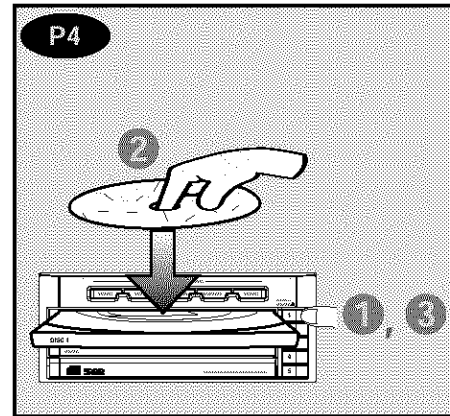
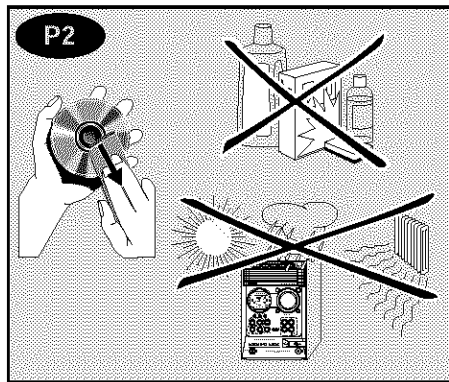
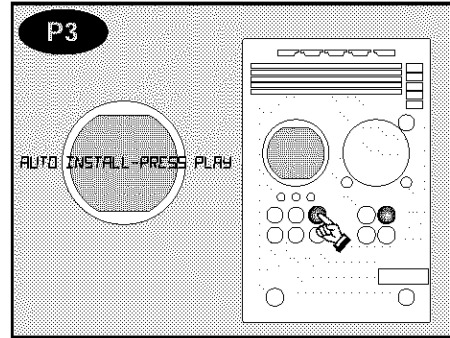
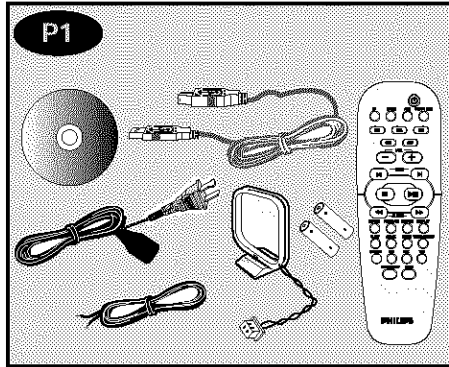

Return your Warranty Registration card today to ensure you receive all the benefits you're entitled to.

- Once your Philips purchase is registered, you're eligible to receive all the privileges of owning a Philips product.
- So complete and return the Warranty Registration Card enclosed with your purchase at once, and take advantage of these important benefits.

Warranty Verification

Registering your product within 10 days confirms your right to maximum protection under the terms and conditions of your Philips warranty.

Owner Confirmation

Your completed Warranty Registration Card serves as verification of ownership in the event of product theft or loss.

Model Registration

Returning your Warranty Registration Card right away guarantees you'll receive all the information and special offers which you qualify for as the owner of your model.

Know these *safety* symbols



t This "bolt of lightning" indicates uninsulated material within your unit may cause an electrical shock. For the safety of everyone in your household, please do not remove product covering.

S The "exclamation point" calls attention to features for which you should read the enclosed literature closely to prevent operating and maintenance problems.

For Customer Use

Enter below the Serial No. which is located on the rear of the cabinet. Retain this information for future reference.

Model No. _____

Serial No. _____

WARNING: TO PREVENT FIRE OR SHOCK HAZARD, DO NOT EXPOSE THIS EQUIPMENT TO RAIN OR MOISTURE.

CAUTION: To prevent electric shock, match wide blade of plug to wide slot, and fully insert.

MAC5097



PHILIPS Visit our World Wide Web Site at <http://www.philips.com>

PHILIPS



***Congratulations on your purchase,
and welcome to the "family!"***

Dear Philips product owner:

Thank you for your confidence in Philips. You've selected one of the best-built, best-backed products available today. And we'll do everything in our power to keep you happy with your purchase for many years to come.

As a member of the Philips "family," you're entitled to protection by one of the most comprehensive warranties and outstanding service networks in the industry.

What's more, your purchase guarantees you'll receive all the information and special offers for which you qualify, plus easy access to accessories from our convenient home shopping network.

And most importantly you can count on our uncompromising commitment to your total satisfaction.

All of this is our way of saying welcome – and thanks for investing in a Philips product.

Sincerely,

Lawrence J. Blanford
President and Chief Executive Officer

P.S. Remember, to get the most from your Philips product, you must return your Warranty Registration Card within 10 days. So please mail it to us right now!

IMPORTANT SAFETY INSTRUCTIONS

1. Read these instructions.

2. Keep these instructions.

3. Heed all warnings.

4. Follow all instructions.

5. Do not use this apparatus near water.

6. Clean only with dry cloth.

7. Do not block any ventilation openings. Install in accordance with the manufacturer's instructions.

8. Do not install near any heat sources such as radiators, heat registers, stoves, or other apparatus (including amplifiers) that produce heat.

9. Do not defeat the safety purpose of the polarized or grounding-type plug.

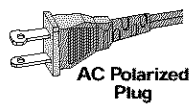

A polarized plug has two blades with one wider than the other. A grounding type plug has two blades and a third grounding prong. The wide blade or the third prong are provided for your safety. If the provided plug does not fit into your outlet, consult an electrician for replacement of the obsolete outlet.

10. Protect the power cord from being walked on or pinched, particularly at plugs, convenience receptacles, and the point where they exit from the apparatus.

11. Only use attachments/accessories specified by the manufacturer:

12.  Use only with the cart, stand, tripod, bracket, or table specified by the manufacturer or sold with the apparatus. When a cart is used, use caution when moving the cart/apparatus combination to avoid injury from tip-over.

13. Unplug this apparatus during lightning storms or when unused for long periods of time.

14. Refer all servicing to qualified service personnel. Servicing is required when the apparatus has been damaged in any way, such as power-supply cord or plug is damaged, liquid has been spilled or objects have fallen into the apparatus, the apparatus has been exposed to rain or moisture, does not operate normally, or has been dropped.

15. Battery usage **CAUTION** – To prevent battery leakage which may result in bodily injury, property damage, or damage to the unit:

- Install **all** batteries correctly, + and - as marked on the unit.
- Do not mix batteries (**old** and **new** or **carbon** and **alkaline**, etc.).
- Remove batteries when the unit is not used for a long time.

EL 6475-E004: 02/8

Class II equipment symbol



This symbol indicates that the unit has a double insulation system

Index

English 8

Français 30

Español 53

English

Français

Español

Contents

General Information

Supplied accessories	9
Environmental information	9
Care and safety information	9

Functional Overview

Main unit and remote control	10–11
Control buttons available on the remote only	11

Connections

Step 1: Connecting FM/AM antennas	12
Step 2: Connecting the speakers	13
Step 3: Connecting to PC	13
Step 4: Connecting the AC power cord	13
Step 5: Inserting batteries into the remote control	13
Using the remote control to operate the system	13

USB PC Link

Quick Setup Guide	14
PC system requirement	14
Install MusicMatch software	14
Enable digital CD audio output	15
Connecting USB PC Link	15

Basic Operations

Switching on/off	16
Switching to active mode	16
Switching to Eco Power standby mode	16
Switching to standby mode (view clock)	16
Demonstration mode	16
Setting the clock	16
Selecting different display mode	17
Dim mode	17
Clock display mode	17
Volume control	17
Sound control	17
MAX sound	17
Digital Sound Control	17
Virtual Environment Control	17

Disc Operations

Playable discs	18
Loading discs	18
Basic playback controls	18
Playing an MP3 disc	19
Repeat and Shuffle	19
Repeat play	19
Random play	19
Programming the disc tracks	20
Checking the program	20
Clearing the program	20

Tuner Operations

Tuning to radio stations	21
Presetting radio stations	21
Using the Plug and Play	21
Automatic presetting	21
Manual presetting	21
Selecting a preset radio station	21
Deleting a preset radio station	21

Timer Operations

Timer setting	22
Activating/Deactivating the timer	22
Checking the timer setting	22
Temporarily deactivating the wake up timer	23
Sleep timer setting	23

Other Connection

Listening to an external source	23
---------------------------------------	----

Specifications

Troubleshooting

Limited Warranty

General Information

Refer to the type plate on the rear or bottom of the system for identification and supply ratings.

Supplied accessories (page 3 - P1)

- USB PC LINK software installer CD-ROM
- USB cable
- Remote control and two AA batteries.
- AM loop antenna
- FM wire antenna
- AC power cord

Environmental information

All unnecessary packaging has been omitted. We have tried to make the packaging easy to separate into three materials: cardboard (box), polystyrene foam (buffer) and polyethylene (bags, protective foam sheet).

Your system consists of materials which can be recycled and reused if disassembled by a specialized company. Please observe the local regulations regarding the disposal of packaging materials, exhausted batteries and old equipment.

Care and safety information

(page 3 - P2)

Avoid high temperatures, moisture, water and dust

- Do not expose the system, batteries or discs to humidity, rain, sand or excessive heat (caused by heating equipment or direct sunlight). Always keep the disc tray closed to avoid dust on the lens.

Avoid condensation problem

- The lens may cloud over when the system is suddenly moved from cold to warm surroundings, making it impossible to play a disc. Leave the system in the warm environment until the moisture evaporates.

Do not block the vents

- In a cabinet, allow about 10cm (4 inches) of free space all around the system for adequate ventilation.

Care of disc

- To clean a CD, wipe it in a straight line from the center towards the edge using a soft, lint-free cloth. A cleaning agent may damage the disc!
- Write only on the printed side of a CDR(W) and only with a soft felt-tipped pen.
- Handle the disc by its edge, do not touch the surface.

Care of the cabinet

- Use a soft cloth slightly moistened with a mild detergent solution. Do not use a solution containing alcohol, spirits, ammonia or abrasives.

Finding a suitable location

- Place the system on a flat, hard, and stable surface.

Built-in safety circuit

- Under extreme conditions, this system may switch to standby mode automatically. If this happens, let the system cool down before reusing it.

Power saving

- This system is designed to use less than 1W of electricity when switches to Eco Power standby. Disconnect the AC power cord from the power outlet when not in use.

Functional Overview

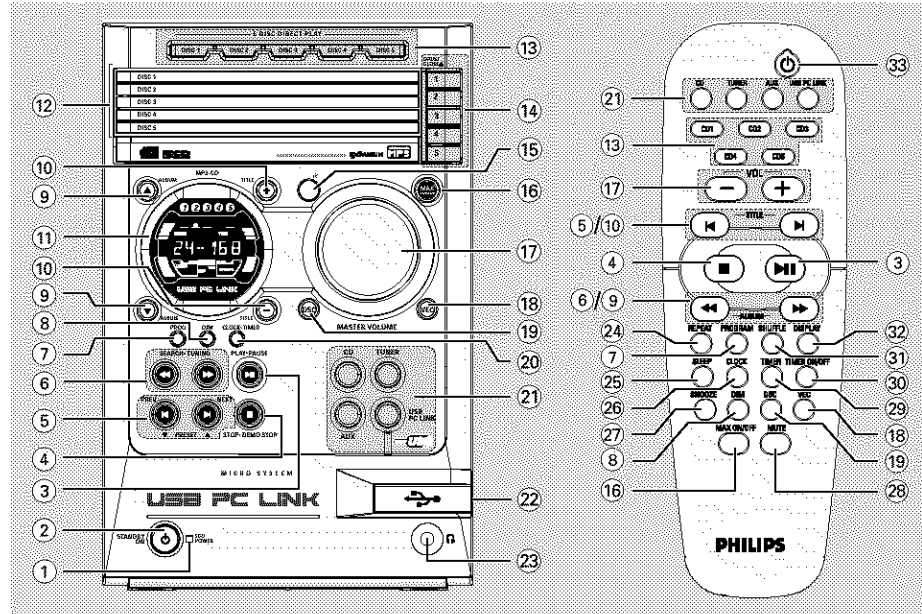

Main unit and remote control

① ECO POWER indicator

- Lights up when the system is in Eco Power standby mode.

② STANDBY ON

- Switches to Eco Power standby mode or turns on the system.
- *Switches to standby mode.

③ PLAY•PAUSE

- CD: starts/pauses playback.
- USB PC LINK: starts/pauses playback.
- (only on the main unit)*
- TUNER: *enters Plug & Play mode and/or starts preset radio station installation.

④ STOP•DEMO STOP

- Exits an operation.
- CD: stops playback or clears a program.
- TUNER: *erases a preset radio station.
- USB PC LINK: stops playback.
- (only on the main unit)*
- *Turns on/off the demonstration mode.

⑤ PREV / NEXT (▼ PRESET ▲)

- CD: selects a track.
- TUNER: selects a preset radio station.
- CLOCK: sets the minutes.
- USB PC LINK: selects a track from the playlist.

⑥

- CD: *searches backward/forward or selects an album from MP3 disc.
- TUNER: tunes the radio frequency up/down.
- CLOCK: sets the hours.
- USB PC LINK: *searches backward/forward.

⑦ PROG (PROGRAM)

- CD: starts or confirms tracks programming.
- TUNER: starts *automatic/manual preset programming.
- CLOCK: selects 12- or 24-hour clock display.

⑧ DIM

- Selects different levels of brightness for display panel.

⑨ ALBUM ▼ ▲ (◀▶)

- Selects an MP3 album.

* = Press and hold the button for more than two seconds.

Functional Overview

⑩ **TITLE + - (◀ ▶)**

- Selects an MP3 title/track.

⑪ **Display screen**

⑫ **Disc trays (1~5)**

⑬ **5 DISC DIRECT PLAY 1~5 (CD 1~5)**

- Selects a disc tray to playback.

⑭ **OPEN/CLOSE ▲ 1~5**

- Opens/closes the individual disc tray.

⑮ **iR**

- Point the remote control towards this sensor.

⑯ **MAX SOUND (MAX ON/OFF)**

- Turns on/off the optimal mix of various sound features.

⑰ **MASTER VOLUME (VOL + -)**

- Adjusts the volume level.

⑱ **VEC**

- Selects different type of environment-based equalizer settings (HALL, CINEMA, CONCERT or CYBER).

⑲ **DSC**

- Selects different type of preset sound equalizer settings (OPTIMAL, JAZZ, ROCK or POP).

⑳ **CLOCK•TIMER**

- *Enters clock or timer setting mode.
- Switches to clock display mode.

㉑ **CD / TUNER / AUX / USB PC LINK**

- Selects the relevant active mode.
- **CD:** toggles between DISC 1~5.
- **TUNER:** toggles between FM and AM band.
- **AUX:** toggles between AUX and CDR mode.

- ㉒ Connect the USB cable between the system and PC's USB port.

㉓ 

- Plug in the headphones jack. The speakers output will be cancelled.

Control buttons available on the remote only

㉔ **REPEAT**

- Repeats a track/disc/all programmed tracks.

㉕ **SLEEP**

- Selects a preset turn-off timer option.

㉖ **CLOCK**

- *Enters clock setting mode.
- Switches to clock display mode.

㉗ **SNOOZE**

- Temporarily deactivate the wake up timer.

㉘ **MUTE**

- Mutes or restores the volume.

㉙ **TIMER**

- *Enters timer setting mode.
- Displays the timer setting.

㉚ **TIMER ON/OFF**

- Turns on/off timer function.

㉛ **SHUFFLE**

- Turns on/off random play mode.

㉜ **DISPLAY**

- Displays the album and title name for MP3 disc.

㉝ 

- Switches to Eco Power standby mode.
- *Switches to standby mode.

* = Press and hold the button for more than two seconds.

Connections

English

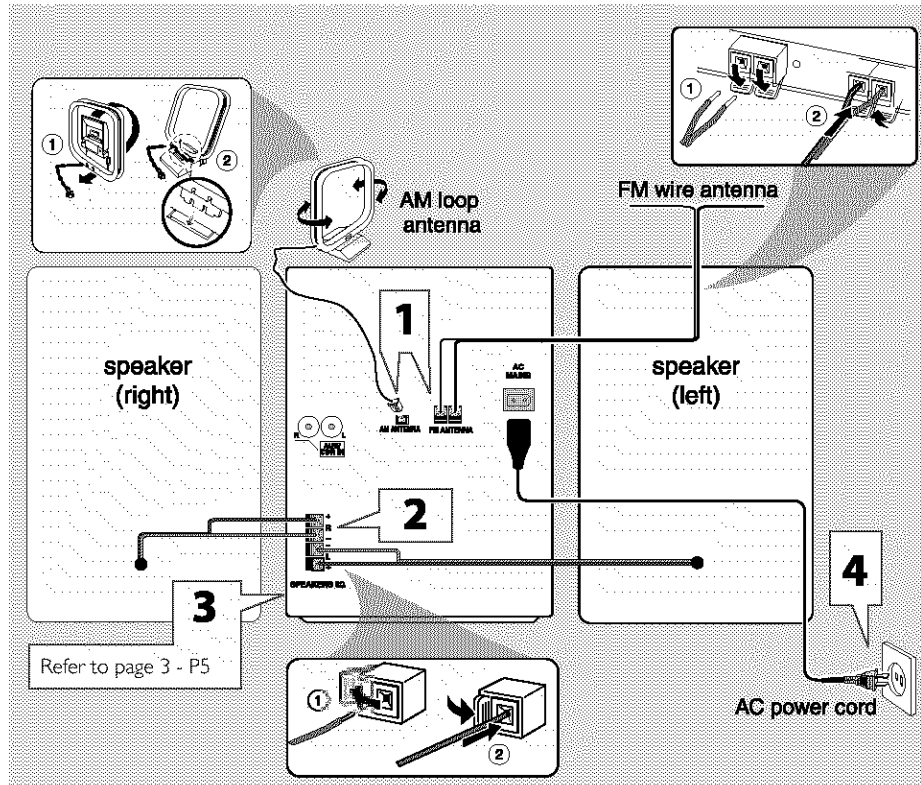

WARNING!

- Use only the supplied speakers. The combination of the main unit and speakers provide the best sound. Using other speakers can damage the unit and sound quality will be negatively affected.
- Never make or change connections with the power switched on.
- Connect the AC power cord to the power outlet only after you have finished hooking up everything.

Step 1: Connecting FM/AM antennas

- Place the AM loop antenna on a shelf or attach it to a stand or wall.
- Extend the FM antenna and fix its ends to the wall.
- Adjust the position of the antennas for optimal reception.
- Position the antennas as far as possible from a TV, VCR or other radiation source to prevent unwanted noise.
- For better FM stereo reception, connect external FM antenna.

Connections

Step 2: Connecting the speakers

Connect the speaker wires to the SPEAKERS terminals, right speaker to "R" and left speaker to "L", colored (marked) wire to "+" and black (unmarked) wire to "-". Fully insert the stripped portion of the speaker wire into the terminal as shown.

Notes:

- Ensure that the speaker cables are correctly connected. Improper connections may damage the system due to short-circuit.
- Do not connect more than one speaker to any one pair of + / - speaker terminals.

Step 3: Connecting to PC (page 3 - P5)

Use the supplied USB cable to connect the system to your personal computer's USB port. You are able to playback your music collection via the system after installing the USB PC LINK application software onto your PC (refer to "USB PC Link").

Step 4: Connecting the AC power cord

"AUTO INSTALL - PRESS PLAY" may appear on the display panel when the AC power cord is plugged into the power outlet for the first time. Press ►|| on the main unit to store all available radio stations (page 3 - P3) or press ■ to exit (refer to "Tuner Operations").

Step 5: Inserting batteries into the remote control

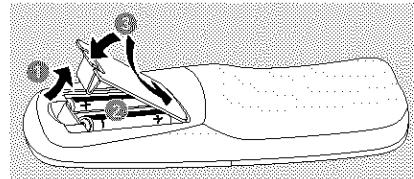

- 1 Open the battery compartment cover.
- 2 Insert two batteries type R06 or AA, matching the markings (+ -) inside the compartment.
- 3 Close the cover.

Using the remote control to operate the system

- 1 Aim the remote control directly at the remote sensor (iR) on the main unit.
- 2 Select the source you wish to control by pressing one of the source select keys on the remote control (for example CD, TUNER).
- 3 Then select the desired function (for example ►||, ◀, ▶).

CAUTION!

- Remove batteries if they are exhausted or will not be used for a long time.
- Do not use old and new or different types of batteries in combination.
- Batteries contain chemical substances, so they should be disposed of properly.

USB PC Link

Quick Setup Guide

PC system requirement

- Windows 98/ ME/ 2000/ XP
- Intel Pentium MMXX200 or higher
- CD-ROM drive
- USB port
- Free hard disk space : 15 MB for the software

Install MusicMatch software

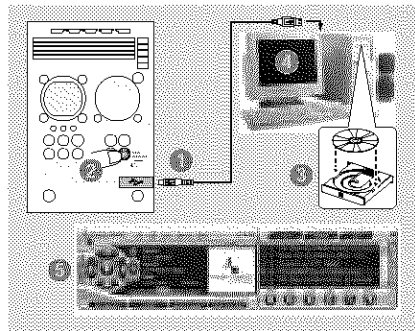

- 1 Use the supplied USB cable to connect the audio system to your personal computer's USB port.
- 2 Press **USB PC LINK**.
- 3 Turn on the PC and insert the USB PC LINK installer disc (which comes with this product) onto the PC's CD-ROM drive.
This application software can also be downloaded from "<http://www.audio.philips.com>".

IMPORTANT!

Please use this customized MusicMatch software for your USB PC Link application. Remember to un-install all other MusicMatch jukebox software first from your PC system (if available).

- 4 The installation guide will appear automatically. If it does not, go to the CD-ROM drive in Windows Explorer and double click on the "USBPCLINK.exe". Then perform the following steps:
 - First, select your desired language from the list.
 - Then, select "installer driver" and follow by "installer MusicMatch jukebox".
 - Select other options (Tutorial, Free goodies, FAQ).

Note:

- You are advised to read the MusicMatch tutorial before using it for the first time. Make sure the mute function on the PC is deactivated in order to ensure sound output from the Audio System. For optimum performance, the equalizer function in MusicMatch should be set to a low level.

- 5 Launch the "MUSICMATCH JUKEBOX" and choose to do one of the followings :

To create a "Playlist"

Select "Open" button on the MusicMatch Jukebox and simply drag/drop the music tracks from anywhere on your PC into the "Playlist" window. Remember to save this "Playlist" for future use.

To create a music library

A music library of all stored music files available on your PC can be setup by simply select "add" function on the MusicMatch Jukebox. Once created, you may then choose to drag/drop any music tracks from this library to a "Playlist" for music playback.

Note:

- It is not possible to create a playlist from the system's 5 CD changer. If you encounter problem using USB PC LINK, please refer to the FAQ (Frequently Asked Questions) stored in your USB PC LINK installer disc or visit "www.audio.philips.com" for latest update on FAQ.

Enable digital CD audio output

Before playing the CD through your PC's CD-ROM drive, it is necessary to configure your PC's hardware as follows:

For Windows ME/ 2000/ XP

- 1 Enter the system control panel menu and select:
"SYSTEM → HARDWARE →
DEVICE MANAGER → CD-ROM DRIVES →
ACTION-PROPERTIES → PROPERTIES".

OR

For Windows 98

Enter the system control panel menu and select: "MULTIMEDIA" and "CD MUSIC".

- 2 Check the 'Enable digital CD audio for this CD-ROM device' setting option is selected (enabled).

Note:

– You may need to refer to your PC's manual for correct configuration.

Connecting to USB PC Link

USB PC LINK allows you to playback your music collection from the PC via the powerful amplifier and speakers of this system.

IMPORTANT!

Make sure the MusicMatch software has been installed. Refer to "Quick Setup Guide" for USB PC Link.

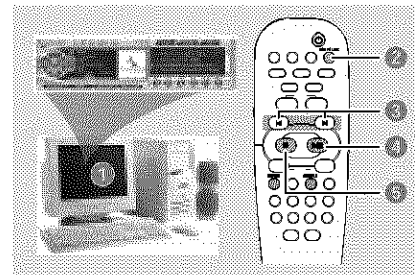

- 1 Turn on your computer and launch the "MUSICMATCH JUKEBOX".
→ The volume level of PC should not be put into mute.
- 2 Press **USB PC LINK**.
→ If the audio streaming is detected, "CONNECTING" is displayed and the USB indicator will be flashing.
→ If "NO CONNECTION" is displayed, check the connection between your PC and micro system.
- 3 Press **◀** or **▶** until the desired track in the playlist is highlighted.
- 4 Press **▶ ||** to start playback.
→ The track information will appear on the display. The display only supports English characters.

During playback,
– Press **SHUFFLE** to play all available tracks in the playlist in random order.
– Press **REPEAT** to repeat playback of all the tracks in the playlist.
- 5 To exit, select another active mode or press **■**.

Basic Operations

Switching on/off

Switching to active mode

- Press **CD, TUNER, AUX** or **USB PC LINK**.

Switching to Eco Power standby mode

- Press **⏻**.
→ ECO POWER button lights up.
→ The display screen will go blank.

Switching to standby mode (view clock)

- Press and hold **⏻**.
→ The clock is displayed.
→ While in standby mode, pressing **CLOCK•TIMER** button will switch the system to Eco Power standby mode.

Note:

- Before switching the system to Eco Power standby or standby mode, make sure the demonstration mode has been deactivated.

Demonstration mode

If the demonstration mode is active, whenever you switch the system to Eco Power standby or standby mode, it will begin showing the various features offered by the system.

To activate the demonstration

- In Eco Power standby/standby mode, press and hold **■** on the main unit until "DEMO ON" is displayed.

To deactivate the demonstration

- Press and hold **■** on the main unit until "DEMO OFF" is displayed.

Setting the clock

The clock can be set in either 12-hour or 24-hour mode ("1:59 PM" or "23:59" for example).

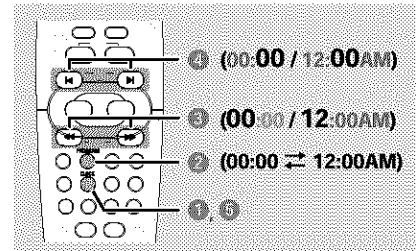

- ① Press and hold **CLOCK** on the remote until the time flashing on the display.

OR

Press and hold **CLOCK•TIMER** on the main unit until "SELECT CLOCK OR TIMER" is displayed. Then press **▶** to change the display to "CLOCK" and press **CLOCK•TIMER** again to confirm.

- ② Press **PROGRAM (PROG)** repeatedly to change between 12-hour and 24-hour clock mode.
- ③ Press **◀** or **▶** repeatedly to set the hour.
- ④ Press **◀** or **▶** repeatedly to set the minute.
- ⑤ Press **CLOCK** (or **CLOCK•TIMER**) to store the setting.
→ The clock will start working.

Notes:

- The clock setting will be erased when the system is disconnected from the power supply.
- The system will exit clock setting mode if no button is pressed within 90 seconds.

Basic Operations

Selecting different display mode

Dim mode

You can select the desired brightness for the display panel.

- In any active mode, press **DIM** repeatedly to select DIM 1, DIM 2, DIM 3 or DIM OFF display mode.
→ **DIM** is shown, except for DIM OFF mode.

DIM mode	button illumination	display brightness	Spectrum analyzer
DIM OFF	on	full	on
DIM 1	on	full	off
DIM 2	on	half	on
DIM 3	off	half	off

Note:

- Pressing **DIM** button in standby mode will toggle between half and full brightness.

Clock display mode

You can choose to show the clock display only.

- Press **CLOCK·TIMER** (or **CLOCK** on remote).
→ In any active mode, pressing the button again will resume normal display.

Note:

- If you pressed any buttons in clock display mode, the display will briefly show the information related to the selected mode.

Volume control

- Adjust **MASTER VOLUME** (or press **VOL +/-** on remote) to increase or decrease the sound level.
→ "**VOL MUTE**" is the minimum volume level and "**0 dB**" is the maximum volume level.

To switch off the volume temporarily

- Press **MUTE** on the remote.
→ Playback will continue without sound and "**MUTE**" is displayed.
→ To restore the volume, press **MUTE** again or increase the volume level.

Sound control

You are only able to select one of the sound controls at a time : **MAX sound, DSC or VEC.**

MAX sound

MAX sound provides the best mixture of various sound features (DSC, VEC for example).

- Press **MAX SOUND** (or **MAX ON/OFF** on remote).
→ If activated, **MAX** is shown and the MAX SOUND button lights up. All other sound effects (DSC or VEC) will be switched off automatically.

Digital Sound Control

DSC provides a different type of preset sound equalizer setting.

- Press **DSC** repeatedly to select : **OPTIMAL, JAZZ, ROCK** or **POP.**

Virtual Environment Control

VEC provides a different type of environment-based equalizer setting.

- Press **VEC** repeatedly to select : **HALL, CINEMA, CONCERT** or **CYBER.**

Disc Operations

IMPORTANT!

- This system is designed for regular discs. Therefore, do not use any accessories such as disc stabilizer rings or disc treatment sheets, etc., as offered on the market, because they may jam the changer mechanism.
- Do not load more than one disc onto each tray.

Playable discs

This system is able to play :

- All pre-recorded audio CDs
- All finalized audio CDR and audio CDRW discs
- MP3-CDs (CD-ROMs with MP3 tracks)



Loading discs (page 3 - P4)

- 1 Press **OPEN/CLOSE ▲ 1** button to open disc tray 1.
- 2 Load a disc with the label side facing up. For double-sided discs, load the side you want to play facing up.
- 3 Press **OPEN/CLOSE ▲ 1** button again to close the disc tray.
⇒ "RETRIEVING" is displayed. The selected disc tray, total number of tracks and the playing time will appear on the display.
- 4 Repeat **steps 1~3** for loading discs onto the **disc trays 2~5**.

Notes:

- To ensure good system performance, wait until the disc trays completely read the disc(s) before proceeding.
- Only one tray can be opened at each time. If you open the second tray before closing the first tray, the first tray will automatically close before the second tray opens.

Basic playback controls

Load discs (page 3 - P4).

To play all discs on the disc trays

- Press **▶ II**
OR

In stop mode, press **CD** to select a disc tray to begin, then press **▶ II**.

⇒ All the available discs will play once, then stop.

To play the selected disc only

- Press one of the **5 DISC DIRECT PLAY (DISC 1~5)** buttons (or **CD 1~5** on remote).

⇒ The selected disc will play once, then stop.

To select a desired track

- Press **◀** or **▶** repeatedly until the desired track is displayed.
⇒ During random play (shuffle mode), pressing **◀** will not affect the current playback.

To search for a particular passage during playback

- Press and hold **◀◀** or **▶▶** and release it when the desired passage is located.
⇒ During searching, the volume will be reduced. For MP3 disc, the volume will be muted.

To replace discs without interrupting playback

- Press **OPEN/CLOSE ▲** buttons of the inactive disc trays (refer to "Loading discs"). For example, if currently disc tray 1 is playing, you can replace the discs on disc tray 2~5.

To interrupt playback

- Press **▶ II**
⇒ To resume normal playback, repeat the above.

To stop playback

- Press **■**.
⇒ If the system remains in stop mode for 30 minutes, it will switch to Eco Power standby mode.

Disc Operations

English

Playing an MP3 disc

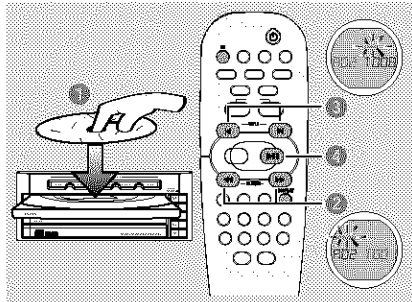

- 1 Load an MP3 disc.
 - The disc reading time may exceed 10 seconds due to the large number of songs compiled into one disc.
 - "TRK 001" and "00:00" is displayed. TRK is the current album number and 00:00 is the current title number.
- 2 Press **ALBUM** ▼▲ (or ◀▶) to select a desired album.
- 3 Press **TITLE** + - (or ◀▶) to select a desired title.
- 4 Press ▶|| to start playback.
- 5 During playback, press **DISPLAY** to show the album and title name.

Supported MP3 disc formats:

- ISO9660, Joliet, UDF 1.5
- Maximum title number : 999 (depending on filename length)
- Maximum album number : 99
- Supported sampling frequencies : 32 kHz, 44.1 kHz, 48 kHz
- Supported Bit-rates : 32~256 (kbps), variable bitrates
- ID3 tags : V1.1, V2.2, V2.3, V2.4

Repeat and Shuffle

You can select and change the various play modes before or during playback.

Repeat play

- 1 Press **REPEAT** on the remote repeatedly to select :

REP	TRK	REP DISC	REP DISC ALL	REP TRK PROG	REP PROG ALL
A		B	C	D	E

- (A) - to repeat playback of the current track.
 - (B) - to repeat playback of the current disc.
 - (C) - to repeat playback of all available discs **(not available for this model)**.
 - (D) - to repeat playback of the current programmed track (only if the program mode is active).
 - (E) - to repeat playback of all the programmed tracks (only if the program mode is active).
- 2 To resume normal playback, press **REPEAT** until "OFF" is displayed.

Random play

- 1 Press **SHUFFLE** on the remote to turn on/off the shuffling mode.
 - If activated, SHUF is shown and the repeat mode (if any) will be cancelled.
 - The random play will start from the current disc tray. Only after all the tracks in the active disc tray has been shuffled, then it will change to the next available disc tray.
 - If program mode is active, only the programmed tracks will be played in random order.

Note:

- Pressing the OPEN/CLOSE button will cancel all repeat and shuffling modes.

Disc Operations

Programming the disc tracks

Programming tracks is possible when playback is stopped. Up to 99 tracks can be stored in the memory in any order.

IMPORTANT!

It is only possible to program from the current selected disc tray.

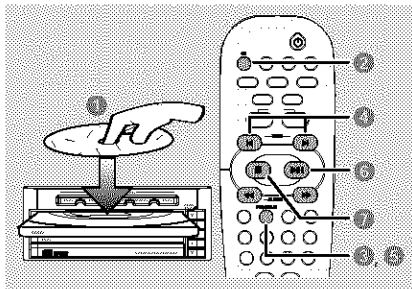

- ① Load the desired discs on the disc trays (refer to "Loading discs").
- ② Press **CD** or one of the **DISC 1-5** buttons to select a disc.
- ③ Press **PROGRAM (PROG)** to start programming.
→ **PROG** starts flashing.
- ④ Press **◀** or **▶** repeatedly to select the desired track.
- ⑤ For MP3 disc, press **◀▶** (**ALBUM ▼▲**) and **◀ / ▶** (**TITLE - +**) to select the desired album and title for programming.
- ⑥ Press **PROGRAM (PROG)** to store.
- ⑦ Repeat **steps 4-5** to select other tracks.
→ If you attempt to program more than 99 tracks, "PROGRAM FULL" is displayed.
- ⑧ To start program play, press **▶▶**
- ⑨ To stop playback or to end the programming, press **■** once.
→ **PROG** stays and the program mode remains active.

Notes:

- If the total playing time reached 100 minutes or if one of the programmed tracks has a number greater than 30, then "----:--" is displayed instead of the total playing time.
- The system will exit programming mode if no button is pressed within 20 seconds.

Checking the program

- ① Stop playback and press **◀** or **▶** repeatedly.
- ② Press **■** to exit.
OR
Press **▶▶** to start playback from the current programmed track

Clearing the program

- Stop playback, then press **■** to clear the program.
OR
Press the **OPEN/CLOSE ▲** button of the disc tray.
→ **PROG** disappears and "PROGRAM CLEAR" is displayed.

Note:

- The program will be erased if the system is disconnected from the power supply or you switch to other source mode.

Tuner Operations

IMPORTANT!

Make sure the FM and AM antennas are connected.

Tuning to radio stations

- ➊ Press **TUNER** to enter tuner mode. To select another waveband (FM or AM), press **TUNER** again.
- ➋ Press and hold **◀** or **▶** until the frequency indication starts to change, then release.
 - The system automatically tunes to the next strong signal radio reception.
 - **st** lights up for FM stereo reception.

For tuning to a weak signal station

- Press **◀** or **▶** briefly and repeatedly until an optimal reception is found.

Presetting radio stations

You can store up to 40 preset radio stations in the memory, starting from FM and followed by AM bands.

Notes:

- The system will exit presetting mode if no button is pressed within 20 seconds.
- If no stereo frequency is detected during Plug and Play, "CHECK ANTENNA" is displayed.

Using the Plug and Play (page 3 - P3)

Plug and Play allows you to store all available radio stations automatically.

- ➊ Connect the system to the power supply, "AUTO INSTALL - PRESS PLAY" is displayed.
OR
In Eco Power standby/standby mode, press and hold **▶||** on the main unit until "AUTO INSTALL - PRESS PLAY" is displayed.
- ➋ Press **▶||** on the main unit to start installation.
 - "INSTALL TUNER" is displayed.
 - All previously stored radio stations will be replaced.
 - Once completed, the last tuned radio station will be played.

Automatic presetting

You can start the automatic presetting from a selected preset number.

- ➊ In tuner mode, press **◀** or **▶** to select a preset number.
- ➋ Press and hold **PROGRAM (PROG)** until "AUTO" is displayed.
 - If a radio station has been stored in one of the presets, it will not be stored again under another preset number.
 - If no preset number is selected, automatic preset will begin from preset (1) and all your former presets will be overridden.

Manual presetting

You can choose to store only the favorite radio stations.

- ➊ Tune to your desired radio station (refer to "Tuning to radio stations").
- ➋ Press **PROGRAM (PROG)**.
 - The preset number starts flashing. If you want to store the radio station in another preset number, press **◀** or **▶**.
- ➌ Press **PROGRAM (PROG)** again to store.
- Repeat **steps 1–3** to store other radio stations.

Selecting a preset radio station

- In tuner mode, press **◀** or **▶**.
 - The preset number, radio frequency, and waveband are displayed.

Deleting a preset radio station

- Press and hold **■** until "PRESET DELETED" is displayed.
 - The current preset radio station will be deleted.
 - All other preset radio stations with higher numbers are decreased by one.

Timer Operations



Timer setting

The system can switch on to CD, TUNER or USB PC LINK mode automatically at a preset time, serving as an alarm to wake you up.

IMPORTANT!

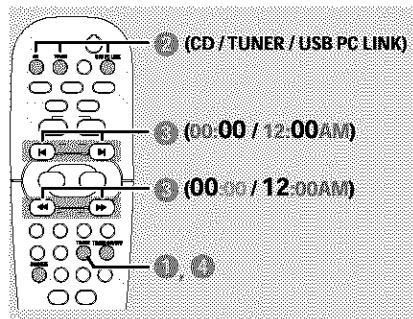
- Before setting the timer, ensure that the clock is set correctly.
- The volume of the timer will increase gradually to the last tuned volume level. If the last tuned volume level is too low, the set will then increase to a predetermined minimum audible level.



- 1 Press and hold **TIMER** on the remote until  icon starts flashing.
OR
Press and hold **CLOCK•TIMER** on the main unit until "SELECT CLOCK OR TIMER" is displayed. Then press **▶** to change the display to "TIMER" and press **CLOCK•TIMER** again to confirm.
- 2 Press **CD** or **TUNER** or **USB PC LINK** to select the wake-up source.
→ The selected source will be lighted while other available sources are flashing.
- 3 Press **◀◀** or **▶▶** (for hours) and **◀** or **▶** (for minutes) repeatedly to set the wake up time.
- 4 Press **TIMER** (or **CLOCK•TIMER**) to store the setting.
→ The timer will always be switched on after it has been set.
→  icon remains on the display. It indicates the timer is activated.

- **At the preset time, the selected sound source will be played for 30 minutes before it switches to Eco Power standby mode** (if no button is being pressed within the time frame).
→ **CD** – playing the first track of the last selected disc. If the last selected disc tray is empty, it will switch to the next available disc. If all the disc trays are not available, it will switch to Tuner mode.
→ **TUNER** – playing the last tuned radio station.
→ **USB PC LINK** – playing the last selected playlist. If the connection fails, it will switch to Tuner mode. Refer to "USB PC Link" for proper connection and setup before use.

Activating/Deactivating the timer

- Press **TIMER ON/OFF** on the remote to turn off the timer or turn on to the last setting again.
→ If activated, the timer information will display for a few seconds, then the system resumes to the last active source or stays in standby mode.
→ If deactivated, "OFF" is displayed.

Note:

- The system will exit timer setting mode if no button is pressed within 90 seconds.

Checking the timer setting

- Press **TIMER** on the remote.
→ The timer information will display for a few seconds, then the system resumes to the last active source or stays in standby mode.

Timer Operations

Temporarily deactivating the wake up timer

You are only able to activate the Snooze function within 30 minutes after the timer wake up from standby mode using the wake up timer.

- 1 After timer wake up, press **SNOOZE** on the remote.
→ The system will switch to standby mode for five minutes. After that, it resumes the timer last selected source again.
- 2 To cancel the snooze function, press **SNOOZE** again.

Sleep timer setting

The sleep timer turns the system to Eco Power standby mode at a preselected time.

- 1 Press **SLEEP** repeatedly until it reaches the desired preset turn-off time.
→ The selections are as follows (time in minutes):
15 → 30 → 45 → 60 → 90 → 120 → OFF → 15 ...
→ **SLEEP** is shown, except for "OFF" mode.
→ To view or change the setting, repeat the above.
 - 2 Before the system switches to Eco Power standby mode, a countdown of 10 seconds is displayed.
"SLEEP 10" → "SLEEP 9" ... → "SLEEP 1"
→ "SLEEP"
- To cancel the sleep timer**
- 1 Press **SLEEP** repeatedly until "OFF" is displayed, or press the **STANDBY ON** button.

Other Connection

Listening to an external source

You can listen to the sound of the connected external device through your system's speakers.

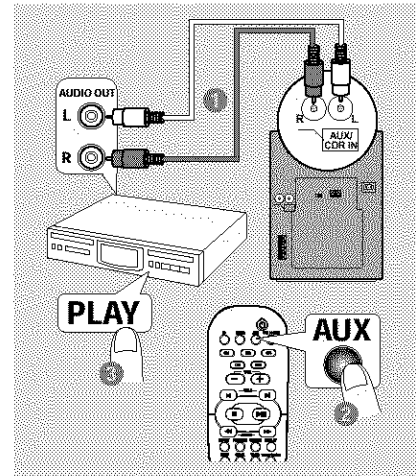

- 1 Use the red/white audio cables to connect the system's **AUX/CDR IN (R/L)** terminals to the AUDIO OUT terminals on the other audio/visual device (such as a TV, VCR, Laser Disc player, DVD player or CD recorder)
→ If the connecting device has only a single audio out terminal, connect it to the AUX/CDR IN left terminal. Alternatively, you can use a "single to double" cinch cable, but the output sounds still remain monaural.
- 2 Press **AUX** repeatedly.
→ Select "AUX" when connecting to a TV, VCR or Laser Disc player.
→ Select "AUX/CDR" when connecting to a CD recorder or DVD player.
- 3 Press **PLAY** on the connected device to start playback.

Notes:

- All the sound control features (DSC, VEC for example) are available for selection.
- Always refer to the owner's manual of the other equipment for complete connection and use details.

Specifications

AMPLIFIER

Output power	200 W total power 2 × 100 W RMS 2 × 95 W FTC ⁽¹⁾
Signal-to-noise ratio	≥ 75 dBA (IEC)
Frequency response	50 – 20000 Hz, –3 dB
Input sensitivity	
AUX/CDR In	500 mV / 1V
Output	
Speakers	≥ 6 Ω
Headphones	32 Ω – 1000 Ω

(1) (6 Ω, 60 Hz – 12.5 kHz, 10% THD)

DISC PLAYER

Programmable tracks	99
Frequency response	20 – 20000 Hz, –3 dB
Signal-to-noise ratio	≥ 76 dBA
Channel separation	≥ 60 dB (1 kHz)
MPEG 1 Layer 3 (MP3-CD)	MPEG AUDIO
MP3-CD bit rate	32-256 kbps (128 kbps advised)
Sampling frequencies	32, 44.1, 48 kHz

USB

Frequency response	20 – 20000 Hz, –3 dB
Signal-to-noise ratio	≥ 75 dBA
Channel separation	≥ 40 dB (1 kHz)
Total harmonic distortion	< 0.3% (1 kHz)

TUNER

FM wave range	87.5 – 108 MHz
AM wave range	530 – 1700 kHz
Number of presets	40
Antenna	
FM	300 Ω dipole wire
AM	Loop antenna

SPEAKERS

System	3 way, Bass reflex
Impedance	6 Ω
Woofer	1 × 6.5"
Tweeter	1 × 2" Ferrofluid cooled
Dimensions (w × h × d)	205 × 268 × 225 (mm) 8.07" × 10.55" × 8.86"
Weight each	3.1 kg / 6.82 pounds

GENERAL

Material/finish	Polystyrene/Metal
AC Power	120 V / 60 Hz
Power Consumption	
Active	80 W
Standby	< 15 W
Eco Power Standby	< 0.5 W
Dimensions (w × h × d)	175 × 268 × 316 (mm) 6.89" × 10.55" × 12.44"
Weight (without speakers)	5.3 kg / 11.66 pounds

Specifications and external appearance are subject to change without notice.

Troubleshooting

WARNING

Under no circumstances should you try to repair the system yourself, as this will invalidate the warranty. Do not open the system as there is a risk of electric shock.

If a fault occurs, first check the points listed below before taking the system for repair. If you are unable to remedy a problem by following these hints, consult your dealer or call 1800-531-0039 for help.

Problem	Solution
When in USB PC LINK mode, "NO CONNECTION" is displayed.	<ul style="list-style-type: none"> ✓ Check the connection between your PC and the system and the initial setup required, see "Connections" and "USB PC Link". ✓ Make sure the connected PC is turned on.
Radio reception is poor.	<ul style="list-style-type: none"> ✓ If the signal is too weak, adjust the antenna or connect an external antenna for better reception. ✓ Increase the distance between the system and your TV or VCR.
"NO DISC" is displayed or the disc cannot be played.	<ul style="list-style-type: none"> ✓ Insert a disc. ✓ Load in the disc with label facing right. ✓ Replace or clean the disc, see "Care and safety information". ✓ Use a finalized CD-R(W) or a correct format disc.
The system does not react when buttons are pressed.	<ul style="list-style-type: none"> ✓ Remove and reconnect the AC power cord and switch on the system again.
Sound cannot be heard or is of poor quality.	<ul style="list-style-type: none"> ✓ Adjust the volume. ✓ Disconnect the headphones. ✓ Check that the speakers are connected correctly. ✓ Check that the AC power cord is connected properly. ✓ When in USB PC LINK mode, check that the PC's volume is not put into mute. ✓ When playing CD from PC's CD drive, refer to "USB PC Link - Enable digital CD audio output".
The remote control does not function properly.	<ul style="list-style-type: none"> ✓ Select the source (CD or TUNER, for example) before pressing the function button (▶ ◀, ◀◀▶▶). ✓ Reduce the distance between the remote control and the system. ✓ Replace the battery. ✓ Point the remote control directly toward the IR sensor.
The timer is not working.	<ul style="list-style-type: none"> ✓ Set the clock correctly. ✓ Press TIMER ON/OFF to switch on the timer.
The system displays features automatically and buttons start flashing.	<ul style="list-style-type: none"> ✓ Press and hold DEMO STOP on the main unit to switch off the demonstration mode.

Refer to the FAQ (Frequently Asked Questions) on the supplied CD-ROM or visit our website "www.audio.philips.com" for latest update on FAQ.

LIMITED WARRANTY

AUDIO SYSTEM

One Year Free Labor

One Year Free Service on Parts

This product must be carried in for repair.

WHO IS COVERED?

You must have proof of purchase to receive warranty service. A sales receipt or other document showing that you purchased the product is considered proof of purchase.

WHAT IS COVERED?

Warranty coverage begins the day you buy your product. For one year thereafter, all parts will be repaired or replaced, and labor is free. After one year from the day of purchase, you pay for the replacement or repair of all parts, and for all labor charges.

All parts, including repaired and replaced parts, are covered only for the original warranty period. When the warranty on the product expires, the warranty on all replaced and repaired parts also expires.

WHAT IS EXCLUDED?

Your warranty does not cover:

- labor charges for installation or setup of the product, adjustment of customer controls on the product, and installation or repair of antenna systems outside of the product.
- product repair and/or part replacement because of misuse, accident, unauthorized repair or other cause not within the control of Philips.
- reception problems caused by signal conditions or cable or antenna systems outside the unit.
- a product that requires modification or adaptation to enable it to operate in any country other than the country for which it was designed, manufactured, approved and/or authorized, or repair of products damaged by these modifications.
- incidental or consequential damages resulting from the product. (Some states do not allow the exclusion of incidental or consequential damages, so the above exclusion may not apply to you. This includes, but is not limited to, prerecorded material, whether copyrighted or not copyrighted.)
- a product that is used for commercial or institutional purposes.

WHERE IS SERVICE AVAILABLE?

Warranty service is available in all countries where the product is officially distributed by Philips. In countries where Philips does not distribute the product, the local Philips service organization will attempt to provide service (although there may be a delay if the appropriate spare parts and technical manual(s) are not readily available).

MAKE SURE YOU KEEP...

Please keep your sales receipt or other document showing proof of purchase. Attach it to this owner's manual and keep both nearby. Also keep the original box and packing material in case you need to return your product.

BEFORE REQUESTING SERVICE...

Please check your owner's manual for assistance. If you have additional questions, call us at 1-800-531-0039.

TO GET WARRANTY SERVICE IN U.S.A., PUERTO RICO, OR U.S. VIRGIN ISLANDS...

Take the product to a Philips factory service center (see enclosed list) or authorized service center for repair. When the product has been repaired, you must pick up the unit at the center. Centers may keep defective parts. (In U.S.A., Puerto Rico, and U.S. Virgin Islands, all implied warranties, including implied warranties of merchantability and fitness for a particular purpose, are limited in duration to the duration of this express warranty. But, because some states do not allow limitations on how long an implied warranty may last, this limitation may not apply to you.)

TO GET WARRANTY SERVICE IN CANADA...

Please contact Philips at:

1-800-661-6162 (French Speaking)
1-800-531-0039 (English or Spanish Speaking)

(In Canada, this warranty is given in lieu of all other warranties. No other warranties are expressed or implied, including any implied warranties of merchantability or fitness for a particular purpose. Philips is not liable under any circumstances for any direct, indirect, special, incidental or consequential damages, howsoever incurred, even if notified of the possibility of such damages.)

REMEMBER...

Please record below the model and serial numbers found on the product. Also, please fill out and mail your warranty registration card promptly. It will be easier for us to notify you if necessary.

MODEL # _____

SERIAL # _____

This warranty gives you specific legal rights. You may have other rights which vary from state/province to state/province.

Philips, P.O. Box 520890, Miami, FL 33152, USA, (402) 536-4171

EL4965E007 / 8-02

Micro Hi-Fi System with 5 CD Tray Changer

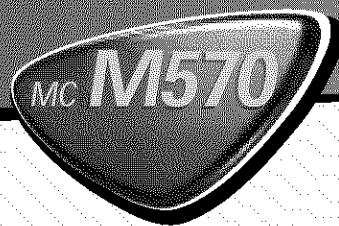

USB PC Link for MP3 Streaming

Remote Control your MP3 music on your PC

- USB PC Link
- Song titles from PC on audio system display

Unlimited Listening Pleasure

- Playback 50 hours of MP3-CD music with 5CDs

Power and Performance

- 200W Total Power0
- Class D Digital Amplifier
- MAX Sound for instant Power Boost

Personalized sound settings

- Digital Sound Control (rock, pop, jazz, optimal)
- Virtual Environment Control (cinema, hall, concert, cyber)



PHILIPS

Micro Hi-Fi System with 5 CD Tray Changer

standard product information



USB PC link

- Bundled MusicMatch Jukebox software
- Track info display
- Navigate via set remote control for Play, Pause, Stop, Next and Previous track

disc player

- 5 CD Tray Changer
- Plays CD, CD-R, CD-RW and MP3-CD discs
- Programmable memory for up to 99 tracks
- Play modes (repeat/shuffle/program)
- CD repeat (track/disc/all)

tuner

- FM/AM Digital Tuning with 40 presets
- Autostore facility
- Plug & Play for easy installation of radio stations

sound

- MAX Sound
- Digital Sound Control (rock, pop, jazz, optimal)
- Virtual Environment Control (cinema, hall, concert, cyber)

amplifier

- 200 watts Total Power
- 2 x 100 watts RMS

loudspeaker boxes

- 3-way Bass Reflex speaker system
- 6.5" woofer
- 2" Tweeter with ferro fluid cooled
- Detachable grilles
- MAX Bass Port

connections

- Audio Input Analog :AUX (cinch)
- Audio Input Digital : USB PC Link
- Stereo headphones : 3.5mm stereo jack
- Antenna : FM coaxial, AM loop

general

- FTD display
- Dim mode
- Clock, Sleep timer, Alarm timer
- 32-key Remote Control
- Eco power standby mode (<0.6 watts)
- Demo mode
- Mute function

USB PC Link

USB PC Link allows the user to turn his PC Hard Disk into a 'Massive MP3 Music Jukebox'. User can playback their MP3 Music Collection from their PC via powerful Amplifier and Speakers on the Philips Audio System. Consumers can use the remote control to navigate through the contents stored in the MusicMatch Jukebox. In addition, personal setting on this MP3 music is also possible via the audio system. During streaming of MP3 music from the PC via USB PC Link, the display on the audio system will give the track information such as Song title and playtime. You can now sit back on your sofa and navigate through your MP3 music from the PC via 'Audio System Remote Control' e.g. Play, Pause, Stop, Next, Previous track. There is no need to run back to your PC for this.

MP3-CD Playback

Download MP3 songs from the internet on a PC and record them on a CD. This special "MP3-CD" can now be played on the Philips MCM570 Micro System. One MP3-CD can carry up to 12 hours of music. As the CD changer can be loaded with 3 CD's, one can enjoy 36 hours of uninterrupted music listening!

The MCM570 is designed to playback MP3 audio recorded with a bit-rate (quality level) between 64kbps and 320kbps. The set will also handle variable bit-rate recordings.

MAX Sound for instant power boost

Consumers constantly want maximum performance from their Audio System but most do not know how to achieve this through their system's equalizer setting. They would like to have a convenient sound feature that at the push of a button enables them to obtain the maximum sound performance from their Audio System. MAX Sound technology produces instant boosting in bass, maximizes the volume performance, and instantly creates the most impressive listening experience with just the touch of the MAX button.

