

# Color Television

## Your Television's Directions for Use



### **Read this manual first!**

*Congratulations on purchasing this Philips product.*

*We've included everything you need to get started.*

*If you have any problems, Philips Representatives can*

*help you get the most from your new product by explaining:*

- Hookups,
- First Time Setup, and
- Feature Operation.

*Do not attempt to return this product to the store.*

**For fast help, call us first!**

**1-800-531-0039**

*Thank you for making Philips a part of your home!*

# MAGNAVOX

Smart. Very smart.®

# Return your Warranty Registration card today to ensure you receive all the benefits you're entitled to.

Once your MAGNAVOX purchase is registered, you're eligible to receive all the privileges of owning a MAGNAVOX product. So complete and return the Warranty Registration Card enclosed with your purchase at once. And take advantage of these important benefits.

## Warranty Verification

Registering your product within 10 days confirms your right to maximum protection under the terms and conditions of your MAGNAVOX warranty.

## Owner Confirmation

Your completed Warranty Registration Card serves as verification of ownership in the event of product theft or loss.

## Model Registration

Returning your Warranty Registration Card right away guarantees you'll receive all the information and special offers which you qualify for as the owner of your model.

Congratulations on your purchase, and welcome to the "family!"

**MAGNAVOX**  
Smart. Very smart.®



Dear MAGNAVOX product owner:

Thank you for your confidence in MAGNAVOX. You've selected one of the best-built, best-backed products available today. And we'll do everything in our power to keep you happy with your purchase for many years to come.

As a member of the MAGNAVOX "family," you're entitled to protection by one of the most comprehensive warranties and outstanding service networks in the industry.

What's more, your purchase guarantees you'll receive all the information and special offers for which you qualify, plus easy access to accessories from our convenient home shopping network.

And most importantly you can count on our uncompromising commitment to your total satisfaction. All of this is our way of saying welcome—and thanks for investing in a MAGNAVOX product.

Sincerely,

Philips Consumer Electronics Company

P.S. Remember, to get the most from your MAGNAVOX product, you must return your Warranty Registration Card within 10 days. So please mail it to us right now!

## Know these safety symbols



This "bolt of lightning" indicates uninsulated material within your unit which may cause an electrical shock. For the safety of everyone in your household, please do not remove product covering.

The "exclamation point" calls attention to features for which you should read the enclosed literature closely to prevent operating and maintenance problems.

WARNING: TO PREVENT FIRE OR SHOCK HAZARD, DO NOT EXPOSE THIS EQUIPMENT TO RAIN OR MOISTURE.

CAUTION: To prevent electric shock, match wide blade of plug to wide slot, and fully insert.

ATTENTION: Pour éviter les chocs électriques, introduire la lame la plus large de la fiche dans la borne correspondante de la prise et pousser jusqu'au fond.

**PHILIPS** Visit our World Wide Web Site at <http://www.philipsusa.com>

# IMPORTANT SAFETY INSTRUCTIONS

## Read before operating equipment

1. Read these instructions.
2. Keep these instructions.
3. Heed all warnings.
4. Follow all instructions.
5. Do not use this apparatus near water.
6. Clean only with a dry cloth.
7. Do not block any of the ventilation openings. Install in accordance with the manufacturers instructions.
8. Do not install near any heat sources such as radiators, heat registers, stoves, or other apparatus (including amplifiers) that produce heat.
9. Do not defeat the safety purpose of the polarized or grounding-type plug. A polarized plug has two blades with one wider than the other. A grounding type plug has two blades and third grounding prong. The wide blade or third prong are provided for your safety. When the provided plug does not fit into your outlet, consult an electrician for replacement of the obsolete outlet.
10. Protect the power cord from being walked on or pinched particularly at plugs, convenience receptacles, and the point where they exit from the apparatus.
11. Only use attachments/accessories specified by the manufacturer.
12.  Use only with a cart, stand, tripod, bracket, or table specified by the manufacturer, or sold with the apparatus. When a cart is used, use caution when moving the cart/apparatus combination to avoid injury from tip-over.
13. Unplug this apparatus during lightning storms or when unused for long periods of time.
14. Refer all servicing to qualified service personnel. Servicing is required when the apparatus has been damaged in any way, such as power-supply cord or plug is damaged, liquid has been spilled or objects have fallen into apparatus, the apparatus has been exposed to rain or moisture, does not operate normally, or has been dropped.
15. This product may contain lead and mercury. Disposal of these materials may be regulated due to environmental considerations. For disposal or recycling information, please contact your local authorities or the Electronic Industries Alliance: [www.eiae.org](http://www.eiae.org)
16. **Damage Requiring Service** - The appliance should be serviced by qualified service personnel when:
  - A. The power supply cord or the plug has been damaged; or
  - B. Objects have fallen, or liquid has been spilled into the appliance; or
  - C. The appliance has been exposed to rain; or
  - D. The appliance does not appear to operate normally or exhibits a marked change in performance; or
  - E. The appliance has been dropped, or the enclosure damaged.
17. **Tilt/Stability** - All televisions must comply with recommended international global safety standards for tilt and stability properties of its cabinet design.
  - Do not compromise these design standards by applying excessive pull force to the front, or top, of the cabinet which could ultimately overturn the product.
  - Also, do not endanger yourself, or children, by placing electronic equipment/toys on the top of the cabinet. Such items could unsuspectingly fall from the top of the set and cause product damage and/or personal injury.
18. **Wall or Ceiling Mounting** - The appliance should be mounted to a wall or ceiling only as recommended by the manufacturer.
19. **Power Lines** - An outdoor antenna should be located away from power lines.
20. **Outdoor Antenna Grounding** - If an outside antenna is connected to the receiver, be sure the antenna system is grounded so as to provide some protection against voltage surges and built up static charges.  
Section 810 of the National Electric Code, ANSI/NFPA No. 70-1984, provides information with respect to proper grounding of the masts and supporting structure grounding of the lead-in wire to an antenna discharge unit, size of grounding connectors, location of antenna-discharge unit, connection to grounding electrodes and requirements for the grounding electrode. See Figure below.
21. **Object and Liquid Entry** - Care should be taken so that objects do not fall and liquids are not spilled into the enclosure through openings.

**Note to the CATV system installer:** This reminder is provided to call the CATV system installer's attention to Article 820-40 of the NEC that provides guidelines for proper grounding and, in particular, specifies that the cable ground shall be connected to the grounding system of the building, as close to the point of cable entry as practical.

### Example of Antenna Grounding as per NEC - National Electric Code

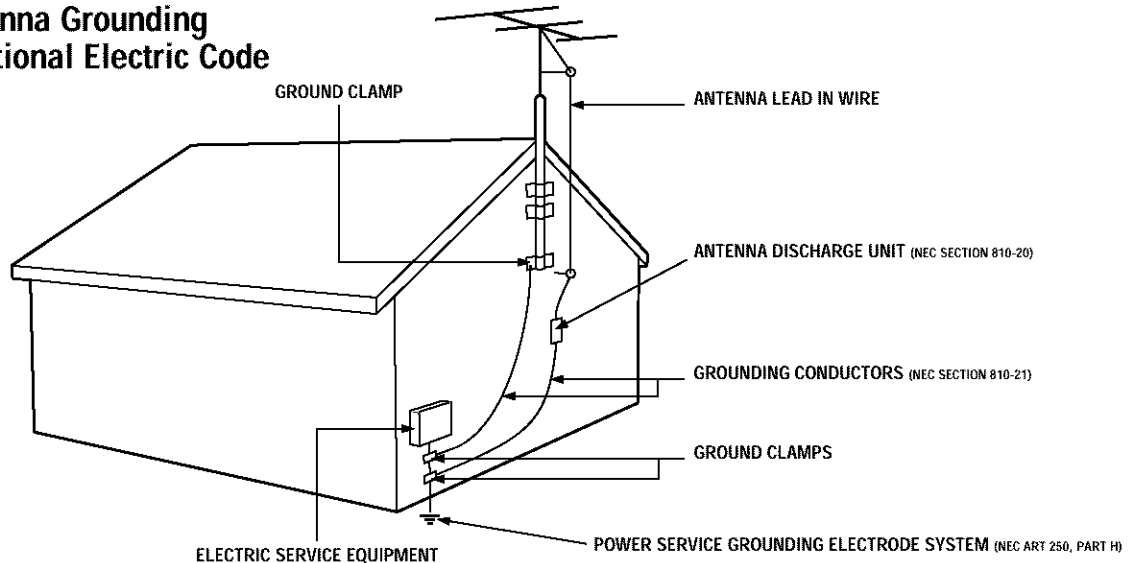

# TABLE OF CONTENTS

## **Introduction**

Welcome/Registration of Your TV .....	2
Safety Instructions .....	3
Table of Contents .....	4



## **Picture Menu**

How to Use the Picture Adjustment Controls .....	5
How to use the DNR (Digital Noise Reduction) Control .....	6
How to use the Contrast + (Black Stretch) Control .....	7



## **Sound Menu**

Using the Treble, Bass, and Balance Controls .....	8
How to Use the AVL Control .....	9
Setting the Incredible Surround Control .....	10
Setting the TV for SAP (Secondary Audio Programs) .....	11
Setting the TV to Receive Stereo Programming .....	12



## **Features Menu**

Using the Timer Controls .....	13
Understanding the SmartLock Controls .....	14
Setting Up the SmartLock Access Code .....	15
How to Block Channels .....	16
How to Clear All Channels at the Same Time .....	17
How to Block All Channels at the Same Time .....	18
Blocking Programming Based on Movie Ratings .....	19
Blocking Programming Based on TV Ratings .....	20
Using the SmartLock Blocking Options .....	21
How to Use the Closed Captioning Control .....	22



## **Audio/Video Connections**

Using the A/V Inputs Jacks .....	23
Using the A/V Output Jacks .....	24
Using the S-Video Input Jack .....	25



## **Remote Control Use**

Setting up the SleepTIMER Option .....	26
Setting the SmartPicture Control .....	27
Setting the SmartSound Control .....	28
Using the Surf Button (Alternate Channel) .....	29
Remote Use with Accessory Devices (Direct Method) ..	30
Remote Use with Accessory Devices (Code Entry) .....	31
Remote Use with Accessory Devices (Search Method) ..	32
Remote Code Entry List .....	33-34
Remote VCR Related Buttons .....	35



## **General Information**

Troubleshooting Tips .....	36
Glossary of Terms .....	37
Index .....	37
Factory Service Location .....	38-39
Warranty .....	40

*Here are a few of the special features built into this new Color Television:*

**SmartLock™** feature allows you to block the viewing of certain channels or external audio/video connections where you might not want your children viewing inappropriate material.

**Infrared Remote Control** works your TV set, and allows you to program certain features with the press of one button. Can also be used with accessory devices such as VCRs, DVDs, Cable Boxes, and more.

**Audio/Video Jackpanel** for direct connections of accessory devices. Audio/Video Inputs and Outputs.

**Standard broadcast (VHF/UHF) or Cable TV (CATV)** channel capability.

**Closed Captioning** allows the viewer to read TV program dialogue or voice conversations as on-screen text.

**Automatic Programming of Channels** for quick and easy selection of favorite stations available in your area.

**On-screen Features** (in either English or Spanish) show helpful messages for setting of TV controls.

**On Timer** automatically turns the TV ON at a preset time, and channel.

**SleepTIMER** automatically turns the TV OFF at preset times.

**SmartPicture™** allows you to set the picture color, tint, contrast, etc. for various types of programming such as Sports, Movies, Personal, Weak Signals or Multi Media with the push of one button.

**SmartSound™** controls allow you to set the sound controls for various types of listening programs such as Personal (sound controls the way you set them), Theatre, Music, or Voice with the push of one button.

**Treble, Bass and Balance** controls to enhance the television's sound.

**NOTE: It is possible that this owner's manual may be used with several different television models. Not all features (and drawings) discussed in this manual will necessarily match those found with your television system. This is normal and does not require you contacting your dealer or requesting service.**

# HOW TO USE THE PICTURE ADJUSTMENT CONTROLS



To adjust your TV picture controls, select a channel and follow the steps shown below:

## BEGIN

- 1 Press the **MENU** button on the remote to display the on-screen menu.
- 2 Press the **CURSOR UP** or **DOWN** buttons until the word **PICTURE** is highlighted.
- 3 Press the **CURSOR RIGHT** button to display the **PICTURE** menu features.
- 4 Press **CURSOR UP** or **DOWN** buttons to scroll the Picture features and highlight the control you wish to adjust (Brightness, Color, Picture, Sharpness, Tint, or Color Temp.).
- 5 Press the **CURSOR RIGHT** or the **CURSOR LEFT** buttons to adjust the selected control or to make selections for the Color Temp. control (Normal, Warm, or Cool).
- 6 Press the **CURSOR UP** or **DOWN** buttons to select and adjust other Picture Menu controls.
- 7 When finished, press the **STATUS** /**EXIT** button to remove the menu from the TV's screen.



### SMART HELP

**BRIGHTNESS** Press the or buttons until darkest parts of the picture are as bright as you prefer.

**COLOR** Press the or buttons to add or eliminate color.

**PICTURE** Press the or buttons until lightest parts of the picture show good detail.

**SHARPNESS** Press the or buttons to improve detail in the picture.

**TINT** Press the or buttons to obtain natural skin tones.





**COLOR TEMP** Press the or buttons to select **NORMAL**, **COOL**, or **WARM** picture preferences. (NORMAL will keep the whites, white; COOL will make the whites, bluish; and WARM will make the whites, reddish.)

Warm  
or  
Cool

# HOW TO USE THE DNR (NOISE REDUCTION) CONTROL

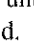
For reasons such as poor cable reception, the picture can sometimes appear slightly "speckled" (or has signal noise shown in the picture). The DNR (Dynamic Noise Reduction) control can help eliminate this type of interference and improve the quality of the picture.

## BEGIN

- 1 Press the **MENU** button on the remote to display the on-screen menu.
- 2 Press the **CURSOR UP**  or **CURSOR DOWN**  button until the word **PICTURE** is highlighted.
- 3 Press the **CURSOR RIGHT**  button to display the **PICTURE** menu features.
- 4 Press the **CURSOR UP**  or **CURSOR DOWN**  button to scroll the Picture menu features until the word **DNR** is highlighted.
- 5 Press the **CURSOR RIGHT**  button turn the **DNR** feature **ON** or **OFF**.
- 6 When finished, press the **STATUS /EXIT** button to remove the menu from the TV's screen.



## SMART HELP

 "Noise" Reduction is a video adjustment feature that affects the picture quality of the TV not the sound.

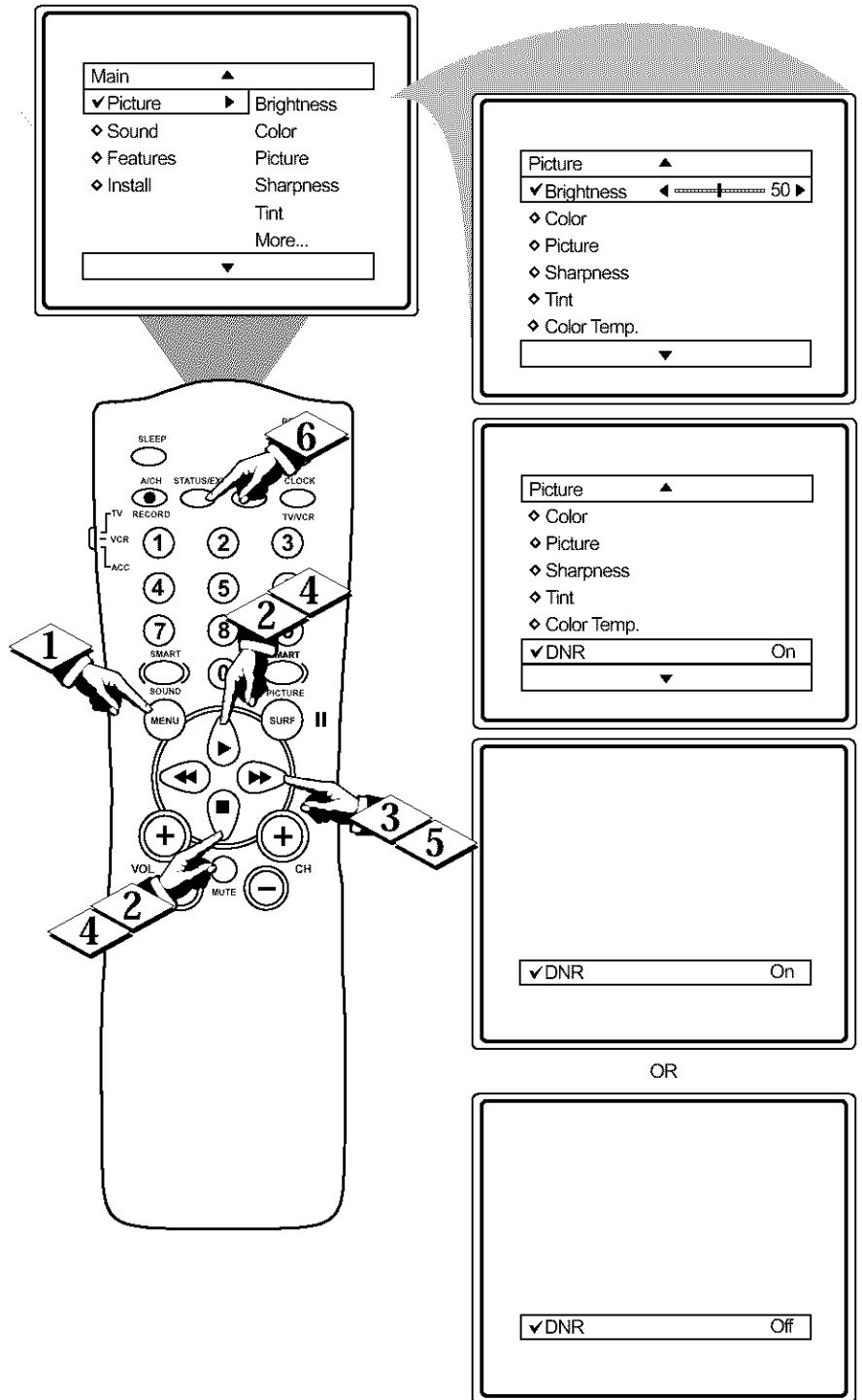

# HOW TO USE THE CONTRAST + (BLACK STRETCH) CONTROL



The Contrast + (Black Stretch) control helps to “sharpen” the picture quality. The black portions of the picture become richer in darkness and the whites become brighter.

**BEGIN**

- 1 Press the **MENU** button on the remote to display the on-screen menu.
- 2 Press the **CURSOR UP** ► or **CURSOR DOWN** ■ button until the word **PICTURE** is highlighted.
- 3 Press the **CURSOR RIGHT** ►► button to display the **PICTURE** menu features.
- 4 Press the **CURSOR UP** ► or **CURSOR DOWN** ■ button to scroll the Picture menu features until the word **CONTRAST +** is highlighted.
- 5 Press the **CURSOR RIGHT** ►► button turn the **CONTRAST +** feature ON or OFF.
- 6 When finished, press the **STATUS /EXIT** button to remove the menu from the TV’s screen.

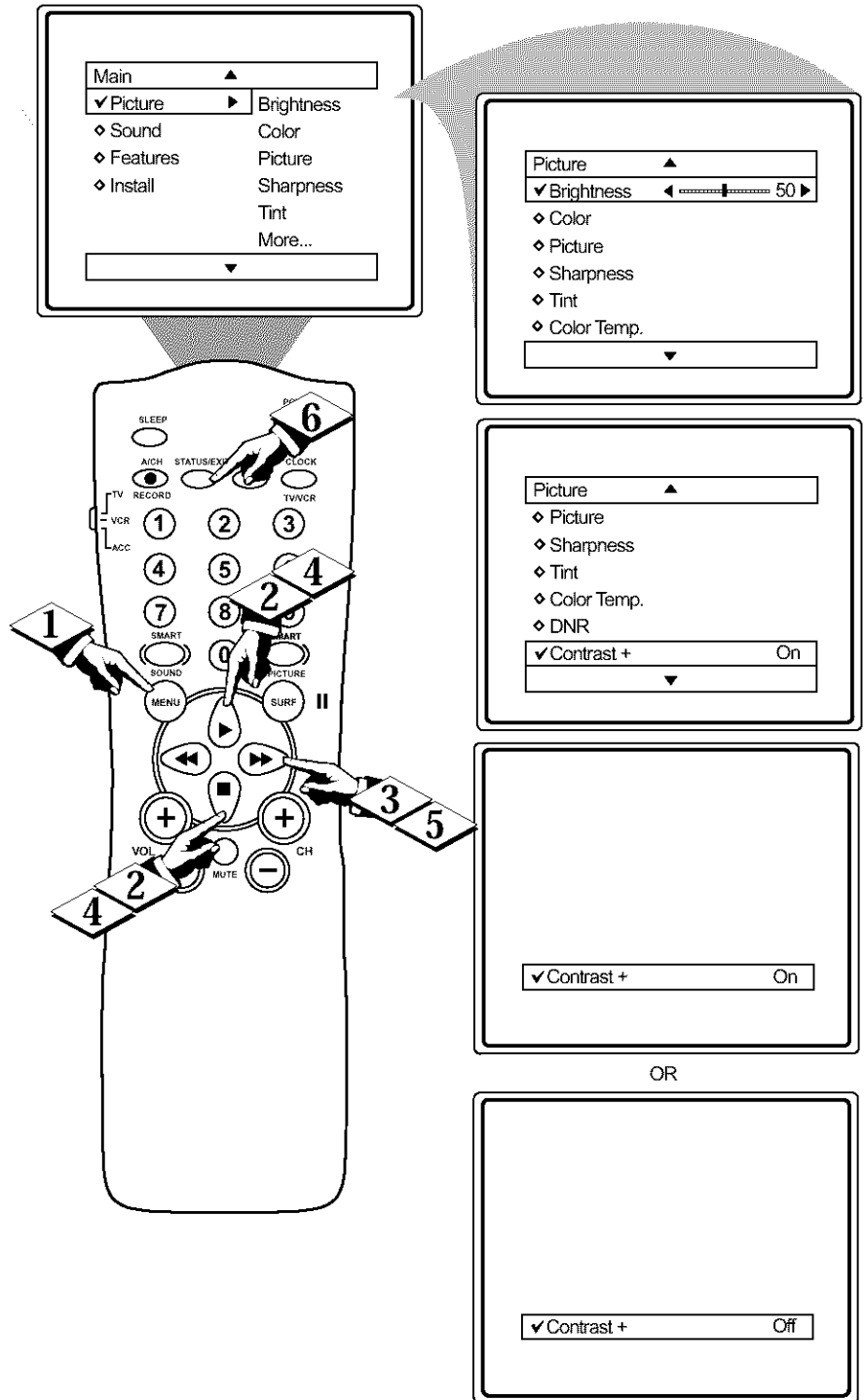



# HOW TO ADJUST THE BASS, TREBLE, BALANCE CONTROLS

Besides the normal volume level control, your TV also has Bass, Treble and Balance sound controls. The TREBLE control effects only the high frequency sound coming from the TV enhancing the highs; while the BASS control effects only the low frequency sound coming from the TV enhancing the lows. The Balance control adjusts the sound level being heard from each speaker.

## BEGIN

- 1 Press the MENU button on the remote to display the on-screen menu.
- 2 Press the CURSOR UP or CURSOR DOWN button until the word SOUND is highlighted.
- 3 Press the CURSOR RIGHT button to display the SOUND menu features.
- 4 Press the CURSOR UP or CURSOR DOWN button to scroll the Sound menu features until the words TREBLE, BASS or BALANCE are highlighted.
- 5 Press the CURSOR RIGHT or LEFT button to adjust the Treble, Bass or Balance controls.
- 6 When finished, press the STATUS /EXIT button to remove the menu from the TV's screen.

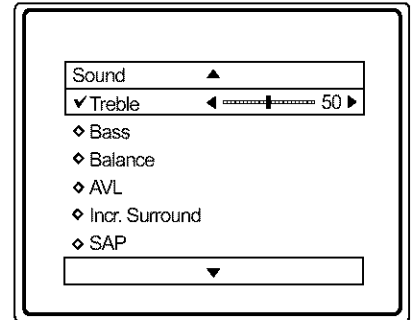
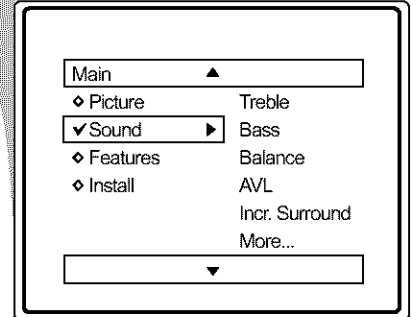
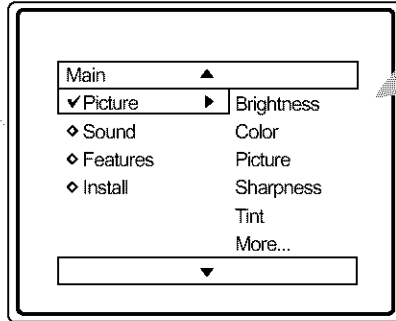

OR

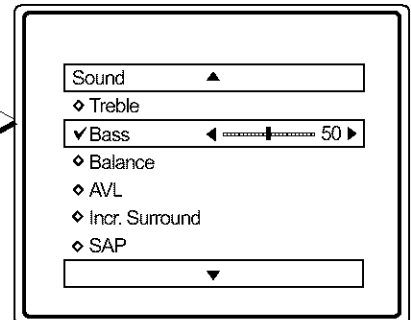

OR

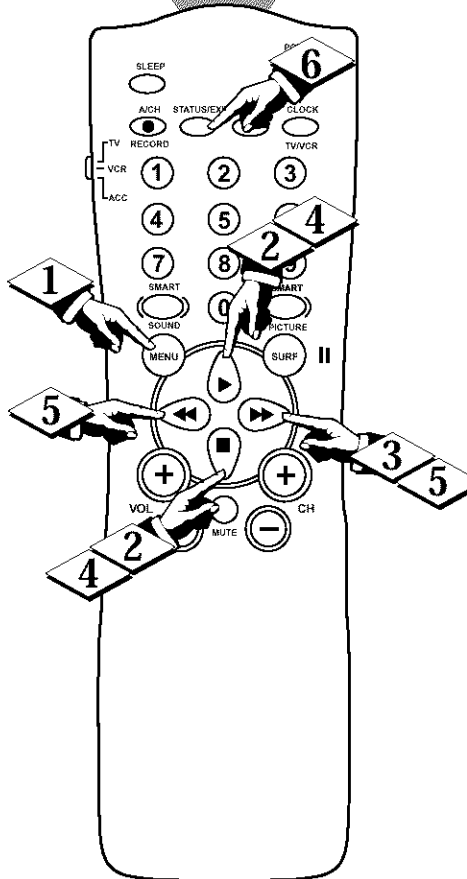
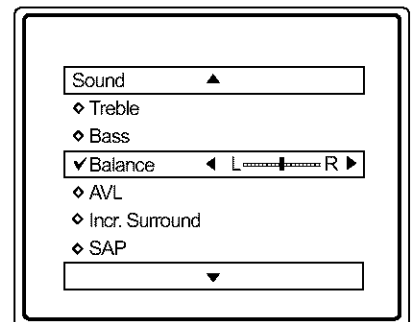



# HOW TO USE THE AVL (AUTOMATIC VOLUME LEVELER) CONTROL

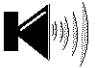

In most cases, the volume levels coming from broadcast programming or commercials are never the same. With the AVL (Audio Volume Leveler) control turned ON, you can have the TV level out sound that is being heard. This makes for a more consistent sound by reducing the peaks and valleys that occur during program changes or commercial breaks. To turn the AVL ON, follow these steps.

## BEGIN

- 1 Press the **MENU** button on the remote to display the on-screen menu.
- 2 Press the **CURSOR UP** or **CURSOR DOWN** button until the word **SOUND** is highlighted.
- 3 Press the **CURSOR RIGHT** button to display the **SOUND** menu features.
- 4 Press the **CURSOR UP** or **CURSOR DOWN** button to scroll the Sound menu features until the word **AVL** is highlighted.
- 5 Press the **CURSOR RIGHT** button to turn the AVL control ON or OFF.
- 6 When finished, press the **STATUS** /**EXIT** button to remove the menu from the TV's screen.

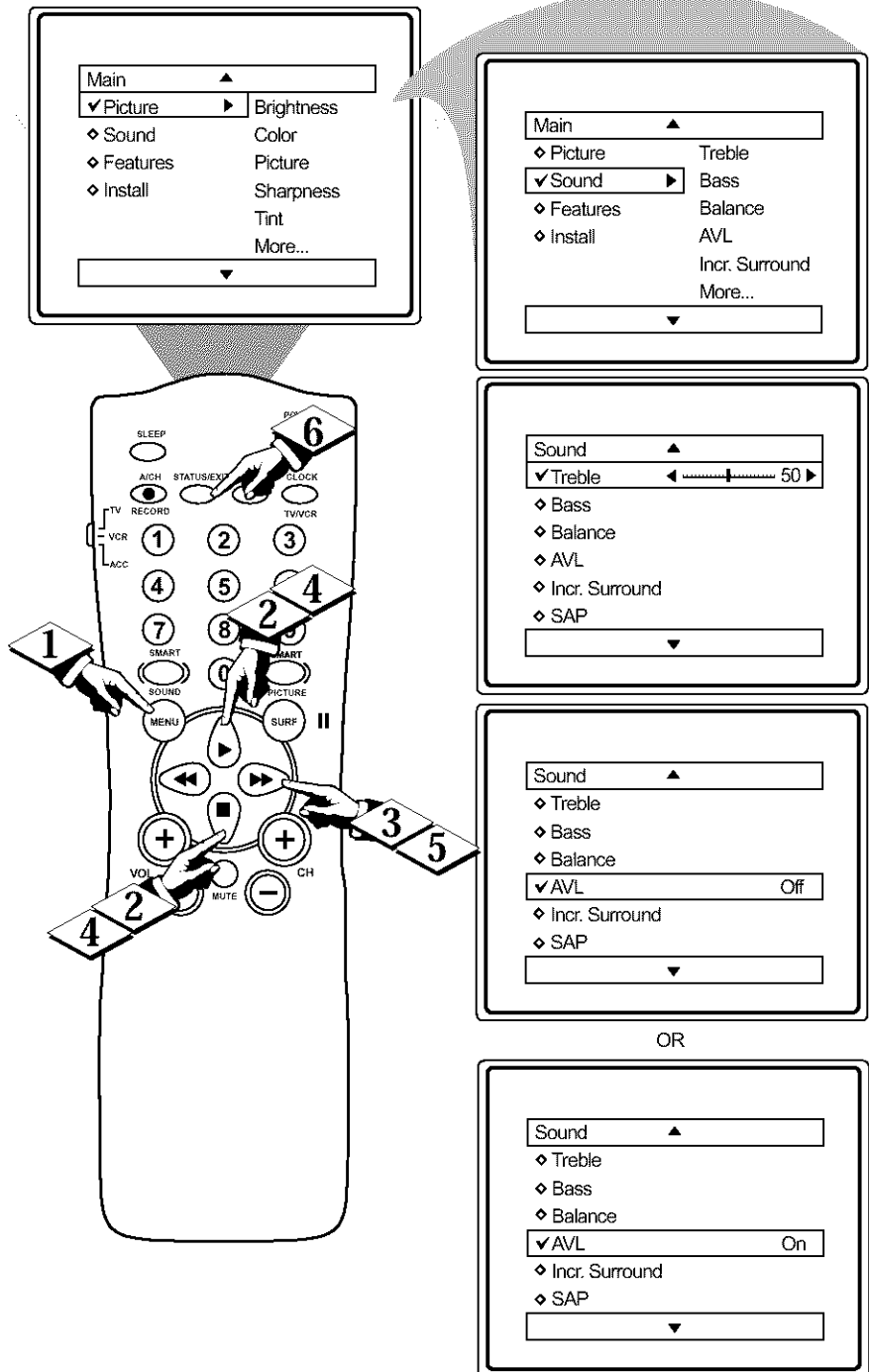



# SETTING THE INCREDIBLE SURROUND CONTROL

*The Incredible Surround feature adds greater depth and dimension to both monaural (MONO) and stereo TV sound. With the control turned ON the TV's speakers can add even wider sound separation to normal broadcasts.*

## BEGIN

- 1 Press the **MENU** button on the remote to display the on-screen menu.
- 2 Press the **CURSOR UP** or **CURSOR DOWN** button until the word **SOUND** is highlighted.
- 3 Press the **CURSOR RIGHT** button to display the **SOUND** menu features.
- 4 Press the **CURSOR UP** or **CURSOR DOWN** button to scroll the Sound menu features until the words **INCR. SURROUND** are highlighted.
- 5 Press the **CURSOR RIGHT** button to set the **Incredible Surround** control as follows:
  - MONO:** When in the Mono Sound Mode, Incredible Surround can be set to Mono or Spatial.
  - STEREO:** When in the Stereo Sound Mode, Incredible Surround can be set to Stereo or Incredible Surround.
- 6 When finished, press the **STATUS/EXIT** button to remove the menu from the TV's screen.



## SMART HELP

**NOTE:** If the TV signal is being received from a mono source, pressing the INCR. SURR. button will cause either MONO or SPATIAL to appear on the the screen. If the TV signal is being received from a stereo source and the "Sound" control is set to Stereo, pressing the INCR. SURR. button will toggle two choices: STEREO and INCR. SURROUND.

**SPATIAL** – widens the "Mono" sound, simulating a broader, fuller sound.

**INCR. SURROUND** – widens the "Stereo" sound, simulating a broader, fuller sound.

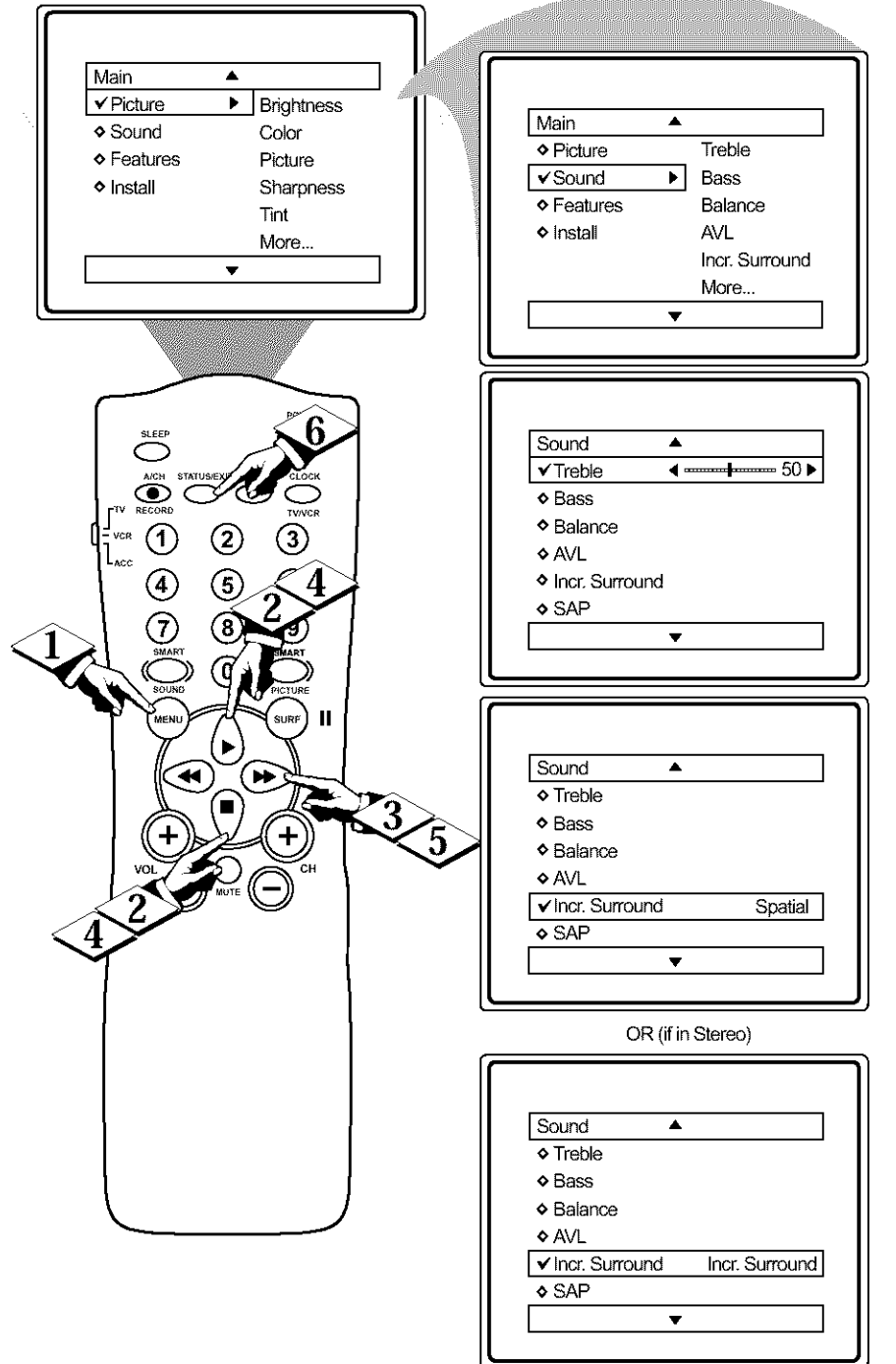

# SETTING THE TV FOR SAP (SECONDARY AUDIO PROGRAMS)



A SAP signal is an additional part of the stereo broadcast system. Sent as a third audio channel, a SAP signal can be heard apart from the current TV program sound. TV stations are free to use SAP for any number of purposes.

If a SAP signal is not present with a selected program, the SAP option cannot be selected. Also, if SAP is selected on a channel (with SAP) and you select another channel, when you return to the original channel, SAP will be OFF. You will have to reselect the SAP feature.

## BEGIN

- 1 Press the **MENU** button on the remote to display the on-screen menu.
- 2 Press the **CURSOR UP** or **CURSOR DOWN** button until the word **SOUND** is highlighted.
- 3 Press the **CURSOR RIGHT** button to display the **SOUND** menu features.
- 4 Press the **CURSOR UP** or **CURSOR DOWN** button to scroll the Sound menu features until the word **SAP** is highlighted.
- 5 Press the **CURSOR RIGHT** button to turn the SAP control ON or OFF.
- 6 When finished, press the **STATUS /EXIT** button to remove the menu from the TV's screen.



The diagram illustrates the process of setting SAP on a TV. It shows a remote control with numbered callouts (1-6) indicating the sequence of button presses. To the right, a series of on-screen menu screens shows the progression: 1. Main menu with 'Picture' selected. 2. Picture menu with 'Sound' selected. 3. Sound menu with 'SAP' selected. 4. SAP control screen with 'SAP' set to 'Off'. 5. SAP control screen with 'SAP' set to 'On'. An 'OR' label indicates an alternative path where 'SAP' is set to 'On'.

Note: If SAP is not present on the channel you are tuned to, when the SAP control is set to ON the screen will read:

“SAP NOT AVAILABLE.”



# SETTING THE TV TO RECEIVE STEREO PROGRAMMING

You can receive broadcast stereo TV programs. The TV has both an amplifier and twin speakers through which the stereo sound can be heard.

## BEGIN

- 1 Press the **MENU** button on the remote to display the on-screen menu.
- 2 Press the **CURSOR UP** or **CURSOR DOWN** button until the word **SOUND** is highlighted.
- 3 Press the **CURSOR RIGHT** button to display the **SOUND** menu features.
- 4 Press the **CURSOR UP** or **CURSOR DOWN** button to scroll the Sound menu features until the word **SOUND** is highlighted.
- 5 Press the **CURSOR RIGHT** button to set the Sound control to Mono or Stereo.
- 6 When finished, press the **STATUS** /**EXIT** button to remove the menu from the TV's screen.



## SMART HELP



Remember, if stereo is not present on a selected show, the Sound control cannot be changed to Stereo. On the other hand, if stereo is present on a selected show the Sound control can be set to Mono.

When channel changes are made, the screen may indicate Mono for a second or two, then change to Stereo if the signal being received is in stereo.

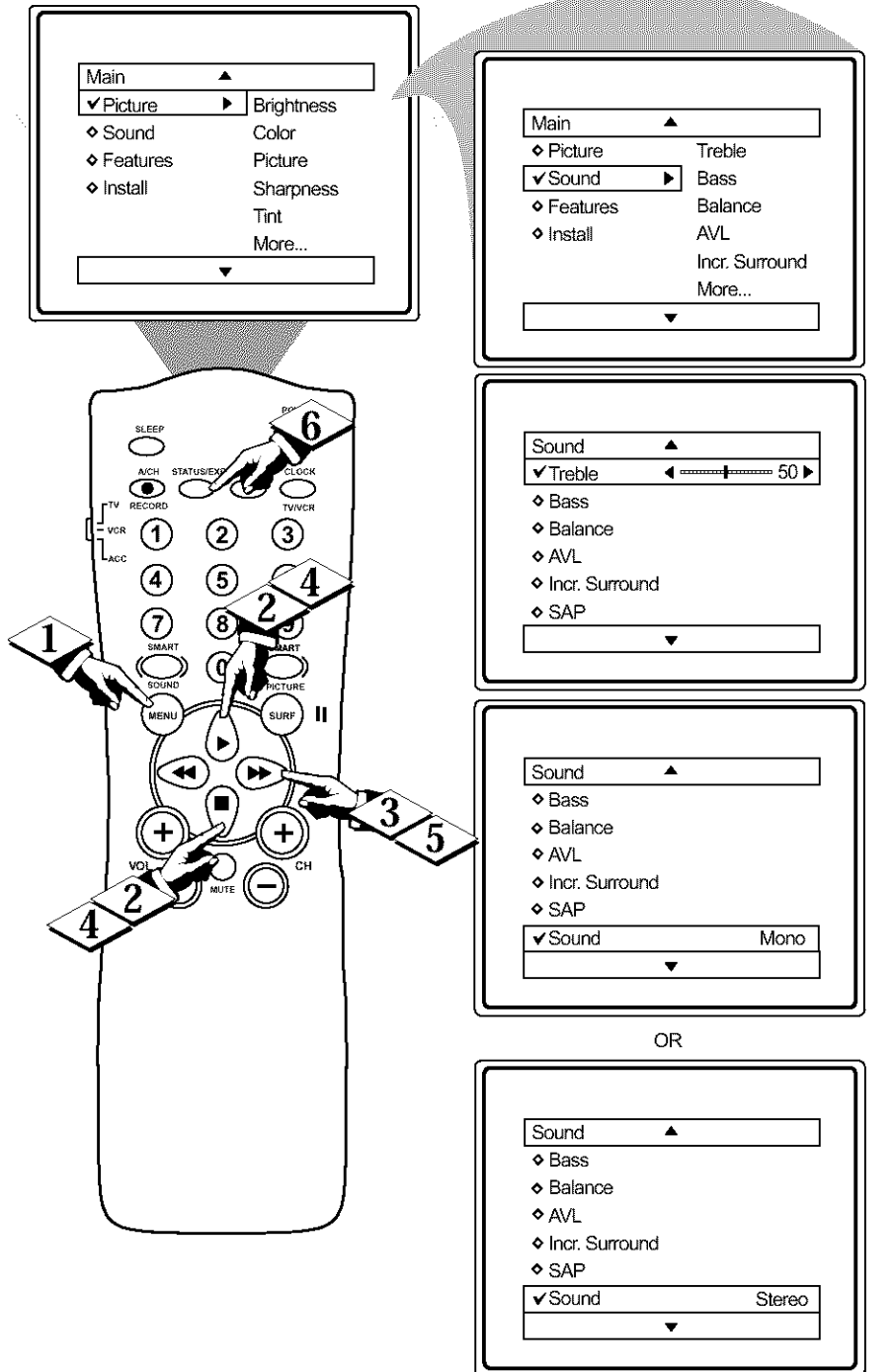

# HOW TO USE THE TIMER CONTROLS



The Timer controls allow you to use your TV as an alarm clock if set to turn itself on and off at a specific time. It also can be set to tune to a specific channel at a specific time.

## BEGIN

- 1** Press the **CLOCK** button on the remote. The Timer menu will appear on the screen.
- 2** Press the **CURSOR UP** or **DOWN** button to highlight one of the Timer controls you wish to set (Time, Start Time, Stop Time, Channel, Activate, or Display).
- 3** Press the **CURSOR RIGHT** button to adjust the selected option.

**TIME:** Enter the current time with the numbered buttons. Use the Cursor Right button to move to the AM/PM area and use the Cursor Left or Right buttons to toggle AM or PM.

**START TIME:** Use the numbered buttons to enter a start-up time for the TV to turn on or to tune a specific channel.

**STOP TIME:** Use the numbered buttons to enter a time for the TV to shut itself off.

**CHANNEL:** Use the Numbered buttons or the CH + or - buttons to select a specific channel for the TV to tune to at the specific Start Time.

**ACTIVATE:** Set the Timer to perform its function ONCE or DAILY.

**DISPLAY:** Set to ON or OFF. When ON, the time will be displayed ALL the time the TV is ON. When OFF, the time will only appear when the STATUS/EXIT button is pressed.

- 4** When finished, press the **STATUS/EXIT** button to remove the menu from the TV's screen.

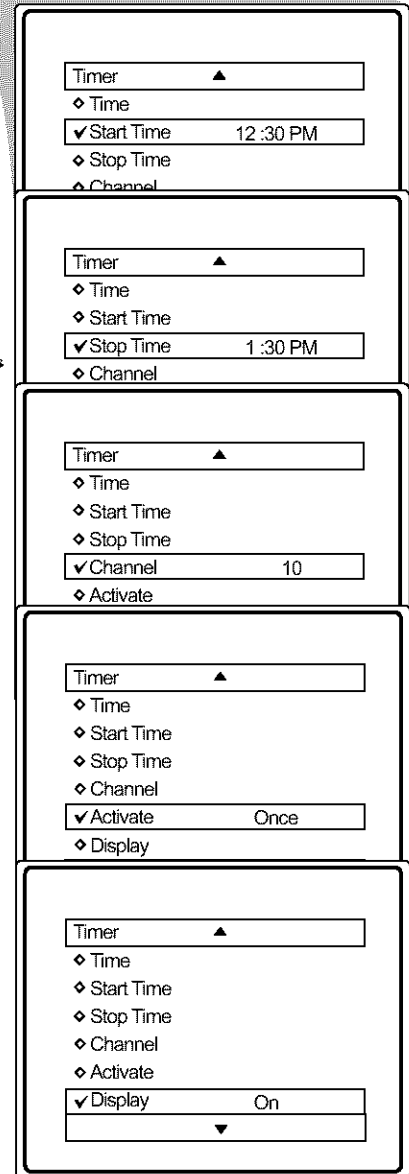
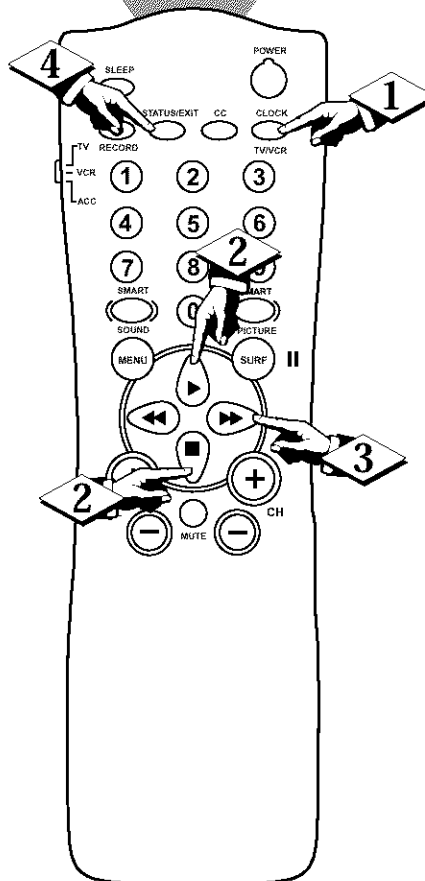
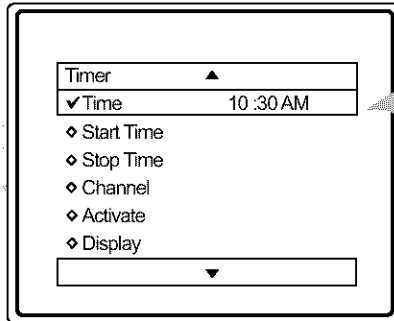



# UNDERSTANDING THE AUTOLOCK CONTROLS

The AutoLock feature is an integrated circuit that receives and processes data sent by broadcasters, or other program providers, that contain program content advisories. When programmed by the viewer, a TV with AutoLock can respond to the content advisories and block program content that may be found objectionable (such as offensive language, violence, sexual situations, etc.). This is a great feature to censor the type of viewing children may watch.

Over the next few pages you'll learn how to block channels and certain rated programming. Below is a brief explanation of some terms and ratings you will find in the AutoLock feature.

AutoLock offers various **BLOCKING** controls from which to choose:

**Access Code:** An Access Code must be set to prevent children from unblocking questionable or censored programming set by their parents.

**Channel Block:** After an access code has been programmed, you can block individual channels including the A/V inputs.

**Clear All:** Allows you clear all channels being blocked from your viewing set with the Channel Block Control.

**Block All:** Allows you to block ALL channels and A/V inputs at one time.

**Movie Ratings:** Certain blocking options exist which will block programming based on ratings patterned by the Motion Pictures Association of America.

**TV Ratings:** Just like the Movie Ratings, programs can be blocked from viewing using standard TV ratings set by TV broadcasters.

To learn more about the Motion Picture Association of America Ratings and the TV Broadcasters Television Ratings, refer to the definitions listed on the columns to the right.

Movie Rating ▲
▼ G On
◇ PG
◇ PG-13
◇ R
◇ NC-17
◇ X
▼

TV Rating ▲
▼ TV-Y On
◇ TV-Y7
◇ TV-G
◇ TV-PG
◇ TV-14
◇ TV-MA
▼

## MOVIE RATINGS (MOTION PICTURE ASSOCIATION OF AMERICA)

**G: General Audience** - All ages admitted. Most parents would find this program suitable for all ages. This type of programming contains little or no violence, no strong language, and little or no sexual dialogue or situations.

**PG: Parental Guidance Suggested** - This programming contains material that parents may find unsuitable for younger children.) It may contain one or more of the following: Moderate violence, some sexual situations, infrequent coarse language, or some suggestive dialogue.

**PG-13: Parents Strongly Cautioned** - This programming contains material that parents may find unsuitable for children under the age of 13. It contains one or more of the following: violence, sexual situations, coarse language, or suggestive dialogue.

**R: Restricted** - This is programming is specifically designed for adults. Anyone under the age of 17 should only view this programming with an accompanying parent or adult guardian. It contains one or more of the following: intense violence, intense sexual situations, strong coarse language, or intensely suggestive dialogue.

**NC-17: No one under the age of 17 will be admitted.** - This type of programming should be viewed by adults only. It contains graphic violence, explicit sex, or crude indecent language.

**X: Adults Only** - This type of programming contains one or more of the following: very graphic violence, very graphic and explicit or indecent sexual acts, very coarse and intensely suggestive language.

## TV PARENTAL GUIDELINES (TV BROADCASTERS)

**TV Y** **TV-Y** - (All children -- This program is designed to be appropriate for all children.) Designed for a very young audience, including children ages 2-6. This type of programming is not expected to frighten younger children.

**TV Y7** **TV-Y7** - (Directed to Older Children - This program is designed for children age 7 and above.) It may be more appropriate for children who have acquired the development skills needed to distinguish between make-believe and reality. This programming may include mild fantasy and comic violence (FV).

**TV G** **TV-G** - (General Audience -- Most parents would find this program suitable for all ages.) This type of programming contains little or no violence, no strong language, and little or no sexual dialogue or situations.

**TV PG** **TV-PG** - (Parental Guidance Suggested -- This program contains material that parents may find unsuitable for younger children.) This type of programming contains one or more of the following: Moderate violence (V), some sexual situations (S), infrequent coarse language (L), or some suggestive dialogue (D).

**TV 14** **TV-14** - (Parents Strongly Cautioned - This program contains some material that many parents would find unsuitable for children under 14 years of age.) This type of programming contains one or more of the following: intense violence (V), intense sexual situations (S), strong coarse language (L), or intensely suggestive dialogue (D).

**TV MA** **TV-MA** - (Mature Audience Only -- This program is specifically designed to be viewed by adults and therefore may be unsuitable for children under 17.) This type of programming contains one or more of the following: graphic violence (V), explicit sexual situations (S), or crude indecent language (L).

# SETTING UP THE AUTOLOCK ACCESS CODE



Over the next few pages you'll learn how to block channels and get a better understanding of the rating terms for certain programming.

First, let's start by learning how to set a personal access code:

## BEGIN

- 1 Press the **MENU** button on the remote to display the on-screen menu.
- 2 Press the **CURSOR UP** or **DOWN** button until the word **FEATURES** is highlighted.
- 3 Press the **CURSOR RIGHT** button to display the **FEATURES** menu options.
- 4 Press the **CURSOR UP** or **DOWN** button until the words **AUTOLOCK** are highlighted.
- 5 Press the **CURSOR RIGHT** button. The screen will read, "ACCESS CODE ----."
- 6 Using the **NUMBERED** buttons, enter 0, 7, 1, 1. "XXXX" appears on the Access Code screen as you press the numbered buttons.  
"INCORRECT CODE" will appear on the screen, and you will need to enter 0, 7, 1, 1 again.
- 7 The screen will ask you to enter a "New Code." Enter a "new" 4 digit code using the **NUMBERED** buttons. The screen will then ask you to **CONFIRM** the code you just entered. Enter your new code again. "XXXX" will appear when you enter your new code and then display the AutoLock menu options.

Proceed to the next page to learn more...

## SMART HELP

Parents - it isn't possible for your child to unblock a channel without knowing your access code or changing it to a new one. If your code changes, and you didn't change it, then you know it's been altered by someone else and blocked channels have been viewed.

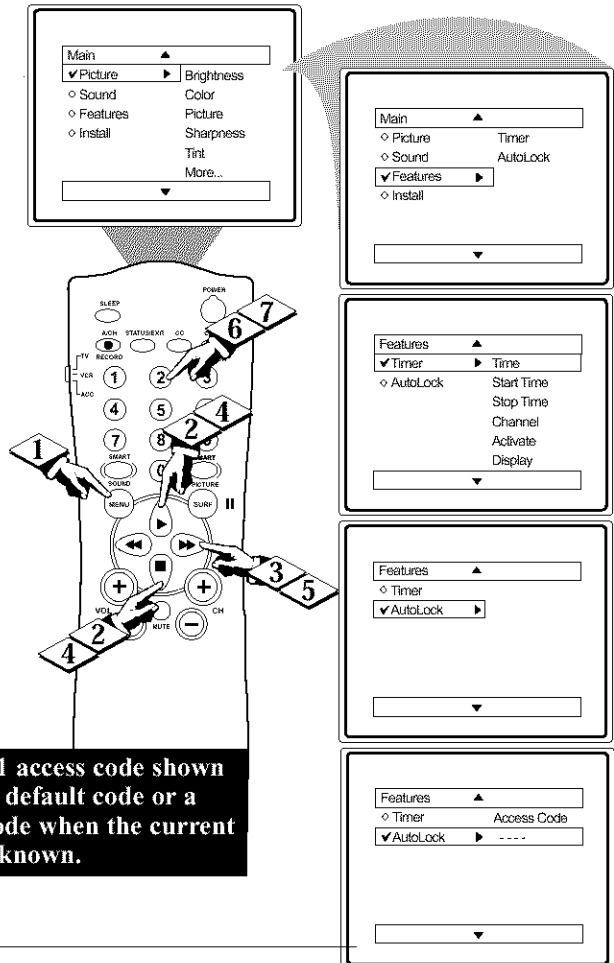

**NOTE:** The 0,7,1,1 access code shown on this page is the default code or a way to reset the code when the current access code is not known.

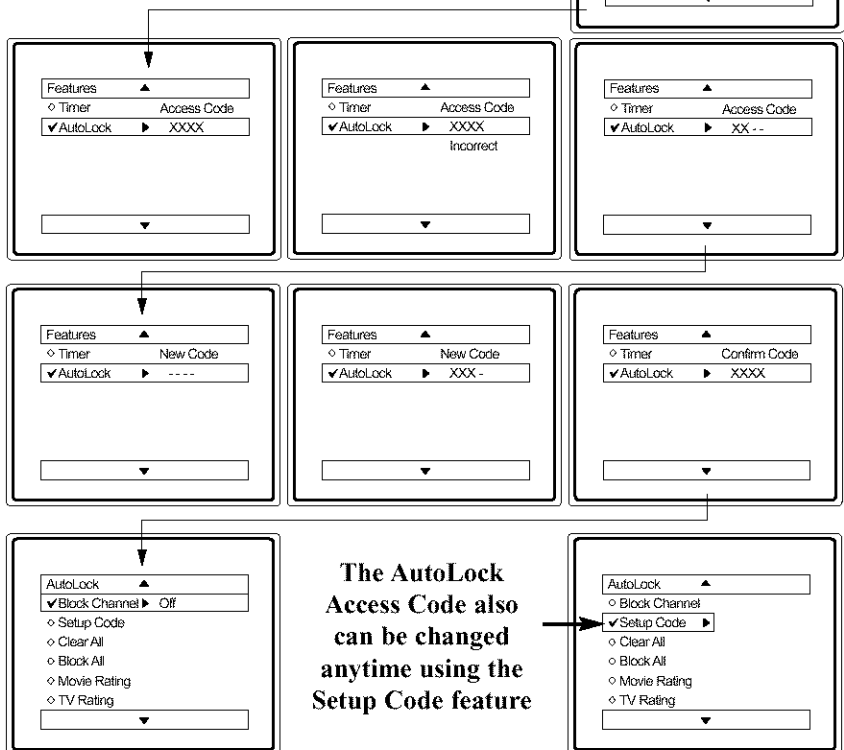

The AutoLock Access Code also can be changed anytime using the Setup Code feature

# HOW TO BLOCK CHANNELS

After your personal access code has been set (see previous page), you are now ready to select the channels or A/V Inputs you want to block out or censor.

## BEGIN

- 1 Press the **NUMBERED (or CH +, -)** buttons to tune the channel you wish to block or censor.
- 2 Press the **MENU** button on the remote to show the on-screen menu.
- 3 Press the **CURSOR UP** or **DOWN** button until the word **FEAT-URES** is highlighted.
- 4 Press the **CURSOR RIGHT** button to display the **FEATURES** menu options.
- 5 Press the **CURSOR UP** or **DOWN** button until the words **AutoLock** are highlighted.
- 6 Press the **CURSOR RIGHT** button.
- 7 Enter the correct access code number. "XXXX" shows on the Access Code display as you press the **NUMBERED** buttons. AutoLock menu options will be displayed.
- 8 Press the **CURSOR UP** or **DOWN** buttons until the words **BLOCK CHANNELS** are highlighted.
- 9 Press the **CURSOR RIGHT** button to turn blocking ON or OFF for that channel. When ON is selected the channel will be blocked.
- 10 Press the **CH + or -** button to select other channels you wish to block. Repeat step 9 to block the new channel.



## SMART HELP

If you tune to a blocked channel and enter your Access Code to view the channel, ALL blocked channels will be viewable until the TV has been turned off. When the TV is powered back ON, the previously blocked channels will be blocked again.

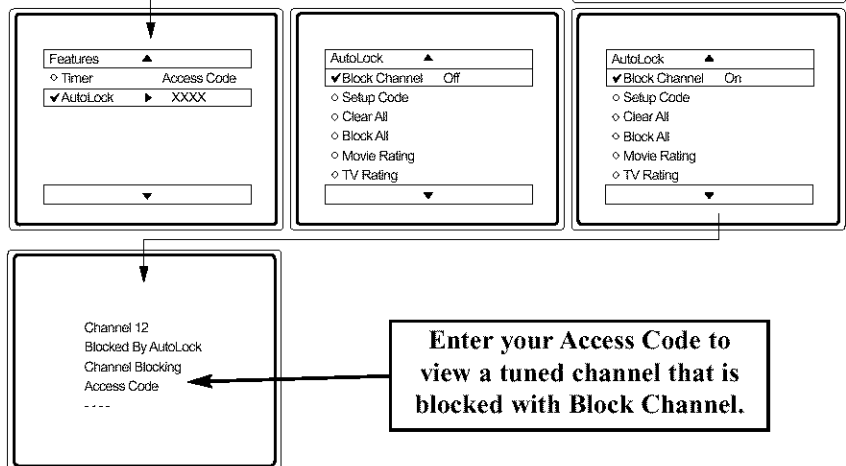
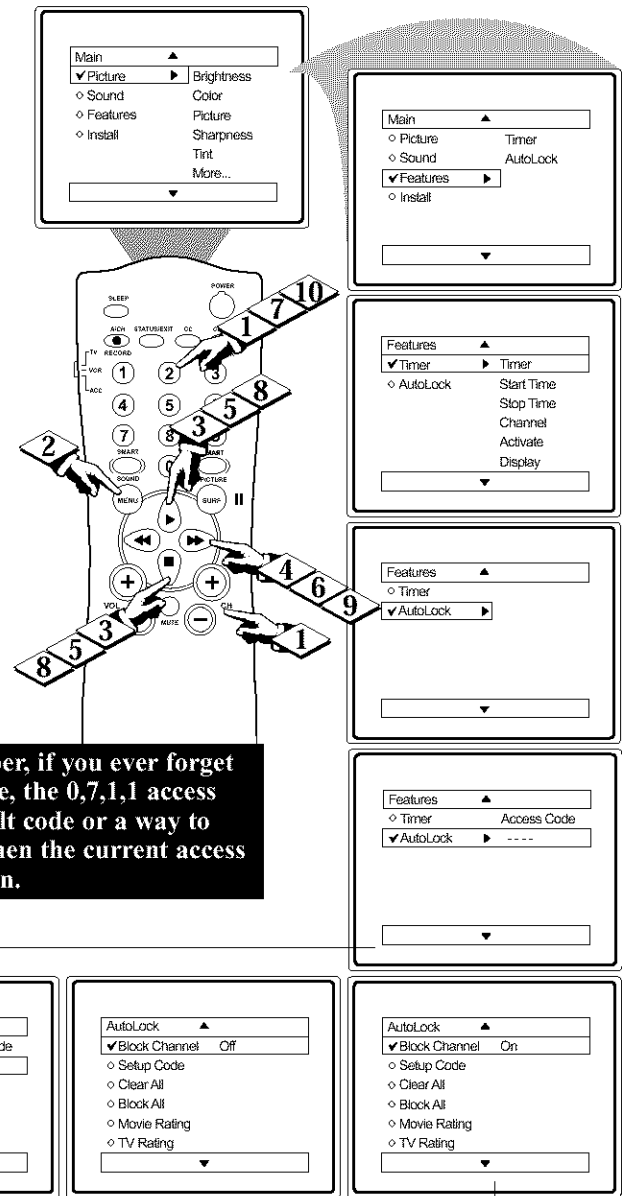



# HOW TO CLEAR ALL BLOCKED CHANNELS AT THE SAME TIME



After blocking specific channels there may come a time when you want to clear all the channels so they can be viewed. The following steps explain how to CLEAR ALL blocked channels.

## BEGIN

- 1 Press the **MENU** button on the remote to show the on-screen menu.
- 2 Press the **CURSOR UP** or **DOWN** button until the word **FEATURES** is highlighted.
- 3 Press the **CURSOR RIGHT** button to display the **FEATURES** menu options.
- 4 Press the **CURSOR UP** or **DOWN** button until the words **AutoLock** are highlighted.
- 5 Press the **CURSOR RIGHT** button.
- 6 Enter the correct access code number. "XXXX" shows on the Access Code display as you press the **NUMBERED** buttons. AutoLock menu options will be displayed.
- 7 Press the **CURSOR UP** or **DOWN** buttons until the words **CLEAR ALL** are highlighted.
- 8 Press the **CURSOR RIGHT** button to clear all blocked channels. The Clear All option will read, "Cleared."
- 9 When finished, press the **STATUS /EXIT** button to remove the menu from the TV's screen.



## SMART HELP

If you tune to a blocked channel and enter your Access Code to view the channel, ALL blocked channels will be viewable until the TV is powered OFF and then turned back ON. When the TV is powered back ON, the previously blocked channels will be blocked again.

CLEAR ALL will not work with the Movie and TV Ratings. These options must be reset individually.

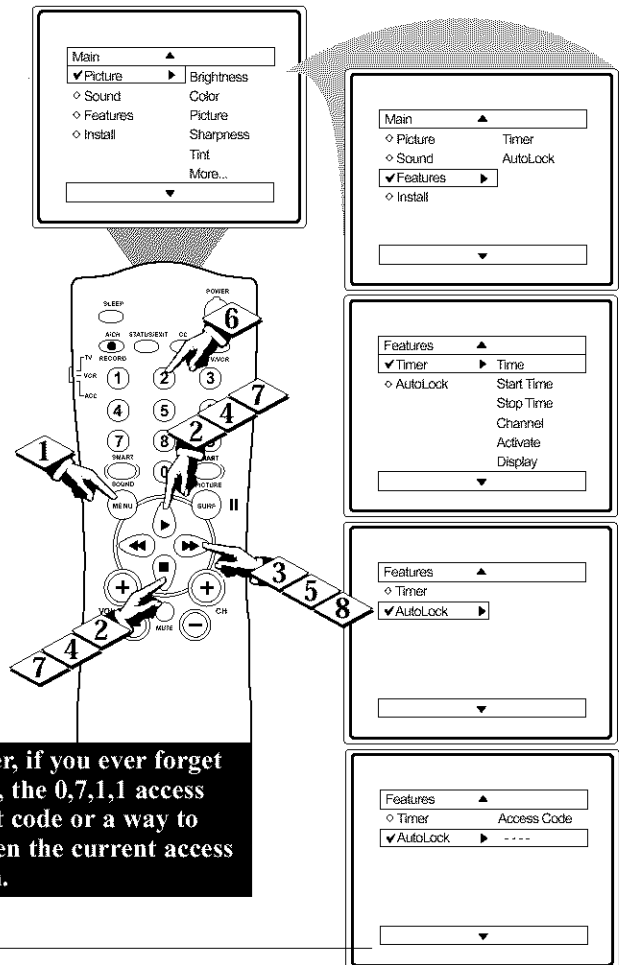

**NOTE:** Remember, if you ever forget your Access Code, the 0,7,1,1 access code is the default code or a way to reset the code when the current access code is not known.

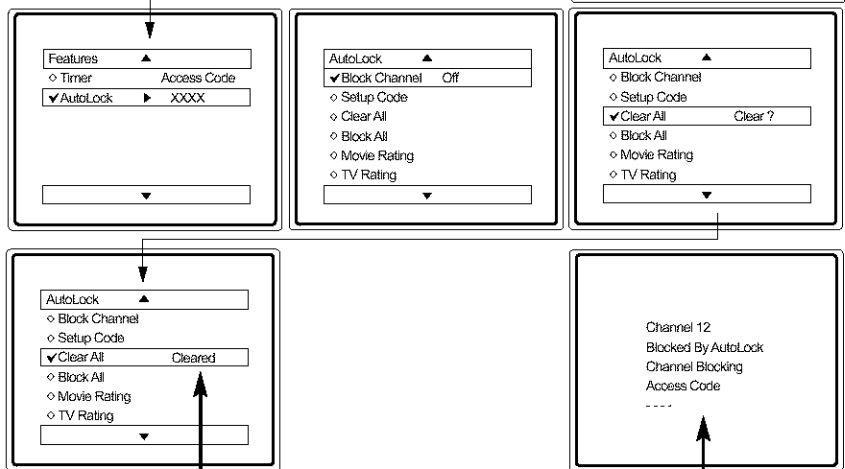

The **Clear All** option when activated will unblock ALL blocked channels. It will not affect programming blocked by the Movie or TV Rating options.

Or, enter your Access Code to view a tuned channel that is blocked with **Block Channel**.

# HOW TO BLOCK ALL CHANNELS AT THE SAME TIME

There may come a time when you want to Block All the television's channels. Maybe you don't want your children to watch TV for a given time. With the Block All control, ALL available channels (including the A/V Inputs) can be set to block at the same time.

## BEGIN

- 1 Press the **MENU** button on the remote to show the on-screen menu.
- 2 Press the **CURSOR UP** or **DOWN** button until the word **FEATURES** is highlighted.
- 3 Press the **CURSOR RIGHT** button to display the **FEATURES** menu options.
- 4 Press the **CURSOR UP** or **DOWN** button until the words **AutoLock** are highlighted.
- 5 Press the **CURSOR RIGHT** button.
- 6 Enter the correct access code number. "XXXX" shows on the Access Code display as you press the **NUMBERED** buttons. AutoLock menu options will be displayed.
- 7 Press the **CURSOR UP** or **DOWN** buttons until the words **BLOCK ALL** are highlighted.
- 8 Press the **CURSOR RIGHT** button to turn Block All ON or OFF. When ON is selected, ALL available channels will be blocked.
- 9 When finished, press the **STATUS/EXIT** button to remove the menu from the screen.



## SMART HELP

If you tune to a blocked channel and enter your Access Code to view the channel, ALL blocked channels will be viewable until the TV has been turned off. When the TV is powered back ON, the previously blocked channels will be blocked again.

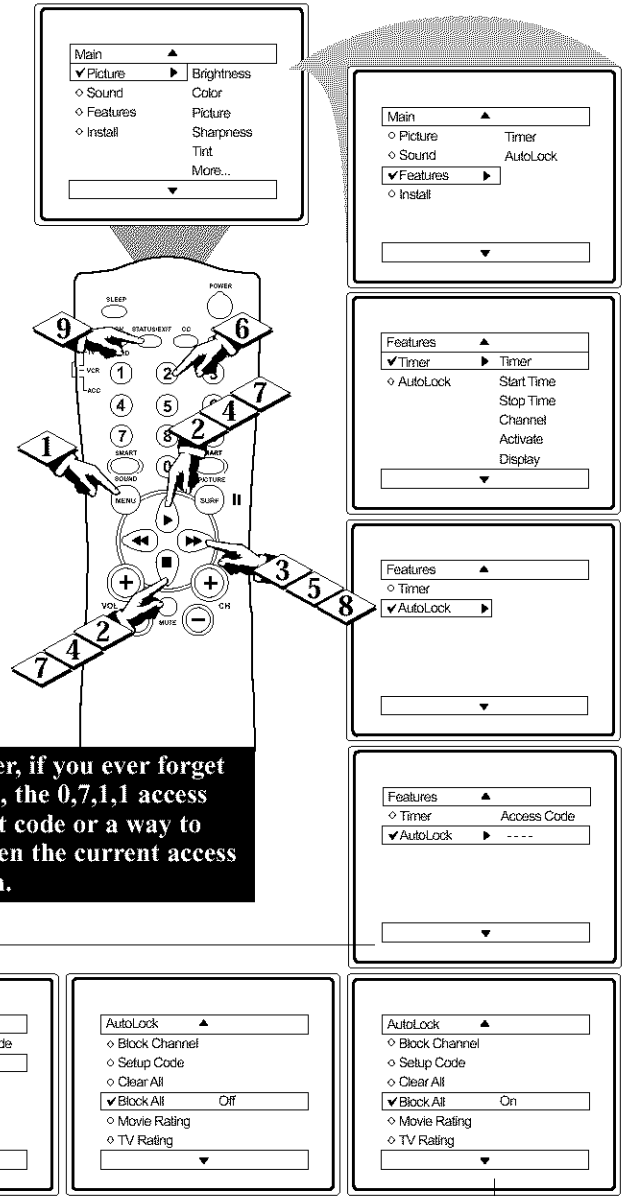

**NOTE:** Remember, if you ever forget your Access Code, the 0,7,1 access code is the default code or a way to reset the code when the current access code is not known.

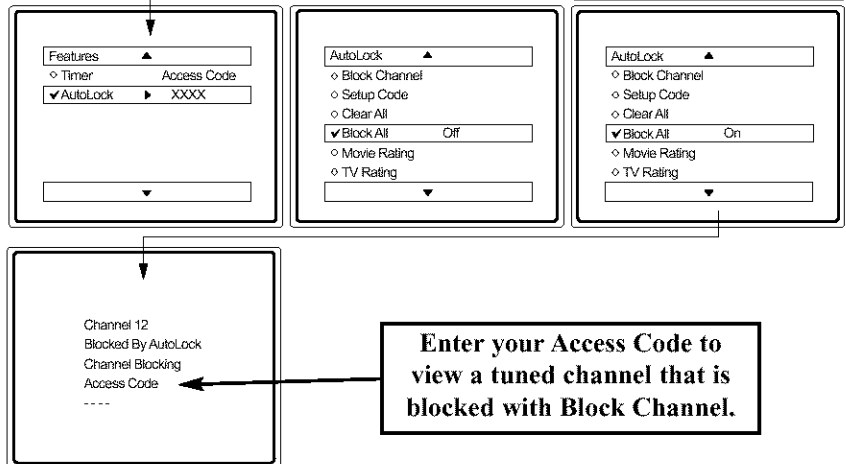

# BLOCKING PROGRAMMING BASED ON MOVIE RATINGS



There are two types of program ratings within the AutoLock feature. One is based on the Movie Industry ratings while the other is based on the TV Industry ratings. Both can be used to block or censor programming that has been rated in either manner.

Let's first look at the Movie Rating options of AutoLock:

## BEGIN

- 1 Press the **MENU** button on the remote to display the on-screen menu.
- 2 Press the **CURSOR UP** or **DOWN** button until the word **FEATURES** is highlighted.
- 3 Press the **CURSOR RIGHT** button to display the **FEATURES** menu options.
- 4 Press the **CURSOR UP** or **DOWN** button until **AutoLock** is highlighted.
- 5 Press the **CURSOR RIGHT** button. The screen will prompt you for your Access Code.
- 6 Using the **NUMBERED** buttons on the remote, enter your 4 digit Access Code. The AutoLock menu options will be displayed.
- 7 Press the **CURSOR UP** or **DOWN** button to highlight the words **MOVIE RATINGS**.
- 8 Press the **CURSOR RIGHT** button to display the **MOVIE RATINGS** options (G, PG, PG-13, R, NC17, or X).
- 9 Press the **CURSOR UP** or **DOWN** button to highlight any of the Movie Ratings options. When highlighted, all these options can be turned **ON** (which will allow blocking) or **OFF** (which will allow viewing).
- 10 Use the **CURSOR RIGHT** button on the remote to turn the rating option ON or OFF.



## SMART HELP

When a rating is set to block, all higher ratings will be automatically blocked as well. (Example: If the the PG-13 rating is set to block, the R, NC-17, and X ratings will also be blocked.)

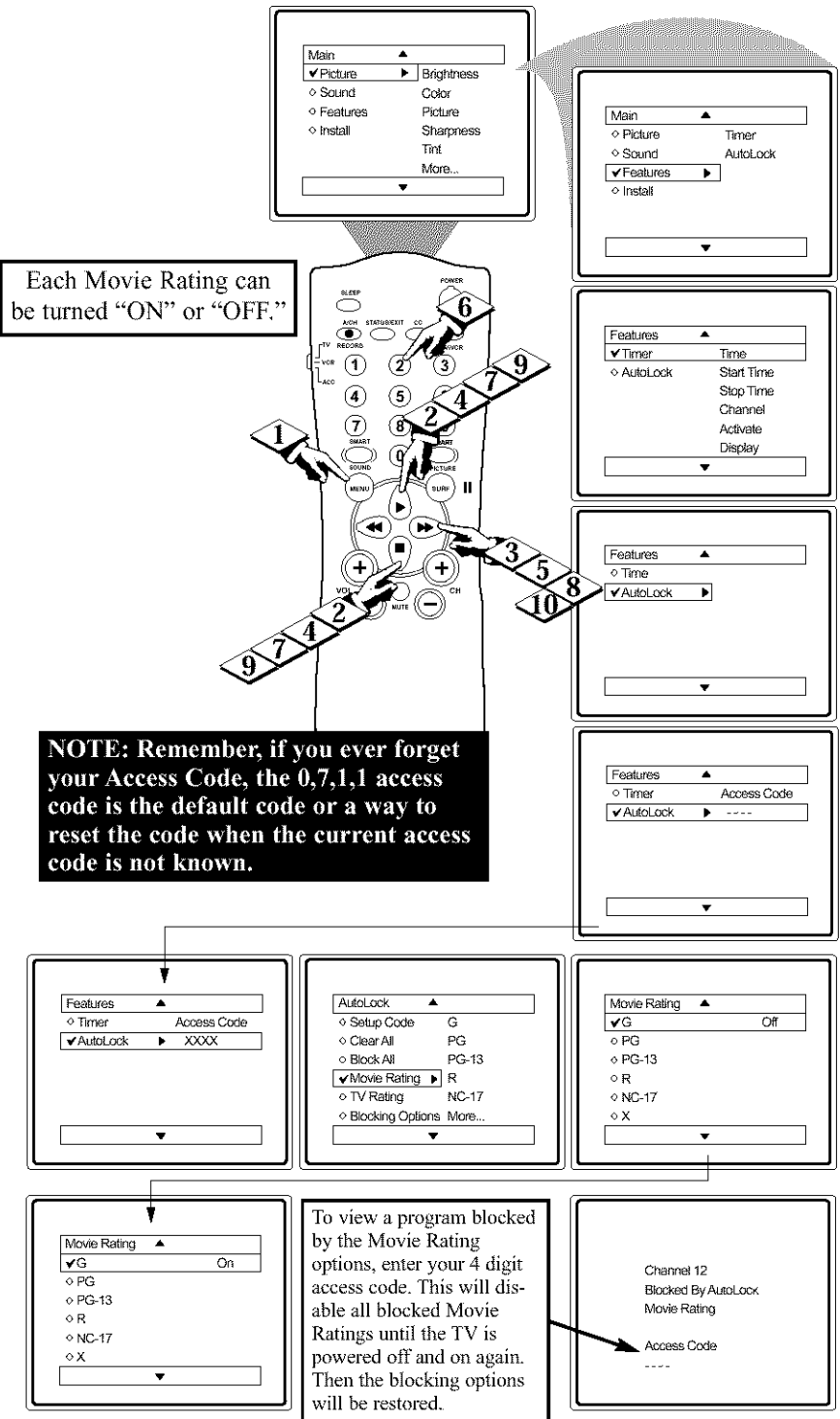







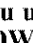

# BLOCKING PROGRAMMING BASED ON TV RATINGS

This portion of the AutoLock features cover program ratings based on the TV Industry rating system. This is known as TV Ratings within AutoLock.

After selecting the Autolock feature and entering your personal access code, the AutoLock options screen appears;

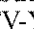
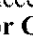
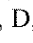
## BEGIN

- 1 Scroll the menu using the CURSOR UP  or DOWN  buttons until the words TV RATINGS are highlighted.
- 2 Press the CURSOR RIGHT  button to display the TV Ratings (TV-Y, TV-Y7, TV-G, TV-PG, TV-14, or TV-MA). When highlighted, the TV-Y and TV-G can be turned ON (which will allow blocking) or OFF (which will allow viewing), of these rated programs. The ratings of TV-Y7, TV-PG, TV-14, TV-MA can be customized to block V (violence), FV (fantasy violence), S (sexual situations), L (coarse language), or D (suggestive dialogue).
- 3 Press the CURSOR UP  or DOWN  button to highlight the desired rating.
- 4 Press the CURSOR RIGHT  button on the remote to turn the TV-Y or TV-G rating ON or OFF. Or, press the CURSOR RIGHT  button to enter the sub-menus for the TV-Y7, TV-PG, TV-14 or TV-MA ratings.
- 5 If the TV-Y7, TV-PG, TV-14 or TV-MA sub-menu is accessed, press the CURSOR UP  or CURSOR DOWN  button to select one of the options (Block All, V, S, L, D, or FV).
- 6 Press the CURSOR RIGHT  button on the remote to turn the option ON or OFF.



To view a program blocked by the TV Rating options, enter your 4 digit access code. This will disable all blocked TV Ratings until the TV is powered off and on again. Then the blocking options will be restored.

Channel 12  
Blocked By AutoLock  
TV Rating  
  
Access Code  
----

TV Rating ▲ Block All  
◊ TV-Y V  
◊ TV-Y7 V  
◊ TV-G S  
▼ TV-PG L  
◊ TV-14 D  
◊ TV-MA

TV Rating ▲ Block All  
◊ TV-Y V  
◊ TV-Y7 S  
◊ TV-G L  
▼ TV-PG D  
◊ TV-14  
◊ TV-MA

TV Rating ▲ Block All  
◊ TV-Y V  
◊ TV-Y7 S  
◊ TV-G L  
▼ TV-PG L  
◊ TV-14  
▼ TV-MA

**TV Ratings and Rating Sub-Menus**  
When a TV Rating is selected to block, ALL higher ratings will be blocked also.

**TV-Y** - (All children -- *This program is designed to be appropriate for all children.*) Designed for a very young audience, including children ages 2-6. This type of programming is not expected to frighten younger children.

**TV-Y7** - (Directed to Older Children -- *This program is designed for children age 7 and above.*) It may be more appropriate for children who have acquired the development skills needed to distinguish between make-believe and reality. This programming may include mild fantasy and comic violence (FV).

**TV-G** - (General Audience -- *Most parents would find this program suitable for all ages.*) This type of programming contains little or no violence, no strong language and little or no sexual dialogue or situations.

**TV-PG** - (Parental Guidance Suggested -- *This program contains material that parents may find unsuitable for younger children.*) This type of programming contains one or more of the following: some suggestive dialogue (D), infrequent coarse language (L), some sexual situations (S), or moderate violence (V).

**TV-14** - (Parents Strongly Cautioned -- *This program contains some material that many parents would find unsuitable for children under 14 years of age.*) This type of programming contains one or more of the following: intensely suggestive dialogue (D), strong coarse language (L), intense sexual situations (S), or intense violence (V).

**TV-MA** - (Mature Audience Only -- *This program is specifically designed to be viewed by adults and therefore may be unsuitable for children under 17.*) This type of programming contains one or more of the following: crude indecent language (L), explicit sexual situations (S), or graphic violence (V).

# USING THE AUTOLOCK BLOCKING OPTIONS



AutoLock offers the viewer other blocking features as well. With these Blocking Options, the censoring can be turned ON or OFF.

## BEGIN

- 1 Press the MENU button on the remote to show the on-screen menu.
- 2 Press the CURSOR UP **▶** or DOWN **■** button until the word FEATURES is highlighted.
- 3 Press the CURSOR RIGHT **▶▶** button to display the FEATURES menu options.
- 4 Press the CURSOR UP **▶** or DOWN **■** button until the words AutoLock are highlighted.
- 5 Press the CURSOR RIGHT **▶▶** button.
- 6 Enter the correct access code number. "XXXX" shows on the Access Code display as you press the NUMBERED buttons. AutoLock menu options will be displayed.
- 7 Press the CURSOR UP **▶** or DOWN **■** buttons until the words BLOCKING OPTIONS are highlighted.
- 8 Press the CURSOR RIGHT **▶▶** button to display the Blocking Options (BLOCKING, UNRATED, or NO RATING) menu.
- 9 Press the CURSOR UP **▶** or DOWN **■** buttons to highlight the desired feature.
- 10 When highlighted, each feature can be turned ON or OFF using the CURSOR RIGHT **▶▶** or LEFT **◀◀** buttons on the remote.

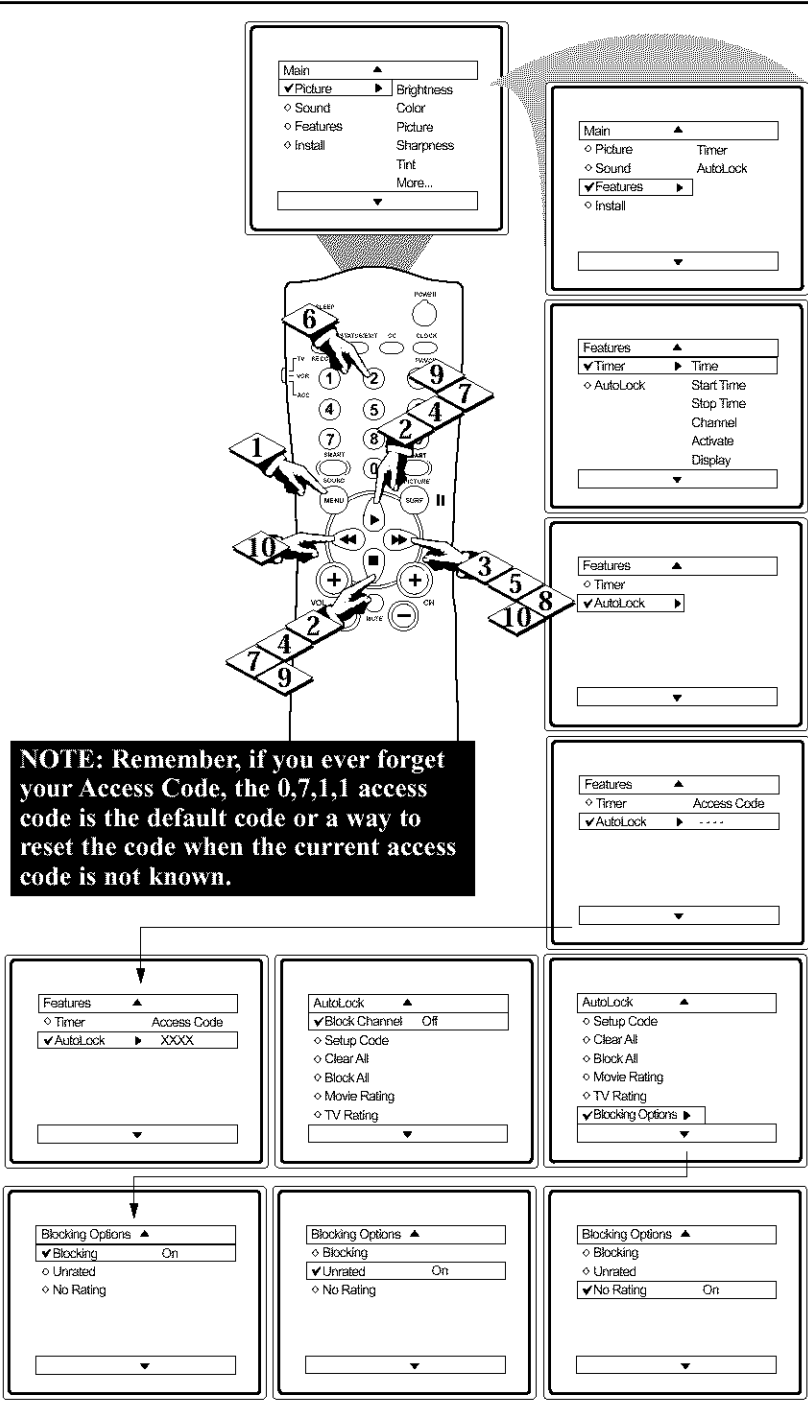

**NOTE:** Remember, if you ever forget your Access Code, the 0,7,1,1 access code is the default code or a way to reset the code when the current access code is not known.

### BLOCKING OPTIONS:

**BLOCKING:** This is what might be called the "master switch" for AutoLock. When in the ON position, ALL blocking/censoring will take place. When in the OFF position, ALL blocking is disabled.

**UNRATED:** ALL unrated programs based on the Movie Ratings or Parental (TV) Guidelines can be blocked if this feature is set to ON and the BLOCKING feature is set to OFF.

**NO RATING:** ALL programming with NO content advisory data can be blocked if this feature is set to ON and the BLOCKING feature is set to OFF.



# HOW TO USE THE CLOSED CAPTION CONTROL

**C**losed Captioning (CC) allows you to read the voice content of television programs on the TV screen. Designed to help the hearing impaired, this feature uses on-screen "text boxes" to show dialogue and conversations while the TV program is in progress.

## BEGIN

- 1** Press the **CC** button on the remote to display the current Closed Caption setting.
- 2** Press the **CC** button repeatedly to choose from the four Closed Caption options (CC Off, CC 1, CC 2, CC Mute). Dialogue (and descriptions) for the action on the captioned TV program will appear on-screen if the tuned program is broadcasting CC information.
- 3** When finished, press the **STATUS /EXIT** button to remove the menu from the TV's screen or let the option time out and disappear from the TV screen.



**SMART HELP**

Not all TV programs and product commercials are made with Closed Caption (CC) information included. Neither are all Closed Caption modes (CC 1, or CC 2) necessarily being used during the transmission of a closed caption program. Refer to your area's TV program listings for the stations and times of Closed Caption shows.

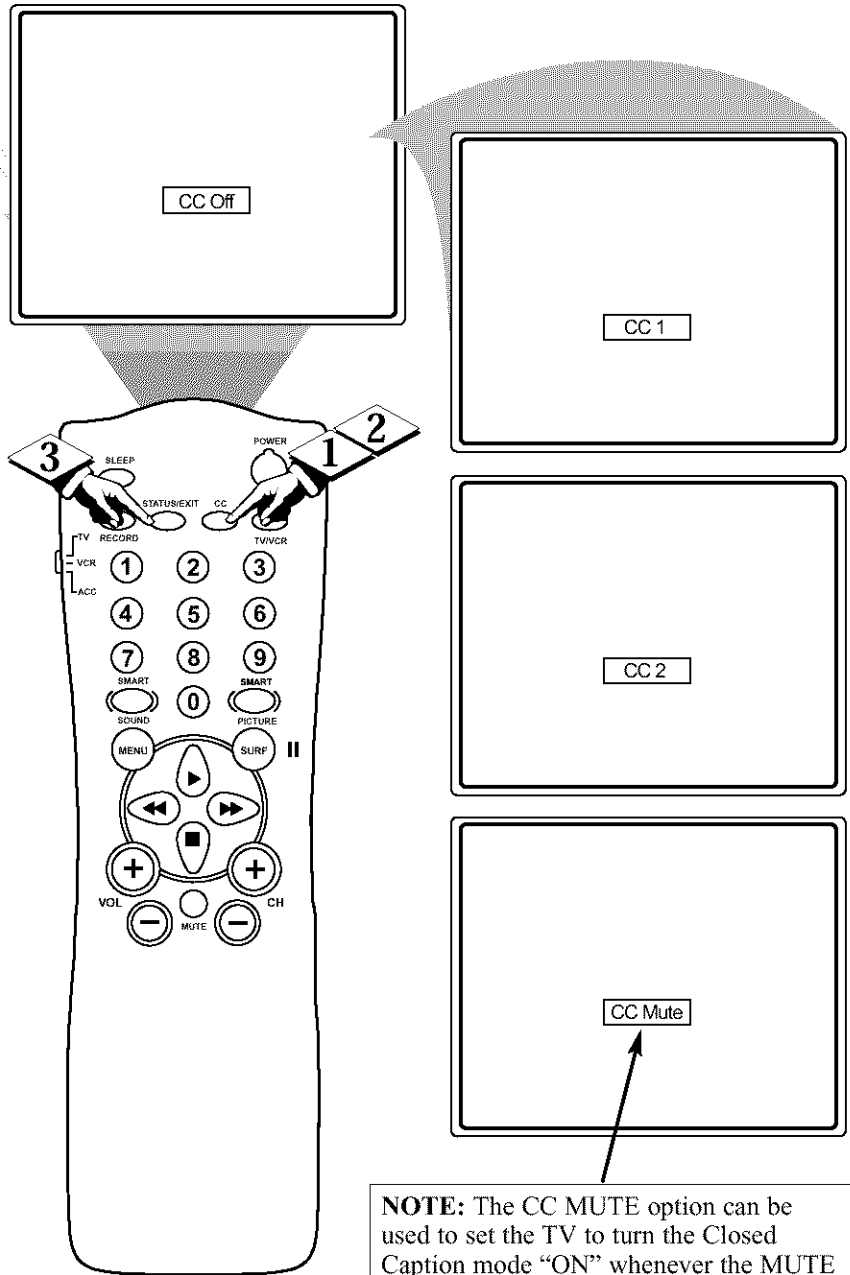

**NOTE:** The CC MUTE option can be used to set the TV to turn the Closed Caption mode "ON" whenever the MUTE button on the remote is pressed. This activates the CC1 option.

# USING THE AUDIO/VIDEO INPUT JACKS



The TV's Audio/Video Input jacks are for direct picture and sound connections between the TV and a VCR (or similar accessory device) that has Audio/Video Output jacks.

## BEGIN

- 1** Connect one end of the VIDEO (yellow) CABLE to the AV1 in VIDEO jack on the back of the TV. Then connect one end the AUDIO (red and white) CABLES to the AV1 in AUDIO L and R(left and right) jacks on the rear of the TV.
- 2** Connect other end of the VIDEO (yellow) CABLE to the VIDEO OUT jack on the back of the VCR. Then connect the other ends of the AUDIO (red and white) CABLES to the AUDIO (left and right) OUT jacks on the rear of the VCR.
- 3** Turn the VCR and the TV ON.
- 4** Press the CH + or - buttons on the remote to scroll the channels until AV1 appears in the upper left corner of the TV screen.
- 5** Slide the TV/VCR/ACC switch to the VCR position.
- 6** Now your ready to place a prerecorded video tape in the VCR and press the PLAY ► button.

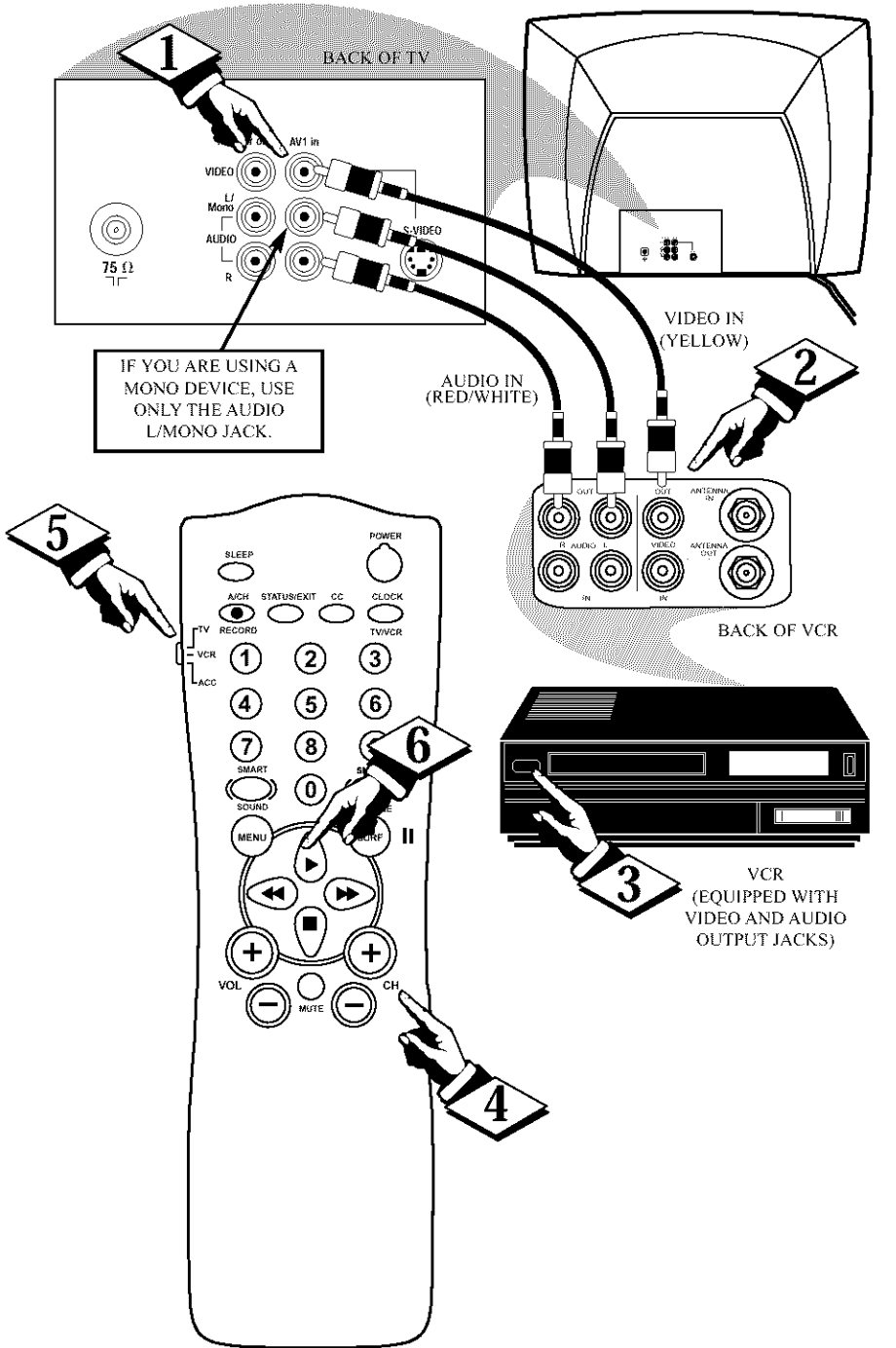



# USING THE AUDIO/VIDEO (MONITOR) OUTPUT JACKS

The Audio/Video (Monitor) Output jacks are great for recording with a VCR or used to connect an external audio system for better sound reproduction.

## BEGIN

**1** For an external audio system, connect one end of the R(ight) and L(ef) AUDIO (Monitor Out) jacks on the TV to the R and L audio input jacks on your amplifier or sound system. Set the audio system's volume to a normal listening level.

**2** Turn the TV and audio system ON. You can hear TV sound coming from the audio system. Adjust the volume at the audio system to a comfortable listening level.

To connect a second VCR for recording:

**3** Connect one end of the yellow Video Cable to the Monitor Out VIDEO plug. Connect the other end to the VIDEO IN plug on the second VCR.

**4** Connect one end of the red and white Audio cable from the Monitor Out AUDIO L and R plugs on the TV to the AUDIO IN plugs on the VCR.

**5** Turn the VCR ON, insert a blank VHS tape and it's ready to record what's being viewed on the TV screen.



IF YOU ARE USING A MONO DEVICE, USE ONLY THE AUDIO L/MONO JACK.

### For Stereo System:

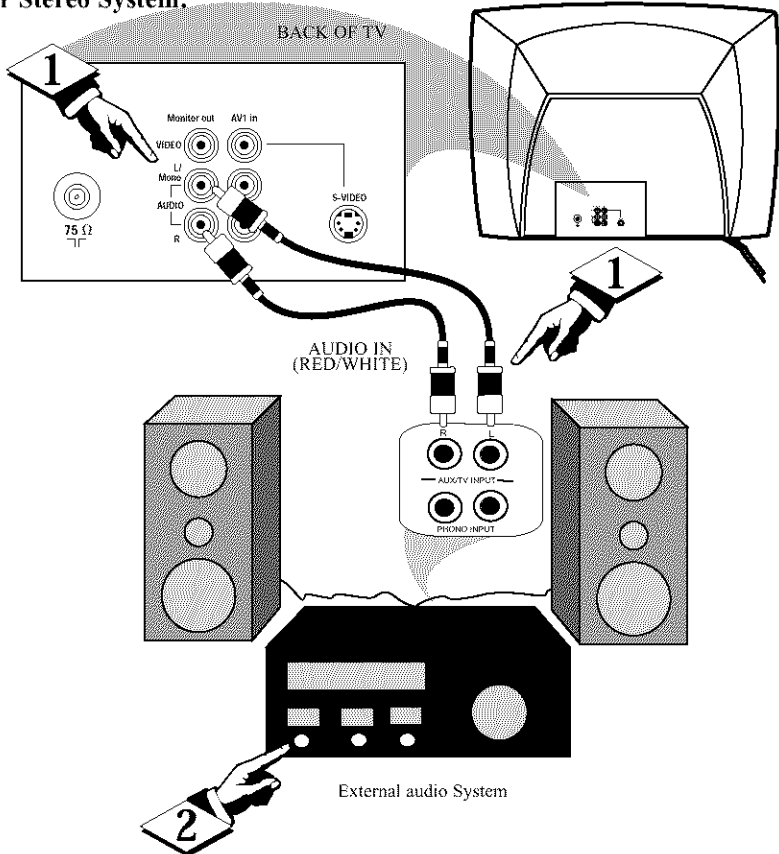

### For Second VCR:

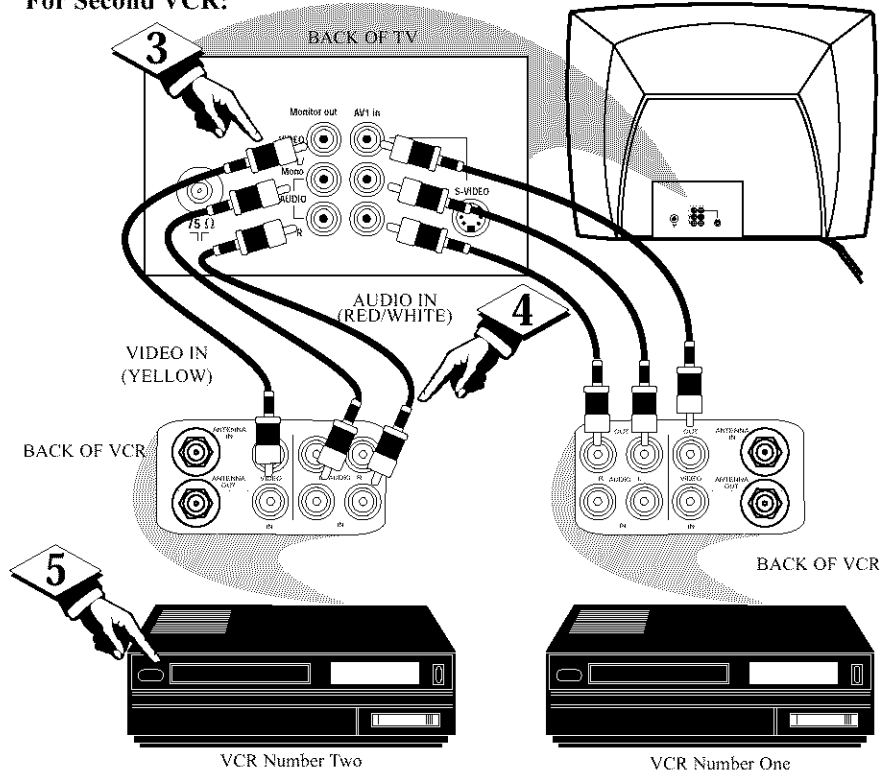



# USING THE S-VIDEO INPUT JACKS



The S(uper)-Video connection on the rear of the TV can provide you with better picture detail and clarity for the playback of accessory sources such as DBS (digital broadcast satellite), DVD (digital video discs), video games, and S-VHS VCR (video cassette recorder) tapes than the normal antenna picture connections.

**NOTE:** The accessory device must have an S-VIDEO OUT(put) jack in order for you to complete the connection on this page.

## BEGIN

- 1** Connect one end of the S-VIDEO CABLE to the S-VIDEO jack on the back of the TV. Then connect one end the AUDIO (red and white) CABLES to the AV1 in AUDIO L and R(left and right) jacks on the rear of the TV.
- 2** Connect other end of the S-VIDEO CABLE to the S-VHS (S-Video) OUT jack on the back of the VCR. Then connect the other ends of the AUDIO (red and white) CABLES to the AUDIO (left and right) OUT jacks on the rear of the VCR.
- 3** Turn the VCR and the TV ON.
- 4** Press the CH + or - buttons on the remote to scroll the channels until SVHS appears in the upper left corner of the TV screen.
- 5** Slide the TV/VCR/ACC switch to the VCR position.
- 6** Now your ready to place a pre-recorded video tape in the VCR and press the PLAY ► button.



## SMART HELP

The S-VIDEO and VIDEO AV1 in(puts) are in parallel. The S-VIDEO input is dominant when in use. If separate video signals are connected to the S-VIDEO and VIDEO AV1 in(put), the signal from the VIDEO AV1 in(put) will not be usable.

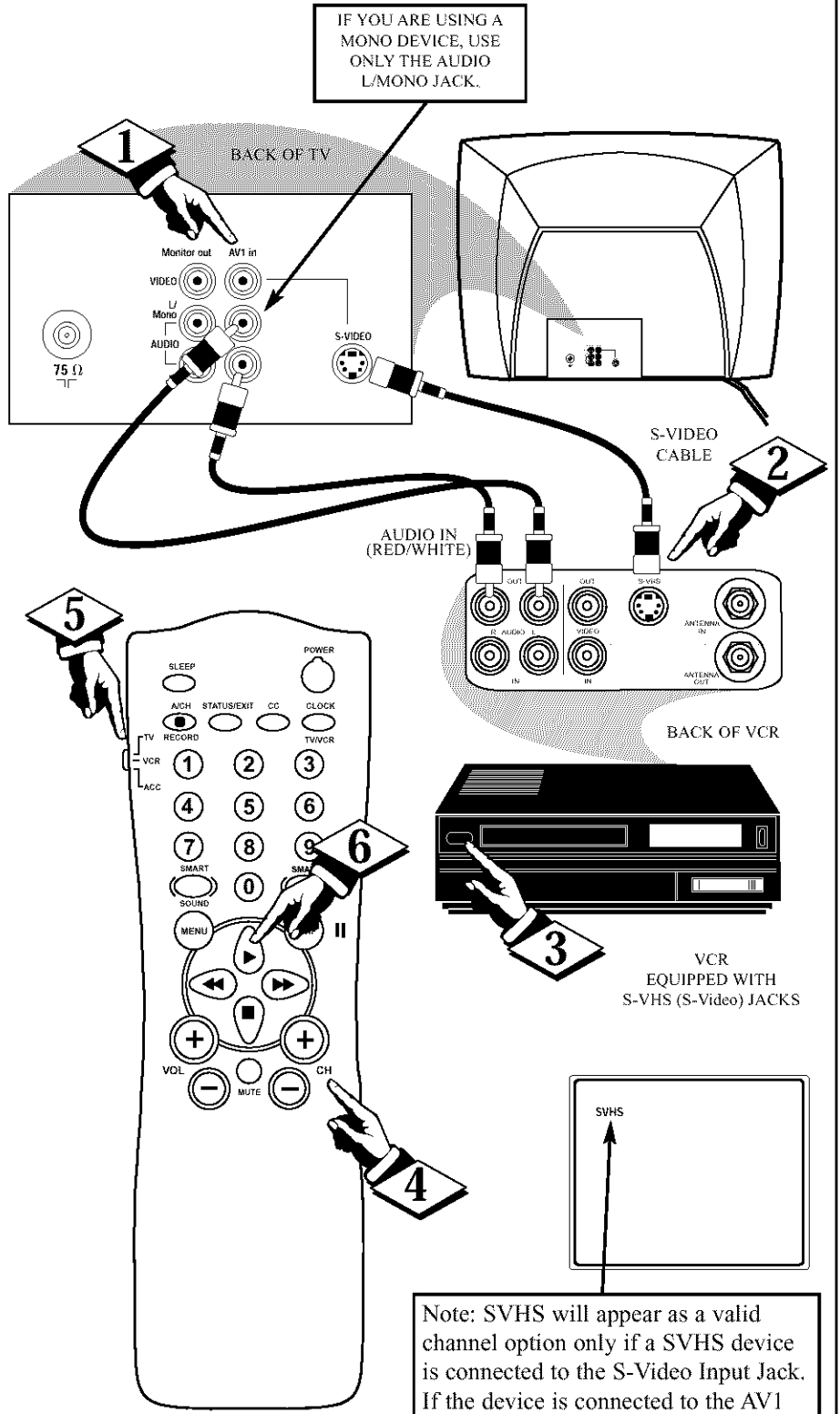

Note: SVHS will appear as a valid channel option only if a SVHS device is connected to the S-Video Input Jack. If the device is connected to the AV1 Video In, the channel will appear as AV1.



# SETTING UP THE SLEEPTIMER OPTION

*Have you ever fallen asleep in front of the TV only to have it wake you up at two in the morning with a test pattern screeching in your ears? Well, your TV can save you all that trouble by automatically turning itself off.*

## BEGIN

- 1 Press the **SLEEP** button on the remote control and the SLEEP timer display will appear on the screen.
- 2 Press the **SLEEP** button repeatedly to pick the amount of time (15, 30, 45, 60, 90, 120, 180, or 240 minutes) before the TV will turn itself off.

An on-screen count down will appear during the last minute before the TV shuts itself off.

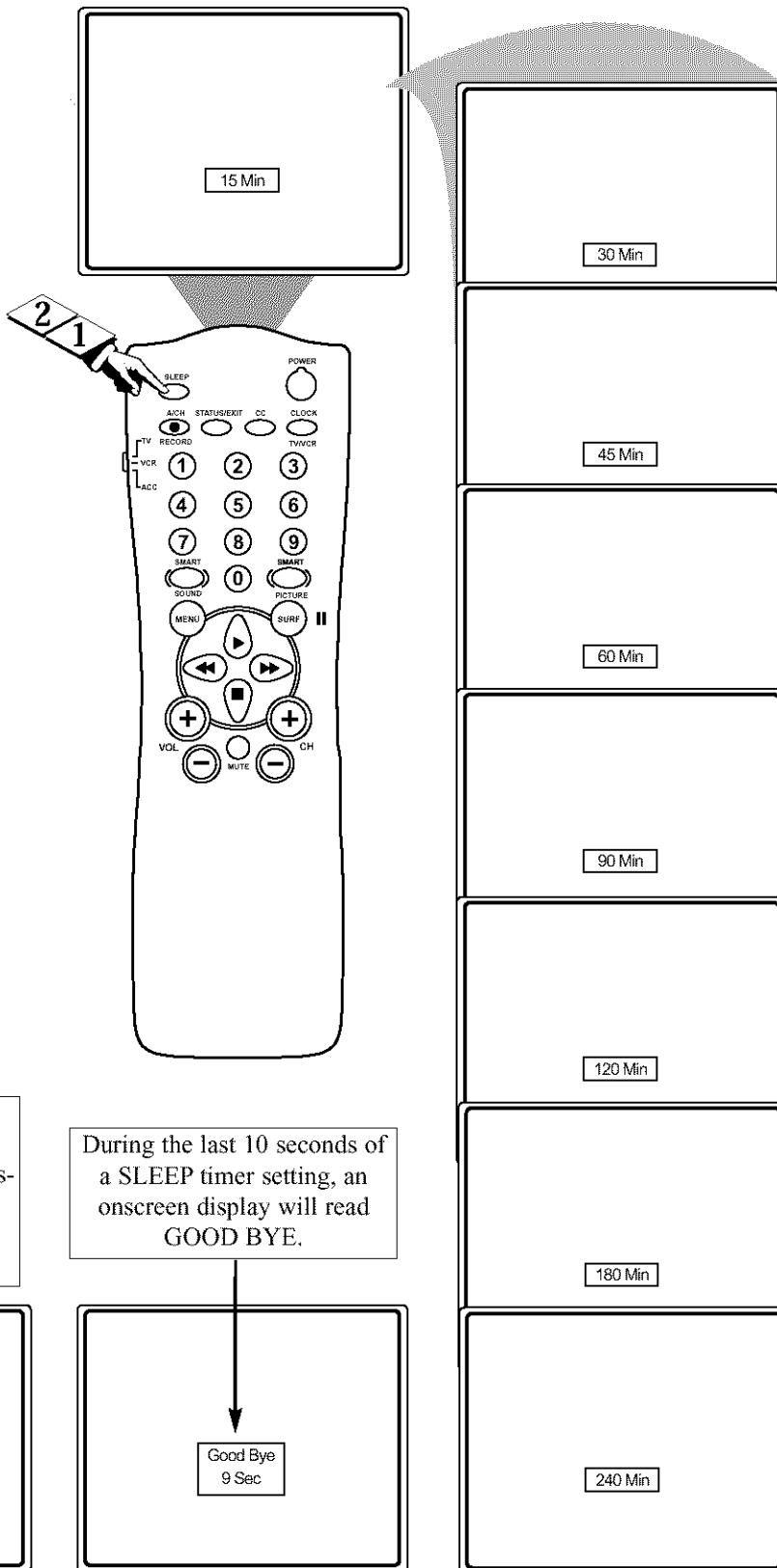

## SMART HELP

The on-screen menu will time out and disappear from the screen when you finish, or you can press the STATUS/EXIT button to clear the menu from the screen.

After a Sleptimer setting has been made, pressing the STATUS/EXIT button will display the remaining time before the TV will shut itself off.

During the last minute of a SLEEP timer setting, an on-screen count down will be displayed. Pressing any button during the last minute will cancel the SLEEP timer.

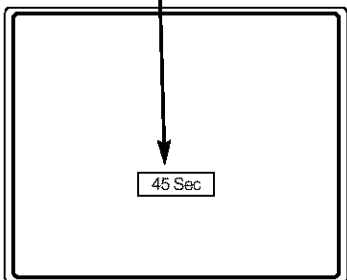

During the last 10 seconds of a SLEEP timer setting, an onscreen display will read GOOD BYE.

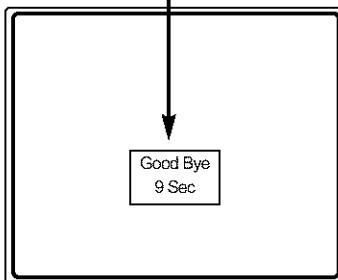

# SETTING THE AUTO PICTURE CONTROL



Whether you're watching a movie or a sporting event, your TV has automatic video control settings matched for your current program source or content. The Auto Picture feature quickly resets your TV's video controls for a number of different types of programs and viewing conditions you may have in your home. Each Auto Picture setting is preset at the factory to automatically adjust the TV's Brightness, Color, Picture, Sharpness, Tint, Color Temperature, DNR and Contrast+ levels.

## BEGIN

**1** Press the **AUTO PICTURE** button on the remote control. The current Auto Picture setting will appear in the middle of the screen.

**2** Press the **AUTO PICTURE** button repeatedly to select either **PERSONAL**, **MOVIES**, **SPORTS**, **WEAK SIGNAL**, or **MULTI MEDIA** picture settings.

**Note:** The **PERSONAL** setting is the setting that you setup using the **PICTURE** options within the on-screen menu. This is the only Auto Picture setting that can be changed. All other settings are setup at the factory during the time of production.

**MOVIES** - Preset picture options for watching Video Tapes, or DVDs.

**SPORTS** - Preset picture options for watching sporting events.

**WEAK SIGNAL** - Preset picture options for watching programs where the reception is not at its best.

**MULTI MEDIA** - Preset picture options for use with video gaming.

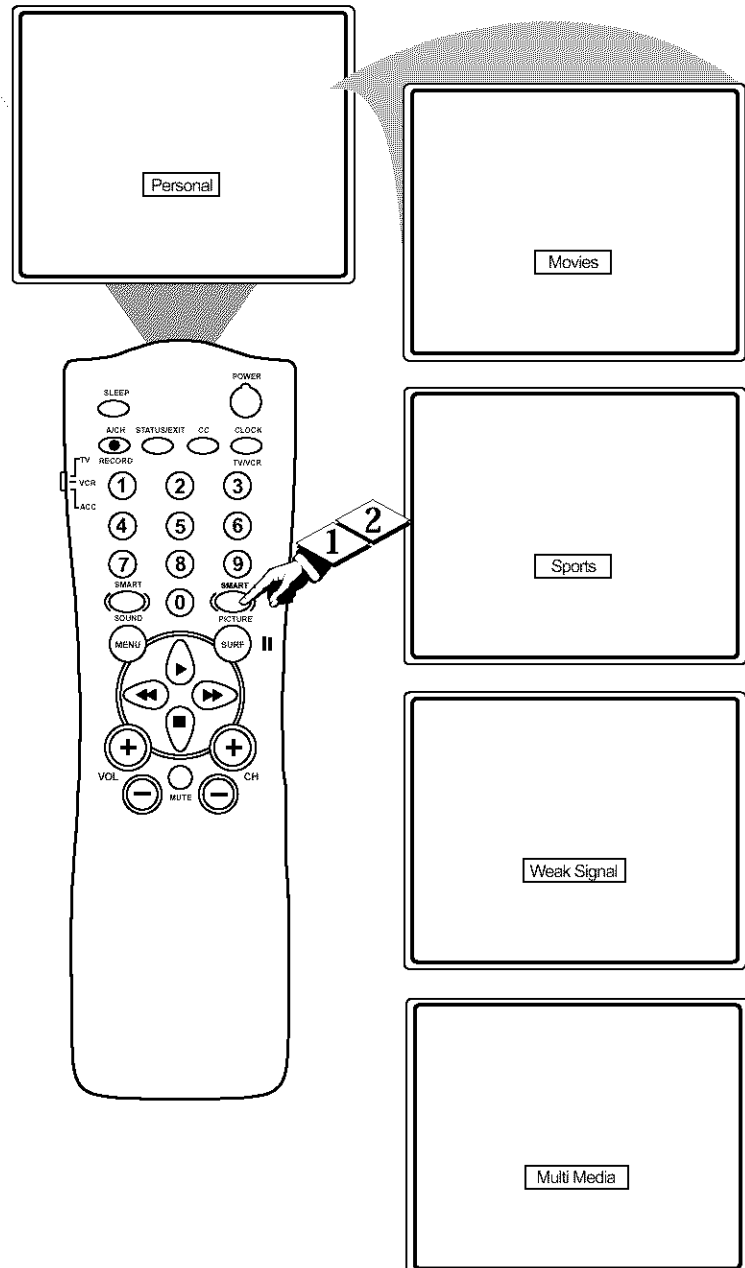



# SETTING THE AUTO SOUND CONTROL

*The Auto Sound feature allows the listener to select between four different factory set sound options. Personal (which can be set by the user), Theatre (for movie viewing), Music (for musical type programming) and Voice (when the program is mainly dialogue). These settings affect the Sound menu's Bass, Treble, AVL, and Incredible Surround controls*

*To select any of the options follow the directions below.*

## BEGIN

- 1** Press the **AUTO SOUND** button on the remote control. The current Auto Sound setting will appear in the middle of the screen.
- 2** Press the **AUTO SOUND** button repeatedly to toggle between the four settings.

**Note:** Only the **PERSONAL** control can be changed by the viewer. This changes the settings in the main on-screen menu's sound controls.

**THEATRE** - Preset sound options for watching movies.

**MUSIC** - Preset sound options for musical programming where there is little dialogue.

**VOICE** - Preset sound options for programming where heavy dialogue is present.

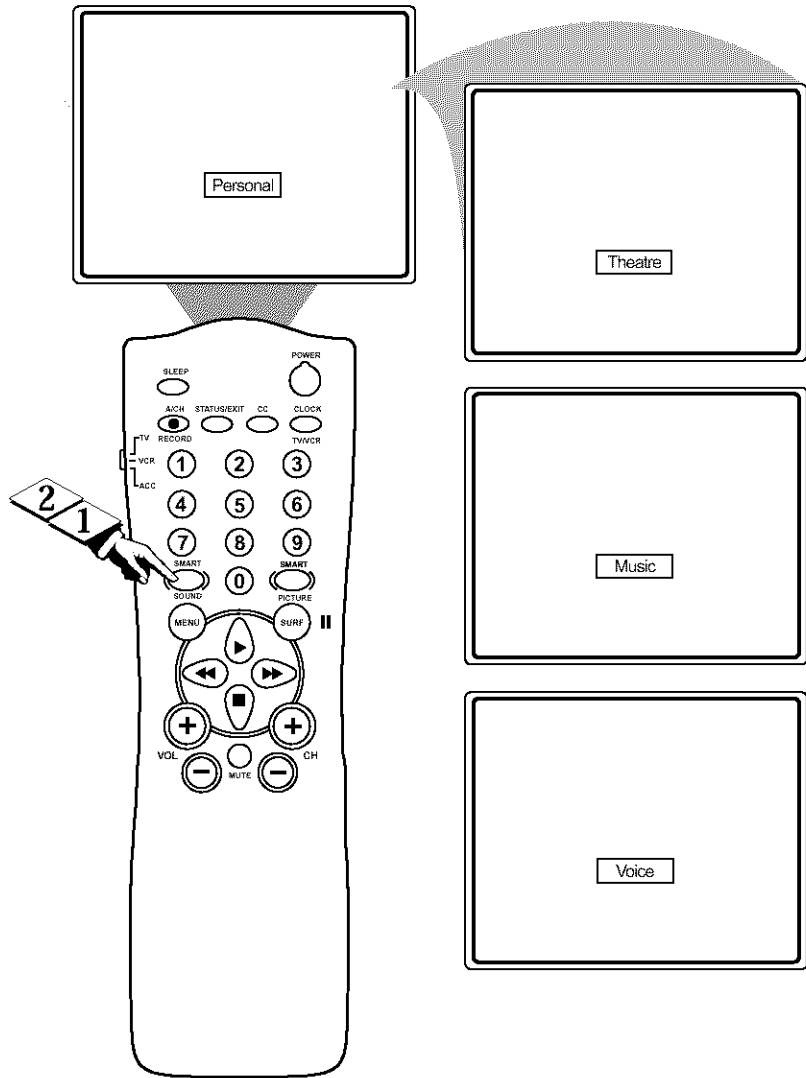

# USING THE SURF BUTTON (AND THE ALTERNATE CHANNEL BUTTON)



A "list" or series of previously viewed channels can be selected using the SURF button on your remote control. With this feature you can easily switch between different TV programs that currently interest you. The SmartSurf control allows you set up to 8 channels in its quick viewing "list".

## BEGIN

- 1 Press the CHANNEL (+) or (-) buttons (or the NUMBER buttons) to select a channel to add to the SURF list.
- 2 Press the SURF button on the remote. The channel number will be displayed with the word ADD to the right.
- 3 Press the CURSOR RIGHT button to ADD the channel to the Surf list. The display will change from ADD to DELETE.

Repeat steps 1 through 3 to add additional channels (up to 8) to the SURF list. As soon as a ninth channel is added, the first channel in the list will be removed.

### How to select Surf channels:

- 4 Press the Surf button on the remote control.
- 5 Press the CURSOR UP or CURSOR DOWN button to scroll the list of up to 8 channels. As you scroll to a channel the TV will tune to that channel.

### To remove a channel from the SURF list:

Follow steps 4 and 5 to select a channel in the Surf list.

- 6 While the Surf Channel List is still displayed on the screen, press the CURSOR RIGHT button to DELETE the channel from the list. The display will change from DELETE to ADD.

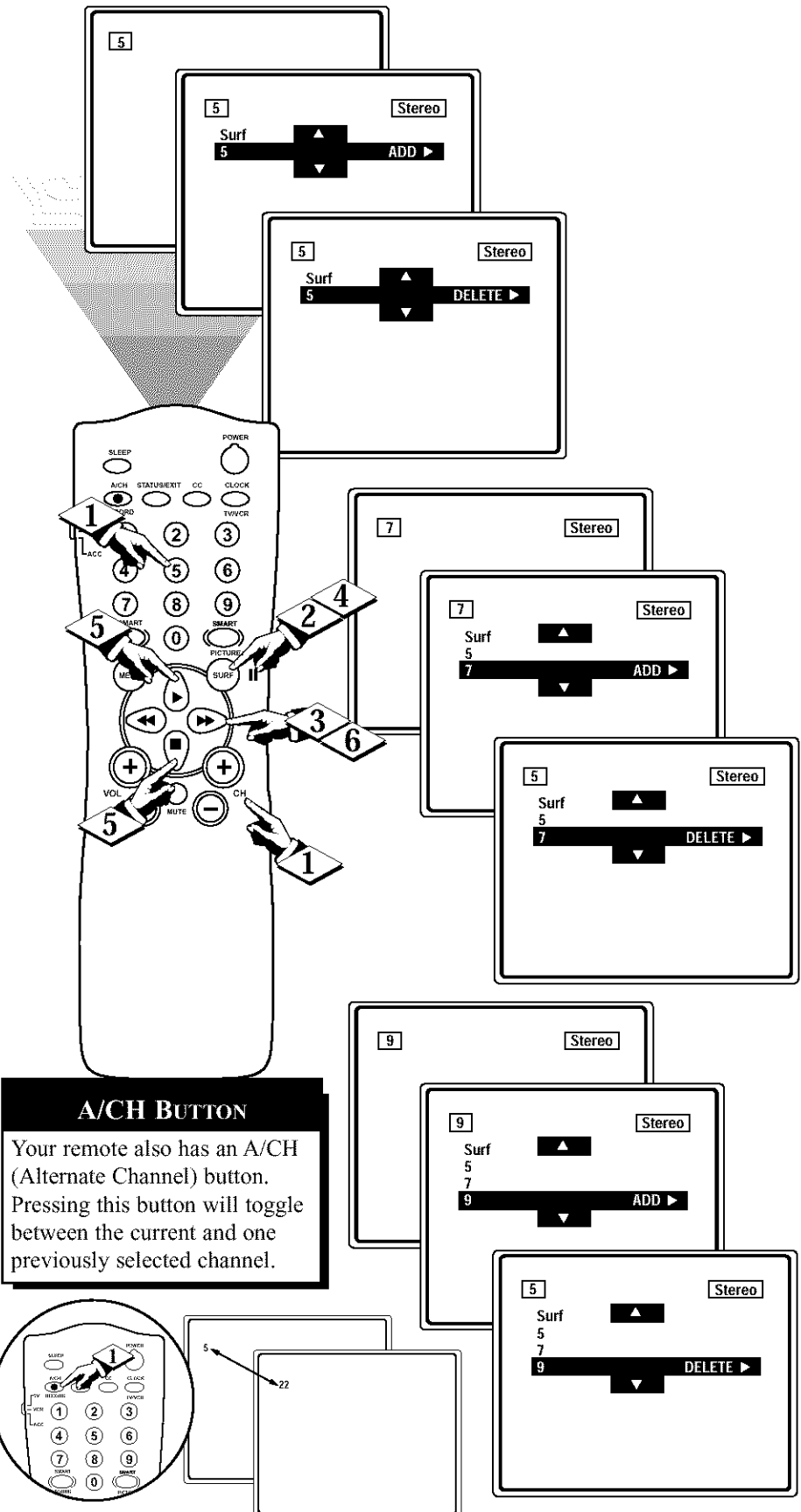



# REMOTE USE WITH ACCESSORY DEVICES - DIRECT METHOD

Your remote control is set to work your TV and many infrared remote (IR) control VCRs, Cable Boxes, Satellite Systems, DBS, DVD, etc. However, an easy onetime step may be necessary before the remote will work your VCR.

Try this initial check to see if going on to the following section is necessary.

## BEGIN

- 1 Place the TV/VCR/ACC Mode Switch in the proper position.
- 2 Point the remote control at the device and press the POWER button.
- 3 Does the remote turn the device ON?

If YES, stop and try other function buttons on the remote. If they also work the device, then the remote is ready and no further steps are needed.

If NO, continue...

- 1 First look up a **THREE-DIGIT remote control number** for your brand of Device before going through the simple steps on the following page.

Find your Three-Digit Code on pages 33-34.

## SMART HELP



Remember, if more than one number is listed, you may have to try more than the first Three-Digit code given in order to locate your Device's remote code.

**NOTE:** Setting up the remote is for use with external accessory devices only and not for use with other television brands.

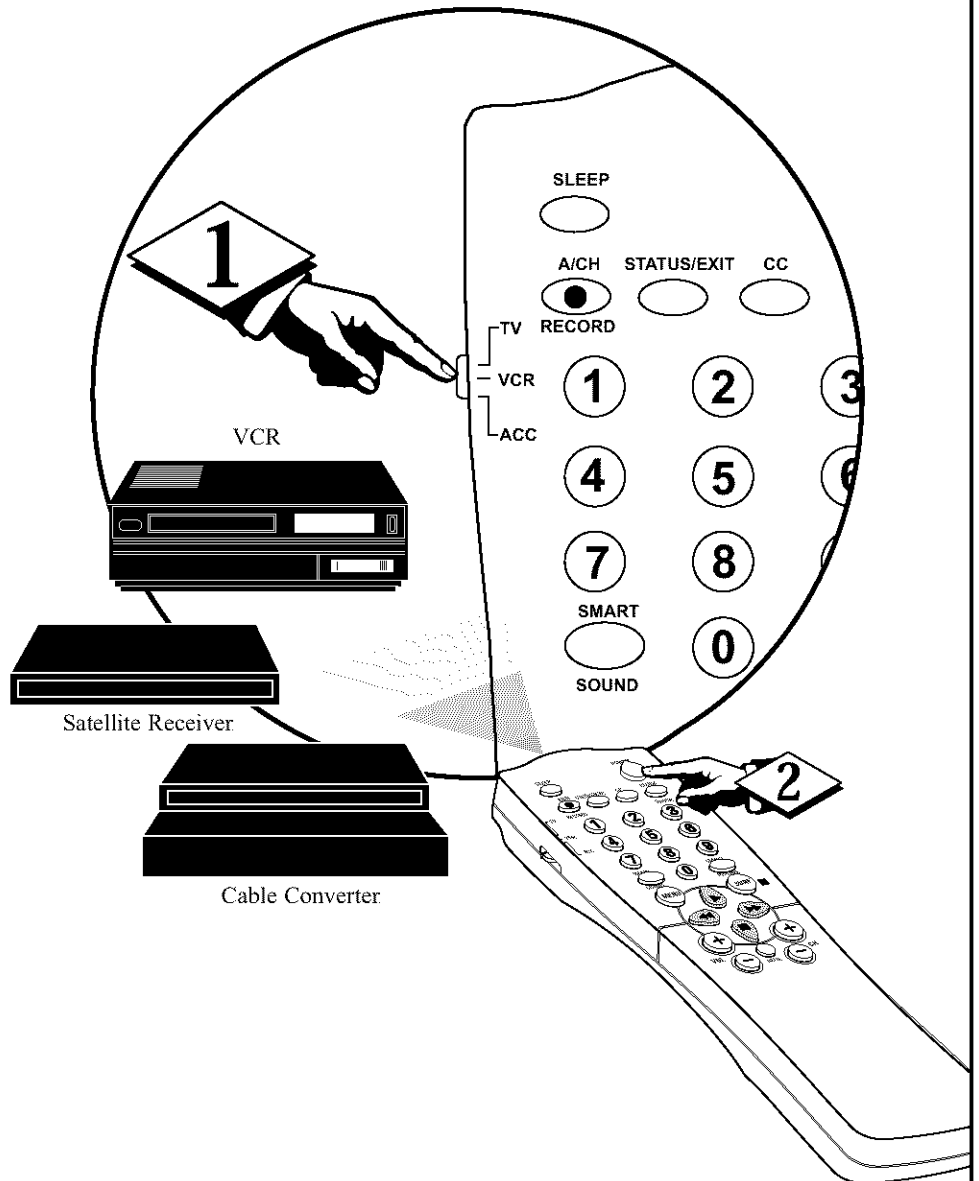



## Direct Access Method

Now that you have looked up the three-digit Remote Code Number for your brand of device, you are ready to follow the four simple steps below.

Please read through steps 1-4 before beginning.

### BEGIN

- 1 Place the TV/VCR/ACC Mode Switch in the proper position.
- 2 Press the VCR RECORD button on the remote control and release.
- 3 Press the SmartSound button on the remote within 30 seconds, then release.
- 4 Enter the THREE-DIGIT REMOTE CODE NUMBER for your desired device. The remote is now ready to send commands to the unit.
- 5 Point the remote at the Device. Press the POWER button on the remote to turn the unit ON.



## SMART HELP

Remember, if this doesn't work the first time, repeat steps using the same remote code number.

After a second try and the remote does not operate your device, see if there is another three-digit code number (pages 33-34) listed for your device and repeat the steps above using the new number.

If after repeated attempts the code number method does not work you device, try the **SEARCH METHOD** on the next page.

**NOTE:** Setting up the remote is for use with external accessory devices only and not for use with other television brands.

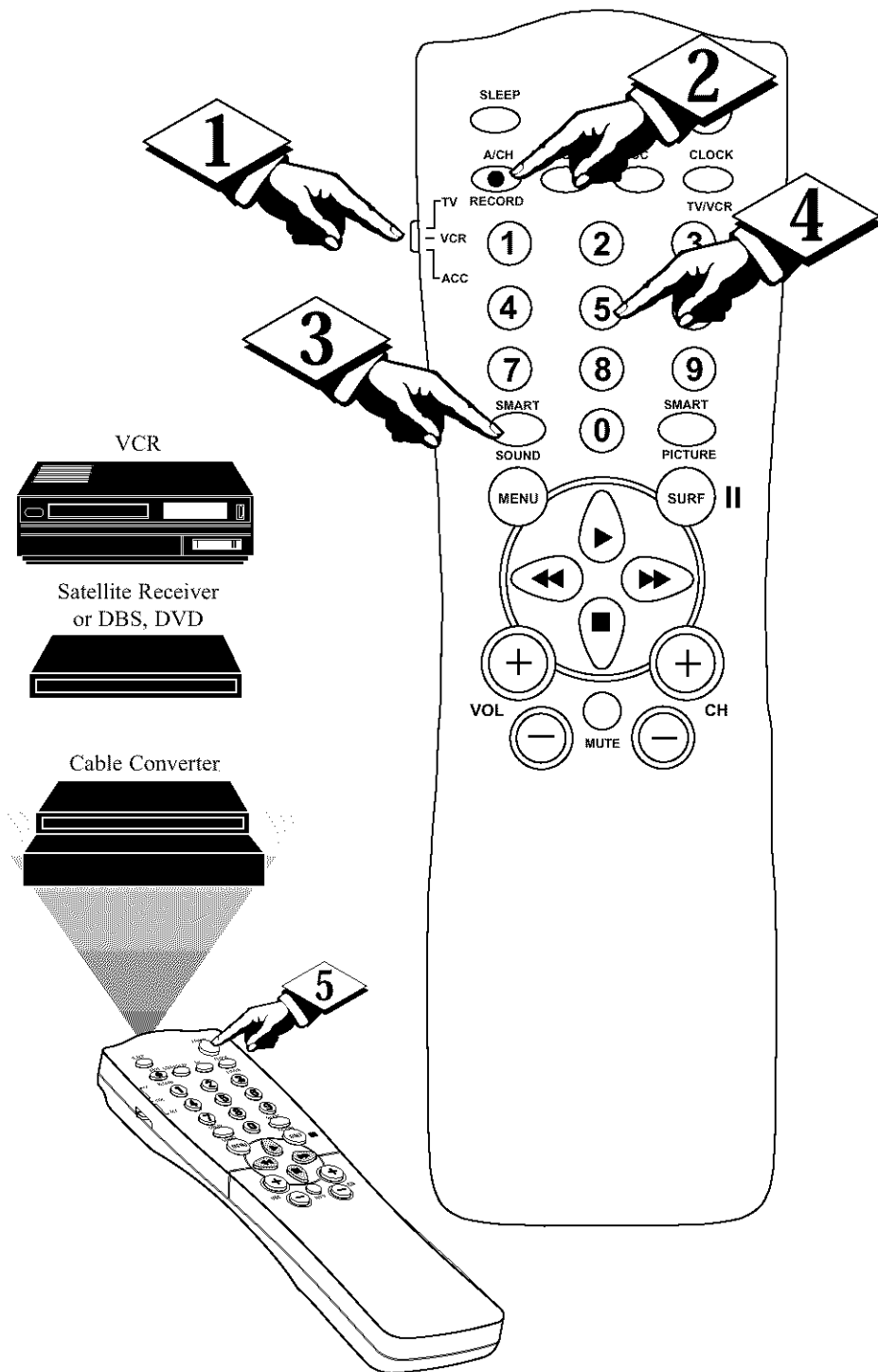



# REMOTE USE WITH ACCESSORY DEVICES - SEARCH METHOD

## Search Method

Your TV remote can be set to work various external devices such as VCRs, Cable Boxes, Satellite Receivers, DBS, DVD, etc. by what is called the search method of remote control programming.

If the "Remote Code" number method shown on the previous page did not set your remote to work your external device, then follow the easy steps listed below.

Please read steps 1-4 before beginning.

### BEGIN

- 1 Press the **POWER** button on the device you are attempting to program to turn it ON.
- 2 Place the **TV/VCR/ACC Mode Switch** in the proper position.
- 3 Press the **(A/CH) • RECORD** and the **SMART SOUND** buttons simultaneously and hold them down.
- 4 The device will begin to change channels after the remote identifies the correct code. When the channels start to change release the **VCR RECORD** and **SMART SOUND** buttons. The remote should be ready to operate the device.



## SMART HELP



This method can take up to two minutes to perform.

Don't let the device scan up more than five channels. If you do the remote may pass up the right code and another two minute search cycle will have to be repeated.

If no channel change happens within two minutes, repeat steps 1-4. Should a channel change still not occur, the remote will not work the desired device.

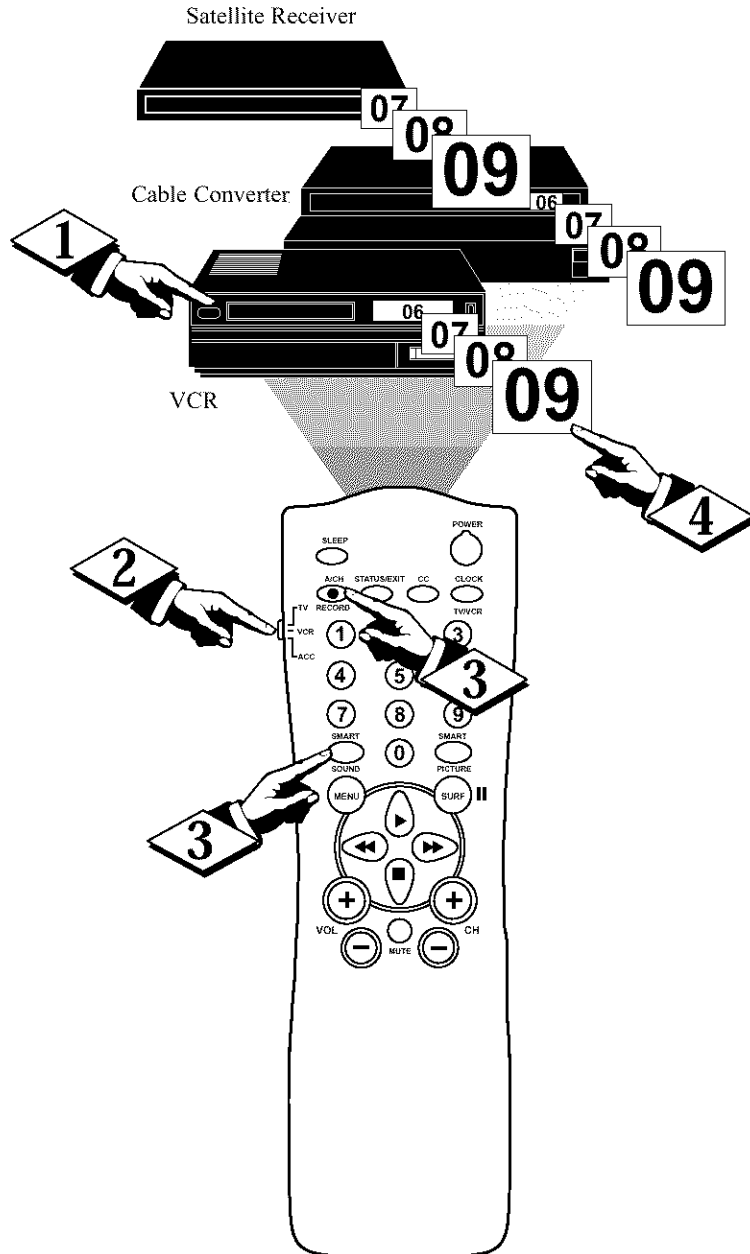

**NOTE:** Setting up the remote is for use with external accessory devices only and not for use with other television brands.



# REMOTE CONTROL DIRECT ENTRY CODES



<u>VCR</u>	<u>REMOTE CODE NO.</u>
Admiral	.048
Advantz	.358
Adventure	.000
Aiko	.278
Aiwa	.000, 037, 307, 348, 352
Akai	.041, 049, 053, 061, 106, 315
Alba	.352
Amercian High	.035
Amstrad	.325, 332
Asha	.240
Audiovox	.037
Baird	.107
Beaumarck	.240
Bell & Howell	.104
Blaupunkt	.003, 006, 154
Brandt	.187, 320, 321
Broksonic	.121, 184, 211, 295, 361
Bush	.352
CCE	.072, 278
Calix	.037
Canon	.035
Capehart	.020
Carver	.081, 146
Citizen	.037, 278
Colt	.072
Combitach	.352
Craig	.037, 047, 072, 240, 271
Curtis Mathes	.035, 041, 060
Cybermax	.051, 240
Daewoo	.020, 045, 276
Daytron	.020
Denon	.042
Dynatech	.000
Electroponic	.037
Emerex	.032
Emerson	.000, 002, 036, 037, 043, 061 .068, 088, 121, 164, 208, 209, .211, 212, 278, 295, 361, 479
Ferguson	.107, 320, 321
Fisher	.047, 054, 066, 104
Fuji	.033, 035
Funai	.000
GE	.035, 060, 065, 202
Garrard	.000
Go Video	.232, 279, 432
Gold Star	.037, 038
Gradiente	.000, 406
Grundig	.003, 007, 195, 347
HI-Q	.047
Harley Davidson	.000
Harman/Kardon	.038, 075
Harwood	.068, 072
Headquarter	.046
Hinari	.004, 352
Hitachi	.000, 004, 041, 042, .065, 105, 168, 235
Ingersol	.004
JVC	.008, 041, 067, 208, 384, 486
Jensen	.041
KEC	.037, 278
KLH	.072
Kenwood	.038, 041, 067, 384
Kodak	.035, 037
LXI	.037
Lloyd's	.000, 206

<u>VCR</u>	<u>REMOTE CODE NO.</u>
Loewe	.004
Logik	.004, 072
MEI	.035
MGA	.043, 061
MGN Technology	.240
MTC	.000, 240
Magnavox	.000, 035, 081, 146, 181
Marta	.037
Matsui	.004, 348, 352
Matsushita	.035, 162, 454
Memmorex	.307
Memorex	.000, 035, 037, 039, 046, .047, 048, 104, 240, 266, 307
Metz	.003, 347
Minolta	.042, 105
Mitsubishi	.043, 061, 067, 075, 173, 443
Motorola	.035, 048
Multitech	.000, 072
NAD	.058
NEC	.036, 040, 041, 067, 104
Nikko	.037
Nikon	.034, 253
Noblex	.240
Nordmende	.297, 320, 321
Okano	.346
Olympus	.035, 226
Optimus	.037, 048, 058, 104, .162, 432, 454
Optonica	.062
Orion	.004, 295, 348, 352, 479
Panasonic	.035, 077, 162, 225, .226, 378, 454
Penney	.035, 037, 038, 040, .042, 065, 105
Pentax	.042, 065, 105
Philco	.035
Philips	.035, 062, 081, 110, 403
Pilot	.037
Pioneer	.058, 067
Portland	.020
Profax	.322
Profitronic	.240
Protec	.072
Pulsar	.039, 051
Quarter	.046
Quartz	.046
Quasar	.035, 077, 162, 454
RCA	.042, 060, 065, 077, .105, 106, 149, 202
Radio Shack	.000, 037
Radix	.037
Randex	.037
Realistic	.000, 035, 037, 045, 047 .048, 062, 066, 104
Ricoh	.034, 253
Runco	.039
SEG	.322
SEI	.004
STS	.042
Saba	.297, 320, 321
Saisho	.004
Salora	.075
Samsung	.045, 051, 053, 240
Sanky	.039, 048
Sansui	.000, 041, 067, 271

<u>VCR</u>	<u>REMOTE CODE NO.</u>
Sanyo	.046, 047, 104, 240, 268
Saville	.352
Scott	.043, 045, 121, 164, 211, 212
Sears	.000, 035, 037, 042, 046, .047, 054, 066, 104, 105
Sharp	.046, 062
Shintom	.072
Shogun	.051, 240
Shoral	.004
Siemens	.003
Singer	.072
Sinudyne	.004
Sony	.000, 011, 022, 032, 033, .034, 035, 253, 275
Sunkel	.348
Sunpak	.253
Sylvania	.000, 035, 043, 081, 103, 110
Symphonic	.000
TMK	.036, 208, 240
Tatung	.041
Teac	.000, 041
Technics	.035, 162
Teknika	.000, 035, 037
Telefunken	.187, 320, 321
Tansal	.322
Thomas	.000
Thomson	.320
Toshiba	.043, 045, 066, 212, 366
Totavision	.037, 240
Towada	.322
Unitech	.240
Universum	.325
Vactor	.045
Vactor Research	.038, 040
Video Concepts	.040, 045, 061
Videosonic	.240
Wards	.000, 035, 042, 047, 048, 060, 062, .072, 081, 149, 161, 212, 240
XR-1000	.000, 035, 072
Yamaha	.038
Zenith	.000, 033, 034, 039

<u>CABLE CONVERTOR</u>	<u>REMOTE CODE NO.</u>
ABC	.001, 003, 007, 008, .011, 013, 014, 017
Aliegio	.153
Andover	.544
Antronix	.022
Archer	.022, 153
Balcor	.056
British Telecom	.105
Cable Star	.056
Cablatenna	.022
Cabletime	.161, 271, 377, 448
Cableview	.022
Century	.153
Citizen	.153
Clyde	.086
Colour Voice	.025, 031
Comtec	.274
Comtronics	.040
Contec	.019
Cryptovision	.600
Deceat	.423



# REMOTE CONTROL DIRECT ENTRY CODES

<u>CABLE CONVERTOR</u>	<u>REMOTE CODE NO.</u>
Eastern	.002, 274
Everquest	.015, 040
Filmnet	.443
Focus	.400
France Telecom	.451
GC Electronics	.056
GEC	.086
Ganard	.153
Gemini	.015, 070, 242
General Instrument	.011, 276, 476
Gold Star	.040
Grundig	.529
Hamlin	.009, 020, 034, 259
Hitachi	.011
Hytex	.007
Jasco	.153
Jerrold	.003, 011, 012, 014, .015, 024, 276, 476
M.N.E. T.	.443
MNet	.443
Macon	.033
Magnavox	.027, 032, 334
Memorex	.000
Movie Time	.063
NSC	.063, 070
Oak	.007, 019
Optimus	.021
Panasonic	.000, 021, 107
Paragon	.000
Philips	.025, 027, 031, 153, 242, 290, 334
Pioneer	.533, 753
Popular Mechanics	.400
Pulsar	.000
RCA	.021
Radio Shack	.015
Recoton	.400
Regal	.020, 259
Regency	.002
Rembrandt	.011, 070
Runco	.000
SL Marx	.040
Salora	.382
Samsung	.040
Satbox	.375
Scientific Atlanta	.008, 017, 477
Signal	.015, 040
Signature	.011
Sprucer	.021
Star Sight	.542
Starcom	.003, 015
Stargate	.015, 040
Starquest	.015
Sylvania	.001
TV85	.063
Tandy	.258
Tele+1	.443
Teleservice	.281
Teleview	.040
Texscan	.001
Timeless	.274
Tocom	.012, 013, 059
Toshiba	.000
Tudl	.286
Tusa	.015
Unike	.022, 153

<u>CABLE CONVERTOR</u>	<u>REMOTE CODE NO.</u>
United Artists	.007
United Cable	.003
Universal	.022, 056, 153, 191
Videoway	.250
Viewstar	.027, 063, 258
Visi Cable+	.461
Westminster	.105
Wolsey Gaine	.544
Zenith	.000, 054, 525
Zentek	.400

<u>DBS</u>	<u>REMOTE CODE NO.</u>
Alpha Star	.772
Echostar	.775
HTS	.775
Hitachi	.819
Hughes Network System	.749
Jerrold	.627
Magnavox	.722, 724
Memorex	.724
Panasonic	.701
Philips	.722, 724
Primestar	.627
RCA	.566
Sony	.639
Toshiba	.790
Uniden	.724

<u>Satellite</u>	<u>REMOTE CODE NO.</u>
AST	.351
Akai	.515
Alba	.352, 515, 613
Aldea	.288
Amstrad	.080, 252, 345, 461, 509, 689
Ankaro	.220, 288, 369
Anitron	.183
Armstrong	.243
Astra	.108
Avalon	.396
Axis	.369
BT	.515, 668
Beko	.189
Best	.369
Boca	.243, 513
Bush	.067
Cambridge	.344, 515
Channel Master	.362
CommLink	.288
Connexions	.396
Conrad	.607
Crown	.243
DDC	.362
DNT	.396
Echostar	.396
Ferguson	.067, 183, 189, 336
Fidelity	.252
Finlux	.108, 397
Fuba	.369, 396
G-Bat	.183
Galaxis	.286
Gooding	.571
Grundig	.173, 189, 571, 750
Hinari	.183

<u>Satellite</u>	<u>REMOTE CODE NO.</u>
Hirschmann	.397, 573
Houston	.668
Huth	.220, 243, 268
ITT	.108
Intervision	.592
JVC	.515, 571
Kathrein	.092, 504, 622, 658
La Sat	.513, 607
Lennox	.592
Lupus	.369
Luxor	.108, 573
Manhattan	.592
Maspro	.092, 336, 750
Matsui	.571
Mediamarkt	.248
Minerva	.571
Mintec	.576
Morgan's	.243, 513
Newhaus	.220
Nikko	.360, 713
Nokia	.108, 397, 573
Nordmende	.362
Orbitech	.501
Pace	.067, 183, 336, 455, 791
Paliadium	.571
Palsat	.501
Philips	.200, 292, 571, 750
Phonotrend	.288, 592
Plasmatic	.442
Proset	.288
Quadral	.362, 628
RFT	.220, 288
Radix	.396
SAT	.351, 461
SEG	.369
Saba	.336
Salora	.108
Satec	.183
Schwaiger	.183, 504
Seemann	.396, 578, 626
Skymaster	.288, 626
Sony	.704
Star Trak	.421
Strong	.421
Sunstar	.513
Tantec	.336
Techni Sat	.262, 501
Teleka	.243, 613
Tonna	.668
Triad	.351
Universum	.571
Vtech	.351
Wisi	.351, 396

<u>DVD</u>	<u>REMOTE CODE NO.</u>
Kenwood	.534
Mitsubishi	.521
Panasonic	.490
Philips	.539
Pioneer	.550
RCA	.522
Sony	.552
Toshiba	.503

# USING THE REMOTE'S VCR BUTTONS



*When using the TV remote with a VCR, first make certain it is set to control your VCR (by the REMOTE CODE or SEARCH method).*

## BEGIN

- 1 Set the TV/VCR/ACC mode switch to VCR on the remote.
- 2 Point the top of the remote toward the front of the VCR (remote sensor window) when pressing the buttons.



### RECORD BUTTON

Hold the (A/CH) • RECORD button down to begin a VCR recording.

### VCR SYSTEM SWITCH

Set in the VCR position to send remote commands to the VCR.

### PLAY BUTTON ▶

Press to begin playback of a video tape.

### REWIND BUTTON ◀◀

Press to rewind tapes. For some VCR's the STOP button may have to be pressed first, then REWIND. In playback mode hold down the button to view picture moving rapidly in reverse.

### STOP BUTTON ■

Press to stop the motion of a tape in playback, rewind, fast forward, etc.

### SMART HELP



Remember, the VCR buttons on the remote will not operate your VCR if those features are not found on your VCR remote control.

Note: All VCR functions (particularly Search, Rewind, Fast Forward, etc.) will operate the same as with the original VCR remote control provided with the VCR.

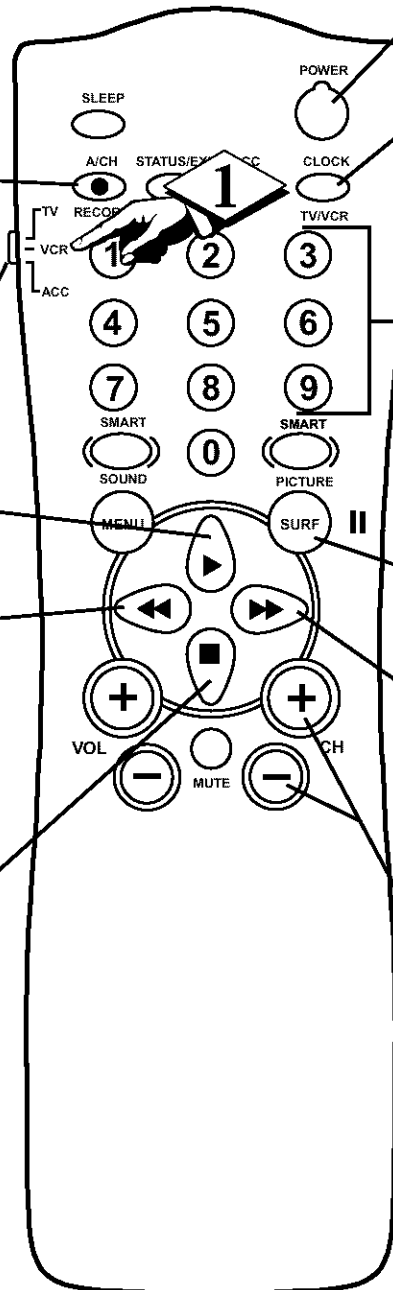

### POWER BUTTON

Press to turn the VCR ON and OFF.

### TV/VCR BUTTON

Press while in the VCR mode (VCR indicator on the front of the unit will light) to view the playback of a tape. Press again to place in the TV position (VCR indicator light will go off) to view one program while recording another program. When used in the TV mode, the TV/VCR/CLOCK button will access the TV's Clock menu options.

### NUMBER BUTTON

Press buttons for direct VCR channel selections.

### PAUSE BUTTON ||

Press to temporarily stop the tape during a playback or recording. Press again to release Pause.

### FAST FORWARD BUTTON ▶▶

Press to rapidly advance the tape. For some VCR's you may need to press the STOP button first, then the FAST FORWARD button. In playback mode hold the button down to view the picture moving rapidly in the forward direction.

### CHANNEL + & - BUTTONS

Press to scan up or down through the VCR channel numbers.



## TROUBLESHOOTING TIPS

*Please make these simple checks before calling for service. These tips can save you time and money since charges for TV installation and adjustment of customer controls are not covered under your warranty.*

### **No Power**

**CAUTION:** A video source (such as a video game, Compact Disc Interactive - CDI, or TV information channel) which shows a constant non-moving pattern on the TV screen, can cause picture tube damage. When your TV is continuously used with such a source the pattern of the non-moving portion of the game could leave an image permanently on the picture tube. When not in use, turn the video source OFF. Regularly alternate the use of such video sources with normal TV viewing.

- Check the TV power cord. Unplug the TV, wait 10 seconds, then reinsert plug into outlet and push POWER button again.
- Check that outlet is not on a wall switch. Be sure fuse is not blown on AC Power strip.

### **No Picture**

- Check antenna connections. Are they properly secured to the TV's 75Ω plug?
- Check the TUNER MODE control for CABLE or ANTENNA setting.
- Check Audio/Video Input jack connections if using a VCR or other external device.

### **No Sound**

- Check the VOLUME buttons.
- Check the MUTE button on the remote control.
- Check Audio/Video Input jack connections if using a VCR or other external device.

### **Unusual Screen Coloring**

- Turn the TV OFF for several seconds, then power the set back ON.
- Unplug the TV for FIVE minutes. Plug the TV back into the AC outlet and power the TV ON. This should correct the problem.
- Check the Picture menu options for proper control settings.
- Press the Auto Picture button on the remote to change the color options. If the color resets itself, readjust the Picture menu option control.

### **Remote Does Not Work**

- Check batteries. Replace with AA Heavy Duty (Zinc Chloride) or Alkaline batteries if necessary.
- Clean the remote and the remote sensor window on the TV.
- Check the TV power cord. Unplug the TV, wait 10 seconds, then reinsert plug into outlet and push POWER button again. Be sure fuse is not blown on AC Power strip.
- Check to be sure TV outlet is not on a wall switch.

### **TV Displays Wrong Channel or No Channels Above 13**

- Repeat channel selection.
- Add desired channel numbers (CHANNEL control) into TV memory.
- Check to be sure the TUNER MODE control is set to the CABLE option.

#### Cleaning and Care

- To avoid possible shock hazard be sure the TV is unplugged from the electrical outlet before cleaning.
- When cleaning the TV screen take care not to scratch or damage the screen surface (avoid wearing jewelry or using anything abrasive). Wipe the front screen with a clean cloth dampened with water. Use even, easy, vertical strokes when cleaning.
- Gently wipe the cabinet surfaces with a clean cloth or sponge dampened in a solution of cool clear water. Use a clean dry cloth to dry the wiped surfaces.
- Never use thinners, insecticide sprays, or other chemicals on or near the cabinet, as they might cause permanent marring of the cabinet finish.

# GLOSSARY TO TELEVISION TERMS



**Auto Picture Booster** • A control that will automatically amplify “weak video signals” to a point where they are acceptable for viewing.

**Auto Programming** • The procedure of adding or deleting channel numbers into the Television’s memory circuits. In this way the Television “remembers” only the locally available or desired channel numbers and skips over any unwanted channel numbers.

**Coaxial Cable** • A single solid antenna wire normally matched with a metal plug (F-type) end connector that screws (or pushes) directly onto a 75 Ohm input found on the Television or VCR.

**Closed Caption** • Broadcast standard which allows you to read the voice content of television programs on the TV screen. Designed to help the hearing impaired this feature uses on-screen “text boxes” to show dialogue and conversations while the TV program is in progress.

**Front Audio/Video Inputs** • Located on the front of the TV these connectors (phono type plug) are used for the input of audio and video signals. Designed for easy use with VCRs or cameras.

**Menu** • An on-screen listing of feature controls shown on the Television screen that are made available for user adjustments.

**On-screen Displays (OSD)** • Refers to the wording or messages generated by the television (or VCR) to help the user with specific feature controls (color adjustment, programming, etc.).

**Quadra Surf** • The feature that allows the programming of four separate Surf lists holding up to 10 channels each.

**Remote Sensor Window** • A window or opening found on the Television control panel through which infrared remote control command signals are received.

**Surf** • The action of scanning specific channel in a limited channel list.

**Status/Exit** • Allows the user to quickly confirm what channel number is currently being viewed. Status can also be used to clear the Television of on screen displays or information (rather than waiting for the displays to “time out” or automatically disappear from the screen).

**Twin Lead Wire** • The more commonly used name for the two strand 300 Ohm antenna wire used with many indoor and outdoor antenna systems. In many cases this type of antenna wire requires an additional adapter (or balun) in order to connect to the 75 Ohm Input terminals designed into the more recent Televisions and VCRs.

**Tuner Mode** • Designed for first time set up and use where the TV is set for antenna or cable TV signal connections.

## INDEX



Alternate Channel Control	29	Picture Control	5
Audio/Video Input Jacks	23	Surf Control	29
Audio/Video Output Jacks	24	Registration Information	2
SmartLock		Remote Control Use with Accessory Devices:	
Access Code	15	Code Entry List	33-34
Block All Channels	18	Code Entry Method of Identification	31
Blocking Channels	16	Direct Access Method of Identification	30
Blocking Options	21	Search Method of Identification	32
Clear All Blocked Channels	17	VCR Related Buttons	35
Definitions/Understanding Auto Lock	14	S-Video Input Jacks	25
Movie Ratings	19	Safety Information	3
TV Ratings	20	SAP (Secondary Audio Program) Control	11
AVL (Automatic Volume Leveler) Control	9	Sharpness Control	5
Balance Control	8	Sleeptimer Control	26
Bass Control	8	SmartPicture Control	27
Brightness Control	5	SmartSound Control	28
Closed Caption Control	22	Sound Control	12
Color Control	5	Stereo/Mono Settings	12
Color Temperature Control	5	Table of Contents	4
Contrast + (Black Stretch) Control	7	Timer Controls	13
DNR (Digital Noise Reduction) Control	6	Tint Control	5
Factory Service Information	38-39	Treble Control	8
Glossary of Terms	37	Troubleshooting Tips	36
Incredible Surround Control	10	Warranty	40
Index	37		



# FACTORY SERVICE LOCATIONS

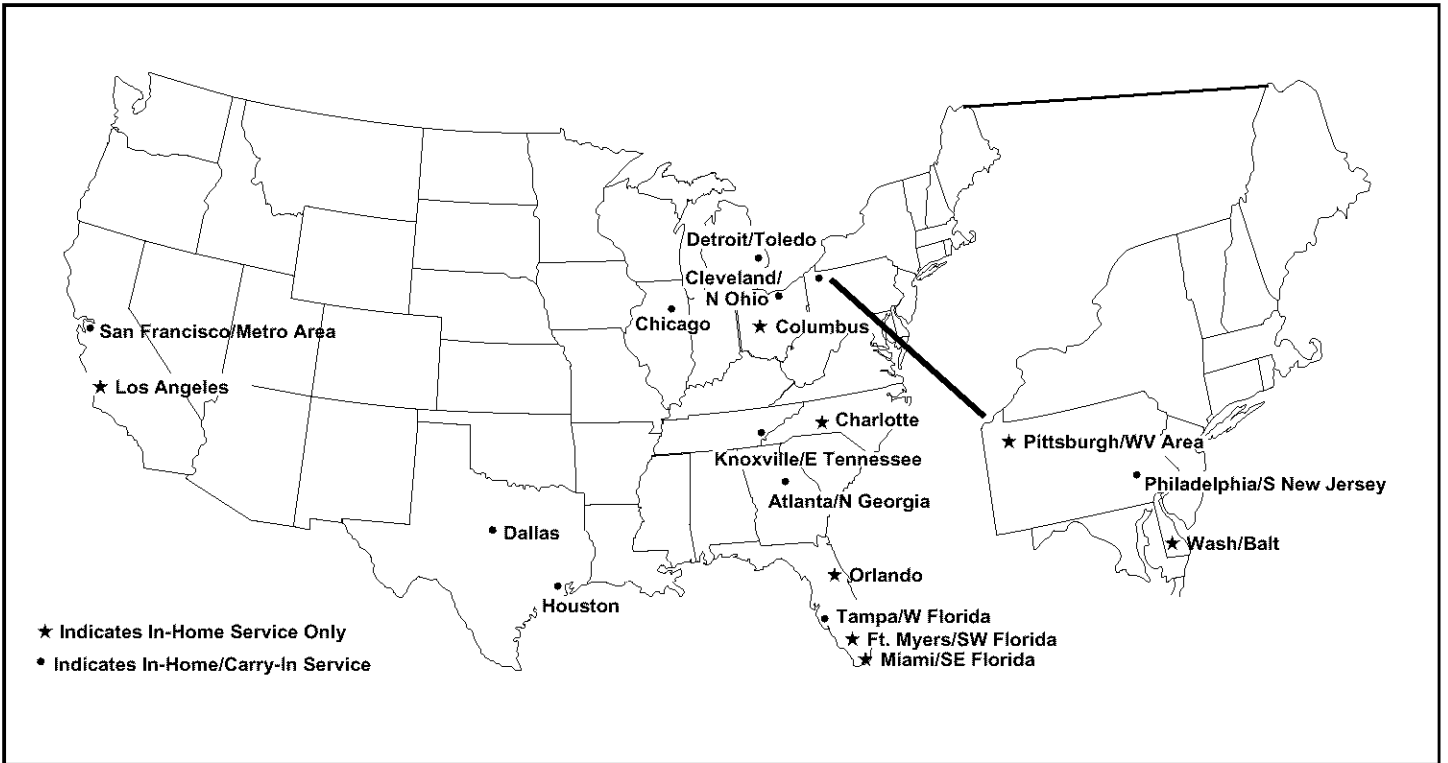

**NOTE:** If you reside in one of our Philips Factory Service Branch areas (see directory on back), you can contact the nearest Service Branch to obtain efficient and expedient repair for your product. If your product is In-Warranty, you should have proof-of-purchase to ensure No Charge Service. For Out-of-Warranty service, call the location nearest you.

**NOTA:** Si vous résidez dans une des régions desservies par une succursale de service après vente du fabricant Philips (voir liste ci-dessous), vous pourrez contacter la branche de service après vente la plus près de chez vous pour obtenir un service après vente rapide et efficace. Si le produit est sous garantie, il suffira de présenter une preuve d'achat pour bénéficier d'un service sans frais. Pour les produits non couverts par la garantie, contactez le centre le plus près de chez vous.

**NOTA:** Si Ud. reside en una de nuestras zonas para sucursales Philips de servicio al de fábrica (ver directorio más abajo), Ud. puede comunicarse con la sucursal de servicio más cercana para obtener una reparación oportuna y eficaz de su producto. Si su producto está todavía bajo garantía, Ud. debe presentar comprobante de compra para no ocasionar ningunos cargos por servicio. Para servicio después del vencimiento de la garantía, llame al lugar más cercano de los abajo indicados.

## In Canada

How you can obtain efficient and expedient carry-in, mail-in, or in-home service for your product

Please contact Philips at  
1-800-661-6162 (French speaking)  
1-800-363-7278 (English speaking)

## Au Canada

Comment obtenir le service après-vente pour les produits apportés ou envoyés par la poste à notre centre de service ou le service à domicile

Veuillez contacter philips à:  
1-800-661-6162 (Francophone)  
1-800-363-7278

## En el Canadá

Cómo recibir servicio eficiente para su producto, en persona, por correo o a domicilio

Favor de comunicarse con Philips al:  
1-800-661-6162 (francófono)  
1-800-363-7278 (anglófono)

# FACTORY SERVICE LOCATIONS



**QUALITY SERVICE IS AS CLOSE AS YOUR TELEPHONE! SIMPLY LOOK OVER THE LIST BELOW FOR THE NUMBER OF A FACTORY SERVICE CENTER NEAR YOU. YOUR PRODUCT WILL RECEIVE EFFICIENT AND EXPEDIENT CARRY-IN, MAIL-IN, OR IN-HOME SERVICE, AND YOU WILL RECEIVE PEACE OF MIND,**

**KNOWING YOUR PRODUCT IS BEING GIVEN THE EXPERT ATTENTION OF PHILIPS' FACTORY SERVICE.**

COMMENT OBTENIR NOTRE SERVICE APRÈS VENTE RAPIDE ET EFFICACE SOIT PAR COURRIER, À DOMICILE, OU EN SE PRÉSENTANT À UN CENTRE DE SERVICE PHILIPS. PLUS DE 600 CENTRES DE RÉCEPTION DE PRODUITS À RÉPARER À TRAVERS LE PAYS: CONTACTER LE CENTRE DE SERVICE AUX CONSOMMATEURS LE PLUS PROCHE POUR SAVOIR L'EMPLACEMENT DE CES DÉPÔTS DANS UN RAYON DE 50 À 75 MILES (80 KM À 120 KM) DU CENTRE DE SERVICE LOCAL.

CÓMO OBTENER UN SERVICIO OPORTUNO Y EFICIENTE POR CORREO, EN CASA O EN PERSONA PARA SU PRODUCTO A TRAVÉS DE UN CENTRO PHILIPS DE SERVICIO. MAS DE 600 SITIOS POR TODO EL PAIS PARA LA RECEPCION DE PRODUCTOS NECESITADOS DE REPARACIONES: COMUNICARSE CON EL CENTRO DE SERVICIO DE FABRICA MAS CERCAÑO PARA ESTOS LUGARES DENTRO DE UN RADIO DE 80 A 120 KM (50 A 75 MILLAS) DEL CENTRO DE SERVICIO LOCAL.

## **ATLANTA**

Philips Factory Service  
200 N. Cobb Pkwy., Suite 120  
Marietta, GA 30062  
800-273-1501

## **TAMPA**

Philips Factory Service  
1911 US Highway 301 North  
Tampa, FL 33619  
800-442-2027

## **SAN FRANCISCO**

Philips Factory Service  
681 East Brokaw Rd.  
San Jose, CA 95112  
800-300-9013

## **HOUSTON**

Philips Factory Service  
1110 N. Post Oak Rd., Suite 100  
Houston, TX 77055  
800-952-3254

## **CLEVELAND**

Philips Factory Service  
950 Keynote Circle  
Brooklyn Heights, OH 44131  
800-331-7037

## **DETROIT**

Philips Factory Service  
25173 Dequindre  
Madison Heights, MI 48071  
800-438-1398

## **DALLAS**

Philips Factory Service  
415 N. Main Street, #107  
Euless, TX 76040  
800-952-3254

## **CHICAGO**

Philips Factory Service  
1279 W. Hamilton Pkwy.  
Itasca, IL 60143  
800-531-2922

## **KNOXVILLE**

Philips Factory Service  
6700 D Papermill Rd.  
Knoxville, TN 37919  
800-821-1767

## **PHILADELPHIA**

Philips Factory Service  
352 Dunks Ferry Rd.  
Bensalem, PA 19020  
800-847-9320

# LIMITED WARRANTY

## COLOR TELEVISION

90 Days Free Labor

One Year Free Replacement of Parts (Two Years Free Replacement on Color Picture Tube)

This product can be repaired in-home.

### WHO IS COVERED?

You must have proof of purchase to receive warranty service. A sales receipt or other document showing that you purchased the product is considered proof of purchase.

### WHAT IS COVERED?

Warranty coverage begins the day you buy your product. *For 90 days thereafter*, all parts will be repaired or replaced free, and labor is free. From 90 days to one year from the day of purchase, all parts will be repaired or replaced free, but you pay for all labor charges. From one to two years from the day of purchase, you pay for the replacement or repair of all parts except the picture tube, and for all labor charges. After two years from the day of purchase, you pay for the replacement or repair of all parts, and for all labor charges.

All parts, including repaired and replaced parts, are covered only for the original warranty period. When the warranty on the product expires, the warranty on all replaced and repaired parts also expires.

### WHAT IS EXCLUDED?

Your warranty does not cover:

- labor charges for installation or setup of the product, adjustment of customer controls on the product, and installation or repair of antenna systems outside of the product.
- product repair and/or part replacement because of misuse, accident, unauthorized repair or other cause not within the control of Philips Consumer Electronics Company.
- reception problems caused by signal conditions or cable or antenna systems outside the unit.
- a product that requires modification or adaptation to enable it to operate in any country other than the country for which it was designed, manufactured, approved and/or authorized, or repair of products damaged by these modifications.
- incidental or consequential damages resulting from the product. (Some states do not allow the exclusion of incidental or consequential damages, so the above exclusion may not apply to you. This includes, but is not limited to, prerecorded material, whether copyrighted or not copyrighted.)
- a product used for commercial or institutional purposes.

### WHERE IS SERVICE AVAILABLE?

Warranty service is available in all countries where the product is officially distributed by Philips Consumer Electronics Company. In countries where Philips Consumer Electronics Company does not distribute the product, the local Philips service organization will attempt to provide service (although there may be a delay if the appropriate spare parts and technical manual(s) are not readily available).

### MAKE SURE YOU KEEP...

Please keep your sales receipt or other document showing proof of purchase. Attach it to this owner's manual and keep both nearby. Also keep the original box and packing material in case you need to return your product.

### BEFORE REQUESTING SERVICE...

Please check your owner's manual before requesting service. Adjustments of the controls discussed there may save you a service call.

### TO GET WARRANTY SERVICE IN U.S.A., PUERTO RICO OR U.S. VIRGIN ISLANDS...

Contact a Philips factory service center (see enclosed list) or authorized service center to arrange repair.

(In U.S.A., Puerto Rico and U.S. Virgin Islands, all implied warranties, including implied warranties of merchantability and fitness for a particular purpose, are limited in duration to the duration of this express warranty. But, because some states do not allow limitations on how long an implied warranty may last, this limitation may not apply to you.)

### TO GET WARRANTY SERVICE IN CANADA...

Please contact Philips at:

1-800-894-5463

1-800-363-7278

(In Canada, this warranty is given in lieu of all other warranties. No other warranties are expressed or implied, including any implied warranties of merchantability or fitness for a particular purpose. Philips is not liable under any circumstances for any direct, indirect, special, incidental or consequential damages, howsoever incurred, even if notified of the possibility of such damages.)

### REMEMBER...

Please record the model and serial numbers found on the product below. Also, please fill out and mail your warranty registration card promptly. It will be easier for us to notify you if necessary.

MODEL # \_\_\_\_\_

SERIAL # \_\_\_\_\_

*This warranty gives you specific legal rights. You may have other rights which vary from state/province to state/province.*

Philips Consumer Electronics Company, P.O. Box 2976, Longview, Texas 75606, (903) 242-4800