

## Assembly Instructions



### Liquid Propane Gas Grill

Model No. 415.152040

This Grill Is For  
Outdoor Use Only

NO TOOLS

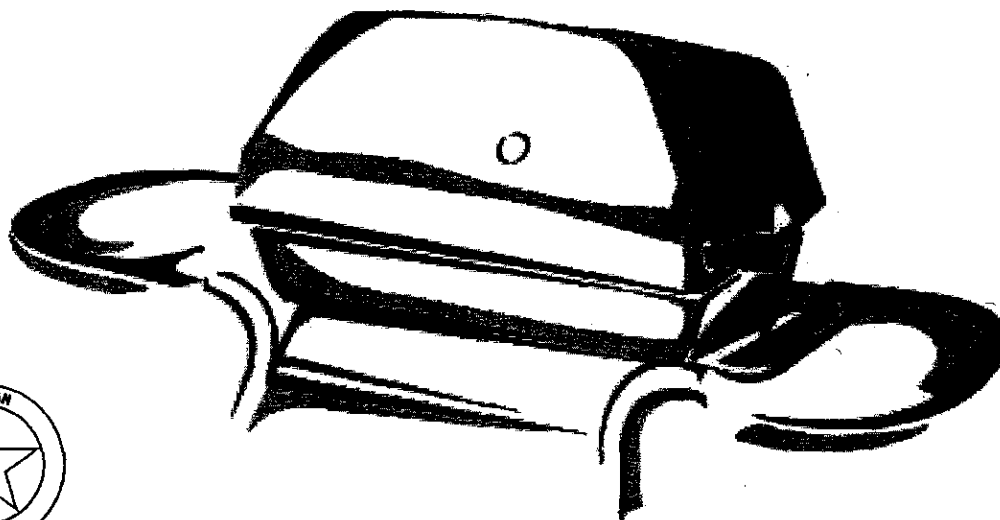

#### **WARNING**

- Failure to follow all manufacturer's instructions could result in serious personal injury and/or property damage.

- Assembly
- Parts
- Recipes

#### **CAUTION**

- Read and follow all Safety Statements, Assembly Instructions and Use and Care Directions before attempting to assemble and cook.
- Some parts may contain sharp edges, especially as noted in these instructions. Wear protective gloves if necessary.

#### Assembly Questions?

Call 1-800-241-7548

#### Parts Ordering:

Call 1-800-366-PART (7278)

To Installer/Assembler: Leave these instructions with consumer.

To Consumer: Keep this manual for future reference.

## PARTS LIST – Model No. 415.152040

Key	Qty	Description	Part #	Key	Qty	Description	Part #
1	2	Leg Assembly .....	4502102	24	1	Drip VapoRISER Bar .....	4501750
2	2	Leg Extender .....	4154492	25	1	Grease Clip .....	5156607
3	2	Rail .....	4503099	26	1	Valve/Hose/Regulator .....	4524120
4	6	#10-24x2" Machine Screw .....	4080064	27	2	#10-24x3/8" Machine Screw .....	4080379 STD511003
5	1	Brace .....	4503047	28	1	Control Panel .....	4526041
6	12	#10-24 Wing Nut .....	4080220 STD541610	29	2	Control Knob .....	4154470
7	4	1-1/2" End Cap .....	4154246	30	1	Ignitor .....	4153713
8	1	Tank Support Bracket .....	4503027	31	1	Right Side Shelf .....	4154375
9	2	Wheel .....	4156956	32	8	#10-16x2-1/4" Wing Screw .....	4080073
10	2	5/16" Axle Bolt .....	4080155	33	1	Left Side Shelf .....	4154373
11	4	1" Hitch Pin .....	4080062	34	1	Grill Lid .....	4580161
12	1	Front Panel .....	4526044	35	1	Logo Plate .....	4157122
13	4	#10-24x1-1/4" Carriage Bolt .....	4080074	36	2	3/16" Pal Nut .....	4153096
14	1	Grill Bottom .....	4580191	37	1	Heat Indicator/Bracket .....	4156800
15	1	Air Shield .....	5501037	38	1	#10-24 Hex Nut (keys) .....	4080208
16	2	#10x1/2", T-20, Self-Tap Screw .....	4080043	39	1	Handle .....	4154473
17	1	Lower Burner Bracket .....	4500231	40	2	#10-24x1" Machine Screw .....	4080302 STD511010
18	1	Upper Burner Bracket .....	4500248	41	2	1/4x1-1/8" Hinge Pin .....	4156513
19	1	Tube Burner .....	5068007	42	1	Condiment Basket .....	4151004
20	1	Wire Mesh .....	4153741	43	1	Lower SwingAway .....	4152124
21	1	Ignitor Shield .....	4501764	44	1	Upper SwingAway .....	4156448
22	1	#6x3/8" Self-Tap Screw .....	4080264 STD610603	45	1	Tank Wire .....	4154195
23	1	Electrode/Wire Assembly .....	5156105	46	1	Cooking Grate .....	4152739

# **PARTS DIAGRAM – Model No. 415.152040**

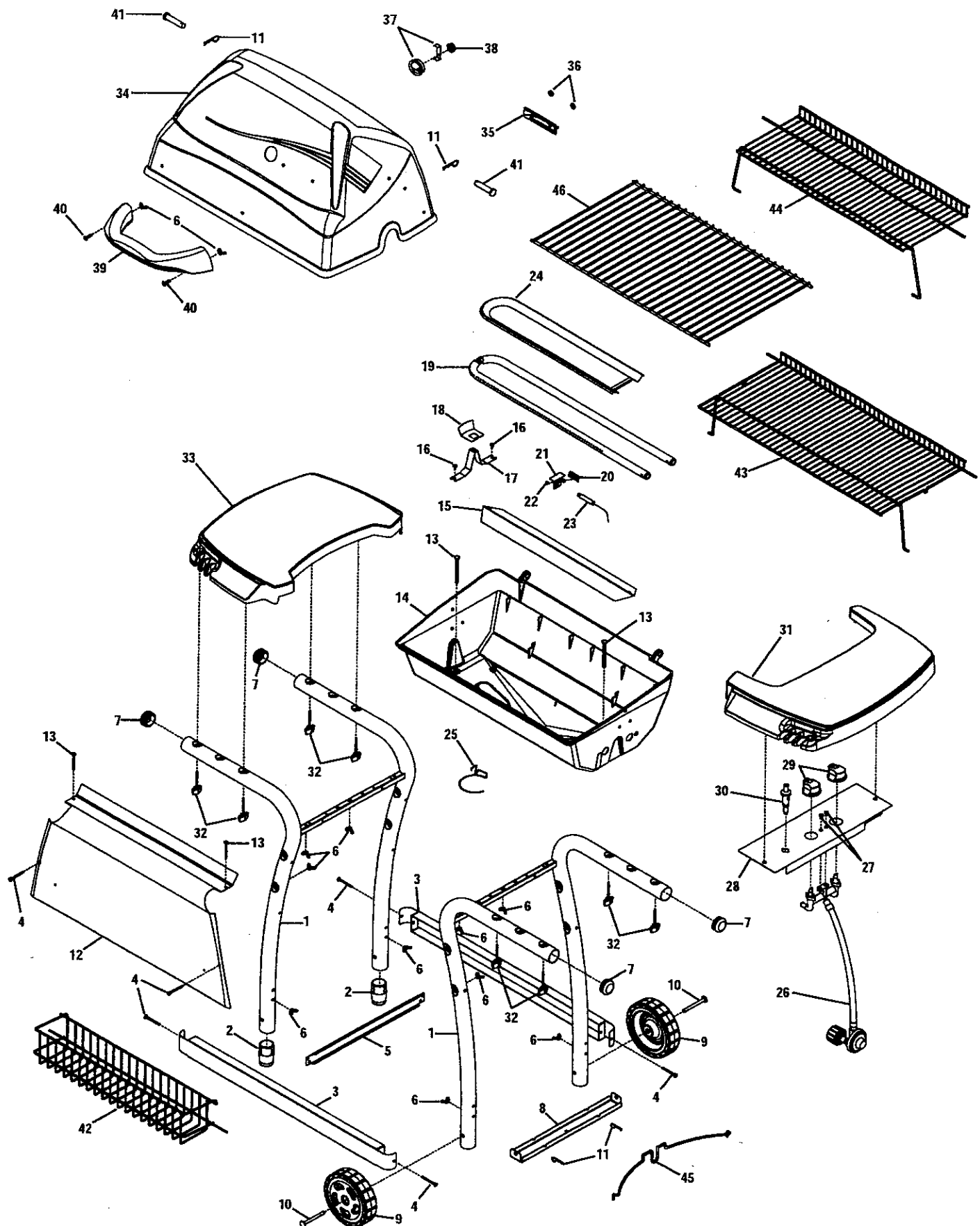

## ASSEMBLY – Model No. 415.152040

# 1

### Cart Assembly Step 1

- ☐ Position leg with extenders to left.
- ☐ Install back rail (with label) using bolts only, no wing nuts.
- ☐ Install front rail using bolts only, no wing nuts.
- ☐ Install brace and four wing nuts.

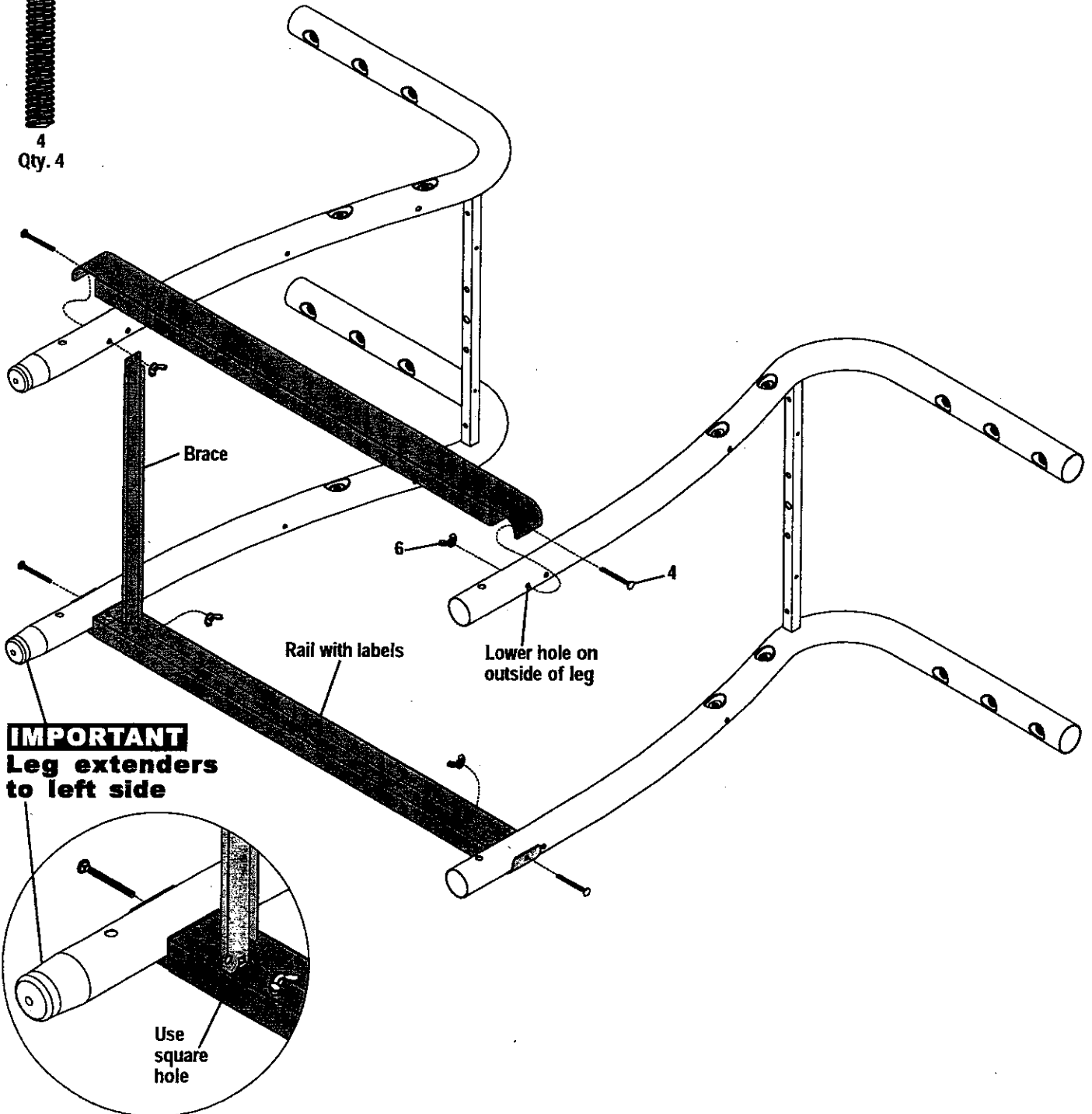
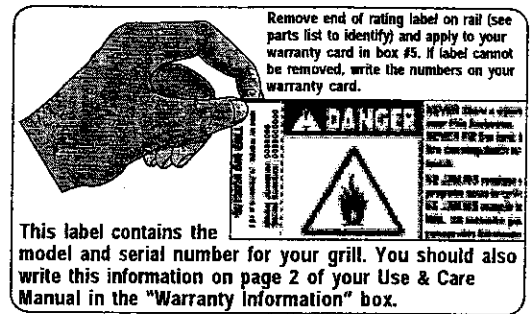
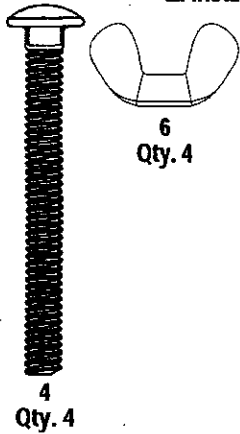

**IMPORTANT**  
Leg extenders  
to left side

# 2

## Cart Assembly Step 2

- Insert four end caps.
- Attach wheels and tank support bracket to ends of right legs.

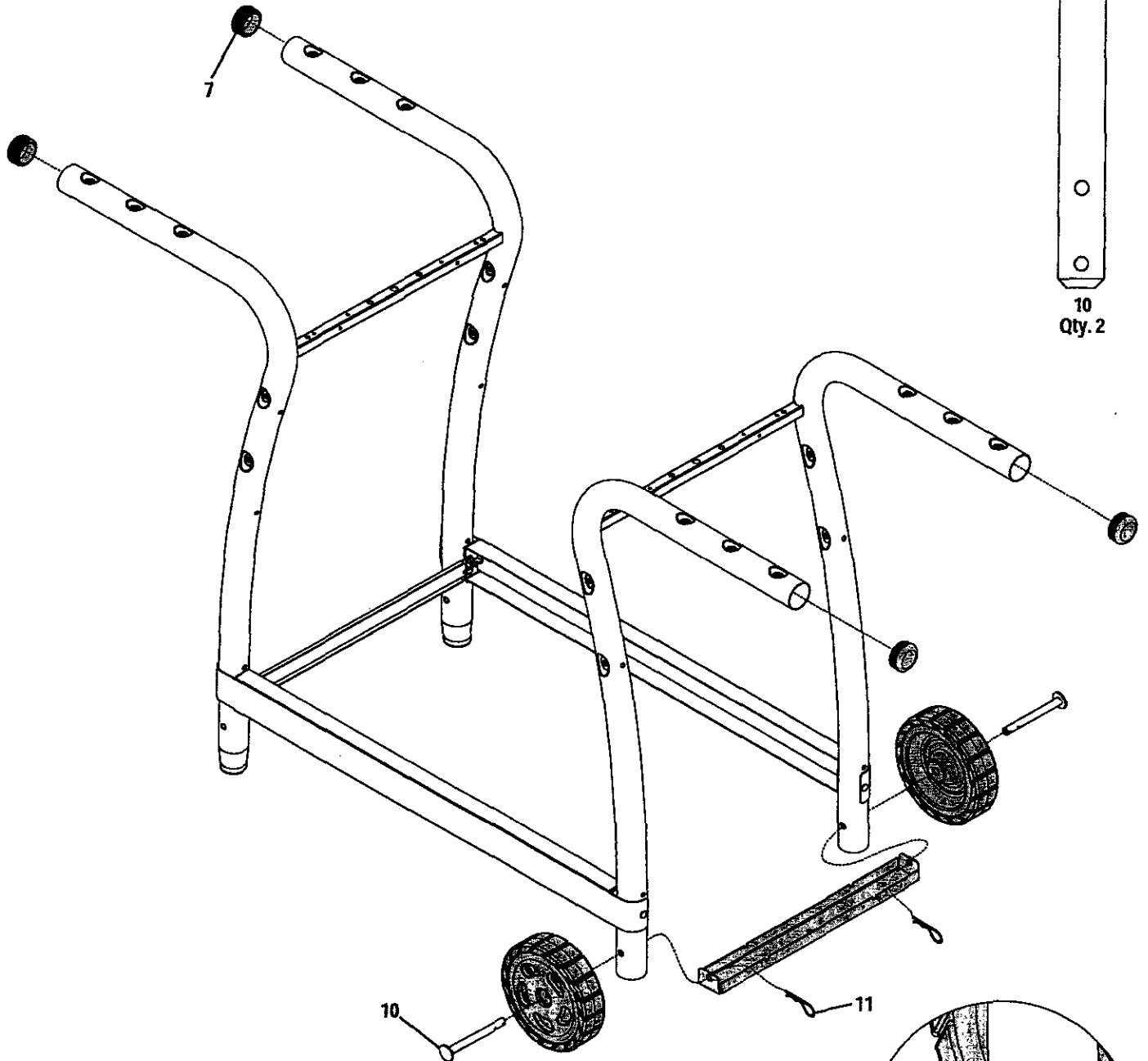
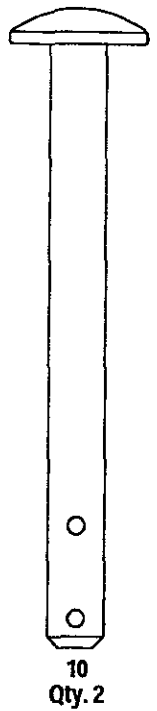
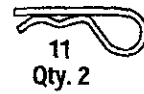

Completed Assembly

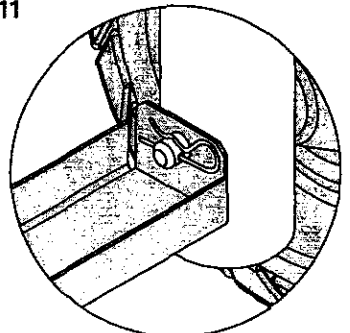

# 3

## Cart Assembly Step 3

- ☐ Assemble front panel loosely with four bolts and wing nuts.
- ☐ Tighten after completing step 4.

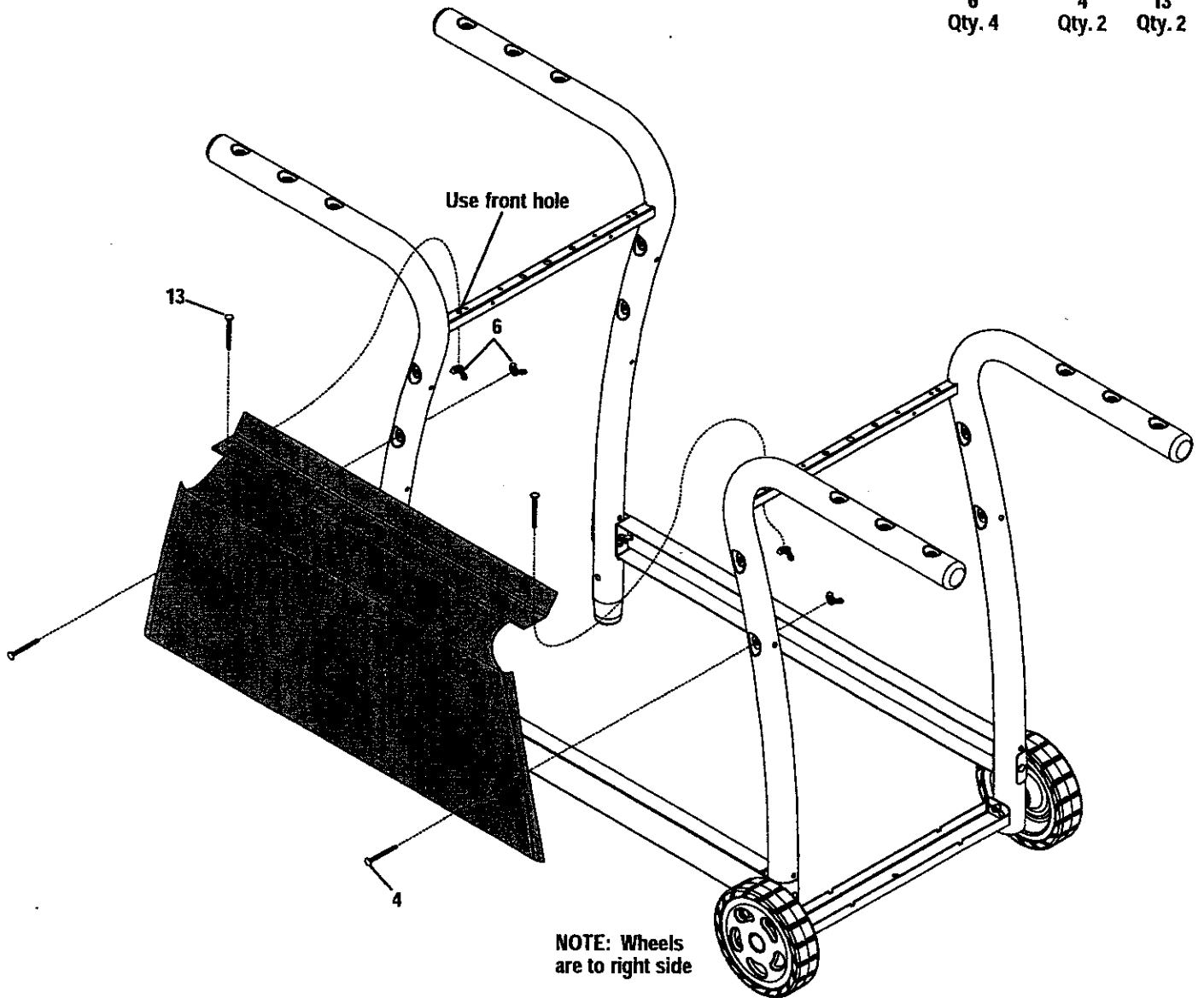
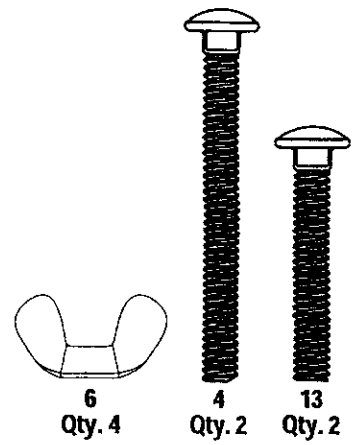

# 4

## Grill Bottom Assembly

- ☐ Assemble grill bottom to cart.
- ☐ Attach grease clip to grill bottom.
- ☐ Attach Sears Grease Cup #22020 (sold separately) or soup can to grease clip.
- ☐ Fully tighten front panel wing nuts.

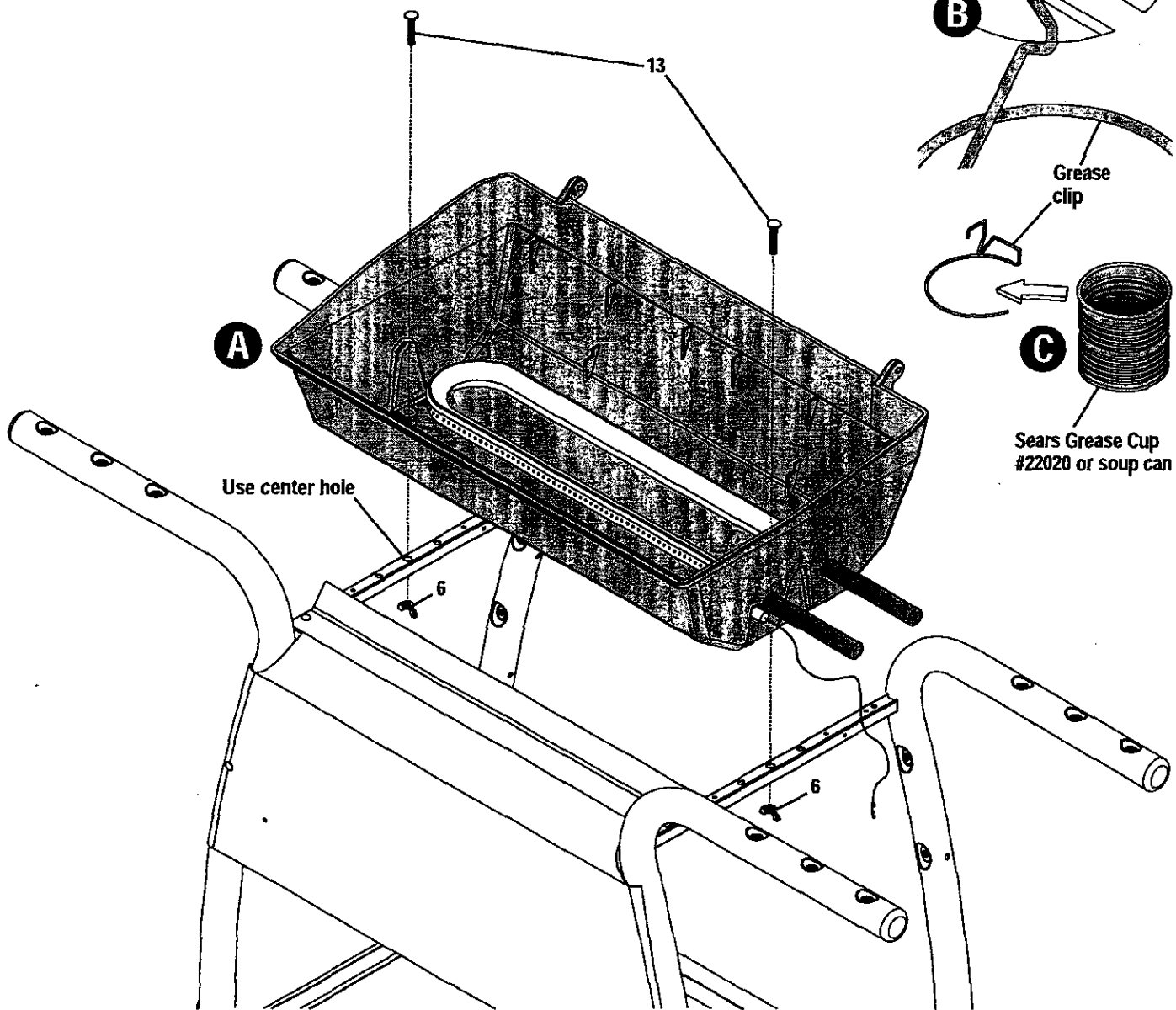
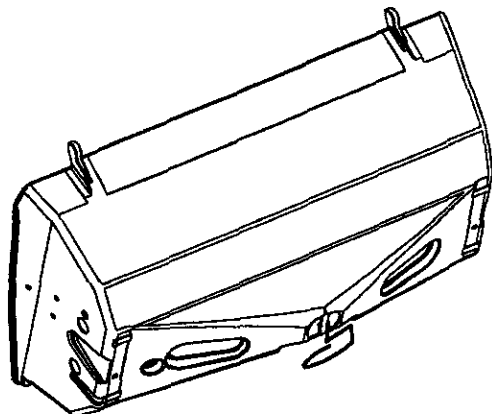
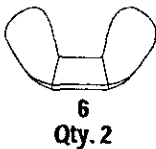

# 5

## Control Panel And Side Shelf Assembly

- ☐ Position valves inside ends of burners.
- ☐ Install control panel and shelf with cut-out to right side of cart.
- ☐ Attach ignitor wire to round terminal on bottom of ignitor.
- ☐ Install remaining shelf to left side of cart.

**NOTE:** Do not allow ignitor wire to contact the grill bottom.  
A damaged wire may impair ignitor function.

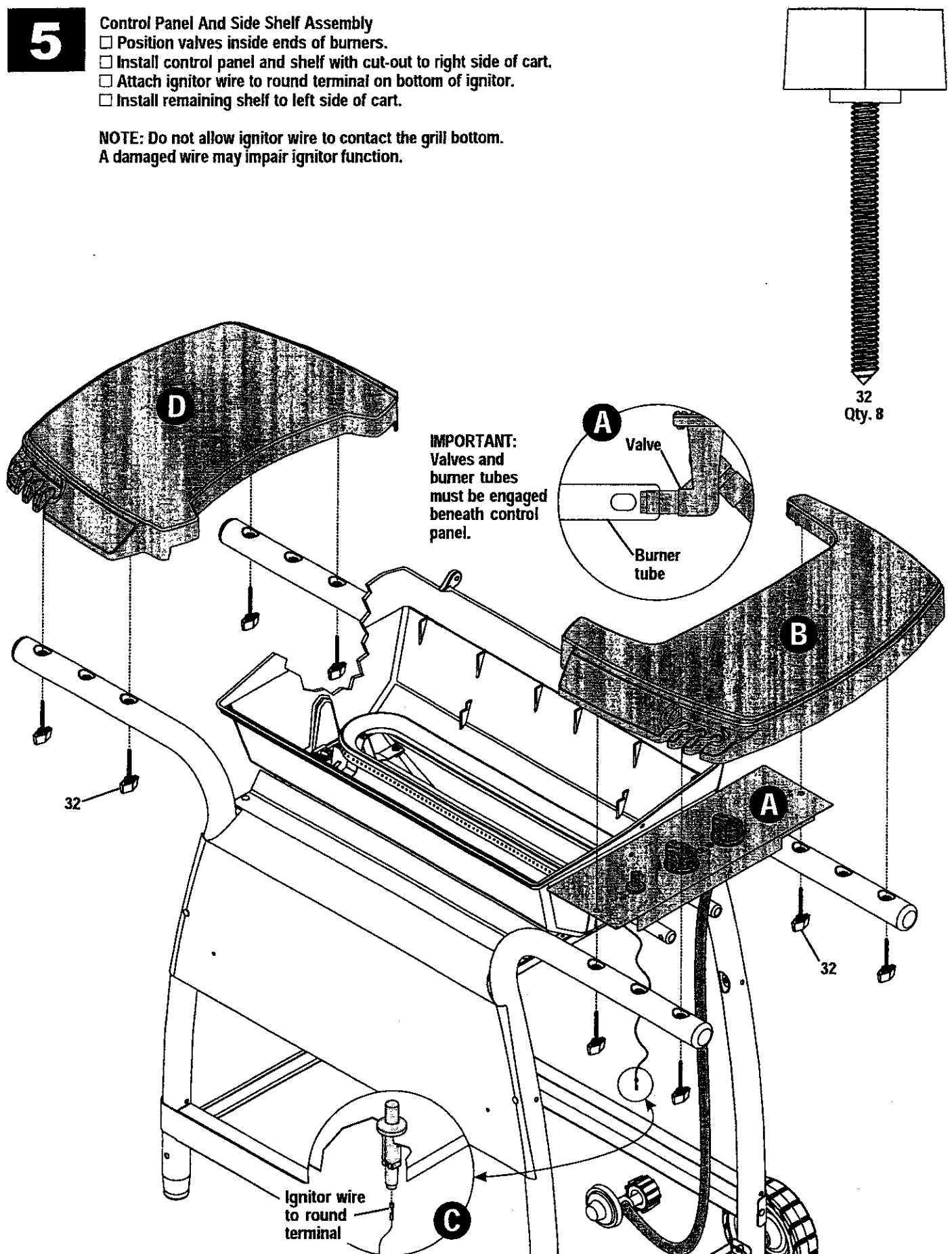



**6**

**Grill Lid and Handle Assembly**  
☐ Install grill lid to grill bottom.  
☐ Install handle to grill lid.

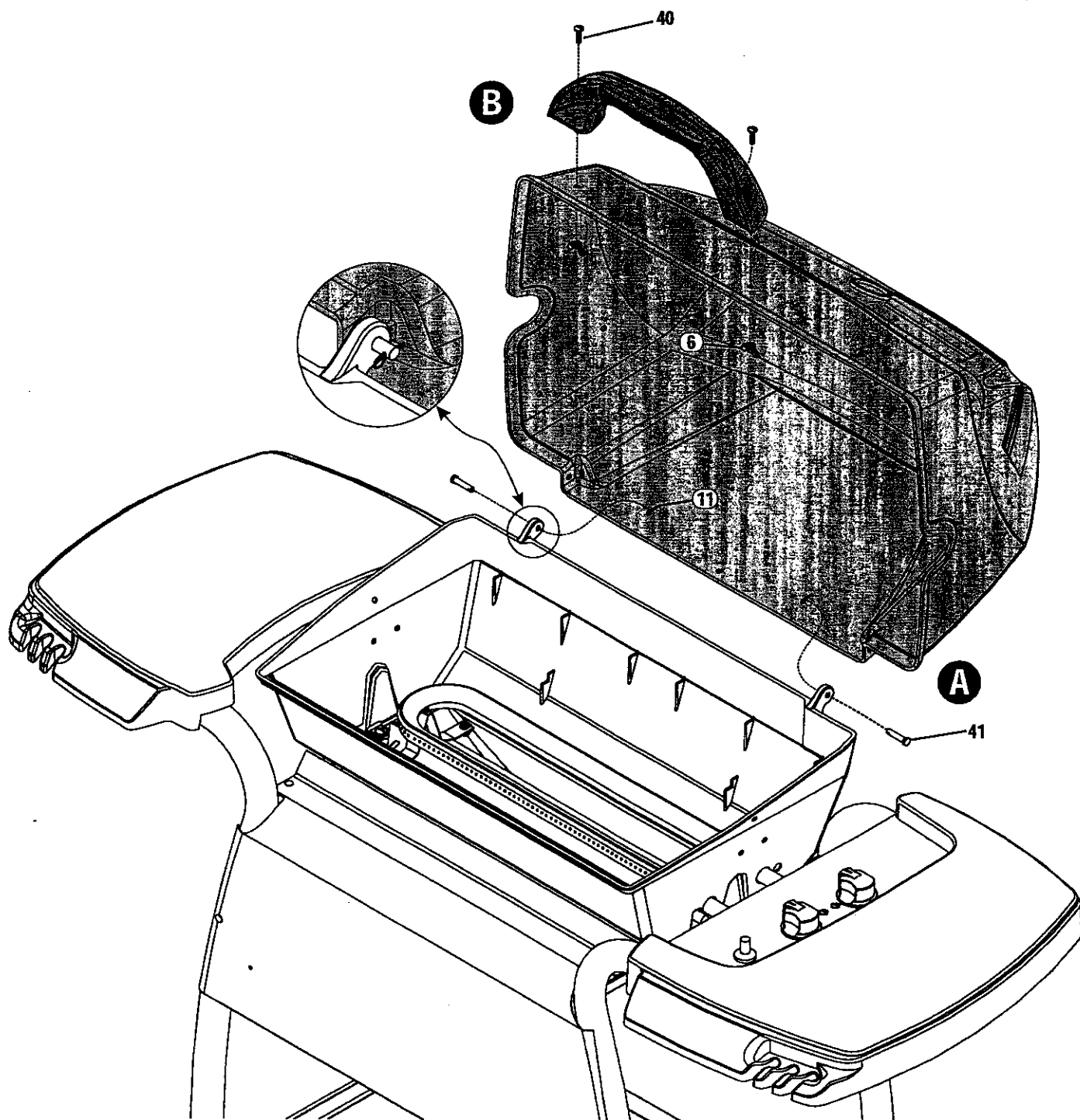
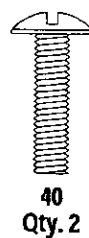
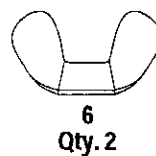
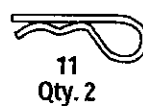
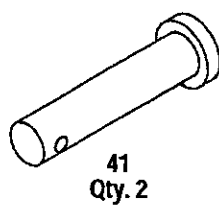

# 7

## Condiment Basket And SwingAway Assembly

- Attach condiment basket to front panel.
- Install lower SwingAway by placing pivot wire into lower holes in sides of grill lid and legs into top holes in sides of grill bottom.
- Install upper SwingAway by placing pivot wire into middle holes in sides of grill lid and legs into loops in sides of lower SwingAway.

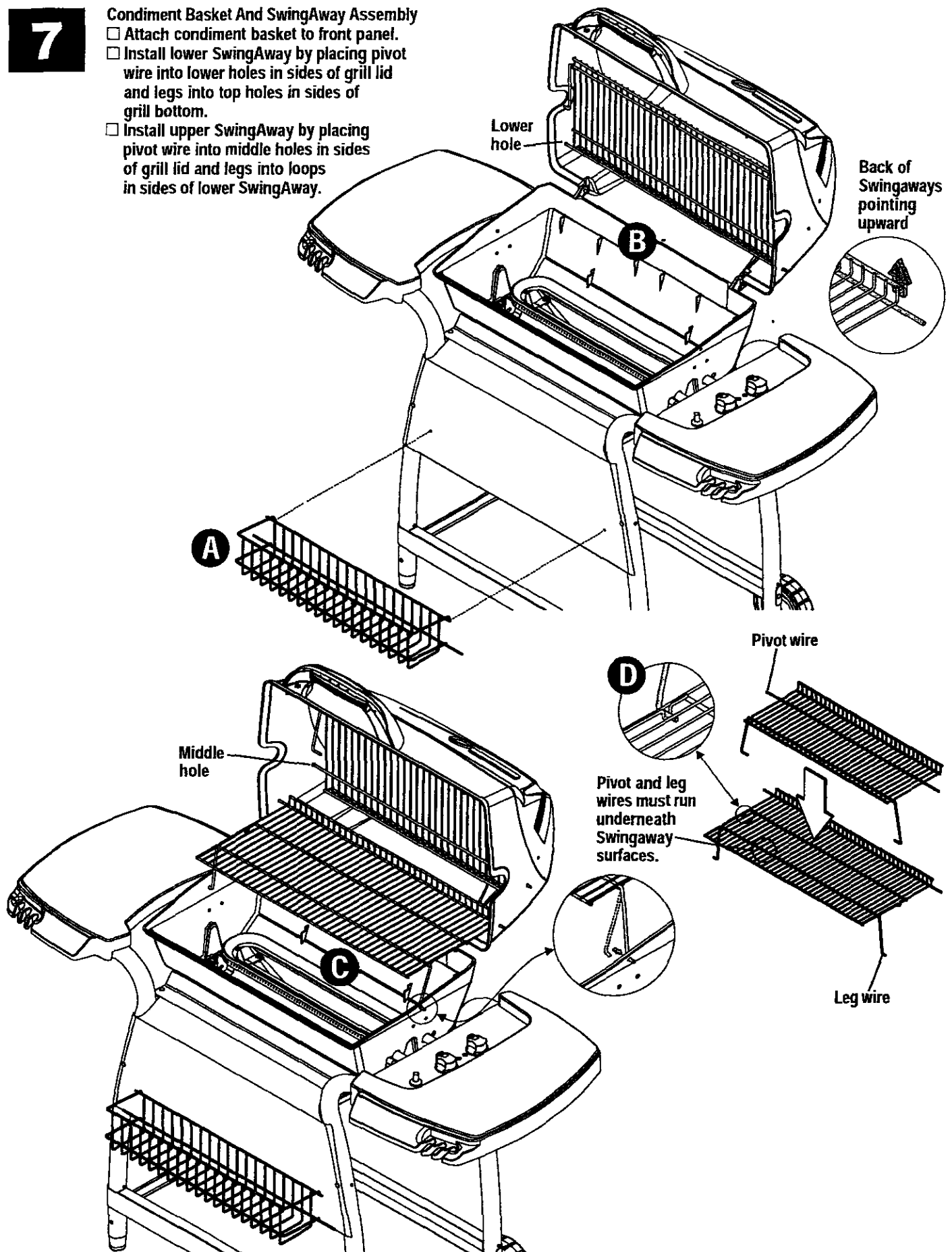

# 8

## Tank Wire And LP Tank Assembly

- ☐ Install tank wire into right leg assembly.
- ☐ Place LP tank onto tank support bracket and snap tank wire over tank collar.
- ☐ See Use & Care Manual for connection of regulator to LP tank.

- ▲ LP GAS TANK IS SOLD SEPARATELY. Before attaching to grill and regulator, fill and leak check. See Use & Care Manual.
- ▲ Curved portion of tank wire should be inside of tank collar.

**NOTE:** Some previously assembled features not shown for clarity.

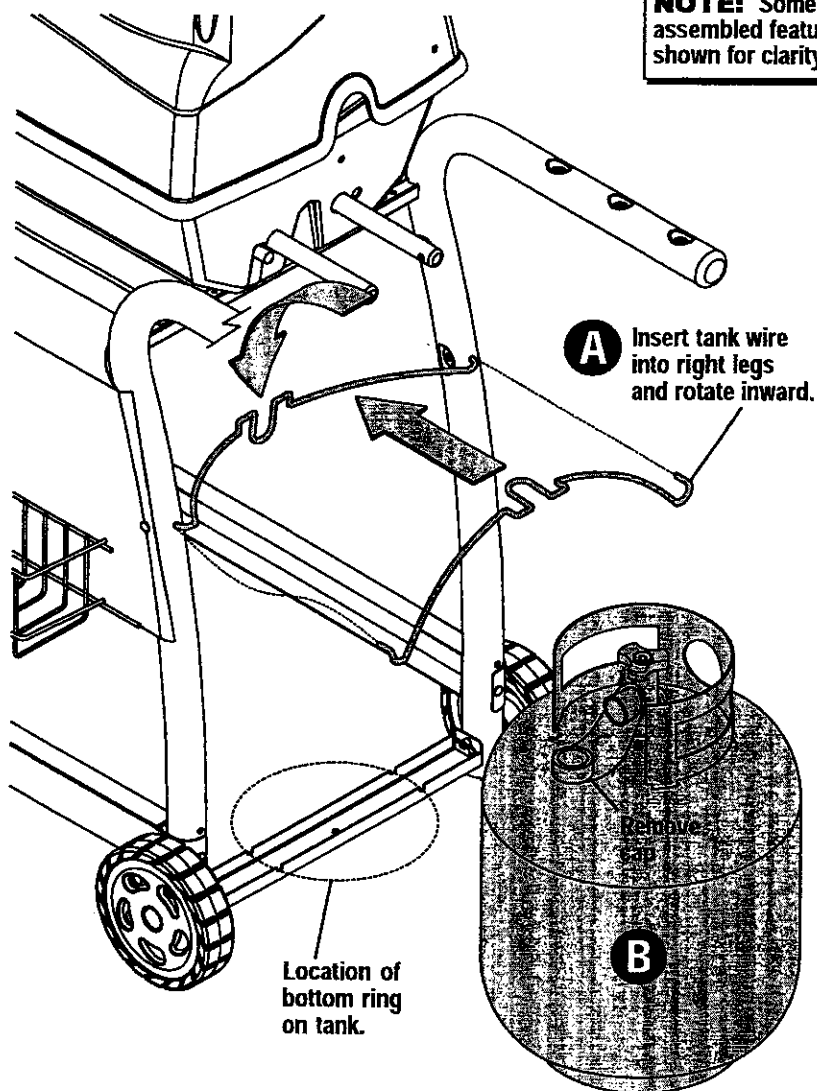

## CAUTION

- Tank collar opening must face to front of cart once tank is attached.
- Failure to install tank correctly may allow gas hose to be damaged in operation.

Curved portion of tank wire.

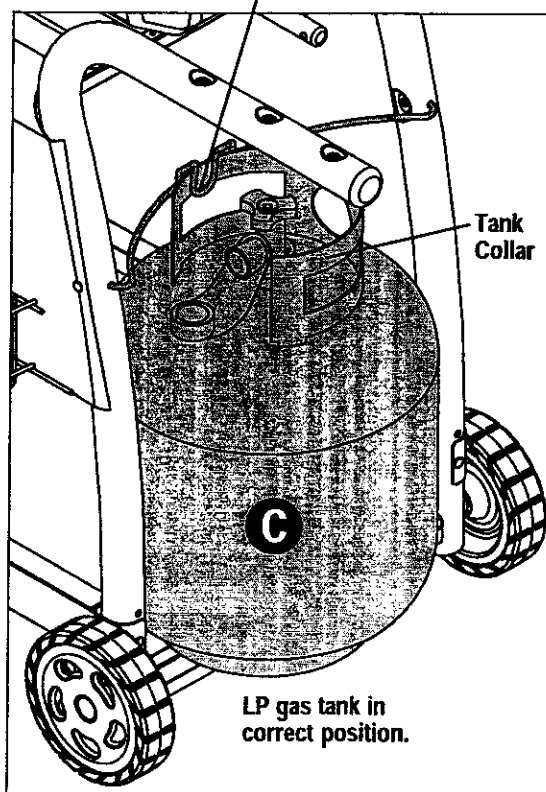

**See Use & Care Manual for important safety instructions before using.**

**9**

**Cooking Grate Assembly**

- Place cooking grate onto grate rests in grill bottom.

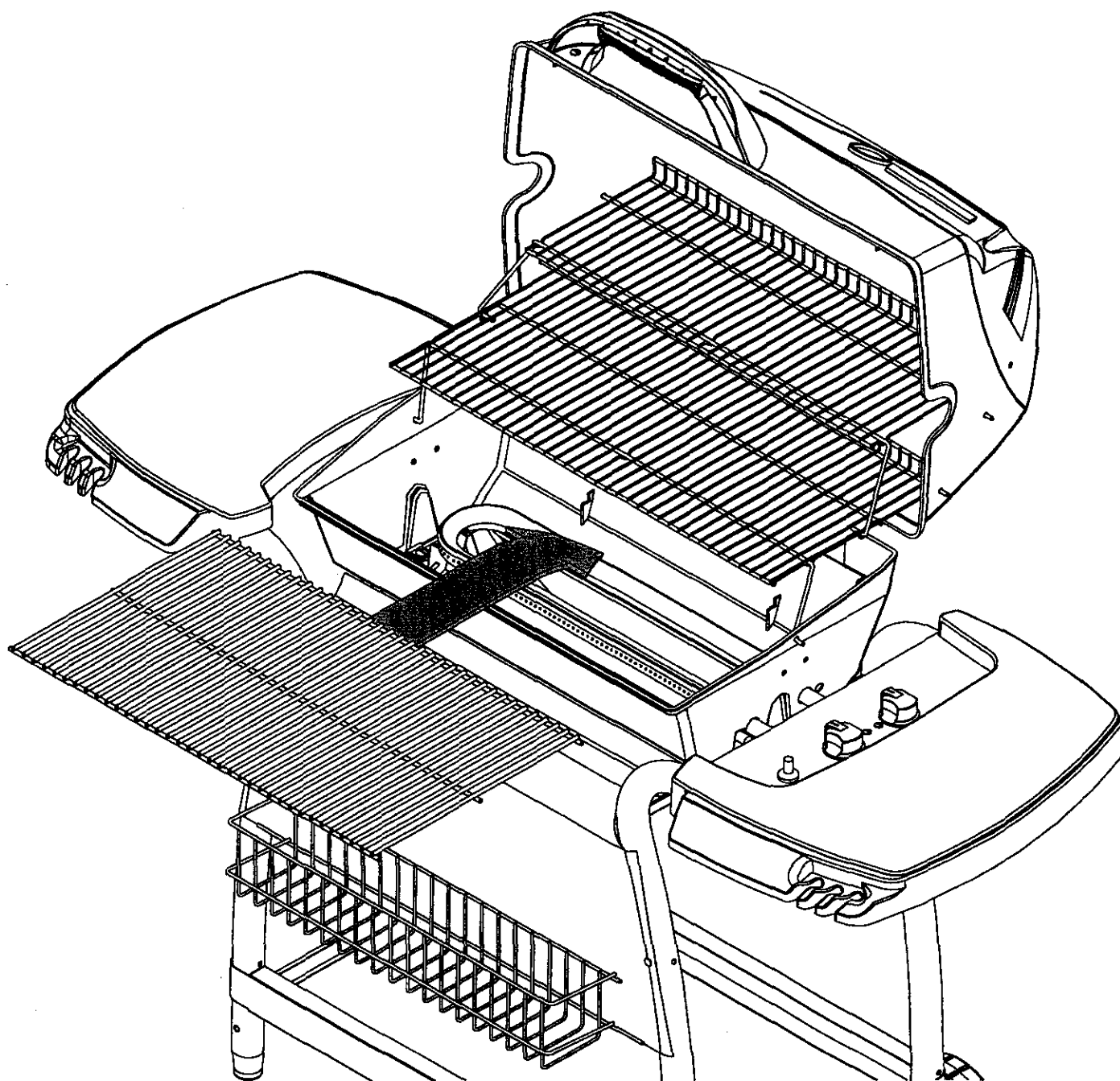



# Recipes

---

## Indirect Cooking:

You can bake or slowly roast many foods on a covered grill by cooking indirectly. Simply light the gas on one side of the grill and place the food on the other side. Close the lid and your grill will bake or roast like a conventional oven.

## Lemon Herb Chicken

Yield: 6 Servings • Cooking Time: 45 Minutes • Method: Low

1/2 cup fresh lemon juice	Grated rind of 1 lemon
1-1/2 tsp. crushed sweet basil	1/2 tsp. crushed thyme
2 cloves garlic, crushed	2 tsp. salt
1 tsp. paprika	1 cup oil
1-1/2 tsp. onion powder	1 cut up frying chicken

Combine all ingredients and pour into plastic bag. Add chicken and marinate for 6 to 8 hours in refrigerator, turning occasionally. Remove from refrigerator 1 hour before grilling. Place chicken on grill, skin-side up. Cook for 20 to 25 minutes, basting often with marinade. Turn, cook for 20 minutes longer. Serve immediately.

## Polynesian Chicken

Yield: 4 Servings • Cooking Time • 1 to 1-1/2 Hours • Method: Low

2 (2 Lb.) split broilers	2 tsp. salt
1/2 cup oil	1/2 tsp. pepper

Brush chicken with oil and season with salt and pepper. Place on grill with bone side down. Grill slowly. Turn after 20 to 25 minutes and cook about 20 minutes longer. Meanwhile make the below listed glaze.

## Pineapple Glaze

1 cup crushed pineapple, drained and reserve 1/4 cup syrup	2 tbs. prepared mustard
2 tbs. lemon juice	1/2 tsp. salt
	1 cup brown sugar

Combine ingredients, brush both sides of chicken with glaze and broil about 10 minutes more or until tender. Turn and baste with glaze. Serve extra glaze with chicken.

## Chicken Shish Kabobs

Yield: 4 Servings • Cooking Time: 12-16 Minutes • Method: Medium

4 chicken breast halves, boned and cut into 1-1/2 inch pieces	1 cup soy sauce
1 green pepper, cut in 1 inch pieces	1/2 lb. mushrooms
1 zucchini squash sliced and parboiled	1 small can pineapple chunks, juice reserved

Combine all but pineapple chunks (include the pineapple juice). Marinate for 8 to 12 hours in refrigerator. Thread chicken, pineapple, mushrooms and bell pepper alternately on skewers. Grill over medium fire for 6 to 8 minutes on each side or until done.

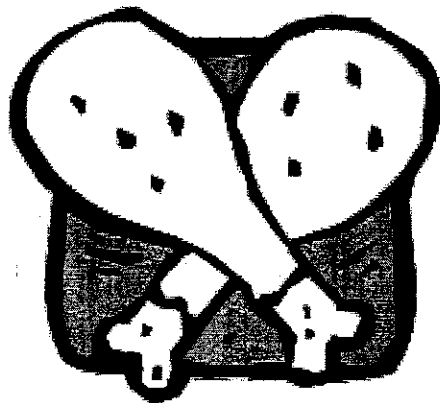



# Recipes

---

## Herb Butter

1 stick butter, softened	1 small clove garlic, pressed
1 tbs. lemon juice	2 tsp. finely chopped chives
2 tsp. finely chopped parsley	2 tsp. finely chopped tarragon

Add herbs and juice to softened butter and cream all together. Cover and store in refrigerator for seasonings to blend. Good on vegetables, bread, fish or steaks.

## Mop Ribs

Yield: About 8 Servings, allow 1 lb. Per Person • Cooking Times: 1-1/2 Hours • Method: Low • 8 lbs. of spareribs or 1 lb. per person

### Mop Sauce

2 cups beef stock or bouillon	1/4 tsp. hot pepper sauce
1/4 cup salad oil	1/2 cup Worcestershire sauce
1/3 cup vinegar	1 tsp. salt
1 bay leaf	1 tsp. dry mustard
3/4 tsp. chili powder	1 tsp. garlic powder
1/2 tsp. paprika	

Combine "Mop" ingredients and let spareribs marinate. Combine dry seasonings and generously sprinkle on spareribs before cooking. Grill spareribs as far from the fire as possible, basting frequently. Should take ribs 1 to 1-1/2 hours over low fire. Dry seasonings keep indefinitely in airtight container.

## Dry Seasonings

2 tbs. salt	1-1/2 tsp. paprika
2 tbs. sugar	2 tsp. pepper
2 tsp. unsweetened lemonade powder	

**Use a Wire Grill Basket** to grill difficult chicken, fish, burgers, steaks, and shrimp. Cook many different items at the same time and same rate by flipping them all at once, safely, surely. Fish and chicken won't fall apart while turning. To keep food from sticking to the wire, coat the basket with oil before use.

## Grilled Fresh Vegetables

Fresh vegetables can be cooked on the grill. Brush the prepared vegetables with cooking oil or a bottled vinaigrette dressing. Place them directly on the cooking grate beside the meat. Turn vegetables once and before long they will be crisp and ready to eat.

## Corn On The Grill

Yield: 6 Servings • Cooking Time: 15 Minutes • Method: Medium  
6 ears unhusked corn      1/4 cup salt

Place unhusked corn in sink and cover with water. Add salt. Soak 2 hours. Place unhusked corn on grill. Cook and turn until entire outside husk is black. Remove from grill and husk corn. Serve with **Herb Butter**.

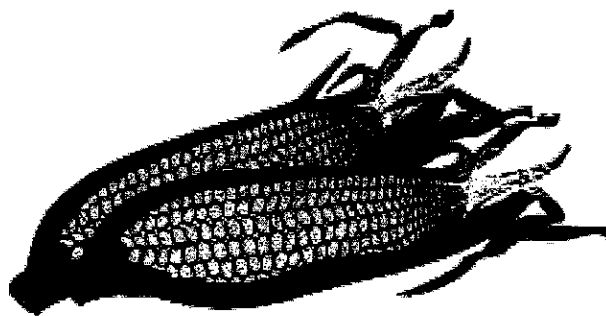



# Recipes

---

## Mauna Key Lamb Chops

Yield: 6 Servings • Cooking Time: 15 Minutes • Method: Medium- Hot

6 1 inch loin, rib or shoulder chops	1/2 cup soy sauce
2 tbs. brown sugar	1 clove garlic, crushed
1 tsp. grated fresh ginger	

Blend together all ingredients except chops. Marinate the chops in the mixture for one hour, turning. Place on grill and cook on medium-hot fire for 15 minutes, basting often. Meat should be a little pink on the inside.

## Venison Burgers

Yield: 8 Servings • Cooking Time: 20 Minutes • Method: Medium

2-1/2 lbs. ground venison or 1/2 venison and 1/2 ground beef or pork	
1/4 cup butter	1 onion, chopped
2 tbs. dry red wine	1 tsp. pepper
1/2 cup finely chopped parsley	1 tsp. salt
2 cloves garlic, minced	2 tbs. soy sauce

Sauté onion, parsley and minced garlic in 1/4 cup butter. When onions are clear remove from heat. Combine sautéed mixture with meat mixture of your choice. Add remaining ingredients and mix well. Form into 8 patties, cook over medium fire for 8 to 10 minutes on each side.

## Venison Tenderloin

Yield: 1/2 Lb. (Uncooked) Per Person • Cooking Time: 20 Minutes • Method: Sear, Then Medium

Venison tenderloin	2 garlic cloves, pressed
1/4 tsp. pepper	2 tbs. soy sauce
6-8 slices bacon (more for larger tenderloin)	6 tbs. olive oil
1 tbs. seasoned salt	

Rub pressed garlic over tenderloin. Combine soy sauce, olive oil, seasoned salt, and pepper. Pour over tenderloin and marinate overnight. Wrap tenderloin in bacon, securing with toothpicks. Cover the meat completely with bacon. Cook on grill over searing heat until bacon is almost done, about 5-7 minutes. Reduce temperature, cook for an additional 13 to 15 minutes over medium fire. Turn meat continuously while searing over medium heat to guarantee even cooking.

## Smoky Ham

Cooking Time: 2-1/2 Hours • Method: Low Fire, Indirect Heat

15 lb. fully cooked ham	1/2 cup brown sugar
Coca Cola	3 Tbs. prepared mustard
3 tbs. Liquid Smoke	1/2 cup cider vinegar

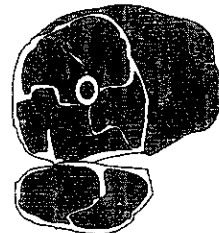

Remove the skin of a fully cooked ham, trimming the fat. Cook for 2 hours over low fire, using indirect heat. Baste several times with Coca Cola and Liquid Smoke. Combine remaining ingredients, making a glaze and brush over the ham, cook for about 30 minutes more.

# Get it fixed, at your home or ours!

For repair of major brand appliances **in your own home...**  
no matter who made it, no matter who sold it!

**1-800-4-MY-HOME®**  
(1-800-469-4663)

Anytime, day or night  
(U.S.A. and Canada)

[www.sears.com](http://www.sears.com)

[www.sears.ca](http://www.sears.ca)

---

For repair of carry-in products like vacuums, lawn equipment,  
and electronics, call for the location of your nearest  
**Sears Parts and Repair Center.**

**1-800-488-1222** Anytime, day or night (U.S.A. only)

[www.sears.com](http://www.sears.com)

---

For the replacement parts, accessories and owner's manuals  
that you need to do-it-yourself, call **Sears PartsDirect™!**

**1-800-366-PART**  
(1-800-366-7278)

6 a.m. – 11 p.m. CST, 7 days a week  
(U.S.A. only)

[www.sears.com/partsdirect](http://www.sears.com/partsdirect)

---

To purchase or inquire about a Sears Service Agreement  
or Sears Maintenance Agreement:

**1-800-827-6655** (U.S.A.)

**1-800-361-6665** (Canada)

7 a.m. – 5 p.m. CST, Mon. – Sat.

9 a.m. – 8 p.m. EST, M – F, 4 p.m. Sat.

---

Para pedir servicio de reparación a  
domicilio, y para ordenar piezas:

**1-888-SU-HOGAR<sup>SM</sup>**  
(1-888-784-6427)

Au Canada pour service en français:

**1-800-LE-FOYER<sup>MC</sup>**  
(1-800-533-6937)  
[www.sears.ca](http://www.sears.ca)

**SEARS**  
HomeCentral™

® Registered Trademark / ™ Trademark / <sup>SM</sup> Service Mark of Sears, Roebuck and Co.

® Marca Registrada / ™ Marca de Fábrica / <sup>SM</sup> Marca de Servicio de Sears, Roebuck and Co.

<sup>MC</sup> Marque de commerce / <sup>MD</sup> Marque déposée de Sears, Roebuck and Co.

© Sears, Roebuck and Co.