

# Owner's Manual

# CRAFTSMAN®

## LONG MITER/RIP FENCE KIT FOR USE WITH CRAFTSMAN 10 in. TABLE SAWS 9-22811 AND 9-22185

Item No.  
9 22217

THIS KIT MAKES EITHER A LONG MITER  
FENCE OR A LONG RIP FENCE FOR  
USE WITH ABOVE MENTIONED  
CRAFTSMAN TABLE SAWS

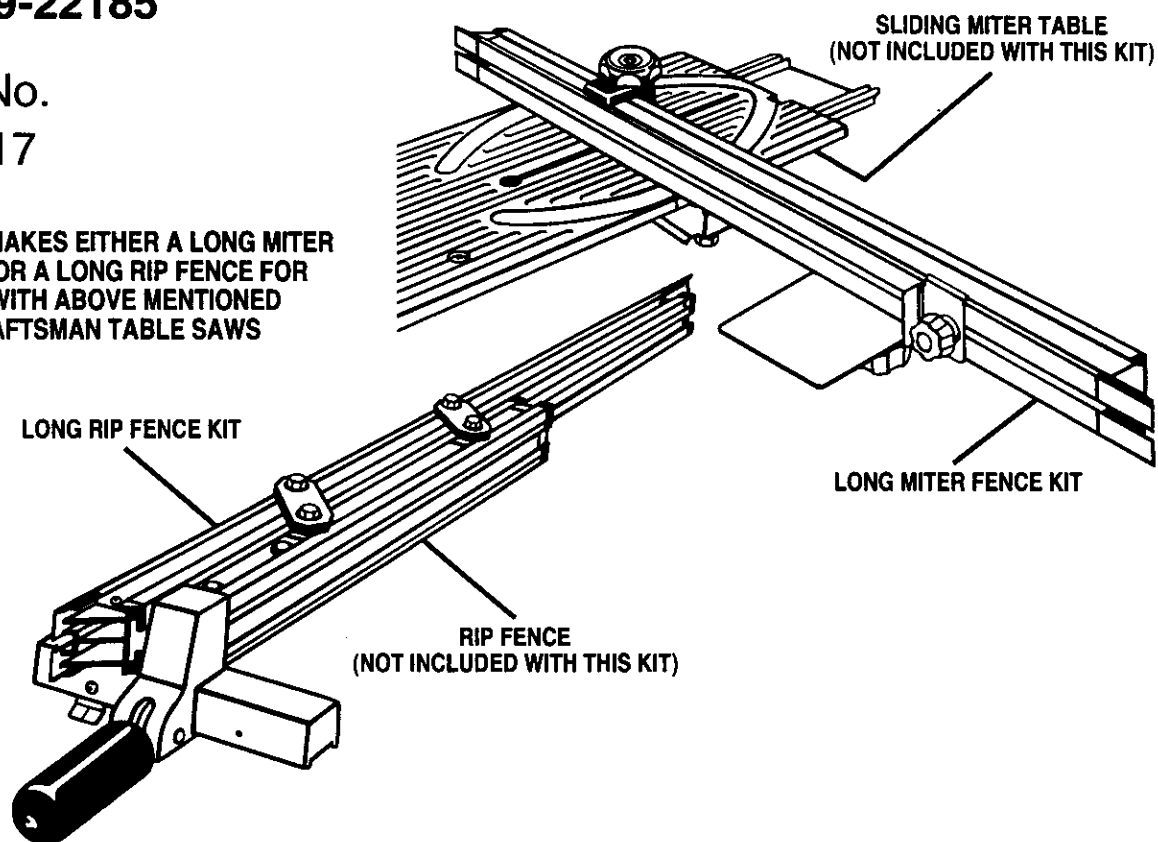

Save this manual for  
future reference.

**▲ CAUTION:** Read and follow  
all Safety Rules and Operating  
Instructions before first use of  
this product.

- SAFETY
- INTRODUCTION
- ASSEMBLY

Customer Help Line: 1-800-932-3188

Sears, Roebuck and Co., Hoffman Estates, IL 60179 USA  
Visit the Craftsman web page: [www.sears.com/craftsman](http://www.sears.com/craftsman)

972000-731  
4-00

## RULES FOR SAFE OPERATION

### READ ALL INSTRUCTIONS

- **READ THESE INSTRUCTIONS AND INSTRUCTIONS FOR YOUR TABLE SAW THOROUGHLY BEFORE USING ACCESSORY.**
- **KNOW YOUR POWER TOOL.** Read the owner's manual for your Table Saw carefully. Learn the saw's applications and limitations as well as the specific potential hazards related to this tool.
- **KEEP THE WORK AREA CLEAN.** Cluttered work areas and work benches invite accidents. **DO NOT** leave tools or pieces of wood on the saw while it is in operation.
- **ALWAYS WEAR SAFETY GLASSES.** Everyday eyeglasses have only impact-resistant lenses; they are **NOT** safety glasses.
- **ALWAYS DISCONNECT SAW FROM POWER SUPPLY BEFORE MAKING ADJUSTMENTS OR ADDING ACCESSORIES.** Make sure the switch is off when reconnecting to power supply.
- **SAVE THESE INSTRUCTIONS.** Refer to them frequently and use to instruct other users. If you loan someone this accessory, loan them these instructions also.

**⚠ Look for this symbol to point out important safety precautions. It means attention!!! Your safety is involved.**

## INTRODUCTION

Read these instructions completely before assembling or using the long miter/rip fence kit.

This new long miter/rip fence kit has been designed for use with Craftsman 10 in. table saws 922811 and 922185. The kit has been engineered and manufactured to Sears high standards for dependability, ease of operation, and operator safety. This kit provides additional support and control for making safe and accurate miter cuts on long pieces of work. It also provides additional support and control for making

safe and accurate rip cuts in long pieces of work. Properly cared for, it will provide years of dependable, trouble-free performance.

**⚠ WARNING:** Before attempting to use this accessory, familiarize yourself with all operating features and safety requirements for the accessory and the table saw.

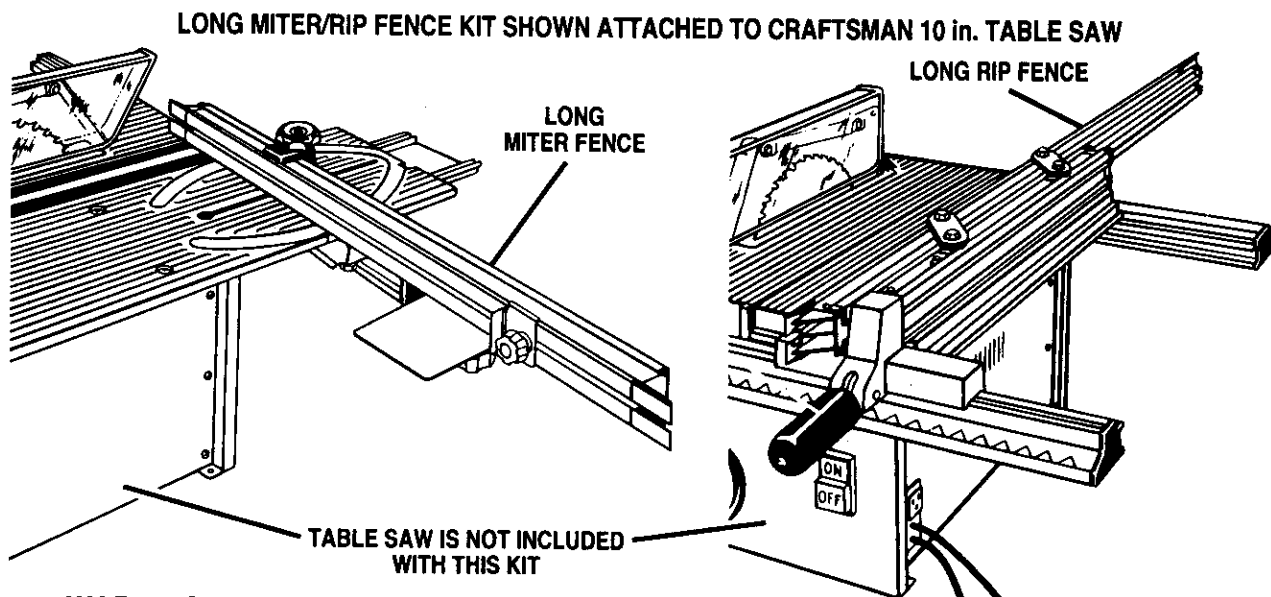

### **⚠ WARNING:**



The operation of any tool can result in foreign objects being thrown into your eyes, which can result in severe eye damage. Before beginning tool operation, always wear safety goggles or safety glasses with side shields and a full face shield when needed. We recommend Wide Vision Safety Mask for use over eyeglasses or standard safety glasses with side shields, available at Sears Retail Stores.

## ASSEMBLY

**⚠ WARNING:** Use recommended accessories. The use of improper accessories may create a risk of injury. Do not use this long miter/rip fence kit for any purpose other than as an accessory to the recommended table saw. Failure to heed this warning can result in serious personal injury.

**Note:** When used as a long miter fence this kit temporarily replaces the miter fence supplied with your saw. When used as a long rip fence it attaches to the rip fence supplied with your saw.

### UNPACKING AND CHECKING PARTS

Your new long miter/rip fence kit includes a 41 in. extension rail, plus the necessary gages, brackets, and connecting hardware required to assemble a long miter fence and attach it to the sliding miter table of your table saw. It also includes connectors and hardware required for attaching a long rip fence to your saw.

Separate all parts from the packing materials. Check the parts with the parts list and Figure 1. If any parts are missing, delay your assembly of this kit until you have obtained the missing part(s).

**⚠ WARNING:** Do not assemble the long miter/rip fence kit or use in any way without obtaining any missing parts. Install all parts correctly. Failure to heed this warning could result in an accident and possible personal injury.

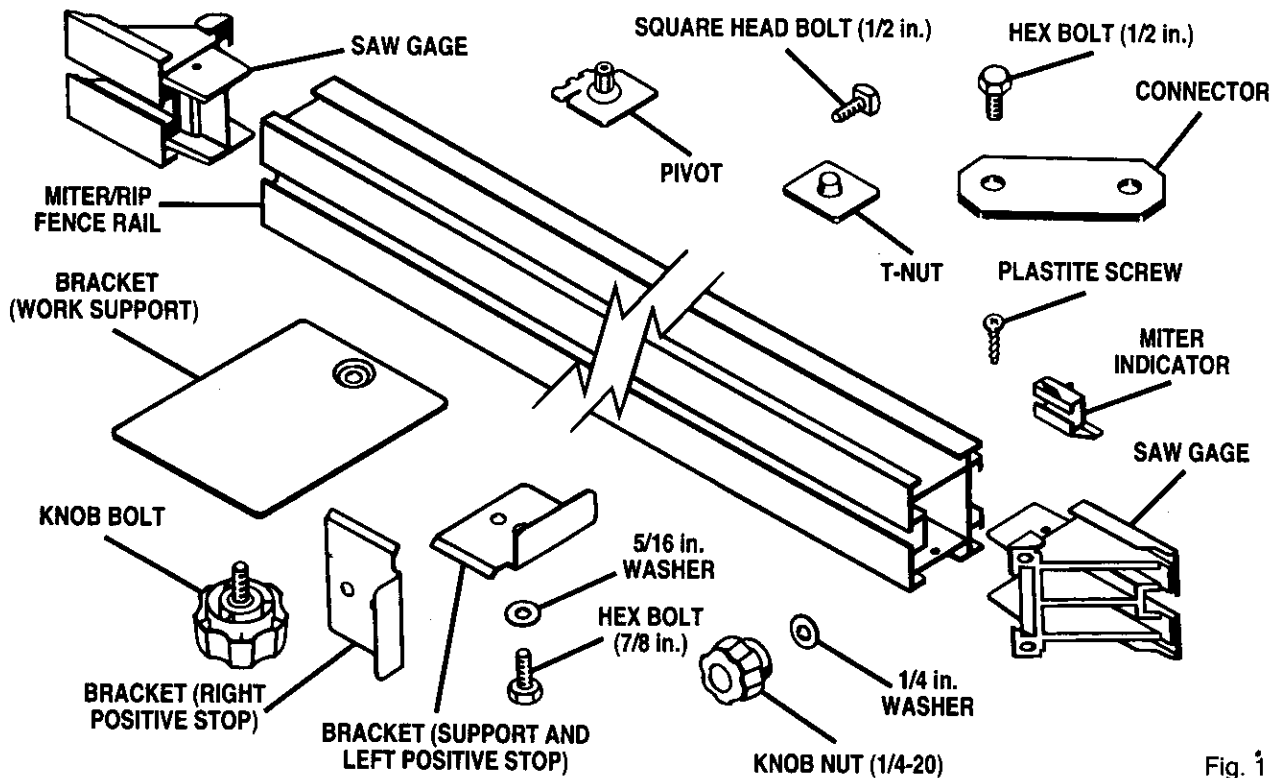

Fig. 1

### List of Loose Parts

Your Long Miter/Rip Fence Kit includes the following parts:

Description	Quantity	Description	Quantity
Miter/Rip Fence Rail .....	1	Washer (1/4 in.) .....	1
Bracket (Support and Left Positive Stop) .....	2	Plastite Screw (8-16 x 5/8 in. Pan Hd.) .....	2
Saw Gage .....	2	Bracket (Work Support) .....	1
Knob Bolt (5/16-18 x 1/2 in.) .....	1	Bolt (5/16-18 x 7/8 in. Hex Hd.) .....	1
Knob Nut (1/4-20) .....	1	Miter Indicator .....	1
5/16 in. T-Nut (Special) .....	6	Pivot .....	1
Bolt (1/4-20 x 1/2 in. Sq. Hd.) .....	1	Connector .....	2
Washer (5/16 in.) .....	6	Bolt (5/16-18 x 1/2 in. Hex Hd.) .....	4
Bracket (Right Positive Stop) .....	1		

# ASSEMBLY

## TOOLS NEEDED

Tools needed for assembly of this kit are a phillips screwdriver, 1/2 in. socket wrench, or the small wrench supplied with your table saw. (Phillips screwdriver and 1/2 in. socket wrench not included).

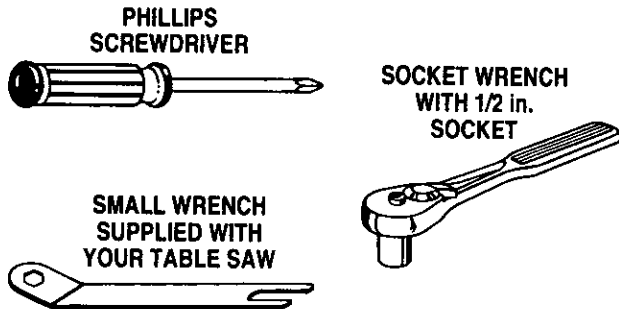

## LONG MITER FENCE TO ASSEMBLE THE PIVOT (Locator Pin)

See Figures 2 and 3.

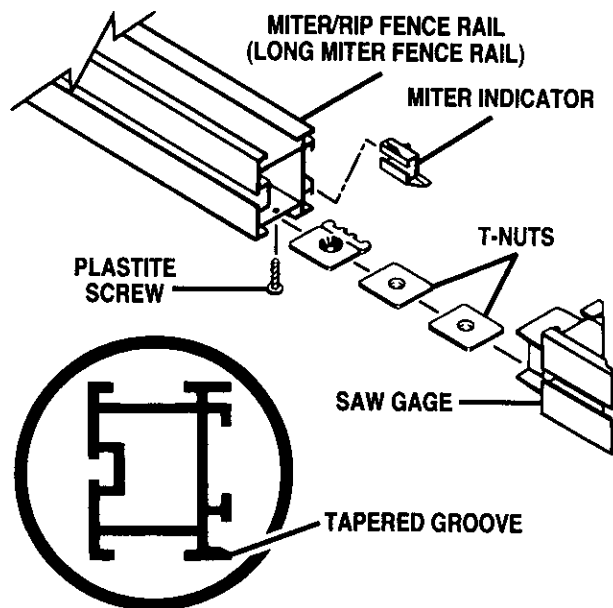

RAIL ORIENTATION FOR LONG MITER FENCE SETUPS

Fig. 2

- Unplug the saw.

**WARNING:** Unplug the saw to avoid possible injury.

- Remove the miter fence, the miter fence holder, and the adjusting clamp from sliding miter table on your table saw.
- Place the long miter fence rail on the sliding miter table. See Figure 3.

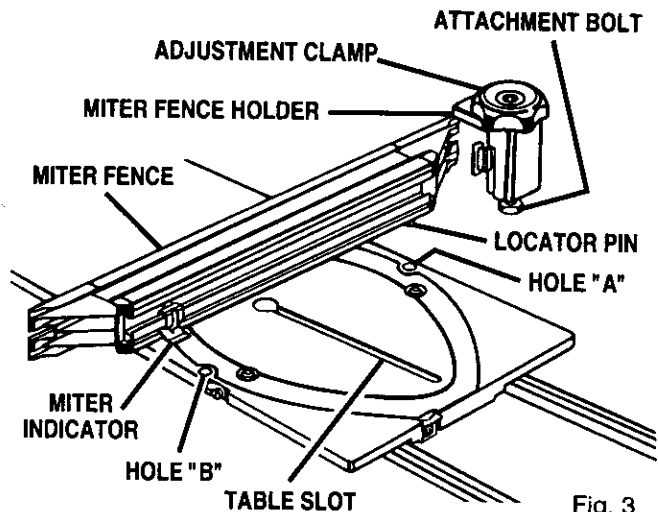

Fig. 3

**IMPORTANT:** Rail must be oriented exactly as shown for proper assembly of all parts.

Tapped holes in the rail are in the bottom channel when using the rail as a long miter fence. Tapped holes are in the top channel when using the rail as a long rip fence.

- Slide the pivot into the bottom channel of the long miter fence rail.

**Note:** The pivot assembled to the miter fence provided with your table saw is assembled identical to this assembly.

This pivot fits in either hole "A" or hole "B" when mounting the long miter fence to the sliding miter table.

**Note:** Raised ribs on the pivot create a tight fit when installing the pivot. It may be necessary to force the pivot into the holes at first. See Figure 3.

## ASSEMBLE THE MITER INDICATOR

See Figure 2.

- Align the miter indicator with the tapered groove on the long miter fence rail.
- Slide the miter indicator onto the rail. The bottom of the miter indicator should be next to the sliding miter table.

**Note:** The miter indicator for the long miter fence is the same as the miter indicator on the miter fence provided with your table saw. Use the miter indicator with the scale on the sliding miter table to set desired angles for making miter cuts.

## ASSEMBLE THE T-NUTS

See Figure 2.

- Slide two of the special 5/16 in. t-nuts into the bottom channel of the long miter fence rail. T-nuts will be used later to secure the brackets. The t-nuts must be placed in the channel before assembling the saw gage screws. The saw gage screws trap the t-nuts inside the channel.

# LONG MITER FENCE

## ASSEMBLE THE SAW GAGES

See Figure 4.

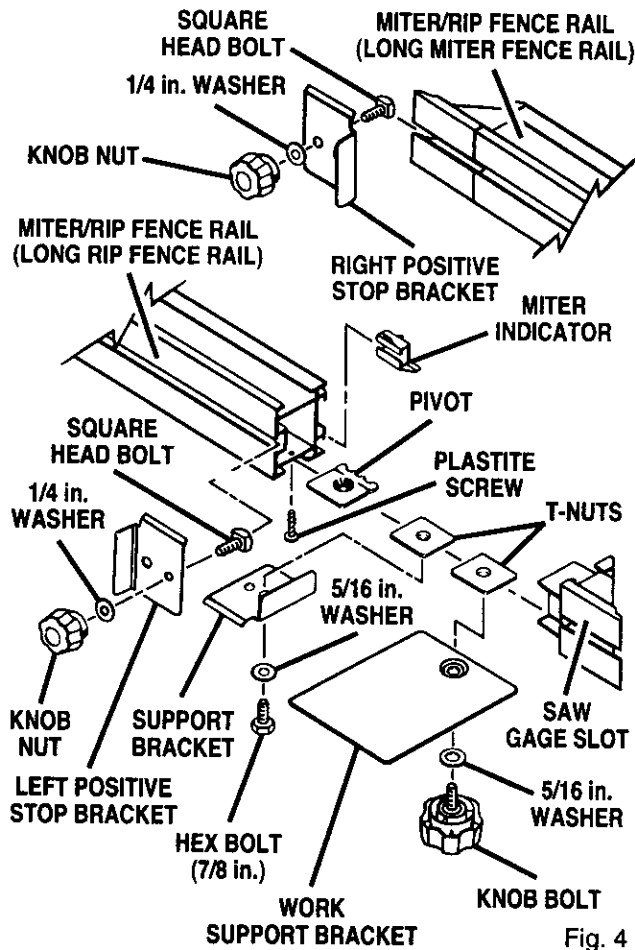

Fig. 4

- Place a saw gage into each end of the long miter fence rail. Correct orientation of the saw gage to the rail is important. Align the slot in the saw gage with the slot in the rail. See Figure 4.
- Secure both saw gages to the rail with 8-16 x 5/8 in. plastite screws provided. The long miter fence rail has tapped holes on the bottom at each end. Place screws through these holes and thread into the pilot holes in the saw gages.

**Note:** If the screw holes in saw gages become stripped after extended use, turn them over and secure to the opposite ends of rail. Pilot holes have been tapped on both the top and bottom of saw gages.

- Tighten screws securely.

## ASSEMBLE THE MITER FENCE HOLDER AND THE ADJUSTING CLAMP

Reassemble the miter fence holder and the adjusting clamp. Place the miter fence holder supplied with your table saw on the long miter fence and secure to the sliding miter table. See Figure 5.

## ASSEMBLE THE SUPPORT BRACKET

See Figures 4 and 5.

The support bracket attaches to the bottom of long miter fence and sliding miter table. As the name implies it provides support and stability for the long miter fence rail.

- Orient the support bracket as shown in figure 5. Slide the bracket under the edge of the sliding miter table.

- Secure the support bracket to the bottom of the long miter fence with a 5/16 in. washer and 5/16 -18 x 7/8 in. hex bolt.

**Note:** Thread the hex bolt into a 5/16 in. t-nut closest to the table saw.

- Tighten the bolt securely.

## ASSEMBLE THE POSITIVE STOP BRACKET

See Figures 4 and 5.

Two positive stop brackets have been provided for use as gages when making repetitive cuts. One each is provided for left or right side application.

- Insert the square head bolt in the slot in the rip fence. See Figures 4 and 5.
- Attach the positive stop bracket to the long miter fence and secure with a 1/4 in. washer and 1/4-20 knob nut.
- Place either of the left or right positive stop brackets at the desired position on the rail for repetitive cuts, etc.
- Tighten the knob nut securely.

## ASSEMBLE THE WORK SUPPORT BRACKET

See Figures 4 and 5.

The work support bracket attaches to the bottom of long miter fence. As the name implies it provides support and stability for long workpieces when making miter cuts on long stock.

- Attach work support bracket to bottom of long miter fence as shown in figures 4 and 5.
- Secure the bracket with a 5/16 in. washer and a 5/16-18 x 1/2 in. knob bolt. Thread the knob bolt into the remaining 5/16 in. t-nut in the bottom channel of the rail.
- Tighten the knob bolt securely.

# LONG MITER FENCE

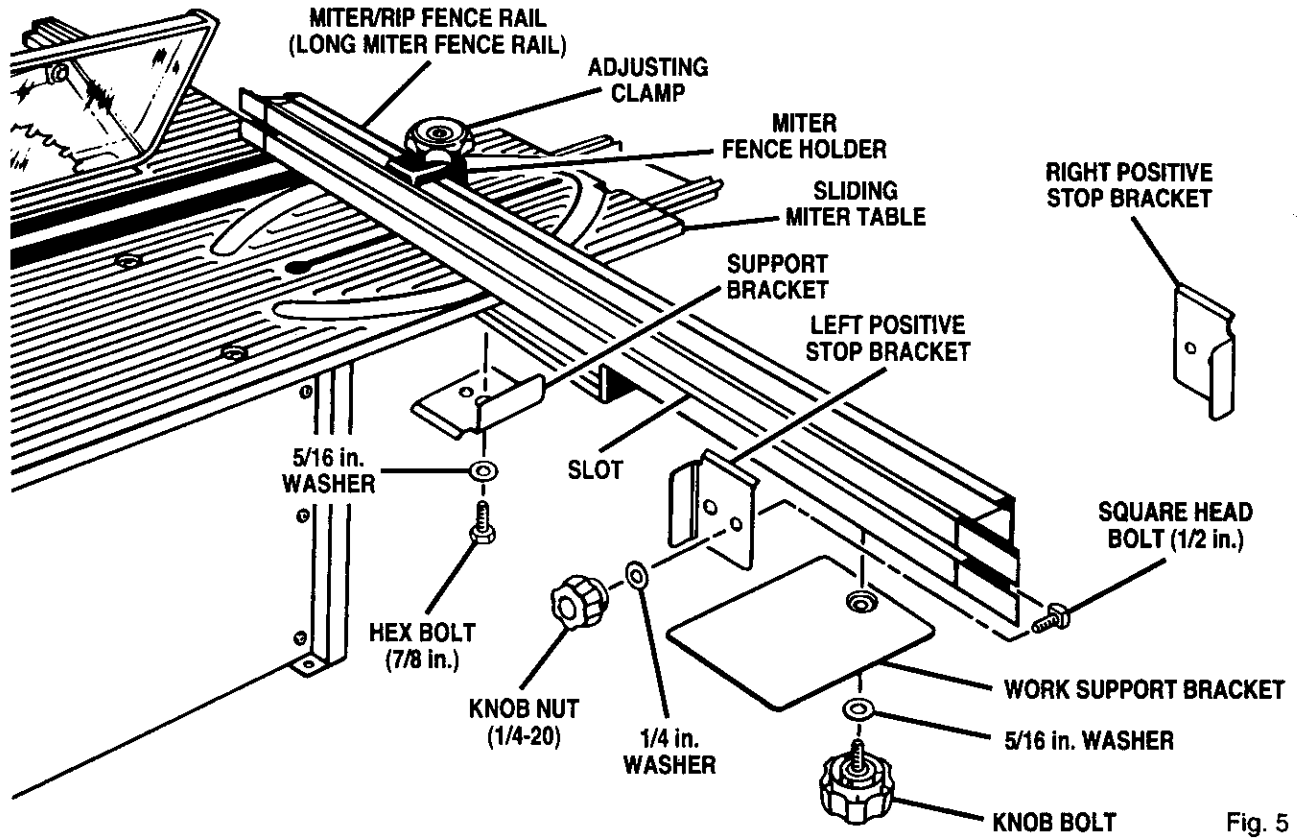
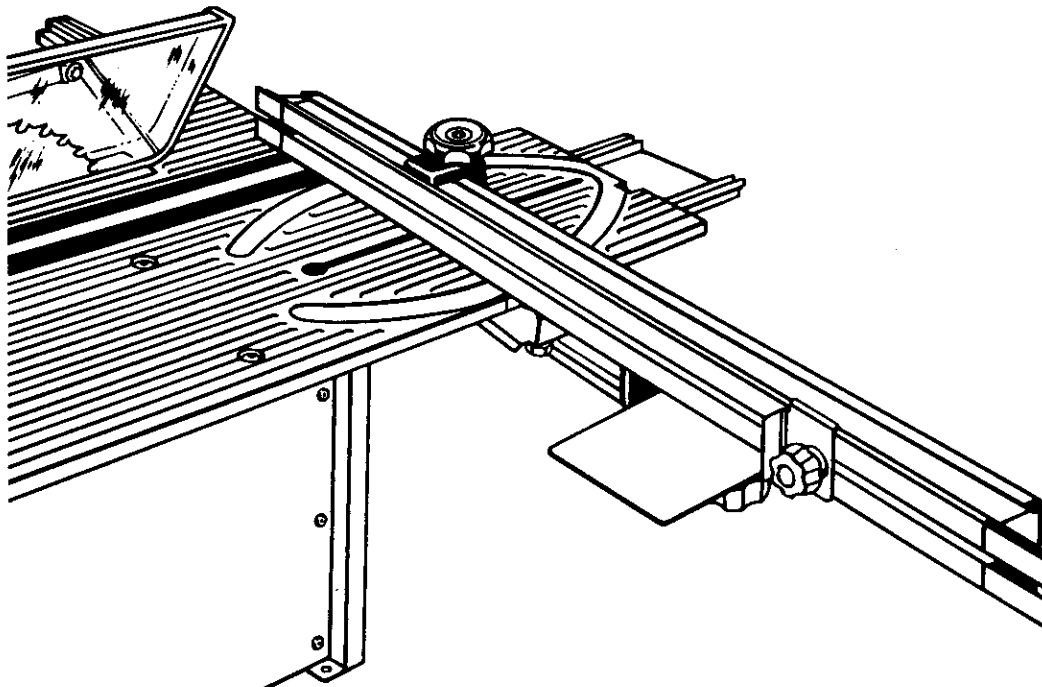

Fig. 5

## COMPLETED LONG MITER FENCE ASSEMBLY

See Figure 6.

After assembling all the parts, your long miter fence should be similar to the illustration shown in figure 6. Recheck all necessary steps. Recheck all bolts, screws, and knobs, for tightness.



LONG MITER FENCE ASSEMBLY SHOWN ATTACHED TO A CRAFTSMAN TABLE SAW

Fig. 6

## LONG RIP FENCE

This kit also includes connectors and hardware required for attaching a long rip fence to your saw. If you have been using this kit as a long miter fence, it will be necessary to remove all connectors, brackets, hardware, etc. If you are assembling for the first time, proceed as follows.

### ASSEMBLE THE LONG RIP FENCE

See Figures 7, 8, and 9.

The long rip fence rail attaches to the existing rip fence on your table saw, to provide a long extension rail when ripping large panels and long pieces of work.

- Place the long rip fence rail on the saw table. See Figure 7. **IMPORTANT: Rail must be oriented exactly as shown for proper assembly of all parts.** Drilled holes in the rail are on the top channel when using as a long rip fence. They are in the bottom channel when using the rail as a long miter fence.
- Slide two of the special 5/16 in. t-nuts into the top channel of the long rip fence rail. T-nuts will be used to secure the connectors. The t-nuts must be placed in the channel before assembling the saw gage screws. Saw gage screws trap the t-nuts inside the channel.
- Place a saw gage into each end of long miter fence rail. Correct orientation of saw gage to rail is important. Align the slot in the saw gage with the slot in the rail. See Figure 7.

#### RAIL ORIENTATION FOR LONG RIP FENCE SETUPS

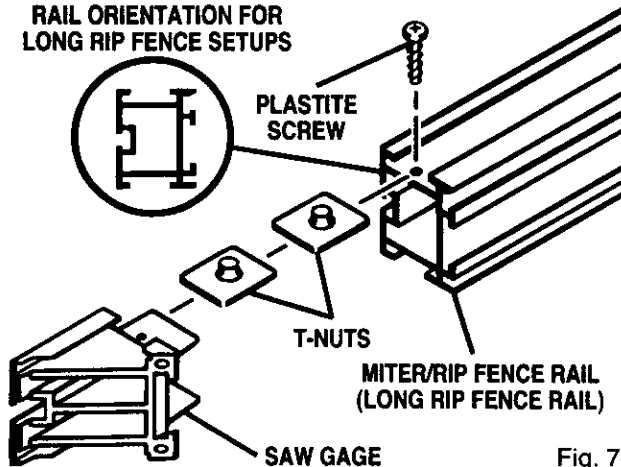

Fig. 7

- Secure each saw gage to the rail with 8-16 x 5/8 in. plastite screws provided. The long rip fence rail has holes drilled on the top at each end. Place screws through these holes and thread into the pilot holes in the saw gage.

**Note:** If the screw holes in the saw gages become stripped after extended use, turn the saw gages over and secure to the opposite ends of the rail. Pilot holes have been drilled on both the top and bottom of the saw gages.

- Tighten the screws securely.

- Slide two of the special 5/16 in. t-nuts into the top channel of your saw's rip fence. T-nuts will be used to secure the connectors. The t-nuts must be placed in the channel from the rear of the saw. See Figure 8.
- Attach the long rip fence to the existing rip fence on the saw with two connectors. See Figure 8.

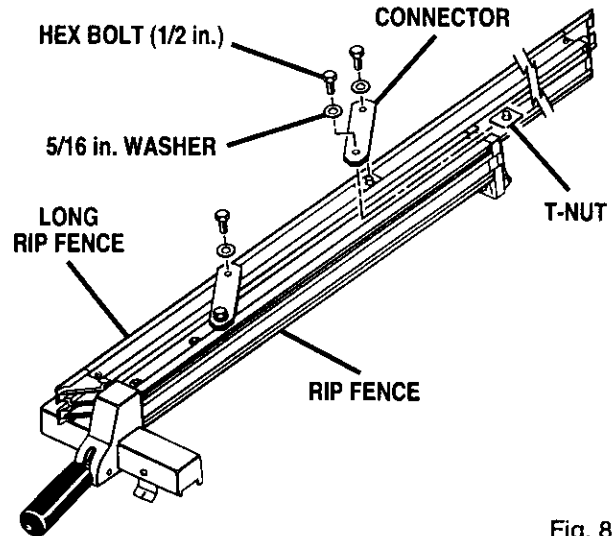

Fig. 8

- Secure the connectors using 5/16 in. washers and 5/16-18 x 1/2 in. bolts.
- Tighten bolts securely.

### COMPLETED LONG RIP FENCE ASSEMBLY

See Figure 9.

#### LONG RIP FENCE ASSEMBLY SHOWN ATTACHED TO A CRAFTSMAN TABLE SAW

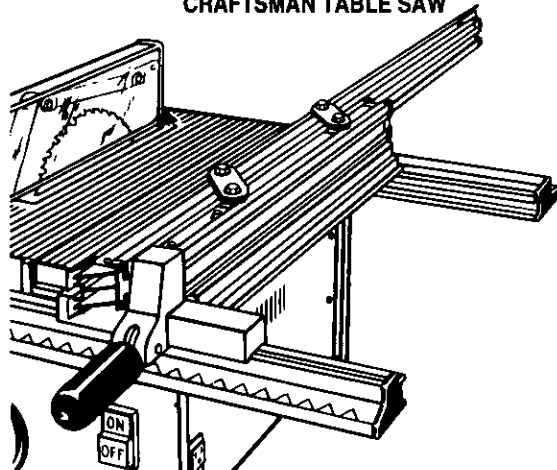
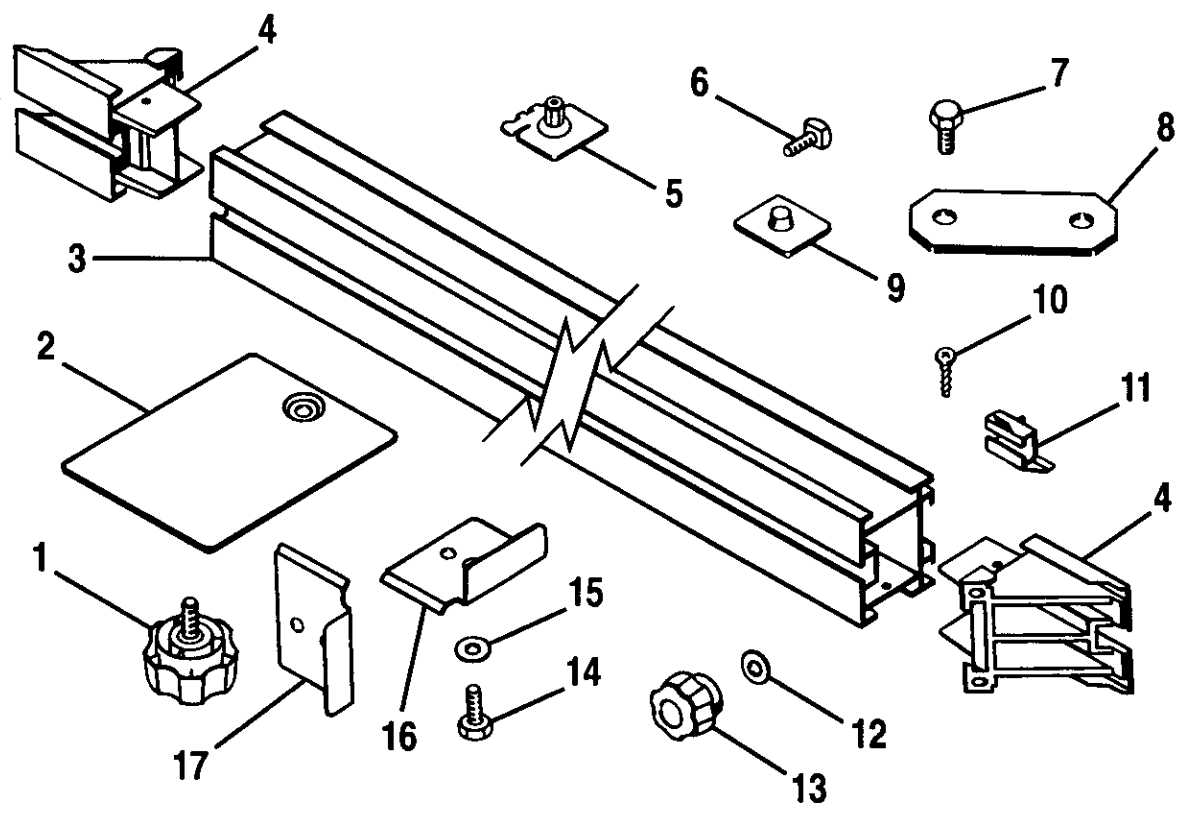

Fig. 9

After assembling all the parts, your long rip fence should be similar to the illustration shown in figure 9. Recheck all necessary steps. Recheck all bolts and screws for tightness.

**CRAFTSMAN LONG MITER/RIP FENCE KIT ITEM NO. 922217**

Always mention the accessory item number in all correspondence regarding your long miter/rip fence kit accessory or when ordering repair parts.



**PARTS LIST**

Key No.	Part Number	Description	Quan.
1	661815-001	Knob Bolt (5/16-18 x 1/2 in.)	1
2	969959-009	Bracket (Work Support)	1
3	969958-001	Miter/Rip Fence Rail	1
4	969190-001	Saw Gage	2
5	661811-001	Pivot	1
6	623166-005	* Bolt (1/4-20 x 1/2 in. Sq. Hd.)	1
7	** STD523108	* Bolt (5/16-18 x 1/2 in. Hex Hd.)	4
8	970147-002	Connector	2
9	969251-001	5/16 in. T-Nut (Special)	6
10	968702-009	Screw (8-16 x 5/8 in. Plastite Pan Hd.)	1
11	969191-002	Miter Indicator	1
12	** STD551025	* Washer (1/4 in.)	1
13	661816-001	Knob Nut (1/4-20)	1
14	** STD523108	* Bolt (5/16-18 x 7/8 in. Hex Hd.)	1
15	** STD551031	* Washer (5/16 in.)	6
16	969960-001	Bracket (Support and Left Positive Stop)	2
17	662125-001	Bracket (Right Positive Stop)	1
	972000-731	Owner's Manual	

\* Standard Hardware Item – May Be Purchased Locally  
 \*\* Available From Div. 98 – Source 980.00