

Owner's Manual

CRAFTSMAN®

AG CART

Model No. 486.244050

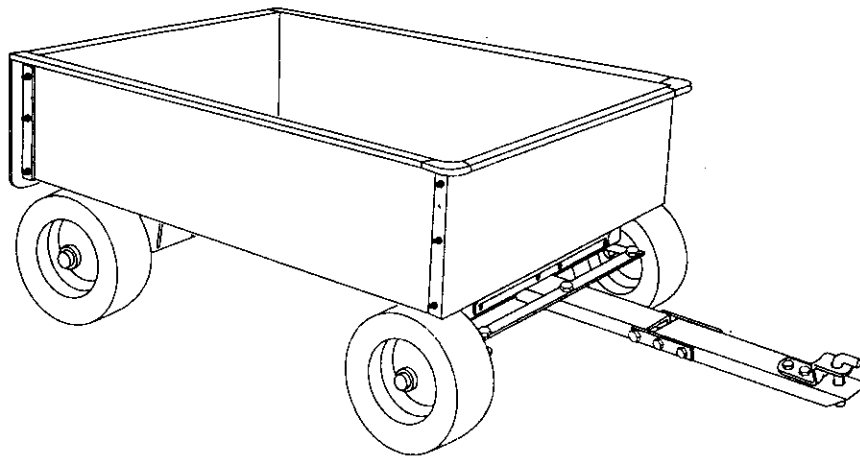

CAUTION:

Before using this product,
read this manual and follow
all Safety Rules and
Operating Instructions.

- Safety
- Assembly
- Operation
- Maintenance
- Parts

Sears, Roebuck and Co., Hoffman Estates, IL 60179 U.S.A.

PRINTED IN U.S.A.

TABLE OF CONTENTS

SAFETY RULES	3	STORAGE	11
FULL SIZE HARDWARE CHART	4	REPAIR PARTS ILLUSTRATION	12
CARTON CONTENTS	5	REPAIR PARTS LIST	13
ASSEMBLY	5	SLOPE GUIDE	15
OPERATION	10	PARTS ORDERING/SERVICE	Back Cover
MAINTENANCE	11		

WARRANTY

LIMITED ONE YEAR WARRANTY ON

For one year from the date of purchase, when this cart is maintained and lubricated according to the operating and maintenance instructions in the owner's manual, Sears will repair any defect in material or workmanship free of charge. If this cart is used for commercial or rental purposes, this warranty applies for only 90 days from the date of purchase.

This warranty does not cover repairs necessary because of operator negligence or abuse, including the failure to maintain the equipment according to instructions contained in the owner's manual.

WARRANTY SERVICE IS AVAILABLE BY CONTACTING THE NEAREST SEARS SERVICE CENTER/DEPARTMENT IN THE UNITED STATES.

This warranty applies only while this product is in the United States.

This warranty gives you specific legal rights, and you may also have other rights which vary from state to state. Sears, Roebuck and Co. D/817 WA. Hoffman Estates, Chicago, IL 60179

The model number and serial numbers will be found on a decal attached to the front panel.

You should record both the serial number and the date of purchase and keep in a safe place for future reference.

MODEL NUMBER: 486.244050

SERIAL NUMBER: _____

DATE OF PURCHASE: _____



SAFETY



Any power equipment can cause injury if operated improperly or if the user does not understand how to operate the equipment. Exercise caution at all times, when using power equipment.

- Exercise caution at all times when using power equipment.
- Read this owners manual before attempting to assemble or operate the cart.
- Read the vehicle owners manual and know how to operate your tractor, before using the cart attachment.
- Do not at any time carry passengers in this cart. It has not been designed to carry passengers.
- Never allow children to operate the tractor or the cart attachment.
- Do not allow adults to operate the tractor or cart attachment without proper instructions.
- Always begin with the transmission in first (low) and gradually increase speed as conditions permit.
- Tow the cart at reduced speed over rough terrain and hillsides or near creeks and ditches to prevent tipping over and loss of control. Do not drive too close to a creek or ditch.
- Vehicle braking and stability may be affected with the attachment of this cart. Do not fill cart to maximum weight capacity without checking the capability of the towing vehicle to safely pull and stop with the cart attached.
- Before operating vehicle on any grade (hill) refer to the safety rules in the vehicle owner's manual concerning safe operation on slopes. Refer also to the slope guide on page 15 of this manual. **Stay off steep slopes!**
- Do not unhook your cart from the tractor while on a slope. The cart could unexpectedly roll down the slope.
- Do not tow this cart on highways or on public thoroughfares.
- Maximum towing speed is 10 m.p.h.
- Follow maintenance and lubrication instructions as outlined in this manual.



Look for this symbol to point out important safety precautions. It means--**Attention!! Become alert!! Your safety is involved.**

HARDWARE PACKAGE CONTENTS

HARDWARE SHOWN FULL SIZE

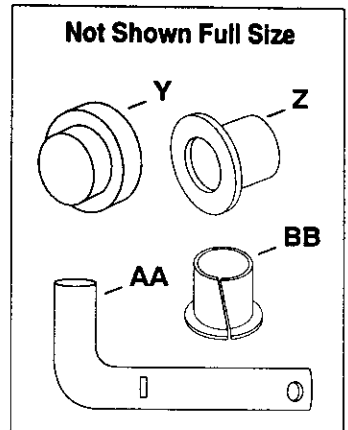
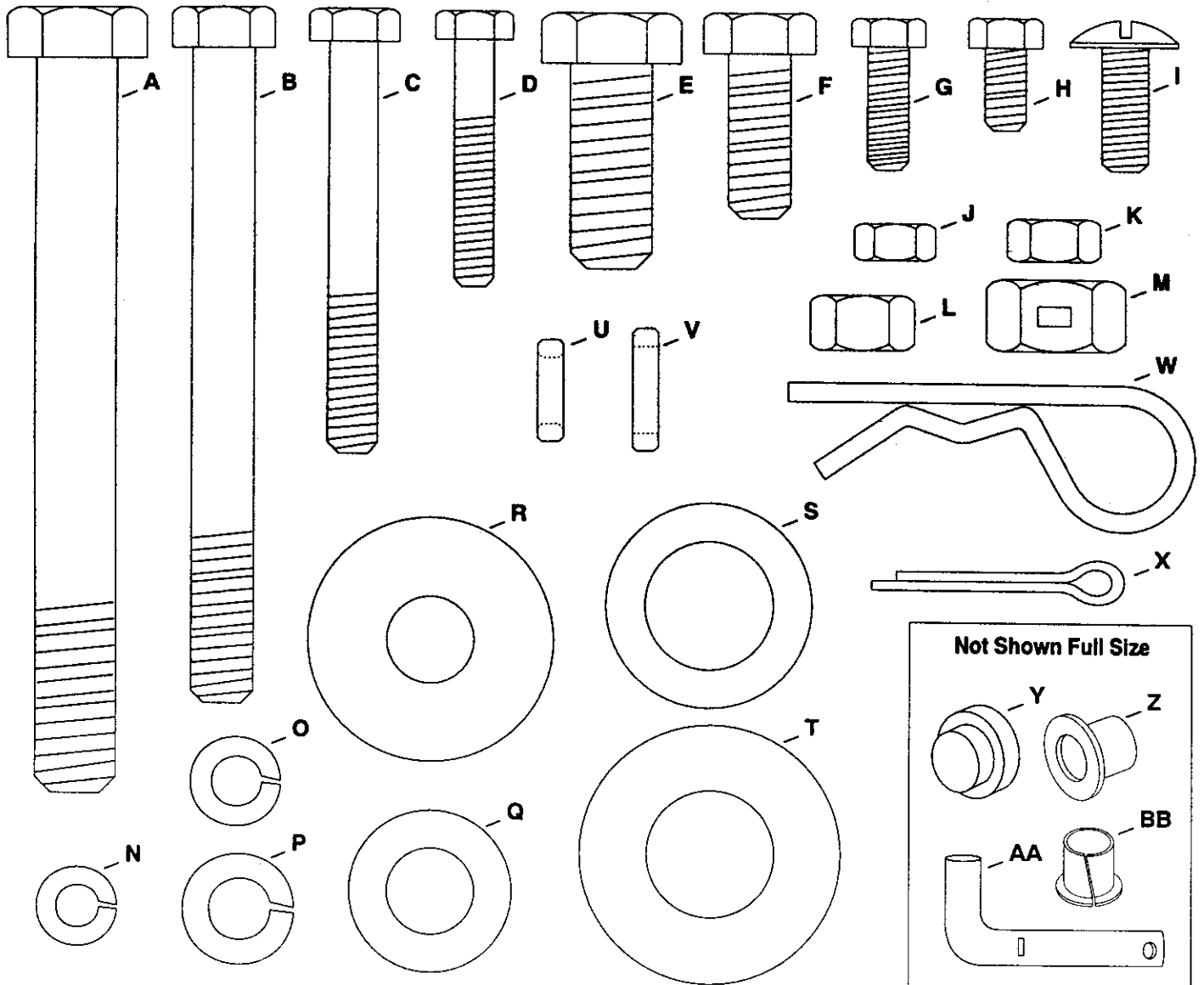

REF.	QTY.	DESCRIPTION	REF.	QTY.	DESCRIPTION
A	2	Hex Bolt, 1/2-13 x 4-1/2" Lg.	O	26	Lock Washer, 5/16"
B	2	Hex Bolt, 3/8-16 x 4" Lg.	P	8	Lock Washer, 3/8"
C	4	Hex Bolt, 5/16-18 x 2-1/2" Lg.	Q	6	Flat Washer, 1/2" (small)
D	1	Hex Bolt, 1/4-20 x 1-1/2" Lg.	R	1	Flat Washer, 1/2" (large)
E	3	Hex Bolt, 1/2-13 x 1-1/4" Lg.	S	4	Flat Washer, 3/4" (small)
F	6	Hex Bolt, 3/8-16 x 1" Lg.	T	8	Flat Washer, 3/4" (large)
G	6	Hex Bolt, 1/4-20 x 3/4" Lg.	U	1	Spacer Bushing
H	27	Hex Bolt, 1/4-20 x 1/2" Lg.	V	1	Pivot Bushing
I	22	Slotted Bolt, 5/16-18 x 3/4" Lg.	W	1	Haircotter Pin, 1/8"
J	34	Hex Nut, 1/4-20 Thread	X	8	Cotter Pin, 1/8" x 1" Lg.
K	26	Hex Nut, 5/16-18 Thread	Y	4	Hub Cap
L	8	Hex Nut, 3/8-16 Thread	Z	2	Plastic Flange Bearing
M	5	Hex Lock Nut, 1/2-13 Thread	AA	1	Hitch Pin
N	34	Lock Washer, 1/4"	BB	4	Plastic Split Bearing

ASSEMBLY

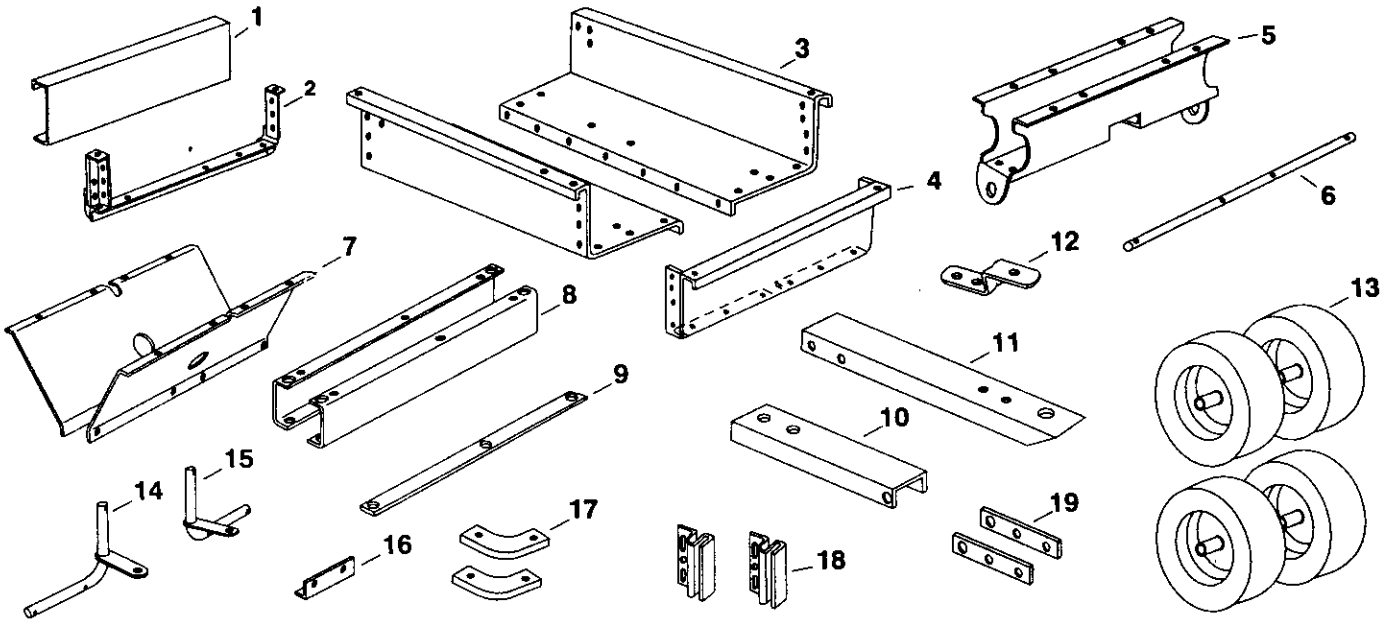

CARTON CONTENTS

- | | | |
|-----------------------------------|---------------------------|--------------------------------|
| 1. Tailgate | 7. Front Axle Support | 14. R.H. Axle Spindle |
| 2. Tailgate Reinforcement Bracket | 8. Front Axle Channel | 15. L.H. Axle Spindle |
| 3. Cart Bed (2) | 9. Tie Rod | 16. Tongue Reinforcement Angle |
| 4. Front Panel | 10. Tongue, Rear Section | 17. Corner Caps (2) |
| 5. Wheel Support | 11. Tongue, Front Section | 18. Tailgate Guides (2) |
| 6. Axle, Rear | 12. Hitch Bracket | 19. Pivot Bars (2) |
| | 13. Wheels (4) | Hardware Package (page 4) |

IMPORTANT: Due to the weight of the cart after all four wheels are attached, it is recommended that someone assist you when it is time to lower the cart onto its wheels.

- Assemble halves together using nine 1/4" x 1/2" hex bolts, 1/4" lock washers and 1/4" hex nuts as shown in figure 1. **Do not tighten at this time.**

TOOLS REQUIRED FOR ASSEMBLY

- (1) Screwdriver
- (1) Pliers
- (2) 7/16" Wrenches
- (2) 1/2" Wrenches
- (2) 9/16" Wrenches
- (2) 3/4" Wrenches
- (4) Recommended - small bricks or blocks of wood (2" x 4") for chocking the wheels.

REMOVAL OF PARTS FROM CARTON

- Remove all parts and hardware packages from the carton. Lay out all parts and hardware and identify using the illustrations on pages 3 and 4.
- Lay out all the parts and hardware as shown on pages 2 and 3.
- Position cart body halves upright on a smooth level surface such as a garage floor or a paved driveway. See figure 1.

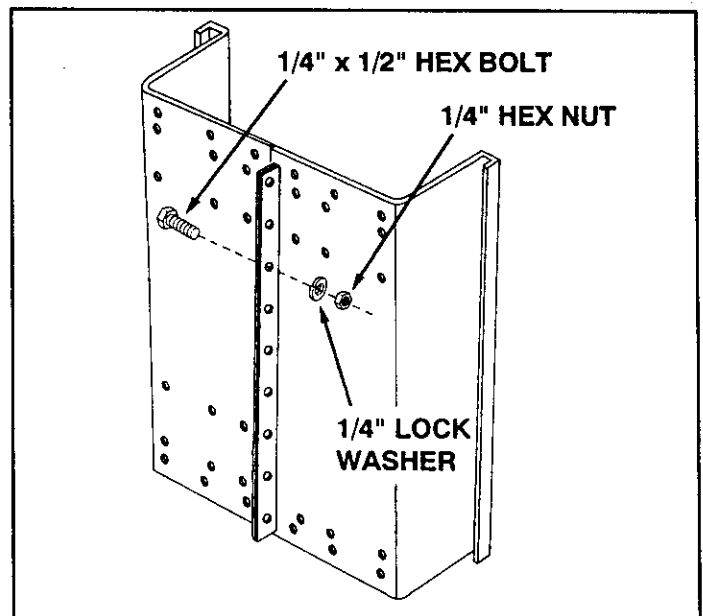

FIGURE 1



CAUTION: Do not leave the cart unattended in an upright position. A falling cart can cause injury. Pay close attention to the stability of the cart while it is in an upright position. For best stability, assemble the cart on a smooth, level surface.

- Position the tailgate reinforcement bracket on outside of cart as shown in figure 2. Assemble to the bottom of the cart body using six 5/16" x 3/4" slotted bolts, 5/16" lock washers and 5/16" hex nuts. **Do not tighten.** See figure 2.
- Position the tailgate guides on the inside of the cart bodies as shown in figure 2 (bolt holes to the rear). Assemble to the cart using six 1/4" x 3/4" hex bolts, 1/4" lock washers and 1/4" hex nuts. **Do not tighten.**
- Assemble two 1/4" x 1/2" hex bolts, 1/4" lock washers and 1/4" hex nuts down through the top rear corners of the cart. **Do not tighten.** See figure 2.
- **Tighten** the six slotted bolts assembled in figure 2. **Tighten** the eight hex bolts assembled in figure 2. **Tighten** the nine hex bolts assembled in figure 1, keeping the bottom of the cart body halves even.

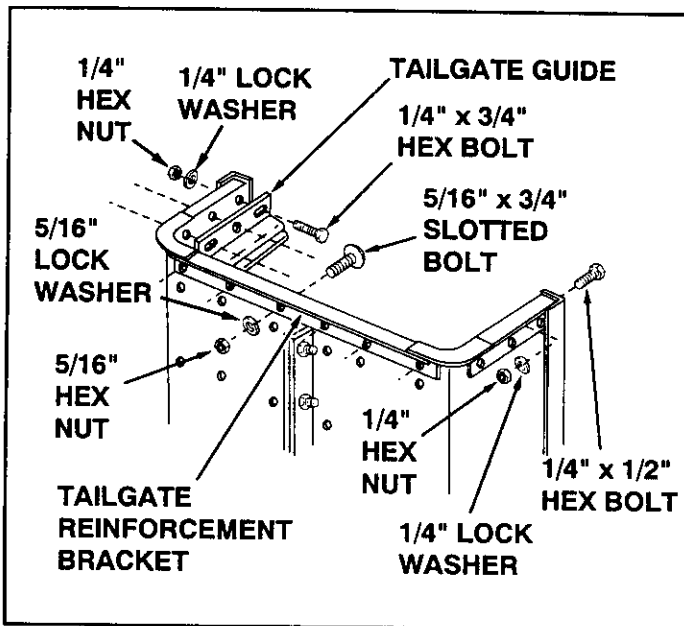

FIGURE 2

- Lower the cart to rest upside down on its top flanges. See figure 3.
- Assemble the wheel support at the rear of the cart using eight 5/16" x 3/4" slotted bolts, 5/16" lock washers and 5/16" hex nuts as shown in figure 3. Bolt heads go on inside of cart. **Tighten.**

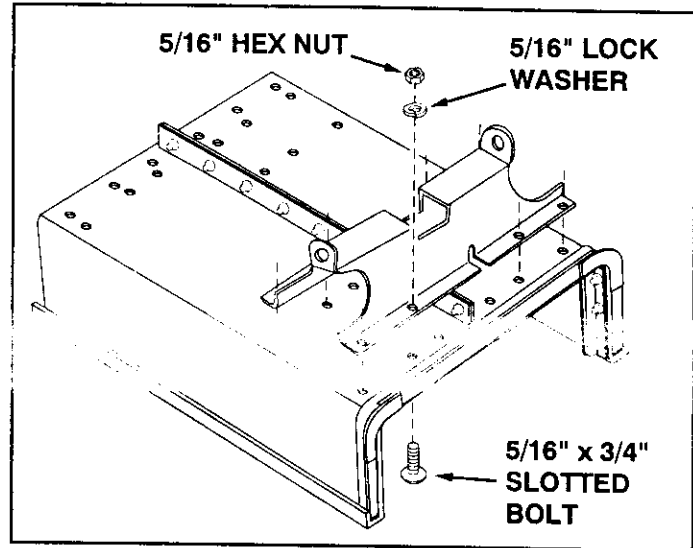

FIGURE 3

- Assemble the two plastic flange bearings to the wheel support as shown in figure 4.
- Assemble the axle through the wheel support and the bearings as shown in figure 4.
- Fasten the axle to the wheel support using a 1/4" x 1-1/2" hex bolt, the spacer bushing, a 1/4" lock washer and a 1/4" hex nut. See figure 4.
- Assemble a large 3/4" flat washer, a wheel, another large 3/4" flat washer and a cotter pin to each end of the axle as shown in figure 4.
- Assemble a hub cap over the 3/4" flat washer on each end of the axle as shown in figure 4.

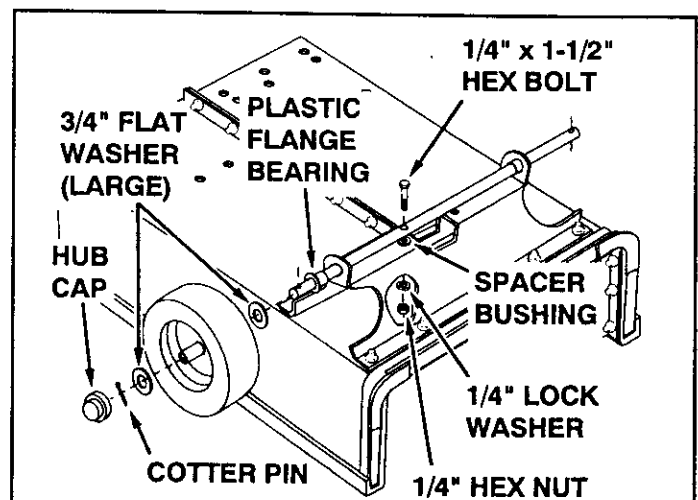

FIGURE 4

- Stand the cart on end, front end facing up.
- Assemble the two front axle supports to the cart using eight 5/16" x 3/4" slotted bolts, 5/16" lock washers and 5/16" hex nuts as shown in figure 5. **Do not tighten yet.**

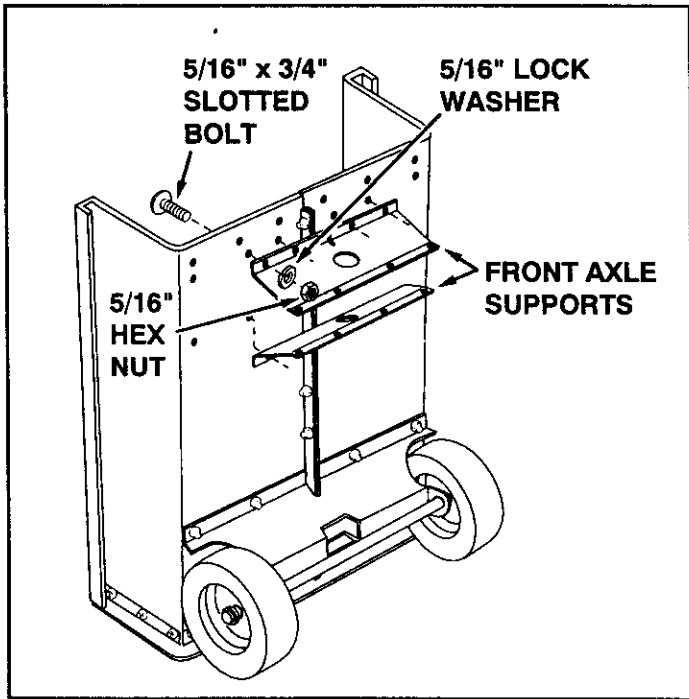

FIGURE 5

- Assemble the R.H. axle spindle to the front axle channels using two split plastic bearings, two small 3/4" flat washers and a cotter pin as shown in figure 7. Repeat for L.H. axle spindle.
- Tighten the two 3/8" x 4" hex bolts assembled in figure 6. **Do not tighten the 1/2" x 4-1/2" center bolt.**

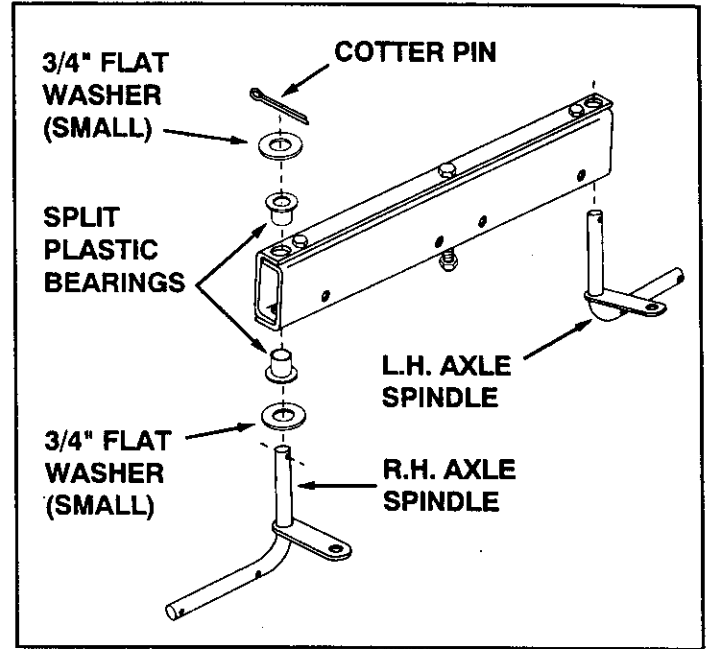

FIGURE 7

- Place the two front axle channels together as shown in figure 6, making sure the holes in the top, bottom and sides are aligned. Use two 3/8" x 4" hex bolts, 3/8" lock washers and 3/8" hex nuts to fasten the ends of the channels together. Place a 1/2" x 4-1/2" hex bolt and a 1/2" hex lock nut in the middle hole in the channels. **Do not tighten** the bolts at this time.

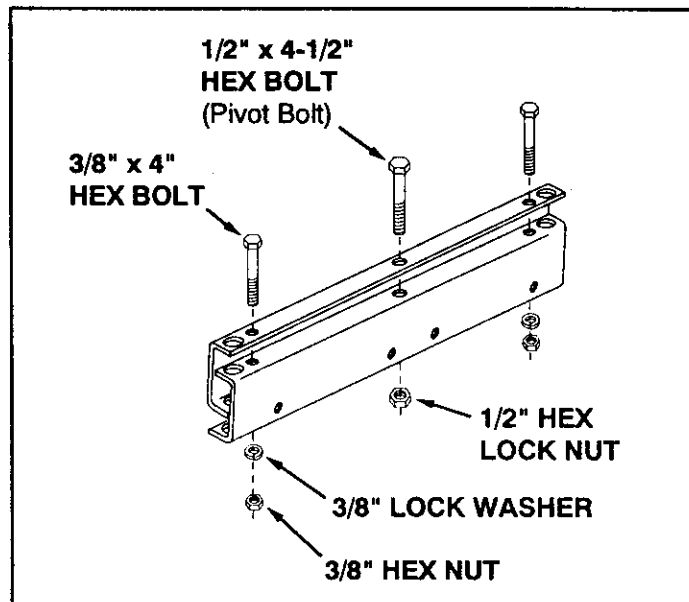

FIGURE 6

- Place the front axle channels between the front axle supports. Assemble two 5/16" x 2-1/2" hex bolts through the holes in the ends of the supports and secure with 5/16" lock washers and 5/16" hex nuts. **Do not tighten.** See figure 8.

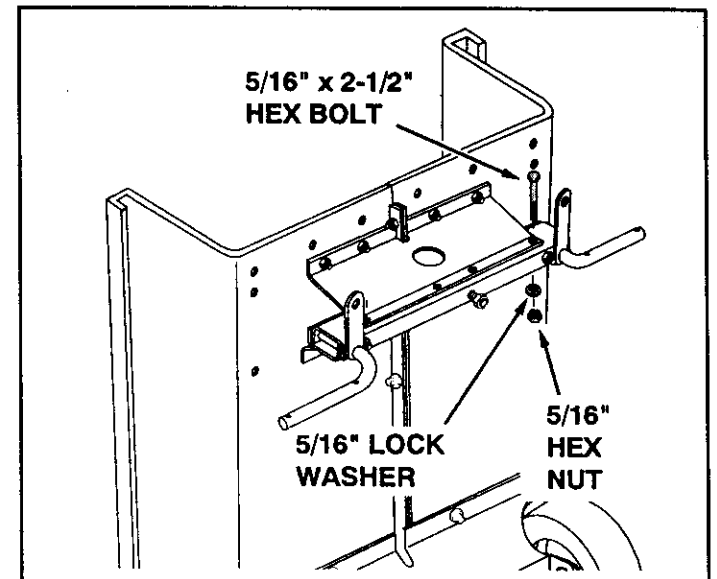

FIGURE 8

- Assemble the tongue reinforcement angle to the back side of the front axle supports as shown in figure 9. Use two 5/16" x 2-1/2" hex bolts, 5/16" lock washers and 5/16" hex nuts. **Do not tighten.**
- Make sure the center bolt (pivot bolt) is inserted as far as possible through the axle channels and then **tighten** the four bolts assembled in figures 8 and 9. Next, **tighten** the eight bolts assembled in figure 5, which fasten the front axle supports to the cart bed.

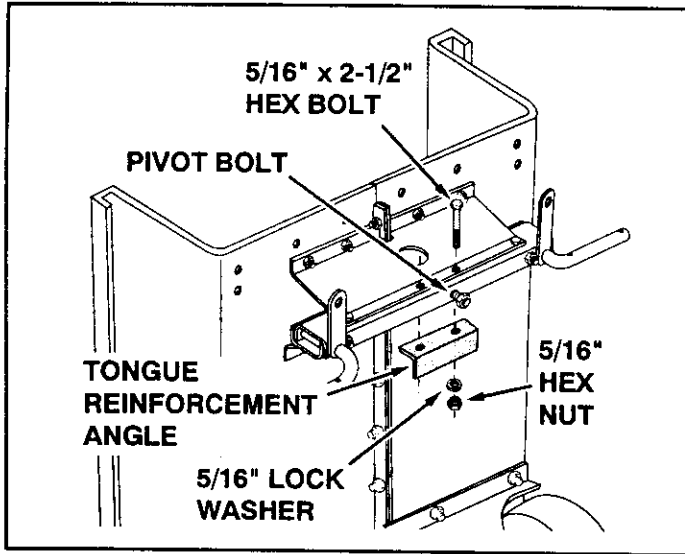

FIGURE 9

- Assemble the front panel over the end of the cart using twelve 1/4" x 1/2" hex bolts, 1/4" lock washers and 1/4" hex nuts. **Tighten** the bolts in the bottom of the panel and then **tighten** the bolts in the sides. See figure 10.
- Assemble two corner caps to the front of the cart using four 1/4" x 1/2" hex bolts, 1/4" lock washers and 1/4" hex nuts. **Tighten.** See figure 10.

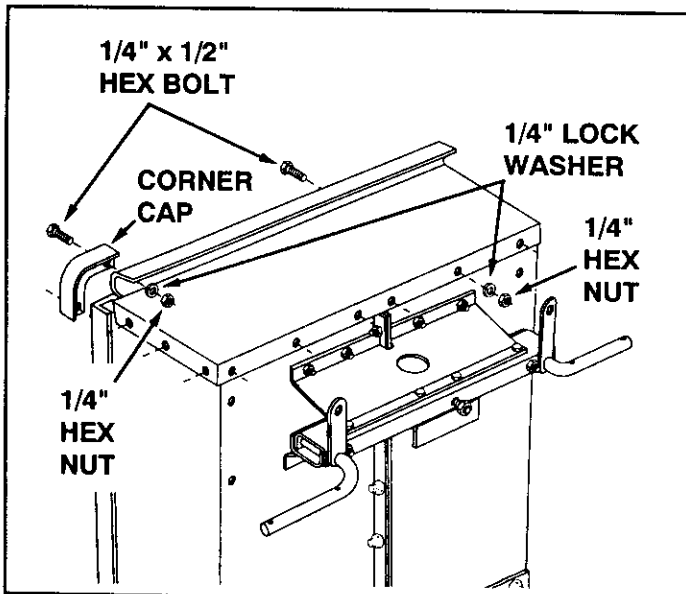

FIGURE 10

- Assemble the tie rod to both axle spindles using two 1/2" x 1-1/4" hex bolts, four small 1/2" flat washers and a two 1/2" hex lock nuts. **Tighten**, leaving loose enough that the spindles still pivot. See figure 11.

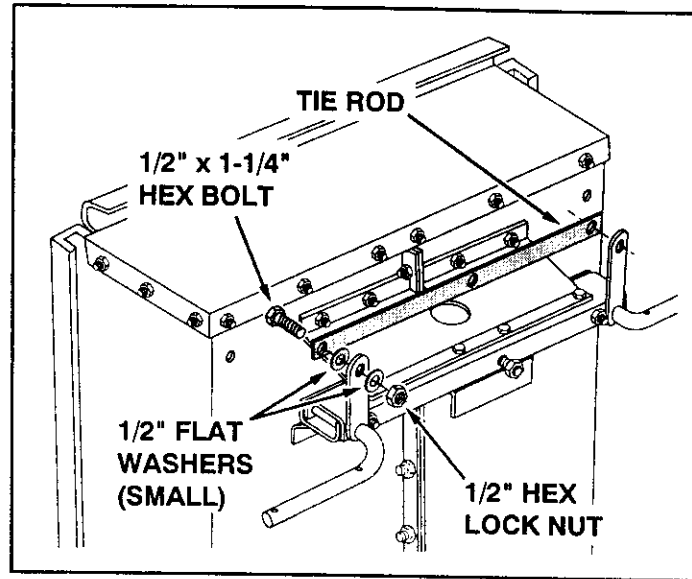

FIGURE 11

- Remove the 1/2" hex lock nut from the center pivot bolt. Assemble the rear tongue section, the pivot bushing, the large 1/2" flat washer and the 1/2" hex lock nut onto the pivot bolt as shown in figure 12. (The pivot bushing fits into the hole in the tongue.) **Tighten.**
- Fasten the tongue to the tie rod as shown in figure 12, using a 1/2" x 1-1/4" hex bolt, two small 1/2" flat washers and a 1/2" hex lock nut. **Tighten**, leaving loose enough that the tongue can pivot.

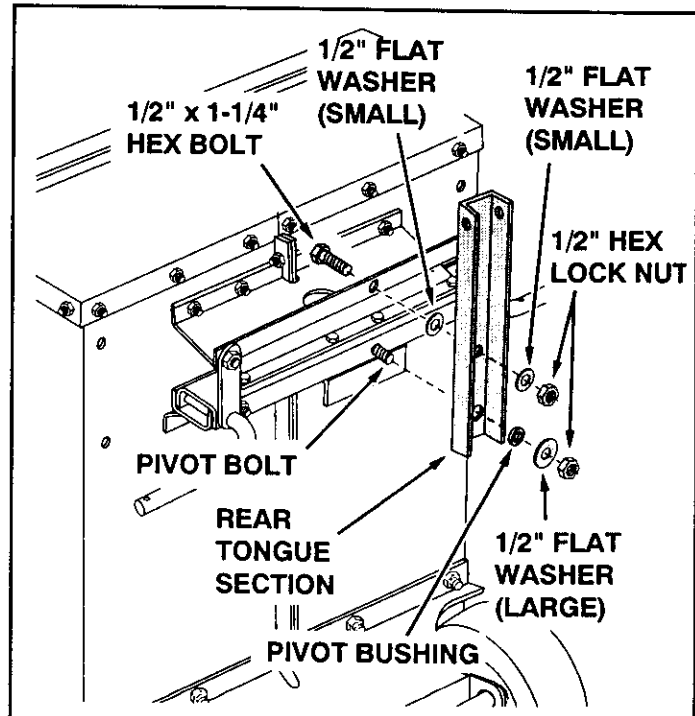

FIGURE 12

- Assemble a cotter pin to the inside hole in an axle spindle. Next place a 3/4" flat washer, a wheel (valve stem facing out) and another 3/4" flat washer onto the axle spindle. Assemble a second cotter pin to the axle. Repeat for other side. See figure 13.
Note: Keep the axle spindle from pivoting downward until the wheel is secured to it by the outer cotter pin.
- Assemble a hub cap over the 3/4" flat washer on each wheel. See figure 13.

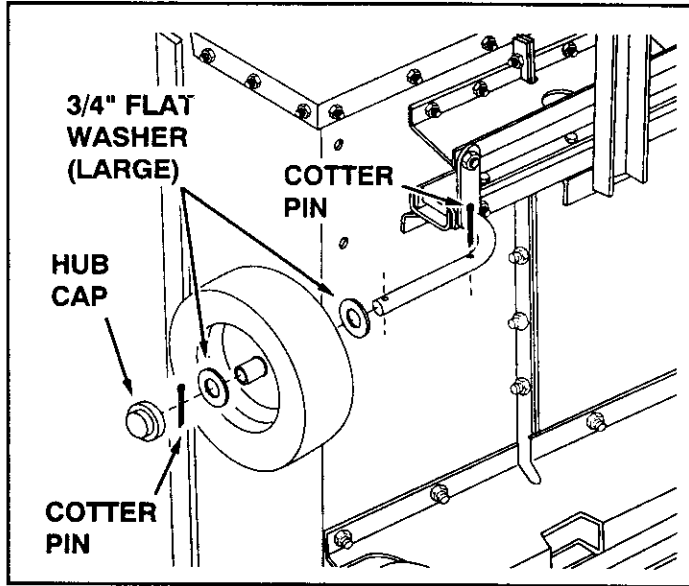

FIGURE 13

ATTENTION: Before lowering the cart, the rear wheels should be chocked as shown in figure 14. You also should get the assistance of another person to help lower the cart onto its wheels.

31. Lower the cart onto its wheels.

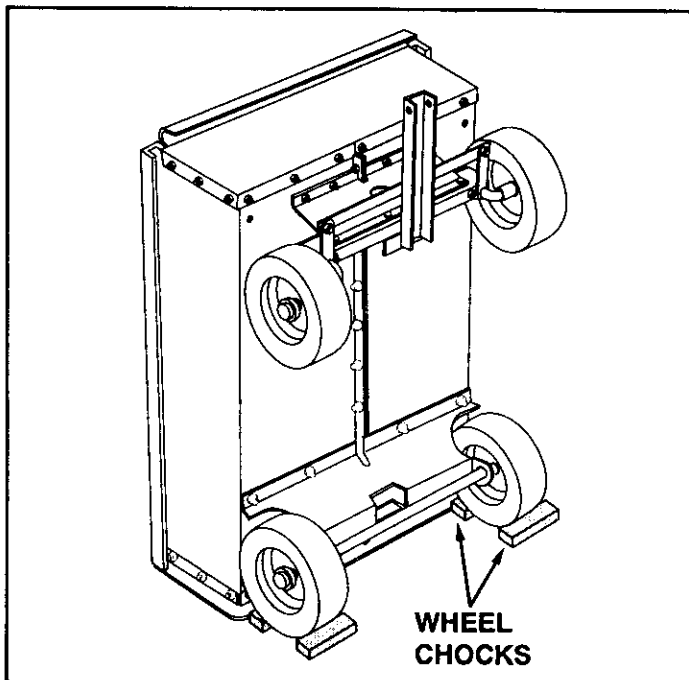

FIGURE 14

- Assemble the two pivot bars to the front tongue section using four 3/8" x 1" hex bolts, 3/8" lock washers and 3/8" hex nuts. **Tighten.** See figure 15.
- Assemble the pivot bars to the rear tongue section using one 1/2" x 4-1/2" hex bolt and one 1/2" hex lock nut. **Tighten,** leaving the nut just loose enough to allow the tongue to pivot. See figure 15.

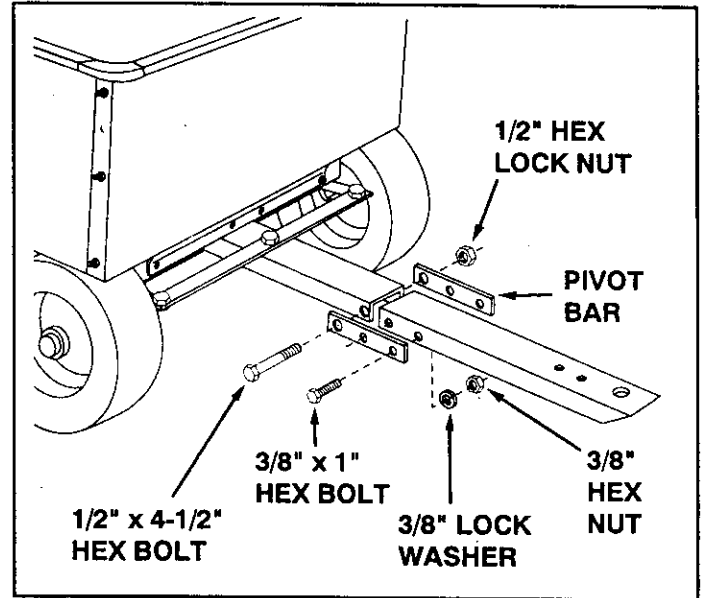

FIGURE 15

- Assemble the hitch bracket to the front tongue section using two 3/8" x 1" hex bolts, 3/8" lock washers and 3/8" hex nuts. **Tighten.** See figure 16.
- Assemble the hitch pin through the hitch bracket and the tongue and secure with the hair cotter pin as shown in figure 16.

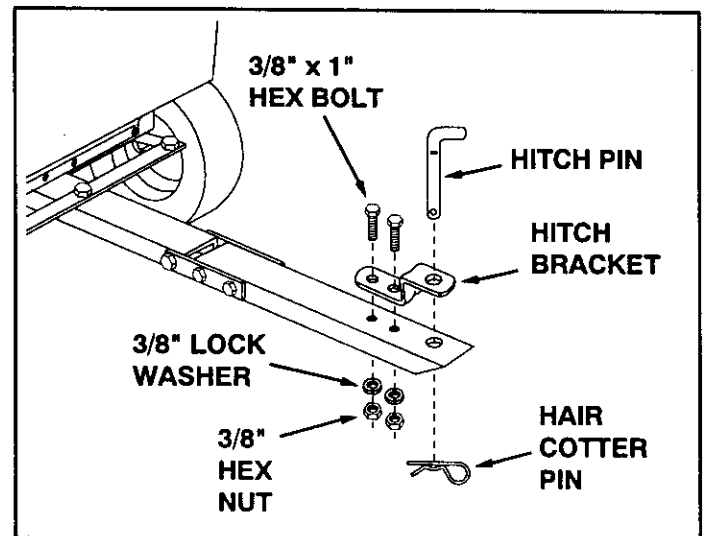

FIGURE 16

- To complete the assembly, place the tailgate down into the tailgate guides with the top and bottom lips of the tailgate facing to the rear.

OPERATION

KNOW YOUR CART

Read this owner's manual and safety rules before operating your cart.

Compare the illustration below with your cart to familiarize yourself with the various controls and their locations.

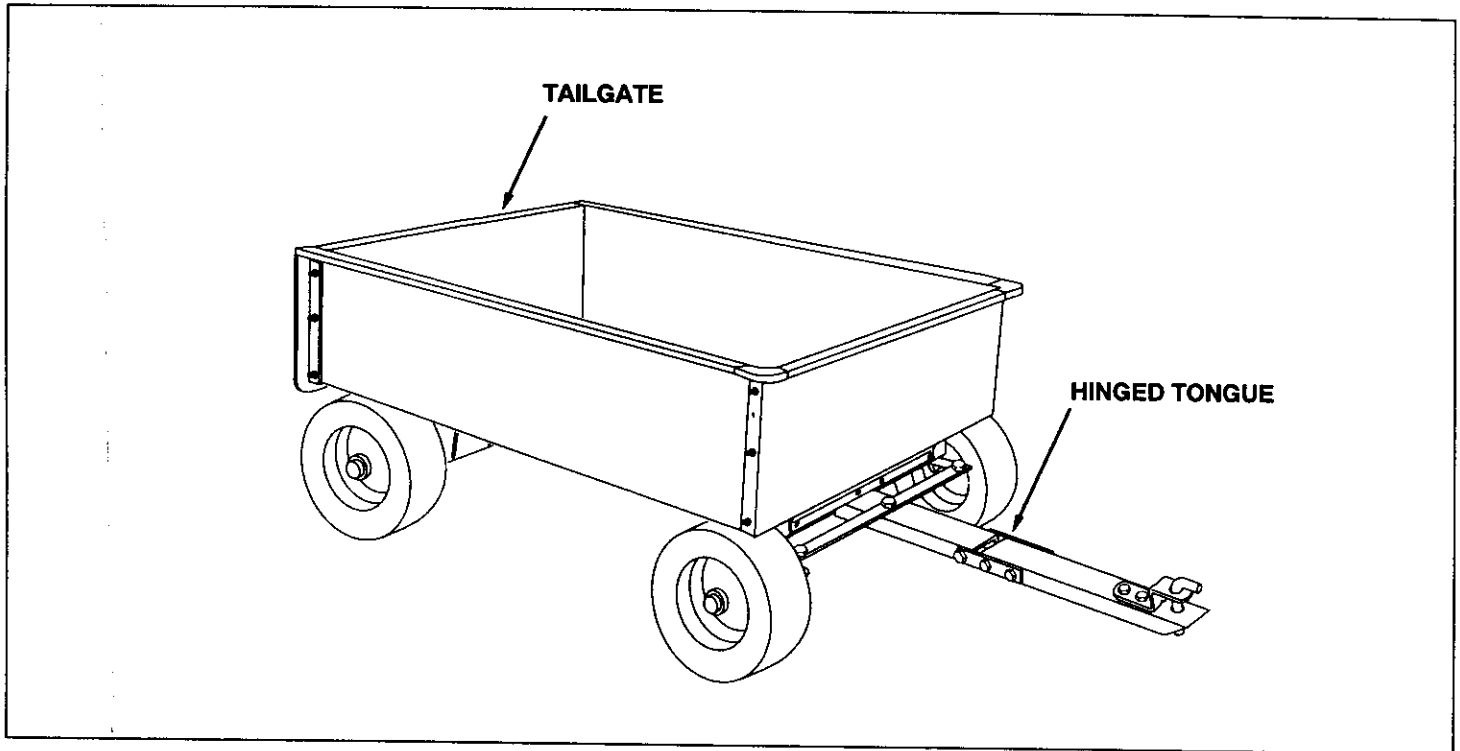

TAILGATE Lifts off the rear of the cart to allow material to be pulled from cart bed.

HINGED TONGUE Hinge allows tongue to be attached to tractor hitches of differing heights.

BEFORE STARTING

- Refer to the vehicle owners manual for instructions on safe operation on slopes.
- Use the slope guide provided on page 15 of this manual to determine if a slope angle is too steep for safe operation while towing the cart.

HOW TO USE YOUR



CAUTION: Vehicle braking and stability may be affected with the addition of an accessory or an attachment. Be aware of changing conditions on slopes.

- For best handling and traction, distribute the weight of the load evenly in the cart.
- Always test to make sure your tractor has adequate towing and braking capabilities whenever hauling a substantial amount of weight in your cart. Use extra caution when operating on slopes.

IMPORTANT: Do Not Exceed 2,000 lb. capacity of cart. One cubic foot of dirt weighs approximately 150 lbs.

- Do not unhook your cart from the tractor while on a slope. The cart could unexpectedly roll down the slope.
- To empty material from the cart, remove the tailgate by lifting it straight up and out from between the guides. Material can then be raked or pulled out from the rear of the cart.
- The maximum towing speed for this cart is 10 m.p.h.

OPERATING TIPS

- 4 wheel steerable carts are difficult to back up. Avoid driving into areas from which you would need to back the cart out.

MAINTENANCE/STORAGE

CUSTOMER RESPONSIBILITIES

- Read and follow the maintenance schedule and the maintenance procedures listed in this section.

MAINTENANCE SCHEDULE Fill in dates as you complete regular service.	Service Dates											
	Before each use	After each use	Every season	Before storage								
Check for loose fasteners	X											
Lubrication		X										
Check tire pressure	X											
Cleaning		X										

CHECK FOR LOOSE FASTENERS

- Before each use make a thorough visual check of the snow thrower for any bolts and nuts which may have loosened. Retighten any loose bolts and nuts.

CHECK TIRE PRESSURE

- Check the tire pressure before each use. The tire pressure should be from 12-14 psi.

LUBRICATION

- Oil the pivot points on the front axle and on the tongue every season. See figure 17.
- Apply grease to the wheel bearings every season. See figure 17.

CLEANING

- Empty the cart and wipe off or wash after each use.

STORAGE RECOMMENDATIONS

- Clean the cart before storing.
- Store in a clean, dry area.

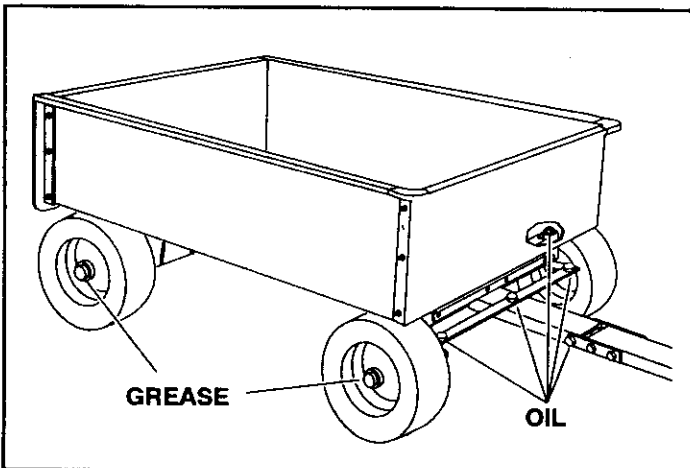
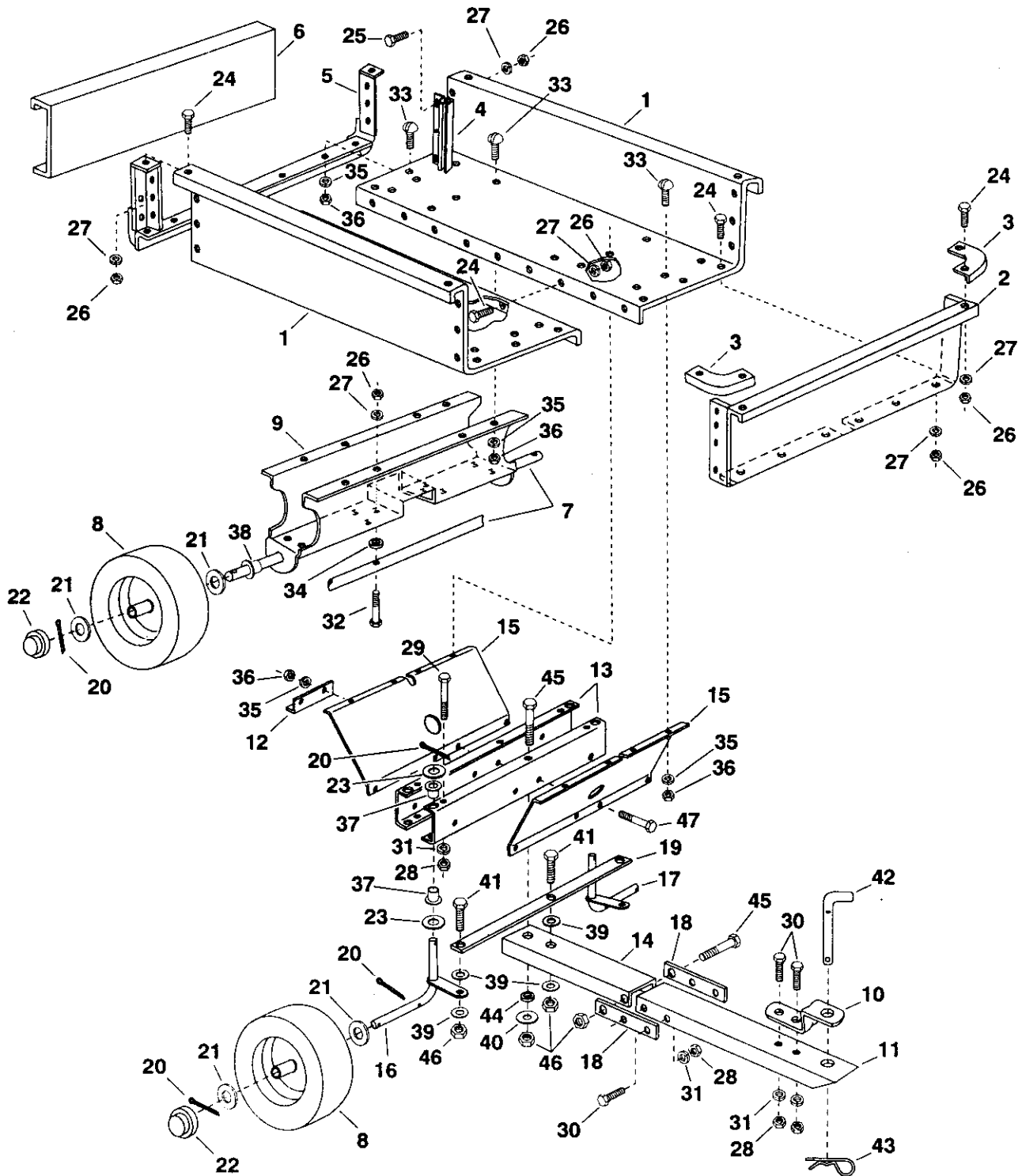

FIGURE 17

PARTS

REPAIR PARTS FOR MODEL 486.244050



REPAIR PARTS FOR MODEL 486.244050

REF. NO.	PART NO.	QTY.	DESCRIPTION
1	24356	2	Cart Bed
2	23490	1	Front Panel
3	23484	2	Cap, Front Corner
4	23548	2	Tailgate Guide
5	62457	1	Tailgate Reinforcement Bracket
6	23504	1	Tailgate
7	24357	1	Axle, Rear
8	46971	4	Wheel
9	23487	1	Wheel Support
10	23014	1	Hitch Bracket
11	24358	1	Tongue, Front Section
12	24375	1	Tongue Reinforcement Angle
13	24359	2	Front Axle Channel
14	24360	1	Tongue, Rear Section
15	24361	2	Front Axle Support
16	63588	1	Axle Spindle, R.H.
17	63587	1	Axle Spindle, L.H.
18	24364	2	Pivot Bar
19	24363	1	Tie Rod
20	43010	8	Cotter Pin, 1/8" x 1"
21	43009	8	Washer, Flat (3/4" large) 1.59" x .78" x .06"
22	43014	4	Hub Cap
23	1540-31	4	Washer, Flat (3/4" small) 1.25 x .78 x .06"
24	43175	27	Hex Bolt, 1/4-20 x 1/2" Lg.
25	43012	6	Hex Bolt, 1/4" x 3/4" Lg.
26	43178	34	Hex Nut, 1/4-20
27	43177	34	Lock Washer, 1/4"
28	43015	8	Hex Nut, 3/8-16 Thread
29	43036	2	Hex Bolt, 3/8-16 x 4" Lg.
30	43001	6	Hex Bolt, 3/8-16 x 1" Lg.
31	43003	8	Lock Washer, 3/8"
32	43648	1	Hex Bolt, 1/4-20 x 1-1/2" Lg.
33	43814	22	Slotted Truss Head Bolt, 5/16-18 x 3/4" Lg.
34	23400	1	Spacer Bushing
35	43086	26	Lock Washer, 5/16"
36	43083	26	Hex Nut, 5/16-18 Thread
37	741-0493A	4	Plastic Split Bearing
38	44798	2	Plastic Flange Bearing
39	R19171616	6	Washer, Flat (1/2" small) 1" x 17/32" x 16 Ga.
40	R19172410	1	Washer, Flat (1/2" large) 1-1/2" x 17/32" x 10 Ga.
41	43351	3	Hex Bolt, 1/2-13 x 1-1/4" Lg.
42	46065	1	Hitch Pin
43	43343	1	Pin, Haircotter 1/8"
44	24365	1	Pivot Bushing
45	47024	2	Hex Bolt, 1/2-13 x 4-1/2" Lg.
46	43262	5	Hex Lock Nut, 1/2-13" Thread
47	44292	4	Hex Bolt, 5/16-18 x 2-1/2" Lg.
	47790	1	Owner's Manual

NOTES

SLOPE GUIDE

(Keep this sheet in a safe place for future reference.)
Use this guide to determine if a slope is safe for the operation of your tractor and cart.
Refer also to the instructions in your vehicle owners manual.

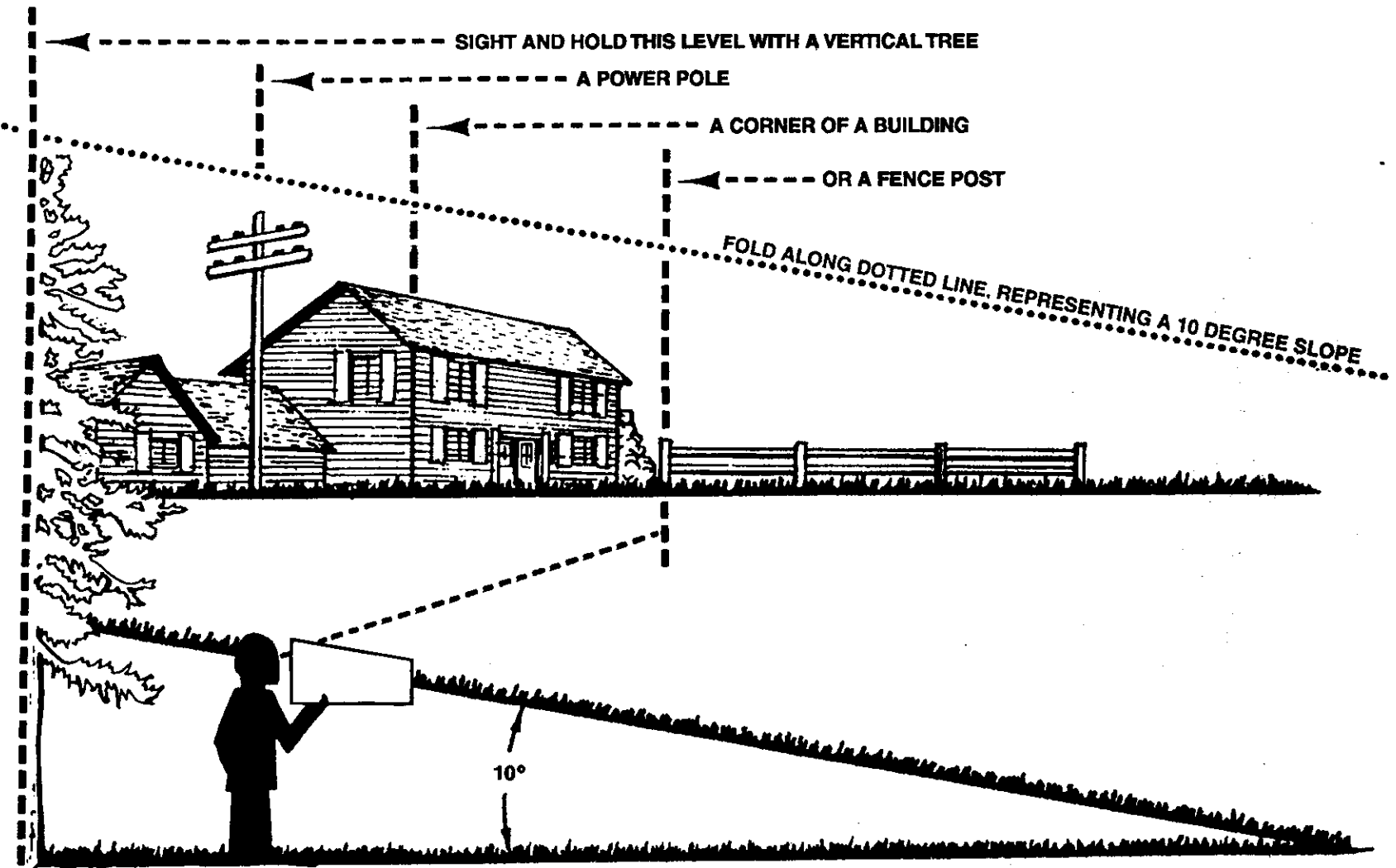

CAUTION: Do not operate your tractor and cart on a slope in excess of 10 degrees. Be sure of your tractor's towing and braking capabilities before operating on a slope. Avoid any sudden turns or maneuvers while on a slope.

For in-home major brand repair service:

Call 24 hours a day, 7 days a week

1-800-4-MY-HOMESM (1-800-469-4663)

Para pedir servicio de reparación a domicilio – 1-800-676-5811

In Canada for all your service and parts needs call – **1-800-665-4455**
Au Canada pour tout le service ou les pièces

For the repair or replacement parts you need:

Call 7 am – 7 pm, 7 days a week

1-800-366-PART (1-800-366-7278)

Para ordenar piezas con entrega a domicilio – 1-800-659-7084

For the location of a Sears Parts and Repair Center in your area:

Call 24 hours a day, 7 days a week

1-800-488-1222

**For information on purchasing a Sears Maintenance Agreement
or to inquire about an existing Agreement:**

Call 9 am – 5 pm, Monday – Saturday

1-800-827-6655



The Service Side of SearsSM