

**OWNERS MANUAL**

**CRAFTSMAN®**

**5 H.P.**

**MOW-N-VAC**

**Model No. 486.24505**

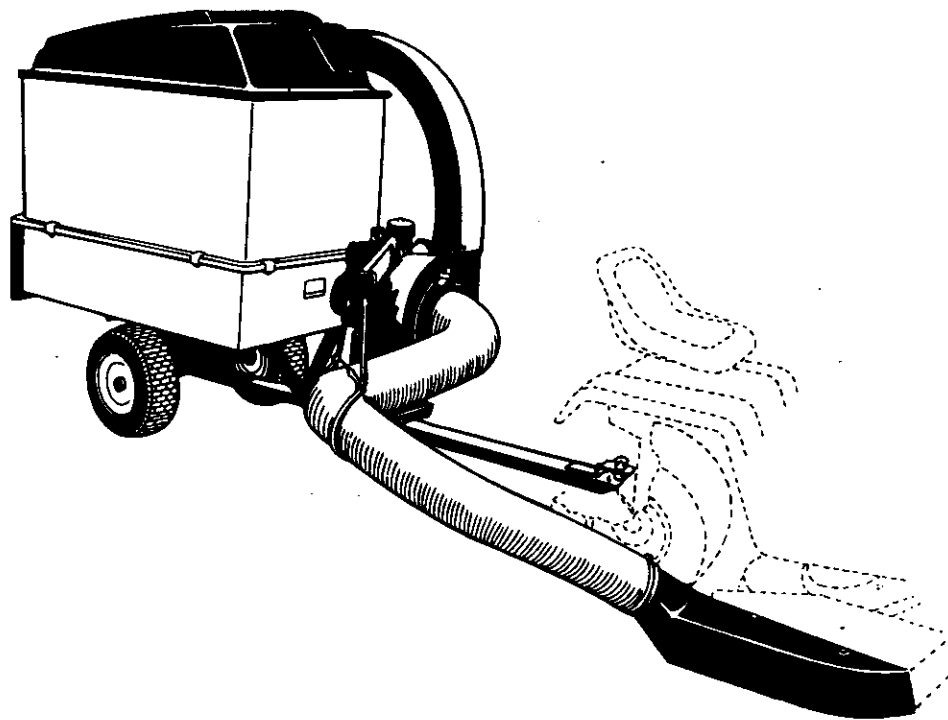

**CAUTION:**

Before using this product,  
read this manual and follow  
all Safety Rules and  
Operating Instructions.

- Safety
- Assembly
- Operation
- Maintenance
- Parts

Sears, Roebuck and Co., Hoffman Estates, IL 60179 U.S.A.

PRINTED IN U.S.A.

## TABLE OF CONTENTS

ACCESSORIES.....	2	MAINTENANCE .....	19
SAFETY RULES .....	3,4	STORAGE .....	20
FULL SIZE HARDWARE CHART .....	5,6	TROUBLESHOOTING .....	20
CARTON CONTENTS .....	6	PARTS .....	23-25
ASSEMBLY .....	7	SLOPE GUIDE .....	27
OPERATION .....	18	PARTS ORDERING/SERVICE.....	Back Page

## WARRANTY

### LIMITED ONE YEAR WARRANTY ON

For one year from the date of purchase, when this Mow-N-Vac is maintained and lubricated according to the operating and maintenance instructions in the owner's manual, Sears will repair any defect in material or workmanship free of charge. If this Mow-N-Vac is used for commercial or rental purposes, this warranty applies for only 90 days from the date of purchase.

This warranty does not cover repairs necessary because of operator negligence or abuse, including the failure to maintain the equipment according to instructions contained in the owner's manual.

WARRANTY SERVICE IS AVAILABLE BY CONTACTING THE NEAREST SEARS SERVICE CENTER/DEPARTMENT IN THE UNITED STATES.

This warranty applies only while this product is in the United States.

This warranty gives you specific legal rights, and you may also have other rights which vary from state to state. Sears, Roebuck and Co. D/817 WA. Hoffman Estates, Chicago, IL 60179

## ACCESSORIES AND ATTACHMENTS

These accessories were available when the unit was purchased. They are also available at most Sears retail outlets and service centers. Most Sears stores can order repair parts for you when you provide the model numbers of your tractor and Mow-N-Vac.

### REMOTE HOSE KIT - Model No. 486.24508

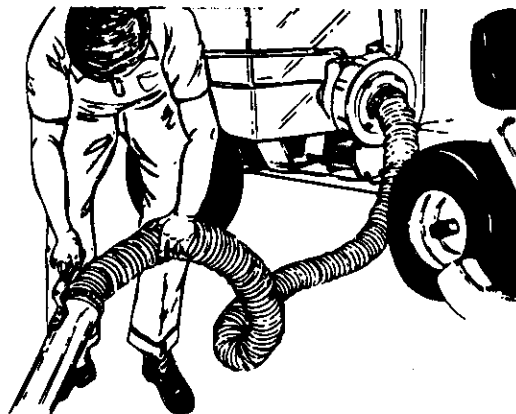

The model number and serial numbers will be found on a decal attached to the Mow-N-Vac.

You should record both the serial number and the date of purchase and keep in a safe place for future reference.

MODEL NUMBER: 486.24505

SERIAL NUMBER: \_\_\_\_\_

DATE OF PURCHASE: \_\_\_\_\_



## SAFETY



Any power equipment can cause injury if operated improperly or if the user does not understand how to operate the equipment. Exercise caution at all times, when using power equipment.

- Read and follow all instructions in this operating and service instruction manual carefully. Be thoroughly familiar with the controls and proper use of this power vacuum. Failure to comply with the instructions in this manual may result in personal injury.
- Read the vehicle owners manual and vehicle safe operation rules before using this equipment.
- Never allow children under 16 to operate this Mow-N-Vac. Children 16 years and older should only operate under close parental supervision.
- Do not allow anyone to operate this equipment without proper instructions.
- Do not allow passengers to ride on this equipment or on the towing vehicle.
- Keep the area of operation clear of all persons, particularly small children. Also keep area clear of pets.
- Check fuel before starting engine. Do not fill fuel tank indoors, or when engine is running, or while engine is hot. Wipe off any spilled fuel before starting engine.
- Engine and muffler get hot. Do not touch! To avoid fire hazard, keep clean of debris and other accumulations.
- Never store Mow-N-Vac with fuel in tank. Allow engine to cool before storing in any enclosure.
- Do not change engine governor settings.
- Do not operate engine if air cleaner or cover is removed, except for adjustment. Removal of these parts could create a fire hazard.
- Before cleaning, repairing or inspecting, make certain all moving parts come to a complete stop. Disconnect spark plug wire and keep wire away from plug to prevent accidental starting. Keep throttle control lever in stop position.
- If the Mow-N-Vac should become blocked with debris at any point, shut engine off and wait until the impeller comes to a complete stop before attempting to remove the obstruction. Disconnect spark plug wire to prevent accidental starting.
- If you strike a foreign object, or if your Mow-N-Vac should start to vibrate abnormally, stop the engine immediately, disconnect the spark plug wire and move the wire away from the spark plug. Allow the machine to stop and take the following steps.
  - a. Inspect for damage.
  - b. Repair or replace any damaged parts.
  - c. Check for loose parts and tighten to assure continued safe operation.
- Check all bolts for tightness at frequent intervals to help insure safe operation.
- Check vinyl hard top boot frequently for wear. Replace if worn or damaged.
- Never operate Mow-N-Vac unless deck adapter, hose, hose adapter (nozzle), elbow, boot and top cover are properly attached in their place.
- Do not remove top cover or attempt to empty contents of cart while engine is running.
- Keep hands, feet, face, long hair and clothing out of Mow-N-Vac inlet and discharge areas. There are **ROTATING BLADES** inside these openings.
- Never attempt to change hose adapter (nozzle) or to install remote hose attachment when engine is running.
- Keep shields and guards (e.g. hose adapter [nozzle] and elbow) in place and securely attached.
- Always wear safety glasses or other suitable eye protection when operating or maintaining this equipment.
- Do not stand behind cart in exhaust discharge area while engine is running.
- Do not operate this equipment while intoxicated or while taking drugs or medication that impairs the senses and reactions.
- When using this equipment, start with the vehicle transmission in first (low) gear and then gradually increase speed only as conditions permit.
- Operate this equipment at reduced speed on rough terrain, along creeks and ditches and on slopes to prevent tipping or loss of control. Do not drive too close to a creek or ditch.
- Vehicle braking and stability are affected by the addition of this equipment. Do not fill the Mow-N-Vac to its full capacity without checking the capability of the towing vehicle to safely pull and stop with the Mow-N-Vac attached.
- Before operating on any grade (hill) refer to the safety rules in the vehicle owner's manual concerning safe operation on slopes. Also refer to the **SLOPE GUIDE** on page 27 of this owner's manual. Do not operate on slopes in excess of 10 degrees. **STAY OFF STEEP SLOPES.**
- Follow the maintenance instructions as outlined in this manual.



Look for this symbol to point out important safety precautions. It mean--**Attention!! Become alert!! Your safety is involved.**



### **DANGER:**

This Mow-N-Vac was built to be operated according to the rules for safe operation in this manual. As with any type of power equipment, carelessness or error on the part of the operator can result in serious injury. This unit is capable of amputating fingers and hands and throwing objects. Failure to observe the following safety instructions could result in serious injury or death.



## CAUTION

**DO NOT REMOVE TOP COVER OR ATTEMPT TO EMPTY CONTENTS OF CART WHILE ENGINE IS RUNNING.**

**DO NOT STAND IN FRONT OF EXHAUST DISCHARGE AREA WHILE ENGINE IS RUNNING.**

**EYE PROTECTION SHOULD BE WORN WHEN OPERATING VACUUM.**



## DANGER

**DO NOT REMOVE NOZZLE OR HOSE WHILE ENGINE IS RUNNING**



## WARNING

**MUFFLER & ADJACENT AREAS MAY EXCEED 150° F**



## WARNING

This unit is equipped with an internal combustion engine and should not be used on or near unimproved forest-covered, or grass-covered land unless the engine's exhaust system is equipped with a spark arrester meeting applicable local or state laws (if any). If a spark arrester is used, it should be maintained in effective working order by the operator.

In the State of California the above is required by law (Section 4442 of the California Public Resources Code). Other states may have similar laws. Federal laws apply on federal lands. A spark arrester muffler is available at you nearest engine authorized service center.

This unit is shipped WITHOUT GASOLINE or OIL. After assembly, see separate engine manual for proper fuel and engine oil recommendations.

# HARDWARE PACKAGE CONTENTS

SHOWN FULL SIZE

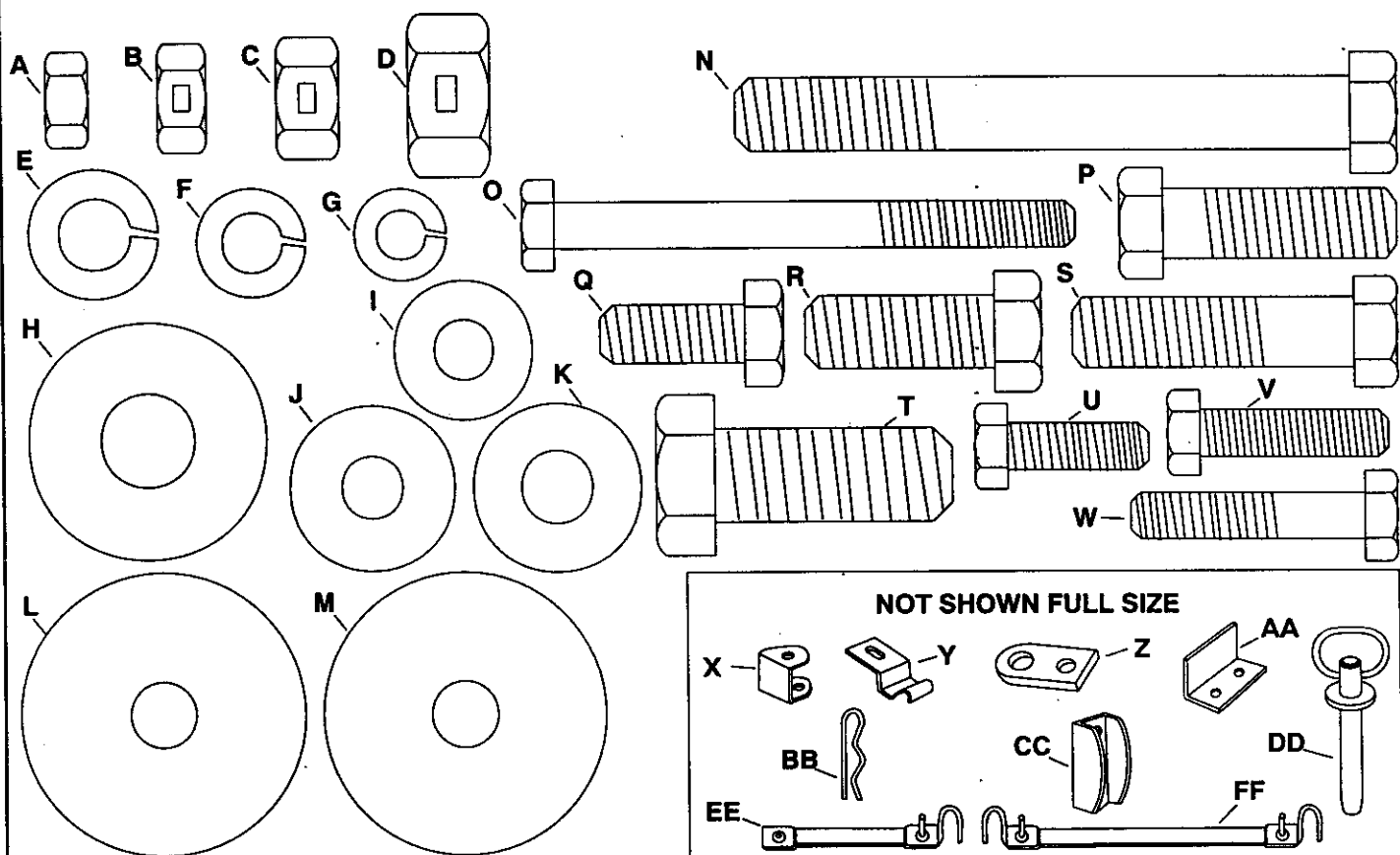

**HARDWARE PACKAGE (Mow-N-Vac Carton)** Additional hardware packages shown on pages 6 and 14.

Ref.	Qty.	Description	Ref.	Qty.	Description
A	38	Hex Nuts, 1/4-20 Thread	Q	5	Hex Bolts, 5/16-18 x 3/4"
B	2	Hex Lock Nuts, 5/16-18 Thread	R	4	Hex Bolt, 3/8-16 x 1.0"
C	9	Hex Lock Nuts, 3/8-16 Thread	S	5	Hex Bolts, 3/8-16 x 1-1/2"
D	1	Hex Lock Nut, 1/2-13 Thread	T	1	Hex Bolt, 1/2-13 x 1-1/4"
E	9	Lock Washers 3/8" I.D.	U	28	Hex Bolts, 1/4-20 x 3/4"
F	1	Lock Washer, 5/16" I.D.	V	2	Hex Bolt, 1/4-20 x 1"
G	36	Lock Washers, 1/4" I.D.	W	2	Hex Bolt, 1/4-20 x 1-1/4"
H	1	Washer, 7/16" Std.	X	5	Clamps, for Cart Panels
I	28	Flat Washers 1/4" I.D.	Y	2	Door Supports
J	1	Flat Washer, 5/16" Std.	Z	1	Hitch Plate
K	2	Nylon Washers, 21/64" (Small)	AA	1	Stop Angle
L	3	Steel Flat Washers 1-1/2" O.D.	BB	1	Hairpin Cotter
M	2	Nylon Washers, 1-1/2" O.D. (Large)	CC	2	Door Latch
N	3	Hex Bolts, 3/8" x 3-1/4"	DD	1	Hitch Pin
O	4	Hex Bolts, 1/4-20 x 2-3/4"	EE	2	Tie Straps (Short)
P	2	Hex Bolts, 3/8-16 x 1-1/4"	FF	1	Tie Strap

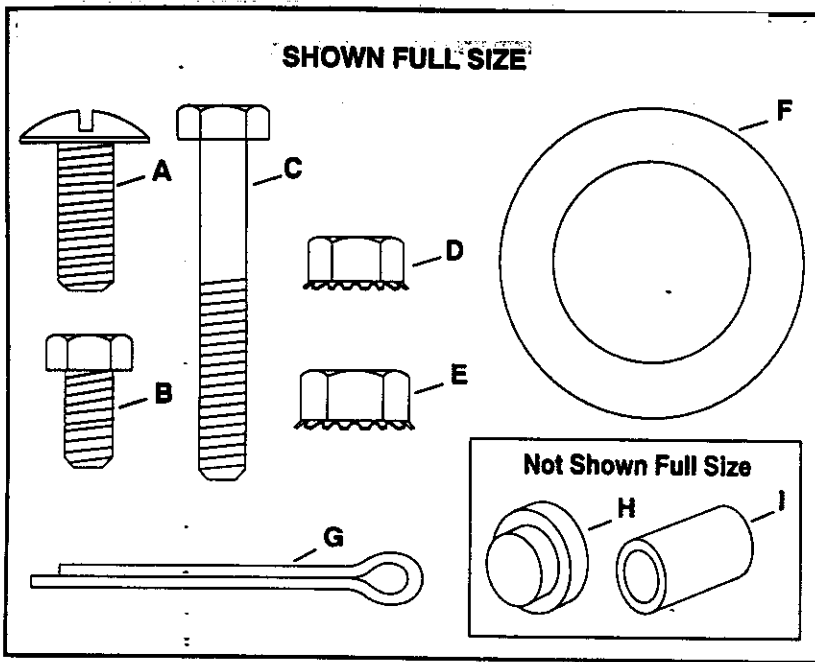

Ref.	Qty.	Description
A	14	Slit Truss Hd. Bolt, 5/16" x 3/4" Lg.
B	25	Hex Bolt, 1/4" x 1/2"
C	2	Hex Bolt, 1/4" x 1-3/4"
D	27	Hex Nut, 1/4-20 Thread (SEMS)
E	14	Hex Nut, 5/16-18 Thread (SEMS)
F	4	Flat Washer, 1"
G	2	Cotter Pin, 1/8" x 1-1/2" Lg.
H	2	Hub Cap
I	2	Spacer Tube, 2" Lg.

**Bag contains extra 1/4" x 1/2" bolts and 1/4" nuts**

**HARDWARE PACKAGE** (Cart Body Carton)

**CARTON CONTENTS**

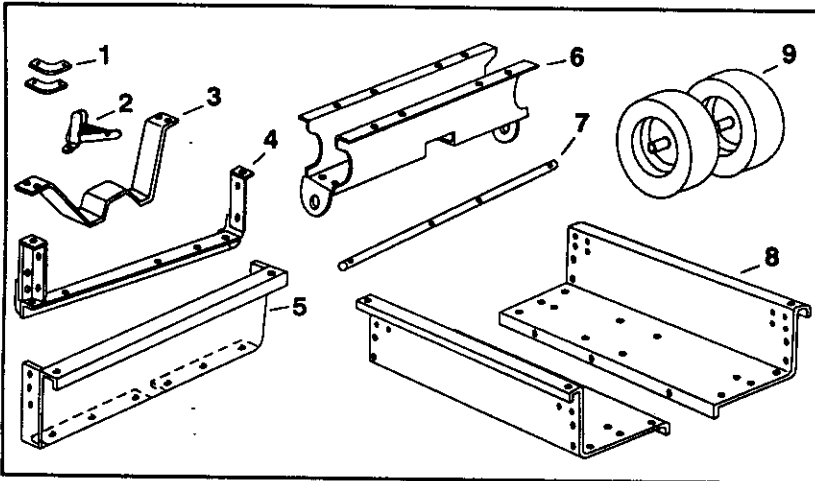

Ref.	Qty.	Description
1	2	Corner Cap
2	1	Latch Lock Assembly
3	1	Latch Stand Bracket
4	1	Tailgate Reinforcement Bracket
5	1	Front Panel
6	1	Wheel Support
7	1	Axle
8	2	Cart Body
9	2	Wheel

**CARTON CONTENTS** (Cart Body Carton)

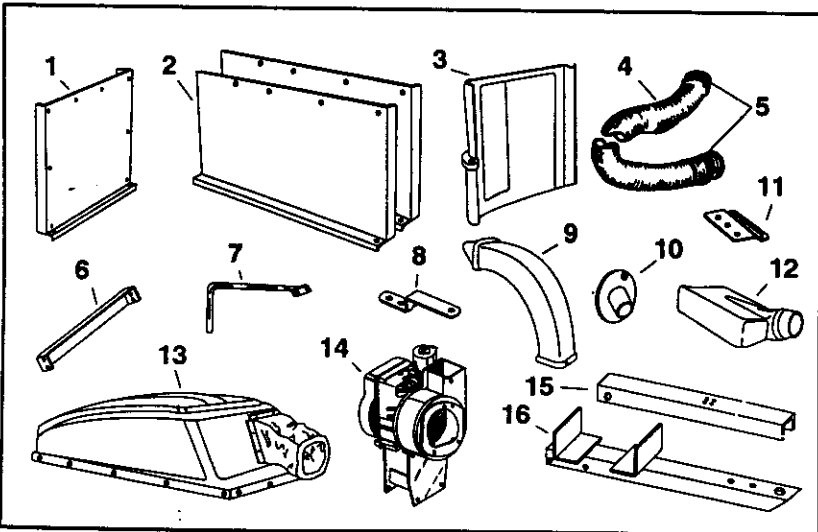

Ref.	Qty.	Description
1	1	Front Panel
2	2	Side Panels (Left & Right)
3	1	Rear Door
4	1	Hose
5	2	Hose Clamps
6	1	Cross Brace
7	1	Hose Hanger Assembly
8	1	Hitch Bracket
9	1	Elbow
10	1	Hose Adapter (Nozzle)
11	1	Adapter Bracket
12	1	Deck Adapter
13	1	Poly Hard Top
14	1	Engine Base Assembly
15	1	Tongue, Rear Section
16	1	Tongue, Front Section

**CARTON CONTENTS** (Mow-N-Vac Carton)

# ASSEMBLY

This unit is shipped WITHOUT GASOLINE or OIL. After assembly, see separate engine manual for proper fuel and engine oil recommendations.

## TOOLS REQUIRED FOR ASSEMBLY

- (1) Screwdriver
- (1) Pliers
- (2) 7/16" Wrenches
- (2) 1/2" Wrench
- (2) 9/16" Wrenches
- (2) 3/4" Wrenches (only if figure 24 on page 14 is used)

## REMOVAL OF PARTS FROM CARTON

- Remove the hardware pack and all loose parts from the carton. Be sure the carton is empty before discarding.
- Lay out all the parts as shown in the carton contents. Keep contents of hardware packages separated.

## ASSEMBLY OF PARTS IN CART BODY CARTON

- Position cart body halves upright on a smooth level surface such as a garage floor or a paved driveway. See figure 1.

**CAUTION:** Do not leave the cart unattended in upright position during assembly. A falling cart can cause personal injury! Pay close attention to the stability of the cart while it remains in an upright position. For best stability, assemble on a smooth level surface.



- Assemble halves together using three 1/4" x 1/2" hex bolts and 1/4" hex nuts (SEMS) as shown in figure 1. Do not tighten.

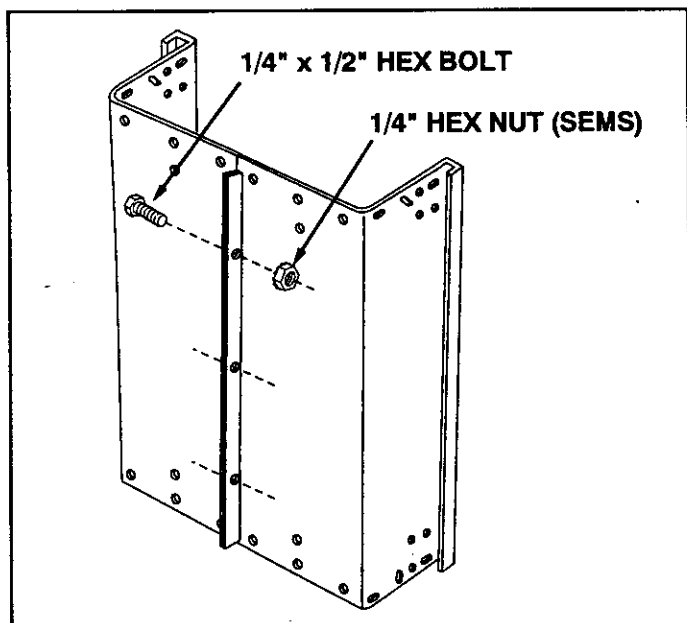

FIGURE 1

- Position the tailgate reinforcement bracket on outside of cart as shown in figure 2. Fasten to the bottom of the cart body using six 5/16" x 3/4" slotted head screws and 5/16" hex nuts (SEMS). Do not tighten. See figure 2.
- Fasten the tailgate reinforcement bracket to the sides of the cart body using four 1/4" x 1/2" hex bolts and 1/4" hex nuts (SEMS) as shown in figure 2. Do not tighten.

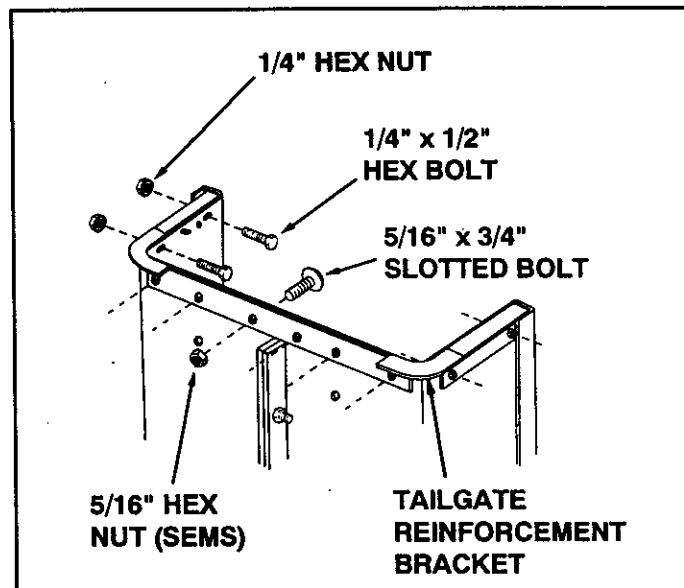

FIGURE 2

- At this time, with the cart body halves pulled together, tighten the six slotted head screws assembled in figure 2 and then tighten the four hex bolts assembled in figure 2. Do not tighten the three hex bolts that were assembled in figure 1.
- Carefully reverse the position of the cart so that it rests on the tailgate reinforcement bracket, as shown in figure 3.

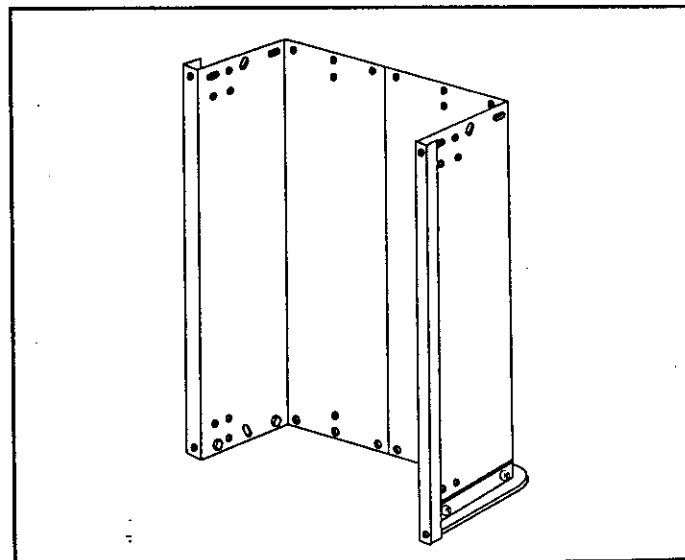

FIGURE 3

- Assemble the front panel over the end of the cart using six 1/4" x 1/2" hex bolts and 1/4" hex nuts (SEMS) as shown in figure 4. Leave two holes open in the bottom of the panel as shown in figure 4. With the cart body halves pulled together, **tighten** the four bolts in the bottom of the front panel, then **tighten** the bolt in each side.

At this time **tighten** the three bolts on the bottom of the cart which were assembled in figure 1.

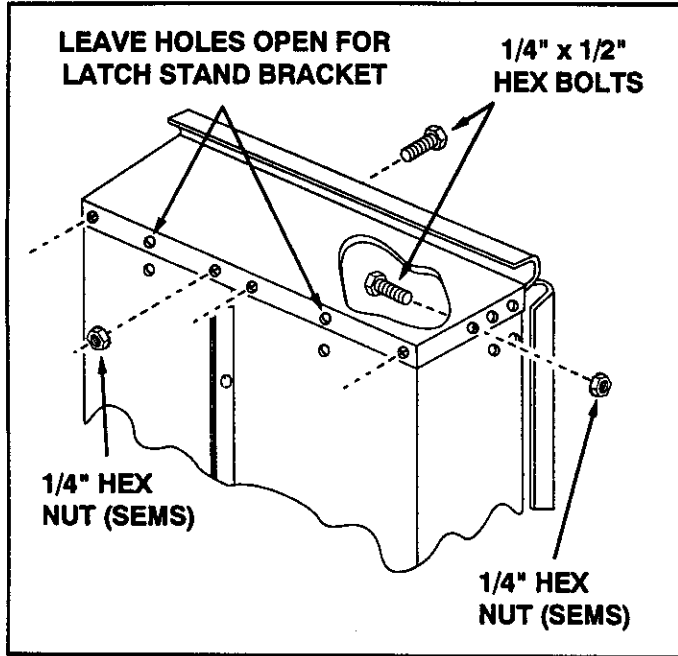

FIGURE 4

- Assemble the wheel support to the bottom of the cart using eight 5/16" x 3/4" slotted head screws and 5/16" hex nuts (SEMS) as shown in figure 5. Heads of screws go to the inside of cart. **Tighten**.

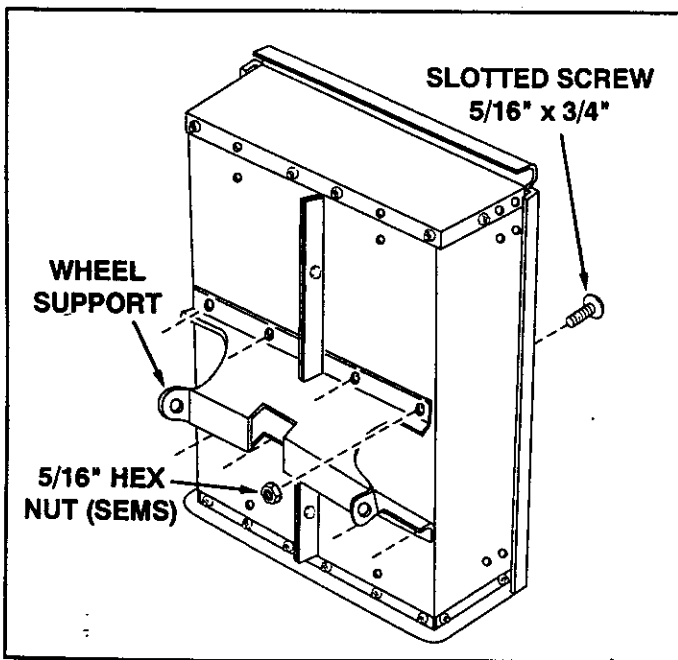

FIGURE 5

- Assemble the latch stand bracket to the cart using four 1/4" x 1/2" hex bolts and 1/4" hex nuts (SEMS). **TIGHTEN**. See figure 6.

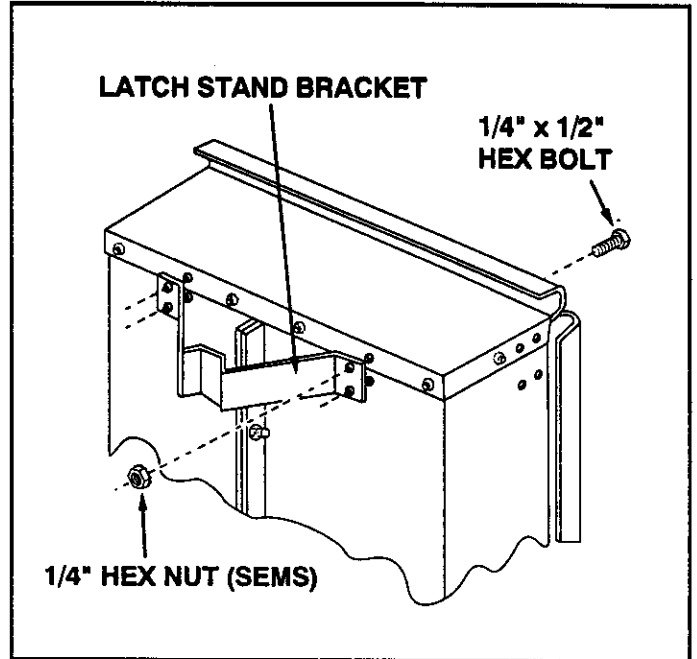

FIGURE 6

- To prevent accidental tipping during the following assembly procedures, lower the cart to rest upside down on the top flanges, so that the wheel support is facing up. Refer to figure 10 on page 9.

### ASSEMBLY OF PARTS IN MOW-N-VAC CARTON

- Assemble the front tongue over the top of the rear tongue using three 3/8" x 3-1/4" hex bolts, 3/8" lock washers and 3/8" hex lock nuts. See figure 7.

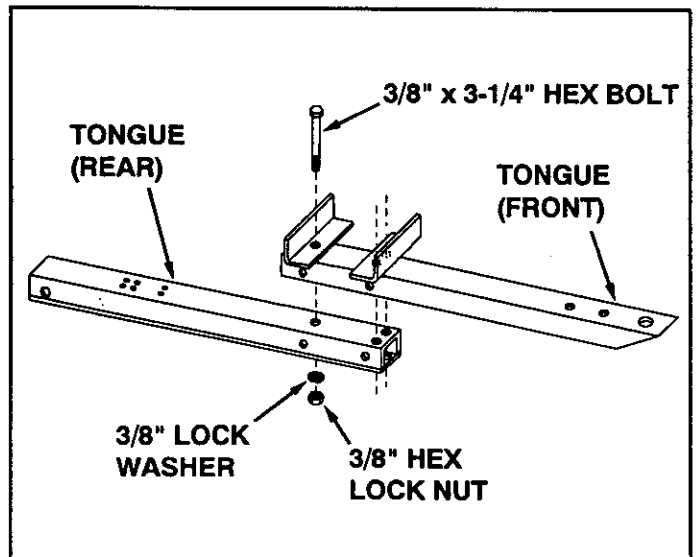

FIGURE 7



- Assemble the hitch bracket to the drawbar tongue, using two 3/8" x 1-1/4" hex bolts, 3/8" lock washers and 3/8" hex nuts. **Tighten.** See figure 8.

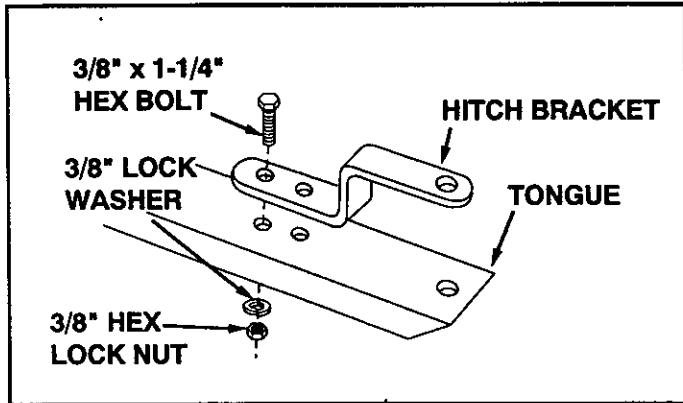

FIGURE 8

- Assemble the latch lock assembly to the tongue using two 1/4" x 2-3/4" hex bolts, two 1/4" lock washers and two 1/4" hex nuts. Fasten to the two front holes in the forward grouping of four holes as shown in figure 9.
- Assemble the angle stop to the tongue using two 1/4" x 2-3/4" hex bolts, two 1/4" lock washers and two 1/4" hex nuts. Fasten to the two front holes in the rear grouping of four holes as shown in figure 9.

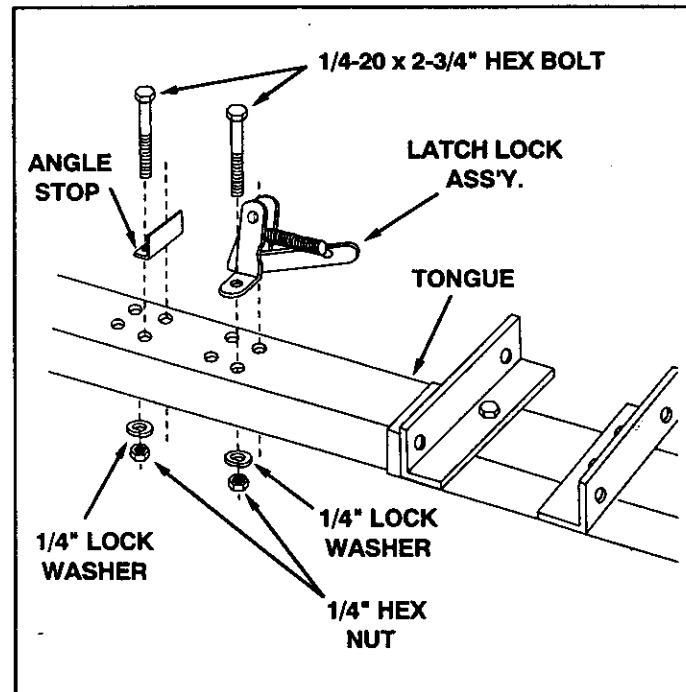

FIGURE 9

- Position the tongue on the bottom of the cart as shown in figure 10. Assemble the axle through the wheel support and the tongue. Fasten the axle to the wheel support using two 1/4" x 1-3/4" hex bolts and 1/4" hex nuts (SEMS). **Tighten.**

**IMPORTANT:** Make sure the tongue is securely locked to the latch stand bracket by the latch lock assembly.

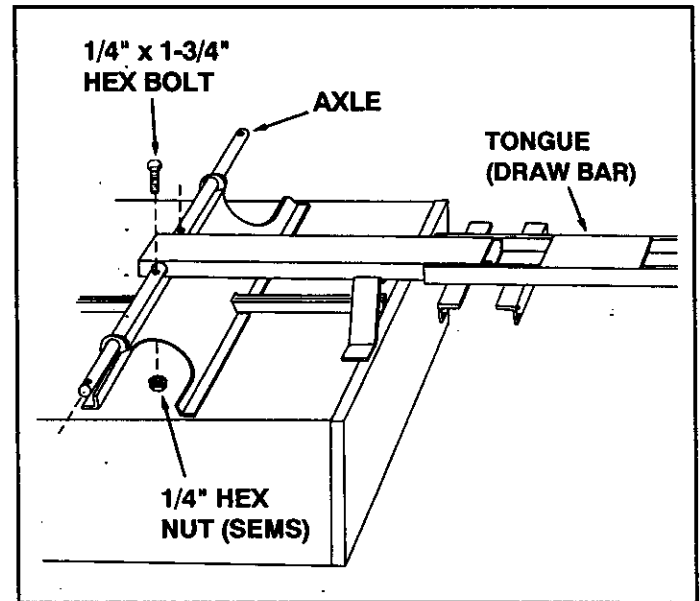

FIGURE 10

- Assemble a spacer tube onto each end of the axle as shown in figure 11.
- Assemble a flat washer, a wheel (valve stem facing out), and another flat washer onto the axle as shown in figure 11. Secure the wheel with a cotter pin, spreading the ends so that a hub cap can fit over the pin. Assemble the hub cap by pressing it onto the flat washer. Repeat on other end of axle.

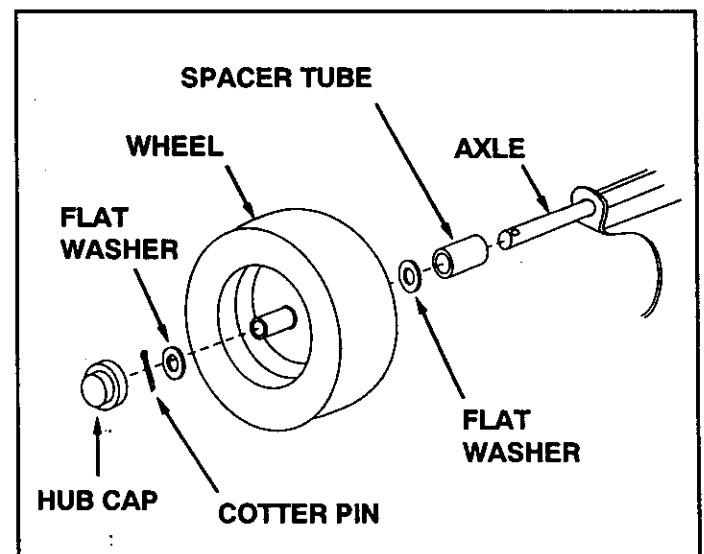

FIGURE 11

- Turn the cart right side up to rests on its wheels.
- Place the engine assembly (blower housing to the front) onto the welded angles of the tongue, aligning the holes in the engine base with the holes in the welded angles. See figure 12.
- Secure the engine base assembly to the welded angles using four 3/8" x 1" hex bolts, 3/8" lock washers and 3/8" hex lock nuts. See figure 12. Tighten all nuts and bolts securely.

**NOTE:** Make sure engine is positioned with blower housing to the front.

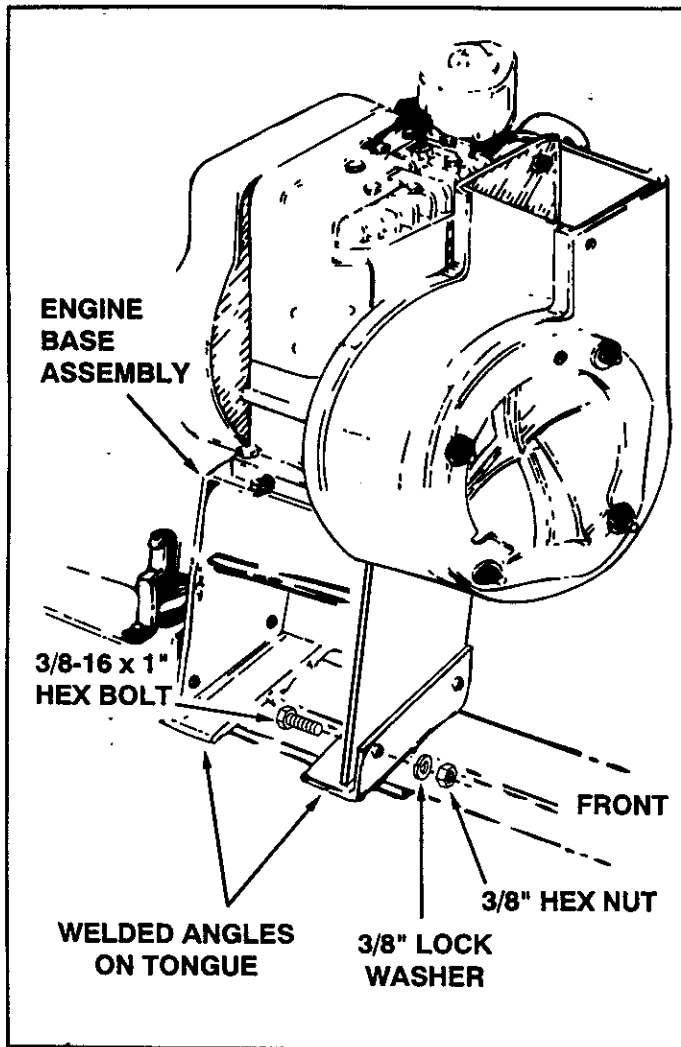

FIGURE 12

- Place a corner cap over each front corner of the cart as shown in figure 13.

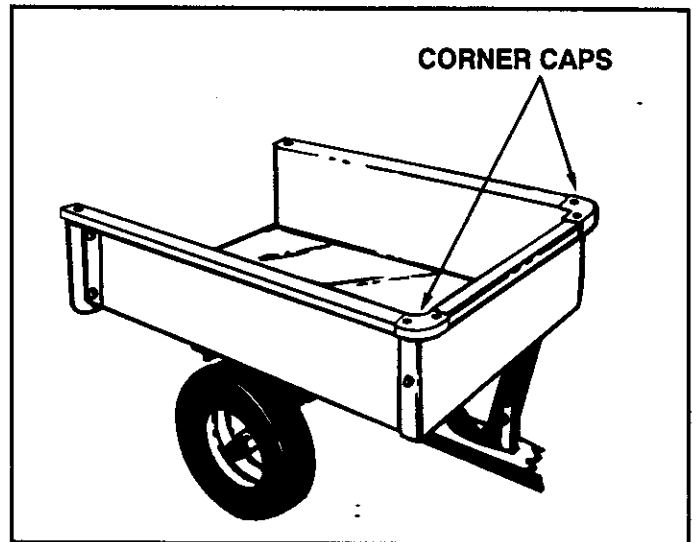

FIGURE 13

- Position a side panel on top of the cart bed flange and front corner cap. Align holes in side panel with holes in corner cap and holes in top of cart bed flange. Fasten together using two 1/4" x 3/4" hex bolts, two 1/4" flat washers, two 1/4" lock washers and two 1/4" hex nuts. Repeat for other side. See figure 14.

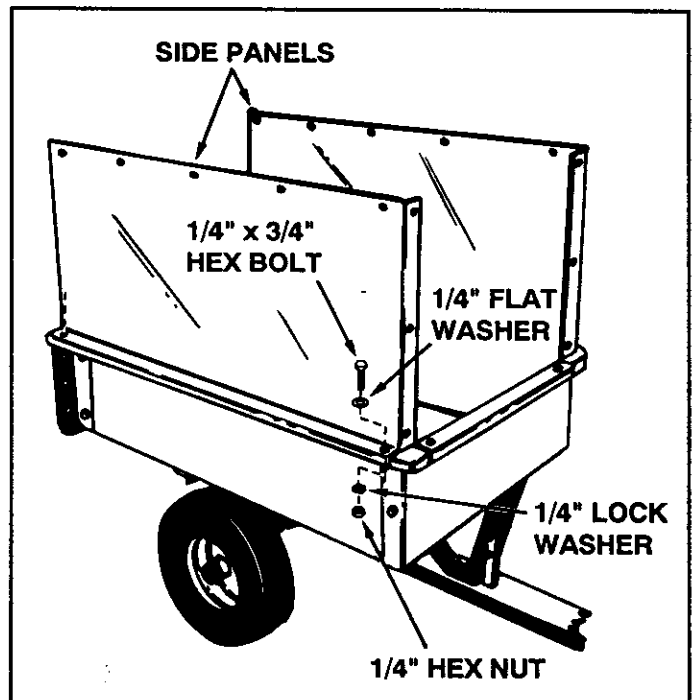

FIGURE 14

- Assemble front panel over the ends of the side panels and on top of the cart bed flange and the corner caps. Leaving the top holes in the front panel empty, fasten it to the cart body and the side panels using six 1/4" x 3/4" hex bolts, six 1/4" flat washers, six 1/4" lock washers and six 1/4" hex nuts. See figure 15.

- Install the poly hard top over the front and side panels. Fasten it to the panels using fourteen 1/4" x 3/4" hex bolts, 1/4" flat washers, 1/4" lock washers and 1/4" hex nuts. See figure 17.
- Assemble four clamps onto the cart flanges, two on each side of the cart, positioned approximately 12" from each end. Fasten each clamp from the bottom with a 3/8" x 1-1/2" hex bolt. See figure 17.
- Assemble a clamp at center of front panel and cart flange using a 3/8" x 1-1/2" hex bolt. See figure 17.

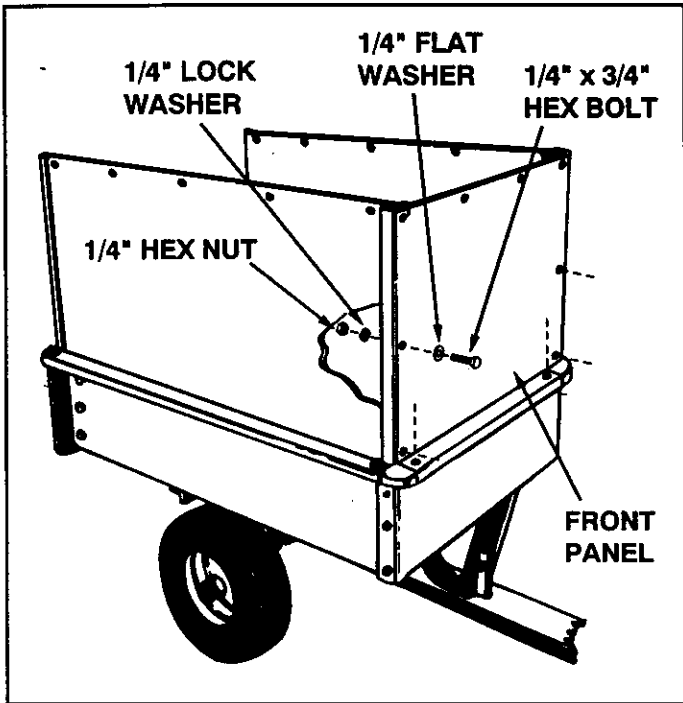

FIGURE 15

- Assemble the cross brace to the two top holes at the rear of each side panel using four 1/4" x 3/4" hex bolts, four 1/4" lock washers and four 1/4" hex nuts. See figure 16.

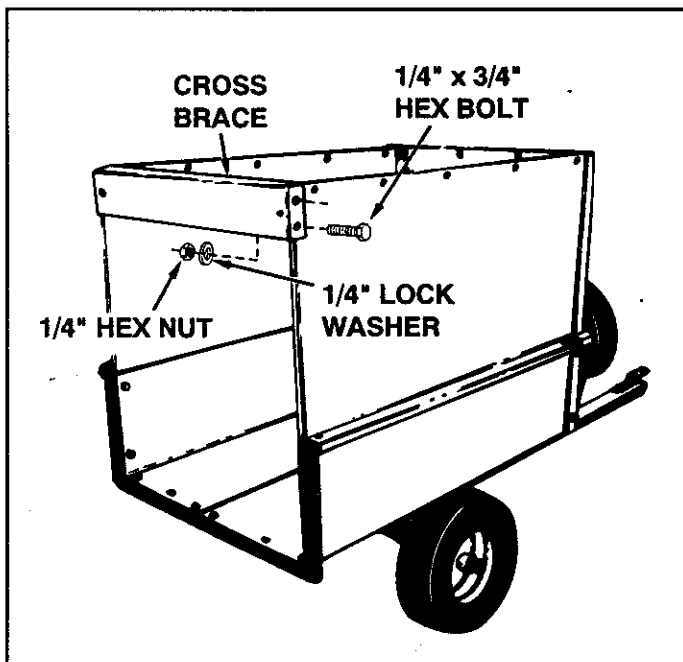

FIGURE 16

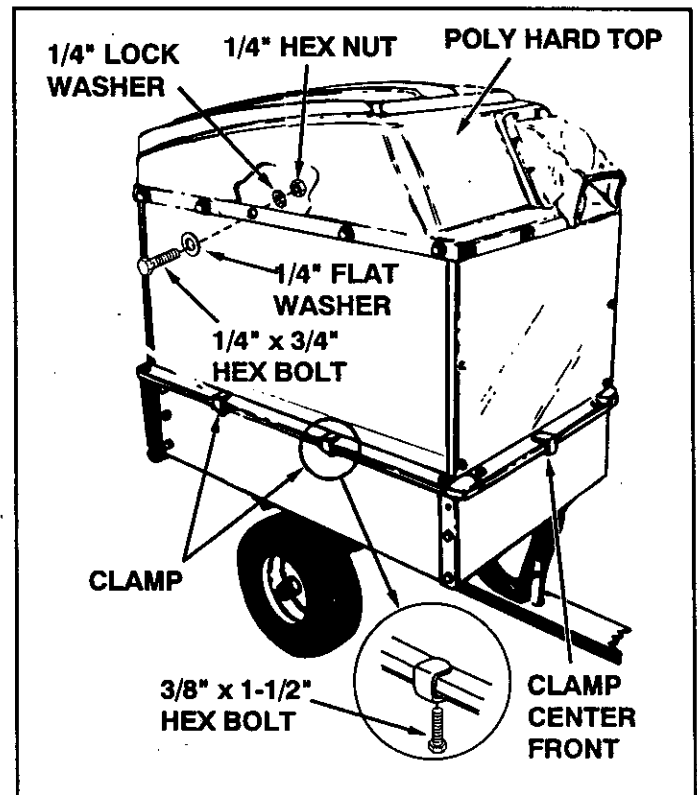

FIGURE 17

- Assemble a door latch at each end of cross brace using a 5/16" x 3/4" hex bolt, a nylon washer and a 5/16" hex lock nut. Place nylon washer between door latch and cross brace. Tighten so that latch is snug but will still rotate. See figure 18.
- Assemble door support brackets underneath the rear of the cart bed by removing the hex nuts from the bolts shown in figure 18. Fasten the brackets to the cart using the same hex nuts which were removed.

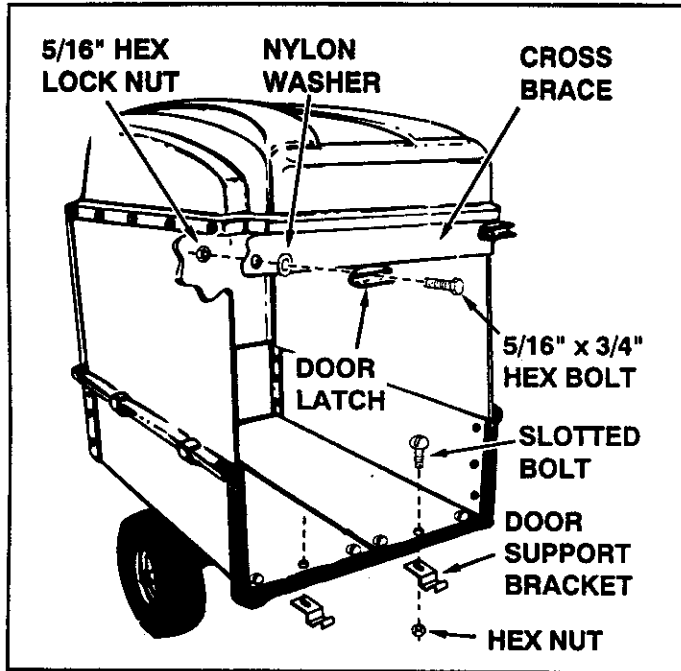

FIGURE 18

- Assemble one short tie strap to each side of rear door using one 1/4" x 1-1/4" hex bolt, two 1/4" flat washers, one 1/4" lock washer and one 1/4" hex nut. Assemble an "S" hook through the loose end of each strap. See figure 19.
- Assemble a 1/4" x 1" hex bolt with a 1/4" hex nut to outside of hole on each side of cart bed and secure from inside with a 1/4" lock washer and a 1/4" hex nut. See inset in figure 19.
- Assemble door to rear of cart by resting bottom of door on door support brackets and rotating top of door forward to meet cross brace. Latch top of door on each side. See figure 19.
- Hook both the tie straps onto the 1/4" x 1" hex bolts which were just assembled. See figure 19.

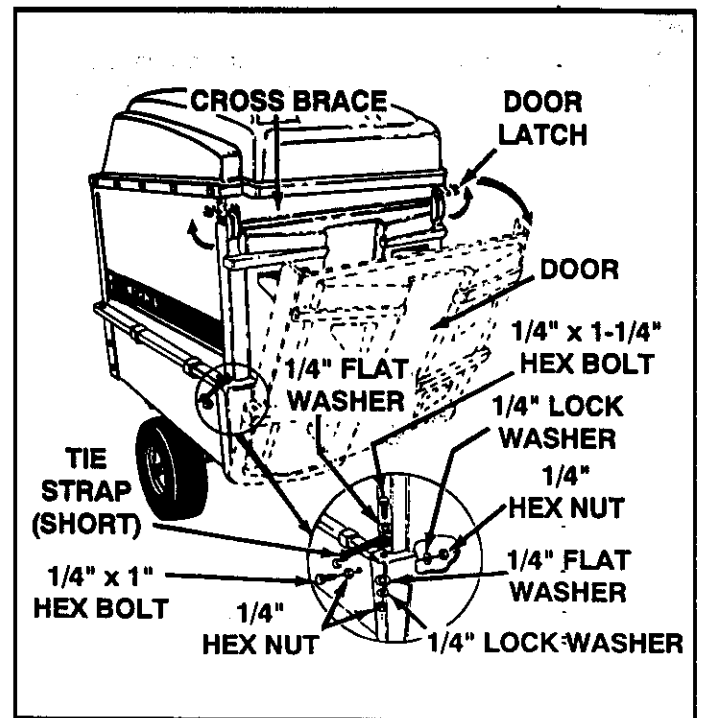

FIGURE 19

- Assemble the elbow to the blower housing, using two 5/16" x 3/4" hex bolts, two large 1-1/2" nylon washers, and two 1-1/2" flat steel washers. See figure 20. Tighten hex bolts securely.

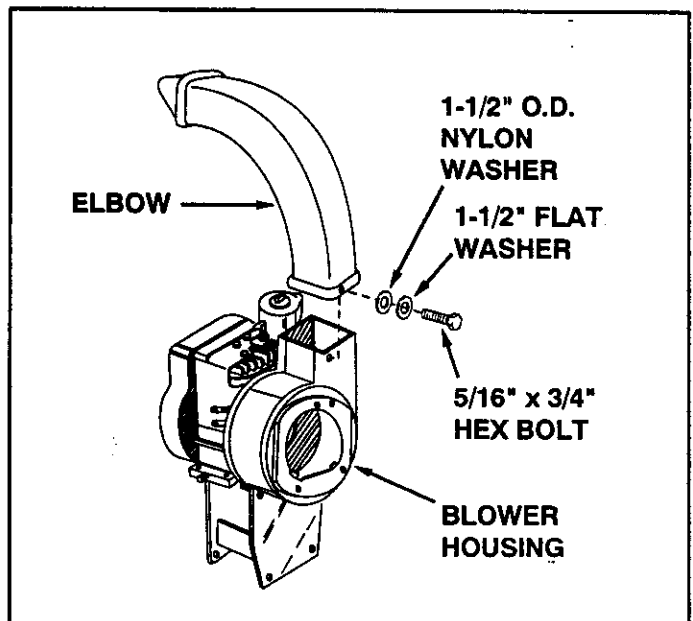

FIGURE 20

- Assemble the hose adapter (nozzle) into slots on front of housing and secure to housing with a 5/16" x 3/4" hex bolt, a 5/16" lock washer and a 5/16" flat washer as shown in figure 21. Remove hex nut and lock washer from weld bolt and place a 1-1/2" O.D. flat washer onto weld bolt so that it overlaps the hose adapter as shown in figure 21. Fasten with original hex nut and lock washer. Tighten securely.

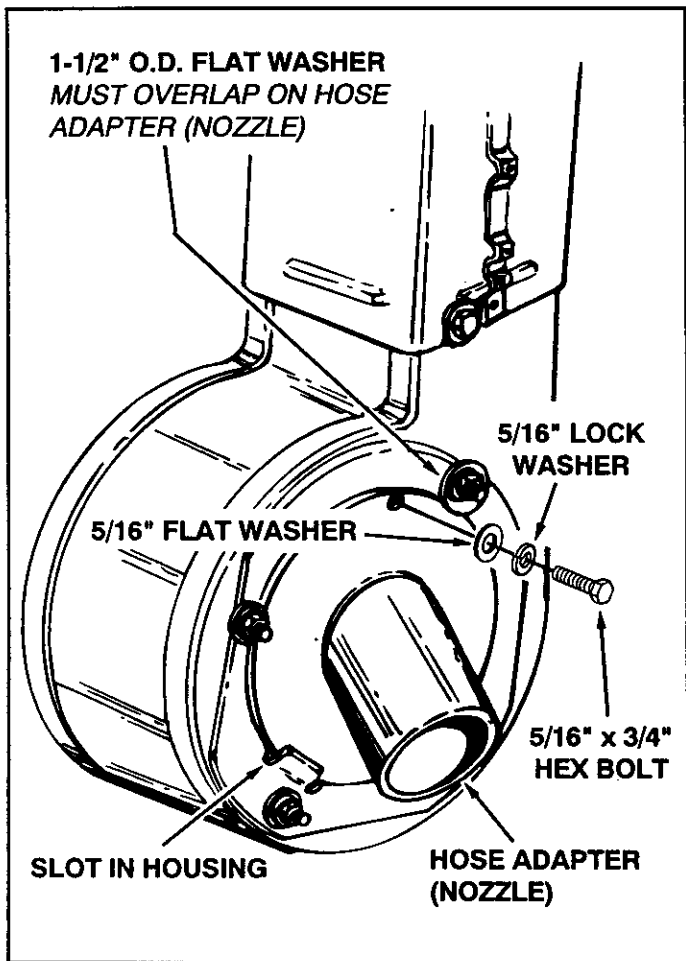

FIGURE 21

- Assemble a hose clamp on end of hose and push hose onto the hose adapter (nozzle). See figure 22. Secure hose by tightening the screw on hose clamp. Do not collapse hose adapter when tightening.

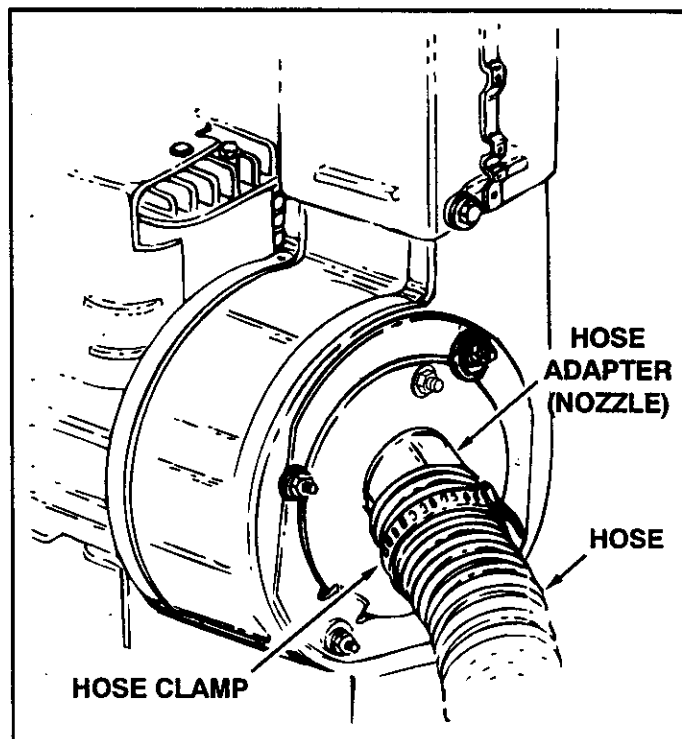

FIGURE 22

- Place hose hanger assembly into welded tube on blower housing assembly. See figure 23.
- Wrap the rubber tie strap under the hose and fasten the hooks to the end of the hose hanger assembly. See figure 23.

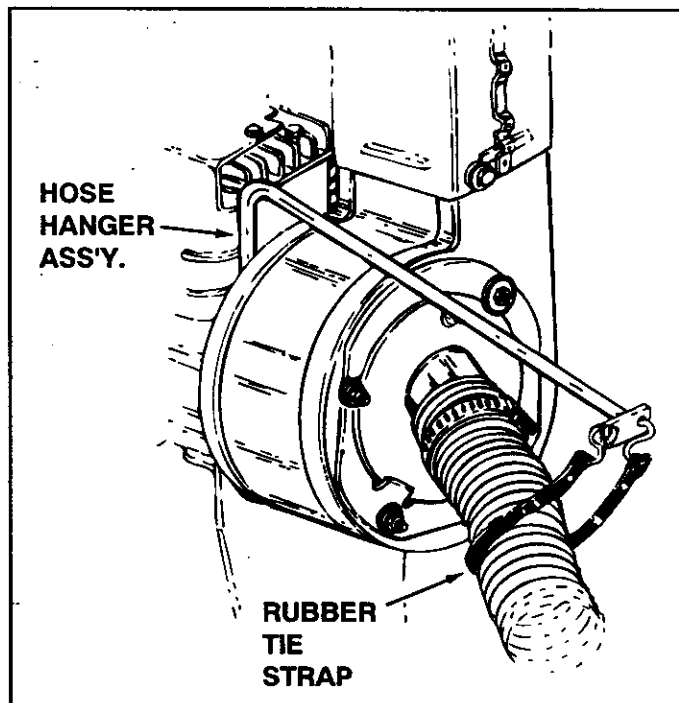
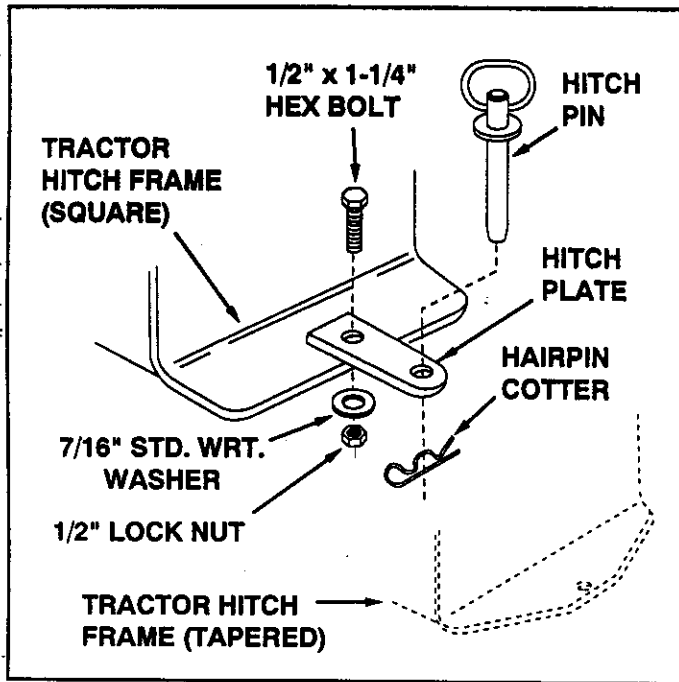

FIGURE 23

- A hitch plate is furnished for tractors having square (straight) hitch frames, to prevent binding of the Mow-N-Vac hitch in tight turns. Assemble as shown in figure 24. Tapered hitch frames, as shown with dotted lines in figure 24, generally do not require the added hitch plate.

**NOTE:** Tractors with light (thin) metal frames may require the added hitch plate to avoid excessive wear.



**FIGURE 24**

- You are now ready to assemble the deck adapter to the mower deck.

## ASSEMBLY OF THE DECK ADAPTER (#62468) TO THE TRACTOR AND MOWER

**Contents of Hardware Pack for Deck Adapter:  
See Figure 25**

Key	Qty.	Description
A	2	Hex Bolts, 5/16" x 1"
B	3	Hex Bolts, 1/4" x 3/4"
C	2	Carriage Bolts, 5/16" x 3/4"
D	3	Hex Lock Nuts, 5/16-18 Thread
E	3	Hex Lock Nuts, 1/4-20 Thread
F	3	Flat Steel Washers, 1/4" Std.
G	12	Flat Washers, 5/16" Std.
H	3	Nylon Washers, 21/64
I	1	Mounting Strap
J	1	Angle Bracket
K	1	Mounting Bracket

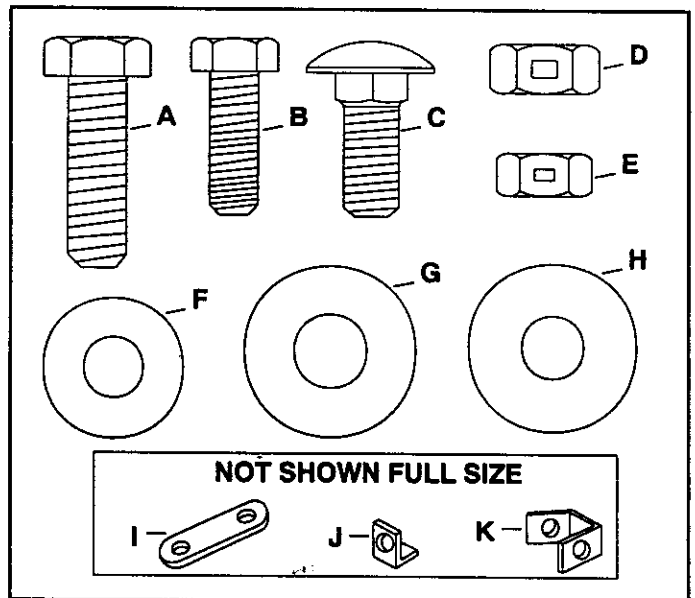

**FIGURE 25- FULL SIZE**

**NOTE:** Not all of the hardware will be used for any one particular fit up.

- Remove the mower discharge deflector from your mower deck. Save the deflector and hardware for remounting.

**IF YOU HAVE A MURRAY TRACTOR WITH A 38" OR 40" DECK, SKIP DIRECTLY TO PAGE 16.**

**IF YOU HAVE A MURRAY TRACTOR WITH A 46" DECK, SKIP DIRECTLY TO PAGE 17.**



**CAUTION:** Mower deflector must be replaced when Mow-N-Vac deck adapter is removed. Do Not operate mower unless adapter or deflector is in place and properly mounted.

- Identify your mower deck (see fold outs) and cut out the correct discharge opening template for your mower deck size. If there is no template for your deck size you can make your own template by marking around a piece of cardboard held against the edge of the discharge opening.
- Tape the template to the face of the adapter, locating template approximately 1/2" from front and 1/4" down from top of adapter. Keep as close to top as possible. See figure 26. Mark outline of template on face of adapter using white crayon, nail or scribe. Drill a starting hole inside the outline, then use a saber saw or key hole saw to cut out the opening. See figure 26.

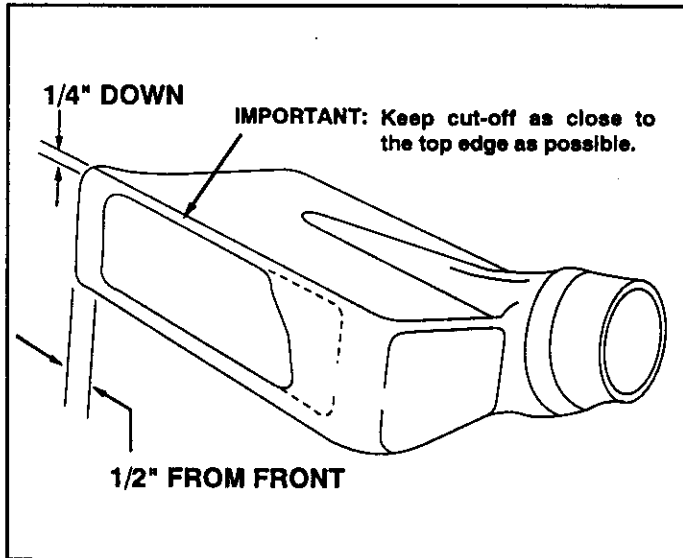

FIGURE 26

- Position the adapter over the deck opening, and check for fit of cutout as shown in figure 27. Trim cutout, if necessary, to allow tilting of adapter, keeping the fit as close as possible for best vacuum suction.

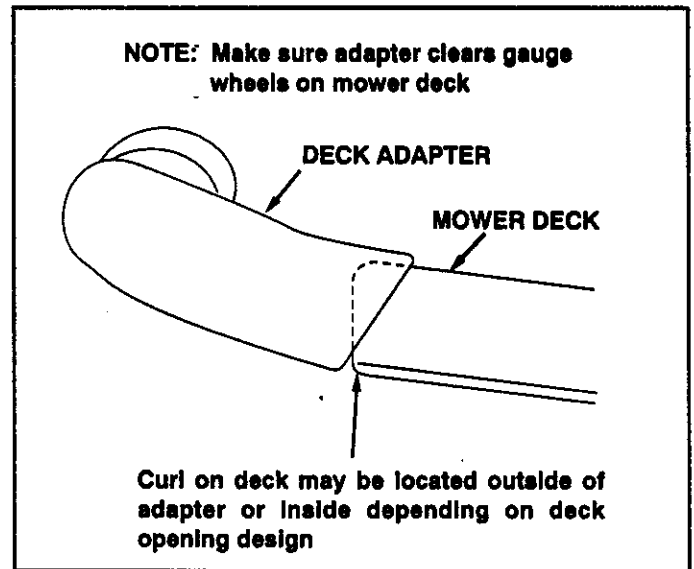

FIGURE 27

- Holding the adapter bracket and the deck adapter together, position the deck adapter on the mower deck. Keeping the edge of deck adapter as close as possible to the offset in the adapter bracket, see if the slot in the adapter bracket can be aligned with one or two of the deflector holes in your mower deck's discharge opening. If the bracket can not be located correctly using existing holes, it will be necessary to drill one or two 5/16" diameter holes in the deck. See figure 28.

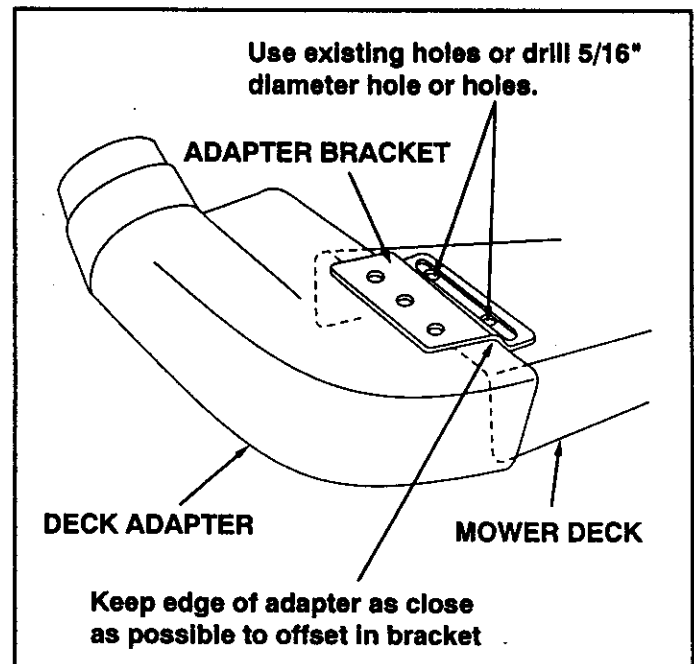

FIGURE 28

- Assemble the adapter bracket to the deck using two 5/16" x 1" hex bolts, 5/16" flat washers and 5/16" lock nuts. See figure 29.

**NOTE:** It may be necessary to use extra 5/16" flat washers to shim under the bracket next to the deck surface. Ten extra washers have been furnished as shims. See figure 29.

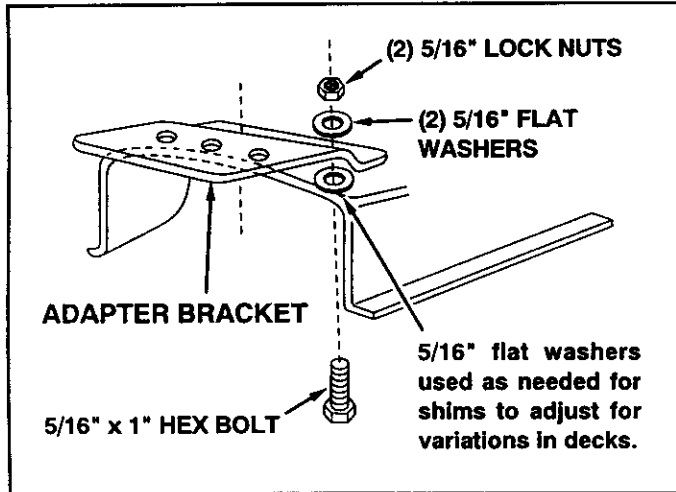

FIGURE 29

- With deck adapter positioned correctly over the discharge opening, use the adapter bracket as a template and drill three 9/32" diameter holes in the top of the deck adapter. See figure 30.
- Bolt deck adapter to bracket using three 1/4" x 3/4" bolts, nylon washers, 1/4" flat washers and 1/4" lock nuts. Nylon washers should be against the inside of the deck adapter. See figure 30.

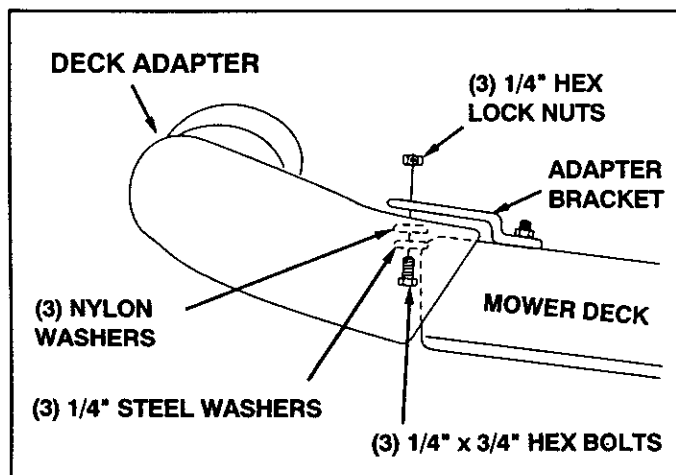

FIGURE 30

- Assemble end of hose and a hose clamp over the round opening of deck adapter and tighten clamp. **GO DIRECTLY TO THE OPERATION INSTRUCTIONS ON PAGE 18.**

## FOR 1990 AND NEWER MURRAY TRACTORS WITH A 38" OR 40" DECK

- Cut out two templates and place on deck adapter as shown in figure 31. Tape smaller one on top and larger one on the side and bottom. After they are in place, carefully mark around the templates, then cut out adapter to obtain correct opening.

- Bolt end of mounting strap to the 5/16" bolt on the mower deck. The other end of the strap will bolt to a hole in the deck adapter, which must be drilled. Position the adapter on the deck, then drill a 5/16" hole in the bottom of the adapter that will align with the hole in the strap. Fasten the adapter to the strap using a 1/4" x 3/4" hex bolt, 1/4" flat washer, nylon washer and 1/4" hex nut. See figure 31.

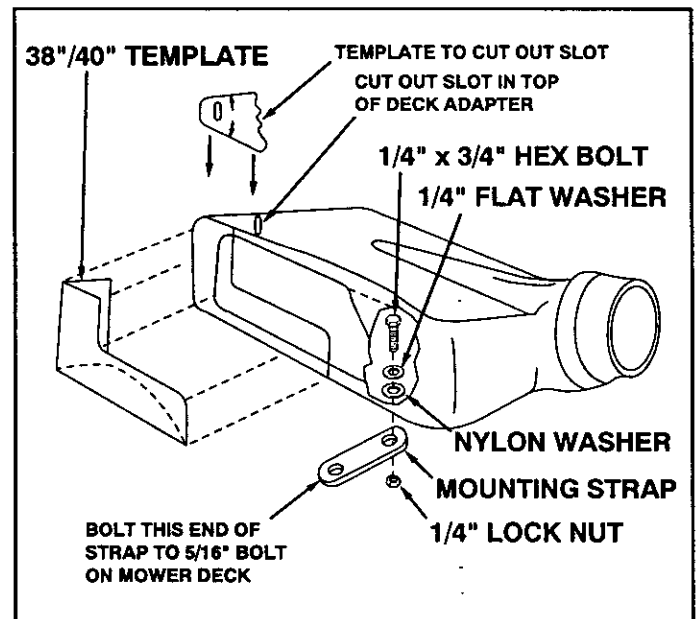

FIGURE 31

- Assemble end of hose and hose clamp over the round opening of deck adapter and tighten clamp. **GO DIRECTLY TO THE OPERATION INSTRUCTIONS WHICH ARE LOCATED ON PAGE 18.**



## FOR 1990 AND NEWER MURRAY TRACTORS WITH A 46" DECK

- Tape 46" template onto deck adapter. Mark and then cut out adapter .
- Fasten the angle bracket and the mounting bracket to the mower deck as shown in figure 32. Use two 5/16" x 3/4" carriage bolts, 5/16" flat washers and 5/16" lock nuts. The bolt heads go on inside of mower deck.
- Drill two 5/16" diameter holes in the deck adapter that will align with the holes in the angle bracket and the mounting bracket. Assemble the deck adapter to both brackets using two 1/4" x 3/4" hex bolts, 1/4" flat washers, nylon washers and 1/4" lock nuts. See figure 32.

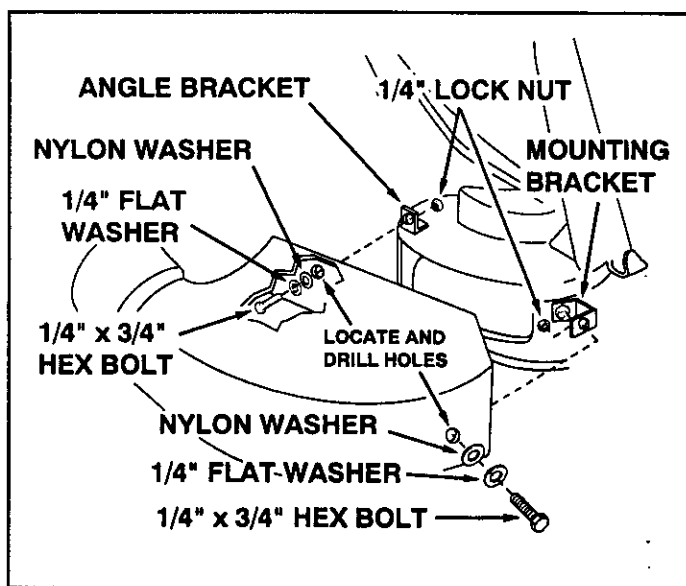

FIGURE 32

- Assemble end of hose and hose clamp over the round opening of deck adapter and tighten clamp. **GO DIRECTLY TO THE OPERATION INSTRUCTIONS WHICH ARE LOCATED ON PAGE 18.**

# OPERATION

Read this owner's manual and safety rules before operating your Mow-N-Vac.

## BEFORE STARTING

- Your Mow-N-Vac engine is shipped without oil or gasoline. Service the Mow-N-Vac engine with oil and gas as instructed in the separate engine manual.
- Inspect the Mow-N-Vac to make sure all covers (rear door, hard top boot, elbow, hose adapter, hose and deck adapter) are properly attached.
- Check tires for proper inflation (12 - 14 lbs).



**WARNING:** Never fill fuel tank indoors, or with the engine running, or while the engine is hot. Do not smoke while filling tank.

## HOW TO STOP YOUR MOW-N-VAC

- To stop engine, move the throttle control lever to the OFF position.
- Disconnect spark plug wire from plug to prevent accidental starting while equipment is unattended or is being worked on.



**CAUTION:** The muffler and adjacent areas are hot!

## HOW TO START YOUR MOW-N-VAC



**WARNING:** Never start or run the engine without all covers being properly attached to the blower housing and cart.

- Check oil and gas in Mow-N-Vac engine.
- Attach spark plug wire to spark plug.
- Move choke lever on engine to CHOKE position. (A warm engine may not require choking.)
- Move throttle control lever on engine to FAST position.
- Grasp starter handle and pull rope out slowly until engine reaches start of compression cycle (rope will pull slightly harder at this point). Let the rope rewind slowly.
- Pull rope with a rapid, continuous, full arm stroke. Keep a firm grip on starter handle. Let rope rewind slowly. Do not let starter handle snap back against starter.
- Repeat instructions in two preceding paragraphs until engine fires. When engine starts, move choke control gradually to RUN position.

## HOW TO USE YOUR MOW-N-VAC



**CAUTION:** Vehicle braking and stability may be affected with the addition of an accessory or an attachment. Be aware of changing conditions on slopes.

- Before beginning operation, inspect the Mow-N-Vac to make sure all covers (rear door, hard top boot, elbow, hose adapter, hose and deck adapter) are properly attached.
- Begin operation at low speed, adjusting forward speed to match grass height and/or moisture condition to prevent clogging.



**WARNING:** Should your Mow-N-Vac become clogged, shut off tractor and Mow-N-Vac engine. Before attempting to unclog, remove wire from spark plug to prevent accidental starting.



**CAUTION:** Never drive over gravel or rocks with the mower blades engaged and running.

- To empty cart, shut off tractor engine and set brake.
- Shut off Mow-N-Vac engine.
- Remove rear door from cart.
- Release the latch holding cart down to the tongue by pulling up on the latch lever. See figure 33.



**CAUTION:** To avoid possible injury, be sure that no one is near the cart before releasing the latch.

- Using a rake or suitable tool, pull the grass clippings and/or leaves out of cart.
- After cart is emptied, tip cart forward and secure to tongue with latch. Reattach the rear door and the hard top boot.

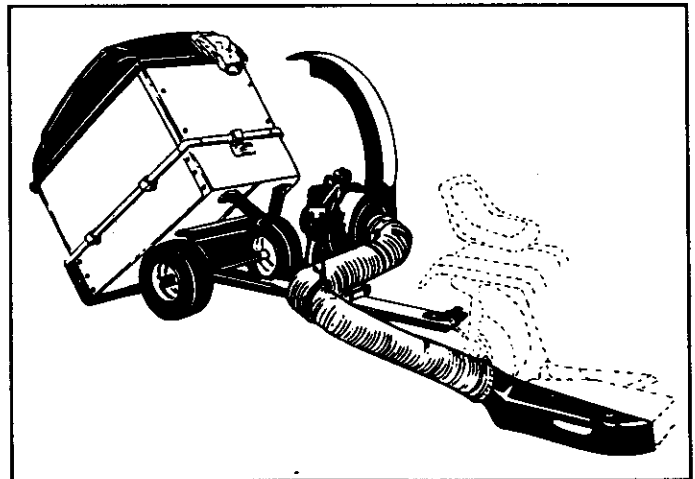

FIGURE 33

# MAINTENANCE

## CUSTOMER RESPONSIBILITIES

- Read and follow the maintenance schedule and the maintenance procedures listed in this section.

MAINTENANCE SCHEDULE Fill in dates as you complete regular service.	Service Dates											
	Before each use	After each use	Every season	Before storage								
Check for loose fasteners	X											
Check soft vinyl boot	X											
Check tire pressure	X											
Check engine oil level	X											
Lubricate			X									
Clean		X		X								
Maintain engine per instructions below and in engine manual.												

## BEFORE EACH USE

### CHECK FOR LOOSE FASTENERS

- Make a thorough visual check of the snow thrower for any bolts and nuts which may have loosened. Retighten any loose bolts and nuts.

### CHECK SOFT VINYL BOOT

- Check the soft vinyl boot (on front of hard top) for wear. Replace if worn or damaged.

### CHECK TIRE PRESSURE

- Check tire pressure regularly. Recommended tire pressure is 12-14 Lbs.

### CHECK ENGINE OIL LEVEL

- Check oil level before each use. Maintain engine oil as instructed in the separate engine manual.

## LUBRICATION

- At the beginning of each season, lubricate the latch, latch pivot bolt, and the axle where the hitch tongue pivots, with a light machine oil.
- At least once a season, grease or oil the wheel bearings. Use automotive wheel bearing type grease or 20 weight oil.

## CLEANING

- Make sure the cart, the side and front panels and top are cleaned after each use. Grass clippings and leaves left in the cart will mildew and cause damage if not cleaned out.
- **Clean the engine** regularly with a cloth or brush. Keep the cooling fins on the engine housing clean to permit proper air circulation which is essential to engine performance and life. Be sure to remove all dirt and debris from muffler area.



**WARNING:** Always stop engine and disconnect spark plug wire before cleaning, lubricating or before performing any repairs or maintenance.

## ENGINE MAINTENANCE

- Service **air cleaner** every 25 hours under normal conditions. Clean every few hours under extremely dusty conditions. Poor engine performance and flooding usually indicates that the air cleaner should be serviced. To service the air cleaner, refer to the separate engine manual.
- The **spark plug** should be cleaned and the gap reset once a season. Spark plug replacement is recommended at the start of each season. Check the engine manual for correct plug type and gap specifications.

## STORAGE

- Clean the engine and the entire unit thoroughly.
- Refer to engine manual for correct engine storage instructions.
- If storing in an unventilated or metal storage shed, coat metal parts with light oil or silicone to prevent rust.
- Store unit in a clean, dry area.

## TROUBLESHOOTING

PROBLEM	POSSIBLE CAUSE(S)	CORRECTIVE ACTION
Engine fails to start	<ol style="list-style-type: none"> <li>1. Spark plug wire disconnected.</li> <li>2. Fuel tank empty, or stale fuel.</li> <li>3. Fuel shut-off valve closed (if so equipped).</li> <li>4. Faulty spark plug.</li> </ol>	<ol style="list-style-type: none"> <li>1. Connect wire to spark plug.</li> <li>3. Fill tank with clean, fresh fuel.</li> <li>4. Open fuel shut-off valve.</li> <li>5. Clean, adjust gap or replace.</li> </ol>
Loss of power; operation erratic.	<ol style="list-style-type: none"> <li>1. Spark plug wire loose</li> <li>2. Unit running on CHOKE.</li> <li>3. Blocked fuel line or stale fuel.</li> <li>4. Water or dirt in fuel system.</li> <li>5. Carburetor out of adjustment.</li> <li>6. Dirty air cleaner.</li> </ol>	<ol style="list-style-type: none"> <li>1. Connect and tighten spark plug wire.</li> <li>2. Move choke lever to OFF position.</li> <li>3. Clean fuel line; fill tank with clean fresh gasoline.</li> <li>4. Disconnect fuel line at carburetor to drain fuel tank. Refill with fresh fuel.</li> <li>5. Adjust carburetor.*</li> <li>6. Service air cleaner.*</li> </ol>
Engine overheats	<ol style="list-style-type: none"> <li>1. Carburetor not adjusted properly.</li> <li>2. Engine oil level low.</li> </ol>	<ol style="list-style-type: none"> <li>1. Adjust carburetor.*</li> <li>2. Fill crankcase with proper oil.</li> </ol>
Too much vibration	Loose parts or damaged impeller.	Stop engine immediately and disconnect spark plug wire. Tighten all bolts and nuts. Make all necessary repairs. If vibration continues, have unit serviced by an authorized service dealer.
Unit does not discharge	<ol style="list-style-type: none"> <li>1. Discharge chute (elbow) clogged.</li> <li>2. Foreign object lodged in impeller.</li> <li>3. Mow-N-Vac cart is full.</li> </ol>	<ol style="list-style-type: none"> <li>1. Stop engine immediately and disconnect spark plug wire. Clean inside of housing and discharge chute (elbow).</li> <li>2. Stop engine immediately and disconnect spark plug wire. Remove lodged object.</li> <li>3. Stop engine and empty cart.</li> </ol>

\*Refer to the engine manual packed with your unit.

**NOTE:** For repairs beyond the minor adjustments listed above, please contact your nearest authorized service dealer.

# NOTES

# NOTES

# PARTS

## MODEL 486.24505 MOW-N-VAC CART BODY

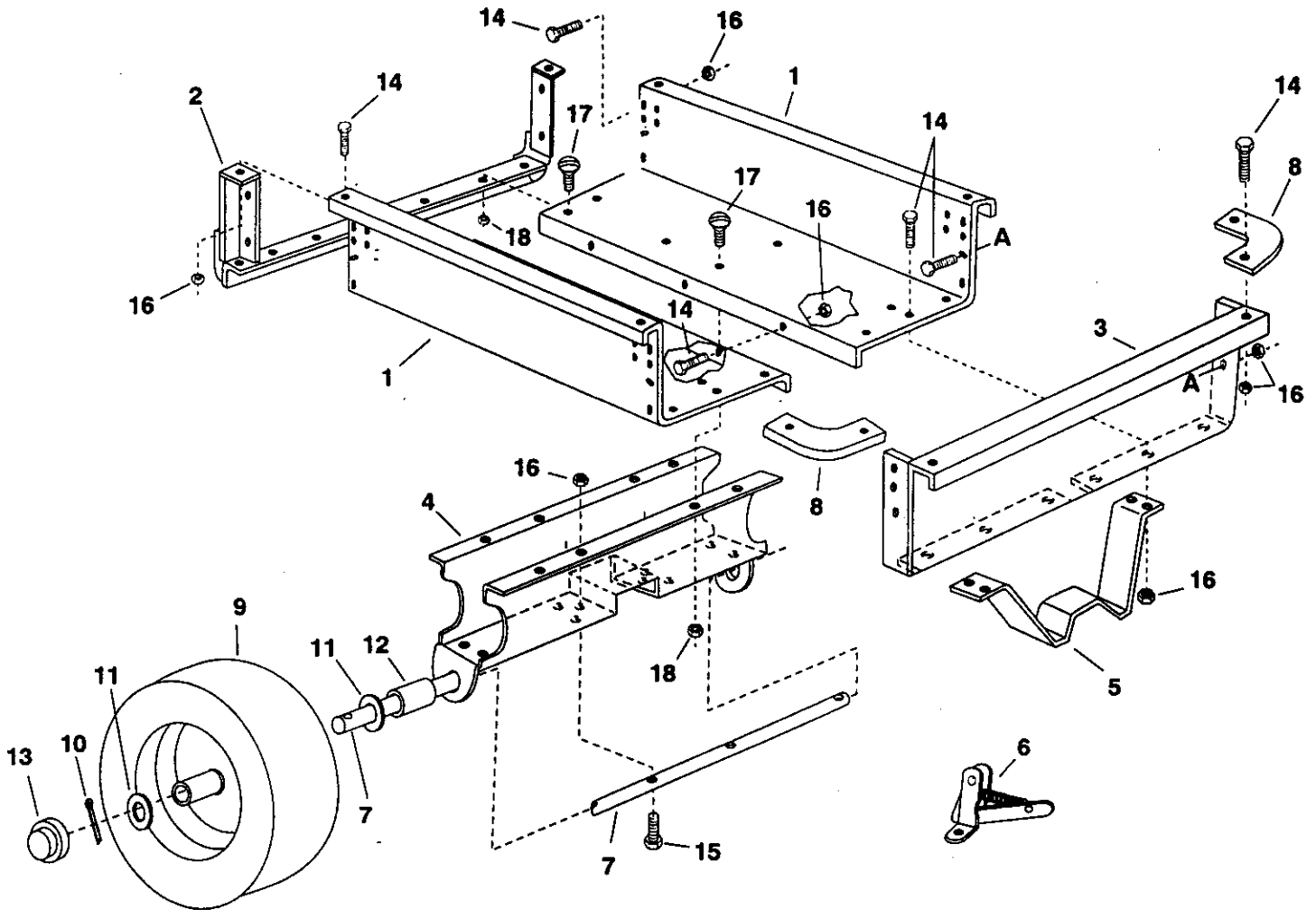

REF. NO.	PART NO.	QTY.	DESCRIPTION	REF. NO.	PART NO.	QTY.	DESCRIPTION
1	23985	2	Cart Body	10	43093	2	Cotter Pin, 1/8" Dia. x 1-1/2"
2	62458	1	Tailgate Reinforcement Bracket	11	43601	4	Washer, Flat 1"
3	23492	1	Front Panel	12	44678	2	Spacer Tube, 1-1/4" O.D. x 2" Lg.
4	23507	1	Wheel Support	13	43014	2	Hub Cap
5	23297	1	Latch Stand Bracket	14	43175	25	Hex Bolt, 1/4-20 x 1/2" *
6	62455	1	Ass'y, Latch Lock	15	1509-69	2	Hex Bolt, 1/4-20 x 1-3/4" *
7	23488	1	Axle, Wheel 1" Dia.	16	46978	27	Hex Nut, 1/4-20 Thread (SEMS)
8	23484	2	Cap, Front Corner	17	43814	14	Slit. Truss Hd. Bolt, 5/16-18 x 3/4" Lg.*
9	46272	2	Wheel, 15/6.00 x 8.00	18	46980	14	Hex Nut, 5/16-18 Thread (SEMS)





## MODEL 486.24505 MOW-N-VAC

REF. NO.	PART NO.	QTY.	DESCRIPTION	REF. NO.	PART NO.	QTY.	DESCRIPTION
1	43063	2	Hex Bolt, 5/16" x 1"	42	43343	1	Hairpin Cotter, 1/8"
2	23655	1	Stop Angle	43	43087	2	Hex Bolt, 3/8" x 1-1/4"
3	23475	1	Hitch Bracket (Heavy Duty)	44	43082	9	Hex Lock Nut, 3/8-16 Thread
4	62450	1	Engine Base Ass'y	45	43001	4	Hex Bolt, 3/8" x 1" (Grade 5)
5		1	5 H.P. B&S Engine (135212-1313-E1)	46	43064	3	Hex Lock Nut, 5/16-18 Thd.
6	43085	4	Hex Bolt, 5/16-18 x 1-1/2"	47	43572	3	Flat Washer, 1-1/2" OD
7	43086	4	Lock Washer 5/16" ID	48	43553	2	Nylon Washer, 1-1/2" OD
8	43064	6	Hex Lock Nut 5/16-18 Thread	49	43182	5	Hex Bolt, 5/16" x 3/4" Lg.
9	23474	1	Bracket, Engine To Blower	50	43081	1	Flat Washer, 5/16" Std.
10	43749	2	Hex Thread Cut Bolt, 5/16-18 x 3/4"	51	44790	1	Poly Rear Door
11	710-0627	2	Hex Bolt, 5/16-24 x 3/4" Lg. Gr. 5	52	43768	5	Hex Bolt, 3/8" x 1-1/2" Lg.
12	43086	2	Lock Washer, 5/16" ID	53	43351	1	Hex Bolt, 1/2" x 1-1/4" Lg.
13	62486	1	Blower Housing Ass'y	54	43262	1	Hex Lock Nut, 1/2" Thd.
14	681-0075	1	Vane Plate Ass'y	55	43352	1	Flat Washer, 7/16" Std. Wrt.
15	14563	1	Nozzle Plate Ass'y	56	43012	31	Hex Bolt, 1/4" x 3/4" Lg.
17	47048	1	Hex Bolt, 3/8-24 x 1-3/4" Grade 5	57	43882	21	Rivet
18	43003	1	Lock Washer 3/8" ID	58	1543-69	2	21/64" Nylon Washer
19	43080	6	Carriage Bolt, 5/16" x 3/4" Lg.	59	23789	2	Door Latch
20	23842	4	Boot Mounting Strap	60	23836	1	Cross Brace
21	43086	5	Lock Washer 5/16" ID	61	23838	2	Door Support
22	43083	4	Hex Nut, 5/16-18 Thread	62	23837	1	Screen Support
23	62451	1	Hose Hanger Ass'y	63	44792	1	(Available only with item no. 81) Screen
24	43788	1	Elbow w/ Deflector	64	44796	1	(Available only with item no. 81) Boot
25	43791	1	Hose Adapter (Nozzle)	65	43910	21	Washer, 3/16"
26	43792	1	6" O.D. Hose	66	44840	2	Tie Strap
27	43793	2	Hose Clamp 6" Dia.	67	43661	2	Hex Bolt, 1/4" x 1" Lg.
28	23834	1	Side Panel (R.H.)	69	1543-69	3	21/64" Nylon Washer
29	23835	1	Front Panel	70	63025	1	Rear Section Tongue Ass'y
30	23833	1	Side Panel (L.H.)	71	63026	1	Front Section Tongue Ass'y
31	44791	1	Poly Hard Top (Available only with item no. 81)	72	46938	3	Hex Bolt, 3/8" x 3-1/4" Lg.
32	43790	1	Tie Strap 25" Lg.	73	43081	12	Flat Washer, 5/16" Std.
33	43884	1	Hitch Pin	74	43830	1	Deck Adapter
34	23478	5	Clamp, Cart Ext.	75	23560	1	Bracket, Deck Adapter
36	23540	1	Hitch Plate	76	23825	1	Mounting Strap
37	43003	9	Lock Washer 3/8" ID	77	23826	1	Angle Bracket
38	43796	4	Hex Bolt, 1/4" x 2-3/4" Lg. Grade 5	78	23827	1	Mounting Bracket
39	43088	31	Flat Washer, 1/4" ID	79	43013	3	Hex Lock Nut, 1/4" Thd.
40	43177	36	Lock Washer, 1/4" ID	80	1509-90	2	Hex Bolt, 1/4-20 x 1-1/4" Lg.
41	43178	38	Hex Nut, 1/4-20 Thread	81	62468	1	Deck Adapter Kit (Includes parts shown in box on page 24.)
				82	62836	1	Hardtop assembly (Includes items 20, 31, 57, 62, 63, 64 and 65.)
					47502	1	Owner's Manual

\* Purchase Common Hardware Locally



# SLOPE GUIDE

(Keep this sheet in a safe place for future reference.)

Use this guide to determine if a slope is safe for the operation of your tractor and Mow-N-Vac. Refer also to the instructions in your vehicle owners manual.

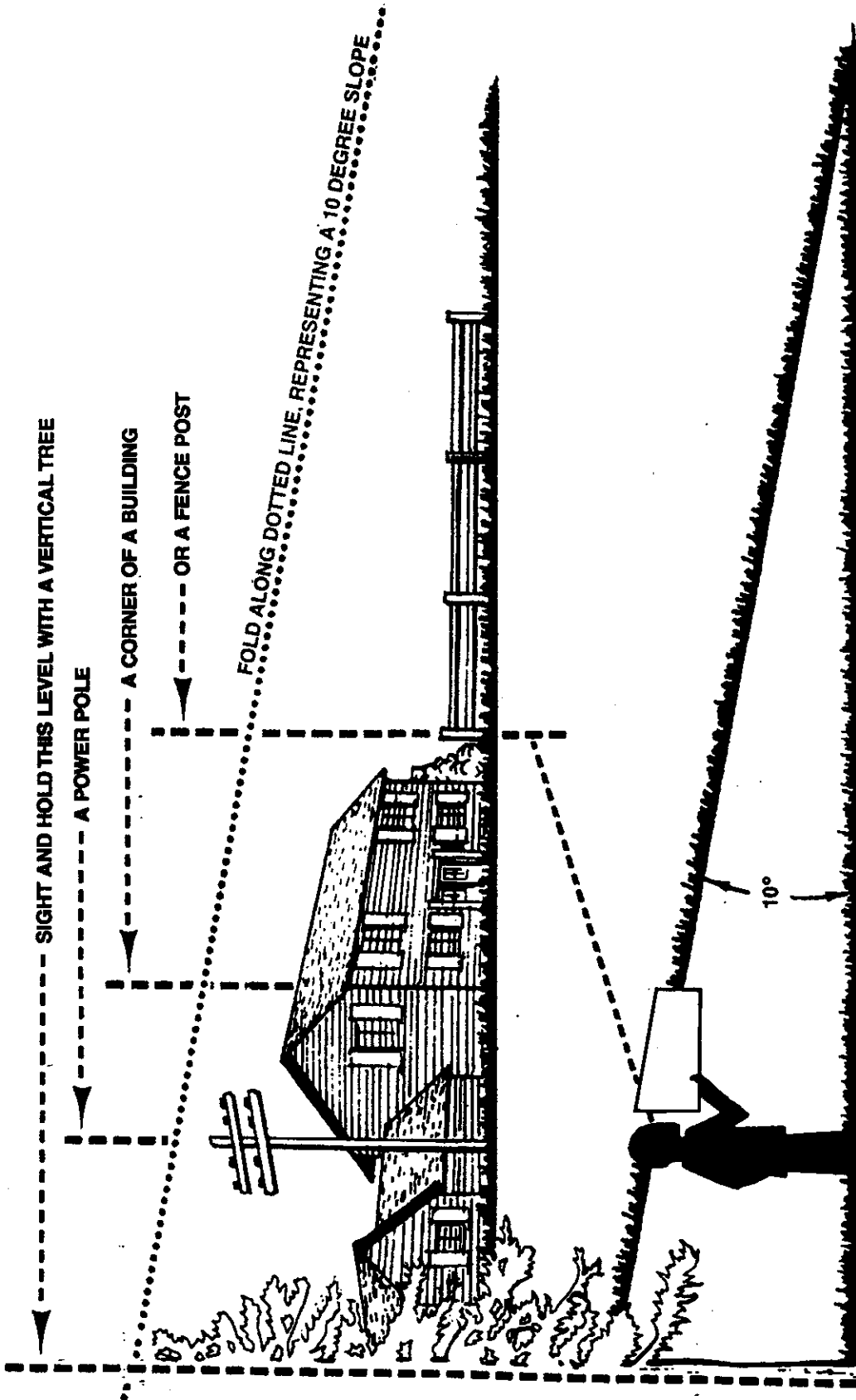

**CAUTION: DO NOT OPERATE YOUR TRACTOR AND MOW-N-VAC ON A SLOPE IN EXCESS OF 10 DEGREES. BE SURE OF YOUR TRACTOR'S TOWING AND BRAKING CAPABILITIES BEFORE OPERATING ON A SLOPE. AVOID ANY SUDDEN TURNS OR MANEUVERS WHILE ON A SLOPE.**



**For in-home major brand repair service:**

Call 24 hours a day, 7 days a week

**1-800-4-MY-HOME<sup>SM</sup>** (1-800-469-4663)

**Para pedir servicio de reparación a domicilio – 1-800-676-5811**

In Canada for all your service and parts needs call – **1-800-665-4455**  
Au Canada pour tout le service ou les pièces

**For the repair or replacement parts you need:**

Call 7 am – 7 pm, 7 days a week

**1-800-366-PART** (1-800-366-7278)

**Para ordenar piezas con entrega a domicilio – 1-800-659-7084**

**For the location of a Sears Parts and Repair Center in your area:**

Call 24 hours a day, 7 days a week

**1-800-488-1222**

**For information on purchasing a Sears Maintenance Agreement  
or to inquire about an existing Agreement:**

Call 9 am – 5 pm, Monday – Saturday

**1-800-827-6655**



The Service Side of Sears<sup>SM</sup>