

Operator's Manual

CRAFTSMAN®

1.4 cu. in./24cc 2-Cycle
205 MPH/410 CFM
**GASOLINE POWERED
BLOWER/VAC**

Model No.
358.797290

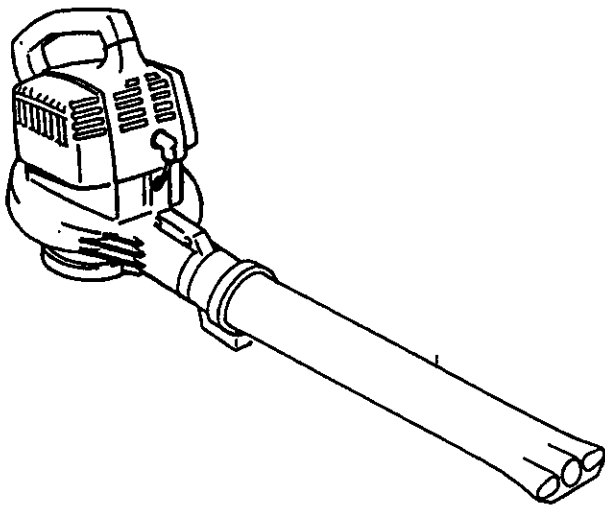

WARNING:
Read and follow all Safety Rules and Operating Instructions before first use of this product.



For answers to your questions about this product:
Call 7 am–7 pm, Mon.–Sat., or 10 am–7 pm, Sun.

1-800-235-5878 (Hours listed are Central Time)

Sears, Roebuck and Co., Hoffman Estates, IL 60179 USA

530-087632 07/10/98

SAFETY

ASSEMBLY

OPERATION

MAINTENANCE

PARTS LIST

ESPAÑOL

TABLE OF CONTENTS

Warranty Statement	2	Storage	10
Safety Rules	2	Troubleshooting Chart	11
Assembly	4	Parts List	13
Operation	6	Spanish	16
Maintenance	8	Parts and Ordering	Back
Service & Adjustments	9		

WARRANTY STATEMENT

FULL TWO YEAR WARRANTY ON CRAFTSMAN® GAS BLOWER

For two (2) years from date of purchase, when this Gas Blower is maintained, lubricated, and tuned up according to the instructions in the operator's manual, Sears will repair, free of charge, any defects in material or workmanship.

This warranty excludes blower tubes, spark plug, and air cleaner, which are expendable parts and become worn during normal use.

If this blower is used for commercial purposes, this warranty applies for 90 days from the date of purchase. If this Blower is used for rental purposes, this warranty applies for 30 days from the date of purchase. This warranty applies only while this product is in use in the United States.

WARRANTY SERVICE IS AVAILABLE BY RETURNING THE BLOWER TO THE NEAREST SEARS SERVICE CENTER IN THE UNITED STATES.

This warranty gives you specific legal rights, and you may also have other rights which vary from state to state.

Sears, Roebuck and Co. D/817WA Hoffman Estates, IL 60179

SAFETY RULES

Failure to follow all Safety Rules and Precautions can result in serious injury.

KNOW YOUR UNIT

- Read your Operator's Manual carefully until you completely understand and can follow all warnings and safety rules before operating the unit.
- Restrict unit to users who understand and will follow all warnings and safety rules in this manual.

PLAN AHEAD

- Always wear eye protection when operating, servicing, or performing maintenance on unit. Wearing eye protection will help to prevent rocks or debris from being blown or ricocheting into eyes and face which can result in blindness and/or serious injury.
- Always wear respirator or face mask when working with unit in dusty environments.
- Secure hair above shoulder length. Secure or remove jewelry, loose clothing, or clothing with loosely hanging straps, ties, tassels, etc. They can be caught in moving parts.

- Do not operate unit when you are tired, ill, upset, or if you are under the influence of alcohol, drugs, or medication.
- Keep children, bystanders, and animals away from work area a minimum of 50 feet (15 m) when starting or operating unit.
- Inspect area before starting unit. Remove all debris and hard objects such as rocks, glass, wire, etc. that can ricochet, be thrown, or otherwise cause injury or damage during operation.

HANDLE FUEL WITH CAUTION

- Eliminate all sources of sparks or flame (including smoking, open flames, or work that can cause sparks) in the areas where fuel is mixed, poured, or stored.
- Mix and pour fuel in an outdoor area; store fuel in a cool, dry, well ventilated place; use an approved, marked container for all fuel purposes.
- Do not smoke while handling fuel or while operating the unit.
- Do not fill fuel tank while engine is running.

- Wipe up fuel spills before starting engine.
- Move at least 10 feet (3 meters) away from fuel and fueling site before starting engine.

OPERATE YOUR UNIT SAFELY

- Stop the engine before opening the vacuum inlet door. The engine must be stopped and the impeller blades no longer turning to avoid serious injury from the rotating blades.
- Inspect unit before each use for worn, loose, missing, or damaged parts. Do not use until unit is in proper working order.
- Keep outside surfaces free from oil and fuel.
- Never start or run engine inside a closed room or building. Breathing exhaust fumes can kill.
- To avoid static electricity shock, do not wear rubber gloves or any other insulated gloves while operating unit.
- Do not set unit on any surface except a clean, hard area while engine is running. Debris such as gravel, sand, dust, grass, etc. could be picked up by the air intake and thrown out through discharge opening, damaging unit, property, or causing serious injury to bystanders or operator.
- Avoid dangerous environments. Do not use in unventilated areas or where explosive vapors or carbon monoxide build up could be present.
- Do not overreach or use from unstable surfaces such as ladders, trees, steep slopes, rooftops, etc. Keep firm footing and balance at all times.
- Never place objects inside the blower tubes; always direct the blowing debris away from people, animals, glass, and solid objects such as trees, automobiles, walls, etc. The force of air can cause rocks, dirt, or sticks to be thrown or to ricochet which can hurt people or animals, break glass, or cause other damage.
- Never run unit without the proper equipment attached. When using your unit as a blower, always install blower tubes. When using the optional vacuum kit, always install vacuum tubes and vacuum bag assembly. Make sure vacuum bag assembly is completely zipped.
- Check air intake opening, blower tubes, and vacuum tubes frequently,

always with engine stopped and spark plug disconnected. Keep vents and discharge tubes free of debris which can accumulate and restrict proper air flow.

- Never place any object in air intake opening as this could restrict proper air flow and cause damage to the unit.
- Never use for spreading chemicals, fertilizers, or other substances which may contain toxic materials.
- To avoid spreading fire, do not use near leaf or brush fires, fireplaces, barbecue pits, ashtrays, etc.
- Use only for jobs explained in this manual.

MAINTAIN YOUR UNIT PROPERLY

- Have all maintenance other than the recommended procedures described in the Operator's Manual performed by Sears Service.
- Disconnect spark plug before performing maintenance except for carburetor adjustments.
- Use only recommended CRAFTSMAN® replacement parts; use of any other parts may void your warranty and cause damage to your unit.
- Empty fuel tank before storing the unit. Use up fuel left in carburetor by starting engine and letting it run until it stops.
- Do not use any accessory or attachment other than those recommended by manufacturer for use with your unit.
- Do not store the unit or fuel in a closed area where fuel vapors can reach sparks or an open flame from hot water heaters, electric motors or switches, furnaces, etc.
- Store in a dry area out of reach of children.

SPECIAL NOTICE: For users on U.S. Forest Land and in some states, including California (Public Resources Codes 4442 and 4443), Idaho, Maine, Minnesota, New Jersey, Oregon, and Washington: Certain internal combustion engines operated on forest, brush, and/or grass covered land in the above areas are required to be equipped with a spark arrestor, maintained in effective working order, or the engine must be constructed, equipped, and maintained for the prevention of fire. Check with your state or local authorities for regulations pertaining to these requirements. Failure to follow these requirements is a violation of the law. This unit

is not factory equipped with a spark arrestor; however, a spark arrestor is available as an optional part. If a spark arrestor is required in your area, contact Sears Service for the correct kit. The spark arrestor, blower tubes, and nozzles must be assembled to unit to be in full compliance with regulations. **SPECIAL NOTICE:** Exposure to vibrations through prolonged use of gasoline powered hand tools could cause blood vessel or nerve damage in the fingers, hands, and joints of people prone to circulation disorders or abnormal swelling.

Prolonged use in cold weather has been linked to blood vessel damage in otherwise healthy people. If symptoms occur such as numbness, pain, loss of strength, change in skin color or texture, or loss of feeling in the fingers, hands, or joints, discontinue the use of this tool and seek medical attention. An antivibration system does not guarantee the avoidance of these problems. Users who operate power tools on a continual and regular basis must monitor closely their physical condition and the condition of this tool.

ASSEMBLY

CARTON CONTENTS

Check carton contents against the following list.

Model 358.797290

- Blower
- Blower tube
- Vacuum bag
- Upper vacuum tube
- Lower vacuum tube
- 2-Cycle Engine Oil

NOTE: It is normal for the fuel filter to rattle in the empty fuel tank.

ASSEMBLY

WARNING: If received assembled, repeat all steps to ensure your unit is properly assembled and all fasteners are secure.

- No tools are required for assembly.

BLOWER TUBE ASSEMBLY

If you have already assembled your unit for use as a vacuum, remove the vacuum tubes and collection bag.

- Align the rib on the blower tube with the groove in the blower outlet; slide the tube into place.

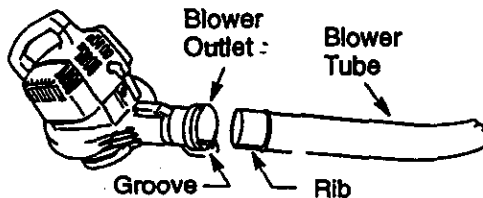

- Tighten the tube clamp by turning the knob clockwise.
- To remove the tube, turn the knob counterclockwise to loosen clamp; remove tube.

VACUUM BAG ASSEMBLY

If you have already assembled your unit for use as a blower, remove the blower tube.

- Place the small end of vacuum bag over the blower outlet and clamp knob.

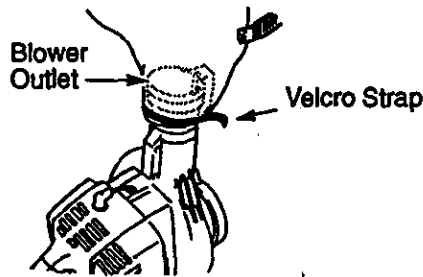

- Tighten the Velcro strap securely.
- Make sure the zipper on the bag is closed completely.
- Secure the ends of the shoulder strap by routing the strap through the buckle as shown.

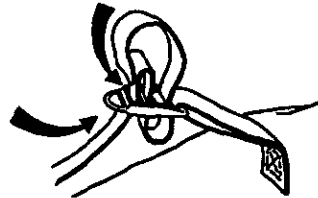

VACUUM TUBE ASSEMBLY

WARNING Stop engine and be sure the impeller blades have stopped turning before opening the vacuum inlet door or attempting to insert or remove the vacuum tubes. The rotating blades can cause serious injury.

- Remove blower tube from engine.

- Align the lower vacuum tube as shown. Push lower vacuum tube into upper vacuum tube.

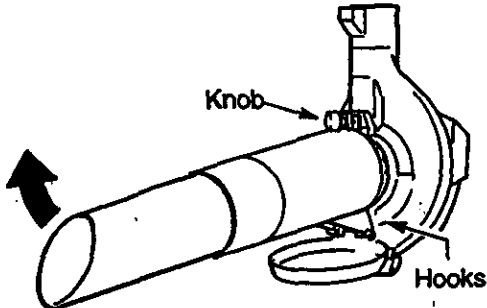
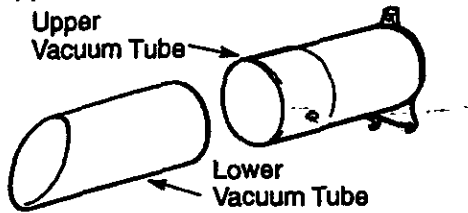

- Insert a screwdriver into the latch area on the vacuum inlet cover.

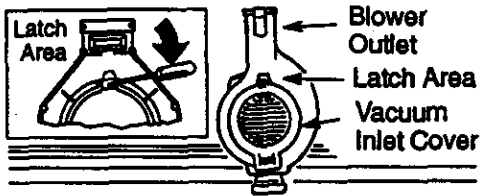

- Gently tilt the handle of the screwdriver toward the back of the unit while pulling up on the vacuum inlet cover with your other hand.
- Hold the vacuum inlet cover open until upper vacuum tube is installed.

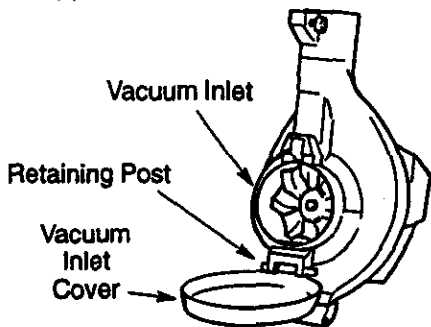

- Place the hooks on the vacuum tube on the retaining posts; pivot tube into position. Secure vacuum tube by turning the knob clockwise until tight.

- When converting back to the blower feature, make sure latch on the vacuum inlet cover is securely fastened.

SHOULDER STRAP ADJUSTMENT (for vacuum use only)

- Hold the unit as shown.
- Pass the shoulder strap over your head and onto your left shoulder.
- Snap the hook onto the retainer on the top handle.
- Extend your right arm toward the rear of the vacuum bag.
- Adjust shoulder strap until the vacuum bag/shoulder strap seam lies between your thumb and index finger.
- Make sure air flows freely from the elbow tube into bag. If bag is kinked, the unit will not operate properly.



OPERATION

MULCHING BLADES

Your blower is equipped with mulching blades as a standard feature. When using the optional vacuum attachment, the mulching blades automatically reduce debris at a ratio of up to 16:1.

KNOW YOUR BLOWER

READ THIS OPERATOR'S MANUAL AND SAFETY RULES BEFORE OPERATING YOUR UNIT. Compare the illustrations with your unit to familiarize yourself with the location of the various controls and adjustments. Save this manual for future reference.

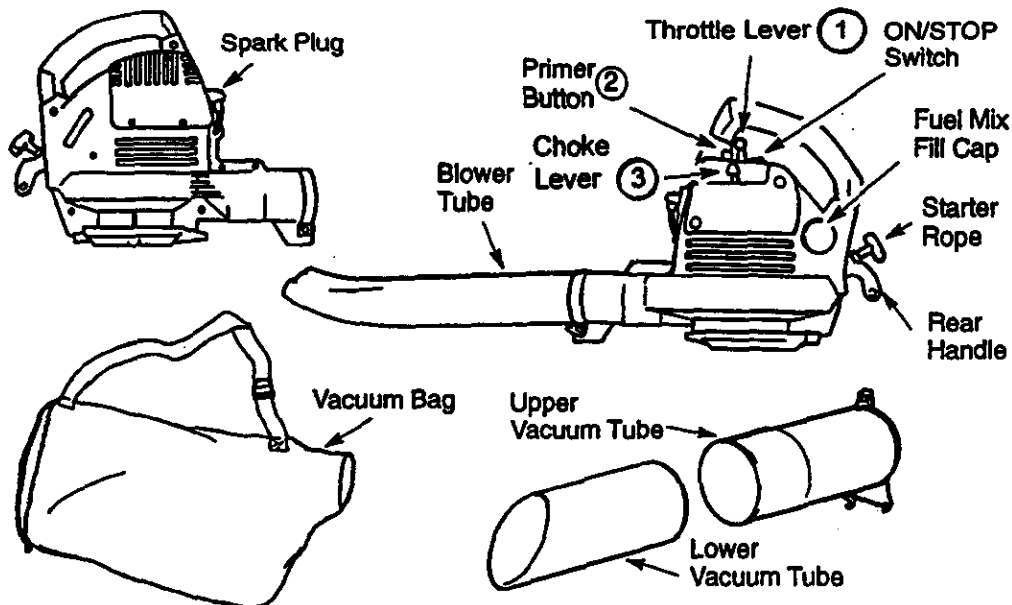

ON/STOP SWITCH

The ON/STOP switch is used to stop the engine. The switch stays in the ON position. To stop engine, push and hold the switch in the STOP position until the engine comes to a complete stop.

THROTTLE LEVER (1)

The Throttle Lever 1 controls engine speed. Move it all the way forward for full speed operation. Move it all the way rearward for idle speed.

PRIMER BUTTON (2)

The Primer Button (2) removes air from the fuel lines and fills them with fuel.

This allows you to start the engine with fewer pulls on the starter rope. Activate Primer Button (2) by pressing it and allowing it to return to its original position.

CHOKE LEVER (3)

The choke helps to supply fuel to the carburetor during starting. This allows you to start a cold engine. Activate the choke by moving the choke lever to the FULL position. After the engine has started, move the choke to the RUN position.

OPERATING TIPS

- To reduce the risk of hearing loss associated with sound level(s), hearing protection is required.
- To reduce the risk of injury associated with contacting rotating parts, stop the engine before installing or removing attachments. Do not operate without guard(s) in place.
- Operate power equipment only at reasonable hours—not early in the morning or late at night when people might be disturbed. Comply with times listed in local ordinances. Usual recommenda-

tions are 9:00 a.m. to 5:00 p.m., Monday through Saturday.

- To reduce noise levels, limit the number of pieces of equipment used at any one time.
- To reduce noise levels, operate power blowers at the lowest possible throttle speed to do the job.
- Use rakes and brooms to loosen debris before blowing.
- In dusty conditions, slightly dampen surfaces or use a mister attachment when water is available.
- Conserve water by using power blowers instead of hoses for many lawn and garden applications, including areas such as gutters, screens, patios, grills, porches, and gardens.
- Use the full blower nozzle extension so the air stream can work close to the ground.
- After using blowers and other equipment, CLEAN UP! Dispose of debris in trash receptacles.

OPERATING POSITION



Eye Protection

BEFORE STARTING ENGINE

WARNING: Be sure to read the fuel information in the safety rules before you begin. If you do not understand the safety rules, do not attempt to fuel your unit. Call 1-800-235-5878.

FUELING ENGINE

This engine is certified to operate on unleaded gasoline. Before operation, gasoline must be mixed with a good quality 2-cycle air-cooled engine oil. We recommend Craftsman brand oil. Mix gasoline and oil at a ratio of 40:1 (A 40:1 ratio is obtained by mixing 3.2 ounces of oil with 1 gallon of unleaded gasoline). DO NOT USE automotive oil or boat oil. These oils will cause engine damage. When mixing fuel, follow instructions printed on container. Once oil is added to gasoline, shake container momentarily to assure that the fuel is thoroughly mixed. Always

read and follow the safety rules relating to fuel before fueling your unit.

IMPORTANT

Experience indicates that alcohol blended fuels (called gasohol or using ethanol or methanol) can attract moisture which leads to separation and formation of acids during storage. Acidic gas can damage the fuel system of an engine while in storage.

To avoid engine problems, empty the fuel system before storage for 30 days or longer. Drain the gas tank, start the engine and let it run until the fuel lines and carburetor are empty. Use fresh fuel next season.

Never use engine or carburetor cleaner products in the fuel tank or permanent damage may occur.

Fuel stabilizer is an acceptable alternative in minimizing the formation of fuel gum deposits during storage. Craftsman brand oil is already blended with fuel stabilizer. See the STORAGE section for additional information.

STOPPING YOUR ENGINE

- To stop the engine, press and hold the stop  switch until engine stops.

STARTING YOUR ENGINE

BEFORE STARTING THE ENGINE

You MUST make sure the tubes are secure before using the unit.



- Fuel engine. Move at least 10 feet (3 meters) away from the fueling site.
- Hold the unit in the starting position as shown. Make sure the blower end is directed away from people, animals, glass, and solid objects.

WARNING: When starting engine, hold the unit as illustrated. Do not set unit on any surface except a clean, hard area when starting engine or while engine is running. Debris such as gravel, sand, dust, grass, etc. could be picked up by the air intake and thrown out through the discharge opening, damaging the unit or

property, or causing serious injury to bystanders or the operator.

STARTING A COLD ENGINE OR A WARM ENGINE AFTER RUNNING OUT OF FUEL

- Move the throttle lever ① to the fast position.
- Press the primer button ② slowly 12 times.
- Move the choke lever ③ to the Full Choke position.

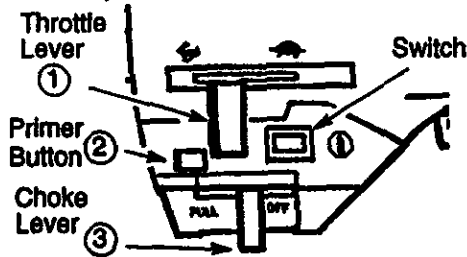

- Pull starter handle sharply until the engine attempts to run, but no more than 5 pulls (below 30°F, 8 pulls).
- NOTE:** If the engine attempts to start before the 5th pull, go to the next step immediately.
- Move choke lever ③ to Half Choke.
 - Pull the starter handle sharply until the engine runs, but no more than 5 pulls (below 30°F, 10 pulls).
 - After a 5 second warm-up, move the choke lever ③ to the Run position.
 - Allow the unit to run for 30 more seconds at Run before moving the throttle lever ① to the Idle position.

If the engine has not started after 5 pulls (at Half Choke), repeat the Starting a Cold Engine Procedure. If the engine still does not start, proceed to Starting a Flooded Engine.

- To stop the engine, press and hold the stop ○ switch until engine stops.

FOR A WARM ENGINE

- Move the throttle lever ① to the fast position.
- Pull the starter handle sharply until the engine starts, but no more than 5 pulls.

NOTE: If the engine has not started, pull starter handle sharply for 5 more pulls. If engine still does not run, it is probably flooded. Proceed to Starting a Flooded Engine.

- To stop the engine, press and hold the stop ○ switch until engine stops.

DIFFICULT STARTING OR STARTING A FLOODED ENGINE

Flooded engines can be started by placing the choke lever in the Off Choke position. Move throttle lever to fast position; then, pull rope until engine starts. After engine starts, move the throttle lever to Idle to allow engine to idle.

Starting could require pulling the starter rope many times depending on how badly the unit is flooded. If the unit still doesn't start, refer to the Troubleshooting Chart or call 1-800-235-5878.

MAINTENANCE

CUSTOMER RESPONSIBILITIES

CARE & MAINTENANCE TASK	WHEN TO PERFORM
Check for Loose fasteners and parts	Before each use
Check for damaged or worn parts	Before each use
Clean unit and labels	After each use
Clean air filter	Every 5 hours of operation
Replace spark plug	Yearly
Replace fuel filter	Yearly

GENERAL RECOMMENDATIONS

The warranty on this unit does not cover items that have been subjected to operator abuse or negligence. To receive full value from the warranty, the operator must maintain unit as instructed in this manual. Various adjustments will need to be made periodically to properly maintain your unit.

CHECK FOR LOOSE FASTENERS AND PARTS

- Spark Plug Boot
- Air Filter
- Housing Screws

CHECK FOR DAMAGED OR WORN PARTS

Refer replacement of damaged/worn parts to your Sears Service Center.

- On/Stop Switch – Ensure On/Stop switch functions properly. To stop engine, push and hold switch in the STOP position until engine comes to a complete stop. Make sure engine stops; then restart engine and continue.
- Fuel Tank – Do not use unit if fuel tank shows signs of damage or leaks.
- Optional Vacuum Bag – Do not use vacuum bag if it is torn or damaged.

CLEAN UNIT & LABELS

- Clean the unit using a damp cloth with a mild detergent.
- Wipe off unit with a clean dry cloth.

CLEAN AIR FILTER

Do not clean filter in gasoline or other flammable solvent. Doing so can create a fire hazard or produce harmful evaporative emissions.

Cleaning the air filter:

A dirty air filter decreases engine performance and increases fuel consumption and harmful emissions. Always clean after every 5 hours of operation.

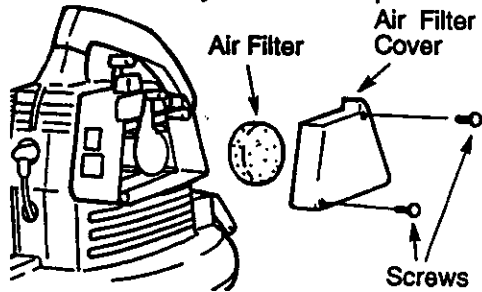

- Clean the cover and the area around it to keep debris from falling into the carburetor chamber when the cover is removed.
- Remove parts as illustrated.
- Wash the filter in soap and water.
- Allow filter to dry.
- Apply a few drops of oil to the filter; squeeze filter to distribute oil.
- Replace parts.

REPLACE SPARK PLUG

Replace spark plug each year to ensure the engine starts easier and runs better. Set spark plug gap at .025 in. Ignition timing is fixed, nonadjustable.

- Twist, then pull off spark plug boot.
- Remove spark plug from cylinder and discard.
- Replace with Champion CJ-8Y spark plug and tighten with a 3/4 in. socket wrench (10-12 ft.-lbs).
- Reinstall the spark plug boot.

REPLACE FUEL FILTER

To replace fuel filter, drain unit by running it dry of fuel, then remove fuel cap/retainer assembly from tank. Pull filter from tank and remove it from the fuel line. Install new fuel filter on fuel line; reinstall parts.

SERVICE AND ADJUSTMENTS

We recommend all service and adjustments not listed in this manual be performed by your Sears Service Center.

CARBURETOR ADJUSTMENT

Carburetor adjustment is critical and if done improperly can permanently damage the engine as well as the carburetor. If you require further assistance or are unsure about performing this procedure, call our customer assistance help line at 1-800-235-5878.

Old fuel, a dirty air filter, a dirty fuel filter, or flooding may give the impression of an improperly adjusted carburetor. Check these conditions before adjusting the carburetor.

The carburetor has been carefully set at the factory. Adjustments may be

necessary if you notice any of the following conditions:

- Engine will not idle. See "Idle Speed" and "Mixture" under adjusting procedure.
- Engine dies or hesitates instead of accelerating. See "Acceleration Check" under adjusting procedure.
- Loss of power. See "Mixture" under adjusting procedure.

CARBURETOR PRESETS

When making carburetor preset adjustments, do not force plastic limiter caps beyond the stops or damage will occur. If carburetor presets are not needed, proceed to "ADJUSTING PROCEDURE, Idle Speed."

To adjust presets:

- Turn the mixture screw counterclockwise until it stops.
- Turn the idle speed screw clockwise until it stops. Now turn counterclockwise 4-1/2 turns.

Start motor, let it run for 3 minutes, and proceed to the adjustment section. If engine does not start, refer to troubleshooting chart or call 1-800-235-5878. If engine performance is acceptable at the preset positions, no further adjustments are necessary.

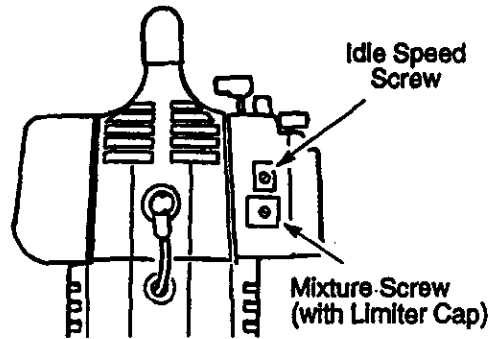

ADJUSTING PROCEDURE

Idle Speed "IDLE"

Allow engine to idle. Adjust speed until engine runs without stalling.

- Turn clockwise to increase engine speed if engine stalls or dies.
- Turn counterclockwise to decrease speed.

No further adjustments are necessary if performance is satisfactory.

Mixture "MIX"

Allow engine to idle. Then accelerate the engine and note performance. If engine hesitates, bogs down, or smokes during acceleration, turn mixture screw clockwise in 1/16-turn increments until performance is satisfactory. Repeat this procedure as necessary for proper adjustment. After completing adjustments, check for acceleration. Reset if necessary.

Acceleration Check

If engine dies or hesitates instead of accelerating, turn mixture screw counterclockwise until you have smooth acceleration. Recheck and adjust as necessary for acceptable performance.

STORAGE

Prepare unit for storage at end of season or if it will not be used for 30 days or more.

WARNING:

- Allow engine to cool, and secure the unit before storing or transporting.
- Store unit and fuel in a well ventilated area where fuel vapors cannot reach sparks or open flames from water heaters, electric motors or switches, furnaces, etc.
- Store unit with all guards in place. Position unit so that any sharp object cannot accidentally cause injury.
- Store unit and fuel well out of the reach of children.

EXTERNAL SURFACES

- If your unit is to be stored for a period of time, clean it thoroughly before storage. Store in a clean dry area.
- Lightly oil external metal surfaces.

FUEL SYSTEM

Under Fueling Engine in the Operating Section of this manual, see message labeled **IMPORTANT** regarding the use of gasohol in your engine.

Fuel stabilizer is an acceptable alternative in minimizing the formation of fuel gum deposits during storage. Add stabilizer to gasoline in fuel tank or fuel storage container. Follow the mix instructions found on stabilizer container. Run engine at least 5 minutes after adding stabilizer. CRAFTSMAN 40:1, 2-cycle engine oil (air cooled) is already blended with fuel stabilizer. If you do not use this Sears oil, you can add a fuel stabilizer to your fuel tank.

INTERNAL ENGINE

- Remove spark plug and pour 1 teaspoon of 40:1, 2-cycle engine oil (air cooled) through the spark plug opening. Slowly pull the starter rope 8 to 10 times to distribute oil.
- Replace spark plug with new one of recommended type and heat range.
- Clean air filter.
- Check entire unit for loose screws, nuts, and bolts. Replace any damaged, broken, or worn parts.

U.S. EPA/CALIFORNIA EMISSION CONTROL WARRANTY STATEMENT

YOUR WARRANTY RIGHTS AND OBLIGATIONS: The U. S. Environmental Protection Agency/California Air Resources Board and SEARS, ROEBUCK AND CO., are pleased to explain the emissions control system warranty on your lawn and garden equipment engine. All new utility and lawn and garden equipment engines must be designed, built, and equipped to meet the stringent anti-smog standards. SEARS, ROEBUCK AND CO. must warrant the emission control system on your lawn and garden equipment engine for the periods of time listed below provided there has been no abuse, neglect, or improper maintenance of your lawn and garden equipment engine. Your emission control system includes parts such as the carburetor and the ignition system. Where a warrantable condition exists, SEARS, ROEBUCK AND CO. will repair your lawn and garden equipment engine at no cost to you. Expenses covered under warranty include diagnosis, parts and labor.

MANUFACTURER'S WARRANTY COVERAGE: If any emissions related part on your engine (as listed under Emissions Control Warranty Parts List) is defective or a defect in the materials or workmanship of the engine causes the failure of such an emission related part, the part will be repaired or replaced by SEARS, ROEBUCK AND CO.

OWNER'S WARRANTY RESPONSIBILITIES: As the lawn and garden equipment engine owner, you are responsible for the performance of the required maintenance listed in your Owner's Manual. SEARS, ROEBUCK AND CO. recommends that you retain all receipts covering maintenance on your lawn and garden equipment engine, but SEARS, ROEBUCK AND CO. cannot deny warranty solely for the lack of receipts or for your failure to ensure the performance of all scheduled maintenance. As the lawn and garden equipment engine owner, you should be aware that SEARS, ROEBUCK AND CO. may deny you warranty coverage if your lawn and garden equipment engine or a part of it has failed due to abuse, neglect, improper maintenance, unapproved modifications, or the use of parts not made or approved by the original equipment manufacturer. You are responsible for presenting your lawn and garden equipment engine to a SEARS Service Center as soon as a problem exists. Warranty repairs should be completed in a reasonable amount of time, not to exceed 30 days. If you have any questions regarding your warranty rights and responsibilities, you should contact your nearest authorized service center or call SEARS, ROEBUCK AND CO. at 1-800-235-5878.

WARRANTY COMMENCEMENT DATE: The warranty period begins on the date the lawn and garden equipment engine is purchased.

LENGTH OF COVERAGE: This warranty shall be for a period of two years from the initial date of purchase.

WHAT IS COVERED: REPAIR OR REPLACEMENT OF PARTS. Repair or replacement of any warranted part will be performed at no charge to the owner at an approved SEARS Service Center. If you have any questions regarding your warranty rights and responsibilities, you should contact your nearest authorized service center or call SEARS, ROEBUCK AND CO. at 1-800-235-5878

WARRANTY PERIOD: Any warranted part which is not scheduled for replacement as required maintenance, or which is scheduled only for regular inspection to the effect of "repair or replace as necessary" shall be warranted for 2 years. Any warranted part which is scheduled for replacement as required maintenance shall be warranted for the period of time up to the first scheduled replacement point for that part.

DIAGNOSIS: The owner shall not be charged for diagnostic labor which leads to the determination that a warranted part is defective if the diagnostic work is performed at an approved SEARS Service Center.

CONSEQUENTIAL DAMAGES: SEARS, ROEBUCK AND CO. may be liable for damages to other engine components caused by the failure of a warranted part still under warranty.

WHAT IS NOT COVERED: All failures caused by abuse, neglect, or improper maintenance are not covered.

ADD-ON OR MODIFIED PARTS: The use of add-on or modified parts can be grounds for disallowing a warranty claim. SEARS, ROEBUCK AND CO. is not liable to cover failures of warranted parts caused by the use of add-on or modified parts.

HOW TO FILE A CLAIM: If you have any questions regarding your warranty rights and responsibilities, you should contact your nearest authorized service center or call SEARS, ROEBUCK AND CO. at 1-800-235-5878.

WHERE TO GET WARRANTY SERVICE: Warranty services or repairs shall be provided at all SEARS Service Centers. Call: 1-800-235-5878

MAINTENANCE, REPLACEMENT AND REPAIR OF EMISSION RELATED PARTS: Any SEARS, ROEBUCK AND CO. approved replacement part used in the performance of any warranty maintenance or repair on emission related parts will be provided without charge to the owner if the part is under warranty.

EMISSION CONTROL WARRANTY PARTS LIST: Carburetor, Ignition System: Spark Plug (covered up to maintenance schedule), Ignition Module.

MAINTENANCE STATEMENT: The owner is responsible for the performance of all required maintenance as defined in the owner's manual.

- At the beginning of the next season, use only fresh fuel having the proper gasoline to oil ratio.

- Do not store gasoline from one season to another.
- Replace your gasoline can if it starts to rust.

OTHER

TROUBLESHOOTING CHART

TROUBLE	CAUSE	REMEDY
Engine will not start.	<ul style="list-style-type: none"> • Engine flooded. • Fuel tank empty. • Spark plug not firing. • Fuel not reaching carburetor. 	<ul style="list-style-type: none"> • See "Starting Instructions." • Fill tank with correct fuel mixture. • Install new spark plug. • Check for dirty fuel filter; replace. Check for kinked or split fuel line; repair or replace. • Contact Sears Service.
Engine will not idle properly.	<ul style="list-style-type: none"> • Carburetor requires adjustment. • Crankshaft seals worn. • Compression low. 	<ul style="list-style-type: none"> • See "Carburetor Adjustments." • Contact Sears Service. • Contact Sears Service.
Engine will not accelerate, lacks power, or dies under a load.	<ul style="list-style-type: none"> • Air filter dirty. • Spark plug fouled. • Carburetor requires adjustment. • Carbon build up. • Compression low. 	<ul style="list-style-type: none"> • Clean or replace air filter. • Clean or replace spark plug; re-gap. • See "Carburetor Adjustments." • Contact Sears Service. • Contact Sears Service.
Engine smokes excessively.	<ul style="list-style-type: none"> • Choke partially on. • Fuel mixture incorrect. 	<ul style="list-style-type: none"> • Adjust choke. • Empty fuel tank and refill with correct fuel mixture.
	<ul style="list-style-type: none"> • Air filter dirty. • Carburetor requires adjustment. 	<ul style="list-style-type: none"> • Clean or replace air filter. • See "Carburetor Adjustments."
Engine runs hot.	<ul style="list-style-type: none"> • Fuel mixture incorrect. • Spark plug incorrect. • Carburetor requires adjustment. • Carbon build up. 	<ul style="list-style-type: none"> • See "Fueling Your Unit." • Replace with correct spark plug. • See "Carburetor Adjustments." • Contact Sears Service.

If situations occur which are not covered in this manual, use care and good judgement. If you need assistance, contact your Sears Service Center/Department or call the Customer Assistance Helpline at 1-800-235-5878.

REPAIR PARTS

WARNING

All repairs, adjustments and maintenance not described in the Operator's Manual must be performed by qualified service personnel.

SEARS MODEL 358.797290

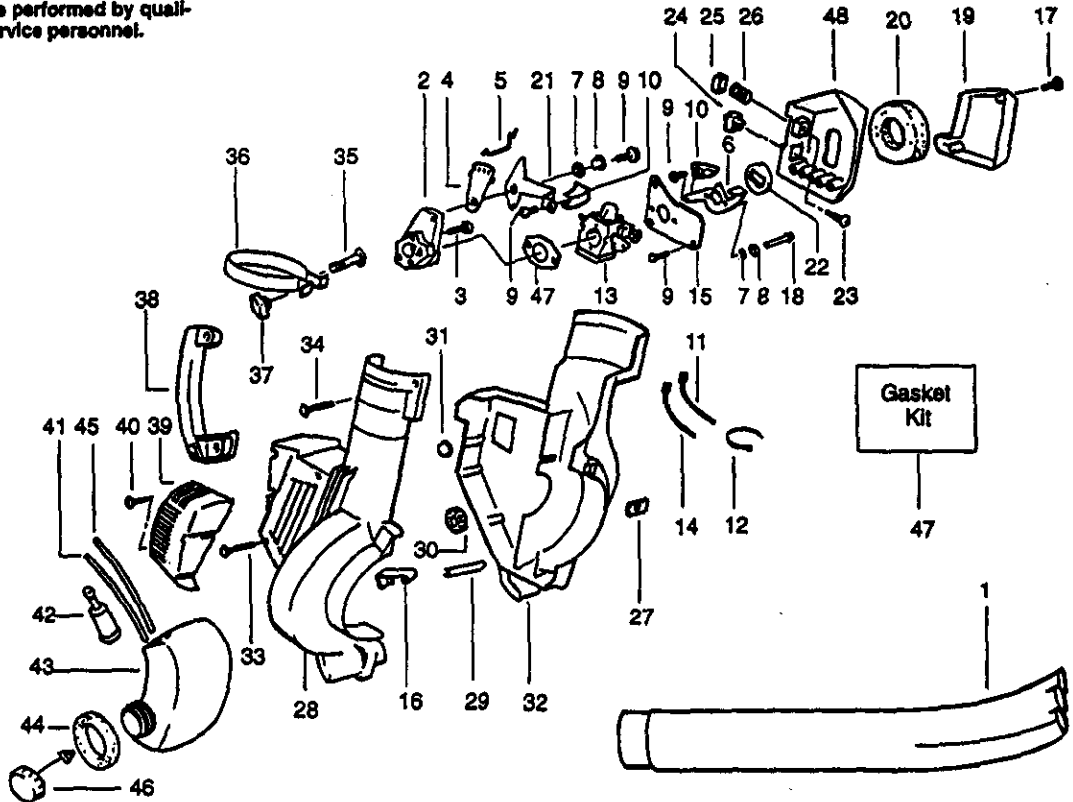

Ref.	Part No.	Description	Ref.	Part No.	Description
1.	530095593	Blower Tube	28.	530049312	Housing-Right
2.	530049322	Carburetor Adaptor	29.	530049617	Guide Starter Rope
3.	530016209	Bolt	30.	530049323	Isolator-Handle
4.	530049526	Throttle Plate	31.	530036792	Isolator-Crankcase
5.	530049324	Throttle Linkage	32.	530049311	Housing-Left
6.	530049834	Choke Lever	33.	530015888	Screw
7.	530015254	Washer	34.	530015880	Screw
8.	530015852	Choke Spacer	35.	530015820	Bolt
9.	530015775	Screw	36.	530095592	Clamp-Blower Tube
10.	530069983	Knob Replacement Kit	37.	530049885	Knob-Tube Clamp
11.	530049495	Leadwire-Switch	38.	530095489	Handle
12.	530049494	Wire Clamp	39.	530049879	Muffler Cover Ass'y.
13.	530069924	Carb Ass'y. Kit (WA-229)	40.	530015880	Screw
14.	530049496	Leadwire-Ground	41.	530069247	Line Kit-Carb/Purge
15.	530052293	Choke Plate	42.	530014382	Fuel Pick-up Ass'y.
16.	530402044	Spring Cover Latch	43.	530049491	Fuel Tank Ass'y.
17.	530015957	Screw	44.	530049527	Gasket-Fuel Tank
18.	530015849	Screw	45.	530069216	Line Kit-Tank/Purge
19.	530049315	Air Filter Cover	46.	530049388	Fuel Cap w/Retainer
20.	530049383	Air Filter	47.	530069813	Gasket Kit
21.	530049325	Throttle Lever	48.	530049318	Box-Air Filter
22.	530019248	Seal-Choke Plate			
23.	530016211	Retainer-Purge Button		Not Shown	
24.	530038114	Switch Momentary			
25.	530049537	Purge Button		530087632	Operator Manual
26.	530016212	Spring-Purge Button		530084403	Engine Stop Decal
27.	530016207	Nut		530053858	Right Decal

REPAIR PARTS

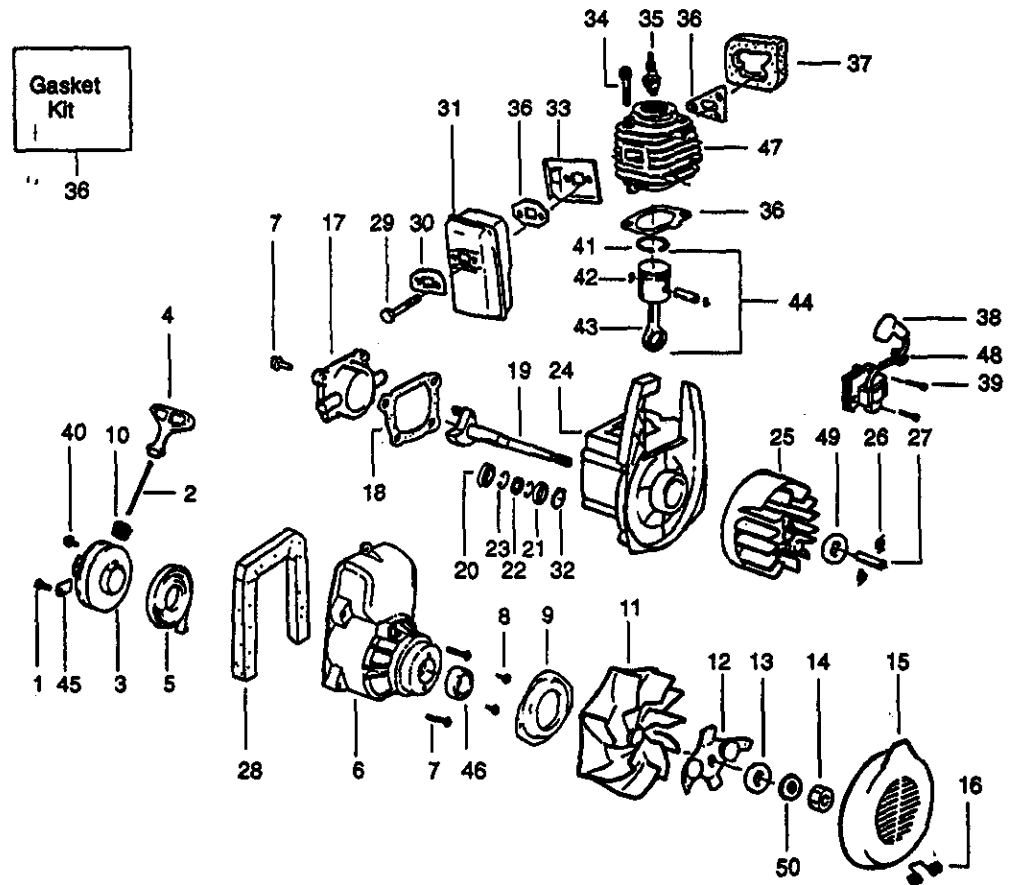

Ref.	Part No.	Description	Ref.	Part No.	Description
1.	530015880	Screw	28.	530049713	Seal-Fan Hsg.-Foam
2.	530069232	Rope Kit	29.	530018203	Muffler Bolt
3.	530069885	Starter Pulley Kit	30.	530049454	Muffler Cover Plate
4.	530049488	Starter Handle	31.	530069914	Muffler Kit
5.	530042088	Starter Spring	32.	530015941	Retainer Ring-C'chaft
6.	530049501	Fan Housing w/bearing	33.	530049502	Muffler Shield
7.	530015810	Screw	34.	530015953	Screw
8.	530015815	Screw	35.	Champion	Spark Plug (CJ-8Y)
9.	530019240	O-Ring	36.	530069813	Gasket Kit
10.	530029182	Eyelet-Flange	37.	530019247	Air Dam
11.	530069817	Impeller Ass'y.	38.	530052266	Ignition Module
12.	530095461	Mulch Blade Ass'y.	39.	530018208	Bolt
13.	530015828	Washer-Flat	40.	530018080	Screw-Starter Pulley
14.	530826605	Nut	41.	530049903	Piston Ring (2)
15.	530049313	Inlet Door	42.	530015182	Retainer
16.	530402043	Spring-Return Cover	43.	530069945	Connecting Rod Ass'y.
17.	530049297	Crankcase Cover	44.	530069812	Piston Kit (Incl. 41 & 42)
18.	530019181	Gasket-Crankcase/Shroud	45.	530018228	Retainer Can
19.	530049429	Crankshaft Ass'y.	46.	530032108	Bearing
20.	530032125	Inner Bearing	47.	530069865	Cylinder Kit
21.	530032124	Outer Bearing	48.	530019182	Grommet-Ign. Module
22.	530019179	Crankcase Seal	49.	530015149	Washer
23.	530015945	Retaining Ring	50.	530092322	Lockwasher
24.	530069818	Crankcase Ass'y. (Incl. 20-23)			
25.	530039209	Flywheel Ass'y. (Incl. 28)			
26.	530023817	Spring-Starter Dog			
27.	530016190	Flywheel Spacer			
				Not Shown	
				530053859	Instruction Decal
				530084404	Warning Decal

REPAIR PARTS

Carburetor Assembly Part Number 530069924 - (WA229)



Key No.	Part No.	Description
1	530038403	Limiter Cap
2	530069811	Carb. Repair Kit
3	530069844	Gasket/Dia. Kit

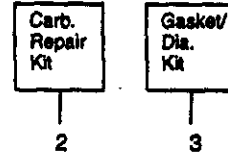

Vacuum Tube Ass'y.

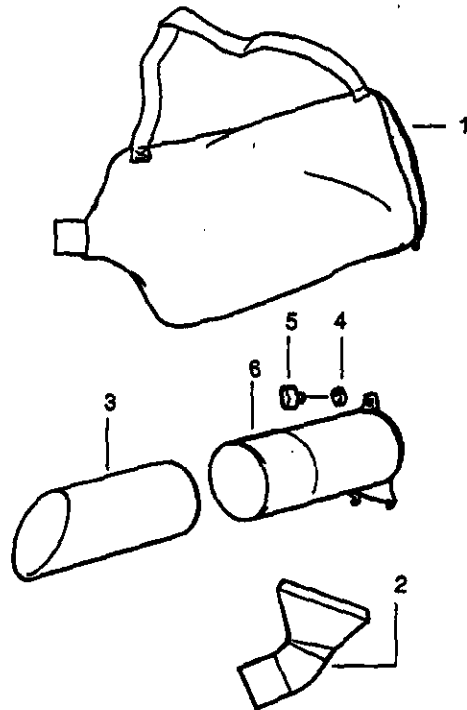

KEY NO.	PART NO.	DESCRIPTION
1	530095564	Vac Bag w/Strap
2	530095470	Elbow-Vac Tube
3	530095589	Lower Tube
4	530049688	Clip-Vac Tube
5	530049485	Knob-Vac Tube
6	530095468	Upper Tube

Gutter Attachment Kit #952-706612

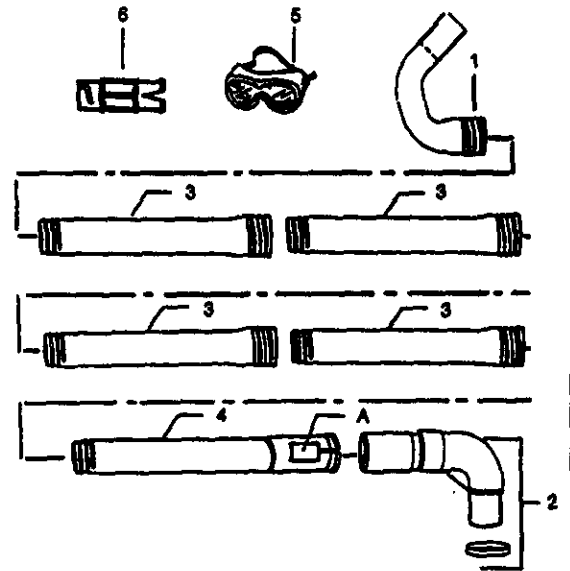

KEY NO.	PART NO.	DESCRIPTION
1	530094426	Nozzle
2	530402918	Elbow&Spacer Ring
3	530094425	Extension Tube
4	530094424	Pivot Tube
5	952701645	Goggles
6	530094850	Adapter
A	530402930	Warning Decal

For the repair or replacement parts you need delivered directly to your home

Call 7 am – 7 pm, 7 days a week

1-800-366-PART

(1-800-366-7278)

Para ordenar piezas con entrega a domicilio – 1-800-659-7084

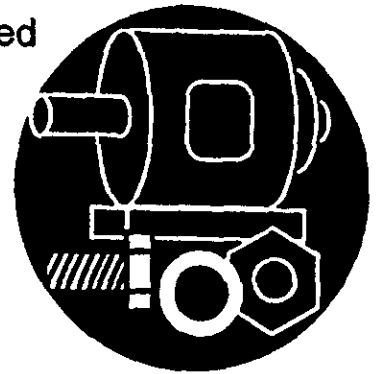

For in-home major brand repair service

Call 24 hours a day, 7 days a week

1-800-4-REPAIR

(1-800-473-7247)

Para pedir servicio de reparación a domicilio – 1-800-676-5811



For the location of a Sears Parts and Repair Center in your area

Call 24 hours a day, 7 days a week

1-800-488-1222



For information on purchasing a Sears Maintenance Agreement or to inquire about an existing Agreement

Call 9 am – 5 pm, Monday–Saturday

1-800-827-6655



When requesting service or ordering parts, always provide the following information:

- Product Type
- Part Number
- Model Number
- Part Description

SEARS
REPAIR SERVICES
America's Repair Specialists