

# Operating Guide

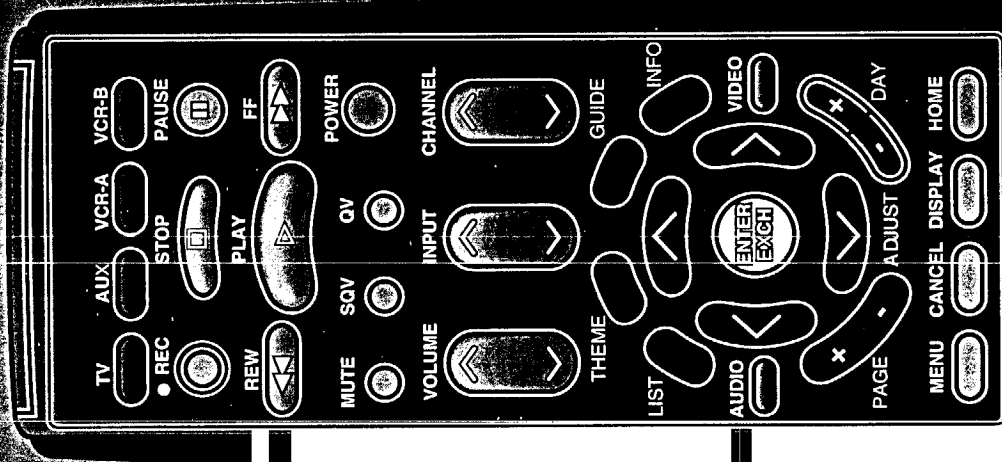

# 2



5087/TS-5089  
6085/VS-7085  
6087/VS-7087/VS-8087

 MITSUBISHI

Operating Guide

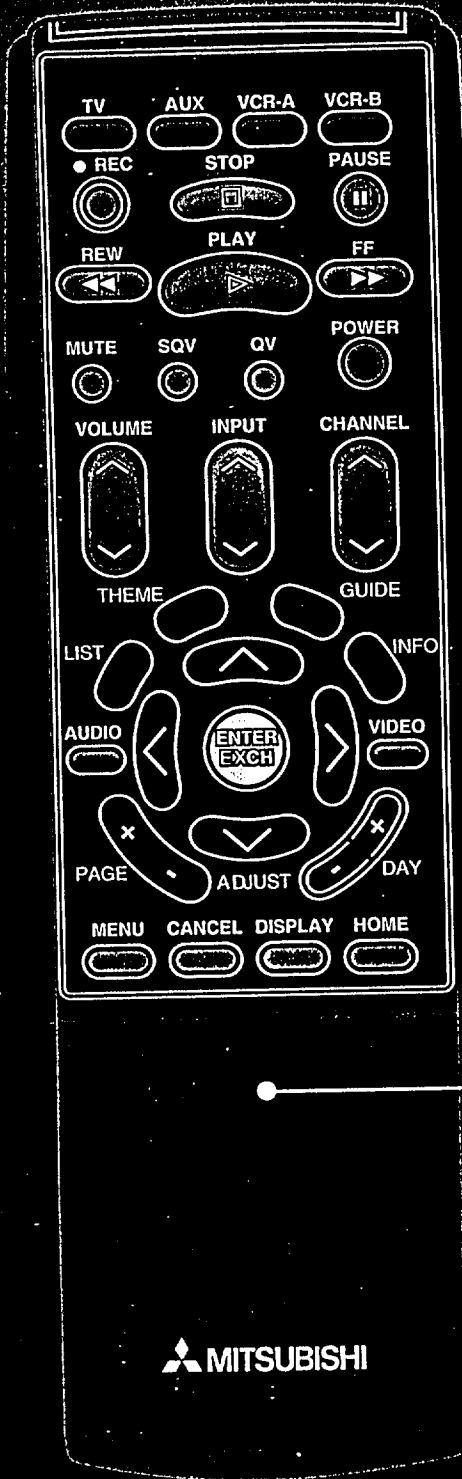

2

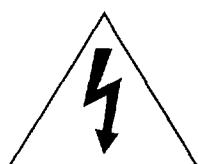
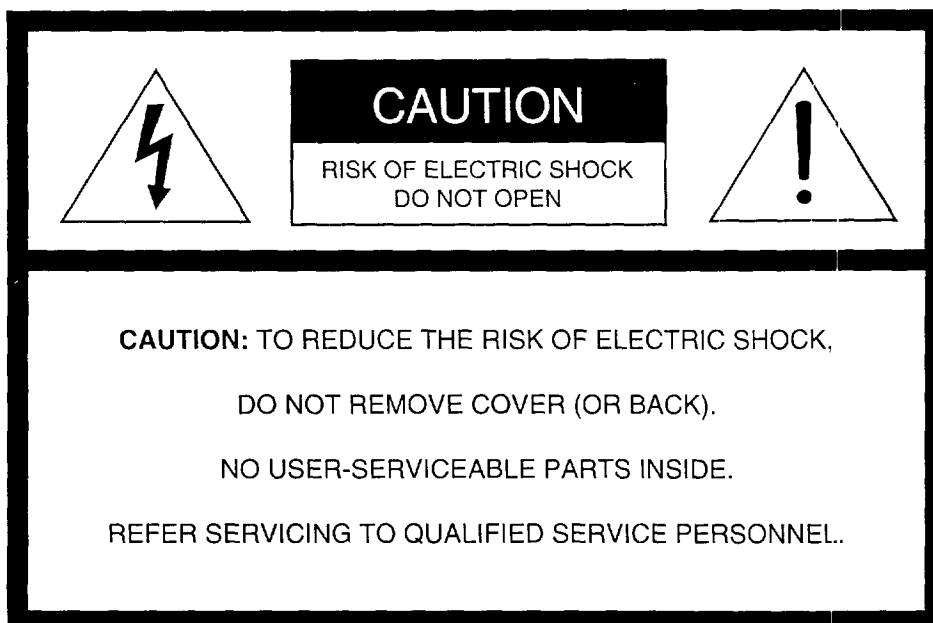

The lightning flash with arrowhead symbol, within an equilateral triangle, is intended to alert the user to the presence of uninsulated “dangerous voltage” within the product’s enclosure that may be of sufficient magnitude to constitute a risk of electric shock.



The exclamation point within an equilateral triangle is intended to alert the user to the presence of important operating and maintenance (servicing) instructions in the literature accompanying the appliance.

► **Warning:** Don’t leave stationary images, such as stock market reports, video games, station logos, or the Projection TV’s displays, on-screen for more than 10 minutes. Still patterns such as these can scar the Projection TV, causing permanent damage to the picture tubes.

**WARNING:**

TO PREVENT FIRE OR SHOCK HAZARD, DO NOT EXPOSE THIS APPLIANCE TO RAIN OR MOISTURE.

**CAUTION:**

TO PREVENT ELECTRIC SHOCK HAZARD, DO NOT USE THIS UNIT’S (POLARIZED) PLUG WITH AN EXTENSION CORD, RECEPTACLE OR OTHER OUTLET UNLESS THE BLADES CAN BE FULLY INSERTED TO PREVENT BLADE EXPOSURE.

**NOTE TO CATV SYSTEM INSTALLER:**

THIS REMINDER IS PROVIDED TO CALL THE CATV SYSTEM INSTALLER’S ATTENTION TO ARTICLE 820-40 OF THE NEC THAT PROVIDES GUIDELINES FOR PROPER GROUNDING AND, IN PARTICULAR, SPECIFIES THAT THE CABLE GROUND SHALL BE CONNECTED TO THE GROUNDING SYSTEM OF THE BUILDING, AS CLOSE TO THE POINT OF CABLE ENTRY AS PRACTICAL.



# Table of Contents

<b>Chapter 1: Getting to Know Your Projection TV .....</b>	<b>1</b>
Overview of the Control Panel .....	2
Overview of the Remote Control .....	5
Getting ready to use the remote control .....	5
Remote control buttons and functions .....	7
<b>Chapter 2: Operating Your Projection TV .....</b>	<b>13</b>
Getting Started .....	14
Using the remote control to operate VCRs, cable boxes and other equipment .....	15
Turning the Projection TV on/off .....	20
Selecting the input source .....	21
Changing channels .....	22
Understanding the ViewPoint III on-screen menus .....	25
Memorizing channels .....	26
Setting the clock .....	28
Adding and deleting channels .....	31
Setting the A/V Network .....	32
Adjusting the color alignment .....	34
Selecting the menu type .....	36
Renaming the inputs .....	38
Naming the channels .....	39
Locking A/V functions .....	40
Adjusting the sound .....	41
Adjusting the picture .....	44
Using the closed caption decoder .....	46
Using the Advanced Features .....	48
Setting the timer .....	49
Using the parental lock .....	50
Using Super Quick View if you haven't subscribed to StarSight ..	54
Using Super Quick View if you've subscribed to StarSight .....	56
Selecting an advanced PIP function .....	58
Resetting the sound and the picture .....	59

---

## Table of Contents (cont.)

<b>Chapter 3: Using the Special Features .....</b>	<b>61</b>
Understanding the On-Screen Displays .....	62
Using the Off-Timer .....	63
Setting the off-timer .....	64
Changing or canceling the off-timer .....	65
Using the Advanced Picture-in-Picture (PIP) Modes .....	66
Activating the PIP image .....	67
Changing the picture in the PIP image .....	68
Exchanging the picture and sound of the PIP image and the main image .....	70
Moving the PIP image .....	71
Freezing the PIP image .....	72
Using the Snap-shot feature .....	73
Using the Replay feature .....	74
Using the Active A/V Network Feature .....	75
<b>Chapter 4: Troubleshooting .....</b>	<b>77</b>
Cleaning .....	81
Caution and Care .....	82
Calling for Service .....	83
<b>Appendix: Procedure for Bypassing the Parental Lock .....</b>	<b>85</b>
<b>Index .....</b>	<b>87</b>
<b>Warranty .....</b>	<b>Inside Back Cover</b>



Now that you have connected your Projection TV and subscribed to the StarSight service\*, it's time to understand the exciting features your Mitsubishi Projection TV offers.

▷ **Important:** If you have not connected your Projection TV and subscribed to StarSight, please see **Booklet #1, "Mitsubishi Installation and Setup Guide"** before reading this owner's guide.

This chapter will introduce you to the range of options available when using the buttons on the remote control or on the control panel of the Projection TV. You'll find information in these two sections:

◆ **Overview of the Control Panel**

◆ **Overview of the Remote Control**

\*"StarSight" is a subscription service offered by StarSight Telecast, Inc., not a service of Mitsubishi Consumer Electronics America, Inc. You must obtain and maintain a subscription from StarSight Telecast to use the StarSight features of your Projection TV. You must be able to receive a local PBS station in order to receive the StarSight transmission, and your StarSight features will not work if StarSight Telecast is not transmitting a signal.

## ◆ Overview of the Control Panel

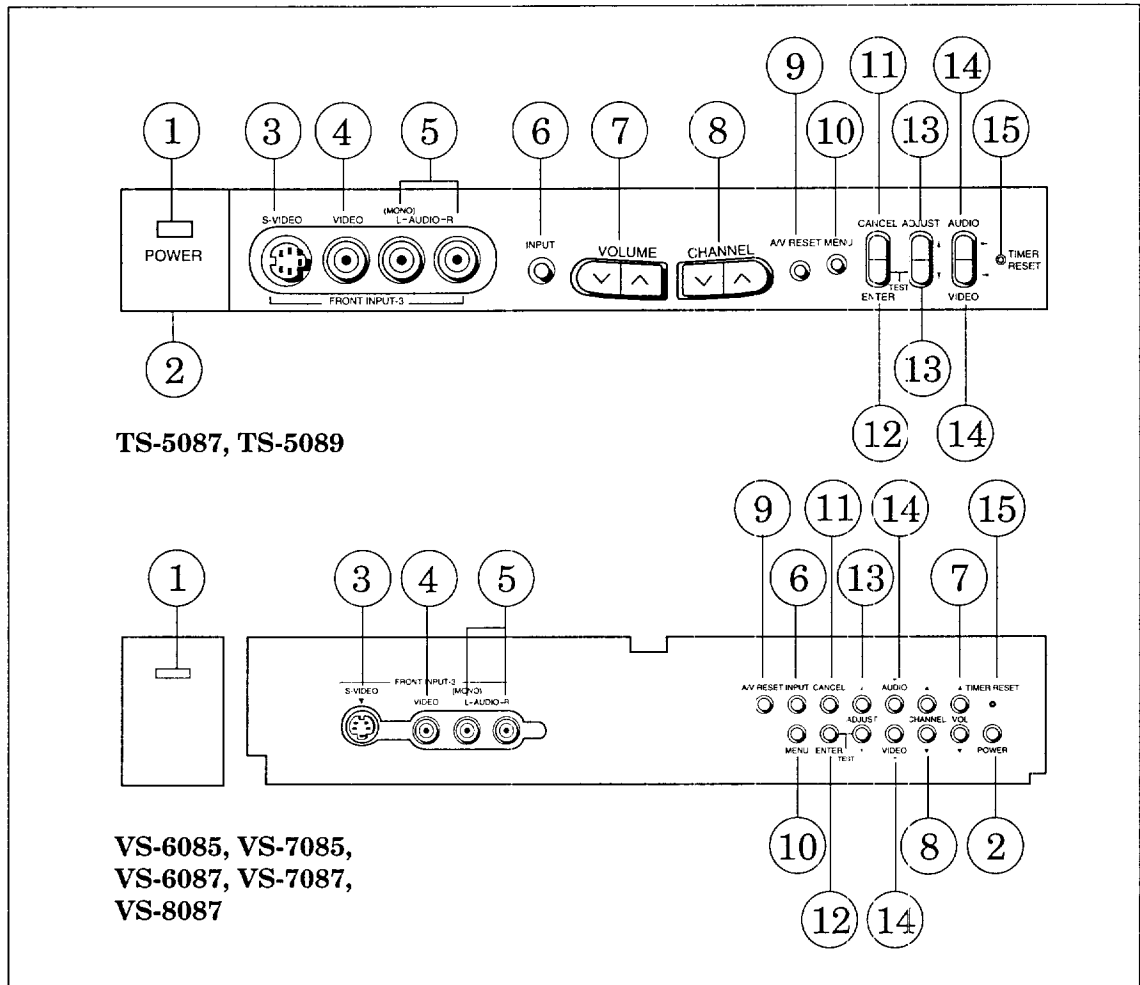

- ① **power/program timer indicator**  
This indicator lights up in green when you turn the Projection TV on; it lights up in red when the timer is set and the Projection TV's power is off; it lights in orange if the timer is set and the Projection TV's power is on.
- ② **power button (POWER)**  
Use to turn the Projection TV on or off.
- ③ **S-VIDEO input terminal**  
Use to connect the S-video output of a VCR, laserdisc player, or camcorder to the Projection TV. If you connect an S-video cable to this terminal, the video input next to it cannot be used.

- 
- ④ **video input terminal**  
Use to connect the video output from a standard VCR or another component to the Projection TV.
- ⑤ **audio input terminals**  
Use to connect the audio output from a VCR or other equipment.
- ⑥ **input button (INPUT)**  
Use to select the input source you wish to watch:
- Antenna A,
  - Antenna B, or
  - Input 1, 2, or 3.
- ⑦ **volume controls (VOLUME)**  
Press the ▲ button to turn up the volume and the ▼ button to turn down the volume.
- ⑧ **channel controls (CHANNEL)**  
Use the ▲ button to switch to a channel with a higher number and the ▼ button to switch to a channel with a lower number.
- ⑨ **A/V reset button (A/V RESET)**  
Press to reset all audio and video functions to their normal level or setting except for volume, the “Listen to:” function (Stereo/SAP/Mono), speaker (Internal/Internal Center Channel/External), monitor out (variable/fixed), and closed captioning.
- ⑩ **menu button (MENU)**  
Use this button to display the on-screen menu system, which contains additional instructions for special functions.
- ⑪ **cancel button (CANCEL)**  
This button is used to cancel a channel number, to clear a channel programmed into super quick view memory, and to clear the settings of some on-screen menus.
- ⑫ **enter button (ENTER)**  
Use this button after selecting a channel number or after selecting an item from the on-screen menu system. It is also used with the PIP button.



---

## Overview of the Control Panel (cont.)

### ⑬ **adjust buttons (ADJUST ▲ ▼)**

After selecting an audio or video function, use these buttons to adjust it. These buttons can be used to:

- increase or decrease the function (e.g., color),
- shift from one end of a scale to the other (e.g., balance), or
- change a setting (e.g., stereo).

Also use these buttons to select items from the on-screen menu.

▷ **Important:** These buttons cannot be used to adjust audio/video settings when you subscribe to StarSight. If you subscribe to StarSight, use the left/right buttons on the remote to adjust audio/video settings.

### ⑭ **audio and video controls (AUDIO, VIDEO)**

Use these buttons to select audio and video functions that you want to adjust. To select an audio or video function, repeatedly press the AUDIO button or VIDEO button. After you have selected a function, use the ADJUST buttons to adjust it.

- **audio function button (AUDIO ►) ---** Use to select one of the following audio functions:
  - stereo/SAP/mono,
  - bass,
  - treble,
  - balance,
  - surround off/simulate/hall,
  - speaker internal/internal center channel/external, or
  - monitor out variable/fixed.
- **video function button (VIDEO ◀) ---** Use to select one of the following video functions:
  - tint,
  - color,
  - contrast,
  - brightness,
  - sharpness,
  - color temperature high/middle/low, or
  - closed captioning.

### ⑮ **timer reset button (TIMER RESET)**

Use this button to reset the clock time and to erase any timer settings. The Projection TV will turn off when you press this button.

#### **test buttons**

The ENTER, ADJUST, AUDIO, and VIDEO buttons can be used to test and adjust the alignment of your Projection TV's picture tubes. See page 34 for more information.

## ◆ Overview of the Remote Control

---

### Getting ready to use the remote control

#### installing the batteries

- 1 Take the box containing four AA size batteries from the packing bag.
- 2 Remove the back cover of the remote control by pushing the tab in the direction of the arrow and lifting off the cover.
- 3 Load the batteries as indicated in the illustration, making sure that they are positioned correctly (+ to +, and - to -).
- 4 Replace the back cover of the remote control.

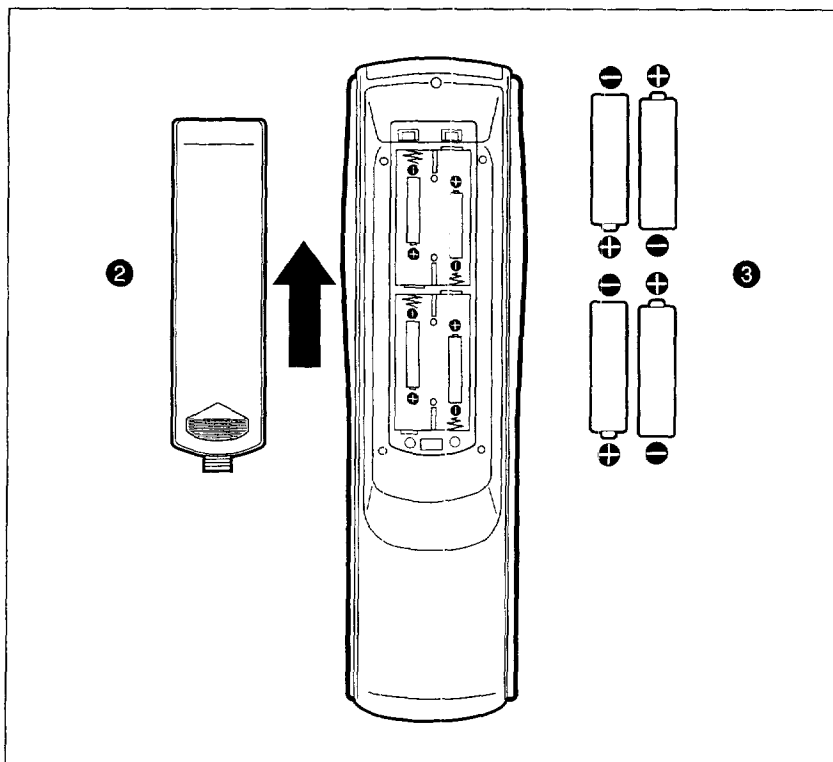

For best results, use Duracell AA (MN1500) batteries.

---

## Getting ready to use the remote control (cont.)

### some do's and don'ts

To ensure that your remote control will continue working properly, follow these guidelines:

- Don't press two or more buttons at the same time, unless you are specifically instructed to do so in this owner's guide.
- Don't allow the remote control to get wet or become heated.
- Avoid dropping the remote control on a hard surface.
- When cleaning the remote control, don't use any harsh chemicals. Use only a soft, slightly moistened cloth.

### general instructions

When using the remote control to operate the Projection TV, VCR, or cable box, follow these procedures:

- ① Be within 20 feet of the desired equipment.
- ② Point the tip of the remote control toward the equipment.
- ③ Press the appropriate button or sequence of buttons.

### guidelines for using batteries

- Don't use a new battery with an old one.
- Don't heat, take apart, or throw batteries into a fire.

---

## Remote control buttons and functions

This section provides you with an overview of the remote control's buttons and the features that they control.

This section does not provide detailed explanations on the use of these buttons. To determine which buttons are used with a particular feature, refer to the instructions for that feature.

The instructions for individual features are found in Chapter 2, "Operating Your Projection TV," and Chapter 3, "Using the Special Features."

## Remote control buttons and functions (cont.)

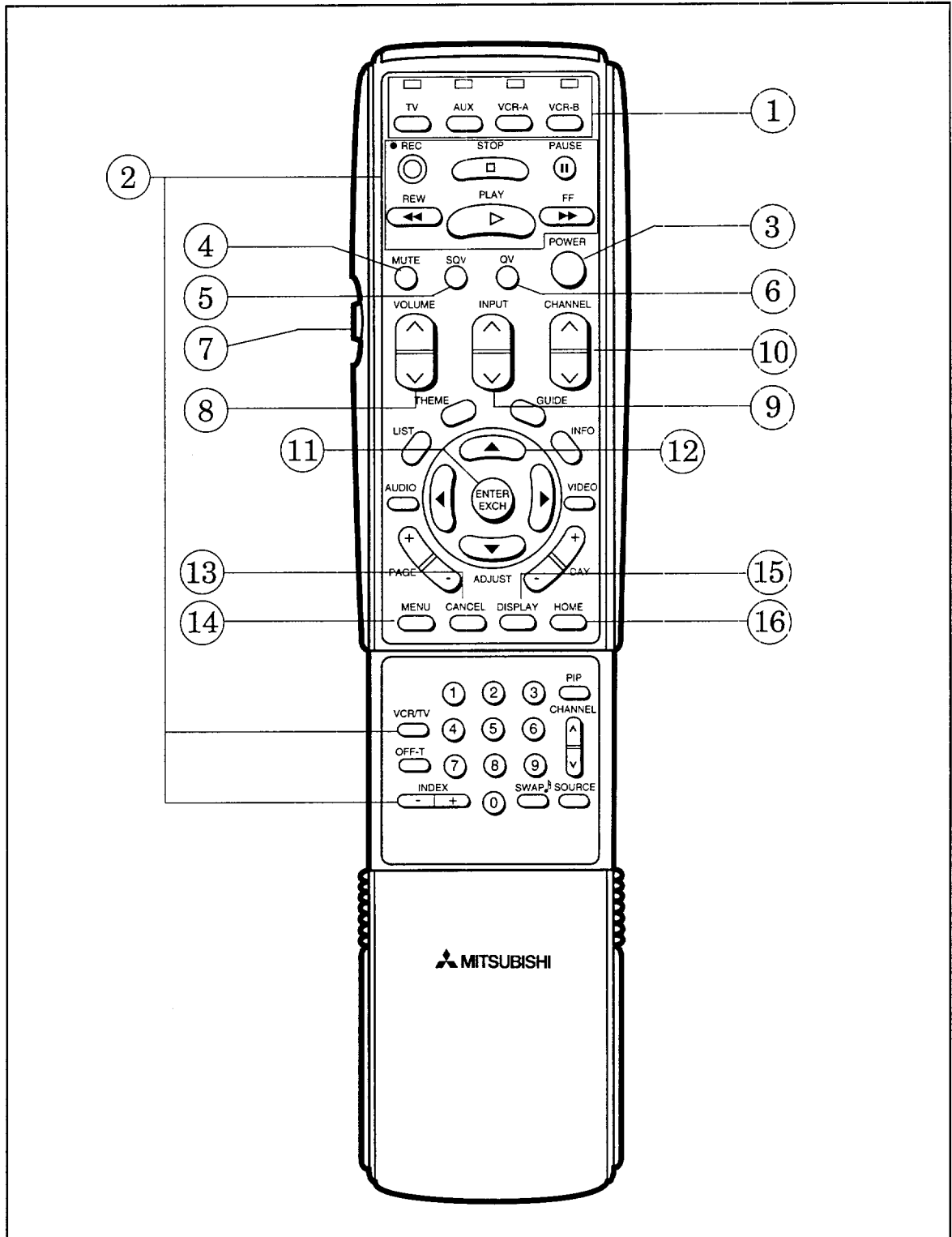

---

① **select buttons**

Your remote control has four layers: the TV layer, the VCR-A layer, the VCR-B layer, and the AUX layer. You can set up each of these layers to operate a different piece of equipment. Use the four buttons across the top of the remote to select the layer you want to set up or use. When you press a button on the remote, the lights above the select buttons will indicate the layer you are using.

② **VCR buttons**

Use these buttons to control most Mitsubishi VCRs, or set up the remote to use them to control other brands of VCRs. The PLAY button is also used with the Active A/V Network Feature (page 75).

③ **power button (POWER)**

Use to turn the Projection TV on or off. When you turn the Projection TV on, the power indicator will light in green.

④ **mute control (MUTE)**

Use to turn the sound off completely or to restore it to its original volume.

⑤ **super quick view button (SQV)**

Press to view channels you have programmed into super quick view memory.

⑥ **quick view button (QV)**

Press this button to instantly switch to the channel that you designated as the “quick view” channel. If you are watching the quick view channel, you will switch to the last channel viewed.

⑦ **light button**

Use to light up the remote (for 3 seconds).

⑧ **volume control (VOLUME)**

Press the top part of the button to turn up the volume; press the bottom part of the button to turn down the volume.

⑨ **input button (INPUT)**

Use to select the input source you wish to watch:

- Antenna A,
- Antenna B, or
- Input 1, 2, or 3.

⑩ **channel control (CHANNEL)**

Press the top part of the button to change to a channel with a higher number; press the bottom part to change to a channel with a lower number.

⑪ **enter button (ENTER / EXCH)**

Use this button after selecting a channel number, after selecting an item from the on-screen menu system, or with the picture-in-picture mode.

⑫ **adjust buttons (▲, ▼, ◀, ▶)**

After selecting an audio or video function, use these buttons to adjust it. Also use these with the picture-in-picture mode, and to select items in the menus.

⑬ **cancel button (CANCEL)**

This button is used to cancel a channel number, to clear a channel programmed into super quick view memory, and to clear the settings of some on-screen menus.

⑭ **menu button (MENU)**

Use this button to display the on-screen menu system, which contains additional instructions for special functions.

⑮ **display button (DISPLAY)**

Use to view an on-screen summary of the current settings for the Projection TV or cable functions and the display related to Extended Data Services (XDS).

⑯ **home button (HOME)**

Press to return to regular TV viewing from the on-screen menus and to turn off the on-screen displays.

**Remote control buttons and functions (cont.)**

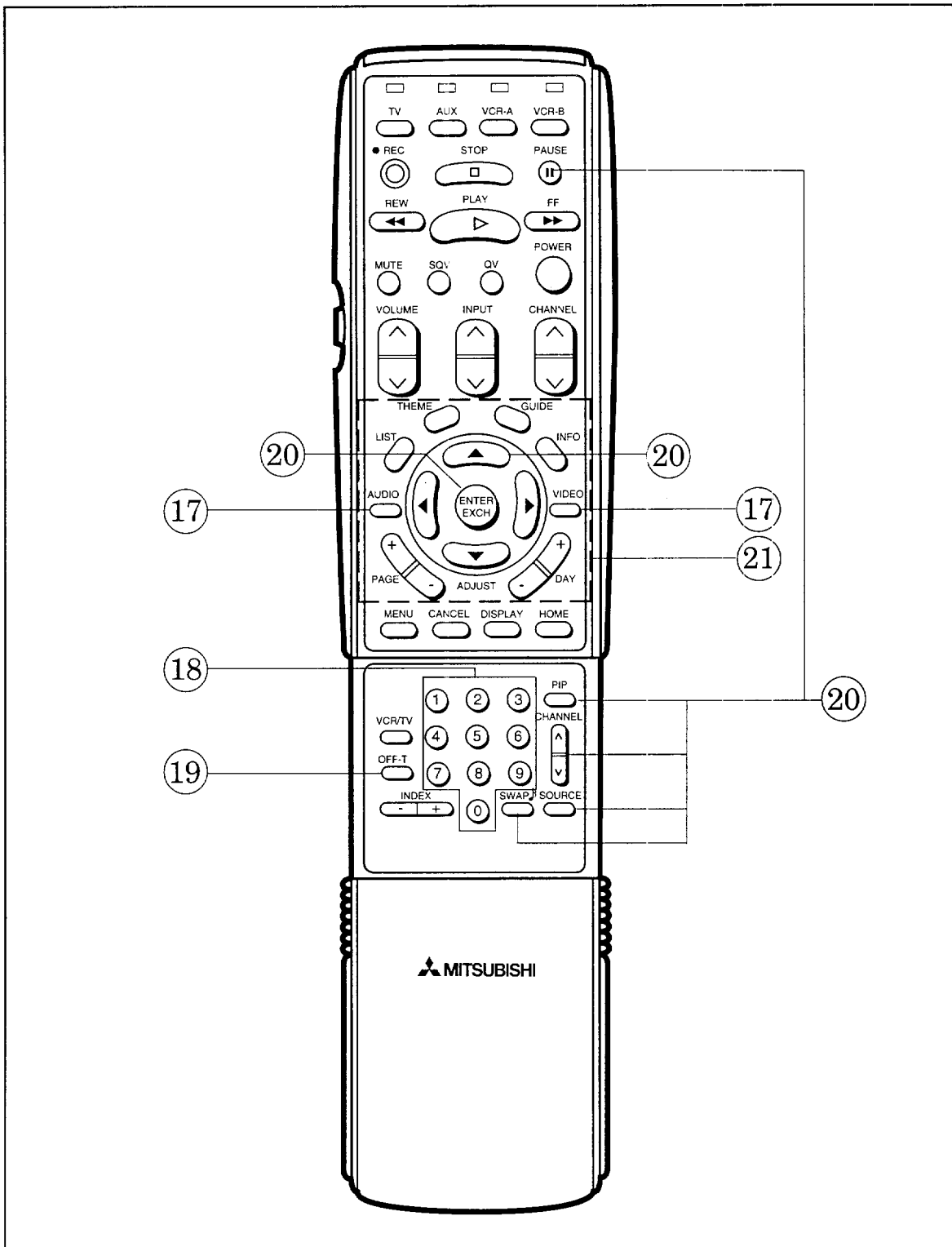

### ⑰ audio and video controls

Repeatedly press the AUDIO button or VIDEO button to select one of the functions listed below. After you select the function, use the ADJUST buttons to adjust it.

- **audio function button (AUDIO)**

- stereo/SAP/mono
- bass
- treble
- balance
- surround off/simulate/hall
- speaker internal/internal center channel/external
- monitor out variable/fixed

- **video function button (VIDEO)**

- tint
- color
- contrast
- brightness
- sharpness
- color temperature high/middle/low
- closed captioning

### ⑱ number buttons (0-9)

Use to select a channel number or to enter a parental lock code.

### ⑲ off-timer button (OFF-T)

Use to program the Projection TV to turn off automatically at a later time.

### ⑳ picture-in-picture controls

Use to control the special picture-in-picture (PIP) function. (See pages 66 – 74.)

- **PIP button (PIP)** -- Press to turn on the reduced PIP image, to change its size, or to cancel it.
- **channel button (CHANNEL)** -- Press to change the channel of the reduced PIP image.

- **swap button (SWAP)** -- Press to exchange the sound between the main image and the reduced PIP image.
- **source button (SOURCE)** -- Press repeatedly to switch the source of the reduced PIP image between the TV and the external inputs.
- **pause button (PAUSE)** -- Press to freeze the reduced PIP image, to return to a “live” image, and to use the Snap-shot and Replay functions.
- **enter button (ENTER / EXCH)** -- Press to exchange the pictures of the PIP image and the main image.
- **adjust buttons (▲, ▼, ◀, ▶)** -- Press to move the PIP image on-screen.

### ㉑ StarSight controls

Use to control the StarSight functions.

- **guide button (GUIDE)** -- Press to see the Grid Guide or Channel Guide.
- **theme button (THEME)** -- Press to see the Theme Guide.
- **list button (LIST)** -- Press to see a list of programs to record.
- **information button (INFO)** -- Press to see information about a selected program.
- **day button (DAY)** -- Press to move forward one day or move back one day in the StarSight guides.
- **page button (PAGE)** -- Press to move forward or back one page in the StarSight guides.
- **adjust buttons (▲, ▼, ◀, ▶)** -- Press to move the cursor up, down, left, or right.

### ▷ Important:

For information on how to subscribe to StarSight, please see **Booklet #1, “Mitsubishi Installation and Setup Guide.”** To learn how to operate StarSight, please see **Booklet #3, “StarSight Operating Guide.”**







This chapter will explain how to operate your Projection TV, first focusing on functions that are basic and easy and then explaining some of the advanced features.

▷ **Important:** Please see **Booklet #3, “StarSight Operating Guide”** for information on using the StarSight feature.

This chapter explains:

- ◆ **Getting Started**
- ◆ **Using the Advanced Features**

## ◆ Getting Started

---

This section is designed to get you started enjoying your new Projection TV. If you follow these procedures one by one, you will soon begin discovering everything your television can do.

You'll find information on:

- **Using the remote control to operate VCRs, cable boxes, and other equipment,**
- **Turning the Projection TV on/off,**
- **Selecting the input source,**
- **Changing channels,**
- **Understanding the ViewPoint III on-screen menus,**
- **Memorizing channels,**
- **Setting the clock,**
- **Adding and deleting channels,**
- **Setting the A/V Network,**
- **Adjusting the color alignment,**
- **Selecting the menu type,**
- **Renaming the inputs,**
- **Naming the channels,**
- **Locking A/V functions,**
- **Adjusting the sound,**
- **Adjusting the picture, and**
- **Using the closed caption decoder.**

► **Warning:** Don't leave stationary images, such as stock market reports, video games, station logos, or the Projection TV's displays, on-screen for more than 10 minutes. Still patterns such as these can scar the Projection TV, causing permanent damage to the picture tubes.

---

## Using the remote control to operate VCRs, cable boxes, and other equipment

### about your remote control

This Projection TV's remote control has four "layers": the TV layer, the VCR-A layer, the VCR-B layer, and the AUX layer. Each layer can be used to operate a different component in your A/V system. You select the layer you want to use by pressing one of the "select" buttons across the top of the remote control.

When you first receive your remote control, the TV layer is set up to operate your Mitsubishi Projection TV, the VCR-A and VCR-B layers are programmed to operate Mitsubishi VCRs, and the AUX layer is set to operate Mitsubishi audio components.

You can use the following buttons to operate your Projection TV.

- power button
- pause button
- mute control
- super quick view button
- quick view button
- volume control
- input button
- channel control
- enter button
- audio and video controls
- StarSight function buttons
- menu button
- cancel button
- display button
- home button
- off-timer button
- number buttons
- PIP controls
- PLAY button

If you have a cable box, a non-Mitsubishi VCR, a Mitsubishi laserdisc player, or a Mitsubishi A/V receiver, you can "set up" the layers in the remote control to operate these components.

The VCR-A layer can be set to operate a non-Mitsubishi VCR; the VCR-B layer can be set to operate any VCR, any cable box, or a Mitsubishi laserdisc player; the AUX layer can be set up to operate a cable box, laserdisc player, or A/V receiver; and the TV layer can be set to operate an A/V receiver.

### setting up the remote control to operate your VCR

- ❶ Turn off your VCR.
- ❷ Press one of the select buttons across the top of the remote to choose the layer you want to set up: VCR-A or VCR-B.
- ❸ While holding in the POWER button on the remote control, enter the code number listed in the chart on the following page for your brand of VCR. Be sure to enter both digits of the code number. If more than one number is listed, try the first one.

## Using the remote control to operate VCRs, cable boxes, and other equipment (cont.)

If your VCR is this brand...	...enter this code	If your VCR is this brand...	...enter this code	If your VCR is this brand...	...enter this code
Mitsubishi (A)	01	Magnavox	03, 10, 11	Scot	15
Mitsubishi (B)	02	Multitech	06	Sharp	16
Canon	03	NEC	12	Sony	17, 18
Emerson	04, 05	Panasonic	03	Sylvania	03, 10, 11
Funai	06	Philco	03, 10	Symphonic	06
General Electric	03	Philips	03, 10, 11	Teknika	04, 06
Goldstar	07	Quasar	03	Toshiba	15
Hitachi	08	RCA	08, 13, 20	Totevision	07
JVC	09	Sanyo	14	Zenith	19

- 4 Release the POWER button.
- 5 Press the POWER button again. Your VCR should turn on. If the VCR turns on, your remote control is now set to operate your VCR.

If your VCR does not turn on, repeat the instructions, trying each code number listed for your brand of VCR. If none of these code numbers work, try each number, 01 through 20.

### using your remote control to operate your VCR

After you have set up your remote control for your particular brand of VCR, you can use the remote to operate your VCR.

- 1 Use the select buttons across the top of the remote control to choose the layer that you "set up" to operate your VCR: VCR-A or VCR-B.
- 2 Point the remote control at the VCR and press the desired buttons.

If you are using a Mitsubishi VCR, you will be able to use all of the buttons on the remote control to operate your VCR except for MUTE, VOLUME and the PIP function buttons, which will always operate the Projection TV itself.

If you are using another brand of VCR, you can use the POWER, CHANNEL, REC, STOP, PAUSE, REW, PLAY, FF and TV/VCR buttons to operate your VCR.

### setting up the remote control to operate your cable box

- 1 Turn on your cable box.
- 2 Press one of the select buttons across the top of the remote to choose the layer you want to set up: AUX or VCR-B.

- ③ While holding in the POWER button on the remote control, enter the code number listed in the chart below for your brand of cable box. Be sure to enter both digits of the code number. If more than one number is listed, try the first one.

If your cable box is this brand...	...enter this code	If your cable box is this brand...	...enter this code	If your cable box is this brand...	...enter this code
ABC	57, 59, 62, 67, 89	Oak	61, 62, 82	Scientific Atlantic	66, 86, 88, 89, 91, 92
Color Voice	73, 74, 98	Panasonic	63, 70	Samsung	65, 84
Comtronics	93	Paragon	51	Signature	57
Gemini	55	Philips	73, 74, 75, 76, 77, 93	Sprucar	63
General Electric	66		94, 95, 96, 97, 98, 99	Starcom	54, 55, 56, 87
General Instruments	55, 56, 57	Pioneer	64, 65, 84	Stargate	55
Hamlin	52, 53, 69	Prime Star	48	Tocom	67, 68, 72
Hitachi	57	Pulsar	51	Toshiba	51
Jerrold	54, 55, 56, 57, 58	RCA	63	Untied Artists	62
	59, 60, 85, 87	RCA DSS	49	United Cable	54
Macom	71	Regal	53	Viewstar	93, 94
Magnavox	94	Regency	79	Zenith	51
Memorex	51				

- ④ Release the POWER button.
- ⑤ Press the POWER button again. Your cable box should turn off. If the cable box turns off, your remote control is now set to operate your cable box. If your cable box does not turn off, repeat the instructions above, trying each code number listed for your brand of cable box. If none of these numbers work, try each number, 51 through 99.

▷ **Important:** After setting up your remote, be sure that your cable box can be turned on with the POWER button. Some of the cable boxes can be turned on with the CHANNEL buttons or the number buttons.

#### using your remote control to operate your cable box

After you have set up your remote control for your particular brand of cable box, you can use the remote to operate your cable box.

- ① Use the select buttons across the top of the remote control to choose the layer that you “set up” to operate your cable box: AUX or VCR-B.
- ② Point the remote control at the cable box and press the desired buttons.

You can use the POWER, CHANNEL, numbers (0-9), and ENTER buttons to operate your cable box. If you are using an RCA DSS or Prime Star converter, you may be able to use additional buttons.

---

## Using the remote control to operate VCRs, cable boxes, and other components (cont.)

### setting up the remote control to operate your Mitsubishi audio component (laserdisc player or A/V receiver)

- ❶ Turn off your audio component.
- ❷ Press one of the select buttons across the top of the remote to choose the layer you want to set up. For a laserdisc player, choose AUX or VCR-B. For an A/V receiver, choose TV or AUX.
- ❸ While holding in the POWER button on the remote control, enter one of these code numbers:
  - For a Mitsubishi A/V receiver: 30 or 31
  - For a Mitsubishi laserdisc player: 32 or 33

Be sure to enter both digits of the code number. If more than one number is listed, try the first one.

- ❹ Release the POWER button.
- ❺ Press the POWER button again. Your audio component should turn on. If it does, your remote control is now set to operate your cable box. If it does not turn on, repeat the instructions above, trying the other code number listed for your component.

### using your remote control to operate your Mitsubishi laserdisc player

After you have set up your remote control for your laserdisc player, you can use the remote to operate the player.

- ❶ Use the select buttons across the top of the remote control to choose the layer that you “set up” to operate your laserdisc player: AUX or VCR-B.
- ❷ Point the remote control at the laserdisc player and press the desired buttons.

You can use the POWER, CHANNEL, numbers (0–9), DISPLAY, MENU, CANCEL, STOP, PAUSE, REW, PLAY, INDEX, and FF buttons to operate your laserdisc player.

### **using your remote control to operate your Mitsubishi A/V receiver**

After you have set up your remote control for your A/V receiver, you can use the remote to operate it.

- ❶ Use the select buttons across the top of the remote control to choose the layer that you “set up” to operate your A/V receiver: TV or AUX.
- ❷ Point the remote control at the A/V receiver and press the desired buttons.

If you are using a Mitsubishi HTS-100, you can use the POWER, VOLUME, and MUTE buttons to operate the receiver.

If you are using a Mitsubishi HTS-300, you can use the POWER, CHANNEL, INPUT, VOLUME, ENTER, number (0–9), DISPLAY, MENU, CANCEL, AUDIO, VIDEO, ADJUST, and MUTE buttons to operate the receiver.

### **notes about your remote control**

- ▷ **Important:** Sometimes manufacturers will change their products, or they may use more than one code. If this is the case, your remote may not be able to operate your VCR or cable box.
- ▷ **Important:** When you replace the batteries in your remote control, the remote will usually return to its initial setting. You may need to set up your remote again.



---

## Turning the Projection TV on/off

- ▷ **Important:** Before using the remote control to operate the Projection TV, press the “TV” select button at the top the remote control.

Use the POWER button on either the control panel or the remote control to turn the Projection TV on and off. The power indicator will light up in green when you turn the Projection TV on.

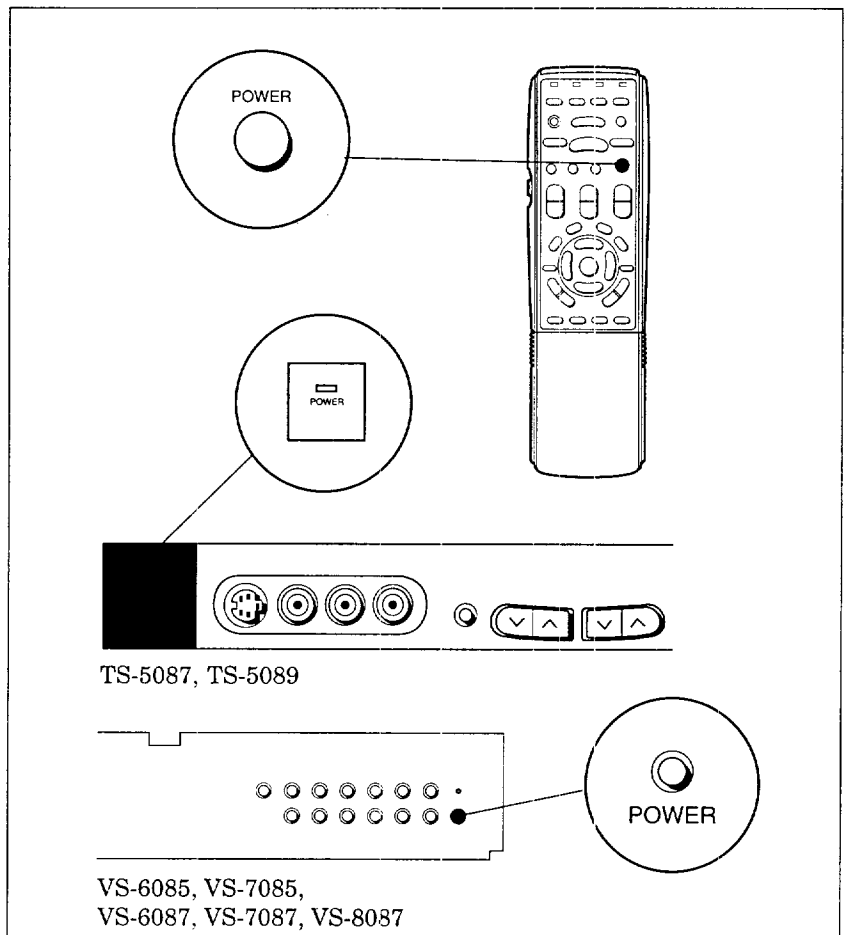

- ▷ **Important:** There is always a small amount of current flowing into the Projection TV, even when the power is turned off. This maintains any changes to the TV's settings and operates the built-in clock and timing functions. Unplugging the set will erase these settings, requiring you to set them again. Unplug the Projection TV only when it won't be used for a long time.

---

## Selecting the input source

If you connected components such as VCRs, camcorders, or laserdisc players to your Projection TV, you will need to change the input source to view the signals from these components.

To select an input source, press the input button (INPUT) on the control panel or on the remote control.

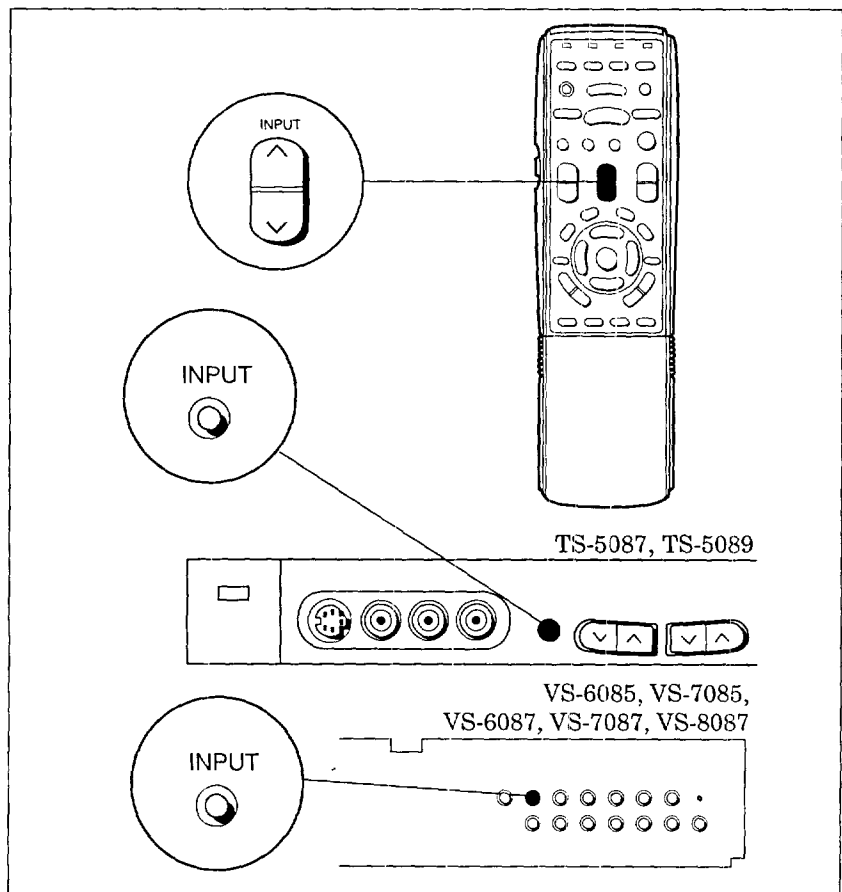

You can choose between the following input sources:

- Ant-A or Ant-B (antennas or cable systems connected to the antenna terminals),
- Input-1 or Input-2 (components connected to the terminals on the back of your television), or
- Input-3 (a component connected to the terminals on the front of the television).

The name of the input you have selected will be displayed briefly in the corner of the screen.

---

## Changing channels

Your Projection TV offers you four ways of changing channels once their numbers have been programmed into channel memory:

- selecting channels one-by-one with the channel controls,
- directly accessing a channel by pressing the number buttons,
- using the special Quick View option to switch to a particular memorized channel, and
- using the Super Quick View function to alternate between channels on a user-chosen list.

▷ **Important:** To change channels faster, use either of the following procedures:

- ✓ Enter three digits for every channel number, using zeros where needed. (For example, enter “004” to view channel 4 and “028” to view channel 28.)
- ✓ Press the ENTER button after selecting the number of the channel. (For example, press “4” and “ENTER” to view channel 4.)

▷ **Important:** Cable channel numbers 0 and greater than 126 are not used. TV stations 0, 1, and 70 through 999 are not used. If you select one of these channel numbers, your Projection TV will not change channels.

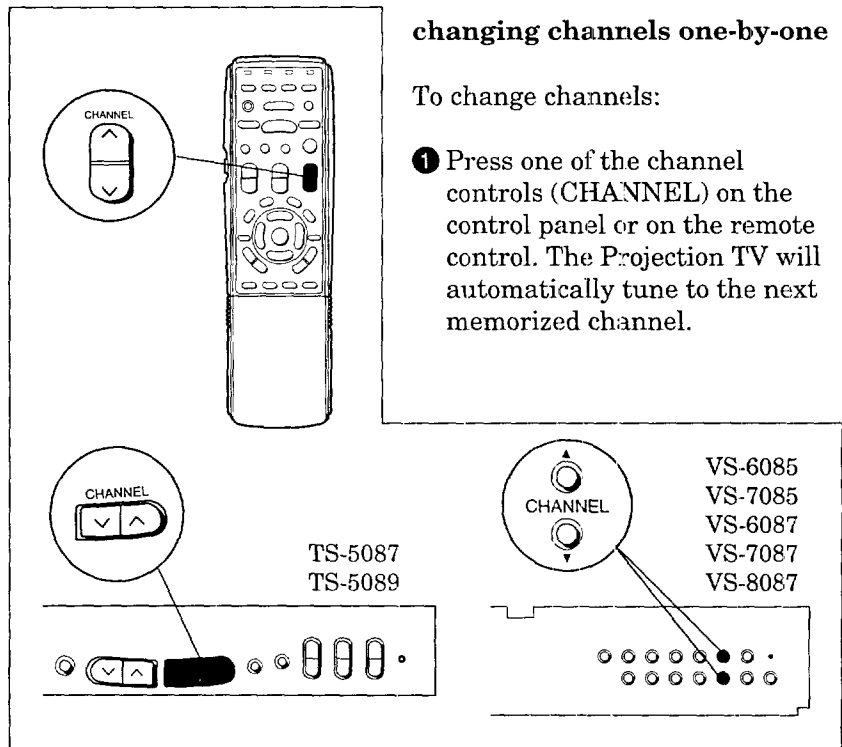

▷ **Important:** You cannot change channels one-by-one until available channels have been programmed into memory. (See “Memorizing channels,” page 26.)

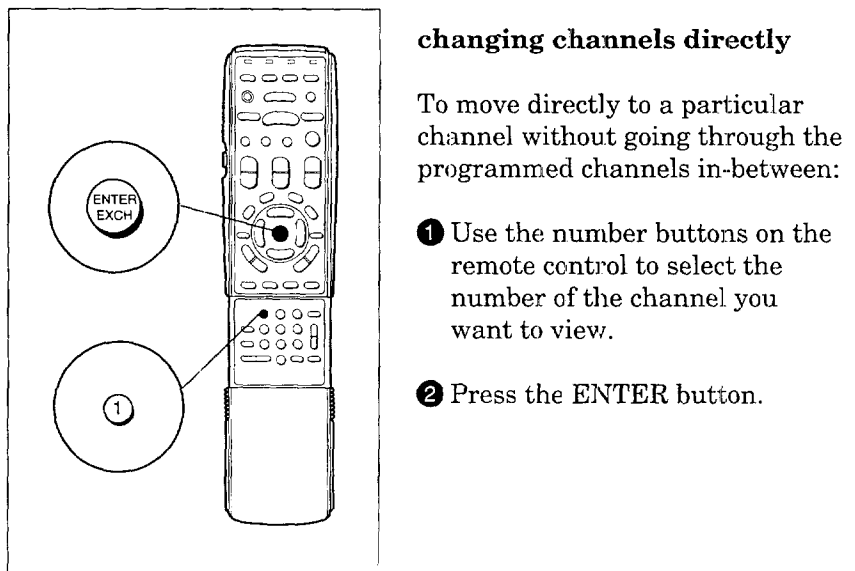

## Changing channels (cont.)

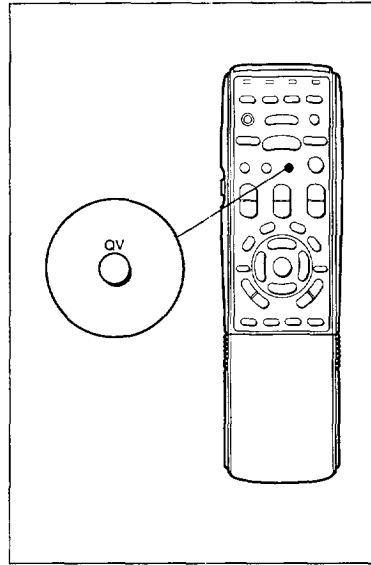

### using the Quick View option

Quick View allows you to memorize a particular channel and switch to it quickly.

- 1 Tune to the channel you wish to memorize.
- 2 Press and hold the QV button for about 2 seconds. When you release the button, the channel numbers will appear on the screen, indicating that you have memorized that channel.
- 3 After changing to another channel, press the QV button to immediately return to the memorized channel.
- 4 Press the QV button again to return to the last channel you were watching.

▷ **Important:** The memorized QV channel will remain the same until you memorize a new channel.

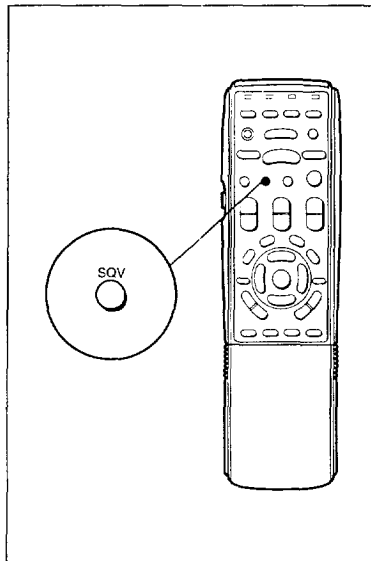

### using Super Quick View option

To view channels programmed into Super Quick View memory:

- 1 Enter the desired channel into Super Quick View memory. (See page 54 or 56.)
- 2 Press the SQV button repeatedly to view the SQV channels in sequence.

If you have subscribed to StarSight, you can program the SQV button to cycle through channels with a particular theme. See **Booklet #3, "StarSight Operating Guide."**

---

## Understanding the ViewPoint III on-screen menus

One of the distinctive features of this Projection TV is Mitsubishi's exclusive ViewPoint On-Screen Operating System. Unlike other television menu systems, ViewPoint includes a special Picture-in-Picture screen to let you view the TV picture while you are using the menu.

ViewPoint also provides step-by-step instructions for using some of the Projection TV's special capabilities.

When using the ViewPoint system, please keep the following in mind:

- ✓ The selected menu item is indicated in white.
- ✓ The on-screen menus will turn off if no item is selected within 5 minutes.
- ✓ Some menu items are available only when you subscribe to StarSight. (Please see **Booklet #3, "StarSight Operating Guide"** for more information about the StarSight menus.)
- ✓ Some on-screen menu items must be set before other items are available. For example, "Set the timer" will only be available if "Set the clock" has been set.
- ✓ You can exit the on-screen menus any time by pressing the MENU button repeatedly. You will then return to regular TV viewing.
- ✓ You can also exit the on-screen menus by pressing the HOME button on the remote control.

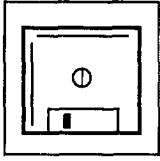

## Memorizing channels

You can use the menus to automatically memorize the channels your Projection TV can receive. Once channels are memorized, you can scan through them using the channel controls on the remote control and control panel.

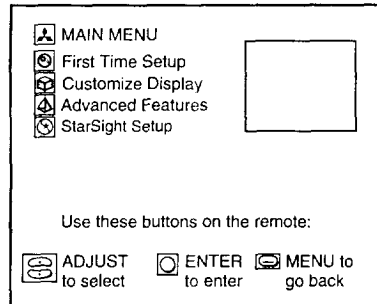

1 Press the MENU button on the remote control. The Main Menu will appear on the screen.

2 Use the ADJUST buttons to select "First Time Setup." Press ENTER.

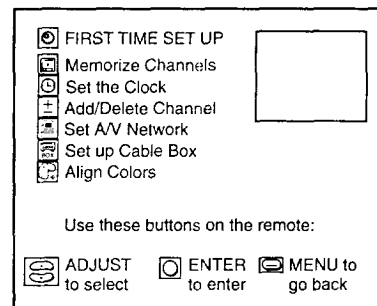

3 You will see the First Time Set Up screen. Use the ADJUST buttons to select "Memorize Channels." Press ENTER.

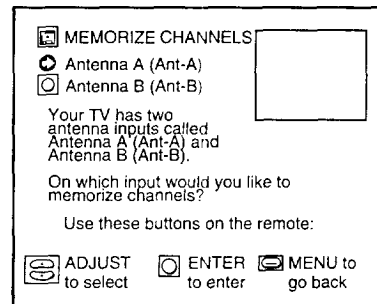

4 Use the ADJUST buttons to select the terminal (Ant-A or Ant-B) to which you attached an antenna or coaxial cable. Press ENTER. (If you made a connection to each terminal, you should memorize the channels for one terminal now, and for the other terminal later.)

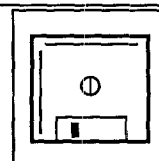

MEMORIZE CHANNELS

Indoor/outdoor antenna

Cable antenna

What kind of antenna is connected to your TV on Antenna A (Ant-A)?

Use these buttons on the remote:

ADJUST to select     ENTER to enter     MENU to go back

**If you select Antenna A**

5 Use the ADJUST buttons to choose the type of antenna you connected: Indoor/outdoor antenna or Cable antenna. Press ENTER.

MEMORIZE CHANNELS

Indoor/outdoor antenna

Cable antenna without Cable Box

Cable antenna with Cable Box

What kind of antenna is connected to your TV on Antenna B (Ant-B)?

Use these buttons on the remote:

ADJUST to select     ENTER to enter     MENU to go back

**If you select Antenna B**

6 Use the ADJUST buttons to choose the type of antenna you connected: Indoor/outdoor antenna, cable antenna without cable box, or cable antenna with cable box. Press ENTER.

MEMORIZE CHANNELS

Channel In memory 015

Now memorizing all the channel you can receive on Antenna A (Ant-A).

Please stand by.

Use this button on the remote:

CANCEL to stop memorization

7 You will see a message that channel memorization is in progress. A channel being added to memory will be labeled "In memory." Channels not being added will be labeled "Not in memory." You can stop channel memorization at any time by pressing CANCEL.

▷ **Important:** Channel controls will work only after channels have been memorized. After memorizing, use the channel controls (CHANNEL) to advance sequentially to the next memorized channel. Use the number buttons to select individual channels.

When you select "Cable antenna with cable box," your Projection TV will memorize channels 1 through 99. If your cable box can receive channels 100 through 125, you will have to add them to your TV's memory with the procedure described in "Adding and deleting channels."

It can take up to 20 minutes for your Projection TV to memorize channels from a cable box.



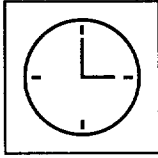

## Setting the clock

Your Projection TV contains an internal clock. If you can receive an XDS time signal from a broadcaster in your area, or if you subscribe to StarSight, then your TV can automatically set its clock. Otherwise, you can set the clock yourself. (If you subscribe to StarSight, the “Set the Clock” menu is not available.)

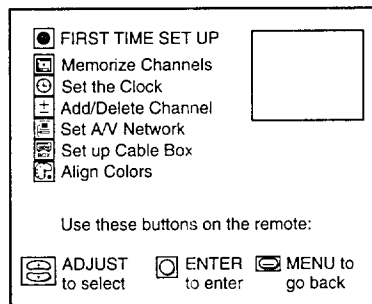

1 Press the MENU button on the remote control. The Main Menu will appear on the screen.

2 Use the ADJUST buttons to select “First Time Setup.” Press ENTER.

3 You will see the First Time Set Up screen. Use the ADJUST buttons to select “Set the clock.” Press ENTER.

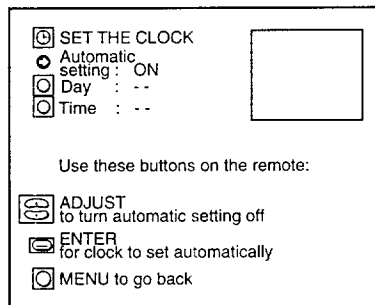

4 If you want your TV to set its clock automatically, use the ADJUST buttons to set “Automatic setting” to “On”; if you want to set the clock yourself, set “Automatic setting” to “Off,” and see “setting the clock yourself,” on page 30.

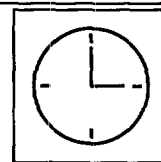

### using automatic clock setting

SET THE CLOCK  
 Which time zone are you in?  
Atlantic  
 Do you follow daylight saving time?  
No  
Current Time: Not set  
Use these buttons on the remote:  
 ADJUST  
to choose time zone  
 ENTER to enter  
 MENU to go back

SET THE CLOCK  
 Which time zone are you in?  
Atlantic  
 Do you follow daylight saving time?  
Yes  
Current Time: 5:30 pm  
Use these buttons on the remote:  
 ADJUST  
to select no  
 ENTER to enter  
 MENU to go back

- Use the ADJUST buttons to select the time zone you live in. The available time zones are: Atlantic, Eastern, Central, Mountain, Pacific, Alaska and Hawaii.
- Press the ENTER button.
- If you follow daylight savings time, use the ADJUST buttons to answer the question with “Yes.” Otherwise, answer “No.”
- Press ENTER. The automatic clock set-up is completed. The screen will return to the First Time Set Up menu.

▷ **Important:** The Projection TV's clock will not be set until you tune your Projection TV to a channel that is broadcasting the time via Extended Data Services (XDS). If your TV loses power, you will need to tune to that channel again to reset your clock.

▷ **Important:** If you set “Daylight savings” to “On,” your TV will adjust the clock by one hour when daylight savings begins and ends.

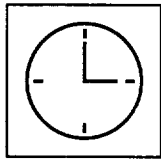

## Setting the clock (cont.)

### setting the clock yourself

SET THE CLOCK  
 Automatic setting : OFF  
 Day : --  
 Time : --

Use these buttons on the remote:

ADJUST to turn automatic setting on  
 ENTER to set the day  
 MENU to go back

- Use the ADJUST buttons to set “Auto clock” to “Off.” Press ENTER.

SET THE CLOCK  
 Automatic setting : OFF  
 Day : Wednesday  
 Time : --

Use these buttons on the remote:

ADJUST to select the day  
 ENTER to set the time  
 MENU to go back

- Use the ADJUST buttons to select the “Day.” Press ENTER.

SET THE CLOCK  
 Automatic setting : OFF  
 Day : Wednesday  
 Time : 9:00 pm

Use these buttons on the remote:

ADJUST to select the time  
 ENTER to start the clock  
 MENU to go back

- Use the ADJUST buttons to set the “Time.”
- After you have set the “Day” and “Time,” press the ENTER button to start the clock.

The screen will return to the “First Time Setup” menu.

▷ **Important:** You can clear the time by pressing the CANCEL button when “Automatic setting” is selected.

▷ **Important:** If you are receiving a VCR signal on channel 3 or channel 4, the automatic setting may not work correctly.

## Adding and deleting channels

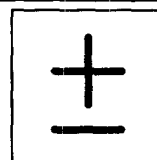

After all available channels have been memorized with the “Memorize channels” feature, channels with weaker signals can be added or deleted with the following procedure.

▷ **Important:** If you subscribe to StarSight, you can only add and delete channels on Antenna A with this menu. If you want to add and delete channels on Antenna B, use the StarSight menus. (Please see **Booklet #3, “StarSight Operating Guide.”**)

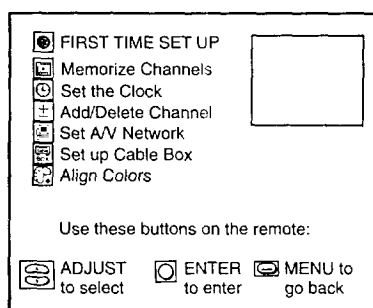

❶ Press the MENU button on the remote control. The Main Menu will appear on the screen.

❷ Use the ADJUST buttons to select “First Time Setup.” Press ENTER.

❸ Use the ADJUST buttons to select “Add/Delete Channel.” Press ENTER.

Either “In memory” or “Not in memory” will appear.

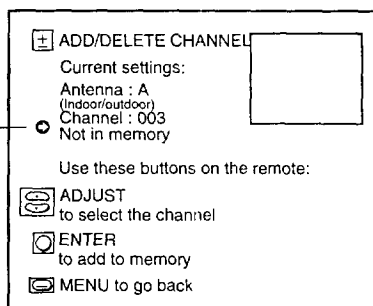

❹ The Add/Delete Channel screen will appear. Use the ADJUST buttons to select the channel you would like to add or delete. (You can also use the CHANNEL controls to change channels.)

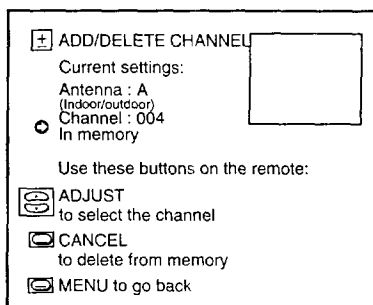

❺ If a channel is labeled “In memory,” use the CANCEL button to remove it from memory. If a channel is labeled “Not in memory,” use the ENTER button to add it to memory.

❻ When you are finished adding and deleting channels, press the HOME button to return to normal TV viewing.

Adding a channel to memory allows you to tune to the channel with the channel controls. If a channel is not in memory, you can only tune to it with the number buttons.

▷ **Important:** In this menu, you can use the CHANNEL buttons to change channels.

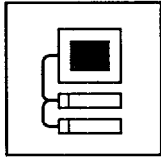

## Setting the A/V Network

The A/V Network is a special system that Mitsubishi developed to make it easier to operate many products with one remote control. When the A/V Network is connected between two Mitsubishi products, you can point the remote control at one product and it will “pass” the remote control command to the other. To set up the A/V Network:

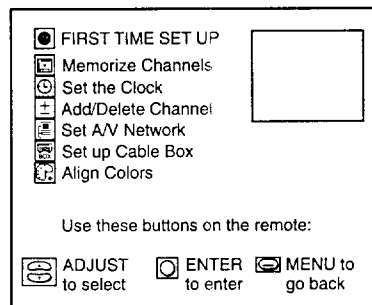

1 Press the MENU button on the remote control. The Main Menu will appear on the screen.

2 Use the ADJUST buttons to select “First Time Setup.” Press the ENTER button.

3 Use the ADJUST buttons to select “Set A/V Network.” Press the ENTER button.

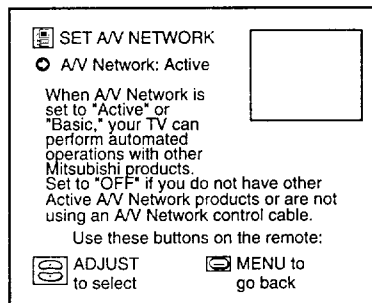

4 Use the ADJUST buttons to select “Active,” “Basic,” or “Off.” Check the rear terminals of your VCR, then use the chart below to determine how you should set your Projection TV.

5 Press the HOME button to return to normal TV viewing.

If your VCR has a rear terminal that reads:	...and you have set your VCR to:	...then set your TV to:
A/V Network	–	Basic
Active A/V Network	Off	Basic
Active A/V Network	Active	Active
Does not have an A/V Network rear terminal	–	Off

If you are not sure how to set your VCR’s A/V Network setting, refer to your VCR’s owner’s guide.

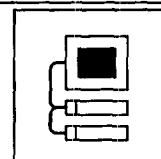

When an A/V Network cable is connected between the Projection TV and VCR and the following conditions are met, your Projection TV has two additional features.

**If...**

- ✓ You set up “StarSight,” **and**
- ✓ Your VCR is one of the following models: HS-U500, HS-U550, HS-U650, HS-U770, HS-U510, HS-U560, or HS-U760, **and**
- ✓ You have set “A/V Network” on your Projection TV and VCR to “Active.”

**Then...**

- ✓ The Projection TV will control your VCR to record current and future programs.
- ✓ You will not have to “set up” your VCR during the StarSight authorization procedure.
- ✓ An error message will be displayed when you record from the “StarSight” screen if the VCR is:
  - currently recording;
  - playing a tape;
  - turned off; or
  - if a tape is not inserted into the VCR

- ▷ **Important:** If connected, the A/V Network will still pass remote control signals, even when the Projection TV’s A/V Network setting is “Off.”
- ▷ **Important:** If you have not connected the A/V Network, set “A/V Network” to “Off,” or there may be problems selecting channels on your TV.
- ▷ **Important:** If you are using a Mitsubishi VCR with A/V Network or Active A/V Network, you should have connected it to the INPUT-1 of your TV.
- ▷ **Important:** If you subscribe to StarSight, the A/V Network “Quick Play” feature will not be available.

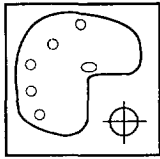

## Adjusting the color alignment

Your Mitsubishi Projection TV has three picture tubes, which are arranged in line to project the light beams that create your television picture. These three tubes must be aligned to create the best color picture. If the tubes are not aligned correctly, the objects on your screen will have “halos” or discoloration around the edges.

You should check the color alignment when your Projection TV is first installed and any time you move your Projection TV.

The color alignment process has two parts: displaying the color alignment “test” screen and adjusting the alignment. You can use either the remote control buttons or the control panel buttons to perform this procedure.

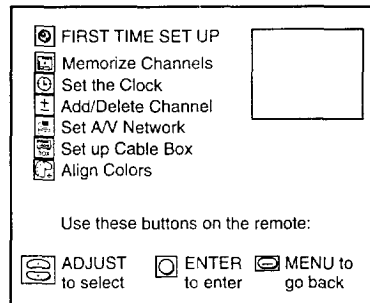

### displaying the color alignment “test” screen with the remote control

- 1 Press the MENU button on the remote control. The Main Menu will appear on the screen.
- 2 Use the ADJUST buttons to select “First Time Setup.” Press ENTER.
- 3 You will see the “First Time Setup” screen. Use the ADJUST buttons to select “Align colors.” Press ENTER.
- 4 You will see the Align Colors screen. Press ENTER. The “test” screen (below left) will appear.

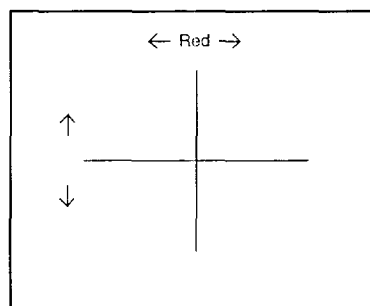
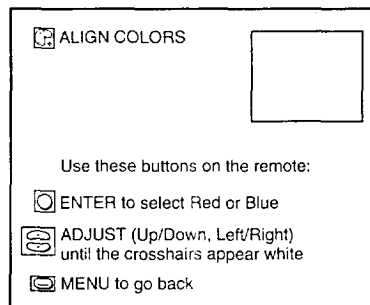

### displaying the color alignment “test” screen with the control panel buttons

- 1 At the same time, press the ENTER button and the ADJUST down button. (These buttons are joined by a line marked “test.”) The “test” screen will appear.

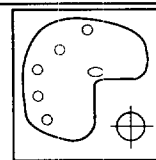

### adjusting the alignment

- 1 If the test screen shows a single, solid white cross, the Projection TV's tubes are aligned correctly. Skip to step 6. If you see three crosses, or if the single cross has discoloration at its edges, go to step 2.

- 2 When you first display the "test" screen, the word "Red" appears at the top of the screen. This indicates that you will be adjusting the red cross on the screen.

Adjust the position of the red cross until it is perfectly aligned with the green cross at the center of the screen. To adjust the red cross, use the ADJUST buttons on the remote, or the ADJUST, VIDEO, and AUDIO buttons on the control panel.

- 3 When you've finished adjusting the red cross, press ENTER. The word "Blue" will appear at the top of the screen.
- 4 Adjust the position of the blue cross until it is perfectly aligned with the green and red crosses at the center of the screen. You can use the ADJUST buttons on the remote, or the ADJUST, VIDEO, and AUDIO buttons on the control panel.
- 5 When all three crosses are perfectly aligned, they should appear as a single, solid white cross.
- 6 To remove the "test" screen from the Projection TV, press the ENTER button on the remote, or the ENTER and ADJUST-down buttons on the control panel.

► **Warning:** The "test" screen should not be left on the screen for a long period of time. It could cause damage to the picture tubes.

▷ **Important:** The alignment of the colors can change over time. If you notice a change in the color quality of the Projection TV's picture, check the color alignment. You may need to adjust the colors periodically.



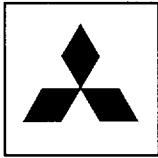

## Selecting the menu type

You can display the on-screen menus in one of two ways. The **Standard Menu**, which is illustrated in this manual, provides step-by-step instructions for all features. The **Advanced Menu** lets you select each feature directly by its name and icon.

Your TV's normal setting is the Standard menu. To switch between the Standard and Advanced Menus:

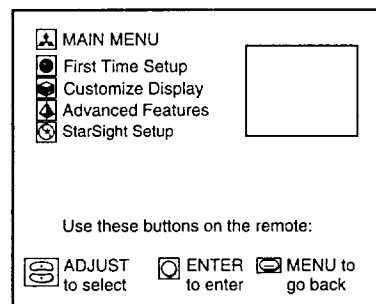

1 Press the MENU button on the remote control. The Main Menu will appear on the screen.

2 Use the ADJUST buttons to select "Customize Display." Press ENTER.

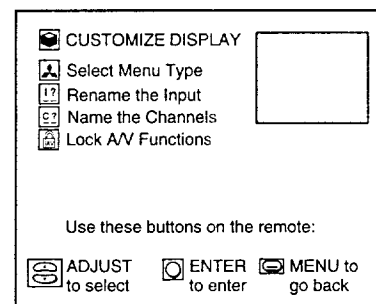

3 You will see the Customize Display menu. Use the ADJUST buttons to select "Select Menu Type." Press ENTER.

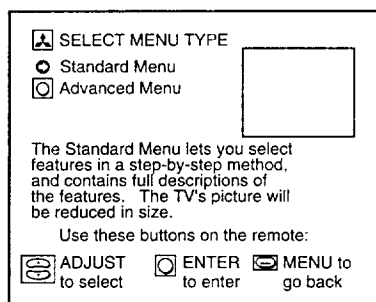

4 Use the ADJUST buttons to select "Standard Menu" or "Advanced Menu."

5 Press the ENTER or MENU button.

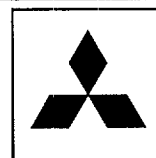

If you select the Standard Menu, the screen will return to the Customize Display menu. If you selected the Advanced Menu, the screen will show the Advanced Menu (shown below.)

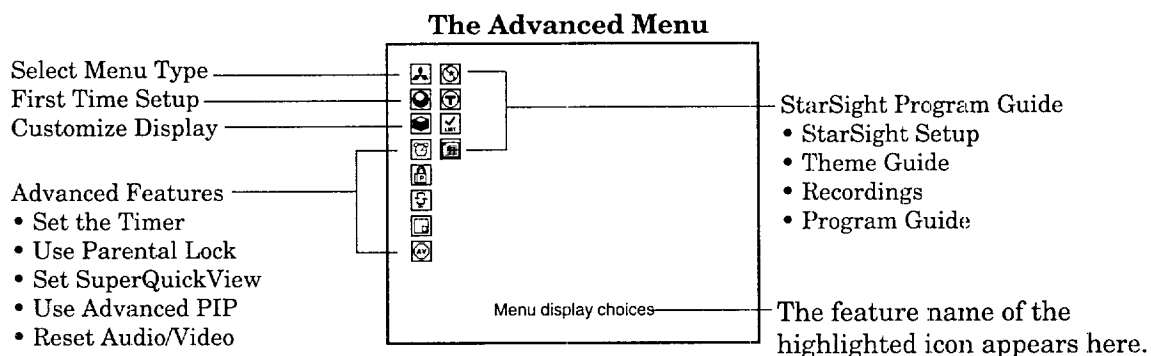

To use the Advanced Menu, use the ADJUST buttons to highlight the icon of the feature you want to use, then press ENTER. The name of the highlighted icon appears at the bottom of the screen.

You can use the following remote control buttons while viewing the Advanced Menu:

- input button
- channel controls
- number buttons
- super quick view buttons
- quick view buttons

This menu disappears if you do not select an item within 1 minute.

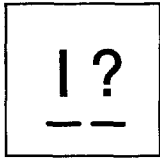

## Renaming the inputs

This feature allows you to rename the inputs so that you can keep track of components you have connected to your TV. For example, you might name one input “VCR,” and another one “DISC.” After renaming, the new name will appear on the screen display. (The original names are “Input-1,” “Input-2,” and “Input-3.”)

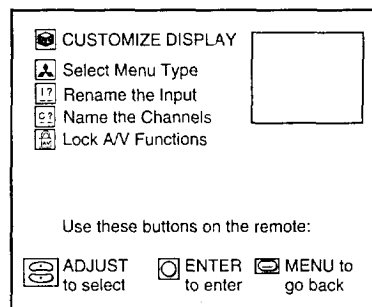

1 Press the MENU button on the remote control. The Main Menu will appear on the screen.

2 Use the ADJUST buttons to select “Customize Display.” Press ENTER.

3 You will see the Customize Display screen. Use the ADJUST buttons to select “Rename the Input.” Press ENTER.

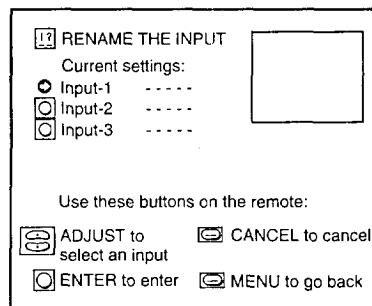

4 Use the ADJUST buttons to select the input you want to rename (Input-1, Input-2, or Input-3). Press ENTER.

5 Use the ADJUST buttons and the ENTER button to select each letter in the new name.

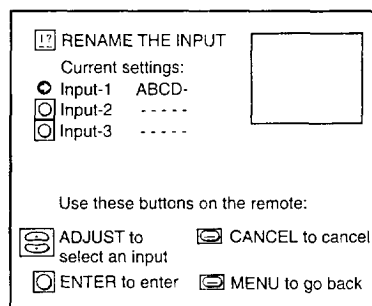

You can rename the inputs using letters (A – Z), numbers (0 – 9), or symbols (: / . , ( ) ! “ # \$ % & ' \* + ; < = > ? blank - ).

If you press the CANCEL button while setting the name, you will move one position to the left. You can clear the entire name by pressing CANCEL when the left-most position is blinking.

6 When you are finished, press the MENU button; the screen will return to the Customize Display menu.

## Naming the channels

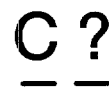

You can name the channels your Projection TV receives, helping you keep track of the many channels available. After you enter a name, it will appear on-screen, next to the channel number.

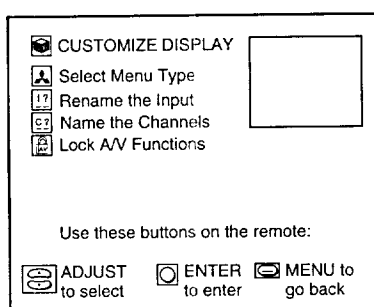

1 Press the MENU button on the remote control. The Main Menu will appear on the screen.

2 Use the ADJUST buttons to select “Customize Display.” Press ENTER.

3 You will see the Customize Display screen. Use the ADJUST buttons to select “Name the Channels.” Press ENTER.

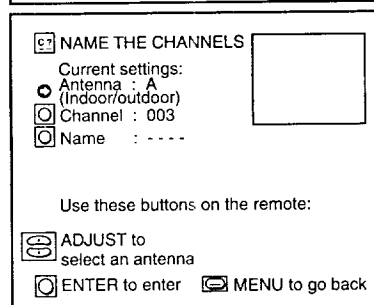

4 Use the ADJUST buttons to select an antenna (A or B). (If you subscribed to StarSight, you can only select Antenna A.) Press ENTER.

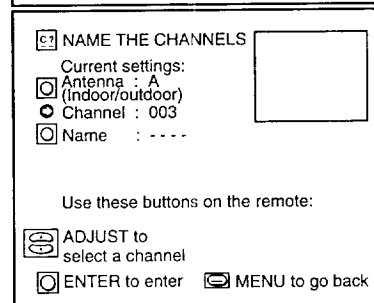

5 Use the ADJUST buttons to select the channel you want to name. Press ENTER.

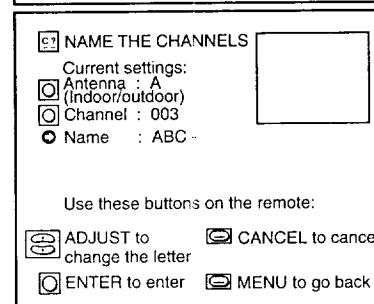

6 Use the ADJUST buttons and the ENTER button to select each letter in the new name. You can use letters (A – Z), numbers (0 – 9), or symbols (: / . , ( ) ! “ # \$ % & ’ \* + ; < = > ? blank - ). When you are setting the name, you can clear it by pressing the CANCEL button.

7 When you are finished, press the HOME button to return to normal viewing

▷ **Important:** The names you set will appear instead of the call letters being supplied by Extended Data Services (XDS). If you subscribe to StarSight, that system will automatically name the channels.

▷ **Important:** You can name up to sixty channels. If you try to name more, the message “Memory over!” will indicate that the memory is full.

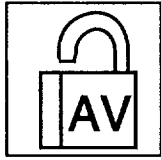

## Locking A/V functions

You can lock some of the audio and video functions (such as “Treble” or “Contrast”) to their current settings. Once you lock a particular function, it will not be displayed on-screen until you unlock it. This will prevent others from accidentally changing the settings of these functions.

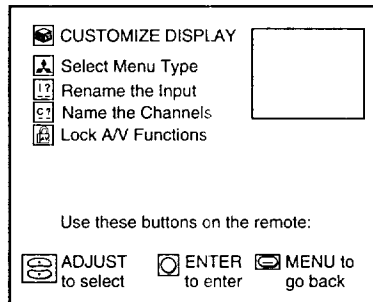

1 Press the MENU button on the remote control. The Main Menu will appear on the screen.

2 Use the ADJUST buttons to select “Customize Display.” Press ENTER.

3 You will see the Customize Display screen. Use the ADJUST buttons to select “Lock A/V Functions.” Press ENTER.

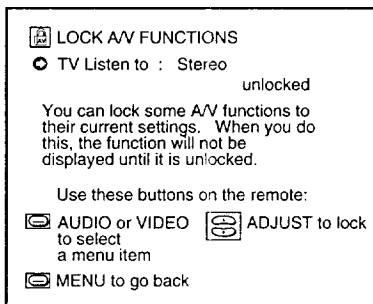

4 To lock an audio function, press the AUDIO button until the function you want to lock appears. To lock a video function, press the VIDEO button until the function you want to lock appears.

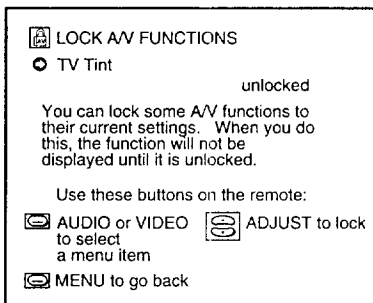

5 Use the ADJUST buttons to switch between “locked” and “unlocked.”

6 When you are finished, press the MENU button; the screen will return to the “Customize Display” menu.

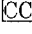
► **Important:** The speaker functions and closed captioning (  ) cannot be locked. If you try to lock these functions, the display below appears:

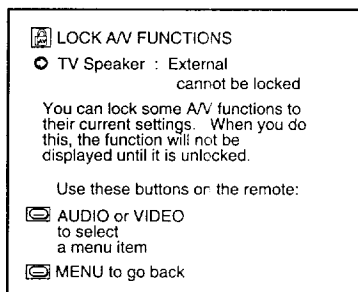

---

## Adjusting the sound

Your TV allows you to customize and adjust the settings of its audio functions. This section gives you descriptions of each audio function, then explains how to adjust the functions.

### descriptions of audio functions

The “**Listen to**” function allows you to determine how your TV will receive an audio signal and play back the sound that you hear. You can set this function to “Stereo,” “S.A.P.,” and “Mono.”

- For almost all situations, you should choose “**Stereo.**” With this setting, the TV will play stereo broadcasts in stereo and mono broadcasts in mono. If a channel is broadcasting in stereo, the word “Stereo” will be displayed when you tune to that channel.
- Some TV stations will broadcast a separate audio programming, or “**S.A.P.,**” signal. This signal is an additional soundtrack that you can’t hear during normal TV viewing. An S.A.P. signal might be related to the program you are watching (e.g., a soundtrack in a foreign language), or it might be unrelated (e.g., a weather report). If a channel is broadcasting an S.A.P. signal, the letters “SAP” will appear on-screen when you tune to that channel. Choose “**Listen to: SAP**” to hear the S.A.P. signal.
- Use the “**Mono**” setting if you are receiving a weak audio signal. This setting will reduce background noise. However, with this setting, the TV will only play in mono, even if the program you are watching is in stereo.

The “**Bass**” function controls the volume of low frequency sound.

The “**Treble**” function controls the volume of high frequency sound.

The “**Balance**” function adjusts the level of sound between the left and right speakers. Adjust the scale until the sound seems to come equally from both speakers.

The “**Surround**” function creates simulated stereo and surround effects. You can set this function to “Off,” “Simulate,” or “Hall.”

- Select “**Off**” if you do not want to use any surround effects.
- Select “**Simulate**” if you are watching a non-stereo program; your Projection TV will create a simulated stereo effect.
- Select “**Hall**” if you are watching a stereo program; your Projection TV will create a simulated surround effect, making the sound seem to extend around and behind you.

---

## Adjusting the sound (cont.)

The “**Speaker**” function allows you to select how the Projection TV’s speakers will be used.

- Choose “**Internal**” if you want to play the Projection TV’s sound through its built-in speakers.
- Choose “**Internal Center Channel**” if you connected your TV to a surround sound processor and you want to use the TV’s built-in speakers as center channel speakers.
- Choose “**External**” if you connected speakers to the speaker terminals on the rear of the TV, or if you want to play the sound of your TV through an audio system.

The “**Monitor out**” function determines how the TV will send an audio signal to an audio system or home theater receiver. Your choices are “Variable” or “Fixed.”

- If you choose “**Fixed**,” the TV will send out an audio signal at a fixed volume level. The level will not change when you adjust the TV’s volume. Use the controls on your audio system to adjust the volume. The “Fixed” setting is most useful when you can control the audio system’s volume with a remote control.
- If you choose “**Variable**,” the TV’s audio output will change when you change the TV’s volume. If you use this setting with an audio system, turn the TV’s volume all the way down, set the audio system’s volume to an average setting, then turn the TV’s volume up until you can hear the signal.

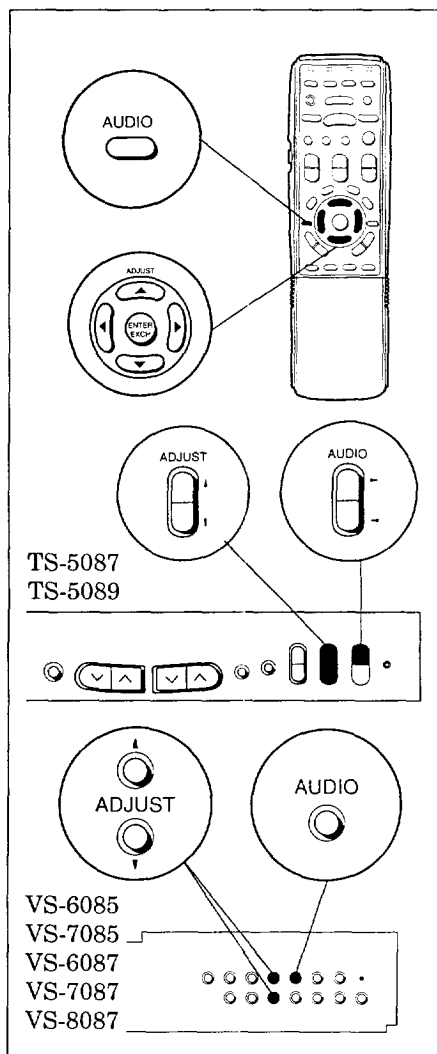

### adjusting the audio functions

When adjusting the audio functions, you can use the buttons on the remote control or on the control panel.

- ❶ Press the AUDIO button repeatedly until the function you want to adjust appears on-screen. (The functions appear at the center of the bottom of the screen.)
- ❷ While the function is still on the screen, use the ADJUST buttons to adjust its setting.
- ❸ The functions will disappear from the screen after a few seconds. (You cannot adjust a function if it is not on the screen.)

▷ **Important:** If you subscribe to StarSight, you can only use the “left/right” buttons on the remote control to adjust the audio functions. You cannot use the up/down buttons on the remote control or the ADJUST buttons on the front panel of your projection TV.



---

## Adjusting the picture

Your TV allows you to customize and adjust the settings of its video functions. This section gives you descriptions of each video function, then explains how to adjust the functions.

### descriptions of video functions

The “**Tint**” function provides a scale that adjusts the proportion of red to green in the picture. This determines the delicate tones of color.

The “**Color**” function provides a scale that determines the intensity of the color.

The “**Contrast**” function provides a scale that controls the level of white-to-black in the picture. When the contrast is low, you will be able to see the variety of shades in the darker images on the screen. When the contrast is high, the screen’s dark images will appear more uniformly black, but this will also make the colors on the screen seem more vibrant.

The “**Brightness**” function provides a scale that controls the overall brightness of the picture.

The “**Sharpness**” function provides a scale that adjusts the detail and clarity of the picture.

The “**Color temp**” (**Color temperature**) function allows you to set how the TV will display white images. Your choices are “Low,” “High,” or “Middle.”

- With the “**Low**” setting, white images on-screen will have a yellow cast to them.
- With the “**High**” setting, white images on-screen will have a blue cast to them.
- With the “**Middle**” setting, white images on-screen will be balanced between yellow and blue.

The “**CC**” function is used to control the closed caption decoder. For details, see “Using the closed caption decoder,” page 46.

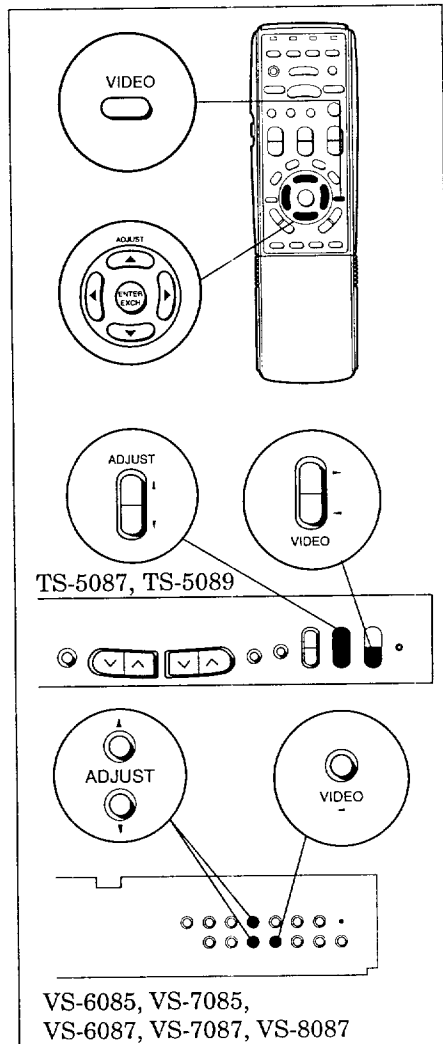

## adjusting the video functions

When adjusting the video functions, you can use the buttons on the remote control or on the control panel.

- 1 Press the VIDEO button repeatedly until the function you want to adjust appears on-screen.

(The functions appear at the center of the bottom of the screen.)

- 2 While the function is still on the screen, use the ADJUST buttons to adjust the function's setting.

- 3 The functions will disappear from the screen after a few seconds. (You cannot adjust a function if it is not on the screen.)

▷ **Important:** If you subscribe to StarSight, you can only use the “left/right” buttons on the remote control to adjust the video functions. You cannot use the up/down buttons on the remote control or the ADJUST buttons on the front panel of your projection TV.

---

## Using the closed caption decoder

Many broadcasters now supply closed captioning information along with their regular broadcasts. Your TV can decode that information and display it on the TV screen.

There are two types of captioning that broadcasters can send: “**standard**” and “**text**.”

**Standard captioning** is related to the program that is being shown. Standard captioning usually follows the dialogue of the characters on-screen.

**Text captioning** often contains information such as weather or news. Text captioning blocks out your view of the program you are watching.

Your TV can decode four different “standard captioning” signals and four different “text captioning” signals from each TV station. However, each station may be broadcasting only one or two captioning signals, or none at all.

When setting the decoder you can choose:

- to display one of four “standard captioning” signals ( **CC** :1, **CC** :2, **CC** :3, **CC** :4),
- to display one of four “text captioning” signals ( **CC** : Text 1, **CC** : Text 2, **CC** : Text 3, **CC** : Text 4),
- to display captions when muting ( **CC** : When Muting),
- or to turn the captions off ( **CC** : Off).

If you select “ **CC** : When Muting,” the standard captioning signal ( **CC** :1) will appear whenever you use the MUTE button.

- ▷ **Important:** If you set the decoder to a “standard” caption setting and tune to a broadcaster that is not sending a caption signal, no captions will appear.
- ▷ **Important:** If you set the decoder to a “text” setting and tune to a broadcaster that is not sending a text signal, a large black rectangle will block your screen.
- ▷ **Important:** The content of captions are determined by the broadcaster. If your captions show strange characters, misspellings, or odd grammar, it is not a malfunction of the Projection TV.

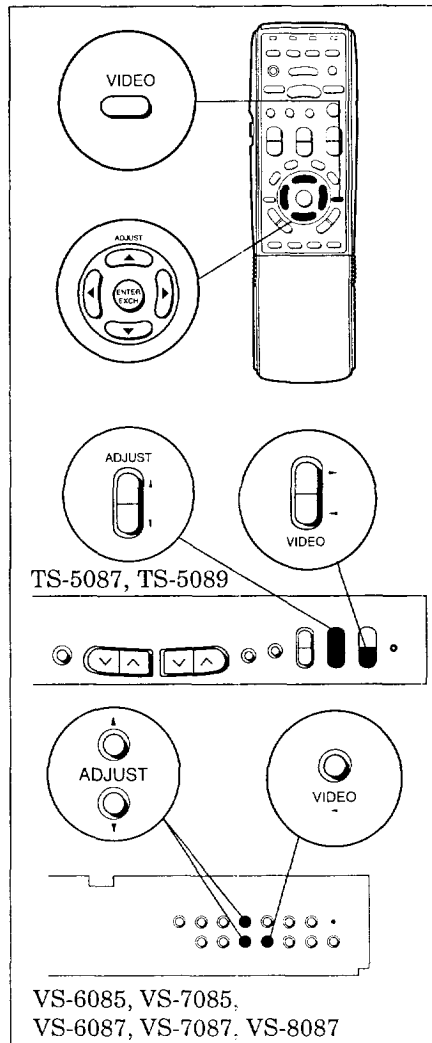

### adjusting the closed caption decoder

When adjusting the closed caption decoder, you can use the buttons on the remote control or on the control panel. To use the closed caption decoder:

- ① Press the VIDEO button until the closed caption display appears on the screen.
- ② Press the ADJUST buttons to select the caption setting you want. (See page 46 for an explanation of the settings.)

#### ► Important:

If you subscribe to StarSight, you can only use the “left/right” buttons on the remote control to adjust the caption functions. You cannot use the up/down buttons on the remote control or the ADJUST buttons on the front panel of your projection TV.

### uses for closed captioning

Closed captioning was initially designed so that those with hearing difficulties could more fully enjoy viewing television.

However, closed captioning can also be used in other ways, such as:

- helping children learn to read,
- learning a foreign language, and
- using the television without disturbing others.

► **Important:** If you cannot display any captions on the screen, please keep in mind that not all broadcasters, video tapes, or laserdiscs supply closed caption signals.

Additionally, captions might not appear:

- if you are playing a video tape that is worn or deteriorated, or
- if you are starting to play a laserdisc from still or search mode.

## ◆ Using the Advanced Features

---

This section explains how to use the more advanced features of your Mitsubishi Projection TV.

▷ **Important:** For information on operating StarSight, please see **Booklet #3, “StarSight Operation Guide.”**

In this chapter, you will learn about.

- **Setting the timer,**
- **Using the parental lock,**
- **Using Super Quick View if you haven’t subscribed to StarSight,**
- **Using Super Quick View if you’ve subscribed to StarSight,**
- **Selecting an advanced PIP function, and**
- **Resetting the sound and the picture.**

## Setting the timer

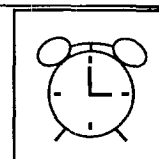

This special feature allows you to program the Projection TV to turn on automatically at a time that you set. To set the timer:

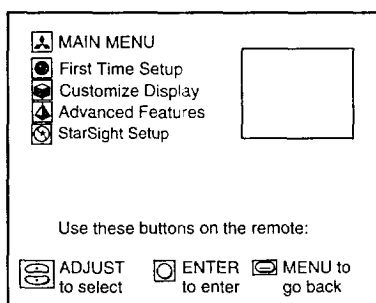

1 Press the MENU button on the remote control. The Main Menu will appear on the screen.

2 Use the ADJUST buttons to select "Advanced Features." Press ENTER.

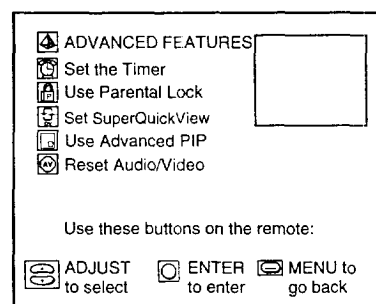

3 You will see the Advanced Features screen. Use the ADJUST buttons to select "Set the timer." Press ENTER.

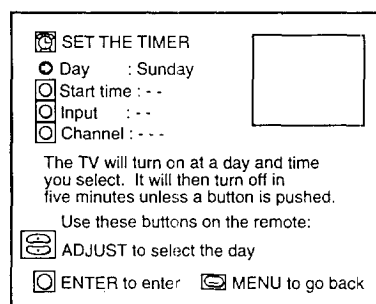

4 Use the ADJUST buttons and the ENTER button to set Day, Start time, Input, and Channel.

After setting the timer, make sure that the program timer indicator is lit. The indicator will light in orange when the TV is turned on and light in red when the TV is turned off. The indicator will not light when using the menus, or when a lock message is displayed.

If you press the CANCEL button while setting the timer, the arrow will move to the previous item. To clear the timer, press CANCEL with the arrow next to "Day."

▷ **Important:** When the timer turns the Projection TV on, the display will flash. If you do not press any function buttons for about 5 minutes, the Projection TV will automatically turn off. Press a function button (such as the display button) to keep the Projection TV on and turn off the flashing display.



## Using the parental lock

This special feature allows you to lock the entire TV during a certain time period or to lock up to ten individual channels. (You cannot lock the TV and lock individual channels at the same time.) When you turn on the lock, you enter a 4-digit secret code that will allow you to turn off the lock later.

If you try to turn on a locked TV, view a locked channel, or the locking “time period” begins, you will see a message asking you to enter the secret code. If you don’t enter the code within five minutes, the TV will turn off or tune to an unlocked channel.

If you enter the secret code, the message will disappear and the lock will be turned off temporarily. However, the TV or channels will be locked again after you turn off the TV. This will continue until you turn the lock off permanently. To turn the lock off permanently, follow the procedure later in this section.

### using parental lock

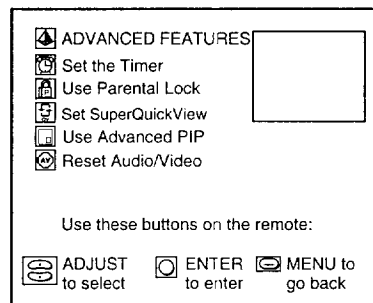

1 Press the MENU button. The Main Menu will appear.

2 Use the ADJUST buttons to select “Advanced Features.” Press ENTER.

3 Use the ADJUST buttons to select “Use Parental Lock.” Press ENTER.

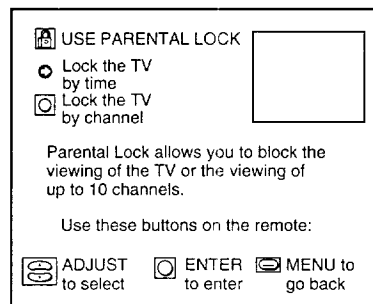

4 Use the ADJUST buttons to select “Lock the TV by time” or “Lock the TV by channel.” Press ENTER.

If you selected “Lock the TV by time,” see page 51.

If you selected “Lock the TV by channel,” see page 52.

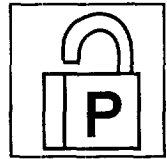

## locking the TV by time

USE PARENTAL LOCK  
Lock the TV  
by time : OFF  
 Secret code : - - - -

After you turn the TV OFF, you will not be able to watch the TV without the code.

Use these buttons on the remote:

NUMBER KEYS to enter a 4-digit code  
 ENTER to enter     MENU to go back

- Enter a four-digit secret code using the number buttons (0-9); press the ENTER button.

You can cancel the code if you press CANCEL before you press ENTER.

USE PARENTAL LOCK  
Lock the TV  
by time : OFF  
 Day : - -  
 Lock at : - -  
 Unlock at : - -

Use these buttons on the remote:

ADJUST to select the day     CANCEL to cancel  
 ENTER to enter     MENU to go back

- Use the ADJUST buttons to select a day; press ENTER.
- Use the ADJUST buttons to set the time at which you want to lock the Projection TV. Press ENTER.

USE PARENTAL LOCK  
Lock the TV  
by time : ON  
 Day : Sunday  
 Lock at : 11:00pm  
 Unlock at: 12:00pm

Use these buttons on the remote:

ADJUST to select the time     CANCEL to cancel  
 ENTER to enter     MENU to go back

- Use the ADJUST buttons to set the time at which you want to unlock the Projection TV. Press ENTER. If you want the lock to be in effect all the time, set the same "Lock at" time as you set for the "Unlock at" time.
- Press HOME to exit the menus.

TV LOCKED BY TIME  
Secret code : - - - -

- When you turn on a locked TV, or if the lock's "time period" begins, you will be asked to enter your four-digit secret code. Enter the code to temporarily disable the lock. The lock will be enabled again when you turn the TV off.

▷ **Important:** If you lock the TV by time and the TV clock is reset due to a prolonged power failure, you will be asked to enter your secret code before you can use the TV again. If the TV only loses power for a short time, the TV clock will not be reset, and the lock will operate normally.



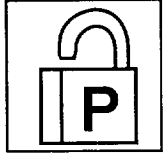

## Using the parental lock (cont.)

**USE PARENTAL LOCK**  
Lock the TV by channel  
● Secret code : ----

After you turn the TV OFF, you will not be able to watch the TV without the code.

Use these buttons on the remote:

NUMBER KEYS to enter a 4-digit code  
 ENTER to enter     MENU to go back

### locking the TV by channel

- Enter a four-digit secret code using the number buttons (0-9); press ENTER.

You can cancel the code if you press CANCEL before you press ENTER.

**USE PARENTAL LOCK**

Ant.	Channel	Ant.	Channel
●	----	<input type="checkbox"/>	----
<input type="checkbox"/>	----	<input type="checkbox"/>	----
<input type="checkbox"/>	----	<input type="checkbox"/>	----
<input type="checkbox"/>	----	<input type="checkbox"/>	----
<input type="checkbox"/>	----	<input type="checkbox"/>	----

Use these buttons on the remote:

ADJUST to select a position     CANCEL to cancel  
 ENTER to enter     MENU to go back

- You will see the channel lock set-up screen. Use the ADJUST buttons to select a position. Press ENTER.

**USE PARENTAL LOCK**

Ant.	Channel	Ant.	Channel
●	Ant-A 019	<input type="checkbox"/>	----
<input type="checkbox"/>	----	<input type="checkbox"/>	----
<input type="checkbox"/>	----	<input type="checkbox"/>	----
<input type="checkbox"/>	----	<input type="checkbox"/>	----
<input type="checkbox"/>	----	<input type="checkbox"/>	----

Use these buttons on the remote:

ADJUST to select a channel     CANCEL to cancel  
 ENTER to enter     MENU to go back

- Use the ADJUST buttons to select the antenna (Ant-A or Ant-B) that has the channel you want to lock. Press ENTER.
- Use the ADJUST buttons or CHANNEL buttons to choose the channel you want to lock. Press ENTER.

TV LOCKED BY CHANNEL  
Secret code : ----

- Repeat the steps above to lock additional channels. When you are finished, press the HOME button to turn off the menus.
- When you try to view a locked channel, you will be asked to enter your four-digit secret code. Enter the code to temporarily disable the lock. The lock will be enabled again when you turn the TV off.

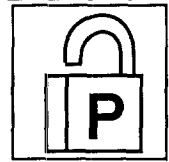

### canceling or changing parental lock

- 1 Press the MENU button. The Main Menu will appear on the screen.
- 2 Select "Advanced Features" using the ADJUST buttons; press ENTER.
- 3 Select "Use Parental Lock" using the ADJUST buttons; press ENTER.
- 4 Enter the four digits of your secret code using the number buttons (0-9); press ENTER.
- 5 If you were locking the TV by time, use the ADJUST buttons to select "Lock at," then press the CANCEL button to turn off the lock.
- 6 If you were locking the TV by channel, use the ADJUST buttons to place the cursor next to the channel whose lock you want to cancel. Press ENTER.
- 7 Press the CANCEL button to unlock that channel, or use the ADJUST buttons to change the channel to a new one.
- 8 Press the MENU button to return to the Advanced Features menu.

You will see this screen if you locked the TV by time.

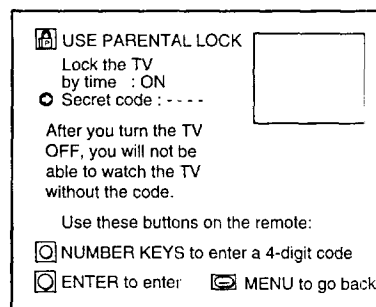

You will see this screen if you locked the TV by channel

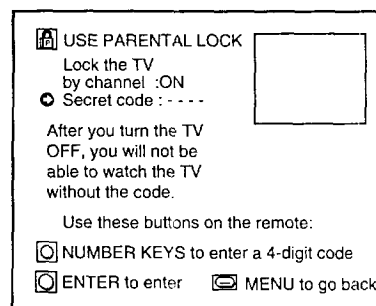

▷ **Important:** If you forget your four-digit secret code, please see page 85.

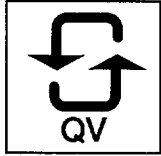

## Using Super Quick View if you haven't subscribed to StarSight

Super-Quick-View allows you to cycle through a list of up to ten numbers with the SQV button. You use the menus to add channels to the list or to remove channels from the list. You can also add channels to the list using only the remote control.

### customizing the Super Quick View list with the menus

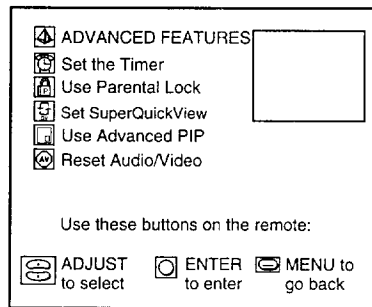

1 Press the MENU button on the remote control. The Main Menu will appear on the screen.

2 Use the ADJUST buttons to select "Advanced Features." Press ENTER.

3 Use the ADJUST buttons to select "Use SuperQuickView." Press ENTER.

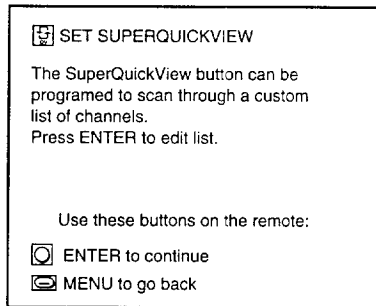

4 A description of Super Quick View will appear. Press ENTER.

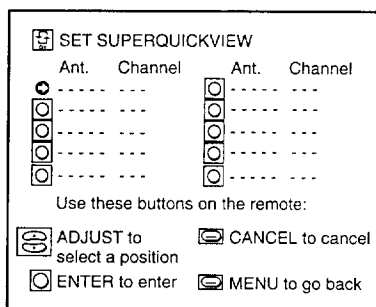

5 Use the ADJUST buttons to select a position in the list; press ENTER.

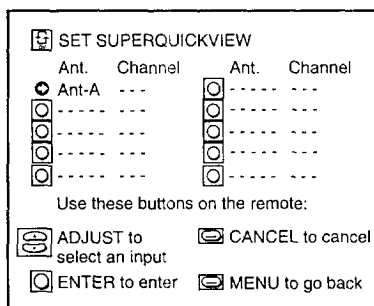
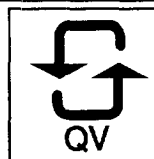

- 6 Use the ADJUST buttons to select an antenna (Ant-A or Ant-B). Press ENTER.

You can clear the antenna by pressing CANCEL.

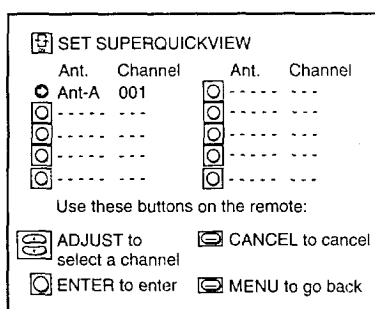

- 7 Use the ADJUST buttons, CHANNEL buttons or number buttons to add a channel to the list; press ENTER. You can clear a channel by pressing the CANCEL button.

- 8 Repeat steps 5, 6, and 7 to customize the Super Quick View memory.

- 9 Press the MENU button to exit this menu.

### adding channels to the list with the remote control

- 1 Use the channel controls or number buttons to tune the TV to the channel you want to add to the list.
- 2 Press and hold the SQV button for about 2 seconds. When you release the button, the letters "SQV" will appear under the channel number, indicating that the channel has been added to Super Quick View memory.

▷ **Important:** If the Super Quick View memory is full, the letters "SQV" will flash when you release the SQV button.

▷ **Important:** Once you've added a channel to the SQV memory, the letters "SQV" appear under the channel number any time the channel number is displayed, even if you tune to the channel in another manner.



## Using Super Quick View if you've subscribed to StarSight

When you subscribe to StarSight, you can use the SQV button to cycle through a list of channels. You can create this list yourself, using the "Customize Channels" option in the menus, or you can use a "theme list" created by StarSight.

For more information about using Super Quick View with StarSight, please see **Booklet #3, "StarSight Operating Guide."**

### selecting a Super Quick View choice

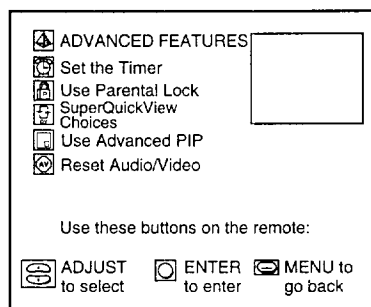

1 Press the MENU button on the remote control. The Main Menu will appear on the screen.

2 Use the ADJUST buttons to select "Advanced Features." Press ENTER.

3 Use the ADJUST buttons to select "SuperQuickView Choices." Press ENTER.

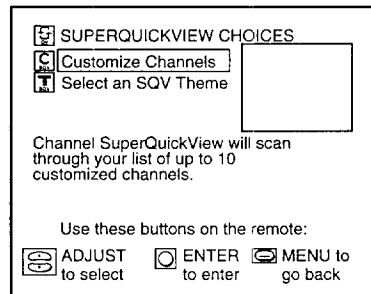

4 Use the ADJUST buttons to select the way you want to use Super Quick View: by customizing the channel list or by selecting an SQV theme. Press ENTER.

### customizing the Super Quick View list

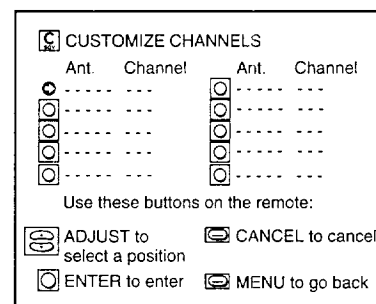

1 Use the ADJUST buttons to select a position in the list; press ENTER.

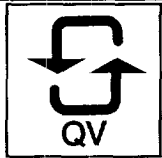

**CUSTOMIZE CHANNELS**

Ant.	Channel	Ant.	Channel
Ant-A	---	---	---
---	---	---	---
---	---	---	---
---	---	---	---

Use these buttons on the remote:

to select an input       to cancel  
 to enter       to go back

2 Use the ADJUST buttons to select an antenna (Ant-A or Ant-B). Press ENTER.

You can clear the input by pressing CANCEL.

**CUSTOMIZE CHANNELS**

Ant.	Channel	Ant.	Channel
Ant-A	001	---	---
---	---	---	---
---	---	---	---
---	---	---	---

Use these buttons on the remote:

to select a channel       to cancel  
 to enter       to go back

3 Use the ADJUST buttons, CHANNEL buttons, or number buttons to add a channel to the list; press ENTER. You can clear a channel by pressing the CANCEL button.

4 Repeat steps 1, 2, and 3 to customize the Super Quick View memory.

5 Press the HOME button to exit this menu.

**SUPERQUICKVIEW CHOICES**

- Customize Channels
- Select an SQV Theme

Theme SuperQuickView will scan through channels which are currently displaying a selected topic (SQV Theme). Press SQV at the SQV Theme Screen to select a topic.

Use these buttons on the remote:

to select       to enter       to go back

### selecting an SQV theme

For more information about selecting a Super Quick View theme with StarSight, please see **Booklet #3, "StarSight Operating Guide."**

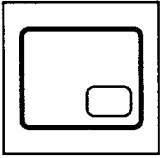

## Selecting an advanced PIP function

When you are using the PIP features, there are special functions you that can occur when you press the PAUSE button. Before using these advanced functions, you need to choose one in the menu system. These advanced functions are:

- “**TV Still**,” which allows you to switch the PIP image between still and moving;
- “**Snap-shot**,” which allows you to view several frozen PIP images and one moving PIP image; and
- “**Replay**,” which allows you memorize six PIP images and display three of them at a time.

For more information, see “Using the Advanced Picture-in-Picture (PIP) Modes,” page 66.

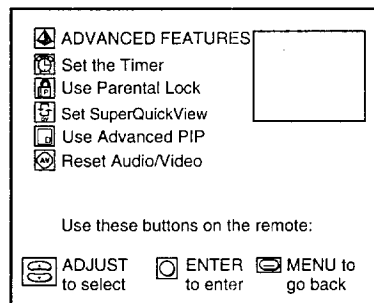

1 Press the MENU button on the remote control. The Main Menu will appear on the screen.

2 Use the ADJUST buttons to select “Advanced Features.” Press ENTER.

3 Use the ADJUST buttons to select “Use Advanced PIP.” Press ENTER.

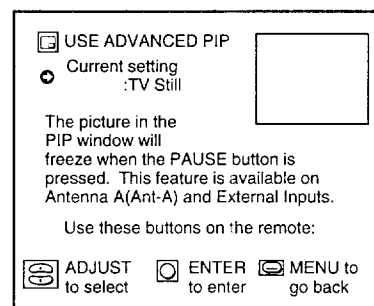

4 Use the ADJUST buttons to select the advanced function you would like to use: TV Still, Snap-shot, or Replay. Press ENTER.

• If you select “Replay,” the next option will be “Replay speed.” Use the ADJUST buttons to set the replay speed from 1 to 9. (1=short interval and 9=long interval.) Press ENTER. (See “Using the Replay feature” on page 74 for more information.)

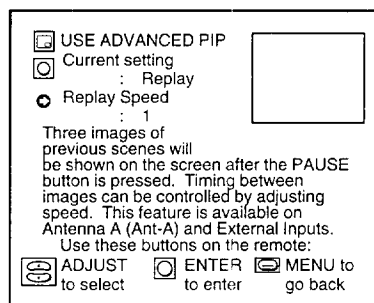

5 Press the MENU button to return to the Advanced Features menu.

## Resetting the sound and the picture

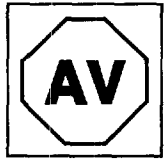

This feature allows you to reset all audio and video functions to their factory level or settings.

Certain settings will not reset, including volume, "Listen to:," speaker, monitor out, and closed captioning.

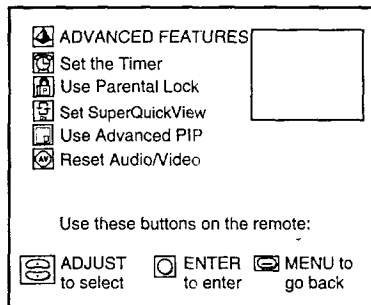

1 Press the MENU button on the remote control. The Main Menu will appear on the screen.

2 Use the ADJUST buttons to select "Advanced Features." Press ENTER.

3 Use the ADJUST buttons to select "Reset Audio/Video." Press ENTER.

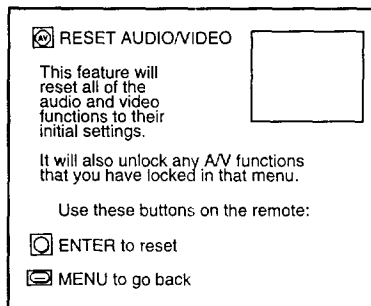

4 A message explaining this feature will appear. If you want to continue, press ENTER.

5 The screen will return to the Advanced Features menu, and the A/V functions will be reset.

▷ **Important:** This feature will also unlock any A/V functions that you have locked in the Lock A/V Functions menu.

▷ **Important:** You can also use the A/V reset button on the control panel to reset the A/V functions.







In addition to the basic and advanced features explained in the previous chapter, this Projection TV offers the user several special features not generally available on other brand Projection TVs. This chapter will explain how to use these distinctive features. It contains the following topics:

- ◆ **Understanding the On-Screen Displays**
- ◆ **Using the Off-Timer**
- ◆ **Using the Advanced Picture-in-Picture (PIP) Modes**
- ◆ **Using the Active A/V Network Feature**

## ◆ Understanding the On-Screen Displays

Your Projection TV provides an on-screen summary of the current settings for the TV or cable channels, as well as the information related to Extended Data Services (XDS). XDS allows broadcasters to supply you with the current time, channel information (such as call letters and the network name), and program information (such as the program name and program description). To view this information, press the display button (DISPLAY) on the remote control to cycle through all the information.

The first time you press DISPLAY, you will see a display like this, if your main source is an antenna:

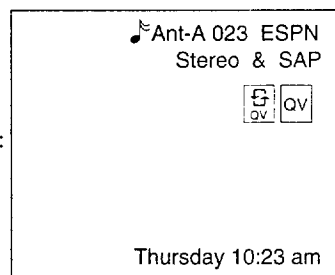

- ❶ This setting shows:
- the sound is coming from the main image,
  - the antenna (A) and channel number (23),
  - this channel's call letters or name,
  - stereo and SAP are available,
  - this channel is programmed into super quick view (SQV) memory and quick view (QV) memory,
  - the day of the week and the time.

The first time you press DISPLAY, you will see a display like this, if your main source is an input:

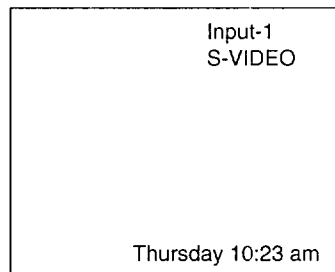

- This setting shows:
- the input name (Input-1),
  - an S-video cable was connected,
  - the day of the week and time.

The second time you press DISPLAY, you will see a display like this:

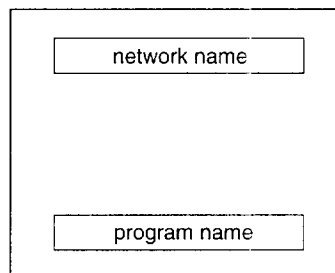

- ❷ This shows where the network name and program name will appear if the broadcaster is supplying that information via XDS.

The third time you press DISPLAY, you will see a display like this:

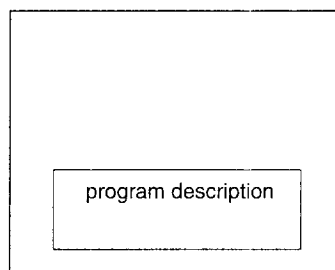

- ❸ This shows where the program description will appear if the broadcaster is supplying that information via XDS.

▷ **Important:** If the broadcaster is not supplying information via XDS, then an error message will appear (“No name available,” “No description available”). Also, the “call letters” will not appear.

## ◆ Using the Off-Timer

---

This special feature allows you to set the Projection TV to turn off automatically. You can set the TV to turn off after a period of time ranging from 10 to 120 minutes, in ten minute intervals. In this section you will learn:

- **Setting the off-timer, and**
- **Changing or canceling the off-timer.**

## Setting the off-timer

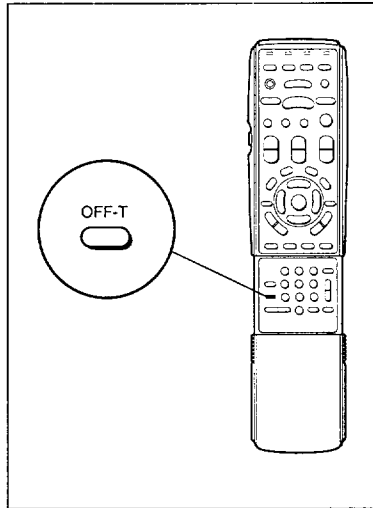

- 1 Press the OFF-T button on the remote control. The off-timer display will appear on the screen, showing that the timer is currently set for 120 minutes.

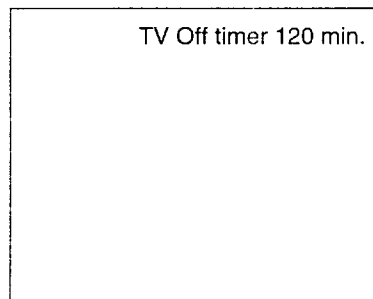

- 2 Select how long you want the Projection TV to stay on by repeatedly pressing the OFF-T button. The time will decrease in 10 minute intervals each time you press the button.

- 3 When you reach the time you want, stop pressing the button. The off-timer display will disappear after a few seconds.

- 4 To view the amount of time left in the off-timer, press the OFF-T button once. The on-screen display shows the amount of time remaining.

▷ **Important:** During the last minute before the Projection TV turns off, "Off-timer 1 min." will flash in red to remind you that the off-timer is set.

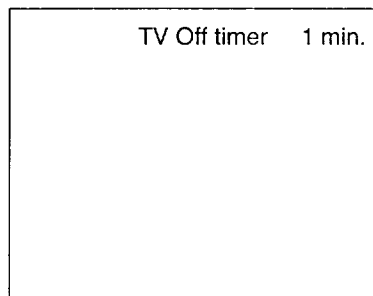

---

## Changing or canceling the off-timer

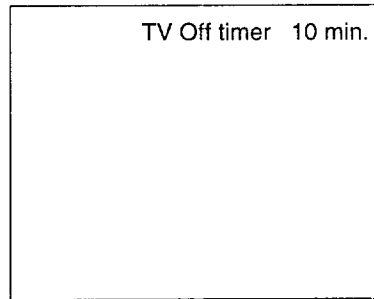

- ① Press the OFF-T button on the remote control. An on-screen display will indicate the amount of time remaining until the Projection TV turns off.
- ② Repeatedly press the OFF-T button to change the remaining time or to cancel the off-timer. The off-timer is canceled when “— —” appears instead of the remaining time.

## ◆ Using the Advanced Picture-in-Picture (PIP) Modes

One of the special features of the TV is the advanced picture-in-picture (PIP) mode, which allows you to view two different pictures at the same time. In this section you'll learn:

- **Activating the PIP image,**
- **Changing the picture in the PIP image,**
- **Exchanging the picture and sound of the PIP image and the main image,**
- **Moving the PIP image,**
- **Freezing the PIP image,**
- **Using the Snap-shot feature, and**
- **Using the Replay feature.**

► **Warning:** If you are watching Antenna-B as the main image and Antenna-A as the PIP image, **DO NOT** exchange the images. You will not be able to exchange the images back. See page 80 in the Troubleshooting section for more information.

## Activating the PIP image

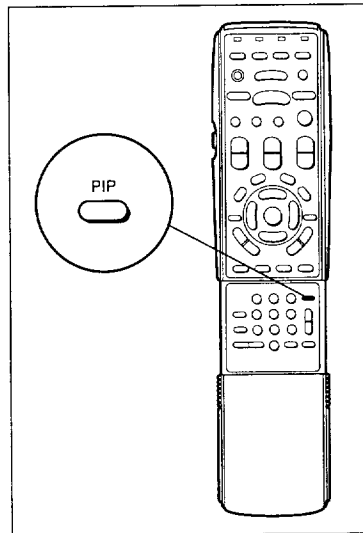

❶ Select the number of the TV channel you want to view with the channel control.

❷ Press the PIP button.

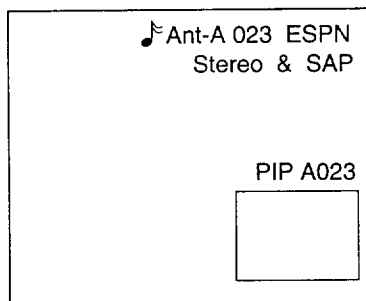

❸ A PIP image will appear in the corner of the screen.

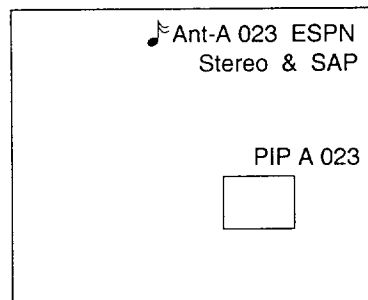

❹ Press PIP again within 10 seconds; the PIP image will reduce to a smaller size.

(If you wait longer than 10 seconds the PIP image will disappear when you press the PIP button.)

❺ Press the PIP button once again to cancel the PIP image.

- ▷ **Important:** When the main image is black and white, the PIP image will also appear in black and white.
- ▷ **Important:** If you move the PIP image and then turn it off, it will remain in its new position when you turn it on again.
- ▷ **Important:** Do not press the PIP button while you are watching a channel that is not receiving broadcasts.



---

## Changing the picture in the PIP image

When you first activate the PIP image, as described on the previous page, you will probably see the same picture in the small image as you do on the main image. This is because both images have the same “source.” A “source” is any signal that your TV is receiving through the antenna terminals or through the input terminals.

If you want to see a different picture in the PIP image, you need to change its channel or change its source.

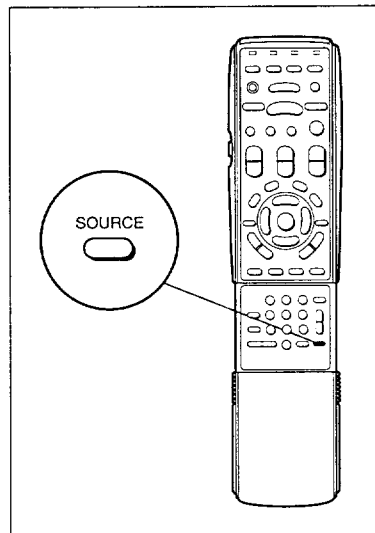

### changing the channels of the PIP image

Because your Projection TV offers “two-tuner” PIP, you do not need to change sources to view a different channel in the PIP image.

- ➊ Make sure Antenna A is the source for your PIP image.
- ➋ Press the small PIP channel button (CHANNEL) on the lower half of your remote to change the channel of the PIP image.

▷ **Important:** To use the “two-tuner” PIP, you must have made a connection to the Antenna A terminal on your Projection TV.

### changing the source of the PIP image

These instructions explain a common way to see a different source in the PIP image: using a VCR connected to Input-1 as a PIP source.

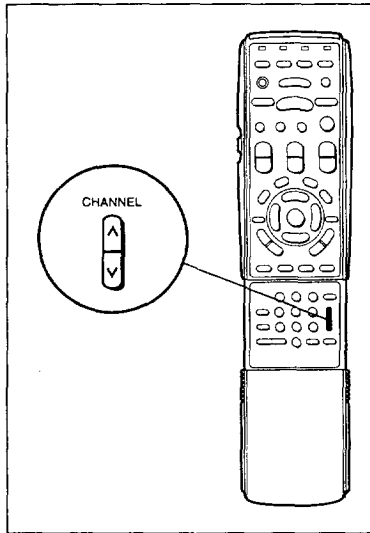

- 1 Turn your VCR on and select a channel on the VCR that is different than the channel you see on your TV screen.
- 2 Press the SOURCE button on the remote control repeatedly until the VCR picture appears in the PIP image
- 3 If you want to select a source other than the VCR, continue pressing the SOURCE button. The source will change as follows:

→TV→Input-1→Input-2→Input-3

The name of the source will appear above the PIP image.

- ▷ **Important:** You cannot select Antenna B as a PIP source when watching Antenna A.
- ▷ **Important:** To change the source of the main image while a PIP image is displayed, press the INPUT button on the control panel or on the remote control.

## Exchanging the picture and sound of the PIP image and the main image

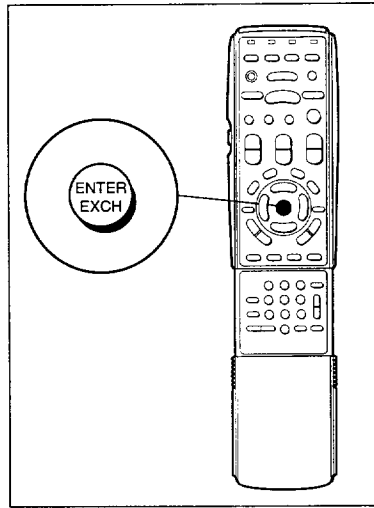

### exchanging the picture

Press the ENTER/EXCH button to exchange the picture of the main (background) image and the PIP image.

#### ► Important

DO NOT exchange images when the main image is Antenna-B and the PIP image is Antenna-A. You will not be able to exchange the images back. See page 80 in the Troubleshooting section for more information.

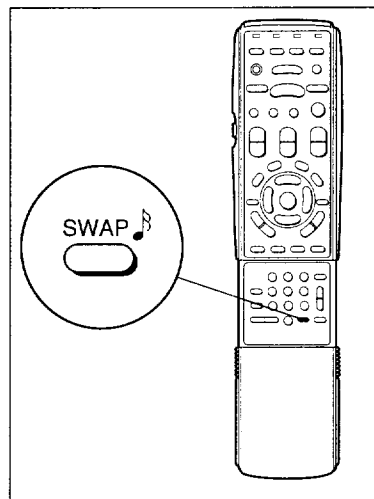
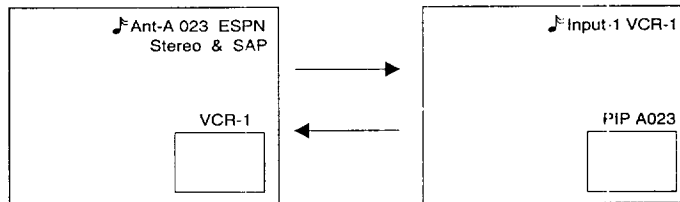

### exchanging the sound

Press the SWAP button to switch the sound of the speakers between the main image and the PIP image. The "musical note" icon indicates the image from which sound is being played.

#### ► Important:

The sound from the PIP image will not be in stereo.

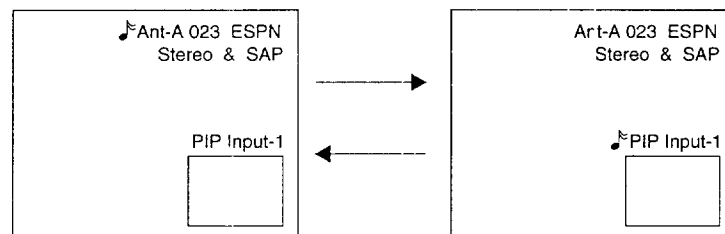

---

## Moving the PIP image

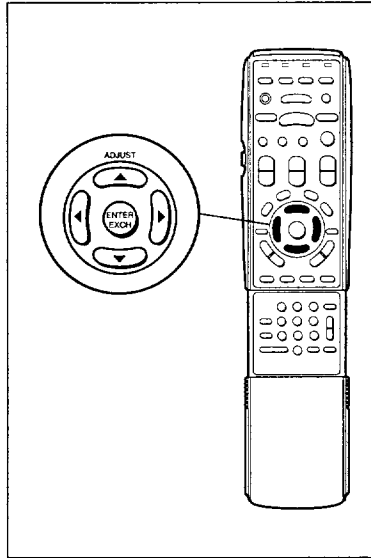

Press and hold down the ADJUST buttons to move the PIP image.

▷ **Important:** If you move the PIP image and then turn it off, it will remain in its new position when you turn it on again.

## Freezing the PIP image

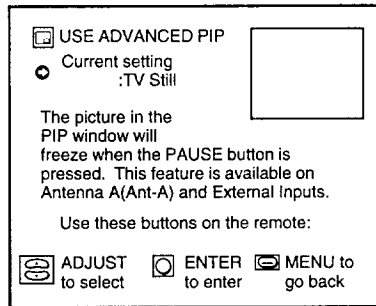

- 1 Select "Use Advanced PIP" in the Advanced Features menu and set it to "TV Still." (See "Selecting an advanced PIP function," page 58.)
- 2 Use the MENU button to return to the normal picture.
- 3 Press the PAUSE button to freeze the PIP image on the screen.
- 4 Press PAUSE again to return to a live picture.

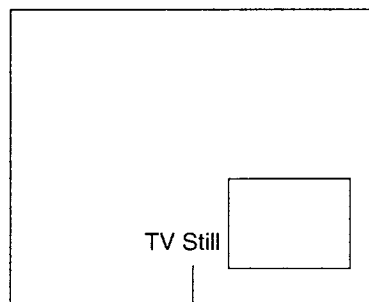
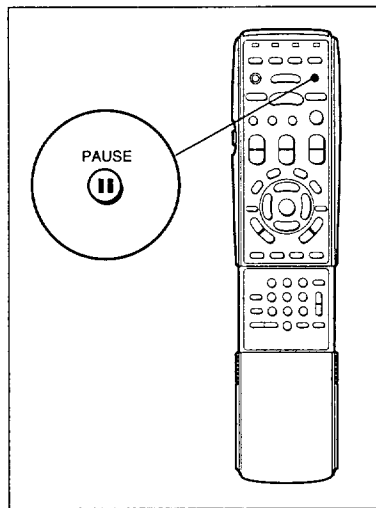

disappears after a few seconds

## Using the Snap-shot feature

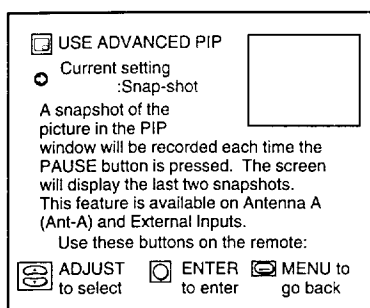

1 Select "Use Advanced PIP" in the Advanced Features menu and set it to "Snap-shot." (See "Selecting an advanced PIP function," page 58.)

2 Use the MENU button to return to the normal picture.

3 Press the PAUSE button once; a frozen PIP image and a moving PIP image will appear.

4 Press the PAUSE button again; a third PIP image will appear, moving. The previous two PIP images will be frozen.

5 Each time you press the PAUSE button, the PIP images will shift upwards one by one: the top image will be replaced by the second image, the second image will be replaced by the third, and a new moving image will appear in the third space.

6 To cancel the PIP image, press the PIP button.

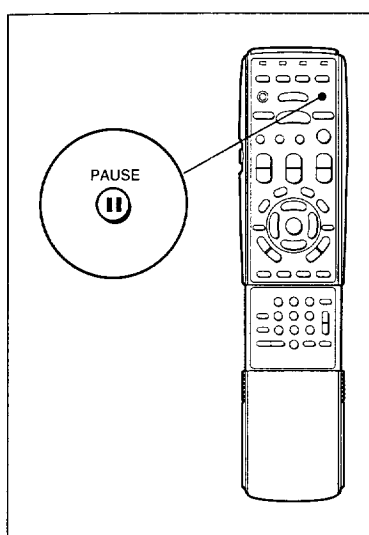

### if the PIP image is off

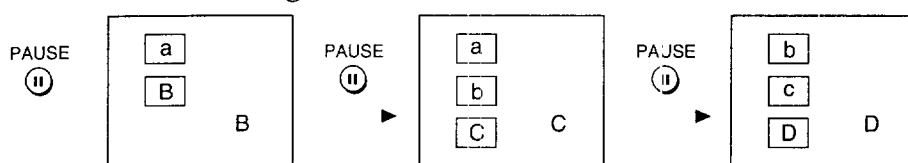

### if the PIP image is on

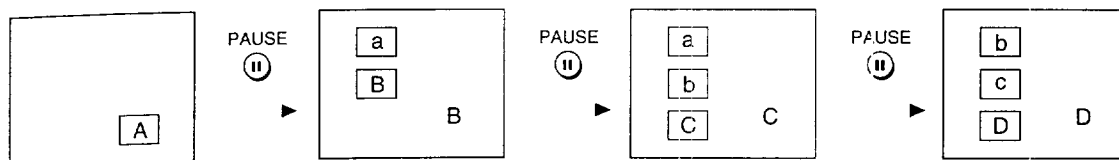

\*A, B, C, D: the moving images

\*a, b, c, d: the frozen images of A, B, C, and D at the instant the PAUSE button is pressed.

## Using the Replay feature

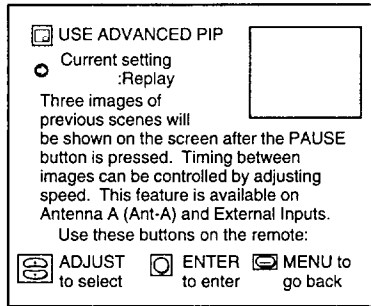

1 Select "Use Advanced PIP" in the Advanced Features menu and set it to "Replay." (See "Selecting an advanced PIP function," page 58.)

2 Set the replay speed between 1 (short interval) and 9 (long interval).

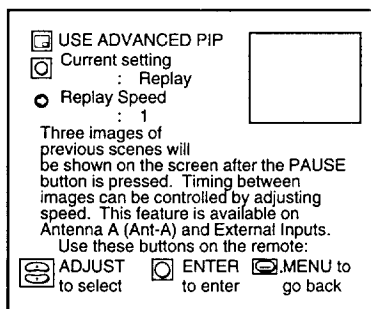

3 Use the MENU button to return to the normal picture.

4 Press the PAUSE button. The TV will memorize six frames of video from the main image and display the first three of these frames as PIP images. (The interval between the frames is determined by the replay speed set in step 2.)

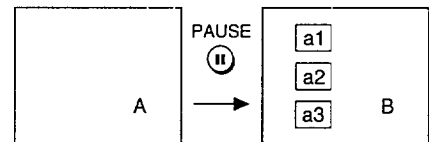
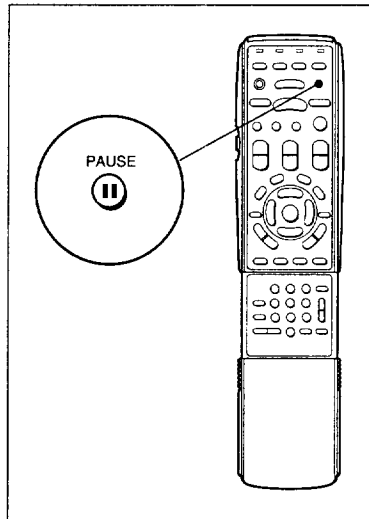

5 Each time you press the PAUSE button, the memorized frames will shift upwards.

6 To cancel the PIP images, press the PIP button.

\*a1 - a6 : memorized frames

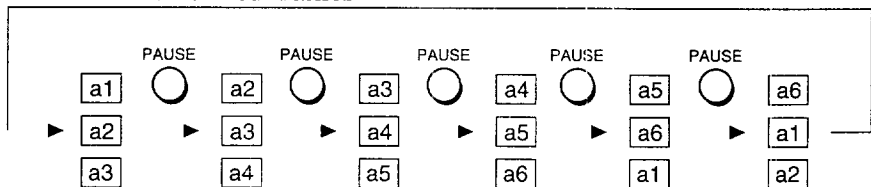

the TV will automatically turn off.

► **Important:** If you turn the TV off while it is set to Input-1, it will return to its previous antenna and channel setting when you turn it back on.

## ◆ Using the Active A/V Network Feature

---

The A/V Network is a special feature that makes it easier to use your Projection TV and your other Mitsubishi A/V components together. When you connect the A/V Network, you can point the remote control at the Projection TV, and it will “pass” the remote control command to the other components.

Additionally, if you have a Mitsubishi VCR with Active A/V Network, it is easier and faster VCR’s play command (Auto Play).

- ▷ **Important:** The A/V Network is only available for select Mitsubishi components. If you subscribe to StarSight, “Auto Play” is not available.

### before you begin

- ✓ You must have connected an A/V Network cable from the Active A/V Network terminal of your Projection TV to the A/V Network IN terminal of your VCR. See **Booklet #1, “Mitsubishi Installation and Setup Guide.”**
- ✓ You must have connected your VCR to Input 1 of your TV.
- ✓ You must have set your Projection TV’s “A/V Network” setting to “Active” or “Basic.” See “Setting the A/V Network,” page 32.
- ✓ Your VCR’s remote control switch should be set to “VCR-A.”
- ✓ Your VCR’s video mute setting should be turned ON.

- ▷ **Important:** When using the Active A/V Network, you should always point your remote control at your Projection TV.

### using Auto Play

When you press PLAY on the remote:

- ✓ Active A/V Network will turn your VCR on and begin playing the tape (if any).
- ✓ Active A/V Network will turn your TV on and switch it to INPUT-1.

When you turn your Projection TV off:

- ✓ If your TV has been set to “Active,” your VCR will turn off, unless it is playing or recording.

- ▷ **Important:** If you leave the Projection TV turned on and:
- it is set to Input-1, and
  - it does not receive a signal for five minutes, and
  - you do not use the menus for five minutes, then:
- the TV will automatically turn off.

- ▷ **Important:** If you turn the TV off while it is set to Input-1, it will return to its previous antenna and channel setting when you turn it back on.







Even though you're now familiar with the basic and advanced operations of the Projection TV, you may run into trouble from time to time as you become accustomed to the Projection TV. This chapter offers solutions to some of the common problems you may encounter. We suggest that you consult this chart before contacting a Mitsubishi service representative.

---

## Troubleshooting (cont.)

---

<b>Problems</b>	<b>Possible Solutions</b>	<b>For More Information</b>
<ul style="list-style-type: none"><li>• The remote control doesn't work.</li></ul>	<ul style="list-style-type: none"><li>• Check that the batteries are installed correctly.</li><li>• Check that the select button is set to "TV."</li><li>• Be sure that you are pointing the tip of the remote control toward the TV from a distance of no more than 20 feet.</li></ul>	<ul style="list-style-type: none"><li>• See "Getting ready to use the remote control" in Chapter 1 for an explanation of how to install batteries in the remote control.</li><li>• See "Remote control buttons and functions" in Chapter 1, which explains where the select buttons are located.</li><li>• See "Getting ready to use the remote control" in Chapter 1, which contains pointers for using the remote control.</li></ul>
<ul style="list-style-type: none"><li>• The TV takes several seconds to respond to button commands.</li></ul>	<ul style="list-style-type: none"><li>• Use the ENTER button to avoid delays.</li></ul>	<ul style="list-style-type: none"><li>• See "Changing channels" in Chapter 2, which explains the function of the ENTER button.</li></ul>
<ul style="list-style-type: none"><li>• You can't access a channel.</li></ul>	<ul style="list-style-type: none"><li>• Be sure that the channel you want to view is programmed into memory.</li><li>• Check that the TV is tuned to the correct input source (antenna) for that channel.</li></ul>	<ul style="list-style-type: none"><li>• See "Memorizing channels" in Chapter 2, which explains how to program channels into the TV's memory.</li><li>• See "Selecting the input source" in Chapter 2, which explains how to change the input source.</li></ul>
<ul style="list-style-type: none"><li>• You can't see a different channel in the reduced PIP image.</li></ul>	<ul style="list-style-type: none"><li>• Use the SOURCE button to change the source of the PIP image.</li><li>• Make sure you have a second source, such as a VCR, turned on and connected to your TV.</li></ul>	<ul style="list-style-type: none"><li>• See "Using the Advanced Picture-in-Picture (PIP) Modes" on page 66.</li></ul>

<b>Problems</b>	<b>Possible Solutions</b>	<b>For More Information</b>
<ul style="list-style-type: none"> <li>On-screen displays appear each time you adjust a function.</li> </ul>	<ul style="list-style-type: none"> <li>This is part of the normal operation of the TV.</li> </ul>	<ul style="list-style-type: none"> <li>See “Understanding the On-Screen Displays” in Chapter 3 for a full explanation of the on-screen displays.</li> </ul>
<ul style="list-style-type: none"> <li>There’s no sound even when the volume is turned up.</li> </ul>	<ul style="list-style-type: none"> <li>Check that the MUTE button isn’t on.</li> <li>The TV’s “Listen to:” setting may be set to “separate audio program” (SAP) or the “speaker” setting may be set to the wrong setting.</li> </ul>	<ul style="list-style-type: none"> <li>See “Remote control buttons and functions” in Chapter 1, which explains the use of the MUTE button.</li> <li>See “Adjusting the sound” in Chapter 2, which explains how to adjust the “Listen to” and “speaker” settings.</li> </ul>
<ul style="list-style-type: none"> <li>You forget the code you used to set the parental lock.</li> </ul>	<ul style="list-style-type: none"> <li>Use the alternate procedure that doesn’t require the use of the code.</li> </ul>	<ul style="list-style-type: none"> <li>See the Appendix, “Procedure for Bypassing the Parental Lock.”</li> </ul>
<ul style="list-style-type: none"> <li>You can’t program the Projection TV to turn on automatically.</li> </ul>	<ul style="list-style-type: none"> <li>The Projection TV may be locked.</li> </ul>	<ul style="list-style-type: none"> <li>See “Using the parental lock” under “Using the Advanced Features” in Chapter 2.</li> </ul>
<ul style="list-style-type: none"> <li>The sound doesn’t match the image on screen.</li> </ul>	<ul style="list-style-type: none"> <li>The TV’s “Listen to:” setting may be set to “separate audio program” (S.A.P.).</li> <li>You may have “swapped” the sound with the PIP image.</li> </ul>	<ul style="list-style-type: none"> <li>See “Adjusting the sound” in Chapter 2, which explains how to adjust the “Listen to” setting.</li> <li>See “Using the Advanced Picture-in-Picture (PIP) Modes” on page 66.</li> </ul>
<ul style="list-style-type: none"> <li>There is a large black rectangle on the screen.</li> </ul>	<ul style="list-style-type: none"> <li>The TV has been set to “text” mode, but there is no text information being broadcast.</li> </ul>	<ul style="list-style-type: none"> <li>See “Using the closed caption decoder” under “Getting started” in Chapter 2.</li> </ul>

---

## Troubleshooting (cont.)

<b>Problems</b>	<b>Possible Solutions</b>	<b>For More Information</b>
<ul style="list-style-type: none"><li>You have problems when you “exchange” the picture of the PIP image and the main image.</li></ul>	<ul style="list-style-type: none"><li>You should not exchange the images when the main image is Antenna-B and the PIP image is Antenna A. If you do, you must press the INPUT button to return to viewing Antenna B.</li></ul>	<ul style="list-style-type: none"><li>See “Using the Advanced Picture-in-Picture (PIP) Modes” on page 66.</li></ul>
<ul style="list-style-type: none"><li>Antenna-B does not appear as a PIP source.</li></ul>	<ul style="list-style-type: none"><li>Antenna B is not available as a PIP source when you are watching Antenna A.</li></ul>	<ul style="list-style-type: none"><li>See “Using the Advanced Picture-in-Picture (PIP) Modes” on page 66.</li></ul>
<ul style="list-style-type: none"><li>You cannot see a picture when you play a tape in the VCR.</li></ul>	<ul style="list-style-type: none"><li>If you connected your VCR with A/V cables, use the INPUT button to select the input (Input 1, 2, or 3) that the VCR is connected to.</li></ul>	<ul style="list-style-type: none"><li>See “Selecting the input source” for an explanation about changing the input.</li></ul>
<ul style="list-style-type: none"><li>The colors in the Projection TV’s picture are not aligned.</li></ul>	<ul style="list-style-type: none"><li>The colors in the Projection TV’s picture tubes may have become misaligned. You will need to align the colors yourself.</li></ul>	<ul style="list-style-type: none"><li>See “Adjusting the color alignment” in Chapter 2, which explains how to align the colors.</li></ul>
<ul style="list-style-type: none"><li>It takes several seconds for the cable box to change channels.</li></ul>	<ul style="list-style-type: none"><li>This is normal. It takes several seconds for the infrared (IR) emitter to pass the remote control signals to the cable box.</li></ul>	

---

## Cleaning

Normally, light dusting with a non-scratching duster will keep your TV clean.

If you want to wipe down your TV, turn it off and unplug it. Then, wipe it gently with a soft cloth slightly moistened with water. You can add a few drops of mild liquid detergent to the water for oily dirt on the cabinet **ONLY**.

When cleaning the screen, wipe up-and-down, going with the grain of the screen.

**DO NOT** allow liquid to enter the TV through the ventilation slots.

**DO NOT** use strong or abrasive cleaners.

**DO NOT** use spray liquids or cleaners directly on the TV's surface.

**DO NOT** scrub or rub the TV harshly. Wipe gently.

**DO NOT** use cleaners or detergent on the Projection TV's screen.

---

## Caution and care

- **Warning:** Don't leave stationary images on-screen for more than 10 minutes. These images can scar the Projection TV, causing permanent damage to the picture tubes. Some examples of stationary images include the following:
- stock-market reports,
  - station logos (especially bright ones),
  - video game displays,
  - shopping channel displays,
  - the television's own on-screen displays.

- ▷ **Important:** If you plan to place speakers next to the Projection TV, make sure they are magnetically shielded. Ordinary speakers will cause distortion in the picture due to their strong magnets. This distortion, however, will not harm the picture tubes.

For maximum enjoyment and safe operation of your Mitsubishi Color TV, please read the "IMPORTANT SAFEGUARDS" carefully and apply them properly. (Please see **Booklet #1, "Mitsubishi Installation and Setup Guide."**)

- ▷ **Important:** When you are disconnecting AV cables from the front control panel, be careful not to hit or scratch the front of your Projection TV. (TS-5087, TS-5089 only)

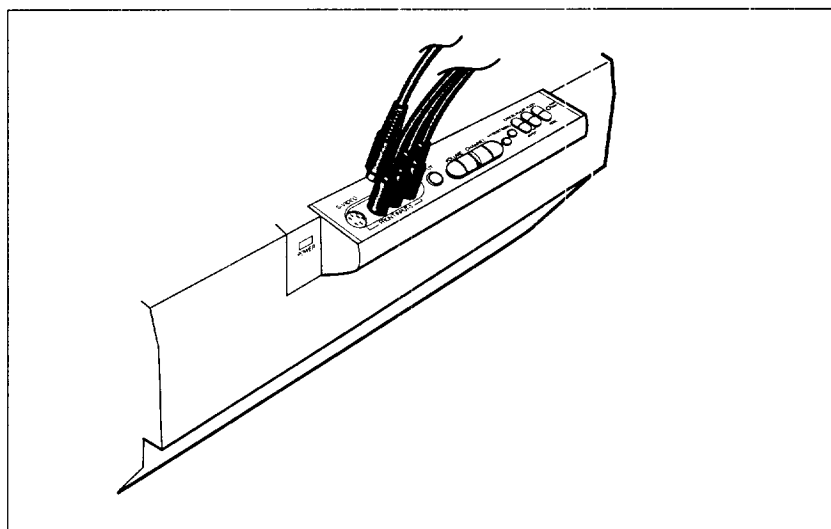

---

## Calling for service

If you are unable to correct a problem with your Projection TV, consult your Mitsubishi dealer or Mitsubishi Authorized Warranty Service Center.

Do not adjust any controls not described in this owner's guide.

Do not remove the protective back cover of this unit.

If you see one of the following display on your screen, you should not change any settings. These are special displays used by the factory.

FACTORY MENU			
Initial	: OFF	E2 Initial	: ON
Hotel	: OFF	3Dia	: ON
Power Restore	: OFF	Speaker Ext	: ON
Antenna	: 2	3D Y/C	: ON
Input	: 3	[CC]	: ON
When muting	: ON	Auto clock	: ON
		Woofers	: OFF
		SS ATTACH	: ON
Firmware Version Number 1.04			

OPTION MENU	
Initial	: OFF
Hotel	: OFF
Power Restore	: OFF
Antenna	: 2
Input	: 3
When muting	: ON

If these displays appear, make sure that all of the on/off settings are the same as the illustrations above and then turn the Projection TV off. If any of the settings are different from the illustrations above, turn the Projection TV off and consult your Mitsubishi dealer or Mitsubishi Authorized Warranty Service Center.

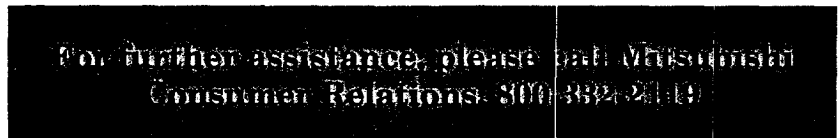







Cut along dotted line and file after reading.

---

After you set the lock, you will need the secret code in order to:

- view a locked channel,
- view the locked TV, or
- cancel the lock.

If you forget the code, you can view the locked TV without entering the code. To do this, simply press the buttons on your remote labeled “QV” and “9” at the same time whenever your secret code is requested.

▷ **Important:** Unlocking with this procedure is only temporary. To cancel the lock completely, follow the procedure below:

- ➊ Turn on your Projection TV. If the TV requests your secret code, press the “QV” button and the “9” button on the remote control at the same time.
- ➋ Press the MENU button to view the main menu. Use the ADJUST buttons to select “Advanced Features.” Press ENTER.
- ➌ Use the ADJUST buttons to select “Use Parental Lock.” Press ENTER.
- ➍ Press the “QV” button and the “9” button on the remote control at the same time, instead of entering the code.
- ➎ If you were using “lock by time,” press the CANCEL button to turn off the lock.
- ➏ If you were using “lock by channel,” use the ADJUST buttons to place the cursor next to the channel whose lock you want to turn off. Press ENTER.
- ➐ Press the CANCEL button to unlock that channel, or use the ADJUST buttons to change the channel to a new one.
- ➑ Press the MENU button to return to the “Advanced Features” menu.

▷ **Important:** You must use the remote control included with this Projection TV. You cannot use a remote control from another Mitsubishi component, and you cannot use any “Universal” remotes from other manufacturers.



<b>A</b>			
A/V functions, locking .....	40	channel(s)	
A/V Network		adding .....	31
active .....	75	changing .....	22
setting .....	32	controls .....	3, 9
A/V receiver, operating with		deleting .....	31
remote .....	18, 19	lock .....	52
A/V reset button .....	3	memorizing .....	26
Active A/V Network .....	75	naming .....	39
adding channels .....	31	cleaning .....	81
adjust buttons .....	4, 9, 11	clock, setting .....	28
adjusting the color		closed caption .....	44, 46
alignment .....	34	codes	
advanced menu .....	36	cable box .....	17
advanced PIP functions .....	58	VCR .....	16
advanced PIP modes .....	66	color .....	44
alignment, color .....	34	color alignment .....	34
Ant-A, Ant-B .....	21	color temperature .....	44
audio		contrast .....	44
adjusting .....	41	control panel, overview .....	2
function button .....	4, 11		
input terminal .....	3	<b>D</b>	
resetting .....	59	day button .....	11
Auto Play .....	75	deleting channels .....	31
AUX button .....	9	display button .....	9
		displays, on-screen .....	62
		<b>E</b>	
		enter button .....	3, 9, 11
		exchange button .....	9, 11, 70
		external .....	42
		<b>F</b>	
		fixed .....	42
		front panel, overview .....	2
		<b>G</b>	
		Getting to Know Your	
		Projection TV .....	1
		guide button .....	11
		<b>H</b>	
		hall .....	41
		home button .....	9
		<b>I</b>	
		information button .....	11
		Input-1, Input-2, Input-3 .....	21
		input	
		audio .....	3
		button .....	3, 9
		renaming .....	38
		S-video .....	2
		selecting .....	21
		video .....	3
		installing batteries .....	5
		internal .....	42
		<b>L</b>	
		laserdisc, operating with	
		remote .....	17, 18
		light button .....	9
		list button .....	11
		listen to .....	41
		lock .....	50-53
		bypassing .....	85
		locking A/V functions .....	40
		<b>M</b>	
		memorizing channels .....	26
		menu button .....	3, 9
		menu type .....	36
		menus, understanding .....	25
		monitor out .....	42
		mono .....	41
		moving PIP .....	71
		mute control .....	9
<b>B</b>			
balance .....	41		
bass .....	41		
batteries, installing .....	5		
brightness .....	44		
buttons, remote control .....	7		
bypassing the lock .....	85		
<b>C</b>			
cable box			
codes .....	17		
operating with remote .....	16, 17		
cancel button .....	3, 9		
caution and care .....	82		
CC .....	46		
center channel .....	42		

## N

- naming the channels ..... 39
- number buttons ..... 11

## O

- off-timer ..... 63
- off-timer button ..... 11
- on-screen displays ..... 62
- on/off, turning the TV ..... 20
- Operating Your
  - Projection TV ..... 13
- overview
  - control panel ..... 2
  - remote control ..... 5

## P

- page button ..... 11
- parental lock ..... 50
- pause button ..... 11
- picture
  - adjusting ..... 44
  - resetting ..... 59
- PIP
  - activating ..... 67
  - advanced functions ..... 58
  - advanced modes ..... 66
  - button ..... 11
  - changing picture ..... 68
  - channel button ..... 11
  - exchanging
    - picture/sound ..... 70
  - freezing ..... 72
  - moving ..... 71
  - replay ..... 74
  - snap-shot ..... 73
- power button ..... 2, 9
- power indicator ..... 2
- program timer indicator ..... 2

## Q

- quick view
  - button ..... 9
  - using ..... 24

## R

- remote control
  - about ..... 15
  - buttons ..... 7
  - operating audio
    - component ..... 18, 19
  - operating cable box .... 16, 17
  - operating VCR ..... 15, 16
  - overview ..... 5
- renaming the inputs ..... 38
- replay ..... 58, 74
- resetting sound and
  - picture ..... 59

## S

- S-video input terminal ..... 2
- SAP ..... 41
- select buttons ..... 9
- service ..... 83
- setting the clock ..... 28
- sharpness ..... 44
- simulate ..... 41
- snap-shot ..... 58, 73
- sound
  - adjusting ..... 41
  - resetting ..... 59
- source button ..... 11, 69
- speaker ..... 42
- standard menu ..... 36
- StarSight
  - controls ..... 11
  - Telecast, Inc. .... 1
- stereo ..... 41
- still ..... 58, 72
- super quick view
  - button ..... 9
  - using ..... 24
  - with StarSight ..... 56
  - without StarSight ..... 54
- surround ..... 41
- swap button ..... 11, 70

## T

- test buttons ..... 4
- test screen ..... 34
- text ..... 46
- theme button ..... 11
- time
  - lock ..... 51
  - setting ..... 28
- timer reset button ..... 4
- timer, setting ..... 49
- tint ..... 44
- treble ..... 41
- troubleshooting ..... 77
- TV button ..... 9

## U

- understanding on-screen
  - displays ..... 62
- understanding the menus... 25

## V

- variable ..... 42
- VCR-A, VCR-B button ..... 9
- VCR
  - codes ..... 16
  - operating with
    - remote ..... 15, 16
- video
  - adjusting ..... 44
  - function button ..... 4, 11
  - input terminal ..... 3
  - resetting ..... 59
- ViewPoint III ..... 25
- volume control ..... 3, 9

## W

- wake-up timer ..... 49

**mitsubishi**  
**PROJECTION TELEVISION**  
**LIMITED WARRANTY**

MITSUBISHI CONSUMER ELECTRONICS AMERICA, INC. ("MCEA") warrants to the original purchaser of this television that if purchased from an authorized MITSUBISHI Audio/Video Dealer, should it prove defective by reason of improper workmanship and/or material:

a. **Parts.** The lenticular (i.e. front picture) screen is warranted against defects in materials and workmanship for a period of 30 days. All other parts are warranted for a period of one year from the date of the original purchase at retail. We will repair or replace, at our option, any defective part without charge for the part. Parts used for replacement are warranted for the remainder of the original warranty period.

b. **Labor.** For 30 days after the original purchase at retail, we will repair or replace, at our option, the lenticular screen if it proves defective. For all other parts, we will provide the labor for a warranty repair by an authorized MITSUBISHI service center without charge for one year from the date of original purchase at retail.

c. **Notice.** To obtain warranty service, you must notify an authorized MITSUBISHI service center of any defect within the applicable warranty time period.

1. TO OBTAIN WARRANTY SERVICE:

a. Contact your nearest authorized MITSUBISHI service center whose name and address can be obtained from your MITSUBISHI dealer or by writing or calling MELA at the address and telephone number provided below.

b. Warranty service will be provided in your home or, if required, at an authorized service shop, provided that your television is located within the geographic territory customarily covered by an authorized MITSUBISHI service center. If not, you must either deliver your television to an authorized service location at your own expense, or pay for any travel and/or transportation costs the service center may charge to and from your home. Actual service labor will be provided without charge.

c. Proof of purchase date from an authorized MITSUBISHI dealer is required when requesting warranty service. Present your sales receipt or other document which establishes proof and date of purchase. **THE RETURN OF THE OWNER REGISTRATION CARD IS NOT A CONDITION OF WARRANTY COVERAGE.** However, please return the Owner Registration Card so that we can contact you should a question of safety arise which could affect you.

2. THIS WARRANTY DOES NOT COVER damage caused by: modification, alteration, repair or service of the product by anyone other than an authorized MITSUBISHI service center; physical abuse to, or misuse of, the product; operation in a manner contrary to the instructions which accompany the product; freight damage; or any damage caused by acts of God such as lightning or fluctuation in electrical power. This warranty also excludes all costs arising from installation, adjustment of user controls, external antenna systems, service of products purchased or serviced outside the U.S.A., initial technical adjustments (set-up) and user-required maintenance. Consult the operating instructions furnished with the product for information regarding user controls.

3. ANY EXPRESS WARRANTY NOT PROVIDED HEREIN, AND ANY REMEDY WHICH, BUT FOR THIS PROVISION, MIGHT ARISE BY IMPLICATION OR OPERATION OF LAW, IS HEREBY EXCLUDED AND DISCLAIMED. THE IMPLIED WARRANTIES OF MERCHANTABILITY AND OF FITNESS FOR ANY PARTICULAR PURPOSE ARE EXPRESSLY LIMITED TO A TERM OF ONE YEAR.

4. UNDER NO CIRCUMSTANCES SHALL MELA BE LIABLE TO PURCHASER OR ANY OTHER PERSON FOR ANY INCIDENTAL, SPECIAL OR CONSEQUENTIAL DAMAGES, WHETHER ARISING OUT OF BREACH OF WARRANTY, BREACH OF CONTRACT, OR OTHERWISE.

5. Some states do not allow limitations on how long an implied warranty lasts, or the exclusion or limitation of incidental, special, or consequential damages, so the above limitations or exclusions may not apply to you.

6. This warranty gives you specific legal rights, and you may also have other rights which vary from state to state.

7. BEFORE REQUESTING SERVICE, please review the instruction booklet to insure proper installation and correct customer control adjustment. If the problem persists, contact your nearest MITSUBISHI Dealer for name(s) of authorized MITSUBISHI Service Center(s). If you are unable to obtain this information, please call 800-332-2119, or write us at the address below.

**MITSUBISHI CONSUMER ELECTRONICS AMERICA, INC.**

PO Box 5025

Norcross, GA 30091-5025



RETAIN THIS PORTION FOR YOUR RECORDS

SERIAL NO. \_\_\_\_\_

CUSTOMER NAME \_\_\_\_\_

STREET ADDRESS \_\_\_\_\_

CITY \_\_\_\_\_ STATE \_\_\_\_\_ ZIP \_\_\_\_\_

PHONE (     ) \_\_\_\_\_ PURCHASE DATE \_\_\_\_\_ / \_\_\_\_\_ / \_\_\_\_\_

MO     DAY     YR

PLACE OF PURCHASE \_\_\_\_\_



**MITSUBISHI CONSUMER ELECTRONICS AMERICA, INC.**  
6100 Atlantic Blvd.  
Norcross, GA 30071-1305