



Refrigerator user manual

imagine the possibilities

Thank you for purchasing this Samsung product.



Free Standing Appliance

SAMSUNG

Contents

SAFETY INFORMATION	2
SETTING UP YOUR SIDE-BY-SIDE REFRIGERATOR	11
OPERATING THE SAMSUNG SIDE-BY-SIDE REFRIGERATOR	20
TROUBLESHOOTING	35

Safety information

SAFETY INFORMATION

- Before using your new Samsung Refrigerator, please read this manual thoroughly to ensure that you know how to operate the features and functions that your new appliance offers safely and efficiently.
- This appliance is not intended for use by persons (including children) with reduced physical, sensory or mental capabilities, or lack of experience and knowledge, unless they have been given supervision or instruction concerning use of the appliance by a person responsible for their safety. Children should be supervised to ensure that they do not play with the appliance.
- Because the following instructions cover various models, the characteristics of your refrigerator may differ slightly from the refrigerator described in this manual.
- If you have any question, contact us at 1-800-SAMSUNG or find help and information online at www.samsung.com.
- R-600a or R-134a is used as a refrigerant. Check the compressor label on the rear of the appliance or the rating label inside the fridge to see which refrigerant is used for your refrigerator. If this product contains flammable gas (Refrigerant R-600a), contact your local authority in regard to safe disposal of this product.
- It is hazardous for anyone other than an Authorized Service Person to service this appliance.



Warning; Risk of fire / flammable materials

Important safety symbols and precautions:



WARNING

Hazards or unsafe practices that may result in severe personal injury or death.

CAUTION

Hazards or unsafe practices that may result in minor personal injury or property damage.

	Do NOT attempt.
	Do NOT disassemble.
	Do NOT touch.
	Follow directions carefully.
	Unplug the power plug from the wall socket.

	Make sure the refrigerator is grounded to prevent electric shock.
	Call the contact center for help.
	Note.

These warning symbols are here to prevent injury to you and others. Please follow them carefully. After reading this section, keep it in a safe place for future reference.

⚠ WARNING

**STATE OF CALIFORNIA
PROPOSITION 65 WARNING
(US ONLY)**

- Cancer and Reproductive Harm - www.P65Warnings.ca.gov.

⚠ WARNING

**CRITICAL INSTALLATION
WARNINGS**

- Do not install the refrigerator in a damp location or place where it may come in contact with water.
- Deteriorated insulation on electrical parts may cause an electric shock or fire.
- Do not place this refrigerator in direct sunlight or expose it to the heat from stoves, room heaters, or other appliances.
- Do not plug several appliances into the same multiple power strip.
The refrigerator should always be plugged into its own individual electrical outlet which has a voltage rating that matches the voltage listed on the refrigerator's rating plate.
- This provides the best performance and also prevents overloading of house wiring circuits, which could cause a fire hazard from overheated wires.
- If the wall socket is loose, do not insert the power plug.
- There is a risk of electric shock or fire.
- Do not use a power cord that has cracks or

- abrasion damage along its length or at either end.
- Do not bend the power cord excessively or place heavy objects on it.
- Do not twist or tie the power cord.
- Do not hook the power cord over a metal object, place a heavy object on the power cord, insert the power cord between objects, or push the power cord into the space behind the appliance.
- When moving the refrigerator, be careful not to roll over or damage the power cord.
 - This may result in an electric shock or fire.
- Never unplug your refrigerator by pulling on the power cord.
Always grip the plug firmly and pull straight out from the outlet.
- Damage to the cord may cause a short-circuit, fire, and/or electric shock.
- Do not use aerosols near the refrigerator.
- Using aerosols near the refrigerator may cause an explosion or fire.
- Do not install this appliance near a heater or inflammable material.
- Do not install this appliance in a humid, oily, or dusty location, or in a location exposed to direct sunlight or water (rain, etc.).
- Do not install this appliance in a location where gas may leak.
 - This may result in an electric shock or fire.

- This refrigerator must be properly located and installed in accordance with the instructions in this manual before you use it.
- Connect the power plug in the proper position with the cord hanging down.
 - If you connect the power plug upside down, the wire can get cut off and cause a fire or electric shock.
- When moving the refrigerator, be careful not to roll over or damage the power cord.
 - This constitutes a fire hazard.
- Make sure that the power plug is not crushed or damaged by the back of the refrigerator.
- Keep the packing materials out of reach of children.
 - There is a risk of death from suffocation if a child puts the packing materials on his or her head.
- The appliance must be positioned so that the plug is accessible after installation.
 - Failing to do so may result in an electric shock

or fire due to electric leakage.

- You need to remove all the protective plastic film before you initially plug the product in.



- The refrigerator must be safely grounded.
- Always make sure that you have grounded the refrigerator before attempting to investigate or repair any part of the appliance. Power leakages can cause severe electric shock.
- Never use gas pipes, telephone lines, or other potential lightning attractors as an electrical ground.
- Improper use of the grounding plug can result in a risk of electric shock. If it is necessary to use an extension cord, use only a 3-wire extension cord that has a 3-blade grounding plug and a 3-slot receptacle that will accept the plug on the appliance. The marked rating of the extension cord should be AC 115-120 V, 10 A, or more. If a grounding adapter is used, make sure the receptacle box is fully grounded.
- Plug the power plug into the wall socket firmly. Do not use a damaged power plug, damaged power cord, or loose wall socket.
- This may result in an electric shock or fire.



- If the power cord is damaged, have it replaced immediately by the manufacturer or one of its service agents.
- The wall socket must be easily accessible so that the appliance can be quickly disconnected from the wall socket in an emergency.
- It must be outside the area of the rear of the appliance.
- When positioning the appliance, ensure the power cord is not trapped or damaged.
- Do not locate multiple portable socket-outlets or portable power supplies at the rear of the appliance.
- Keep ventilation openings, in the appliance enclosure or in the built-in structure, clear of obstruction.
- Connect to potable water supply only.
- Do not store explosive substances such as aerosol cans with a flammable propellant in this appliance.

CAUTION

INSTALLATION CAUTIONS





- Allow sufficient space around the refrigerator and install it on a flat surface.
- Keep the ventilation space in the appliance enclosure or mounting structure clear of obstructions.
- Allow the appliance to stand for 2 hours before loading foods after installation and turning on.
- We strongly recommend you have a qualified technician or service company install the refrigerator.
- Failing to do so may result in an electric shock, fire, explosion, problems with the product, or injury.

WARNING

CRITICAL USAGE WARNINGS



- Do not insert the power plug into a wall socket with wet hands.
- Do not store articles on the top of the appliance.
- When you open or close the door, the articles may fall and cause personal injury and/or material damage.
- Do not insert hands, feet or metal objects (such as knives, etc.) into the bottom or the back of the refrigerator.
- This may result in an electric shock or injury.
- Any sharp edges may cause a personal injury
- Do not put a container filled with water on the refrigerator.
- If spilled, there is a risk of fire or electric shock.
- Children should be supervised to ensure that they do not play with the appliance.
- Keep fingers out of "pinch point" areas. Clearances between the doors and cabinet are necessarily small. Be careful when you open the doors if children are in the area.
- Do not let children hang on the door. A serious injury may occur.
- Do not let children go inside the refrigerator. They could become trapped.
- Do not insert your hands into the bottom area under the appliance.
- Any sharp edges may cause personal injury.
- Do not let children step on a drawer cover.
- The drawer may break and cause them to slip.
- Do not overfill the refrigerator with food.

- When you open the door, an item may fall out and cause personal injury or material damage.
 - Do not touch the inside walls of the freezer or products stored in the freezer with wet hands.
 - This may cause frostbite.
 - Never put fingers or other objects into the water dispenser hole, ice chute, or ice maker bucket.
 - It may cause personal injury or material damage.
 - Do not use or place any substances sensitive to temperature such as inflammable sprays, inflammable objects, dry ice, medicine, or chemicals near or inside the refrigerator.
 - Do not keep volatile or inflammable objects or substances (benzene, thinner, propane gas, alcohol, ether, LP gas, and other such products) in the refrigerator.
 - This refrigerator is for storing food only.
 - This may result in fire or explosion.
 - Do not store pharmaceutical products, scientific materials, or temperature sensitive products in the refrigerator.
 - Products that require strict temperature controls must not be stored in the refrigerator.
 - Do not place or use an electrical appliance inside the refrigerator, unless it is of a type recommended by the manufacturer.
 - Do not stand on top of the appliance or place objects (such as laundry, lighted candles, lighted cigarettes, dishes, chemicals, metal objects, etc.) on the appliance.
This may result in an electric shock, fire, problems with the product, or injury.
 - Do not put a container filled with water on the appliance.
 - If spilled, there is a risk of fire or electric shock.
 - Do not use mechanical devices or any other means to accelerate the defrosting process, other than those recommended by the manufacturer.
 - Do not damage the refrigerant circuit.
 - Do not spray volatile material such as insecticide onto the surface of the appliance.
 - As well as being harmful to humans, it may also result in an electric shock, fire, or problems with the product.
 - Never stare directly at the UV LED lamp for long periods of time.
 - This may result in eye strain due to the ultraviolet rays.
-
- Do not use any fuse (such as cooper, steel wire, etc.) other than a standard fuse.
 - If your appliance needs to be repaired or reinstalled, contact your nearest service center.
 - Failing to do so may result in an electric shock, fire, problems with the product, or injury.
 - If the interior or exterior LED lamp has gone out, please contact your nearest service center.
-
- 
 - Children should be supervised to ensure that they do not play with the appliance.
 - Keep fingers out of "pinch point" areas. : Clearances between the doors and cabinet are necessarily small.
Be careful when you open the doors if children are in the area.
 - Do not let children hang on the door.
A serious injury may occur.
 - Do not let children go inside the refrigerator.
They could become trapped.
 - Bottles should be stored tightly together so that they do not fall out.
 - This product is intended only for the storage of food in a domestic environment.
 - If a gas leak is detected, avoid any naked flames or potential sources of ignition, and air the room in which the appliance is standing for several minutes.
 - Do not touch the appliance or power cord.
 - Do not use a ventilating fan.
 - A spark may result in explosion or fire.
 - Use only the LED Lamps provided by the manufacturer or its service agents.
-
- 
 - If the refrigerator emits a burning smell or smoke, unplug the refrigerator immediately and contact your Samsung Electronics service center.
 - If you experience difficulty changing a non-LED light, contact a Samsung service center.
 - If the product is equipped with LED Lamps, do not disassemble the Lamp Covers and LED Lamps yourself.
 - Please contact your service agents.
 - If dust or water enters the refrigerator, unplug the refrigerator and contact your Samsung Electronics service center.
 - There is a risk of fire.



- Do not attempt to repair, disassemble, or modify the appliance yourself.

CAUTION

USAGE CAUTIONS



- Do not re-freeze frozen foods that have thawed completely.
Do not place carbonated or fizzy drinks in the freezer compartment.
Do not put bottles or glass containers in the freezer.
- When the contents freeze, the glass may break and cause personal injury.
- Use only the ice maker provided with the refrigerator.
- Have the refrigerator's water supply connected only to a potable water supply.
To operate the ice maker properly, water pressure of 20 ~ 125 psi (138 ~ 862 kPa) is required.
If you will be away from home for a long period of time (on vacation, for example) and won't be using the water or ice dispensers, close the water valve.
- Otherwise, water leakage may occur.
- If you won't be using the refrigerator for a very long period of time, (3 weeks or more) empty the refrigerator including ice bucket, unplug it, close the water valve, wipe excess moisture from the inside walls, and leave the doors open to prevent odors and mold.



- Service Warranty and Modification.
- Any changes or modifications performed by a 3rd party on this finished appliance are not covered under Samsung warranty service, nor is Samsung responsible for safety issues that result from 3rd party modifications.
- Do not block the air vents inside the refrigerator.
- If the air vents are blocked, especially with a plastic bag, the refrigerator can be over cooled. If this cooling period lasts too long, the water filter may break and cause water leakage.
- If the refrigerator is disconnected from the power supply, you should wait for at least five minutes before plugging it back in.
- If you have a long vacation planned or do not intend to use the refrigerator for a long period of time, (3 weeks or more) empty the refrigerator including ice bucket, pull out the power plug, close the water valve, wipe excess moisture from the inside walls, and leave the doors open

to prevent odors and mold.



- To get the best performance from the product:
- Do not place food too close to the vents at the rear of the appliance as it can obstruct free air circulation in the refrigerator compartment.
- Wrap food up properly or place it in airtight containers before putting it into the refrigerator.
- Do not place glass bottles or carbonated beverages into the freezer.
They can freeze and break.
Broken beverage containers can cause injury.
- Please observe maximum storage times and expiration dates of frozen goods.
- There is no need to disconnect the refrigerator from the power supply if you will be away for less than three weeks.
However, if you will be away for more than three weeks, remove all the food and ice in the ice bucket, unplug the refrigerator, close the water valve, wipe excess moisture from the inside walls, and leave the doors open to prevent odors and mold.
- Fill the water tank and ice cube trays with potable water only (tap water, mineral water, or purified water).
- Do not fill the tank with tea or a Sports drink. This may damage the refrigerator.
- Do not strike or apply excessive force to any glass surface.
- Broken glass may result in a personal injury and/or property damage.



- If the product is flooded, make sure to contact your nearest service center.
- There is a risk of electric shock or fire.
- Do not keep vegetable oil in your refrigerator's door bins. The oil can solidify, making it foul-tasting and difficult to use. In addition, the open container can leak and the leaked oil can cause the door bin to crack. After opening an oil container, it is best to keep the container in a cool and shaded place such as a cupboard or pantry.
- Examples of vegetable oil: olive oil, corn oil, grape-seed oil, etc.

CAUTION

CLEANING CAUTIONS

-  • Do not spray water directly on the inside or outside the refrigerator.
 - There is a risk of fire or electric shock.
 - Do not use a hair dryer to dry the inside of the refrigerator.
 - Do not place a lighted candle in the refrigerator to remove bad odors.
 - This may result in an electric shock or fire.
-
-  • Use a clean, dry cloth to remove any foreign matter or dust from the power plug blades.
Do not use a wet or damp cloth when cleaning the plug.
 - Otherwise, there is a risk of fire or electric shock.
-
-  • Before cleaning or performing maintenance, unplug the appliance from the wall socket.
 - Failing to do so may result in an electric shock or fire.
 - Use a clean sponge or soft cloth and a mild detergent in warm water to clean the refrigerator.
 - Do not use abrasive or harsh cleansers such as window sprays, scouring cleansers, flammable fluids, muriatic acid, cleaning waxes, concentrated detergents, bleaches, or cleansers containing petroleum products on exterior surfaces (doors and cabinet), plastic parts, door and interior liners, and gaskets.
 - These can scratch or damage the material.
 - Do not clean glass shelves or covers with warm water when they are cold. Glass shelves and covers may break if exposed to sudden temperature changes or impacts such as bumping or dropping.

WARNING

CRITICAL DISPOSAL WARNINGS

-  • **DANGER** : Risk of child entrapment.
Before you throw away your old refrigerator or freezer:
 - Take off the doors and door latch.
 - Leave the shelves in place so that children may not easily climb inside.
 - Children trapped inside a refrigerator can hurt themselves or suffocate to death.
- Please dispose of the packaging material from this product in an environmentally friendly manner.
- Ensure that none of the pipes on the back of the appliance are damaged prior to disposal.
- R-600a or R-134a is used as a refrigerant. Check the compressor label on the rear of the appliance or the rating label inside the fridge to see which refrigerant is used for your refrigerator.
If this product contains flammable gas (Refrigerant R-600a), contact your local authority in regard to safe disposal of this product.
- When disposing of this refrigerator, remove the door/door seals and door latch so that small children or animals cannot become trapped inside.
Children should be supervised to ensure that they do not play with the appliance.
If trapped inside, the child may get hurt or suffocate to death.
- Cyclopentane is used in the insulation. The gases in the insulation material require a special disposal procedure. Please contact your local authorities in regard to the environmentally safe disposal of this product.
- Keep all packaging materials well out of the reach of children, as packaging materials can be dangerous to children.
- If a child places a bag over his or her head, the child could suffocate.



ADDITIONAL TIPS FOR PROPER USAGE

- In the event of a power failure, call the local office of your Electricity Company and ask how long it is going to last.
- Most power failures that are corrected in an hour or two will not affect your refrigerator temperatures. However, you should minimize the number of door openings while the power is off.
- Should the power failure last more than 24 hours, remove and discard all frozen food.
- The appliance might not operate consistently (frozen contents can thaw or temperatures can become too warm in the frozen food compartment) when sited for an extended period of time in a location where ambient air temperatures are constantly below the temperatures for which the appliance is designed.
- In case of particular foods, keeping it under refrigeration can have a bad effect on preservation due to its properties.
- Your appliance is frost free, which means there is no need to manually defrost your appliance. This will be carried out automatically.
- Temperature rise during defrosting complies with ISO requirements.
But If you want to prevent an undue rise in the temperature of frozen food while the appliance defrosts, wrap the frozen food in several layers of newspaper.
- Do not re-freeze frozen foods that have thawed completely.

Saving Energy Tips

- Install the appliance in a cool, dry room with adequate ventilation.
Ensure that it is not exposed to direct sunlight and never put it near a direct source of heat (a radiator, for example).
- Not to block any vents and grilles is recommended for energy efficiency.
- Allow warm food to cool down before placing it in the appliance.
- Put frozen food in the refrigerator to thaw.
You can then use the low temperatures of the frozen products to cool food in the refrigerator.
- Do not keep the door of the appliance open for too long when putting food in or taking food out.
The shorter the time the door is open, the less frost build-up you'll have in the freezer.
- It is recommended to install the refrigerator with clearance to the back and sides.
This will help reduce power consumption and keep your energy bills lower.

THIS APPLIANCE IS INTENDED TO BE USED IN HOUSEHOLD AND SIMILAR APPLICATIONS SUCH AS

- staff kitchen areas in shops, offices and other working environments;
- farm houses and by clients in hotels, motels and other residential type environments;
- bed and breakfast type environments;
- catering and similar non-retail applications.

1. Regulatory Notice

1.1 FCC Notice



FCC CAUTION:

Any changes or modifications not expressly approved by the party responsible for compliance could void the user's authority to operate the equipment.

Contains Transmitter Module FCC ID: A3LSWL-B70F

This device complies with Part 15 of FCC Rules. Operation is Subject to the following two conditions:

- (1) This device may not cause harmful interference, and
- (2) This device must accept any interference received including interference that cause undesired operation.

For products available in the US and Canadian markets, only channels 1~11 are available.
You cannot select other channels.

FCC STATEMENT:

This equipment has been tested and found to comply within the limits for a Class B digital device, pursuant to part 15 of the FCC Rules. These limits are designed to provide reasonable protection against harmful interference in a residential installation.

This equipment generates, uses, and can radiate radio frequency energy and, if not installed and used in accordance with the instructions, may cause harmful interference to radio communications. However, there is no guarantee that interference will not occur in a particular installation. If this equipment does cause harmful interference to radio or television reception, which can be determined by turning the equipment off and on, the user is encouraged to try to correct the interference by one or more of the following measures:

- Reorient or relocate the receiving antenna
- Increase the separation between the equipment and receiver
- Connect the equipment to an outlet that is on a different circuit than the receiver.
- Consult the dealer or an experienced radio/TV technician for help.

FCC RADIATION EXPOSURE STATEMENT:

This equipment complies with FCC radiation exposure limits set forth for an uncontrolled environment. This equipment should be installed and operated so there is at least 8 inches (20 cm) between the radiator and your body. This device and it's antennas must not be co-located or operated in conjunction with any other antenna or transmitter except in accordance with FCC multi-transmitter product procedures.

SAVE THESE INSTRUCTIONS

1. Regulatory Notice

1.2 IC Notice

Contains Transmitter Module IC: 649E - SWLB70F

The term "IC" before the radio certification number only signifies that Industry Canada technical specifications were met. Operation is subject to the following two conditions : (1) this device may not cause interference, and (2) this device must accept any interference, including interference that may cause undesired operation of the device.

This Class B digital apparatus complies with Canadian ICES-003.

Cet appareil numérique de la classe B est conforme à la norme NMB-003 du Canada.

For products available in the US and Canadian markets, only channels 1~11 are available.
You cannot select other channels.

IC RADIATION EXPOSURE STATEMENT:

This equipment complies with IC RSS-102 radiation exposure limits set forth for an uncontrolled environment. This equipment should be installed and operated so there is at least 8 inches (20 cm) between the radiator and your body. This device and it's antennas must not be co-located or operated in conjunction with any other antenna or transmitter except in accordance with FCC multi-transmitter product procedures.

SAVE THESE INSTRUCTIONS

Setting up your side-by-side refrigerator

GETTING READY TO INSTALL THE REFRIGERATOR

Congratulations on your purchase of this Samsung Side-By-Side Refrigerator.

We hope you enjoy the state-of-art features and efficiencies that this new appliance offers.

Selecting the best location for the refrigerator

Choose:

- A location with easy access to a water supply.
- A location without direct exposure to sunlight.
- A location with a level floor.
- A location with enough space for the refrigerator doors to open easily.
- A location that provides sufficient space to the right, left, back, and top for air circulation.
- A location that allows you to move the refrigerator easily if it needs maintenance or service.
- Do not install the refrigerator in locations where the temperature is over 110 °F (43 °C) or below 50 °F (10 °C).
- Do not locate the refrigerator where it may become wet.

If the refrigerator does not have enough space, it can cause the bad influence to refrigeration efficiency and power consumption.

If your refrigerator has an ice maker, allow extra space at the back for the water line connections. When you install the refrigerator next to a fixed wall, you need a minimum clearance of 2" (50 mm) between the refrigerator and wall to allow the door to swing open.

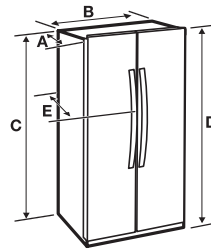

Model	RS22HDHPN**
Depth "A"	27" (687 mm)
Width "B"	35 7/8" (912 mm)
Height "C"	68 1/2" (1742 mm)
Overall Height "D"	70 1/8" (1782 mm)
Depth "E"	30" (762 mm)

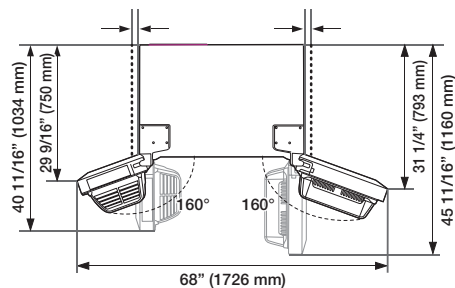

- Each measurement based on the design dimension, so it may differ depending on the measuring method.
- Make sure you disconnect the water supply line BEFORE removing the freezer door. See the next section on "Separating the Water Line" to avoid damage.

⚠ CAUTION

When moving your refrigerator

To prevent floor damage, be sure the front adjusting legs are in the up position (above the floor).

Refer to 'Leveling the Refrigerator' on page 15.

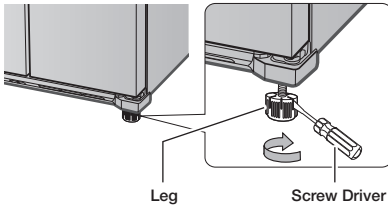

Required Tools (Not provided)

Phillips screwdriver (+)	Flat-blade screwdriver (-)	Socket wrench (13/32") (10 mm)
Allen wrench (3/16") (5 mm)		

Flooring

For proper installation, you must place this refrigerator on a level, hard surface that is the same height as the rest of the floor. This surface should be strong enough to support a fully loaded refrigerator.

To protect the finish of the flooring, cut a large section of the cardboard carton and place it under the refrigerator where you are working.

When moving the refrigerator, you need to pull and push it straight forwards or back.

Do not wiggle it from side to side.

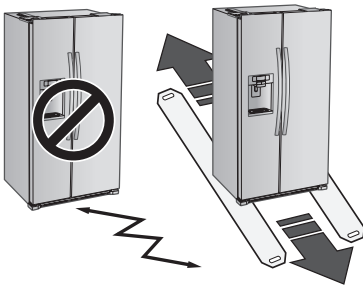

REMOVING THE REFRIGERATOR DOORS

If your entrance won't allow the refrigerator to pass easily through it, you can remove the refrigerator doors.

To remove the doors, follow the steps below. If you do not need to remove the doors, go to "Leveling the Refrigerator" on page 15.

1. Removing the front leg cover

Open both the freezer and refrigerator doors. Unscrew the three screws holding the front leg cover in place by turning them counter-clockwise. When the screws are loose, remove the front leg cover.

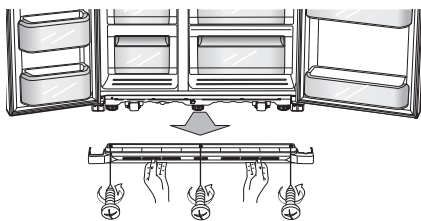

2. Separate the water supply line from the refrigerator

Remove two water lines (orange for ice and the other for water) by pressing the coupler (1) and pulling the water line (2) away.

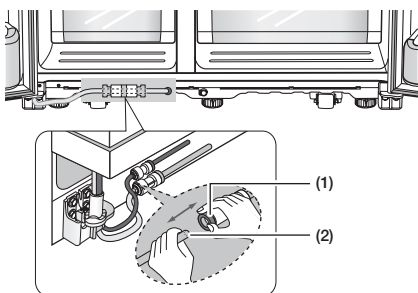

 Do not cut the water line. Gently separate it from the coupler.

3. Removing the freezer door

A few things to mention first.

- Make sure that you lift the door straight up so the hinges are not bent or broken.
- Be careful not to pinch the water tubing and wire harness on the door.
- Place doors on a protected surface to prevent scratching or damage.

1. With the Freezer door closed, remove the upper hinge cover (1) using a screwdriver, and then disconnect the wires by gently pulling them apart (2).

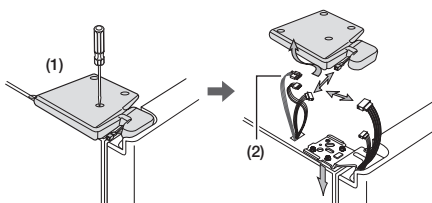

2. Remove the hinge screws (3) by turning them counterclockwise, and then take off the upper hinge (4).

Be careful that the door does not fall on you as you are removing the hinge.

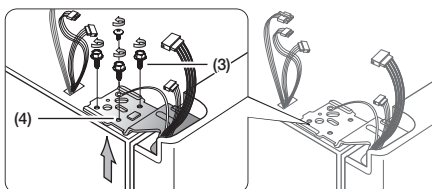

CAUTION

Be sure to keep track of all parts you are removing.

- Next, remove the door from the lower hinge (5) by carefully lifting the door straight up (6).

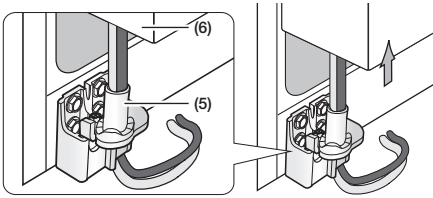

⚠ CAUTION

Be careful not to pinch the water tubing and wire harness on the door.

- Remove the lower hinge (7) from the bracket (8) by gently lifting the lower hinge upwards.

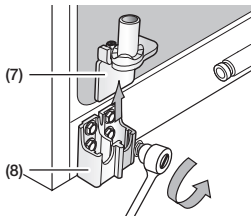

4. Remove the Fridge Door

- With the door closed, remove the upper hinge cover (1) using a screwdriver.

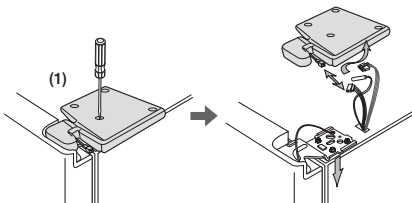

- Remove hinge screws (3) and the ground screw (2) by turning counter-clockwise, and then take off the upper hinge (4). Be careful that the door does not fall on you as you are removing the hinge.

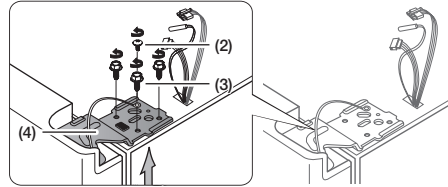

⚠ CAUTION

Be sure to keep track of all parts you are removing.

- Remove the door from the lower hinge (5) by lifting the door straight up (6).

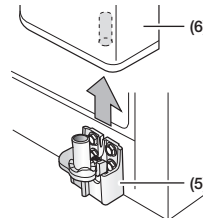

- Remove the lower hinge (7) from the bracket (8) by gently lifting the lower hinge upwards.

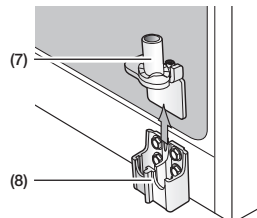

- After you have removed the Fridge and Freezer doors, move the refrigerator to its installation location.

Re-attaching the Fridge Door

To re-attach the fridge door, replace parts in reverse order.

Re-attaching the Freezer Door

To re-attach the freezer door, replace parts in reverse order.

Re-attaching the Water Supply Lines

1. The Water Lines must be fully inserted into the center of the transparent coupler to prevent water leakage from the dispenser.
2. Insert the 2 clips in the install pack as shown below, and then confirm that each clip holds the line firmly.

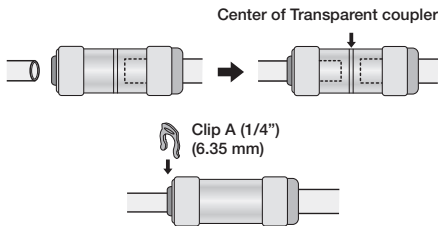

⚠ CAUTION

- Make sure the color of the water lines match.
- Keep the clips out of the reach of children and make sure that children do not play with them or put them into their mouths.

LEVELING THE REFRIGERATOR

Make sure the refrigerator is level so that you can make final adjustments.

Use a level to test if the refrigerator is level both side to side and back to front.

If the refrigerator is not level, you will not be able to get the doors perfectly even, which may cause moisture condensation and increased energy bills.



The front of the refrigerator is also adjustable.

Before levelling the refrigerator, remove the front leg cover.

Open both the freezer and refrigerator doors. Unscrew the three screws holding the front leg cover in place by turning them counter-clockwise. When the screws are loose, remove the front leg cover.

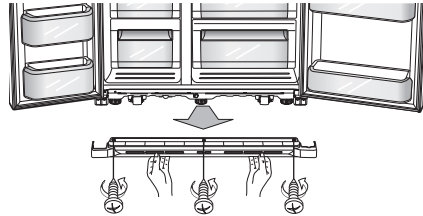

When the Freezer part is lower than the Fridge part.

Insert a flat-blade screwdriver into a slot on the Freezer Leg, then turn it clockwise.

When the Fridge part is lower than the Freezer part.

Insert a flat-blade screwdriver into a slot on the Fridge Leg, then turn it clockwise.

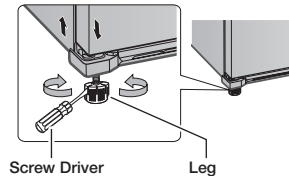

Refer to the next section for the best way to make very minor adjustments to the doors.

MAKING MINOR ADJUSTMENTS TO THE DOORS

A level refrigerator is necessary for getting the doors perfectly even.

Make sure your refrigerator is level before you begin.

If you need help leveling, review the previous section on leveling the refrigerator.

When the door of the freezer is higher than the fridge

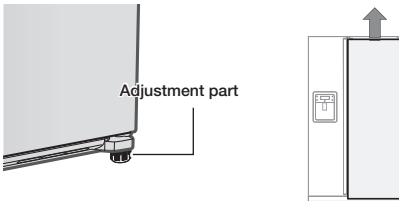

The process for adjusting each door is the same. Open the doors and adjust them, one at a time, as follows:

1. Unscrew the nut (**1**) from the lower hinge until it reaches the upper end of the bolt (**2**).

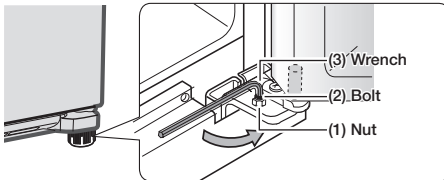

When you release the nut (**1**), make sure that you use the Allen wrench provided (**3**) to loosen the bolt (**2**) in a counter-clockwise direction. You should then be able to unscrew the nut (**1**) with your fingers.

2. Adjust the height difference between the doors by turning the bolt (**2**) clockwise (↻) or counter clockwise (↺).

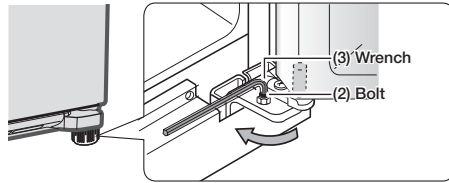

When you turn clockwise (↻), the door will move up.

3. After adjusting the doors, turn the nut (**1**) clockwise (↻) until it reaches the lower end of the bolt, then tighten the bolt again with the wrench (**3**) to fix the nut in place (**1**).

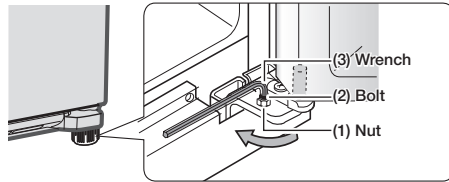

If you do not secure the nut firmly, the bolt may release.

Installing the water filter.



Before installing the water filter, please remove the top shelf.

1. Remove the water filter cover (**1**).
2. Remove the fixed cap by turning it counter clockwise.
Keep the cap in a safe place for later use if you don't use a filter.
3. Remove the water filter from the box and put a replacement indicator sticker on the filter as shown.
Place a sticker on the filter with a date six months in the future.
For example, if you install the water filter in March, put the "SEP" sticker on the filter to remind you to replace it in September.
That way you'll know when it is time to replace the filter.
Normal filter life is about 6 months.

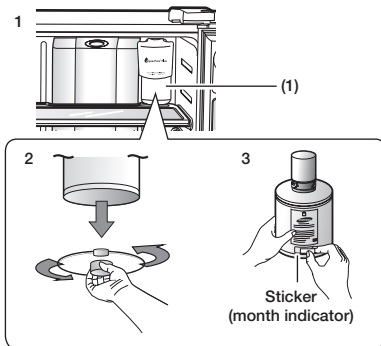

4. Remove the filter cap and insert the filter into the filter housing.
5. Slowly turn the water filter 90° clockwise to align the indicator mark on the filter with lock indicator on the filter housing.
Make sure to align the water filter label mark with the center of the lock indicator as illustrated above, right. Do not over-tighten.

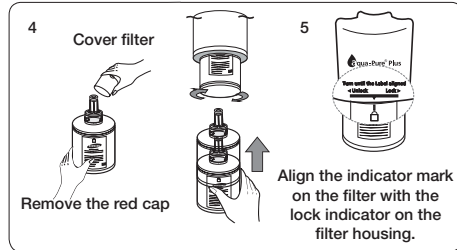

A newly installed water filter cartridge may cause water to briefly spurt from the water dispenser.
This is caused by air getting into the line.
It should pose no problem to operation.

INSTALLING THE WATER DISPENSER LINE

A water dispenser is one of the helpful features on your new Samsung Refrigerator.

To help promote better health, the Samsung water filter removes unwanted particles from your water. However, it does not sterilize or destroy microorganisms.

You may need to purchase a water purifying system to do that.

The water line also connects to the ice maker.

For the ice maker to operate properly, water pressure of 20 ~ 125 psi (138 ~ 862 kPa) is required.

If the refrigerator is installed in an area with low water pressure (below 20 psi), you can install a booster pump to compensate for the low pressure.

After you have connected the water line, make sure the water storage tank inside the refrigerator is properly filled.

To do this, press the water dispenser lever until water runs from the water dispenser.

- 
 • Water line installation kits are available at extra cost from your dealer. We recommend using a water supply kit that contains copper tubing.
- Use the new hose-sets supplied with the appliance only. Do not re-use an old hose set.

Connecting to the water supply line

1. First, shut off the main water supply line and turn the ice-maker off.
2. Locate the nearest cold water drinking water line.
3. Install the pipe clamp and shut off valve.
4. Connect the water line installation kit to the shut off valve.

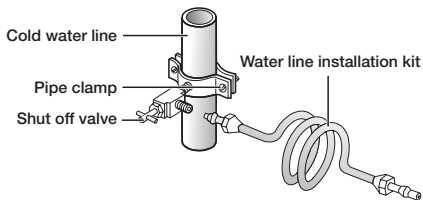

Connecting the water supply line to the refrigerator

There are several items that you need to purchase to complete this connection.

You may find these items sold as a kit at your local hardware store.

Use Copper Tubing	Use Plastic Tubing
<ul style="list-style-type: none"> • ¼" copper tubing • ¼" compression nut (1pc) • Ferrule (2pc) 	<ul style="list-style-type: none"> • ¼" plastic tubing → Molded end (Bulb) • ¼" compression nut (1pc)

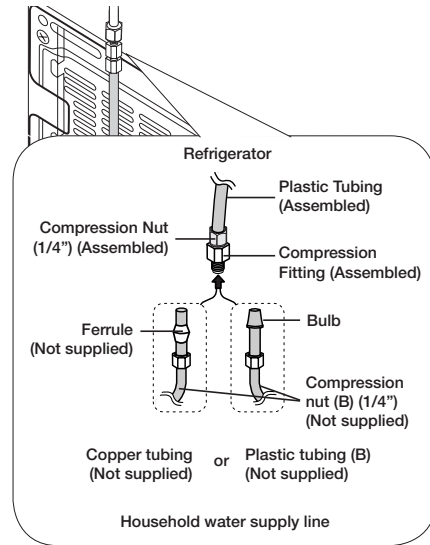

1. Connect the household water line to the assembled compression fitting.
 - If you are using copper tubing, slip the compression nut (**B**) (not supplied) and ferrule (not supplied) on the copper tubing (not supplied) as shown.
 - If you are using plastic tubing (**B**), insert the molded end (Bulb) of the plastic tubing (**B**) into the compression fitting.

CAUTION

Do not use plastic tubing (**B**) without the molded end (Bulb).

2. Tighten the compression nut (**B**) onto the compression fitting.
Do not over-tighten the compression nut (**B**).
3. Turn the water on and check for any leaks inside the refrigerator, around the water filter, and in any connection areas.

If you find water drops or leaks, turn off the main water supply.

If the leaks are in the connection areas, check the connections and, if necessary, tighten. If there are leaks in the refrigerator, check the water filter and confirm it is in the locked position.

Turn on the water supply and check for leaks again.

4. Plug in the refrigerator.
5. Flush 3 gallons of water through the filter before drinking or using the water from the refrigerator. (Flush approximately 6 minutes.)
This will clean the water supply system and remove air from the lines.

To flush, press the Water button, and then press a large glass or cup against the water dispenser lever. Fill the glass, empty it into the kitchen sink after it is filled, and then repeat.



Additional flushing may be required in some households.

6. Open the refrigerator door and make sure there are no water leaks coming from the water filter.



- After you turn on the refrigerator, let the ice maker make ice for 1 to 2 days.
Over that period of time, throw out the first 1 or 2 buckets of ice the ice maker makes to ensure all impurities have been removed from the water line.

- Only connect the water line to a drinkable water source.
- If you have to repair or disassemble the water line, cut off 1/4" of the plastic tubing to make sure you get a snug, leak-free connection.
- You can test the water line quickly using a paper cup.
Under normal conditions, the water dispenser can fill a 5.75 oz. (170 cc) cup in about 10 seconds.

COMPLETING THE SET UP

Now that you have your new refrigerator installed in place, you are ready to set up and enjoy the features and functions of the appliance.

By completing the following steps, your refrigerator should be fully operational.

1. Make sure your refrigerator is in an appropriate location with reasonable clearance between it and the wall. Refer to installation instructions in this manual.
2. Once the refrigerator is plugged in, make sure the interior light comes on when you open the doors.
3. Set the Temperature control to the coldest temperature and wait for an hour.
The freezer will get slightly chilled and the motor will run smoothly.
Reset the refrigerator and freezer to the temperatures you want.
4. After you plug the refrigerator in, it will take a few hours to reach the appropriate temperature.
You can store food and drinks in the refrigerator after the temperature is sufficiently cool.



If condensation or water drops appear on both sides of the fridge door's central part, turn the Energy Saver mode off after removing the condensation.
(See the explanation of the Energy Saver button in "Using the Control Panel" on page 20.)

Operating the SAMSUNG side-by-side refrigerator

USING THE CONTROL PANEL / DIGITAL DISPLAY

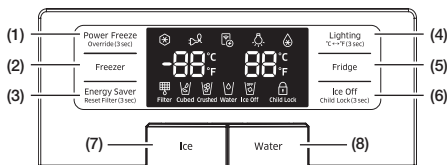

<p>(1) Power Freeze / Override (3sec)</p>	<ol style="list-style-type: none"> 1. Press the Power Freeze button to decrease the time needed to freeze products in the Freezer. This can be helpful if you need to quickly freeze items that spoil easily or if the temperature in the freezer has warmed dramatically. (For example, if the door was left open). 2. The Override function activates/deactivates Smart Grid (page 25). Press the Power Freezer/Override button for 3 seconds to set/clear the Override function.
---	---

<p>(2) Freezer</p>	<p>Press the Freezer button to set the freezer temperature. You can set the temperature between 5 °F (-15 °C) and -8 °F (-23 °C).</p>
--------------------------------------	---

<p>(3) Energy Saver / Reset Filter (3sec)</p>	<ol style="list-style-type: none"> 1. For better energy efficiency, press the Energy Saver button. If condensation occurs on the doors, press again to turn the Energy Saver Button function off. 2. When you change the water filter, press and hold this button for 3 seconds to reset the water filter indicator.
---	--

<p>(4) Lighting / °C↔°F (3sec)</p>	<ol style="list-style-type: none"> 1. Press the Lighting button to turn on the dispenser LED lamp. 2. To switch the temperature units between °C and °F, press and hold this button for 3 seconds. <p>Each time you press and hold the button for 3 seconds, the °C and °F temperature modes alternate and the °C or °F icon lights up, indicating your selection.</p>
--	--

<p>(5) Fridge</p>	<p>Press the Fridge button to set the Fridge temperature. You can set temperature between 44 °F (7 °C) and 34 °F (1 °C). The Power Cool function starts operating when you set the temperature lower than 34 °F (1 °C). If you select "Power Cool", the inside temperature of the Fridge will decrease for about two and a half hours. When the Power Cool mode exits, the notch is reset to the factory default temperature.</p>
-------------------------------------	---

<p>(6) Ice Off / Child Lock (3sec)</p>	<ol style="list-style-type: none"> 1. Press the Ice Off button to turn the ice making function off. 2. Press and hold this button for 3 seconds, to turn on the Child lock and lock all the panel buttons, including the Ice button and the dispensers. To cancel this function, press and hold this button for 3 seconds again.
--	--

<p>(7) Ice</p>	<p>Press the Ice button to choose cubed or crushed ice.</p>
----------------------------------	---

<p>(8) Water</p>	<p>Press the Water button for water.</p>
------------------------------------	--

USING THE DIGITAL DISPLAY

"Freezer Temp." indicates the current Freezer temperature.

"Fridge Temp." indicates the current Fridge temperature.

When not in use, the Display will turn off. This is normal operation.

Power Freeze

This icon lights when you activate the “Power Freeze” feature. “Power Freeze” is great for times when you need a lot of ice.

When you have enough, just press the button again to cancel the “Power Freeze” mode.



When you use this function the energy consumption of the refrigerator will increase.

Remember to turn it off when you don't need it and return the freezer to your original temperature setting.

Energy Saver

This icon lights when you activate the “Energy Saver” function.

The Energy Saver function is automatically set to “ON” when power is supplied to the Refrigerator. If condensation appears on the doors, turn the Energy Saver function off.

E-Smart

The E-Smart icon lets you check the status of the refrigerator's AP connection (network connection).

- When connected to an AP: The E-Smart icon is on.
- When not connected to an AP: The E-Smart icon is off.

Lighting

This icon lights when you activate the “Lighting” feature. When the icon is lit, the dispenser light (under the display) is on continuously.

If you want the Dispenser lamp to come on only when someone uses the dispenser, press the Lighting button to turn the continuous mode off.

Power Cool

This icon lights when you activate the “Power Cool” feature (refer to number 5, Fridge Button on Page 20 to select this function).

For a quick fridge cool down, use “Power Cool”.

If you select “Power Cool”, the inside temperature of the Fridge will decrease for about two and a half hours.

Filter Indicator

This icon lights when you need to change the filter, usually after the refrigerator has dispensed about 300 gallons of water (after about 6 months).

After you install the new water filter, reset the filter indicator by touching and holding the “Energy Saver” button for 3 seconds.

- If water is not dispensing or dispensing slowly, you need to replace the water filter because the water filter is clogged.
- Some areas have large amounts of lime in their water, which causes the water filter to clog more quickly.

Cubed Ice , Crushed Ice

Enjoy cubed or crushed ice by selecting your preference on the digital control panel.

The ice type light indicates the type of ice that is currently chosen.

Water

This icon lights when you activate the “Water” feature.

Ice Off

This icon lights when you activate the “Ice Off” feature. The ice maker is turned off and will not produce ice.

When ICE OFF blinks on the display panel, reinsert the ice bucket and/or make sure it's installed properly.

Child Lock

This icon lights when you activate the “Lock” feature.

When the Child Lock icon is lit, all the panel buttons, including the Ice button and the dispensers, are locked and de-activated.

Press and hold the Ice Off / Child Lock button for 3 seconds to turn Child Lock off and re-activate the panel buttons.

Cooling Off Mode

Cooling Off mode (also called Shop mode), is designed for use by retailers when they are displaying refrigerators on the shop floor. In Cooling Off mode, the refrigerator’s fan motor and lights work normally, but the compressors do not run, and the refrigerator and freezer do not get cold.

To start Cooling Off mode, touch and hold the Power Freeze button and the Freezer button for 5 seconds during normal operation.

The refrigerator chime sounds and OFF appears on the display.

To cancel Cooling Off mode, touch and hold the Power Freeze and Freezer buttons again for 5 seconds, until the chime sounds.

Important: If you see the OFF code on your refrigerator’s display, your refrigerator is in Cooling Off mode.

Follow the directions above to cancel.

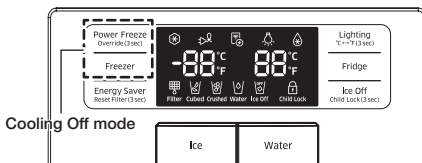

Display Off Function

To energy conservation the Panel Display turns off automatically under the following conditions:

When no button has been pressed, when no doors are open, or when no Dispenser Lever has been pushed for a period of time.

However, the icon indicating your Water or Cubed / Crushed Ice selection, will stay on.

When you press a button, open a door, or push a Dispenser Lever, the Panel Display will turn on again.

Except for the Water and Cubed / Crushed Ice buttons, all function buttons will become operational after you remove your finger from the button you are currently pressing.

E-SMART Refrigerator Features

How to get the most out of your E-Smart refrigerator.

Getting Connected

To use the Smart Grid (Demand Response) and E-Smart function on your Refrigerator, you need the following devices and apps:

- Devices: 1) Wireless Router, 2) Samsung E-Smart Refrigerator, 3) Smartphone (Recommended: Galaxy S4, Galaxy Note3/ Android OS Jelly bean).
- Applications: 1) “Samsung E-Smart App” from the Google Play Store or Samsung Apps.

In addition, you need to:

- Connect the Refrigerator and the Smartphone to the same Wi-Fi network in your home.
- Install and run Samsung E-Smart App on your Smartphone (to use the Samsung E-Smart function).

In addition, to use the Smart Grid (Demand Response) function, you must Register for the service with your electric company.

The company must have an EMS (Energy Management System) that supports SEP (Smart Energy profile).

Downloading the E-Smart App and Connecting the Refrigerator to your Network

1. On your Smartphone, connect to the app store (e.g. Google Play, etc.).
2. Search for the app using "Samsung E-Smart Ref." as the keyword.
3. Download the app and install it on your phone.
4. Launch the app.
The network configuration screen appears.
5. Configure the AP information (SSID, Password, etc.) on the app screen.
6. Configure the network settings according to the instructions in the app.
7. On the refrigerator, press and hold the Fridge and Energy Saver buttons at the same time for 3 seconds.
The refrigerator enters the AP mode.

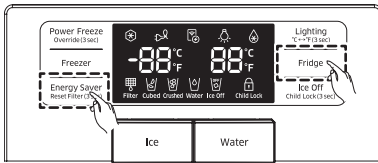

8. If you have completed the network settings properly, the app shows the home screen.

- Please confirm your the Internet devices (AP, Smartphone) are working properly before configuring the network settings.
- This refrigerator supports the IEEE 802.11 a/b/g/n protocols.
Samsung Electronics recommends IEEE 802.11n.
- To connect the refrigerator to a wireless network, you have to connect the refrigerator to an AP (router or modem).
If the AP supports DHCP, you can connect the refrigerator to the Internet using DHCP or a fixed IP address.
- Set the channel of the AP to one not currently being used.
If the channel set for the AP is being used by another device nearby, it may result in interference.
- Most wireless networks allow you to configure network security settings. If your network has a security password, you must enter the password to connect to the network.
- The refrigerator supports the following wireless security modes and encryption types:
 - Security Mode: WEP, WPA2PSK, WPA2PSK
 - Encryption Type: WEP, TKIP, AES (WPA2PSK and AES are recommended.)
- The app supports indoor control only.
- The Samsung E-Smart Ref. app is optimized for Samsung Electronics Smartphones (Galaxy S4 , Galaxy Note 3).
For other Smartphones, some functions may work differently.

MAC Address Display Mode

This function displays the MAC address of the Wi-Fi module on the refrigerator display. The refrigerator displays the MAC address of the Wi-Fi module for 1 minute.

1. Press and hold the Power Freeze and Energy Saver buttons at the same time for 3 seconds.

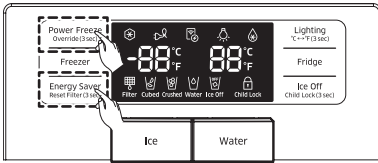

2. A Buzzer sounds. Four of the twelve Mac address of the Wi-Fi module are displayed in turns in the freezer and fridge temperature displays for 1 minute. For example, if the Wi-Fi module's MAC address is "11-22-33-44-55-66", the MAC address is displayed as follows: "11 22" → "33 44" → "55 66" → ---- → "11 22" for 1 minute.
3. After 1 minute, the display returns to the normal state and the Buzzer sounds again.



If the Mac addresses are not available or there is no Wi-Fi module, '----' is displayed on the freezer and fridge temperature displays.

SMART GRID Function (Demand Response)

When the refrigerator operates in SMART GRID (Demand Response) mode, the E-Smart Refrigerator function can control energy usage or delay the operation of some functions to save money when energy prices or demand are the highest.



You can deactivate the SMART GRID (Demand Response) function at any time.

(Using the Override On/Off function)



To use the SMART GRID (Demand Response) function, you need a separate contract with your utility company.

Using the SMART GRID (Demand Response) Function

This feature monitors energy prices and demand information from your utility company and sends notifications to the refrigerator to run high energy-consuming tasks during off-peak times when electricity costs and demand are lower.

If the refrigerator receives a control signal from the Utility Company, the refrigerator will display the DAL (L3) ~ TALR (L4) levels on the refrigerator display and control the power consumption according to the level.

[Exception condition] The DAL and TALR control signals from an utility company work as long as product performance is maintained.

If the refrigerator receives the SMART GRID (Demand Response) signal (DAL or TALR), the refrigerator will operate in Delay Appliance Load (Display: L3) or Temporary Appliance Load Reduction (Display: L4) mode.

- Delay Appliance Load (L3): The refrigerator responds to a DAL signal by providing a moderate load reduction for the duration of the delay period.
This function controls functions that consume a lot of energy such as adjusting the Cooling system, running the defrost cycle, and making ice.
- When the refrigerator operates in DAL (L3) mode, "L3" is displayed on the refrigerator display.
- DAL mode is automatically deactivated after it lasts for the amount of time stipulated by the DAL signal (max. 4.5 hours) or when the Override key is pressed.
- Temporary Appliance Load Reduction (L4): The refrigerator responds to a TALR signal by aggressively reducing the load for a short time period.
This function reduces energy consumption by stopping the compressor and controlling the functions that consume a lot of energy such as the defrost cycle and making ice.)
- When the refrigerator operates in TALR (L4) mode, "L4" is displayed on the refrigerator display.
- TALR (L4) mode is automatically deactivated after it lasts for the received duration (max. 15 minutes), or when the Override key is pressed. The mode is immediately deactivated and the refrigerator returns to the normal state when the door is opened or closed, or the dispenser is used.

Override Mode

When you want to ignore the SMART GRID (Demand Response) signal from the Utility Company, you can activate OVERRIDE mode. If OVERRIDE mode is activated, the SMART GRID (Demand Response) signal is ignored and the refrigerator will not be controlled by the Utility Company.

Activating and deactivating Override mode

1. Press and hold the [Power Freeze] button for 3 seconds.

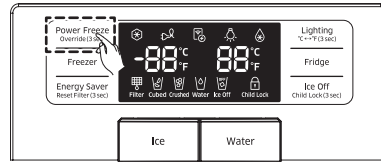

2. A buzzer sounds and 'Or' and 'on' is displayed in the freezer and fridge temperature displays for 5 seconds.
3. If the refrigerator receives a SMART GRID (Demand Response) signal from the Utility Company, 'Or' is displayed in the freezer temperature display.
4. To deactivate OVERRIDE mode, press and hold the [Power Freeze] button for 3 seconds.

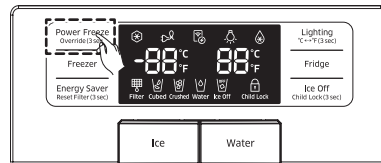

5. A buzzer sounds and 'Or' and 'oF' appears in the freezer and fridge temperature displays for 5 seconds.



Alternatively, you can activate or deactivate OVERRIDE mode using the app.

Using the E-SMART Function

The E-SMART function enables you to control and monitor your E-Smart refrigerator remotely for your convenience.



- To use the E-SMART refrigerator functions, you have to install the corresponding app first.
- The app supports indoor control only.

1. Operational Status, User Settings & Messages.

- You can view the freezer and fridge temperature settings.
- You can receive an alarm when the freezer or fridge door is open for 2 minutes.
- The door-open alarm indicator appears on the status bar of the top area of your mobile phone.
- You can check the DR and Override status.
- You can check the operational condition of the ice maker in the freezer.

2. Remote Management.

- Power Freeze Setting : You can remotely activate the Power Freeze function.
- Power Cool Setting : You can remotely activate the Power Cool function.
- Ice On/Off Setting : You can remotely set up the Ice On/Off Setting function.

3. Energy Consumption Reporting.

- Shows the accumulated power consumption. Power consumption data is updated every 10 minutes.



The energy consumption report may differ from the power consumption specifications of the product depending on the operating environment and the stored food.

4. Delay Defrost Capability.

- The Delay Defrost Capability function saves energy by delaying the defrost operation to a time specified by the user.

You can configure the time, and this function will save energy during the specified period in a 24 hour cycle. If the time is not set, the function works with the default time settings.

The default time settings are below:

- 6 am to 10 am : 1st. November ~ 30th. April
- 3 pm to 7 pm : 1st. May ~ 31th. October

To change the time setting for the Delay Defrost Capability

You can change the time setting for the Delay Defrost Capability on the app.

Provision for Open Access to the Connected Product Requirements

1. SGIP Open Standards (Smart Energy Profile 2.0 <http://www.csep.org/>)
 - Energy Consumption Reporting
 - Demand Response
2. Samsung OPEN API
 - Operational Status, User Settings & Messages
 - ICE Maker Status: GET /external/ icestatus?icegetstatus=opt (relevant to the energy consumption of the product 1)
 - Door Open Alarm: GET /devices/0/ Door?type=opt (relevant to the energy consumption of the product 2)
 - DR Status: GET /external/drlc?drgetstatus=opt
 - Delay Defrost Capability
 - Set Schedule of the Defrost Delay: POST / devices/0/defrost/addSchedule
 - Get Schedule of the Defrost Delay : GET / devices/0/defrost/getSchedule
 - Delete Schedule of the Defrost Delay: POST / devices/0/defrost/delSchedule
 - Defrost Delay On/OFF: PUT /devices/0/defrost/ delayevent.

CONTROLLING THE TEMPERATURE

Basic Temperature of Freezer and Fridge

The basic and recommended temperature of Freezer and Fridge compartments are 0 °F (-18 °C) / 37 °F (3 °C).

If the temperature of Freezer and Fridge compartments are too high or low, adjust the temperature manually.

Controlling the Freezer temperature

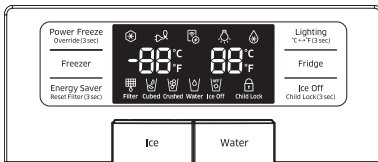

The freezer temperature can be set between 5 °F (-15 °C) and -8 °F (-23 °C) to suit your particular needs.

Press the Freezer button repeatedly until the desired temperature is shown in the temperature display.

Fahrenheit : 0 °F → -1 °F → -2 °F → -3 °F → -4 °F → -5 °F → -6 °F → -7 °F → -8 °F → 5 °F → 4 °F → 3 °F → 2 °F → 1 °F → 0 °F.

Centigrade : -18 °C → -19 °C → -20 °C → -21 °C → -22 °C → -23 °C → -15 °C → -16 °C → -17 °C → -18 °C.

Keep in mind that foods like ice cream may melt at 4 °F (-15.5 °C).

The temperature display will move sequentially from 5 °F (-15 °C) to -8 °F (-23 °C).

When the display reaches 5 °F (-15 °C), it will begin again at -8 °F (-23 °C).

Controlling the Fridge temperature

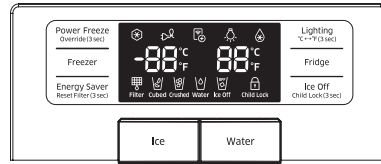

The refrigerator temperature can be set between 44 °F (7 °C) and 34 °F (1 °C) to suit your particular needs.

Press the Fridge button repeatedly until the desired temperature is shown in the temperature display.

Fahrenheit : 37 °F → 36 °F → 35 °F → 34 °F → Power Cool → 44 °F → 43 °F → 42 °F → 41 °F → 40 °F → 39 °F → 38 °F → 37 °F.

Centigrade : 3 °C → 2 °C → 1 °C → Power Cool → 7 °C → 6 °C → 5 °C → 4 °C → 3 °C.

The temperature control process for the Fridge works just like the Freezer process.

Press the Fridge button to set your desired temperature.

After a few seconds, the Fridge will begin tracking towards the newly set temperature.

This will be reflected in the digital display.



- The temperature of the freezer or the refrigerator may rise if you open the doors too frequently, or if a large amount of warm or hot food is placed in either side.
- This may cause the digital display to blink. Once the freezer and refrigerator return to their normal set temperatures the blinking will stop.
- If the blinking continues, you may need to “reset” the refrigerator. Unplug the appliance, wait about 10 minutes, and then plug it back in.

USING THE ICE AND COLD WATER DISPENSER

When Ice Off blinks on the display panel, reinsert the ice bucket and / or make sure it's installed properly.

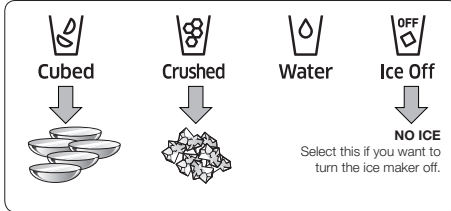

Using the Water Dispenser

Press the Water button.
Place your cup under the water outlet, and then push gently against the dispenser pad.
Make sure the glass is in line with the dispenser to prevent the water from splashing out.

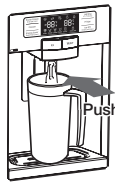

To get cooler water :

- The dispensed water is cool, not icy cold.
- When you want colder water with ice, dispense ice into your glass first before filling it with water to prevent water from splashing out.

Using the ice Dispenser

Press the Ice button to select the type of ice you want.
Place your cup under the ice outlet, and then push gently against the dispenser pad.
Make sure the glass is in line with the dispenser to prevent the ice from bouncing out.
If you select Cubed Ice after using the Crushed Ice feature, a small amount of residual crushed ice might be produced.

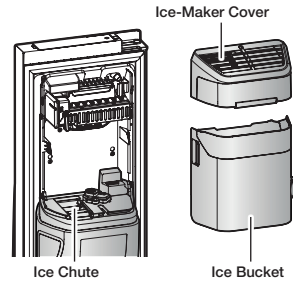

⚠ WARNING

- Do not put your fingers, hands, or any unsuitable objects in the chute or ice-maker bucket.
- This can cause personal injury or material damage.
- Use only the ice maker provided with the refrigerator.
- Have the refrigerator's water supply connected only to a potable water supply.
- The ice maker requires water pressure of 20 - 125 psi (138-862 kPa) to operate properly.

⚠ CAUTION

- If you are going on a long vacation or business trip and won't be using the water or ice dispensers for that period of time, close the water valve to prevent leaks.
- If you have not used the Ice maker for a while, or you have opened the Freezer door frequently, the Ice may stick together. If this occurs, empty the ice bucket or break up the ice with a wood kitchen tool. Do not use sharp items such as knives or forks.
- When you remove the ice bucket, there may still be some residual ice in the ice maker. The ice maker may eject this ice into the freezer.

STORING FOOD

The Samsung Side-By-Side Refrigerator has been designed to provide you with maximum space saving features and functions.

Here are some of the customized compartments we have created to keep your food fresher, longer.

Remember, to prevent odors from penetrating the ice in the freezer, wrap stored food as securely and as airtight as possible.

CAUTION

Because the following operating instructions cover various models, your refrigerator may differ slightly from those described in this manual.

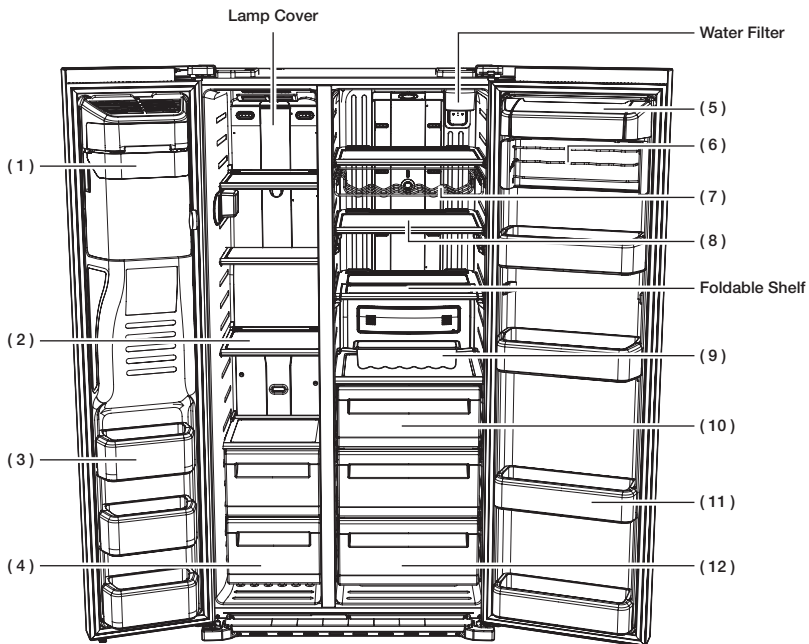

Storing food in the freezer

(1) Ice Maker Bucket

Designed to store lots of ice easily.

WARNING

Do not put your fingers, hands or any other objects in the ice chute or the ice maker bucket. Doing so can cause personal injury or material damage

(2) Shelves

Can be used to store all types of frozen food.

(3) Door Bins

Can be used for small packages of frozen food.

(4) Drawers

Best used to store meats or dry foods. Stored food should be wrapped securely using foil or other suitable wrapping materials or containers.

Storing food in the fridge

(5) Dairy Bin

Can be used to store smaller dairy items like butter or margarine, yogurt, or cream-cheese bricks.

(6) Tilt Can Carry

Can be used to store beverage cans or bottles.

(7) Wine Rack (optional)

Helps wine maintain its taste by providing an optimized place for storing your wine bottles.

(8) Shelves

Designed to be crack-resistant.

They can be used to store all types of food and drinks.

Circular marks on the glass surface are a normal phenomenon and can usually be wiped clean with a damp cloth.

(9) Egg Container

Best place to keep eggs.

Place the egg tray on a shelf for easy access.

(10) Fresh Drawer

Helps to preserve the taste of food and prolongs its freshness. Use to store bread and cake.

(11) Door Bins

Designed to handle large, bulky items such as gallons of milk or other large bottles and containers.

(12) Fruit & Vegetable Drawer

Used to preserve the freshness of your stored vegetables and fruits.



Bottles should be stored tightly together so that they do not tip and fall out when the refrigerator door is opened.

WARNING

- If you plan to go away for a significant time, empty the refrigerator and turn it off. Wipe excess moisture from the inside of the refrigerator and leave the doors open. This helps keep odor and mold from developing.
- If you do not intend to use the refrigerator for a long period of time, pull out the power plug.
- Deteriorating power cord insulation may cause a fire.

REMOVING THE FREEZER/ FRIDGE ACCESSORIES

Cleaning and rearranging the interior of the freezer is a snap.

1. Shelves (Freezer/Fridge)

- Remove the shelf by pulling it out to the point where there is a gap in the shelf support as shown in the circled figure. Then, lift up the right side or the shelf and pull it out.

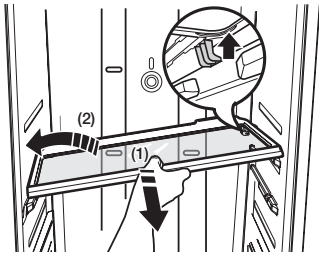

2. Door bin

- Remove the Door Bin by holding it with both hands and then gently lifting it up.

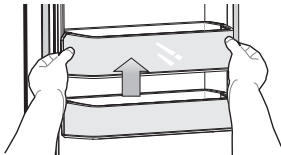

3. Drawer

- Remove the Drawer by pulling it out and slightly lifting it up.

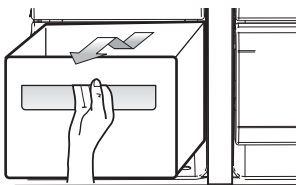

4. Drawer Cover

- Remove all Drawers before removing the cover.
- Pull the cover out to the point where there is a gap in the support as shown in the circled figure. Then, lift up the right side of the cover and pull it out.

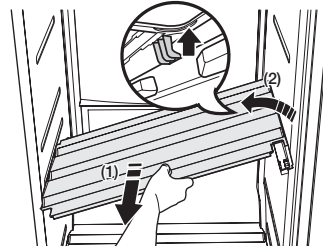

5. Ice Bucket (Freezer)

- Remove the Icemaker Bucket by lifting it up and pulling it out slowly.
- Grip the handle as shown in the figure.
- Remove the Ice Bucket slowly to prevent damage.

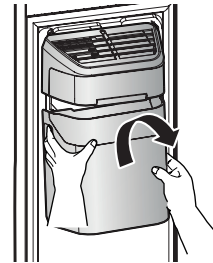

Do not use excessive force when removing the drawer cover. Otherwise, the cover may break and cause injury.



Before removing any accessories, make sure that no food is in the way. When possible, remove the food altogether to reduce the risk of accidents.

CLEANING THE REFRIGERATOR

Caring for your Samsung Side-By-Side Refrigerator prolongs the life of your appliance and helps keep it odor and germ-free.

Cleaning the Interior

Clean the inside walls and accessories with a mild detergent, and then wipe dry with a soft cloth. You can remove the drawers and shelves for a more thorough cleaning. Just make sure to dry them before putting them back into place.

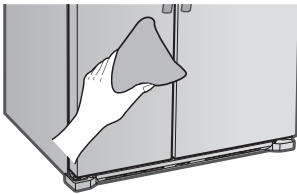

Cleaning the Exterior

Wipe the control panel and digital display with a damp, clean, soft cloth.

Do not spray water directly on the surface of the refrigerator.

The doors, handles, and cabinet surfaces should be cleaned with a mild detergent, and then wiped dry with a soft cloth.

To keep your appliance looking its best, polish the exterior once or twice a year.

⚠ WARNING

Do not use benzene, thinner, car detergent, or Clorox to clean the exterior of your refrigerator. These substances may damage the surface of the appliance and can cause a fire.

Cleaning the Rubber door seals

If the rubber door seals are dirty, the doors may not close properly, and the refrigerator will not operate efficiently.

Keep the door seals free of grit or grime by cleaning the doors with a mild detergent and damp cloth.

Wipe dry with a clean, soft cloth.

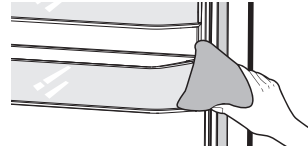

⚠ CAUTION

Do not spray the refrigerator with water while it is plugged in, as it may cause an electric shock. Do not clean the refrigerator with benzene, thinner or car detergent. These substances can cause a fire.

CHANGING THE INTERIOR LIGHTS

⚠ WARNING

- Pull the power plug out of the socket before changing the interior light of the refrigerator.
- Otherwise, there is a risk of electric shock. If you experience difficulty changing the light, contact a Samsung service center.

🔧 Changing the LED Type Lighting

⚠ CAUTION

Do not disassemble or replace the LED type Lighting. If you need to change the LED Type Lighting, contact a Samsung service center.

CHANGING THE WATER FILTER

⚠ WARNING

To reduce risk of water damage to your property DO NOT use generic brands of water filters in your SAMSUNG Refrigerator.

USE ONLY SAMSUNG BRAND WATER FILTERS. SAMSUNG is not legally responsible for any damage, including, but not limited to, property damage caused by water leakage from the use of a generic water filter.

SAMSUNG Refrigerators are designed to work ONLY WITH SAMSUNG Water Filter.

The “Filter Indicator” red LED light lets you know when it is time to change your water filter cartridge. To give you preparation time to get a new filter, the red light will come on just before the capacity of the current filter runs out.

Changing the filter on time provides you with the freshest, cleanest water from your fridge.



To make changing the water filter easier, you may want to shut off the water supply, and then drain any water remaining in the water line by pressing a glass against the water dispenser pad.

- Remove the new water filter from its box and put a month indicator sticker on the filter as shown.
Place a sticker on the filter with a date six months in the future.
For example, if you are replacing the water filter in March, put the “SEP” (September) sticker on the filter to remind you to replace in September. Normal filter life is about 6 months.
- Remove the old filter from the filter housing, and then remove the new filter's protective cap.
- Position the new filter, and then inset it into the filter housing.
Slowly turn the water filter clockwise to align the indicator mark on the filter with lock indicator on the filter housing.
Make sure to align the water filter label mark with the center of the lock indicator as illustrated above, right.
Do not over-tighten.

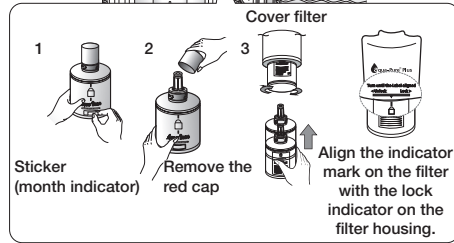

- Once you have completed this process, hold the “Energy Saver” simultaneously for 3 seconds to reset the filter indicator.

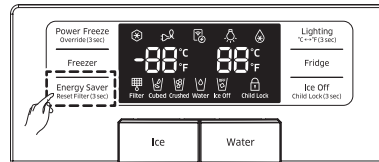

- Turn on the water supply if you turned it off.
- Flush 3 gallons of water through filter before drinking or using the water from the refrigerator.
This should take about 6 minutes.
To flush, press the Water button, and then press a large glass or cup against the water dispenser lever.
Fill the glass, empty it into the kitchen sink after it is filled, and then repeat.
Make sure that water flows clearly again before drinking.



A newly installed water filter cartridge may cause water to briefly spurt from the water dispenser.
This is caused by air getting into the line.
It should pose no problem to operation.

Ordering replacement filters

To order more water filter cartridges, contact your authorized Samsung dealer. You can also order replacement filters on line at www.samsungparts.com.

USING THE DOORS

The refrigerator doors are equipped with a door opening and closing feature that ensures that the doors close all the way and are securely sealed. After opening beyond a certain point, the door will “catch” and remain open.

When the door is open short of the catch that allows it to stay open, it will close automatically.

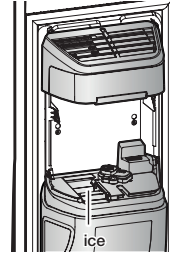

USING THE ICE MAKER

- To Remove the Ice Bucket.
- Hold the handle as shown in figure 1.
- Lift up and pull the Bucket out slowly.
- Take out Ice Bucket out slowly to prevent damage.
- After reinstalling the ice bucket, select the ICE mode.

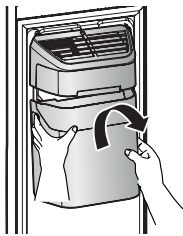
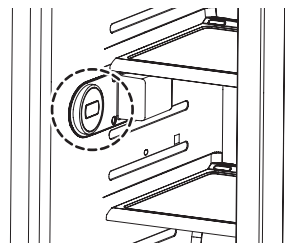

Figure 1

- Normal Operation
- Any sounds you hear when the ice maker dumps ice into the bucket are part of normal operation.
- Ice may clump in the bucket if you do not dispense ice for long periods of time. If this occurs, remove all the ice and empty the bucket.
- If ice does not come out, check for any ice stuck in the chute and remove it.
- The first batch of ice cubes after installation may be small because air has entered the water line. Any air will be purged during normal use.

⚠ CAUTION

- When ICE OFF blinks on the display panel, reinsert the ice bucket and/or make sure it's installed properly.
- When the door is open, the Ice and water dispenser do not work.
- If you close the door hard, it may cause water to spill over the ice maker.
- To prevent the ice bucket from dropping, use both hands when removing it.
- To prevent injury, be sure to clean up any ice or water that may have dropped on the floor.
- Do not let the children hang on the ice dispenser or on the bucket. They may get hurt.
- Be sure not to put your hand or any object into the ice chute. It may cause personal injury or damage mechanical parts.
- Use care when storing food in plastic bags in the freezer. Incorrectly stored bags can get caught in the ice bucket's Auger Motor and prevent the refrigerator from dispensing ice or cause the freezer door to open unexpectedly.



Troubleshooting

PROBLEM	SOLUTION
The refrigerator does not work at all or it does not chill sufficiently.	<ul style="list-style-type: none"> • Check that the power plug is properly connected. • Is the temperature control on the display panel set to the correct temperature? Try setting it to a lower temperature. • Is the refrigerator in direct sunlight or located too near a heat source? • Is the back of the refrigerator too close to the wall and therefore keeping air from circulating?
The food in the fridge is frozen.	<ul style="list-style-type: none"> • Is the temperature control on the display panel set to the correct temperature? Try setting it to a warmer temperature. • Is the temperature in the room very low? • Did you store the food with a high water content in the coldest part of the fridge?
You hear unusual noise or sounds.	<ul style="list-style-type: none"> • Check that the refrigerator is level and stable. • Is the back of the refrigerator too close to the wall and therefore keeping air from circulating? • Was anything dropped behind or under the refrigerator? • If you hear a "ticking" sound from inside the refrigerator, this is normal. It occurs because various parts contract or expand in response to temperature changes in the refrigerator interior.
The front corners of the appliance are hot and condensation is occurring.	<ul style="list-style-type: none"> • Some heat is normal as anti-condensators are installed in the front corners of the refrigerator to prevent condensation. • Is the refrigerator door ajar? Condensation can occur when you leave the door open for a long time. • Water condensation in a drawer may occur if the drawer contains vegetables. The condensation will dissipate naturally as time passes.
Ice is not dispensing.	<ul style="list-style-type: none"> • Did you wait for 12 hours after installation of the water supply line before making ice? • Is the water line connected and the shut-off valve open? • Did you manually stop the ice making function? Make sure Ice is set to Cubed or Crushed. • Are there any ice clumps in the ice maker bucket? Remove them. • Is the freezer temperature too warm? Try setting the freezer temperature lower.
You can hear water bubbling in the refrigerator.	<ul style="list-style-type: none"> • This is normal. The bubbling comes from the refrigerant coolant liquid circulating through the refrigerator.
There is a bad smell in the refrigerator.	<ul style="list-style-type: none"> • Has a food item spoiled? • Make sure that strong smelling food (for example, fish) is wrapped so that it is airtight. • Clean out your freezer periodically and throw away any spoiled or suspect food.
Frost forms on the walls of the freezer.	<ul style="list-style-type: none"> • Is the air vent blocked? Remove any obstructions so air can circulate freely. • Allow sufficient space between the foods stored for efficient air circulation. • Is the freezer door closed properly?
The water dispenser is not functioning.	<ul style="list-style-type: none"> • Is the water line connected and the shut-off valve open? • Has the water supply line tubing been crushed or kinked? Make sure the tubing is free and clear of any obstruction. • Is the water tank frozen because the refrigerator temperature is too low? Try selecting a warmer setting on the main display panel.

PROBLEM	SOLUTION
<p>What Do I Need to Use the E-Smart and Smart Grid functions?</p>	<ul style="list-style-type: none"> • To use the Smart Grid (Demand Response) and E-Smart function on your Refrigerator, you need the following devices and apps: - Devices: 1) Wireless Router, 2) Samsung E-Smart Refrigerator, 3) Smartphone (Recommended: Galaxy S4, Galaxy Note3/ Android OS Jelly bean) - Applications: 1) "Samsung E-Smart App" from the Google Play Store or Samsung Apps. <p>You also need to:</p> <ul style="list-style-type: none"> • Connect the Refrigerator and the Smartphone to the same Wi-Fi network in your home. • Install and run Samsung E-Smart App on your Smartphone (to use the Samsung E-Smart function). • In addition, to use the Smart Grid (Demand Response) function, you must Register for the service with your electric company. The company must have an EMS (Energy Management System) that supports SEP (Smart Energy profile).
<p>Why isn't the E-Smart function working normally?</p>	<ul style="list-style-type: none"> • Confirm that the router in your home and the Internet are working properly. - Connect a Smartphone to the router (AP, Access Point), and then confirm that you can browse the Internet on the phone. • Confirm that refrigerator is connected to the AP. - Check the E-Smart icon on the PANEL of refrigerator. If the refrigerator is connected, the icon will be on. • Confirm that the refrigerator and Smart Phone are connected to the same router.
<p>Why isn't the Delay Defrost Capability working normally?</p>	<ul style="list-style-type: none"> • Confirm that the router in your home and the Internet are working properly. - Connect a Smartphone to the router (AP, Access Point), and then confirm that you can browse the Internet on the phone. • Confirm that the area where you live is properly entered into the Smart phone App. • Confirm that the Smart Grid function works correctly. (Check the PANEL. L3 and L4 should not be displayed on the PANEL.)

OPEN SOURCE ANNOUNCEMENT

The software included in this product contains open source software.

You may obtain the complete corresponding source code for a period of three years after the last shipment of this product by sending an email to <mailto:oss.request@samsung.com>.

It is also possible to obtain the complete corresponding source code in a physical medium such as a CD-ROM; a minimal charge will be required.

The following URL <http://opensource.samsung.com/opensource/ConnectedProduct/seq/0> leads to the download page of the source code made available and open source license information as related to this product.

This offer is valid to anyone in receipt of this information.



Warranty: USA

WARRANTY ON SAMSUNG REFRIGERATOR

LIMITED WARRANTY (U.S.A.)

SAMSUNG REFRIGERATOR

LIMITED WARRANTY TO ORIGINAL CONSUMER PURCHASER WITH PROOF OF PURCHASE

This SAMSUNG brand product, as supplied and distributed by Samsung Electronics America, Inc. (SAMSUNG) and delivered new, in the original carton to the original consumer purchaser, is warranted by SAMSUNG against manufacturing defects in materials or workmanship for the limited warranty period of:

One (1) year parts and labor

Five (5) years parts and labor on Sealed Refrigeration System Only (Compressor, Evaporator, Condenser, Drier, and Connecting Tubing)

Ten (10) years part and Five (5) years labor on Digital Inverter Compressor Only

This limited warranty is valid only on products purchased and used in the United States that have been installed, operated, and maintained according to the instructions attached to or furnished with the product. To receive warranty service, the purchaser must contact SAMSUNG at the address or phone number provided below for problem determination and service procedures. Warranty service can only be performed by a SAMSUNG authorized service center. The original dated bill of sale must be presented upon request as proof of purchase to SAMSUNG or SAMSUNG's authorized service center to receive warranty service.

SAMSUNG will provide in-home service within the contiguous United States during the warranty period at no charge, subject to availability of SAMSUNG authorized servicers within the customer's geographic area. If in-home service is not available, SAMSUNG may elect, at its option, to provide transportation of the product to and from an authorized service center. If the product is located in an area where service by a SAMSUNG authorized servicer is not available, you may be responsible for a trip charge or required to bring the product to a SAMSUNG authorized service center for service.

To receive in-home service, product must be unobstructed and accessible to the service agent.

During the applicable warranty period, a product will be repaired, replaced, or the purchase price refunded, at the sole option of SAMSUNG. SAMSUNG may use new or reconditioned parts in repairing a product, or replace the product with a new or reconditioned product.

Replacement parts and products are warranted for the remaining portion of the original product's warranty or ninety (90) days, whichever is longer. All replaced parts and products are the property of SAMSUNG and you must return them to SAMSUNG.

This limited warranty covers manufacturing defects in materials or workmanship encountered in normal household, noncommercial use of this product and shall not cover the following: damage that occurs in shipment, delivery, installation, and uses for which this product was not intended; damage caused by unauthorized modification or alteration of the product; product where the original factory serial numbers have been removed, defaced, changed in any way, or cannot be readily determined; cosmetic damage including scratches, dents, chips, and other damage to the product's finishes; damage caused by abuse, misuse, pest infestations, accident, fire, floods, or other acts of nature or God; damage caused by use of equipment, utilities, services, parts, supplies, accessories, applications, installations, repairs, external wiring or connectors not supplied or authorized by SAMSUNG; damage caused by incorrect electrical line current, voltage, fluctuations and surges; damage caused by failure to operate and maintain the product according to instructions; in-home instruction on how to use your product; and service to correct installation not in accordance with electrical or plumbing codes or correction of household electrical or plumbing (i.e., house wiring, fuses, or water inlet hoses). The cost of repair or replacement under these excluded circumstances shall be the customer's responsibility.

Visits by an authorized servicer to explain product functions, maintenance or installation are not covered by this limited warranty. Please contact SAMSUNG at the number below for assistance with any of these issues.

EXCLUSION OF IMPLIED WARRANTIES

IMPLIED WARRANTIES, INCLUDING THE IMPLIED WARRANTIES OF MERCHANTABILITY OR FITNESS FOR A PARTICULAR PURPOSE, ARE LIMITED TO ONE YEAR OR THE SHORTEST PERIOD ALLOWED BY LAW. Some states do not allow limitations on how long an implied warranty lasts, so the above limitations or exclusions may not apply to you. This warranty gives you specific rights, and you may also have other rights, which vary from state to state.

LIMITATION OF REMEDIES

YOUR SOLE AND EXCLUSIVE REMEDY IS PRODUCT REPAIR, PRODUCT REPLACEMENT, OR REFUND OF THE PURCHASE PRICE AT SAMSUNG'S OPTION, AS PROVIDED IN THIS LIMITED WARRANTY. SAMSUNG SHALL NOT BE LIABLE FOR SPECIAL, INCIDENTAL OR CONSEQUENTIAL DAMAGES, INCLUDING BUT NOT LIMITED TO TIME AWAY FROM WORK, HOTELS AND/OR RESTAURANT MEALS, REMODELING EXPENSES, LOSS OF REVENUE OR PROFITS, FAILURE TO REALIZE SAVINGS OR OTHER BENEFITS REGARDLESS OF THE LEGAL THEORY ON WHICH THE CLAIM IS BASED, AND EVEN IF SAMSUNG HAS BEEN ADVISED OF THE POSSIBILITY OF SUCH DAMAGES. Some states do not allow exclusion or limitation of incidental or consequential damages, so the above limitations or exclusions may not apply to you. This warranty gives you specific rights, and you may also have other rights, which vary from state to state.

SAMSUNG does not warrant uninterrupted or error-free operation of the product. No warranty or guarantee given by any other person, firm, or corporation with respect to this product shall be binding on SAMSUNG.

To obtain warranty service, please contact SAMSUNG at:

Samsung Electronics America, Inc.

85 Challenger Road

Ridgefield Park, NJ 07660

1-800-SAMSUNG (726-7864)

www.samsung.com/us/support

If your refrigerator needs service

Do not hesitate to call any Samsung Authorized Service Center nearby giving them your name, address and telephone number when your product is not functioning properly.

Warranty Information (CANADA)

Limited Warranty for Original Purchaser

This Samsung product is warranted by Samsung Electronics Canada Inc. (hereafter referred to as SECA) against manufacturing defects in material or workmanship for the following periods:

Labor : 1 year (in-home)
Parts : 1 year
Inverter Compressor : 10 Years (Part only)

SECA further warrants that if this product fails to operate properly within the specified warranty period and the failure is due to improper workmanship or defective material, SECA will repair or replace the product at its option. In-home service is not available in all areas. Contact us to find out if in-home service is currently available in your area by using the contact information at the back of this warranty.

All warranty repairs or part replacements must be performed by a SECA Authorized Service Center. (To find the nearest SECA Service Center, call 1-800-SAMSUNG (7267864) or visit our web site at www.samsung.com/ca)

Obligation to the Original Owner

The original dated sales receipt must be retained by the customer and is the only acceptable proof of purchase. It must be presented to a SECA Authorized Service Center at the time service is requested before warranty services are rendered. On all carry-in models, transportation to and from the Authorized Service Center is the responsibility of the customer.

Exclusions of the Warranty

This warranty does not cover damage due to accident, fire, flood, and/or other Acts of God, misuse, incorrect line voltage, improper installation, improper or unauthorized repairs, commercial use, or damage that occurs during shipping. Customer adjustments which are explained in this owners manual are not covered under the terms of this warranty. This warranty will automatically be voided for any unit found with a missing or altered serial number. This warranty is valid only on products purchased and used in the Canada.

SAMSUNG CUSTOMER CARE CENTER

Samsung Electronics Canada Inc. 2050 Derry Road West, Mississauga, Ontario L5N 0B9 Canada
1-800-SAMSUNG (726-7864)
www.samsung.com/ca/support (English)
www.samsung.com/ca_fr/support (French)

memo



Scan the QR code* or visit
www.samsung.com/spsn
to view our helpful
How-to Videos and Live Shows

* Requires reader to be installed on your
smartphone

Scan this with your smartphone

Contact SAMSUNG WORLD WIDE

If you have any questions or comments relating to Samsung products, please contact the SAMSUNG customer care center.

Country	Contact Center	Web Site	Subsidiaries office address
U.S.A	1-800-SAMSUNG (726-7864) 1-844-SAM-PAYS (726-7297)	www.samsung.com/us/support	Samsung Electronics America, Inc. 85 Challenger Road Ridgefield Park, NJ 07660
CANADA	1-800-SAMSUNG (726-7864)	www.samsung.com/ca/support (English) www.samsung.com/ca_fr/support (French)	Samsung Electronics Canada Inc. 2050 Derry Road West, Mississauga, Ontario L5N 0B9 Canada