

KitchenAid

Hand Blender
5KHB1231P



TABLE OF CONTENTS

PARTS AND FEATURES

Parts and accessories.....	3
Immersion Blender features	4

IMMERSION BLENDER SAFETY

Important safeguards	4
----------------------------	---

IMMERSION BLENDER SAFETY

Electrical requirements.....	7
Electrical equipment waste disposal	7

OPERATING YOUR IMMERSION BLENDER

Assembling the Immersion Blender	8
Using the blending arm	9

TIPS FOR GREAT RESULTS

Blending tips.....	11
Operating tips	12

CARE AND CLEANING

Washing the motor body.....	13
Washing the accessories and attachments.....	13

PRODUCT WARRANTY	14
-------------------------------	----



PARTS AND FEATURES

PARTS AND ACCESSORIES

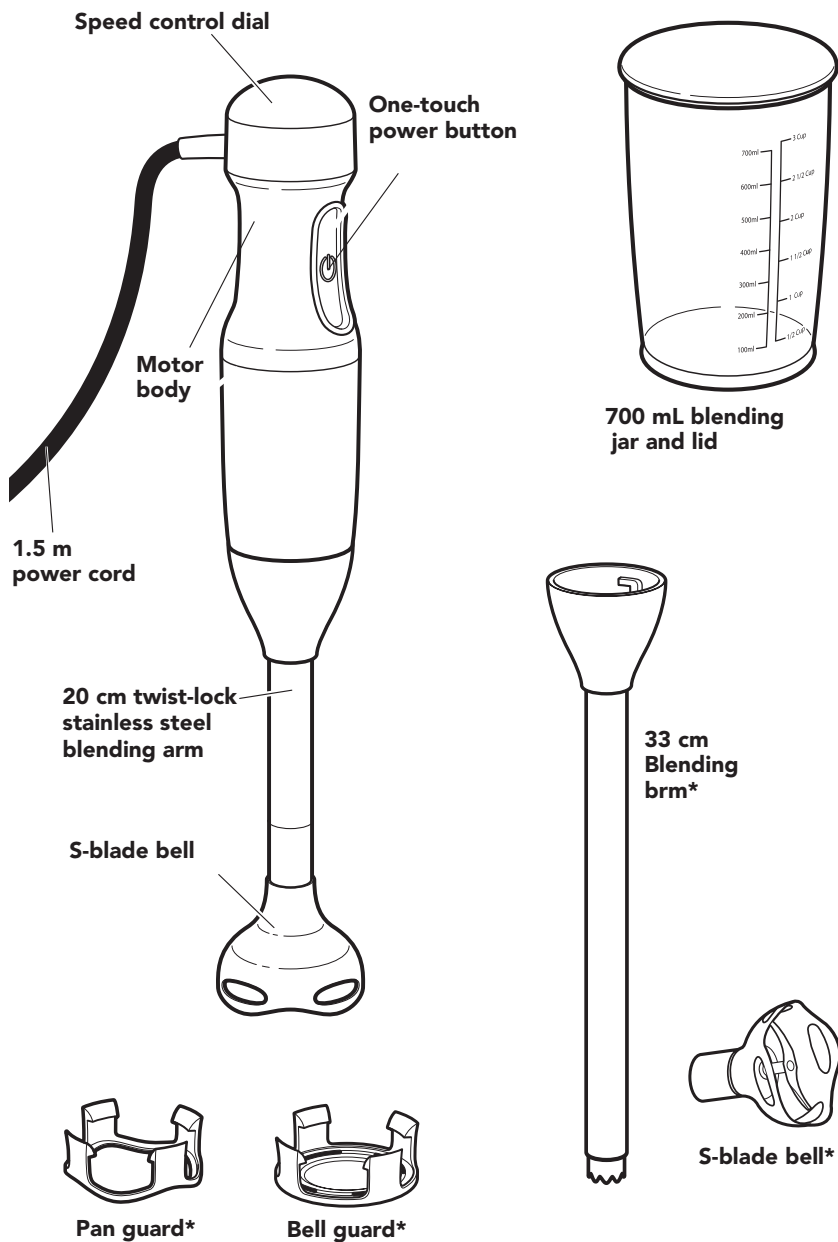

*Not available on all models.



PARTS AND FEATURES

IMMERSION BLENDER FEATURES

Speed control

Provides easy adjustment of speed.

One-touch power button

Activate the Immersion Blender by pressing and holding the POWER button during blending. To stop blending, simply release the power button.

Motor body

Designed for a comfortable, nonslip grip.

Powerful DC motor (not shown)

Provides a powerful blending action and is designed for quiet, long-life operation.

1.5 m power cord

Long enough to take the Immersion Blender to the cooktop or work area, the power cord is rounded with no grooves for easy cleanup. A silicone cord strap is included for convenient cord storage.

Twist-lock stainless steel blending arm

Attaches onto the motor body with a simple twist and rotates to lock into place. The sharp stainless steel blade is covered to help prevent splashing while blending.

Blending jar

700 mL BPA-free jar with lid.

IMMERSION BLENDER SAFETY

Your safety and the safety of others are very important.

We have provided many important safety messages in this manual and on your appliance. Always read and obey all safety messages.



This is the safety alert symbol.

This symbol alerts you to potential hazards that can kill or hurt you and others.

All safety messages will follow the safety alert symbol and either the word "DANGER" or "WARNING." These words mean:

 **DANGER**

You can be killed or seriously injured if you don't immediately follow instructions.

 **WARNING**

You can be killed or seriously injured if you don't follow instructions.

All safety messages will tell you what the potential hazard is, tell you how to reduce the chance of injury, and tell you what can happen if the instructions are not followed.

IMPORTANT SAFEGUARDS

When using electrical appliances, basic safety precautions should always be followed, including the following:

1. Read all instructions. Misuse of appliance may result in personal injury.



IMMERSION BLENDER SAFETY

2. To protect against risk of electrical shock do not put motor body, cord, or electrical plug of this Immersion Blender in water or other liquid.
3. This appliance is not intended for use by persons (including children) with reduced physical, sensory or mental capabilities, or lack of experience and knowledge, unless they have been given supervision or instruction concerning use of the appliance by a person responsible for their safety.
4. Children should be supervised to ensure that they do not play with the appliance.
5. Turn the appliance OFF, then unplug from the outlet when not in use, before assembling or disassembling parts and before cleaning. To unplug, grasp the plug and pull from the outlet. Never pull from the power cord.
6. Avoid contacting moving parts. Keep hands, hair, and clothing, as well as spatulas and other utensils away from accessories during operation to reduce the risk of injury to persons and/or damage to the appliance.
7. Do not operate any appliance with a damaged cord or plug or after the appliance malfunctions, or is dropped or damaged in any manner. Contact the manufacturer at their customer service telephone number for information on examination, repair, or adjustment.
8. If the supply cord is damaged, it must be replaced by the manufacturer, its service agent, or similarly qualified persons in order to avoid a hazard.
9. Never leave the appliance unattended while it is in operation.
10. Refer to the “Operating Your Hand Blender” section for maximum operating time and speed.
11. Keep hands and utensils out of the container while blending to prevent the possibility of severe injury to persons or damage to the unit. A scraper may be used but must be used only when the unit is not running.
12. Do not let the cord hang over edge of table or counter.



IMMERSION BLENDER SAFETY

13. Switch off the appliance and disconnect from supply before changing accessories or approaching parts that move in use.
14. The use of attachments not recommended or sold by KitchenAid may cause fire, electric shock, or injury.
15. Be careful if hot liquid is blended in the jar, as it can be ejected out due to a sudden steaming.
16. When mixing liquids, especially hot liquids, use a tall container or make small quantities at a time to reduce spillage.
17. Always disconnect the blender from the supply if it is left unattended and before assembling, disassembling or cleaning.
18. Do not allow children to use the blender without supervision.
19. Do not let cord contact hot surface, including the stove.
20. Do not use the Hand Blender outdoors.
21. Blades are sharp. Care should be taken when handling the sharp cutting blades, emptying the bowl, and during cleaning.
22. To avoid product damage, do not use the Hand Blender bowls in areas of high heat such as an oven, microwave, or on a stovetop.
23. Refer to the “Care and Cleaning” section for instructions on cleaning the surfaces in contact with food.
24. This appliance is intended to be used in household and similar applications such as:
 - staff kitchen areas in shops, offices, or other working environments;
 - farmhouses;
 - by clients in hotels, motels, and other residential type environments;
 - bed and breakfast type environments.

SAVE THESE INSTRUCTIONS



IMMERSION BLENDER SAFETY

ELECTRICAL REQUIREMENTS

Voltage: 230 V

Frequency: 60 Hz

NOTE: If the plug does not fit in the outlet, contact a qualified electrician. Do not modify the plug in any way.

ELECTRICAL EQUIPMENT WASTE DISPOSAL

Disposal of packing material

The packing material is 100% recyclable and is marked with the recycle symbol

. The various parts of the packing must therefore be disposed of responsibly and in full compliance with local authority regulations governing waste disposal.

Scrapping the product

- This appliance is marked in compliance with European Directive 2012/19/EU, Waste Electrical and Electronic Equipment (WEEE).

- By ensuring this product is disposed of correctly, you will help prevent potential negative consequences for the environment and human health, which could otherwise be caused by inappropriate waste handling of this product.



- The symbol  on the product or on the accompanying documentation indicates that it should not be treated as domestic waste but must be taken to an appropriate collection centre for the recycling of electrical and electronic equipment.

For more detailed information about treatment, recovery, and recycling of this product, please contact your local city office, your household waste disposal service or the shop where you purchased the product.



OPERATING YOUR IMMERSION BLENDER

ASSEMBLING THE IMMERSION BLENDER

Before using the KitchenAid Immersion Blender for the first time, wipe the motor body and attachment adapters with a clean, damp cloth to remove any dirt or dust. Mild dish soap may be used, but do not use abrasive cleansers.

NOTE: Do not immerse the motor body or the adapters in water.

Dry with a soft cloth. Wash all the other attachments and accessories by hand or in the top rack of the dishwasher. Dry thoroughly.

NOTE: Always be sure to unplug the power cord from the wall socket before installing or removing attachments.

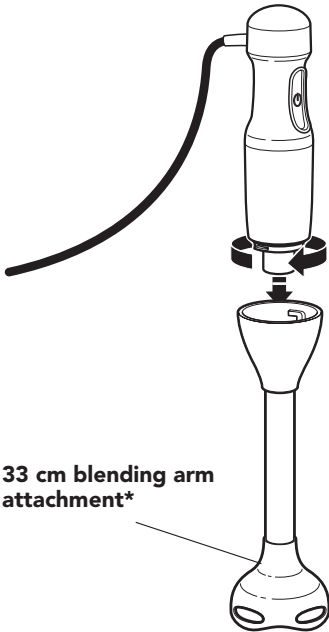

Bell guard*

Easily snaps onto bell blade and provides protection to blades while the Immersion Blender is not in use.

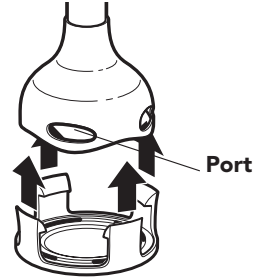

NOTE: Ensure bell guard is installed with the mounting clips positioned between the ports on the bell blades.

Pan guard*

The pan guard snaps onto any of the included bell blades and provides protection to the Immersion Blender and your cookware.

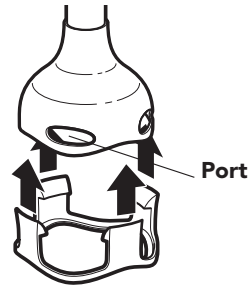

NOTE: Ensure pan guard is installed with the mounting clips positioned between the ports on the bell blades.

NOTE: Do not exceed 30 seconds continuous operation at Speed 2.

*Not available on all models



OPERATING YOUR IMMERSION BLENDER

USING THE BLENDING ARM

Use the blending arm attachment for smoothies, milkshakes, soup, cooked vegetables, frosting, or baby food.

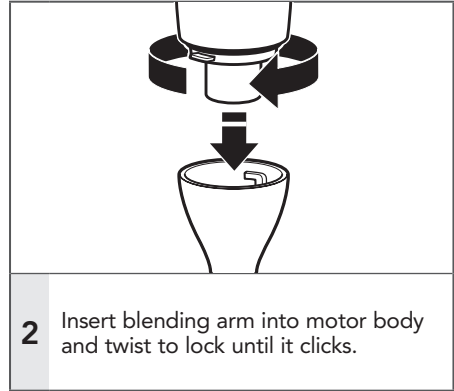
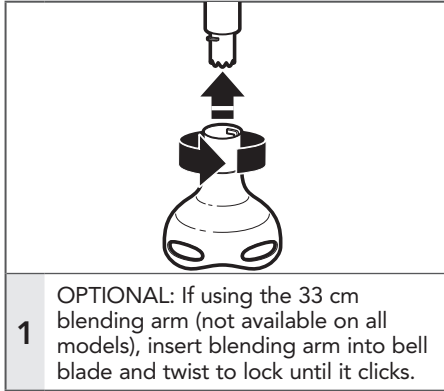

! WARNING



Electrical Shock Hazard

- Plug into an earthed outlet.**
- Do not remove earth prong.**
- Do not use an adapter.**
- Do not use an extension cord.**

Failure to follow these instructions can result in death, fire, or electrical shock.

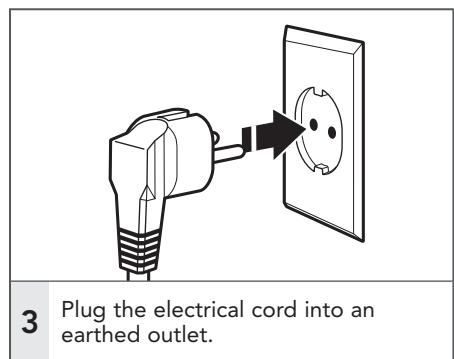

OPERATING YOUR IMMERSION BLENDER

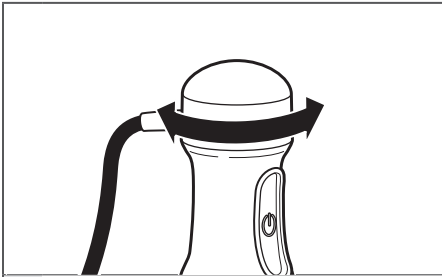

- 4** Set Immersion Blender on Speed 1. Adjust the speed by turning the speed control dial on top of the Immersion Blender.

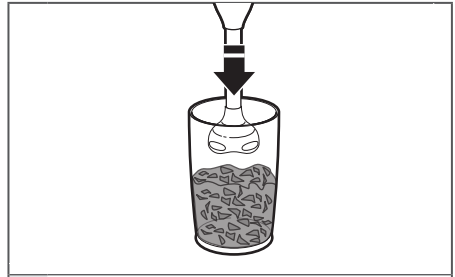

- 5** Insert the Immersion Blender into the mixture.

IMPORTANT: The Immersion Blender should only be immersed in liquids the length of the attachment. Do not submerge beyond the seam of the blending attachment. Do not immerse the motor body into liquids or other mixtures.

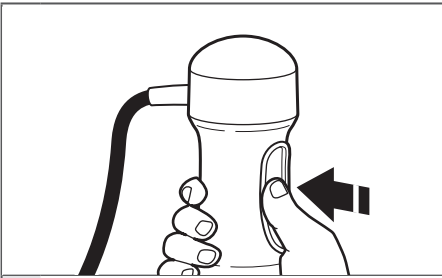

- 6** Press the POWER button to activate the Immersion Blender.

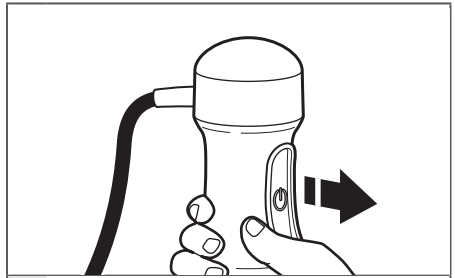

- 7** When blending is complete, release the power button before removing Immersion Blender from the mixture.

IMPORTANT: Do not exceed 30 seconds continuous operation at Speed 2.

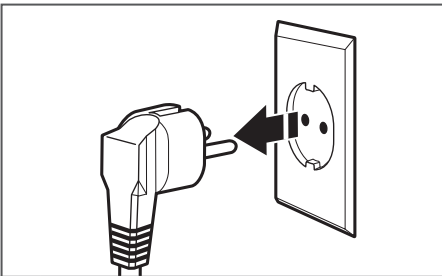

- 8** Unplug immediately after use, and before removing or changing attachments.



TIPS FOR GREAT RESULTS

BLENDING TIPS



Blending: Insert Immersion Blender with blending arm attached into the blending jar containing ingredients at an angle. Use your free hand to cover the top of the blending jar for better stability and avoid splattering. Remember to stop the Immersion Blender before removing it from the jar to avoid splashing.



Drawing up: Rest the Immersion Blender on the bottom of the blending jar momentarily then hold at an angle and slowly draw it upwards against the side of the jar. As the Immersion Blender is drawn up, you will notice the ingredients from the bottom of the jar being drawn up. When the ingredients are no longer being drawn up from the bottom, return the Immersion Blender to the bottom of the jar and repeat the process until the ingredients are at the desired consistency.

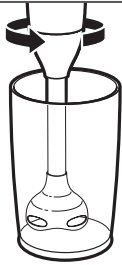

Wrist movement: Using a light circular motion from your wrist, draw the Immersion Blender up slightly and let it fall again into the ingredients. Allow your wrist motion and the weight of the Immersion Blender to do the work.



TIPS FOR GREAT RESULTS

OPERATING TIPS

- Cut solid foods into small pieces for easier blending or chopping.
- The Immersion Blender is equipped with thermal protection from high operating temperatures. Should the Immersion Blender suddenly stop during use, unplug it and allow 10 minutes to automatically reset.
- To avoid splashing, insert the Immersion Blender into the mixture before pressing the power button, and release the power button before pulling the Immersion Blender out of the mixture.
- When blending in a saucepan on a cooktop, remove the pan from the heating element to protect the Immersion Blender from overheating.
- For best blending, hold the Immersion Blender at an angle and gently move up and down within the container. Do not pound down on the mixture with the Immersion Blender.
- To prevent overflow, allow room in the container for the mixture to rise when using the Immersion Blender.
- Be sure the extra-long cord of the Immersion Blender is not extending over a hot heating element.
- Do not let the Immersion Blender sit in a hot pan on the cooktop while not in use.
- Remove hard items, such as fruit pits or bones, from the mixture before blending or chopping to help prevent damage to the blades.
- Do not use your Immersion Blender to process coffee beans or hard spices such as nutmeg. Processing these foods could damage the blades of the Immersion Blender.
- Do not use the jar in the microwave oven.



CARE AND CLEANING

WASHING THE MOTOR BODY

Always clean the Immersion Blender prior to initial use, after each use, and before storing.

1. Unplug the Immersion Blender before cleaning.
2. Remove all attachments.
3. Wipe the motor body and power cord with a warm sudsy cloth; wipe clean with a damp cloth. Dry with a soft cloth. Mild dish soap may be used, but do not use abrasive cleansers.

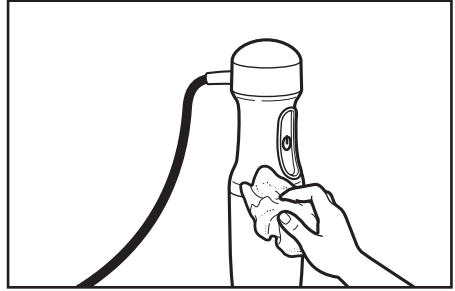

IMPORTANT: Do not immerse the motor body in water or other liquid.

WASHING THE ACCESSORIES AND ATTACHMENTS

1. Wash blending arms*, jar and lid, blades, blade guard*, and pan guard* in hot, soapy water, or in the top rack of the dishwasher.
2. Dry thoroughly with a soft cloth.

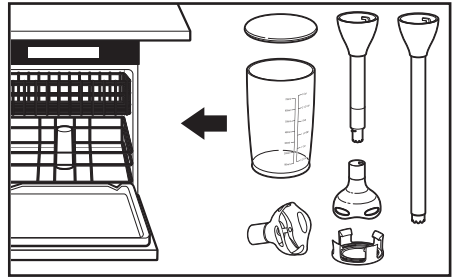

*Not available on all models



PRODUCT WARRANTY

Length of Warranty:	Focus Global Inc. Pay For:	Focus Global Inc. will repair and service for free under the following conditions:
Philippines: 2 year full warranty from date of purchase.	The replacement parts and repair labour costs to correct defects in materials or workmanship. Service will be provided by Focus Global Inc.	<ul style="list-style-type: none"> - The unit was purchased from a local authorised store / dealer. - Proof of purchase must be presented to claim the warranty. - Unit has been used for normal household food preparation only. - Damage to the unit is not due to accident, alteration, misuse, abuse, installation or operation not in accordance with local electrical codes. - Spare part damaged is non-consumable. - Replacement of the unit shall only be made after 3 unsuccessful attempts to repair /remedy the same issue.

Units that did not conform to the above conditions may still be serviced at any Authorized Focus Global Inc. and Coleman Service Centers nationwide at a minimal fee. Shipping fee or transport of unit will be charged to customer.

Focus Global Inc. DOES NOT ASSUME ANY RESPONSIBILITY FOR INDIRECT DAMAGES.

CUSTOMER SERVICE

In Philippines:

For any questions, or to find the nearest Authorised Service Centre, please find our contact details below.

NOTE: All service should be handled locally by an Authorised Focus Global Inc. Service Centre.

For Warranty / Repair, p/s to contact -
 Company: Focus Global Inc.

Address: Pioneer corner Reliance St., Mandaluyong City

Customer Service: +632 86553590 local 118 | +632 87059999

Email: kitchenaid@focusglobalinc.com

Facebook: /KitchenAidPHL

Business Hours: Monday to Friday, 7:30AM to 4:30PM

For more information, visit our website at:
www.focusglobalinc.com

©2019 All rights reserved.
 Specifications subject to change without notice.





KitchenAid

©2019 All rights reserved.
Specifications subject to change without notice.

