

KEK1222
INSTRUCTIONS
INSTRUCTIONS
INSTRUCCIONES



KitchenAid[®]

WELCOME TO THE WORLD OF KITCHENAID.

We're committed to helping you create a lifetime of delicious meals for family and friends. To help ensure the longevity and performance of your appliance, keep this guide handy. It will empower you with the best way to use and care for your product. Your satisfaction is our #1 goal. Remember to register your product online at www.kitchenaid.com or by mail using the enclosed Product Registration Card.



Join us in the kitchen at www.kitchenaid.com for recipes, tips, and more.

USA: 1.800.832.7173
Canada: 1.800.807.6777

KitchenAid.com
KitchenAid.ca

TABLE OF CONTENTS

ELECTRIC KETTLE SAFETY	
Important safeguards	4
Electrical requirements	5
PARTS AND FEATURES	
Parts.....	6
OPERATING THE ELECTRIC KETTLE	
Before first use	7
Heating water	7
CARE AND CLEANING	
Cleaning the exterior.....	8
Cleaning the filter	8
Removing mineral deposits from the interior.....	9
TROUBLESHOOTING	9
WARRANTY AND SERVICE	10

PROOF OF PURCHASE & PRODUCT REGISTRATION

Always keep a copy of the itemized sales receipt showing the date of purchase of your Electric Kettle. Proof of purchase will assure you of in-warranty service. Before you use your Electric Kettle, please fill out and mail your product registration card packed with the unit, or register online at www.kitchenaid.com. This card will enable us to contact you in the unlikely event of a product safety notification and assist us in complying with the provisions of the Consumer Product Safety Act. This card does not verify your warranty. Please complete the following for your personal records:

Model Number _____

Serial Number _____

Date Purchased _____

Store Name _____

Your safety and the safety of others are very important.

We have provided many important safety messages in this manual and on your appliance. Always read and obey all safety messages.



This is the safety alert symbol.

This symbol alerts you to potential hazards that can kill or hurt you and others.

All safety messages will follow the safety alert symbol and either the word "DANGER" or "WARNING." These words mean:

 **DANGER**

You can be killed or seriously injured if you don't immediately follow instructions.

 **WARNING**

You can be killed or seriously injured if you don't follow instructions.

All safety messages will tell you what the potential hazard is, tell you how to reduce the chance of injury, and tell you what can happen if the instructions are not followed.

State of California Proposition 65 Warnings:

WARNING: This product contains one or more chemicals known to the State of California to cause cancer.

WARNING: This product contains one or more chemicals known to the State of California to cause birth defects or other reproductive harm.

IMPORTANT SAFEGUARDS

When using electrical appliances, basic safety precautions should always be followed, including the following:

1. Read all instructions.
2. Do not touch hot surfaces. Use handles.
3. To protect against fire, electrical shock and injury to persons do not immerse base, cord, plug, or Electric Kettle in water or other liquids.
4. Close supervision is necessary when any appliance is used by or near children.
5. Unplug Electric Kettle from outlet when not in use and before cleaning. Allow to cool before putting on or taking off parts, and before cleaning appliance.
6. Do not operate any appliance with a damaged cord or plug or after the appliance malfunctions, or has been damaged in any manner. Return appliance to the nearest authorized service facility for examination, repair, or adjustment.
7. The use of accessory attachments not recommended by the appliance manufacturer may result in fire, electric shock, or injury to persons.
8. Do not use outdoors.
9. Do not let cord hang over edge of table or counter, or touch hot surfaces.
10. Do not use near or on a hot gas or electric burner stove, or in a heated oven.
11. The Electric Kettle should only be used to heat water.
12. Do not use the Electric Kettle without lid properly closed.

13. Do not use the Electric Kettle with a loose or weakened handle.
14. Do not use the appliance for other than intended use.
15. Do not clean Electric Kettle with abrasive cleaners, steel wool, or other abrasive materials.
16. This product is designed for indoor household use only. Not designed for commercial use.
17. Do not overfill Electric Kettle.
18. To disconnect, turn any control to "off," then remove plug from wall outlet.
19. Scalding may occur if the lid is removed during the brewing cycle.

SAVE THESE INSTRUCTIONS

Electrical requirements

! WARNING



Electrical Shock Hazard

Plug into a grounded 3 prong outlet.

Do not remove ground prong.

Do not use an adapter.

Do not use an extension cord.

Failure to follow these instructions can result in death, fire, or electrical shock.

Volts: 120 V.A.C.

Hertz: 60 Hz

NOTE: The Water Kettle has a 3 prong grounded plug. To reduce the risk of electrical shock, this plug will fit in an outlet only one way. If the plug does not fit in the outlet, contact a qualified electrician. Do not modify the plug in any way.

Do not use an extension cord. If the power supply cord is too short, have a qualified electrician or serviceman install an outlet near the appliance.

A short power supply cord (or detachable power supply cord) should be used to reduce the risk resulting from becoming entangled in or tripping over a longer cord.

Longer detachable power supply cords or extension cords are available and may be used.

If a longer detachable power supply cord or extension cord is used:

- The marked electrical rating of the cord set or extension cord should be at least as great as the electrical rating of the appliance.
- If the appliance is of the grounded type, the extension cord should be a grounding-type 3-wire cord.
- The cord should be arranged so that it will not drape over the countertop or tabletop where it can be pulled on by children or tripped over unintentionally.

PARTS AND FEATURES

Parts

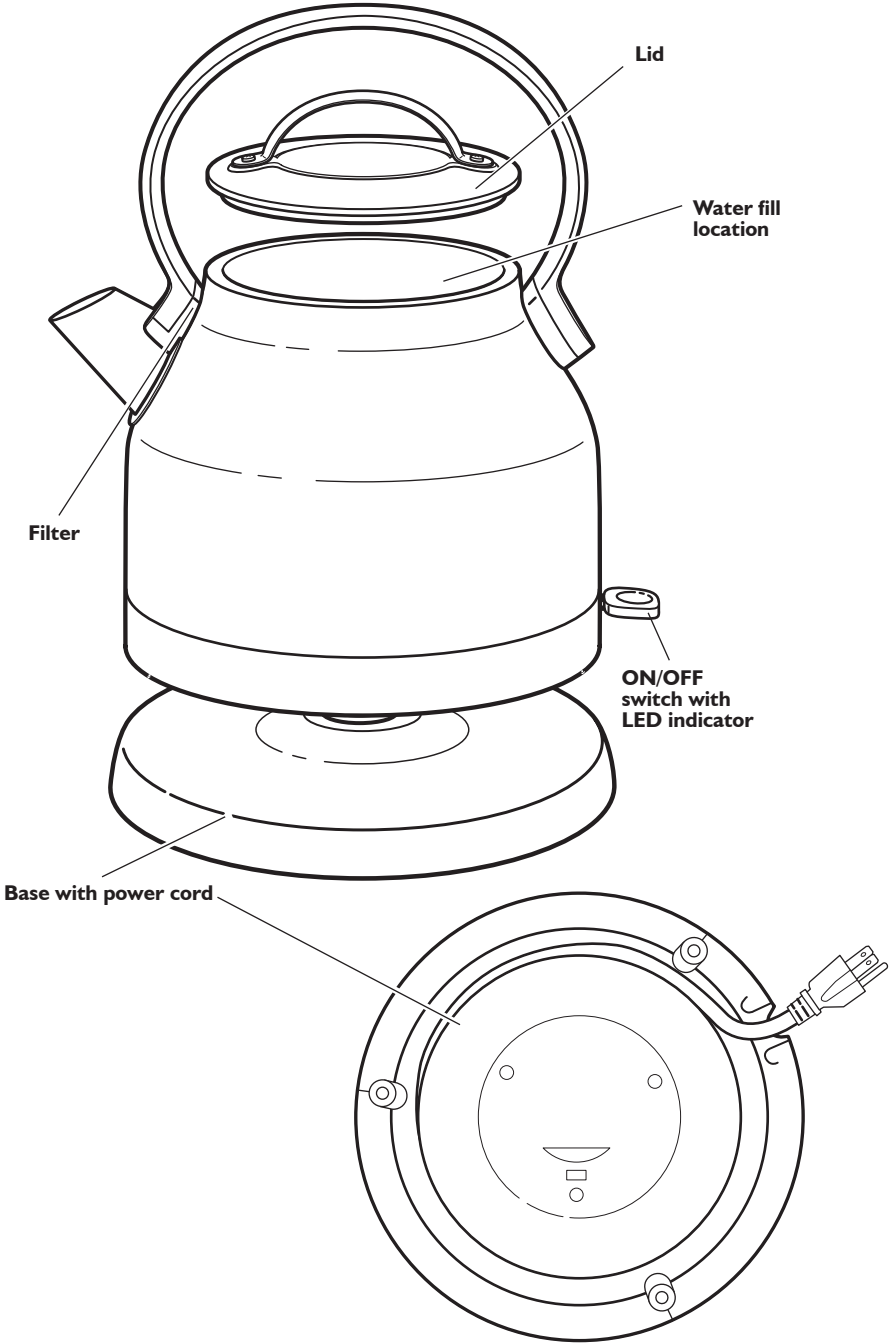

OPERATING THE ELECTRIC KETTLE

Before first use

Before first use, fill the Electric Kettle to the maximum level, then boil and discard the water. If the cord is too short, turn the Kettle base over and unwrap any additional cord needed to plug in where desired.

NOTE: The Electric Kettle is designed for water only. Do not put any other liquids or substances in the Electric Kettle.

Heating water

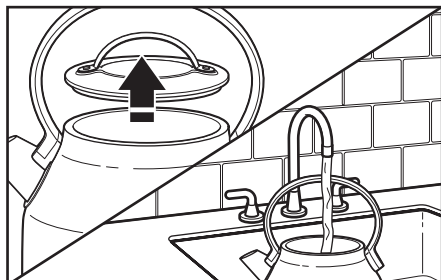

1 Remove the lid from the kettle. Fill the electric kettle with water.

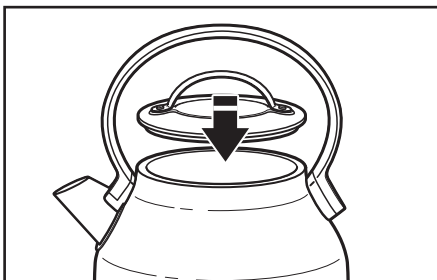

2 Replace the lid.

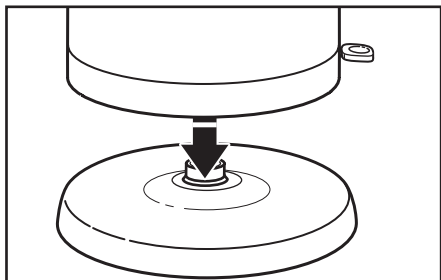

3 Place the electric kettle on the base.

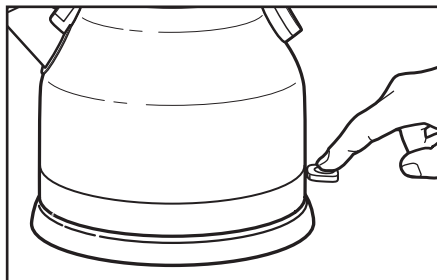

4 Turn the electric kettle ON by pressing the ON/OFF switch down. The LED indicator will light. Kettle will automatically turn OFF when water has finished boiling.

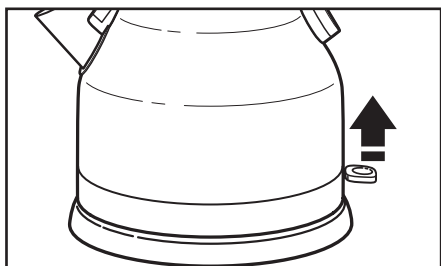

5 You may also turn it off by raising the switch to the OFF position.

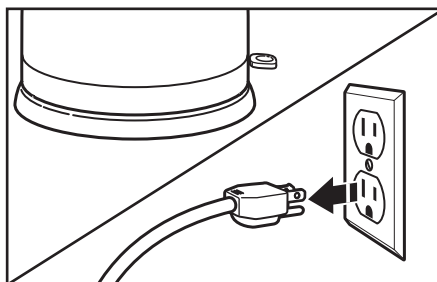

6 Unplug cord when Electric Kettle is not in use.

CARE AND CLEANING

Cleaning the exterior

IMPORTANT: Before cleaning always disconnect the Electric Kettle from electrical outlet. Make sure the Electric Kettle has cooled completely.

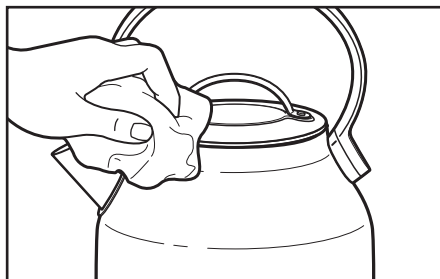

1 The exterior of the Electric Kettle may be cleaned with a damp cloth. Dry and polish the Electric Kettle with a soft cloth. Abrasives and scouring agents of any kind are not recommended.

Cleaning the filter

The Electric Kettle features a removable mesh filter that traps scale deposits for cleaner water. The filter will need to be cleaned periodically—more often if you have hard water.

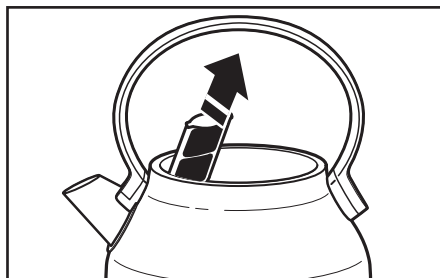

1 To access filter: Open the lid; the filter is located behind spout inside Electric Kettle. Grasp the top of the filter to remove.

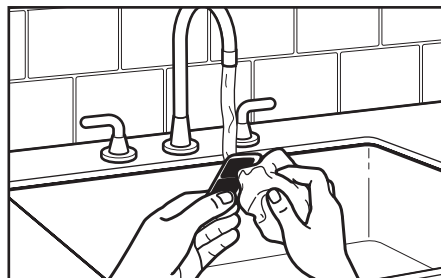

2 Clean under hot water with a soft brush or cloth to remove deposits, and replace filter by sliding the filter into the slot behind the spout.

NOTE: If calcium deposits remain on the filter, let it stand overnight in a solution of water and white vinegar. Rinse the filter thoroughly and replace in the Electric Kettle.

CARE AND CLEANING

Removing mineral deposits from the interior

To get the best performance from your Electric Kettle, decalcification will be necessary. Calcium deposits may form on the interior metal parts of the Electric Kettle. The cleaning interval will depend on the hardness of the water you put in the Electric Kettle.

English

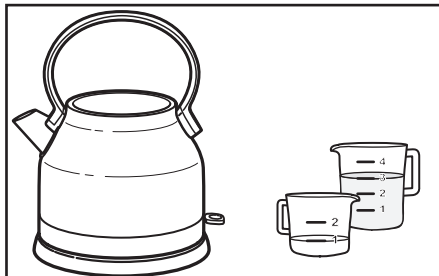

- 1 Fill the Electric Kettle with 1 cup (.25 L) white vinegar. Add 3 cups (.75 L) water. Turn kettle ON.

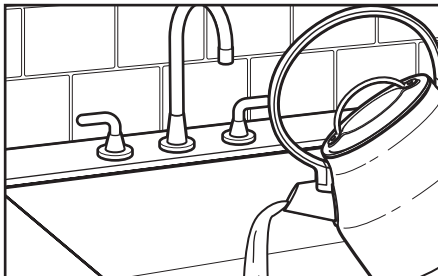

- 2 Empty solution from Electric Kettle and repeat process twice. Electric Kettle is now ready for use.

TROUBLESHOOTING

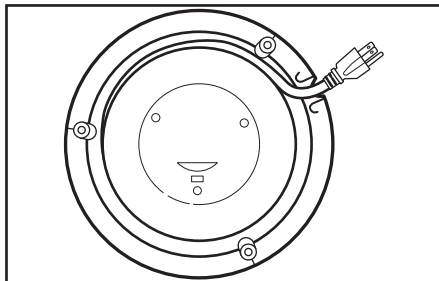

Cord seems too short:

If the cord is too short, turn the Kettle base over, and unwrap any additional cord needed to plug in where desired.

WARRANTY AND SERVICE

KitchenAid® Electric Kettle Warranty for the 50 United States, the District of Columbia, Puerto Rico, and Canada

This warranty extends to the purchaser and any succeeding owner for Electric Kettle operated in the 50 United States, the District of Columbia, Puerto Rico, and Canada.

Length of Warranty:	One Year Full Warranty from date of purchase.
KitchenAid Will Pay for Your Choice of:	Hassle-Free Replacement of your Electric Kettle. See the next page for details on how to arrange for service, or call the Customer eXperience Center toll-free at 1-800-541-6390 . OR The replacement parts and repair labor costs to correct defects in materials and workmanship. Service must be provided by an Authorized KitchenAid Service Center.
KitchenAid Will Not Pay for:	<ul style="list-style-type: none">A. Repairs when Electric Kettle is used in other than normal single family home use.B. Damage resulting from accident, alteration, misuse or abuse.C. Any shipping or handling costs to deliver your Electric Kettle to an Authorized Service Center.D. Replacement parts or repair labor costs for Electric Kettle operated outside the 50 United States, District of Columbia, Puerto Rico, and Canada.
DISCLAIMER OF IMPLIED WARRANTIES; LIMITATION OF REMEDIES IMPLIED WARRANTIES, INCLUDING TO THE EXTENT APPLICABLE WARRANTIES OF MERCHANTABILITY OR FITNESS FOR A PARTICULAR PURPOSE, ARE EXCLUDED TO THE EXTENT LEGALLY PERMISSIBLE. ANY IMPLIED WARRANTIES THAT MAY BE IMPOSED BY LAW ARE LIMITED TO ONE YEAR, OR THE SHORTEST PERIOD ALLOWED BY LAW. SOME STATES AND PROVINCES DO NOT ALLOW LIMITATIONS OR EXCLUSIONS ON HOW LONG AN IMPLIED WARRANTY OF MERCHANTABILITY OR FITNESS LASTS, SO THE ABOVE LIMITATIONS OR EXCLUSIONS MAY NOT APPLY TO YOU. IF THIS PRODUCT FAILS TO WORK AS WARRANTED, CUSTOMER'S SOLE AND EXCLUSIVE REMEDY SHALL BE REPAIR OR REPLACEMENT ACCORDING TO THE TERMS OF THIS LIMITED WARRANTY. KITCHENAID AND KITCHENAID CANADA DO NOT ASSUME ANY RESPONSIBILITY FOR INCIDENTAL OR CONSEQUENTIAL DAMAGES. This warranty gives you specific legal rights and you may also have other rights which vary from state to state or province to province.	



Hassle-Free Replacement Warranty – 50 United States, District of Columbia, and Puerto Rico

We're so confident the quality of our products meets the exacting standards of KitchenAid that, if your Electric Kettle should fail within the first year of ownership, KitchenAid will arrange to deliver an identical or comparable replacement to your door free of charge and arrange to have your original Electric Kettle returned to us. Your replacement unit will also be covered by our one year limited warranty.

If your Electric Kettle should fail within the first year of ownership, simply call our

toll-free Customer eXperience Center at **1-800-541-6390** Monday through Friday. Please have your original sales receipt available when you call. Proof of purchase will be required to initiate the claim. Give the consultant your complete shipping address. (No P.O. Box numbers, please.)

When you receive your replacement Electric Kettle, use the carton, packing materials, and prepaid shipping label to pack up your original Electric Kettle and send it back to KitchenAid.

Hassle-Free Replacement Warranty – Canada

We're so confident the quality of our products meets the exacting standards of the KitchenAid brand that, if your Electric Kettle should fail within the first year of ownership, we will replace your Electric Kettle with an identical or comparable replacement. Your replacement unit will also be covered by our one year limited warranty.

If your Electric Kettle should fail within the first year of ownership, simply call our toll-free Customer eXperience Center

at **1-800-807-6777** Monday through Friday. Please have your original sales receipt available when you call. Proof of purchase will be required to initiate the claim. Give the consultant your complete shipping address.

When you receive your replacement Electric Kettle, use the carton, packing materials, and prepaid shipping label to pack up your original Electric Kettle and send it back to KitchenAid.

Arranging for Service after the Warranty Expires, or Ordering Accessories and Replacement Parts

In the United States and Puerto Rico:

For service information, or to order accessories or replacement parts, call toll-free at **1-800-541-6390** or write to:

Customer eXperience Center,
KitchenAid Small Appliances,
P.O. Box 218, St. Joseph, MI 49085-0218

Outside the United States and Puerto Rico:

Consult your local KitchenAid dealer or the store where you purchased the Electric Kettle for information on how to obtain service.

For service information in Canada:

Call toll-free **1-800-807-6777**.

For service information in Mexico:

Call toll-free **01-800-0022-767**.

KitchenAid®

®/™ © 2015 KitchenAid. All rights reserved. Used under license in Canada.

®/™ © 2015 KitchenAid. Tous droits réservés. Utilisé sous licence au Canada.

®/™ © 2015 KitchenAid. Todos los derechos reservados. Usada en Canadá bajo licencia.