



**INSTALLATION INSTRUCTIONS**  
**(ORIGINAL INSTRUCTIONS)**  
COMMERCIAL WASHER

**INSTRUCTIONS D'INSTALLATION**  
**(INSTRUCTIONS D'ORIGINE)**  
LAVE-LINGE COMMERCIAL

**INSTRUCCIONES DE INSTALACIÓN**  
**(INSTRUCCIONES ORIGINALES)**  
LAVADORA COMERCIAL

**ISTRUZIONI D'INSTALLAZIONE**  
**(ISTRUZIONI ORIGINALI)**  
LAVATRICE COMMERCIALE

---

XCAE2765FQ



## TABLE OF CONTENTS

	Page
Washer Safety .....	3
<b>FOR OWNER</b>	
General Use Instructions .....	4
Typical Full Load Sizes .....	4
Transporting Your Washer .....	5
If You Need Assistance or Service .....	5
<b>FOR WHIRLPOOL AUTHORIZED SERVICE PERSON</b>	
Tools & Parts .....	6
Alternate Parts & Accessories .....	6
Dimensions .....	7
Location Requirements .....	8
Installation Instructions .....	9
Level Washer .....	10
Connect Drain Hose .....	11
Drain System .....	12
Connect Inlet Hoses .....	13
Electrical Requirements .....	14
Complete Installation .....	15
Installing Coin Slide and Coin Box .....	15
Washer Disposal .....	16
Warranty .....	17

## ÍNDICE

	Página
Seguridad de la lavadora .....	33
<b>PARA EL PROPIETARIO</b>	
Instrucciones del uso general .....	34
Tamaños de cargas típicas de volumen completo .....	34
Transporte de la lavadora .....	35
Si necesita asistencia o servicio .....	35
<b>PARA EL PERSONAL DE SERVICIO AUTORIZADO DE WHIRLPOOL</b>	
Herramientas y piezas .....	36
Piezas y accesorios alternativos .....	36
Dimensiones .....	37
Requisitos de ubicación .....	38
Instrucciones de instalación .....	39
Nivelación de la lavadora .....	40
Conexión de la manguera de desagüe .....	41
Sistema de desagüe .....	42
Conexión de las mangueras de entrada .....	43
Requisitos eléctricos .....	44
Complete la instalación .....	45
Instalación del tragamonedas y la caja de monedas .....	45
Eliminación de la lavadora .....	46
Garantía .....	47

## TABLE DES MATIÈRES

	Page
Sécurité du lave-linge .....	18
<b>POUR LE PROPRIÉTAIRE</b>	
Instructions de l'utilisation général .....	19
Taille typique des charges complètes .....	19
Transport du lave-linge .....	20
Si vous avez besoin d'assistance ou service .....	20
<b>POUR LE PERSONNEL D'ENTRETIEN AUTORISÉ PAR WHIRLPOOL</b>	
Outillage et pièces .....	21
Pièces supplémentaires et accessoires .....	21
Dimensions .....	22
Exigences d'emplacement .....	23
Instructions d'installation .....	24
Établissement de l'aplomb du lave-linge .....	25
Raccordement du tuyau de vidange .....	26
Système de vidange .....	27
Raccordement des tuyaux d'arrivée d'eau .....	28
Spécifications électriques .....	29
Achever l'installation .....	30
Installation de la glissière et de la boîte à monnaie .....	30
Élimination du lave-linge .....	31
Garantie .....	32

## SOMMARIO

	Pagina
Sicurezza della lavatrice .....	48
<b>PER IL PROPRIETARIO</b>	
Istruzioni del uso generale .....	49
Dimensioni tipiche a carico completo .....	49
Transporto della lavatrice .....	50
Se avete bisogno dell'assistenza o servizio .....	50
<b>PER IL PERSONALE DI ASSISTENZA AUTORIZZATO WHIRLPOOL</b>	
Attrezzi e componenti .....	51
Parti e accessori alternativi .....	51
Dimensioni .....	52
Requisiti di posizionamento .....	53
Istruzioni d'installazione .....	54
Livellamento della lavatrice .....	55
Connessione del tubo di scarico .....	56
Sistema di scarico .....	57
Collegare i tubi d'ingresso .....	58
Requisiti elettrici .....	59
Completamento dell'installazione .....	60
Installazione dello scivolo monete e della gettoniera .....	60
L'eliminazione della lavatrice .....	61
Garanzia .....	64

# WASHER SAFETY

## Your safety and the safety of others are very important.

We have provided many important safety messages in this manual and on your appliance. Always read and obey all safety messages.



This is the safety alert symbol.

This symbol alerts you to potential hazards that can kill or hurt you and others.

All safety messages will follow the safety alert symbol and either the word "DANGER" or "WARNING."

These words mean:

**⚠ DANGER**

You can be killed or seriously injured if you don't immediately follow instructions.

**⚠ WARNING**

You can be killed or seriously injured if you don't follow instructions.

All safety messages will tell you what the potential hazard is, tell you how to reduce the chance of injury, and tell you what can happen if the instructions are not followed.

**NOTE:** Washer installation and service must be performed by a Whirlpool authorized service person.

## IMPORTANT SAFETY INSTRUCTIONS

**WARNING:** To reduce the risk of fire, electric shock, or injury to persons when using the washer, follow basic precautions, including the following:

- Read all instructions before using the washer. 
- Do not wash articles that have been previously cleaned in, washed in, soaked in, or spotted with petrol, dry-cleaning solvents, or other flammable or explosive substances as they give off vapours that could ignite or explode.
- Do not add petrol, dry-cleaning solvents, or other flammable or explosive substances to the wash water. These substances give off vapours that could ignite or explode.
- Under certain conditions, hydrogen gas may be produced in a hot water system that has not been used for 2 weeks or more. **HYDROGEN GAS IS EXPLOSIVE.** If the hot water system has not been used for such a period, before using the washer, turn on all hot water taps and let the water flow from each for several minutes. This will release any accumulated hydrogen gas. As the gas is flammable, do not smoke or use an open flame during this time.
- The appliance must be disconnected from its power source during service and when replacing parts. The power cord plug should be visible at all times once disconnected to verify that power remains removed.
- This appliance is not intended for use by children or by persons with reduced physical, sensory, or mental capabilities, or lack of experience and knowledge, unless they have been given supervision or instructions concerning safe use of the appliance by persons responsible for their safety. Such persons must also understand the possible hazards involved during use.
- The appliance can be used by children age 8 years and above and persons with reduced physical, sensory, or mental capabilities, or lack of experience and knowledge if they have been given supervision or instructions concerning safe use of the washer, and if they understand the hazards involved.
- Children of less than 3 years should be kept away unless continuously supervised.
- This appliance is intended to be used in household and similar applications such as staff kitchen areas, shops, offices, other working environments, farm houses. It can also be used by clients in hotels, motels, other residential type environments, bed and breakfast type environments, areas for communal use in blocks of flats, or in laundrettes.

**SAVE THESE INSTRUCTIONS**

- No washer can completely remove oil. Do not dry anything that has ever had any type of oil on it (including cooking oils). Doing so can result in death, explosion, or fire.
- It is recommended that fiberglass items not be washed in coin-operated washers. If these items are washed in the washer, run the washer through a complete cycle to rinse away any residue that might be left in the washer.
- Cleaning and user maintenance by children must be supervised.
- Do not allow children to play on, in, or with the washer. Close supervision of children is necessary when the washer is used near children.
- Before the washer is removed from service or discarded, remove the door or lid.
- Do not reach into the washer if the basket, tub, or agitator is moving.
- Do not install or store the washer where it will be exposed to the weather.
- Do not tamper with controls.
- After installation, access to mains plug or mains supply via a double-pole switch must be maintained at all times in order to ensure immediate deactivation of the washer in case of emergency.
- Do not repair or replace any part of the washer or attempt any servicing unless specifically recommended in this manual. You must also understand these instructions and have the skills to carry them out.
- See “Electrical Requirements” for grounding instructions.

**SAVE THESE INSTRUCTIONS**

## GENERAL USE INSTRUCTIONS

- Water pressure of 138–690 kPa (20–100 psi) is needed for operation of the washer.
- Use new hoses supplied with the washer. Do not reuse old hoses.
- If the supply cord is damaged, it must be replaced by the manufacturer, its service agent, or similarly qualified persons in order to avoid a hazard.

## TYPICAL FULL LOAD SIZES

Load Type	Loading Suggestion	Load Type	Loading Suggestion
Mixed Load	3 double sheets 4 pillowcases 6 pair shorts 8 T-shirts 2 shirts 2 blouses 8 handkerchiefs	Heavy Work Clothes	3 pair pants 3 shirts 1 coverall 4 pair jeans 1 overall
Permanent Press	2 double or 1 king size sheet 1 tablecloth 1 dress 1 blouse 2 slacks 3 shirts 2 pillowcases	Knits	3 blouses 4 slacks 6 shirts 4 tops 4 dresses

# TRANSPORTING YOUR WASHER

---

- Shut off both water faucets. Disconnect and drain water inlet hoses.
- Disconnect drain from drain system and drain any remaining water into a pan or bucket. Disconnect drain hose from back of washer.
- Unplug power cord.
- Place inlet hoses and drain hose inside washer basket.
- Drape power cord over edge and into washer basket.
- Place packing tray from original shipping materials back inside washer and reuse shipping base to support the motor and tub. If you do not have original packaging, place heavy blankets or towels above basket, between the washer top and the tub ring. Close lid and place tape over lip and down the front of the washer. Keep lid taped until washer is moved to new location.

## IF YOU NEED ASSISTANCE OR SERVICE

---

Your installation may require additional parts. To order, please contact your authorised commercial laundry distributor from whom you purchased your washer or an authorised service company.

You will need the washer model number and serial number. Both numbers can be found on the serial-rating plate located on the washer.

### **IF YOU NEED SERVICE:**

Contact your authorized Whirlpool® Commercial Laundry distributor. To locate your authorized Whirlpool® Commercial Laundry distributor, visit [www.WhirlpoolCommercialLaundry.com](http://www.WhirlpoolCommercialLaundry.com).

For written correspondence:

**Whirlpool® Commercial Laundry Service Department**  
**2000 N M 63**  
**Benton Harbor, Michigan 49022-2632 USA**

# TOOLS & PARTS

## Tools Needed:



Level

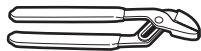

Pliers



Utility Knife



14 mm (9/16")  
Open-End Wrench  
or Adjustable Wrench



Flat-Blade Screwdriver

## Optional tools:

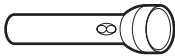

Flashlight



Bucket

## Parts Supplied:

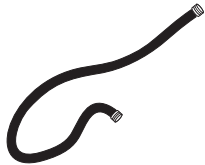

Water Inlet Hoses (2)



Inlet Hose Washers (4)

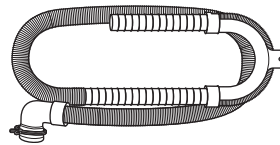

Drain Hose with Clamp,  
U-Form, and Cable Tie

# ALTERNATE PARTS & ACCESSORIES

Your installation may require additional parts. To order, please contact the dealer from whom you purchased your washer or an authorised service company.

If You Have:	You Will Need:
Overhead sewer	Standard 76 L (20 gal.) 990 mm (39") tall drain tub or utility sink, sump pump, and connectors (available from local plumbing suppliers)
1" (25 mm) standpipe	51 mm (2") diameter to 25 mm (1") diameter Standpipe Adapter Part Number 3363920, Connector Kit Part Number 285835
Lint clogged drain	Drain Protector Part Number 367031, Connector Kit Part Number 285835
Floor drain system	Siphon Break Part Number 285320, Connector Kit (x2) Part Number 285835, Extension Drain Hose Part Number 285863

If You Have:	You Will Need:
Water faucets beyond reach of fill hoses	2 longer water fill hoses: 1.8 m (6 ft.) 90° bend hose Part Number 76314, 3.0 m (10 ft.) Part Number 350008
	Inlet hoses are sold as a pair in kit W10575888
Accessories	
If You Have:	You Will Need:
	Washer Drip Trays Part Number 8212526
	Fabric Softener Dispenser Kit Part Number 63594
Drain beyond the reach of drain hose	1.2 m (4 ft.) Drain Hose Extension Part Number DRNEXT4

# DIMENSIONS

Front View

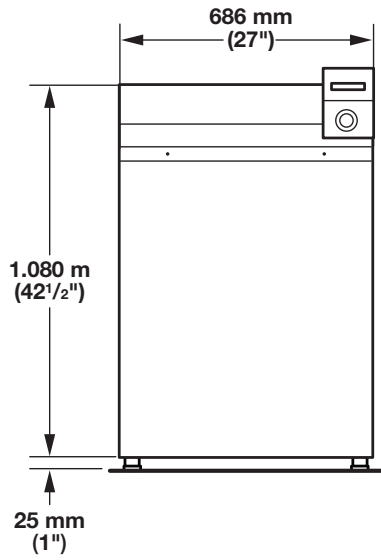

Side View

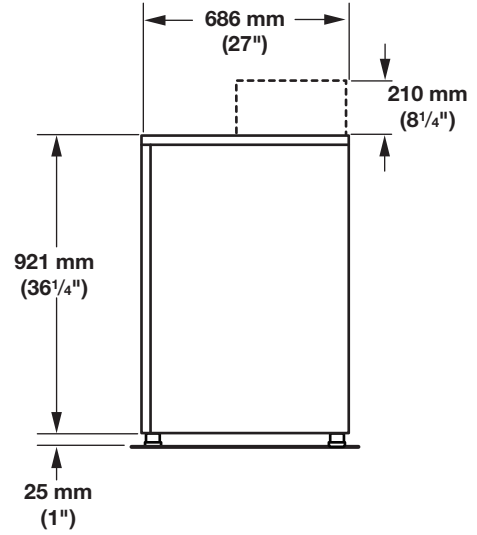

Back View

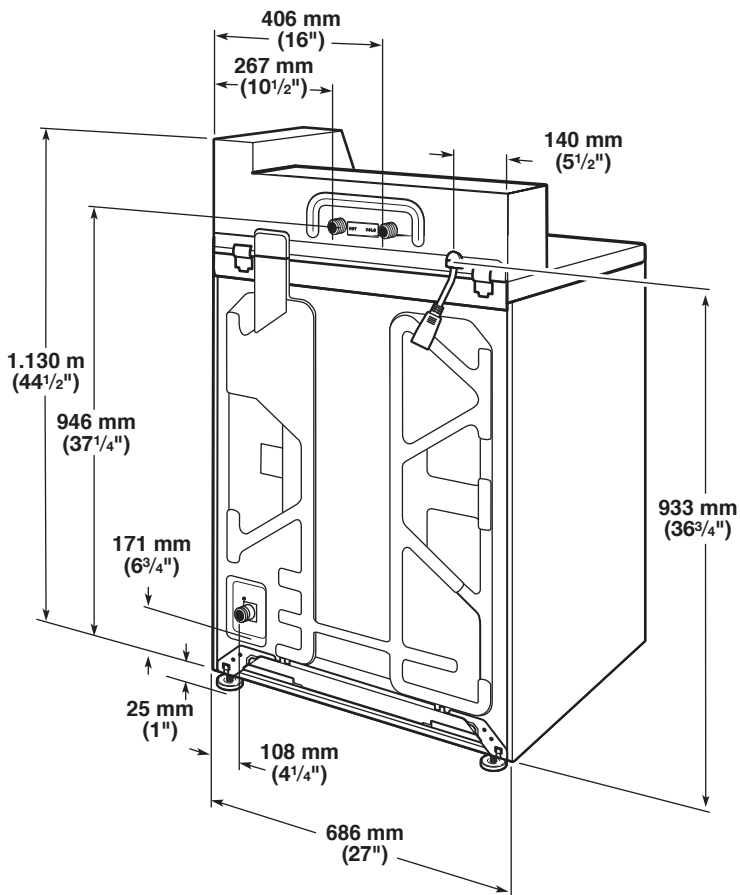

# LOCATION REQUIREMENTS

Selecting the proper location for your washer improves performance and minimizes noise and possible washer “walk.” Your washer can be installed in a basement, laundry room, or recessed area. See “Drain System.”

Companion appliance location requirements should also be considered.

**IMPORTANT:** Do not install or store the washer where it will be exposed to the weather. Do not store or operate the washer in temperatures at or below 0°C (32°F). Some water can remain in the washer and can cause damage in low temperatures. Proper installation is your responsibility.

## You will need:

- A water heater set to 49°C (120°F).
- An earthed electrical outlet located within 1.2 m (4 ft.) of power cord on back of washer. See “Electrical Requirements.”
- Hot and cold water faucets located within 1.2 m (4 ft.) of hot and cold water fill valves on washer, and water pressure of 138–690 kPa (20–100 psi). A pressure reduction valve should be used in the supply line where inlet pressure entering the building exceeds 690 kPa (100 psi) to avoid damage to the washer mixing valve.
- Single washer installations require 300 mm (12") minimum risers to provide an air cushion and avoid noise and damage to valves.
- A level floor with maximum slope of 25 mm (1") under entire washer. Installing on carpet is not recommended.
- Floor must support washer’s total weight (with water and load) of 143 kgs (315 lbs).
- A floor drain under the bulkhead. Prefabricated bulkheads with electrical outlets, water inlet lines, and drain facilities should be used only where local codes permit.

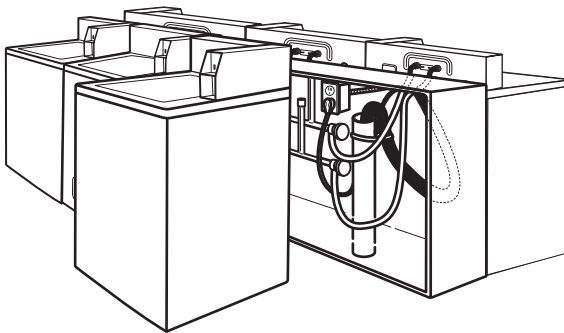

## Recessed Area or Closet Installation

This washer may be installed in a recessed area or closet. The installation dimensions shown are the minimum spaces allowable. Additional spacing should be considered for ease of installation and servicing. Companion appliance spacing should be considered.

## Minimum installation spacing

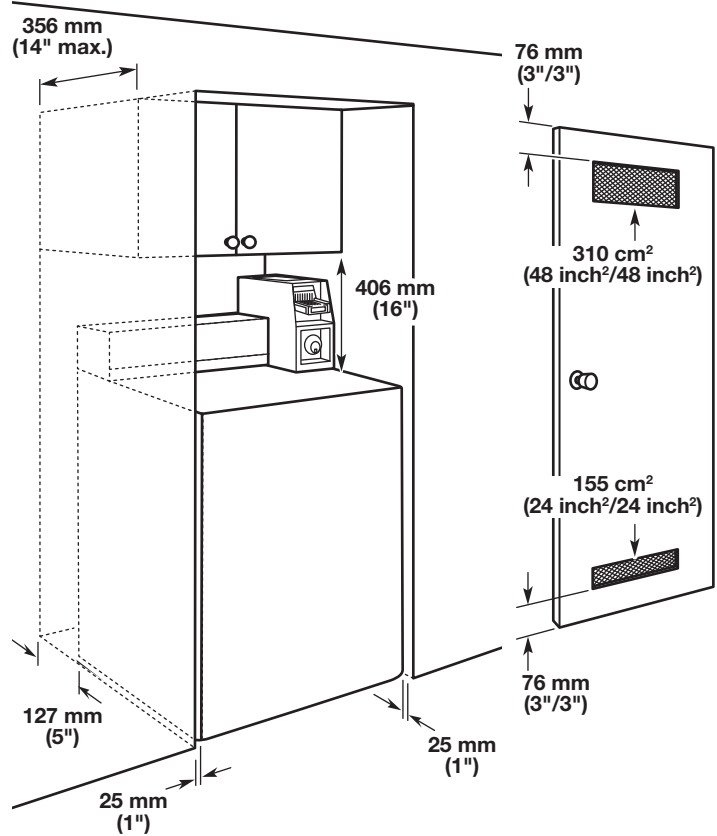



# INSTALLATION INSTRUCTIONS

## **⚠ WARNING**

### **Excessive Weight Hazard**

**Use two or more people to move and install washer.**

**Failure to do so can result in back or other injury.**

It is necessary to remove all shipping materials for proper operation and to avoid excessive noise from washer.

1. Move washer to within 1.2 m (4 ft.) of its final location; it must be in a fully upright position.

**NOTE:** To avoid floor damage, set washer onto cardboard before moving it and make sure lid is taped shut.

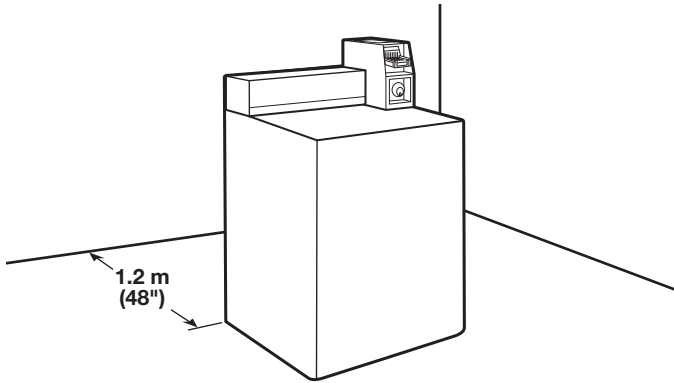

2. To avoid damaging floor, place cardboard supports from shipping carton on floor behind washer. Tip washer back and place on cardboard supports. Remove shipping base. Set washer upright.

**IMPORTANT:** Removing shipping base is necessary for proper operation. If your washer includes a sound shield, please refer to the instructions included with the sound shield to install it at this time.

**NOTE:** Keep shipping base in case you need to move washer later.

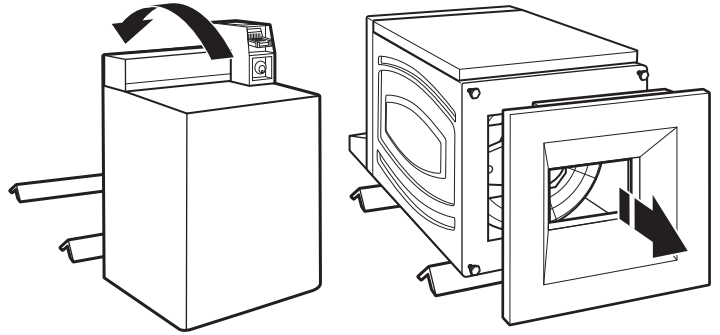

3. Remove tape from washer lid, open lid, and remove cardboard packing tray from tub. Be sure to remove all parts from tray.

**NOTE:** Tray must be removed prior to plugging the washer into an outlet. Keep tray in case you need to move washer later.

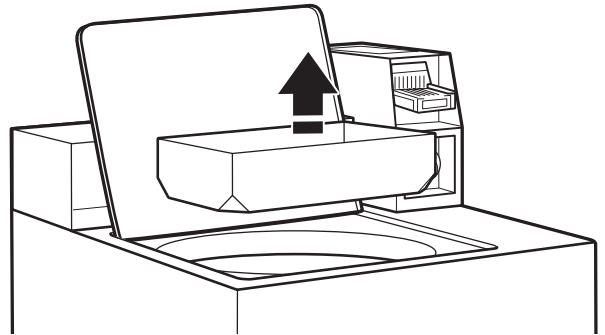

# LEVEL WASHER

**IMPORTANT:** Level washer properly to reduce excess noise and vibration.

## **⚠ WARNING**

### **Excessive Weight Hazard**

**Use two or more people to move and install washer.**

**Failure to do so can result in back or other injury.**

1. Move the washer to its final location. Place a level on top edges of washer. Use side seam as a guide to check levelness of sides. Check levelness of front using lid, as shown. Rock washer back and forth to make sure all 4 feet make solid contact with floor.

Place level here

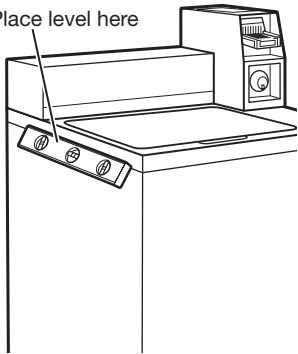

Place level here

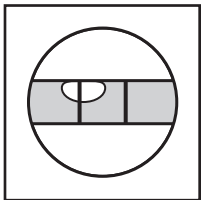
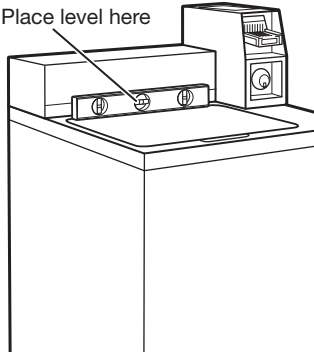

Not Level

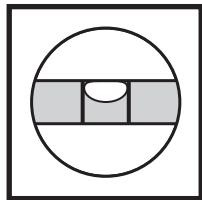

LEVEL

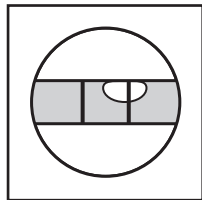

Not Level

2. Use a 14 mm or 9/16" open-end or adjustable wrench to turn jam nuts clockwise on feet until they are about 13 mm (1/2") from the washer cabinet. Then turn the leveling foot clockwise to lower the washer or counterclockwise to raise the washer. Recheck levelness of washer and repeat as needed.

**HELPFUL TIP:** You may want to prop up front of washer about 102 mm (4") with a wood block or similar object that will support weight of washer.

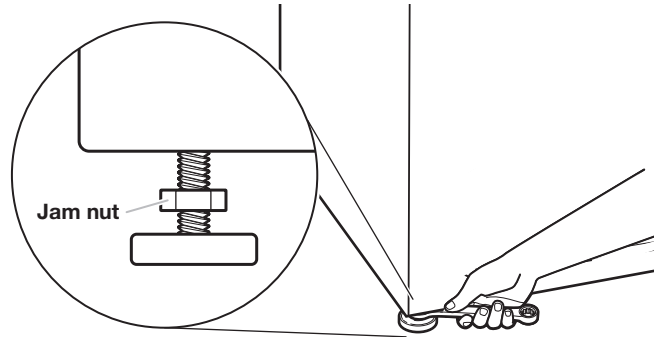

3. When washer is level, use a 14 mm or 9/16" open-end or adjustable wrench to turn jam nuts counterclockwise on leveling feet tightly against washer cabinet.

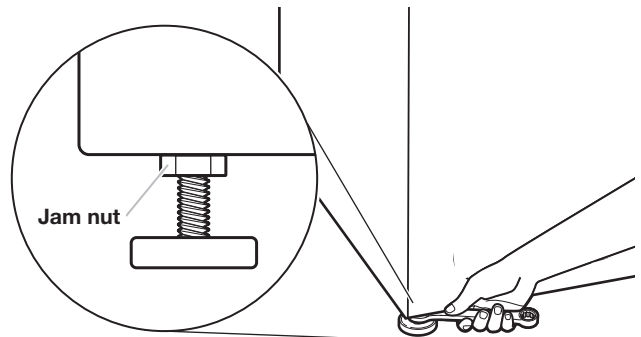

# CONNECT DRAIN HOSE

Proper routing of the drain hose avoids damage to your floor due to water leakage.

## Remove drain hose from the washer basket

1. Remove cap from the washer drain port on the back of the washer.

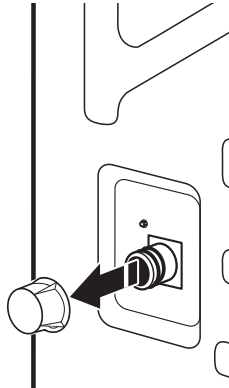

2. If clamp is not already in place on elbow end of drain hose, slide it over end as shown.

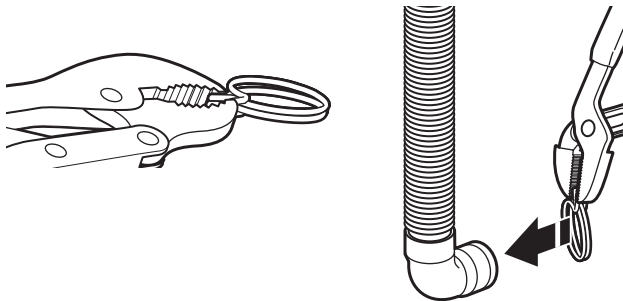

3. Squeeze clamp with pliers and slide elbow end of drain hose onto washer drain port and secure with clamp.

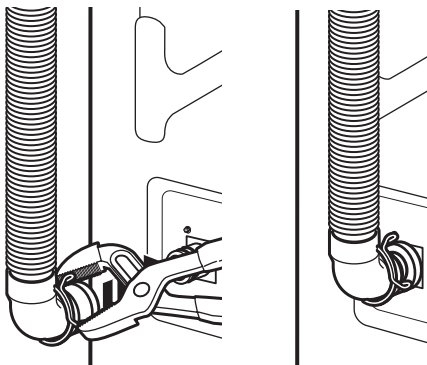

4. The washer drain system can be installed using a floor drain, wall standpipe, floor standpipe, or laundry tub.

5. Place hose into standpipe (shown in picture) or over side of laundry tub.

### IMPORTANT:

- Drain hose is not to exceed 203 mm (8") into drain pipe; do not force excess hose into standpipe or lay on bottom of laundry tub. Drain hose form must be used.
- It is the responsibility of the installer to install and secure the drain hose into the provided plumbing/drain in a manner that will avoid the drain hose coming out of, or leaking from, the plumbing/drain.

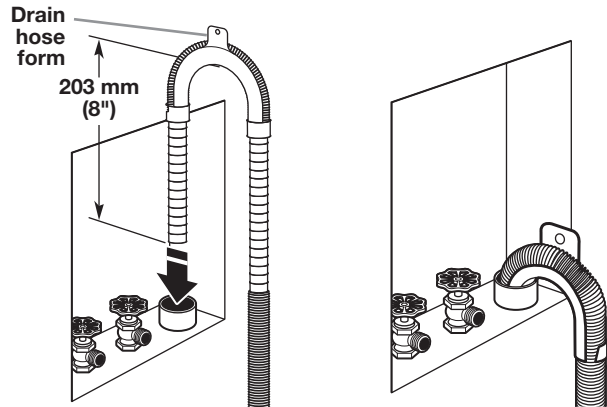

6. For floor drain installations, you will need to remove the drain hose form from the end of the drain hose. You may need additional parts with separate directions. See "Tools and Parts."

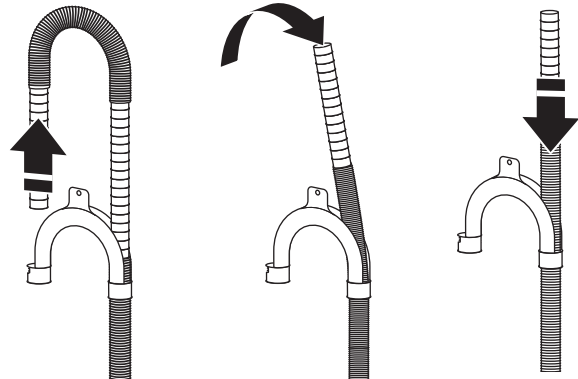

7. The floor drain system requires a siphon break that may be purchased separately. The siphon break (Part Number 285320) must be a minimum of 710 mm (28") from the bottom of the washer. Additional hoses might be needed.

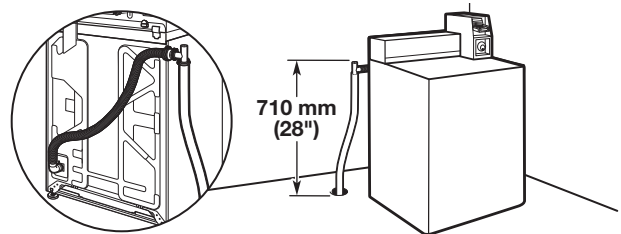

# DRAIN SYSTEM

Drain system can be installed using a floor drain, wall standpipe, floor standpipe, or laundry tub. Select method you need.

## Floor standpipe drain system

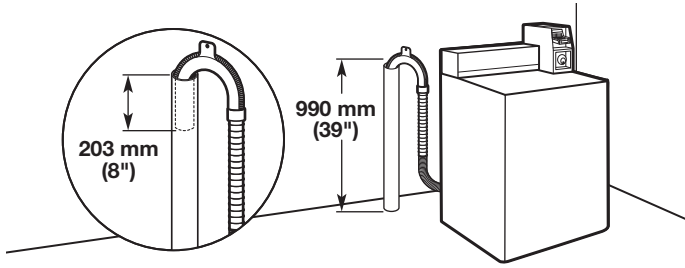

Minimum diameter for a standpipe drain: 51 mm (2"). Minimum carry-away capacity: 38 L (10 gal.) per minute. Top of standpipe must be at least 990 mm (39") high; install no higher than 2.44 m (96") from bottom of washer.

## Wall standpipe drain system

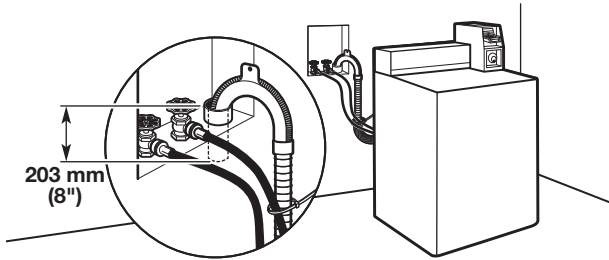

See requirements for floor standpipe drain system.

## Floor drain system

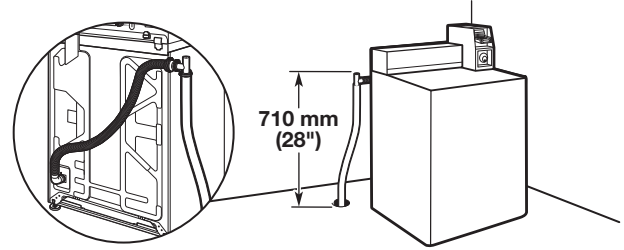

Floor drain system requires a Siphon Break Kit (Part Number 285320). Minimum siphon break: 710 mm (28") from bottom of washer. Additional hoses may be needed.

## Laundry tub drain system

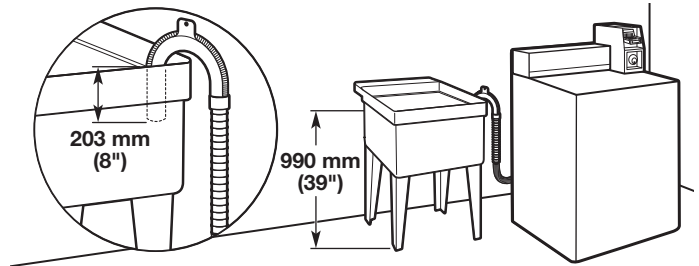

Minimum capacity: 76 L (20 gal.). The top of the laundry tub must be at least 990 mm (39") above floor.

# CONNECT INLET HOSES

Insert new hose washers (supplied) into each end of the inlet hoses. Firmly seat the washers in the couplings.

**NOTE:** Use new hoses supplied with the washer. Do not reuse old hoses.

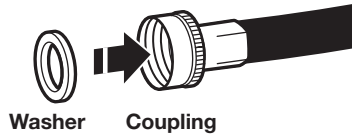

## Connect Inlet Hoses to Water Faucets

1. Attach hose to hot water faucet. Screw on coupling until it is seated on washer. Repeat process for cold water.

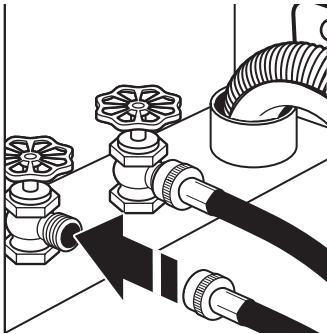

2. Use pliers to tighten the couplings an additional two-thirds turn.

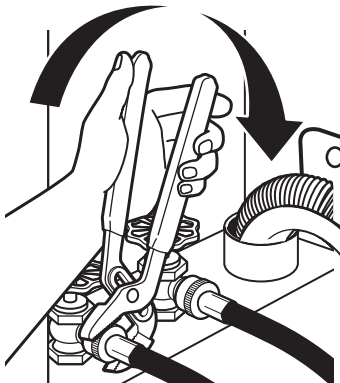

**IMPORTANT:** Do not overtighten or use tape or sealants on valve when attaching to faucets or washer. Damage can result.

3. Secure drain hose to inlet hose with zip strap.

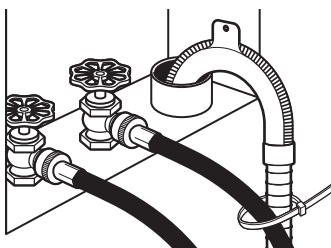

## Clear Water Lines

- Run water through both faucets and inlet hoses, into a laundry tub, drainpipe, or bucket, to get rid of particles in the water lines that might clog the inlet valve screens.
- Check the temperature of the water to make sure that the hot water hose is connected to the hot water faucet and that the cold water hose is connected to the cold water faucet.



## Connect Inlet Hoses to Washer

1. Attach cold water hose to cold water inlet valve marked with a blue ring. Screw coupling by hand until it is snug.

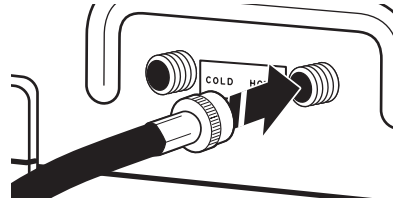

2. Attach hot water hose to hot water inlet valve marked with a red ring. Screw coupling by hand until it is snug.

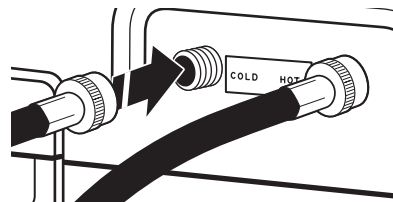

3. Use pliers to tighten couplings an additional two-thirds turn.

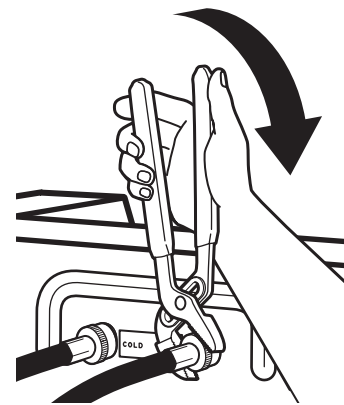

**NOTE:** Do not overtighten. Damage to the valve can result.

4. Turn on water faucets to check for leaks. A small amount of water may enter washer. It will drain later.

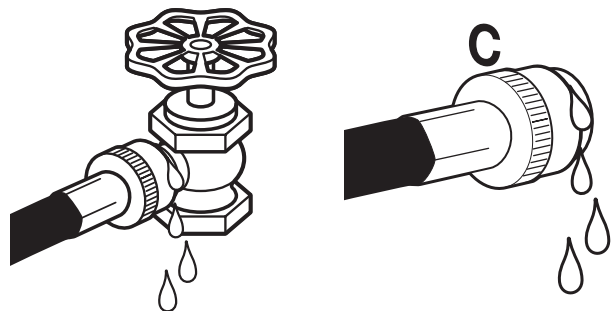

**NOTE:** Replace inlet hoses after 5 years of use to reduce the risk of hose failure. Record hose installation or replacement dates on the hoses for future reference.

Periodically inspect and replace hoses if bulges, kinks, cuts, wear, or leaks are found.

# ELECTRICAL REQUIREMENTS

## ⚠ WARNING



### Electric Shock Hazard

**Electrically earth this appliance.**

**Do not use an extension cord or an electrical portable outlet device.**

**Failure to follow these instructions can result in death, fire, or electric shock.**

- A 220–240 volt, 50 Hz., AC-only, 10-amp, fused electric supply is required. A time-delay fuse or circuit breaker is recommended. It is recommended that a separate circuit serving only this appliance be provided.
- After installation, access to mains plug or disconnection from mains supply via a double-pole switch must be ensured at all times in order to ensure immediate deactivation of the washer in case of emergency.
- This washer is equipped with a power supply cord having an earthing plug. The plug should be accessible for disconnection from the supply.
- If the supply cord is damaged, it must be replaced by the manufacturer, its service agent, or similarly qualified persons in order to avoid a hazard.

## EARTHING INSTRUCTIONS

This washer must be earthed. In the event of a malfunction or breakdown, earthing will reduce the risk of electric shock by providing a path of least resistance for electric current. This washer is equipped with a cord having an equipment-earthing conductor and an earthing plug. The plug must be plugged into an appropriate outlet that is properly installed and earthed in accordance with all local codes and ordinances.

**WARNING:** Improper connection of the equipment-earthing conductor can result in a risk of electric shock. Check with a qualified electrician or serviceman if you are in doubt as to whether the appliance is properly earthed.

Do not modify the plug provided with the appliance – if it will not fit the outlet, have a proper outlet installed by a qualified electrician.

### Using the universal cord included with this washer:

This washer is equipped with a universal cord with interchangeable plugs.

1. To use the universal cord, select the plug end that fits your electrical outlet, and plug it into the adapter on the supply cord.
2. Secure the plug end in place on the cord by aligning the 2 cover halves over the cord adapter and clipping them together.

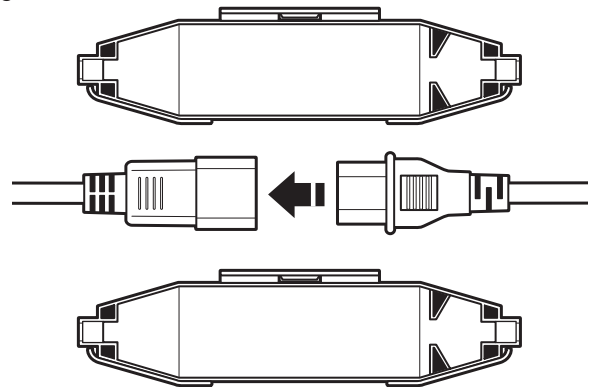

# COMPLETE INSTALLATION

## ⚠ WARNING



### Electric Shock Hazard

**Electrically earth this appliance.**

**Do not use an extension cord or an electrical portable outlet device.**

**Failure to follow these instructions can result in death, fire, or electric shock.**

- Check that all parts are now installed. If there is an extra part, go back through steps to see what was skipped.
- Check that you have all of your tools.
- Check that shipping materials were completely removed from washer.
- Dispose of/recycle all packaging materials.
- Check that the water faucets are on.
- Check for leaks around faucets and inlet hoses.
- Remove film from console and any tape remaining on washer.
- Plug into a grounded outlet, or connect power.
- Check that circuit breaker is not tripped or fuse is not blown.
- Start washer using the payment system (if available) to check that the wash cycle completes without an error code or water leak.

- Check electrical requirements. Be sure that you have the correct electrical supply and the recommended earthing method.

## INSTALLING COIN SLIDE AND COIN BOX

The coin slide mechanism, service door lock and key, and coin box lock and key are not included with some models but can be obtained from the usual industry sources.

Remove the service door of the meter case by lifting it up at the back. Install the money-accepting device. (Refer to manufacturer's instructions for proper installation.)

An earthing connection is needed for the coin slide, which can be made by connecting the available harness (W10846503) to the coin slide.

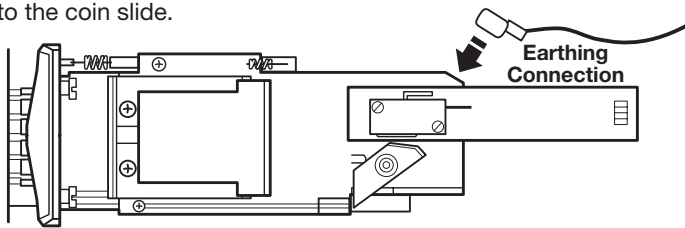

The available terminal is designed for a metal thickness of 1.51–1.91 mm.

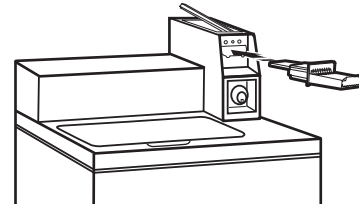

Install a lock and cam on the meter case service door. Install the coin vault with lock and key in the meter case opening.

For Free Vend, an OPL kit can be purchased from Whirlpool. Whirlpool part number W10222023.

# WASHER DISPOSAL

---



This appliance is marked according to the European directive 2012/19/EU on Waste Electrical and Electronic Equipment (WEEE).

By ensuring this product is disposed of correctly, you will help avoid potential negative consequences for the environment and human health, which could otherwise be caused by inappropriate waste handling of this product.

The symbol on the product, or on the documents accompanying the product, indicates that this appliance may not be treated as household waste. Instead it shall be handed over to the applicable collection point for the recycling of electrical and electronic equipment.

Disposal must be carried out in accordance with local environmental regulations for waste disposal.

For more detailed information about treatment, recovery and recycling of this product, please contact your local city office, your household waste disposal service or the shop where you purchased the product.



# WHIRLPOOL® COMMERCIAL LAUNDRY LIMITED WARRANTY

## IF YOU NEED SERVICE:

Contact your authorized Whirlpool® Commercial Laundry distributor. To locate your authorized Whirlpool® Commercial Laundry distributor, visit [www.WhirlpoolCommercialLaundry.com](http://www.WhirlpoolCommercialLaundry.com).

For written correspondence:

**Whirlpool® Commercial Laundry Service Department**  
2000 N M 63  
Benton Harbor, Michigan 49022-2632 USA

## THREE YEAR LIMITED WARRANTY

### WHAT IS COVERED

#### THREE YEAR LIMITED WARRANTY (PARTS ONLY – LABOR NOT INCLUDED)

For the first three years from the original date of purchase, when this commercial appliance is installed, maintained, and operated according to the instructions attached to or furnished with the product, Whirlpool Corporation (hereafter “Whirlpool”) will pay for factory specified replacement parts to correct defects in materials or workmanship that existed when this commercial appliance was purchased. This limited warranty does not include labor.

YOUR SOLE AND EXCLUSIVE REMEDY UNDER THIS LIMITED WARRANTY SHALL BE PRODUCT REPAIR AS PROVIDED HEREIN. Whirlpool recommends that you use an “authorized” service provider to diagnose and repair your Commercial Laundry product. Whirlpool will not be responsible under this warranty to provide additional replacement parts as a result of incorrect diagnosis or repair by an “unauthorized” service company. Except in the European Union, this limited warranty is valid only when the commercial appliance is used in the country in which it was purchased. This limited warranty is effective from the date of the original consumer purchase. Proof of original purchase date is required to obtain service under this limited warranty.

### WHAT IS NOT COVERED

1. All other costs including labor, transportation, shipping, or custom duties for covered parts.
2. Factory specified replacement parts if this commercial appliance is used for other than normal, commercial use or when it is used in a manner that is inconsistent to published user or operator instructions and/or installation instructions.
3. Service calls to correct the installation of your commercial appliance, to instruct you on how to use your commercial appliance, to replace or repair house fuses, or to correct external wiring or plumbing.
4. Service calls to repair or replace appliance light bulbs, air filters, or water filters. Consumable parts are excluded from warranty coverage.
5. Damage resulting from improper handling of product during delivery, theft, accident, alteration, misuse, abuse, fire, flood, acts of God, improper installation, installation not in accordance with local electrical or plumbing codes, or use of products not approved by Whirlpool.
6. Pick up and delivery. This commercial appliance is designed to be repaired on location.
7. Repairs to parts or systems resulting from unauthorized modifications made to the commercial appliance.
8. The removal and reinstallation of your commercial appliance if it is installed in an inaccessible location or is not installed in accordance with published installation instructions.
9. Damage resulting from exposure to chemicals.
10. Changes to the building, room, or location needed in order to make the commercial appliance operate correctly.
11. Factory specified replacement parts on commercial appliances with original model/serial numbers that have been removed, altered, or cannot be easily determined.
12. Discoloration, rust, or oxidation of stainless steel surfaces.
13. Factory specified replacement parts as a result of incorrect diagnosis or repair by an “unauthorized” service company.

**The cost of repair or replacement under these excluded circumstances shall be borne by the customer.**

## DISCLAIMER OF IMPLIED WARRANTIES

IMPLIED WARRANTIES, INCLUDING ANY IMPLIED WARRANTY OF MERCHANTABILITY OR IMPLIED WARRANTY OF FITNESS FOR A PARTICULAR PURPOSE, ARE LIMITED TO THREE YEARS OR THE SHORTEST PERIOD ALLOWED BY LAW. Some locations may not allow limitations on the duration of implied warranties of merchantability or fitness, so this limitation may not apply to you. This warranty gives you specific legal rights, and you also may have other rights that vary.

## DISCLAIMER OF REPRESENTATIONS OUTSIDE OF WARRANTY

Whirlpool makes no representations about the quality, durability, or need for service or repair of this major appliance other than the representations contained in this Warranty. If you want a longer or more comprehensive warranty than the limited warranty that comes with this major appliance, you should ask your retailer about buying an extended warranty. The benefits to you given by this warranty are in addition to other rights and remedies available to you under a law in relation to the goods or service to which this warranty relates. Please contact Whirlpool for further information on warranty terms.

## LIMITATION OF REMEDIES; EXCLUSION OF INCIDENTAL AND CONSEQUENTIAL DAMAGES

YOUR SOLE AND EXCLUSIVE REMEDY UNDER THIS LIMITED WARRANTY SHALL BE PRODUCT REPAIR AS PROVIDED HEREIN. WHIRLPOOL SHALL NOT BE LIABLE FOR INCIDENTAL OR CONSEQUENTIAL DAMAGES. Some locations do not allow the exclusion or limitation of incidental or consequential damages, so these limitations and exclusions may not apply to you. This warranty gives you specific legal rights, and you also may have other rights that vary by location.

01/17