

KitchenAid

KST4054



PARTS AND FEATURES

PARTS AND ACCESSORIES

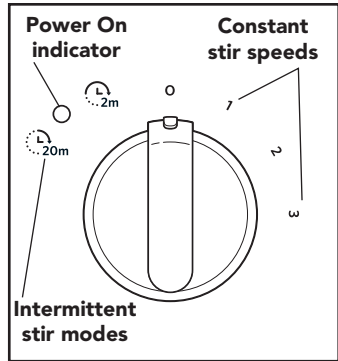
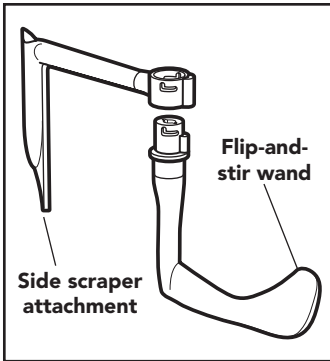
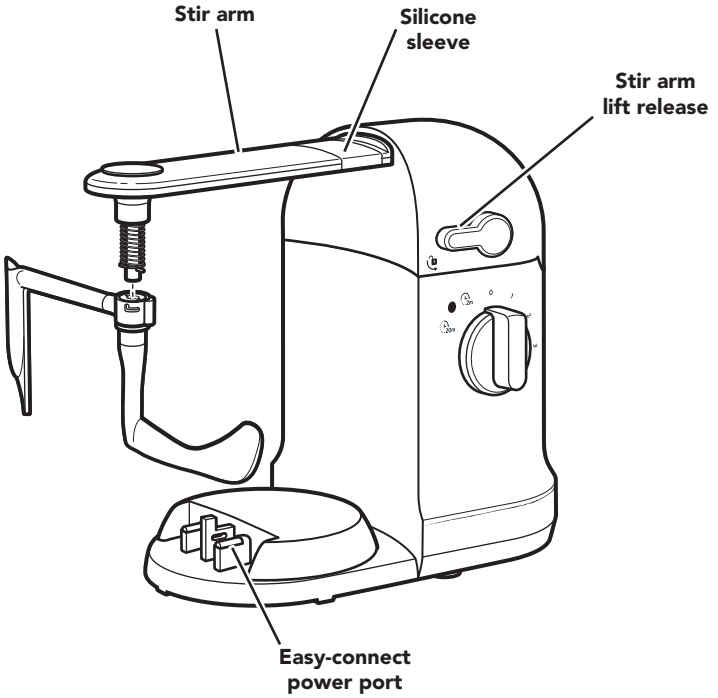

Your safety and the safety of others are very important.

We have provided many important safety messages in this manual and on your appliance. Always read and obey all safety messages.



This is the safety alert symbol.

This symbol alerts you to potential hazards that can kill or hurt you and others.

All safety messages will follow the safety alert symbol and either the word “DANGER” or “WARNING.” These words mean:

 **DANGER**

You can be killed or seriously injured if you don't immediately follow instructions.

 **WARNING**

You can be killed or seriously injured if you don't follow instructions.

All safety messages will tell you what the potential hazard is, tell you how to reduce the chance of injury, and tell you what can happen if the instructions are not followed.

State of California Proposition 65 Warnings:

WARNING: This product contains one or more chemicals known to the State of California to cause cancer.

WARNING: This product contains one or more chemicals known to the State of California to cause birth defects or other reproductive harm.

IMPORTANT SAFEGUARDS

When using electrical appliances, basic safety precautions should always be followed, including the following:

1. Read all instructions.
2. Do not touch hot surfaces. Use potholders or oven mitts when handling the cooking bowl, lid, or attachments.
3. To avoid electrical shock do not immerse cord, plugs, or the multi-cooker base in water or other liquid.
4. Close supervision is necessary when any appliance is used by or near children.
5. Disconnect from Multi-Cooker when not in use and before cleaning. Allow to cool before putting on or taking off parts.
6. Do not operate any appliance with a damaged cord or plug or after the appliance malfunctions or has been damaged in any manner. Return appliance to the nearest Authorized Service Facility for examination, repair, or adjustment.

STIR TOWER SAFETY

7. The use of accessory attachments not recommended by KitchenAid may cause injuries.
8. Do not use outdoors.
9. Do not place on or near a hot gas or electric burner, or in a heated oven.
10. Extreme caution must be used when moving an appliance containing hot oil or other hot liquids.
11. Do not use appliance for other than intended use.
12. To disconnect, set all controls to OFF, then separate from Multi-Cooker.

SAVE THESE INSTRUCTIONS

This product is designed for household use only.

ELECTRICAL REQUIREMENTS

Voltage: 120 VAC

Frequency: 60 Hz



Wattage: 50 Watts

NOTE: This Stir Tower is designed for use only with the KitchenAid Multi-Cooker.

SELECTING STIR SPEEDS

STIR SPEED SELECTOR

Your Stir Tower features 3 stir speeds and 2 intermittent stir modes. The Power On indicator will be lit whenever the Stir Tower is on, including in intermittent modes.

SETTING	SPEED	RPM	DURATION	OPTIMAL FOR:
0	OFF	—	—	—
1	LOW	20	Constant ON	Risotto, soups, stir-fry
2	MEDIUM	45	Constant ON	Hot cereals, sauces
3	HIGH	75	Constant ON	Puddings, yogurt
2-Minute Intermittent 	LOW	20	ON for 15 seconds every 2 minutes	Searing and sautéing
20-Minute Intermittent 	LOW	20	ON for 1 minute every 20 minutes	Slow cooking and stews

USING THE STIR TOWER

BEFORE FIRST USE

1. Remove all packaging materials, if present.
2. Wash the side scraper and flip-and-stir wand attachments in hot, sudsy water. Dry thoroughly.

ATTACHING THE STIR TOWER TO THE MULTI-COOKER (SOLD SEPARATELY)

Use the flip-and-stir wand by itself when cooking foods with larger pieces or when sautéing and frying in smaller quantities.

Add the side scraper blade when preparing soups, stews, and sauces to help circulate ingredients thoroughly.

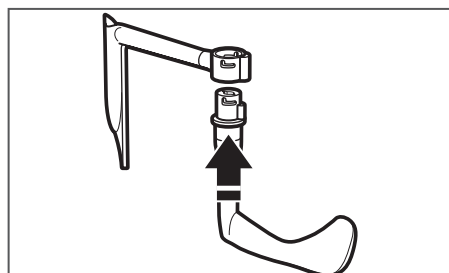

- 1 If using both attachments: Align the tab on the top of the flip-and-stir wand with the groove on the side scraper and slide into place.

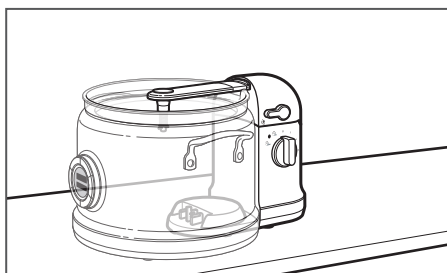

- 2 Make sure the Stir Speed selector is set to the 0 (OFF) position. Place the stir tower on a sturdy, level surface such as a countertop, with enough space for the Multi-Cooker.

USING THE STIR TOWER

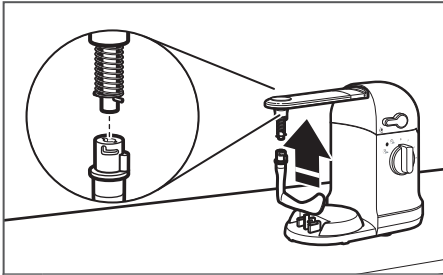

- 3** Align the pins on the stir tower shaft with the slots on the flip-and-stir wand. Press the wand up and rotate counterclockwise to lock into place.

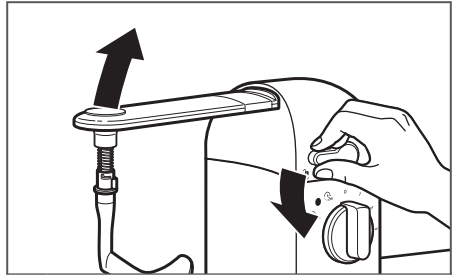

- 4** Raise the stir arm by pressing down on the release lever.

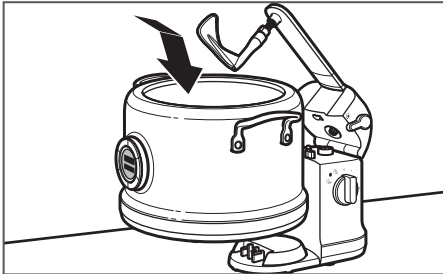

- 5** With the lid removed, align the back of the Multi-Cooker with the front of the Stir Tower. Make sure the Stir Speed selector is set to 0 (OFF) position before placing the Multi-Cooker onto the easy connect power port on the stir tower base.

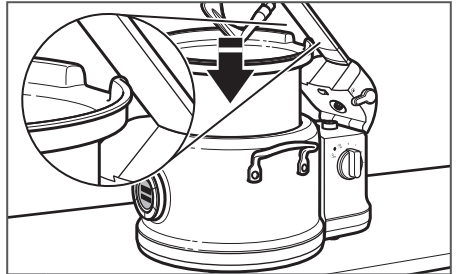

- 6** Place the cooking pot in the Multi-Cooker, aligning the notch in the cooking pot with the stir arm.

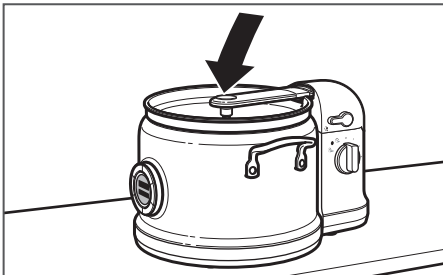

- 7** Lower the stir arm until it locks into place.

USING THE STIR TOWER

COOKING WITH THE STIR TOWER

NOTE: For additional information on how to add ingredients and select cooking modes, see the instructions included with your Multi-Cooker, or visit www.kitchenaid.com/quickstart.

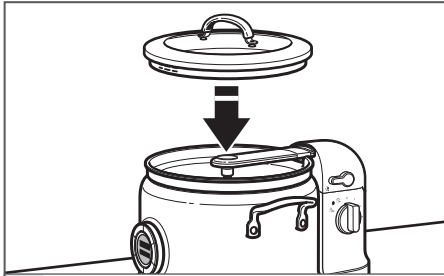

- 1** Add ingredients to the cooking pot, align the cutout in the multi-cooker lid with the stir arm and cover the cooking pot.



- 2** Once the cooking mode is set and started (see Multi-Cooker instructions), select the desired stir speed or intermittent stir mode. Power On indicator will light.

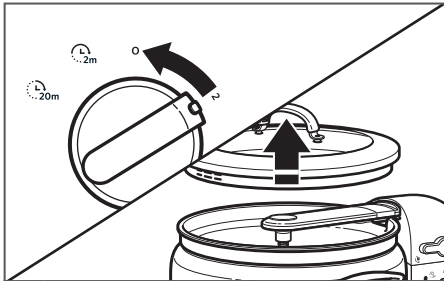

- 3** When cooking has finished, set the Stir Tower to 0 (OFF) and remove the lid from the pot using a hot pad or oven mitt.

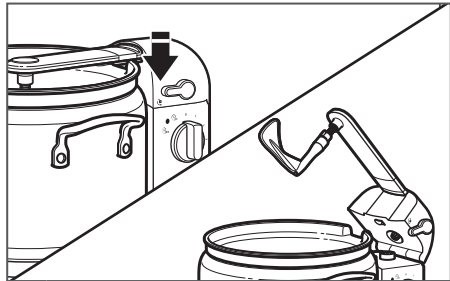

- 4** Press down on the release lever and raise the stir arm before removing the cooking pot.

NOTE: The stir arm can become hot to the touch when cooking.

USING THE STIR TOWER

TIPS AND TRICKS

- For most food preparation, use the flip-and-stir wand only for best performance. When preparing larger quantities (near the MAX FILL line), or for foods like soups and stews, add the side scraper to help mix and circulate foods.
- For stirring risotto (Arborio) rice, it is recommended to stir at least 2–4 cups (380–760 g) of rice to get the best flipping and stirring performance.
- Flip-and-stir wand is designed to stir/incorporate 3–4 cups (0.75–1.0 L) of ingredients at a time.
- Use of the Stir Tower is not recommended when preparing smaller quantities of lighter or delicate ingredients such as mushrooms.
- The flip-and-stir wand is ideal for preparing foods ingredients such as onions, carrots, broccoli, potatoes (cubed), meatballs (2-3 oz./40-60 g each), small to medium shrimp, and sliced or cubed meats and poultry.

CARE AND CLEANING

CLEANING YOUR STIR TOWER

Remove the Stir Tower from the Multi-Cooker before cleaning.

- Allow Stir Tower and accessories to cool completely before cleaning.
- Wipe the outside of the Stir Tower with a clean, damp cloth and dry thoroughly.
- Do not use abrasive cleaners or metal scouring pads. They could scratch the surface.
- Stir Tower arm features a nonstick ceramic coating for easy cleaning.

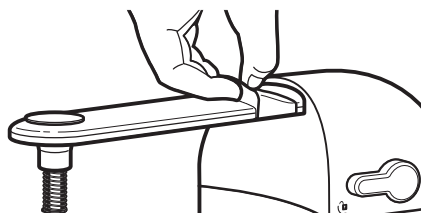

To clean the silicone sleeve:

Remove sleeve from arm by sliding your finger under to lift it (see image), then gently stretch it while working it down and off of the arm. Wash in warm, soapy water. Rinse and air dry.

CLEANING YOUR FLIP-AND-STIR ATTACHMENT

The flip-and-stir wand and side scraper are dishwasher durable, but handwashing in hot, soapy water is recommended.

After cooking recipes with strong odors, it may be necessary to deep clean the flip-and-stir wand and side scraper in a baking soda solution to remove any residual odors.

To deep clean flip-and-stir attachment:

- Pour 500 g water in the multi-cooker cooking pot. Add 50 g baking soda and mix well.
- Immerse the flip-and-stir wand and side scraper in the baking soda solution for 12 hours. Rinse well with warm tap water.

TROUBLESHOOTING

IF YOUR STIR TOWER MALFUNCTIONS OR FAILS TO OPERATE

! WARNING



Electrical Shock Hazard

Plug into a grounded 3 prong outlet.

Do not remove ground prong.

Do not use an adapter.

Do not use an extension cord.

Failure to follow these instructions can result in death, fire, or electrical shock.

Stir Tower not turning on:

The Stir Tower is powered by the Multi-Cooker. Be sure that the Multi-Cooker is plugged into a grounded 3 prong outlet and seated properly on the easy-connect power port.

Food not being stirred, or sticking to side of pot:

For most cooking, use only the flip-and-stir wand.

For larger quantities or for foods like soups and stews, use both stirring attachments together.

Motor shutting off:

The stirring motor has built-in thermal overload protection. If food is too thick or heavy, try selecting a slower speed, or prepare a smaller quantity.

Stir arm won't lock into place:

If the stir arm does not go all the way down, rotate the attachments slightly before lowering the arm.

Be sure that the stir arm is aligned with the pouring spout.

Power On indicator does not light up:

If the Power On indicator does not light up when the Stir Speed selector is in the ON position, and then lift the stir arm and lower it back into place. Make sure the Stir Speed selector is in the 0 (OFF) position before placing the Multi-Cooker onto the easy connect port on the stir tower base.

If the problem cannot be corrected: See the "Warranty and Service" section. Do not return the Multi-Cooker to the retailer; retailers do not provide service.

REPLACEMENT PARTS

The following parts are available to order as extra or replacement parts for the Stir Tower accessory:

Part Name	Part Number
Scraping Blade	W10726707
Flipping Wand	W10726709

WARRANTY AND SERVICE

KITCHENAID STIR TOWER WARRANTY FOR THE 50 UNITED STATES, THE DISTRICT OF COLUMBIA, PUERTO RICO, AND CANADA

This warranty extends to the purchaser and any succeeding owner for Stir Towers operated in the 50 United States, the District of Columbia, Puerto Rico, and Canada.

Length of Warranty:	One Year Full Warranty from date of purchase.
KitchenAid Will Pay for Your Choice of: 	Hassle-Free Replacement of your Stir Tower. See the next page for details on how to arrange for service, or call the Customer eXperience Center toll-free at 1-800-541-6390 . OR The replacement parts and repair labor costs to correct defects in materials and workmanship. Service must be provided by an Authorized KitchenAid Service Center.
KitchenAid Will Not Pay for:	<ul style="list-style-type: none">A. Repairs when your Stir Tower is used in other than normal single family home use.B. Damage resulting from accident, alteration, misuse or abuse.C. Any shipping or handling costs to deliver your Stir Tower to an Authorized Service Center.D. Replacement parts or repair labor costs for Stir Towers operated outside the 50 United States, District of Columbia, Puerto Rico, and Canada.
DISCLAIMER OF IMPLIED WARRANTIES; LIMITATION OF REMEDIES IMPLIED WARRANTIES, INCLUDING TO THE EXTENT APPLICABLE WARRANTIES OF MERCHANTABILITY OR FITNESS FOR A PARTICULAR PURPOSE, ARE EXCLUDED TO THE EXTENT LEGALLY PERMISSIBLE. ANY IMPLIED WARRANTIES THAT MAY BE IMPOSED BY LAW ARE LIMITED TO ONE YEAR, OR THE SHORTEST PERIOD ALLOWED BY LAW. SOME STATES AND PROVINCES DO NOT ALLOW LIMITATIONS OR EXCLUSIONS ON HOW LONG AN IMPLIED WARRANTY OF MERCHANTABILITY OR FITNESS LASTS, SO THE ABOVE LIMITATIONS OR EXCLUSIONS MAY NOT APPLY TO YOU. IF THIS PRODUCT FAILS TO WORK AS WARRANTED, CUSTOMER'S SOLE AND EXCLUSIVE REMEDY SHALL BE REPAIR OR REPLACEMENT ACCORDING TO THE TERMS OF THIS LIMITED WARRANTY. KITCHENAID AND KITCHENAID CANADA DO NOT ASSUME ANY RESPONSIBILITY FOR INCIDENTAL OR CONSEQUENTIAL DAMAGES. This warranty gives you specific legal rights and you may also have other rights which vary from state to state or province to province.	

WARRANTY AND SERVICE

HASSLE-FREE REPLACEMENT WARRANTY – 50 UNITED STATES, DISTRICT OF COLUMBIA, AND PUERTO RICO

We're so confident the quality of our products meets the exacting standards of KitchenAid that, if your Stir Tower should fail within the first year of ownership, KitchenAid will arrange to deliver an identical or comparable replacement to your door free of charge and arrange to have your original Stir Tower returned to us. Your replacement unit will also be covered by our one year limited warranty.

If your Stir Tower should fail within the first year of ownership, simply call our toll-free

Customer eXperience Center at **1-800-541-6390** Monday through Friday. Please have your original sales receipt available when you call. Proof of purchase will be required to initiate the claim. Give the consultant your complete shipping address. (No P.O. Box numbers, please.)

When you receive your replacement Stir Tower, use the carton, packing materials, and prepaid shipping label to pack up your original Stir Tower and send it back to KitchenAid.

HASSLE-FREE REPLACEMENT WARRANTY – CANADA

We're so confident the quality of our products meets the exacting standards of the KitchenAid brand that, if your Stir Tower should fail within the first year of ownership, we will replace your Stir Tower with an identical or comparable replacement. Your replacement unit will also be covered by our one year limited warranty.

If your Stir Tower should fail within the first year of ownership, simply call our toll-free Customer eXperience Center at

1-800-807-6777 Monday through Friday. Please have your original sales receipt available when you call. Proof of purchase will be required to initiate the claim. Give the consultant your complete shipping address.

When you receive your replacement Stir Tower, use the carton, packing materials, and prepaid shipping label to pack up your original Stir Tower and send it back to KitchenAid.

ARRANGING FOR SERVICE AFTER THE WARRANTY EXPIRES, OR ORDERING ACCESSORIES AND REPLACEMENT PARTS

In the United States and Puerto Rico:

For service information, or to order accessories or replacement parts, call toll-free at **1-800-541-6390** or write to:

Customer eXperience Center,
KitchenAid Small Appliances,
P.O. Box 218, St. Joseph, MI 49085-0218

Outside the United States and Puerto Rico:

Consult your local KitchenAid dealer or the store where you purchased the Stir Tower for information on how to obtain service.

For service information in Canada:

Call toll-free **1-800-807-6777**.

For service information in Mexico:

Call toll-free **01-800-0022-767**.

DISCOVER MORE. DÉCOUVREZ PLUS. DESCUBRA MÁS.
KITCHENAID.COM



PRODUCT QUESTIONS OR RETURNS
QUESTIONS SUR LE PRODUIT OU LES RETOURS
PREGUNTAS SOBRE EL PRODUCTO O DEVOLUCIONES

USA: 1.800.541.6390 | KitchenAid.com
CANADA: 1.800.807.6777 | KitchenAid.ca
MEXICO: KitchenAid.com.mx
LATIN AMERICA: KitchenAid-latam.com



KitchenAid®
FOR THE WAY IT'S MADE.®

©2016 All rights reserved. KITCHENAID and the design of the Stand Mixer are trademarks in the U.S. and elsewhere. Used under license in Canada.

©2016 Tous droits réservés. KITCHENAID et la forme du batteur sur socle sont des marques de commerce aux E.-U. et dans d'autres pays. Utilisé sous licence au Canada.

©2016 Todos los derechos reservados. KITCHENAID y el diseño de la batidora con base son marcas registradas en EE.UU. y en otras partes. Usada en Canadá bajo licencia.