

CRAFTSMAN®

Product questions or problems?

1-888-331-4569

Customer Care Hot Line

**Get answers to questions, troubleshoot problems,
order parts, or schedule repair service.**

Para respuestas a preguntas o problemas, y ordenar
piezas o pedir servicio para la reparación de su equipo.

To help us help you, register your product at www.craftsman.com/registration

Para poder ayudarte mejor, registra tu producto en www.craftsman.com/registration

Join the Craftsman Club today!

CRAFTSMAN CLUB®

www.craftsman.com/signup

**Receive exclusive member benefits including special pricing and offers,
project sharing, expert advice, and SHOP YOUR WAY REWARDS!**

Como miembro exclusivo, recibe diversos beneficios como ofertas, precios especiales, proyectos
nuevos, consejos de expertos y nuestro programa de puntos SHOP YOUR WAY REWARDS!

® Registered Trademark / ™ Trademark of KCD IP, LLC in the United States, or Sears Brands, LLC in other countries
® Marca Registrada / ™ Marca de Fábrica de KCD IP, LLC en Estados Unidos, o Sears Brands, LLC in otros países

Operator's Manual

CRAFTSMAN®

4 Volt Slide Screwdriver

Model No.
172.417710

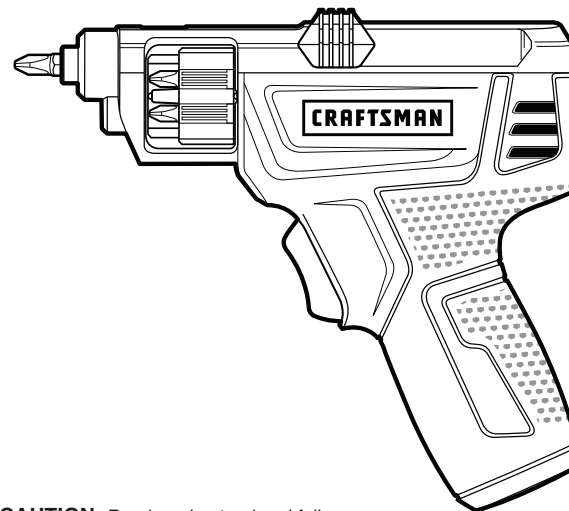

CAUTION: Read, understand and follow
all Safety Rules and Operating Instructions
in this manual before using this product.

Sears Brands Management Corporation,
Hoffman Estates, IL 60179 U.S.A.
www.craftsman.com

- WARRANTY
- SAFETY
- OPERATION
- MAINTENANCE
- PARTS LIST
- ESPAÑOL

TABLE OF CONTENTS

Warranty.....	Page 1
Safety Instructions.....	Pages 3-4
Safety Symbols.....	Page 5
Unpacking / Description.....	Page 6
Technical Data.....	Page 7
Operation.....	Pages 7-10
Maintenance.....	Pages 10
Parts List.....	Pages 11-13

CRAFTSMAN LIMITED WARRANTY

FOR ONE YEAR from the date of sale this product is warranted against defects in material or workmanship.

WITH PROOF OF SALE a defective product will be replaced free of charge.

For warranty coverage details to obtain free replacement, visit the web page: www.craftsman.com/warranty

This warranty does not cover the bit(s), which are expendable parts that can wear out from normal use within the warranty period.

This ONE YEAR warranty is void if this product is ever used while providing commercial services or if rented to another person. For 90 DAY commercial and rental use terms, see the Craftsman warranty web page.

This warranty gives you specific legal rights, and you may also have other rights which vary from state to state.

Sears Brands Management Corporation, Hoffman Estates, IL 60179

SAVE THESE INSTRUCTIONS! READ ALL INSTRUCTIONS!

⚠ WARNING: Some dust created by power sanding, sawing, grinding, drilling and other construction activities contains chemicals known to the state of California to cause cancer, birth defects or other reproductive harm.

Some examples of these chemicals are:

- Lead from lead-based paints;
- Crystalline silica from bricks and cement and other masonry products and
- Arsenic and chromium from chemically-treated lumber.

Your risk from these exposures varies, depending on how often you do this type of work. To reduce your exposure to these chemical: work in a well ventilated area, and work with approved safety equipment, such as those dust masks that are specially designed to filter out microscopic particles.

GENERAL POWER TOOL SAFETY WARNINGS

⚠ WARNING: Read all safety warnings and instructions. Failure to follow the warnings and instructions may result in electric shock, fire and/or serious injury.

SAVE ALL WARNINGS AND INSTRUCTIONS FOR FUTURE REFERENCE.

The term power tool in the warnings refers to your electric (corded) power tool or battery-operated (cordless) power tool.

WORK AREA SAFETY

1. **Keep work area clean and well lit.** Cluttered or dark areas invite accidents.
2. **Do not operate power tools in explosive atmospheres, such as in the presence of flammable liquids, gases or dust.** Power tools create sparks which may ignite the dust or fumes.
3. **Keep children and bystanders away while operating a power tool.** Distractions can cause you to lose control.

ELECTRICAL SAFETY

1. **Power tool plugs must match the outlet. Never modify the plug in any way. Do not use any adapter plugs with earthed (grounded) power tools. Unmodified plugs and matching outlets will reduce risk of electric shock.**
2. **Avoid body contact with earthed or grounded surfaces such as pipes, radiators, ranges and refrigerators.** There is an increased risk of electric shock if your body is earthed or grounded.
3. **Do not expose power tools to rain or wet conditions.** Water entering a power tool will increase the risk of electric shock.
4. **Do not abuse the cord. Never use the cord for carrying, pulling or unplugging the power tool. Keep cord away from heat, oil, sharp edges or moving parts.** Damaged or entangled cords increase the risk of electric shock.
5. **When operating a power tool outdoors, use an extension cord suitable for outdoor use.** Use of a cord suitable for outdoor use reduces the risk of electric shock.
6. **If operating a power tool in a damp location is unavoidable, use a residual current device (RCD) protected supply.** Use of an RCD reduces the risk of electric shock.

PERSONAL SAFETY

1. **Stay alert, watch what you are doing and use common sense when operating a power tool. Do not use a power tool while you are tired or under the influence of drugs, alcohol or medication.** A moment of inattention while operating power tools may result in serious personal injury.
2. **Use personal protective equipment. Always wear eye protection. Protective equipment such as dust mask, non-skid safety shoes, hard hat, or hearing protection used for appropriate conditions will reduce personal injuries.**
3. **Prevent unintentional starting. Ensure the switch is in the off-position before connecting to power source and/or battery pack, picking up or carrying the tool. Carrying power tools with your finger on the switch or energising power tools that have the switch on invites accidents.**
4. **Remove any adjusting key or wrench before turning the power tool on. A wrench or a key left attached to a rotating part of the power tool may result in personal injury.**
5. **Do not overreach. Keep proper footing and balance at all times. This enables better control of the power tool in unexpected situations.**

GENERAL POWER TOOL SAFETY WARNINGS cont.

PERSONAL SAFETY cont.

6. **Dress properly. Do not wear loose clothing or jewellery. Keep your hair, clothing and gloves away from moving parts.** *Loose clothes, jewellery or long hair can be caught in moving parts.*
7. **If devices are provided for the connection of dust extraction and collection facilities, ensure these are connected and properly used.** *Use of dust collection can reduce dust-related hazards.*

POWER TOOL USE AND CARE

1. **Do not force the power tool. Use the correct power tool for your application.** *The correct power tool will do the job better and safer at the rate for which it was designed.*
2. **Do not use the power tool if the switch does not turn it on and off.** *Any power tool that cannot be controlled with the switch is dangerous and must be repaired.*
3. **Disconnect the plug from the power source and/or the battery pack from the power tool before making any adjustments, changing accessories, or storing power tools.** *Such preventive safety measures reduce the risk of starting the power tool accidentally.*
4. **Store idle power tools out of the reach of children and do not allow persons unfamiliar with the power tool or these instructions to operate the power tool.** *Power tools are dangerous in the hands of untrained users.*
5. **Maintain power tools. Check for misalignment or binding of moving parts, breakage of parts and any other condition that may affect the power tools operation. If damaged, have the power tool repaired before use.** *Many accidents are caused by poorly maintained power tools.*
6. **Keep cutting tools sharp and clean.** *Properly maintained cutting tools with sharp cutting edges are less likely to bind and are easier to control.*
7. **Use the power tool, accessories and tool bits etc., in accordance with these instructions and in the manner intended for the particular type of power tool, taking into account the working conditions and the work to be performed.** *Use of the power tool for operations different from those intended could result in a hazardous situation.*

BATTERY TOOL USE AND CARE

1. **Recharge only with the charger specified by the manufacturer.** *A charger that is suitable for one type of battery pack may create a risk of fire when used with another battery pack.*
2. **Use power tools only with specifically designated battery packs.** *Use of any other battery packs may create a risk of injury and fire.*
3. **When battery pack is not in use, keep it away from other metal objects, like paper clips, coins, keys, nails, screws or other small metal objects, that can make a connection from one terminal to another.** *Shorting the battery terminals together may cause burns or a fire.*
4. **Under abusive conditions, liquid may be ejected from the battery; avoid contact.** *If contact accidentally occurs, flush with water. If liquid contacts eyes, additionally seek medical help. Liquid ejected from the battery may cause irritation or burns.*

SERVICE

1. **Have your power tool serviced by a qualified repair person using only identical replacement parts.** *This will ensure that the safety of the power tool is maintained.*

SCREWDRIVER SAFETY WARNINGS

1. **Hold power tool by insulated gripping surfaces, when performing an operation where the fastener may contact hidden wiring.** Fasteners contacting a "live" wire may make exposed metal parts of the power tool "live" and could give the operator an electric shock.

Charger Safety and Information for radiated emission

This device complies with Canadian ICES-001.

This device complies with Part 15 of the FCC Rules.

Operation is subject to the following two conditions:

- (1) this device may not cause harmful interference, and
- (2) this device must accept any interference received, including interference that may cause undesired operation.

⚠ WARNING: Changes or modifications to this unit not expressly approved by the party responsible for compliance could void the user's authority to operate the equipment.

NOTE: This equipment has been tested and found to comply with the limits for a Class B digital device, pursuant to Part 15 of the FCC Rules.

These limits are designed to provide reasonable protection against harmful interference in a residential installation. This equipment generates, uses and can radiate radio frequency energy and, if not installed and used in accordance with the instructions, may cause harmful interference to radio communications.

However, there is no guarantee that interference will not occur in a particular installation. If this equipment does cause harmful interference to radio or television reception, which can be determined by turning the equipment off and on, the user is encouraged to try to correct the interference by one or more of the following measures:

- Reorient or relocate the receiving antenna.
- Increase the separation between the equipment and receiver.
- Connect the equipment into an outlet on a circuit different from that to which the receiver is connected.
- Consult the dealer or an experienced radio/TV technician for help.

ADDITIONAL SAFETY WARNINGS

1. Do not use damaged or worn driver bits.
2. Use clamps or a vice to hold workpiece, if possible.

GENERAL SAFETY WARNINGS

⚠ WARNING: Read all safety warnings and instructions. Failure to follow the warnings and instructions may result in electric shock, fire and/or serious injury.





1. **WARNING: Risk of fire and burns. Do not disassemble, heat above 100°C (212°F), or incinerate. Do not expose cells or batteries to heat or fire. Avoid storage in direct sunlight.**
2. **Dispose of used battery promptly. When disposing of secondary cells or batteries, keep cells or batteries of different electrochemical systems separate from each other.**
3. **Keep battery out of reach of children and in original package until ready to use.**
4. **Never put batteries in mouth. If swallowed, contact your physician or local poison control center.**
5. **CAUTION – The battery used in this device may present a risk of fire or chemical burn if mistreated. Replace battery with manufacturer only. Use of another battery may present a risk of fire or explosion.**
6. **Warning: Do not use a visibly damaged battery pack or tool as applicable.**
7. **Warning: Do not modify or attempt to repair the tool or the battery pack as applicable.**
8. **BATTERY MUST BE RECYCLED.**

GENERAL SAFETY WARNINGS cont.

9. Do not short-circuit a cell or battery. Do not store cells or batteries haphazardly in a box or drawer where they may short-circuit each other or be short-circuited by conductive materials.
10. Do not subject cells or batteries to mechanical shock.
11. Keep cells and batteries clean and dry. Wipe the cell or battery terminals with a clean dry cloth if they become dirty.
12. Do not maintain secondary cells and batteries on charge when not in use.
13. Retain the original cell and battery literature for future reference.
14. Do not use any charger other than that specifically provided for use with the tool. Secondary cells and batteries need to be charged before use. Always use the correct charger and refer to the manufacturer's instructions or tool manual for proper charging instructions.
15. When possible, remove the battery from the tool when not in use.
16. Prevent unintentional starting. Ensure the switch is in the off-position before connecting to battery pack, picking up or carrying the tool. Carrying the tool with your finger on the switch or energizing tool that have the switch on invites accidents.
17. Under abusive conditions, liquid may be ejected from the battery; avoid contact. If contact accidentally occurs, flush with water. If liquid contacts eyes, additionally seek medical help. Liquid ejected from the battery may cause irritation or burns.
18. Have servicing performed by a qualified repair person using only identical replacement parts. This will ensure that the safety of the product is maintained.

SAFETY SYMBOLS FOR YOUR TOOL

The label on your tool may include the following symbols.

- | | |
|---|---|
|  To reduce the risk of injury, user must read instruction manual |  Wear eye protection |
|  Wear ear protection |  Wear dust mask |
|  Li-Ion battery, battery must be recycled | |

BATTERY PACK REMOVAL AND PREPARATION FOR RECYCLING

To reserve natural resources, please recycle or dispose of batteries properly. This product contains lithium-ion batteries. Local, state or federal laws may prohibit disposal of lithium-ion batteries in ordinary trash. Consult Your local waste authority for information regarding available recycling and/or disposal options.



call2recycle

WARNING: Upon removal of the battery pack for disposal or recycling, cover the battery pack's terminals with heavy-duty adhesive tape. Do not attempt to destroy or disassemble the battery pack or remove any of its components. Lithium-ion batteries must be recycled or disposed of properly. Also, never touch the terminals with metal objects and/or body parts as a short circuit may result. Keep away from children. Failure to comply with these warnings could result in fire and/or serious injury.

CAUTION: LITHIUM ION BATTERY Do Not Load or Transport Package if Damaged

For more information, call Within USA and Canada: 1-800-424-9300
Outside USA and Canada: +1-703-741-5970

DESCRIPTION

KNOW YOUR ELECTRIC SCREWDRIVER (Fig. 1 & 2)

(Fig. 1)

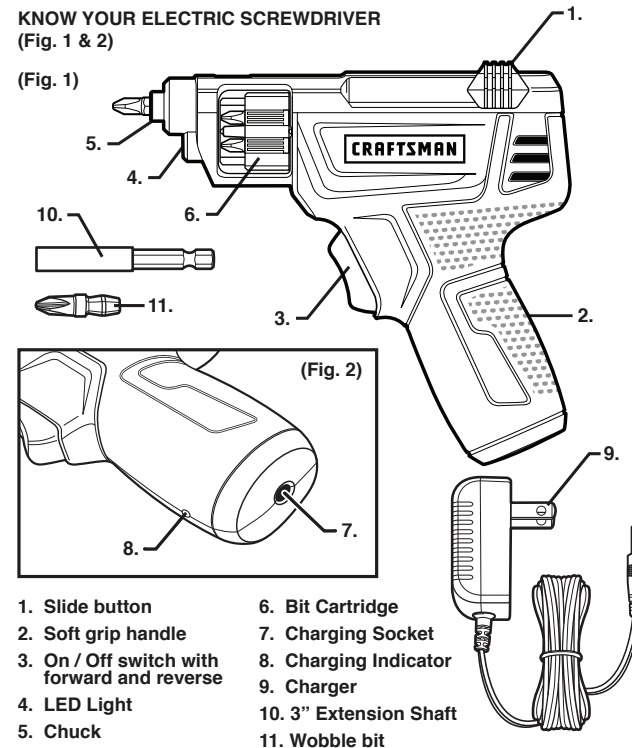

- | | |
|---|------------------------|
| 1. Slide button | 6. Bit Cartridge |
| 2. Soft grip handle | 7. Charging Socket |
| 3. On / Off switch with forward and reverse | 8. Charging Indicator |
| 4. LED Light | 9. Charger |
| 5. Chuck | 10. 3" Extension Shaft |
| | 11. Wobble bit |

INCLUDED ACCESSORIES:

25 mm Screwdriver Bit	5
25 mm Pilot Hole Drill Bit	1
#2 Wobble bit	2
3" extension shaft	2
3-5H charger	1

TECHNICAL DATA

	41771 4V screwdriver
Charger voltage	120 V~ 60Hz
Rated voltage	4 V
Battery capacity	1.5 Ah Li-ion
Rated speed	180 /min
Max torque	31 inch-lbs
Machine weight	1.05 lbs
Charging time	3-5 hours
Charger protection class	II/□
Charger output	5 V ↔ 500 mA

OPERATING INSTRUCTIONS



NOTE: Before using the tool, read the instruction book carefully.

Intended Use: The power tool is intended for driving in and loosening screws as well as for drilling in wood, metal and plastic.

Inspect the Screwdriver before using to ensure all the parts are running smoothly and there are no abnormal sounds or sparks.

⚠ WARNING: Before using screwdriver to drive fasteners into walls, check behind walls for wire and other electrical shock hazards or plumbing.

OPERATING INSTRUCTIONS cont.

BEFORE OPERATING THIS TOOL

A) CHARGE THE BATTERY

The battery charger supplied is only for the Li-ion battery installed in the tool. Do not use another battery charger. The Li-ion battery is protected against deep discharging. When the battery is empty, the tool is switched off by means of a protective circuit: The tool will not turn on when the trigger is engaged. When the Battery Pack is charged for the first time or after prolonged storage, the Battery Pack will accept a 100% charge only after several charge and discharge cycles.

B) CHARGING (See Fig. 3)

Plug the charger plug into a suitable power outlet. Next, connect the charger to the Charging Socket on the screwdriver; the indicator will illuminate Red during charging. Let the battery charge for 3-5 hours. The battery is fully charged as soon as the indicator changes to Green. Then unplug the charger. Disconnect the Charger from the screwdriver. The screwdriver is ready to be used.

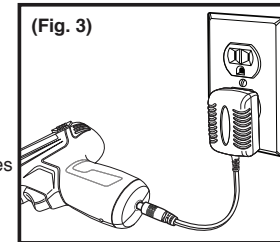

Important: When charging, the charger and screwdriver may become warm to the touch; this is normal and does not indicate a problem.

SELECTING A BIT

Pull the Slide button back (1) completely. Manually rotate the Bit Cartridge counterclockwise until the desired bit appears in the top window (2). Push the Slide button forward (3) completely. (SEE Fig. 4 & 4A). The magnetic chuck will hold the bit firmly in place.

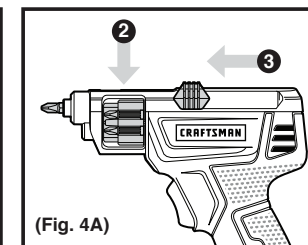
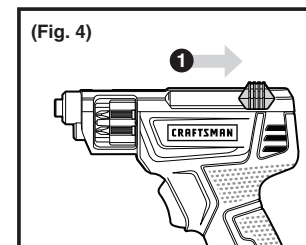

NOTE: The Screwdriver will not operate if the Slide button is not fully pushed into the forward position.

OPERATING INSTRUCTIONS cont.

REPLACING A BIT

If the bits in the Bit Cartridge need to be replaced, remove Bit Cartridge by pulling the Slide button back and pushing the Bit cartridge through the left window. Replace the bits with the desired bits. Ensure the bits are properly positioned in the Cartridge and are not protruding from the back of the Bit Cartridge. Or simply pull a worn or broken bit from the chuck and replace it with a new one. It will load into the Cartridge automatically when the Slide button is pulled back. (See Fig. 5).

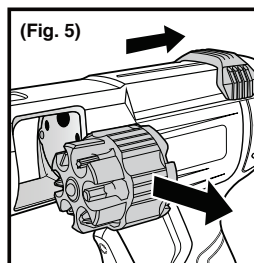

NOTE:

- 1) Only 25 mm bits are compatible with the screwdriver.
- 2) If the Slide button is not pulled back fully, the Bit Cartridge will get stuck when taking it out from the tool. Pull the Slide button all the way back.
- 3) The Slide button may not fully push forward if the bit cartridge is not properly aligned inside. Make sure the bit cartridge has clicked into place when selecting the desired bit to use. If the Slide button cannot properly be pushed forward, just turn the bit cartridge slightly clockwise or counterclockwise and try again.

EXTENSION SHAFT

Use the extension shaft to extend the reach of the screwdriver into recessed areas. To insert extension shaft into screwdriver, select the bit you need to extend and push the slide button forward to engage it. Then, using your thumb and index finger, remove the bit and insert the extension shaft into the screwdriver. Then load the bit into the extension.

WOBBLE BIT

The wobble bit is engineered to angle into hard to reach corners and recessed areas by swiveling inside of the chuck (See Fig. 6B). To use the wobble bit, first push forward and remove one of the bits from the Bit Cartridge. Insert the wobble bit directly into the chuck in place of the removed bit.

The wobble bit may also be inserted into the end of the extension shaft to extend the reach of the screwdriver even further into recessed areas.

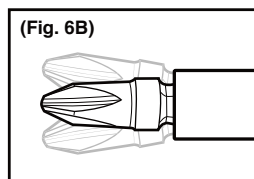
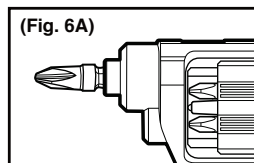

OPERATING INSTRUCTIONS cont.

FORWARD / REVERSE SWITCH (See Fig. 7)

This switch changes the chuck bit rotation direction. Push the top of the rocker switch for driving forward and push the bottom for removing screws/reverse.

⚠ WARNING: Never change the direction of rotation when the Chuck is rotating; wait until it has stopped!

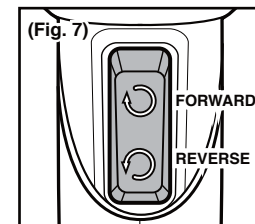

FULLY AUTOMATIC SPINDLE LOCKING (AUTO-LOCK) (See Fig. 8)

The screwdriver Chuck (Fig. 8) is locked when the On/Off Switch (Fig. 7) is not pressed. This allows the driver to be used manually when needed.

Important: When using as a manual tool, do not press the On/Off Switch (Fig. 7). Otherwise the screwdriver will be damaged.

USING THE LED LIGHT (See Fig. 9)

To turn on the light simply press the On/Off Switch. When you release the On/Off Switch, the light will be off.

LED light increases visibility and is great for dark or enclosed areas.

PROTECTION AGAINST DEEP DISCHARGING

The Li-ion battery is protected against deep discharging by the "Discharging Protection System". When the battery is empty, the tool is switched off by means of a protective circuit: The chuck no longer rotates. When this occurs you need to recharge the battery.

MAINTENANCE

Your tool requires no additional lubrication or maintenance. There are no user serviceable parts in your power tool. Never use water or chemical cleaners to clean your power tool. Wipe clean with a dry cloth. Always store your power tool in a dry place. Keep the motor ventilation slots clean. Keep all working controls free of dust. Occasionally you may see sparks through the ventilation slots. This is normal and will not damage your power tool.

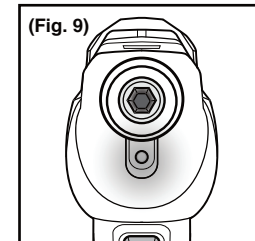
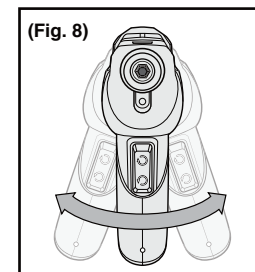

PARTS LIST

4 Volt Slide Screwdriver

Model No. 172.417710

The model number will be found on the nameplate of the Screwdriver. Always mention the model number when requesting parts and service for your tool. To purchase parts, call 1-800-331-4569

Position No.	Parts No.	Part Description	Qty.
1	CSD40QU-1	Driving Rotor	1
2	CSD40QU-2	Cartridge & Bits	1
3	CSD40QU-3	Pump subassemble	1
4	CSD40QU-4	Dial Block	1
5	CSD40QU-5	Left/Right housing	1
6	CSD40QU-6	Self tapping screw	8
7	CSD40QU-7	Terminal	2
8	CSD40QU-8	Battery(Li-ion, 1.5Ah, 4V)	1
9	CSD40QU-9	Switch PCB Board	1
10	CSD40QU-10	Light Body	1
11	CSD40QU-11	Switch button	1
12	CSD40QU-12	3-5hr Adapter (ACG336SU)	1
13	CSD40QU-13	Output shaft	1
14	CSD40QU-14	Shaft cover	1
15	CSD40QU-15	Axle Check Ring	2
16	CSD40QU-16	Retainer Ring	1
17	CSD40QU-17	Washer	1
18	CSD40QU-18	Steel ball	1
19	CSD40QU-19	Cartridge	1
20	CSD40QU-20	Orientation Pole	1
21	CSD40QU-21	Spring	1
22	CSD40QU-22	Magnet	1
23	CSD40QU-23	Cover	1
24	CSD40QU-24	Bits	6
25	CSD40QU-25	Self tapping screw	4
26	CSD40QU-26	Gear Case Cover	1
27	CSD40QU-27	Gear Case	1
28	CSD40QU-28	Block	1

PARTS LIST

Position No.	Parts No.	Part Description	Qty.
29	CSD40QU-29	Spring	3
30	CSD40QU-30	Transfer shaft	1
31	CSD40QU-31	Dial Block	1
32	CSD40QU-32	Pin	2
33	CSD40QU-33	Shaft cover C	2
34	CSD40QU-34	Shaft cover B	3
35	CSD40QU-35	Washer	2
36	CSD40QU-36	Gear C	1
37	CSD40QU-37	Gear B	1
38	CSD40QU-38	Gear A	1
39	CSD40QU-39	Sleeve A	1
40	CSD40QU-40	Stop block	1
41	CSD40QU-41	Stop block	1
42	CSD40QU-42	Press plate	2
43	CSD40QU-43	Output spindle	1
44	CSD40QU-44	Fixing Ring	1
45	CSD40QU-45	Washer	1
46	CSD40QU-46	Transfer connector	1
47	CSD40QU-47	Spindle Lock	6
48	CSD40QU-48	Planet carrier	1
49	CSD40QU-49	2# Planet Gear	3
50	CSD40QU-50	1# Planet Frame	1
51	CSD40QU-51	1# Planet Gear	3
52	CSD40QU-52	Inner Gear Ring	1
53	CSD40QU-53	Washer	1
54	CSD40QU-54	Motor gear	1
55	CSD40QU-55	Screw	2
56	CSD40QU-56	End bell	1
57	CSD40QU-57	Motor	1
58	CSD40QU-58	Connector	1
59	CSD40QU-59	Terminal block	1
60	CSD40QU-60	PCB Board	1
61	CSD40QU-61	Switch	1
62	CSD40QU-62	LED light	1

PARTS LIST

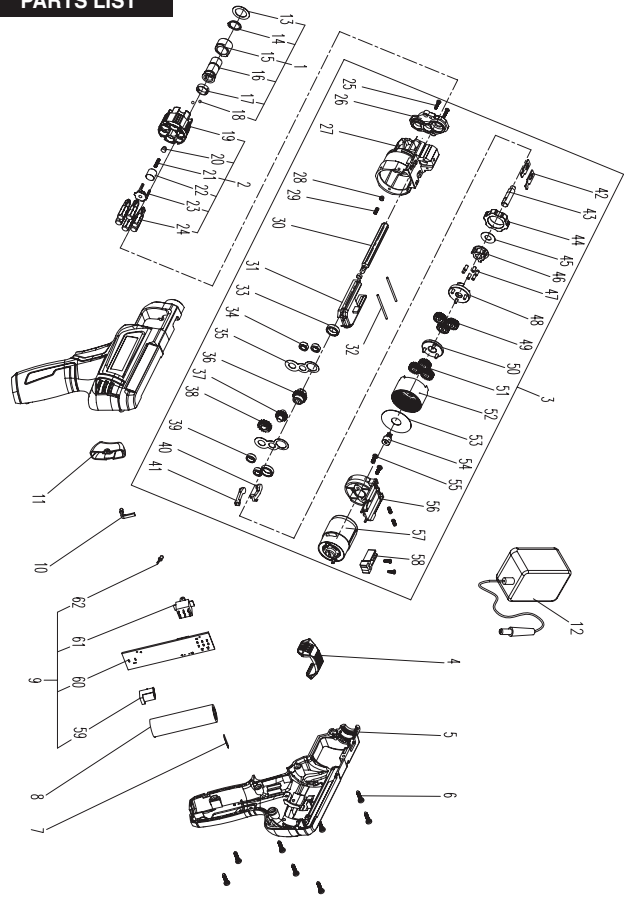

NOTES
