

Owner's Manual

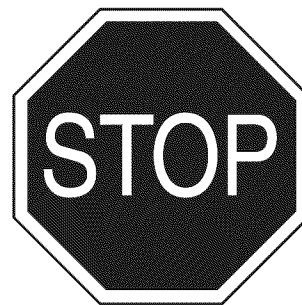

## 48" TINE DETHATCHER

Model No. 486.24310

DO NOT RETURN TO STORE  
For Missing Parts or Assembly  
Questions Call 1-866-576-8388

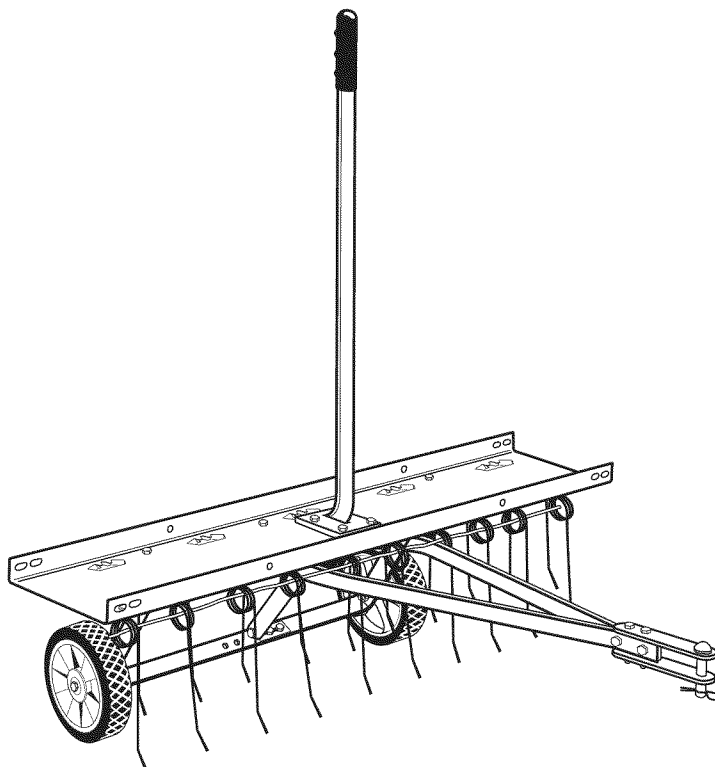

### CAUTION:

Before using this product, read this manual and follow all Safety Rules and Operating Instructions.

- Safety
- Assembly
- Operation
- Maintenance
- Parts

Sears Brands Management Corporation, Hoffman Estates, IL 60179 U.S.A.  
[www.craftsman.com](http://www.craftsman.com)

# TABLE OF CONTENTS

SAFETY RULES..... 2	OPERATION..... 6
FULL SIZE HARDWARE CHART..... 3	MAINTENANCE/STORAGE ..... 6
CARTON CONTENTS..... 4	REPAIR PARTS ..... 7
ASSEMBLY..... 4	PARTS ORDERING/SERVICE .....Back Cover

## WARRANTY

### CRAFTSMAN LIMITED WARRANTY

FOR ONE YEAR from the date of sale this product is warranted against defects in material or workmanship. WITH PROOF OF SALE a defective part will be replaced free of charge. If a replacement part is unavailable, the product will be replaced with one of equal value.

For warranty coverage details to obtain free replacement, visit the web page: [www.craftsman.com/warranty](http://www.craftsman.com/warranty)

This warranty does not cover expendable items that can wear out from normal use or deterioration within the warranty period, including but not limited to tires, belts, exterior finishes or product labels.

This warranty does not apply to a product that is damaged or altered through transportation, misuse, abuse, corrosion, accident, neglect modification or mishandling.

This warranty is void if this product is ever used while providing commercial services or if rented to another person.

This warranty gives you specific legal rights, and you may also have other rights which vary from state to state.

**Sears Brands Management Corporation, Hoffman Estates, IL 60179**

DO NOT RETURN TO STORE for Missing Parts or Assembly Questions  
Call 1-866-576-8388 Attachment Hotline

The model number and serial numbers will be found on a decal attached to the dethatcher.  You should record both the serial number and the date of purchase and keep in a safe place for future reference.	SERIAL NUMBER: _____  DATE OF PURCHASE: _____
------------------------------------------------------------------------------------------------------------------------------------------------------------------------------------------------------------------	-----------------------------------------------------



## SAFETY



Any power equipment can cause injury if operated improperly or if the user does not understand how to operate the equipment. Exercise caution at all times when using power equipment.

- Read this owners manual carefully for operating and service instructions before attempting to assemble or operate this equipment. Be thoroughly familiar with the proper use of this equipment.
- Read the vehicle owners manual and vehicle safety rules, and know how to operate the vehicle before using this equipment.
- Never allow children to operate the tractor or dethatcher attachment, and do not allow adults to operate without proper instructions.
- This dethatcher attachment has sharp tine points. Always handle with care and wear substantial foot wear when operating this dethatcher.
- Do not allow anyone to ride or sit on dethatcher attachment frame or on towing vehicle.
- Keep the area of operation clear of all persons, particularly small children, and also pets.
- Always begin with the transmission in first (low) gear and engine at low speed, and gradually increase speed as conditions permit.
- The vehicle braking and stability may be affected with the attachment of this equipment. Be aware of changing conditions on slopes. Refer to safety rules in the vehicle owner's manual concerning safe operation on slopes. **STAY OFF OF STEEP SLOPES.**
- Always operate up and down a slope, never across the face of a slope
- This equipment should be operated at reduced speed on rough terrain, along creeks and ditches and on hillsides, to prevent tipping and loss of control. Do not drive too close to a creek or a ditch.
- Do not tow this equipment on a highway or any other public thoroughfare.
- Follow the maintenance instructions as outlined in this owners manual.



Look for this symbol to point out important safety precautions. It means — **Attention!! Become alert!! Your safety is involved.**

# HARDWARE PACKAGE CONTENTS

## SHOWN FULL SIZE

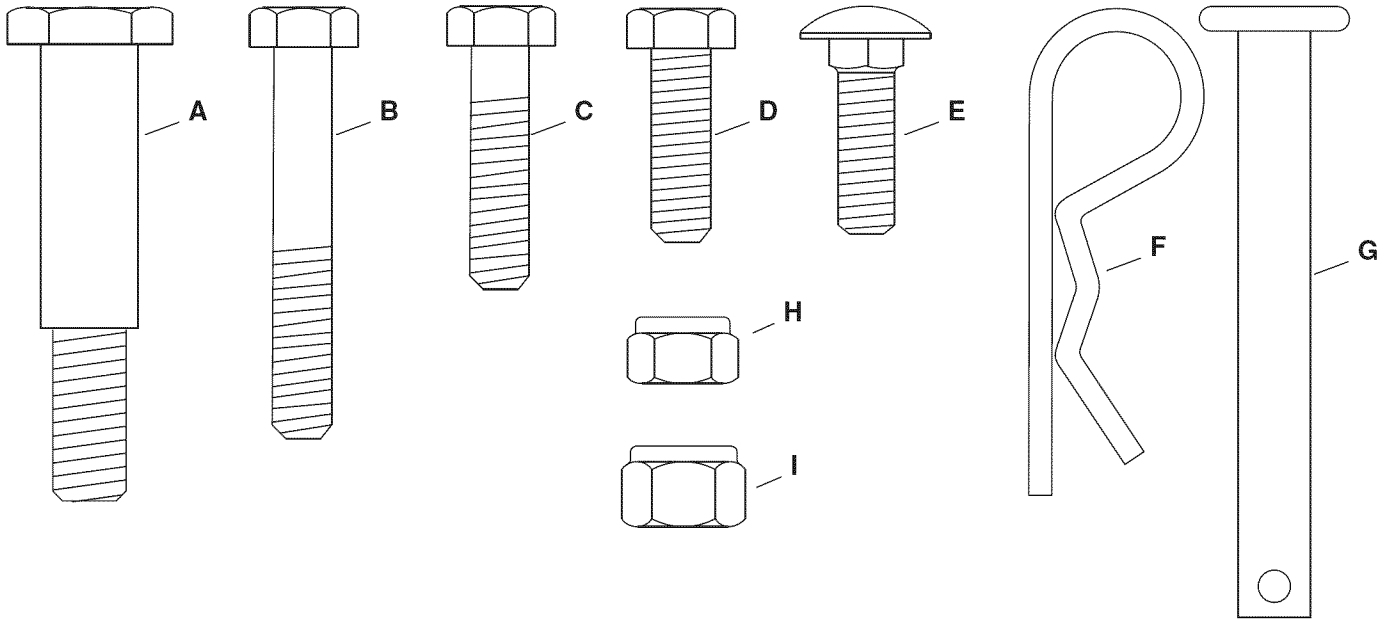

## NOT SHOWN FULL SIZE

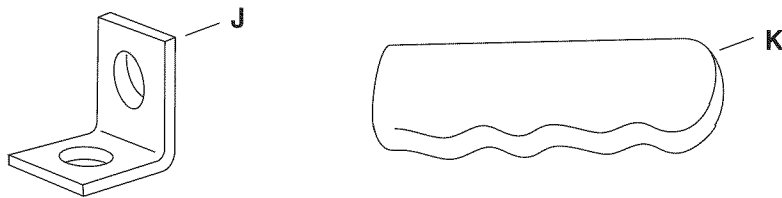

REF	QTY	PART NO.	DESCRIPTION	REF	QTY	PART NO.	DESCRIPTION
A	2	43029	Shoulder Bolt	G	1	47623	Hitch Pin, 3/8"
B	2	44180	Hex Bolt, 5/16 x 2"	H	23	47810	Nylock Nut, 5/16"
C	2	43840	Hex Bolt, 5/16 x 1-1/4"	I	2	HA21362	Nylock Nut, 3/8"
D	15	43063	Hex Bolt, 5/16 x 1"	J	4	23826	Angle Bracket
E	4	44326	Carriage Bolt, 5/16 x 1"	K	1	43943	Grip
F	1	43343	Hair Cotter Pin, 1/8"				

# ASSEMBLY

## CARTON CONTENTS

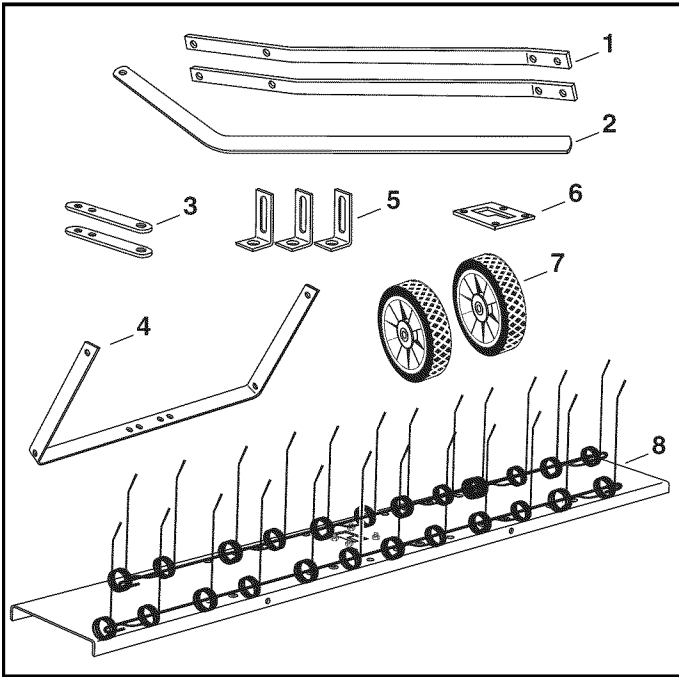

- |                         |                                 |
|-------------------------|---------------------------------|
| 1. Hitch Mount Arms (2) | 5. Hitch Arm Mount Brackets (3) |
| 2. Lift Handle          | 6. Lift Plate                   |
| 3. Hitch Brackets (2)   | 7. Wheels (2)                   |
| 4. Axle Bracket         | 8. Tine Shield Assembly         |

## TOOLS REQUIRED FOR ASSEMBLY

- (2) 1/2" wrenches
- (1) 9/16" wrench
- (1) 3/4" wrench or adjustable wrench
- (1) Pliers

## REMOVAL OF PARTS FROM CARTON

- Remove all parts and hardware packages from the carton. Lay out all parts and hardware and identify using the illustrations on pages 3 and 4.
- Assemble the lift plate to the top of the tine shield using four 5/16" x 1" hex bolts and 5/16" nylock nuts. **Tighten.** See figure 1.

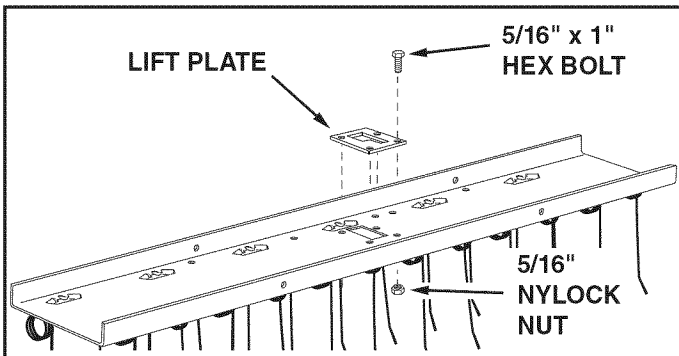

FIGURE 1

- Assemble two (tall) hitch arm mount brackets and two (short) angle brackets to the bottom of the tine shield at the rear. Use four 5/16" x 1" hex bolts and 5/16" nylock nuts. **Do not tighten yet.** Position the brackets as shown in figure 2.
- Assemble two angle brackets to the bottom of the tine shield at the front. Use two 5/16" x 1" hex bolts and 5/16" nylock nuts. **Do not tighten yet.** Position the brackets as shown in figure 2.

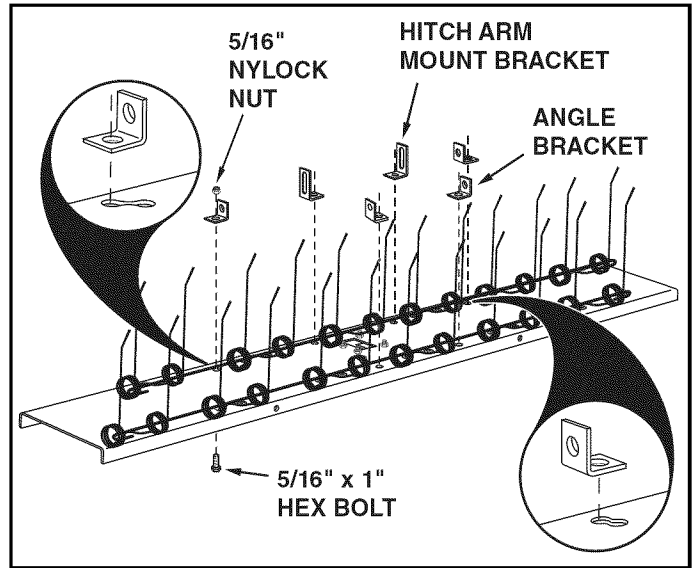

FIGURE 2

- Fasten the hitch mount arms to the outside of the front angle brackets. Use two 5/16" x 1" hex bolts and 5/16" nylock nuts. **Tighten, then loosen** the nuts slightly. See figure 3.
- Fasten the hitch mount arms to the outside of the rear hitch arm mount brackets. Use two 5/16" x 1" carriage bolts and 5/16" nylock nuts. **Do not tighten yet.** See figure 3.

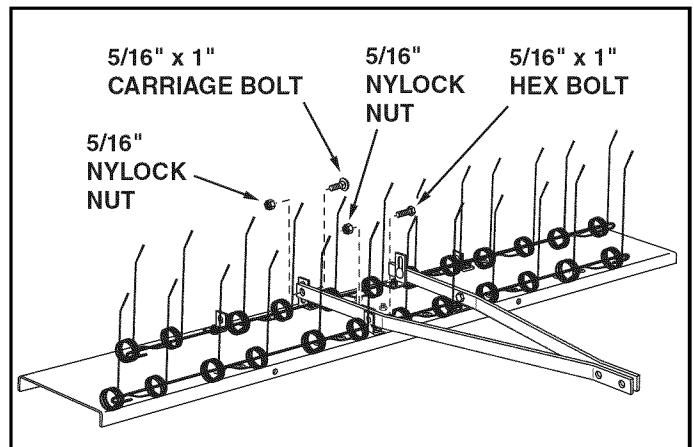

FIGURE 3

- Assemble the front ends of the hitch mount arms together using two 5/16" x 1-1/4" hex bolts and 5/16" nylock nuts. **Do not tighten yet.** See figure 4.
- Assemble the hitch brackets to the hitch mount arms using two 5/16" x 2" hex bolts and 5/16" nylock nuts. **Do not tighten yet.** See figure 4.
- Assemble the 3/8" hitch pin through the hitch brackets and secure it with a 1/8" hair cotter pin. See figure 4.

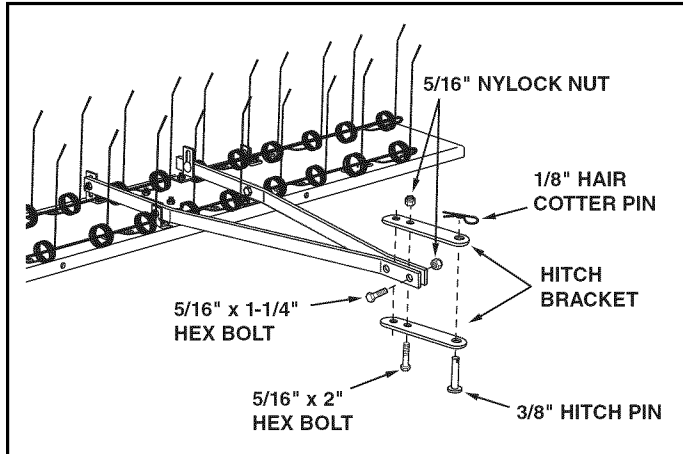

FIGURE 4

- **Tighten** the bolts and nuts assembled in figure 4. **Tighten** the bolts and nuts assembled in figure 2. **Tighten** the rear bolts and nuts assembled in figure 3.
- Assemble the axle bracket to the outside of the rear angle brackets using two 5/16" x 1" hex bolts and 5/16" nylock nuts. The angled ends of the axle bracket must point as shown in figure 5. **Tighten** the bolts and nuts and then **loosen** slightly.

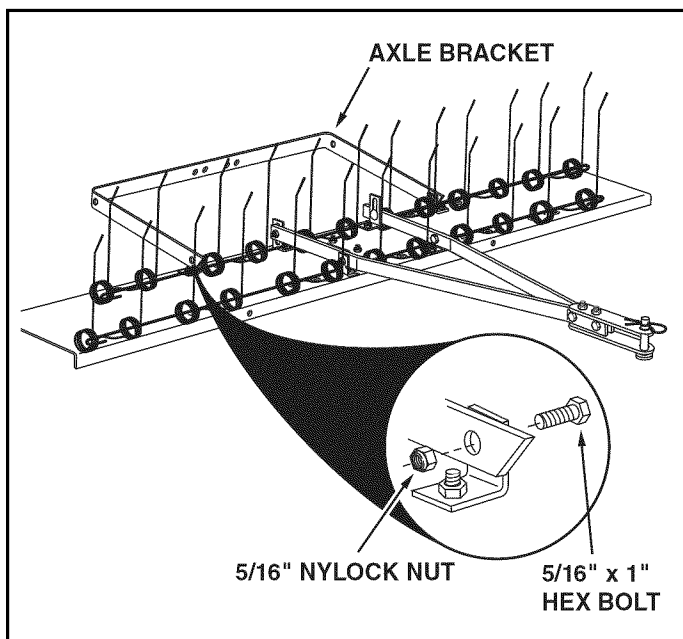

FIGURE 5

- Assemble the wheels to the axle bracket using two shoulder bolts and two 3/8" nylock nuts. **Tighten.** See figure 6.

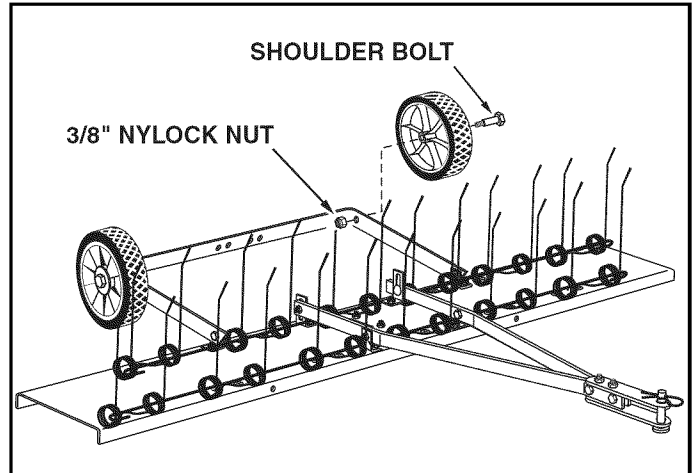

FIGURE 6

- Assemble a hitch arm mount bracket to the axle bracket using two 5/16" x 1" carriage bolts and 5/16" nylock nuts. **Do not tighten yet.** See figure 7.
- Insert the lift handle down through the tine shield. Attach it to the just assembled hitch arm mount bracket using a 5/16" x 1" hex bolt and a 5/16" nylock nut. **Tighten.** See figure 7.
- Position the hitch arm mount bracket so that there is side tension on the lift handle when it is locked in the up position. **Tighten** the nuts. See figure 7.
- Assemble the grip onto the end of the lift handle. See figure 7.

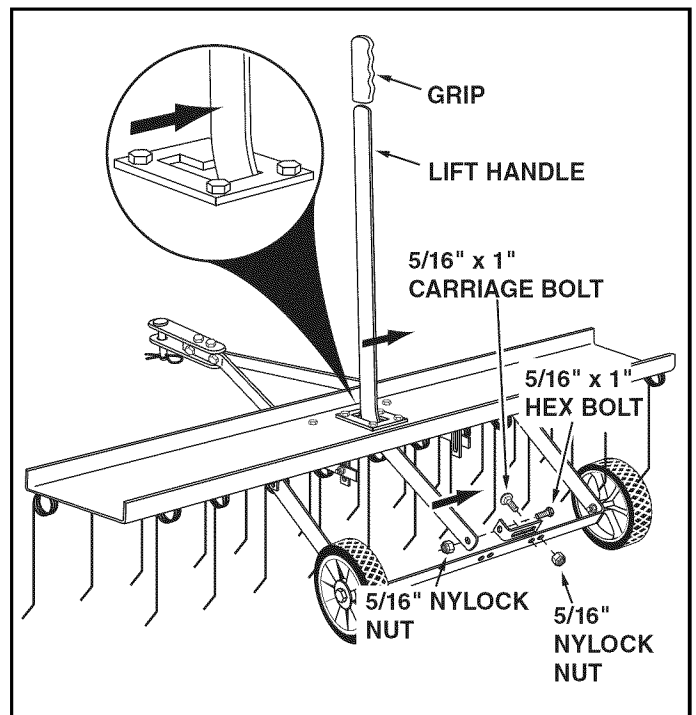

FIGURE 7

# OPERATION

Regular removal of thatch is critical to maintenance of a healthy lawn. Excessive thatch prevents air, water and fertilizer from reaching the roots. To effectively dislodge excessive thatch from your lawn, read these instructions for proper adjustment and operation of the dethatcher.

## ADJUSTMENT OF TINE SHIELD

- Move the towing vehicle onto a level surface, such as a driveway or garage floor and attach the tine dethatcher to the vehicle hitch. See figure 8.
- Lower the dethatcher into operating position using the lift handle. Loosen the two nylock nuts and carriage bolts which fasten the hitch mount arms to the hitch arm mount brackets at the rear of the tine shield. Adjust the tine shield until it is level and both the front and rear spring tines are in contact with the ground. Retighten the hex nuts. See figure 8.

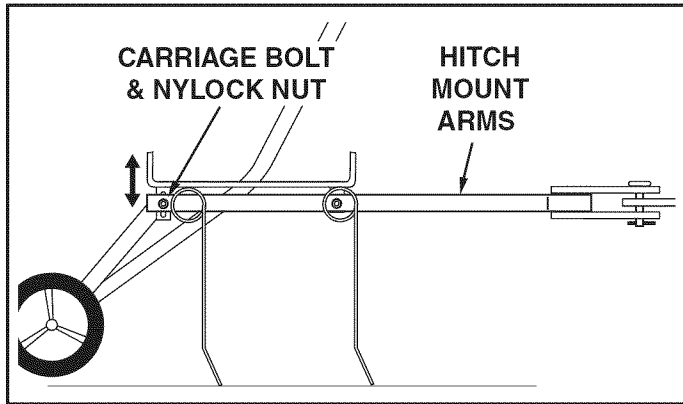

FIGURE 8

## OPERATING TIPS

- Vary the vehicle's forward speed until the best dethatching action is achieved.
- For best results, use a crisscross pattern on your lawn.
- If the dethatcher appears to be "jumping" during use, then extra weight should be added to the tine shield. In most conditions extra weight will be needed. Concrete patio blocks are recommended for weight because of their low profile; however any type of weight is suitable if it can be tied down to the shield. Secure weight by using suitable binding material such as rubber tie down straps or wire, fastening to the holes in the shield flange. See figure 9.

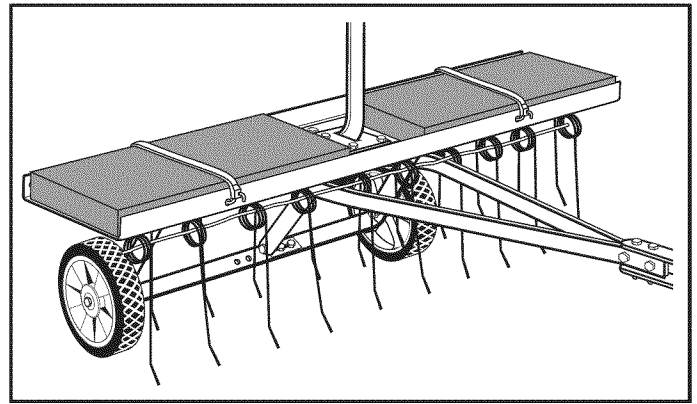

FIGURE 9

# MAINTENANCE/STORAGE

## CUSTOMER RESPONSIBILITIES

- Read and follow the maintenance schedule and the maintenance procedures listed in this section.

MAINTENANCE SCHEDULE Fill in dates as you complete regular service.	Service Dates											
	Before each use	After each use	Every season	Before storage								
Check for loose fasteners	X											
Lubrication		X										

- Before each use check all nuts and bolts for tightness.
- Lubricate wheels at least once a year or as needed.
- If rust appears on the shield or spring tines, sand lightly and coat with enamel paint.
- Always store in a dry area, and coat exposed metal with light oil when not in use.
- To remove a spring tine, insert a screw driver or punch into the locking tab and pry up. Replace spring tine and pry tab down. See figure 10.

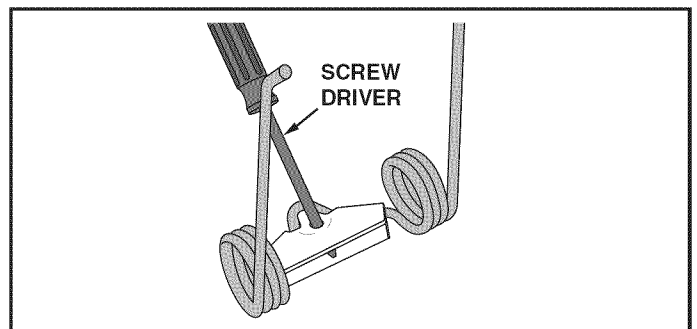
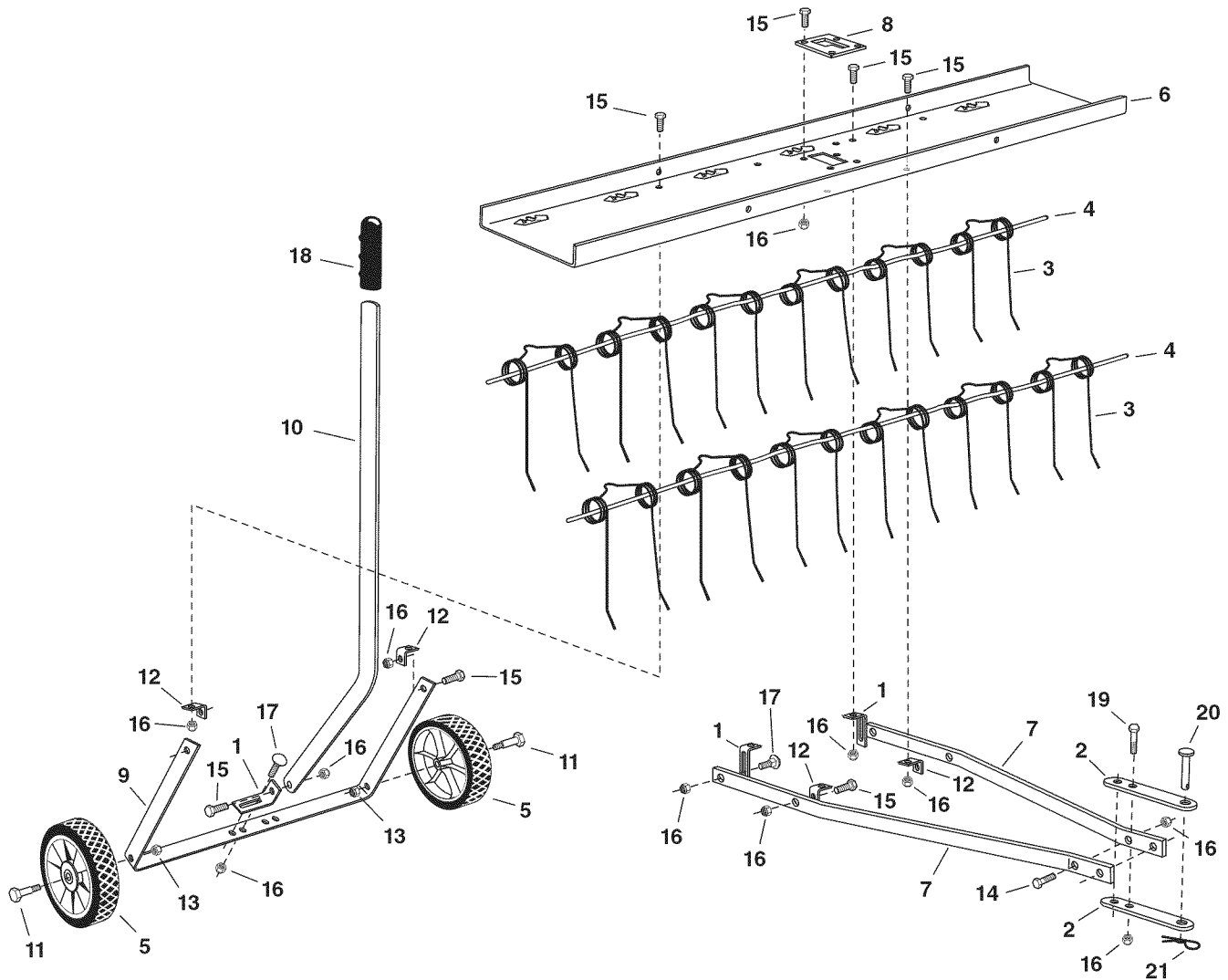

FIGURE 10

# PARTS

## 48" TINE DETHATCHER MODEL 486.24310

To purchase repair parts, call the following toll-free number: 1-888-331-4569



REF	PART NO.	QTY	DESCRIPTION	REF	PART NO.	QTY	DESCRIPTION
1	23442	3	Hitch Arm Mount Bracket	12	23826	4	Angle Bracket
2	23981	2	Hitch Bracket	13	HA21362	2	Nylock Nut, 3/8"
3	43783	12	Spring Tine	14	43840	2	Hex Bolt, 5/16 x 1-1/4"
4	47654	2	Spring Alignment Wire	15	43063	15	Hex Bolt, 5/16 x 1"
5	43021	2	Wheel	16	47810	23	Nylock Nut, 5/16"
6	24854	1	Tine Shield	17	44326	4	Carriage Bolt, 5/16 x 1"
7	23914	2	Hitch Mount Arm	18	43943	1	Grip
8	24594	1	Lift Plate	19	44180	2	Hex Bolt, 5/16 x 2"
9	24595	1	Axle Bracket	20	47623	1	Hitch Pin, 3/8"
10	24596	1	Lift Handle	21	43343	1	Hair Cotter Pin, 1/8"
11	43029	2	Shoulder Bolt		41220	1	Owner's Manual

\* Purchase Common Hardware Locally

# CRAFTSMAN®

Product questions or problems?

# 1-888-331-4569

## Customer Care Hot Line

Get answers to questions, troubleshoot problems,  
order parts, or schedule repair service.

Para respuestas a preguntas o problemas, y ordenar  
piezas o pedir servicio para la reparación de su equipo.

To help us help you, register your product at [www.craftsman.com/registration](http://www.craftsman.com/registration)

Para poderte ayudar mejor, registra tu producto en [www.craftsman.com/registration](http://www.craftsman.com/registration)

Join the Craftsman Club today!

# CRAFTSMAN CLUB®

[www.craftsman.com/signup](http://www.craftsman.com/signup)

Receive exclusive member benefits including special pricing and offers,  
project sharing, expert advice, and **SHOP YOUR WAY REWARDS!**

Como miembro exclusivo, recibe diversos beneficios como ofertas, precios especiales, proyectos nuevos, consejos de expertos y nuestro programa de puntos **SHOP YOUR WAY REWARDS!**