

4-480-203-11(1)

SONY[®]

Digital Still Camera

كاميرا رقمية

Instruction Manual

DSC-QX10/QX100



4480203110

©2013 Sony Corporation
Printed in China

AR

Cyber-shot

DSC-QX10/QX100

SONY[®]

Digital Still Camera

Appareil photo numérique/Digitale Fotokamera/
Cámara fotografia digital/Fotocamera digitale/
Digitale camera/Cámara fotográfica digital/
Digital stillbildskamera/Цифровой фотоаппарат/
디지털 카메라/數位照相機

Instruction Manual

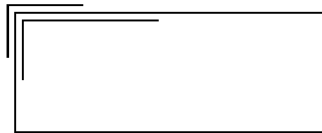

Cyber-shot

DSC-QX10/QX100

4-480-203-11(1)

GB

FR

DE

ES

IT

NL

PT

SE

RU

KR

CT

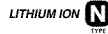

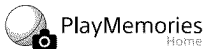

You can download the image management software “PlayMemories Home” from the following URL.

<http://www.sony.net/pm/>

Owner's Record

The model and serial numbers are located on the back. Record the serial number in the space provided below. Refer to these numbers whenever you call your Sony dealer regarding this product.

Model No. DSC-QX10/DSC-QX100 _____

Serial No. _____

WARNING

To reduce fire or shock hazard, do not expose the unit to rain or moisture.

CAUTION

Battery pack

If the battery pack is mishandled, the battery pack can burst, cause a fire or even chemical burns. Observe the following cautions.

- Do not disassemble.
- Do not crush and do not expose the battery pack to any shock or force such as hammering, dropping or stepping on it.
- Do not short circuit and do not allow metal objects to come into contact with the battery terminals.

- Do not expose to high temperature above 60°C (140°F) such as in direct sunlight or in a car parked in the sun.
- Do not incinerate or dispose of in fire.
- Do not handle damaged or leaking lithium ion batteries.
- Be sure to charge the battery pack using a genuine Sony battery charger or a device that can charge the battery pack.
- Keep the battery pack out of the reach of small children.
- Keep the battery pack dry.
- Replace only with the same or equivalent type recommended by Sony.
- Dispose of used battery packs promptly as described in the instructions.

AC Adaptor

Use the nearby wall outlet (wall socket) when using the AC Adaptor. Disconnect the AC Adaptor from the wall outlet (wall socket) immediately if any malfunction occurs while using the apparatus.



Hereby, Sony Corporation, declares that this DSC-QX10/QX100 Digital Still Camera is in compliance with the essential requirements and other relevant provisions of Directive 1999/5/EC. For details, please access the following URL:
<http://www.compliance.sony.de/>

Notice for the customers in the countries applying EU Directives

Manufacturer: Sony Corporation, 1-7-1 Konan Minato-ku Tokyo, 108-0075 Japan
For EU product compliance: Sony Deutschland GmbH, Hedelfinger Strasse 61,
70327 Stuttgart, Germany

Notice

If static electricity or electromagnetism causes data transfer to discontinue midway (fail), restart the application or disconnect and connect the communication cable (USB, etc.) again.

This product has been tested and found compliant with the limits set out in the EMC regulation for using connection cables shorter than 3 meters (9.8 feet).

The electromagnetic fields at the specific frequencies may influence the picture and sound of this unit.

Disposal of Old Electrical & Electronic Equipment (Applicable in the European Union and other European countries with separate collection systems)



This symbol on the product or on its packaging indicates that this product shall not be treated as household waste. Instead it shall be handed over to the applicable collection point for the recycling of electrical and electronic equipment. By ensuring this product is disposed of correctly, you will help prevent potential negative consequences for the environment and human health, which could otherwise be caused by inappropriate waste

handling of this product. The recycling of materials will help to conserve natural resources. For more detailed information about recycling of this product, please contact your local Civic Office, your household waste disposal service or the shop where you purchased the product.

Disposal of waste batteries (applicable in the European Union and other European countries with separate collection systems)



This symbol on the battery or on the packaging indicates that the battery provided with this product shall not be treated as household waste.

On certain batteries this symbol might be used in combination with a chemical symbol. The chemical symbols for mercury (Hg) or lead (Pb) are added if the battery contains more than 0.0005% mercury or 0.004% lead.

By ensuring these batteries are disposed of correctly, you will help prevent potentially negative consequences for the environment and human health which could otherwise be caused by inappropriate waste handling of the battery. The recycling of the materials will help to conserve natural resources. In case of products that for safety, performance or data integrity reasons require a permanent connection with an incorporated battery, this battery should be replaced by qualified service staff only.

To ensure that the battery will be treated properly, hand over the product at end-of-life to the applicable collection point for the recycling of electrical and electronic equipment.

For all other batteries, please view the section on how to remove the battery from the product safely. Hand the battery over to the applicable collection point for the recycling of waste batteries.

For more detailed information about recycling of this product or battery, please contact your local Civic Office, your household waste disposal service or the shop where you purchased the product.

For Customers in Singapore

Complies with
IDA Standards
DB00353



About the camera

The camera is designed to be connected to a smartphone via Wi-Fi. You can transfer images to a smartphone on the spot just after shooting.

Check the supplied items

- Rechargeable battery pack NP-BN (1)
- Micro USB cable (1)
- Wrist strap (1)
- Smartphone attachment (1)
- Instruction Manual (this manual) (1)

Name of main parts

- 1 Power button
- 2 Microphone
- 3 Display panel
 - : Indicates memory card not inserted
 - : Indicates remaining battery capacity
- 4 Hook for strap
- 5 Tripod socket
- 6 Control ring (DSC-QX100)

7 Power/Charge/Movie lamp

Green: Power ON

Orange: Charging

Red: Recording a movie

8 Zoom lever

9 Shutter button

10 Multi terminal

11 RESET button

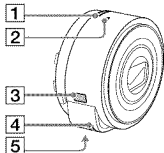

DSC-QX10

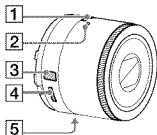
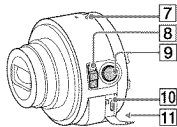

DSC-QX100

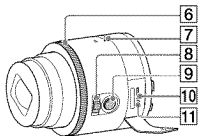

Charging the battery

Charge the battery before using the camera. To charge, use the micro USB cable (supplied) to connect the camera to a computer.

- Turn off the power when the battery is being charged.
- If you do not have a computer, use the AC adaptor AC-UD10 or AC-UD11 (both sold separately). The AC-UD11 (sold separately) may not be available in some countries/regions.

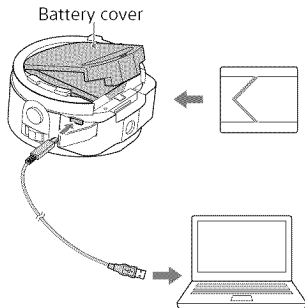

Inserting a memory card

Insert a microSD memory card or "Memory Stick Micro" (M2) media before shooting.

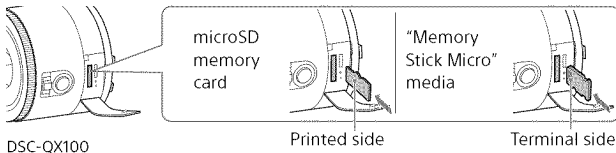
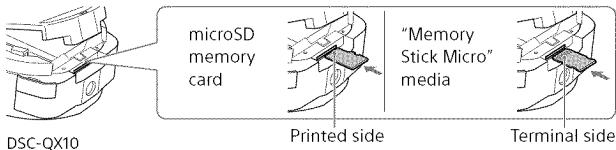

Installing “PlayMemories Mobile”

Install “PlayMemories Mobile” to the smartphone before using the camera. If “PlayMemories Mobile” is already installed, update it to the latest version.

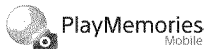

For details on “PlayMemories Mobile”, refer to the support website
<http://www.sony.net/pmm/>



■ Android

Search for “PlayMemories Mobile” from Google Play and install it.



■ iPhone

Search for “PlayMemories Mobile” from App Store and install it.



Connecting the camera and a smartphone via Wi-Fi

The connection method varies depending on the type of smartphone. Confirm your smartphone type and connect via Wi-Fi.

Android

- ① Turn on the power of the camera.
- ② Start "PlayMemories Mobile" on the smartphone.
- ③ Select the SSID, as printed on the inside of the camera's battery cover or on the cover of this manual.

- ④ Input the password, as printed on the same label (first time only).

Connecting the camera and a smartphone via Wi-Fi (continued)

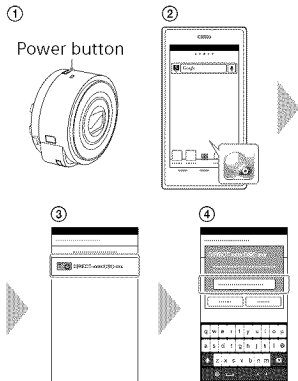

Android (NFC-compatible)

- ① Touch the **N** (N mark) of the smartphone against the N Mark of the camera.

Powered on: Continue to touch (1-2 seconds) without moving until "PlayMemories Mobile" starts up.

Powered off: Keep the camera and a smartphone touching until the lens of the camera extends.

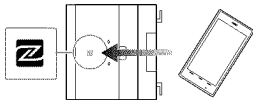

iPhone

- ① Turn on the power of the camera.
- ② On the smartphone, select [Settings], then select [Wi-Fi].
- ③ Select the SSID, as printed on the inside of the camera's battery cover or on the cover of this manual.
- ④ Input the password, as printed on the same label (first time only).
- ⑤ Confirm the connection to the SSID of the camera.
- ⑥ Go back to the Home screen, then start "PlayMemories Mobile".

①

Power button

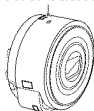

②



Continued →

Connecting the camera and a smartphone via Wi-Fi (continued)

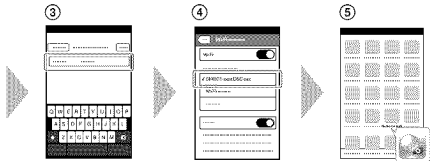

Attaching the camera to a smartphone

Attach a smartphone after fixing the camera to the smartphone attachment (supplied).

- ① Fix the camera to the attachment.
Put the camera into the slot of the attachment, aligning the index, then rotate the attachment until it clicks.

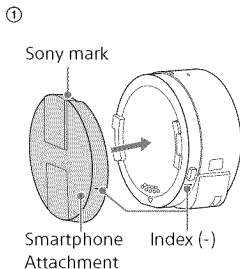

Continued →

Attaching the camera to a smartphone (continued)

- ② Open the clamps of the attachment.
 - ③ Extend the clamps and attach a smartphone.
- Do not swing the camera around with a smartphone attached to it, as the smartphone may slip out of the attachment.
 - Make sure no buttons are caught when the smartphone is attached.

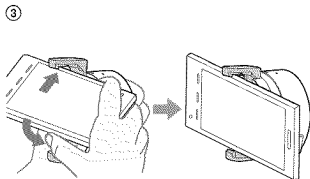
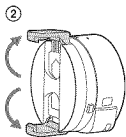

Removing the smartphone attachment

Slide the removal lever to the lens side and rotate the attachment.



Removal lever

Shooting images

- ① Start "PlayMemories Mobile" on the smartphone.
- ② Shoot images with the shutter button of the camera or "PlayMemories Mobile". The shutter button of the camera is not available while shooting movies.

[2M] images are transmitted automatically to the smartphone.
[18M] images are saved into the memory card of the camera (default setting).

Screen of "PlayMemories Mobile"*

- ① Switching exposure modes
- ② Settings
- ③ Shutter/movie button
- ④ Switching between still image/movie
- ⑤ Zoom

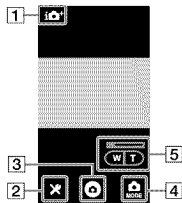

Terminating

-
- ① End "PlayMemories Mobile" to return to the Home screen.
 - ② Turn off the power of the camera.
 - If you turn off the power of the camera before ending "PlayMemories Mobile", an error message will be displayed. This is not a malfunction.
- * The display screen for the application is subject to change without notice by future upgrades.

Refer to the Help Guide

The Help Guide is an online manual. Refer to the Help Guide when you would like to know further details, settings and operations of "PlayMemories Mobile", and precautions.

<http://www.sony.net/SonyInfo/Support/>

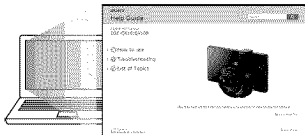
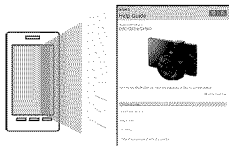

Why doesn't the camera charge?

- Turn the power off.

Why the power lamp flashing red?

- Memory card is not inserted correctly. Insert it in the correct direction.

How can I correct the date/time?

- When Wi-Fi connection between the camera and the smartphone is made, the date/time on the camera is automatically set to that of the smartphone.

How can I return to the default setting?

- Turn on the power of the camera, then press the RESET button.

How can I change a setup of image size, etc.?

- You can make changes on the settings screen of "PlayMemories Mobile".

How can I see the number of images or information about the camera?

- Refer to the "Specifications" of this manual or the "Help Guide (HTML)".

Continued 

Why has the power of the camera turned on unexpectedly?

- If an NFC-enabled smartphone is close to the camera, the power may turn on accidentally. This is not a malfunction.

Why does an image not transfer to my smartphone after shooting?

- Movies are recorded on a memory card, but are not transferred automatically.

I've forgotten the password. Where can I find out what it is?

- The password and SSID are printed on the inside of the battery cover or on the cover of this manual.

Specifications

Dimensions (CIPA compliant):

DSC-QX100: 62.5 mm × 62.5 mm × 55.5 mm (2 1/2 inches × 2 1/2 inches × 2 1/4 inches) (W/H/D)

DSC-QX10: 62.4 mm × 61.8 mm × 33.3 mm (2 1/2 inches × 2 1/2 inches × 1 5/16 inches) (W/H/D)

Mass (CIPA compliant) (including NP-BN battery pack, "Memory Stick Micro" media):

DSC-QX100: Approx. 179 g (6.3 oz)

DSC-QX10: Approx. 105 g (3.7 oz)

Power: Rechargeable battery pack NP-BN, 3.6 V

Power consumption (during shooting): 1.1 W

Battery life and number of images that can be recorded

	Battery life	Number of images
Shooting (still images)	Approx. 110 min.	Approx. 220 images
Actual shooting (movies)	Approx. 25 min.	-
Continuous shooting (movies)	Approx. 55 min. (DSC-QX100) Approx. 65 min. (DSC-QX10)	-

- The number is based on the CIPA standard.
(CIPA: Camera & Imaging Products Association)
- The above number varies depending on the type of smartphone and how it is used.

Trademarks

- The following marks are trademarks of Sony Corporation.

Cyber-shot, "Cyber-shot", "Memory Stick",  **MEMORY STICK**™, "Memory Stick Micro", **MEMORY STICK MICRO**, "PlayMemories Home".

- microSDXC logo is a trademark of SD-3C, LLC.
- Android, Google Play are trademarks or registered trademarks of Google Inc.
- Wi-Fi, the Wi-Fi logo, Wi-Fi PROTECTED SET-UP are trademarks or registered trademarks of the Wi-Fi Alliance.
- The N Mark is a trademark or registered trademark of NFC Forum, Inc. in the United States and in other countries.
- In addition, system and product names used in this manual are, in general, trademarks or registered trademarks of their respective developers or manufacturers. However, the ™ or ® marks are not used in all cases in this manual.

Notes on using the camera

Notes on using the camera

When you attach a smartphone attachment to the camera, be careful not to pinch a finger.

On camera's temperature

Your camera and battery may get hot due to continuous use, but it is not a malfunction.

On the overheat protection

Depending on the camera and battery temperature, you may be unable to record movies or the power may turn off automatically to protect the camera. In this case, leave the power off and wait until the camera and battery temperature goes down. If you turn on the power without letting the camera and battery cool enough, the power may turn off again or you may be unable to record movies.

On use and care

Avoid rough handling, disassembling, modifying, physical shock, or impact such as hammering, dropping, or stepping on the product. Be particularly careful of the lens.

Additional information on this product and answers to frequently asked questions can be found at our Customer Support Website.

<http://www.sony.net/>