

Operator's Manual



# HAMMERHEAD™

## C3 AUTO-HAMMER WITH ADJUSTABLE HEAD

Model No. 320.38600

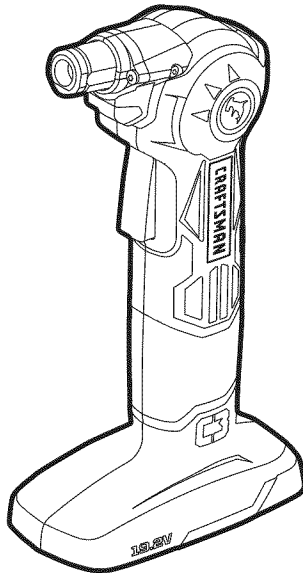

**▲ WARNING:** To reduce the risk of injury, the user must read and understand the Operator's Manual before using this product.

- WARRANTY
- SAFETY
- DESCRIPTION
- ASSEMBLY
- OPERATION
- MAINTENANCE

Sears Brands Management Corporation, Hoffman Estates,  
IL 60179 U.S.A.

[www.craftsman.com](http://www.craftsman.com)

## TABLE OF CONTENTS

Warranty	Page 2
Safety Symbols	Pages 4-5
Safety Instructions	Pages 6-9
Description	Pages 10-11
Assembly	Page 12
Operation	Pages 13-15
Maintenance	Page 17
Troubleshooting	Page 17
Parts List	Pages 18-19

### **CRAFTSMAN ONE YEAR LIMITED WARRANTY**

FOR ONE YEAR from the date of purchase, this product is warranted against any defects in material or workmanship. With proof of purchase, defective product will be replaced free of charge.

**For warranty coverage, details to obtain free replacement, visit the web site: [www.craftsman.com/warranty](http://www.craftsman.com/warranty)**

This ONE YEAR warranty is void if this product is ever used while providing commercial services or if rented to another person. For 90 DAY commercial and rental use terms, see the Craftsman warranty web page.

This warranty gives you specific legal rights, and you may also have other rights which vary from state to state.

Sears Brands Management Corporation, Hoffman Estates, IL 60179

This auto-hammer has many features for making its use more pleasant and enjoyable. Safety, performance, and dependability have been given top priority in the design of this product making it easy to maintain and operate.

**SAVE THESE INSTRUCTIONS!**

**READ ALL INSTRUCTIONS!**

**⚠ DANGER:** People with electronic devices, such as pacemakers, should consult their physician(s) before using this product. Operation of electrical equipment in close proximity to a heart pacemaker could cause interference or failure of the pacemaker.

**⚠ WARNING:** Some dust created by power sanding, sawing, grinding, drilling and other construction activities contains chemicals known to the state of California to cause cancer, birth defects or other reproductive harm. Some examples of these chemicals are:

- Lead from lead-based paints
- Crystalline silica from bricks and cement and other masonry products, and
- Arsenic and chromium from chemically-treated lumber.

Your risk from these exposures varies, depending on how often you do this type of work. To reduce your exposure to these chemical: work in a well ventilated area, and work with approved safety equipment, such as those dust masks that are specially designed to filter out microscopic particles.

## SAFETY SYMBOLS

The purpose of safety symbols is to attract your attention to possible dangers. The safety symbols and the explanations with them deserve your careful attention and understanding. The symbol warnings do not, by themselves, eliminate any danger. The instructions and warnings they give are no substitutes for proper accident prevention measures.

**⚠ WARNING:** Be sure to read and understand all safety instructions in this manual, including all safety alert symbols such as “**DANGER**,” “**WARNING**,” and “**CAUTION**” before using this tool. Failure to follow all instructions listed in this manual may result in electric shock, fire and/or serious personal injury.

### SYMBOL SIGNAL MEANING

**SAFETY ALERT SYMBOL:** Indicates **DANGER**, **WARNING**, or **CAUTION**; may be used in conjunction with other symbols or pictographs.

**⚠ DANGER:** Indicates a hazardous situation which, if not avoided, will result in death or serious injury.

**⚠ WARNING:** Indicates a hazardous situation which, if not avoided, could result in death or serious injury.

**⚠ CAUTION:** Indicates a hazardous situation which, if not avoided, could result in minor or moderate injury.

### Damage prevention and Information Messages

These inform the user of important information and/or instructions that could lead to equipment or other property damage if they are not followed. Each message is preceded by the word “NOTICE”, as in the example below:

**NOTICE:** Equipment and/or property damage may result if these instructions are not followed.



**⚠ WARNING:** To ensure safety and reliability, all repairs should be performed by a qualified service technician.



**⚠ WARNING:** The operation of any power tools can result in foreign objects being thrown into your eyes, which can result in severe eye damage. Before beginning power tool operation, always wear safety goggles or safety glasses with side shield and a full face shield when needed. We recommend a Wide Vision Safety Mask for use over eyeglasses or standard safety glasses with side shields. Always use eye protection which is marked to comply with ANSI Z87.1.

## SAVE THESE INSTRUCTIONS

Some of these following symbols may be used on this tool. Please study them and learn their meaning. Proper interpretation of these symbols will allow you to operate the tool better and more safely.

SYMBOL	NAME	DESIGNATION/EXPLANATION
V	Volts	Voltage
A	Amperes	Current
Hz	Hertz	Frequency (cycles per second)
W	Watt	Power
min	Minutes	Time
~	Alternating Current	Type of current
≡	Direct Current	Type or a characteristic of current
$n_0$	No-load Speed	Rotational speed, at no load
	Class II Construction	Double-insulated construction
.../min	Per Minute	Revolutions, strokes, surface speed, orbits, etc., per minute
	Wet Conditions Alert	Do not expose to rain or use in damp locations.
	Read The Operator's Manual	To reduce the risk of injury, user must read and understand operator's manual before using this product.
	Eye Protection	Always wear safety goggles or safety glasses with side shields and a full face shield when operating this product.
	Safety Alert	Precautions that involve your safety.
	No-Hands Symbol	Failure to keep your hands away from the blade will result in serious personal injury.
	No-Hands Symbol	Failure to keep your hands away from the blade will result in serious personal injury.
	No-Hands Symbol	Failure to keep your hands away from the blade will result in serious personal injury.
	No-Hands Symbol	Failure to keep your hands away from the blade will result in serious personal injury.
	Hot Surface	To reduce the risk of injury or damage, avoid contact with any hot surface.

# SAFETY INSTRUCTIONS

## GENERAL POWER TOOL SAFETY WARNINGS

**⚠ WARNING:** Read all safety warnings and instructions. Failure to follow the warnings and instructions may result in electric shock, fire and/or serious injury.

**Save all warnings and instructions for future reference.**

The term “power tool” in the warnings refers to your mains-operated (corded) power tool or battery-operated (cordless) power tool.

## WORK AREA SAFETY

- **Keep work area clean and well lit.** Cluttered or dark areas invite accidents.
- **Do not operate power tools in explosive atmospheres, such as in the presence of flammable liquids, gases or dust.** Power tools create sparks which may ignite the dust or fumes.
- **Keep children and bystanders away while operating a power tool.** Distractions can cause you to lose control.

## ELECTRICAL SAFETY

- **Power tool plugs must match the outlet. Never modify the plug in any way. Do not use any adaptor plugs with earthed (grounded) power tools.** Unmodified plugs and matching outlets will reduce risk of electric shock.
- **Avoid body contact with earthed or grounded surfaces such as pipes, radiators, ranges and refrigerators.** There is an increased risk of electric shock if your body is earthed or grounded.
- **Do not expose power tools to rain or wet conditions.** Water entering a power tool will increase the risk of electric shock.
- **Do not abuse the cord. Never use the cord for carrying, pulling or unplugging the power tool. Keep cord away from heat, oil, sharp edges or moving parts.** Damaged or entangled cords increase the risk of electric shock.
- **When operating a power tool outdoors, use an extension cord suitable for outdoor use.** Use of a cord suitable for outdoor use reduces the risk of electric shock.
- **If operating a power tool in a damp location is unavoidable, use a ground fault circuit interrupter (GFCI) protected supply.** Use of a GFCI reduces the risk of electric shock.

## PERSONAL SAFETY

- **Stay alert, watch what you are doing and use common sense when operating a power tool. Do not use tool while tired or under the influence of drugs, alcohol, or medication.** A moment of inattention while operating power tools may result in serious personal injury.
- **Use personal protective equipment. Always wear eye protection.** Protective equipment such as dust mask, non-skid safety shoes, hard hat, or hearing protection used for appropriate conditions will reduce personal injuries.
- **Prevent unintentional starting. Ensure the switch is in the off-position before connecting to power source and/or battery pack, picking up or carrying the tool.** Carrying power tools with your finger on the switch or energizing in power tools that have the switch on invites accidents.
- **Remove any adjusting key or wrench before turning the power tool on.** A wrench or a key left attached to a rotating part of the power tool may result in personal injury.
- **Do not overreach. Keep proper footing and balance at all times.** This enables better control of the power tool in unexpected situations.
- **Dress properly. Do not wear loose clothing or jewelry. Keep your hair, clothing and gloves away from moving parts.** Loose clothes, jewelry or long hair can be caught in moving parts.
- **If devices are provided for the connection of dust extraction and collection facilities, ensure these are connected and properly used.** Use of these devices can reduce dust-related hazards.

## POWER TOOL USE AND CARE

- **Do not force the power tool. Use the correct power tool for your application.** The correct power tool will do the job better and safer at the rate for which it was designed.
- **Do not use the power tool if the switch does not turn it on and off.** Any power tool that cannot be controlled with the switch is dangerous and must be repaired.
- **Disconnect the plug from the power source and/or the battery pack from the power tool before making any adjustments, changing accessories, or storing power tools.** Such preventive safety measures reduce the risk of starting the power tool accidentally.
- **Store idle power tools out of the reach of children and do not allow persons unfamiliar with the power tool or these instructions to operate the power tool.** Power tools are dangerous in the hands of untrained users.

- **Maintain power tools. Check for misalignment or binding of moving parts, breakage of parts and any other condition that may affect the power tool's operation. If damaged, have the power tool repaired before use.** Many accidents are caused by poorly maintained power tools.
- **Keep cutting tools sharp and clean.** Properly maintained cutting tools with sharp cutting edges are less likely to bind and are easier to control.
- **Use the power tool, accessories and tool bits etc., in accordance with these instructions, taking into account the working conditions and the work to be performed.** Use of the power tool for operations different from those intended could result in a hazardous situation.

## BATTERY TOOL USE AND CARE

- **Recharge only with the charger specified by the manufacturer.** A charger that is suitable for one type of battery pack may create a risk of fire when used with another battery pack.
- **Use power tools only with specifically designated battery packs.** Use of any other battery packs may create a risk of injury and fire.
- **When battery pack is not in use, keep it away from other metal objects, like paper clips, coins, keys, nails, screws or other small metal objects that can make a connection from one terminal to another.** Shorting the battery terminals together may cause burns or a fire.
- **Under abusive conditions, liquid may be ejected from the battery; avoid contact. If contact accidentally occurs, flush with water. If liquid contacts eyes, additionally seek medical help.** Liquid ejected from the battery may cause irritation or burns.

## SERVICE

- **Have your power tool serviced by a qualified repair person using only identical replacement parts.** This will ensure that the safety of the power tool is maintained.
- **Follow instructions in the Maintenance section of this manual.** Use of unauthorized parts or failure to follow Maintenance instructions may create a risk of shock or injury.

## SPECIFIC SAFETY RULES FOR AUTO-HAMMER

- **Hold power tools by insulated gripping surfaces when performing an operation where the tool may contact hidden wiring or its own cord.** Contact with a “live” wire will also make exposed metal parts of the tool “live” and shock the operator.
- **Use auxiliary handle(s), if supplied with the tool.** Loss of control can cause personal injury.



- **Do not insert or try to insert your finger into the hammer sleeve at anytime**, failure to do so could result in personal injury. Your finger may get hurt.
- **Do not stare into the LED** worklight directly; never project the worklight to others' eyes.
- **Never put your hand continuously on the nail when hammering.** Only use your hand to hold the nail on the workpiece at the beginning of hammering.
- **This auto-hammer** is to be used for the nails with nail head diameter less than 7/16 in. and length less than 3-1/2 in.
- **Use clamps or another practical way to secure and support the workpiece to a stable platform before hammering.** Holding the work by hand against your body leaves it unstable and may lead to loss of control.

 **WARNING:** Wear ear protection. Exposure to noise can cause hearing loss.

 **WARNING:** To reduce the risk of injury, user must read instruction manual.

## DESCRIPTION

### KNOW YOUR AUTO-HAMMER (Fig. 1)

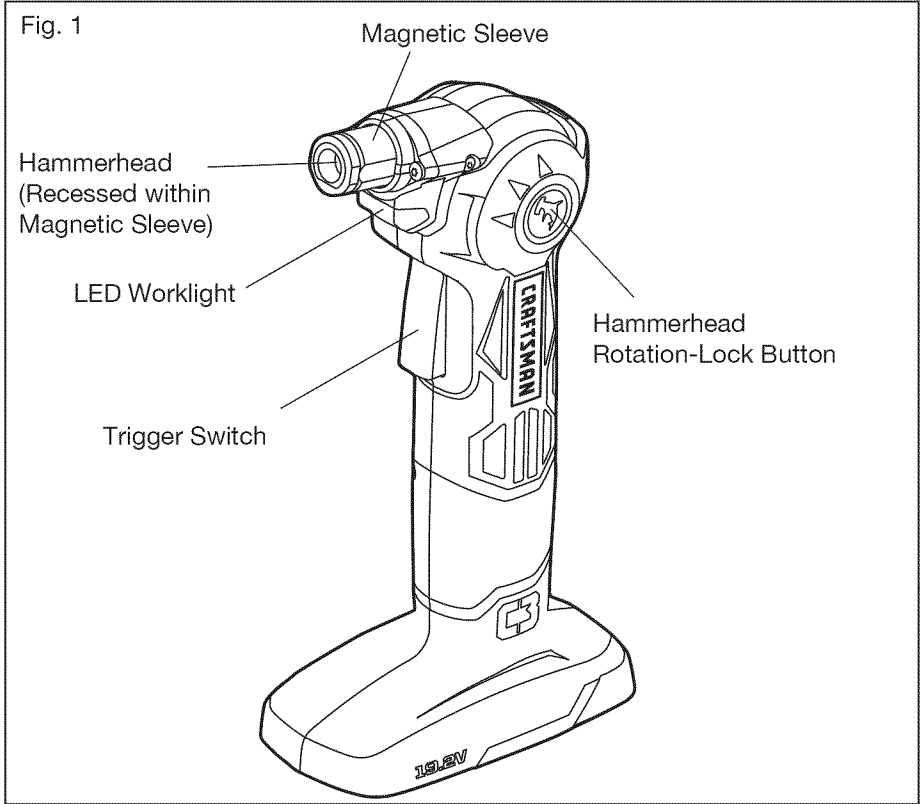

#### PRODUCT SEPCIFICATIONS

Motor	19.2 Volt DC
Clamp	7/16 in.
Hammerhead Adjustment Angles	0°, 45° and 80°

**⚠ WARNING:** The safe use of this product requires an understanding of the information on the tool and in this operator's manual, as well as knowledge of the project you are attempting. Before using this product, familiarize yourself with all operating features and safety rules.

## HAMMERHEAD

The hammerhead impacts the nails automatically when the tool is turned on and the impact mechanism is pressed onto a nail.

## HAMMERHEAD ARTICULATION ADJUSTMENT

The hammerhead rotation-lock button allows you to set the head at 0°, 45° and 80°, as shown in Fig. 5.

## MAGNETIC SLEEVE (Fig. 2)

The magnetic sleeve holds the head of the inserted nail against the recessed shaft at the start of nail driving. The sleeve retracts at the end of nail driving to allow the hammerhead to drive the nail head flush to the workpiece.

## LED WORKLIGHT

The LED worklight, located on the front of the hammer, illuminates when the trigger switch is depressed. This feature provides extra light for increased visibility.

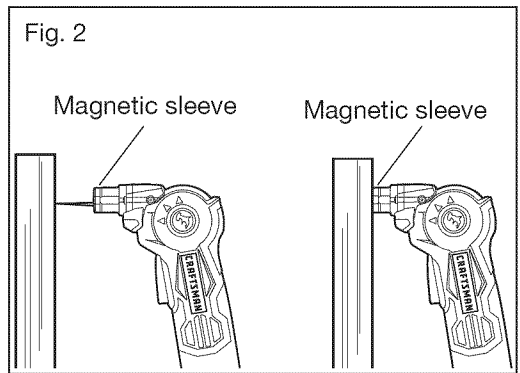

## ASSEMBLY

**⚠ WARNING:** If any parts are broken or missing, do not attempt to attach the battery pack (available separately) or operate the auto-hammer until the broken or missing parts are replaced. Failure to do so could result in possible serious injury.

**⚠ WARNING:** Do not attempt to modify this auto-hammer or create accessories not recommended for use with this hammer. Any such alteration or modification is misuse and could result in a hazardous condition leading to possible serious injury.

**⚠ WARNING:** To prevent accidental starting that could cause serious personal injury, always remove the battery pack from the auto-hammer when the hammer is not in use.

### UNPACKING

This product has been shipped completely assembled.

- Carefully remove the tool from the carton. Make sure that all items listed in the packing list are included.
- Inspect the tool carefully to make sure no breakage or damage occurred during shipping.
- Do not discard the packing material until you have carefully inspected and satisfactorily operated the tool.
- If any parts are damaged or missing, please return the tool to the place of purchase.

### PACKING LIST

Auto-hammer and operator's manual.

## OPERATION

**CAUTION:** To avoid the possibility of accidental starting, always take care not to activate the trigger switch when you are attaching or detaching the battery pack .

### TO ATTACH BATTERY PACK (Fig. 3)

1. Align the raised rib on the battery pack with the groove inside the auto-hammer, and then insert the battery pack into the auto-hammer.
2. Make sure that the latch on the battery pack snaps into place and that the battery pack is secured to the auto-hammer before operation.

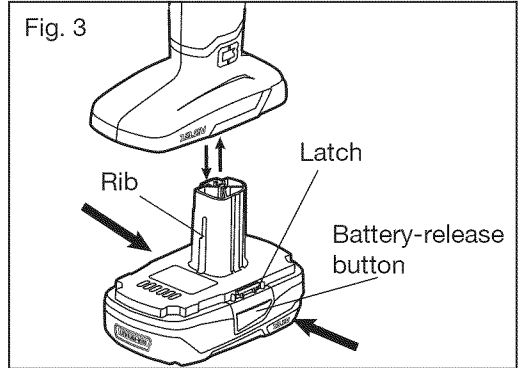

**CAUTION:** When placing the battery pack in the auto-hammer, be sure that the raised rib on the battery pack aligns with the groove in the auto-hammer and that the battery snaps into place properly. Improper assembly of the battery pack can cause damage to internal components.

### TO DETACH BATTERY PACK (Fig. 3)

1. Depress both battery-release buttons located on the sides of the battery pack to release the battery pack.
2. Pull the battery pack out and remove it from the tool.

### TRIGGER SWITCH (Fig.4)

To turn the hammer on, depress the trigger switch. To turn it off, release the trigger switch.

### LED WORKLIGHT (Fig. 4)

The LED worklight, located on the front of the auto-hammer, will turn on when the trigger switch is depressed. The LED worklight will turn off when the trigger switch is released. This provides additional lighting on the surface of the workpiece for operation in lower-light areas.

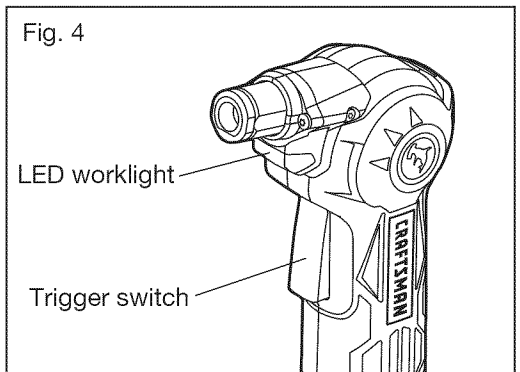

## ELECTRIC BRAKE

To stop the auto-hammer, release the trigger switch and allow the tool to come to a complete stop. The electric brake will engage automatically when you release the trigger switch.

## HAMMERHEAD ARTICULATION (Fig. 5)

The hammerhead rotation-lock button allows you to set the head at 0°, 45° and 80°.

Depress the hammerhead rotation-lock button to release the hammerhead. Tilt the head at the appropriate angle for your operation, and then release the lock button. You will hear a “click” to indicate that the hammerhead is locked in place.

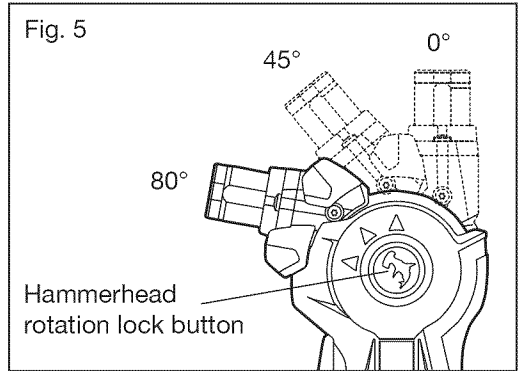

## HAMMERING NAILS

1. Attach the battery pack to the auto-hammer.
  2. Secure the material to be nailed with clamps to keep it from turning when hammering.
  3. Adjust the hammerhead to the appropriate angle for your job.
- For hammering nails on the walls or doors or other vertical surfaces, set your hammerhead at 80° (Fig. 6).
  - For hammering nails on the floor or ceiling, set your hammerhead at 0° as shown in Fig. 6a.

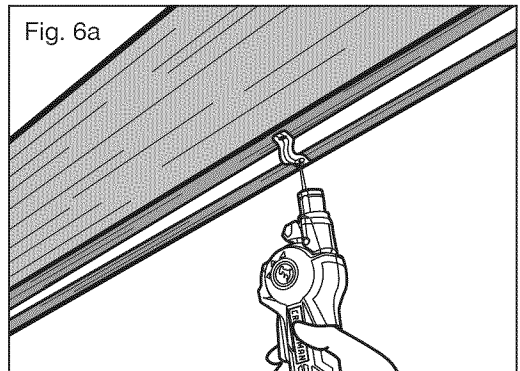
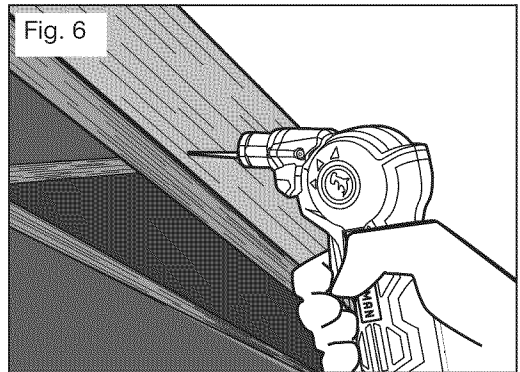

- For hammering nails on an angle or in tight places, set your hammerhead at 45° (Fig. 6b).
4. Insert the head of the nail into the magnetic sleeve and up against the hammerhead, where it will be held in place by the magnet. Place the tip of the nail against the workpiece.

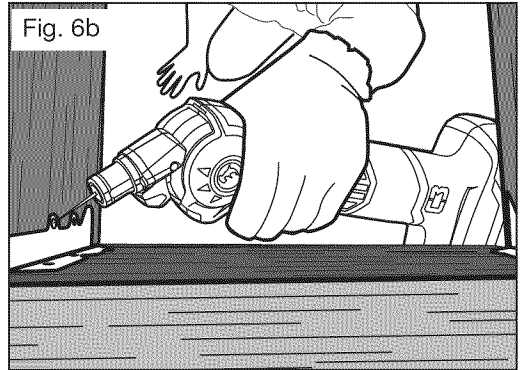

**⚠ WARNING:** Before depressing the trigger switch to start hammering, make sure that the rotational head of the auto-hammer is locked in place. Otherwise, the hammerhead could move, causing serious personal injury.

5. Holding the shaft of the nail steady with your hand, push down on the tool and press the trigger switch to initiate the hammering action; drive the nail far enough into the workpiece so that it stands on its own. Release the trigger switch and remove your hand from the nail.

**⚠ CAUTION:** Be especially careful when driving shorter nails, such as brads, that you remove your hand as soon as the nail stands on its own in the workpiece.

6. Resume pushing down on tool and pressing the trigger switch to continue hammering until the nail is fully driven into the workpiece. Near the end of hammering, the magnetic sleeve will retract to allow the hammerhead to drive the nail head flush to the workpiece.

**⚠ WARNING:** To avoid possibly serious injury, do not apply excessive force to the auto-hammer or apply side pressure. Hold the tool firmly while pushing steadily to allow the hammerhead to drive the nail automatically.

### **Recommended Nails for Use with the Auto-Hammer with Adjustable Head**

The auto-hammer is versatile for use with a variety of nails. Nails with diameters less than 7/16 in. and length equal to or less than 3-1/2 in. are recommended for use with this auto-hammer.

Refer to the table below.

No	Nail Type	Size	Shank Diameter	Head Diameter	Length
1	Bright Common	4d	0.1"	1/4"	1-1/2 in.
2	Bright Finish	6d	0.091"	9/64"	2 in.
3	Bright Finish	4d	0.072"	7/64"	1-1/2 in.
4	Coated Sinker	4d	0.08"	13/64"	1-3/8 in.
5	Electro Galvanized Roofing	4d	0.12"	1/4"	1-1/2 in.
6	Framing nails	10d	0.115"	3/8"	3 in.
7	Tempered Hard Trim	6d	0.07"	9/64"	2 in.
8	Framing nails	16d	0.1495"	5/16"	3-1/2 in.

### **Recommended Nailing Materials for the Auto-Hammer**

The auto-hammer may be used for nailing into all types of woods, wood-like materials, and plaster board.

**NOTICE:** The tool is not suitable for nailing in hard metal or concrete.



## MAINTENANCE

**⚠ WARNING:** To avoid serious personal injury, always remove the battery pack from the tool when cleaning or performing any maintenance.

**⚠ WARNING:** Always wear safety goggles or safety glasses with side shields when using compressed air to clean the tool. If the operation is dusty, also wear a dust mask.

### GENERAL MAINTENANCE

Avoid using solvents when cleaning plastic parts. Most plastics are susceptible to damage from various types of commercial solvents and may be damaged by their use. Use clean clothes to remove dirt, dust, oil, grease, etc.

**⚠ WARNING:** Do not at any time let brake fluids, gasoline, petroleum-based products, penetrating oils, etc. come in contact with plastic parts. Chemicals can damage, weaken or destroy plastic which may result in serious personal injury.

**⚠ WARNING:** When servicing, use only identical Craftsman replacement parts. Use of any other parts may create a hazard or cause product damage. To ensure safety and reliability, all repairs should be performed by a qualified service technician.

## TROUBLESHOOTING

PROBLEM	CAUSE	SOLUTION
The auto-hammer does not work	1. Battery is depleted	1. Charge the battery
	2. The auto-hammer is too hot after continuous usage	2. Allow the auto-hammer to cool
	3. Battery is too hot after continuous usage	3. Allow battery to cool or replace with a cool battery

## PART LIST

### AUTO-HAMMER WITH ADJUSTABLE HEAD MODEL NO. 320.38600

The Model Number will be found on the nameplate attached to the handle of the tool. Always mention the Model Number when ordering parts for this tool.

To order parts, call 1-800-469-4663.

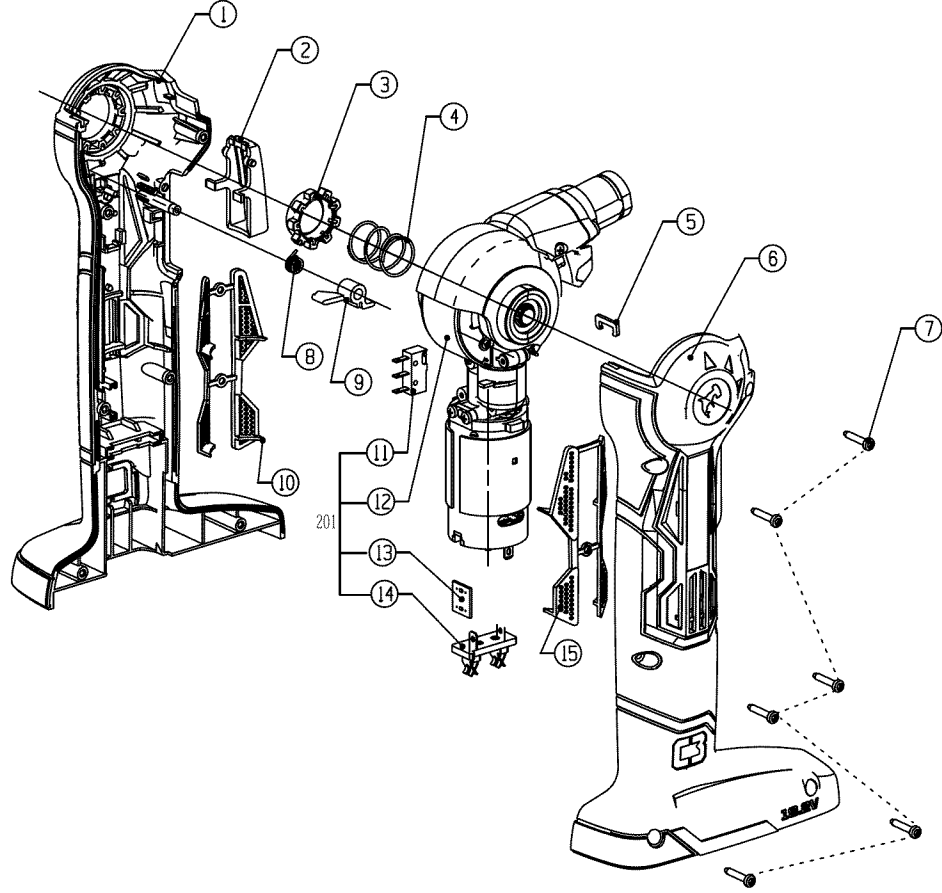

## PART LIST

### AUTO-HAMMER WITH ADJUSTABLE HEAD MODEL NO. 320.38600

The Model Number will be found on the nameplate attached to the handle of the tool. Always mention the Model Number when ordering parts for this tool.

To order parts, call 1-800-469-4663.

No	Part No	Part Name	Quantity
1	2823699000	Left Housing Assembly	1
2	3125764000	Switch Trigger	1
3	3321588000	Lock Button	1
4	3660497000	Compression Spring	1
5	3705046000	Handle Hoop	1
6	2823700000	Right Housing Assembly	1
7	5610241000	Screw	6
8	3660487000	Torsion Spring	1
9	3125765000	Push Button	1
10	3127165000	Left Mesh	1
201	2823698000	Motor Assembly (comprises parts No. 11-14)	1
11	4870064000	Switch	1
12	2790340000	Motor and Gear Case Assembly	1
13	2830011000	Electric Assembly	1
14	2820186000	Contact Receptacle Assembly	1
15	3127166000	Right Mesh	1

