



ELECTRIC OR GAS DRYER USE AND CARE GUIDE

SECHE-LINGE ELECTRIQUE OU A GAZ GUIDE D'UTILISATION ET D'ENTRETIEN

SECADORA A GAS O ELÉCTRICA MANUAL DE USO Y CUIDADO

Table of Contents

DRYER SAFETY	2	CYCLE GUIDE	6
SPECIFICATIONS.....	3	USING YOUR DRYER	7
CHECK YOUR VENT SYSTEM FOR GOOD AIR FLOW	4	DRYER CARE.....	9
CONTROL PANEL & FEATURES.....	5	TROUBLESHOOTING	11

Table des matières

SECURITE DU SECHE-LINGE	14	GUIDE DE PROGRAMMES	18
SPÉCIFICATIONS.....	15	UTILISATION DU SECHE-LINGE	19
VERIFICATION D'UNE CIRCULATION D'AIR ADEQUATE POUR LE SYSTEME D'EVACUATION.....	16	ENTRETIEN DU SECHE-LINGE	21
TABLEAU DE COMMANDE ET CARACTERISTIQUES.....	17	DEPANNAGE	23

Índice

SEGURIDAD DE LA SECADORA	25	GUÍA DE CICLOS	29
ESPECIFICACIONES	26	USO DE SU SECADORA	30
REVISE QUE EL SISTEMA DE VENTILACIÓN TENGA UN BUEN FLUJO DE AIRE.....	27	CUIDADO DE LA SECADORA.....	32
PANEL DE CONTROL Y CARACTERÍSTICAS	28	SOLUCIÓN DE PROBLEMAS.....	34

DRYER SAFETY

Your safety and the safety of others are very important.

We have provided many important safety messages in this manual and on your appliance. Always read and obey all safety messages.



This is the safety alert symbol.

This symbol alerts you to potential hazards that can kill or hurt you and others.

All safety messages will follow the safety alert symbol and either the word "DANGER" or "WARNING."

These words mean:

⚠ DANGER

You can be killed or seriously injured if you don't immediately follow instructions.

⚠ WARNING

You can be killed or seriously injured if you don't follow instructions.

All safety messages will tell you what the potential hazard is, tell you how to reduce the chance of injury, and tell you what can happen if the instructions are not followed.



WARNING - "Risk of Fire"

- Clothes dryer installation must be performed by a qualified installer.
- Install the clothes dryer according to the manufacturer's instructions and local codes.
- Do not install a clothes dryer with flexible plastic venting materials or flexible metal (foil type) duct. If flexible metal duct is installed, it must be of a specific type identified by the appliance manufacturer as suitable for use with clothes dryers. Flexible venting materials are known to collapse, be easily crushed, and trap lint. These conditions will obstruct clothes dryer airflow and increase the risk of fire.
- To reduce the risk of severe injury or death, follow all installation instructions.
- Save these instructions.

WARNING: Gas leaks cannot always be detected by smell.

Gas suppliers recommend that you use a gas detector approved by UL or CSA.

For more information, contact your gas supplier.

If a gas leak is detected, follow the "What to do if you smell gas" instructions.

FOR YOUR SAFETY

1. Do not use or store gasoline or other flammable materials in this appliance or near this appliance.
2. Do not spray aerosols in the vicinity of this appliance while it is in operation.
3. Do not modify this appliance.

IMPORTANT SAFETY INSTRUCTIONS

WARNING: To reduce the risk of fire, electric shock, or injury to persons when using the dryer, follow basic precautions, including the following:

- Read all instructions before using the dryer.
- Do not place items exposed to cooking oils in your dryer. Items contaminated with cooking oils may contribute to a chemical reaction that could cause a load to catch fire.
- Do not dry articles that have been previously cleaned in, washed in, soaked in, or spotted with gasoline, dry-cleaning solvents, or other flammable or explosive substances as they give off vapors that could ignite or explode.
- Do not allow children to play on or in the dryer. Close supervision of children is necessary when the dryer is used near children.
- Before the dryer is removed from service or discarded, remove the door to the drying compartment.
- Do not reach into the dryer if the drum is moving.
- Do not install or store the dryer where it will be exposed to the weather.
- Do not tamper with controls.
- Do not repair or replace any part of the dryer or attempt any servicing unless specifically recommended in this Use and Care Guide or in published user-repair instructions that you understand and have the skills to carry out.
- Do not use fabric softeners or products to eliminate static unless recommended by the manufacturer of the fabric softener or product.
- Do not use heat to dry articles containing foam rubber or similarly textured rubber-like materials.
- Clean lint screen before or after each load.
- Keep area around the exhaust opening and adjacent surrounding areas free from the accumulation of lint, dust, and dirt.
- The interior of the dryer and exhaust vent should be cleaned periodically by qualified service personnel.
- See "Electrical Requirements" located in the installation instructions for grounding instructions.

SAVE THESE INSTRUCTIONS

WARNING: For your safety, the information in this manual must be followed to minimize the risk of fire or explosion, or to prevent property damage, personal injury, or death.

- Do not store or use gasoline or other flammable vapors and liquids in the vicinity of this or any other appliance.
- **WHAT TO DO IF YOU SMELL GAS:**
 - Do not try to light any appliance.
 - Do not touch any electrical switch; do not use any phone in your building.
 - Clear the room, building, or area of all occupants.
 - Immediately call your gas supplier from a neighbor's phone. Follow the gas supplier's instructions.
 - If you cannot reach your gas supplier, call the fire department.
- Installation and service must be performed by a qualified installer, service agency, or the gas supplier.

SPECIFICATIONS

These units are sold in multiple regions with different requirements for measuring capacity. Below are a few of the valid forms of measure posted on this product:

Dry Linen Capacity: A weight measure that reflects a maximum load size that can be loaded into the dryer.

UL Capacity: The capacity measure that represents the capacity at which safety testing was completed.

Dry Linen Capacity
10,5 kg (23 lb)
UL Capacity
9,97 kg (22 lb)

CHECK YOUR VENT SYSTEM FOR GOOD AIR FLOW

⚠ WARNING



Fire Hazard

Use a heavy metal vent.

Do not use a plastic vent.

Do not use a metal foil vent.

Failure to follow these instructions can result in death or fire.

Good air flow

Along with heat, dryers require good air flow to efficiently dry laundry. Proper venting will reduce your drying times and improve your energy savings. See Installation Instructions.

The venting system attached to the dryer plays a big role in good air flow.

Service calls caused by improper venting are not covered by the warranty and will be paid by the customer, regardless of who installed the dryer.

Maintain good air flow by:

- Cleaning your lint screen before each load.
- Replace plastic or foil vent material with 102 mm (4") diameter heavy, rigid vent material.

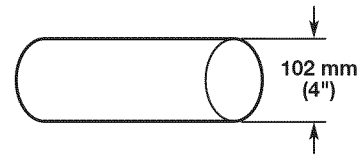

- Use the shortest length of vent possible.
- Use no more than four 90° elbows in a vent system; each bend and curve reduces air flow.

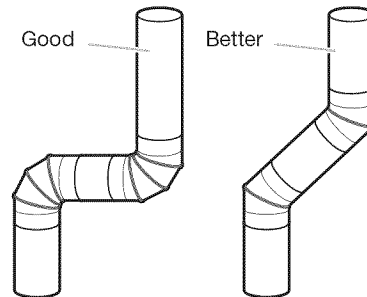

- Remove lint and debris from the exhaust hood.
- Remove lint from the entire length of the vent system at least every 2 years. When cleaning is complete, be sure to follow the Installation Instructions supplied with your dryer for final product check.
- Clear away items from the front the dryer.

Use Sensor Cycles for better fabric care and energy savings

Use the Sensor Cycles to provide the most energy savings and enhanced fabric care from the dryer. During Sensor Cycles, drying air temperature and moisture level are sensed in the load. This sensing occurs throughout the drying cycle and the dryer shuts off when the load reaches the selected dryness.

With Timed Dry, the dryer runs the amount of time set and sometimes results in shrinkage, wrinkling, and static due to over-drying. Use Timed Dry for the occasional damp load that needs a little more drying time or when using the drying rack.

CONTROL PANEL & FEATURES

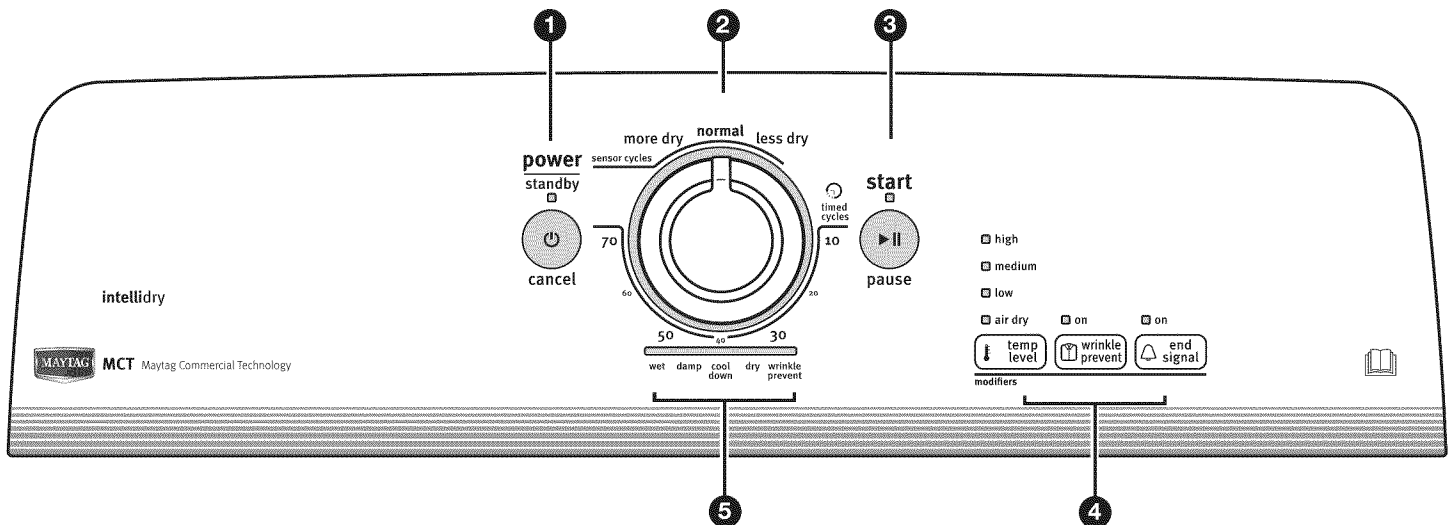

Not all features and options are available on all models.
Appearance may vary.

1 POWER/STANDBY/CANCEL BUTTON

Press to turn the dryer on and off.

2 DRYER CYCLE KNOB

Use your Dry Cycle Knob to select available cycles on your dryer. Turn the knob to select a cycle for your laundry load. See “Cycle Guide” for detailed descriptions of cycles.

3 START/PAUSE BUTTON

Press to start a cycle, or press once while a cycle is in process to pause it.

4 MODIFIERS

TEMP LEVEL

Select a drying temperature based on the fabrics in your load. If you are unsure of the temperature to select for a load, select the lower setting rather than the higher setting.

NOTE: The Air Dry Temp Feature is not available on the Sensor Cycles.

WRINKLE PREVENT

When you are unable to remove a load of clothes from the dryer as soon as it stops, wrinkles can form. The WRINKLE PREVENT feature periodically tumbles, rearranges, and fluffs the load to help keep wrinkles from forming.

- Get up to 60 or 150 minutes for models with two choices, 90 minutes for models with only one choice of heat-free, periodic tumbling at the end of a cycle. Press the WRINKLE PREVENT button to turn ON or OFF at any time before the cycle has ended.

END SIGNAL

The End Signal produces an audible sound when the drying cycle is finished. Promptly removing clothes at the end of the cycle reduces wrinkling.

Press END SIGNAL until the desired volume (High or Low) is selected.

NOTE: When the Wrinkle Prevent setting is selected and the End Signal is on, the tone will sound every 20 minutes until the clothes are removed, or the Wrinkle Prevent setting ends.

5 CYCLE STATUS LIGHTS

Lights indicate the progress of the drying cycles.

wet damp cool dry wrinkle
down prevent

WET

The load is still wet and/or the cycle just started.

DAMP

This indicator shows that the load is partially dried and items that you may wish to hang up or iron while still damp may removed.

COOL DOWN

The dryer has finished drying with heat, and is now tumbling the load without heat to cool it down and reduce wrinkling.

DRY

This will indicate that the selected cycle has ended and the load may be removed from the dryer. If the Wrinkle Prevent option has been selected, the dryer may continue to tumble the load, even if the Dry indicator is lit.

WRINKLE PREVENT

This indicator will light if the Wrinkle Prevent option has been selected and is running. Get up to 60 or 150 minutes for models with two choices, 90 minutes for models with only one choice of heat-free, periodic tumbling at the end of a cycle.

CYCLE GUIDE — SENSOR DRY CYCLES

Not all cycles and settings are available on all models. Settings and options shown in **bold** are default settings for that cycle.

SENSOR DRY CYCLE - Senses moisture in the load or air temperature and shuts off when the load reaches the selected dryness level. Gives the best drying in the shortest time. Drying time varies based on fabric type, load size, and dryness setting.

Depending on model, temperature may be selected on cycle knob or be a separate control.

Items to dry:	Cycle:	Drying Temperature:	Available Modifiers:	Cycle Details:
Jeans, heavy work clothes, towels	More Dry	High	Temp Level Wrinkle Prevent	Gives the best drying in the shortest time. Drying time varies based on fabric type, load size, and dryness setting. Select a drying temperature based on the fabrics in your load. If you are unsure of the temperature to select for a load, select the lower setting rather than the higher setting.
Work clothes, medium weight fabrics, sheets	Normal	Medium		
Casual, shirts, pants, lightweight items	Less Dry	Low		

NOTE: If loads do not seem as dry as you would like, select More Dry next time you dry a similar load. If loads seem drier than you like, select Less Dry next time you dry a similar load.

CYCLE GUIDE — TIMED DRY CYCLES

Not all cycles and settings are available on all models. Settings and options shown in **bold** are default settings for that cycle.

TIMED DRY - Will run the dryer for the specified time on the control. Depending on model, temperature may be selected on cycle knob or be a separate control.

Items to dry:	Cycle:	Drying Temperature:	Available Modifiers:	Cycle Details:
Any load	Timed Dry	Any	Temp Level Wrinkle Prevent	Dries items to a damp level for items that do not require an entire drying cycle. Select a drying temperature based on the fabrics in your load. If you are unsure of the temperature to select for a load, select the lower setting rather than the higher setting.
Rubber, plastic, heat sensitive fabrics	Timed Dry	Air Dry	Temp Level Wrinkle Prevent	Use a no heat (air dry) setting for foam, rubber, plastic, or heat-sensitive fabrics.

COOL DOWN – This step is added to any cycle that uses heat. The load is cooled slowly to reduce wrinkling and make it easier to handle.

Setting the Drying Temperature

If your dryer has multiple heat settings:

- A High heat setting may be used for drying heavyweight items such as towels and work clothes.
- A Low to Medium heat setting may be used for drying medium-weight items such as sheets, blouses, dresses, underwear, permanent press fabrics, and some knits.

- Use an Air Dry (no heat) setting for foam, rubber, plastic, or heat-sensitive fabrics.
- Line dry bonded or laminated fabrics.

NOTE: If you have questions about drying temperatures for various loads, refer to the care label directions.

USING YOUR DRYER

⚠ WARNING



Explosion Hazard

Keep flammable materials and vapors, such as gasoline, away from dryer.

Do not dry anything that has ever had anything flammable on it (even after washing).

Failure to follow these instructions can result in death, explosion, or fire.

⚠ WARNING



Fire Hazard

No washer can completely remove oil.

Do not dry anything that has ever had any type of oil on it (including cooking oils).

Items containing foam, rubber, or plastic must be dried on a clothesline or by using an Air Cycle.

Failure to follow these instructions can result in death or fire.

1. Clean the lint screen

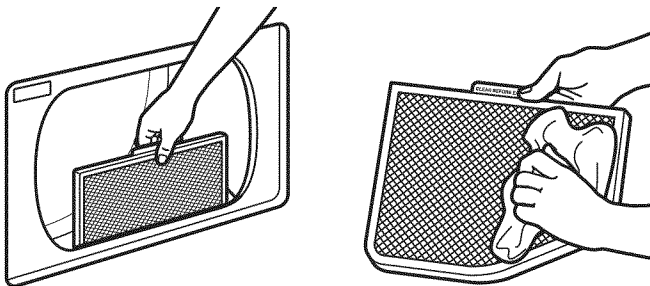

Clean the lint screen before each load. Pull the lint screen straight up. Roll lint off the screen with your fingers. Do not rinse or wash screen to remove lint. Push the lint screen firmly back into place.

For additional cleaning information, see "Dryer Care."

2. Load the dryer

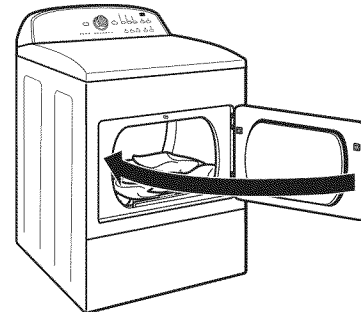

Place laundry in the dryer. Close the door. Do not overload the dryer; clothes should be able to tumble freely.

3. Press POWER/STANDBY/CANCEL

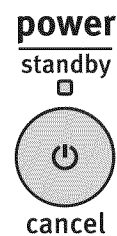

Press the POWER/STANDBY/CANCEL button to turn on the dryer.

4. Select the desired cycle

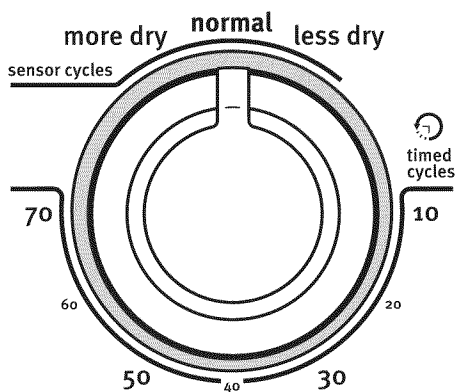

Select the desired cycle for your load. See the “Cycle Guide” or the display for more information about each cycle.

5. Select cycle modifiers

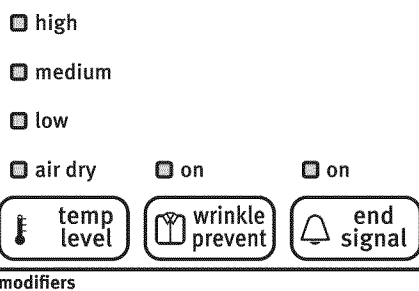

The default cycle settings will be shown. For some cycles, you may select alternate settings by pressing the button for that setting. Time adjusts for Timed Cycles only.

NOTE: Not all modifiers are available with all cycles.

6. Press START/PAUSE to begin cycle



Press the START/PAUSE button to begin the cycle.

7. Remove garments promptly after cycle is finished

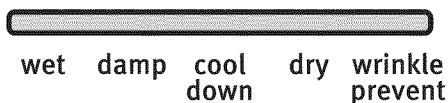

Promptly remove garments after cycle has completed to reduce wrinkling. Use the Wrinkle Prevent feature to avoid wrinkling when you are unable to remove a load from the dryer as soon as it stops.

DRYER CARE

Cleaning the dryer location

Keep dryer area clear and free from items that would block the air flow for proper dryer operation. This includes clearing piles of laundry in front of the dryer.

WARNING



Explosion Hazard

Keep flammable materials and vapors, such as gasoline, away from dryer.

Place dryer at least 460 mm (18 inches) above the floor for a garage installation.

Failure to do so can result in death, explosion, or fire.

Cleaning the dryer interior

To clean dryer drum

1. Apply a liquid, nonflammable household cleaner to the stained area of the drum and rub with a soft cloth until stain is removed.
2. Wipe drum thoroughly with a damp cloth.
3. Tumble a load of clean cloths or towels to dry the drum.

NOTE: Garments that contain loose dyes, such as denim blue jeans or brightly colored cotton items, may discolor the dryer interior. These stains are not harmful to your dryer and will not stain future loads of clothes. Dry these items inside out to avoid drum staining.

Removing accumulated lint

From Inside the Dryer Cabinet

Lint should be removed every 2 years, or more often, depending on dryer usage. Cleaning should be done by a qualified servicer.

From the Exhaust Vent

Lint should be removed every 2 years, or more often, depending on dryer usage.

Cleaning the lint screen

Every load cleaning

The lint screen is located in the door opening of the dryer. A screen blocked by lint can increase drying time.

To clean:

1. Pull the lint screen straight up. Roll lint off the screen with your fingers. Do not rinse or wash screen to remove lint.

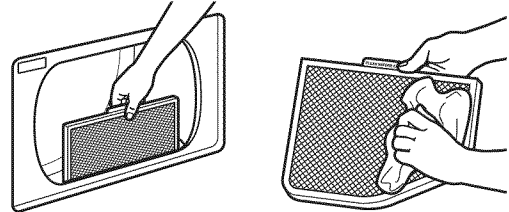

2. Push the lint screen firmly back into place.

IMPORTANT:

- Do not run the dryer with the lint screen loose, damaged, blocked, or missing. Doing so can cause overheating and damage to both the dryer and fabrics.
- If lint falls off the screen into the dryer during removal, check the exhaust hood and remove the lint. See "Venting Requirements."

As needed cleaning

Laundry detergent and fabric softener residue can build up on the lint screen. This buildup can cause longer drying times for your clothes, or cause the dryer to stop before your load is completely dry. The screen is probably clogged if lint falls off while the screen is in the dryer.

Clean the lint screen with a nylon brush every 6 months, or more frequently, if it becomes clogged due to a residue buildup.

To wash:

1. Roll lint off the screen with your fingers.
2. Wet both sides of lint screen with hot water.
3. Wet a nylon brush with hot water and liquid detergent. Scrub lint screen with the brush to remove residue buildup.

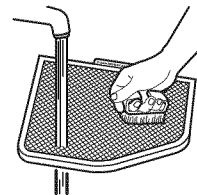

4. Rinse screen with hot water.
5. Thoroughly dry lint screen with a clean towel. Reinstall screen in dryer.

Vacation, storage, and moving care

Install and store your dryer where it will not freeze. Because some water may stay in the hoses, freezing can damage your dryer. If storing or moving your dryer during freezing weather, winterize it.

Non-Use or Storage Care

Operate your dryer only when you are at home. If you will be on vacation or not using your dryer for an extended period of time, you should:

1. Unplug dryer or disconnect power.
2. Clean lint screen. See "Cleaning the Lint Screen."

Moving Care

For power supply cord-connected dryers:

1. Unplug the power supply cord.
2. Steam models only: Shut off water faucet.
3. Steam models only: Disconnect the water inlet hose from faucet, then drain the hose. Remove the hose from the back of the dryer. Transport hose separately.
4. Make sure leveling legs are secure in dryer base.
5. Use tape to secure dryer door.

WARNING



Electrical Shock Hazard

Disconnect power before servicing.

Replace all parts and panels before operating.

Failure to do so can result in death or electrical shock.

For direct-wired dryers:

1. Turn off power at fuse or breaker box.
2. Disconnect wiring.
3. Steam models only: Shut off water faucet.
4. Steam models only: Disconnect the water inlet hose from faucet, then drain the hose. Transport hose separately.
5. Make sure leveling legs are secure in dryer base.
6. Use tape to secure dryer door.

Reinstalling the Dryer

Follow the "Installation Instructions" to locate, level, and connect the dryer.

Changing the Sensor Cycle settings to increase drying time

If all your loads on all Sensor cycles are consistently not as dry as you would like, you may change the default settings to increase the default dryness level.

Your sensor drying settings can be adjusted to adapt to different installations, environmental conditions, or personal preference. This change is retained and will affect all of your Sensor cycles, not just the current cycle/load. There are 3 drying settings, which are displayed using the "Status" lights (Wet, Damp, Cool Down)

- 1 Factory preset dryness level.
- 2 Slightly drier clothes, 15% more drying time.
- 3 Much drier clothes, 30% more drying time.

To change the drying settings:

NOTE: The settings cannot be changed while the dryer is running or paused. The dryer must be in standby mode (the power button is off) to adjust the default settings.

1. Before starting a cycle, press and hold the TEMP LEVEL button for 6 seconds.
2. Press the TEMP LEVEL button to select the dryness level shown in the LED display: Wet light on = level 1, Wet and Damp lights on = level 2, and Wet, Damp, and Cool Down lights on = level 3.
3. Press START/PAUSE to save the new dryness level setting.

TROUBLESHOOTING

First try the solutions suggested here to possibly avoid the cost of a service call.

If you experience	Possible Causes	Solution
Clothes are not drying satisfactorily, drying times are too long, or load is too hot	Lint screen clogged with lint.	Lint screen should be cleaned before each load.
	Has the Air Dry cycle been selected.	Select the right cycle for the types of garments being dried. See "Air Dry."
	Load too large and heavy to dry quickly.	Separate the load to tumble freely.
	Exhaust vent or outside exhaust hood clogged with lint, restricting air movement?	Run the dryer for 5-10 minutes. Hold your hand under the outside exhaust hood to check air movement. If you do not feel air movement, clean exhaust system of lint or replace exhaust vent with heavy metal or flexible metal vent. See the "Installation Instructions."
	Fabric softener sheets blocking the grille.	Use only one fabric softener sheet, and use it only once.
	Exhaust vent the incorrect length.	Check that the exhaust vent is not too long or has too many turns. Long venting will increase drying times. See the "Installation Instructions."
	Exhaust vent diameter the incorrect size.	Use 102 mm (4") diameter vent material.
	Dryer located in a room with temperature below 7°C (45°F).	Proper operation of dryer cycles requires temperatures above 7°C (45°F).
	Dryer located in a closet.	Closet doors must have ventilation openings at the top and bottom of the door. The front of the dryer requires a minimum of 25 mm (1") of airspace, and, for most installations, the rear of the dryer requires 127 mm (5"). See the "Installation Instructions."
Dryer will not run	Door not closed completely.	Make sure the dryer door is closed completely.
	START/PAUSE button not pressed firmly or held long enough.	Press and HOLD the START/PAUSE button until you hear the dryer drum moving.
	Household fuse is blown or circuit breaker has tripped.	Electric dryers use 2 household fuses or circuit breakers. The drum may be turning, but you may not have heat. Replace the fuse or reset the circuit breaker. If the problem continues, call an electrician.
	Incorrect power supply.	Electric dryers require 220-240 volt power supply. Check with a qualified electrician.
	Wrong type of fuse.	Make sure you have right fuse.
Unusual sounds	Dryer has not been used for an extended period of time.	If the dryer hasn't been used for awhile, there may be a thumping sound during the first few minutes of operation.
	A coin, button, or paper clip is caught between the drum and front or rear of the dryer.	Check the front and rear edges of the drum for small objects. Clean out pockets before laundering.
	Gas valve operating (gas dryers only).	The gas valve clicking is a normal operating sound.
	Are the four legs installed, and is the dryer level front to back and side to side?	The dryer may vibrate if not properly installed. See the "Installation Instructions."
	Clothing knotted or balled up.	When balled up, the load will bounce, causing the dryer to vibrate. Separate the load items and restart the dryer.
No heat	Household fuse is blown or circuit breaker has tripped.	The drum may be turning, but you may not have heat. Electric dryers use 2 household fuses or circuit breakers. Replace both fuses or reset the circuit breaker. If the problem continues, call an electrician.
	Supply line valve not open.	For gas dryers, is the valve open on the supply line.
	Incorrect power supply.	Electric dryers require 220-240 volt power supply. Check with a qualified electrician.

TROUBLESHOOTING

First try the solutions suggested here to possibly avoid the cost of a service call.

If you experience	Possible Causes	Solution
Cycle time too short	Sensor cycle ending early.	The load may not be contacting the sensor strips. Level the dryer.
		Use Timed Dry for very small loads. Change the dryness level setting on Sensor Cycles.
		Increasing or decreasing the dryness level will change the amount of drying time in a cycle. If loads are consistently ending too early, see also Changing the Sensor Dry Default Settings.
Lint on load	Lint screen clogged.	Lint screen should be cleaned before each load.
Stains on load or drum	Dryer fabric softener not properly used.	Add dryer fabric softener sheets at the beginning of the cycle. Fabric softener sheets added to a partially dried load can stain your garments. Drum stains are caused by dyes in clothing (usually blue jeans). These will not transfer to other clothing.
Loads are wrinkled	Load not removed from dryer at the end of the cycle.	Select Wrinkle Prevent feature to tumble the load without heat to avoid wrinkling.
	Dryer tightly packed.	Dry smaller loads that can tumble freely.
Odors	Have you recently been painting, staining, or varnishing in the area where your dryer is located?	If so, ventilate the area. When the odors or fumes are gone from the area, rewash and dry the clothing.
	The electric dryer is being used for the first time.	The new electric heating element may have an odor. The odor will be gone after the first cycle.
Load is too hot	Laundry items were removed from the dryer before the end of the cycle.	Allow the Cool Down cycle to finish before removing laundry from dryer. All cycles are cooled slowly to reduced wrinkling and make it easier to handle. Items removed before Cool Down may feel very warm.
	Was a high temperature cycle used, or was a separate temperature control set on high?	Select a lower temperature, and use an automatic drying cycle. These cycles sense the temperature or the moisture level in the load and shut off when the load reaches the selected dryness. This reduces overdrying.

NOTES

W10462984C

© 2012 Maytag Corporation.
All rights reserved
Tous droits réservés
Todos los derechos reservados