

Table of Contents

- Child Safety Guide1
- Caution and Warning2
- FCC Notice2
- Safety Precautions3
- Check Accessories3
- Select TV Table Stand3
- Select TV Location3
- Connection and Using3
- TV Stand Installation3
- TV Signal Connection4
- Cable Connections4
- Side Panel Connections4
- Connecting AV Composite Video device4
- Connecting HDMI Component device5
- Connecting HDA device5
- How to Obtain Various Levels of Input Signals5
- TV Keys Explanation5
- Keypad and Front Panel6
- Panel Buttons6
- Front Panel6
- Remote Control Instructions6
- Inserting Batteries in the Remote6
- Remote Control Reception Angle6
- Learning about Remote Control6
- Remote Control Buttons6
- Initial Setup7
- Basic Operations7
- Turning On and Off7
- Choosing TV Channel7
- Selecting Input Source7
- Channel Store7
- Activating Volume7
- EPG (Electronic Program Guide)8
- OSD Menu Operations8
- Adjust the OSD Screen8
- Picture Menu8
- Sound Menu9
- Channel Menu9
- Parental Menu9
- Setup Menu10
- Other Menu10
- Frequently Asked Questions (FAQs)11
- Troubleshooting11
- V-Chip Rating Explanations12
- US V-Chip Rating System12
- Canadian English Rating System12
- Canadian French Rating System12
- Wall Mounting Unit Specification13
- USB Media Play13
- Product Specifications13
- Warranty Card14

Child Safety Guide



Conratulations on your purchase!
As you enjoy your new product, please keep these safety tips in mind:

THE ISSUE
The television environment represents a growing need to change the way children use portable products. However, flat panel displays are not always designed for the proper angle or modality according to the manufacturer's recommendations.

- Flat panel displays that use supporting devices (stands, brackets, shelves, spacers, etc.) or other may tilt and house away.

THIS MANUFACTURER CARES!

The company electronic industry is committed to making those environment required for safe.

TUNE INTO SAFETY

- One can use NGF T.V. It follows the manufacturer's recommendations for the safe installation and use of flat panel display.
- Carefully read user's handbook (if included) instructions for proper use of this product.
- Don't allow children to climb on top of play with television set when use.
- Don't place flat panel display on furniture that can easily be used to support such as other displays.
- Remember, flat displays can become excited with watching programs, especially our larger size flat panel display (Class and above sizes), to drop or knock it down.
- Care should be taken to watch children not climb onto furniture that the flat panel display is not being viewed by children or adults.

WALL MOUNTING: IF YOU DECIDE TO WALL MOUNT YOUR FLAT PANEL DISPLAY, ALWAYS:

Use a mount that has been specifically designed for flat panel manufacture and is listed by an independent laboratory such as UL, CSA, TUV.

Follow all instructions supplied for the display and wall mount manufacturer.

If you have any doubts about your ability to safely install your flat panel display, contact your dealer, dealer, contractor, or professional.

Make use the flat wall where you can mounting the display to suspension. Some will result in the required size mount to safely hold and/or tilt when they are combined. If you are unsure, contact your dealer.

A minimum of two people are required for installation. Flat panel display are heavy.



Child Safety Guide



(Muchas gracias por su uso del presente producto! Cuando usted disfruta de su nuevo producto, por favor lea en cualquier los consejos de seguridad.)

POSIBLES PROBLEMAS

- La electricidad de alimentación de este en casa es una tensión fluctuante y la gestión moderna de energía que así muy pequeñas. Sin embargo, los requisitos de energía para un flat panel como en los televisores, estéreos, cámaras, equipos de audio, etc. se incrementan con el tiempo. Los montajes de pantalla plana que se han instalado inadecuadamente en los televisores, estéreos, equipos de audio, etc. se incrementan con el tiempo. Los montajes de pantalla plana que se han instalado inadecuadamente en los televisores, estéreos, equipos de audio, etc. se incrementan con el tiempo.
- La fuente electrónica del computador está controlada a través de un ordenador de mesa que genera un campo magnético de campo.

AJUSTAR HASTA SEGURIDAD

Un técnico de NO es necesario para ello. Una de las recomendaciones de instalación para el propietario incluye el uso de su control de pantalla plana. Use con cuidado y entienda todas las instrucciones adaptadas para el uso seguro de esta tecnología.

- No permita a los niños a subir a equipo o jugar con televisores y video-cámaras.
- No deje que los niños jugar con el control de pantalla plana como si fuera un juguete. Deje que los niños jugar con el control de pantalla plana como si fuera un juguete. Deje que los niños jugar con el control de pantalla plana como si fuera un juguete. Deje que los niños jugar con el control de pantalla plana como si fuera un juguete.

MONTAJE DE PARED: SI USTED DECIDE A MONTAR SU MONITOR DE PANTALLA PLANA A LA PARED, SIEMPRE:

- Use una montaje que sea la recomendada por el fabricante de monitor y/o listado por laboratorios independientes (como UL, CSA, TUV).
- Siga todas las instrucciones e instrucciones de fabricantes de monitor y montaje de pared.
- Si usted tiene cualquier dudas sobre su habilidad para instalar seguramente su monitor de pantalla plana, contacte a su distribuidor para la instalación profesional.
- Compruebe que el panel adhesive está contenido al monitor en cualquier momento que se lo instala. No se deslice hacia ser movido, y asegure que el monitor de pantalla plana se encuentre en su posición correcta. Si usted tiene dudas, contacte a un instalador profesional.
- Por favor no deje niños en la habitación para la instalación. Los montajes de pantalla plana pueden ser pesados.



Caution and Warning

CAUTION
RISK OF ELECTRIC SHOCK
DO NOT OPEN

Caution: To reduce the risk of electric shock, do not remove cover or back. No user-serviceable parts inside. Refer servicing to qualified service personnel.

The lightning flash with arrowhead symbol is intended to alert the user to the presence of uninsulated dangerous voltages within the product enclosure that may be of sufficient magnitude to constitute a risk of electric shock.

The exclamation point within the equilateral triangle is intended to alert the user to the presence of important operating and maintenance (servicing) instructions in the literature accompanying the TV.

FCC Notice

This equipment has been tested and found to comply with the limits for Class B digital devices, pursuant to Part 15 of the FCC Rules. These limits are designed to provide reasonable protection against harmful interference in a residential installation. The equipment generates, uses and can radiate radio frequency energy and, if not installed and used in accordance with the instructions, may cause harmful interference to radio communications. However, there is no guarantee that interference will not occur in a particular installation. If this equipment does cause harmful interference to radio or television reception, which can be determined by turning the equipment off and on, the user is encouraged to try to correct the interference by one of the following measures:

- Reorient or relocate the receiving antenna.
- Increase the separation between the equipment and the receiver.
- Connect the equipment into an outlet on a circuit different from that to which the receiver is connected.
- Consult the dealer or an experienced radio/TV technician for help.

Safety Precautions

1. Read these instructions.
2. Keep these instructions.
3. Heed all warnings.
4. Follow all instructions.
5. Do not use this apparatus near water. For example, do not use near a laundry tub, a wet basement, or near a swimming pool.
6. Clean only with dry cloth.
7. Do not block any ventilation openings. Install in accordance with the manufacturer's instructions. Slots and openings in the cabinet back or bottom are provided for ventilation, to ensure reliable operation of the TV and to protect from overheating. These openings must not be blocked or covered. The openings should never be blocked by placing the TV on a book, sofa, rug, or other similar surface.
8. Do not install near any heat sources such as radiators, heat registers, stoves, or other apparatus (including amplifiers that produce heat).
9. Do not defeat the safety purpose of the polarized or grounding-type plug. A polarized plug has two blades; one wider than the other. A grounding-type plug has two blades and a third grounding prong. The wide blade or the third prong is provided for your safety. If the provided plug does not fit into your outlet, consult an electrician for replacement of the obsolete outlet.
10. Protect the power cord from being walked on or pinched particularly at the appliance, convenient receptacles, and the point where they exit from the appliance.
11. Use only accessories (wall brackets, stands) specified by the manufacturer, or sold with the apparatus. When a cart is used, use caution when moving the cart/appliance combination to avoid injury from a falling A.T.V. and cart combination should be moved with care. Quick stops, excessive force, and uneven surfaces may cause the TV and cart combination to overturn.
12. Unplug this apparatus during lightning storms or when seldomed for long periods of time. For added protection for this TV, unplug during a lightning storm, or when it is left unused for long periods of time, unplug from the wall outlet and disconnect antenna or cable system. This will prevent damage to the TV due to lightning and power surges.
13. Refer all servicing to qualified service personnel. Servicing is required when the equipment has been damaged in any way, such as:

power supply cord or plug is damaged, liquid has been spilled or objects have fallen into the apparatus, the apparatus has been exposed to rain or moisture, does not operate normally, or has been dropped.

16. This TV should be operated only from the type of power supply indicated on the rating label. If customer is not sure the type of power supply in your home, consult your appliance dealer or local power company. For TV remote control battery power, refer to the operating instructions.
16. The TV set shall be exposed to dripping or splashing. No objects filled with liquids, such as vases, shall be placed on the TV set.
17. Never push objects of any kind into the TV through openings as they may touch dangerous voltage or other electrical parts that could result in fire or electric shock. Never call liquid of any kind into the TV.
18. Unplug the TV from the wall outlet before cleaning. Do not use liquid or aerosol cleaners. Use a damp cloth for cleaning.
19. This TV should never be placed near or over a radiator or heat source. This TV should not be placed in a built-in installation such as a bookcase or rack unless proper ventilation is provided or the manufacturer's instructions have been adhered to.
20. Do not place the TV on an unstable cart, stand, tripod, bracket, or table. The TV may fall, causing serious injury to persons, and serious damage to the appliance.
21. Do not attempt to service this TV by yourself because opening or removing covers may expose you to dangerous high voltage or other hazards. Refer all servicing to qualified service personnel.
22. The device complies with Part 15 of the FCC Rules. Operation is subject to the following two conditions: (1) the device may not cause harmful interference, and (2) this device must accept any interference received, including interference that may cause undesired operation.
23. WARNING: To prevent injury, this apparatus must be securely attached to the floor/ceiling in accordance with the installation instructions.
24. To reduce the risk of electric shock, the grounding of center pin of plug must be maintained.

If an outside antenna or cable system is connected to the TV, be sure the antenna or cable system is grounded to provide noise protection against voltage surges and built-up static charges. Section 910 of the National Electrical Code, ANSI/NFPA 70, provides information with respect to proper grounding of the mast and supporting structure, grounding of the lead-in wire to an antenna discharge unit, size of grounding conductor, location of antenna discharge unit, connection to grounding electrode, and requirements for the grounding electrode. (See Figure A)

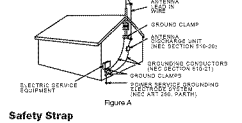

Safety Strap

Caution: Flipping, pulling or drabing on the TV may cause the TV falling. Do not let children climb or hang on the TV. Always place the TV on a sturdy, level, stable surface that can hold the weight of TV. And if possible, secure the TV according to the instruction below (Note: The backing components such as screws are not supplied with TV). Step one: Insert the left mounting screws into the upper two wall mounting screw holes and fasten them (Figure B).

Step two: Insert anchors to wall and connect the bolts and anchors with nuts or walts (Figure C).

Always unplug the AC cord first when installing/removing the stand.

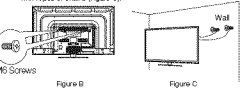

Preparation for Your New TV

Before Turning On TV
Check Accessories that are packed with your TV.

The accessories that are packed with your TV include:

- REMOTE CONTROL
- AAA BATTERIES
- TV STAND SCREWS
- TV STAND NUTS
- TV STAND BOLTS
- TV STAND ANCHORS
- TV STAND BRACKET
- TV STAND SCREWS
- TV STAND BOLTS

Documents included:

- USER'S GUIDE
- QUICK START GUIDE
- PATENT CARD

Setup TV Table Stand

Please refer to TV Stand Installation guide in next page to carry out stand installation.

Select TV Location

Select a flat, stable table to place your TV set. Please follow the Safety instructions when placing the TV.

TV Stand Installation

TV LED65SR1200 is packaged with the TV stand separated from the cabinet. To setup the TV table stand, please carry out the installation according to the instructions below.

Step One:
Place the TV faced down on a soft cloth or cushion to prevent the LED LCD panel from being damaged.

The LED LCD panel can be scratched easily, so please:
1. Choose an absolutely flat surface to place the TV on.
2. Use soft cloth or cushion to place the TV panel.
Do not put TV on the table directly.

Step Two:
Take the rack. Please align the screw holes of the rack and the TV, and then insert the 4 screws into the 4 holes on the rack and tighten them.

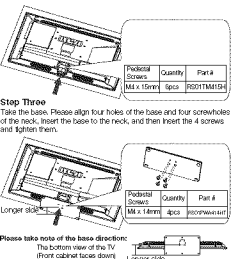

TV Signal Connection

The first step to connecting your TV is obtaining the signal. Your TV LED60E65F120Q has a back panel, which allows you to receive analog and/or digital television channels via ANTICABLE Jack. Before connecting your TV, determine using an antenna or a cable service to obtain the signal.

- A. Antenna**
Connect the antenna to TV via coaxial cable on ANTICABLE Jack of the back panel. You are ready to receive all local digital and analog channels.
- B. Cable TV service**
Connect the cable TV wall jack to TV via coaxial cable on ANTICABLE Jack of the back panel. You are ready to receive all local digital and analog channels.
- C. Set-Top Box**
If you use a set-top box, you may need to call your cable company or satellite service provider, which uses a special connection, please refer to the user's guide of set-top box.

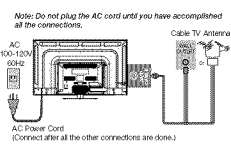

Cable Connections

Choose Your Connections
TV LED60E65F120Q supports various connections to other devices (such as DVD, VCR, Set-top box, etc.). Please follow the table to choose the cables which adapt to your device.

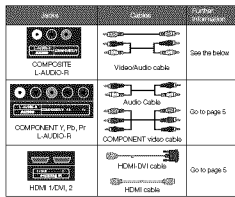

Note: HDMI, the HDMI logo, and High-Definition Multimedia Interface are trademarks or registered trademarks of HDMI Licensing LLC.
Caution: Unplug the AC cord when you connect other devices to TV.

Side Panel Connections

Connecting AV Composite device (Good Video Quality)

Composite connector will be shared with Component Y connector. To connect a composite AV device, such as a DVD player, follow these steps:
1. Connect the COMPOSITE Jack on the side of TV to the video output jacks of device via video cable (yellow).
2. Connect the AUDIO-R Jacks on the side of TV to the audio output jacks of device via audio cable.
Note: The left channel jack and plugs are white and the right channel jack and plugs are red.
Note: AV signal carries to composite video. This kind of video signal has lower display quality.

Composite Video Connection

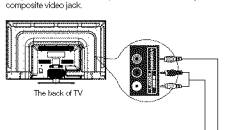

Connecting HDMI device (Best Video Quality)

To connect a HDMI device, such as a DVD player, please connect the HDMI/DVI Jack on the side of TV to the output jacks of device via HDMI cable.
To connect a DVI device, via DVI port of PC or Device and HDMI Jack of TV:
1. Connect the HDMI/DVI Jack on the side of TV to the DVI port of PC or HDMI/DVI cable.
2. Connect the AUDIO-R Jack on the side of TV to the audio output jacks of computer with audio cable (each channel RCA jacks to 5.0mm stereo jack or the AUDIO-R jacks).
Note: 1. HDMI High-Definition Multimedia Interface is a compact audio/video interface for transmitting uncompressed digital data. It carries the audio and video signals via the same cables and has the best display quality.
2. HDMI/DVI cable transfers only video signals from DVI port of DVI device to HDMI Jack of TV. For audio signal, please connect audio cable to L-AUDIO-R Jack on TV back panel.

HDMI Connection

The picture below is an example of a connection using the HDMI video Jack.

Connecting YPbPr Component device (Better Video Quality)

To connect a component device, such as a DVD player, follow these steps:
1. Connect the COMPONENT IN YPbPr Jack on the side of TV to the video output jacks of device via video cable (green, blue and red).
2. Connect the AUDIO-R Jacks on the side of TV to the audio output jacks of device via audio cable.
Note: The left channel jack and plugs are white and the right channel jack and plugs are red.

Note: YPbPr Jacks are component video. This kind of video signal has better display quality.

Component Video Connection

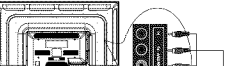

How to Obtain Various Kinds of Input Sources

After connection is done, press INPUT button on remote control or TV top panel to the input source you need. See page 7, Basic Operation of TV.

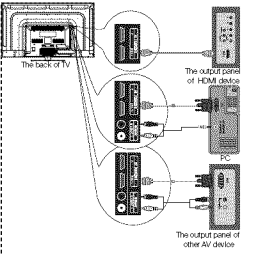

TV Jacks Explanation

- HEADPHONE**: Connect a 3.5mm headphone for personal audio.
- USB**: Connect your USB storage device to enjoy music/photo files on your TV. (Also used for service purpose).
- HDMI/DVI 2**: High-Definition Multimedia Interface. It provides an uncompressed digital connection that carries both video and audio data by use of an integrated multi-cable.
- COMPONENT YPbPr**: Connect a device that has component video jacks, such as a DVD player. To access device connected to the YPbPr Jack, press the INPUT button on your remote; then press the OPTION arrow to select Component. Press the ENTER button at last to confirm.
- YPbPr (Component Video)**: This provides good picture quality because the video signal is separated into three components. Use three video-gauge or component video cables for the connection. When using YPbPr, make sure you connect left and right audio cables to the AUDIO-R Jacks.
- L-AUDIO-R, COMPOSITE**: Connect an AV Jacks that has composite video jacks, such as a VCR or a DVD player. To access device connected to these jacks, press the INPUT button on your remote; then press the OPTION arrow to select AV. Press the ENTER button at last to confirm.
- AUDIO IN L**: Left audio channel connection. The left audio connector is usually white. For mono audio sources, be sure to use the left AUDIO IN L.
- AUDIO IN R**: Right audio channel connection. The right audio connector is usually red.
- ANTICABLE**: Connect to receive the signal from your antenna or cable via coaxial cable.
- Digital Audio out**: Connect a coaxial cable for digital audio output.

Remote Control Instructions

- Remove the cover of battery cabin on the back of the remote control by lifting the cover.
- Insert two AAA batteries, making sure the polarities (+ and -) are signed correctly.
- Place the cover back.

If the remote control does not work, check these points:

- Are the batteries (+, -) correct?
- Are the batteries inserted?
- Is there an AC power failure?
- Is the power cord plugged in?
- Is there any interference of block near the remote control sensor?

Keypad and Front Panel

Keypad Buttons
If you cannot locate your remote, you can use the keypad buttons on your TV to operate many TV features.

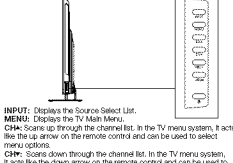

Universal Remote Control Code List

- Codes for DIRECTV: 0178, 10178
- Codes for Time Warner Cable: 0178, 10178
- Codes for Cox Communications: 0178
- Codes for Comcast: 10178
- Codes for Dish Network: 027
- Codes for Net Network: 0205, 0487, 0491, 0775

Learning about Remote Control

Remote Control Buttons
MUTE (M): Reduces the TV volume to its minimum level.
POWER (P): Turns the TV on or off.
CHANNEL (C): Displays the channel list.
FAV: Access the favorite channel list of your favorite list, or saves the current channel from your favorite list if this channel is a favorite channel ahead.
FAV: or FAV: : Scroll up or down through the current favorite channel list.
Numeric Buttons: Use these buttons to enter numbers.
< : To enter a digital channel with a sub-channel, enter the main channel, then press this button to enter the sub-channel and press ENTER.
Back (B): Returns to the previous channel.
EPC Shows Electronic Program Guide (see page 8).
INPUT: Accesses the available input channels (TV, AV, Component, HDMI 1/2, Media). Use the arrows to highlight options, and press ENTER to select.
Arrow (A): Use the four arrows to highlight different items in the TV menu or change the value. The up/down arrow can also work as CH+CH- button, and the left/right arrow can also work as VOL+VOL- button.
ENTER: Enter and confirm button.
MENU: Accesses the Main Menu, or return to the top level of a submenu.
FREEZE: Freeze the current screen frame, press again to return to normal.
DISPLAY: Displays the Channel Bar (see page 7).
EXIT: Exit the current menu or function.
VOL- or VOL+: Increases or decreases the TV volume.

Remote Control Reception Angle

Use your remote control within the distance and angle range shown below.

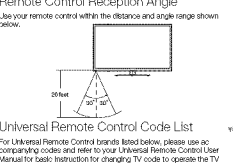

Keypad and Front Panel

CAUTION:

- Do not use old or worn-out batteries together.
- DO NOT use new and old batteries together.
- Change both the batteries at the same time.
- When not using the remote controller for a long time, remove the batteries from the unit.

Initial Setup

FR is the first time you turn on your TV, or you have done Clear Channel List option (see page 10), the Initial Setup menu appears automatically.



Choosing TV Channel

Tuning To Analog Channels
An analog channel has a channel number beginning with "4". Input the digital number with numeric buttons directly and press ENTER button on remote control, and input the sub number at last. For example, to watch analog channel "45T", press "0", "4", "5", "T", "ENTER" on remote control in sequence.
Note: Although there is no analog TV signal available in America, we reserve a TV channel for system adjustable use.

Tuning To Digital Channels

A digital channel has a channel number beginning with "0". Input the main digital number with numeric buttons directly, then press "1" button on remote control, and input the sub number at last. For example, to watch analog channel "031-1", press "0", "3", "1", "1", "ENTER" on remote control in sequence.

Changing Channels Directly

You can use CH+ button to increase channel number and CH- to decrease channel number. When No OSD (On-Screen Display) is used, the up/down arrows can also work as CH+CH- buttons.

Selecting Input Source



Channel Bar

Press the DISPLAY button on the remote control, the channel bar will appear on the top right corner of the screen. It displays the current channel's information. The following list describes the items on the channel bar.

Basic Operations

Tuning On Off

Connect the AC cord to power the LED LCD TV. At this time the TV will enter standby mode and power indicator will turn red. Use Power button on the top panel of TV or on the remote control to turn on the TV. After switching off the TV for 6 seconds, you can turn on TV again.

Adjusting Volume

Press the VOL+VOL- buttons on the remote control to adjust the volume. If you want to muter sound off, press MUTE (M). When OSD (On-Screen Display) is not used, the arrows MUTE can also work as VOL+VOL- buttons.

Channel Bar

If the channel is analog A is displayed. If it's a digital channel, D is displayed. For example, in the picture above, AC is an analog channel, and 030-1 is a digital channel (-1 is a sub-channel number).

MUTE/VIDEO-ND
Mute/English
4800i/DSR
16:9/CV-TV-PG
Oct 31 23:14 Mon
Adjusts current date and time.

Press the VOLUME buttons on the remote control to adjust the volume. If you want to muter sound off, press MUTE (M). When OSD (On-Screen Display) is not used, the arrows MUTE can also work as VOL+VOL- buttons.

Press the DISPLAY button on the remote control, the channel bar will appear on the top right corner of the screen. It displays the current channel's information. The following list describes the items on the channel bar.

ATV DTV
A2/D50-1
Mute/English
4800i/DSR
16:9/CV-TV-PG
Oct 31 23:14 Mon

Press the DISPLAY button on the remote control, the channel bar will appear on the top right corner of the screen. It displays the current channel's information. The following list describes the items on the channel bar.

ATV DTV
A2/D50-1
Mute/English
4800i/DSR
16:9/CV-TV-PG
Oct 31 23:14 Mon

Press the DISPLAY button on the remote control, the channel bar will appear on the top right corner of the screen. It displays the current channel's information. The following list describes the items on the channel bar.

ATV DTV
A2/D50-1
Mute/English
4800i/DSR
16:9/CV-TV-PG
Oct 31 23:14 Mon

Press the DISPLAY button on the remote control, the channel bar will appear on the top right corner of the screen. It displays the current channel's information. The following list describes the items on the channel bar.

ATV DTV
A2/D50-1
Mute/English
4800i/DSR
16:9/CV-TV-PG
Oct 31 23:14 Mon

Press the DISPLAY button on the remote control, the channel bar will appear on the top right corner of the screen. It displays the current channel's information. The following list describes the items on the channel bar.

ATV DTV
A2/D50-1
Mute/English
4800i/DSR
16:9/CV-TV-PG
Oct 31 23:14 Mon

Press the DISPLAY button on the remote control, the channel bar will appear on the top right corner of the screen. It displays the current channel's information. The following list describes the items on the channel bar.

ATV DTV
A2/D50-1
Mute/English
4800i/DSR
16:9/CV-TV-PG
Oct 31 23:14 Mon

