

INSTALLATION CHECKLIST

1 CARRYING THE WASHER

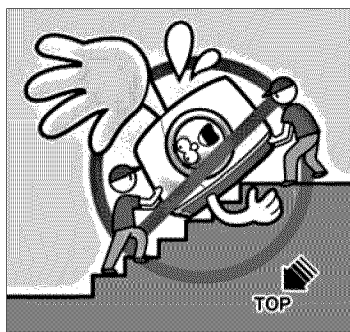

- ▶ While transporting the washer, the shipping bolts should be fixed. Do not turn washer over by more than 180 degrees. When carrying the washer, make sure that the top of the washer is always facing upwards.

NOTE

After unpacking the washer and moving it to its final location, check the rubber bottoms of the leveling legs to make sure they are clean and undamaged. Dirty or damaged feet can contribute to excess noise and vibration.

2 SHIPPING BOLTS

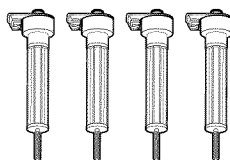

- ▶ Before using your Washer, you must remove the four shipping bolts from the back of the unit.

- Loosen all the bolts with the supplied wrench.
- Slide the bolt and spacer up and remove the bolt with the spacer through the hole in the rear wall of your washer. Repeat for each bolt.
- Fill the holes with the supplied plastic covers.

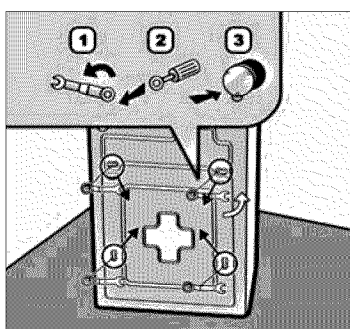

CAUTION

Failure to remove the four shipping bolts can cause severe vibration and noise during operation, will damage the washer and can cause property damage.

NOTE

Save the four shipping bolts and the wrench for future use. To prevent damage to the washer if it must be moved, reinstall the shipping bolts before transporting the washer.

3 CONNECT WATER HOSES

- ▶ Connect the water supply hoses to the HOT and COLD water faucets tightly by hand and then tighten another 2/3 turn with pliers. Turn on the water faucets and check for leaks.

NOTE

To ensure sufficient clearance for water lines, allow minimum clearances of at least 4 in. (10 cm) behind the washer.

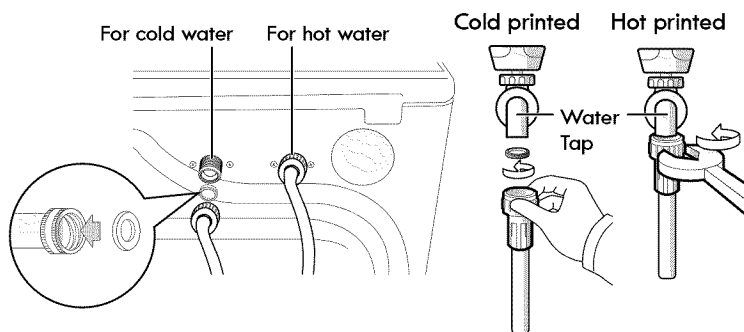

CAUTION

Use ONLY the inlet hoses provided with this laundry product. After-market hoses are not guaranteed to fit or function correctly. Other hoses may not tighten correctly and could cause leaks. Subsequent damage to product or property will not be covered under the terms of the warranty.

NOTE

The water pressure should be between 20~116 psi (137~800kPa) when the taps are turned on. If the water pressure is high, water hammering noise can occur when the valves are turned on/off. This is not product defect and a pressure regulator valve must be installed.

4 SELECTING A LOCATION

- ▶ Do not install your washer on a soft, unlevel surface. Do not install your washer on carpet. Install your washer on a hard, level surface.

NOTE

Before installing the washer, make sure the floor is clean, dry and free of dust, dirt, water and oils so the washer feet can not slide easily. Leveling feet that can move or slide on the floor can contribute to excess vibration and noise due to poor contact with the floor.

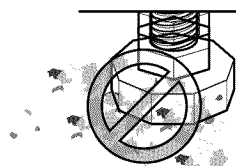

5 CONNECT POWER CORD

Plug the power cord securely into a properly grounded 120V/60Hz 3-prong outlet which is protected by a 15-amp fuse or circuit breaker.

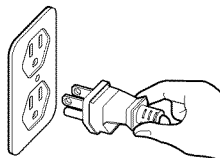

6 CONNECT DRAIN HOSE

NOTE

Before installing the drain hose, clean the inside of standpipe with liquid chlorine bleach.

- ▶ Ensure that the connection between the drain hose and the stand pipe is NOT airtight. The stand pipe must be at least 18 in. (46cm) high. In case the drain hose cannot be conveniently elevated, it must be supported. Please use the provided supporter.

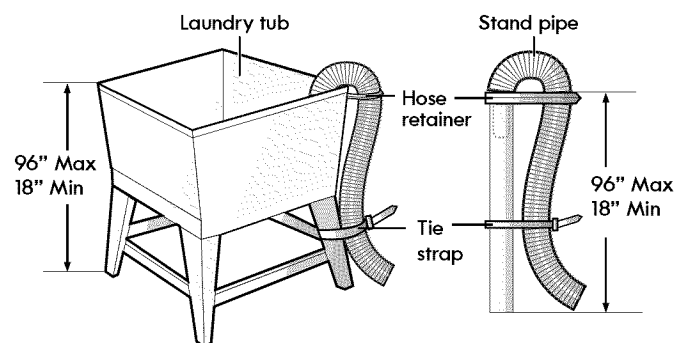
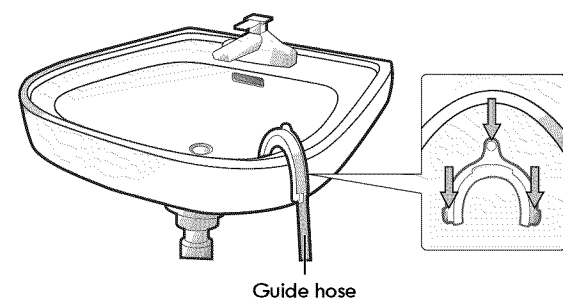

- ▶ Both the inlet and drain hoses should not be twisted or tangled. Ensure all hoses are unknicked to prevent water drainage and supply problems.

7 PERIODICALLY CLEAN FILTER

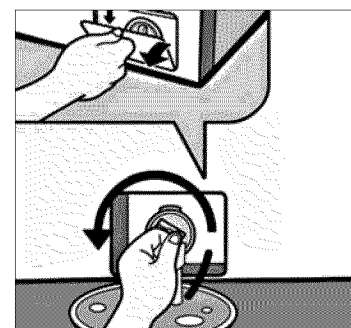

- ▶ To clean the filter, first open the cover, drain the water trapped in the drain tube, turn the cap counter clockwise, then loosen any debris. Prepare a large bucket to catch the drained water. Regularly clean the filter once every two months.

8 LEVEL WASHER

To level the washer on the floor, adjust the legs as follows.

Diagonal Leveling Check

If the floor is not even, adjust the legs when pushing down the edges of the washer top plate diagonally, the washer should not move up and down at all. (Please check both directions.) If the washer rocks when pushing the top plate diagonally, adjust the legs with the included wrench.

- ▶ Make sure that all four legs are stable and resting on the floor firmly. Then check that the washer is perfectly leveled. (Use a level.)

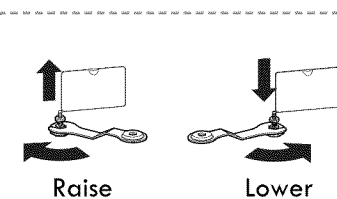
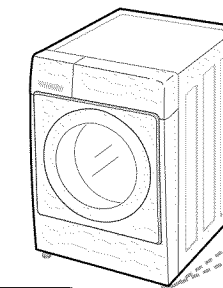
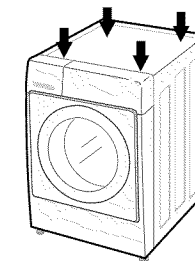

NOTE

Do not extend the legs more than necessary to level the washer. The more the legs are extended, the more the washer will vibrate.

- ▶ After the washer is leveled, tighten the lock nuts up toward the base of the washer using the wrench or (-) flathead screwdriver. All four lock nuts should be tightened.

- ▶ It is critical to adjust the legs perfectly. The final leveling check must be done while the washer is spinning with a real load. Run the washer with a test load to make certain your washer is properly leveled. Put approximately 6 pounds (or approx. 3 kg) of laundry in the washer tub. Then, press POWER (⊙), RINSE & SPIN or EXPRESS WASH, and START/PAUSE (▶), in that order. When the machine spins at high speed, verify that it is stable. If not, adjust the legs accordingly.

Use the supplied wrench to adjust the legs until there is no vibration. Then tighten the lock nuts to prevent further adjustment.

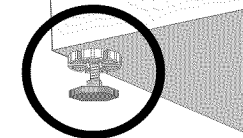
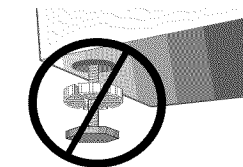
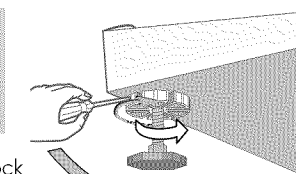

9 CHECK LIST

✓	INSTALLATION STEP
	Is the washer leveled and securely placed on the floor?
	Are the shipping bolts removed?
	Do excessive vibrations and noise occur while running the spin test?
	Are the lock-nuts on the legs fastened securely?
	Are both water taps open and supplying water?
	Are both inlet water hoses connected correctly? (Not switched)
	Is there a water leak at the connection points?

- * Please consult your Owner's Manual for more details.
- * Retain it for future reference.