

Sears
owners
manual

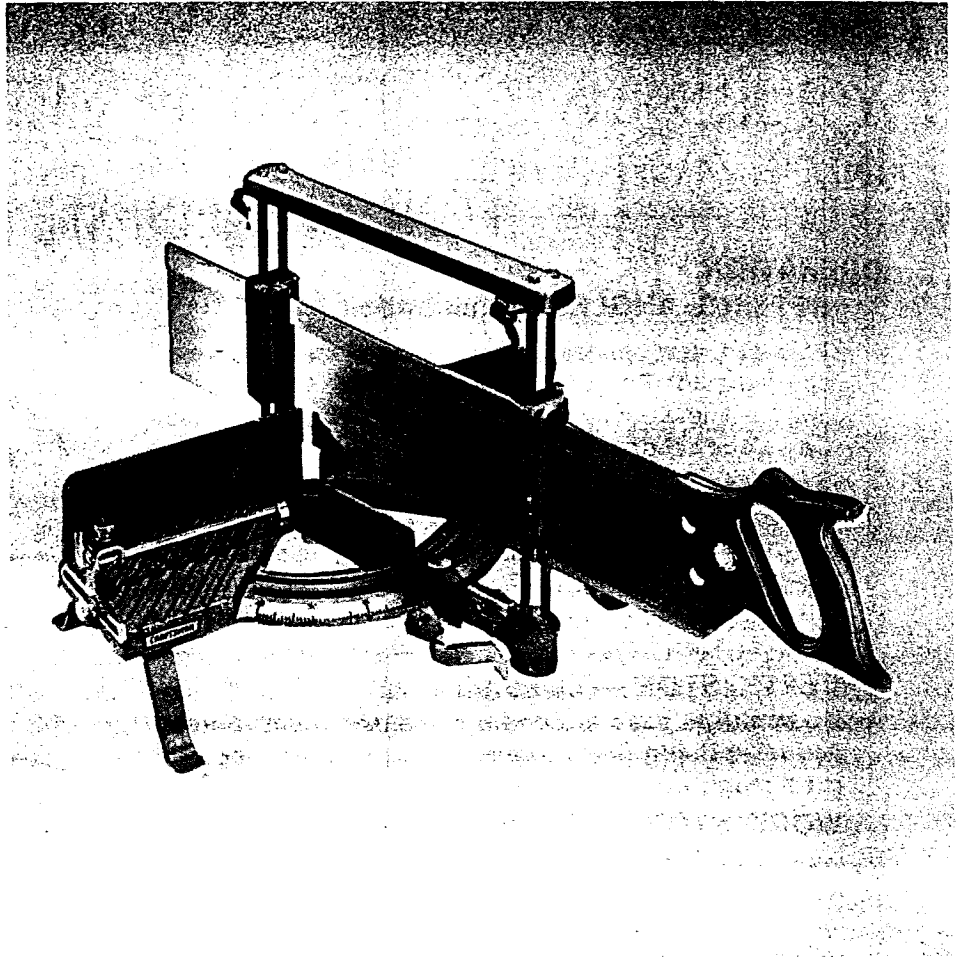

MODEL NO.

CRAFTSMAN
MITER BOX

Operating Instructions
Repair Parts

30001

YOUR NEW CRAFTSMAN MITER BOX HAS BEEN ADJUSTED AND CHECKED AND IS READY FOR IMMEDIATE USE

OPERATION

SETTING ANGLES — Illustration #1

To move saw guides, raise yellow Cam Lock Lever, pull Indicator Pin and move pivot arm to any desired angle. Release Indicator Pin and press down on yellow Cam Lock Lever.

SAW HANGER — Illustration #2

The Saw Hangers are designed to hold your saw while you are setting your angles, or placing and removing work from the cutting surface. To engage Saw Hangers, raise saw to top of guide rods. To release saw, lift front and rear saw hangers and saw can be lowered.

DEPTH STOP — Illustration #3

If saw strikes base, loosen front and rear Thumb Screws and raise Depth Stop. Tighten Screws. If saw does not cut through work, lower Depth Stop.

WORK STOP — Illustration #4

Wood pieces of equal lengths can be cut by using the work stop bracket as illustrated. For multiple cuts longer than 14", a longer rod would be required.

WORK CLAMP — Illustration #5

Work can be held by using the cam on the opposite end of the work stop as illustrated.

IMPORTANT: This Miter Box was adjusted, saw tested, and carefully checked for accuracy at the factory. Check carefully before making adjustments.

ADJUSTMENTS:

Problem: Cutting inaccurate angles.

Solution: Illustration # 6

Set angle indicator pin in 0° notch. Loosen Screws and raise cam lock lever. Holding square or right triangle lightly against the saw, move pivot arm either left or right until the saw is at right (90°) angle to the back. Tighten screws. After tightening screws, check your setting with square for accuracy. Now your tool is once again in perfect adjustment.

Problem: Saw fits guide too loose or too tight.

Solution: Illustration #7.

Insert saw through the guides with the stiff back of your saw above top rollers. Loosen slightly four screws and 2 bolts. Turn both saw guide assemblies until saw wobble is eliminated. Hold guide assemblies in this position while tightening screws and bolts. The saw then should guide easily and smoothly. Clearance between the saw and rollers should be about the thickness of one sheet of newspaper. Adjust depth stops (illustration 3) so saw teeth do not touch the base.

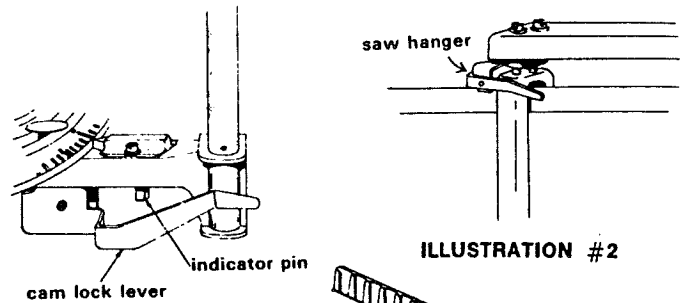

ILLUSTRATION #1

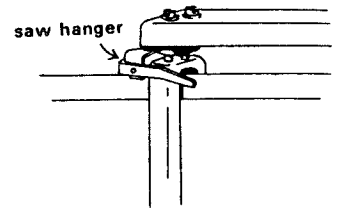

ILLUSTRATION #2

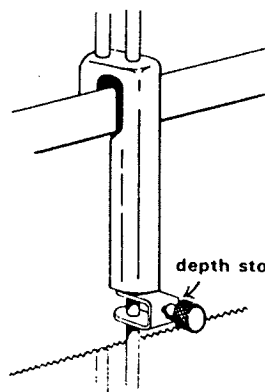

ILLUSTRATION #3

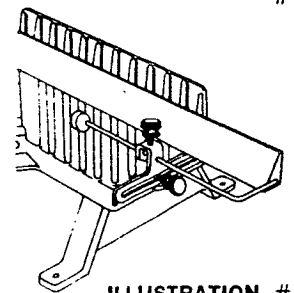

ILLUSTRATION #4

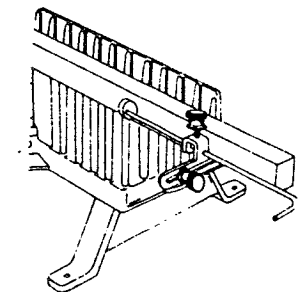

ILLUSTRATION #5

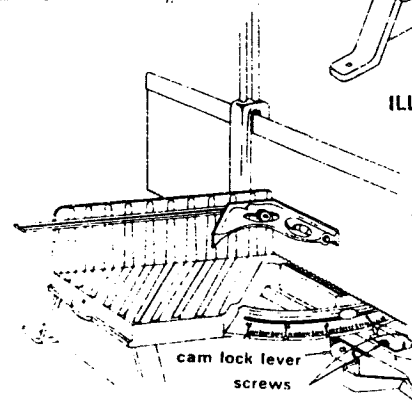

ILLUSTRATION #6

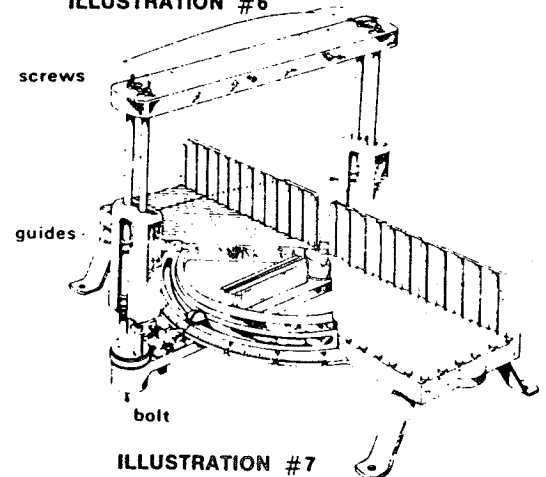
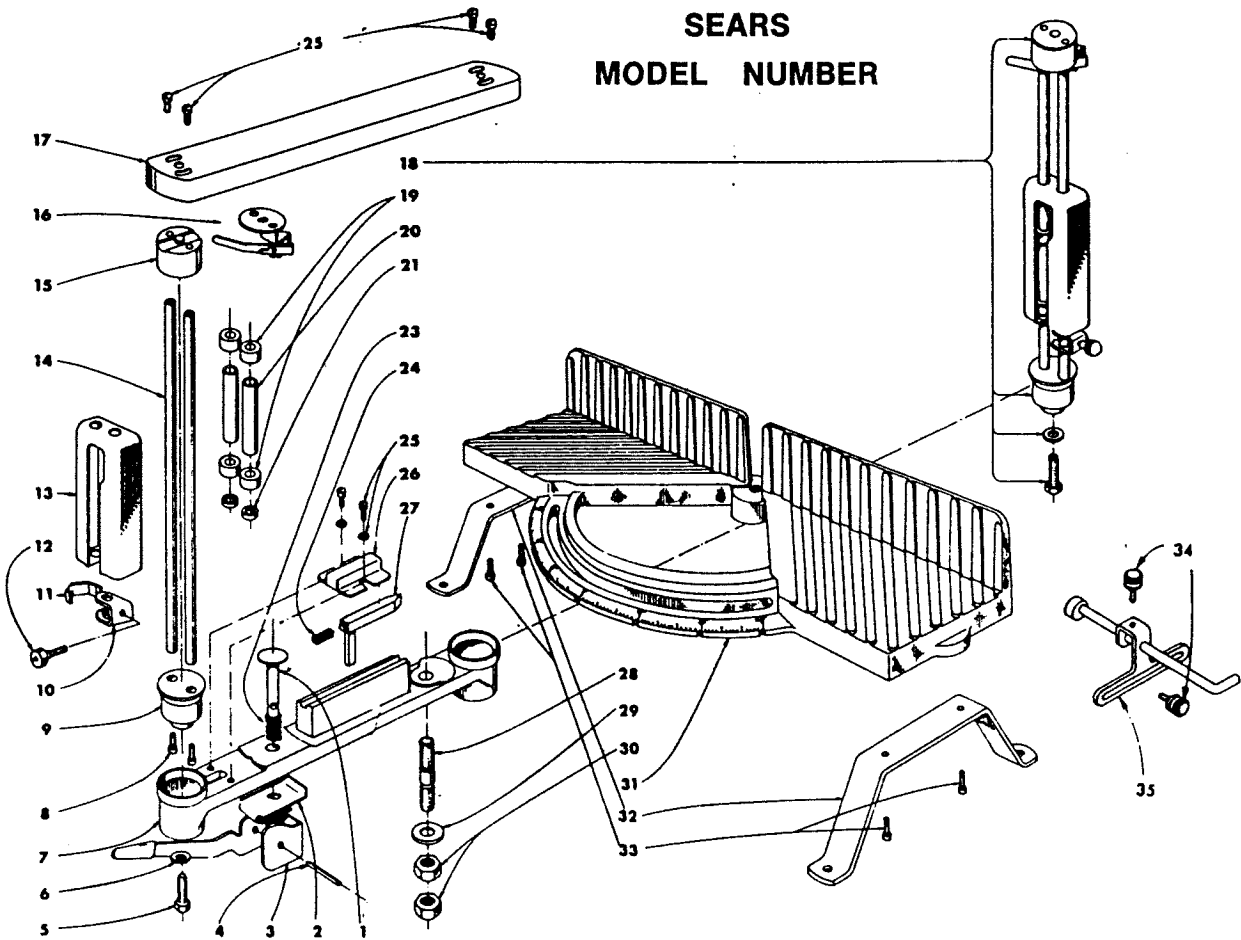

ILLUSTRATION #7

SEARS MODEL NUMBER



KEY NO.	PART NO.	DESCRIPTION	NO. OF PARTS REQ.	KEY NO.	PART NO.	DESCRIPTION	NO. OF PARTS REQ.
	30001	Instructions & Parts List—Not Illustrated		20	3020	Roller Spacer—Upper	4
1	8036	Clamp Pin	1	21	3021	Roller Spacer—Lower	4
2	80461	Cam Support	1	23	8040	Compression Spring	1
3	8041	Cam Lock Lever	1	24	3024	Compression Spring	1
4	8047	Roll Pin—3/16" x 1-1/2"	1	25	3025	Machine Screw Fillister Head Sems— #10-32 x 3/8"	6
5	3005	*Hex Head Bolt—1/4-20 x 3/4"	2	26	3026	Indicator Pin Retainer	1
6	3006	*Plain Washer—9/32" ID x 5/8" OD	2	27	3027	Indicator Pin	1
7	30071	Pivot Arm	1	28	3028	Pivot Stud	1
8	4006	Machine Screw Fillister Head 10-32 x 7/16"	4	29	3029	*Flat Washer—1/2" ID x 1" OD	1
9	3009	Carrier Rod Support	2	30	3030	Lock Nut-1/2-20	1
10	30101	Depth Stop Stamping	2	31	3031	Miter Box Base	1
11	30111	Depth Stop Shoe	2	32	3032	Base Leg	2
12	3012	Special Thumb Screw	2	33	3033	Tapping Screw—#10-24 x 1/2"	4
13	3013	Roller Guide Carrier	2	34	4017	Special Knurled Thumb Screw	2
14	3014	Roller Carrier Rod —11-5/8"	4	35	4018	Work Clamp and 14 1/2" Stop Assembly	1
15	3015	Guide Carrier Rod Cap	2		2400	4" x 24" Back Saw—Not Illustrated	
16	30161	Saw Hanger	2				
17	3017	Top Rod Support	1				
18	3018	**Saw Guide—Complete Assembly					
19	3019	Saw Guide Roller	8				

*Standard Hardware Items—May be purchased locally
 **Front & Rear Saw Guide are identical

THE MODEL NUMBER WILL BE FOUND ON THE BASE LEG. ALWAYS MENTION THE MODEL NUMBER IN ALL CORRESPONDENCE REGARDING YOUR MITER BOX OR WHEN ORDERING REPAIR PARTS.

Sears
owners
manual

**SEARS
MODEL NUMBER**

SEARS NATIONWIDE
SERVICE
IS AT YOUR SERVICE

ANOTHER QUALITY CRAFTSMAN TOOL

The Model Number will be found on the base leg. Always mention the Model Number when requesting service or repair parts for your Craftsman Miter Box.

All parts listed herein may be ordered from any SEARS, ROEBUCK AND CO. or SIMPSONS-SEARS LIMITED retail or catalog store. If the parts you need are not stocked locally, your order will be electronically transmitted to a Sears Repair Parts Distribution Center for expedited handling.

**WHEN ORDERING REPAIR PARTS, ALWAYS GIVE THE
FOLLOWING INFORMATION SHOWN ON THIS LIST:**

1. The PART NUMBER.
2. The PART DESCRIPTION.
3. The QUANTITY DESIRED.
4. The NAME OF ITEM.
5. The MODEL NUMBER.

Your Sears merchandise takes on added value when you discover that Sears has over 2,000 Service Units throughout the country. Each is staffed by Sears-trained, professional technicians using Sears approved parts and methods.

Sears, Roebuck and Co., Chicago, Ill. 60684 U.S.A.
and Simpsons Sears Limited, Toronto, Ontario